

All the electrical circuits in your car have fuses to protect them from a short circuit or overload. These fuses are located in two fuse boxes.

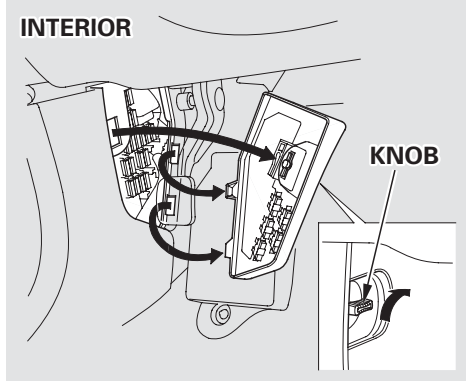

The interior fuse box is underneath the dashboard on the driver's side. To open it, turn the knob as shown.

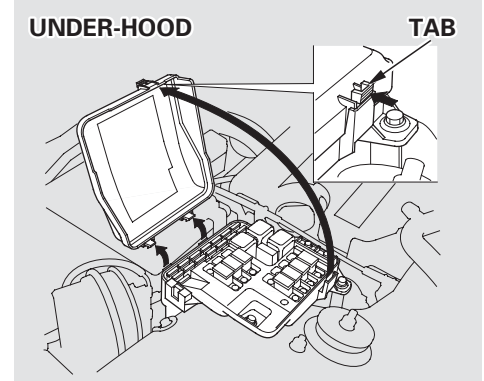

The under-hood fuse box is located in the engine compartment next to the battery. To open it, push the tab as shown.

Fuses

Checking and Replacing Fuses

If something electrical in your car stops working, the first thing you should check for is a blown fuse. Determine from the chart on pages 304 and 305, or the diagram on the fuse box lid, which fuse or fuses control that component. Check those fuses first, but check all the fuses before deciding that a blown fuse is not the cause. Replace any blown fuses and check the component's operation.

1. Turn the ignition switch to LOCK (0). Make sure the headlights and all other accessories are off.
2. Remove the cover from the fuse box.

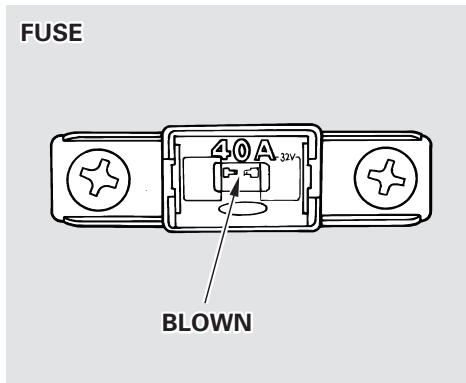

3. Check each of the large fuses in the under-hood fuse box by looking through the top at the wire inside. Removing these fuses requires a Phillips-head screw-driver.

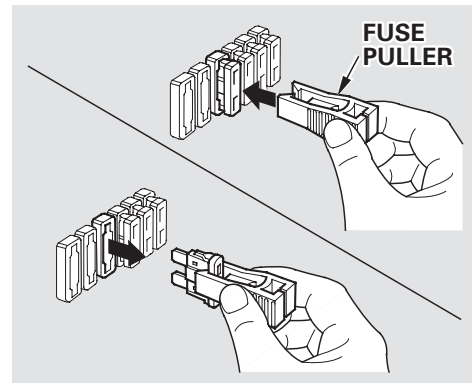

4. Check the smaller fuses in the under-hood fuse box and all the fuses in the interior fuse box by pulling out each fuse with the fuse puller provided in the door of the interior fuse box.

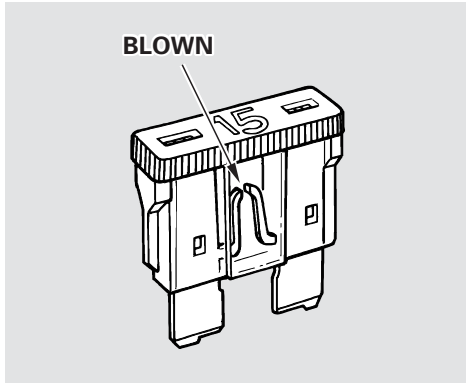

5. Look for a burned wire inside the fuse. If it is burned, replace it with one of the spare fuses of the same rating or lower.

If you cannot drive the car without fixing the problem, and you do not have a spare fuse, take a fuse of the same rating or a lower rating from one of the other circuits. Make sure you can do without that circuit temporarily (such as the cigarette lighter or radio).

If you replace the blown fuse with a spare fuse that has a lower rating, it might blow out again. This does not indicate anything wrong. Replace the fuse with one of the correct rating as soon as you can.

NOTICE

Replacing a fuse with one that has a higher rating greatly increases the chances of damaging the electrical system. If you do not have a replacement fuse with the proper rating for the circuit, install one with a lower rating.

6. If the replacement fuse of the same rating blows in a short time, there is probably a serious electrical problem in your car. Leave the blown fuse in that circuit and have your car checked by a qualified mechanic.

If the radio fuse is removed, the audio system will disable itself. The next time you turn on the radio you will see “Code” in the frequency display. Use the Preset buttons to enter the five-digit code (see page [156](#)).

CONTINUED

Fuses

UNDER-HOOD FUSE BOX

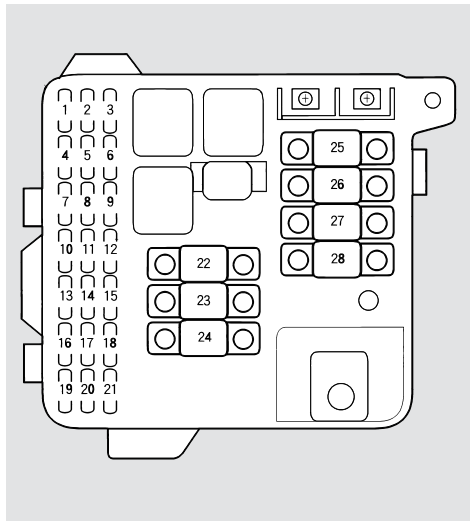

No.	Amps.	Circuits Protected
1	—	Not Used
2	20 A	Stop, Horn
3	10 A	Hazard
4	20 A	Driver Power Window
5	15 A	TCS
6	20 A	VSA
7	20 A	Power Door Lock
8	20 A	Right Headlight Low
9	20 A	Left Headlight Low
10	20 A	Cooling Fan
11	10 A	Left Headlight High
12	10 A	Right Headlight High
13	20 A	Condenser Fan
14	30 A	Moonroof
15	30 A	Front Passenger's Power Seat

No.	Amps.	Circuits Protected
16	20 A	Front Fog Light
17	20 A	ETS (Electrical Tilt/ Telescope Steering)
18	15 A	Meter
19	7.5 A	Back-up, Radio
20	20 A	Interior Lights
21	30 A	Wiper Motor
22	50 A	Ignition Switch
23	40 A	Power Window
24	40 A	Heater Motor
25	120 A	Battery
26	40 A	VSA Motor
27	40 A	Rear Window Defogger
28	50 A	Fuse box

INTERIOR FUSE BOX

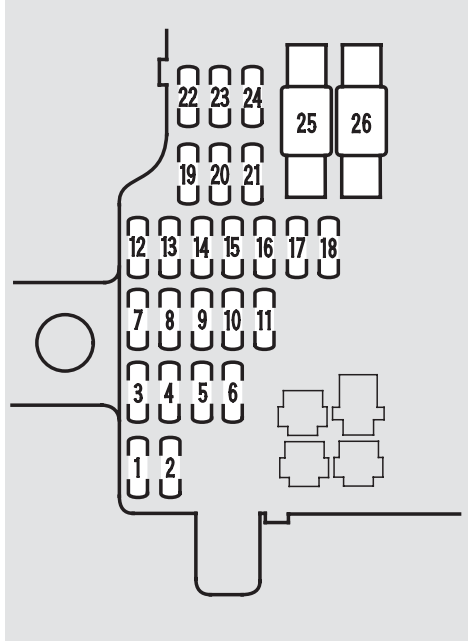

No.	Amps.	Circuits Protected
1	15 A	Small Light
2	—	Not Used (OP)
3	7.5 A	Rear Window Defogger Relay, Cooling Fan Relay
4	10 A	Radio, ACC
5	20 A	A/C Clutch, Heated Seat
6	20 A	ECU (PCM)
7	10 A	SRS
8	20 A	Driver's Power Seat
9	20 A	Bose Audio System
10	10 A	Daytime Running Lights* ¹
11	20 A	Driver's Power Seat
12	7.5 A	Daytime Running Lights* ¹
13	7.5 A	Meter, Moonroof

* 1 : On Canadian models

No.	Amps.	Circuits Protected
14	7.5 A	Starter Signal
15	7.5 A	ACG
16	10 A	ACC Socket
17	7.5 A	Power Window MPCS
18	20 A	Front Right Power Window
19	7.5 A	Mirror
20	20 A	ECU (Body)
21	20 A	Rear Right Power Window
22	20 A	Fuel Pump
23	7.5 A	SRS
24	20 A	Rear Left Power Window
25	30 A	Ignition Coils
26	—	Not Used