

### Streetworks

**DESCRIPTION**  
The Archcon™ Small LED roadway luminaire delivers all the performance benefits of the latest Eaton LED platforms and technologies with a modern, yet familiar cobrahead form factor. This discrete LED solution with the patented, high-efficiency AccuLED Optics™ system, provides uniform and energy conscious illumination for municipal streets and highways. Our customer focused features include single latch top cover entry, industry leading surge protection options and superior lumen maintenance and performance, all in an economical design. Available in 14 standard lumen packages per optic making it the ideal LED replacement for any application of 50W to 150W HPS cobraheads.

**SPECIFICATION FEATURES**  
**Construction**  
Heavy duty die-cast aluminum housing and door. Tool-less entry, hinged removable door for easy maintenance. 3G vibration rated.  
**Optics**  
Choice of four patented, high-efficiency AccuLED Optics. Available in Type IR, III, II, IV wide and V square wide the optics are precisely designed to shape the distribution maximizing efficiency and application spacing. Offered standard in 4000K (±275K CCT) and minimum 70 CRI. Optional 3000K, 5000K CCT. For the ultimate level of spill light control, an optional house side shield accessory is available and can be field or factory installed. The house side shield is designed to seamlessly integrate with the T2R, T3, and T4W optics. Optics are IP66 enclosure rated.

**Electrical**  
120-277V 50/60Hz, 347V 60Hz or 480V 60Hz operation. Standard 0-10V dimming and 10V/15A common and differential mode surge protection available. Thermal management transfer heat away from the LED source for optimal efficiency. Light output and lumen maintenance. Ambient operating temperature from -40°C to 40°C. 50°C HA, high ambient, capability available. Standard with three position tunnel type compression terminal block. Greater than 90% lumen maintenance expected at 60,000 hours.  
**Warranty**  
Standard five-year warranty. Optional ten year warranty, please see your Eaton Streetworks sales representative for more information.

available with round pole adapter and mounting hardware included.  
**Finish**  
Housing and cast parts finished in five stage super TGIC polyester powder coat paint, 2.5 mil nominal thickness for superior protection against fade and wear. Consult your lighting representative at Eaton for a complete selection of standard colors.  
**Mounting**  
Standard five-year warranty. Optional ten year warranty, please see your Eaton Streetworks sales representative for more information.

**ARCH ARCHEON SMALL**  
LED  
ROADWAY LUMINAIRE

**CERTIFICATION DATA**  
UL, ULX, Wet Location Listed  
IP66 Enclosure  
30 Vibration Rated  
UL1881  
DesignLights Consortium™ Qualified  
Dark Sky Approved (3000K CCT and warmer CCT only)

**ENERGY DATA**  
Electronics LED Driver  
9.9 Power Factor  
±20% Total Harmonic Distortion  
120-277V 50/60Hz  
±20% Minimum Temperature Rating  
±40°C Ambient Temperature Rating

**EPA**  
Effective Projected Area (Sq. Ft.): 0.5

**SHIPPING DATA**  
Approximate Net Weight:  
12 lbs. (5.4 kg)

**1** FIXTURE SA1  
E0-01 N.T.S.

### Streetworks

**DESCRIPTION**  
The Archcon™ Medium LED roadway luminaire delivers all the performance benefits of the latest Eaton LED platforms and technologies with a modern, yet familiar cobrahead form factor. This discrete LED solution with the patented, high-efficiency AccuLED Optics™ system, provides uniform and energy conscious illumination for municipal streets and highways. Our customer focused features include single latch top cover entry, industry leading surge protection options and superior lumen maintenance and performance, all in an economical design. Available in 13 standard lumen packages per optic.

**SPECIFICATION FEATURES**  
**Construction**  
Heavy duty die-cast aluminum housing and door. Tool-less entry, hinged removable door for easy access to terminal block, mounting tabs, and optional surge module. 3G vibration rated.  
**Optics**  
Choice of four patented, high-efficiency AccuLED Optics. Available in Type IR, III, II, IV wide and V square wide the optics are precisely designed to shape the distribution maximizing efficiency and application spacing. Offered standard in 4000K (±275K CCT) and minimum 70 CRI. Optional 3000K, 5000K CCT. For the ultimate level of spill light control, an optional house side shield accessory is available and can be field or factory installed. The house side shield is designed to seamlessly integrate with the T2R, T3, and T4W optics. Optics are IP66 enclosure rated.  
**Mounting**  
Standard five-year warranty. Optional ten year warranty, please see your Eaton Streetworks sales representative for more information.

**ARCH ARCHEON MEDIUM**  
LED  
ROADWAY LUMINAIRE

**CERTIFICATION DATA**  
UL, ULX, Wet Location Listed  
IP66 Enclosure  
30 Vibration Rated  
UL1881  
DesignLights Consortium™ Qualified  
Dark Sky Approved (3000K CCT and warmer CCT only)

**ENERGY DATA**  
Electronics LED Driver  
9.9 Power Factor  
±20% Total Harmonic Distortion  
120-277V 50/60Hz  
±20% Minimum Temperature Rating  
±40°C Ambient Temperature Rating

**EPA**  
Effective Projected Area (Sq. Ft.): 0.5

**SHIPPING DATA**  
Approximate Net Weight:  
12 lbs. (5.4 kg)

**2** FIXTURE SA2  
E0-01 N.T.S.

**1** FIXTURE SA1  
E0-01 N.T.S.

**2** FIXTURE SA2  
E0-01 N.T.S.

### McGraw-Edison

**DESCRIPTION**  
The Galeon™ LED luminaire delivers exceptional performance in a highly scalable, low-profile design. Patented, high-efficiency AccuLED Optics™ system provides uniform and energy conscious illumination to walkways, parking lots, roadways, building areas and security lighting applications. IP66 rated and ULXCS, Wet Location Listed.

**SPECIFICATION FEATURES**  
**Construction**  
Extruded aluminum driver enclosure thermally isolated from removable tray assembly for easy light Squares for optimal thermal performance. Heavy-walled, die-cast aluminum end caps enclose housing and die-cast aluminum heat sinks. A unique, patent pending, standard with Eaton proprietary circuit module designed to withstand 100% of transient line surge. The Galeon LED luminaire is available for operation in -40°C to 40°C ambient environments. For applications with ambient temperatures exceeding 40°C, specify the HA (High Ambient) option. Light Squares are IP66 rated. Greater than 90% lumen maintenance expected at 60,000 hours. Available in standard 1A 10W current and optional 600mA, 800mA and 1200mA drive currents (nominal).  
**Mounting**  
STANDARD ARM MOUNT  
Extruded aluminum arm includes internal both guides allowing for easy positioning of fixture during mounting. When mounting two or more luminaires at 90° and 120° apart, the EA extended arm may be required. Refer to the arm mounting requirement table. Round pole adapter included. For wall mounting, specify wall mount bracket option. QUICK MOUNT™ ARM: Adapter is bolted directly to the pole. Quick mount arm facilitates on-site placement and is secured via two screws, facilitating the versatile, patent pending, quick mount arm accommodates multiple drill patterns ranging from 1-1/2" to 4-7/8". Removal of the arm on the quick mount arm enables wiring of the fixture without having to access the driver compartment. A knock-out enables round pole mounting.  
**Finish**  
Housing finished in super durable TGIC polyester powder coat paint, 2.5 mil nominal thickness for superior protection against fade and wear. Heat sink is powder coated black. Standard housing colors include black, bronze, grey, white, dark platinum and graphite metallic. RAL and custom color matches available.  
**Warranty**  
Five-year warranty.

**GLEON GALLEON LED**  
1-10 Light Squares  
Solid State LED  
AREA/SITE LUMINAIRE

**WaveLinX**  
Luminaire Technology  
Eaton

**CERTIFICATION DATA**  
UL1881 Listed  
ULXCS, Wet Location Listed  
IP66 Enclosure  
30 Vibration Rated  
UL1881  
DesignLights Consortium™ Qualified  
Dark Sky Approved (3000K CCT and warmer CCT only)

**ENERGY DATA**  
Electronics LED Driver  
9.9 Power Factor  
±20% Total Harmonic Distortion  
120-277V 50/60Hz  
±20% Minimum Temperature Rating  
±40°C Ambient Temperature Rating  
±40°C Max. Temperature (HA Option)

**EPA**  
Effective Projected Area (Sq. Ft.): 1.12

**SHIPPING DATA**  
Approximate Net Weight:  
17 lbs. (7.7 kg)

**3** FIXTURE SB1 (WALL MOUNTED) AND SB2 (POLE MOUNTED)  
E0-01 N.T.S.

### McGraw-Edison

**DESCRIPTION**  
The Galeon™ Wall LED luminaire's appearance is complementary with the Galeon area and site luminaires bringing a modern architectural style to lighting applications. Flexible mounting options accommodate wall surfaces in both an upward and downward configuration. The Galeon family of LED products deliver exceptional performance with patented, high-efficiency AccuLED Optics™, providing uniform and energy conscious lighting for parking lots, building and security lighting applications.

**SPECIFICATION FEATURES**  
**Construction**  
Driver enclosure thermally isolated from optics for optimal thermal performance. Heavy wall aluminum housing die-cast with integral external heat sink to provide superior structural rigidity and an IP66 rated housing. Overall construction passes a 1.5G vibration test to ensure mechanical integrity. UL1881 Listed. Specify with the UPS option for inverted mount upright housing with additional protections to maintain IP rating.  
**Optics**  
Choice of thirteen patented, high-efficiency AccuLED Optics. The optics are precisely designed to shape the distribution maximizing efficiency and application spacing. AccuLED Optics create consistent distributions with the scalability to meet customized application requirements. Offered standard in 4000K (±275K CCT) and minimum 70 CRI. Optional 3000K, 5000K and 6000K CCT. Greater than 90% lumen maintenance expected at 60,000 hours. Available in standard 1A drive current and optional 1200mA, 800mA, and 600mA drive currents.  
**Electrical**  
LED drivers are mounted for ease of maintenance. 120-277V 50/60Hz, 347V or 480V 60Hz systems only. Drivers are provided standard with 0-10V dimming. An optional Cooper Lighting Solutions proprietary surge protection module is available and designed to withstand 100V of transient line surge. The Galeon Wall LED luminaire is suitable for operation in -40°C to 40°C ambient environments. For applications with ambient temperatures exceeding 40°C, specify the HA (High Ambient) option. Emergency bypass options for 20°C ambient environments and occupancy aware available.  
**Mounting**  
Gasketed and zinc plated rigid steel mounting attachment fits directly to 4" box or wall with the Galeon Wall "Hook-N-Lock" mechanism for quick installation. Secured with two captive corrosion resistant black oxide coated allen head set screws which are concealed but accessible from bottom of fixture.  
**Finish**  
Housing finished in super durable TGIC polyester powder coat paint, 2.5 mil nominal thickness for superior protection against fade and wear. Standard colors include black, bronze, grey, white, dark platinum and graphite metallic. RAL and custom color matches available. Consult the McGraw-Edison Architectural Colors brochure for the complete selection.  
**Warranty**  
Five-year warranty.

**GWC GALLEON WALL**  
1-2 Light Squares  
Solid State LED  
WALL MOUNT LUMINAIRE

**WaveLinX**  
Luminaire Technology  
Eaton

**CERTIFICATION DATA**  
UL1881 Listed  
ULXCS, Wet Location Listed  
IP66 Enclosure  
30 Vibration Rated  
UL1881  
DesignLights Consortium™ Qualified

**ENERGY DATA**  
Electronics LED Driver  
9.9 Power Factor  
±20% Total Harmonic Distortion  
120-277V 50/60Hz  
±20% Minimum Temperature Rating  
±40°C Ambient Temperature Rating  
±40°C Max. Temperature (HA Option)

**EPA**  
Effective Projected Area (Sq. Ft.): 0.21

**SHIPPING DATA**  
Approximate Net Weight:  
12 lbs. (5.4 kg)

**4** FIXTURE SC1  
E0-01 N.T.S.

### Lumark

**DESCRIPTION**  
The patented Lumark Crosstour™ LED Wall Pack Series of luminaires provides an architectural style with super bright, energy efficient LEDs. The low-profile, rugged die-cast aluminum construction, universal back box, stainless steel hardware along with a sealed and gasketed optical compartment make the Crosstour impervious to contaminants. The Crosstour wall luminaire is ideal for wall surface, inverted mount for facade/canopy illumination, postballast, site lighting, floodlight and low level pathway illumination including stairs. Typical applications include building entrances, multi-use facilities, apartment buildings, institutions, schools, stairways and loading docks etc.

**SPECIFICATION FEATURES**  
**Construction**  
Slim, low-profile LED design with rugged one-piece, die-cast aluminum hinged removable door and back box. Matching housing styles incorporate both a small and medium design. The small housing is available in 12W, 18W and 26W. The medium housing allows for safe and easy tool-less electrical connections. Back box includes three half-inch, NPT threaded conduit entry points. The universal back box supports both mounts to standard 3-1/2" to 4" round and octagonal, 4" square, single gang and masonry junction boxes. Key hole gasket allows for adaptation to junction box or wall. External design extracts heat from the fixture surface. One-piece silicone gasket seals door and back box. Minimum 8" wide pole for site lighting application. Not recommended for car wash applications.  
**Optical**  
Silicone sealed optical LED chamber incorporates a custom engineered mirrored anodized reflector providing high efficiency illumination. Optical assembly includes impact resistant tempered glass and meets IESNA requirements for full cutoff compliance. Available in seven lumen packages; 5000K, 4000K and 3000K CCT.  
**Electrical**  
LED driver is mounted to the die-cast housing for optimal heat sinking. LED thermal management system incorporates both conduction and natural convection to transfer heat rapidly away from the LED source. 12W, 18W, 26W and 39W series operate in -40°C to 40°C (140°F to 104°F). High ambient 50°C models available. Crosstour luminaires maintain greater than 89% of initial light output after 72,000 hours of operation. These half-inch NPT threaded conduit entry points allow for three branch wiring. Back box is an authorized electrical wiring compartment. Integral LED electronic driver incorporates surge protection. 120-277V 50/60Hz or 347V 60Hz models.  
**Finish**  
Crosstour is protected with a Super durable TGIC carbon bronze or sunmetal white polyester powder coat paint. Super durable TGIC powder coat paint finishes withstand extreme climate conditions while providing optimal color and gloss retention of the installed fixture.  
**Warranty**  
Five-year warranty.

**XTOR CROSSTOUR LED**  
APPLICATIONS:  
WALL / SURFACE  
POST / ROLLBAR  
LOW LEVEL  
FLOODLIGHT  
INVERTED  
SITE LIGHTING

**CERTIFICATION DATA**  
Dark Sky Approved (Heat model, Full cutoff, and 3000K CCT only)  
ULXCS, Wet Location Listed  
LM79 (LM88 Compliant)  
IP66 Enclosure  
IP66 Ingress Protection Rated  
The ULXCS Compliant  
DesignLights Consortium™ Qualified

**TECHNICAL DATA**  
40°C Maximum Ambient Temperature  
External Supply Wiring 80°C Maximum

**EPA**  
Effective Projected Area (Sq. Ft.):  
XTOR18, XTOR26, XTOR39-0.34  
XTOR18-0.5

**SHIPPING DATA**  
Approximate Net Weight:  
17 - 5.25 lbs. (1.7 - 2.4 kg)

**5** FIXTURE SC2  
E0-01 N.T.S.

ELECTRICAL LEGEND	
LIGHTING	
○	WALL MOUNTED FIXTURE (LETTER DENOTES TYPE)
◐	POLE MOUNTED FIXTURE (LETTER DENOTES TYPE)

ELECTRICAL DRAWING LIST	
DRAWING NUMBER	DRAWING NAME
ES-01	LEGEND, DRAWING LIST, LIGHTING FIXTURE SCHEDULE & CUTSHEETS, AND PHOTOMETRIC VALUES
ES-01	ELECTRICAL SITE PLAN
ES-02	PARTIAL ELECTRICAL SITE PLAN 1 OF 6
ES-03	PARTIAL ELECTRICAL SITE PLAN 2 OF 6
ES-04	PARTIAL ELECTRICAL SITE PLAN 3 OF 6
ES-05	PARTIAL ELECTRICAL SITE PLAN 4 OF 6
ES-06	PARTIAL ELECTRICAL SITE PLAN 5 OF 6
ES-07	PARTIAL ELECTRICAL SITE PLAN 6 OF 6

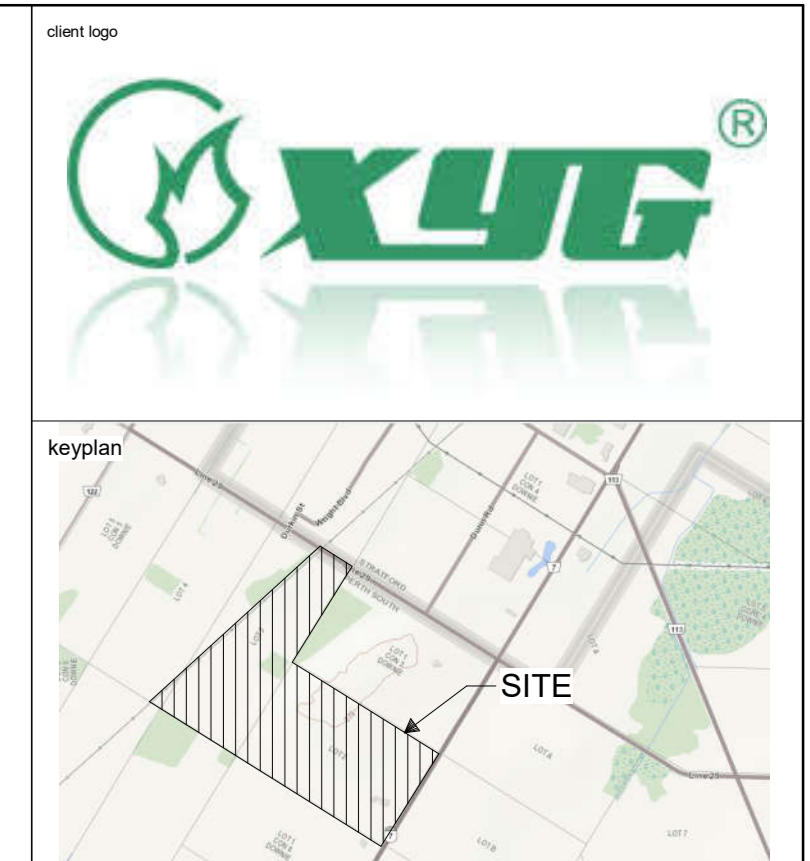

no.	Issuance	date
1	SD & SPA REVIEW	2020-04-09
2	SPA PRE-CONSULTATION - SUB #1	2020-04-20

CUSTOMER  
XINYI CANADA GLASS LIMITED

PROJECT  
XCG - STRATFORD FACILITY

Stratford, ON

TITLE  
LEGEND, DRAWING LIST, LIGHTING FIXTURE SCHEDULE & CUTSHEETS, AND PHOTOMETRIC VALUES

**WALTER FEDY**  
KITCHENER HAMILTON



REPRODUCTION OR DISTRIBUTION FOR PURPOSES OTHER THAN AUTHORIZED BY WALTER FEDY IS PROHIBITED. CONSULTANTS SHALL REVIEW AND BE RESPONSIBLE FOR ALL DIMENSIONS AND CONDITIONS ON THE JOB AND REPORT ANY VARIATIONS FROM THE DIMENSIONS AND CONDITIONS SHOWN TO WALTER FEDY. THIS DRAWING DOES NOT SCALE. THIS DRAWING

SCALE: As Indicated SHEET NO: 04/02/20  
DATE: 2018-0833-11  
PROJECT NO: 2018-0833-11  
DRAWN BY: Author  
CHECKED BY: Checker

**E0-01**

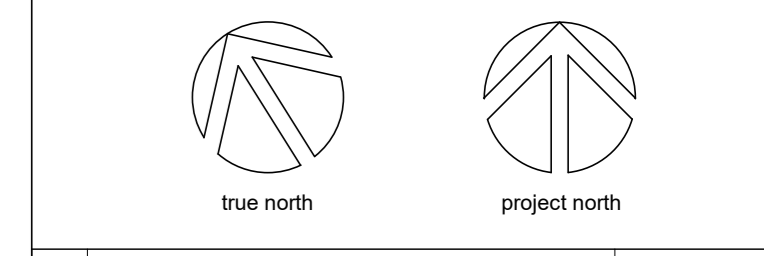
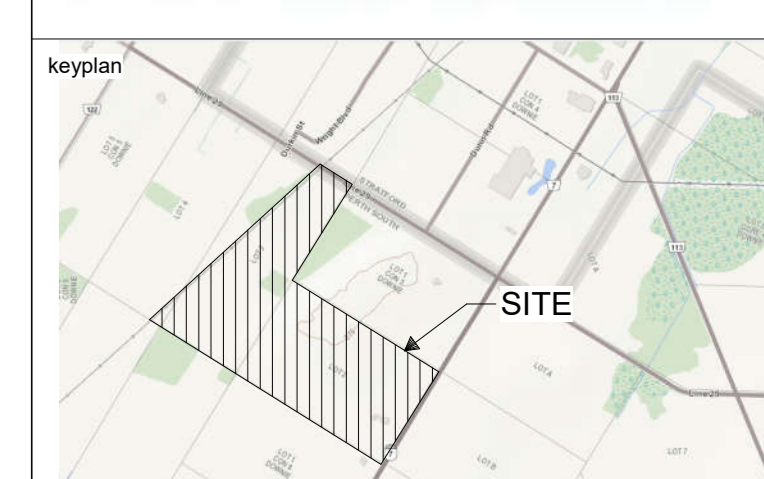
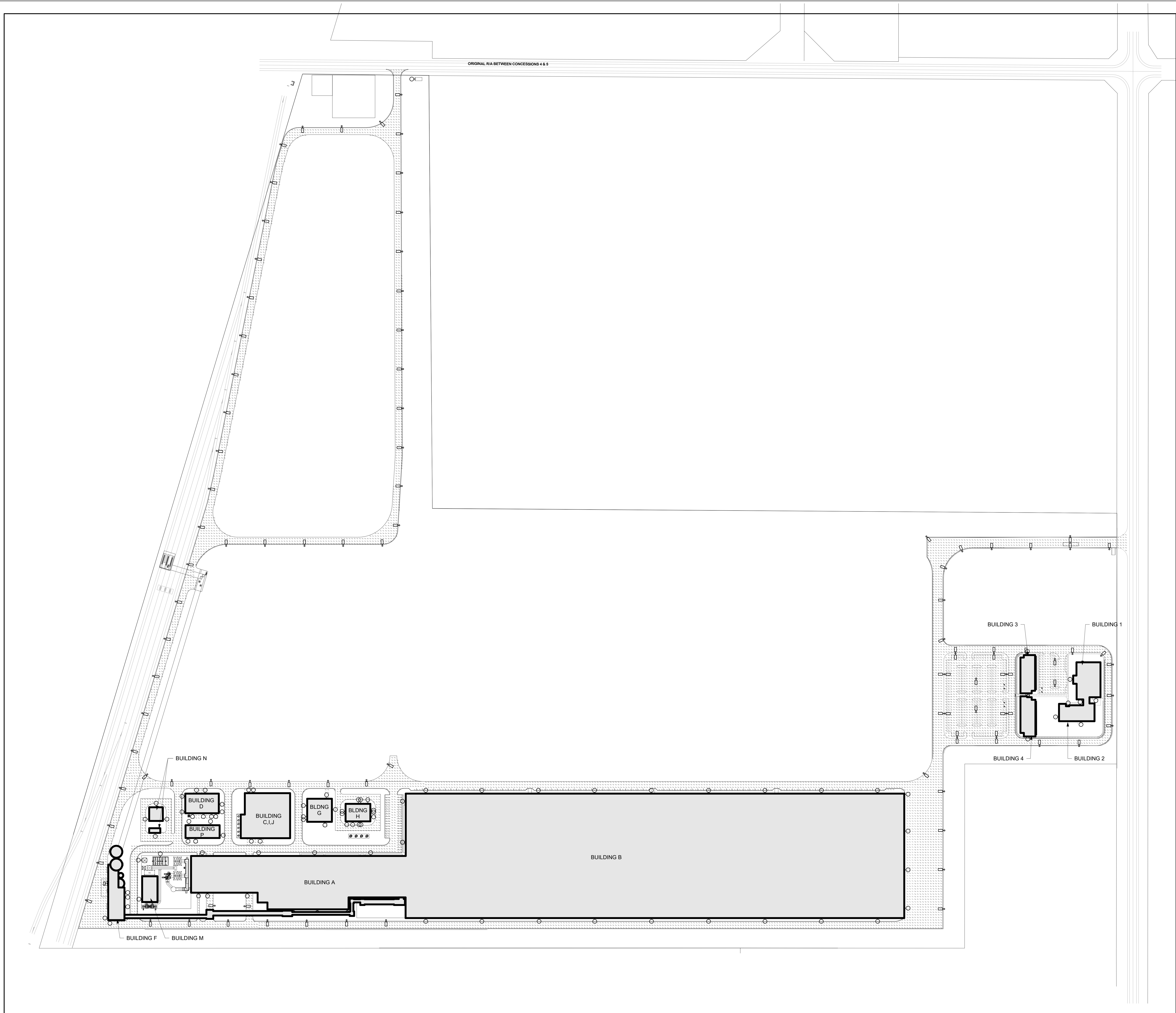

no.	issuance	date
1	SD & SPA REVIEW	2020-04-09
2	SPA PRE-CONSULTATION - SUB #1	2020-04-20

CUSTOMER  
XINYI CANADA GLASS LIMITED

PROJECT  
XCG - STRATFORD FACILITY

Stratford, ON  
TITLE  
ELECTRICAL SITE PLAN

**WALTERFEDY**  
KITCHENER HAMILTON



REPRODUCTION OR DISTRIBUTION FOR PURPOSES OTHER THAN AUTHORIZED BY WALTERFEDY CONTRACTORS SHALL BE VOID AND BE RESPONSIBLE FOR ALL DIMENSIONS AND CONDITIONS ON THE JOB AND REPORT ANY VARIATIONS FROM THE DRAWINGS AND CONDITIONS PRIOR TO COMMENCEMENT OF WORK. THESE DO NOT SCALE THIS DRAWING.

SCALE: 1 : 1500	SHEET NO:
DATE: 03/25/20	
PROJECT NO: 2018-0833-11	
FILE:	
DRAWN BY: Author	
CHECKED BY: Checker	

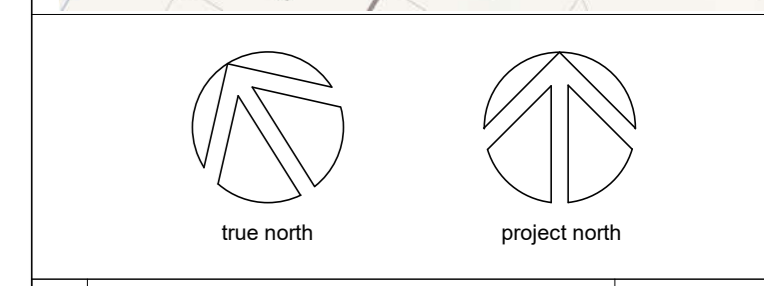
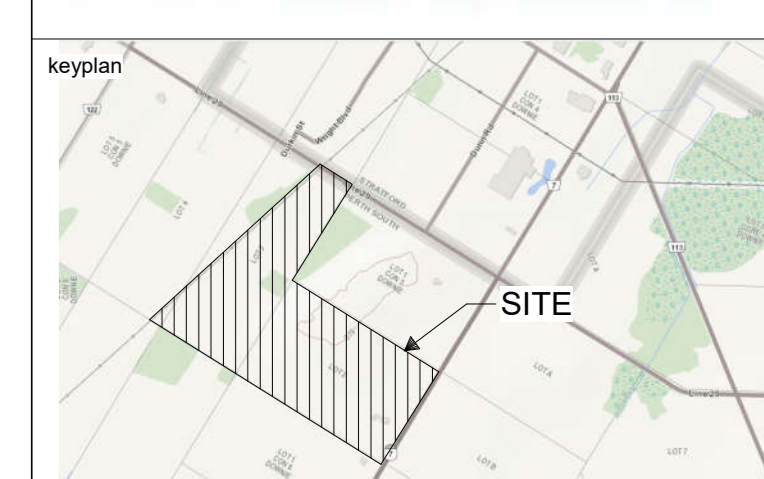

no.	issuance	date
1	SD & SPA REVIEW	2020-04-09
2	SPA PRE-CONSULTATION - SUB #1	2020-04-20

ORIGINAL R/A BETWEEN CONCESSIONS 4 & 5

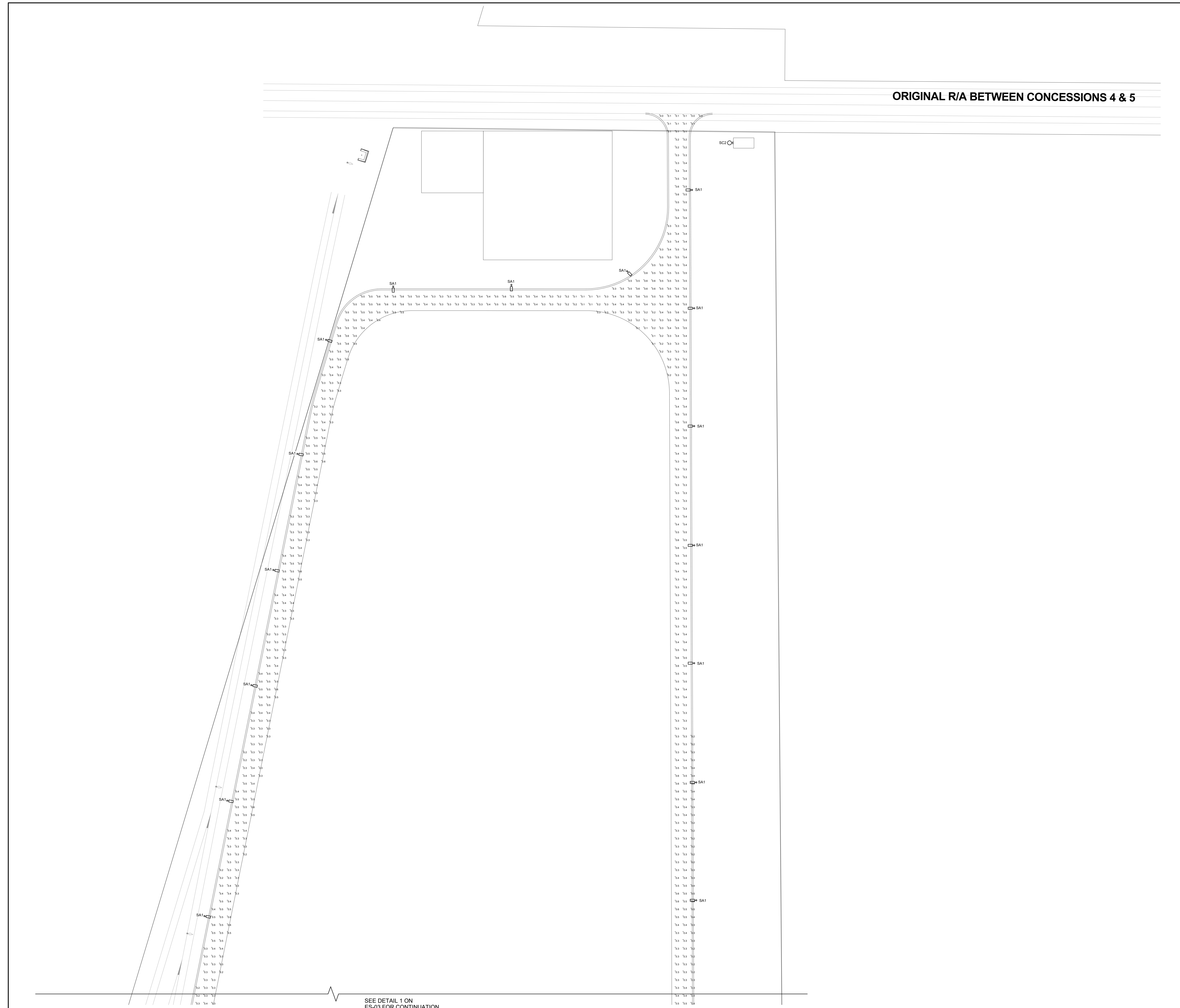

SEE DETAIL 1 ON  
ES-03 FOR CONTINUATION

CUSTOMER  
XINYI CANADA GLASS LIMITED

PROJECT  
XCG - STRATFORD FACILITY

Stratford, ON  
TITLE  
PARTIAL ELECTRICAL SITE PLAN 1 OF 6

**WALTERFEDY**  
KITCHENER HAMILTON

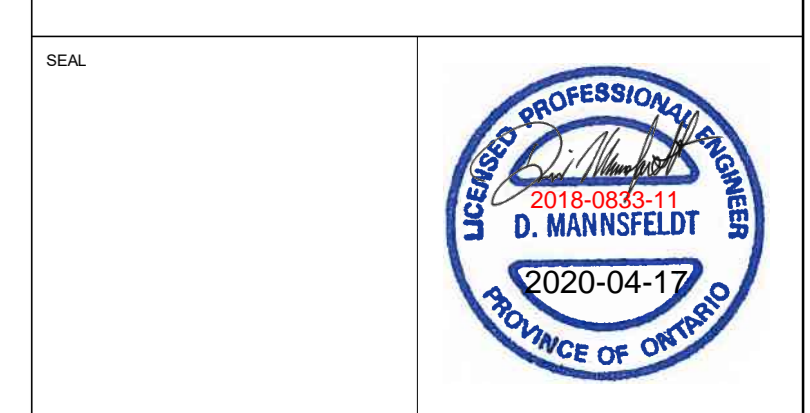

REPRODUCTION OR DISTRIBUTION FOR PURPOSES OTHER THAN AUTHORIZED BY WALTERFEDY PROFESSIONAL ENGINEERS SHALL BE AT THE USER'S RISK AND BE RESPONSIBLE FOR ALL DIMENSIONS AND CONDITIONS ON THE JOB AND REPORT ANY VARIATIONS FROM THE DIMENSIONS AND CONDITIONS SHOWN ON DRAWINGS TO WALTERFEDY. DO NOT SCALE THIS DRAWING.

SCALE: 1:500	SHEET NO:
DATE: 03/25/20	
PROJECT NO: 2018-0833-11	
DRAWN BY: Author	
CHECKED BY: Checker	

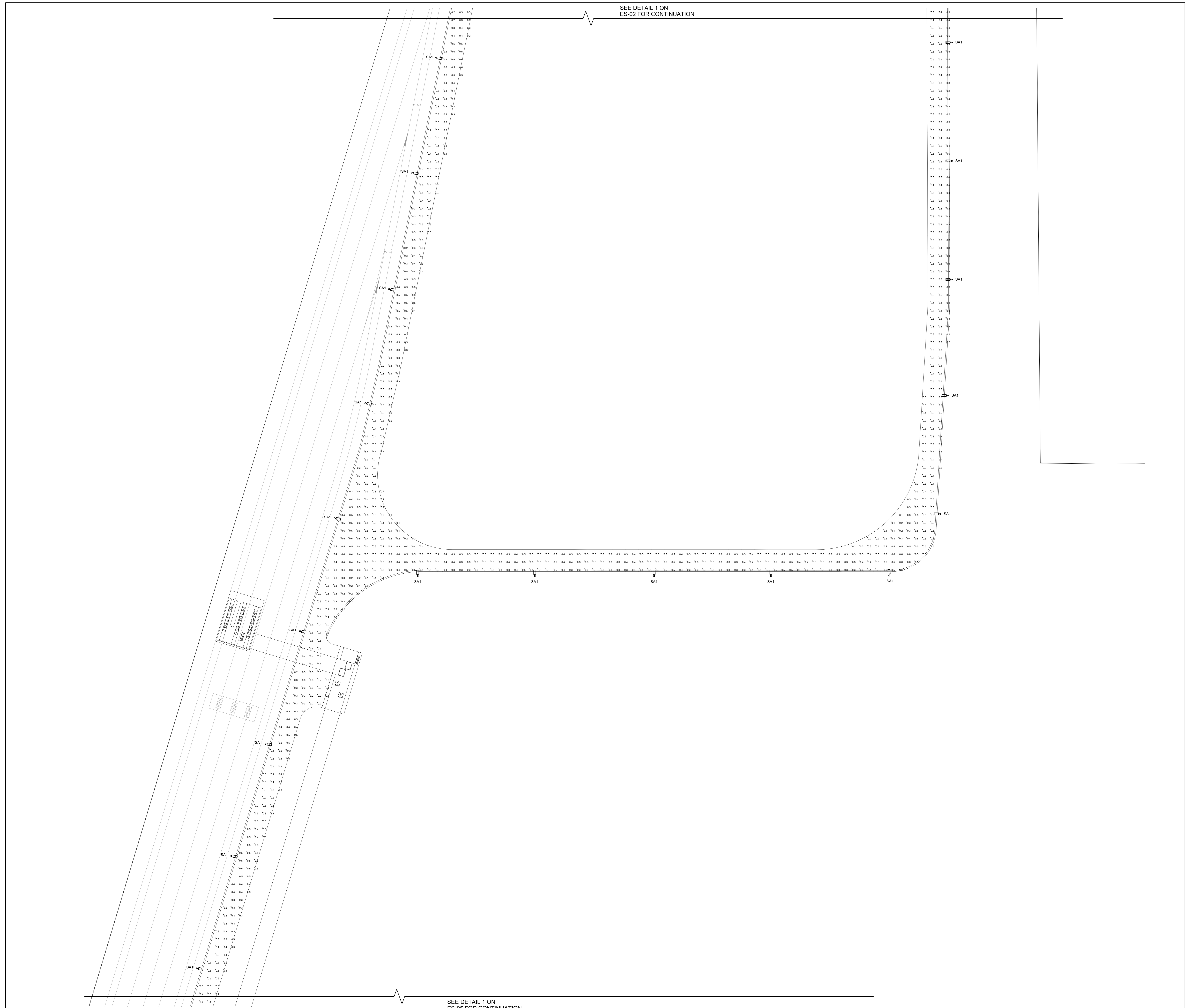

SEE DETAIL 1 ON  
ES-02 FOR CONTINUATION

SEE DETAIL 1 ON  
ES-05 FOR CONTINUATION

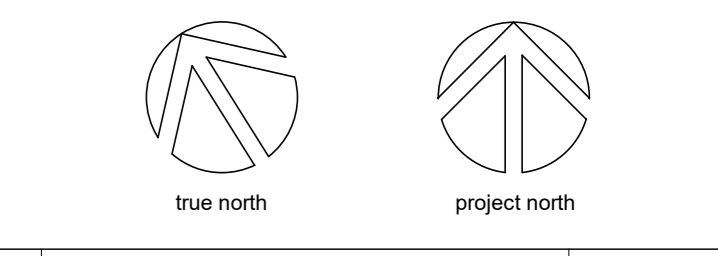

no.	issuance	date
1	SD & SPA REVIEW	2020-04-09
2	SPA PRE-CONSULTATION - SUB #1	2020-04-20

CUSTOMER  
XINYI CANADA GLASS LIMITED

PROJECT  
XCG - STRATFORD FACILITY

Stratford, ON  
TITLE  
PARTIAL ELECTRICAL SITE PLAN 2 OF 6

**WALTERFEDY**  
KITCHENER HAMILTON



REPRODUCTION OR DISTRIBUTION FOR PURPOSES OTHER THAN AUTHORIZED BY WALTERFEDY OR FORBIDDEN. CONTRACTORS SHALL VERIFY AND BE RESPONSIBLE FOR ALL DIMENSIONS AND CONDITIONS ON THE JOB AND REPORT ANY VARIATIONS FROM THE DRAWINGS AND CONDITIONS SHOWN TO WALTERFEDY. DO NOT SCALE THIS DRAWING.

SCALE: 1:500	SHEET NO: ES-03
DATE: 03/26/20	
PROJECT NO: 2018-0833-11	
FILE:	
DRAWN BY: Author	
CHECKED BY: Checker	

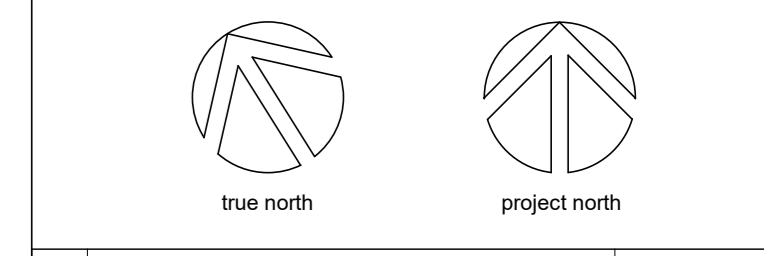

no.	issuance	date
1	SD & SPA REVIEW	2020-04-09
2	SPA PRE-CONSULTATION - SUB #1	2020-04-20

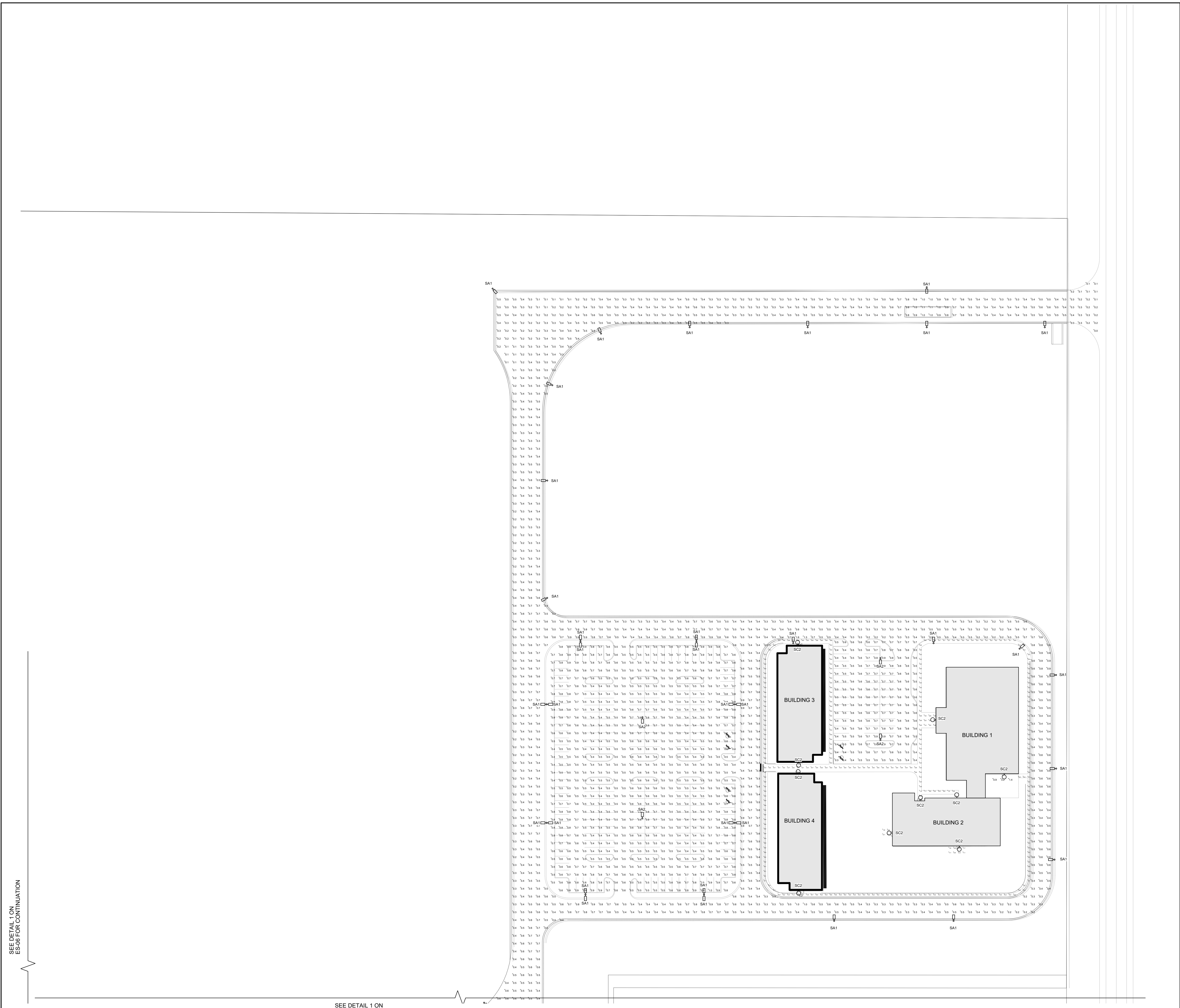

SEE DETAIL 1 ON  
ES-06 FOR CONTINUATION

SEE DETAIL 1 ON  
ES-07 FOR CONTINUATION

CUSTOMER  
XINYI CANADA GLASS LIMITED

PROJECT  
XCG - STRATFORD FACILITY

Stratford, ON  
TITLE  
PARTIAL ELECTRICAL SITE PLAN 3 OF 6

**WALTER FEDY**  
KITCHENER HAMILTON



REPRODUCTION OR DISTRIBUTION FOR PURPOSES OTHER THAN AUTHORIZED BY WALTER FEDY OR ITS CONTRACTORS SHALL BE VOID AND BE RESPONSIBLE FOR ALL DIMENSIONS AND CONDITIONS ON THE JOB AND REPORT ANY VARIATIONS FROM THE DRAWINGS AND CONDITIONS PRIOR TO COMMENCEMENT TO AVOID DELAYS. DO NOT SCALE THIS DRAWING.

SCALE: 1:500	SHEET NO:
DATE: 03/26/20	
PROJECT NO: 2018-0833-11	
FILE NO:	
DRAWN BY: Author	
CHECKED BY: Checker	

SEE DETAIL 1 ON  
ES-03 FOR CONTINUATION

SEE DETAIL 1 ON  
ES-06 FOR CONTINUATION

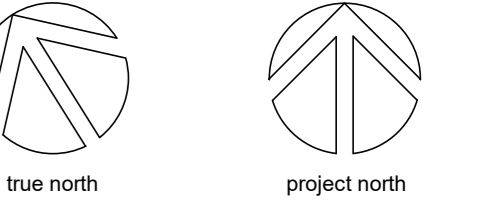
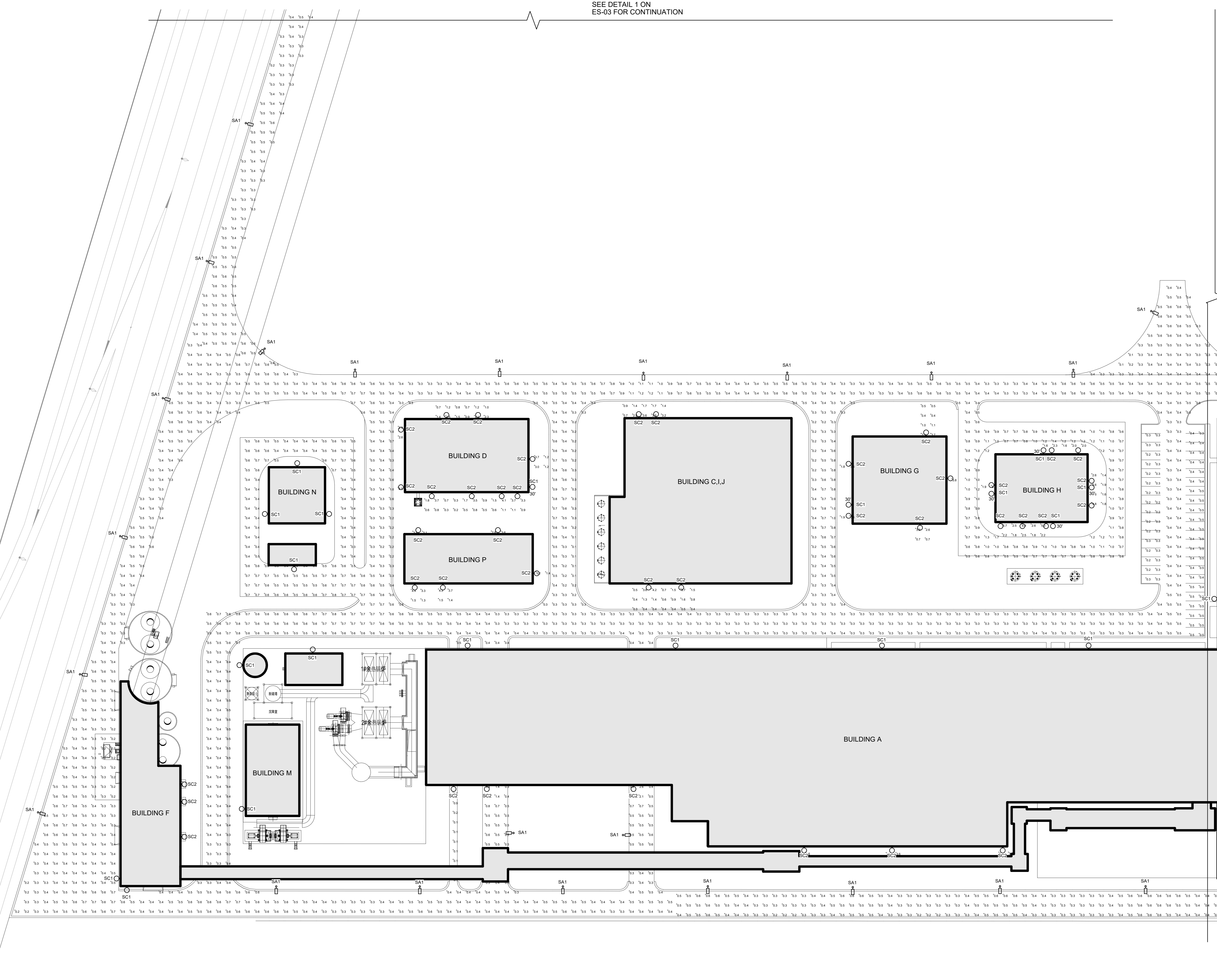

no.	issuance	date
1	SD & SPA REVIEW	2020-04-09
2	SPA PRE-CONSULTATION - SUB #1	2020-04-20

CUSTOMER  
XINYI CANADA GLASS LIMITED

PROJECT  
XCG - STRATFORD FACILITY

Stratford, ON  
TITLE  
PARTIAL ELECTRICAL SITE PLAN 4 OF 6

**WALTER FEDY**  
KITCHENER HAMILTON



REPRODUCTION OR DISTRIBUTION FOR PURPOSES OTHER THAN AUTHORIZED BY WALTER FEDY OR ITS CONTRACTORS SHALL BE VOID AND BE RESPONSIBLE FOR ALL DIMENSIONS AND CONDITIONS ON THE JOB AND REPORT ANY VARIATIONS FROM THE DIMENSIONS AND CONDITIONS SHOWN ON DRAWINGS TO WALTER FEDY. DO NOT SCALE THIS DRAWING.

SCALE: 1:500	SHEET NO: ES-05
DATE: 03/26/20	
PROJECT NO: 2018-0833-11	
P.L.S.:	
DRAWN BY: Author	
CHECKED BY: Checker	

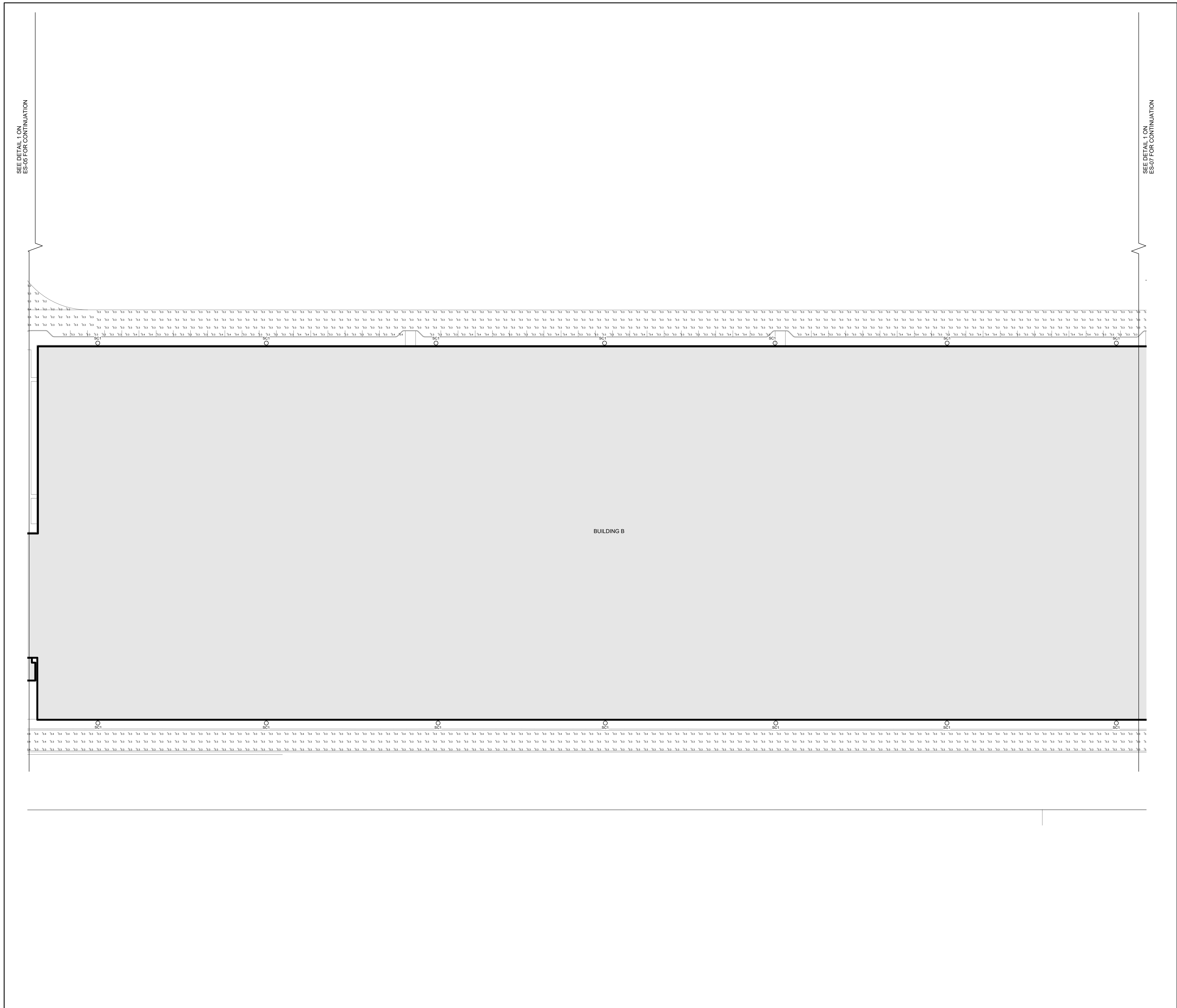

1 PARTIAL ELECTRICAL SITE PLAN  
ES-06 1:500

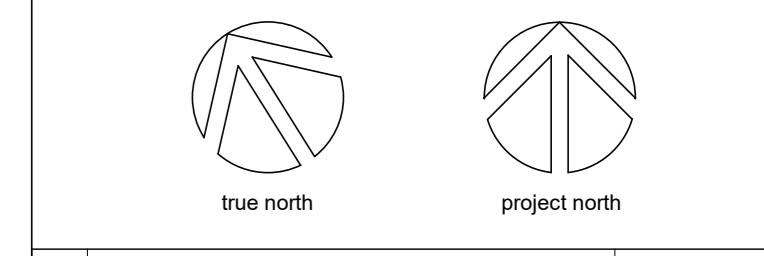

no.	issuance	date
1	SD & SPA REVIEW	2020-04-09
2	SPA PRE-CONSULTATION - SUB #1	2020-04-20

CUSTOMER  
XINYI CANADA GLASS LIMITED

PROJECT  
XCG - STRATFORD FACILITY

Stratford, ON  
TITLE  
PARTIAL ELECTRICAL SITE PLAN 5 OF 6

**WALTERFEDY**  
KITCHENER HAMILTON



REPRODUCTION OR DISTRIBUTION FOR PURPOSES OTHER THAN AUTHORIZED BY WALTERFEDY PROFESSIONAL ENGINEERS SHALL BE PROHIBITED AND THE USER SHALL BE RESPONSIBLE FOR ALL DIMENSIONS AND CONDITIONS ON THE JOB AND REPORT ANY VARIATIONS FROM THE DRAWINGS AND CONDITIONS PRINTED OR OTHERWISE TO WALTERFEDY. DO NOT SCALE THIS DRAWING.

SCALE: 1:500	SHEET NO: ES-06
DATE: 03/26/20	
PROJECT NO: 2018-0833-11	
P.L.S.:	
DRAWN BY: Author	
CHECKED BY: Checker	

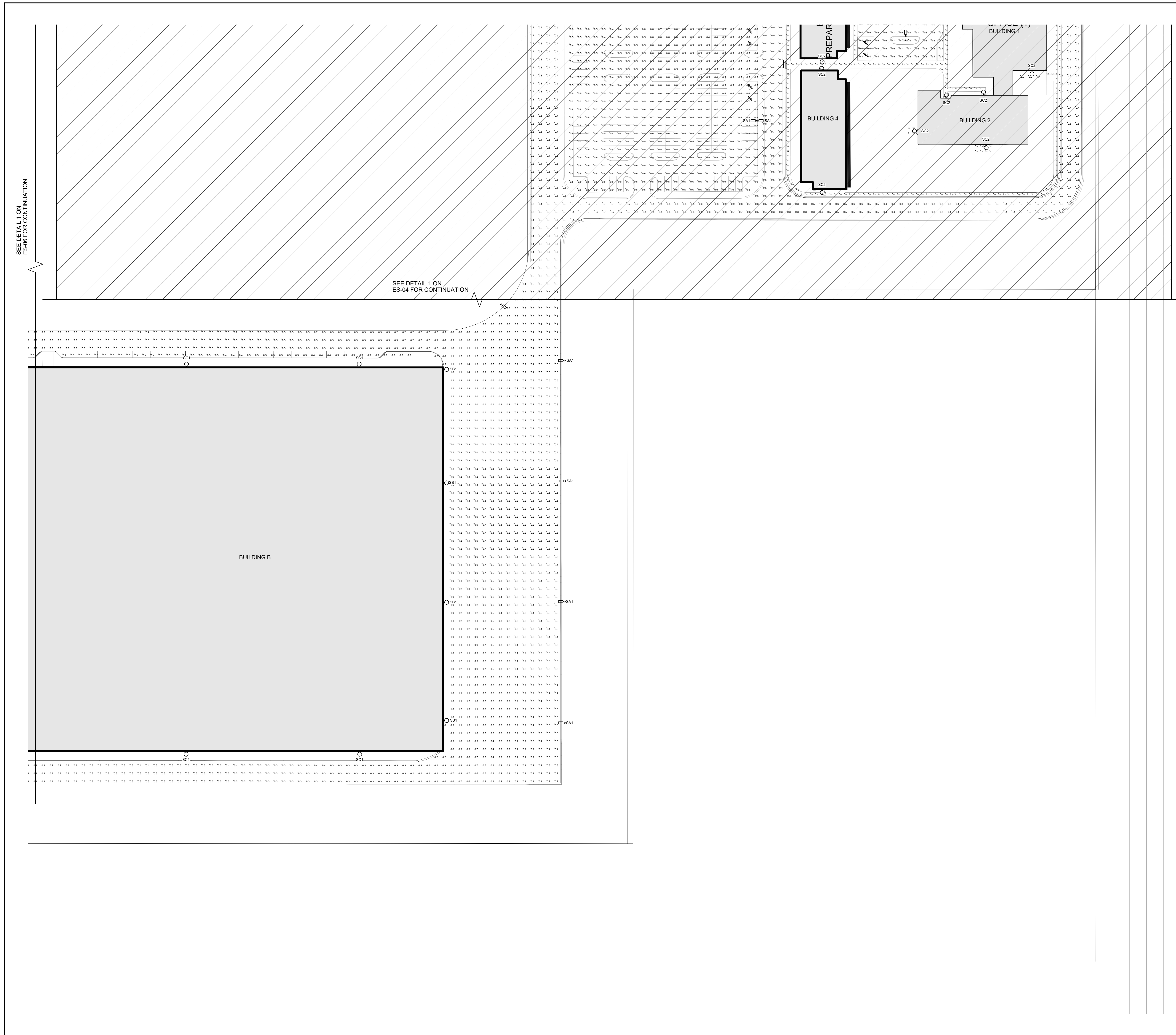

no.	issuance	date
1	SD & SPA REVIEW	2020-04-09
2	SPA PRE-CONSULTATION - SUB #1	2020-04-20

CUSTOMER  
XINYI CANADA GLASS LIMITED

PROJECT  
XCG - STRATFORD FACILITY

Stratford, ON

TITLE  
PARTIAL ELECTRICAL SITE PLAN 6 OF 6

**WALTER FEDY**  
KITCHENER HAMILTON

REPRODUCTION OR DISTRIBUTION FOR PURPOSES OTHER THAN AUTHORIZED BY WALTER FEDY OR CONTRACTORS SHALL BE VOID AND BE RESPONSIBLE FOR ALL DIMENSIONS AND CONDITIONS ON THE JOB AND REPORT ANY VARIATIONS FROM THE DIMENSIONS AND CONDITIONS SHOWN ON DRAWINGS TO WALTER FEDY. DO NOT SCALE THIS DRAWING.

COPYRIGHT © 2020 WalterFedy Inc.

SCALE: 1 : 500

DATE: 03/26/20

PROJECT NO: 2018-0833-11

DRAWN BY: Author

CHECKED BY: Checker

SHEET NO: **ES-07**