

# 1 General Information

Product Name:	Transmission support
Product Type:	Load holding device
Product Number:	T90003
Weight:	25 kg
Max. load capacity:	400 kg
Static Test Coefficient:	3.0

## Intended use:

- ▶ To support vehicle assembly groups during their removal and installation in accordance with the workshop manuals of the Volkswagen Group brands.

## Terms of use:

- ▶ For qualified workshop personnel only.
- ▶ Use the load holding device only for work approved by the Volkswagen Group.
- ▶ For use on gas-powered vehicles or high-voltage components only by qualified personnel.
- ▶ Use only for loads up to 400 kg.
- ▶ Use only with a suitable engine and transmission jack (e.g. VAS 6931/V.A.G 1383A) (see the workshop manuals of the Volkswagen Group brands).
- ▶ Do not hold or lift any persons or animals.
- ▶ Do not hold or lift articles other than those described in the workshop manuals of the Volkswagen Group brands.
- ▶ Do not stand under suspended loads.
- ▶ Use only on level, even, and stable ground.
- ▶ Use only with the approved accessories (see the workshop manuals of the Volkswagen Group brands).

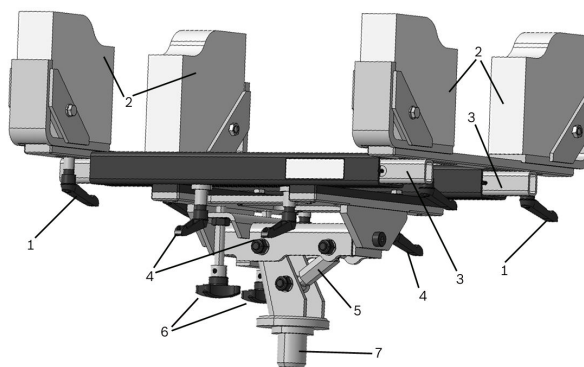
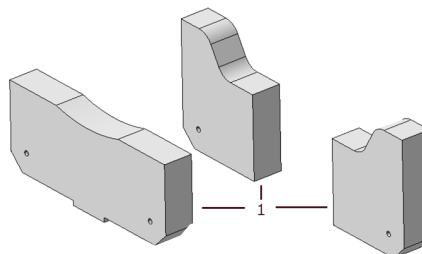

Figure 1: Transmission support T90003

- 1** Holder with supports (4 pieces T90003-24) and clamping lever
- 2** Support (4 pieces)
- 3** Boom (2 pieces)
- 4** Clamping lever, adjustment of the boom (2 pieces)
- 5** Incline adjustment lengthwise (actuation with spanner SW 19)
- 6** Incline adjustment transverse
- 7** Support for the transmission lever (e.g. VAS 6931/V.A.G 1383A)



- 8** Tension strap, one-piece 1000 daN, 25 mm strap width



- 1** Supports (1 set = 3 pieces; 1 piece T90003-25, 2 pieces T90003-26)

## 2 General Safety Instructions

### WARNING

#### Read and follow all safety notes and instructions!

Failure to follow the safety instructions could result in serious injuries and severe damage to materials.

Observe and follow the safety notes below.

- 
- ▶ The load holding device has been specifically constructed for its intended use. The safety of the load holding device can no longer be ensured if it is misused or modified in ways not expressly approved by the manufacturer. Serious injuries or severe damage to materials could occur.
  - ▶ Ensure that each person using the load holding device is familiar with these instructions and can access them at all times.
  - ▶ Ensure that all users are also familiar with the instructions of the tools and workshop equipment that are necessary for the work.
  - ▶ Observe and follow the basic information and safety notes for gas-powered vehicles or high-voltage components in the corresponding Volkswagen Group information materials.
  - ▶ Carefully read and adhere to the instructions in the technical safety information of the Volkswagen Group brands.
  - ▶ Wear safety shoes (in accordance with ISO 20345, S2).
  - ▶ Wear protective gloves in order to avoid cuts.
  - ▶ Position hands and feet so as to avoid potential crushing hazards.
  - ▶ Use the load holding device only for work approved by the Volkswagen Group.
  - ▶ Use the load holding device only with the accessories approved by the Volkswagen Group.
  - ▶ Do not exceed the maximum load capacity of 400 kg.
  - ▶ Do not use the tension belt to lift loads under any circumstances.
  - ▶ Tighten the screws with the specified torque (see workshop manuals of the Volkswagen Group brands).
  - ▶ Use only with a suitable engine and transmission jack (e.g. VAS 6931/V.A.G 1383A) (see the workshop manuals of the Volkswagen Group brands).
  - ▶ Observe the center of gravity in accordance with the position of the support pin.
  - ▶ The engine and transmission jack may only be operated by one person.
  - ▶ It is prohibited for persons to stand under the load and in the danger zone during the movement process.
  - ▶ Move the load slowly and carefully.
  - ▶ Observe the transmission support as well as the load during all movements.
  - ▶ Move the load only on the lowest setting.
  - ▶ Ensure that the path is clear and easily visible.
  - ▶ Do not work on suspended loads.

### 3 Operating Instructions

1. Check that the transmission support is complete and inspect it for visible damages such as signs of wear, deformation, breakages, cracks, and corrosion damages prior to each use. Inspect all threads for damages and ease of operation. Do not use the transmission support when defects are detected and discard it immediately. Inspect the tension belt for damages and tears, and check that the turnbuckle functions correctly.
2. Carry out the necessary preparation work to use the transmission support in accordance with the workshop manuals.
3. Place the engine support on the engine and transmission jack and ensure that the support pin is inserted completely into the attachment of the engine and transmission jack, and is secured.
4. Check that the adjusters, hand wheels, and the clamping levers function correctly.
5. Adjust the transmission support on the load in accordance with the workshop manuals.
  - ▶ Adjust the boom (3) with the help of the clamping levers (4). The maximum extension length is 115 mm.

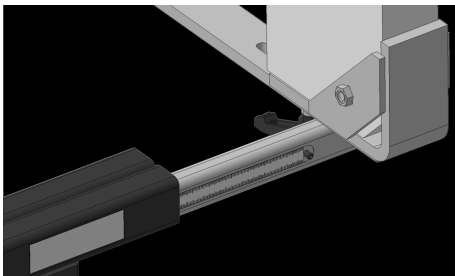

Figure 2: Extended boom

#### **WARNING**

##### **Danger of the load tilting or falling!**

Attaching the transmission support to the load incorrectly could cause the load to tilt or fall! This could result in serious injuries and severe damage to materials.

- ▶ Do not exceed the maximum extension length at any time.
- ▶ Secure the extensions with the clamping levers.

- ▶ Adjust the supports (2) and fix them with the clamping levers (1).

#### **WARNING**

##### **Danger of the load tilting or falling!**

Attaching the transmission support to the load incorrectly could cause the load to tilt or fall! This could result in serious injuries and severe damage to materials.

- ▶ Secure the supports with the clamping levers.

- ▶ Adjust the lengthwise incline adjustment (5) with a spanner SW 19.
- ▶ Position the base plate with the transverse incline adjustment (6) and tighten both star knob screws. The center of gravity must correspond to the center of gravity of the transmission.

#### **WARNING**

##### **Danger of the load tilting or falling!**

Attaching the transmission support to the load incorrectly could cause the load to tilt or fall! This could result in serious injuries and severe damage to materials.

- ▶ Tighten both star knob screws.

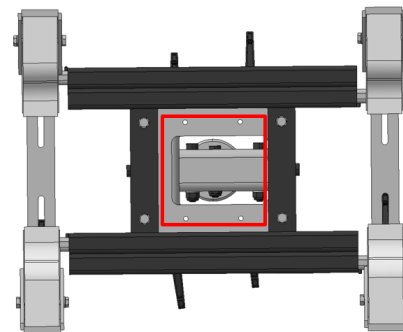

Figure 3: Center of gravity of the load to be supported

- ▶ Secure the load to the transmission with the tension belt (8).

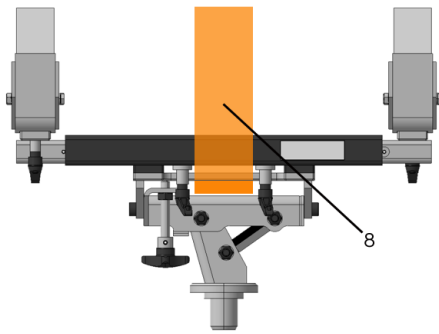

Figure 4: Positioning the tension belt

6. Ensure that the load is properly secured. Lower the load.

### **WARNING**

#### **Moving loads could cause injury!**

Moving, lifting, or lowering the load could cause limbs to be crushed between the load and vehicle.

- ▶ Position hands and feet so as to avoid potential crushing hazards when moving the load.
- ▶ Observe the engine and transmission jack, as well as the load, during all movements.

7. Carry out further work as described in the workshop manuals.
8. Ensure that all parts of the special tool have been removed after completing the repair work.

## 4 Inspection and Maintenance

- ▶ Check that the transmission support and the tension belt with the turnbuckle are complete and inspect them for visible damages such as signs of wear, deformation, breakages, cracks, and corrosion damages prior to each use. Inspect all threads for damages and ease of operation. Do not use the transmission support when defects are detected and discard it immediately.
- ▶ Replacement parts are available on request. Use only original replacement parts.
- ▶ Contact your first-level support representative with any queries.

### **NOTICE**

*Modifications to this product which have not been expressly approved by the manufacturer will void any warranty. The manufacturer assumes no liability for personal injury or damage to materials which occur as the result of improper use of this product.*



## Declaration of Conformity with the Machinery Directive 2006/42/EC, Annex II 1A

Manufacturer:	Bosch Automotive Service Solutions GmbH Am Dörrenhof 1 85131 Pollenfeld-Preith Germany
Authorized to compile the technical documents:	Bosch Automotive Service Solutions GmbH Am Dörrenhof 1 85131 Pollenfeld-Preith Germany
Product Name:	Transmission support
Product Type:	Load holding device
Product Number:	T90003

We hereby declare that each product described above complies with the relevant clauses of the 2006/42/EC Machinery Directive.

Any modification to a product not expressly approved by the manufacturer will void the validity of this declaration.

The following harmonized standards have been applied:

EN ISO 12100:2010	Safety of machinery - General principles for design - Risk assessment and risk reduction
EN 13155:2003+A2:2009	Cranes - Safety - Non-fixed load lifting attachments

Pollenfeld, January 18, 2019  
Place, Date

Matthias Wagner, Managing Director