

JOB NAME \_\_\_\_\_

CONTACT \_\_\_\_\_

ORDERING CODE \_\_\_\_\_

## CABLE ORDERING CODE

LM-79

SERIES	EXT	exterior
TYPE	SKY-CABLE	skyline, suspension power cord

## SKYLINE SYSTEM

Skyline Outdoor/Indoor Catenary Cable IP67

System Hardware

ORDERING CODE \_\_\_\_\_

Follow the steps to specify your fixture, example:  
EXT / SKY - CABLE

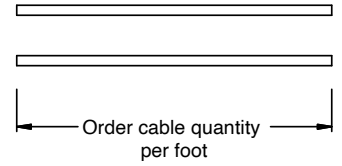
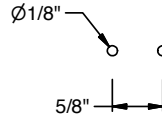

### DESCRIPTION

SKYLINE is a lightweight, highly versatile, and exceptionally elegant catenary system for indoor and outdoor applications. Up to 780 lumens from a 1" aperture cylinder. SKYLINE enables safe, reliable, clutter-free catenary on strong woven Kevlar, self-healing cable with marine grade, hard anodized aluminum fixture housings. Applications are endless, from outdoor gathering spaces to indoor accent lighting for retail and hospitality.

### MOUNTING

- Twin cable powered suspended catenary system.
- Kevlar / Copper cable braid, breaking strength of 100Kg / 220lbs.
- Hydrolysis UV resistant TPE outer jacket, Black.
- Dim over power. 0-10V and Dali (together)
- Ambient operating temperatures Min. -40°F / Max 131°F.
- Kevlar Cable (set of 2): 0.022 lbs. / 0.35 oz. per foot.
- Turnbuckles (set of 2): 0.175 lbs. / 2.80 oz.
- Strain Reliefs (set of 4): 0.058 lbs. / 0.93 oz.
- Wall mounting plate: 0.087 lbs. / 1.39 oz.
- Eyebolt: 0.055 lbs. / 0.88 oz.
- Pole/Tree strap: 0.25 lbs. - 0.5 lbs. / 4 oz. - 8 oz.

### LISTING

- ETLus listed to UL2108 (suitable for dry, damp and wet locations)
- cETL listed to CSA C22.2 #250.0

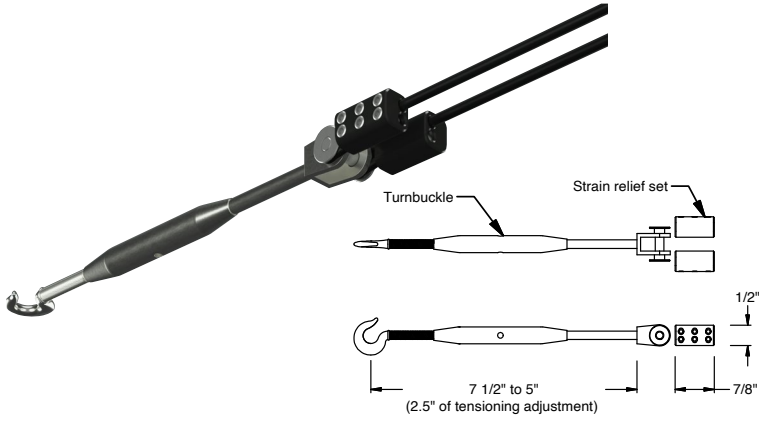

## TURNBUCKLE ORDERING CODE

<b>SERIES</b>	<b>EXT</b>	exterior
<b>TYPE</b>	<b>SKY-TB</b>	skyline, single turnbuckle and strain reliefs set

ORDERING CODE

Follow the steps to specify your fixture, example:  
**EXT / SKY - TB**

### DESCRIPTION

- Turnbuckle: 0.0875 lbs. / 1.40 oz.
- Strain Reliefs (set of 2): 0.024 lbs. / 0.47 oz.

## WALL MOUNT ORDERING CODE

<b>SERIES</b>	<b>EXT</b>	exterior
<b>TYPE</b>	<b>SKY-WALL</b>	skyline, universal wall mount

ORDERING CODE

Follow the steps to specify your fixture, example:  
**EXT / SKY - WALL**

### DESCRIPTION

- Wall plate: 0.087 lbs. / 1.39 oz.

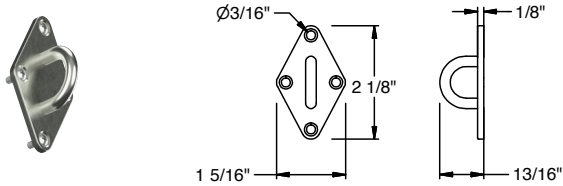

## POLE/TREE MOUNT ORDERING CODE

<b>SERIES</b>	<b>EXT</b>	exterior
<b>TYPE</b>	<b>SKY-POLE</b>	skyline, pole/tree mount
<b>SIZE</b>	1 <sup>1</sup>	2.5" to 3.5", diameter
	2	5.75" to 7.75", diameter
	3	8.75" to 10.75", diameter
	4	10.50" to 12.50", diameter
	5	15.5" to 17.25", diameter

ORDERING CODE

Follow the steps to specify your fixture, example:  
**EXT / SKY - POLE / 2**

**NOTE**  
1. for additional strap diameters consult factory.

### DESCRIPTION

- Tree/Pole clamp: 0.25 lbs. - 0.5 lbs. / 4 oz. - 8 oz.

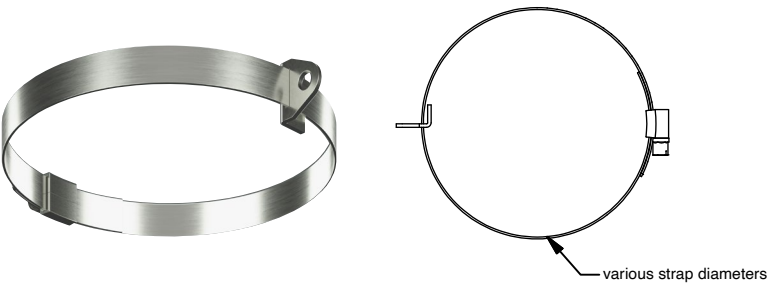

Consult factory for specific strap diameter

## EYEBOLT MOUNT ORDERING CODE

<b>SERIES</b>	<b>EXT</b>	exterior
<b>TYPE</b>	<b>SKY-MAS</b> <b>SKY-TIM</b> <b>SKY-MET</b>	skyline, eyebolt mount for masonry skyline, eyebolt mount for timber skyline, eyebolt mount for sheet metal

ORDERING CODE

Follow the steps to specify your fixture, example:  
**EXT / SKY - MAS**

### DESCRIPTION

- Eyebolt: 0.055 lbs. / 0.88 oz.

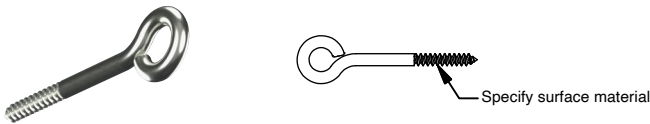

## REMOTE DRIVER 10V - ORDERING CODE

### DESCRIPTION

- Meanwell HLG-150H / 320H Class 1 Constant Voltage LED Power Supply
- Up to 12 Skylines on 150W and 25 on 320W
- 0-10V Dimmable to 10%
- 12"x12"x4" Indoor or Outdoor metal housing.
- (2x) 1/2 KOs, (4x) 3/4 KOs, (3x) 1 KOs, (1x) 1-1/4 KOs and (4x) mounting holes

### ELECTRICAL/CONTROLS

- 90-305 VAC, 47-63Hz input
- 150W / 320W max output
- Ambient temperature @ full load: -40°C / -40°F to +60°C / 140°F
- NEMA 3R enclosure
- Outdoor rated: Rainproof
- Short circuit protection
- Overload protection
- Over-voltage protection
- Thermal protection
- Built in PFC function
- Box: Length = 12", Height = 12", Width = 4"
- Driver: Length = 8-5/8", Width = 2-5/8", Height = 1-1/2"

<b>PART NUMBER</b>	<b>P70495</b>	LED driver with box
<b>VOLTAGE</b>	<b>24</b>	24V
<b>DIMMING</b>	<b>10V</b>	0-10V dimming to 10%
<b>ELECTRICAL OPTIONS</b>	<b>150</b> <b>320</b>	150W 320W

### ORDERING CODE

Follow the steps to specify your fixture, example:  
**P70495 - 24 - 10V - 150**

#### A: MAXIMUM WIRING DISTANCE FROM DRIVER TO START OF RUN LENGTH AT VARIOUS LOADS

NO. OF SKYLINES	5	10	15	20	25
<b>AWG VALUE</b>	<b>DISTANCE (FT)</b>				
10	100	100	75	60	40
12	100	75	50	40	30
14	75	50	35	25	20
CATENARY CABLE (18AWG)	"AS NEEDED" MUST SUBTRACT FROM - "CATENARY RUN LENGTH", SEE WIRING DESIGN GUIDE 1				

#### B: MAXIMUM CATENARY RUN LENGTH AT VARIOUS LOADS

NO. OF SKYLINES	5	10	15	20	25
<b>DRIVER OUTPUT</b>	<b>DISTANCE (FT)</b>				
150W	210	105	N/A	N/A	N/A
320W	210	105	70	52	42

## REMOTE DRIVER

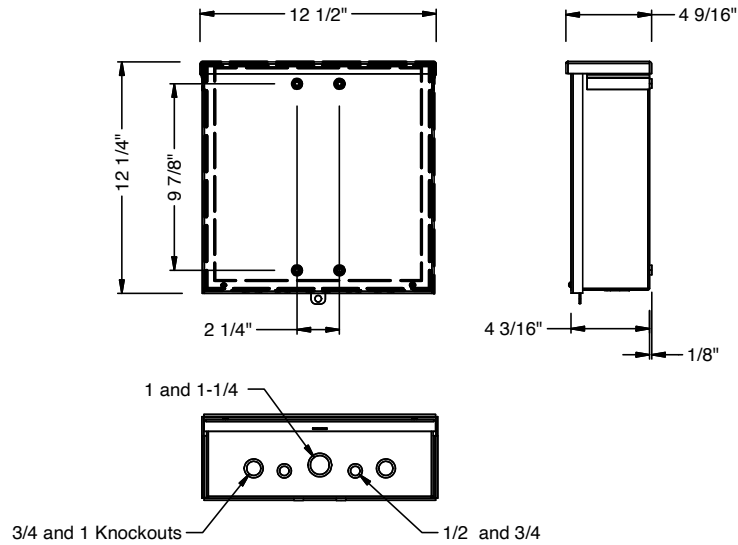
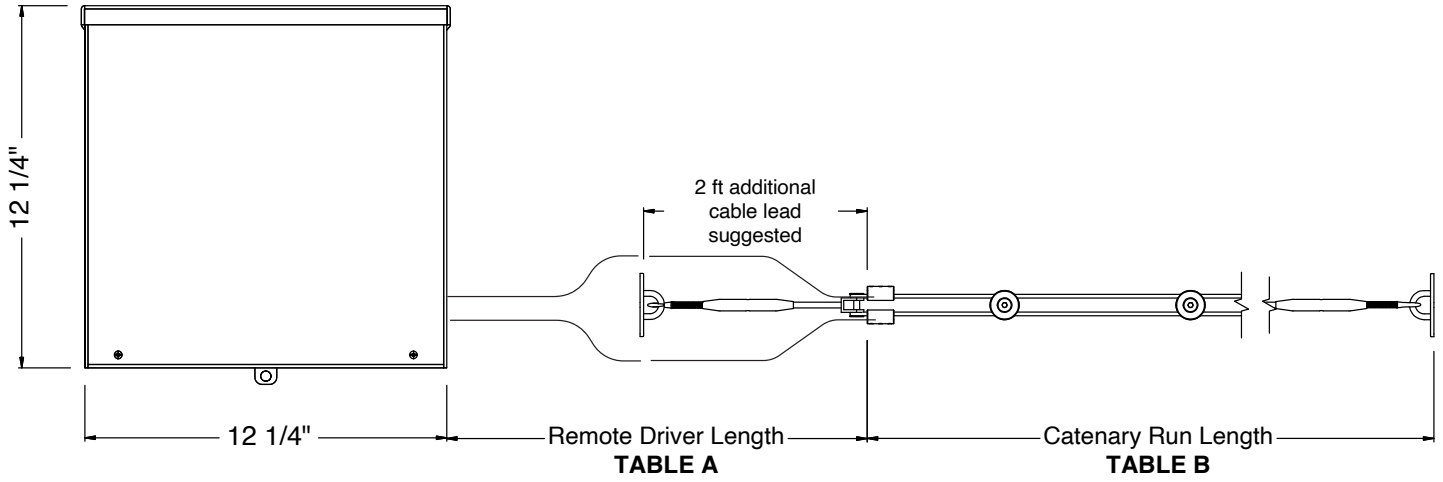

## WIRING DESIGN 1

Example: 15 Skylines at a maximum of 70 ft of Kevlar cable, but only need 50ft of catenary run.  
The remaining 20ft can be designated for remoting to the driver.

NOTE: Run lengths will vary based on number of skylines and installation requirements.

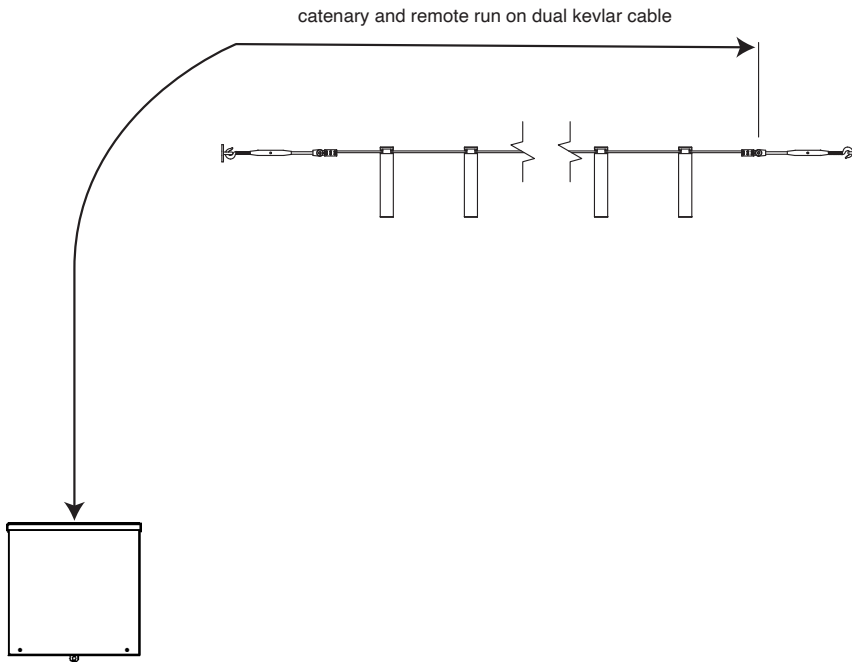

## WIRING DESIGN 2

