

2005 | ADMIRAL[®] SE

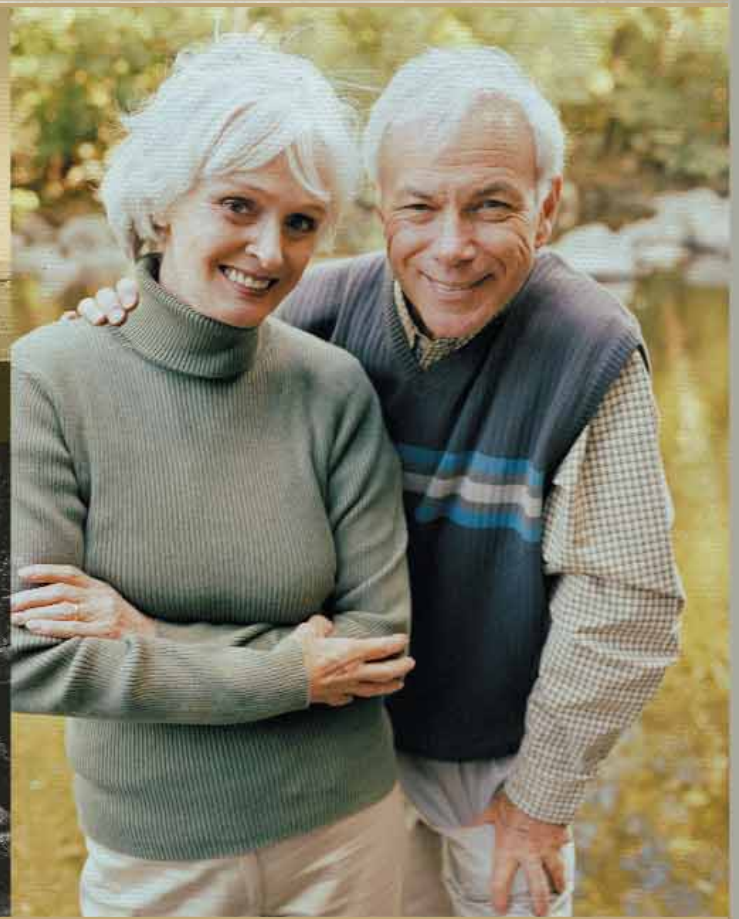

This is Living[®]

 HOLIDAY RAMBLER[®]

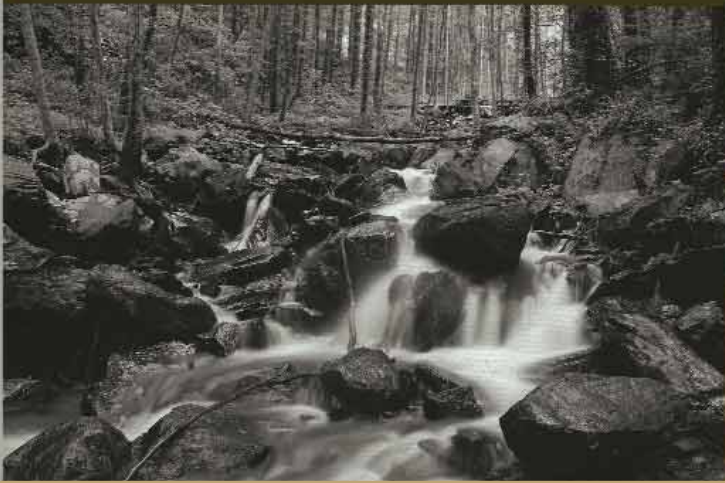



This is Living[®]

Fifty-one years. It's a proud reminder of our many accomplishments. After all, we were there from the start of an industry, and innovation by innovation we've led the way toward creating a rich and wonderful RV lifestyle.

Maybe it's not until you own a Holiday Rambler that you can truly feel the strength of our heritage. You'll feel it in the peace of mind you'll have knowing your family's in the safest RV on the road. You'll feel it in the quality of your experiences, thanks to the hundreds of conveniences we've developed. And you'll feel it when you realize you're free to roam throughout North America with confidence, knowing our network of support is with you every mile of the way.



So join us as we look forward to a new model year. For 2005, we're celebrating an exciting new lineup, full of more groundbreaking products and high-tech advances than ever.



2005 ADMIRAL SE

THE ROAD'S BEST VALUE.

When you're ready to step up to a gas motorhome, you can be confident you'll find Holiday Rambler's legendary quality in every coach we build. Our commitment to innovation extends throughout our lineup, including the 2005 Admiral SE. This value-packed RV is highlighted by our exclusive Alumaframe® superstructure and multi-layer insulation. And this year, it boasts a whopping 32% increase in storage capacity, so you can plan to bring along everything you need for your family's outdoor adventures.



Holiday Rambler®

1954 - 2005



CASTLE GATE DECOR WITH VINTAGE OAK WOOD.

36DBD



{ SEE MORE. DO MORE. LIVE BETTER. }

Welcome aboard the 2005 Admiral SE. Allow us to point out some of the quality, value and innovation that make this affordable gas motorhome the best choice in its class. To begin with, you'll notice the warmth and beauty of the woodwork. Details include raised panel doors on the overhead cabinets, stylish satin brass hardware, new wood slide-out fascia and wood grain crown molding. To customize the coach to fit your lifestyle, you'll choose from a long list of furniture options — in both plush fabric and soft touch vinyl coverings. You'll also enjoy upgraded padded carpeting in the living area and bedroom, paired with optional laminated plank flooring or Armstrong laminated tile flooring in the kitchen, bath and entryway.

As you look to the front of the coach (below), you'll see the large, comfortable cockpit seats, shown here in optional soft touch vinyl. And overhead, you'll find the 24" flatscreen stereo TV, as well as cabinets with smoked glass doors for the optional VCR and DVD player.





{ READY AND WAITING
FOR YOUR NEXT ADVENTURE. }

The Admiral SE's stylish efficiency is designed to take you wherever the next road leads. In the kitchen, you'll enjoy a full complement of high-quality appliances, with attractive options that include a large double-door refrigerator with optional ice maker and a versatile convection microwave. The dining area comes standard with a wood booth dinette with side-sliding table top and convenient storage doors. Or, you may choose the optional freestanding table and chairs shown here. In the living area, an optional hide-a-bed sofa enhances the flexibility of your floorplan, giving you more sleeping room for family or guests. And in the bedroom, you'll love the queen bed with beautifully coordinated bedspread and decorative pillows. On most floorplans, a swing-away cabinet neatly houses the optional 19" color TV with remote control.

This year, the Admiral SE features new side-hinged baggage doors, making it easier to see and reach items stowed below. Plus, with new pass-through bays, the coach has a 32% increase in storage capacity. You can also count on your Holiday Rambler to have the most reliable slide-out construction in the industry — for years of trouble-free operation.





CASTLE GATE DECOR WITH VINTAGE OAK WOOD.

36DBD



ALUMAFRAME® CONSTRUCTION SINCE 1966:

The Admiral SE features Holiday Rambler's exclusive Alumaframe® Superstructure. Our revolutionary system of aluminum C-Channel crossmembers runs the entire length of the unit, with double-welded intersections for added strength. This rigid design is both lighter and sturdier than wood or tubular aluminum frames — and much more reliable than butt-welded or screwed joint designs. From dirt roads to potholes, you can count on Alumaframe® to handle the relentless stresses of the road and provide superior structural integrity for many years to come.



Alumaframe®



Wood

Aluminum (Butt-Welded)

Alumaframe® (C-Channel)

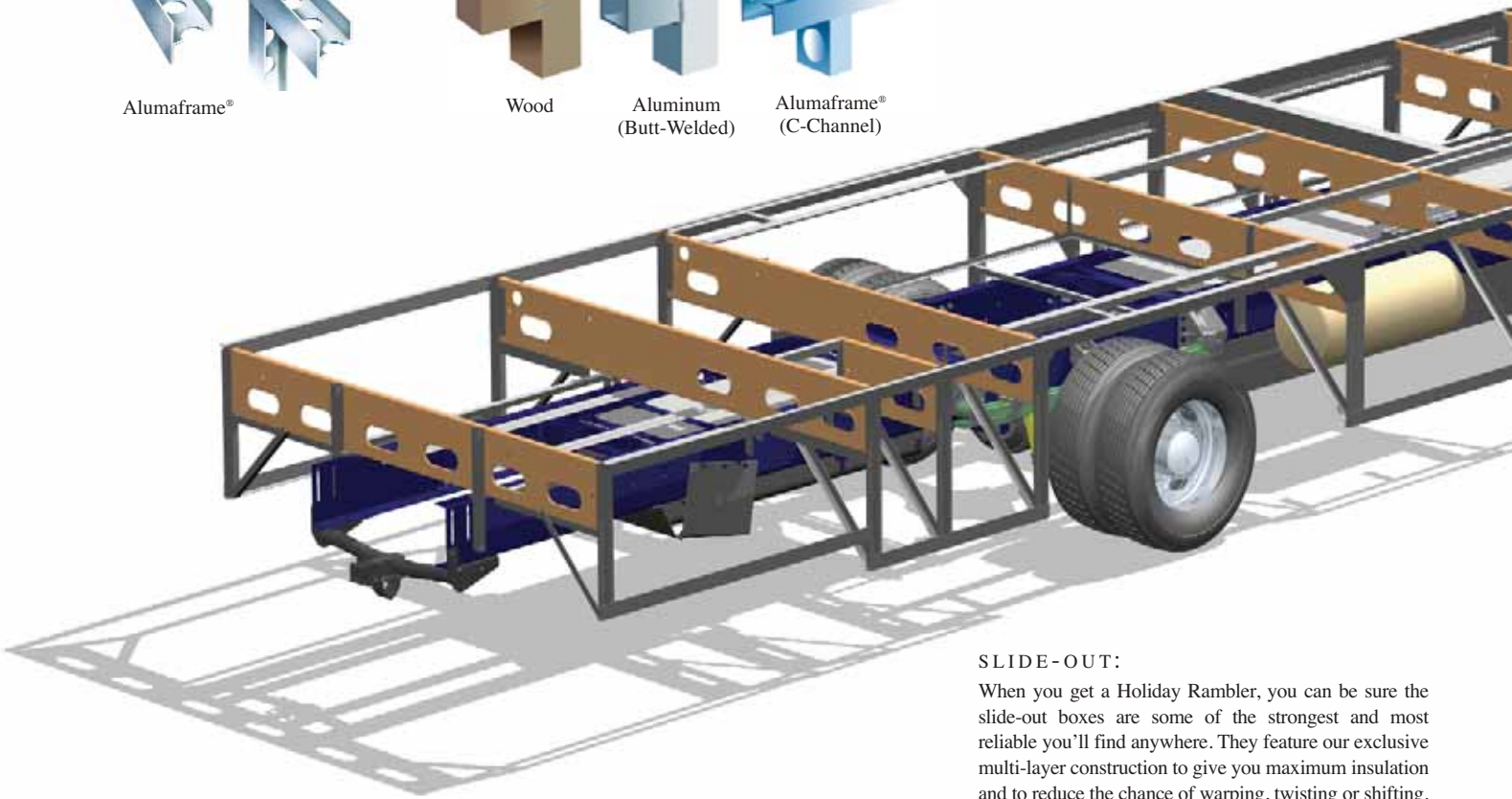

SLIDE-OUT:

When you get a Holiday Rambler, you can be sure the slide-out boxes are some of the strongest and most reliable you'll find anywhere. They feature our exclusive multi-layer construction to give you maximum insulation and to reduce the chance of warping, twisting or shifting.



9-LAYER ROOF: (top to bottom)

- Peaked aluminum roof
- Luau backing
- Thick, tapered bead foam insulation
- Aluminum double I-beam superstructure filled with fiberglass insulation
- Vapor barrier
- Structure foam: thermal insulative barrier
- 1/2" bead foam insulation
- Foam padding for extra insulation
- Padded vinyl ceiling

5-LAYER EXTERIOR WALL: (top to bottom)

- Smooth .063 aluminum is standard, gel coat fiberglass is optional
- Interlocking C-Channel filled with 1-1/2" fiberglass insulation bonded in place so it doesn't sag or leave spaces uninsulated
- Vapor barrier
- Bead foam adds comfort, saves energy and provides a thermal insulative barrier
- Interior paneling

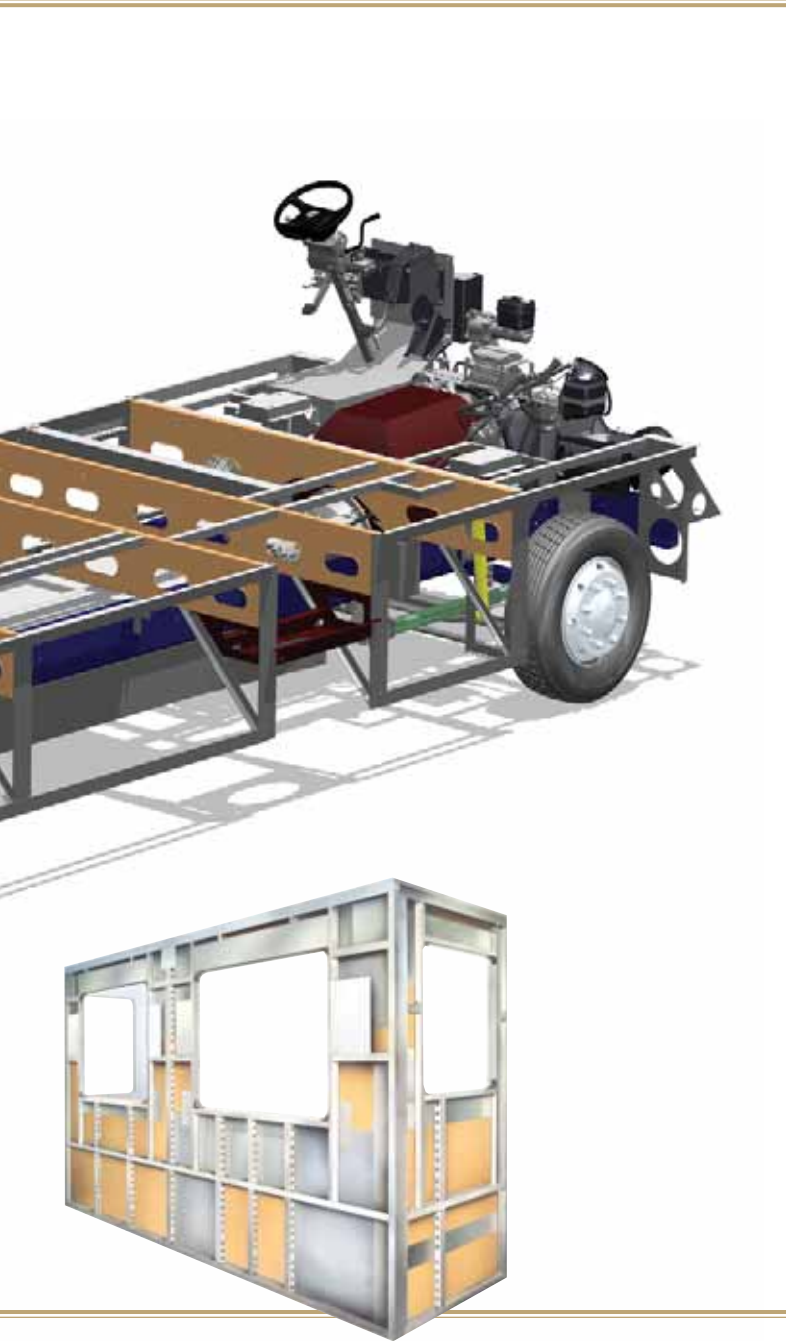

SMARTSTRUCTURE II: STRONGER AND BETTER

The SmartStructure II achieves overall chassis strength by optimizing the inherent benefits of strain hardened steel in conjunction with an aerodynamic metal removal principle to allow stress flow in the truss system to evenly distribute both static and dynamic loading across the coach platform.

Integrity is stamped into the truss system instead of relying on the welds of the tubular structure.

This equates to 40% fewer welds and strategically located metal removal to reduce the overall chassis weight and provide for greater carrying capacity.

SmartStructure II is fully integrated with your choice of Ford or Workhorse Chassis.



- 4-LAYER FLOOR:**
(top to bottom)
- Structurwood™
 - Blue foam insulation
 - 1-1/2" aluminum tube
 - Three-ply poly underbelly





CELEBRATING THE FREEDOM OF CHOICE.

At Holiday Rambler, we're dedicated to giving you more ways to help you create the coach of your dreams. That's why the Admiral SE features a wide selection of exciting double and triple slide-out floorplans, with numerous furniture options to fit your lifestyle. In addition, our designers have created exquisite color and fabric combinations to give you the most beautiful interiors you'll find anywhere. Add to that the woodwork of your choice, and you'll have a luxurious motorcoach you can truly call home.

A	B
	C
	D

- A Sofa
- B Accent
- C Bedspread
- D Carpet

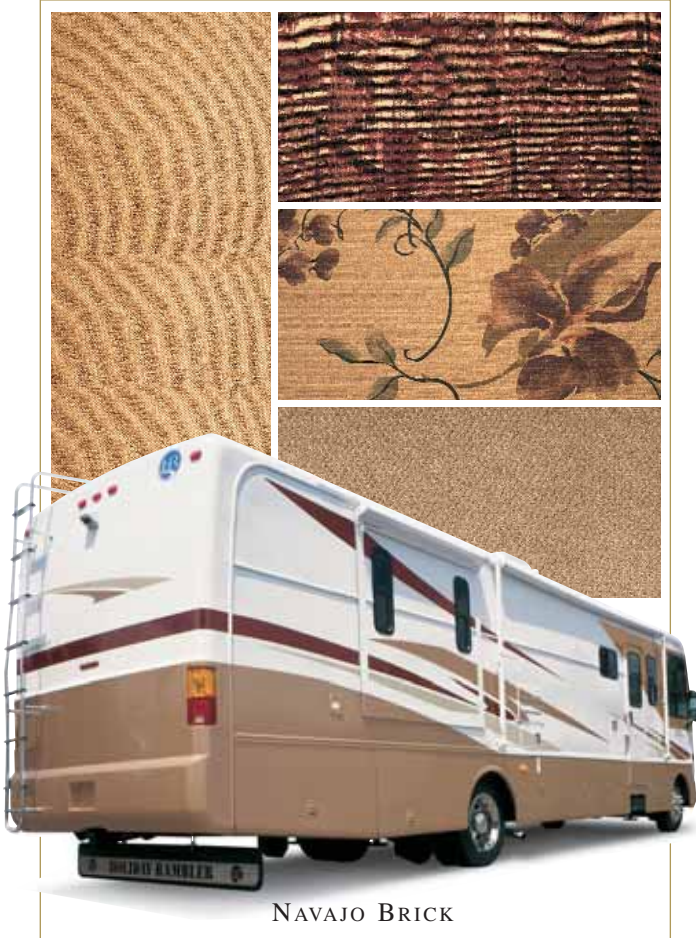





CASTLE GATE

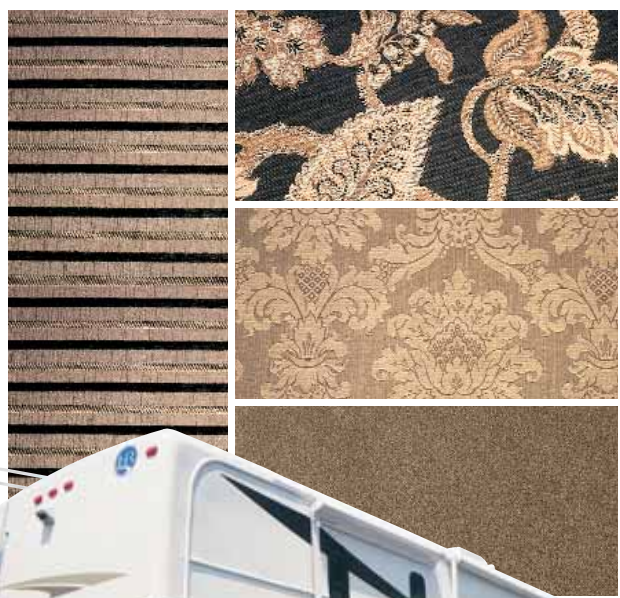

SILVER SAGE



EBONY VINE



**BETTER
STAIN
PROTECTION**

Manufactured in, not added on. For added protection against stains, Dupont Teflon® soil repellent is applied to virtually all upholstery fabric during the finishing process for superior coverage.*

*Brand and application of upholstery fabric protection may vary depending on date recreational vehicle was manufactured.



Vintage Oak



Autumn Cherry



Maple

**BODY CONSTRUCTION****STANDARD FEATURES**

- Alumaframe® Superstructure
- Steel Cage Cockpit Construction
- Peaked Aluminum Roof with Fiberglass Insulation
- Smooth Aluminum Exterior Walls
- Front and Rear Molded Fiberglass Caps
- Aluminum Framed Floor on Steel Trusses
- Laminated Structurwood™ Flooring
- Interior Paneling with 3/4" Insulation
- Foam Insulated Floor Framing with 3-Ply Underbelly
- One-Piece Engine Cover
- Power Heated Remote Exterior Mirrors with Bottom Convex
- Headlamps with Turn Signals
- Pass-Through Storage Bays under Slide-Outs with New Roto Cast Boxes (32% Increased Storage)
- Side-Hinged Baggage Doors, All Opening Doors Between Front and Rear Tires Where Applicable
- One-Piece Polyethylene Storage Compartment
- Wheel Mud Flaps
- Integrated Metal Fuel Door with Lock
- Painted Mask and Skirt with Vinyl Exterior Graphics
- Rear Ladder
- Interior Rubber Entry Step
- Exterior Triple Entry Steps
- Undercoating

OPTIONS

- Smooth Gel Coat Fiberglass Exterior Walls
- Full-Length Mud Flap

FORD CHASSIS/ENGINE/SUSPENSION**STANDARD FEATURES**

- 6.8L V-10 Gasoline Engine with Electronic Fuel Injection
- Engine Displacement: 6.8 Liters 415 Cu. In.
- Power: 310 HP; Torque: 425 lbs./ft.
- 4-Speed Automatic Transmission with Overdrive
- Fuel Tank Capacity 75 Gallon
- 130 Amp Alternator
- Rear Axle Ratio 5.38:1
- Radial Tires 235/80R 22.5G
- Polished Aluminum Wheels
- Leaf Spring Suspension

- ABS Brake System
- Hitch Receiver with Dual Connector 4-Pin or 7-Pin 4,000 Lb.
- SmartStructure II

WORKHORSE CHASSIS/ENGINE/SUSPENSION**STANDARD FEATURES**

- 8.1L V-8 Gasoline Engine with Electronic Fuel Injection
- Engine Displacement: 8.1 Liters 496 Cu. In.
- Power: 340 HP; Torque: 455 lbs./ft.
- 5-Speed Automatic Transmission with Overdrive
- Fuel Tank Capacity 75 Gallon
- 145 Amp Alternator
- Rear Axle Ratio 5.38:1
- Radial Tires 235/80R 22.5G
- Stainless Steel Wheel Liners
- Leaf Spring Suspension
- ABS Brake System
- Hitch Receiver with Dual Connector 4-Pin or 7-Pin 4,000 Lb.
- SmartStructure II

OPTIONS

- Fully Automatic Hydraulic Leveling System

COCKPIT**STANDARD FEATURES**

- Fiberglass Automotive Dash with Burlwood Instrumentation Panel and Two Tone Dash Vinyl
- CD Player/Radio with Four Speakers
- Multi-Positioned Sunvisors
- Pleated Front Privacy Drape with Braided Tie Backs
- Rear Vision System Prep
- Intermittent Windshield Wipers
- Tilt Steering Wheel
- Cruise Control
- Power Steering
- Electric Automotive Horn
- Redesigned Wood Center Console on Engine Cover, Recess Tray with Rubber Mat, and Plastic Two-Tier Cup Holders. Front Tip-Door Ford/Front Drawer Workhorse Chassis
- Two-Tier Side Cup Holders for Pilot Seat (N/A with Door Option)
- Two-Tier Side Cup Holders for Co-Pilot Seat with Magazine Rack Below
- Fabric Pilot and Co-Pilot Recliner Seats
- Carpeted Driver and Passenger Floor Mats



- Dash Workstation
- Wood Framed Cabinet Doors with Smoked Glass over Front Entertainment Center Systems
- Secure Front Cab over TVs with Steel Framing

OPTIONS

- Six-Way Power Pilot Seat
- Six-Way Power Co-Pilot Seat
- Soft Touch Vinyl Pilot and Co-Pilot Seats
- Rear Vision System with Audio and Adjustable Camera
- 3-Camera Rear Vision System with Audio and Adjustable Center Camera
- Pilot and Co-Pilot Pull-Down Sunshades
- CB Radio Prep
- Driver's Side Door with Power Window
- Cassette Radio Option Includes AM/FM Tuner, CD Player, Weather Band

APPLIANCES AND ACCESSORIES**STANDARD FEATURES**

- Large Double-Door Refrigerator
- High-Output 3-Burner Cooktop without Oven
- Bi-Fold Range Cover
- Spacesaver Microwave with Touch Control
- 24" Flatscreen Stereo Color TV with Remote Control in Living Area
- TV Antenna
- VCR Prep and Video Control Box with Booster
- Exterior Hook-Ups for DSS Dish and Cable
- Interior Cable TV Hook-Up and Telephone Jacks
- Digital Satellite System Prep
- Exterior Gas Line Hook-Up Prep for LP Accessories

OPTIONS

- Large Double-Door Refrigerator with Ice Maker
- Large Double-Door Refrigerator with Ice Maker 10 Cu. Ft.
- Large Four-Door Refrigerator with Ice Maker (N/A with Pantry)
- High-Output Three-Burner Range with Oven
- Spacesaver Convection Microwave with Touch Control
- Washer/Dryer Prep, Requires 50 Amp Service Option (N/A: 34SBD, 37PCT)
- Combination Washer/Dryer, Requires Washer/Dryer Prep Option (N/A: 34SBD, 37PCT)
- Living Area Stereo TV Wired through Ceiling Speakers
- 19" Color TV with Remote Control in Bedroom
- VCR
- DVD Player
- Exterior Entertainment Center, CD Player Radio with Two Speakers

INTERIOR**STANDARD FEATURES**

- Vintage Oak Cabinetry
- Raised Panel Cabinet Doors on Overhead Cabinets, Flat Panel Doors on Base Cabinets and Wardrobes
- Cabinet End Panels
- Black ABS Refrigerator Insert
- Decorative Wallboard
- Wallpaper Border Kitchen and Bath
- Self-Supporting Top-Hinged Overhead Storage Doors and Positive Catches on All Other Doors
- Heavy-Duty Ball Bearing Drawer Guides
- Wood Cabinet Drawer Boxes
- Wood Interior Grab Handle on Cabinet at Entry Door
- Brass Finished Entry Rail for Stepwell
- Satin Brass Cabinetry Hardware and Bath Accessories
- Integrated Cup Holder to Slide-Out next to Sofa
- Laminate Kitchen Countertop with Stainless Steel Sink, Brushed Nickel Faucet and Two Sink Covers
- Toe Kicks Kitchen and Bath Base Cabinets
- Laminate Bathroom Countertop with Laminate Perm-Edge
- All Other Countertops Are Laminate with Wood Edge
- Kitchen Overhead Cabinets with Adjustable Shelf
- Kitchen Pantry next to Refrigerator with Adjustable Shelves in Upper Cabinet and Three Drawers below (N/A with Four-Door Refrigerator Option)
- Silverware Drawer with Organizer Kitchen Base Cabinets, (N/A with Range Option)
- Trash Can in Kitchen Base Cabinet
- Linoleum Flooring in Kitchen Flooring to Include Entry Door
- Linoleum Flooring in Center Bathroom
- Rear Bath Flooring to Match Flooring Selection of Kitchen and Front Bath (36DBD)
- Upgraded Nylon Carpeting with Pad in Living Area and Bedroom
- Soft Touch Padded Vinyl Ceiling
- New Wood Slide-Out Fascia with Vinyl Inserts
- Elongated Beveled Octagon Living Area or Bedroom Mirror, with Border under Mirrors Living Area Location (N/A: 36WDD)
- Picture Living or Bedroom Area, 34SBD End of Shower Wall (N/A: 36DBD, 37PCT)
- Bath Door with Accent Trim on Hallway Side
- Wood Trim for Bath Door Opening Hallway Side
- Wood Louvers on Washer and Dryer Doors (N/A: 34SBD, 37PCT)
- Magazine Rack Bathroom (N/A: 33PBD, 34SBD, 37PBD)
- Wood Grain Crown Molding in Bedroom and Living Area on All Open Walls
- Medicine Cabinet with Adjustable Shelves



- Bathroom Lavatory Base Mirror with Wood Frame
- Towel Rack on Back of Bath Door
- Satin Brass; Two Towel Rings in Bathroom
- Accent Mirror with Wood Trim on Rear Wall with Wall Border under Mirror (33PBD, 34SBD, 37PBD)
- Rear Wardrobe Closet with Deluxe Mirror Door Frames Brass Finish (36WDD)
- Bedroom Swing-Away TV Cabinets (Stationary TV on 36DBD)
- Bedspread with Two Decorative Pillows
- Fabric Headboard
- Blackout Day/Night Pleated Shades in Living Area and in Bedroom
- Mini Blinds in Kitchen and Bathroom, Where Applicable
- Soil Repellant on Fabric, Teflon® Fabric Protection

OPTIONS

- New Decors: Navajo Brick, Saville Row, Castle Gate, Silver Sage, Ebony Vine
- Wood Choice: Autumn Cherry and Maple
- Armstrong Laminated Flooring Kitchen and Bath, Flooring to Include Entry Door (Armstrong Laminated Tile or Laminated Plank Flooring is a Required Option)
- Laminated Plank Flooring in Kitchen and Bath (Laminated Plank Flooring or Armstrong Laminated Tile is a Required Option)
- Hardwood Raised Panel Doors on Refrigerator

FURNITURE**STANDARD FEATURES**

- Queen Bed with Nightstands
- Arched Back Wood Booth Dinette with Side Sliding Table Top and Drawers
- Fabric Jackknife Sofa, Two Pillows on All Sofas
- Fabric Swivel Glider Barrel Chair
- Fabric Swivel Glider Barrel Chair and Desk Chair Bedroom (37PCT)

OPTIONS

- Fabric Hide-A-Bed Sofa with Two Pillows
- Fabric Hide-A-Bed Sofa with Air Mattress and Two Pillows
- Soft Touch Vinyl Hide-A-Bed Sofa with Two Pillows
- Soft Touch Vinyl Hide-A-Bed Sofa with Air Mattress and Two Pillows
- Curbside Soft Touch Vinyl J-Lounge IPO Swivel Glider Barrel Chair and Computer Desk (37PBD)
- Fabric Electric Sofa IPO Jackknife Sofa
- Fabric Swivel Recliner Chair IPO Fabric Swivel Glider Barrel Chair
- Soft Touch Vinyl Swivel Recliner Chair IPO Fabric Swivel Glider Barrel Chair
- Fabric Swivel Glider Barrel Chair IPO Desk Chair Bedroom (37PCT)

- Curbside Two Fabric Recliners IPO Swivel Glider Barrel Chair and Computer Desk (37PBD)
- Curbside Two Soft Touch Vinyl Recliners IPO Swivel Glider Barrel Chair and Computer Desk (37PBD)
- Bedroom Desk (N/A: 37PCT)
- Adjustable Coffee Table
- Freestanding Dinette with Two Freestanding Chairs and Two Folding Chairs

ELECTRICAL SYSTEMS AND LIGHTS**STANDARD FEATURES**

- 30 Amp 120V Distribution Panel and Power Cord
- 55 Amp Electronic 12V Power Converter
- Onan® 5.5 kW Gas Generator
- Two 6V House Batteries
- Battery Disconnect Switches
- 12V and 110V Outlet in Cockpit Area
- Porch Light and Exterior Step Light on Same Switch
- Exterior Power Entry Step with Light
- Interior Stepwell Entry Step Lights
- Water Pump Switch in Service Bay Area and Interior Systems Panel
- Lights in Outside Storage Compartments
- 120V Receptacles in Outside Storage Compartment
- Underhood Utility Light
- Receptacle and Phone Jack in Dinette Area
- Directional Map Lights Pilot and Co-Pilot Seats
- Systems Control Center in Hallway
- Fluorescent Light(s) with Night Light Function under Kitchen Overhead
- Fluorescent Ceiling Lights Throughout
- Fluorescent Ceiling Lights inside Living Area Slide-Out House
- Decorative Wood Framed Galley Ceiling Fluorescent Light
- Decorative Satin Brass Lighting Living Room Wall Light, Dinette Overhead, Bedroom Cosmetic Vanity Light
- Satin Brass Decorative Bathroom Cabinet Light with Cover
- Halogen Lights under Living Room and Dining Room Overhead Cabinets
- Bullet Lights over Bed Satin Brass Finish with His and Hers Switches
- Decorative Side Lights inside Bedroom Slide-Out, on End Walls

OPTIONS

- Energy Management System with or without 50 Amp Service
- 50 Amp 120V Distribution Panel and Cord
- 140 Watt Inverter
- Storage Compartment Tank Monitor Gauge

**PLUMBING AND LP SYSTEMS****STANDARD FEATURES**

- Kitchen Stainless Steel Sink with Single Lever Brushed Nickel Faucet
- Separate Brushed Chrome Faucet for Filtered Water
- Bath Lavatory Faucet Single Handle Brass Finish
- Demand Water System and Water Pump
- 10 Gallon LP Gas/Electric Water Heater with Electronic Ignition, DSI
- Winterization Valving System
- Water Heater Bypass Valve
- Toilet with Sprayer
- No-Fuss Flush Holding Tank Rinsing System
- Insulated Systems Compartment with Easy Access to Hook-Up
- Shower inside Wet Bay with Hot/Cold Water
- Soap Dispenser inside Utility Bay
- Gravity and Pressurized Water Fill
- Contained Storage Area for Sewer Hose
- One-Piece Fiberglass Shower
- Shower Diverter, Shower Hose and Head
- Shower Light on Ceiling inside Shower
- Brass Shower Door Frame with Obscure Glass

OPTIONS

- RV Sani-Con 2 System, Holding Tank Flush System
- Bathtub Option IPO Shower

HEATING, VENTS AND AIR CONDITIONING**STANDARD FEATURES**

- One 13.5M BTU Air Conditioner with Ducted Air and Analog Wall Thermostat, Low-Profile Ford and Workhorse (33PBD, 34SBD)
- One 13.5M BTU and One 11.0M BTU Air Conditioner with Ducted Air and Wall Analog Thermostat Low-Profile Ford and Workhorse (N/A: 33PBD, 34SBD)
- 35M BTU Electronic Ignition Furnace
- Electronic Dash AC/Heat Climate Control System
- In-Floor Ducted Heating System with Metal Floor Registers
- Manual Roof Vent Kitchen (N/A: 33PBD, 34SBD)
- Manual Roof Vent Living Area (33PBD, 34SBD)
- 12V Roof Vent Bathroom
- Manual Roof Vent Bedroom (33PBD, 34SBD)
- Metal Air Return Grill Furnace Antique Brass Finish
- Metal Floor Registers Antique Brass

OPTIONS

- Dual 13.5M BTU Air Conditioner, Requires 50 Amp Service, Low-Profile Ford and Workhorse (N/A: 33PBD, 34SBD)
- One 13.5M BTU and One 11.0M BTU Air Conditioner, Low-Profile Ford and Workhorse (33PBD, 34SBD)
- Dual 13.5M BTU Air Conditioner with Heat Pumps, Requires 50 Amp Service, Low-Profile Ford and Workhorse
- One 13.5M BTU Air Conditioner with Heat Pump, Kitchen (N/A with Twin Air Conditioner, Low-Profile Ford and Workhorse) (33PBD, 34SBD)
- 12V Attic Fan Kitchen (N/A with Single Air Conditioner)
- 12V Attic Fan Living Area (N/A with Twin Air Conditioners)
- 12V Heater in Wet Bay, Heat Pad on Fresh Tank (N/A: 36DBD)

WINDOWS, DOORS AND AWNINGS**STANDARD FEATURES**

- Radius Flush Mount Single Pane Safety Glass Dark Tinted Slider Windows
- Bathroom Window (36WDD, 36DBD, 37PCT)
- Radius Entrance Door with Clear Glass, Roller Shade, Screen Door and Anti-Skid Steps
- Two Interior Grab Handles and One Exterior Grab Handle
- Topper Slide-Out Awnings Living Area and Bedroom
- Protecta Glaze Tinted Plexiglas® Skylight in Bathroom
- Awning Rail

OPTIONS

- Radius Flush Mount Dual Pane Safety Glass Dark Tinted Slider Windows
- Texture Vinyl Patio Awning
- Eclipse Texture Vinyl Automatic Patio Awning
- Texture Vinyl Window Awnings Living Area Slide-Out House Windows
- Texture Vinyl Side Window Awning Bedroom (N/A: 37PCT)

SAFETY**STANDARD FEATURES**

- Fire Extinguisher
- Deadbolt Lock on Entrance Door
- 120V GFI Protected Circuit, Kitchen, Bath and Exterior
- LP Gas Detector
- Smoke Detector
- Carbon Monoxide Detector
- Pilot and Co-Pilot Three-Point Seat Belts
- Third Brake Safety Light
- Egress Windows

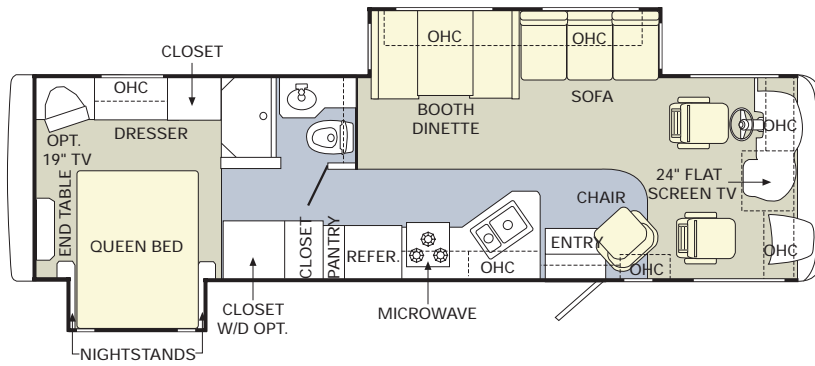

33PBD

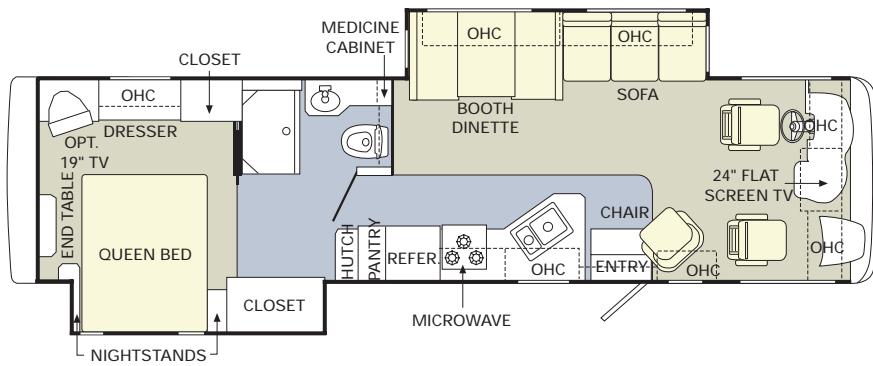

34SBD

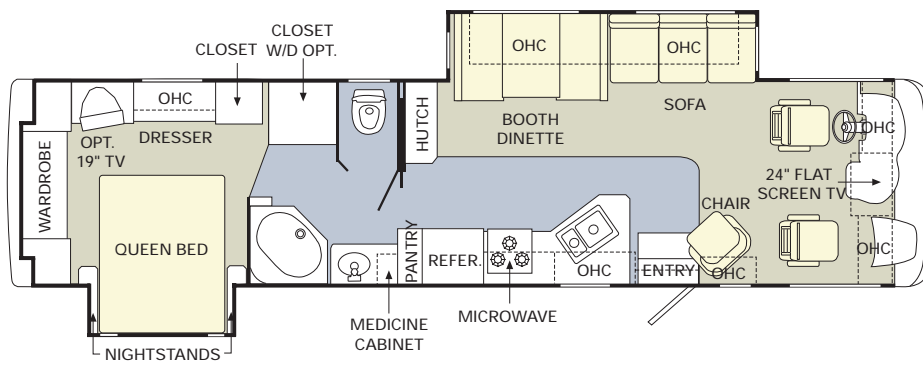

36WDD

- CARPET
- LINOLEUM
- PLANK FLOORING

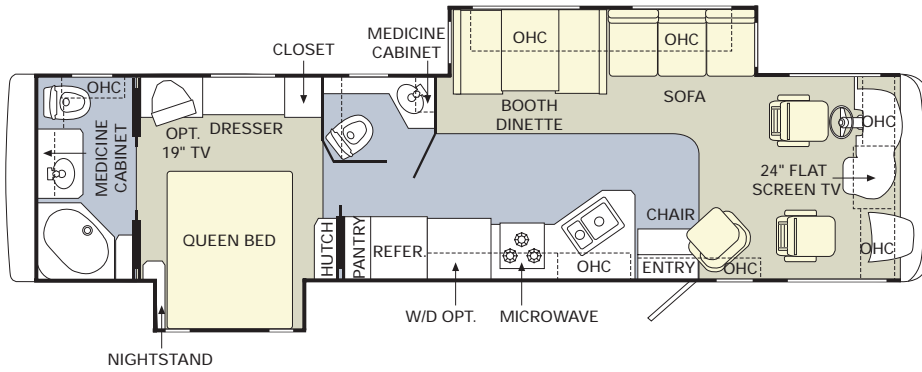

36DBD

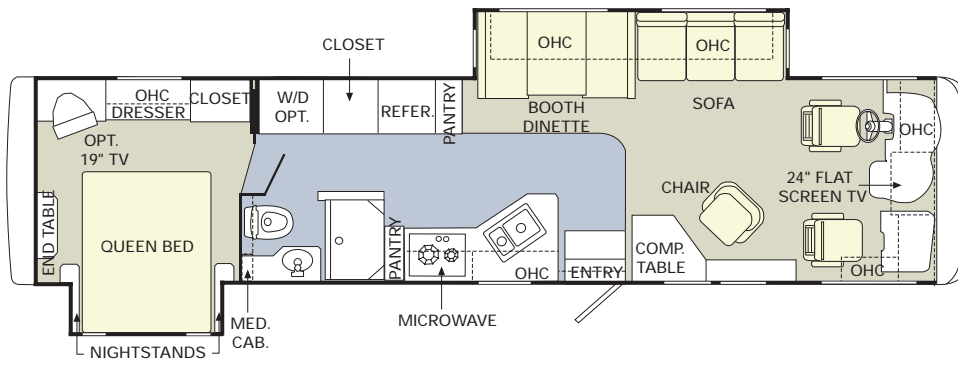

37PBD

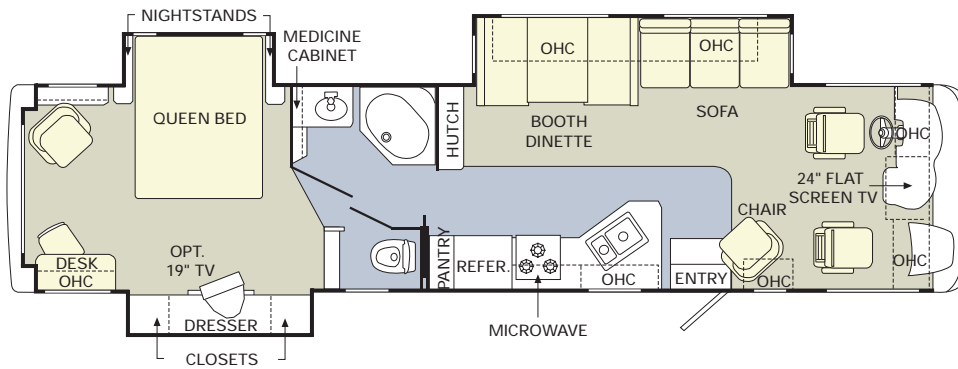

37PCT



Weights* (Ford Chassis)	33PBD	34SBD	36WDD	36DBD	37PBD	37PCT
Gross Vehicle Weight Rating (Lbs.)	22,000	22,000	22,000	22,000	22,000	22,000
Gross Combined Weight Rating (Lbs.)	26,000	26,000	26,000	26,000	26,000	26,000
Front Gross Axle Weight Rating (Lbs.)	7,500	7,500	7,500	7,500	7,500	7,500
Rear Gross Axle Weight Rating (Lbs.)	14,500	14,500	14,500	14,500	14,500	14,500

Weights* (Workhorse Chassis)	33PBD	34SBD	36WDD	36DBD	37PBD	37PCT
Gross Vehicle Weight Rating (Lbs.)	22,000	22,000	22,000	22,000	22,000	22,000
Gross Combined Weight Rating (Lbs.)	26,000	26,000	26,000	26,000	26,000	26,000
Front Gross Axle Weight Rating (Lbs.)	8,000	8,000	8,000	8,000	8,000	8,000
Rear Gross Axle Weight Rating (Lbs.)	14,500	14,500	14,500	14,500	14,500	14,500

Measurements						
Wheelbase	228"	228"	242"	242"	242"	242"
Overall Length	34' 3"	35' 2"	36' 9"	36' 9"	37' 4"	37' 4"
Overall Height (including A/C) (Ford)	11' 9"	11' 9"	11' 9"	11' 9"	11' 9"	11' 9"
Overall Height (including A/C) (Workhorse)	12'	12'	12'	12'	12'	12'
Interior Height	6' 6"	6' 6"	6' 6"	6' 6"	6' 6"	6' 6"
Interior Width	94.5"	94.5"	94.5"	94.5"	94.5"	94.5"
Exterior Width	100.5"	100.5"	100.5"	100.5"	100.5"	100.5"

Tank Capacities**						
Water Heater (Gal.)	10	10	10	10	10	10
Gray (Gal.)	45	40	45	42/39	42	45
Black Tank (Gal.)	54	42	54	42/39	42	54
Fresh Tank (Gal.)	60	60	60	60	60	60
LP Tank *** (Gal.)	24	24	24	24	24	24

* Towing capacity is limited by GCWR; your vehicle's towing capacity is the difference between the GCWR and the actual vehicle weight, including all water, fuel, passengers and cargo. Your towed vehicle should be equipped with auxiliary brakes if the weight of the towed vehicle exceeds 1,000 lbs. Consult your Owner's Manual for further towing information.

** Variances in the fabrication and installation of the tanks may cause the actual "usable capacity" to be greater or less than the capacities designated above.

*** Actual filled LP capacity is 80% of listing due to safety shut-off required on tank.

Due to the large variety of options and floorplan arrangements available to our customers, actual weights for each unit can differ significantly. Holiday Rambler provides a weight sticker on each unit we produce which includes that unit's tank capacities and approximate weight. Consult your local Holiday Rambler dealer for unit availability and further information.

The information printed in this brochure reflects product design, fabrication, and component parts at the date of printing. The manufacturer reserves the right, at any time, to make changes in product design or material or component specifications as its sole option, without notice. This includes the substitution of components of a different brand or trade name, which will result in comparable performance. All information printed in this brochure is subject to change after the date of printing. Some features shown or mentioned in this brochure are optional and may only be available in selected floorplans. Photographs may show props or decorations that are not standard equipment on Holiday Rambler models. Holiday Rambler, the HR logo and its design, are registered trademarks. All other products and company names are trademarks and/or registered trademarks of their respective holders.

While the color of the motorhome's exterior and the interior fabrics depicted in this sales brochure are fair and reasonable depictions, the colors depicted may not be an exact match of the actual colors because of the variances in photo-processing and variances caused by inserting the photographs within the sales brochure. Due to product improvements, changes during the model year and/or transcription errors that may occur, information represented within this brochure may not be accurate at the time of your purchase. If certain information is significant to your purchasing decision, please confirm the information with your dealer prior to submitting your order.

The actual overall length of the recreational vehicle may differ from that indicated in the brochure due to variances in the manufacturing process and/or installed components. The actual length may be greater or less than that indicated.

Component part and appliance manufacturers issue limited warranties covering those portions of the recreational vehicle not covered by the Limited Warranties issued by the Monaco Coach Corporation companies. To learn more on what specific component parts and appliances are excluded from the Limited Warranties issued by the Monaco Coach Corporation companies please contact your selling dealership or Monaco Coach Corporation directly or review the warranty packet inside the recreational vehicle.



{ IT'S ALL ABOUT BUILDING A LASTING RELATIONSHIP. }



WELCOME TO THE FAMILY ADVANTAGE.

What is the Family Advantage? It's all the ways we put the strength of our family to work for yours. It's the unmatched level of teamwork, expertise and combined experience of all our companies.

It's our ability to respond rapidly to our owner's needs, with new features and technologies. And it's our commitment to value and to giving you more RV for your money.

The most important aspect of the Family Advantage is being there when you need us. Our staff is available 24/7/365 to help you with virtually any situation that may arise — with troubleshooting, operational instruction or facilitating repairs at the nearest of our 350 nationwide service centers. In addition, you will be enrolled in our Owner Advantage Roadside Assistance Program free of charge for your first year of ownership — providing additional emergency assistance, including towing, tire repairs and many more services around the clock. No matter where you are, someone is standing by to talk with you 24 hours a day — to help you get the most from your time on the road.

In short, when you purchase an RV from Monaco Coach Corporation, you get a wider array of benefits than any other manufacturer can offer. To see it all for yourself, call 1-800-634-0855 or 1-800-650-7337. We'd love to meet you Monday through Friday for a tour of one of our state-of-the-art production facilities in Oregon or Indiana.



350 | SERVICE FACILITIES
NATIONWIDE AND GROWING.

OWNER ADVANTAGE ROADSIDE ASSISTANCE PROGRAM
At no charge to you in your first year of ownership, we offer an extensive support program that provides complete roadside assistance and special motor club benefits that follow you wherever your travels take you. This coverage also includes one additional family vehicle at no extra charge! Highlights include towing, tire repairs, fuel delivery, lock-out service, service appointment assistance, trip interruption coverage and much more.

WARRANTIES

12 MONTH/24,000 MILE
basic limited warranty

5 YEAR/50,000 MILE
limited warranty on aluminum or steel frame structure of sidewall, roof, front and rear cap

Applies to certain models. See owner's manual for complete details.



2005 | ADMIRAL® SE



This is Living®



HOLIDAY RAMBLER®

This is Living®

www.holidayrambler.com

(800) 245-4778

MONACO COACH CORPORATION

Monaco is traded on the New York Stock Exchange under the listing MNC
© 2004, Monaco Coach Corporation 1104 NPN:BROHADM Litho in USA.

