

2006

# Captiva™

LIGHTWEIGHT  
TRAVEL TRAILERS  
by COACHMEN

GO WHERE THE FUN IS



Leader to the Great Outdoors®



You've been dreaming about the weekend... your own mini vacation. The Captiva by Coachmen RV is designed to move you, your family and friends to the places where some of life's best memories begin. Lightweight Captiva provides the ultimate in flexibility for active families on the go. Hook up to Captiva and pull away from your everyday world with all the comforts of home in tow.

# Captiva™



The power rear bed slide out on the Captiva EX models opens up to provide comparable interior living space to a traditional travel trailer that tows several feet longer. When the rear slide is retracted for travel you have a shorter unit that is easy to tow, without sacrificing valuable interior space. (Shown in Summit Maple)



Storage a-plenty in the modern kitchen area. Interior cabinet storage is maximized through thoughtful design like the floor ducted heat (no heat ducts running through the cabinetry), and an under cabinet mounted CD player. The Captiva also boasts many residential style amenities such as the one-piece molded countertops, high spout faucet, under sink silverware drawer, hidden hinges and the optional double door refrigerator and range with oven.



## OPEN WIDE AND SAY AHHH



An under sink silverware drawer is a convenient feature that helps to maximize interior storage space. The molded divider tray is also easily removable for cleaning.

TUSCAN BLUE



# TRAVEL TRAILERS BY COACHMEN LIGHTWEIGHT AND EASY TO TOW...



6'6"  
INTERIOR  
HEIGHT



Convenient wall organizers at each bunk are the perfect place for your children's knick nacks, shoes, games, etc...

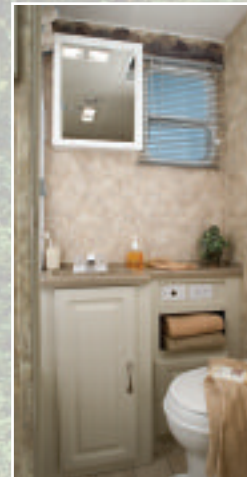

The bath area features a one-piece molded lav countertop, a convenient medicine cabinet and a user-friendly foot pedal toilet for hands free use.

## DECOR SELECTIONS

Dazzling interiors feature skillfully coordinated upholstery and window treatments. Coachmen RV chooses only top-grade fabrics wear-dated as heavy-duty. These fabrics have been tested for durability beyond 15,000 double rubs (in and out action) to simulate heavy usage. An average chair in an American home is subjected to only 3,000 double rubs per year.

### FABRIC KEY

A Main B Accent C Bedspread

The Captiva was designed with your family in mind. Convenient features such as the 6'6" tall interior ceiling height, indoor/outdoor dinette table, and floorplans with up to 10 sleeping positions are just a few of the ways the Captiva will enhance your travel experience. Keeping your Captiva clean inside is also quick and easy by design. Just grab a wet towel and wipe down the thermofoiled cabinet doors and the one-piece molded countertops throughout the coach. Designer vinyl flooring throughout provides an elegant and durable floor covering that won't trap dirt and grime like carpet.

### CAJUN SPICE

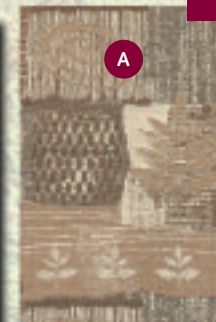
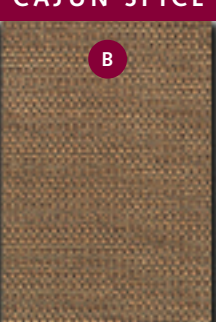

### VENETIAN SAND

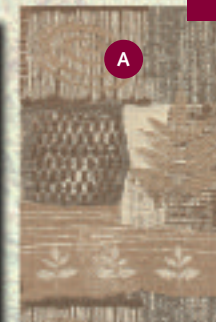



## QUALITY BY DESIGN

Coachmen RV is committed to providing a high quality, reliable, and innovative product. That's why Coachmen designs quality into our products up-front, through computer aided design and analysis software. This helps to assure appropriate weight distributions, structural integrity, alignment of the various parts and components and overall reliability of the design.

Our attention to quality does not stop on the computer screen as all of our major product designs undergo rigorous road tests, rain booth testing, complete compliance audits for all codes, standards and safety related items, and comprehensive product audits.

Coachmen designs, builds and markets a superior product for reasons that may not always be easy to see, however are very easy to appreciate down the road.

Our quality equates to high value, which can be critical to your long-term satisfaction.

## CAPTIVA FLOORPLANS

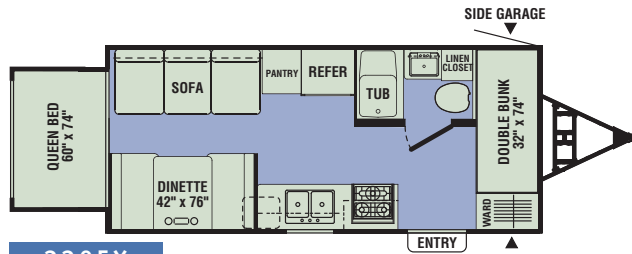

220EX

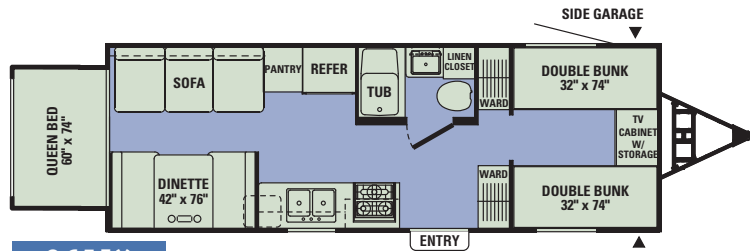

265EX

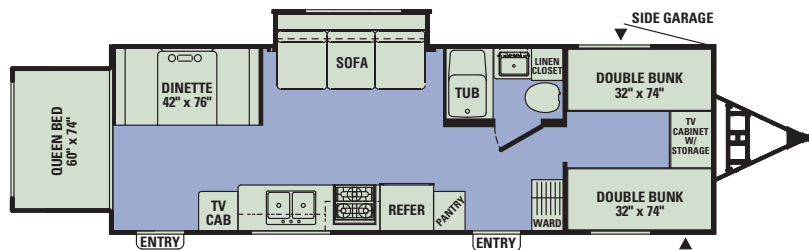

280EX

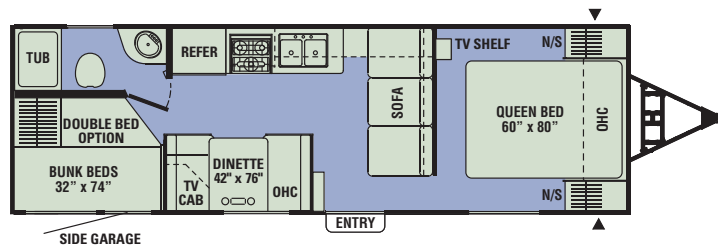

270RBH

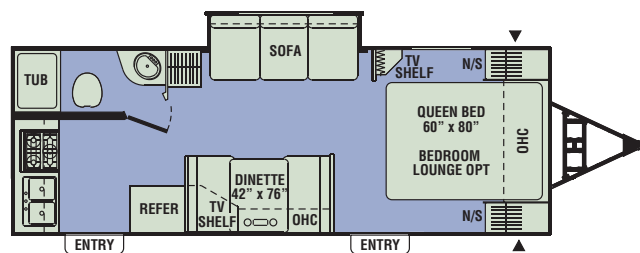

271RKS

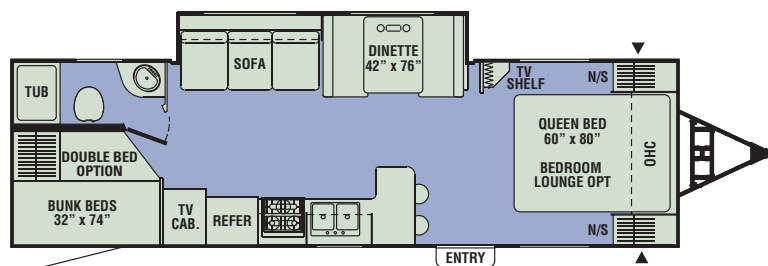

290BHS



LINOLEUM FLOORING



OUTSIDE STORAGE

# STANDARDS AND OPTIONS

## INTERIOR AND DECOR

- Thermofooled Monterey Haze Cabinetry
- Linoleum Flooring Throughout
- Mini Blinds—Throughout (Except in Bunks)
- Safety Glass Windows
- Jack Knife Sofa
- Aluminum Framed Booth Dinette
- Indoor/Outdoor Dinette Table
- Coat Hooks
- Optic Lens Lighting Package
- TV Antenna Ready
- Cable TV Jack
- LP Leak Alarm
- Fire Extinguisher
- Smoke Detector
- Carbon Monoxide Detector

## GALLEY

- Microwave Ready
- 3-Burner (High Output) Range Top
- Power Range Hood
- Large Single Door Refrigerator
- Monitor Panel
- Molded Kitchen Countertop
- Silverware Drawer w/Removable Divider

## SLEEPING

- 60" x 80" Queen Bed (270RBH, 271RKS, 290BHS)
- 60" x 74" Queen Bed (EX Models)
- Lift-up Bed Storage (270RBH, 271RKS, 290BHS)
- Aluminum Framed Bed Bases
- Bunk Beds (Except 271RKS)
- Bunk Area Wall Organizers (Except 271RKS)

## BATH AND WATER

- Marine Toilet w/Foot Pedal
- Power Bath Vent

- 6-Gallon Gas E.I. Water Heater
- Water Heater By-Pass Valve
- Demand Water Pump
- Decorative Bath Hardware
- Medicine Cabinet
- Skylight Over Tub

## ELECTRICAL/HEATING/ AIR CONDITIONING

- GFI Circuit
- Outside Receptacle GFI
- Patio Light
- LP Hitch Light
- Double 20# LP Bottles
- 25,000 BTU E.I. Furnace w/In-floor Ducted Heat
- Speakers and Wiring for Radio
- 12V Outlets

## EXTERIOR/CONSTRUCTION

- 6 Side Alumicage™ Construction
- Fiberglass Sidewalls
- Laminated Roof, Walls & Floor
- Gutter Rail with Awning Rail
- Double Entry Step
- Dead Bolt Lock
- Radial Tires
- Rally Wheels
- Pass Through Storage
- Side Bunk Garage Storage (Except 271RKS)
- Polyethylene Wheel Wells
- Break Away Switch
- Rubber Roof
- Retractable Stabilizer Jacks w/Sand Pads
- Electric Slideout Mechanism(s)
- Fully Enclosed Underbelly w/Heated Tanks
- 1-1/4" Rear Accessory Hitch

## OPTIONAL FEATURES

- PREMIER PACKAGE (Adds approximately 396 lbs. to base weight)
  - Bedspread (Main Bed - Except EX Models)
  - TV Antenna
  - AM/FM CD Stereo
  - Double Door Refrigerator
  - Microwave Oven
  - 3-Burner Range w/Oven
  - One-Piece ABS Tub Surround
  - Double 30# LP Bottles w/Auto Changeover
  - Aerodynamic LP Bottle Cover
  - 13,500 BTU Ducted Roof Air
  - Pull-Out Storage Tray (Except 220 EX)
  - Patio Awning
  - 6-Gallon Gas/Electric E.I. Water Heater
  - Exterior Security Light
  - Owner's Information Guide

## ADDITIONAL OPTIONS

- Spare Tire w/Cover (47 lbs.)
- Sink Cover
- Range Cover
- Fantastic Fan (10 lbs.)
- 15,000 BTU Ducted Roof Air (Upgrade)
- Outside Shower (3 lbs.)
- Tinted Safety Glass Windows
- Pleated Shades
- Roof Ladder (Except EX Models) (8 lbs.)
- CSA Upfit
- Designer Chrome Wheels
- Double Bed Down w/Bunk Over (270RBH, 290BHS)
- Bedroom Lounge (271RKS, 290BHS) (40 lbs.)
- Maple Edition (Includes: Summit Maple Cabinetry, Wood Plank Linoleum, Interior Décor Package and 2 Tone Exterior Sidewalls)

# SPECIFICATIONS

## CAPTIVA 220EX 265EX 280EX 270RBH 271RKS 290BHS

	220EX	265EX	280EX	270RBH	271RKS	290BHS
Base Weight	3,947	4,499	5,109	4,165	4,330	5,062
Carrying Capacity	1,611	1,659	1,979	1,893	1,808	1,866
Hitch Weight	410	580	630	580	580	770
Interior Height	78"	78"	78"	78"	78"	78"
Exterior Height	10' 1"	10' 1"	10' 1"	10' 1"	10' 1"	10' 1"
Exterior Length	22' 6"	27' 5"	29' 11"	29' 11"	27' 5"	31' 11"
Exterior Width	8'	8'	8'	8'	8'	8'
Sleeping Capacity	8	10	10	8	6	8
Fresh Water Capacity (gal.)	36	36	36	36	36	36
Waste Water Capacity (gal.)	32	32	32	32	32	32
Grey Water Capacity (gal.)	32	32	32	32	32	32
Water Heater Capacity (gal.)	6	6	6	6	6	6
LP Gas Capacity (lbs.)	60	60	60	60	60	60
Furnace Rating (x1,000) BTU	25	25	25	25	25	25
Tire Size	X	X	X	X	X	X

X = ST205/75R14C

### BASE WEIGHT (lbs.):

The weight of the unit with no fluids, cargo, optional equipment or accessories.

### CARRYING CAPACITY (lbs.):

The difference between the Base Weight and the GVWR. This is the amount of weight available for all fluids, cargo, optional equipment and accessories. The actual "loaded" weight will depend on the equipped unit and the owner's individual choice of cargo, etc.

All information contained in this brochure is believed to be accurate at the time of publication. However, during the model year, it may be necessary to make revisions and Coachmen reserves the right to make all such changes without notice, including changes in prices, colors, materials, equipment and specifications, as well as the addition of new models and the discontinuance of models shown in this brochure. Therefore, please consult with your Coachmen dealer and confirm the existence of any materials, design or specifications that are material to your purchase decision.

**ASK YOUR DEALER ABOUT THESE COACHMEN EXCLUSIVE DESIGN FEATURES...**



**SAFETY FIRST**

All Captiva travel trailers utilize Duratube™ full length copper LP lines with double flared ends to ensure a tight seal and years of corrosion free use. Coachmen builds quality for the long haul.



**SAFETY FIRST**

Coachmen's SureLine™ Electrical Harness provides color coded wiring and specific wiring schematics for easy serviceability. High quality automotive electrical connectors and autoloam protective covering make for a reliable and durable harness. The wires are grouped together and neatly tucked into the framework under the coach, safe from road debris.



**Even Cool**  
By Coachmen

The Coachmen Even Cool™ air conditioning system is ducted through the crowned roof, and utilizes AMOCO insulated ductwork with radiused corners to provide for maximum cooling efficiency.

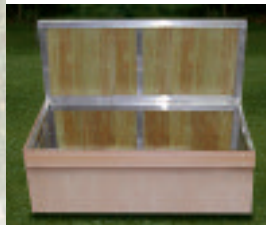

The quality of aluminum framed construction continues throughout the Captiva with aluminum framed dinette booths and beds.



Welded onto every Captiva frame is a 1 1/4" accessory hitch receiver that is perfect for a bike or rear storage rack.



The free standing dinette table is perfect for indoor or outdoor use. A one piece molded top makes this table light weight, weather resistant and extremely durable.



Exterior storage has been utilized to its fullest with pass through storage on most models. Add the optional slide out storage tray for easy pull out access from either side of the coach.



The fold up lower bunk on most Captiva's creates an enormous storage area for several bikes, golf clubs and other gear. The residential style door features a deadbolt lock to enhance the safety of your family and your gear inside the coach.



A large fold out grab handle provides for a solid handhold when entering or exiting the unit.



**SAFETY FIRST**

All Coachmen RV products come standard with an LP leak detector, fire extinguisher and smoke detector for your safety.



Jalousie bedroom windows tilt out design allows them to be opened for ventilation even when the weather outside is less than favorable. Just because the rain keeps you inside doesn't mean that you can't enjoy fresh air outside.



Designer chrome wheels give your Captiva an automotive style and high line appearance.

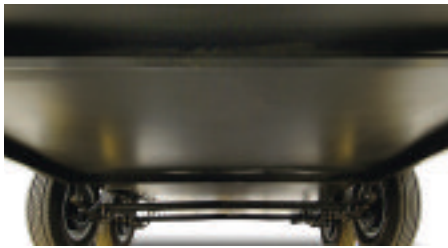

The standard enclosed underbelly extends the camping season with heated tanks. Captiva's exclusive notched frame rail accommodates a truly flush underbelly for improved aerodynamics and a better seal from the elements.

## AERODYNAMIC, EASY TO TOW

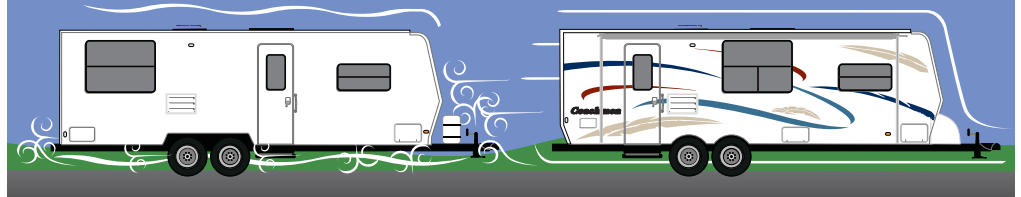

The Captiva features an aerodynamic design with a true flush underbelly and a custom molded bottle cover that further enhances the aerodynamic appeal as it slopes upward toward the front of the unit.

## TOWING GUIDE

The popular Captiva series of travel trailers has been designed with the new generation of tow vehicles in mind. In deciding which Coachmen is right for you, you will want to compare its weight shown in the specification chart to the towing limits of your tow vehicle. Because of the many variables, the process can be confusing. This guide is provided for your convenience as a general reference. It lists the 2005 model, engine and published maximum towing capacity. **Please note: This guide does not attempt to provide all necessary information such as axle ratios, cooling systems, transmissions and any additional equipment required by the tow vehicle manufacturer to achieve the published maximum towing limits.**

Please be sure to verify your particular tow vehicle manufacturer's specifications. Your Coachmen dealer will be glad to help you with questions.

Model	Engine	Tow Capacity (2WD/4WD-AWD)
<b>DAIMLER CHRYSLER PICKUP</b>		
Dakota Club Cab	3.7L V-6	4,850 / 4,700
	4.7L V-8	7,150 / 6,950
Dakota Quad Cab	3.7L V-6	4,750 / 4,600
	4.7L V-8	7,000 / 6,850
Ram 1500 Reg Cab	4.7L V-8	7,750 / 7,400
	5.7L V-8	9,250 / 8,850
Ram 1500 Quad Cab	4.7L V-8	7,400 / 7,150
	5.7L V-8	8,900 / 8,600
<b>DAIMLER CHRYSLER SUV</b>		
Durango	4.7L V-8	7,400 / 7,200
	5.7L V-8	8,950 / 8,650
Grand Cherokee	4.7L V-8	6,500
	5.7L V-8	7,200
Liberty	2.8L I-4	5,000
	3.7L V-6	5,000
ML 350	3.7L V-6	6,200
<b>FORD/LINCOLN/MERCURY PICKUP</b>		
F-150 Reg Cab	4.2L V-6	5,600
	4.6L V-8	7,100 / 6,800
	5.4L V-8	9,900 / 9,500
F-150 Super Cab	4.6L V-8	6,900 / 6,600
	5.4L V-8	9,500 / 9,300
F-150 Super Crew	4.6L V-8	6,800 / 6,500
	5.4L V-8	9,500 / 9,200
Explorer Sport Trac	4.0L V-6	5,300 / 5,080
Ranger	4.0L V-6	5,980 / 5,660
Ranger Super Cab	4.0L V-6	5,860 / 5,580
<b>FORD/LINCOLN/MERCURY SUV</b>		
Aviator	4.6L V-8	5,000 / 7,100
Excursion	5.4L V-8	7,600 / 7,200
Expedition	5.4L V-8	8,900 / 8,600
Explorer	4.0L V-6	5,760 / 5,380
	4.6L V-8	7,140 / 7,000
Mountaineer	4.0L V-6	5,660 / 5,280
	4.6L V-8	7,040 / 6,900
Navigator	5.4L V-8	8,600 / 8,300
<b>FORD VAN</b>		
E-150 PV	4.6L V-8	6,100
	5.4L V-8	6,500
E-150 CV	4.6L V-8	6,500
	5.4L V-8	6,900

Model	Engine	Tow Capacity (2WD/4WD-AWD)
<b>GENERAL MOTORS PICKUP</b>		
Avalanche 1500	5.3L V-8	8,200 / 7,900
Denali/Silverado SS	6.0L V-8	8,100
Escalade EXT	6.0L V-8	7,300
Sierra/Silverado		
1500 Reg Cab	4.3L V-6	5,100
	4.8L V-8	8,000
1500 Ext Cab	5.3L V-8	7,500
	6.0L V-8	7,600
1500 Crew Cab	5.3L V-8	7,500
<b>GENERAL MOTORS SUV</b>		
Blazer 2-Door	4.3L V-6	5,700 / 5,400
Envoy	4.2L I-6	6,300 / 6,100
	5.3L V-8	7,000 / 6,500
Envoy XL	4.2 I-6	6,000 / 5,800
	5.3L V-8	7,100 / 6,700
Envoy XUV	4.2L I-6	6,000 / 5,800
	5.3L V-8	6,500 / 6,400
Trail Blazer	4.2L I-6	6,300 / 6,100
	5.3L V-8	7,000 / 6,500
Trail Blazer EXT	4.2L I-6	6,000 / 5,800
Denali	5.3L V-8	7,100 / 6,700
Escalade	5.3L V-8	7,400
H1 4-Door Open Top	6.5L V-8	7,867
H1 Station Wagon	6.5L V-8	7,409
H2	6.0L V-8	6,700
Ranier	4.2L I-6	6,200 / 6,000
	5.3L V-8	6,700 / 6,500
Suburban/Yukon XL 1500	5.3L V-8	8,400 / 8,100
Tahoe/Yukon	5.3L V-8	7,700 / 7,800
<b>GENERAL MOTORS VAN</b>		
Astro/Safari CV	4.3L V-6	5,700 / 5,500
Astro/Safari PV	4.3L V-6	5,400 / 5,100
G1500 CV	5.3L V-8	6,100
G1500 PV	5.3L V-8	6,000
<b>HONDA</b>		
Ridgeline	3.5L V-6	5,000
<b>INFINITI</b>		
QX 56	5.6L V-8	9,000 / 8,900

Model	Engine	Tow Capacity (2WD/4WD-AWD)
<b>ISUZU</b>		
Ascender	4.2L I-6	5,500 / 5,300
	5.3L V-8	6,800 / 6,300
Axiom	3.5L V-6	4,500
<b>LAND ROVER</b>		
LR3	4.4L V-8	5,500
Range Rover	4.4L V-8	5,500
<b>LEXUS</b>		
GX470	4.7L V-8	6,500
LX470	4.7L V-8	5,000
<b>MITSUBISHI</b>		
Montero	3.8L V-6	5,000
<b>NISSAN PICKUP</b>		
Titan Crew Cab	5.6L V-8	9,400
Titan King Cab	5.6L V-8	9,500
<b>NISSAN SUV</b>		
Armada	5.6L V-8	9,100
Frontier	4.0L V-6	6,000
Pathfinder	4.0L V-6	6,000
Xterra	4.0L V-6	5,500
<b>PORSCHE</b>		
Cayenne S/Turbo	All	7,716
<b>TOYOTA PICKUP</b>		
Tacoma Reg Cab	4.0L V-6	6,500
Tacoma Access Cab	4.0L V-6	6,500
Tundra Reg Cab	4.7L V-8	7,200
Tundra Access Cab	4.7L V-8	7,100 / 6,900
Tundra Double Cab	4.7L V-8	6,800 / 6,500
<b>TOYOTA SUV</b>		
4Runner	4.0L V-6	5,000
	4.7L V-8	7,300 / 7,000
Land Cruiser	4.7L V-8	6,500
Sequoia	4.7L V-8	6,500 / 6,200
<b>VOLKSWAGEN</b>		
Touareg	4.2L V-8	7,716
	5.0L V-10	7,716
<b>VOLVO</b>		
XC90	All	5,000

2006  
**Captiva™**



LIGHTWEIGHT  
TRAVEL TRAILERS  
by COACHMEN

## DISCOVER THE COACHMEN ADVANTAGES

### SERVICE AFTER THE SALE

#### INDUSTRY LEADING BUCKSTOPPER™ WARRANTY –

Coachmen's exclusive Buckstopper™ Limited Warranty provides one-year coverage on most parts, components and appliances. Coachmen stands behind their product and is supported by a network of over 300 service centers.

#### TWO YEAR STRUCTURAL & MAJOR COMPONENTS MANUFACTURER'S WARRANTY –

Coachmen provides a two-year structural and major components manufacturer's warranty, along with a complete written Warranty Summary Guide, for your peace of mind.

#### COMPREHENSIVE OWNER'S INFORMATION –

For your convenience we offer published materials on key equipment and options, as well as information pertaining to the function of important components. We also offer a true Trouble Shooting and Maintenance Guide for the simple answers to frequently asked questions.



#### TOLL FREE SERVICE NUMBERS –

Our toll free phone numbers provide you with direct access to a Coachmen RV Service Representative.

#### DEALER SUPPORT TOOLS –

Coachmen makes sure that their dealers are well equipped and trained to service your needs with: Systems Manuals, PDI Manuals, Electronic Parts Catalogs, Coach-Link® "On-Line" Electronic Dealer Communication System and continual service training.

#### SERVICE SUPPORT CENTER WEB SITE –

Coachmen provides you access to key information 24-hours a day through the Internet. On-line you can find a Service Dealer Locator, Maintenance Information, Trouble Shooting Information, Product Warranty Information, Customer "E-Assistance", Frequently Asked Questions (FAQ's) and Publications ordering, dating back to 1972 models.

#### PRIORITY PARTS ORDERING –

Coachmen provides a program for overnight parts shipment in critical repair situations.

### COACHMEN CARAVAN CAMPING CLUB™

Coachmen Caravan Camping Club is your ticket to making friends for life. Share old stories and make new, in the company of fellow Coachmen Caravan members. With the purchase of a Coachmen RV, you are invited to join one of the nation's largest manufacturer sponsored RV clubs with a FREE 1st year membership.



As part of the Coachmen Caravan family, you will receive incredible membership benefits that will help to ensure your safety and enjoyment throughout your RV experiences. Enjoy your Coachmen RV more with the Coachmen Caravan Camping Club.



Leader to the Great Outdoors®

Coachmen Recreational Vehicle Company, LLC  
P.O. Box 30, Middlebury, IN 46540  
P.O. Box 948, Fitzgerald, GA 31750

Visit our website at: [www.coachmenrv.com](http://www.coachmenrv.com)

©2005 Coachmen Recreational Vehicle Company, LLC - All rights reserved. Litho in USA 11/05

