

2006 Monaco Camelot 42-DSQ

Date Purchased: March 13, 2017

License: **BXG-6135**



VIN: **1RF43561162040521**

Coach #: **1666696**

Roadmaster RR10S (Side Radiator) Chassis

Monaco with full body paint. Central air and heat.

- 4 Slides.
- Full body paint.
- 10KW Diesel Generator.
- Hydro-Hot 3 zone central heating and cooling.
- 3 Camera rear/side vision system with audio.
- Automatic 3 point leveling system.
- 10 airbags.
- Satellite dish, surround sound system. Corian countertops, leather interior, Convection/microwave, two burner stove, double sinks.
- Bath and a half. Rear bath tub/shower and electric toilet. Day and night shades. Queen bed in the back. Tons of storage inside and out.

Options:

- Solid surface kitchen sink
- Auto generator start
- Power hose reel
- Power electric reel
- RV Sani-Con tank drainage system
- Storage bay slide out tray
- 14 Cu Ft. 2-way stainless steel refrigerator with ice and water dispenser in door
- Microwave/Convection
- Washer/dryer combo
- Bedroom clock radio AM/FM/CD/DVD player in bedroom
- Automatic satellite system
- Central Vacuum
- Sirius satellite radio
- Rear bathtub and shower
- Ceiling fan in bedroom
- 3 Fantastic 12V attic fan with rain sensor and electronic wall thermostats

2006 Monaco Camelot 42-DSQ



Upgrades:

- TNT TPMS System with 12 sensors.
- Silverleaf VMSPc engine/trans monitoring system with HP tablet interface.
- Garmin RV GPS.
- Tile floor living room, kitchen and cockpit
- Full computer desk with cabinets
- Larger TV's in cockpit and bedroom
- Queen bed with Tempurpedic mattress
- Lighting system changed to LED lighting
- Air conditioner Diffusers
- Electric shade and Sunscreens in cockpit
- Spiced Maple cabinetry throughout.

Safety:

- Tyron Safety Bands
- Fire Extinguisher
- Deadbolt lock on entrance door with electronic keypad
- 120V GFI protected circuit
- LP gas detector
- Smoke and carbon monoxide detector
- Bedroom egress window



2006 Monaco Camelot 42-DSQ



Dimensions

	<u>Travel Mode</u>
Width:	100 ½" (2553 mm)
Overall Length:	42' 10" (13,056 mm)
Height:	12' 10" (3912 mm)
Wheelbase:	270' ¼" (6864 mm)
1° Off-Level:	4 ¾" (120 mm) at axle.

	<u>Slide Extension</u>
Max Width (Slides Extended):	161 ½" (4102 mm)
Curb Side Front:	18 ½" (470 mm)
Curb Side Rear:	30" (762 mm)
Road Side Front:	31" (787 mm)
Road Side Rear:	18 ¼" (464 mm)

Tank Capacities

Grey:	227 L / 60 gal
Black:	151 L / 40 gal
Fresh:	378 L / 100 gal
Propane:	208 L / 55 gal
Fuel:	492 L / 130 gal

2006 Monaco Camelot 42-DSQ

Weights

	Rated Max		May 07, 2017		
	kg	lbs	kg	lbs	% of Max
Front:	6622	14600	6560	14462 2 @ 7231	99%
Drive:	9072	20000	8165	18001 4 @ 4500	90%
Tag:	4536	10000	2795	6161 2 @ 3081	62%
Tag Set Pressure:			48 psi		
Rear Total:	13608	30000	10960	24163	81%
Total (GVWR):	20230	44600	17520	38625	87%
Cargo Carrying Capacity:	3690	8136			
Spare On-board Capacity:			2710	5975	
GCWR:	24766	54600	24766	54600	
Available Towing Capacity:	4536	10000	7246	15975 Max Hitch 10000	

Monaco and Car Hauler Weight Calculator



Hitch Weight	
kg	lb
280	617

EMPTY

Trailer Axles	
kg	lb
1710	3770

Hitch Wt		Net Change			
		Steer Axle		Drive Axle	
kg	lb	kg	lb	kg	lb
280	617	-133	-293	413	910
300	661	-142	-314	442	975
325	717	-154	-340	479	1056
350	772	-166	-366	516	1138
375	827	-178	-392	553	1219
400	882	-190	-418	590	1300
425	937	-202	-444	627	1381
450	992	-213	-470	663	1463
475	1047	-225	-497	700	1544
500	1102	-237	-523	737	1625
525	1157	-249	-549	774	1706
550	1213	-261	-575	811	1788
575	1268	-273	-601	848	1869
600	1323	-285	-627	885	1950
625	1378	-296	-653	921	2031
650	1433	-308	-680	958	2113
675	1488	-320	-706	995	2194
700	1543	-332	-732	1032	2275



Steer Axle to Drive Axle: 291 inches
 Steer Axle to Hitch: 429 inches
 Drive Axle to Hitch: 138 inches

Trailer Length: 23' 3" from center of trailer ball. Combined rig: 69' 3".

2006 Monaco Camelot 42-DSQ

Wheels

Steer



Diameter: 22.5"

Bolt Holes: 10

Bolt Diameter: 11.25"

Dish Diameter: ~15"

Tyron Bands Installed. Fasteners replaced May 11, 2022 when tires replaced.

Drive

Tag

Tire Pressure Monitoring System:

TST Truck System Technologies: https://tsstruck.com//shop.html?market_application=24

Model: 507 Series - 10 Flow Thru Sensor TPMS System with Color Display

Batteries: CR1632 (*Before installing, check voltage – Must be > 3 Volts*)

Product Support: <https://tsstruck.com/product-support>

2006 Monaco Camelot 42-DSQ

Maintenance

Diesel Fuel Additives:

Diesel Kleen - Endorsed by Cummins - [Technical Bulletin](#)
Opti-Lube XPD - Endorsed by some on Monaco Yahoo Group

Leveling System

<http://www.lci1.com/power-gear%C2%AE-hydraulic-leveling-system>

Touchpad #: 500629 or 140-1226

Control Box #: 500630 or 140-1227

Float switch #: Power gear 140-1146 or Lippert 35908

Belts

A/C Belt: Dayco 15465

Alternator Belt: Dayco 3911581

Air Filter

Donaldson P537448 (NAPA: NGF 6891 @ C\$ 307.09)

Boost Pressure (Normal as per Cummins)

Governed Speed (2200 rpm): 32 psi (65 inch-Hg)

Maximum HP (2100 rpm): 33 psi (68 inch-Hg)

Maximum Torque (1400 rpm): 31 psi (63 inch-Hg)

Fuel Filters

Primary: Fleetguard FS1003 (NAPA: Gold NGF 3604 @ C\$65.59)

Secondary: Fleetguard FF5488

Engine: Cummins ISL 400 8.9 L

S/N: 46580780

No DEF

Horsepower: 350 @ 2100 RPM

Note: Cummins spec is 400

Torque: 1200 ft-lbs @ 1400 RPM

Governed Speed: 2200 RPM

Wrist Pin Recall: [Click Here](#)

Engine Oil:

15W40 HD Conventional

Volume: 22.7 Liters / 6 usgal / 24 qts

Filter: Fleetguard LF9009 (NAPA: Gold NGF 1748XD @ C\$84.69)

Engine Cooling System:

Stock: Coolant Additive (SCA): Minimum = 1.2 Maximum = 3.0 units per gallon

Upgrade June 2018: Organic Acid Technology (ES Compleat™ OAT)

Change Interval: 24 months or 60,000 miles

Capacity: 9.75 usgal (39 Qts) = 36.9078 Litres

Thermostat Part #: 5284903

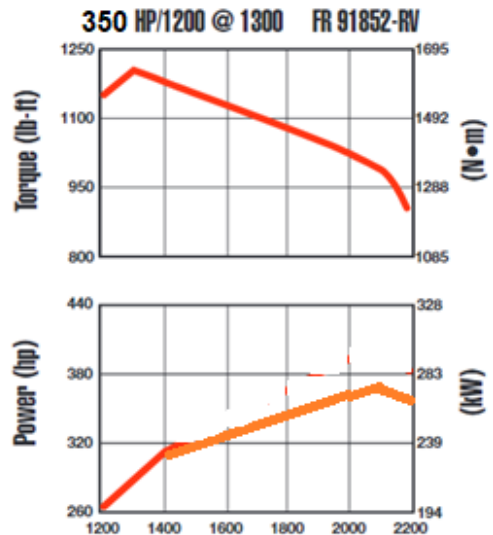

Specifications

ADVERTISED HORSEPOWER	350 HP	298 KW
PEAK TORQUE	1200 LB-FT	1627 N•M
GOVERNED SPEED	2200 RPM	
CLUTCH ENGAGEMENT TORQUE	550 LB-FT	746 N•M
NUMBER OF CYLINDERS	6	
OIL SYSTEM CAPACITY	7.3 U.S. GALLONS	27.6 LITERS
SYSTEM WEIGHT	1,685 LB	764 KG
ENGINE (DRY)	1,635 LB	742 KG

2006 Monaco Camelot 42-DSQ

Coolant Tank Replacement

[C-Low Fab and Performance LLC](#)

Angled Outlet

Installed: August 2022

Radiator Hose Replaced: Gates 24220 (1 1/4")

Radiator Cap: STANT 10228 (7 psi)

Coolant level Sensor: WVE 5S1465

Alt:

FORD CLS1026

FORD F700 1995-1997

FORD F800 1995-1999

XC4Z10D968AA, SU2385,

NTK EE0029

WVE 5S1465

STANDARD FLS164

AIRTEX / WELLS 5S1465



Engine Data Plate (as per Cummins QuickServe Data for S/N 46580780)

Engine Dataplate - (Original) VIN:		
Marketing Model Name	Service Model Name	EPA Model Name
ISL-400	ISL CM850	6CEXH0540LAJ
Shop Order	Build Plant	Build Date
S037921	CNS - CONSOLIDATED DIESEL CO.	10 Feb 2006
Warranty Start Date	ECM Code	Fuel Pump Part #
30 Mar 2007	Not Available	4921431
Fuel Pump Calibration	Marketing Engine Configuration #	Technical Engine Configuration #
NA94	D563003BV07	D563003BX03
CPL #	Customer Number	Customer Name
CPL1096	76229	Not Available

Wrist Pin Recall (as per Cummins QuickServe Data for S/N 46580780)

Warranty Campaigns		
This engine may be eligible for a field campaign or TRP. Please contact your authorized Cummins service location for details.		
Number	Description	Status
C0713	ISL CM850 WRIST PIN, RV CAMPAIGN	COMPLETED

Upgrade May 2019: Source Engineering Wax Valve

Replaced unreliable electronic control module for managing side radiator hydraulic fan speed. The electronic control module is difficult to find, expensive and prone to failure and short service life. When it has failed, the radiator fan runs at maximum speed regardless of engine temperature.

Kit: <http://sorcerv.com/conversion>

- Wax valve Part #: 553/1/09857/210
- Hoses and connectors.
- 0.018 Orifice

Note: The orifice is required to maintain a minimum fan speed to prevent high A/C compressor discharge pressure if A/C is operating, but engine is consuming minimal cooling.

Replacement/spare Wax Valve available from:

<http://www.whitehouseproductsllc.com/product-details.aspx?pid=18059453&&pn=553%2f1&page=4>



Engine Starter:

(Unconfirmed) Delco-Remy

2006 Monaco Camelot 42-DSQ

39MT
8300013



Engine Data

Link – J1708

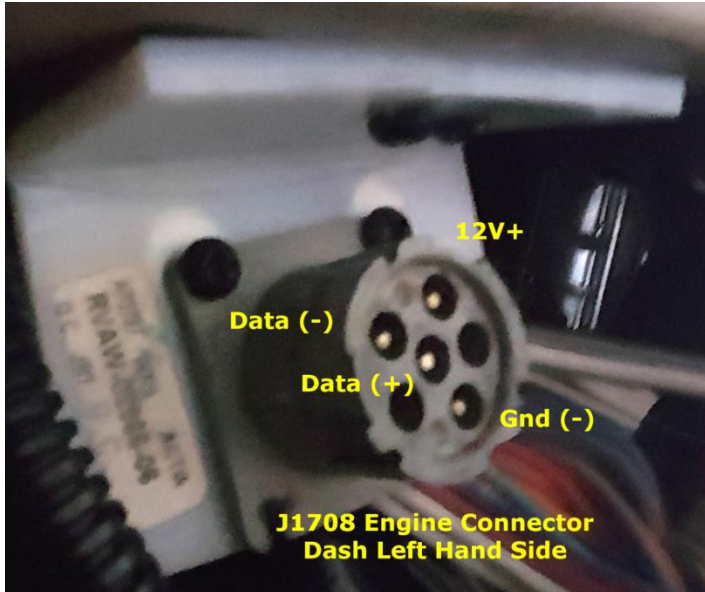

J1708

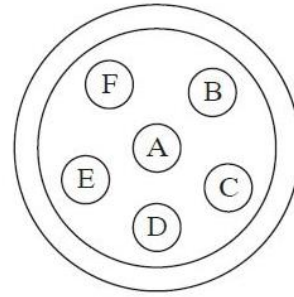

Six-Pin Diagnostic

*A - Data Link +
B - Data Link -
C - Power
E - Ground*

Engine & Transmission Monitoring (Real Time)

VMSpc by Silverleaf Electronics (<http://www.silverleafelectronics.com/node/6>)

Via: HP tablet

Throttle Position Sensor

Type: Hall Effect Sensor

Part #: 050g-e4634

Note: No longer made.



Possible replacements

Part # ACDelco 15150990 GM

Fits: See Doorman 699-100 Fitment Chart



Dorman 699-100 Accelerator Pedal Assembly



2006 Monaco Camelot 42-DSQ

Doorman 699-100 Fitment		
2008	Isuzu	Ascender
2007	Isuzu	Ascender
2003	Chevrolet	SSR
2003	Chevrolet	Trailblazer
2003	Chevrolet	Trailblazer EXT
2003	GMC	Envoy
2003	GMC	Envoy XL
2003	Isuzu	Ascender
2003	Oldsmobile	Bravada
2002	Chevrolet	Trailblazer
2002	Chevrolet	Trailblazer EXT
2002	GMC	Envoy
2002	GMC	Envoy XL
2002	Oldsmobile	Bravada

Hydraulic System (steering & cooling fan)

Hydraulic Oil Filters (3):

Specified: **Nelson: 84101B**

Alternates:

NAPA Industrial Hydraulics: W02AP536

WIX Industrial Hydraulics: W02AP536

Hydraulic Oil: Dexron III / Mercon. Alt: AW46 or 15W40 (Do not mix)

Note: Need approx.. 10 L - 12L to refill reservoir after drain down and filter replacement.

Air Dryer

Meritor Wabco System Saver 1200

Air Dryer Cartridge:

Meritor Wabco R950011

Alliance Parts ABP/N10G-R950011

NAPA: FLE 950011G3

Transmission: Allison 3000 MH 6 speed S/N: 6510625589

Filters(2): High Capacity Filter Kit **29558118** (plus 10 Quarts (9.5L) Transynd)
(as per Alison Service Tip #1099, Rev. T March, 2017)

Filter Change Interval: 75,000 miles (120,000 km) / 3000 hrs / 36 months

Fluid Change: 300,000 miles (480,000 km) / 6000 hrs / 48 months

Fluid Capacities (Approximate)*			
Transmissions Fluid Loss — Filter Change Only: Main Filter = 1.9 liters (2 quarts) Lube Filter = 7.6 liters (8 quarts)			
Model	Sump	Initial Fill**	Refill**
		Liters (Quarts)	Liters (Quarts)
 3000	4 inch	27 (29)	18 (19)
<small>* Fluid fill capacity is dependent on vehicle configuration. Final fluid capacity must be determined by dipstick level (see Mechanic's Tips MT3004EN Section 1 or your Operator's Manual under "Care and Maintenance". ** Approximate quantities, do not include external lines, cooler, and hose *** Add 2.8 Liters (3 Quarts) for Transmissions with PTO</small>			

Approved Fluids – TES 295

Castrol Transynd, App Num: AN-011001 (1 Gal Jug Part #: 27101-CTCS)

BP Autran Syn 295™, App Num: AN-031002

BASF Emgard 2805™, App Num: AN-031003

International Fleetrite Synthetic ATF™, App Num: AN-031004

2006 Monaco Camelot 42-DSQ

Mobil Delvac Synthetic ATF™ / Mobil Delvac 1 ATF™, App Num: AN-051005
 John Deere HD SynTran™, App Num: AN-071006
 Mack Synthetic ATF™, App Num: AN-1010007
 Shell Spirax S6 ATF A295™, App Num: AN-121008
 CNH HD Synthetic ATF™, App Num: AN-121009

Transmission Configuration as Installed

#	<i>Description</i>
FTL	LEFT FILL TUBE OR PLUG
RSN	NO REAR SUPPORT BRKT.
01-835	MAIN HSG. MD - GEN 4
02-636	W/O FILL TUBE & DIPSTICK
05-598	MAIN SHAFT MODULE (CR)
08-813	MD1610 FULL ROUND YOKE W/SHIELD
10-603	OIL PUMP STD W/O PLATE
14-1003	P1 PLANETARY MOD (CR&WR)
15-509	P2 PLANETARY MODULE (CR)
16-1826	CNTRL VALVE MD,4" SUMP , OLS, PLUS 4
20-509	REAR REMOTE PROVISION
21-936	TC421 CONVERTER MODULE MD**
24-771	TRNS SE CUM"C",6 BOLT
25-542	ROTATING CL 3066/B4 STD
34-542	CONVERTER HOUSING STD
39-884	MD,REAR COVER, CR,NO TACHO, 1BOLT,N/O,S/

Stall Torque Ratio: 1.77 (TC-421 Converter Module**)

Mechanical Ratios (do not include torque converter multiplication)

Rev	1st	2nd	3rd	4th	5th	6th
-5.03:1	3.49:1	1.86:1	1.41:1	1.0:1	0.75:1	0.65:1

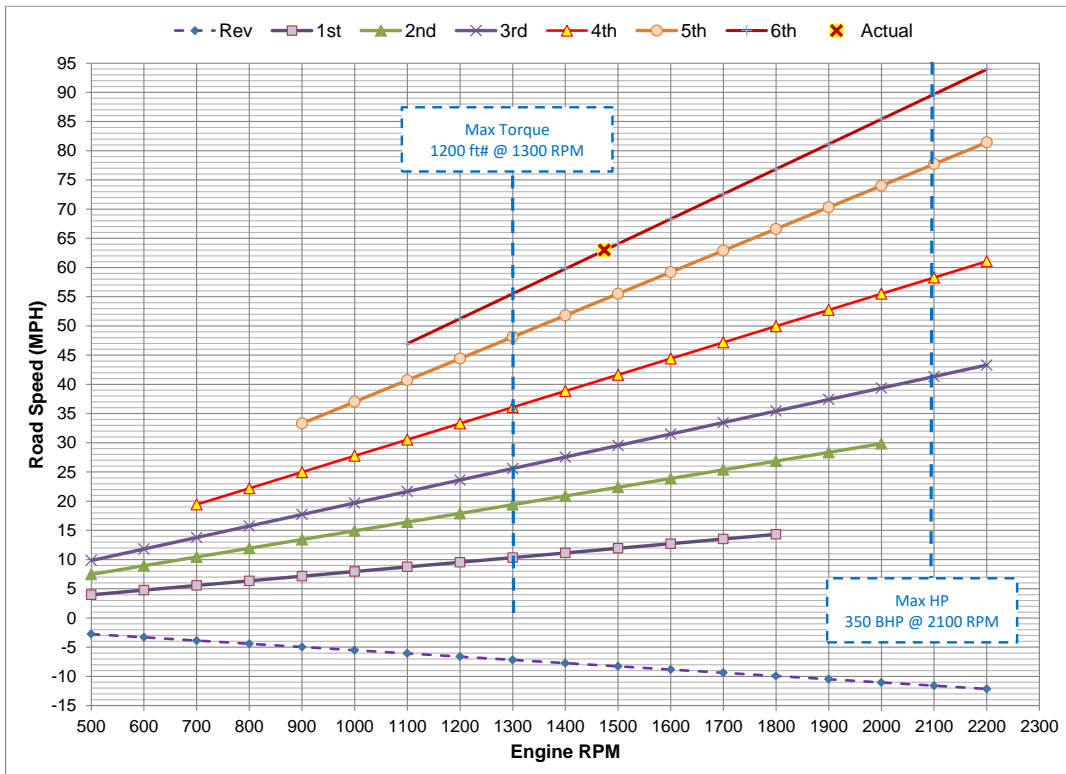

2006 Monaco Camelot 42-DSQ

Differential

Rear Axle Ratio: 4.30 to 1

Lubricant: API GL-5 or MT-1 type gear lubricant, 75w-90 Full Synthetic

Volume: 15.1 Liters / 4.0 usgal (approx..)

Tag Axle

Lubricant: API GL-5 or MT-1 type gear lubricant, 75w-90 Full Synthetic

Batteries

House: 4 x 6 Volt Lead acid.

Part #: SLIGC110

20 AH CAP: 115 (discharge to 0% over 20 hours @ 115/20 = 5.75 Amps)

105 Min @ 75 Amps

Tray: 19 7/8" (W) X 17 3/8" (Deep)

Chassis: 2 x 12 Volt No Maint Lead Acid

Transfer Switch:

IOTA ITS-50R

Inspected & Checked Terminal Torque: Sep 9, 2022

No sign of overheating or Contact Damage



Spare Transfer Switch carried onboard: WFCO T57 50 Amp – Purchased Aug 23, 2022

Marker/Clearance Lights

Front: Kaper II L14-0026A – Replaced May 2019

Rear: Kaper II L14-0026R

LED MARKER LAMP 12 DIODE

FMVSS: P2 P3

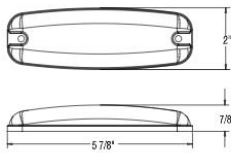

L14-0026R



L14-0026A



FEATURES:

- 5 7/8" x 2"
- 2 bare wire

MATERIAL:

- Polycarbonate lens
- ABS housing

LIGHT SOURCE:

L14-0026R

- 12 light emitting diodes
- Tested at 12.8V

L14-0026A

- 12 light emitting diodes
- Tested at 12.8V

2006 Monaco Camelot 42-DSQ

Paint Colors

Touch-up Paint: R-M Diamont (A brand of BASF)

Website: <https://refinish.basf.us/brands/r-m/>

Technical Manual:

https://www.coatingsmall.com/cap_data_docs/documentum/RM/Technical_Manuals/English/AD2526%20R-M%20English%20US%20Manual.pdf

For spraying, dilute with Lacquer Thinner (Automotive Grade)

Color Scheme: Ultramarine

Dark Green – Diamont R-M: Thistle Green Metallic

Mid Green – Diamont R-M: Bermuda Teal Metallic

Gold – Diamont R-M: Ivorywood Metallic (or Ironwood??)

2006 Monaco Signature Series Model Lineup

1. Executive
2. Dynasty
3. Windsor
- 4. Camelot**
5. Diplomat
6. Knight
7. Cayman
8. LaPalma
9. Monarch SE
10. Esquire

Generator

Onan Quiet Diesel 10000

Model #: 10HDKCA11506B Spec: B

S/N: B060885264

Amps: 41.7

Options: B273-2, R10A-2, A223-1, F166-1, L045-1, P090-1, Spec-B, 10HDKCA

Starter Current Draw: 197 Amps @ 15 °C (60 °F) [Initial Peak 207 Amps]

Air Cleaner: 140-3071 (Donaldson P822686)

Fuel Filter: 149-2513

Oil Filter: 122-0893 (Kubota HH164-32430)

Oil Capacity = 5.68 Liters (6.0 quarts) w/oil filter

5F to 120F – 15W40 (-13 F to 88 F – 10W30 / -40 F to 88 F – 5W30)

Glow Plug: 185-5990

Fuel Consumption:

0 Load: 0.11 usgph
½ Load: 0.43 usgph
Full Load: 1.0 usgph

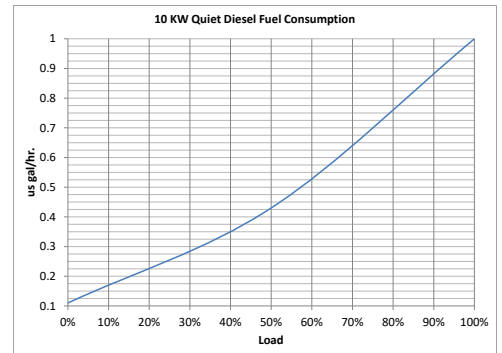

2006 Monaco Camelot 42-DSQ

HydroHot Heater

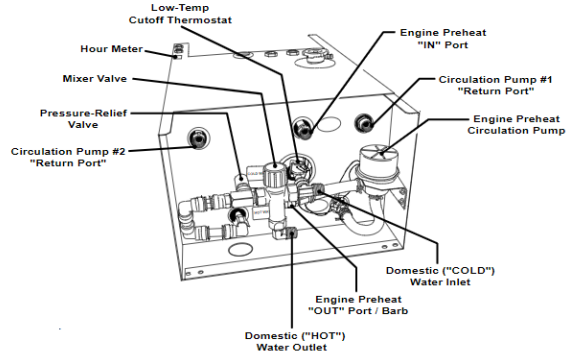
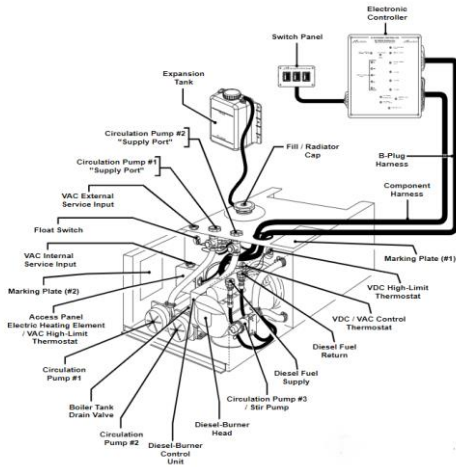

Model: HHE-200-09E
 Serial #: HE06-0512
 Manufacture Date: 03-06
 Diesel-Burner Serial #: 07231
 Diesel-Burner, Heat Input (Firing Rate): 50,000 BTU (14.65 KW)
 Diesel-Burner, Fuel Consumption (Continuous Operation): 0.40 gal/hr
 Heater, Voltage/Maximum Power Consumption: 12 Vdc /60 watts
 Electric Heating Element: 120 Vac /1650 watts
 Zone Heat Circulation Pump: 2 @ 12 Vdc/21 watts
 Number of Heating Zones: 2 - *plus* Engine Preheat
 Domestic Water Heating Capacity: continuous/on-demand GRAS
 Antifreeze Type: (Generally Recognized as Safe) Propylene Glycol (Red)
 Antifreeze Concentration: 50/50
 Freeze Point: -28 °F (-33 °C)
 Boiling Point: 222 °F (105.6 °C)
 Dimensions: 12"H x 18.5"W x 30"L
 Dry Weight: ~ 127 lbs.
 Wet Weight: ~ 184 lbs.
 Fuel Filter: Garber R Fuel Filter
 ○ FLE-120-100
 Alt: ○ Luber Finer LFF5
 ○ Napa 3109

Yearly maintenance

- Clean combustion chamber.
- Clean heat exchanger.
- Clean fire eye.
- Adjust ignitors.
- Replace nozzle.

Replaced bearings.

Replaced wave washer.

Set Fan clearance.

Greased fuel pump gears.

Replaced Fuel Solenoid.

Replaced Blower Casing – Small stress cracks on top connection (over torque??)

Hydro-Hot Service – June 25, 2020
 @ 1821.4 hours

2006 Monaco Camelot 42-DSQ

Wet Bay Heater

Model 3000RV

Snap Disc: 36TX21 21190 L55-15F A0525

Air Conditioners

Make: Dometic

MFG #: 651515.301K0

Prod #: 991762342

SKU: 9108561078

S/N (rear Unit): 00896620

13500 BTU

10.5 Amp Heater

20 Amp max draw (with or without heater)

Refrigerant: 410A / 25.0 oz.

July 30, 2020: Replaced all 3 A/C shrouds with shrouds from: <https://www.icondirect.ca/penguin-dometic-duo-therm-air-conditioner-shroud-pw/>



Headlights

Curb Side / Passenger Side SAE HR 96 DOT (R) TYC 20-5197-90

Same unit at 97-05 Buick Century and 97-04 Buick Regal



Road Side / Drivers Side SAE HR 96 DOT (L) TYC 20-5198-90

Same unit at 97-05 Buick Century and 97-04 Buick Regal



Windshield Wiper Blades

Recommended Wiper for 2006 Monaco Camelot

TRICO RV »

32" Blade - Driver & Passenger Side Part # 67-321



Where to Buy »

Replaced with Reflex Ice Defense 28" 021-2111-4 (Sep 2022)

Windshield Wiper Motor

Wexco G138 (400.01000.5512) 05304

55 nm.

Alt: 17299 KOR 1M26372917J26A74A (Not Confirmed)

2006 Monaco Camelot 42-DSQ

Air Bags (10 Required)

Monaco #: 0180-4591

Contitech #: 9 9-12 P 730, Order No. 64664)

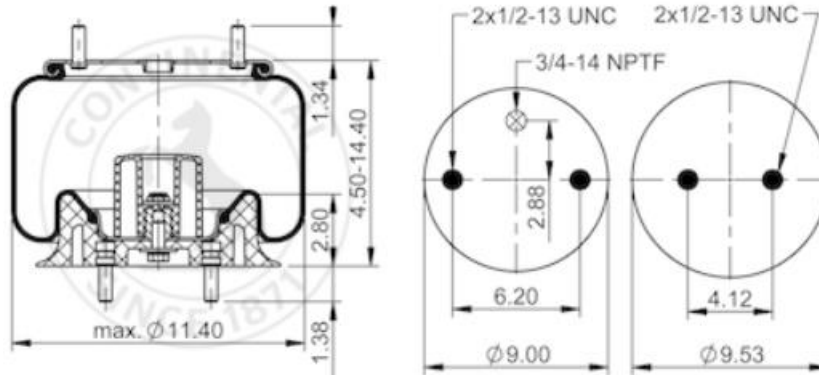

Torque:

3/4 -14 NPTF – Max 22 ft lb

1/2-13 UNC – Max 35 ft lb

Alternates: [Link](#)

Automann PN: AB 1DK20D-8897

Firestone W01-358-8897 (replaced by W01-358-9376)

Firestone Style: 1T15L-2

Triangle AS-8730

TRP AS88970

Firestone W01-358-8897

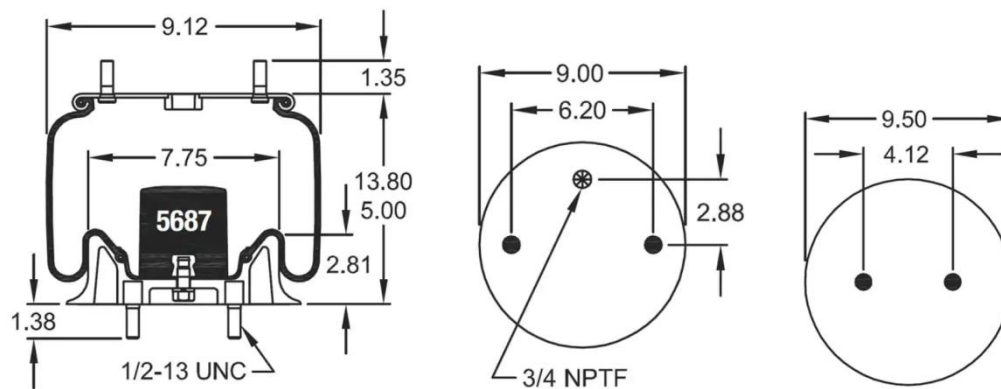

2006 Monaco Camelot 42-DSQ

Firestone W01-358-9376

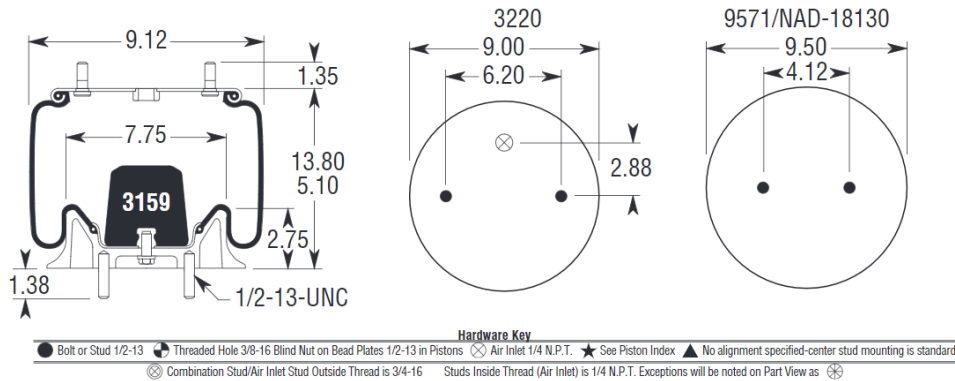

Upholstery

Loveseat/Bed & Captains Chairs reupholstered May 2020: Ultraleather - Buff #104251.
Kitchen Chairs reupholstered April 2020: Ultraleather - Cashmere #103848.

Steps – Front Door

Manufacturer: CoachStep by Lippert
Model: 3691461
Control Module: [301702](#) (Replaced Sep 2020)
Motor: [301695](#)

Over the Door Awning

Manufacturer: Carefree of Colorado
Model: Marquee
Size: 50" (Actual 51 1/2")
Fabric Width: 46 1/2"
Documentation: <https://www.carefreeofcolorado.com/products/marquee-otd.html>

Florescent Fixtures

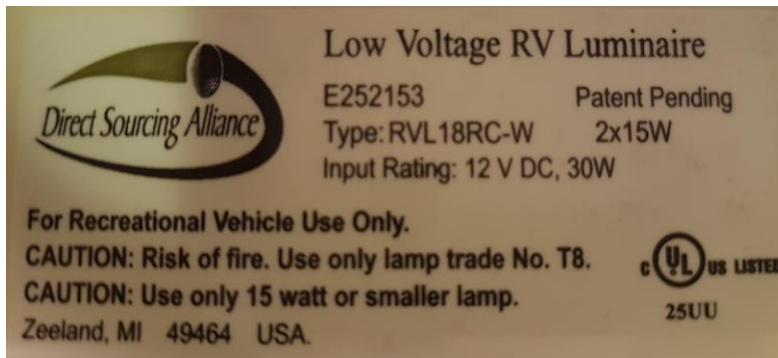

Outside: 6 1/4" (W) x 22 7/16" (Len)
Cut-out: 4 3/4" (W) x 18 3/8" (Len)

2006 Monaco Camelot 42-DSQ

LED strip conversion:



2 or 4 18" 60/m LED strips (4 shown)

Florescent bulbs and fittings (incl. ballast) removed.

¼" 3m moulding tape used to attach LED Strips

Power Consumption:

2 Strip - 0.8 Amps (9.6 Watts)

4 Strip – 1.6 Amps (19.2 Watts)

Microwave Oven

Sharp Model R-1874F

Over the Range Convection Oven

AC Power: 1600 Watts / 13.2 Amps

Microwave: 850 Watts

Convection: 1400 Watts

O/S Dim: 29 15/16" (W) x 16 11/32" (H) x 15 9/32" (D)

Turntable: 13"

I/S Dim: 17 1/8" (W) x 8 1/16" (H) x 13 13/16" (D)

Replacement: Sharp T1874R

Refrigerator

Dometic Auto Defrost

Model: NDA-1402

S/N: 52300011

Washer/Dryer

Make: Splendide

Model: WC 2100XC (NA)

S/N: 404236048 ' 80866760000

UL Listed 37H1 E77149

Mar 2018: Error Code F13 - Drying NTC sensor (Thermistor ntc part # C0083915) open / short circuited. Fan motor (Part #: C00110434) blocked

Solution: http://www.visualsc.com/Splendide_F13_Error_Solution.pdf

Built-in Vacuum

Dirt Devil Model CV1500

Bags Part #:9597

Toilet (1/2 Bath)

Thetford Aqua Magic V (Tall model in Bone) – Replaced Jan 2019

Planned Work

FASS Fuel Pump Installation: FASS Titanium TS-D08-165G

2006 Monaco Camelot 42-DSQ

https://www.irv2.com/forums/f123/fass-installation-on-cummins-isl-in-monaco-dynasty-529299.html?utm_source=newsletter&utm_medium=email

<https://www.dirtydieselcustom.ca/products/1998-2004-cummins-165gph-signature-series-titanium-lift-pump-td08165g>

<https://www.dirtydieselcustom.ca/products/1998-5-2004-cummins-250gph-signature-series-titanium-lift-pump-td08250g>

Micro-Air EasyTouch RV Thermostat



Model RV357 to replace 5 button

<https://www.microair.net/products/easytouch-rv-thermostat?variant=37538126627005>

2006 Monaco Camelot 42-DSQ

Build Sheet – From Monaco

Recreational Vehicle Data Card

Unit Serial Number: 060119184223400166696
 Federal ID Number: 1RF43561162040521

Monaco Coach
 Mpv / Mha (Mh / Ac)
 Camelot

Order #
 130639

ITEM	MANUFACTURER	MODEL #	SERIAL #
LP TANK	MANCHESTER	68140	65565
GENERATOR	ONAN	10HDKA11506C	B060885264
INVERTER	MAGNUM	ME2012B20	B1-11177
WATER PUMP	AQUA-JET	5503-4V15-B636	1995563
TOILET	THETFORD	34425	060309-34425-7316
TOILET	THETFORD	28970	060224-28970-9809
CABLE BOX	WINEGARD	VS0604/6412	000189
MICROWAVE	SHARP	R-1874-F	412034
ROOF AIR-CONDITIONER	DUO-THERM	630035.331	611 34434
REFRIGERATOR	NORCOLD	NDA1402	60700005
RANGE/COOKTOP	AMANA	ALZ8590ADB	11047970JA
AQUA HOT/HYDRO HOT	HYDRO-HOT	HHE-200	HE06-0512
DASH RADIO	MAGNADYNE	M9900CDS	051002264
REAR VIEW MONITOR	WELDEX	WDRV-6800M	WDFB2500002
ROOF AIR CONDITIONER	DUO-THERM	630035.321	610 34700
ROOF AIR-CONDITIONER	DUO-THERM	630035.321	610 34699
ENTRANCE DOOR			223
ENTRANCE DOOR KEY	TRIMARK		1050
DEADBOLT KEY			13346
BAGGAGE DOOR KEY		1050	751
IGNITION KEY		GM	10C4
ALLADIN SYSTEM		431-06L;	2282
PAINT CODE	PIN 6341	MASK 6317	STRIPE 6117
TRIMARK	19906-01	REV-4040	121905-0040
OTHER	RIVER PARK	6CHXOV-01	053411610
HOME THEATRE SYSTEMW/DVD	RCA	RTD-300	NA055E395NA05F
TELEVISION-FRONT	SHARP	LC-32GA5U	A502823771
TELEVISION-REAR	RCA 20"	20V412T	F494EC258
AWNING-ENTRANCE	CAREFREE		2082618910
AWNING-WINDOW	CAREFREE		2082725681
AWNING-WINDOW	CAREFREE		2082759300
AWNING-S/O	CAREFREE		2082759270
AWNING-S/O	CAREFREE		2082825991
AWNING-S/O	CAREFREE		2082759250
AWNING-S/O	CAREFREE		2082759280
FRONT AXLE	DANA	E1462W 1462 BN 202-1	HU00691468
REAR AXLE	DANA	21060S SPEC#0599911	HN02197902
TAG AXLE		D22AU601A133-001	LV00071931
STEERING GEAR BOX	TRW	TAS65187-A	
JACK PUMP	POWER GEAR	501196	0000901
ENGINE	CUMMINS	ISL 400HP	46580780
TCM BOX		ISL400T	BK4773N1529353PG
CAL#		A41001M9	
TRANSMISSION	ALLISON	E012544	6510625589
EXHAUST BRAKE		C26085	008769
RADIATOR	MODINE	X-6925-51	039T2692551
A/C COMP	SCS FRIGETTE	094-00018	0581505580
A/C EVAP	SCS FRIGETTE	08600347	1787579
A/C BLOWER	SCS FRIGETTE	08700251	1872718
TIRE RF: DOT# DANV2CAW	GOODYEAR	G670 295/80R22.5H	5205
TIRE LF: DOT# DANV2CAW	GOODYEAR	G670 295/80R22.5H	5205
TIRE RRI: DOT# DANV2CAW	GOODYEAR	G670 295/80R22.5H	4705
TIRE RRO: DOT# DANV2CAW	GOODYEAR	G670 295/80R22.5H	5005
TIRE LRI: DOT# DANV2CAW	GOODYEAR	G670 295/80R22.5H	5205
TIRE LRO: DOT# DANV2CAW	GOODYEAR	G670 295/80R22.5H	5205
TIRE RTAG: DOT# DANV2CAW	GOODYEAR	G670 295/80R22.5H	5205
TIRE LTAG: DOT# DANV2CAW	GOODYEAR	G670 295/80R22.5H	0106
VIN			1RF43561162040521