

2010 Motorhomes by Jayco



**Jayco**

AMERICA'S MOST LIVEABLE RVs.

2010 SENECA

# Great Explorer



# Freedom



## POWERFUL

Seneca's Duramax® V8 turbo diesel engine, six-speed Allison® 1000 Series transmission with overdrive, 150-amp alternator and 1,000-watt engine block heater will never leave you stranded.

SENECA®  
2010 Motorhomes by Jayco®

LIVEABILITY MEETS MANEUVERABILITY

# granted.

Whether the kids are grown up yet or not, family time will always be important. Fortunately, the spacious, comfortable and easy-to-drive Seneca makes hitting the road and visiting with family easier than ever before. Seneca's powerful engine offers unbeatable carrying capacity, while its distinctive and tastefully decorated interior rivals the best hotels. You'll enjoy every minute spent in your new Seneca.



## MANEUVERABLE

Tight corners are a breeze with Seneca's 53-degree turning radius, while its smart cab design, large windshield and sloped hood make it easy to see objects as close as 13 feet from the bumper.

## SMOOTH

Built on a 22,000-pound Chevy™ Kodiak® chassis for maximum cargo carrying capacity, Seneca utilizes rear suspension helper springs, a heavy-duty front stabilizer bar, power all-wheel ABS brakes and power steering to provide a smoother ride.

## A TRADITION OF LIVEABILITY

Starting with our first lifter system for fold-down campers in 1968, which made for an easier, more enjoyable camping experience, Jayco has always been about liveability. Today, we're the world's largest family-owned RV manufacturer, yet our priorities remain the same: making RVs more liveable and family time more memorable.



SENECA 36FS | INDIGO



## BIG ON COMFORT. BIGGER ON SAVINGS.

With Northridge Maple raised-panel cabinetry, oil-rubbed bronze cabinet hardware, J-Stone® solid-surface countertops and interior halogen recessed ceiling lights throughout, Seneca's lavish interior offers the comfort and luxury of an upscale Class A motorhome, for the price of a Class C.

## SPACIOUS

There's no chance of getting in each other's way in Seneca's roomy living area, with comfortable dinette and leather hide-a-bed sofa.

## CHARMING

Seneca's tastefully designed bedroom features a decorative headboard, contemporary cabinetry, color-coordinated fabrics and ample storage.

## PEACEFUL

A rounded glass shower door, medicine cabinet with mirror and residential linoleum floor are just a few of the bathroom's home-like touches.



SENECA 36MS | CHOCOLATE



SENECA 36MS | CHOCOLATE



SENECA 36FS | INDIGO

## Jayco construction

At Jayco, we've built a reputation for superior construction and craftsmanship. We always use top-quality materials and production techniques, giving our products **reliable resale value** and our owners peace of mind.

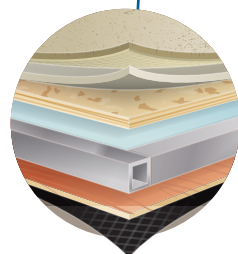

### FLOOR

Vacuum bonding joins our welded aluminum frame with a heavy-duty Structurwood® floorboard to create one of the strongest foundations in the industry.

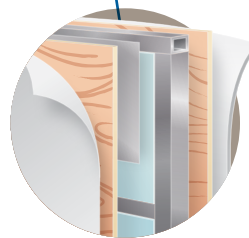

### WALLS

TuffShell™ vacuum bonding combines with welded aluminum frames and metal backers, creating a durable structure designed to withstand use and travel.

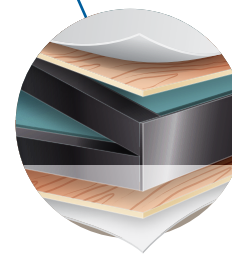

### ROOF

The laminated, vacuum-bonded roof is comprised of ¼" plywood decking on 5" arched aluminum trusses with bead-foam insulation (R-23) and a seamless fiberglass shield that protects against moisture and resists aging.

## Jayco craftsmanship

Jayco's dedicated production team includes Amish craftsmen who build with well-honed woodworking techniques passed down for generations.



## Jayco liveability

### DRAWER GUIDES

New ball bearing drawer guides provide smooth operation and full-drawer extension.

### HDTVS

The living area boasts an impressive 32" LCD HDTV, while the bedroom features a 22" LCD HDTV.

### BACK-UP MONITOR

The in-dash built-in back-up color camera, monitor and optional in-dash navigation system add an extra layer of safety.

### STAY COOL

Central air conditioning and a Carefree® 12V Eclipse™ electric patio awning make it easy to stay cool both inside and out.

# Standards and options

## STANDARD BATHROOM EQUIPMENT

6-panel residential-style passage doors
Oil-rubbed bronze fixtures
Overhead cabinet above stool (select models)
Radius fiberglass shower with surround and glass shower door
Residential linoleum floor in bathroom
Residential medicine cabinet with mirror
Robe and towel hooks
Skylight in shower with light (select models)
Theftford® porcelain stool with foot pedal
Toilet paper holder
Towel holder
Towel ring
Vanity light fixture

## STANDARD BEDROOM EQUIPMENT

22" digital LCD HDTV
Decorative headboard
Halogen oil-rubbed bronze reading lights
Pillow shams (2)
Queen bed with Cloud Ten™ pillowtop mattress
Quilted bedspread
Under-bed storage, bed lifts easily on gas struts

## STANDARD KITCHEN EQUIPMENT

8 cu. ft. flush-mount refrigerator, double door with ice maker
Bi-fold recessed cover for stove
Booth dinette with comfortable seating mechanism
Drawer for silverware, divided for utensils
Dream Dinette™ mechanism, raises and lowers dinette table top
High-rise, single-lever faucet with pull-out sprayer
Microwave oven GE® 1.4 cu. ft. with carousel
Mini-blind
One-piece J-Stone® solid-surface high-gloss countertop with integrated deep bowls and backsplash
Oversized oven
Recessed 3-burner range with 9,000-BTU SuperBurner™ and piezo igniter
Residential linoleum floor in kitchen
Sink/cutting board covers (2)
Splash guard, made of Plexiglas®
Water purification system

## STANDARD CAB EQUIPMENT

3-point lap and shoulder safety belts (driver and passenger)
Auxiliary start switch
Padded fabric headliner
Privacy curtains for cab area
Remote keyless entry
Upgraded seats with full front/back adjustment and map pockets

## STANDARD CHASSIS EQUIPMENT

6-speed automatic Allison® 1000 Series transmission with overdrive
80-gal. fuel tank
150-amp alternator
1,000-watt engine block heater
8,000-lb. hitch with 7-pin plug
A/C and cruise control from factory
Alcoa® aluminum rims
All-wheel ABS (Anti-lock Braking System)
Deluxe heated, remote-control side-view mirrors
Dome lights
Dual chassis batteries
Duramax® 6.6L diesel engine 330 HP
Electronic exhaust restrictor
Engine exhaust brake
Heavy-duty 19,000-lb. rear springs
Heavy-duty front stabilizer bar
Hellwig® helper springs
Power anti-lock brakes with power steering
Power windows and door locks
Tilt steering wheel
Transmission temperature gauge

## STANDARD CONSTRUCTION FEATURES

Bead-foam insulation (R-23 roof, R-9 floor, R-9 walls)
Cabinetry crafted with screwed-stile construction
Deluxe hidden cabinet hinges
Electric-powered slideout
One-piece fiberglass roof
Smooth gel-coat fiberglass exterior walls
TuffShell™ vacuum-bonded 5" crowned laminated roof
TuffShell™ vacuum-bonded laminated sidewalls
Unitized 1-1/2" laminated construction of floor
Welded tubular-aluminum sidewall framework

## STANDARD EXTERIOR EQUIPMENT

80"-tall fiberglass, radius-cornered entrance door and screen door
120V G.F.C.I. protected exterior receptacle
Caps on front and rear made of high-gloss fiberglass with radius corners
Carefree® 12V Eclipse™ electric patio awning
Door for dump valve access
Dual slideout battery tray (2 batteries included)
Electric-powered, triple entrance step
Heavy-duty grab handle for entry assistance
Hydraulic automatic leveling jacks
One-piece polyethylene pass-through storage compartments
Patio light with inside switch
Roof ladder
Side-hinged baggage doors
Slideout awning toppers
Uni-Dock™ utility center, heated and enclosed

## STANDARD INTERIOR EQUIPMENT

Ball bearing drawer guides 100-lb. capacity with full-drawer extension
Cable TV hookup with RG6 Coax
Crank-up digital antenna for TV with signal booster
Decorative oil-rubbed bronze lighting throughout
Decorative pillows for sofa and hide-a-bed
Decorative trim package
Entertainment center in front, includes 32" digital LCD HDTV
High-intensity halogen recessed 12V lighting package
Leather hide-a-bed sofa
Northridge Maple solid hardwood raised-panel doors throughout
Padded vinyl ceiling throughout
Padded wings behind cab
Pleated day/night shades throughout
Prep for satellite dish for roof and sidewall
Residential trackless carpeting with padding (bedroom and living area)

## STANDARD HEAT, POWER AND WATER

10-gal. gas/electric DSI auto-ignition water heater
12V demand water pump
12V electrical system with 120V, 80-amp power converter
50-amp, quick-connect power cord
56-lb. propane gas tank, chassis-mounted
1,800-watt inverter with 4 batteries
13,500-BTU low profile A/C with digital thermostat and Chillgrille™ in living area and bedroom
Auto-ignition furnace with wall thermostat
Black holding tank sprayer
Conveniently placed water pump switches
Holding and fresh water tanks, ducted or radiant-heated
Hookup for city water
Onan® 6,000-watt Quiet Diesel™ generator with auto-changeover
Onan® energy command center
Outside shower
Systems monitor panel
Water heater bypass system

## STANDARD SAFETY EQUIPMENT

Battery disconnect switch
Deadbolt lock on entrance door
Driver and passenger side air bags
Egress window
Fire extinguisher
Lap safety belts in living area
Propane/carbon monoxide alarm
Smoke alarm
Third brake light
Tinted safety-glass window

## OPTIONS

10 cu. ft. refrigerator with ice maker
22" LCD HDTV on door side exterior
8,000-watt diesel generator
Bunk DVD players (2) (36FS)
Cab over bunk with 32" LCD HDTV
Canadian standards
Convection microwave
Customer Value Package
Diamond Shield™ paint protection film
Dinette and sofa ensemble (36MS)
Electric leather sofa
Euro chair in lieu of recliner (35GS)
Euro chair in lieu of swivel chair (36FS, 36MS)
Free-standing table with 4 chairs (2 chairs and 2 folding)
Navigation system
Pewter Cast premium paint
Provincial Glazed Maple cabinetry
Satellite kit
Thermal pane tinted safety-glass windows
Winegard® dome satellite dish

## CUSTOMER VALUE PACKAGE

Attic fan
Bathroom power vent
Exterior entertainment center with Sony® AM/FM/CD/DVD player and two speakers
Non-powered Optima leather passenger-side seat
Portable, outside gas grill
Power Optima leather driver-side seat
Touch-Screen Premium In-Dash Sound System™ AM/FM/CD/DVD with back-up camera monitor

# Specifications

FLOORPLAN	EXTERIOR LENGTH	EXTERIOR HEIGHT W/AC	INTERIOR HEIGHT	GROSS VEHICLE WEIGHT RATING (LBS.)	GROSS COMBINED WEIGHT RATING (LBS.)	ENGINE/SIZE	WHEEL BASE	FURNACE AUTO-IGNITION (BTUS)	FRESH WATER CAPACITY (GALS.) (INCLUDES WATER HEATER)	GREY WASTE WATER CAPACITY (GALS.)	BLACK WASTE WATER CAPACITY (GALS.)
35GS	36' 7"	144"	80"	22,000	26,000	Duramax 6.6L V8 Turbo	251"	40M	81 - 1/2	41	51 - 1/2
36FS	37' 3"	144"	80"	22,000	26,000	Duramax 6.6L V8 Turbo	260"	40M	81 - 1/2	41	51 - 1/2
36MS	37' 5"	144"	80"	22,000	26,000	Duramax 6.6L V8 Turbo	260"	40M	81 - 1/2	82	66

# Floorplans

◀ = outside storage  
 LAV. = bathroom sink  
 MICRO. = microwave  
 OHC. = overhead cabinets  
 REFRIG. = refrigerator  
 WARD. = wardrobe

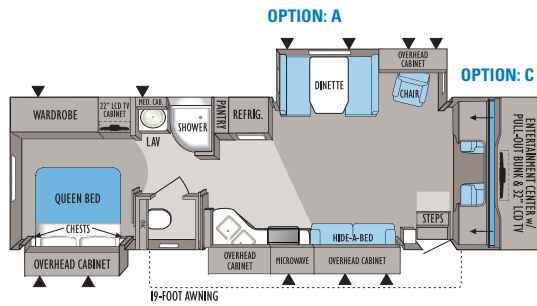

**SENECA | 35GS**  
 Ext. Length: 36' 7" Ext. Height: 144"

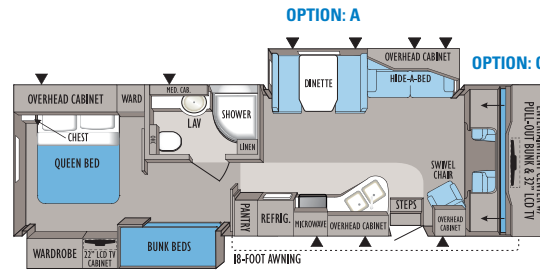

**SENECA | 36FS**  
 Ext. Length: 37' 3" Ext. Height: 144"

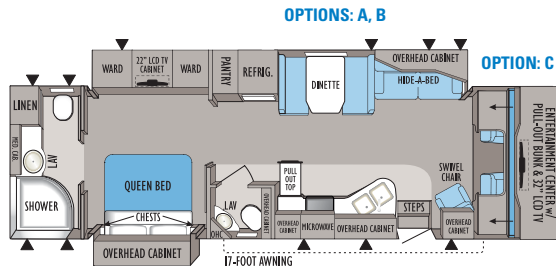

**SENECA | 36MS**  
 Ext. Length: 37' 5" Ext. Height: 144"

## Floorplan options (available on select models only)

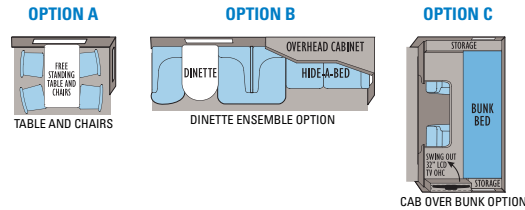

# Interior color options



CHOCOLATE

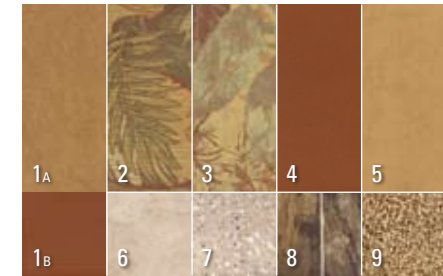

CORDOVAN

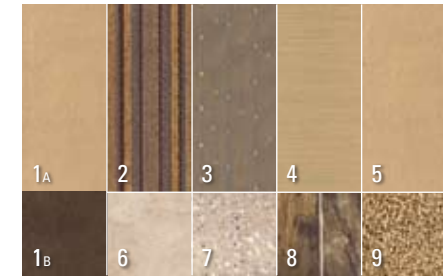

INDIGO



WOOD OPTIONS

- 1 Sofa and driver/passenger (two-tone)
- 2 Accent fabric
- 3 Bedroom accent
- 4 Bedroom accent
- 5 Bedroom accent
- 6 Wall panel
- 7 Countertop
- 8 Flooring
- 9 Carpet

# Exterior color options



STANDARD PAINT



PEWTER CAST PREMIUM PAINT

**Gross Vehicle Weight Rating (GVWR):** GVWR means the maximum permissible weight of the motorhome, including the Unloaded Vehicle Weight (UVW) plus passengers, personal items, all cargo, fluids, options and dealer-installed accessories. The GVWR is equal to or greater than the sum of the UVW and the Cargo Capacity Capability.

**Gross Combined Weight Rating (GCWR):** The maximum allowable combined weight of the motorhome used as a tow vehicle and the attached towed vehicle.

It is important for your safety and enjoyment that you are aware of the weights and tow ratings of the RV you select. Consult a competent advisor for questions or advice. Whether you are new to RVing or a veteran, get a feel for the performance of your RV before heading out on the roadways. When you tow a vehicle with your RV, you must drive differently than when you drive a single vehicle. Practice hooking up, driving, backing up and braking in a safe environment or seek out professional instruction. Jayco affixes a weight label to each RV which lists weight information for that vehicle. Refer to that label to verify the vehicle will meet your requirements.



AMERICA'S MOST **LIVEABLE** RVs.

## 2 YEAR WARRANTY

The Jayco Co-Pilot Warranty is a manufacturer's limited warranty. It comes from the people who build Jayco recreation vehicles to the people who buy them. Each Jayco is warranted to the original purchaser for twenty-four (24) months or twenty-four thousand (24,000) miles (mileage limitation applies to motorized products only), whichever occurs first, from the original date of purchase against defects in materials and workmanship. Jayco's limited warranty is not transferable.

**Go ahead and compare the Jayco warranty with other manufacturers' warranties. You'll find it's the best in the business!**

For a copy of the limited warranty with full terms and conditions, ask your local Jayco dealer.

Your Jayco Dealer

## 300 JAYCO DEALERS

Establishing a solid relationship with your local Jayco dealer is a key component in the enjoyment of your new Jayco. By purchasing from a local dealer, you will have a convenient location for sales, parts and service support.

Jayco dealers are required to deliver all products at the site of the sale to provide a full product orientation and walkthrough at the time of delivery. It's a good way to become familiar with your Jayco and to meet the service, parts and warranty staff members who will be assisting you. If you live in Canada, there are regulations that must be met when buying a Jayco RV. Your local Canadian dealer is a professional at meeting these requirements and regulations. There simply is no substitute for a good relationship with your local Jayco dealer.

## 1 YEAR ROADSIDE ASSISTANCE

Travel worry-free with Jayco's Customer First Roadside Assistance program, yours at no cost during your first year of ownership. This program is offered through Coach-Net®, the largest RV emergency road service in the country, and gives you immediate access to dependable roadside assistance and support services with a simple phone call.

- Free jump starts
- Free tire changes
- Free fuel delivery
- Free lockout service
- Free travelers checks
- Toll-free nationwide service appointment assistance
- 24-hour toll-free emergency message service
- Free custom trip routing and full-color map service
- Free dispatch of on-site mechanical service
- \$2,000 trip-interruption reimbursement
- RV technical assistance hotline
- Free towing to nearest qualified service



Jayco proudly sponsors Tread Lightly!, a nonprofit organization whose mission is to empower generations to enjoy the outdoors responsibly through education and restoration.



From RV insurance to extended warranties, JayPlus has it covered. Ask your Jayco dealer about our exclusive JayPlus program today.



As a Jayco owner, you can be part of the Jayco Jafari International Travel Club. Ask your dealer about the Jafari "flight" in your area, write Jayco or visit our website.

Jayco, Inc., P.O. Box 460, Middlebury, IN 46540  
[www.jayco.com](http://www.jayco.com) 

See dealer for further information and prices. All information in this brochure is the latest available at the time of publication approval. Jayco reserves the right to make changes and to discontinue models without notice or obligation. Photos in this brochure may show optional equipment and props for photography purposes. RVs built for sale in Canada may differ to conform to Canadian codes. ©2010 Jayco, Inc. 10-SNCA-PL 0809-50K Printed in U.S.A.