



**2016 OUTLANDER**

**Owner's Handbook**



PLEASE PLACE COPIES OF THE FOLLOWING ITEMS IN THE POCKET BELOW:

1. Pre-Delivery Inspection Form (Customer Copy)
2. Triple Diamond Delivery Checklist (Customer Copy)
3. Salesperson or Key Dealership Contact's Business Card



Thank you for buying a Mitsubishi Outlander. There's no doubt you've already realized how well your car drives on the open road. What you may not know is all the great features that help your car perform the way it does. In the pages ahead we're going to run through the basics and prepare you for the road.

We'd also love to hear from you regarding your overall Mitsubishi experience. Within a week or so after your purchase, we'll be sending you a very brief survey to complete. We would appreciate it so much if you could take a minute or two to tell us how we did. We highly value your comments.

We hope you will visit the Mitsubishi Owner's site where we store the latest Mitsubishi news and special offers. Here you can also keep track of your car's warranty and servicing needs, get Roadside Assistance Information and tap into other owner-centric details. Just log on to **[www.Mitsubishicars.com/ownersonly](http://www.Mitsubishicars.com/ownersonly)**.

## Table of Contents

Driver's View .....	Page 2-3
Controls .....	Page 4-5
Own the Road .....	Page 6
Switches .....	Page 7
ECO Driving .....	Page 8
Folding and Stowing the Second and Third Row Seat .....	Page 9
Technology .....	Page 10
Homelink® Wireless Control System.....	Page 11
Audio System.....	Page 12
Display Audio System (if equipped) .....	Page 13-14
Bluetooth® .....	Page 15
FAQ's.....	Page 16-17



### Driver's View

- 1** Climate Controls..... Page 4
- 2** Headlights ..... Page 4
- 3** De-Icer Controls (if equipped) ..... Page 4
- 4** Side Mirror Adjustment ..... Page 5
- 5** Windshield Wiper Lever..... Page 5
- 6** Cruise Control / Adaptive Cruise Control (if equipped)..... Page 6
- 7** Drive Mode Selector..... Page 6
- 8** Paddle Shifters (GT only) ..... Page 6
- 9** Seat Heater Switch (if equipped) ..... Page 6
- 10** Lane Departure Warning (LDW) and Forward Collision Mitigation (FCM) (if equipped)..... Page 7
- 11** Power Liftgate Main Switch (if equipped)..... Page 7
- 12** ECO Mode Switch ..... Page 8
- 13** Multi Information Display (MID)..... Page 10
- 14** Start/Stop Engine Switch (if equipped with F.A.S.T.-key)..... Page 10
- 15** Audio Remote Control Buttons ..... Page 11
- 16** Homelink (if equipped) ..... Page 11
- 17** Display Audio/Navigation (if equipped)..... Page 12-13
- 18** Bluetooth® Controls..... Page 14





6

8

14

5

1

3

11

12

17

7

16

9



Regular Headlights

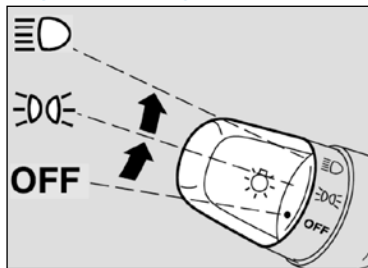

Automatic Headlights (if equipped)

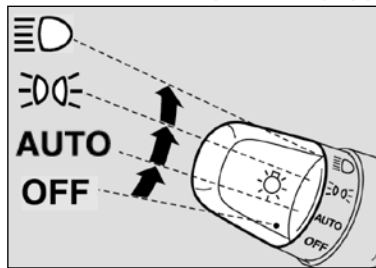

Headlights and other lights on.



Parking, tail, front and rear sidemarker lights, license plate and instrument panel lights on.

**AUTO**

Turns headlights on or off automatically in accordance with the outside light level (GT and OPT SEL). Otherwise, headlights turn off automatically when the ignition switch is turned off and the door is open.

Dual-Zone Automatic Climate Controls (if equipped)

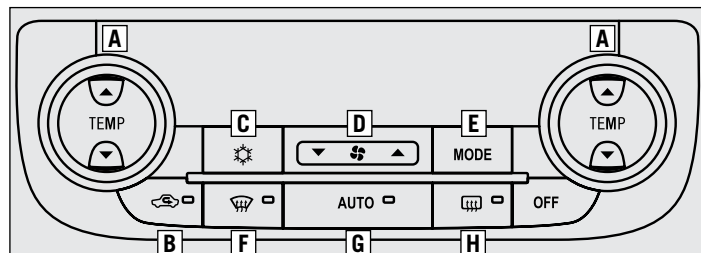

- A** - Push to select the desired temperature
- B** - Push to select outside air (Indicator light off) or recirculated air (Indicator light on)
- C** - Push for air conditioning ON/OFF
- D** - Push to select the blower speed
- E** - Push to select the position of air flowing from the vents
- F** - Push to defog windshield.
- G** - When the AUTO switch is pushed, the settings are automatically controlled. Passenger's side temperature will be changed to the same temperature set as the driver's side
- H** - Push to defog the rear windows and to activate the De-Icer Controls (if equipped)

### Windshield Wipers

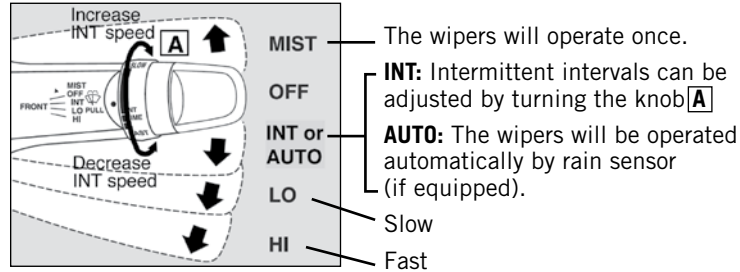

### Rear Window Wiper and Washer

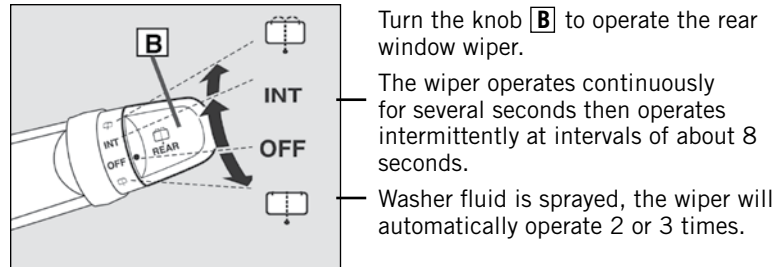

### Side Mirror Adjustment

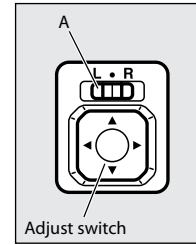

The outside rearview mirrors can be adjusted when the ignition switch is in the "ON" or "ACC" position or the operation mode is put in ON or ACC.

Move the lever (A) to the same side as the mirror you wish to adjust.

### Folding Side Mirrors (if equipped)



Automatically folds in when the car doors are locked and ignition is off

### Power Folding Side Mirror Switch (if equipped)

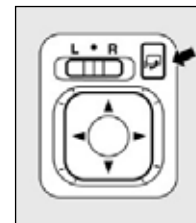

Press switch to fold in mirrors if needed

## OWN THE ROAD

### Paddle Shifters (GT only)

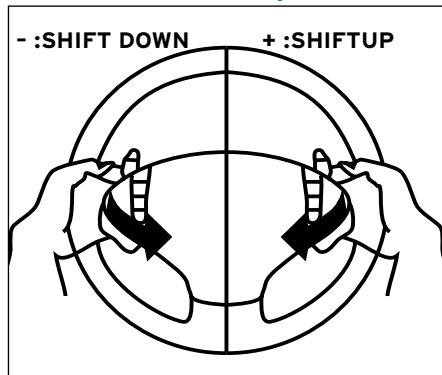

Simply upshift or downshift with a tap of your fingers – without moving your hands from the steering wheel.

You can return to the “D” operation by pulling the + (SHIFT UP) side paddle shifter rearwards (toward the driver) and holding for over **2 seconds**.

### Drive Mode Selector (if equipped)



The drive mode can be switched by pressing the drive mode button while the ignition switch is in the ON position.

Pressing the button will change the drive mode in order to:

AWC ECO, NORMAL, SNOW, LOCK

### Cruise Control / Adaptive Cruise Control (if equipped)



- A**- **CANCEL**: To deactivate the ACC or cruise control
- B**- **RES +**: To increase the set speed or resume control after cancelling the ACC or cruise control function.
- C**- **SET-**: To set the desired speed and to reduce the set speed.
- D**- **ON / OFF**: To turn cruise control ON or OFF
- E**- **ACC Distance Switch** - Used to set or change the following distance between your vehicle and the vehicle in front of you.

#### To set a cruising speed

- Press **D** and the “**ACC**” (if equipped) or “**CRUISE**” indicators will appear in the multi information display.
- Accelerate or decelerate to your desired speed (above 25 mph). Press **C** and remove your foot from the accelerator pedal.

#### To accelerate or decelerate speed

Push up **B** to increase set cruising speed.

Push down **C** to decrease set cruising speed.

**To cancel the cruising speed** Press **A** or press brake pedal, or press **D**.

### Seat Heater Switch (if equipped)



Position	Action
<b>HI</b>	For quick heating
<b>NEUTRAL</b>	Heater off
<b>LO</b>	To keep the seat warm



### Active Stability Control (ASC) Off Switch

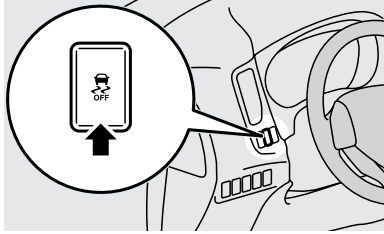

You can deactivate the system by pressing down the “ASC OFF” switch for 3 seconds or longer.

When the ASC is deactivated, the display/indicator will turn on. To reactivate the ASC, momentarily press the “ASC OFF” switch; the display/indicator is turned off.

### Lane Departure Warning (LDW) Switch (if equipped)

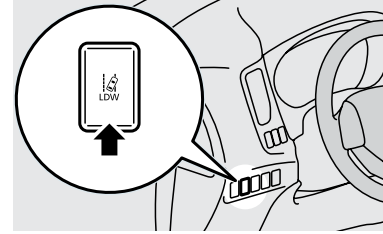

When you press the LDW switch, the “LDW” indicator on the information screen of the multi information display turns OFF and the LDW system is inactive.

Press the switch again, the system will activate.

### Power Liftgate Main Switch (if equipped)



When the power liftgate main switch (located in the lower center dash area) is ACTIVE, the power liftgate can be operated using either the power liftgate switch on the F.A.S.T.-key, the driver’s side power liftgate switch or the open/close switches on the power liftgate.

### Power Liftgate Switch (if equipped)

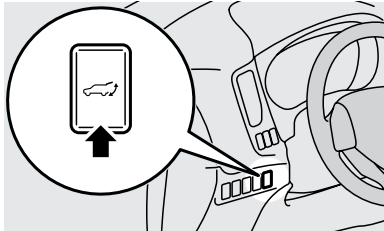

The power liftgate can be opened by pressing the Power Liftgate Switch.

### Forward Collision Mitigation (FCM) Switch (if equipped)



Every time the operation mode is turned to “ON”, the FCM will automatically be turned on.

To turn off the FCM, press and hold the FCM switch. A buzzer will sound and the “FCM OFF” message and indicator will appear in the multi information display.

To change the warning distance mode, briefly press the FCM switch.

## ECO DRIVING

### ECO indicator



This indicator will be displayed when fuel efficient driving is achieved.

### ECO Drive Assist

#### ECO drive level

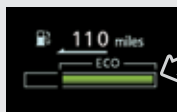

Low → High

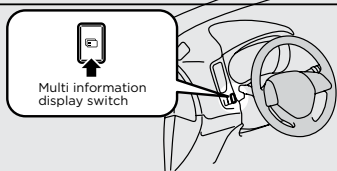

This function displays how fuel-efficiently you are driving under different driving conditions. To show, press the multi information display switch.

The ECO drive assist is displayed only when vehicle is driven with the selector lever in the “D” (DRIVE) position or when vehicle is driven in the sport mode (for vehicles equipped with sportronic steering wheel paddle shifter).

### ECO Score

#### ECO drive level

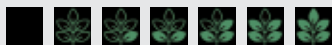

Low → High

ECO score indicates the points you have scored on fuel-efficient driving by the number of leaves. To show, press the multi information display switch.

### ECO mode switch

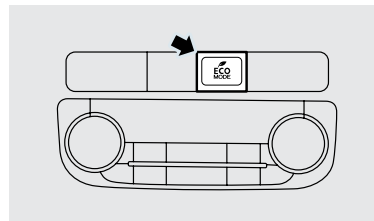

ECO mode is an eco-driving support system which automatically controls the engine, air conditioning system, 4WD system (if equipped) and S-AWC (if equipped) to improve fuel efficiency.

To activate, press the ECO mode switch.

### Momentary fuel consumption display

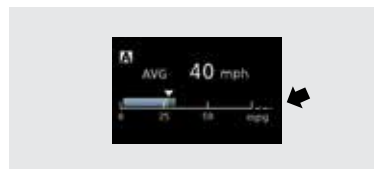

While driving, the momentary fuel consumption is shown with a bar graph.

The “” mark in the momentary fuel gauge shows the average fuel consumption.

When the momentary fuel consumption surpasses the average fuel consumption, the momentary fuel consumption is displayed with a green bar graph.

Maintaining your fuel consumption above the average fuel consumption point will help increase your mileage per gallon.

To show, press the multi information display switch.

### Tire Pressure Monitoring System (TPMS)



The Tire Pressure Monitoring System light illuminates when one or more of your tires is significantly under inflated. Please note that changes in the outside temperature may decrease tire pressure causing the TPMS light to turn on. If the TPMS light remains illuminated, check your tire pressure.

If the warning light illuminates, take the necessary measures referring to the owner’s manual.

### Folding the second row seats

1. When folding the left side second row seat, store the seat belt for the middle seating position of the second row seat. Refer to “Detachable center seat belt for second row” in your Owner’s Manual for help.
2. Lower the head restraint for second row middle seating position to its lowest position.
3. Pull the strap (A) and tilt forward the head restraints for second row outside seating position.

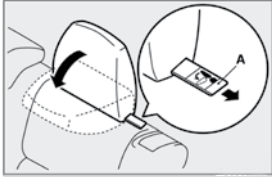

4. On vehicles with the second row seat slide function, move the second row seat fully backward. Refer to “To adjust the seat forward or backward” in your Owner’s Manual for help.



**NOTE:** If you do not move the second row seat fully backward, you may not be able to fold the second row seat.

5. Pull the strap (B) to flip the seat cushion forward.
6. Fold forward the seat belt buckle.



7. Pull up the lever (D), then fold the seatback forward.

**CAUTION:** Do not allow any person to sit on the flipped seat cushion, and do not place luggage on it. The seat’s mounting fittings could bend under the weight, making it impossible for the seat cushion to be secured when it returns to the original position.

### Unfolding the second row seats

1. Raise the seatback until it locks securely into place.
2. While lifting the seat belt buckle (A), gently lower the seat cushion. Make sure that there is a hook (B) at the position shown in the illustration.
3. Push down the seat cushion until it locks securely into place.
4. Make sure that all seat belt buckles are properly positioned on the seat cushion.
5. If the center seat belt is stored;
  - Pull out the detachable anchor plate (D) from the seatback.
  - Pull the small latch plate (E) slowly and insert it into the detachable anchor plate until a click is heard.
  - Make sure that the seat belt is not twisted.

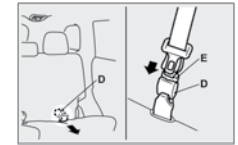
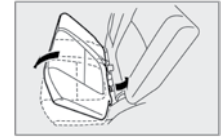
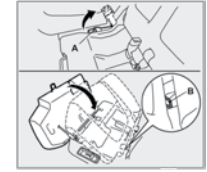

### Folding the third row seat (Seating 7 passengers)

1. Remove the head restraints from the third row seats. (Refer to “Head restraints” in your Owner’s Manual for help).
2. Pull up the strap (A), then fold the seatback forward.
3. Stow the removed head restraints in the luggage floor box with their front faces facing downward.

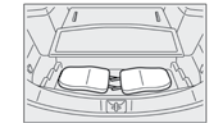
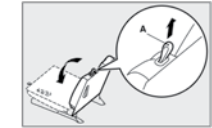

### Unfolding the third row seat

1. Pull the strap (A), then raise the seatback until it locks securely into place. Push lightly on the seatback to confirm that it has actually been secured.
2. Install the head restraints.

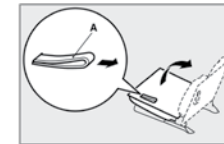

## Keyless Entry System

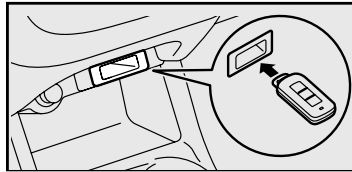
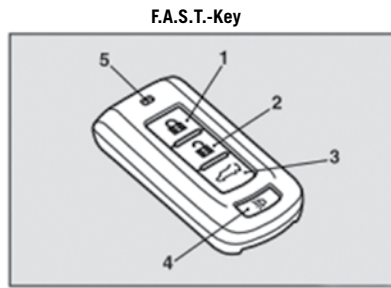

While carrying the F.A.S.T.-key, press the driver's or front passenger's door lock/unlock switch **A**.

1. **LOCK** (🔒) button
2. **UNLOCK** (🔓) button
3. Power liftgate button (if equipped)
4. **PANIC** button
5. Operation indicator light



### If the F.A.S.T.-key battery is not operating properly

Insert the F.A.S.T.-key into the key slot in the instrument panel. Starting the engine and changing the operation mode should be now possible. Remove the F.A.S.T.-key from the key slot after starting the engine or changing the operation mode.

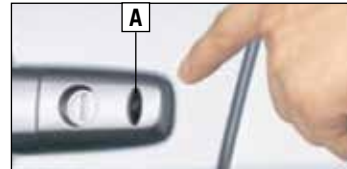

## Start/Stop Engine Switch (if equipped with F.A.S.T.-key)

### How to start engine

While carrying the F.A.S.T.-key within the operating range, the Start/Stop button can be used to start the engine.

- Move the selector lever in "P" position and hold the brake pedal down firmly, push the Start/Stop button.
- To stop the engine, stop the vehicle completely and move the selector lever in "P" then press the Start/Stop button.

### Function explanation

**\* If you have to bring the engine to an emergency stop while driving, press and hold the Start/Stop button for 3 seconds or more, or press it quickly 3 times or more.**

- If you press the Start/Stop button without depressing the brake pedal, you can change the operation mode in the order of OFF, ACC, ON, OFF.
- If the engine cannot be started or the operation mode cannot be changed, check the position of the F.A.S.T.-key or the battery performance of the F.A.S.T.-key.

## Multi Information Display Switch



Each time the multi information display switch is operated, the buzzer sounds and the multi information display changes between information such as warnings, trip odometer, average and momentary fuel consumption, distance range, etc.



## Programming a new HomeLink®

To program HomeLink® to operate a garage door, gate, or entry door opener, home or office lighting, you need to be at the same location as the device.

1. Press the HomeLink® button that you would like to program. The indicator light (A) will flash orange slowly.
2. Position the end of your hand-held transmitter (B) 1 to 3 inches (2 to 8 cm) away from the HomeLink® button while keeping the indicator light in view.
3. Press and hold the hand-held transmitter button while watching the indicator light (A). Continue pressing the button until the indicator light (A) changes from slowly flashing orange to either rapidly flashing green (rolling code) or continuously lit green (fixed code). Now you may release the hand-held transmitter button.
4. Press the just-trained HomeLink® button and observe the indicator light.
  - If the indicator light stays on constantly green, programming is complete and your device should operate when the HomeLink® button is pressed and released.
  - If the indicator light rapidly flashes green, firmly press, hold for 2 seconds and release the programmed HomeLink® button. Repeat the “press/hold/release” sequence a second time, and, depending on the brand of the garage door opener (or other rolling code equipped device), repeat this sequence a third time to complete the programming process. At this point if your device operates, programming is complete.
  - If the device does not operate, continue with “Programming a new HomeLink®” steps 5 to 7 to complete the programming of a rolling code equipped device.
5. At the garage door opener receiver (motor-head unit) in the garage, locate the “Learn” or “Smart” button. This can usually be found where the hanging antenna wire is attached to the motor-head unit (see the garage door opener manual to identify the “Learn” button).
6. Firmly press and release the “Learn” or “Smart” button. (The name and color of the button may vary by manufacturer.) There are typically 30 seconds to initiate step 7.
7. Return to the vehicle and firmly press, hold for 2 seconds and release the programmed HomeLink® button. Repeat the “press/hold/release” sequence a second time, and, depending on the brand of the garage door opener (or other rolling code equipped device), repeat this sequence a third time to complete the programming process. HomeLink® should now activate your rolling code equipped device.

**NOTE:** Some hand-held transmitters may actually train better a distance of 6 to 12 inches (15 to 20 cm). Keep this in mind if you have difficulty with the programming process.

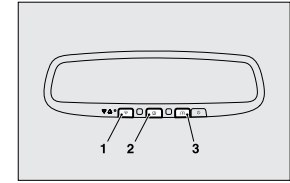

- 1- HomeLink® button 1
- 2- HomeLink® button 2
- 3- HomeLink® button 3

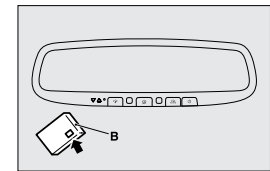
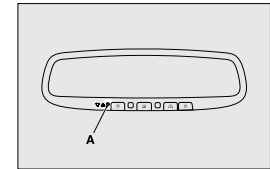



### To enter frequencies into the memory (AM/FM/SAT)

1. Press **A** to turn on the audio system.
2. Press **B** to select the desired band (AM/FM/SAT).
3. Press **C** to Seek Station
4. Hold down one of the Memory select buttons **D** (1-6) until it beeps in order to save that station to memory.

### To adjust the clock

1. Press and hold the **PAGE** or **MENU** key and the clock display flashes
2. Press the various buttons to adjust.
  - H**- "Hour" setting  
Press this key to fast-forward the "hours"
  - M**- "Minutes" setting  
Press this key to fast-forward the "minutes"
3. Press the **PAGE** or **MENU** key to finish adjusting the time.  
When the adjustment is completed, the clock display stops flashing.

**NOTE:** Please refer to your Owner's Manual for more detailed information on how to use your audio system.

### Audio Remote Control Button

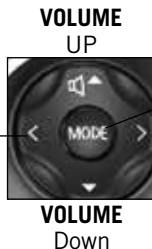

**SEEK**  
Change station or track

**MODE**  
Change the audio source

### USB and iPod Input

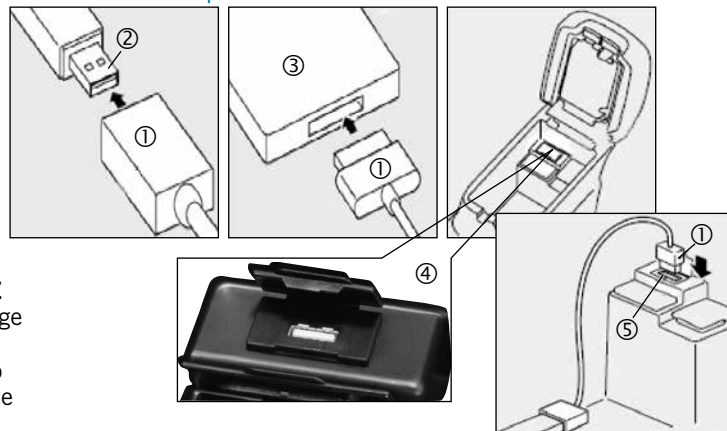

1. Park your vehicle in a safe place and turn the ignition switch to LOCK position.
2. Connect the cable ① (cable is not included with the vehicle) to the USB memory device ② or the Dock connector ① to the iPod ③.
3. Open the cover ④ in the floor console box. Connect the cable ① to the USB input terminal ⑤.
4. Turn the ignition switch to the "ACC" position. Turn on the audio system.
5. Press **MEDIA** several times to switch to the USB mode. The input mode changes as follows:  
**CD → USB → Bluetooth®**
6. Depending on your USB device, it may take longer for playback to start.
7. Once the device is selected, playback starts.

### With Display Audio System, follow steps 1 through 4 above

5. Press **MENU** on the touch screen.
6. Touch **USB**.
7. Touch **<Folder>** then select a track and begin playback.



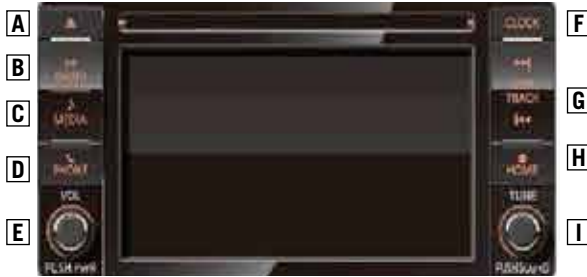

- A** - Eject Button for CD
- B** - Selects AM/FM, and/or Sirius (if equipped)
- C** - Selects type of Media (CD, MP3 and BT-A)
- D** - Bluetooth for Phone
- E** - Power and Volume knob
- F** - Clock setting
- G** - Seek stations or CD track - up or down
- H** - Displays all radio & media modes available
- I** - Tune stations / adjust sound settings

### To Adjust the Clock

You can adjust the time and date by touching the “Clock” **F** button on the top right of the display audio.

Settings name	Settings value	Settings content
Time Adjustment	Time	<p>Touch the corresponding <input type="button" value="▲"/> or <input type="button" value="▼"/></p>

**HD Radio®** This HD Radio receiver enables:

- PSD** Program Service Data: Contributes to the superior user experience of HD Radio Technology. Presents song name, artist, station IDs, HD2/HD3 Channel Guide, and other relevant data streams.
- HD2/HD3** Adjacent to traditional main stations are extra local FM channels. These HD2/HD3 Channels provide new, original music as well as deep cuts into traditional genre.
- Digital Sound** Digital, CD-quality sound. HD Radio Technology enables local radio stations to broadcast a clean digital signal. AM sounds like today’s FM and FM sounds like a CD.



## NAVIGATION AUDIO (if equipped)

### MMCS Audio



- A - PWR** – Turns Audio on or off and Volume Control
- B - Radio** – Select between AM/FM/ & Sirius stations
- C - Media** – Selects CD/SD/USB / & BT Audio
- D - Phone** – Controls Your Phone
- E - Tune** – Tune stations or push knob for Sound Control
- F - Seek / Track** – Locate stations or CD tracks up or down
- G - Open / Close** – Eject CD or Gain Access to SD cards
- H - Navi Control** – Access a variety of Navi functions
- I - Map** – Provides Real Time Map & Location
- J - Info set** – Provides other information or setting functions

### Setting an Address

1. Click on the NAV button at the bottom right of the screen
2. Click on Address/Intersection
3. If the state is correct – touch on All Cities. If not correct, touch on the State displayed and type in the correct state
4. Touch in All Cities and type in the correct city
5. Touch All Streets and type in the correct street
6. Touch All House Numbers and type in the correct house #
7. Touch Set



### Setting a Home Address

1. Click on the NAVI button at the bottom right of the screen
2. Click on Home button on bottom left of screen. If Home Location not set, it will ask if you want to jump to Personal Settings to register – Select Yes
3. Click on Address/Intersection – New
4. If the state is correct – touch on All Cities. If not correct, Touch on the State showing and type in the correct state
5. Touch in All Cities and type in the correct city
6. Touch All Streets and type in the correct street
7. Touch All House Numbers and type in the correct house #
8. Touch Set



## Bluetooth® Controls

For a list of compatible Bluetooth® devices please go to <http://www.mitsubishicars.com/owners>



- A SPEECH button:**  
Change to voice recognition
- B PICK-UP button:**  
Answer an incoming call
- C HANG-UP button**  
End a call or voice recognition

## Pairing a Bluetooth® device with the Bluetooth® 2.0 interface

(Pairing is required only when the device is used for the first time.)

- Step 1: Stop your vehicle in a safe area, put the selector lever in the “P” (PARK) position and pull the parking brake lever.
- Step 2: Press the PHONE button either on the Display Audio or MMCS Navi unit
- Step 3: If you haven't paired your phone, then the pairing process begins immediately. Follow the pairing features for your phone.
- Step 4: Enter the 4-digit code in your phone that is shown on the display screen and submit. This process may take a few seconds.
- Step 5: The pairing process is complete. A new message will show “Import entire phonebook from this phone.” Either select yes or no.  
Press Yes to download your phonebook. This process may take a few minutes.  
Press No to complete the pairing process at this time.

Please refer to the Owner's Manual for additional pairing options.

\*\*See Display Audio Owner's Manual

## To Make a Call

There are 3 ways to make a call: By Saying a Telephone Number, By using the Bluetooth 2.0 interface's phonebook, and by redialing a telephone number.

### Saying A Telephone Number

1. Press the Speech Button or PICK-UP button.
2. Say “Dial.”
3. After the voice guide says “Number please,” say the telephone number.
4. The voice guide will say “Dialing <number recognized>”. The Bluetooth 2.0 interface will then make the call. When the confirmation function is on, the system will confirm the telephone number again. To continue with that number, answer “Yes.” To change the telephone number, answer, “No.” The system will say “Number please.” then say the telephone number again.



### Making A Call Using A Phonebook Number:

1. Press the SPEECH button (except for vehicles with the Mitsubishi Multi-Communication System - MMCS) or PICK-UP button (for vehicles with MMCS).
2. Say “Call” (Note: You must have names stored in the Phonebook or it will say “The vehicle phonebook is empty. Would you like to add a new entry now?”)
3. After the voice guide says, “Name please.” Say the name you want to call, from those registered in the phonebook. If there is only 1 match, the system voice guide will say “Calling <name>” and will dial the telephone number. If there are 2 or more matches, the voice guide will say “More than one match was found, would you like to call <repeats name>”. If that person is the one you want to call, answer “Yes.” If not the person, answer “No.” The name of the next matching person will be mentioned by the voice guide.



### Redialing

Press the SPEECH button (except for vehicles with the Mitsubishi Multi-Communication System - MMCS) or PICKUP button (for vehicles with MMCS). Say “Redial”. The last phone number used in the system will then redial.



**Q: Is my phone compatible with the factory Mitsubishi Bluetooth® Hands Free System?**

A: Check the list of compatible phones, [www.mitsubishicars.com/owners](http://www.mitsubishicars.com/owners) to see if the phone is Bluetooth® supported.

**Q: How do I use Bluetooth® Audio (if equipped)?**

A: Please refer to your Owner's Manual for instructions.

**Q: Why does my Anti-Lock Braking System (ABS) make a noise?**

A: Each time your vehicle is started and driven a short distance, you will hear the sound of the ABS motor operating from the right front engine compartment. This is the normal sound the Anti-Lock Braking System makes when performing a self check.

**Q: Why does the Audio System take so long to upload my music from my audio music device?**

A: The Mitsubishi system can read multiple device structures in order to catalog the music files for easy playing and listening. Depending on the amount of music you have on your device, this may take a few minutes.

**Q: What are the different ways of playing music from my portable music player through the stereo system in my vehicle, when equipped with the FUSE Hands-free Link System™?**

A: There are two ways of playing music through your vehicle's sound system.

- USB port - The FUSE system will find the songs in your device and categorize them according to Artist, Album, and Genre. Then you can have the FUSE system find and play the song in your device that you prefer without physically searching your device. This is done via voice commands.
- Bluetooth® Streaming - Once your device is paired to the FUSE system, you can stream music from your device through the FUSE system to your vehicles sound system. No wires or cords. Your music stops and restarts at the same song when you exit and when you re-enter the vehicle. Voice commands are not available.

**Q: Why can't I control the music track selection via voice commands while Bluetooth® streaming?**

A: The Mitsubishi system uses AVRCP 1.3 (Audio/Video Remote Control Profile) which does support song information (title, artist, track, etc.). However, you must have a device that also supports AVRCP 1.3 to supply that information to the Mitsubishi system.

**Q: My Outlander is equipped with "Micron Air Filtration". Where is the filter located and does it need servicing?**

A: The micron air filter is a small filter element which is located in the HVAC box just behind the lower glove box. The filter should be inspected frequently for debris. The filter works well at filtering incoming air however the filter will clog and lead to reduced outlet air volume if not serviced on a regular basis.

**Q: I am having trouble with my Power Liftgate working properly. Sometimes it works and sometimes it doesn't. Am I doing something wrong?**

A: First check the **ACTIVE/OFF** button located below the climate control unit and check to see that this button is set to **ACTIVE**. If so, then you will find that the system needs to have ALL the doors unlocked for the unit to work properly. If only the driver's door is unlocked, the power liftgate button will not work.

**Q: My Outlander has two 12V accessory outlets. What devices can be plugged into these outlets?**

A: Both of these outlets are protected with 15 amp fuses. Always check the current draw rating of any device prior to use in the vehicle. If the device is rated above 12 amps, this could lead to circuit overload and the electrical fuse opening (no current flow).

**Q: How can I get the MPG stated on the window sticker?**

A: Vehicle driving styles will greatly affect MPG. Avoid sudden abrupt starts from a stop and let the vehicle coast to the traffic light. Both of these styles will increase mileage and reduce brake lining wear.

- Vehicles are designed to achieve the best fuel mileage when they are driven at the speed limits on the freeway. Avoid driving over 65 mph.
- Under inflated tires will increase rolling resistance and will reduce fuel mileage. Check tire pressure frequently to increase miles per gallon. Proper tire pressure also ensures optimum tire performance (including tire wear.)

**Q: How does the Navigation System choose a certain route?**

A: The system takes into account traffic conditions, road types, distance and road width to recommend the route.

**Q: Why do my Rain Sensing Windshield Wipers operate on their own when it's not raining?**

- A:
- When the lever is in the AUTO position, the rain sensor detects rain or snow and automatically turns on the wipers.
  - The wipers may automatically operate when things such as insects or foreign objects are affixed to the windshield on top of the rain sensor or when the windshield is frosted over.
  - To stop the wipers, place the lever in the OFF position.

**Q: Why does my check engine light come on after I put gas in my car?**

A: There are many reasons why your check engine light may illuminate. Before calling your dealership, make sure the fuel cap is fully engaged and you have heard three clicks when tightening it. After checking and hearing three clicks and the light is still on, contact your dealership.

**Q: How do I use the emergency key when the F.A.S.T.-key battery or vehicle battery is run down?**

A: If your Outlander is equipped with a One Touch Start button and the door does not open, take the key out from the fob and unlock the door manually. Put the key back into the fob and insert it into the slot provided below the Climate Control Switches. Starting the engine and changing the operation mode should now be possible. Remove the F.A.S.T.-key from the key slot after starting the engine or changing the operation mode.

Product features and descriptions are subject to change without notice. Not all features listed are standard or available on all trim lines. For any product related questions, please consult your dealership or the actual Owner's Manual.



