

2017 KENTUCKY FRUIT AND VEGETABLE CONFERENCE

JANUARY 9-10, 2017
Monday and Tuesday



**KENTUCKY STATE
HORTICULTURAL
SOCIETY**

161st Annual Meeting

**KENTUCKY VEGETABLE
GROWERS ASSOCIATION**

46th Annual Meeting

**ORGANIC ASSOCIATION
OF KENTUCKY**

8th Annual Meeting

**KENTUCKY WINERIES
ASSOCIATION**

In cooperation with:
*University of Kentucky
College of Agriculture, Food, and Environment
Kentucky State University
and
Kentucky Department of Agriculture*

Meeting Place:
Embassy Suites Hotel
1801 Newtown Pike
Lexington, Kentucky 40511
(859) 455-5000
FAX (859) 455-5122
Reservations: 800-EMBASSY

Conference Notes

Conference Overview

Sunday, January 8

Pre-conference Sessions

Room

| | | |
|----------------|---|--------------|
| 1:30-5:00 p.m. | Plasticulture Strawberry Short Course | Coldstream 4 |
| 6:30-7:30 p.m. | Vegetable Round Table Discussion | Coldstream 4 |
| 7:30-8:30 p.m. | Tree & Small Fruit Round Table Discussion | Coldstream 4 |
| 5:00-9:00 p.m. | Exhibitor Set-up | |



Monday, January 9

Main Conference Sessions

| | | |
|------------|-------------------------------------|------------------|
| 8:00 a.m. | Exhibits and Registration Desk Open | |
| 8:50 a.m. | Concurrent Sessions | |
| | KSHS-KVGA Joint Session | Coldstream 3 |
| | Grape & Wine Short Course | Coldstream 4 |
| 10:30 a.m. | Break | |
| 12:10 p.m. | Exhibitor & Grower Luncheon | Coldstream 1 & 2 |
| 1:30 p.m. | Concurrent Sessions | |
| | Farmers' Markets | Coldstream 1 & 2 |
| | Vegetable Production | Coldstream 3 |
| | Grape & Wine Short Course | Coldstream 4 |
| | Tree Fruit Production | Coldstream 5 |
| | OAK Annual Meeting | Fayette |
| 2:30 p.m. | Break | |
| 5:00 p.m. | Exhibits Close | |
| 6:00 p.m. | Commissioner Cup Wine Tasting | Coldstream 1 & 2 |



Tuesday, January 10

| | | |
|------------|---|------------------|
| 8:00 a.m. | Exhibits Open | |
| 8:30 a.m. | Concurrent Sessions | |
| | Organic Production | Coldstream 1 & 2 |
| | Vegetable Production | Coldstream 3 |
| | Grape & Wine Short Course | Coldstream 4 |
| | Tree Fruit | Coldstream 5 |
| | Wholesale Marketing | Fayette |
| 10:00 a.m. | Break | |
| 11:45 a.m. | Conference Luncheon | Coldstream 1 & 2 |
| 1:30 p.m. | Concurrent Sessions | |
| | Food Safety | Coldstream 1 & 2 |
| | Greenhouse & High Tunnel Workshop | Coldstream 3 |
| | Grape & Wine Short Course | Coldstream 4 |
| | Small Fruit Production | Coldstream 5 |
| | What to Think About Before You Plant Workshop | Fayette |
| 2:30 p.m. | Break | |
| 3:00 p.m. | Exhibit Hall Closes | |

Dear Fruit and Vegetable Growers:

The 2017 Kentucky Fruit and Vegetable Conference and Trade Show will again be at the Embassy Suites Hotel, Lexington, KY, Monday and Tuesday, January 9 and 10, 2017. The conference will begin with a pre-conference Plasticulture Strawberry Short Course and Vegetable, Tree and Small Fruit Round Table Discussions. During the conference there will be sessions on Farmers' Markets, Commercial Fruit and Vegetable Production, Greenhouse and High Tunnel Production, Small Fruit Production, Organic Production, the Grape and Wine Short Course, Wholesale Marketing, Food Safety and a What to Think About Before You Plant workshop. We have many excellent out-of-state speakers this year including: Bradley Beam, Enology Specialist, Illinois Grape Growers and Vintners Association, Springfield, IL; Brad Bergefurd, Extension Horticulturist, The Ohio State University; Brenda and Keegan Hash, High Tunnel Growers, Hardinsburg, IN; Dr. David Lockwood, Extension Fruit Specialist, University of Tennessee, Knoxville, TN; Paul Mock, Mock's Greenhouse and Farm, Berkeley Springs WV; and Carl Sams, Fruit & Vegetable Teaching and Research, University of Tennessee, Knoxville, TN.

There will be an optional Commissioner Cup Wine Tasting Monday evening. We will also have Exhibitor/Grower and Conference Luncheons featuring Kentucky Proud products.

A Trading Post bulletin board will be available to sell used equipment. If you are looking for equipment buyers, bring along a description containing your name, phone number and the equipment price.

PLEASE make your room reservations directly with the hotel at **859-455-5000**. **Our block of rooms will be held until December 30th, 2016. After this, room prices will be higher.** Be sure to let the hotel know that you will be staying for the Kentucky Fruit and Vegetable Conference by calling 859-455-5000 to obtain our special suite room rate for a single or double (they are all suites) of \$119.95. If you are told that the block of rooms at our conference rate is full on or before Dec. 30, please call Amy Stamper at Embassy Suites (859-455-5109) only to increase the number of rooms that we have blocked. The room cost includes an evening managers' reception from 5:30 to 7:30 p.m. with drinks and a full cooked-to-order breakfast daily. We encourage growers to stay at Embassy Suites Hotel to help cover meeting overhead expenses. Note: If the hotel parking lot is full, meeting attendees may park along Aristides Street in front of the hotel.

The \$40 meeting registration fee includes a year's membership in the KVGGA, KSHS or OAK and entrance into the Grape & Wine Short Course.

The enclosed pre-registration form enables you to preregister so your tickets and name tag will be ready for you when you arrive at the meeting. NOTE: WE STRONGLY URGE YOU TO PRE-REGISTER. LUNCHEON TICKETS MAY NOT BE AVAILABLE AT THE REGISTRATION DESK. NAME BADGES WILL BE REQUIRED TO ENTER MEETING ROOMS. PRE-REGISTRATION FORMS NEED TO BE IN OUR HANDS BY FRIDAY DECEMBER 16, 2016. Phone registrations will not be accepted. Participants that do not pre-register may register at the door. If you would like to serve on the KVGGA or KSHS boards of directors or would like to nominate another member, please designate this on your registration sheet.

If circumstances are such that you cannot attend the meeting, and you would like to remain a member of the KVGGA, KSHS, or OAK, please complete and return the form with a check to Ms. Mary Ann Kelley, Research & Education Center, P.O. Box 469, Princeton, KY 42445 to continue your association membership.

Sincerely,

Joel Wilson, President
KY Vegetable Growers Association

Dana Reed, President
KY State Horticultural Society

**KENTUCKY STATE HORTICULTURAL
SOCIETY OFFICERS**

President: Dana Reed, Paris
Vice-President: Matt Gajdzik, Shelbyville
Secretary: Doug Archbold, Lexington
Treasurer: Amanda Gajdzik, Shelbyville
Directors: Maurice Fegenbush, Bloomfield
Larry Ayres, Owenton
Jonathan Price, Bowling Green
Katie Reid Clark, Owensboro
George Deutsch, Taylorsville
Don Haney, Nancy
Terry Creech, Cumberland
Kevan Evans, Georgetown
Dwight Greenwell, Louisville

Advisors: Jeremy Hinton, Hodgenville
Kirk Pomper, Frankfort
John Strang, Lexington
Shawn Wright, Jackson

**KENTUCKY VEGETABLE GROWERS
ASSOCIATION OFFICERS**

President: Joel Wilson, Nancy
Vice-President: Kirby Overman, Lancaster
Secretary: Annette Meyer-Heisdorffer,
Owensboro
Treasurer: Ron McMaine, Salvisa
Directors: Zeldon Angel, Winchester
John Bell, Georgetown
Butch Case, Cynthiana
Sandi Deutsch, Taylorsville
Sarah Fannin, West Liberty
Josh Lindau, Frankfort
David Neville, Campbellsburg
Brad Reid, Owensboro
Jacob Sharpe, Georgetown
Robert Stone, Paris
Beth Wilson, Nancy

Advisors: Shubin Saha, Lexington
John Strang, Lexington
Shawn Wright, Jackson

**ORGANIC ASSOCIATION OF
KENTUCKY OFFICERS**

President: Mac Stone, Georgetown
Vice-President: Larry Brandenburg, Shelbyville
Executive
Director: Delia Scott, Lexington
Treasurer: John Bell, Georgetown
Directors: Rhona Kamar, Fisherville
Dave Koester, Alexandria
Ford Waterstrat, London
Ashton Potter Wright, Lexington
Cindy Youngblood, Prospect

Advisors: Sean Clark, Berea
Sarah Fritschner, Louisville
Irvin Ramer, Elkton
Jake Schmitz, Frankfort
Tony Silvernail, Frankfort
Adam Watson, Frankfort
Mark Williams, Lexington

**KENTUCKY WINERIES ASSOCIATION
OFFICERS**

President: Brance Gould, Shepherdsville
Vice-President: Allen Dossey, Paducah
Secretary: Francine Sloan, Lawrenceburg
Treasurer: Logan Leet, Louisville
Directors: Tom Beall, Nicholasville
Shanna Osborne, Owenton

All Times Are Eastern Standard Time

PRE-CONFERENCE SESSIONS

SUNDAY AFTERNOON, JANUARY 8

1:30-5:00 p.m. PLASTICULTURE STRAWBERRY SHORT COURSE

Coldstream 4 Room
Shawn Wright, Presiding

- 1:30 p.m. The Basics of Plasticulture Strawberry Production – Brad Bergefurd
- 2:00 p.m. Continued
- 2:30 p.m. Break
- 3:10 p.m. High Tunnel Strawberry Production in Eastern Kentucky – Shawn Wright
- 3:40 p.m. How to Make A Spray Schedule – Nicole Gauthier & Ric Bessin
- 4:10 p.m. Kentucky Strawberry Assoc. Meeting and Round Table Discussion
– Henry Cardwell

6:30-7:30 p.m. VEGETABLE ROUND TABLE DISCUSSION

Coldstream 4 Room
Shubin Saha, Presiding

7:30-8:30 p.m. TREE & SMALL FRUIT ROUND TABLE DISCUSSION

Coldstream 4 Room
John Strang, Presiding

5:00-9:00 p.m. Exhibitor Set-up

Pre-Function Area & Lower Atrium



Literature Table

Nourse Farms, Inc.
41 River Road
South Deerfield, MA 01373
phone: 413-665-2658
e-mail: info@noursefarms.com

Stokes Seeds Inc.
13265 Howe Rd.
Fishers, IN 46038
phone: 317-409-3445
e-mail: kwagner@stokeseeds.com

GFG Ag Services, LLC
606 W 4th St.
Stanbury, MO 64489
Phone: 660-783-0006
e-mail: bryan.wright@gfgagservices.com

MONDAY, JANUARY 9

8:00 a.m. Exhibits Open, Pre-Function & Lower Atrium Areas
 Registration, Pre-Function area outside meeting rooms
 Meeting registration is \$40.00. Please see the registration form for association memberships.



| (1) KSHS-KVGA JOINT SESSION | (2) GRAPE & WINE SHORT COURSE | (3) ORGANIC ASSOCIATION OF KENTUCKY ANNUAL MEETING |
|--|--|---|
| <i>Coldstream 3 Room</i> <i>Robert Stone, Presiding</i> | <i>Coldstream 4</i> <i>Branche Gould, Presiding</i> | <i>Fayette Room</i> <i>Mac Stone, Presiding</i> |
| 8:45 a.m. Welcome – Joel Wilson | 8:50 a.m. Welcome – Branche Gould | |
| 8:55 a.m. Horticulture Department Update – Bob Houtz | | |
| 9:00 a.m. Horticulture Council Update – Mac Stone | 9:00 a.m. Craft Beer Narratives – Jeff Rice | |
| 9:15 a.m. Kentucky State University Update – Kirk Pomper | | |
| 9:30 a.m. Kentucky Department of Agriculture Update – Commissioner of Agriculture, Ryan Quarles | 9:30 a.m. Subconscious & Conscious Marketing through Bottle Shape and Label – Tyler Madison | |
| 9:40 a.m. Growing and Marketing Vegetables for 12 Months – Nathan and Michelle Howell | | |
| 10:05 a.m. Greenhouse/High Tunnel Hydroponic Pesticide Free Vegetable, Berry and Herb Production in WV – Paul Mock | 10:00 a.m. How Glass Bottles are Made – Bill Stiles | |
| 10:40 a.m. Cider/Coffee Break and Visit Exhibits Pre-Function and Lower Atrium Areas | 10:30 a.m. Cider/Coffee Break and Visit Exhibits – Pre-Function and Lower Atrium Areas | |
| 11:10 a.m. New Technologies: Drones, Sat Maps & Field Mapping – Jeremy Sandifer | 11:00 a.m. Addressing Common Wine Flaws and Faults – Bradley Beam | 11:00 a.m. Organic Association of Kentucky Annual Meeting |
| 11:40 a.m. Produce Safety Certificates – Josh Lindau | 11:30 a.m. Continued | |
| 11:50 a.m. Farm Service Agency Update – Gidget Cropper | | |



12:00 p.m. **EXHIBITORS AND GROWERS LUNCHEON** - Coldstream 1 & 2 Rooms

12:00 p.m. **KVGA, KSHS, KWA BOARD MEETINGS**
 KSHA and KVGA board members should pick up their lunch at the buffet outside of Coldstream 1 & 2
 and then meet in the designated room at the top of the hotel lobby stairs located
 over the meeting rooms.
Kentucky State Horticultural Society - Paris Room
Kentucky Vegetable Growers Association- Georgetown Room
Kentucky Wineries Association - Fayette Room

MONDAY AFTERNOON, JANUARY 9

4 CONCURRENT SESSIONS

Concurrent sessions will enable participants to attend topics of interest in different sessions

.....

(4) FARMERS' MARKETS

*Coldstream 1 & 2 Rooms
Sharon Spencer, Presiding*

(5) VEGETABLE PRODUCTION

*Coldstream 3 Room
Ty Cato, Presiding*

- 1:30 p.m. Farmers Market for the Health of It
– Valerie Ison Horn
- 2:00 p.m. Food Sampling at the Farmers' Market
– Sharon Spencer and Tim Woods
- 2:30 p.m. Cider/Coffee Break and Visit Exhibits
– Pre-Function and Lower Atrium Areas
- 3:10 p.m. Nutritional Programs Update
– Beverly Salchli and Tina Garland
- 3:40 p.m. CFA's 2016 Farmers' Market Support
Program and What to Expect in 2017
– James Cochran and Martin Richards
- 4:10 p.m. Selling Flowers at the Farmers Market
– Elizabeth Montgomery

- 1:30 p.m. Growing Giant Pumpkins and
Watermelons – Frank Mudd
- 2:00 p.m. Vegetable Grafting – Carl Sams
- 2:30 p.m. Cider/Coffee Break and Visit Exhibits
– Pre-Function and Lower Atrium
Areas
- 3:10 p.m. Vegetable Cultivar Trial Results (Fall
Broccoli, Supersweet Corn,
Muskmelon and Watermelon)
– Daniel Becker, Shubin Saha,
John Walsh and Chris Smigell
- 4:10 p.m. How Much is Too Much Phosphorus
– Brad Lee
- 4:40 p.m. Marketing Your Business with Excel
Farm – E. Paulette Akers and
Emily Ohde

MONDAY AFTERNOON, JANUARY 9

.....
(6) GRAPE AND WINE SHORT COURSE

*Coldstream 4 Room
Jeff Wheeler, Presiding*

- 1:30 p.m. Hard Cider Production Method Basics
– Jeff Wheeler
- 2:00 p.m. Cryoextraction of Apples for Hard
Cider Production – Nancy Savage
- 2:30 p.m. Cider/Coffee Break and Visit Exhibits
– Pre-Function and Lower Atrium
Areas
- 3:10 p.m. Tasting of Hard Ciders Produced at
UKHRF – Jeff Wheeler
- 3:40 p.m. Producing Award Winning Kentucky
Wines – Roundtable Discussion with
Commissioner’s Cup Award Winners
- 4:10 p.m. Continued
- 4:40 p.m. KY Wine Industry Update

(7) TREE FRUIT PRODUCTION

*Coldstream 5 Room
Amanda Sears, Presiding*

- 1:30 p.m. Antibiotic Resistance
– Nicole Gauthier
- 2:00 p.m. The Managed Pollinator Protection Plan
for Kentucky – Tammy Horn
- 2:30 p.m. Cider/Coffee Break and Visit Exhibits
–Pre-Function and Lower Atrium Areas
- 3:10 p.m. Apple Fruit Rots – Nicole Gauthier
- 3:40 p.m. Biofumigation in Strawberries and Tree
Fruit – Carl Sams
- 4:10 p.m. Fruit Abiotic Disorders – John Strang
- 4:40 p.m. Horticulture in Transylvania
– Chris Smigell

.....
MONDAY EVENING, JANUARY 9

5:00 p.m. **Exhibits Close**

6:00-7:30 p.m. **COMMISSIONER CUP WINE TASTING**

“A Toast to the Gold Medal Winners” - *Coldstream 1 & 2 Rooms*

The cost is \$20.00 for the event including souvenir glass and light refreshments. Featuring 2016
Commissioner’s Cup Award Winning Wines

TUESDAY MORNING, JANUARY 10

8:00 a.m. Exhibits Open, Pre-Function and Lower Atrium Areas
Registration, Pre-Function Area outside meeting rooms

5 CONCURRENT SESSIONS

Concurrent sessions will enable participants to attend topics of interest in different sessions.

(8) ORGANIC PRODUCTION

Coldstream 1 & 2 Rooms

Delia Scott, Presiding

8:30 a.m. OAK Transition Trainers Program
– Delia Scott, Tony Silvernail, Andrew Oles,
and Corina Common

9:00 a.m. Growing Organic Blueberries – Jeff Essig

9:30 a.m. Organic Soil Management – Steve Diver

10:00 a.m. Cider/Coffee Break and Visit Exhibits
– Pre-Function and Lower Atrium Areas

10:40 a.m. Organic Production in Nepal
– Debendra Shrestha

11:45 a.m. **CONFERENCE LUNCHEON** -- *Coldstream 1 & 2 Rooms*

12:00 noon

KENTUCKY GRAPE AND WINE COUNCIL BOARD MEETING

Board members should pick up their lunch at the buffet outside of Coldstream 1 & 2 and then meet in the Paris room at the top of the stairs located over the meeting rooms.

TUESDAY AFTERNOON, JANUARY 10

(13) FOOD SAFETY

Coldstream 1 & 2 Rooms

Faye Kuosman, Presiding

1:30 p.m. Produce Safety Programs
– Paul Vijayakumar

2:00 p.m. Food Systems Innovation Center
– Melissa Newman

2:30 p.m. Cider/Coffee Break and Visit Exhibits
– Pre-Function and Lower Atrium Areas

3:10 p.m. GAP, FSMA, Produce Safety Certificates,
OH MY! – Adam Watson and
Josh Lindau

3:40 p.m. Third Party Audits: A USDA GAP Auditor
Perspective – DJ DeSantis

4:10 p.m. Panel Discussion – Paul Vijayakumar,
Melissa Newman, Adam Watson, Josh
Lindau, DJ DeSantis, and Bryan Brady

(9) VEGETABLE PRODUCTION

Coldstream 3 Room

David Davis, Presiding

8:30 a.m. KVGA Annual Business Meeting, Produce
Auction Needs & Food Safety
– Lloyd Schrock

9:00 a.m. New Vegetable Grower Experiences
– Bryan Glover, James Williamson, and
Brent Cornett

9:30 a.m. Pumpkin Varieties and the Southern Ohio
Pumpkin Growers Cooperative
– Brad Bergefurd

10:00 a.m. Cider/Coffee Break and Visit Exhibits
– Pre-Function and Lower Atrium Areas

10:40 a.m. Deer, Raccoon and Coyote Control
– Matt Springer

11:10 a.m. Downy Mildew on Cucurbits – Emily Pfeufer

(14) GREENHOUSE AND HIGH TUNNEL PRODUCTION

Coldstream 3 Room

Jeff Casada, Presiding

1:30 p.m. Grower Experiences with High Tunnels
– Brenda and Keegan Hash

2:00 p.m. Converting to Soilless Culture to Solve
Problems – Shubin Saha

2:30 p.m. Cider/Coffee Break and Visit Exhibits
– Pre-Function and Lower Atrium
Areas

3:10 p.m. Biological Control of Arthropod Pests in
Greenhouses and High Tunnels
– John Obrycki

3:40 p.m. Aquaponics Potential – Janelle Hager

5 CONCURRENT SESSIONS

Concurrent sessions will enable participants to attend topics of interest in different sessions.

**(10) GRAPE & WINE
SHORT COURSE**

*Coldstream 4 Room
Nancy Savage, Presiding*

- 9:00 a.m. Developing an Effective Vineyard Pest Spray Program – Ric Bessin
- 9:30 a.m. Continued
- 10:00 a.m. Cider/Coffee Break and Visit Exhibits – Pre-Function and Lower Atrium Areas
- 10:40 a.m. Effective Spray Programs for Multiple Cultivar Plantings – Nicole Gauthier
- 11:10 a.m. Identifying Understanding, and Preventing Late Season Bunch Rots – Nicole Gauthier

(11) TREE FRUIT

*Coldstream 5 Room
Sarah Stolz, Presiding*

- 8:30 a.m. Strategies for Designing Spray Programs for Peaches – Ric Bessin, Nicole Gauthier, and John Strang
- 9:00 a.m. Controlling Problem Orchard Weeds – Shawn Wright
- 9:30 a.m. The Intelligent Sprayer and Saving on Pesticide Costs – Dave Lockwood
- 10:00 a.m. Cider/Coffee Break and Visit Exhibits – Pre-Function and Lower Atrium Areas
- 10:40 a.m. Pawpaw Production – Kirk Pomper
- 11:10 a.m. KSHS Annual Business Meeting

**(12) WHOLESALE
MARKETING**

*Fayette Room
Roger Snell, Presiding*

- 8:30 a.m. Meet the Buyers: What Supermarket, Retail, and Wholesale Buyers are Looking for in 2017. Informal meetings between producers, wholesalers and restaurateurs.
- 9:00 a.m. Continued
- 9:30 a.m. Continued
- 10:00 a.m. Cider/Coffee Break and Visit Exhibits– Pre-Function and Lower Atrium Areas
- 10:40 a.m. Farm Food Safety: Low Cost Solutions and On-farm Assistance – Bryan Brady

TUESDAY AFTERNOON, JANUARY 10

**(15) GRAPE AND WINE
SHORT COURSE**

*Coldstream 4 Room
Bruce Kunze, Presiding*

- 1:30 p.m. Maintaining Productivity of Mature Vineyards – Dave Lockwood
- 2:00 p.m. Improving Early Productivity: Vine Establishment – Sean Lynch
- 2:30 p.m. Cider/Coffee Break and Visit Exhibits – Pre-Function and Lower Atrium Areas
- 3:10 p.m. State of the Industry – Tyler Madison, Brance Gould and Roger Leasor
- 3:40 p.m. Roundtable Grower Discussion – Bruce Kunze
- 4:10 p.m. Continued

**(16) SMALL FRUIT
PRODUCTION**

*Coldstream 5 Room
Sharon Flynt, Presiding*

- 1:30 p.m. Small Fruit Farm-to-School Marketing - Tina Garland
- 2:00 p.m. Roadside Signs, Research: What Works the Best – Alex Butler
- 2:30 p.m. Cider/Coffee Break and Visit Exhibits – Pre-Function and Lower Atrium Areas
- 3:10 p.m. Blueberry Potting Media – Winston Dunwell
- 3:40 p.m. Primocane Fruiting Blackberry Production – Jeremy Lowe
- 4:10 p.m. Matted Row Strawberry Production and Variety Trial Results – John Strang

**(17) CENTER FOR CROP
DIVERSIFICATION
WORKSHOP**

*Fayette Room
Brett Wolff, Presiding*

- 1:30 p.m. What To Think About Before You Plant – Tim Woods
- 2:30 p.m. Cider/Coffee Break and Visit Exhibits – Pre-Function and Lower Atrium Areas
- 3:10 p.m. Continued – Grower/Buyer Panel
- 4:40 p.m. Adjourn

All Times Are Eastern Standard Time

SPEAKERS 2017

E. Paulette Akers, Director, Division of Compliance Assistance, Frankfort, KY

Bradley Beam, Enology Specialist, Illinois Grape Growers and Vintners Association, Springfield, IL

Daniel Becker, Small Fruit and Vegetable Extension Associate, UKREC, Princeton, KY

Brad Bergefurd, Extension Horticulturist, Ohio State University Extension, Scioto County, Portsmouth, OH

Dr. Ric Bessin, Extension Entomologist, Department of Entomology, University of Kentucky, Lexington, KY

Bryan Brady, Ag Extension Senior Associate, The Food Connection, University of Kentucky, Lexington, KY

Alex Butler, Extension Associate, Department of Agricultural Economics, University of Kentucky, Lexington, KY

Henry Cardwell, Grower, Russell Springs, KY

Ty Cato, Vegetable Crops Extension Associate, Department of Horticulture, University of Kentucky, Shelbyville, KY

Jeff Casada, Clay County Extension Agent for Agriculture and Natural Resources, Manchester, KY

Christy Cassady, Extension Specialist, Center for Crop Diversification, Department of Horticulture, University of Kentucky, Lexington, KY

James Cochran, Farmers Market Support Program Manager, Community Farm Alliance, Berea, KY

Corina Common, Grower, Summer Shade, KY

Brent Cornett, Grower, London, KY

Gidget Cropper, Program Specialist, Farm Service Agency, Lexington, KY

David Davis, Clark County Extension Agent for Agriculture and Natural Resources, Winchester, KY

Daleria (DJ) DeSantis, Tennessee USDA GAP Auditor, Glasgow, KY

Steve Diver, Horticultural Research Farm Manager, Department of Horticulture, University of Kentucky, Lexington, KY

Dr. Winston Dunwell, Extension Nursery Crop Specialist, UKREC, Princeton, KY

Jeff Essig, Bluegrass Blueberries, Bowling Green, KY

Sharon Flynt, Scott County Extension Agent for Horticulture, Georgetown, KY

Tina Garland, Program Coordinator, Kentucky Department of Agriculture, Mt Sterling, KY

Dr. Nicole Gauthier, Extension Plant Pathologist, Department of Plant Pathology, University of Kentucky, Lexington, KY

Bryan Glover, Grower, Pleasureville, KY

Brance Gould, President, Kentucky Wineries Association, Forest Edge Winery, Shepherdsville, KY

Brenda and Keegan Hash, Growers, Hardinsburg, IN

Janelle Hager, Research Assistant, Kentucky State University, Division of Aquaculture, Aquaculture Research Ctr., Frankfort, KY

Dr. Tammy Horn, KY State Apiarist, KY Department of Agriculture, Frankfort, KY

Valerie Ison Horn, Community Farm Alliance, Whitesburg, KY

Dr. Bob Houtz, Chair, Department of Horticulture, University of Kentucky, Lexington, KY

Nathan and Michelle Howell, Growers, Scottsville, KY

Faye Kuosman, Woodford County Extension Agent for Horticulture, Versailles, KY

Bruce Kunze, Grower, Browns Valley Vineyard, Utica, KY

Roger Leasor, President, Kentucky Grape and Wine Council, Lexington, KY

Dr. Brad Lee, Extension Water Quality Specialist, Department of Plant and Soil Sciences, University of Kentucky, Lexington, KY

Joshua Lindau, Ag Marketing & Agribusiness Recruitment, Kentucky Department of Agriculture, Frankfort, KY

Dr. Dave Lockwood, Extension Fruit Specialist, Plant Sciences, University of Tennessee, Knoxville, TN

Jeremy Lowe, Co-Investigator of Horticulture, Kentucky State University, Frankfort, KY

Sean Lynch, U.K. Research Farm Technician, Department of Horticulture, University of Kentucky, Lexington, KY

Tyler Madison, Grape and Wine Marketing Specialist, Kentucky Department of Agriculture, Frankfort, KY

Paul Mock, Mock's Greenhouse and Farm, Berkeley Springs, WV

Elizabeth Montgomery, Three Toads Farm, Winchester, KY

Frank Mudd, Grower, Vine Grove, KY

Dr. Melissa Newman, Animal Nutritionist and Food Microbiologist, Department of Animal and Food Sciences, University of Kentucky, Lexington, KY

Emily Ohde, Compliance Assistance Branch Manager, Frankfort, KY

SPEAKERS 2017

Andrew Oles, Organic Farming
Coordinator, Berea College, Berea, KY

Dr. John Obrycki, Research
Entomologist, Department of
Entomology, University of Kentucky,
Lexington, KY

Dr. Emily Pfeufer, Extension Plant
Pathologist, Department of Plant
Pathology, University of Kentucky,
Lexington, KY

Dr. Kirk Pomper, Director-KSU
Agricultural Experiment Station,
College of Agriculture, Food Science
and Sustainable Systems, Kentucky
State University, Frankfort, KY

Ryan Quarles, Agriculture
Commissioner, Kentucky Department
of Agriculture, Frankfort, KY

Dana Reed, President, Kentucky State
Horticultural Society, Grower, Reed
Valley Orchard, Paris, KY

Dr. Jeff Rice, Professor and Chair,
Department of Writing, Rhetoric and
Digital Studies University of Kentucky,
Lexington, KY

Martin Richards, Executive Director,
Community Farm Alliance, Berea, KY

Nancy Savage, Research Analyst,
Department of Horticulture, University
of Kentucky, Lexington, KY

Dr. Shubin K. Saha, Extension
Vegetable and Protected Agriculture
Specialist, Department of Horticulture,
University of Kentucky, Lexington, KY

Beverly Salchli, Procedures
Development Coordinator, Department
of Public Health, Nutrition Services
Branch, Frankfort, KY

Dr. Jeremy Sandifer, Science,
Technology, Engineering, and
Mathematics Coordinator, Kentucky
State University, Frankfort, KY

Dr. Carl Sams, Teaching and Research,
Plant Sciences, University of Tennessee,
Knoxville, TN

Lloyd Schrock, Lincoln County
Produce Auction Manager, Crab
Orchard, KY

Delia Scott, Executive Director,
Organic Association of Kentucky,
Lexington, KY

Amanda Sears, Madison County
Extension Agent for Horticulture,
Richmond, KY

Debendra Shrestha, Ph.D Graduate
Student, Department of Horticulture,
University of Kentucky, Lexington, KY

Tony Silvernail, Grower, Beyond the
Bridge, Frankfort, KY

Chris Smigell, Small Fruit and
Vegetable Extension Associate,
Department of Horticulture, University
of Kentucky, Lexington, KY

Roger Snell, Farm to Retail Liaison,
Office of Ag Marketing & Product
Promotion, Kentucky Department of
Agriculture, Frankfort, KY

Sharon Spencer, Farmers' Market
Marketing Specialist, Kentucky
Department of Agriculture, Frankfort,
KY

Dr. Matt Springer, Extension Wildlife
Management Specialist, Department
of Forestry, University of Kentucky,
Lexington, KY

Bill Stiles, Christianburg Farms and
Winery, Shelbyville, KY

Sarah Stolz, Campbell County
Extension Agent for Horticulture,
Highland Heights, KY

Mac Stone, Executive Director,
Kentucky Horticultural Council,
President Organic Association of
Kentucky, Grower, Georgetown, KY

Dr. John Strang, Extension Fruit and
Vegetable Specialist, Department of
Horticulture, University of Kentucky,
Lexington, KY

Dr. Paul Vijayakumar, Extension Food
Science Specialist, Department of
Animal and Food Sciences, University
of Kentucky, Lexington, KY

John Walsh, Research Farm Technician
III, Department of Horticulture,
University of Kentucky, Lexington, KY

Adam Watson, Organic Program
Manager, Industrial Hemp Program
Coordinator, Kentucky Department of
Agriculture, Frankfort, KY

Jeff Wheeler, Extension Enology
Specialist, Department of Horticulture,
University of Kentucky, Lexington, KY

James Williamson, Grower, Shelbyville,
KY

Joel Wilson, President, Kentucky
Vegetable Growers Association, Grower,
Nancy, KY

Brett Wolff, Senior Extension
Associate, Center for Crop
Diversification and UK SARE Program,
Department of Agricultural Economics,
University of Kentucky, Lexington, KY

Dr. Tim Woods, Agricultural
Economics Extension Specialist,
Department of Agricultural Economics,
University of Kentucky, Lexington, KY

Dr. Shawn Wright, Extension
Horticulture Specialist, Department of
Horticulture, University of Kentucky,
Robinson Center for Appalachian
Resource Sustainability, Jackson, KY

EXHIBITORS 2017

All American Containers
206 Finley Rd.
Belle Vernon, PA 15012
phone: 315-585-6045
e-mail: rparmelee@allamericancontainers.com

Arton Products
Attn: Lisa Roman
P.O. BOX 340
Lively, VA 22507
phone: 804-462-5800
email: lroman@artonproducts.com

Berger Peat Moss
1941 Saint Gregory's Court
Knoxville, TN 37931
phone: 865-312-2258
e-mail: adaml@berger.ca

Center for Crop Diversification
University of Kentucky
N-318 Ag. Science Center North
Lexington, KY 40546-0091
phone: 859-257-1477 or
859-218-4384
e-mail: cgcass0@uky.edu
email: brett.wolff@uky.edu

Central Kentucky Ag. Credit
640 S. Broadway
Lexington, KY 40508
phone: 859-253-3249
e-mail: cbrock@iglou.com

Clifton Seed Company
P.O. Box 206
Faison, NC 28341
phone: 910-267-2690
e-mail: chrisc@cliftonseed.com

Continental Industries
P.O. Box 865
Shepherdsville, KY 40165
phone: 502-543-2600
email: jchamilton@windstream.net

Crop Production Services
6803 N. Henderson Ford Rd.
Mooreville, IN 46158
phone: 317-831-2559
e-mail: johnphillips@uap.com

Daisy Farms
28355 M-152
Dowagiac, MI 49047
phone: 269-782-6321
e-mail: daisyfarms@qtm.net

Deerfield Supplies
2825 Stringtown Rd.
Elkton, KY 42220
phone: 270-265-2425

Dillman Farm, Inc.
4955 West State Road 45
Bloomington, IN 47403
phone: 812-825-5525
e-mail: carydillman@dillmanfarm.com

Entomology Solutions
1701 Deer Lane
Louisville, KY 40205
phone: 502-384-8953
e-mail: blair@bugsbehavingbadly.com

Fairview Produce Auction
10292 US Hwy 68E
Pembroke, KY 42266
phone: 270-887-0053

Fresh Start Grower Supply
1007 East Jefferson St.
Louisville, KY 40206
phone: 502-442-7883
e-mail: steve@freshstartgrowers.com

Glacier Valley Ent., LLC
600 South Blvd.
Baraboo, WI 53913-2866
phone: 608-356-2244
e-mail: sales@glacierv.com

Glean KY/Faith Feeds of KY Inc.
P.O. Box 4448
Lexington, KY 40544
phone: 859-444-4769
e-mail: stephanie@gleanky.org

Governor's Office of Ag. Policy
404 Ann Street
Frankfort, KY 40601
phone: 502-564-4627
e-mail: emily.milam@ky.gov

H & H Farm Machine Co., Inc.
7916 Unionville-Brief Rd.
Monroe, NC 28110
phone: 704-753-4919
e-mail: dave.teague@hhspray.com

Harvest Energy Solutions
2218 E. High St.
Jackson, MI 49203
Phone: 517-788-8800
e-mail: chartung@harvestenergysolutions.com

Indiana Berry & Plant Co.
2811 Michigan Rd.
Plymouth, IN 46563
phone: 574-784-2905
e-mail: sales@superbhorticulture.com

Innovative Labels
4000 Hamilton-Middletown Rd.
Hamilton, Ohio 45011
phone: 888-860-2457, ext. 1292
e-mail: ottknop@ILSlabels.com

Kentucky Department of Agriculture
Office of Marketing
111 Corporate Drive
Frankfort, KY 40601
phone: 502-782-4115
e-mail: Joshua.Lindau@ky.gov

Kentucky Farm Bureau Roadside Farm Market Program
P.O. Box 20700
Louisville, KY 40250
phone: 502-495-5000
e-mail: fran.mccall@kyfb.com

Kentucky Irrigation Co.
605 Blue Sky Parkway
Lexington, KY 40509
phone: 859-254-7022
e-mail: bob@kentuckyirrigation.com

Kentucky State University Fruit and Vegetable Mobile Processing Initiative
129 Atwood Research Facility
Kentucky State University
Frankfort, KY 40601
phone: 502-597-5942
e-mail: kirk.pomper@ky.edu

Kentucky Women in Agriculture, Inc.
P.O. Box 4409
Lexington, KY 40544
phone: 270-293-8151
e-mail: sfurches@mchsi.com

Lewis Seed Co.
130 N. Spring St.
Louisville, KY 40206
phone: 502-386-8335
e-mail: steve.lewisseed@gmail.com

Lincoln County Produce Auction
450 Al Wyler Rd.
Crab Orchard, KY 40419
phone: 606-355-0030

Midwest Vineyard Supply
2300 South Twin Bridge Road
Decatur, IL 62521
phone: 217-864-9896
e-mail: sales@midwestvineyardsupply.com

Miller Chemical & Fertilizer Corp.
P.O. Box 333
Hanover, PA 17331
phone: 717-632-8921
e-mail: jshannon845@gmail.com

ML Irrigation
226 Shady Lane
Midway, KY 40347
phone: 859-229-3096
e-mail: rmcniel@highlandmoor.com

Monte Package Company
P.O. Box 128
Riverside, MI 49084
phone: 800-653-2807
e-mail: MikeV@montepkg.com

Rockford Package Supply
10421 Northland Dr.
Rockford, MI 49341
phone: 800-444-7225
e-mail: tpaulson@rockfordpack.com

Rupp Seeds Inc.
17919 County Road B
Wauseon, OH 43567
phone: 1-800-700-1199
e-mail: info@ruppseeds.com

Scott Laboratories
P.O. Box 4559
Petaluma, CA 94955
phone: 707-765-6666
e-mail: michelles@scottlab.com

Seedway, LLC
7520 Ruggles Ferry Pike
Knoxville, TN 37924
phone: 865-548-7333
e-mail: kbhosey@gmail.com

Siegers Seed Company
13031 Reflections Dr.
Holland, MI 49424
phone: 731-431-6730
e-mail: jim_elam@siegers.com

Southern FS
200 Jamestown Rd.
Cobden, IL 62920
phone: 618-322-7027 or 618-893-4852
e-mail: applejam1@charter.net
agunther@southernfs.com

Stand 'n Plant
95 Rose Rd.
Saltsburg, PA 15681
phone: 724-448-8689
e-mail: franalope@yahoo.com

Sun Sugar Farms
1258 Maddox Lane
Verona, KY 41092
Phone: 888-883-7259 or 859-493-0331
e-mail: linda@sunsugarfarms.com

USDA Farm Service Agency
771 Corporate Drive
Lexington, KY 40503
phone: 859-224-7624
e-mail: Winnie.breeding@ky.usda.gov

USDA National Agricultural Statistics Service
P.O. Box 1120
Louisville, KY 40201
phone: 502-582-5293
e-mail: david.knopf@nass.usda.gov

Waters Agricultural Laboratories, Inc.
2101 Calhoun Rd., Hwy 81
Owensboro, KY 42301
phone: 270-685-4039
e-mail: jeff@watersag.com

Westfall Company, Inc.
124 Workman Court
Eureka, MO 63025
phone: 636-938-3113
e-mail: awestfall@westfallcompany.com

Wright Graphics
5115 Prospect St.
Thomasville, NC 27361
phone: 336-472-4200
e-mail: heatherb@wrightglobalgraphics.com

Waldo & Associates, Inc./ Premium Horticultural Supply Co.
28214 Glenwood Rd.
Pettysburg, OH 43551
phone: 1-800-468-4011 x 104
e-mail: richard.weis@waldoinc.com

Webb & Associates
2035 Matthes Dr.
Mansfield, OH 44906
Phone: 740-504-8931
e-mail: webbandassociates1@gmail.com

2nd Floor

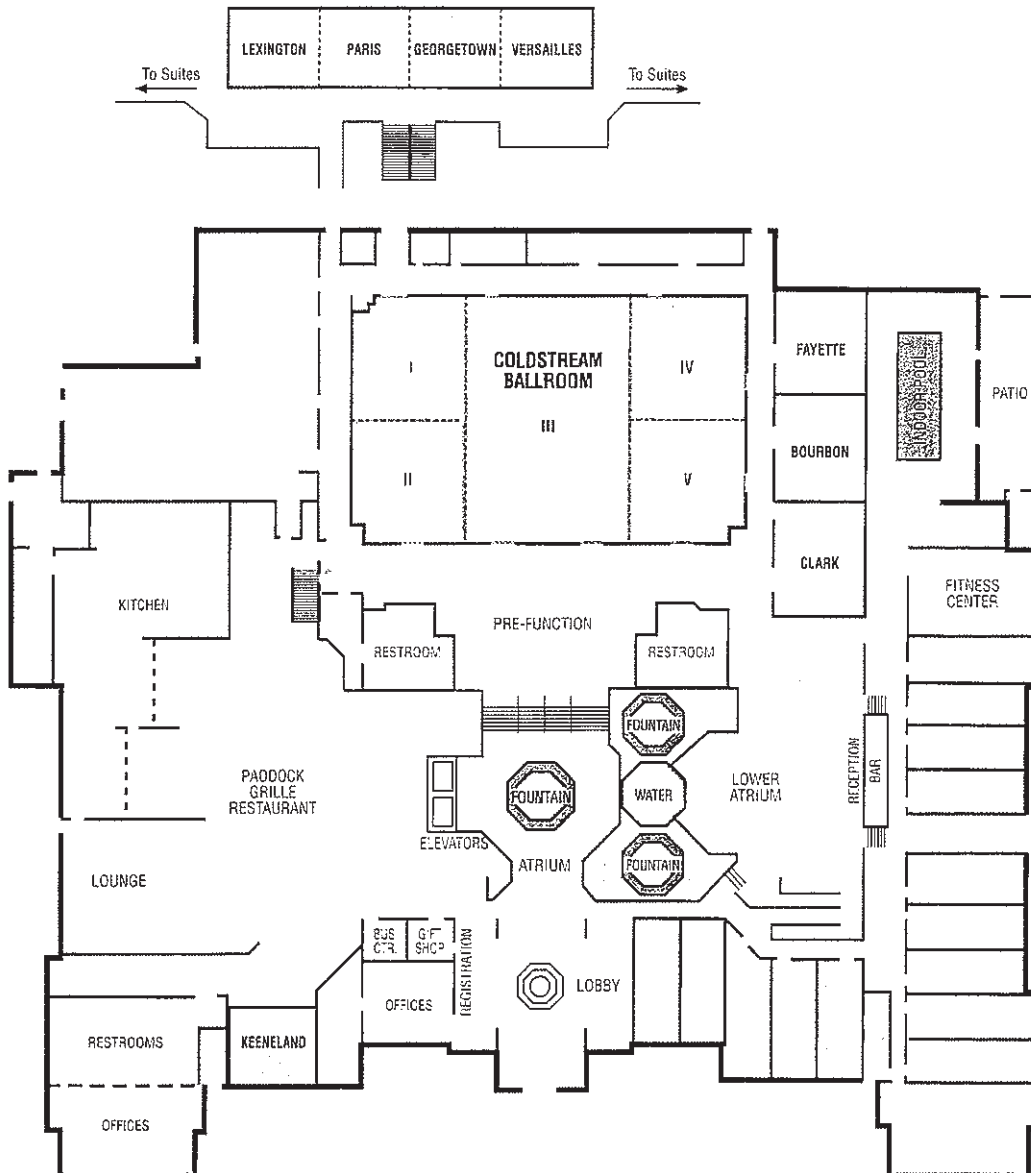

Kentucky State Horticultural Society
UK Research & Education Center
P.O. Box 469
Princeton KY 42445-0469

DIRECTIONS

From I-75/64: Take Exit 115 then right on to Newtown Pike. Turn right onto Aristides Blvd. at the UK Coldstream Research Campus. Hotel is on the right.
From Blue Grass Airport: Exit left on to Man O'War Blvd. to Versailles Rd. Turn right onto Versailles Rd. Take Rt. 4 New Circle Rd. north to Newtown Pike Exit North. Turn left onto Aristides Blvd. at the UK Coldstream Research Campus. Hotel is on the right.

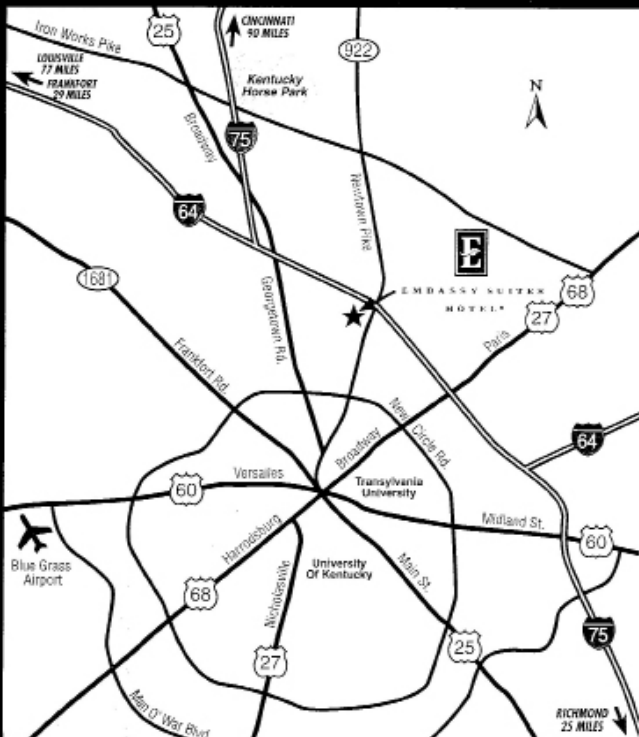

Cover design provided by
Central Kentucky Ag Credit