

2019 KENTUCKY FRUIT AND VEGETABLE CONFERENCE

JANUARY 7-8, 2019
Monday and Tuesday



KENTUCKY STATE
HORTICULTURAL SOCIETY
163rd Annual Meeting

KENTUCKY VEGETABLE
GROWERS ASSOCIATION
48th Annual Meeting

ORGANIC ASSOCIATION OF KENTUCKY

KENTUCKY WINE ASSOCIATION

and

KENTUCKY HORTICULTURE
COUNCIL

In cooperation with:

*University of Kentucky
College of Agriculture, Food and Environment
Kentucky State University
and
Kentucky Department of Agriculture*

Meeting Place:

Embassy Suites Hotel
1801 Newtown Pike
Lexington, Kentucky 40511
(859) 455-5000
FAX (859) 455-5122
Reservations: 800-EMBASSY



We Know Ag

Ag Credit professionals understand farming and crop production. That includes special financing needs of fruit and vegetable growers. Central Kentucky Ag Credit is the best financial partner you will find. Loans for land, farms, homes in the country and so much more!

Danville
859-236-6570

Frankfort
502-875-0863

Lebanon
270-692-4411

Lexington
859-252-4717

Paris
859-987-4344

Richmond
859-623-1624

Stanford
606-365-7500



AgCreditOnline.com

Conference Overview

<u>Sunday, January 6</u>	Pre-conference Sessions	Room
6:30-7:30 p.m.	Vegetable Round Table Discussion	Coldstream 4
7:30-8:30 p.m.	Tree & Small Fruit Round Table Discussion	Coldstream 4
5:00-9:00 p.m.	Exhibitor Set-up	



<u>Monday, January 7</u>	Main Conference Sessions	
8:00 a.m.	Exhibits and Registration Desk Open	
8:50 a.m.	Concurrent Sessions	
	General Session	Coldstream 3
	Grape & Wine Short Course	Coldstream 4
10:30 a.m.	Break	
12:10 p.m.	Exhibitor & Grower Luncheon	Coldstream 1 & 2
1:30 p.m.	Concurrent Sessions	
	Farmers' Markets and More	Coldstream 1 & 2
	Vegetable Production	Coldstream 3
	Grape & Wine Short Course	Coldstream 4
	Tree Fruit Production	Coldstream 5
2:30 p.m.	Break	
5:00 p.m.	Exhibits Close	
6:00 p.m.	Wine Tasting	Coldstream 1 & 2



<u>Tuesday, January 8</u>		
8:00 a.m.	Exhibits Open	
8:30 a.m.	Concurrent Sessions	
	Tree Fruit Production for Experienced Growers	Coldstream 1 & 2
	Vegetable Production	Coldstream 3
	Grape & Wine Short Course	Coldstream 4
	Organic Production	Coldstream 5
	The Good & the Bad of Selling Produce	Fayette
10:00 a.m.	Break	
11:45 a.m.	Tuesday Luncheon	Coldstream 1 & 2
1:30 p.m.	Concurrent Sessions	
	Marketing & Business Management	Coldstream 1 & 2
	Hight Tunnel Production	Coldstream 3
	Grape & Wine Short Course	Coldstream 4
	Small Fruit Production	Coldstream 5
	PBPT & FSMA Updates	Fayette
2:30 p.m.	Break	
3:00 p.m.	Exhibit Hall Closes	

Dear Fruit and Vegetable Growers:

The 2019 Kentucky Fruit and Vegetable Conference and Trade Show will again be at the Embassy Suites Hotel, Lexington, KY, Monday and Tuesday, January 7 and 8, 2019. You may pre-register on line at <https://kyhortcouncil.org/2019-fruit-veg-registration/>. The conference will begin with pre-conference Vegetable and Tree & Small Fruit Round Table Discussions. The conference will feature sessions on Farmers' Markets and More, Commercial Fruit and Vegetable Production, Organic Production, High Tunnel Production, The Good and the Bad of Selling Produce, Marketing and Business Management, PBPT and FSMA Updates, and a Grape and Wine Short Course. We have a number of excellent out-of-state speakers this year including: Dr. Bruce Bordelon, Extension Viticulturist, Purdue University, Lafayette, IN; Dr. Carl Cantaluppi, Retired North Carolina Extension Agent and east coast asparagus expert, Selinsgrove, PA; Maria Peterson, Filtration Media Specialist, Scott Laboratories, Petaluma, CA; Dr. Celeste Welty, Extension Entomologist, Ohio State University, Columbus, OH and Dr. Annette Wszelaki, Vegetable Extension Specialist, University of Tennessee, Knoxville, TN.

There will be an optional Wine Tasting Monday evening. On Monday we will have an Exhibitor/Grower Luncheon and a Luncheon on Tuesday featuring Kentucky Proud products.

A Trading Post bulletin board will be available to sell used equipment. If you are looking for equipment buyers, bring along a description containing your name, phone number and the equipment price.

PLEASE make your room reservations directly with the hotel at **859-455-5000**. **Our block of rooms will be held until January 5, 2019. After this, room prices will be higher.** Be sure to let the hotel know that you will be staying for the Kentucky Fruit and Vegetable Conference by calling 859-455-5000 to obtain our special suite room rate for a single or double (they are all suites) of \$121.95. If you are told that the block of rooms at our conference rate is full on or before Jan. 5, please call Amy Stamper at Embassy Suites (859-455-5109) only to increase the number of rooms that we have blocked. The room cost includes an evening managers' reception from 5:30 to 7:30 p.m. with drinks and a full cooked-to-order breakfast daily. We encourage growers to stay at Embassy Suites Hotel to help cover meeting overhead expenses. Note: If the hotel parking lot is full, meeting attendees may park along Aristides Street in front of the hotel.

The \$40 meeting pre-registration fee or \$60 registration fee on site includes a year's membership in the KVGA, KSHS or OAK and entrance into the Grape & Wine Short Course. Pre-registration means that your tickets and name tag will be ready for you when you arrive at the meeting. **LUNCHEON TICKETS MAY NOT BE AVAILABLE AT THE REGISTRATION DESK. NAME BADGES WILL BE REQUIRED TO ENTER MEETING ROOMS.** PRE-REGISTRATION FORMS OR ONLINE REGISTRATIONS NEED TO BE IN OUR HANDS BY FRIDAY, DECEMBER 14, 2018. Phone registrations will not be accepted. If you would like to serve on the KVGA or KSHS boards of directors or would like to nominate another member, please designate this on your registration sheet.

NOTE: WE STRONGLY URGE YOU TO PRE-REGISTER AS REGISTRATION WILL BE \$60 ON SITE.

If circumstances are such that you cannot attend the meeting, and you would like to remain a member of the KVGA, KSHS, or OAK, please complete and return the form with a check to Ms. Mary Ann Kelley, 36 Ethridge Dr., Princeton, KY 42445 to continue your association membership.

Sincerely,

Joel Wilson, President
KY Vegetable Growers Association

Matt Gajdzik, President
KY State Horticultural Society

**KENTUCKY STATE HORTICULTURAL
SOCIETY OFFICERS**

President: Matt Gajdzik, Shelbyville
Vice-President: Jonathan Price, Bowling Green
Secretary: Doug Archbold, Lexington
Treasurer: Amanda Gajdzik, Shelbyville
Directors: Maurice Fegenbush, Bloomfield
Lyle Allen, Versailles
Larry Ayres, Owenton
Don Haney, Nancy
Terry Creech, Cumberland
Kevan Evans, Georgetown
Dwight Greenwell, Louisville
Bryan Bailey, Bowling Green
Rick Ekstrom, Corydon

Advisors: Kirk Pomper, Frankfort
Dana Reed, Paris
John Strang, Lexington
Shawn Wright, Jackson

**ORGANIC ASSOCIATION OF
KENTUCKY OFFICERS**

President: Mac Stone, Georgetown
Vice-President: Larry Brandenburg, Shelbyville
Exec. Director: Brooke Gentile, Lexington
Secretary: Ashton Potter Wright, Lexington
Treasurer: John Bell, Georgetown
Directors: John Cambron, Frankfort
Rachael Peake, Frankfort
Chad Rosen, Louisville
Ford Waterstrat, London
Cindy Youngblood, Prospect

Advisors: Sean Clark, Berea
Sarah Fritschner, Louisville
Krista Jacobsen, Lexington
David Koester, Burlington
Shawn Lucas, Lexington
Lee Meyer, Lexington
Irvin Ramer, Elkton
Rachel Rudolph, Lexington
Tony Silvernail, Frankfort

**KENTUCKY VEGETABLE GROWERS
ASSOCIATION OFFICERS**

President: Joel Wilson, Nancy
Vice-President: Kirby Overman, Lancaster
Secretary: Sandi Deutsch, Taylorsville
Treasurer: Ron McMaine, Salvisa
Directors: Zeldon Angel, Winchester
Jonathan Berkshire, Glencoe
Vicki Fryman, Cynthiana
David Neville, Campbellsburg
Brad Reid, Owensboro
Kim Roberts, Franklin
Shubin Saha, Stanford
Jacob Sharpe, Georgetown
John Sparks, Winchester
Nathan Truesdell, Salvisa

Advisors: Josh Lindau, Frankfort
Rachel Rudolph, Lexington
John Strang, Lexington
Shawn Wright, Jackson

**KENTUCKY WINERIES ASSOCIATION
OFFICERS**

President: Chad Peach, Frankfort
Vice-President: Joey Sloan, Lawrenceburg
Secretary: Francine Sloan, Lawrenceburg
Treasurer: Logan Leet, Louisville
Directors: Mike Hatzell, Brooks
Brian Young, Nicholasville

All Times Are Eastern Standard Time

PRE-CONFERENCE SESSIONS

SUNDAY AFTERNOON, JANUARY 6

6:30-7:30 p.m. **VEGETABLE ROUND TABLE DISCUSSION**

Coldstream 4 Room
Rachel Rudolph, Presiding

7:30-8:30 p.m. **TREE & SMALL FRUIT ROUND TABLE DISCUSSION**

Coldstream 4 Room
John Strang, Presiding

5:00-9:00 p.m. **Exhibitor Set-up**

Pre-Function Area & Lower Atrium

Leading Kentucky in Local Production

Kentucky fruit and vegetable growers are leading Kentucky towards more locally based agricultural systems. When close ties are built consumers benefit and producers benefit. Kentucky agriculture is better.

Congratulations to all those involved in the fruit and vegetable food systems in Kentucky.

Your local source for your farm and rural living needs.



AgCreditOnline.com

MONDAY, JANUARY 7

8:00 a.m. Exhibits Open, Pre-Function & Lower Atrium Areas
Registration, Pre-Function area outside meeting rooms.
Meeting pre-registration is \$40.00 and \$60.00 on site. Please see the registration form
for association memberships.



**(1) GENERAL
SESSION**

*Coldstream 3 Room
Matt Gajdzik, Presiding*

(2) GRAPE & WINE SHORT COURSE

*Coldstream 4 Room
Jeff Wheeler, Presiding*

8:45 a.m. Welcome – Joel Wilson
8:55 a.m. Horticulture Department Update
– Mark Williams
9:00 a.m. Kentucky Department of Agriculture
Update – Ryan Quarles
9:15 a.m. Kentucky Horticulture Council Update
– Cindy Finneseth
9:25 a.m. Kentucky State University Update
– Kirk Pomper
9:35 a.m. FDA On-Farm Readiness Reviews
– Ben Conner
9:50 a.m. Center for Crop Diversification Tools
– Josh Knight, Christy Cassidy, and
Brett Wolff
10:00 a.m. Fruit and Vegetable Production Engineering
Advances – Joseph Dvorak
10:25 a.m. Do You Need to Fertilize with Phosphorus?
– Rick Durham
10:40 a.m. Cider/Coffee Break and Visit Exhibits
Pre-Function and Lower Atrium Areas
11:10 a.m. Kentucky Maple Syrup Opportunities
– Keith Moore
11:25 a.m. GotEquipped - Serving Farmers' Equipment
Needs – Phil Hager
11:35 a.m. Organic Association of Kentucky Update
– Brooke Gentile
11:40 a.m. Farm Service Agency Update
– Brian Lacefield
11:50 a.m. Kentucky Farm Bureau Update
– Drew Graham
Noon Adjourn for Lunch

8:50 a.m. Welcome
– Chad Peach
9:00 a.m. Fining and Filtration to Increase Wine
Quality – Maria Peterson
9:30 a.m. Continued
10:00 a.m. Continued
10:30 a.m. Cider/Coffee Break and Visit Exhibits
– Pre-Function and Lower Atrium Areas
11:00 a.m. Getting Your New Winery Flying
– Eddie O'Daniel
11:30 a.m. Continued



12:00 p.m. **EXHIBITOR/GROWER LUNCHEON** - Coldstream 1 & 2 Rooms

12:00 p.m. **KVGA, KSHS, KWA BOARD MEETINGS**
KSHS and KVGA board members should pick up their lunch at the buffet outside of Coldstream 1 & 2
and then meet in the designated room at the top of the hotel lobby stairs located over the
meeting rooms.

*Kentucky Vegetable Growers Association - Georgetown Room
Kentucky State Horticultural Society - Paris Room
Kentucky Wineries Association - Fayette Room*

MONDAY AFTERNOON, JANUARY 7

4 CONCURRENT SESSIONS

Concurrent sessions will enable participants to attend topics of interest in different sessions

.....

(3) FARMERS' MARKETS AND MORE

*Coldstream 1 & 2 Rooms
Nancy Monroe, Presiding*

(4) VEGETABLE PRODUCTION

*Coldstream 3 Room
Nikki Rhein Bell, Presiding*

1:30 p.m.	The "Farmer's" Farmers' Market Experience – Kirby and Babette Overman	1:30 p.m.	Winter Vegetable Production – Nathan Howell
2:00 p.m.	New Product Development and Marketing – Jeong Hyun An	2:00 p.m.	Continued
2:30 p.m.	Product Sampling and Cider/Coffee Break and Visit Exhibits - Pre-Function and Lower Atrium Areas	2:30 p.m.	Cider/Coffee Break and Visit Exhibits – Pre-Function and Lower Atrium Areas
3:10 p.m.	Leveraging Social Media for Your Market and Business – Kati Bowman	3:10 p.m.	Drip Irrigation Setup and Calculations – Brent Rowell
3:40 p.m.	Retail Pricing for Farmer Markets – Brett Wolff and Alex Butler	3:40 p.m.	Trap Crops for Stink Bugs – Lauren Fann
4:10 p.m.	Homebased Processing Legislative Update – Ky Food Safety Branch	4:10 p.m.	UK Research Farm Virtual Tour – Steve Diver
4:40 p.m.	Value-Added Products Panel – Joseph Farmer, Courtney McBaen, Gina Micciche, Annhall Norris, and David Walker	4:40 p.m.	Vegetable Cultivar Trial Results (Bell Pepper, Spring and Fall Broccoli) – Daniel Becker and Chris Smigell
		5:20 p.m.	Kentucky Strawberry Assn. Meeting

MONDAY AFTERNOON, JANUARY 7



(5) GRAPE AND WINE SHORT COURSE

*Coldstream 4 Room
Jeff Wheeler, Presiding*

(6) TREE FRUIT PRODUCTION

*Coldstream 5 Room
Chelsey Anderson, Presiding*

1:30 p.m. Promising Red Wine Cultivars for KY
(includes wine tasting) – Jeff Wheeler

2:00 p.m. Continued

2:30 p.m. Cider/Coffee Break and Visit Exhibits
– Pre-Function and Lower Atrium
Areas

3:10 p.m. Traditional Method Sparkling Wines for
KY (includes wine tasting)
– Jeff Wheeler

3:40 p.m. Continued

4:10 p.m. KY Wine Industry Update
– Tyler Madison

4:40 p.m. Continued

1:30 p.m. Fruit Tree Varieties that We Like
– Dana Reed, Lon McGlasson, and Terry
Creech

2:00 p.m. Bitter Rot Management – Madison
McCulloch and Nicole Gauthier

2:30 p.m. Cider/Coffee Break and Visit Exhibits
–Pre-Function and Lower Atrium Areas

3:10 p.m. How To Read Soil and Leaf Analysis
Tests – John Strang

3:40 p.m. Invasive Species: Spotted Lantern Fly
and Brown Marmorated Stink Bug
– Ric Bessin

4:10 p.m. Appraising the Monetary Value of Trees
Lost from Accidents, Vandalism and
Catastrophic Events – Bill Fountain

4:40 p.m. Growing Pawpaws in Kentucky
– Sheri Crabtree



MONDAY EVENING, JANUARY 7

5:00 p.m. **Exhibits Close**

6:00-7:30 p.m. **WINE TASTING**
Coldstream 1 & 2 Rooms

The cost is \$10.00 for the event and includes a souvenir glass.
Featuring wines from Kentucky grown grapes.

TUESDAY MORNING, JANUARY 8

8:00 a.m. Exhibits Open, Pre-Function and Lower Atrium Areas
Registration, Pre-Function Area outside meeting rooms

5 CONCURRENT SESSIONS

Concurrent sessions will enable participants to attend topics of interest in different sessions.

**(7) TREE FRUIT PRODUCTION
FOR EXPERIENCED GROWERS**

*Coldstream 1 & 2 Rooms
Adam Leonberger, Presiding*

**(8) VEGETABLE
PRODUCTION**

*Coldstream 3 Room
Will Stallard, Presiding*

- 8:30 a.m. Fungicides 201: Resistance and Rain Fastness – Nicole Gauthier
- 8:30 a.m. KVGA Annual Business Meeting +Vegetable Production Q & A – Ric Bessin, Chris Smigell, and Rachel Rudolph
- 9:00 a.m. Brown Marmorated Stink Bug: Biocontrol Progress – Celeste Welty
- 9:00 a.m. Asparagus Production – Carl Cantaluppi
- 9:30 a.m. Advanced Fruit Disease Identification – Nicole Gauthier
- 9:30 a.m. Continued
- 10:00 a.m. Cider/Coffee Break and Visit Exhibits – Pre-Function and Lower Atrium Areas
- 10:00 a.m. Cider/Coffee Break and Visit Exhibits – Pre-Function and Lower Atrium Areas
- 10:40 a.m. How Calibration Can Help You Get Better Control from Your Sprays – Celeste Welty
- 10:40 a.m. Does Biodegradable Mulch Have a Place in Your Production System? – Annette Wszelaki
- 11:10 a.m. KSHS Annual Business Meeting
- 11:10 a.m. Economics of Tomato Caging vs Staking – Carl Cantaluppi

11:45 a.m. **TUESDAY LUNCHEON** - Coldstream 1 & 2

12:00 p.m. **KENTUCKY GRAPE AND WINE COUNCIL BOARD MEETING**
Board members that have purchased tickets should pick up their lunch at the buffet outside of Coldstream 1 & 2 and then meet in the Paris Room at the top of the stairs located over the meeting rooms.

TUESDAY AFTERNOON, JANUARY 8

**(12) MARKETING & BUSINESS
MANAGEMENT**

*Coldstream 1 & 2 Rooms
April Wilhoit, Presiding*

(13) HIGH TUNNEL PRODUCTION

*Coldstream 3 Room
Bonnie Sigmon, Presiding*

- 1:30 p.m. Marketing for All: Visual Marketing – Tim Woods, Alex Butler, and Brett Wolff
- 1:30 p.m. Finding the Time for Cover Crops in Your High Tunnels – Annette Wszelaki
- 2:00 p.m. Continued
- 2:00 p.m. Growing Ginger and Turmeric in High Tunnels – Kristi Durbin
- 2:30 p.m. Cider/Coffee Break and Visit Exhibits – Pre-Function and Lower Atrium Areas
- 2:30 p.m. Cider/Coffee Break and Visit Exhibits – Pre-Function and Lower Atrium Areas
- 3:10 p.m. Budgeting and Planning: How to Use CCD Budgets – Matt Ernst
- 3:10 p.m. High Tunnel Grower Resources – Josh Knight
- 3:40 p.m. Hiring Your First Employee – Aleta Botts
- 3:40 p.m. High Tunnel Salinity Problems – Krista Jacobsen
- 4:10 p.m. Business Plan Basics – Brent Lackey
- 4:10 p.m. Cultivar Trial Results: Squash, Zucchini, Ground Cherry – Rachel Rudolph

TUESDAY MORNING, JANUARY 8

5 CONCURRENT SESSIONS

Concurrent sessions will enable participants to attend topics of interest in different sessions.



(9) GRAPE & WINE SHORT COURSE

*Coldstream 4 Room
Patsy Wilson, Presiding*

(10) ORGANIC PRODUCTION

*Coldstream 5 Room
Brooke Gentile, Presiding*

(11) THE GOOD AND THE BAD OF SELLING PRODUCE

*Fayette Room
Roger Snell, Presiding*

- | | | | | | |
|------------|--|------------|---|------------|---|
| 9:00 a.m. | Timing and Management Strategies for an Effective Disease Management Program – Bruce Bordelon | 8:30 a.m. | Preparing for Organic Certification – Megan Clark and Tony Silvernail | 8:30 a.m. | Effective Market Strategies for Selling Produce – Tim Woods |
| 9:30 a.m. | Continued | 9:00 a.m. | Tips to Outmaneuver Pests – Ric Bessin | 9:00 a.m. | Grower Experience with Wholesale Buyers – Joel Wilson |
| 10:00 a.m. | Cider/Coffee Break and Visit Exhibits – Pre-Function and Lower Atrium Areas | 9:30 a.m. | Weed Control in Organic Systems – Krista Jacobsen and Kristi Durbin | 9:30 a.m. | Produce Grower Markets Q&A Panel |
| 10:40 a.m. | Climate Change and How it Affects Vineyard Management – Bruce Bordelon | 10:00 a.m. | Cider/Coffee Break and Visit Exhibits – Pre-Function and Lower Atrium Areas | 10:00 a.m. | Cider/Coffee Break and Visit Exhibits– Pre-Function and Lower Atrium Areas |
| 11:10 a.m. | Adjusting Vineyard Spray Programs to Accommodate Seasonal Changes in Weather Patterns – Bruce Bordelon | 10:40 a.m. | Biologicals for Tomato Disease Management – Erica Fealko | 10:40 a.m. | Fruit and Vegetable Post-Harvest Quality – Bryan Brady |
| | | 11:10 a.m. | Soil Testing and Management in Organic Systems – Rachel Rudolph | 11:10 a.m. | Growing Our Local Food Economy: Challenges & Opportunities – Ashton Potter Wright |

TUESDAY AFTERNOON, JANUARY 8

(14) GRAPE AND WINE SHORT COURSE

*Coldstream 4 Room
Nancy Savage, Presiding*

(15) SMALL FRUIT PRODUCTION

*Coldstream 5 Room
Kara Back, Presiding*

(16) PBPT and FSMA UPDATES

*Fayette Room
Paul Vijayakumar, Presiding*

- | | | | | | |
|-----------|---|-----------|---|-----------|--|
| 1:30 p.m. | Identifying Insect Damage and Control Strategies – Ric Bessin | 1:30 p.m. | Plasticulture Strawberry Production – John Strang | 1:30 p.m. | Good Agricultural Practices (GAP) Auditing – Bryan Brady |
| 2:00 p.m. | Herbicide Resistance and Vineyard Weed Management – Shawn Wright | 2:00 p.m. | An Innovative Blackberry Trellis and Plasticulture Strawberry Experiences – Tom Dutkanych | 2:00 p.m. | Continued |
| 2:30 p.m. | Cider/Coffee Break and Visit Exhibits – Pre-Function and Lower Atrium Areas | 2:30 p.m. | Cider/Coffee Break and Visit Exhibits – Pre-Function and Lower Atrium Areas | 2:30 p.m. | Cider/Coffee Break and Visit Exhibits – Pre-Function and Lower Atrium Areas |
| 3:10 p.m. | Modified Training Systems – Sean Lynch | 3:10 p.m. | CoolBot: Low Cost Refrigeration Basics – John Wilhoit | 3:10 p.m. | Produce Best Practices Training (PBPT) and Food Safety Modernization Act (FSMA) – Paul Priyesh Vijayakumar |
| 3:40 p.m. | Grower Round Table Discussion | 3:40 p.m. | Herbicide Resistance – Shawn Wright | 3:40 p.m. | Continued |
| 4:10 p.m. | Continued | 4:10 p.m. | Organic Production of Primocane Fruiting Blackberries in Ky – Jeremy Lowe | 4:10 p.m. | Continued |

SPEAKERS 2019

Jeong Hyun An, YAGO Farm & Food, Grower, Lexington, KY

Chelsey Anderson, Cumberland County Extension Agent for Agriculture and Natural Resources, Burkesville, KY

Kara Back, Taylor County Extension Agent for Horticulture, Campbellsville, KY

Daniel Becker, Small Fruit and Vegetable Extension Associate, UKREC, Princeton, KY

Nikki Rhein Bell, Marshall County Extension Agent for Agriculture and Natural Resources, Benton, KY

Dr. Ric Bessin, Extension Entomologist, Department of Entomology, University of Kentucky, Lexington, KY

Aleta Botts, Executive Director, Kentucky Center for Agriculture and Rural Development (KCARD), Elizabethtown, KY

Dr. Bruce Bordelon, Professor, Department of Horticulture and Landscape Architecture, Purdue University, West Lafayette, IN

Kati Bowman, Marketing and Communications Specialist, Kentucky Center for Agriculture and Rural Development (KCARD), Elizabethtown, KY

Bryan Brady, Cultivate Kentucky, The Food Connection, Lexington, KY

Alex Butler, Extension Associate, Department of Agricultural Economics, University of Kentucky, Lexington, KY

Dr. Carl Cantaluppi, Retired North Carolina Extension Agent, Selinsgrove, PA

Christy Cassady, Extension Specialist, Center for Crop Diversification, Department of Horticulture, University of Kentucky, Lexington, KY

Megan Clark, Organic Program Specialist, Kentucky Department of Agriculture, Frankfort, KY

Ben Conner, Produce Safety Program Manager, Kentucky Department of Agriculture, Frankfort, KY

Sheri Crabtree, Horticulture Research and Extension Associate, Land Grant Program, College of Agriculture, Communities and the Environment, Kentucky State University, Frankfort, KY

Terry Creech, Grower, Apple Tree, Cumberland, KY

Steve Diver, Farm Superintendent, Horticulture Research Farm, Department of Horticulture, University of Kentucky, Lexington, KY

Kristi Durbin, Horticulturist Senior, CSA Manager, Department of Horticulture, University of Kentucky, Lexington, KY

Dr. Rick Durham, Extension Consumer Horticulture Specialist, Department of Horticulture, University of Kentucky, Lexington, KY

Tom Dutkanych, Grower, Eckert's Belleville Country Store and Farms, Belleville, IL

Dr. Joseph Dvorak, Machine Systems Automation Engineering, Department of Biosystems and Agricultural Engineering, University of Kentucky, Lexington, KY

Matt Ernst, Agricultural Writer and Analyst, Gray Summit, MO

Lauren Fann, M.S. Graduate Student, Department of Entomology, University of Kentucky, Lexington, KY

Joseph Farmer and Gina Micciche, Growers, Lucky Clover Farm, Richmond, KY

Erica Fealko, M.S. Student, Department of Plant Pathology, University of Kentucky, Lexington, KY

Dr. Cindy Finneseth, Executive Director, Kentucky Horticulture Council, Lexington, KY

Dr. Bill Fountain, Extension Aboriculture, Urban Forestry Specialist, Department of Horticulture, University of Kentucky, Lexington, KY

Matt Gajdzik, President, Kentucky State Horticultural Society, Grower, Mulberry Orchard, Shelbyville, KY

Dr. Nicole Gauthier, Extension Plant Pathologist, Department of Plant Pathology, University of Kentucky, Lexington, KY

Brooke Gentile, Executive Director, Organic Association of Kentucky, Lexington, KY

Drew Graham, Executive Vice President, Kentucky Farm Bureau Federation, Louisville, KY

Phil Hager, Got Equipped, Lexington, KY

Nathan Howell, Grower, Need More Acres Farm, Scottsville, KY

Dr. Krista Jacobsen, Sustainable Agriculture Teaching and Research, Department of Horticulture, University of Kentucky, Lexington, KY

Josh Knight, Horticulture Senior Extension Associate, Department of Horticulture, University of Kentucky, Lexington, KY

Brian Lacefield, Kentucky State FSA Executive Director, Lexington, KY

Brent Lackey, Business Specialist, Kentucky Center for Agriculture and Rural Development, (KCARD), Elizabethtown, KY

Adam Leonberger, Franklin County Extension Agent for Horticulture, Frankfort, KY

Jeremy Lowe, Research Associate II in Horticulture, Land Grant Program, College of Agriculture, Communities and the Environment, Kentucky State University, Frankfort, KY

SPEAKERS 2019

Sean Lynch, U.K. Research Farm Technician, Department of Horticulture, University of Kentucky, Lexington, KY

Courtney McBaen, Director of Operations, SoKY Marketplace, Bowling Green, KY

Tyler Madison, Grape and Wine Spirits Program Manager, Kentucky Grape and Wine Council, Kentucky Department of Agriculture, Frankfort, KY

Nancy Monroe, Ag Program Coordinator, Direct Farm Marketing Division, Kentucky Department of Agriculture, Frankfort, KY

Keith Moore, President, Kentucky Maple Syrup Association, Savage Farms, Louisa, KY

Madison McCulloch, Graduate Student, Department of Plant Pathology, University of Kentucky, Lexington, KY

Lon McGlasson, Grower, McGlasson Farms, Hebron, KY

Annhall Norris, Extension Associate, Department of Dietetics and Human Nutrition, University of Kentucky, College of Agriculture Food and Environment, Lexington, KY

Eddie O'Daniel, Springhill Winery, Bloomfield, KY

Babette and Kirby Overman, Growers, Overman's Bluegrass Fruits and Vegetables, Lancaster, KY

Chad Peach, President, Kentucky Wineries Association, Winemaker/Owner, Prodigy Vineyards and Winery, Frankfort, KY

Dr. Kirk Pomper, Director-KSU Agricultural Experiment Station, College of Agriculture, Communities and the Environment, Kentucky State University, Frankfort, KY

Maria Peterson, Filtration Media Specialist, Scott Laboratories, Petaluma, CA

Ryan Quarles, Agriculture Commissioner, Kentucky Department of Agriculture, Frankfort, KY

Dana Reed, Grower, Reed Valley Orchard, Paris, KY

Dr. Brent Rowell, Extension Professor, International Programs, Department of Horticulture, University of Kentucky, Lexington, KY

Dr. Rachel Rudolph, Extension Vegetable Specialist, Department of Horticulture, University of Kentucky, Lexington, KY

Nancy Savage, Research Analyst, Department of Horticulture, University of Kentucky, Lexington, KY

Bonnie Sigmon, Laurel County Extension Agent for Horticulture, London, KY

Tony Silvernail, Organic Transition Trainer, Organic Association of Kentucky, Frankfort, KY

Chris Smigell, Small Fruit and Vegetable Extension Associate, Department of Horticulture, University of Kentucky, Lexington, KY

Roger Snell, Farm to Retail Liaison, Office of Ag Marketing & Product Promotion, Kentucky Department of Agriculture, Frankfort, KY

Will Stallard, Lincoln County Extension Agent for Agriculture and Natural Resources, Stanford, KY

Dr. John Strang, Extension Fruit and Vegetable Specialist, Department of Horticulture, University of Kentucky, Lexington, KY

Dr. Paul Vijayakumar, Extension Food Science Specialist, Department of Animal and Food Sciences, University of Kentucky, Lexington, KY

David Walker, Walker's Family Farms, Hardy, KY

Dr. Celeste Welty, Associate Professor, Extension Entomologist, Ohio State University, Columbus, OH

Jeff Wheeler, Extension Enology Specialist, Department of Horticulture, University of Kentucky, Lexington, KY

April Wilhoit, Fleming County Extension Agent for Agriculture and Natural Resources, Flemingsburg, KY

Dr. John Wilhoit, Grower, Versailles, KY

Dr. Mark Williams, Chair, Department of Horticulture, University of Kentucky, Lexington, KY

Joel Wilson, President, Kentucky Vegetable Growers Association, Grower, Cedar Point Farm, Nancy, KY

Patsy Wilson, Extension Viticulture Specialist, Department of Horticulture, University of Kentucky, Lexington, KY

Brett Wolff, Extension Specialist, Center for Crop Diversification and UK SARE Program, Department of Agricultural Economics, University of Kentucky, Lexington, KY

Dr. Tim Woods, Agricultural Economics Extension Specialist, Department of Agricultural Economics, University of Kentucky, Lexington, KY

Dr. Ashton Potter Wright, Local Food Coordinator, Office of the Mayor, Lexington-Fayette Urban County Government, Lexington, KY

Dr. Shawn Wright, Extension Horticulture Specialist, Department of Horticulture, University of Kentucky, Robinson Center for Appalachian Resource Sustainability, Jackson, KY

Dr. Annette Wszelaki, Vegetable Extension Specialist, University of Tennessee, Knoxville, TN

EXHIBITORS 2019

All American Containers
206 Finley Rd.
Belle Vernon, PA 15012
phone: 315-585-6045
e-mail: rparmelee@allamericancontainers.com

Berger Peat Moss
1941 Saint Gregory's Court
Knoxville, TN 37931
phone: 865-312-2258
e-mail: adaml@berger.ca

Center for Crop Diversification
University of Kentucky
N-318 Ag. Science Center North
Lexington, KY 40546-0091
phone: 859-257-1477 or
859-218-4384
e-mail: cgclass0@uky.edu
e-mail: brett.wolff@uky.edu

Central Kentucky Ag. Credit
640 S. Broadway
Lexington, KY 40508
phone: 859-253-3249
e-mail: TalkToUs@AgCreditOnline.com

Clifton Seed Company
P.O. Box 206
Faison, NC 28341
phone: 910-267-2690
e-mail: wayne@cliftonseed.com

Continental Industries
P.O. Box 865
Shepherdsville, KY 40165
phone: 502-543-2600
email: jchamilton@windstream.net

Daisy Farms
28366 M152
Dowagiac, MI 49047
phone: 269-782-6321
e-mail: daisyfarms@qtm.net

Deerfield Supplies
2825 Stringtown Rd.
Elkton, KY 42220
phone: 270-265-2425

Dillman Farm, Inc.
4955 West State Road 45
Bloomington, IN 47403
phone: 812-825-5525
e-mail: carydillman@dillmanfarm.com

Fairview Produce Auction
10292 US Hwy 68E
Pembroke, KY 42266
phone: 270-887-0053

Farm Safe USA
754 37 9/10 RD.
Palisade, CO 81526
phone: 530-906-5001
e-mail: farmsafeusa@gmail.com

Governor's Office of Ag. Policy
404 Ann Street
Frankfort, KY 40601
phone: 502-782-1731
e-mail: marielle.manning@ky.gov

H & H Farm Machine Co., Inc.
7916 Unionville-Brief Rd.
Monroe, NC 28110
phone: 704-753-4919
email: ave.teague@hhspray.com

Indiana Berry & Plant Co.
2811 Michigan Rd.
Plymouth, IN 46563
phone: 574-784-2905
e-mail: sales@superbhorticulture.com

Innovative Labeling Solutions
4000 Hamilton Middletown Rd.
Hamilton, OH 45011
phone: 513-860-2457
e-mail: kristenwaite@ilslabels.com

Kentucky Department of Agriculture
Office of Marketing
111 Corporate Drive
Frankfort, KY 40601
phone: 502-782-4115
e-mail: Joshua.Lindau@ky.gov

Kentucky Farm Bureau Roadside Farm Market Program
P.O. Box 20700
Louisville, KY 40250
phone: 502-495-5000
e-mail: fran.mccall@kyfb.com

Kentucky Maple Syrup Association
P.O. Box 784
Whitesburg, KY 41858
phone: 606-922-0762
e-mail: kymaplesyrup@wordpress.com

Kentucky State University Fruit and Vegetable Mobile Processing Initiative
120 Atwood Research Facility
Kentucky State University
Frankfort, Ky 40601
phone: 502-597-5942
e-mail: kirk.pomper@ky.edu

Kentucky Women in Agriculture, Inc.
P.O. Box 4409
Lexington, KY 40544
phone: 270-293-8151
email: sfurches@mchsi.com

Lewis Seed Co.
130 N. Spring St.
Louisville, KY 40206
phone: 502-386-8335
e-mail: steve.lewisseed@gmail.com

Lincoln County Produce Auction
450 Al Wyler Rd.
Crab Orchard, KY 40419
phone: 606-355-0030

Midwest Vineyard Supply
2300 South Twin Bridge Road
Decatur, IL 62521
phone: 217-864-9896
e-mail: sales@midwestvineyardsupply.com

Miller Chemical & Fertilizer Corp.
P.O. Box 333
Hanover, PA 17331
phone: 717-632-8921
e-mail: jshannon845@gmail.com

ML Irrigation
226 Shady Lane
Midway, KY 40347
phone: 859-229-3096
e-mail: rmciel@highlandmoor.com

Monte Package Company
P.O. Box 128
Riverside, MI 49084
phone: 800-653-2807
e-mail: MikeV@montepkg.com

Nutrien Ag Solutions
7855 W 650 S
Rossville, IN 46065
phone: 765-714-8387
e-mail: stuart.brenneman@nutrien.com

Rockford Package Supply
10421 Northland Dr.
Rockford, MI 49341
phone: 800-444-7225
e-mail: tpaulson@rockfordpack.com

Rupp Seeds Inc.
17919 County Road B
Wauseon, OH 43567
phone: 1-800-700-1199
e-mail: info@ruppseeds.com

Scott Laboratories
480 Cader Lane
Petaluma, CA 94955
phone: 707-765-6666
e-mail: arlys@scottlab.com

Seedway, LLC
7520 Ruggles Ferry Pike
Knoxville, TN 37924
phone: 865-548-7333
e-mail: kbhosey@gmail.com

Shelby Insurance Agency, Inc.
500 Main Street
Shelbyville, KY 40065
phone: 502-633-6108
e-mail: sia4@iglou.com

Southern FS
200 Jamestown Rd.
Cobden, IL 62920
phone: 618-322-7027 or 618-893-4852
e-mail: applejam1@charter.net
agunther@southernfs.com

Stokes Seeds, Inc.
13265 Howe Rd.
Fishers, IN 46038
phone: 317-409-3445
e-mail: kwagner@stokesseeds.com

Sun Sugar Farms
1258 Maddox Lane
Verona, KY 41092
Phone: 888-883-7259 or 859-493-0331
e-mail: linda@sunsugarfarms.com

University of Kentucky Occupational Health and Safety
252 East Maxwell St.
Lexington, KY 40506-0314
859-257-2924

USDA Farm Service Agency
771 Corporate Drive
Lexington, KY 40503
phone: 859-224-7624
e-mail: Winnie.breeding@ky.usda.gov

USDA National Agricultural Statistics Service
601 W Broadway, Room 645
Louisville, KY 40202
phone: 502-907-3218
e-mail: david.knopf@usda.gov

VanMeter Family Farm
164 Old Peonia Loop
Clarkson, KY 42726
phone: 270-963-2320
e-mail: vanmeterfamilyfarm@gmail.com

**Waldo & Associates, Inc./
Premium Horticultural
Supply Co.**
915 East Jefferson Steet
Louisville, KY 40206
phone: 502-582-3897
e-mail: richard.weis@waldoinc.
com

Westfall Company, Inc.
124 Workman Court
Eureka, MO 63025
phone: 636-938-3113
e-mail: awestfall@westfallcompany.com

Literature Table

Nourse Farms, Inc.
41 River Road
South Deerfield, MA 01373
phone: 413-665-2658
e-mail: info@noursefarms.com

**Waters Agricultural
Laboratories, Inc.**
2101 Calhoun Rd., Hwy 81
Owensboro, KY 42301
phone: 270-685-4039
e-mail: jeff@watersag.com

Swihart's LLC
7240 County Road AA
Quinter, KS 67752
phone: 785-754-3513
e-mail: swiharts@ruraltel.net

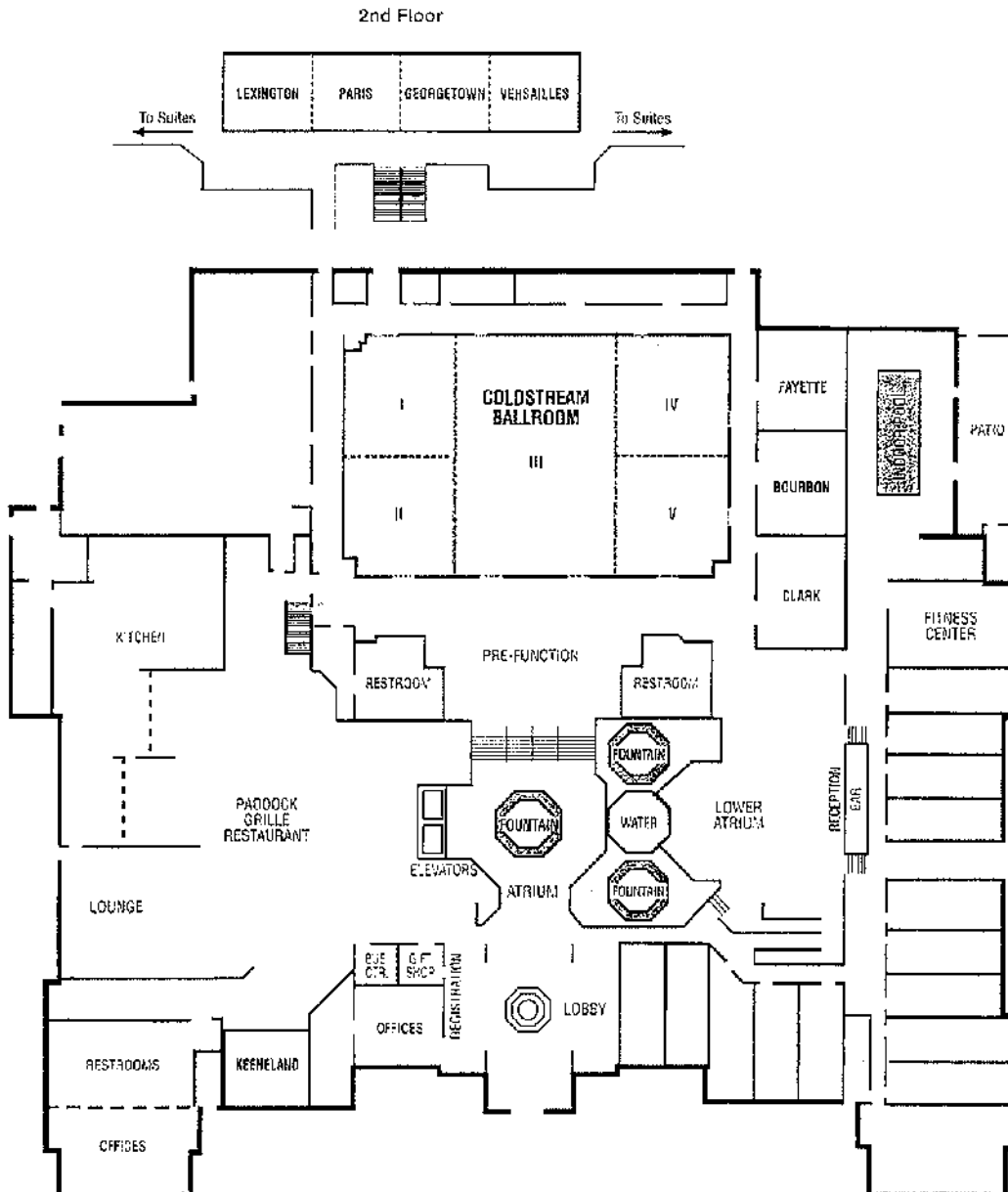

Kentucky State Horticultural Society
UK Research & Education Center
P.O. Box 469
Princeton KY 42445-0469

DIRECTIONS

From I-75/64: Take Exit 115 then right on to Newtown Pike. Turn right onto Aristides Blvd. at the UK Coldstream Research Campus. Hotel is on the right.

From Blue Grass Airport: Exit left on to Man O'War Blvd. to Versailles Rd. Turn right onto Versailles Rd. Take Rt. 4 New Circle Rd. north to Newtown Pike Exit North. Turn left onto Aristides Blvd. at the UK Coldstream Research Campus. Hotel is on the right.

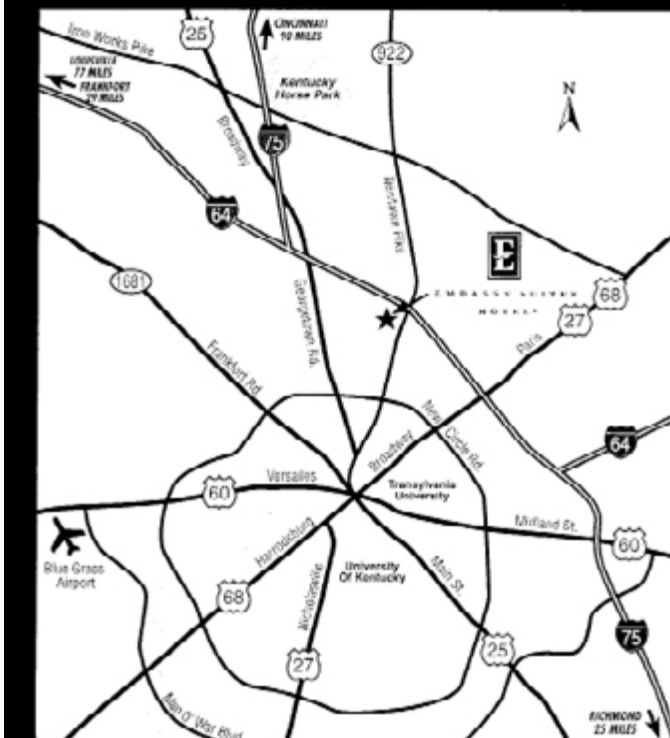

Program printing provided by



AgCreditOnline.com