

HENRY CLAY



D
BLUE



V
I
L
S

Program
of Studies
2020~2021



Welcome to Henry Clay High School Home of the Blue Devils

2100 Fontaine Road
Lexington, KY 40502
Main Office: (859) 381-3423
Counseling Office: (859) 381-3435
Attendance Office: (859) 381-3429
Fax: (859) 381-3430
www.henryclay.fcps.net

Our Mission

To educate and to prepare our students
for a life of productive citizenship.

Principal

Paul Little Jr.

Assistant Principals

J. J. Allen (Interim)
Chad Carpenter
Laura Donovan



Counselors

Bonnie Barnes
April Cain
Josh Edwards
Ashley Harris
Rachael Howard
Lyndsey Timoney
Sharron Wesley-Porter

Social Worker: Tori Mason

Academy Coordinator: Catherine Stephens

Youth Service Center: Paula Caise

Dean of Students: Demetrius Gay

BELL SCHEDULE

Zero Hour	7:25 - 8:20 a.m.
1st Period Class	8:25 - 9:25 a.m.
2nd Period Class	9:30 - 10:30 a.m.
3rd Period Class	10:35 - 11:35 a.m.
4th Period Class	11:40 a.m. - 1:05 p.m.
1st Lunch - 11:40 - 12:05 2nd Lunch - 12:10 - 12:35 3rd Lunch - 12:40 - 1:05	
5th Period Class	1:10 - 2:10 p.m.
6th Period Class	2:15 - 3:15 p.m.

Our high school was named in honor of the great Kentuckian and national statesman Henry Clay Sr. whose home, Ashland, was nearby. The oldest public high school in Lexington, Henry Clay High originally opened on Main Street in 1928. In the dedicatory address, George Bain said the school would be like a rich sapphire set in pure gold...hence the school colors of Blue and Gold.

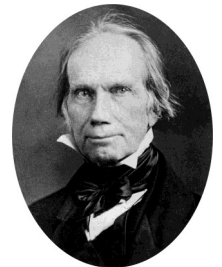

The school moved to its current Fontaine Road facility in 1970 and underwent a complete renovation in 2006. Henry Clay High School is home to a richly diverse student population representing more than 50 countries offering a comprehensive and challenging curriculum for all students. In 2018, Henry Clay High School was ranked 10th within Kentucky in the U.S. News & World Report Best High Schools and #955 in the national rankings - www.usnews.com/education/best-high-schools/national-rankings for additional data.



HENRY CLAY HIGH SCHOOL GRADUATION REQUIREMENTS

Students earn 1/2 credit per course per semester or 1 credit per year.

- **English (Language Arts)**..... 4 Credits
 - **Mathematics** 3 Credits for the Class of 2021 and 2022—For the Class of 2023 and beyond, 4 Credits
Algebra 1, Geometry, Algebra II, and one additional math. All seniors must be enrolled in a math course.
 - **Science**..... 3 Credits
 - Option 1:** Intro to Physics > Intro. to Chemistry > Intro. to Biology.
 - Option 2:** Intro to Physics > Adv. Biology > Adv. Chemistry.
 - Option 3*:** Advanced Biology** > Advanced Chemistry > Advanced Physics OR AP Physics I.
 - *Once you begin Option 3, you may not change to Option 1 or 2 after the first 10 days of school.**
 - **Advanced Biology—It is recommended that 9th grade students meet qualifying MAP testing scores of 240 for MATH and 228 for Reading as well as be enrolled in a math course ABOVE Algebra 1 concurrently.**
 - **Social Studies:** 1 Credit Each of Government*, World History, and U.S. History 3 Credits
*Government courses include Citizenship, Government, Int. Social Studies or Political Science.
 - **Health and Physical Education (1/2 Credit for each is required.)** 1 Credit
This course is typically taken during your Sophomore year OR in Henry Clay’s summer school.
 - **Fine Arts/Humanities**..... 1 Credit
This curriculum is embedded into the English 3 and World Civilization/History classes at Henry Clay.
Course credit is earned after successful completion of the Humanities curriculum.
 - **Electives** 7 Credits for the Class of 2021 and 2022—For the Class of 2023 and beyond, 6 Credits
- TOTAL CREDIT REQUIREMENTS..... 22 Credits***

*Students must pass a civics test correctly answering at least 60 out of 100 questions composed from the United States Citizenship and Immigration Services test. Students will be provided a review and may retake the exam as many times as deemed necessary to pass the test. Also, the Kentucky Board of Education approved new minimum high school graduation requirements requiring students to show basic competency in reading and math and fulfill one of eight “qualifiers” designed to help students be career or college ready.

KENTUCKY DEPARTMENT OF EDUCATION NEW GRADUATION REQUIREMENTS

Students entering high school in 2019-2020 and thereafter, must complete ONE graduation qualifier from this list:

1. Complete the Pre-College Curriculum (see below).
2. School benchmark on one section of college admissions test.
3. Earn a C or higher in a 3-credit hour college course.
4. Successfully complete an AP course and earn a 3 or higher on the AP exam.
5. Earn an Industry Certification.
6. Earn 4 credits within a single career pathway.
7. Complete 2 years of a KDE approved pre-apprenticeship or apprenticeship.
8. Verify 500 hours of exceptional work experience as outlined in a student’s IEP. This can be paid or unpaid and occur over multiple year between the time of enrolling in 9th grade and graduating high school.

Students entering high school in 2020-2021 and thereafter, must meet ONE or a combination of the following:

1. Score Proficient or higher for reading or mathematics or both reading and mathematics on the student’s 8th grade state-required assessment.
2. Score at least an Apprentice in reading and mathematics on the 10th grade state-required assessments. Students who do not meet the minimum criteria on one or both assessments may retake the reading and/or mathematics assessments twice annually in the 11th and 12th grades of high school enrollment.
3. The principal may submit a collection of student evidence to the superintendent for review and approval.

PRE-COLLEGE MINIMUM CURRICULUM FOR ALL KENTUCKY PUBLIC UNIVERSITIES AND COLLEGES

*Research your colleges prior to your junior year to make sure
you are meeting admission requirements for your selected schools.*



- English** 4 Credits
- Mathematics** (Algebra 1, Geometry, Algebra II, and one math elective.) 4 Credits
- Science** 3 Credits
- Social Studies** 3 Credits
- Health and Physical Education** 1 Credit
- Art and Humanities** 1 Credit
- World Language (The 2 credits must be of the same language.)**..... Demonstrated Competency or 2 Credits
Completion of Level 2 of a World Language is completion of the pre-college curriculum requirement.
- Recommended Electives:** Additional math, science, social studies, world language, fine arts,
and a digital literacy (computer application) course.

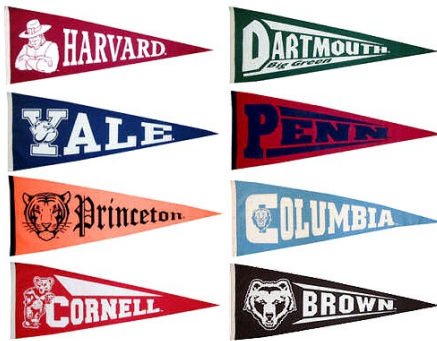

Recommended Pre-College Curriculum FOR SELECTIVE COLLEGES

(Example: Centre, Duke, Wake Forest, Harvard, Centre, etc.)

English (including intensive composition courses)	4 Credits
Mathematics (4 credits or study through Calculus)	4 Credits
Science (3 credits of laboratory science)	3 Credits
Social Studies	3 Credits
World Language (3 credits of the same world language)	3 Credits
Fine Arts/Humanities.....	1 Credit
Health/PE.....	1 Credit
Electives	3 Credits

CONVERSION CHART FOR ATTENDING A BLOCK SCHEDULE		
Years spent in a 6-period day	Years spent in a Block Schedule	Credits Required
4	0	22
3.5	0.5	22.5
3	1	23
2.5	1.5	23.5
2	2	24
1.5	2.5	24.5
1	3	25
0.5	3.5	25.5
0	4	26



AP Capstone is comprised of two AP courses—AP Seminar and AP Research. Students who earn scores of 3 or higher in AP Seminar and AP Research and on four additional AP Exams of their choosing will receive the AP Capstone Diploma™.

This signifies students' outstanding academic achievement and attainment of college-level academic and research skills. Students who earn scores of 3 or higher in both AP Seminar and AP Research but not on four additional AP Exams will receive the AP Seminar and Research Certificate™.

For more information, go to:
<https://apcentral.collegeboard.org/courses/ap-capstone>

GRADUATION PLAN at HENRY CLAY HIGH SCHOOL



<u>Grade 9</u>	<u>Grade 10</u>	<u>Grade 11</u>	<u>Grade 12</u>
English 1	English 2	English 3*	English 4
Math	Math	Math	Math
Science	Science	Science	Elective
Government	World History*	U.S. History	Elective
Elective	Health/PE	Elective	Elective
Elective	Elective	Elective	Elective



*Arts and Humanities is embedded in World History and English 3 awarding 1/4 credit for each semester.

SCHEDULE CHANGES AND CREDITS



- **IMPORTANT!!!!** Students can change an elective during the first 5 days of the semester if there is space, but options are limited because classes are offered based on student demand in the spring. Some courses reach their capacity and cannot accept additional students. Most all courses are offered for a full-year. Students cannot switch or change classes in the middle of the semester or after the 1st semester for full-year courses. Counselors cannot grant requests for a teacher or hour change after the start of the first day of school.
- Henry Clay is the only high school in Fayette County on a 6-period day. Henry Clay's schedule provides students with the opportunity to earn a total of 25 credits (6 periods X 4 years plus the embedded Arts/Humanities credit). Marching band is offered at 7:25 a.m. or after school giving these students a 7-period day. Students may also take Health/PE during the summer giving an opportunity for more credits.
- Students receive a 1/2 credit for each course successfully completed each semester with a 65% (D) or better. **Grades are based on each semester. Fall semester grades and spring semester grades are not averaged together.** However, KEEES money is based on the average unweighted GPA for both fall and spring semesters.
- Students may request a Level change (AP to Advanced or Advanced to General) at any time during the first 12 weeks or after the completion of the first semester. **Grades from the previous class transfer to the new class with the student if the change is made during the first 12 weeks. Students MUST see their counselor prior to the last day of the 12 weeks as reported on the Grade Reporting Periods calendar.**

SCHEDULING TIPS

- ENGLISH:** Students should be aware of the recommended and required summer readings. The advanced curriculum is more rigorous and requires more outside class time completion of work and reading. AP levels are taught at a college pace.
- MATH:** Freshmen taking any course above Algebra I **MUST** be enrolled in the Advanced level. It is recommended that students have a 245 on the MAP Math test and successfully completed Envision Algebra I before enrolling in Adv. Geometry.
- SCIENCE:** For Advanced Biology, a MAP Math score of 240 and a MAP Reading score of 228 is strongly recommended. It is also suggested they be enrolled in a math course higher than Algebra I. There is a substantial difference in the math involved in Advanced Chemistry and Advanced or AP Physics than that of the introductory courses.
- SOCIAL STUDIES:** All 9th grade students take Advanced Government or AP Government & Politics. Since AP Government & Politics is taught at a college level, it is strongly recommended for students to have a MAP Reading score of 233, a strong work ethic, maturity, and an interest in government. Students should also have the recommendation of their current 8th grade social studies teacher. AP classes require daily reading and homework.
- WORLD LANGUAGES:** Students who successfully complete the second level of a world language are considered to have completed the pre-college curriculum. Students wishing to take Level 2 or above for the first time in high school are encouraged to take the STAMP (Standards-based Assessment and Measurement of Proficiency) which will help determine a student's placement. The cost is \$25 and checks should be made payable to Henry Clay High School. Dates for testing will be announced.
- ELECTIVES:** Students should be very serious when selecting an elective. The master schedule and staffing are determined by student requests. Changes may not be possible because of capacity. **Electives cannot be changed after the 5th day of school.** All electives are year-long courses. See the "Schedule Changes and Credits" on the previous page.

GRADING/REPORTING and INFINITE CAMPUS

- High schools are on a semester system (18 weeks) and will receive final grades at the end of each semester. **Progress reports are issued to students every 6 weeks. Final semester grades are mailed home to parents.** To register or login to an Infinite Campus account, go to www.fcps.net and click Students then Infinite Campus Portal.
- Students are awarded 1/2 credit per semester in grades 9–12 upon successful completion of a one-semester course. Students who fail a semester course and wish to remove the "F" from the GPA calculation may do so by:
 - Repeating the course during the regular term for general and advanced levels.
 - Taking the course through e-School if it is a general level course.

The repeated course must be at the same level or higher to remove the "F" from the GPA calculation.
- The following criteria or some combination is used when determining the final grade:**
 - Formative (40% of the Grade):** Assigned class work which may include participation, homework, seatwork, note-taking, discussion, quizzes, and/or portfolios and notebooks.
 - Summative (40% of the Grade):** Test/Assessments, quizzes, and Special Projects
 - Final Exam (20% of the Grade):** End of Course Assessments or Final Exams.
- High School Grading Standards:** Students will have their GPA calculated on a 4.0 system. Students are no longer ranked at Henry Clay High School.
- Calculating the GPA:** To calculate a GPA, divide the total amount of quality points earned by the total credits attempted. Most public colleges and universities use the unweighted GPA for admissions and scholarships. Please make sure you investigate your options and know the criteria of the colleges in which you are interested in attending.



<u>Transcript Grade</u>	<u>Unweighted Quality Points</u>
A.....	4.0
B.....	3.0
C.....	2.0
D	1.0
F.....	0

- How to be Promoted to the Next Grade Level:** Grade promotion is based on credits. Each class is worth 1/2 credit per semester giving students the opportunity to earn 6 credits per year (1/2 credit X 6 classes X 2 semesters = 6). Students must earn 65% or higher for the semester to earn credit. Students are required to have 22 credits to graduate—see graduation requirements on Page 1.



Before the first day of school, students must earn:	to be Promoted to:
5 Credits	10th Grade (Sophomore Level)
10 Credits	11th Grade (Junior Level)
16 Credits	12th Grade (Senior Level)



Get Paid for Good Grades

Kentucky Educational Excellence Scholarship

Every year that you attend a certified Kentucky high school and earn at least a 2.5 GPA, you will earn a KEES award ranging from \$125 (for a 2.5 GPA) to \$500 (for a 4.0 GPA). That's not all! You may also earn bonus money for a 15+ on the ACT. When combined with your GPA awards, that means you may earn up to \$2,500 for each year of college!

KEES AWARD AMOUNTS			
GPA	BASE AMOUNT	ACT SCORE	BONUS AMOUNT
2.50	\$125	15	\$36
2.60	150	16	71
2.70	175	17	107
2.75	187	18	143
2.80	200	19	179
2.90	225	20	214
3.00	250	21	250
3.10	275	22	286
3.20	300	23	321
3.25	312	24	357
3.30	325	25	393
3.40	350	26	428
3.50	375	27	464
3.60	400	28+	500
3.70	425		
3.75	437		
3.80	450		
3.90	475		
4.00	500		

Amounts may change based on funding.
Only AP and dual credit courses are weighted.



KHEAA will post KEES awards online at the end of each school year. Create a Zip Access user ID and password to access your data at kheaa.com for the first time. If no record is found or if your data is incorrect, you should contact your guidance counselor. You must earn a 2.5 cumulative GPA your first year in college and a 3.0 cumulative GPA thereafter to retain your full KEES award.

All information on this page was obtained from the Kentucky Higher Education Assistance Authority Education Guide. For more information go to www.kheaa.com or call 800-928-8926.

HOW MUCH WILL YOU GET FOR COLLEGE?

If you receive a KEES award for your freshman year, enter your final GPA and the award amounts on the line. For future years, enter your final GPA or predict your GPA and highest ACT score, filling in the blanks. Add up your amounts, and you can estimate what your total award will be to help you pay for each year of college.

	GPA	Amount
Freshman Year	-----	\$-----
Sophomore Year	-----	+\$-----
Junior Year	-----	+\$-----
Senior Year	-----	+\$-----
Highest ACT Score	-----	+\$-----
Total Estimated Award =		\$-----



TESTING AT HENRY CLAY

Credit Recovery programs use MAP test scores or national testing scores to determine eligibility. Students should have at least a 230 on the MAP Reading or an 18 on the ACT Reading to be eligible for programs such as eSchool or night school because of their independent online expectations.

- MAP testing is conducted three (3) times a year for 9th and 10th grade students only.
- The PSAT is used in the 11th grade as a qualifying score for the National Merit Scholarship Program. Students in the 11th grade pay to take the PSAT. Registration is in early September.
- The ACT is currently given to 11th grade students in the spring for free. This is subject to change based on state initiatives.
- AP Testing is administered in May each year. Students should see their AP teacher for registration information.
- Students may register at www.actstudent.org for the ACT. Check the website for dates and deadlines.
- Students may register at www.collegeboard.org for the SAT. Check the website for dates and deadlines.
- The ASVAB is a great measuring tool for strengths, weaknesses, and potential jobs suitable for you. Students are not required to join the military or have any interest in the military. It is a timed multi-aptitude test which identifies areas that need improvement.

ACT's College Readiness Benchmark Scores to determine college readiness:

English—18 Math—19 Reading—20 Science—24

HENRY CLAY HIGH SCHOOL PATHWAYS



The career pathway is the central focus for developing the Individual Graduation and Learning Plan. To prepare students for transition to postsecondary education, work or military, students should select high level academic and career-related courses and work-based learning experiences. The first-year course is considered “Exploring”. When a student has completed 2 courses within a single pathway, they become “Concentrators” and are eligible to sit for the End-of-Program Assessment. Students passing the End-of-Program Assessment receives their Career Readiness Certificate.



BUSINESS AND MARKETING			
<u>ADMINISTRATION SUPPORT</u>	<u>E-COMMERCE</u>	<u>MANAGEMENT AND ENTREPRENEURSHIP</u>	<u>MARKETING</u>
Digital Literacy	Digital Literacy	Digital Literacy	Marketing Applications
Personal Finance	Marketing Applications	Personal Finance	Personal Finance
Intro. to Management	Entrepreneurship	Intro. to Management	Sports & Event Marketing
Business Co-op	Business Co-op	Entrepreneurship	Entrepreneurship
		Business Co-op	

FAMILY AND CONSUMER SCIENCES	
<u>CULINARY AND FOOD SERVICES</u>	<u>EARLY CHILDHOOD EDUCATION</u>
Life Skill Essentials	Life Skill Essentials
Foods and Nutrition	Early Lifespan Development
Adv. Foods and Nutrition	Child Development Services 1
Culinary Arts 1	Child Development Services 2
Culinary Arts 2	Co-op: Early Childhood Education
Culinary Internship	

FCPS TECHNICAL CENTERS

Descriptions of technical center programs/pathways can be found on page 18 and on their individual websites.

Eastside
www.eastside.fcps.net

Locust Trace
www.locustrace.fcps.net

Southside
www.southside.fcps.net

MILITARY

Army JROTC 1
Army JROTC 2
Army JROTC 3
Army JROTC 4



ENGINEERING AND TECHNOLOGY			
<u>AUTOMATION</u>	<u>CIVIL</u>	<u>DESIGN</u>	<u>MECHANICAL</u>
Engineering 1	Engineering 1	Engineering 1	Engineering 1
AP Computer Principles OR AP Computer Science	AP Computer Principles OR AP Computer Science	AP Computer Principles OR AP Computer Science	AP Computer Principles OR AP Computer Science
Robotics Automation	Civil Engineering	Unmanned Aircraft Systems	Robotics Engineering
Robotics Engineering	Unmanned Aircraft Systems	Engineering Capstone	Unmanned Aircraft Systems
Unmanned Aircraft Systems	Engineering Capstone	Engineering Co-op	Engineering Capstone
Engineering Capstone	Engineering Co-op		Engineering Co-op
Engineering Co-op			

The Liberal Arts Academy at Henry Clay High School

The Liberal Arts Academy at Henry Clay challenges its students in all disciplines with required Academy courses that are specially designed or adapted for the Academy's gifted and talented population. These courses combine acceleration, differentiation and enrichment to stimulate and extend student learning.



For its freshmen class, the Liberal Arts Academy accepts qualified students each year through a district application process. Parents or students must complete an online application through the Office of Gifted and Magnet Education by an early October date. Eligibility for the Liberal Arts Academy requires scores in the 9th stanine (96th percentile or higher) on nationally normed, math and reading achievement tests and a cognitive abilities test. Students must also have a supporting score in the 8th stanine (89th percentile or higher) on one additional nationally normed math test and reading test to be eligible. Students within the Accelerated Clusters at Winburn Middle or Tates Creek Middle Schools are automatically eligible for the Liberal Arts Academy.

The Academy curriculum is rigorous and requires several AP courses. Students have the option to pursue the AP Capstone Diploma or the AP Capstone Research Certificate. To view the most up to date Academy requirements and course of studies, please visit the Liberal Arts Academy web site at www.fcps.net/Page/9203 or email Catherine Stephens at catherine.stephens@fayette.kyschools.us or call at (859) 381-3423 Ext. 1133.

ACADEMY INDIVIDUAL GRADUATION PLAN for the MEDALLION				
Only Academy Students May Enroll in Academy Labeled Courses				
	Grade 9	Grade 10	Grade 11	Grade 12
1	Academy English	Academy AP Seminar (English)	Academy AP Language	Academy AP Literature
2	Advanced Math	Advanced or AP Math	Advanced or AP Math	AP or Dual Credit Math
3	Academy Biology	Academy Chemistry	AP Physics	AP Research
4	Academy AP US Government	Academy AP World History	Academy AP U.S. History	Elective: AP Level
5	World Language	World Language	World Language	Health/PE*
6	Elective:	Elective:	Elective:	Elective:

* Health/PE can also be completed during summer school between the student's 9th and 10th grade year.

The Academy Medallion requirements take effect starting with the Class of 2019.

- Students must be prepared to take Adv. Geometry in the 9th grade. If students do not have Algebra 1 on their middle school transcript, they must take both Algebra 1 and Advanced Geometry their freshman year.
- Seniors must be in a college-credit bearing math class. AP Computer Science will only fulfill the math requirement for senior year if students have already taken AP Calculus AB.
- Students must take three consecutive years of the same world language. All students are strongly encouraged to take through the AP level.
- All students must earn a "C" or higher each semester of each class in order to earn the Academy medallion. Students failing to earn a "C" may choose to repeat the class and it must be taken at the same level.
- All students must take at least one AP elective course that does not fulfill their other requirements for the Academy medallion (i.e. A student who will take the AP level of their world language to meet their third year requirement may not also count that as an AP elective.)
- Students must complete 20 hours of community service annually.
- Student must take the PSAT, ACT or SAT every year (except senior year) and provide proof of testing to the Academy Facilitator.
- Students must attend the monthly Academy class meetings. Students who have an unexcused absence must complete an additional two hours of community service to maintain medallion eligibility.

ADDITIONAL OPPORTUNITIES FOR COLLEGE CREDIT

OPPORTUNITY MIDDLE COLLEGE: A partnership with BCTC—Opportunity Middle College is a partnership between Fayette County Public Schools and Bluegrass Community Technical College (BCTC). Students have the opportunity to enroll in both college and high school courses earning both high school and college credit for these courses. All courses are taught at the BCTC campus and students do not attend classes at Henry Clay's campus. Students who will be a junior or senior next fall are eligible to apply. Students must submit ACT scores along with a high school transcript to verify they can successfully complete the early college curriculum. Fees may be required. See your high school counselor for an application.

WESTERN KENTUCKY UNIVERSITY CAROL MARTIN GATTON ACADEMY OF MATHEMATICS AND SCIENCE: The Gatton Academy at WKU is a public, **residential** high school for juniors and seniors who have demonstrated a desire to pursue advanced careers in science, technology, engineering, and math (STEM) fields in addition to exceptional education performance. Student live in Schneider Hall on the WKU campus and attend classes at WKU earning both college and high school credit. A minimum ACT math score of 22 or SAT math score of 520 is required. Visit www.wku.edu/academy for additional information and for an application. All materials must be submitted by February 1.



MOREHEAD STATE UNIVERSITY CRAFT ACADEMY FOR SCIENCE AND MATHEMATICS:

The Craft Academy at Morehead State University is a unique **residential** educational opportunity for gifted and talented juniors and seniors focusing on math and science courses while engaging in electives in arts and humanities. The Craft Academy offers unique, project-based STEM+X courses that will enrich education experiences. Students live in a newly renovated residence hall designed for high school-aged students. A minimum ACT math score of 22 or SAT math score of 520 is required. Visit www.moreheadstate.edu/craft-academy for more information and for an application. All materials must be submitted by February 1.

PREPARATIONS FOR COLLEGE ADMISSIONS AND CAREER READINESS

9th and 10th Grade

- Design a college and/or career preparatory program of study.
- Maintain a high grade point average (2.5 or above is recommended).
- Take the PSAT to determine areas of academics that need improvement.
- Start developing a resume of awards, extracurricular activities, clubs, volunteer experiences, and work experiences.
- Athletes should become familiar with NAIA and NCAA requirements.



11th Grade

- September
 - ✓ Register for the PSAT to qualify for National Merit Scholarships and/or Governors Scholars Program.
 - ✓ Attend Junior Meetings with your counselor.
- October
 - ✓ Take the PSAT to prepare for the SAT, Governor's Scholar Program, and for the National Merit Scholars Program.
 - ✓ Attend the College Fair at Heritage Hall.
- During the school year:
 - ✓ Update and maintain your resume.
 - ✓ Request admission packets and information from colleges and keep a list of colleges.
 - ✓ Determine required college entrance tests, minimum GPA requirements, and the application process.
 - ✓ Visit www.kheaa.com and click on "Publications" to find the Getting Ready handbook for high school juniors.
- February—Juniors will meet with their counselors about:
 - ✓ Senior year scheduling.
 - ✓ Summer enrichment opportunities.
 - ✓ Post-secondary possibilities.
- Spring—Take the ACT.
- April or June—Take the ACT and/or SAT.
- May—AP testing for AP classes.
- Athletes should register with NCAA or NAIA at the end of their junior year and make sure they are on track.

12th Grade

- August
 - ✓ Register for the September ACT or October SAT to ensure your scores are delivered to colleges prior to Dec. 1.
 - ✓ Make sure you are taking a full academic load throughout your senior year. Final admission to some colleges is dependent on maintaining a strong academic standing.
 - ✓ Finalize college applications and make a list of deadlines.
 - ✓ Familiarize yourself with the scholarship listing on the Henry Clay website.
- September
 - ✓ Attend Senior Meetings with your counselor.
 - ✓ Prepare and get ready to file your FAFSA.
 - ✓ Start attending sessions with college representatives. A sign-up book is located in the counseling office and on the Henry Clay counseling webpage.
 - ✓ Determine if your college choices use the Common Application (www.commonapp.org). If you are only applying to one college, do not use the Common Application.
- October
 - ✓ **October 1 - FAFSA can be submitted.**
 - ✓ Attend College Fair at Heritage Hall.
 - ✓ Participate in College Application Week at Henry Clay.
- November—Finalize all transcript requests and recommendations before November 10 for the December 1 deadlines. Use Parchment at www.parchment.com to request transcripts electronically.
- December—before December 5—Submit transcript requests and recommendation requests for January deadlines.
- January—Go to www.parchment.com to request Mid-Year Reports to be sent to colleges.
- February—If you have decided on which school to attend, notify the college of your decision and let any other colleges that have accepted you know about your decision.
- April—Follow up on your financial aid packages and compare lenders if you will need student loans.
- May—Remember the May 1 deadline to notify colleges of your decision if necessary.
 - ✓ AP testing for AP classes.
 - ✓ Let the counseling office know of your college decision and scholarships received. This will be completed on a form provided to you in your English class during May.
 - ✓ Go to www.parchment.com to request final transcripts to be sent to your school of choice before August 1.
 - ✓ Write thank-you notes to those who helped you through the process.



English Department Summer Reading 2020-2021

For all Advanced, AP, and Academy courses, the listed works **MUST** be read prior to the first day of the fall semester. Keep copies of the works accessible. **Students will be tested on all readings on the first day of school or shortly thereafter.** Grades earned on summer reading tests will follow students who transfer from a higher level to a lower level English class. Students who move from lower level classes to levels that require summer readings or newly enrolled students will have one month from the date of transfer to complete all required summer readings and assignments.

INCOMING 9TH GRADE PARENTS, GUARDIANS, AND STUDENTS: We offer a variety of books from which students can choose in order to give them the ability to find something to read that interests them. Please review the books using online resources, by talking to a librarian, or by other means to make sure the content is appropriate for your student.

*English 1 (9th Grade)—Students are recommended (not required) to read ONE book from the Adv. English 1 list.

*Advanced English 1 (9th Grade)—Students must read TWO books from the following list:

1. Jackaby by William Ritter
2. Just One Day by Gayle Forman
3. I Hunt Killers by Barry Lyga
4. Mosquitoland by David Arnold
5. Challenger Deep by Neal Shusterman
6. Persuasion by Jane Austen
7. Watership Down by Richard Adams
8. Aristotle and Dante Discover the Secrets of the Universe by Benjamin Alire Saenz
9. Between Shades of Gray by Ruta Sepetys
10. All the Bright Places by Jennifer Niven

*Freshman Academy English 1—One required reading: The Odyssey (Fitzgerald Translation).

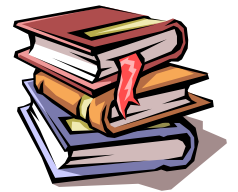

*English 2—Summer reading is not required. It is recommended for students to read a book of their choice.

*Advanced English 2— Students are required to read Life of Pi by Yann Martel.

*AP Seminar for Sophomores (Academy and Non-Academy): Students will receive a summer writing assignment (with required readings chosen by the students) after registering for the class. The assignment will be on the HC Media Center website.

*English 3—Summer reading is not required, but it is recommended for students to read a book of their choice.

*Advanced English 3—Students are required to read TWO books: Affrilachia by Frank X. Walker AND ONE of the following: Clay's Quilt by Silas House OR Hillbilly Elegy: A Memoir of a Family and Culture in Crisis by J.D. Vance.

*AP Language and Composition for Non-Academy Juniors—ONE required book: David and Goliath by Malcolm Gladwell. Be prepared to analyze how the author's rhetorical choices contribute to the purpose and meaning of the work.

*ACADEMY AP Language and Composition—TWO required books: The Teenage Brain by Frances E. Jensen/Amy Ellis Nutt AND Writing with Style 3rd edition by John R. Trimble. Students will also receive a summer assignment. This assignment will be on the HC Media Center website and the Academy website.

*English 4 and Advanced English 4—There are no recommended or required readings for these classes.

*AP English Literature for Non-Academy Seniors —THREE required readings: 1. The Color Purple by Alice Walker, 2. Macbeth by William Shakespeare, AND 3. How to Read Literature Like a Professor by Thomas Foster.

*ACADEMY AP English Literature & Composition—Students must perform the following tasks:

- A) Select, read, and annotate one pair of books, both a classic and a work of contemporary fiction, from the list below AND
 - B) Complete the multi-genre assignment found on the HCHS Media Center resource page. Students can also pick up the complete handout with rubric in the counseling office or Ms. Whitman's Room #35.
1. Pride and Prejudice by Jane Austen AND Homegoing by Yaa Gyasi
 2. Things Fall Apart by Chinua Achebe AND The Poisonwood Bible by Barbara Kingsolver
 3. A Passage to India by E.M. Forster AND The Sympathizer by Viet Thanh Nguyen
 4. The Stranger by Albert Camus AND Extremely Loud and Incredibly Close by Jonathan Safran Foer
 5. Invisible Man by Ralph Ellison AND In the Time of the Butterflies by Julia Alvarez

*Dual Credit English 101/102—At the time of this publication, BCTC and Fayette County Public Schools had not determined an agreement for dual credit classes. To qualify for Dual Credit English 101/102, students must obtain a score of 18 on the ACT English subsection and 20 on the ACT Reading subsection prior to May 15. The last possible date a student can take the ACT is April. Also, at the time of this publication, BCTC had not determined the textbooks to be used in ENG 101/102. The English 101/102 teachers will announce the required textbooks on the first day of school on the course syllabus. Students will then have two weeks to purchase their own copies of the texts. In the past, textbooks have ranged between \$100 and \$200. Go to www.kheaa.com for information about the Mary Jo Young Scholarship to help with textbook fees. A KHEAA account must be created to apply. The deadline in the past was May 15.



COURSE DIRECTORY AND DESCRIPTIONS

NOTE WHEN SELECTING COURSES: The master schedule is determined by student selection in the spring. It is **VERY** important that students make their selections carefully. Once the master schedule is developed, there is very little room for changes. Staffing and courses are determined in late March for the following school year. Students cannot expect to change their course selections after April because of staffing and course offerings. Most courses are a full year unless otherwise stated as a one-semester course.

LANGUAGE ARTS:

ENGLISH 1—Integrates composition, literature and language studies. **Summer reading is recommended. See summer reading list.**

ENGLISH 2—Integrates the study of literature, composition, vocabulary, and language usage with a strong focus on helping students develop effective oral, digital literacy, and reading skills. Student will build their capacity for narrative, descriptive, expository, and persuasive writing.

ENGLISH 3—Integrates American literature, composition, and language. Oral and written activities will be emphasized as a means of learning.

ENGLISH 4—Integrates English and world literature, composition, and language. Writing to learn and flexibility in writing will be emphasized.

ADVANCED ENGLISH 1: This course will allow students to explore what it means to come of age amidst common teenage struggles through fiction, nonfiction, poetry, and drama incorporating extensive experience through group work and individual critical thinking. Handbooks will be given to each student for home study/work. **PREREQUISITE: Language Arts Teacher Recommendation. SUMMER READING IS REQUIRED. See summer reading list.**

ADVANCED ENGLISH 2: This course integrates the study of literature, composition, vocabulary, and language usage with a strong focus on helping students develop effective oral communication, digital literacy, and reading skills. Students will build their capacity for narrative, descriptive, expository, and persuasive writing. The curriculum is rigorous with activities and assessments to continually challenge students. **SUMMER READING IS REQUIRED.**

AP SEMINAR (Academy and Non-Academy) for 10th Grade Students—Fulfills the requirements of English II as well as part of the AP Capstone Program. Additionally, this course is meant to be foundational for all other AP courses, including AP Language and Composition and AP Research. Students will implement multiple research methodologies and consider multiple points of view to develop deep understanding of complex issues. **PREREQUISITE: Recommendation of 9th grade English teacher and a passing grade in English I. A SUMMER ASSIGNMENT IS REQUIRED.**

ADVANCED ENGLISH 3—Introduces students to American literature and ideas and exposes them to the types of writing (especially that of the research process) expected of them after high school. Preparation for the state-mandated ACT is included. Class assignments including reading are nearly always completed outside of class. Students in this course will have mastered skills outlined in English I and II. **SUMMER READING IS REQUIRED.**

ADVANCED ENGLISH 4—Expect more in-depth assignments, reading, and independent work at a faster pace than the English 4 course described above. Basic skills to progress to formal writing, intensive vocabulary study, thematic literary study, and independent higher level reading are expected. **PREREQUISITE: Recommendation of English 3 teacher is requested.**

AP ENGLISH LANGUAGE AND COMPOSITION for JUNIORS—Comparable to a college composition class, the course provides training for the skilled reading of prose written in a variety of periods, disciplines, and rhetorical contexts. The course is a preparation for the Advanced Placement Language and Composition Examination. **SUMMER READING IS REQUIRED.**

AP ENGLISH LITERATURE AND COMPOSITION for SENIORS—Provides for a careful reading of literary works for the purposes of developing critical standards for the independent sensitivity to literature as shared experience. The course is a preparation for the Advanced Placement Literature and Composition Examination. **SUMMER READING IS REQUIRED!**

ENGLISH 101 (DUAL CREDIT)—Focuses on academic writing. Provides instruction in drafting and revising essays that express ideas in Standard English, including reading critically, thinking logically, responding to texts, addressing specific audiences, researching and documenting sources. Includes review of grammar, mechanics, and usage. Students must purchase their own textbooks. **CREDIT: ½ credit is given for English IV and 3 hours of college credit is awarded for English 101 from BCTC for the 1st semester upon successful completion of a “C” or better. PREREQUISITE: ACT score of 18 or higher in English and a 20 or higher in Reading AND completed BCTC application.**

ENGLISH 102 (DUAL CREDIT)—Emphasizes argumentative writing. Includes continued instruction and practice in reading critically, thinking logically, responding to texts, addressing specific audiences, and researching and documenting credible academic sources. This course requires students to purchase their own textbooks. **CREDIT: ½ credit is given for English IV and 3 hours of college credits are awarded for English 102 from BCTC for the 2nd semester upon successful completion of a “C” or better. PREREQUISITE: Successful completion with a “C” or better in English 101.**

AFRICAN-AMERICAN LITERATURE: Black literature from its earliest origins in Africa to the present United States will be explored. Students will discuss the African literary tradition and learn to recognize major Black authors. Students will critique texts as part of a larger cultural debate.

ADVANCED AMERICAN HERO IN FILM—Explores concepts of the American Hero as portrayed in American film and television. Students will read about the history of various time periods and then view films in and out of class which depict the Hero and its varied interpretations throughout history.

BROADCAST JOURNALISM—Production of news, interviews, academics, and sporting events in and around Henry Clay. Students learn skills and techniques for both in front of and behind the camera. This class will be responsible for delivering live news to the school five days a week and will require students to work outside the school day when covering sporting events. **Advanced Broadcast Journalism 2** is a continuation of 1 with more responsibilities.

ADVANCED DEBATE 1—Advanced research techniques to produce documentation affirming and negating specific topics. They will use cases to debate fellow students. Note-taking skills are very important for this course. **Advanced Debate 2** is a continuation of Debate I. Students will do more in-depth study of cases and present more in-depth debate with fellow students. **PREREQUISITE: A grade of “C” or higher in Debate I.**

DRAMA 1 (INTRO TO THEATRE) - The 1st semester focuses on theater production from a technical aspect. The elements of design, staging, technical aspects, and other physical features of drama are studied. The 2nd semester focuses on the techniques of acting with stage experience as an emphasis.

DRAMA 2—A continuation of Drama 1. This second year course offers serious drama students an opportunity to refine their acting skills and broaden performance repertoires. It is designed for active participation. **PREREQUISITE: Successful completion of Drama 1.**

JOURNALISM (NEWSPAPER 1)—Students study advertising, photography, graphic design, layout and editing. Students will produce the school newspaper. Students may continue their work with the school newspaper in Advanced Journalism 2 and 3 with the recommendation of the teacher.

READING DEVELOPMENT—This course will provide students the opportunity to improve their literacy and overall communication. The primary focus of year 1 will be on developing effective study habits, organizational systems, and test-taking strategies, while year 2 will focus on ACT reading and writing remediation and preparing for life after high school. This course is meant to support students in their other classes.

TV/RADIO PRODUCTION—Focuses on the production and evaluation of television programming and covers the basics of broadcast journalism as well as storyboarding, script writing and editing, oral communication skills, equipment operations, and video editing.

ADVANCED TV/RADIO PRODUCTION 2—Designed to provide motivated and experienced students leadership opportunities in the form of directing and producing various creative and practical projects using multimedia equipment and software. **PREREQUISITE: Successful completion of the Radio/TV Production, an individual project, letter to teacher explaining reason for pursuing education in Radio/TV Production, and teacher approval.**

YEARBOOK 1, ADVANCED YEARBOOK 2, and ADVANCED YEARBOOK 3—Offers extended in-depth, journalistic experience in yearbook production. General language skills will be refined and the techniques of yearbook production will be practiced with the yearbook as the final product.

MATHEMATICS:

ALGEBRA I—This course is for 9th grade students who have successfully mastered middle school math content.

GEOMETRY—Topics include constructions, inductive/deductive reasoning, points, lines, planes, angles, triangles, planar figures, similarity/congruence, circles, area, volume, coordinate geometry, and transformation. **PREREQUISITE: Successful completion of Algebra I.**

ADVANCED GEOMETRY—Taught at an accelerated pace for students with a high degree of proficiency in abstract mathematical ideas. This course includes the skills and concepts of Geometry but will differ in the approach and include rigorous formal proof. **PREREQUISITE: Successful completion of Envision Algebra I and a recommended score of 245 on the Math MAP test.**

ALGEBRA II—Expands on the mathematical concepts of Algebra I and Geometry. **PREREQUISITE: Successful completion of Algebra I and Geometry.**

ADVANCED ALGEBRA II—Includes skills and concepts of Algebra II, but covered in greater depth. Taught at an accelerated pace for students with a high degree of proficiency in abstract mathematical ideas. **PREREQUISITE: Successful completion of Envision Advanced Geometry.**

ALGEBRA 3 / TRIG—For juniors or seniors who have successfully completed the Algebra I/Geometry/Algebra 2 sequence and intend to take a college math course. Topics include relations and functions (including circular, trigonometric, etc.), complex numbers matrices, sequences, series, and probability. **PREREQUISITES: Successful completion of Geometry AND Algebra II.**

COLLEGE PREP MATH—For seniors who have not attained the math benchmark ACT score of 19 for college admissions. It is designed to help students improve their ACT score. Topics include remediation in algebra, geometry, and advanced math topics required for success in college level math classes. This course does not replace the 3 required math courses required for graduation. **PREREQUISITE: 12th grade students. This course is NOT NCAA approved.**

ADVANCED PRE-CALCULUS—For students who plan to take a regular calculus course in high school or college. Includes topics traditionally taught in Trigonometry and Analytic Geometry. **PREREQUISITE: Successful completion of Advanced Geometry AND Advanced Algebra II.**

PROBABILITY AND STATISTICS—For seniors wishing to study probability and statistics in a project and simulation environment. **PREREQUISITE: An ACT score of a 16 or higher. This course is for 12th grade students who have already received credit for Algebra I, Geometry, and Algebra 2.**

ADVANCED CALCULUS I—For students who have successfully completed Pre-Calculus. This course covers the material usually taught in differential and integral calculus. **PREREQUISITE: Successful completion of Advanced Pre-Calculus.**

AP CALCULUS AB and BC—Advanced Placement courses covering the material usually taught in differential and integral Calculus. Students who complete the course may take the Advanced Placement Exam in Calculus to attempt to earn college credit. **PREREQUISITE: AP Calculus AB requires successful completion of Advanced Pre-Calculus and a recommended ACT math score of a 24 or higher. AP Calculus BC requires successful completion of AP Calculus AB AND a passing score of 3+ on the AP Calculus AB exam. A summer assignment is also required for AP Calculus AB.**

AP STATISTICS—This Advanced Placement course includes study of distributions, relations in categorical data, random variables, use and abuse of tests and inference for linear regression. **PREREQUISITE: 12th grade students only, a preferred ACT Math score of 24, and successful completion of Adv. Algebra II.**

MATH 111—Contemporary Math (Dual Credit)—Provides an introduction to concepts and applications of mathematics, with examples drawn from such areas as voting methods, consumer finance, graph theory, number theory and game theory. This course does not serve as a prerequisite for any calculus course. This is a college level course worth 1/2 credit in high school math and 3 college credit hours at BCTC. **PREREQUISITE: 12th grade students with two years of high school algebra and a Math ACT score of 19. Completion of BCTC application and textbook fee is required. College credit of 3 hours is awarded for from BCTC upon successful completion of a “C” or better.**

MATH 150—College Algebra (Dual Credit)—For seniors which includes selected topics in algebra and analytic geometry developing manipulative algebraic skills required for successful calculus study. This is a college level course providing the successful student with 1/2 credit in high school math and 3 college hours at BCTC. **PREREQUISITE: 12th grade students with successful completion of Algebra II or higher math with a “C” or better, minimum ACT math score of 22, and recommendation of high school math teacher. Students planning to take AP Calculus are not permitted to take this course. Completion of BCTC application and textbook fee is required. College credit of 3 hours is awarded for from BCTC upon successful completion of a “C” or better.**

MATH 170—Elementary Calculus and its Applications (Dual Credit)—This senior course is an elementary college calculus course to be taken the 2nd semester of the Dual Credit route. Taking this class and MA 150 will fulfill the math requirement for many majors at UK. **PREREQUISITE: 12th grade students with successful completion with a “C” or higher in Math 150 AND a minimum ACT Math score of 27. Textbook fee is required. College credit of 3 hours is awarded for from BCTC upon successful completion of a “C” or better.**

SCIENCE:

Kentucky Academic Standards for Science suggest a sequence of Intro. Physics Earth/Space > Intro. Chemistry Earth/Space > Intro. Biology Earth/Space.

INTRO TO PHYSICS WITH EARTH/SPACE—Provides a foundation for further study in high school science. Physics is the study of motion and energy. **A \$5 lab fee is required.**

INTRO TO CHEMISTRY WITH EARTH/SPACE—Chemistry is the study of matter; it’s properties and how it changes both from a qualitative and quantitative viewpoint. **PREREQUISITE: Successful completion of Intro to Physics with Earth/Space and Algebra 1. A \$5 lab fee is required.**

INTRODUCTION TO BIOLOGY WITH EARTH/SPACE—Biology is the study of living organisms and how they interact with their environment. **PREREQUISITE: Successful completion of Intro to Chemistry with Earth/Space. A \$5 lab fee is required.**

ADVANCED BIOLOGY WITH EARTH/SPACE—Biology is the study of living organisms and how they interact with their environment. **PREREQUISITE: A MAP reading score of 228, MAP math score 240 and successful completion of Algebra 1. A \$5 lab fee is required.**

ADVANCED CHEMISTRY WITH EARTH/SPACE—See Intro to Chemistry above. This course is taught at an accelerated pace with high math expectations. **PREREQUISITE: Successful completion of Advanced Biology with Earth Space AND Algebra 1. A \$5 lab fee is required.**

ADVANCED PHYSICS WITH EARTH/SPACE SCIENCE: Studies include topics and physics and earth/space science providing a foundation for further study in high school science. Physics is the study of motion and energy. **PREREQUISITE: Successful completion of Advanced Chemistry with Earth/Space Science. A \$5 lab fee is required.**



SCIENCE ELECTIVES

BOTANY—This one-semester course focusing on the study of the plant kingdom. Topics include plant anatomy, plant evolution, plant ecology, and plant genetics. Laboratory and outdoor experiences will complement classroom activities. **PREREQUISITE: Successful completion of Biology. A \$5 lab fee is**

ENVIRONMENTAL SCIENCE—This one-semester course acquaints students with the physical, ecological, social and political principles of environmental science. This course shows how ecological realities and the material desires of humans often clash, leading to environmental degradation and pollution. **PREREQUISITE: Successful completion of Biology or Chemistry or taking concurrently.**

FORENSIC SCIENCE—This one-semester course is rich in exploration and lab investigation which applies many disciplines of scientific study to solve crimes. **PREREQUISITE: Successful completion of Biology or Chemistry or taking concurrently. A \$15 lab fee is required.**

ADVANCED HEREDITY—This one-semester course is an extension of the heredity/genetic concepts introduced in biology. Topics include mendelian and non mendelian inheritance, Chromosome Structure, DNA replication, transcription, and translation. **PREREQUISITE: Successful completion of Biology with a grade of at least 78% and successful completion of Chemistry or take Chemistry concurrently. Credit: ½ credit 1st semester.**

SCIENCE Continued...



ADVANCED HUMAN ANATOMY—Study of the anatomical and physiological functioning of human body systems from the cellular level to the organism level. Examples may include but are not limited to the skeletal system, muscular system, respiratory system, nervous system, circulatory system, cellular metabolism etc. This course is designed for the college bound junior or senior who is interested in pursuing a career in health sciences or health related fields such as medicine, physical therapy, nursing, pharmacy, and so on. **PREREQUISITE: Successful completion of Biology with a grade of at least 78% and successful completion of Chemistry or take Chemistry concurrently. Students who may suffer from allergies to animals such as cats or rabbits, or have allergic reactions to latex, should consult with the instructor prior to enrolling. A \$15 lab fee is required.**

ADVANCED MICROBIOLOGY—This is **one-semester** laboratory based course that is an extension of the concepts experienced in Advanced Biology. Students will investigate cellular function by studying cell structures. Proper laboratory techniques are stressed as infectious diseases and their relationships between microorganisms and humans will be studied. **PREREQUISITE: Successful completion of Biology with a grade of at least 78% and successful completion of Chemistry or take Chemistry concurrently. Credit: ½ credit 2nd semester.**

ZOOLOGY—This **one-semester** course focusing on the structure and function of various animal specimens by dissection of organisms. This course will examine the physiology, comparative anatomy, development, life history, evolution, and diversity of animal phyla. **Dissections are REQUIRED. PREREQUISITE: Successful completion of Biology. A \$5 lab fee is required.**

AP BIOLOGY—The emphasis in AP Biology will vary from year to year depending on the instructor and the advances being made in research. The teacher has the freedom to choose emphases and order of presentation of topics within the major framework of the outline. For the purpose of study, the biological sciences may be divided into several broad areas: molecular and cellular biology, organism biology and populations biology, microbiology and plant biology. **PREREQUISITES: Completion of Advanced Biology and Advanced Chemistry with a grade of 78% or better.**

AP CHEMISTRY—An overview of freshman college general chemistry. Topics include stoichiometry, acid-base equilibrium, kinetics, thermodynamics, atomic theory, organic chemistry, behavior of gases, descriptive and solution chemistry. **PREREQUISITE: Completion of Advanced Biology and Advanced Chemistry I with a grade of 78% or better and be currently enrolled in either Pre-Calculus, Calculus, or Calculus II. A \$5 lab fee is required.**

AP PHYSICS 1—Equivalent to a first semester college course in algebra-based physics. This course covers Newtonian mechanics, work, energy and power; mechanical waves and sound, and introductory circuits. Students must have a strong understanding of mathematics. **PREREQUISITE: Science sequence, plus successful completion of Algebra 2 and taking Pre-Calculus concurrently. A \$5 lab fee is required.**

AP PHYSICS 2—Algebra-based, introductory college-level physics course cultivate their understanding of Physics through inquiry-based investigations as they explore fluid mechanics, thermodynamics, electricity and magnetism, atomic and nuclear physics. The Physics C Mechanics portion of this course is equivalent to a one-semester, calculus-based, college-level physics course utilizing the student's knowledge of differential and integral calculus. **PREREQUISITE: Science sequence, plus successful completion of Advanced or AP Physics 1 and Calculus with a grade of at least 78% in each course. A \$5 lab fee is required.**



SOCIAL STUDIES

ADVANCED GOVERNMENT—Emphasizes the major themes of government through topics that lead to an understanding of being an active citizen in the United States and today's global society.

AP U.S. GOVERNMENT & POLITICS for 9th Grade—Provides students with an analytical perspective on government and politics in the United States. This course includes both the study of general concepts used to interpret U.S. government and politics and the analysis of specific examples. **Students should have demonstrated a strong work ethic, maturity, and an interest in government throughout middle school. It is recommended students have a reading MAP score of 233 or higher AND be recommended by their 8th grade social studies teacher.**

WORLD HISTORY—Focuses primarily on the historical, geographic, economic, governmental and cultural development of major civilizations after 1500, with a focus on the impact of the past on today's world. The first semester covers the period from the Renaissance to the French Revolution; the second semester covers the period from the French Revolution to the present.

ADVANCED WORLD HISTORY—Taught at an accelerated pace and includes a more in-depth study of World History. Students should be at an advanced reading level. **Recommendation of Social Studies teacher is requested.**

AP WORLD HISTORY—Develops a greater understanding of the evolution of global processes and contacts in interaction with different types of human societies. Focused primarily on the past 1000 years of the global experience, the course builds on an understanding of cultural, institutional, and technological precedents that, along with geography, set the human stage. This course is taught at an accelerated pace. **A teacher recommendation is requested. A "B" or higher in a previous social studies class and a MAP reading score of 233 is recommended. NON-ACADEMY STUDENTS will be invited to participate in a voluntary skills workshop to prepare them for the upcoming school year.**

AP WORLD HISTORY FOR ACADEMY STUDENTS—**Summer reading of 1493: Uncovering the New World Columbus Created by Charles Mann is required. Students will take a 55-question multiple choice test the first week of school.**

U.S. HISTORY—Historical, societal and political development of the United States from Reconstruction to the present. Students will study government at various levels, explore the contributions of various cultures to the development of the American experience, examine the transformation of the US economy, and analyze how geographic features have affected US development.

ADVANCED U.S. HISTORY—The Advanced course is taught at an accelerated pace and includes a more in-depth study of U.S. History.

AP U.S. HISTORY—Offered for the student with well-developed reading and analytical skills as well as maturity in thought and purpose. The focus is on depth and quality of work preparing the student for advanced college work in this subject area. **A teacher recommendation is requested.**

SOCIAL STUDIES ELECTIVES:

CRIMINAL JUSTICE—Introduction to the people and procedures of the criminal justice system. Particular attention will be given to the needs and interests of today's youth. The topics of study will include the history of the criminal justice system in America, prevention and causes of crime, modern police procedures and personnel, victims' rights and the rights of the accused, correction including prison, parole and probation, a comparison between criminal and civil law procedures, and studies concerning the costs of crime. Students should be prepared to participate in discussions of mature subject matter. **This course is open to 10th, 11th, and 12th grade students only.**

KENTUCKY STUDIES—This course brings the various elements together which are stressed in earlier grades. Topics include arts, civil rights, communications, traditions, education, environment, labor history, religions, the sciences, and transportation.

PSYCHOLOGY—Designed to introduce students to the basics of psychology, which is the study of behavior and mental processes. Includes common research methods, theories that seek to explain why people do the things they do and how biology affects behavior. Topics include learning, life-span development, memory, emotion, dreaming, personality, and psychological disorders. **This course is open to 10th, 11th and 12th grade students.**

ADVANCED POLITICAL SCIENCE—The judicial system, laws, and the courts from the Constitutional Convention to the present is one basic area covered. The second area deals with issues and concerns of state and local government. This course is taught at an accelerated pace. **This course is open to students who have completed, or are concurrently enrolled in US History or who have a teacher recommendation. A "B" or higher in previous social studies and English classes is suggested.**

ADVANCED SOCIOLOGY—Various aspects of human interaction are covered including the roles of an individual in the family, schools, neighborhoods, rural and urban communities, and other groups with which humans identify. This course is taught at an accelerated pace. **This course is open to 11th and 12th grade students only. A "B" or higher in previous social studies and English classes is suggested.**

SOCIAL STUDIES Continued...

AP COMPARATIVE GOVERNMENT & POLITICS—Illustrates the rich diversity of political life, to show available institutional alternatives, to explain differences in processes and policy outcomes, and to communicate to students the importance of global political and economic changes. **A teacher recommendation is requested. A “B” or higher in a previous social studies class and a MAP reading score of 233 is recommended.**

AP EUROPEAN HISTORY—Historical, geographical, economic, governmental, and cultural developments of major European civilizations. Students learn the chronology of the major events and trends from approximately 1450 through the present. **This course is open to 10th, 11th or 12th grade students. A teacher recommendation is requested. A “B” or higher in a previous social studies class and a MAP reading score of 233 is recommended.**

AP HUMAN GEOGRAPHY—A systematic study of patterns and processes that have shaped human understanding, use, and alteration of the Earth’s surface. Students examine human social organization and its environmental consequences. They also learn about the methods and tools geographers use in their science and practice. **This course is open to all students. A teacher recommendation is requested. A “B” or higher in a previous social studies class and a MAP reading score of 233 is recommended.**

AP PSYCHOLOGY—This course is offered for the student interested in pursuing college work in psychology and as preparation for the Advanced Placement Psychology Examination. Course content includes psychological research techniques, major schools of thought, brain-behavior relationships, learning theory, sensation and perception, human development, intelligence and creativity, and memory. **This course is open to 10th, 11th or 12th grade students. A teacher recommendation is requested. A “B” or higher in a previous social studies class and a MAP reading score of 233 is recommended.**



ART

ART I—Introduces students to the world of visual arts in a variety of ways. Students will learn to draw basic subject matter and paint in a manner of a famous artist. This course is primarily based on understanding and using the elements and principles of design. **A \$25 fee per semester is required.**

ART 2—Students will further explore a variety of art media through more involved projects. **PREREQUISITE: Art I with a “B” or higher. A \$25 fee per semester is required.**

COMPUTER ASSISTED ART—Students will become familiar with manipulating photos, creating posters and flyers announcing upcoming events for several school groups. Students will be creating fine art projects using Adobe Photoshop CS6. **PREREQUISITE: For students in grades 10, 11, or 12 who have successfully completed Drawing I or Art I with a “C” or better. A \$25 lab/printing fee per semester is required.**

COMPUTER ASSISTED ART 2—For students wanting to further their studies in the use of Photoshop and to learn basic uses of Illustrator. **PREREQUISITE: Computer Asst. Art 1 with a “B” or higher. A \$25 lab fee per semester is required.**

CRAFTS—This course focuses more on functional art than fine art. Topics include wood-burning, ceramics, embroidery, sewing, screen-printing, paper Mache, clock making, mosaics, and more.

ADVANCED DIGITAL PHOTOGRAPHY—Students will develop technical skills that lead to success in digital camera operation, as well as a working knowledge of the language of photography. **PREREQUISITE: Grades 10-12 who have successfully completed Computer Assisted Art, Yearbook, TV/Radio, or permission of instructor. Having own camera is encouraged but not necessary. A \$35 fee per semester is required.**

ADVANCED DIGITAL PHOTOGRAPHY 2—A personal camera is suggested but not required. Individualized projects will make up the majority of the curriculum for students in this course. **PREREQUISITE: Completion of Adv. Digital Photography 1 with a “B” or higher AND recommendation from instructor is required. A \$25 fee per semester is required.**

DRAWING 1—This course is designed to teach basic drawing skills. Students will explore several different drawing materials to include graphite, charcoal, pastels, and ink. Subject matter for projects ranges from still-life and portrait to abstract and non-objective. **A \$25 fee per semester is required.**

DRAWING 2—Further work with drawing media will be explored. Individualized projects will be implemented. **PREREQUISITE: Drawing I with a “B” or higher. A \$25 fee per semester is required.**

DRAWING 3—This is a continuation of Drawing 2. Individualized projects will be implemented. **PREREQUISITE: Drawing 2 with a “B” or higher and teacher permission. Open to 11th and 12th grade students only. A \$25 fee per semester is required.**

PAINTING 1—Students will develop techniques required in painting media and understanding the painting process. Functions of known artists’ works, schools, and styles will be explored. Watercolor and acrylic paints will be the most used painting media. **PREREQUISITE: Art I or Drawing I. A \$35 fee per semester is required.**

PAINTING 2—For students wanting to further their studies in Painting. An upper level curriculum will be explored using watercolors, acrylics, and possibly other painting materials. **PREREQUISITE: Painting I with a “B” or higher (NO EXCEPTIONS). A \$35 fee per semester is required.**

POTTERY 1—Introduces students to the medium of clay and the methods of clay construction, involving development of forming and finishing skills. **Space is limited. PREREQUISITE: Art I or Drawing I. A \$35 fee per semester is required.**

POTTERY 2—For students wanting to further their studies in Pottery. A strong understanding of clay and pottery techniques are required. **PREREQUISITE: “B” or higher in Pottery 1 AND recommendation from instructor. A \$35 fee per semester is required.**

ADVANCED PRINTMAKING 1/2—The art of creating prints, students will focus on enhancing media skills. Students will create more advanced printmaking artworks. **PREREQUISITE: For students in grades 10, 11, or 12 who have successfully completed Drawing I or Art I with a “C” or better. A \$35 art fee per semester is required.**

THEATER STAGECRAFT SCULPTURE—Students will learn the ‘ins and outs’ of theater production including but not limited to set design, costume design, set construction, and sound and lighting techniques. All students will help design the sets, costumes, lighting, and sound for all Henry Clay productions. **This course is open to all students. A \$25 art fee per semester is required.**

AP ART HISTORY—This is a special college-level course that is challenging and stimulating. This course requires more time than other high school art courses and gives the student great opportunity for individual progress and accomplishment. Students will examine major forms of artistic expression from the ancient world to the present and from a variety of cultures. **A SUMMER ASSIGNMENT IS REQUIRED.**

ADVANCED ART INDEPENDENT STUDY—Designed for students pursuing further independent instruction in visual arts. The curriculum is completely comprised of individualized projects to meet student needs. **PREREQUISITE: Completion of 2 visual art courses with “B” or higher AND recommendation from instructor. A \$35 fee per semester is required.**

ADVANCED ART PORTFOLIO DEVELOPMENT—For JUNIORS who plan to take AP Art Studio their senior year. This class will focus on the first half of the AP Art Portfolio with a variety of art media and subject matter. AP Art Studio will be a two-year program designed to help develop and perfect the student’s portfolios for submission. Students will be in class with AP Art Studio seniors to insure a fully implemented course of study. **PREREQUISITE: MUST have permission from AP Art Studio teacher to enroll. Summer work and a \$35 per semester fee is required.**

AP ART STUDIO—This is the most demanding art class offered requiring students to demonstrate college-level work. Students must complete a portfolio that demonstrates exceptional performance in one of three areas: drawing, two-dimensional design, or three-dimensional design. **PREREQUISITE: Payment of \$82 is required for the Art Portfolio Review. A \$35 art fee per semester is also required. Students must have the recommendation of their art teacher to enroll. Summer drawings will be assigned by the teacher during the SPRING semester.**





ARMY JROTC—Taught by retired military personnel with a goal to motivate, develop, and orient participants to be better citizens by education them in leadership position. JROTC is NOT a military recruitment program. Military tactics are NOT taught. Cadets are under no obligation to enter the military. JROTC assists in preparing students for future career and educational opportunities after high school. Students may start JROTC at level 1 in any year or semester.

COMPUTER SCIENCE:

AP COMPUTER SCIENCE PRINCIPLES—Intended to prepare students for further work in computer science or related fields. Includes principles of structured programming and introductory systems analysis. **PREREQUISITE: Successful completion of Algebra I with a “B” or higher.**

AP COMPUTER SCIENCE—Emphasizes object-oriented programming methodology with an emphasis on problem solving and algorithm development and is meant to be the equivalent of a college course. **PREREQUISITE: Successful completion or concurrently enrolled in Advanced Algebra 2.**

BUSINESS:

BUSINESS LAW—This class will provide students with an understanding of their legal rights and responsibilities in their everyday roles of consumers, citizens, and workers.

DIGITAL LITERACY—Formerly Computer Applications and Technology. Students will use the Microsoft Office Suite to learn how to properly format documents and reports using Word, Excel, PowerPoint, and Publisher. **A \$5 lab fee is required.**

ENTREPRENEURSHIP—This course provides students the skills needed to effectively organize, develop, create and manage their own business. **A \$5 lab fee is required.**

MARKETING APPLICATIONS—This class will introduce students to the marketing mix and relationships between consumers and businesses. Topics to be covered include social media marketing, advertising & consumer behavior.

ADVANCED OFFICE ADMINISTRATION—Formerly Advanced Computer Applications—This course is designed to provide students an advanced-level experience with practical applications of MS Office. Upon completion of this course, a student will be prepared to take the core level tests for Microsoft Office Specialist (MOS) Certification and/or the Administrative Support Skill Standard Assessment. **PREREQUISITE: Successful completion of Digital Literacy. A \$5 lab fee is required.**

PERSONAL FINANCE—Designed to provide students with knowledge and skills to manage one’s financial resources. Topics include economics, money in the economy, budgeting, credit, consumer rights, investments and retirement planning.

SPORTS AND EVENT MARKETING—This course is designed to develop a thorough understanding of the marketing concepts and theories that apply to sports and events, along with event management opportunities. A \$5 lab fee is required.

INTRODUCTION TO MANAGEMENT—Seniors Only—Emphasizes the skills needed for managing a business that involves the selection and supervision of employees including efficient use of time, personnel, facilities, and financial resources. Students will explore effective management strategies, and effective communication. **PREREQUISITE: Senior standing, employed within two weeks of the start of the first semester, AND completion of application with approval of the Business Management Coordinator. ALSO, successful completion of TWO Business/Marketing courses. A \$20 fee is required which will cover the lab fee and FBLA dues.**

BUSINESS EDUCATION CO-OP—Seniors Only taken with Intro. to Management—This is an internship for Career and Technical Education courses involves work-site experiences for high school students associated with their identified career pathway. **PREREQUISITE: By application only with teacher approval.**



FAMILY & CONSUMER SCIENCE:

ADULT LIVING 101—Prepares students for life after high school. Topics explored include college and career readiness, personal finance, consumer decisions, grocery shopping, cooking, health and safety, and navigating resources within the community. **Open to 11th and 12th grade students only who have not taken Life Skills.**

CHILD SERVICES 1 and 2—This course provides hands on time with children as you help in a classroom at Breckinridge Elementary school three days a week. Students will work with young children, learn the importance of understanding their developmental stage and get a chance to practice many things learned in child development. Students will earn credit for Child Services 1 for the 1st semester and Child Services 2 for the 2nd semester. **PREREQUISITE: Successful completion of Child Development. A \$30 fee is required for background check.**

INTERNSHIP: EARLY CHILDHOOD EDUCATION—This course is a supervised work site experience related to child services. **PREREQUISITE: Successful completion of Child Services 1 and 2. Application required with teacher recommendation. A \$30 fee is required for background check. Students must have their own transportation.**

CULINARY ARTS 1 and 2—This two-hour course allows students to increase skills in food preparation. Students are encouraged to enroll in this course if they have an interest in a Culinary Arts Career or if they would simply like to improve upon this essential life skill. **PREREQUISITE: Successful completion of Foods & Nutrition required. A \$50 fee is required.**

EARLY LIFESPAN DEVELOPMENT (CHILD DEVELOPMENT)—Like Children? Want to know more about how they grow, develop and learn? Interested in working with them for your career? This is the class for you! Prenatal development, pregnancy, and birth as well as the intellectual, physical, social, and emotional development of the child age newborn to one year are covered. You will have the opportunity to take home the “real care baby”. **Open to 10th – 12th grade students. A \$20 fee is required.**

FOOD & NUTRITION—Like to cook or want to be better at it? Interested in how to fuel your body? This course examines attitudes toward food, preparation skills, food safety and sanitation, nutrition basics and food budgeting. Cooking labs are incorporated to introduce students to food preparation skills. **Open to 10th, 11th, and 12th grade students. A \$40 fee is required.**

ADVANCED FOOD AND NUTRITION—An advanced version of Foods & Nutrition which examines attitudes toward food, nutrition facts, special health concerns and diets, management of food resources, preparation skills, food safety and sanitation. Cooking labs are incorporated throughout the entire course to introduce students to food preparation skills. **Open to 10th – 12th grade students. Approval of instructor is required. A \$40 fee is required.**

LIFE SKILLS—This course provides an opportunity for acquiring basic life skills. Emphasis is on family, employability skills, adolescent development, introduction to textiles, interiors and design, financial management, establishing healthy relationships, and creating a foundation for healthy lifestyles and nutrition. **Open to 9th and 10th grade students.**



ADVANCED EXPERIENCED BASED CAREER EDUCATION (EBCE)

Academic Internships through EBCE are designed to utilize the entire community as a classroom. Seniors are provided opportunities to observe, study and apply academic skills in a variety of businesses and industries, as well as public and private agencies in this year-long shadowing, internship, mentoring program. By spending two or more hours a day in the Academic Internship Program, a student can earn academic credit while shadowing a series of professionals to learn about career opportunities and planning for the future. **PREREQUISITE: Students must be in the 12th grade. AND complete all application requirements before the deadline. Students should see their counselor for an application prior to their registration meeting.**

HEALTH AND PHYSICAL EDUCATION—\$10 Fee is Required for Each Course

FITNESS FOR LIFE—9th Grade Students Only—This course does not count towards the state required physical education course. It is designed to teach students how to gain weight, lose weight, trim, tone, and become physically fit, as well as how to plan and eat a healthy diet. Weight training fundamentals will be included. Students are required to dress appropriately.

CONTROLLING STRESS/YOGA—Emphasizes flexibility, strength, and endurance. Students are required to dress appropriately for a gym class.

HEALTH EDUCATION—Involves discussing the topics of mental health, drugs, alcohol, tobacco, sex education, sexually transmitted diseases, infectious diseases, safety and first aid, CPR, nutrition, consumer health and non-infectious diseases. Credit: ¼ per semester – ½ required for graduation.

PHYSICAL EDUCATION—Involves the teaching of lifetime leisure sports, individual sports and team sports. Students are required to dress appropriately for a gym class. **Credit: ¼ per semester – ½ required for graduation.**

PHYSICAL EDUCATION II OR III: PE II—For students who desire to develop advanced skills in selected games and sports. **Successful completion of PREREQUISITE: Physical Education I and teacher recommendation is requested. PE III—teacher recommendation requested.**

ADVANCED SPORTS OFFICIATING/ADMINISTRATION—Methods, resources, practices and procedures utilized in sports officiating will be covered. Content emphasizes public relations, promotions, and mass communication. Rules and duties of sports officials will be emphasized. This course will also involve participation in officiating other physical education classes in preparation for earning a state or YMCA certification for officiating. Students must have a mature and positive attitude. **PREREQUISITE: Successful completion of PE I with a “B” or higher and teacher recommendation.**

STRENGTH AND CONDITIONING—Students will learn the basic fundamentals of weight training strength training, aerobic training, and overall fitness training and conditioning. PREREQUISITE: Successful completion of Health and PE I with a “B” or higher and teacher recommendation.



MUSIC

SOPRANO/ALTO/Tenor/Bass (SATB) CHOIR—Designed primarily for beginning and intermediate choral instruction. It will provide an understanding of the fundamentals of proper vocal techniques, choral techniques, and music theory. No audition required. **There are some out-of-school rehearsals and performances required. A \$20 course fee is required.**



ADVANCED SINGERS—This course is designed to expose students to advanced level choral literature through a range of time periods and styles. Emphasis is placed on individual performance technique and ensemble performance. Students will also learn music theory (written and aural). Opportunities for solo singing and small ensemble singing are offered in this group. **PREREQUISITE: Audition or director recommendation required. Open to 10th, 11th, and 12th grades only. There are some out-of-school rehearsals and performances required. A \$20 course fee is required.**

BEGINNING GUITAR—For students with limited or no previous guitar experience. Students will learn how to read music and learn the many different skills and techniques required to become a successful guitarist. **There will be some out-of-school rehearsals and performances required. A \$15 fee is required. Guitars are also available for rent for an additional \$15.**

ADVANCED GUITAR 2—Students enrolled in this course should have a basic understanding of music theory and an ability to read musical notation for guitar. Emphasis is also placed on the music industry and approaching music through a business perspective. **There will be some out-of-school rehearsals and performances required. A \$15 yearly fee is required. Guitars are also available for rent for an additional \$15. PREREQUISITE: Successful completion of Beginning Guitar and/or audition with instructor.**

CONCERT BAND—For woodwind and brass musicians. Out of school rehearsals and performances are required. PREREQUISITE: Students must have 2 years of prior playing and are admitted through AUDITION ONLY.

SYMPHONIC BAND—For woodwind and brass musicians. Provides students with opportunities to study, appreciate, and effectively perform all styles and periods of wind band literature. **Out of school rehearsals and performances are required. PREREQUISITE: Students must have 2 years of prior playing and are admitted through AUDITION ONLY.**

ADVANCED BAND AND THEORY—Designed for advanced woodwind and brass musicians. The students will study and perform the most challenging wind band literature of all eras and styles. **Out of school rehearsals and performances are required. PREREQUISITE: Students must have 2 years of prior playing experience and are admitted through AUDITION ONLY.**

PERCUSSION—Designed for percussionists only and exposes students to the fundamentals of percussion performance. Out of school performances are required. PREREQUISITE: Students must have prior playing experience and are admitted through AUDITION ONLY.

ADVANCED PERCUSSION—Designed for advanced percussionists only. All students are required to perform with either the Concert Band or Advanced Band in rehearsals and concerts. **Out of school rehearsals and performances are required. PREREQUISITE: Students must have 2 years of prior playing experience and are admitted through AUDITION ONLY.**

ADVANCED JAZZ BAND—Provides students with opportunities to study, appreciate, and effectively perform all styles and genres of jazz literature. Out of school performances are required. PREREQUISITES: Students must be enrolled in a Henry Clay High School music performance course (band, orchestra, or chorus). Students must have prior playing experience and are admitted through AUDITION ONLY.

ADVANCED MARCHING BAND—Designed to provide students with an experience in marching band. Students will learn the fundamentals and technique of marching and performing a field show. This course meets outside the instructional day beginning in mid July continuing through early November. **Regular after school rehearsals and Friday/Saturday performances are required. All students are required to attend and complete summer band camp as a part of the course. PREREQUISITES: Students must be enrolled in a music performance course (band, orchestra, or chorus) except for color guard members. Student must have prior playing experience and are admitted through AUDITION ONLY.**



REPERTORY ORCHESTRA—Members are admitted by audition, as judged by the directors. Large group rehearsals take place daily with periodic sectional work and individual playing tests to perform medium grade string orchestra music. Students are encouraged to take private lessons and participate in KMEA Solo & Ensemble. **This orchestra performs in 5 concerts as well as at KMEA Festival.**

ADVANCED CHAMBER ORCHESTRA—Members are admitted by audition, as judged by the directors. Two days a week are spent rehearsing as smaller chamber ensembles, while the remaining three days are spent in whole group rehearsals. With a strong desire to focus on music, these students audition for KMEA All-State, perform at KMEA Solo & Ensemble and KMEA Festival, and average a dozen performances over the school year.

ADVANCED SYMPHONIC ORCHESTRA—Members are admitted by audition, as judged by the directors. Large group rehearsals take place daily with periodic sectional work and individual playing tests to perform medium-advanced grade string orchestra music. Players are encouraged to take private lessons, perform at KMEA Solo & Ensemble, and may audition for All-State. This orchestra annually performs five concerts and at KMEA Festival.





TECHNOLOGY AND ENGINEERING

CIVIL ENGINEERING—Students will learn basic sketching and mechanical drafting skill discovering the different types of architectural styles, floor plan arrangements, zoning requirements, and utility codes. Students will build two small models to learn the residential construction of housing concepts. **A \$30 lab fee is required.**

ENGINEERING 1—This course applies the skills, concepts, and principles of engineering. Students explore various technological systems and engineering processes in related career fields. This class is computer-based and teaches problem-solving skills and the design development process. This is a project based design class, but mostly computer based modeling concepts. **A \$30 lab fee is required.**

ROBOTICS AUTOMATION AND DESIGN—A project-based course using a hands-on approach to introduce the basic concepts/skills essential to the design and operation of robotic systems. **Open to 11th and 12th grade students only. A \$15 lab fee is required.**

ROBOTICS ENGINEERING—This course provides students with the foundation in content and skills associated with robotics and automation, including artificial intelligence, electronics, physics, and principles of engineering. **A \$15 lab fee is required.**

UNMANNED AIRCRAFT SYSTEMS—This course provides students with the foundation skills to design, build and pilot UAS, both remotely and autonomously. Students will be prepared to complete the FAA Part 107 Remote Pilot exam upon completion of the course.

WORLD LANGUAGES: FRENCH GERMAN SPANISH

WORLD LANGUAGES: Students who successfully complete the second level of a world language are considered to have completed the pre-college curriculum. **Students wishing to take Level 2 or above for the first time in high school are encouraged to take the STAMP (Standards-based Assessment and Measurement of Proficiency) which will recommend a student's placement.** The cost is \$25 and checks should be made payable to *Henry Clay High School*. **Testing dates will be announced.**

LEVEL 1—This class is for students with little or no previous background in the language. Students will learn basic listening, speaking, reading and writing skills. **It is recommended to have a "C" or higher in English to enroll in the class.**

LEVEL 2—Emphasis will be placed on grammatical structures and vocabulary development while improving listening, speaking, reading and writing skills. **RECOMMENDATION: Successful completion of Level 1 of a "C" or higher and teacher recommendation.**

ADVANCED LEVEL 3—The main goal of this fast-paced level is for students to learn to express their ideas accurately and resourcefully both orally and in writing with reasonable fluency. **RECOMMENDATION: Successful completion of Level 2 with a "C" or higher and teacher recommendation.**

ADVANCED LEVEL 4—Students are expected to understand the spoken language as heard on the radio and in films. **RECOMMENDATION: Successful completion of Level 3 with a "C" or higher and teacher recommendation.**

ADVANCED SPANISH 5—Readings on Hispanic Literature are discussed in Spanish. Students will be expected to understand the spoken language. This course does not prepare the students for AP Spanish. **RECOMMENDATION: Successful completion of Spanish 4 with "C" or higher.**

SPANISH FOR NATIVE SPEAKERS—This course will teach native speaking Hispanic students to correct Spanish grammar and spelling, to write a well-organized composition, and to read and analyze Hispanic literature.

AP LEVEL—Equivalent of an intermediate college course in the advanced language of composition and conversation. **There is a \$20 class fee required. RECOMMENDATION: Successful completion of Level 4 with teacher consultation.**

SPANISH 102 AND 201 (Dual Credit through BCTC) - Spanish 102 is a fall semester course and 201 is a spring semester course **PREREQUISITE: Successful completion of Spanish 1, 2, and 3. Students must apply to BCTC and must have a 2.5 or higher GPA. Students must also have already met the ACT English (18) and Reading (20) benchmarks. College credit of 3 hours is awarded from BCTC for each course upon successful completion of a "C" or better. Students will be responsible for textbooks and may be responsible for tuition. See your counselor for further details.**



ESL – English as a Second Language

ESL is provided for all non-English speaking students, grades nine through twelve. International students must go through the Office of Pupil Personnel before enrolling in the schools. The only exceptions are naturalized citizens and students with a permanent resident visa. The program is a sequential course of study which teaches English vocabulary and structures using second language teaching techniques. Instruction includes the development of skills in listening, speaking, reading and writing English.

Henry Clay aims to promote the full participation and inclusion of limited English proficient (LEP) students in the general education curriculum, ensure their academic success on par with native speakers and enable LEP students to make successful transitions to post-secondary opportunities. Students will take a placement test and provide a transcript.

E-SCHOOL AT MLK

e-SCHOOL: In partnership with Jefferson County Public Schools, students may take courses through the e-School online learning system. MLK on Liberty Road supports the eSchool program and all tests are administered at MLK. Students must have a minimum reading level of 230 on the MAP or 18 on the ACT Reading to be admitted. The cost is \$125 per 1/2 credit (\$80 for reduced lunch students and \$60 for free lunch students). All fees are the responsibility of the student. See your counselor for an application and additional information.



SUMMER SCHOOL AT HENRY CLAY HIGH SCHOOL

The Summer Physical Education class dates have not been determined. Dates will be announced in late March or mid April AFTER inclement weather make-up days have been determined. Summer school will NOT be in session June 25–July 9, 2020 because of KHSAA dead period.

Students pick 1 of the summer sessions—either June or July to attend PE from 8:30 until 3:30 with a 30 minute lunch break. Students are responsible for their own lunch. The cost has not been determined. The cost in the past was \$160 for the ½ Credit of PE. Reduced lunch students paid \$100 and free lunch paid \$75.

Students taking PE during summer school will take Health through e-School. e-School is a separate registration process and a separate payment. e-School is \$125 for Health. (Reduced lunch students pay \$80 and free lunch students pay \$60.) This course is completed by the student independently on the internet. Students will need to get the e-School application from their counselor in May.

Registration Dates will be announced after Spring Break. Watch the Infinite Campus announcements and your email.

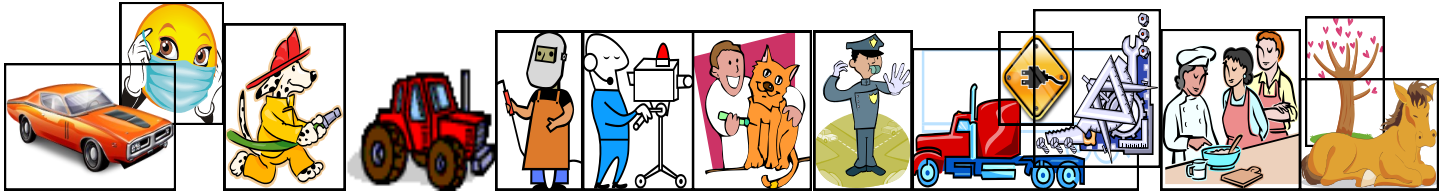

FAYETTE COUNTY TECHNICAL CENTERS

The Fayette County Technical Centers offer career and technical occupational training to high school students. All courses offered at Fayette County Technical Centers follow the **Kentucky Department of Education (KDE) Kentucky Tech Education** curriculum and upon completion of an approved pathway of study will qualify the student as Career Ready. Students interested in receiving training in one of the technical programs should have a satisfactory scholastic standing, possess an average mechanical ability, and be able to follow written and verbal instructions. Students may also attend a technical center class for a second school year for more advanced training and possible certification. Students who have achieved a level of acceptable work in a course may be allowed to participate in a work-based learning program, which allows students an opportunity to spend part of the school day working at a job in the community in a particular field of training.

PREREQUISITE: Acceptable standards of conduct, good attendance, classroom work, and practical work are required. Applications are required and can be obtained in the counseling office.

Contact Information: Eastside—(859) 381-3740 Locust Trace—(859) 381-3990 Southside—(859) 381-3603

Complete Description of Programs can be found at:

www.eastside.fcps.net

www.locusttrace.fcps.net

www.southside.fcps.net

See the Subject Choice Card for a complete list of core courses offered at each technical center.

EASTSIDE CAMPUS PROGRAMS



AERONAUTICS AND AEROSPACE—This pathway prepares individuals to apply technical knowledge into the first phase of aviation training leading to a commercial pilot license as well as the skills needed to repair, service and maintain all aircraft and their components. Some of the areas studied include navigation of commercial and passenger aircraft, flight systems and controls, flight crew operations and procedures, and safety and traffic regulations. Students will also study how to repair/service and maintain aircraft engines, propellers, avionic instruments, layout and fabrication of sheet metal, fabric, parts, cables and hydraulic units. To satisfy FAA requirements, students must log hours and work with approved FAA rated Airframe and Powerplant Technicians or Inspection Authorized persons.

AUTOMOTIVE TECHNOLOGY—Various systems of automotive technology to develop skills in troubleshooting are introduced. Students will learn to perform preventive maintenance as well as service and repair automobiles. Areas of study are to ASE and industry specifications and include engines, electrical & electronic, brake systems, and steering & suspension.

CINEMATOGRAPHY & VIDEO PRODUCTION—Students learn about reporting and anchoring for TV, videography, editing, behind the scenes news production, podcasting, blogging, composing original music for newscasts, and storytelling through digital photography. Eastside students have access to the most up-to-date equipment. They will learn to use the same editing software used in academy award winning blockbusters.

COLLISION REPAIR TECHNOLOGY—From repairing small dents to rebuilding the bodies of wrecked or damaged vehicles, this program trains students according to current commercial standards. Students are taught the types of materials used in filler compounds, the colors and chemical make-up of paints, design and installation of trim, cost estimation and preparation for finish work. Students completing this program are qualified to continue their education at the postsecondary level as well as for employment in shops and dealerships.

DIESEL TECHNOLOGY—Students in diesel technology learn to repair and maintain heavy trucks, heavy equipment and diesel engines. Students develop skills in troubleshooting, preventative maintenance, repair and servicing of all vehicles and equipment that utilizes diesel power. Instruction is focused on preparing students for post secondary or career placement within this high-tech, high-demand career field.

DIGITAL DESIGN & GAME DEVELOPMENT—Provides a broad and in-depth approach to computer programming through game design. Using comprehensive theory and hands-on experiences, students will gain the skills and knowledge required for the entire development process of gaming from concept to completion. Gaming programs as Alice, KODU, Scratch, RPG VX Maker, RPG IG Maker, and Gamemaker are used. Opportunities may become available in programming languages (Ruby, Java, HTML, PHP, etc.), as well as, development of mobile applications for selected students. **Prior knowledge of Microsoft Office and completion of Algebra is highly recommended.**

FIRE & EMERGENCY SERVICES—Includes intense physical training, introduction to firefighting equipment & use, fire behavior & combustion, fire investigation, fire protection system, and fire prevention.

LAW ENFORCEMENT—This is a broad based program for students with an interest in criminal justice, law enforcement, public safety and other related legal careers. The program includes the study of civil and criminal law providing a strong foundation for entry into advanced training within the military, at a police academy or college. Intense physical training based on current peace officer standards for Kentucky, as well as studies in criminal investigations, crime scene investigations, officer safety, patrol techniques, communications, and criminal law are included.

LOCUST TRACE CAMPUS AGRICULTURE PROGRAMS

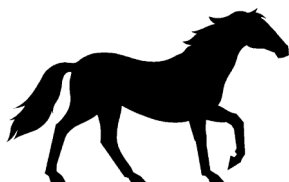

In addition to classroom space, Locust Trace has an 82 acre working farm, a veterinary clinic (open for public use), an equine barn with show arena, a livestock barn and community gardens. Agricultural career opportunities will be emphasized in all courses. Leadership development will be provided through FFA, which offers many activities to support the curriculum and the development of leadership skills. Career development throughout enrollment from SAE (Supervised Agricultural Experience). Upon passing the KOSSA exam and earning a “B” or higher in 3 courses within a pathway, students may receive up to 6 hours of articulated college credit with UK, ECU, KSU, WKU, Morehead State University, and Murray State University. This is in addition to dual credit offerings available for upper-level students. Students will choose one pathway, but some crossover should be expected.

AGRIBUSINESS SYSTEMS—Students will learn and apply skills such as finance, management practices, marketing, economics, tax accounting, business principles, inventory, and personnel management applicable to the agricultural industry. Courses include Ag Sales and Marketing, Agriscience, Ag Employability Skills and Ag Communications.

AG POWER, MECHANICAL, AND STRUCTURAL SYSTEMS—Students will learn a variety of skills utilized in the agriculture industry including small engine mechanics, farm maintenance, equipment operation, safety and emergency procedures, carpentry, welding, basic electricity, basic plumbing, equipment restoration, alternate energy sources and sustainable agriculture practices. All of these mechanical and engineering skills required to maintain a basic farming operation are covered in this program.

ANIMAL SCIENCE SYSTEMS—Develops knowledge and skills pertaining to identification, selection, nutrition, reproduction, genetics, health management and marketing of multiple species of small and large animals. Students in this pathway gain real-world experience working with a variety of different animals residing on Locust Trace’s 82 acre facility. Students will choose from among 4 pathway options: Animal Science, Equine Science, Veterinary Assistant, and Pre-Veterinary. Also included is the process of raw agricultural products into processed forms suitable for direct human consumption as well as the storage of such products. Includes instructions in applicable aspects of the agricultural sciences, human physiology and nutrition, food chemistry, food additives, food preparation and packaging, food storage and shipment, and related aspects of human health and safety including toxicology and pathology.

HORTICULTURE AND PLANT SCIENCE SYSTEMS: The Horticulture and Plant Science Systems pathway provides an introduction to the growth of all types of plants, both edible and decorative. Edible plant topics will include nutrition, food preparation, consumption trends, production, processing and transporting. Decorative plant topics will include floral design including the use of silk, dried and fresh flowers as well as practical applications of horticulture principles in both landscaping and sports turf management. Includes instruction in subjects such as climate, air, soil, water, land, fish and wildlife and plant resources; in the basic principles of environmental science and natural resources management; and the recreational and economic uses of renewable and nonrenewable natural resources. Core courses in this pathway include Agriscience, Greenhouse Technology, Landscaping and Turf Management, Plant & Land Science and Floriculture/Floral Design.



LOCUST TRACE VETERINARY CLINIC

In addition to classroom space, the 82 acre working farm has a veterinary clinic, arena barn, livestock barn and community gardens. **Locust Trace Veterinary Clinic is Open to the Public!** Fayette County Public School employees and students receive a **10% discount on services including General Wellness Exams, Intestinal Parasite Exam, nail Trim, Routine Surgeries (spay/neuter), Preventive Dental, and Radiology.** Clinic Hours are **8:00—5:00 Monday through Friday** and there is a **“Drop Off Service”** in the mornings allowing you to pick your pet up in the evening.

SOUTHSIDE CAMPUS PROGRAMS

CARPENTRY—Teaches students to perform to national construction industry standards. Students should have a strong background in mathematics. Students are provided with hands-on carpentry experiences. Students will have the opportunity to attain OSHA 10 hour and 30 certifications.

CULINARY ARTS—**Recommended 2.5 G.P.A. and a previous foods class.** Students who aspire to become a chef should take advantage of this program offering. Prepares students for post-secondary opportunities at area universities as they pursue an associate’s degree or chef certifications. Enrollment in this program requires three full class periods which means an academic course will not be available for Culinary Art students at Southside. Open to 11th and 12th grade students.

ELECTRICITY—Students will have the opportunity to study and practice residential wiring, industrial electricity, and programmable logic controllers (PLCs). Students will learn how to install wiring, conduit, service motors, and much more.

ELECTRONICS—Class and lab activities using a modular approach to electronic circuitry. Focus is on integrated electronics with emphasis being placed upon home and industrial engineering and installation of security, theater, audio and surveillance systems. There are opportunities to work with robotics.

MEDICAL SCIENCES (Recommended 2.5 G.P.A. and a “C” or better is previous medical related courses): This program is oriented toward students with a desire to pursue a career in an allied health care and is geared to allow the student to study the role of the chosen career and to gain experience in a health care setting. The program is open to juniors and seniors who have a sincere interest in health care careers. During the second semester of the Medical Health Sciences Course, the student chooses a discipline to study and enters a clinical experience in a health care setting. **Enrollment in this program requires three full class periods which means that an academic course offering will not be available at Southside for Medical Science students.**

MEDICAID NURSE’S AIDE (Recommended 2.5 G.P.A. and a “C” or better is previous medical related courses): The Nurse Aide Training and Competency Evaluation program is designed to provide both classroom instruction and clinical practice that will assist the student in gaining knowledge and skills essential to the provisions of nurse aide services. Students will also earn certifications in First Aid and CPR. This program is open to seniors who have a sincere interest in becoming a Nurses Aid. This is a course that most colleges/universities require to be accepted in the RN program. Students in this class **MUST** take the Certified Nursing Assistant examination at the end of the school year. Students are recommended to have completed a year of study in the Medical Sciences course prior to entrance in the Medicaid Nurse Aid program. **Enrollment in this program requires three full class periods which means that an academic course offering will not be available at Southside for this program.**

WELDING TECHNOLOGY: The welding course is designed to develop basic manipulative skills and knowledge in each of the following techniques: oxygen-acetylene cutting, welding and brazing, shielded metal arc welding, gas metal arc welding, and metal fabrication. These skills are taught relevant to the demands of industry. Students will spend much of their time on live work projects to develop fabrication skills.



HENRY CLAY STUDENT EXPECTATIONS

Dress Code

The following cannot be shown at school:

- ⊗ Bare midriffs
- ⊗ Bare shoulders (i.e., tank tops, spaghetti-strap tops, or muscle shirts)
- ⊗ Bare backs (i.e., sundresses)
- ⊗ Underwear above the belt-line of pants

The following apparel cannot be worn at school:

- ⊗ Gang or cult-related attire
- ⊗ Grooming combs, pencils, hair nets, or curlers in the hair
- ⊗ Items with unusual, vulgar, drug/alcohol/tobacco-related design or designs that advocate illegal or racist activity, or are otherwise distracting
- ⊗ See-through clothing or low-cut tops
- ⊗ Sunglasses, gloves, hats, caps, hoods, scarves, or bandanas, except when worn for religious purposes. These items should be in a locker or book bag by the first bell or they will be confiscated.
- ⊗ Shorts or skirts that are too short. Items that are too short are defined as those that do not reach the student's fingertips when his/her arms are at rest by his/her sides.

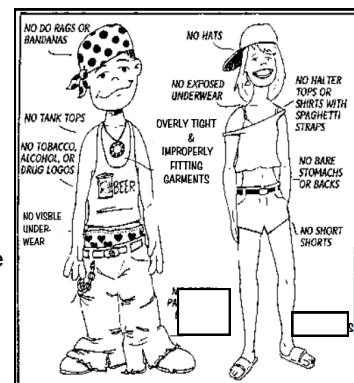

Students will be given the opportunity to comply. If they refuse, administrative action will follow.

Hall Passes

No hall passes are issued during the first or last ten minutes of class. Students found in the hall without a valid pass will be taken to SAFE.

Student ID Cards

All students are required to wear a lanyard with a student ID card attached. Lost ID cards will cost \$1.00 to replace. The \$1.00 can be refunded if the student locates the lost card and presents it to administration. Students will be placed in SAFE if they do not have an ID card.

Off-Limit Areas

Students are not permitted outside during lunch unless they are in the enclosed courtyard. Students are not allowed in the following areas during the school day without written permission from an administrator, his/her designee, or Law Enforcement:

- *Parking lots, including the faculty parking lot
- *Woods
- *Area under the cafeteria in the back of the building
- *Baseball field
- *Entrance to the band room
- *Football stadium



Tardiness

A student is considered tardy if he or she arrives after the designated start time or leaves before the end of the instructional day. Students must be checked in or out of school by a parent, guardian, or authorized adult. Late arrivals or early dismissals will be counted as an absence or tardy according to the arrival/departure time. All excused absence notes, check-ins, and check-outs will be handled by the attendance clerk's office.

BE ON TIME !!!

School begins at 8:25 a.m. A student is considered tardy if he or she arrives after the designated school start time or leaves before the end of the instructional day. Students must be checked in or out of school by a parent, guardian or authorized adult. Late arrivals or early dismissals will be counted as an absence or tardy according to the arrival/departure time. Every time a student has an unexcused absence it costs Henry Clay educational dollars.



Absences and Make-up Work

Students **MUST** submit their absence notes to the attendance clerk within three (3) days of the absence for it to be excused. Students with an excused absence are eligible to receive and earn credit for their make-up work. Students are responsible for obtaining make-up work from each of their teachers upon their return and will receive the same number of days as the student was absent, plus one day to turn in make-up work.

Students are permitted to use 10 parent notes per school year for full day absences, 10 parent notes per year for tardiness to school, 3 family emergency days and additional days for funerals, and unlimited doctor notes for appointments and procedures. See the Student Code of Conduct for complete attendance explanations.

The attendance clerk can be contacted at (859) 381-3429. Notes should have the full name of the student, the date of the absence, the reason for the absence, and the parent signature and telephone number. Notes can be submitted in person at the attendance office, they can be faxed to (859) 381-3430, or they can be emailed to scarlett.bailey@fayette.kyschools.us within three (3) days of the absence.

Truancy

Any student who has been absent from school without a valid excuse for three days or more, or tardy without valid excuse on three days or more, is considered truant. A student who has been reported truant two or more times is considered a habitual truant and parents may face legal ramifications. See the Student Code of Conduct for valid excuses to miss school.

These expectations are designed and enforced to create a safe, orderly, and comfortable environment for all students. Thank you for your cooperation. Have a great year!



ATHLETIC ELIGIBILITY

Certification Requirements:

- For NCAA, student athletes can find eligibility requirements and can register with the NCAA Initial Eligibility Clearinghouse at www.eligibilitycenter.org.
- For NAIA, students should go to www.paynaia.org or registration and information.

DIVISION I Qualifier Requirements	DIVISION II	NAIA
<p>*Athletics aid, practice, and competition</p> <ul style="list-style-type: none"> • 16 core courses <ul style="list-style-type: none"> • Ten (10) core courses completed before the start of seventh semester (senior year). 4 English, 3 Math, 2 Science, 1 additional n English, Math or Science, 2 Social Studies, and 4 additional approved core courses. • Corresponding test score (See chart at www.eligibilitycenter.org AND 2.3 minimum GPA in core courses. • Graduate from high school. 	<ul style="list-style-type: none"> • 16 core courses - 3 English, 3 Math, 2 Science, 2 Social Studies, and 3 additional courses in English, math, and/or science, and 4 additional approved core courses. • Minimum GPA 2.2 in 16 core courses. • Earn an ACT sum score of 68 or an SAT combined score of 820. • Graduate from high school. <p>When registering for the ACT or SAT, use code 9999 in the section on the college and scholarship codes.</p>	<p>Student-Athletes MUST meet 2 out of the following 3 requirements and graduate from high school.</p> <ol style="list-style-type: none"> 1. Score a minimum ACT composite score of an 18 OR SAT score of a 970 (evidence-based reading/writing and math). 2. Earn at least a 2.0 GPA on a 4.0 scale in high school. There is not a core course list – this is a student’s overall GPA on a 4.0 scale. 3. Rank in the top 50% of their high school graduating class. <p>Remember, the student-athlete only has to meet TWO of the THREE requirements above.</p>



Henry Clay Athletics A Tradition of Excellence

A QUICK REFERENCE TO ATHLETIC ELIGIBILITY AT HENRY CLAY HIGH SCHOOL		
KHSAA REQUIRES	FAYETTE COUNTY REQUIRES	HENRY CLAY REQUIRES
Student must be on schedule to graduate by the FIRST day of school in August. Visit KHSAA at www.khsaa.org for the handbook.	Student must be online to graduate defined as freshman (promoted from the 8th grade), sophomore (earned 5 credits), junior (earned 10 credits), or senior (earned 16 credits) by the start of the first day of school in August.	Same as FCPS
At the time of tryout, an athlete must have passed 4 classes the preceding semester and be online to graduate. Also, said athlete must also be eligible on the first day of school in August. Example: a spring sport athlete must be eligible after both the preceding Spring and Fall semesters.	At time of tryout, an athlete must have passed 4 classes the preceding semester and carried a 2.0 GPA for that semester. This GPA can be calculated by dropping the lowest grade as long as the athlete has a full academic schedule of 6 classes (Health/PE must be averaged together as one course). The 2.0 is not a KHSAA requirement—only FCPS and HC.	Same as FCPS except the GPA can be averaged using weighted grades.
Weekly grade checks must be complete each week and student must be passing 4 out of 6 hours of instruction.	Same as KHSAA. The 4 out of 6 hour instruction rule is calculated by 4/6 or passing 66% of the coursework that week.	Same as KHSAA with grade checks on Thursday for the following Monday—Sunday.
Athletes must attend school the day of competition, practice or tryouts to be eligible to participate.	Students must attend half a day to compete, practice or tryout.	Student must attend 3 academic hours to compete, practice, or tryout.
Athletes have 4 consecutive calendar years of eligibility	Same as KHSAA	Same as KHSAA
Student athletes reaching the age of 19 before August 1 are not eligible for athletic participation.	Same as KHSAA	Same as KHSAA
Transfer - Varsity eligibility MUST be established with the Athletic Director. See Handbook and discuss with the Athletic Director.	Same as KHSAA...with some exceptions - most notably 36 week waiting period for all levels.	Same as KHSAA
Out-of-District - Student must live in school attendance area.	Student must attend in district school or meet specific criteria spelled out in FCPS Athletic Guidelines. See the Athletic Director for explanations.	Same as FCPS...reminder that any student not living in district must sit 36 weeks from the day of enrollment in order to be eligible at any level of participation.
Athletes who are ineligible for ANY reason are not eligible for competition, practice or even tryouts.	Same as KHSAA	Same as KHSAA

MAP of HENRY CLAY HIGH SCHOOL

UPSTAIRS

Sheet 1 of 2

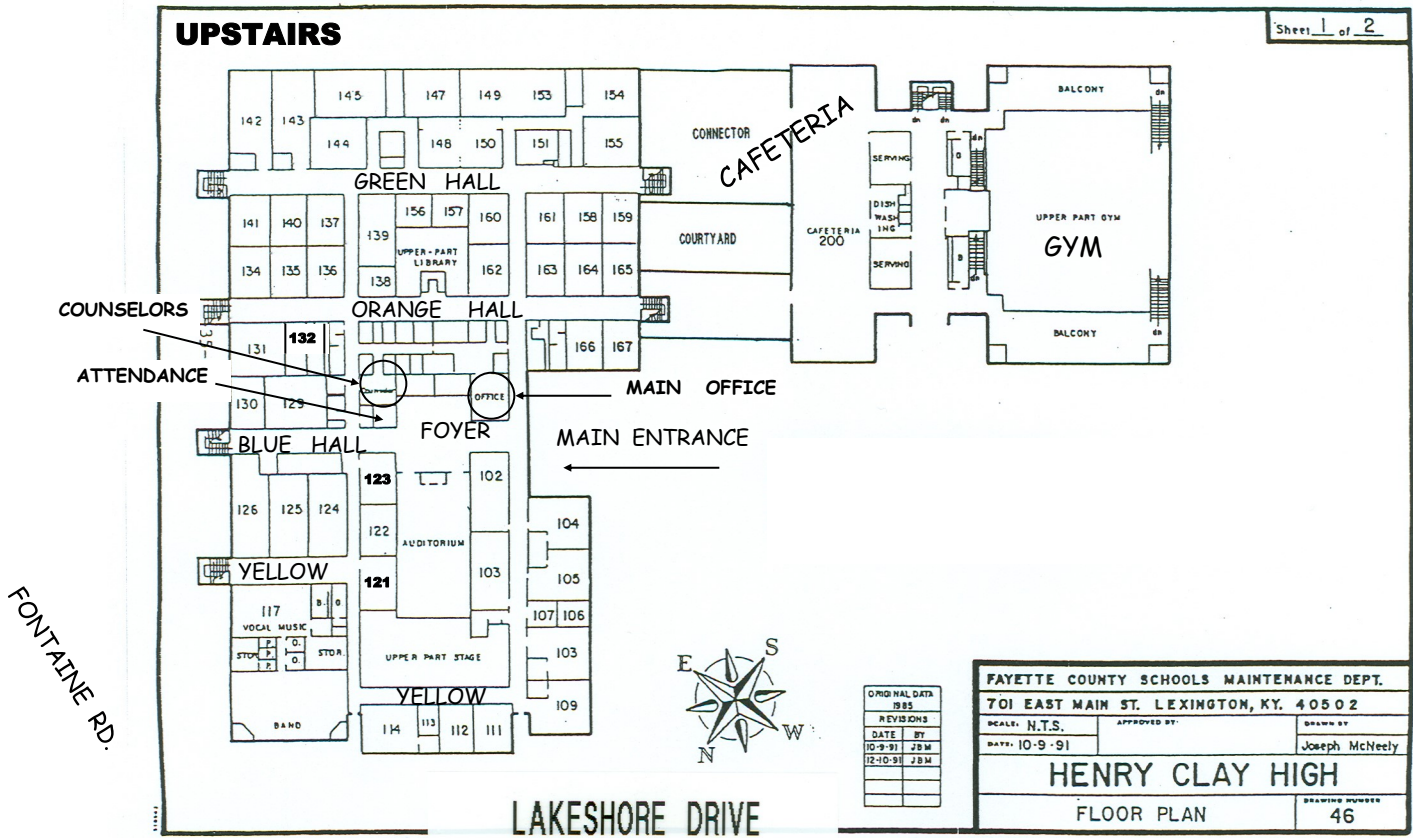

ORIGINAL DATA	1985
REVISIONS	
DATE	BY
10-9-91	JBM
12-10-91	JBM

FAYETTE COUNTY SCHOOLS MAINTENANCE DEPT.			
701 EAST MAIN ST. LEXINGTON, KY. 40502			
SCALE: N.T.S.	APPROVED BY:	DRAWN BY	
DATE: 10-9-91		Joseph McNeely	
HENRY CLAY HIGH			
FLOOR PLAN			DRAWING NUMBER
			46

DOWNSTAIRS

Sheet 2 of 2

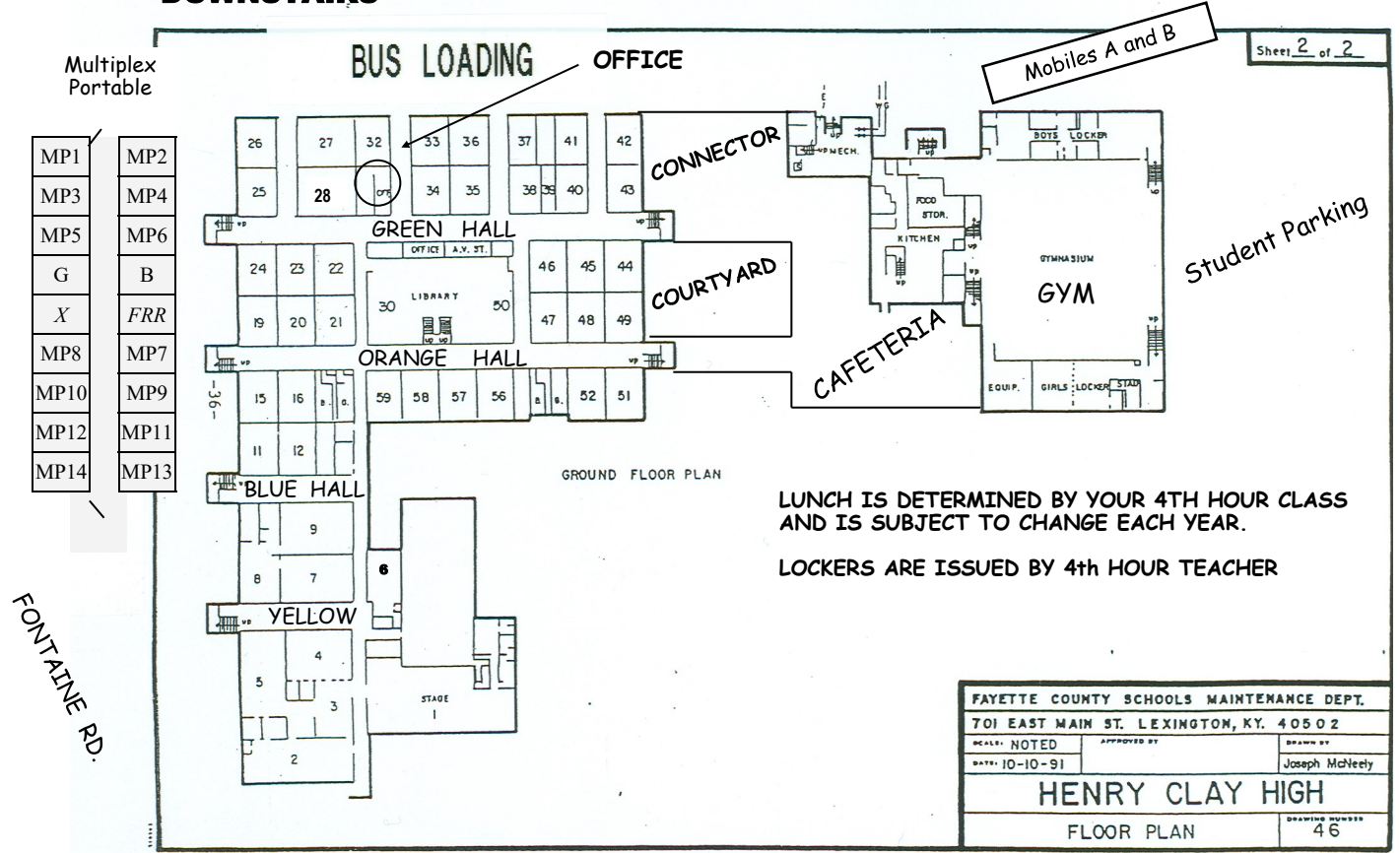

- Multiplex Portable
- MP1
 - MP2
 - MP3
 - MP4
 - MP5
 - MP6
 - G
 - B
 - X
 - FRR
 - MP8
 - MP7
 - MP10
 - MP9
 - MP12
 - MP11
 - MP14
 - MP13

LUNCH IS DETERMINED BY YOUR 4TH HOUR CLASS AND IS SUBJECT TO CHANGE EACH YEAR.
LOCKERS ARE ISSUED BY 4th HOUR TEACHER

FAYETTE COUNTY SCHOOLS MAINTENANCE DEPT.			
701 EAST MAIN ST. LEXINGTON, KY. 40502			
SCALE: NOTED	APPROVED BY:	DRAWN BY	
DATE: 10-10-91		Joseph McNeely	
HENRY CLAY HIGH			
FLOOR PLAN			DRAWING NUMBER
			46



We are Henry Clay

HENRY CLAY HIGH SCHOOL SPORTS and COACHES

Coaches are listed according to 2019-2020 school year.
This is subject to change for the 2020-2021 school year.

Athletic Director—Kristian Junker

www.henryclayathletics.com

Kentucky High School Athletic Association - www.khsaa.org

Archery—Jennifer Varble
Baseball—Jordan Tarrence
Basketball Boys—Daniel Brown
Basketball Girls—Eric Sanford
Bass Fishing—Daniel Brown
Bowling—Kevin Smith
Cheerleading—Tiara Shelby
Cross Country —Tommy Craft
Dance—Nikki Henlein
Diving—Noah Richter
Football—Demetrius Gay

Golf Boys—Jarred Baugh
Golf Girls—Kevin Mims
Lacrosse—Josh Stewart
Soccer Boys—Jason Behler
Soccer Girls—Mebit Aragaw
Softball—Tim McCoy
Swimming—Daniel Porter
Tennis—John Herring
Track—Demetrius Gay
Volleyball—Dale Grupe
Wrestling—Andy Critchfield



Henry Clay Fight Song

Get going Blue Devils,
Hold that ball and crash that line
O, Blue Devils,
you've just got to win this time.
And you can do it, so go to it
and Fight, Fight, Fight!

Get out and play Devils,
Like you've never played before,
and pray, devils,
that you score and score some more
And you can do it if you only try
for dear ol' Henry Clay High!
D-E-V-I-L-S
Devils!



FAYETTE COUNTY PUBLIC SCHOOLS 2020-2021 SCHOOL CALENDAR



Refer to www.fcps.net for the district's online listings which also include report card dates, Board of Education meetings, and more.



The Fayette County Board of Education approved this calendar June 24, 2019. It is subject to change, pending legislation and/or statute requirements.

2020 August	12	First day of school for students.
	21	No classes for students
September	7	Labor Day - Schools and offices closed.
October	1 - 2	Fall Break - No classes for students.
November	3	Election Day - Schools and offices closed.
	25	Schools and offices closed.
	26	Thanksgiving Day - School and offices closed.
	27	Schools and offices closed.
December	21 - 31	Winter Break.
2021 January	1	Winter Break
	4	Classes Resume
	18	Martin Luther King, Jr. Day - Schools and offices closed.
February	15	Presidents Day - Schools and offices closed.
March	19	No school for students - Possible weather make-up day.
March 29 - April 2		Spring Break.
May	21	Last day of school for students pending weather make-up days.
	NOTE:	High school gradations are not set until the threat of bad weather has passed and all make-up days have been announced. Calendars will be updated after the graduation schedule is released.
	24 - 28	Possible weather make-up days.
	31	Memorial Day - Schools and Offices Closed.
June	1 - 4	Possible weather make-up days.

NOTE: Weather make-up days are scheduled at the superintendent's discretion and the FCPS calendars are updated after each official announcement. Go to www.fcps.net/weather for updates. Graduation dates and summer school dates will not be decided until the threat of bad weather has passed and all make-up days have been announced.



Please check the Henry Clay website at www.henryclay.fcps.net for important dates about upcoming events. We also send out updates and reminders on our Infinite Campus Messenger. Make sure your email address is correct on Infinite Campus.