

24V Solar Charger Instructions

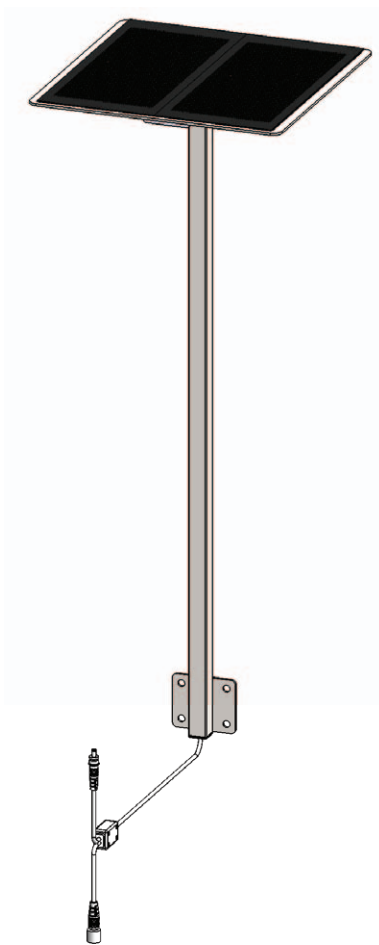

PART #: F-045SCH-02
(For use with Revolution, Scout and Titan)

MANDATORY
LEAVE THIS MANUAL WITH LIFT OWNER

Read and follow all instructions.
Lift safety can only be ensured if the lift is installed and operated according to these instructions.

- NEVER permit children to play on or around the lift
- Do not allow children to use the lift without adult supervision
- NEVER apply direct water pressure to the electronics
- NEVER use the lift with a dry pool

READ CAREFULLY

Check entire box and all packing materials for parts. Before beginning assembly, read the instructions and identify parts using the figures and parts listed in this document.

It is critical that all parts be carefully inspected prior to installation. If any damage occurred in transit, Aqua Creek Products, LLC must be notified within three days of receipt of unit.

Proper installation cannot be overstressed, as an improper installation voids Aqua Creek's warranty and may affect the safety of the user.

Unpacking and Installation

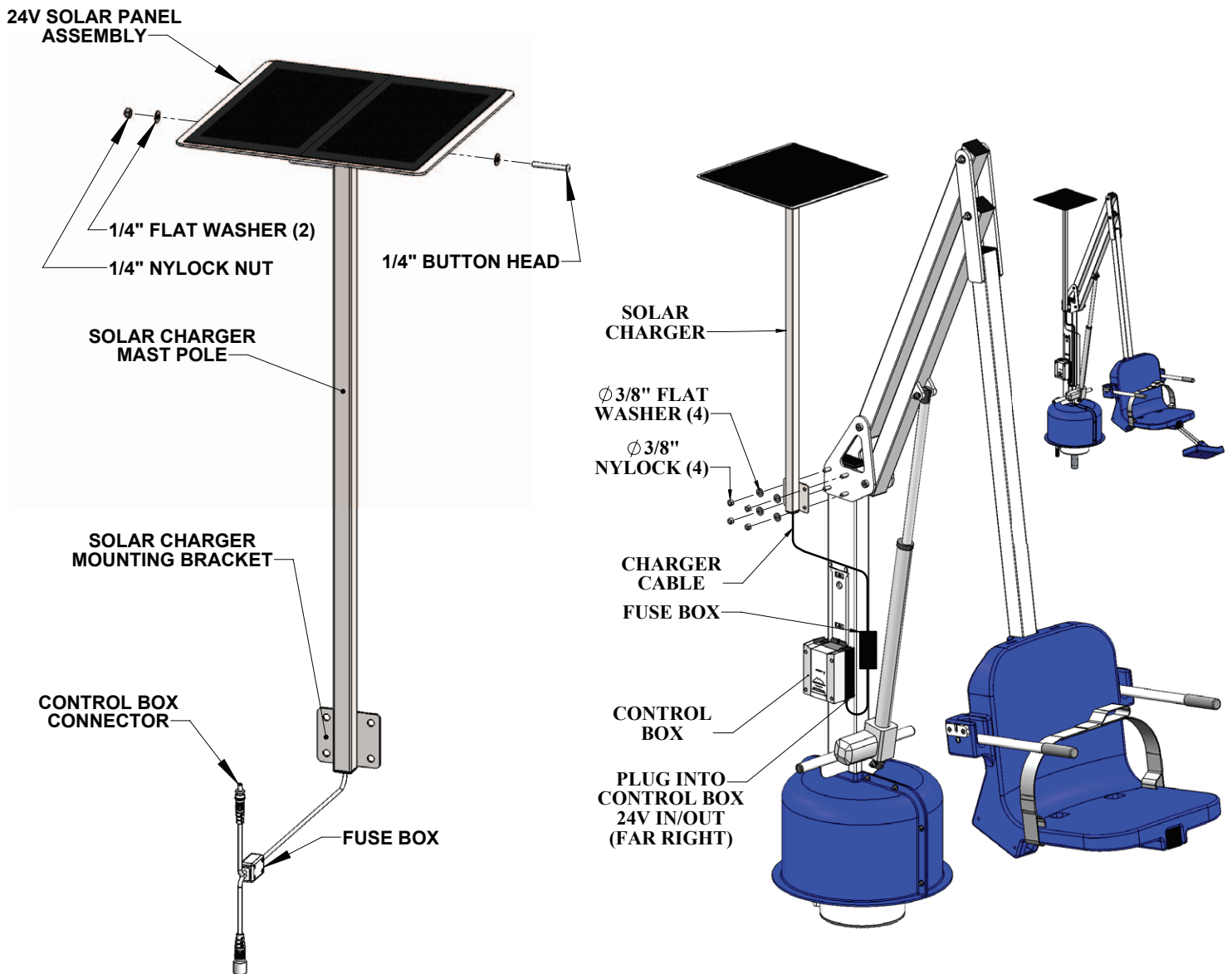

Before installing the 24V Solar Charger to the lift, flip-up the 24V Solar Panel Assembly and install the 1/4" button head bolt as shown in the diagram above. The 24V Solar Charger bolts directly to the mast of the lift and may be left on the unit 24 hours a day. In most cases this will mean the battery will not need to be charged during the day, or for heavy usage will not need to be put on the AC wall charger as often. To install the 24V Solar Charger, remove the four (4) 3/8" Nylock nuts and flat washers from the lift as shown, and install the charger. The control box connector plugs directly into the control box as shown above and on page 8.

Control Box Modification Instructions

NOTE: This modification is only necessary for Linak style control boxes. If you purchased a Scout lift you will not need to do this as those units are sold with a Vito style control box.

Check to make sure the far right plug in does not have a plastic disk at the top of the hole. If it has a plastic disk, follow the instructions on how to remove it. If the hole is clear, skip to "Installing The Charge Connector".

NOTE: Removing the plastic disk voids the warranty of the control box! A new solar charger ready control box can be purchased, if you do not wish to void your control box warranty. Contact Aqua Creek for additional information.



**TO OPEN THE CONTROL BOX
USE A TORX T20 DRIVER**



**"TORX" T20 DRIVER FOR
OPENING CONTROL-BOX**



REMOVE THE FOUR (4) SCREWS FROM THE TOP OF THE CONTROL BOX: LEAVE SCREWS IN HOLES



Control Box Modification Instructions



REMOVE THE COVER AND PLACE ON TABLE RIGHT-SIDE UP: NOTE POSITION OF EMERGENCY-SWITCH CAP



USE A "TORX" T10 DRIVER TO REMOVE THE THREE (3) SCREWS FROM THE CONTROL BOARD

Control Box Modification Instructions

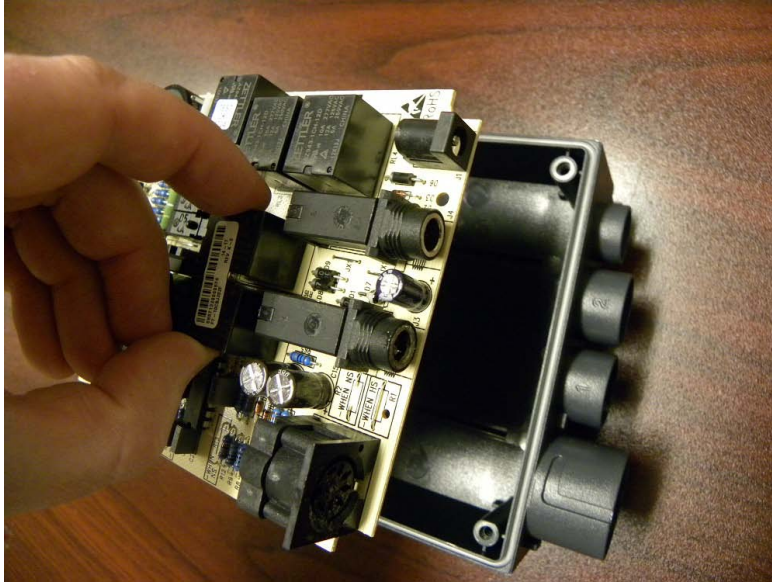

REMOVE THE CONTROL BOARD FROM THE CONTROL BOX



USE SCREWDRIVER, AND MALLET IF NECESSARY, TO PUNCH-OUT AND REMOVE PLASTIC-DISC ON 24V INPUT/OUTPUT PORT

Control Box Modification Instructions

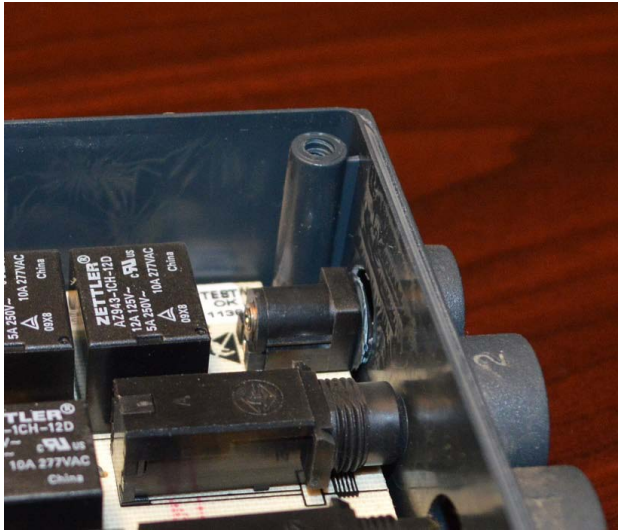

PLACE THE CONTROL BOARD BACK IN PLACE INSIDE THE CONTROL BOX



RETURN THE THREE (3) SCREWS TO SECURE THE CONTROL BOARD BACK IN PLACE

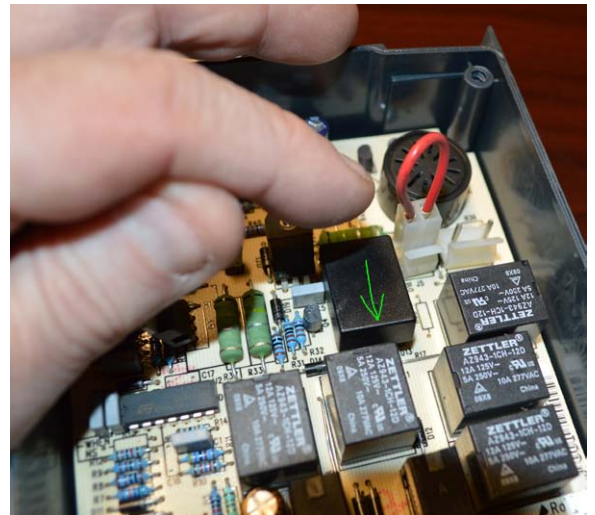

REPLACE THE EMERGENCY-SWITCH CAP WITH "ARROW" POINTING DOWN AS SHOWN

Control Box Modification Instructions



PUT COVER ON AND REINSTALL SCREWS



TEST EMERGENCY-SWITCH WITH DRIVER, LISTEN FOR "CLICK"

Solar Charger Installation with Linak Controls

The CHARGER CABLE gets plugged into the 24V in-out slot of the control box which is located on the far right. Run the battery cable along the side of the CONTROL BOX bracket so it is out of the way.

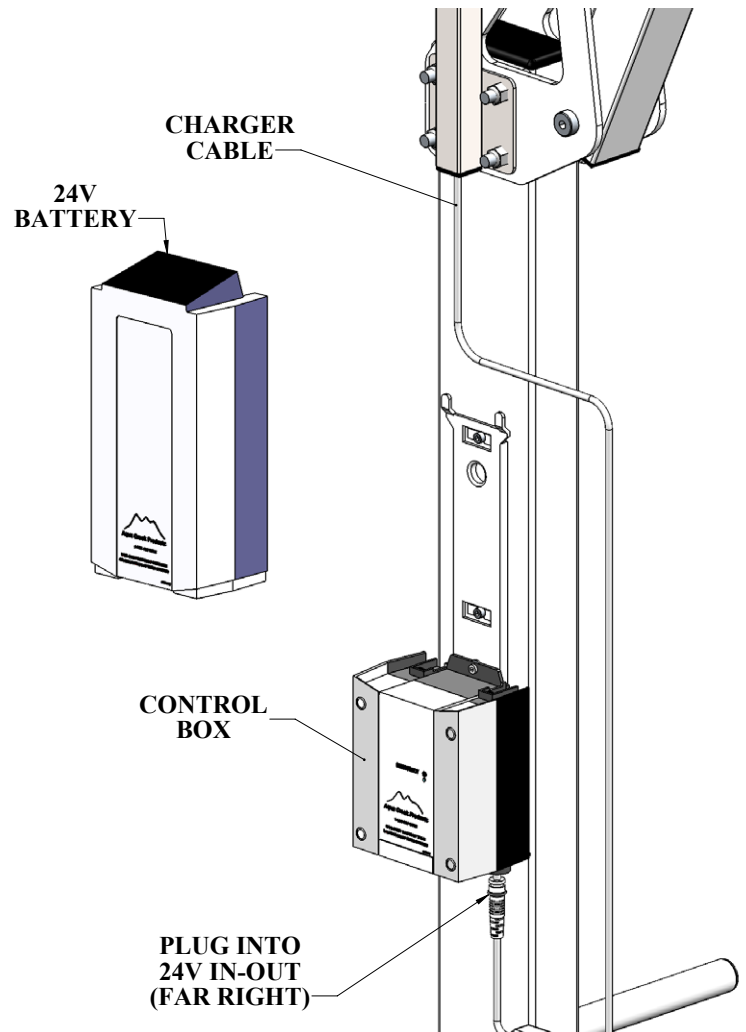

NOTE: Make sure the plug is fully engaged into the control box. Make sure the lights come on (see next page) and the lift functions normally when the 24V Solar Charger is installed. If the lift does not function, check all connections going into the control box and make sure they are pressed all the way in. When installed properly the battery will charge as the lift operates simultaneously.



Solar Charger Installation with Vito Controls

Disconnect the the cable that connects the battery to the control box. The SOLAR CHARGER CABLE has a male end and a female end that split off from the FUSE BOX. Connect the male end of the SOLAR CHARGER CABLE into the female end of the BATTERY. Then connect the female end of the SOLAR CHARGER CABLE to the male end of the CONTROL BOX. See pictures below.

NOTE: Make sure all plugs are fully engaged, the lights on the solar charger come on and that the lift functions correctly.



Solar Charger Operation

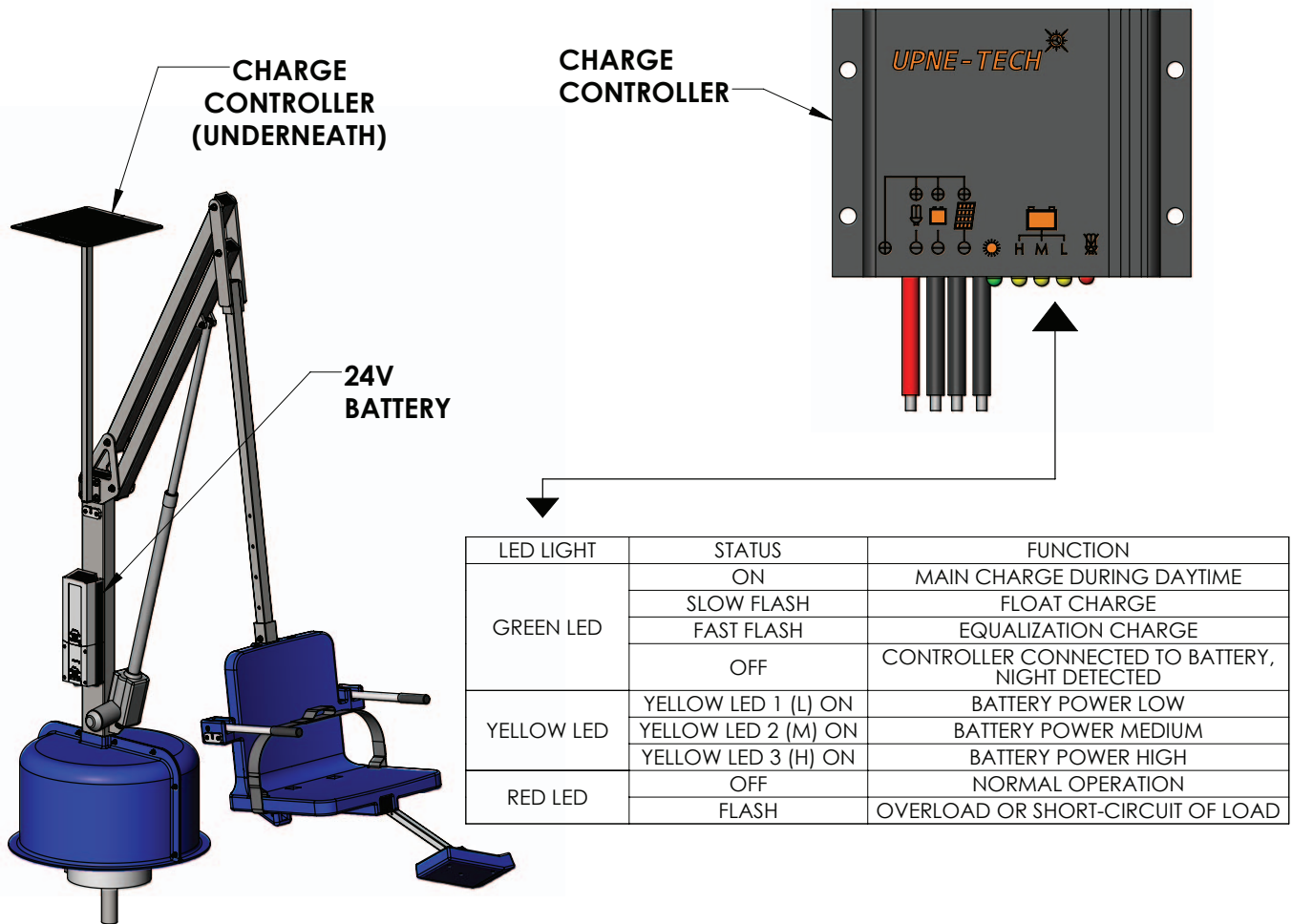

Once the solar charger has been installed and both the control box and battery have been plugged in, and there is sufficient daylight, the 24V Solar Charger will turn on and start trickle-charging the battery. Without both the control box and battery being plugged in, the 24V Solar Charger will be off and will remain off until both components are plugged in.

When a 24V battery is installed onto the lift, and there is sufficient daylight, the GREEN LED will turn on to show a 24V battery has been detected and the charger is operational. If a fully charged battery is being used, the YELLOW LED marked "H" will light up as well. If a non-fully charged battery is being used, either the YELLOW LED marked "M" or the YELLOW LED marked "L" will turn on, depending on how drained the battery is.

See the table in the image above for more descriptions on what all of the LED lights mean when they are either on or off.

The 24V Solar Charger will continue to charge the battery, even as the lift is being used. So once the 24V Solar Charger has been installed it will function without any need for adjustment. The user should check the indicators periodically to make sure it is working.

Linak Battery Maintenance

1. Do NOT expose the battery to freezing temperatures.
2. Do NOT expose the battery to prolonged periods of extreme heat or severe cold temperatures.
3. Do NOT expose the battery to temperatures below 0 degrees Celsius (32 degrees F.)
4. Do NOT expose the battery to long periods of direct sunlight. Heat will shorten your battery life. Optimum operating temperature is below 20 degrees Celsius (68 degrees F.) Aqua Creek recommends a battery cover be used with solar chargers since the battery is left on the lift at all times.
5. Never drop or bump the battery pack. This may result in loose or damaged internal connections, and may damage the battery terminals.
6. Keep battery terminals clean and free from dirt and corrosion to ensure good contact. The terminals may be cleaned using alcohol and a cotton swab. Clean off any corrosion or discoloration of the battery contacts with a Scotch-Brite™ pad and then apply dielectric grease (supplied with lift) as shown in the figure below.



Clean with alcohol
and a cotton swab and
apply dielectric grease
to terminals

Solar Charger Parts List

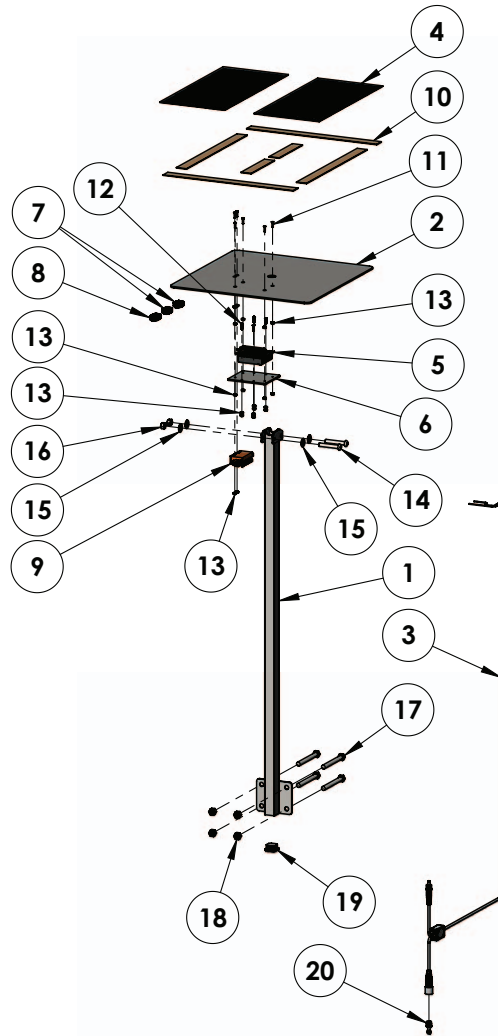

ITEM #	QTY	PART #	DESCRIPTION
1	1	RSC-100-10	REV SOLAR CHARGER LOWER WELDMENT
2	1	PSC-300-10	REV SOLAR CHARGER TOP WELDMENT
3	1	VSCC2	CABLE, SOLAR CHARGER CABLE, VITO
4	2	P-WSME-0040	SOLAR PANEL, 4 WATT MOBILE
5	1	SLAC-MH10A	CONTROLLER, SOLAR CHARGER
6	1	P-042AP	SOLAR CHARGER ADAPTER PLATE
7	2	222-412	CONNECTOR, WAGO, 2 LEVER
8	1	222-413	CONNECTOR, WAGO, 3 LEVER
9	1	222-500	CARRIER, HOUSING, FOR WAGO CONNECTORS
10	5FT	TAPE, MOUNTING, DOUBLE SIDED	TAPE, DOUBLE SIDED MOUNTING TAPE, 1" WIDE, 20 LBS
11	6	BC 4 X 1/2	BOLT, 316 SS, #4-40 X 1/2" FH PHILLIPS
12	4	BP 4 X 1/2	#4-40 X 1/2 PANHEAD MACHINE SCREW
13	20	NN 4	NUT, 316 SS, NYLOCK, #4-40
14	2	BB 5/16 X 2	BOLT, 316 SS, 5/16-18 X 2 BHSCS
15	4	WF 5/16	WASHER, FLAT, 5/16, 316 SS
16	2	NN 5/16	NUT, 316 SS, NYLOCK, 5/16-18
17	4	BH 3/8 X 3 3/4	BOLT, 316 SS, 3/8-16 X 3 3/4 HCS
18	4	NN 3/8	NUT, 316 SS, NYLOCK, 3/8-16
19	1	SQR-1-14-20	CAP, PLASTIC, 1 X 1 SQUARE
20	1	00918174	LINAK DUMMY PLUG FOR DC PORT

AQUA CREEK PRODUCTS, LLC LIMITED ONE (1) YEAR WARRANTY:
SOLAR CHARGING SYSTEMS

(ITEM #'s F-043SCH, F-044SCH, F-045SCH, F-046SCH, F-047SCH)

Aqua Creek Products, LLC (a.k.a. Aqua Creek) warrants to the original end user purchaser that products manufactured by Aqua Creek, when properly installed in accordance with assembly and installation instructions and properly used and maintained, shall be free from defects in material and workmanship for a period of **one (1) year from the date of original purchase**, provided that Aqua Creek receives prompt notice in writing of any defect or failure and satisfactory proof thereof, with the following exceptions:

Exceptions:

- All electrical components shall be warranted for a period of ninety (90) days from the date of original purchase.
- This warranty specifically excludes reimbursement for labor to remove, repair, or install the product and any freight charges.
- This warranty does not cover any damages due to accident, force majeure, act of nature, misuse, abuse, negligence or failure to properly maintain any products, or normal wear and tear from day to day operations.
- In the event that any products are altered, repaired, or improperly installed by anyone without the prior written approval by Aqua Creek, all warranties are void.

To initiate a warranty claim, the owner of an Aqua Creek product must provide the place of purchase, in writing, with a full description of the product, its serial number, the dates of purchase and installation, and the exact nature of the defect. Within thirty (30) days after receipt of a written warranty claim by Aqua Creek, and barring any unforeseen delays, the place of purchase will be notified of Aqua Creek's decision regarding the claim. All warranty calculations are from date of original purchase at manufacturer's suggested retail price. Non-payment for product to Aqua Creek may void warranty.

If requested by Aqua Creek, any defective product must be returned, freight prepaid by customer, to Aqua Creek's designated factory location or duly appointed distributor for inspection and/or repair. Aqua Creek will, at its option, repair or replace the failed or defective item, and deliver the repaired product or replacement to the customer. All freight charges are the responsibility of the customer. Products returned to Aqua Creek for which Aqua Creek provides replacement under this limited warranty shall become the property of Aqua Creek. A new warranty period shall **NOT** be established for the repaired or replaced products. Such products shall remain under warranty only for the remainder of the original warranty period on the original products purchased.

This written limited warranty constitutes the final, complete and exclusive statement of warranty terms. No person or organization is authorized to make any other specific or implied warranties or representations on behalf of Aqua Creek.

THE WARRANTIES SET FORTH HEREIN ARE IN LIEU OF ALL OTHER WARRANTIES, EXPRESSED OR IMPLIED, WHICH ARE HEREBY DISCLAIMED AND EXCLUDED, INCLUDING WITHOUT LIMITATION ANY WARRANTY OF MERCHANTABILITY OR FITNESS FOR A PARTICULAR PURPOSE OR USE.

THE SOLE AND EXCLUSIVE REMEDIES FOR BREACH OF ANY AND ALL WARRANTIES WITH RESPECT TO THE PRODUCTS SHALL BE LIMITED TO REPAIR OR REPLACEMENT AT AQUA CREEK'S DESIGNATED FACTORY LOCATION, OR DULY APPOINTED DISTRIBUTOR, OR IN PLACE AT AQUA CREEK'S OPTION. IN NO EVENT SHALL AQUA CREEK'S LIABILITY EXCEED THE ENTIRE AMOUNT PAID TO AQUA CREEK BY THE ORIGINAL PURCHASER FOR THE FAILED OR DEFECTIVE PRODUCT.

IN NO EVENT SHALL AQUA CREEK PRODUCTS, LLC BE LIABLE FOR ANY INCIDENTAL, CONSEQUENTIAL, SPECIAL, INDIRECT, PUNITIVE OR EXEMPLARY DAMAGES OR LOST PROFITS FROM ANY BREACH OF THIS LIMITED WARRANTY OR OTHERWISE.

Aqua Creek Products, LLC
9889 Garrymore Lane
Missoula, MT 59808
(888) 687-3552 – (406) 549-0769
www.aquacreek.com