

SHOCKWAVE

SHOCKWAVE

ADVENTURE AWAITS...

27RQDX

INTERIOR COLOR
SLATE



LIVING AREA



KITCHEN



GLASS SHOWER DOOR



9-PLY BIRCH DRAWERS

MODERN CONSTRUCTION

Built with modern equipment in mind, all Shockwave floorplans are ready to accommodate a variety of offroad vehicles. We know everyone has their own style, so each floorplan offers a 102" wide chassis, boasting the maximum amount of width to make loading a breeze. You can be confident that all your toys are safe and ready to ride when you reach your destination.

Experience the difference..



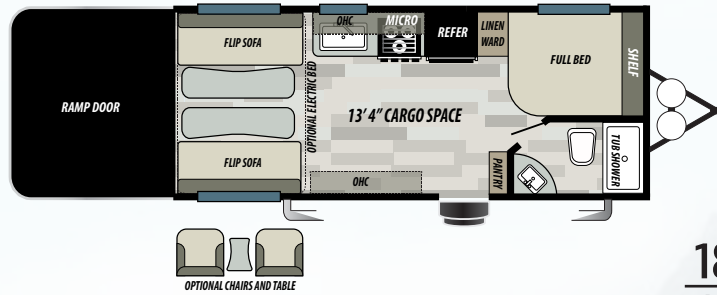

18CBMX
 DRY WEIGHT
 6,399 LBS

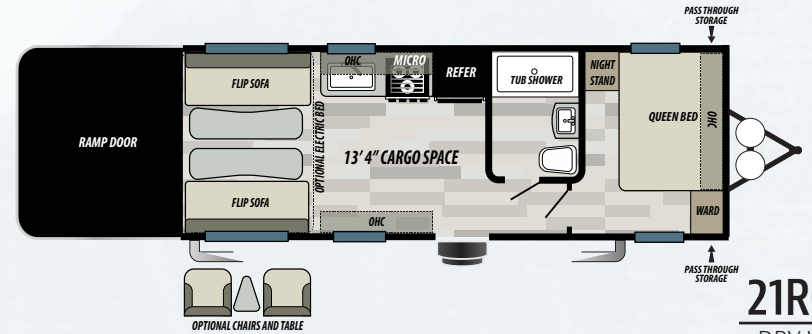

21RQM
 DRY WEIGHT
 6,611 LBS

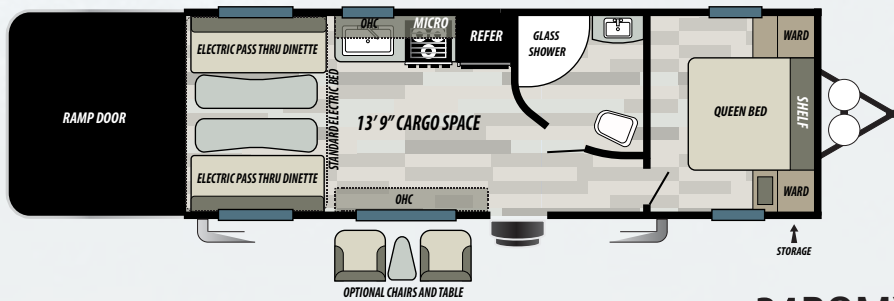

24RQM
 DRY WEIGHT
 6,859 LBS

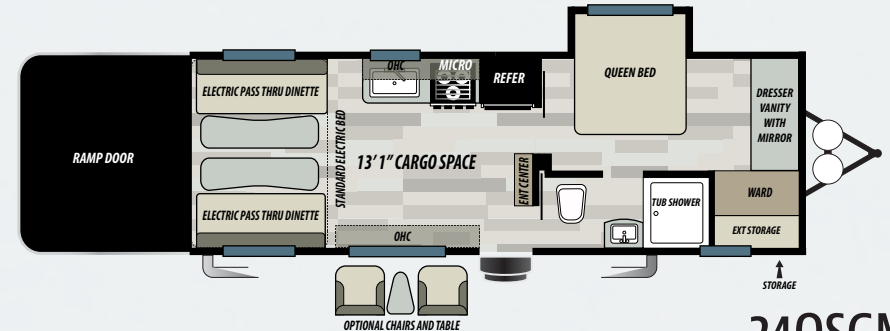

24QSGM
 DRY WEIGHT
 7,099 LBS

	18CBMX	21RQM	24RQM	24QSGM	25RQM	27RQDX/27RQGD	28RQDX	28KSGDX	29RQGD	29KSGDX	30KSGDX	30KSGDX
HITCH WEIGHT (LBS.)	853	913	1,087	1,080	1,207	1,092	1,174	1,351	1,415	1,360	1,505	1,630
GROSS VEHICLE WEIGHT RATING (LBS.)	9,999	9,999	9,999	9,999	9,999	9,999/10,999*	12,100	6,000	13,000	13,360	13,000	10,322
UNLOADED VEHICLE WEIGHT (LBS.)	6,399	6,611	6,859	7,274	7,099	7,750	8,212	8,567	9,479	9,108	10,051	13,630
CARGO CARRYING CAPACITY (LBS.)	3,600	3,388	3,140	2,725	2,900	2,249/3245*	3,888	4,746	3,521	4,252	2,949	3,270
EXTERIOR LENGTH (FT.)	25' 7"	27' 11"	30' 4"	26' 11"	30' 7"	33' 6"	35'	36' 4"	35' 10"	35' 10"	36' 8"	36' 10"
EXTERIOR HEIGHT (FT.)	12'	12'	12'	12'	12'	12' 7"	12' 7"	12' 7"	12' 4"	12' 9"	12' 4"	12' 9"
FRESH WATER (GAL.)	86	86	146	86	146	146	150	150	150	150	150	150
GREY WATER (GAL.)	65	65	65	80	65	65	65	65	65	80	80	65
BLACK WATER (GAL.)	35	40	40	40	40	40	40	40	40	40	40	40
TIRE SIZE (IN.)	15"	15"	15"	15"	15"	15"	16"	16"	16"	16"	16"	16"

27RQGD *

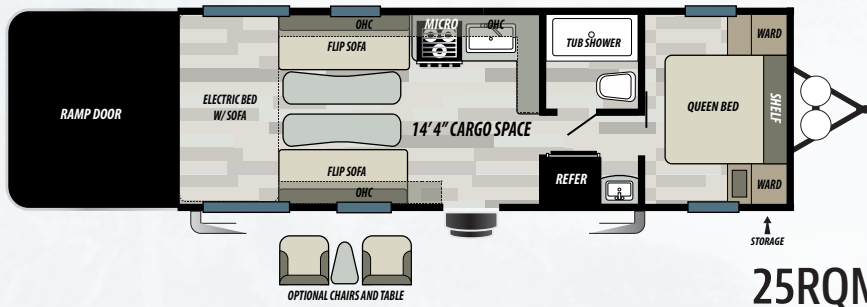

25RQMX
 DRY WEIGHT
 7,099 LBS

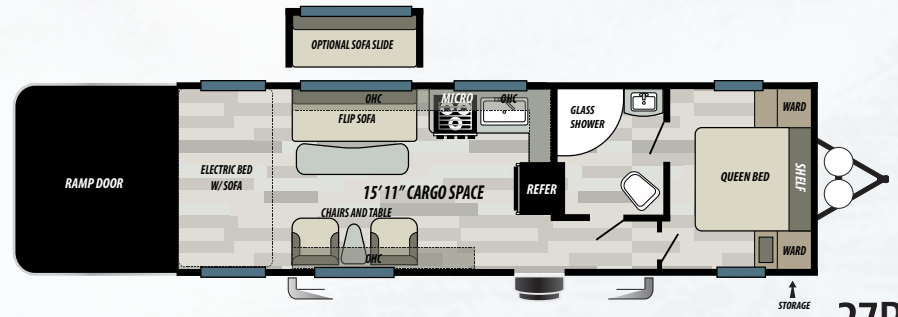

27RQMX
27RQDX
 DRY WEIGHT
 7,750 LBS

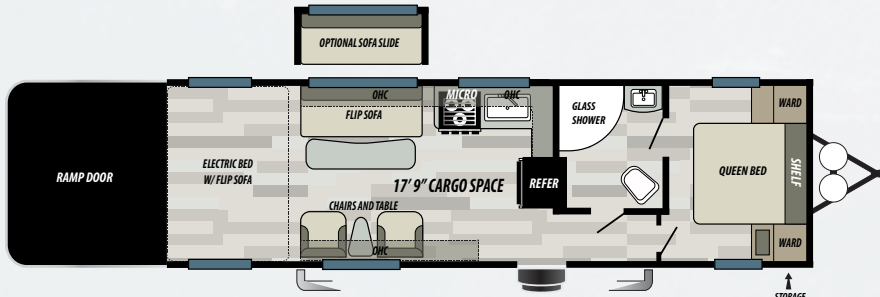

28RQDX
 DRY WEIGHT
 8,212 LBS

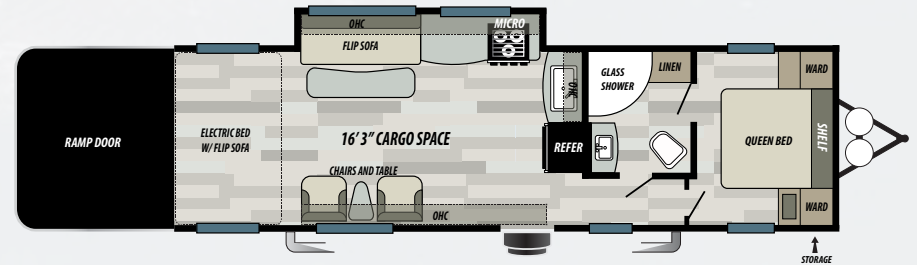

28KSGDX
 DRY WEIGHT
 8,567 LBS

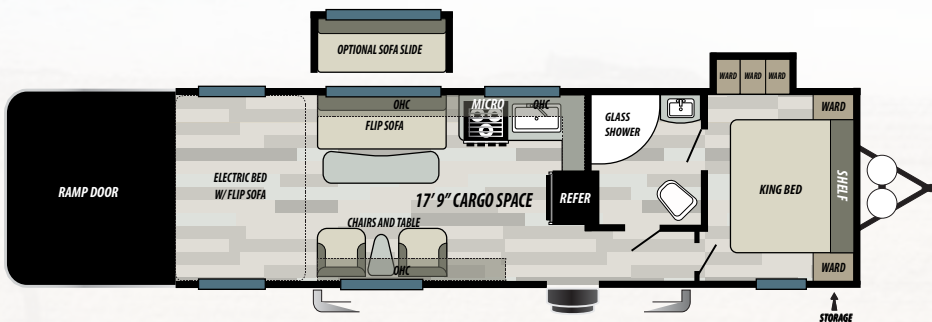

29RQDX
 DRY WEIGHT
 9,108 LBS

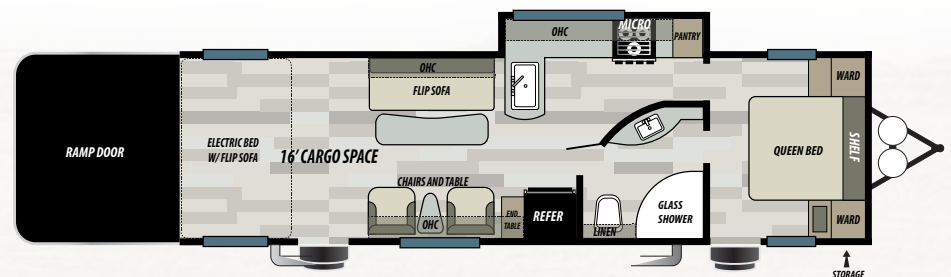

29KSGDX
 DRY WEIGHT
 9,108 LBS

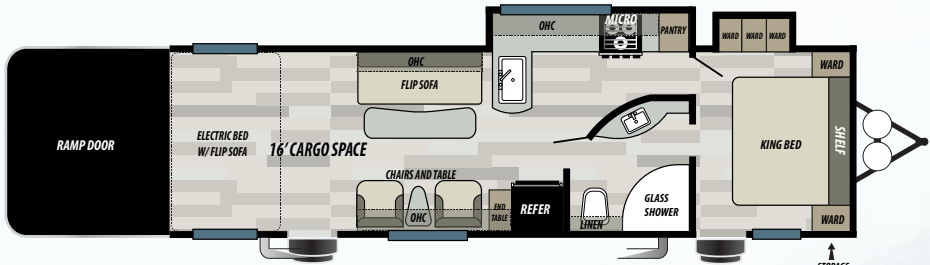

30KSGDX
 DRY WEIGHT
 6,399 LBS

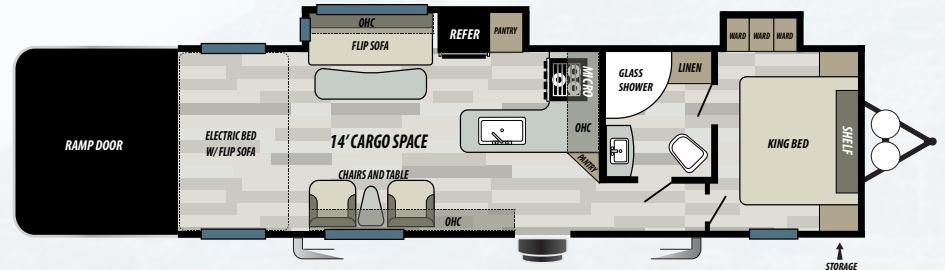

30KSGDX
 DRY WEIGHT
 10,322 LBS



LG Solid Surface Countertops

Designer Spring Faucet

Stainless Steel Appliance Package

LED Lights

Increased Ceiling Height For Toys and Gear

Extra Large Cabinets With Hidden Hinges

Pull Down Night Shades

Fold Up Sofa Also Makes Into a Sleeping Area

Custom Embroidered Swivel Chairs

Scratch, Tear, and Cold Crack Resistant Wood Plank Linoleum

Thermafoil Table Tops

MX SERIES

POPULAR FEATURES

- 60" X 80" RESIDENTIAL QUEEN MATTRESS – MAIN BEDROOM
- HEATED & ENCLOSED TANKS
- 35 GALLON FUEL STATION
- 6 GALLON GAS & ELECTRIC WATER HEATER
- 13,500 BTU DUCTED AIR CONDITIONER
- 30,000 BTU FURNACE
- 8 CU FT DOUBLE DOOR REFRIGERATOR
- 102" WIDE BODY CONSTRUCTION
- BEAVER TAIL FLOOR (PER FP)
- TIE DOWNS MOUNTED TO STEEL
- 3,000 LB. RADIUS RAMP DOOR
- SINGLE ELECTRIC BED (PER FP)
- OUTSIDE SHOWER
- DRIVE-ON WHEEL WELL (DOOR SIDE)
- GLASS SHOWER DOOR
- ELECTRONIC CHARGING STATIONS (3)
- 2" FULLY INSULATED FLOOR
- AM/FM BLUETOOTH RADIO WITH INTERIOR & EXTERIOR SPEAKERS
- 220 WATT SOLAR PANEL & REGULATOR
- STABILIZER JACKS ALL 4 CORNERS
- CAPITAL PILLOW TOP MATTRESS
- LG SOLID SURFACE KITCHEN COUNTERTOP
- ALUMINUM WHEELS

- 22" CHEF'S OVEN WITH RECESSED GLASS TOP
- STAINLESS STEEL APPEARANCE APPLIANCES
- RAMP DOOR PATIO CABLES
- LED AWNING LIGHT STRIP
- FRICTION HINGE ENTRY DOORS
- MAGNETIC BAGGAGE DOOR LATCHES

G-SERIES PACKAGE

- ALUMA-WALL FIBERGLASS
- NIGHT SHADES
- POWER AWNING

AVAILABLE OPTIONS

- 2 CHAIRS WITH BAY WINDOW IN PLACE OF C/S SOFA (PER FP)
- 4.0 ONAN GENERATOR
- 8 CU FT DOUBLE DOOR REFRIGERATOR IN PLACE OF 6 CU FT
- DUAL 30# LP BOTTLES IN PLACE OF 20# BOTTLES
- 1,500 WATT GO POWER INVERTER
- 39" LED TV IN LIVING ROOM
- 28" TV IN BEDROOM
- 15,000 BTU AIR CONDITIONER IPO 13,500 BTU
- CARPET KIT
- ELECTRIC PASS THROUGH DINETTE – (PER FP)
- GREY FIBERGLASS EXTERIOR IN PLACE OF WHITE FIBERGLASS

Popular Features

- FIBERGLASS MOLDED FRONT CAP
- KENWOOD AUDIO SOUND SYSTEM
- NIGHT SHADES IPO MINI BLINDS
- POWER AWNING WITH ADJUSTABLE LEGS – STANDARD IN G-SERIES
- POWER TONGUE JACK
- RAMP DOOR PLAYPEN
- TOUGH PLY FLOORING IN CARGO AREA
- TOYLOK DOOR SIDE
- ARCTIC PACKAGE – RADIANT FOIL INSULATION IN THE ROOF AND FLOOR

COMFORT & CONVENIENCE PACKAGE

- ADD-A-WALL
- BLACK TANK FLUSH
- ENTRY SWING AWAY HANDLE
- MATCHING ALUMINUM SPARE TIRE
- RETRACTABLE ROOF LADDER
- BBQ HOOK UP CONNECTION
- WATER HEATER BYPASS

DX SERIES

POPULAR FEATURES

- 4.0 ONAN GENERATOR
- 35 GALLON FUEL STATION
- 2 CHAIRS WITH BAY WINDOW
- 60" X 80" RESIDENTIAL QUEEN MATTRESS (PER FP)
- RESIDENTIAL KING SIZE MATTRESS (PER FP)
- 8 CU FT REFRIGERATOR
- HEATED & ENCLOSED UNDERBELLY
- 146 GALLON FRESH WATER CAPACITY
- 60 GALLON GREY TANK (80 IN T291)/ 40 GALLON BLACK TANK
- 6 GALLON GAS & ELECTRIC WATER HEATER
- 30,000 BTU FURNACE
- 102" WIDE BODY CONSTRUCTION
- TIE DOWNS MOUNTED TO STEEL
- 3,000 LB. RADIUS RAMP DOOR
- BEAVER TAIL FLOOR
- ELECTRIC AWNING WITH ADJUSTABLE LEGS
- ELECTRIC BED AND BOTTOM FLIP SOFA
- OUTSIDE SHOWER
- DRIVE-ON WHEEL WELL (DOOR SIDE)
- GLASS SHOWER DOOR
- ELECTRONIC CHARGING STATIONS (3)
- 2" FULLY INSULATED FLOOR
- AM/FM BLUETOOTH RADIO WITH INTERIOR & EXTERIOR SPEAKERS
- 220 WATT SOLAR PANEL & REGULATOR
- STABILIZER JACKS ALL 4 CORNERS

- CAPITAL PILLOW TOP MATTRESS
- LIGHTED LG SOLID SURFACE KITCHEN COUNTERTOP
- ALUMINUM WHEELS
- 1.6 CU FT STAINLESS STEEL MICROWAVE
- 22" CHEF'S OVEN WITH RECESSED GLASS TOP
- STAINLESS STEEL APPEARANCE APPLIANCES
- RAMP DOOR PATIO CABLES
- FRICTION HINGE ENTRY DOORS
- MAGNETIC BAGGAGE DOOR LATCHES
- LED AWNING LIGHT STRIP

G-SERIES PACKAGE

- ALUMA-WALL FIBERGLASS
- NIGHT SHADES
- POWER AWNING
- 10 GALLON WATER HEATER
- FENDER SKIRTS W/ RADIUS AUTO MOLD

POPULAR OPTIONS

- 5.5 ONAN GENERATOR W/ 50 AMP SERVICE AND 13,500 BTU AC IN BEDROOM
- 10 GAL WATER HEATER IN PLACE OF 6 GALLON – STANDARD G-SERIES
- DUAL 30# LP BOTTLES IN PLACE OF 20# BOTTLES
- 1,500 WATT GO POWER INVERTER
- CARPET KIT
- ELECTRIC PASS THROUGH DINETTE IN PLACE OF ELECTRIC BED SOFA

- 39" LED TV IN LIVING ROOM
- 28" TV IN BEDROOM
- FIBERGLASS MOLDED FRONT CAP
- GREY FIBERGLASS EXTERIOR IPO WHITE FIBERGLASS
- KENWOOD AUDIO SOUND SYSTEM
- NIGHT SHADES IN PLACE OF MINI BLINDS – MANDATORY ON METAL UNITS. STANDARD IN G-SERIES
- POWER TONGUE JACK
- RAMP DOOR PLAYPEN
- SOFA SLIDE-OUT WITH CABINETS (PER FP)
- TOUGH PLY FLOORING IN CARGO
- TOYLOK DOOR SIDE
- ARCTIC PACKAGE – RADIANT FOIL INSULATION IN THE ROOF AND FLOOR
- POWER STABILIZER JACKS

COMFORT & CONVENIENCE PACKAGE

- ADD-A-WALL
- BLACK TANK FLUSH
- ENTRY SWING AWAY HANDLE
- MATCHING ALUMINUM SPARE TIRE
- RETRACTABLE ROOF LADDER
- BBQ HOOK UP CONNECTION
- WATER HEATER BYPASS
- 15,000 BTU AIR CONDITIONER

Sport Series

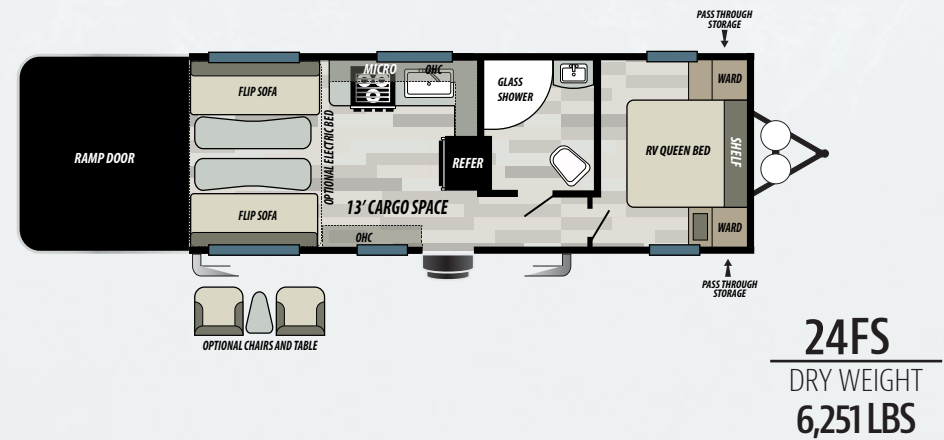
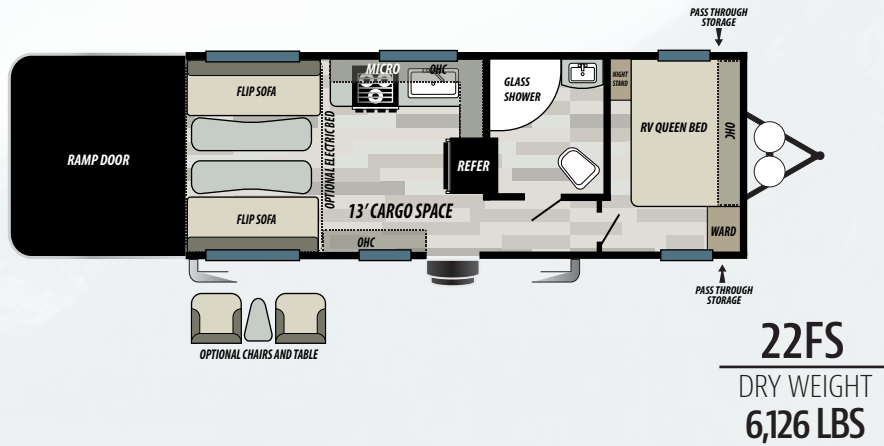

AFFORDABLE COMFORT

Sometimes all you want is to get out and ride. The Shockwave Sport Series was built for just that purpose. With unique options, the Sport Series can be equipped to meet your needs without the extra cost of additional equipment. The requirements for every camper and offroad enthusiast are different. Understanding those unique requisites, Shockwave has introduced a series specifically designed to meet your budget and still have you camping in style.

Popular Features

STANDARD FEATURES

- HEATED & ENCLOSED TANKS
- 86 GALLON FRESH WATER CAPACITY
- 40 GALLON GREY TANK / 40 GALLON BLACK TANK
- 6 GALLON GAS & ELECTRIC WATER HEATER
- 13,500 BTU DUCTED AIR CONDITIONER
- 30,000 BTU FURNACE
- 8 CU FT DOUBLE DOOR REFRIGERATOR
- 102" WIDE BODY CONSTRUCTION
- TIE DOWNS MOUNTED TO STEEL
- 3,000 LB. RADIUS RAMP DOOR
- 2" FULLY INSULATED FLOOR
- THERMAFOIL COUNTERTOPS

AVAILABLE OPTIONS

- 2 CHAIRS WITH BAY WINDOW IN PLACE OF SOFA
- DUAL 30# LP BOTTLES IN PLACE OF 20# BOTTLES
- 15,000 BTU AIR CONDITIONER IPO 13,500 BTU
- RETRACTABLE EXTERIOR ROOF LADDER
- WATER HEATER BYPASS
- 135W SOLAR PANEL W/ REGULATOR
- POWER AWNING WITH ADJUSTABLE LEGS
- ARCTIC PACKAGE – RADIANT FOIL INSULATION IN THE ROOF AND FLOOR

ENTERTAINMENT PACKAGE

- BLUETOOTH STEREO W/ INTERIOR & EXTERIOR SPEAKERS
- TV ANTENNA W/ BOOSTER
- ELECTRIC CHARGING STATIONS (3)

COMFORT AND CONVENIENCE PACKAGE

- BLACK TANK FLUSH
- STABILIZER JACKS (4)
- MATCHING ALUMINUM SPARE TIRE
- SINGLE ELECTRIC BED
- SOLAR PREP
- 20 GALLON FUEL STATION
- CAPITAL PILLOWTOP MATTRESS
- NIGHT SHADES

Floorplan Key

OHC

OVERHEAD CABINET

WARD

WARDROBE

MICRO

MICROWAVE

REFER

REFRIGERATOR

	22FS	24FS
HITCH WEIGHT (LBS.)	918	871
GROSS VEHICLE WEIGHT RATING (LBS.)	9,999	9,999
UNLOADED VEHICLE WEIGHT (LBS.)	6,126	6,251
CARGO CARRYING CAPACITY (LBS.)	3,873	3,748
EXTERIOR LENGTH (FT.)	28' 11"	30' 1"
EXTERIOR HEIGHT (FT.)	12' 1"	12' 1"
FRESH WATER (GAL.)	86	86
GREY WATER (GAL.)	40	40
BLACK WATER (GAL.)	40	40
TIRE SIZE (IN.)	15"	15"

28FWGDX
INTERIOR COLOR
SLATE





Fifth wheels

STANDARD FEATURES

- 4.0 ONAN GENERATOR
- 35 GALLON FUEL STATION
- 2 CHAIRS WITH BAY WINDOW
- 60" X 80" RESIDENTIAL QUEEN MATTRESS – MAIN BEDROOM
- HEATED & ENCLOSED TANKS
- 150 GALLON FRESH WATER CAPACITY
- 65 GALLON GREY TANK / 40 GALLON BLACK TANK
- 30,000 BTU FURNACE
- 15,000 BTU DUCTED A/C
- 8 CU FT DOUBLE DOOR REFRIGERATOR
- 102" WIDE BODY CONSTRUCTION
- TIE DOWNS MOUNTED TO STEEL
- 3,000 LB. RADIUS RAMP DOOR
- BEAVER TAIL FLOOR
- ELECTRIC AWNING WITH ADJUSTABLE LEGS
- ELECTRIC BED AND BOTTOM FLIP SOFA
- OUTSIDE SHOWER
- DRIVE-ON WHEEL WELL (DOOR SIDE)
- GLASS SHOWER DOOR
- ELECTRONIC CHARGING STATIONS (3)
- 2" FULLY INSULATED FLOOR
- KENWOOD TOUCH DVD PLAYER WITH INTERIOR & EXTERIOR SPEAKERS
- BLACK TANK FLUSH
- BBQ HOOK UP CONNECTION
- 220 WATT SOLAR PANEL & REGULATOR

- STABILIZER JACKS REAR
- CAPITAL PILLOW TOP MATTRESS
- LIGHTED LG SOLID SURFACE KITCHEN COUNTERTOP
- ALUMINUM WHEELS
- 1.6 CU FT STAINLESS STEEL MICROWAVE
- 22" CHEF'S OVEN WITH RECESSED GLASS TOP
- RAMP DOOR PATIO CABLES
- LED AWNING LIGHT STRIP
- 10 GALLON WATER HEATER
- FLIPPED AXLES
- BEDROOM SLIDEOUT

AVAILABLE OPTIONS

- 5.5 ONAN GENERATOR W/ 50 AMP SERVICE AND 13,500 BTU AC IN BEDROOM
- 1,500 WATT GO POWER INVERTER
- CARPET KIT
- ELECTRIC PASS THROUGH DINETTE IN PLACE OF ELECTRIC BED SOFA
- 39" LED TV IN LIVING ROOM
- 28" TV IN BEDROOM
- GREY FIBERGLASS EXTERIOR IN PLACE OF WHITE FIBERGLASS
- RAMP DOOR PLAYPEN
- SOFA SLIDE-OUT WITH CABINETS
- TOUGH PLY FLOORING IN CARGO
- TOYLOK DOOR SIDE
- ARCTIC PACKAGE – RADIANT FOIL INSULATION IN THE ROOF AND FLOOR

COMFORT & CONVENIENCE PACKAGE

- ADD-A-WALL
- ENTRY SWING AWAY HANDLE
- MATCHING ALUMINUM SPARE TIRE
- RETRACTABLE ROOF LADDER
- WATER HEATER BYPASS

	28FWGDX	33FWGDX
HITCH WEIGHT (LBS.)	2,210	2,458
GROSS VEHICLE WEIGHT RATING (LBS.)	14,210	14,999
UNLOADED VEHICLE WEIGHT (LBS.)	9,640	9,954
CARGO CARRYING CAPACITY (LBS.)	4,570	5,045
EXTERIOR LENGTH (FT.)	32' 6"	36' 6"
EXTERIOR HEIGHT (FT.)	13' 4"	13' 4"
FRESH WATER (GAL.)	150	150
GREY WATER (GAL.)	65	65
BLACK WATER (GAL.)	40	40
TIRE SIZE (IN.)	16"	16"

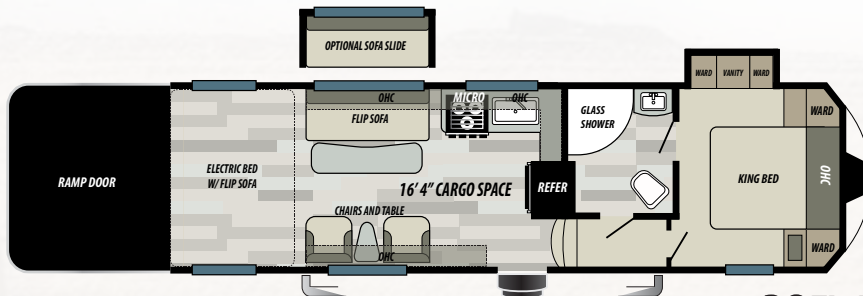

28FWGDX
DRY WEIGHT
9,640 LBS

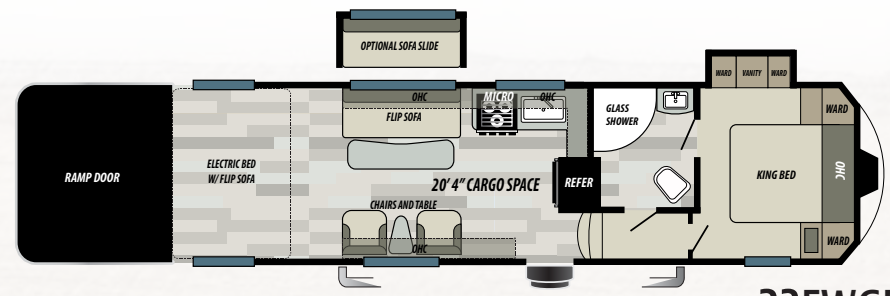

33FWGDX
DRY WEIGHT
9,954 LBS

SHOCKWAVE

Specification Definitions

GVWR (Gross Vehicle Weight Rating) - is the maximum permissible weight of the unit when fully loaded. It includes all weights, inclusive of all fluids, cargo, optional equipment and accessories. For safety and product performance do NOT exceed the GVWR.

GAWR (Gross Axle Weight Rating) - is the maximum permissible weight, including cargo, fluids, optional equipment and accessories that can be safely supported by a combination of all axles.

UVW (Unloaded Vehicle Weight)* - is the typical weight of the unit as manufactured at the factory. It includes all weight at the unit's axle(s) and tongue or pin and LP Gas. The UVW does not include cargo, fresh potable water, additional optional equipment or dealer installed accessories.

*Estimated average based on standard build optional equipment.

CCC (Cargo Carrying Capacity)** - is the amount of weight available for fresh potable water, cargo, additional optional equipment and accessories. CCC is equal to GVWR minus UVW. Available CCC should accommodate fresh potable water (8.3 lbs per gallon). Before filling the fresh water tank, empty the black and gray tanks to provide for more cargo capacity. ** Estimated average based on standard build optional equipment

Each Forest River RV is weighed at the manufacturing facility prior to shipping. A label identifying the unloaded vehicle weight of the actual unit and the cargo carrying capacity is applied to every Forest River RV prior to leaving our facilities. The load capacity of your unit is designated by weight, not by volume, so you cannot necessarily use all available space when loading your unit.

All information contained in this brochure is believed to be accurate at the time of publication. However, during the model year, it may be necessary to make revisions and Forest River, Inc., reserves the right to make all such changes without notice, including prices, colors, materials, equipment and specifications as well as the addition of new models and the discontinuance of models shown in this brochure. Therefore, please consult with your Forest River dealer and confirm the existence of any materials, design or specifications that are material to your purchase decision. Litho. U.S.A. FOR 1420 P/W: 2019.3.1

FREE MEMBERSHIP
to Forest River Owners' Group

www.forestriverfrog.com



Learn More
Scan this barcode using a QR Reader on your smart phone to learn more about Forest River.



A Berkshire Hathaway company.

FOREST RIVER INC., 255 S PEPPER AVE RIALTO, CA 92376 | (909) 873-3777
WWW.FORESTRIVERINC.COM/SHOCKWAVE | WWW.FORESTRIVERACCESSORIES.COM

CUSTOMER SATISFACTION



www.ForestRiverBuyLocal.com

YOUR SHOCKWAVE DEALER