

INSTRUCTIONS



309317

Rev. B



This manual contains important warnings and information.
READ AND KEEP FOR REFERENCE.

INSTRUCTIONS

US Patent Pending

HVLP–Turbine Guns

10 psi (0.07 MPa, .7 bar) Maximum Inlet Air Pressure

50 psi (0.35 MPa, 3.5 bar) Maximum Inlet Fluid Pressure

Related Manuals

309205 – HVLP–Turbine Gun for maintenance and service instructions

309243 – HVLP Turbine

309244 – HVLP Compressor/Cart

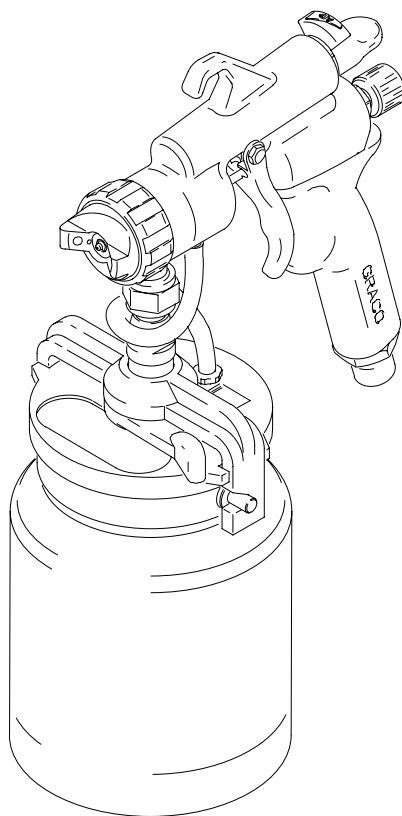

Cup Feed

Includes 1-quart (1 liter) cup

Model 244113, without fluid set

Model 244117, with # 3 fluid set

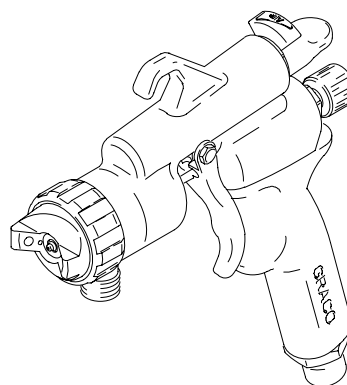

T10746

Remote Pressure Feed

Model 244115, without fluid set

Model 244118, with # 3 fluid set

GRACO INC. P.O. BOX 1441 MINNEAPOLIS, MN 55440-1441

©COPYRIGHT 2001, GRACO INC.

Graco Inc. is registered to I.S. EN ISO 9001

Table of Contents

Symbols	2
Warnings	3
Component Identification	4
Setup	7
Spray	7
Shutdown	8
Parts List	15
Parts Drawing	14
Technical Data	16
Graco Phone Number	NO TAG

Warning Symbol



This symbol alerts you to the possibility of serious injury or death if you do not follow instructions.

Caution Symbol



This symbol alerts you to the possibility of damage to or destruction of equipment if you do not follow instructions.

You will need:

Cleaning fluids: a compatible solvent; water-based paint also requires soap and water.

Suggested proper clothing:

- Safety glasses
- Sturdy boots or shoes
- Respirator
- Gloves



WARNINGS

KNOW ALL HAZARDS BEFORE OPERATING SPRAYER!

Fire and explosion hazard: Solvent and paint fumes can ignite or explode.

- Sprayers generate sparks. Keep sprayer at least 20 feet (6 m) from explosive vapors.
- **Use in an extremely well ventilated area.**
- Eliminate all ignition sources; such as pilot lights, cigarettes and static arcs from plastic drop cloths. Do not plug or unplug power cords or turn lights on or off in spray area.
- Ground Sprayer, object being sprayed, paint and solvent pails.
- Do not use 1,1,1-trichloroethane, methylene chloride, other halogenated hydrocarbon solvents or fluids containing such solvents in pressurized aluminum equipment. Such use could result in a chemical reaction, with the possibility of explosion.

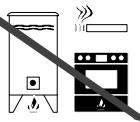

Equipment Misuse Hazard: Equipment misuse can cause the equipment to rupture or malfunction and result in serious injury.

- Before operating equipment, read all instruction manuals, tags, and labels.
- Check equipment daily. Repair or replace worn or damaged parts immediately.
- Do not exceed maximum working pressure (MWPR) of the lowest-rated system component
- Use fluids and solvents that are compatible with the equipment wetted parts. See Specifications on page for this information.
- Wear hearing protection when operating this equipment.
- Do not "blow back" fluid; this is not an air spray system
- Follow **Pressure Relief** before cleaning, checking or servicing the equipment.



INSTRUCTIONS

TOXIC FLUID HAZARD: Hazardous fluid or toxic fumes can cause serious injury or death if splashed in eyes or on skin, inhaled, or swallowed.

- Know specific hazards of fluid you are using and take protective measures as recommended by the fluid and solvent manufacturer.



Component Identification

Air flow control – Adjusts TOTAL air flow to spray gun

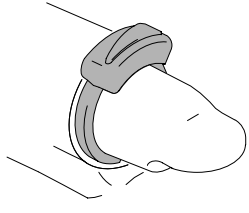

Pattern Adjustment Knob – Adjusts pattern from fan to round

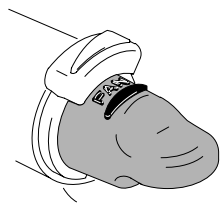

Air cap/retaining ring – Adjusts fan direction

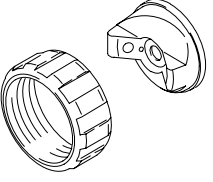

Fluid flow/Pattern size control – Adjusts fluid volume

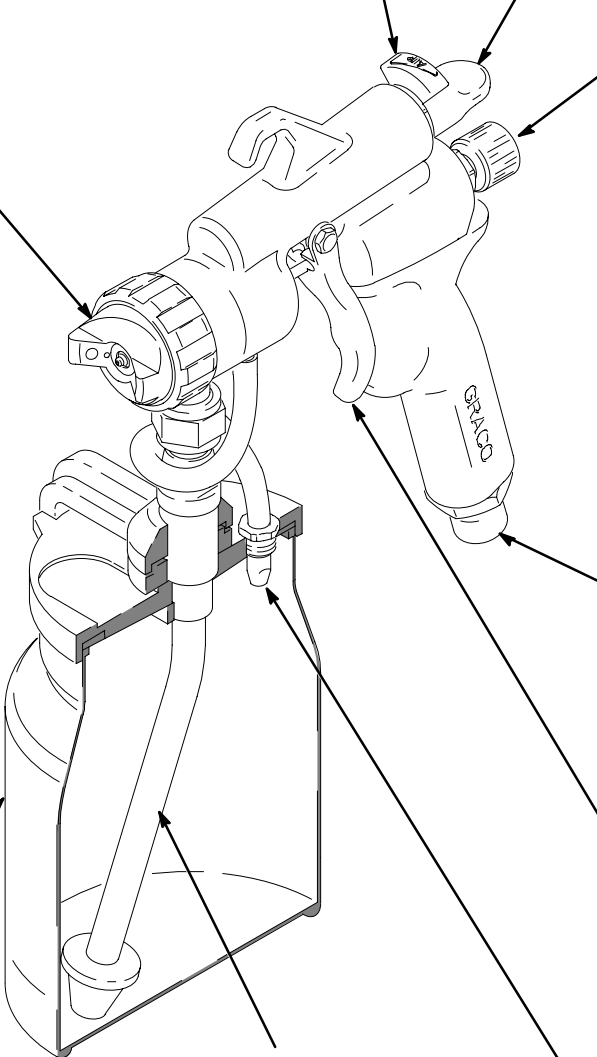
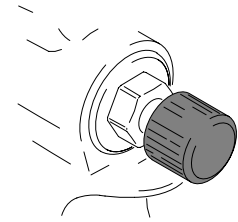

Air inlet



Cup

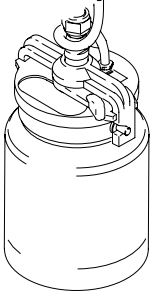

EasyGlide™ Trigger

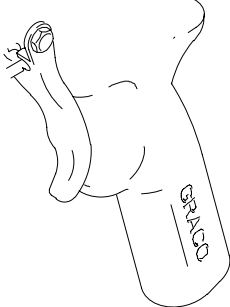

Swivel tube and strainer

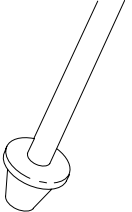

Duckbill check valve

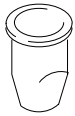

PRESSURE RELIEF – Follow this procedure when cleaning, repairing or shutting down sprayer

For Cup Guns



Follow these instructions whenever you stop spraying.



1. Turn off turbine.

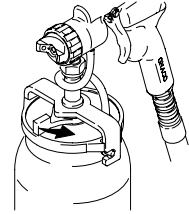

2. Unlatch cup

For Pressure Feed Guns



Follow these instructions whenever you stop spraying.

1. Turn off air supply to the pot.

2. Open pressure relief (A) on pot until pressure is completely relieved. Close relief.

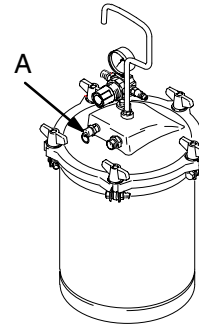

8069A

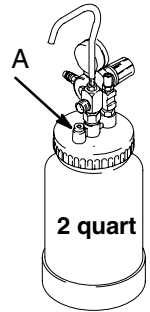

02882

TIP SELECTION

A Tip consists of a fluid nozzle, and fluid needle. Use the following chart for recommendations.

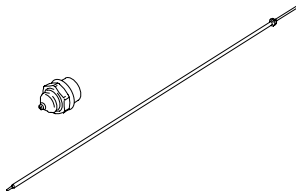

Fluid Set	Tip Size	Fluid Usage
#2 244123	0.8 mm (0.032 in)	Ink, dye and non-wiping stain.
#3 244124	1.3 mm (0.051 in)	Water base lacquer, urethane, varnish, stain, and automotive finish.
#4 244125	1.8 mm (0.071 in)	Lacquer, urethane, varnish, stain, primer, enamel and epoxy.
#5 244126	2.2 mm (0.087 in)	Lacquer, urethane, varnish, stain, primer, enamel, epoxy and higher output industrial finishes.
#6 244127	2.5 mm (0.098 in)	Latex, multi-spec, oil wall paint, industrial finishes, butyrate, and nitrate dope.

Installing the Fluid Set

CAUTION

Trigger the gun whenever you tighten or remove the nozzle. This keeps the needle seat away from the nozzle seating surface and prevents the seat from being scratched.

-
1. Use your hand to loosen and remove the air cap retaining ring and air cap housing.

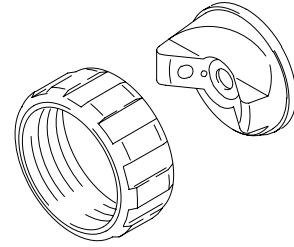

2. Test spray pattern and atomization while holding gun about 6 to inches (150 to 200 mm) from test piece.

-
3. **While triggering the gun**, use your hand to loosen and remove the nozzle.

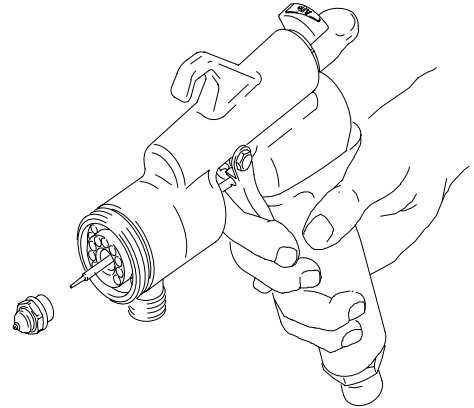

-
4. Use your hand to loosen and remove the fluid knob assembly and compression ring from the back of the gun and remove the old needle.

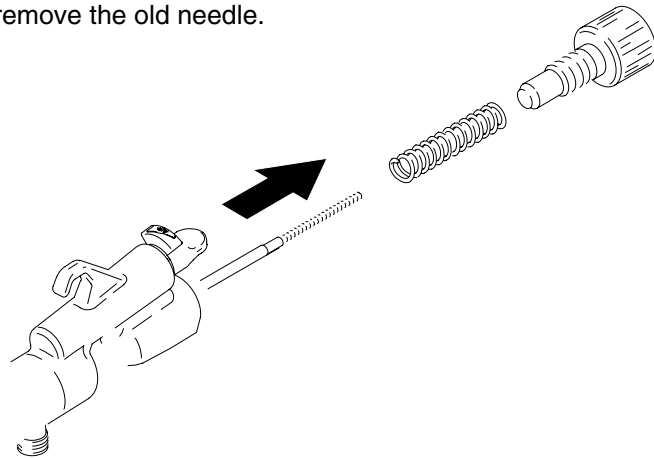

-
5. Insert the needle assembly in the back of the gun. Reassemble nozzle, air cap housing and air cap retaining ring. Hand tighten.

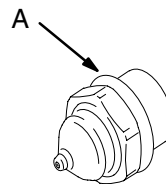

Note: Nozzle should always have an o-ring (A).

Setup

6. Connect air hose to gun and turbine.

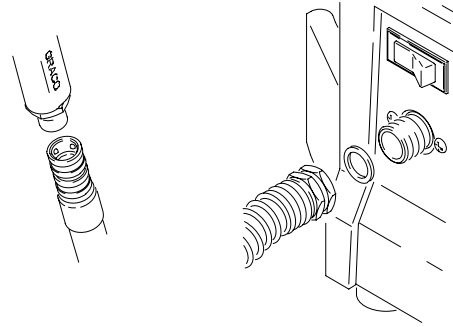

7. For cup gun, turn fluid control out until trigger movement is not restricted.
Caution: Turning knob too far will remove it.

For remote pressure pot, hold gun parallel to floor and adjust fluid pressure to an 8 to 10 inch (203 to 254 mm) fluid stream.

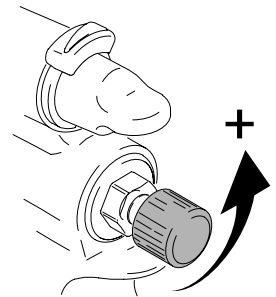

NOTE: Heavier fluids or longer fluid hoses require greater pressures.

8. Reduce and test catalyze all paint to manufacturer's specifications.
- If no reduction instructions are given, mix the fluid thoroughly, then gradually mix in reducer. To check the consistency of the fluid. Remove the stir stick from the thinned paint. When the paint streaming off the stick breaks into droplets, the first few drops should be one second apart.
 - To compensate for faster drying time of turbine systems, use a reducer one step slower than used for conventional air spray systems.

9. Remove cup. Fill 3/4 full. **DO NOT OVERFILL.** Reattach and latch cup.

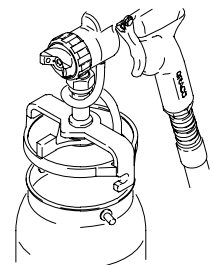

10. Plug turbine power cord into a grounded outlet.

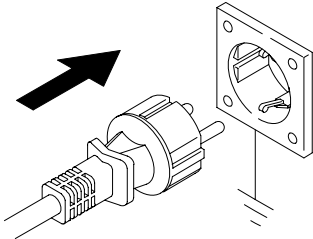

SPRAY

11. Open air control valve.

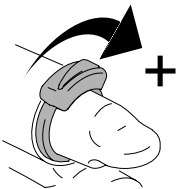

12. Turn turbine on. Wait several minutes prior to spraying to allow warm-up time.

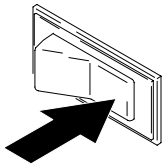

13. Turn air cap to obtain desired direction.

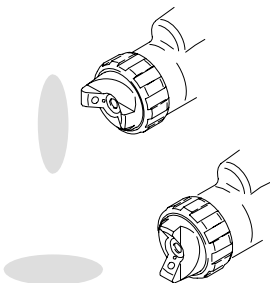

14. Lock air cap with retaining ring.

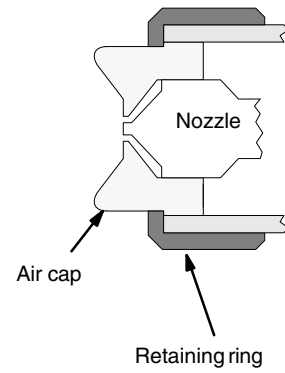

15. Select spray pattern by adjusting the fluid knob and pattern selection knob. The air control adjusts the TOTAL air to the pattern and gun.

Round Pattern
Set knob to RND



Vertical Pattern
Set knob to FAN



Horizontal Pattern
Set knob to FAN

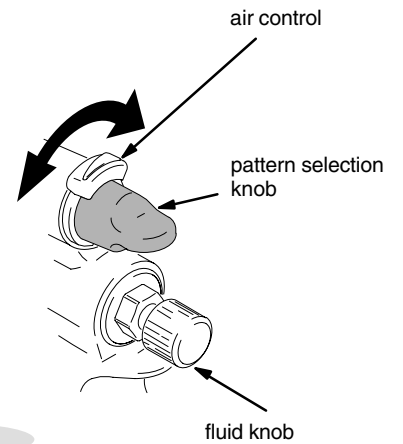

Note: If fluid is not atomizing properly, fluid may need to be thinned further, or a different tip size may be used.

16. Hold gun perpendicular, 6–8 inches from surface. Move gun first, then pull gun trigger to spray.

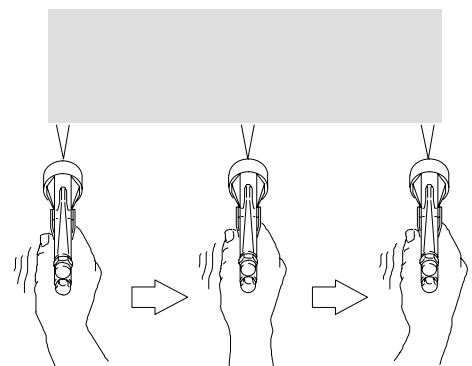

17. To control over-spray, reduce air flow or reduce fluid volume.

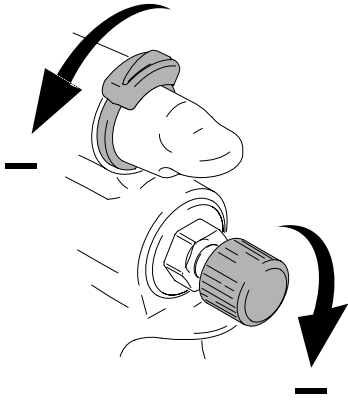

Note: If fluid is not atomizing properly, fluid may need to be thinned further, or a different tip size may be used.

Swivel Tube Adjustment

The adjustable swivel tube allows the HVLP-Turbine Gun to be held in any position when spraying. To adjust the position of the tube in the cup:

1. Loosen the nut (A) with a wrench (42).
2. Rotate the cup to the desired spray position.
3. Retighten the nut (A) with a wrench (42).

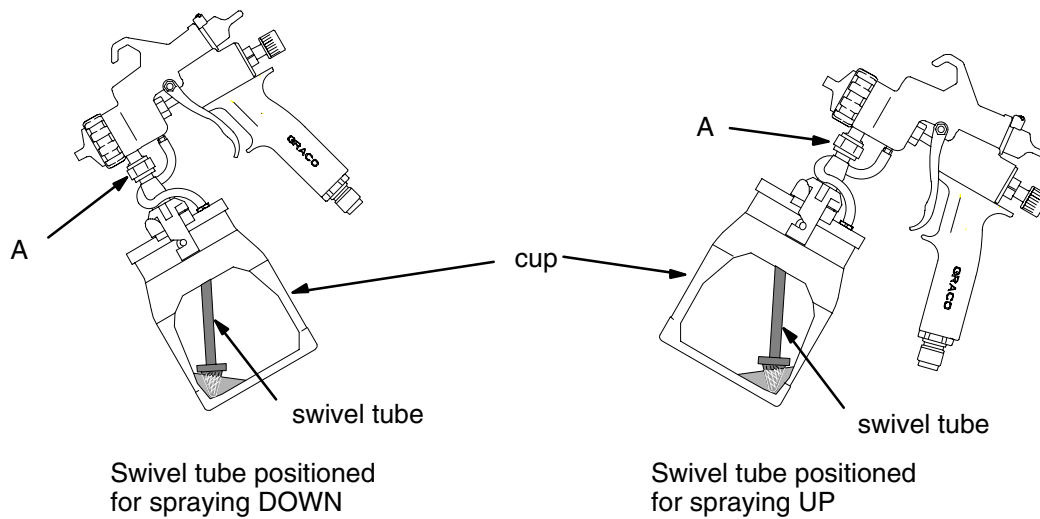

Shutdown

Cleaning the Spray Gun (solvent/oil-based)

1. Close air valve.

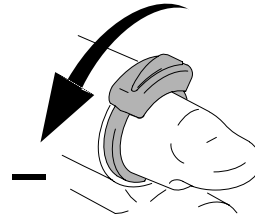

-
2. Perform Pressure Relief Procedure. Remove and empty cup.

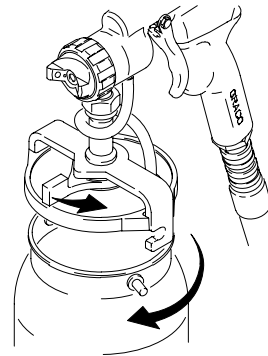

-
3. Add 1.5 inches of compatible cleaning solvent. Reinstall cup.

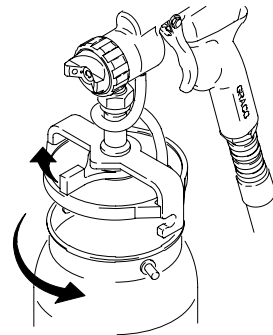

-
4. Turn fan control to round spray pattern.

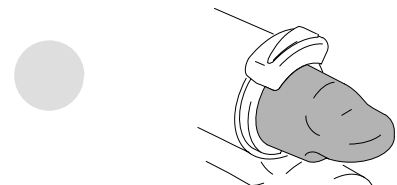

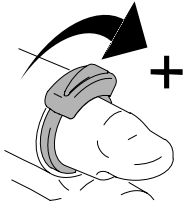

5. Turn air control valve to approximately half way.

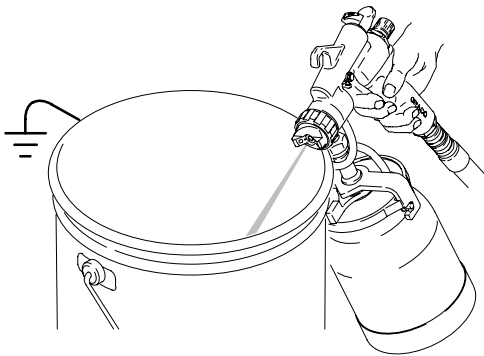

6. Trigger gun until solvent runs clean.

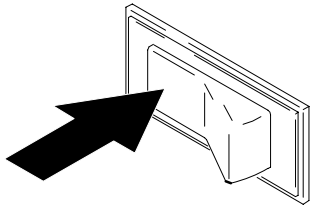

7. Turn turbine off.

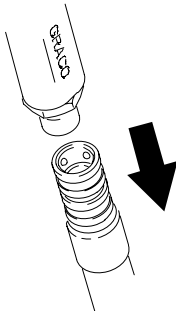

8. Disconnect hose from gun. Perform Pressure Relief. Properly dispose of excess solvent.

Shutdown (water base)

1. Turn turbine off.

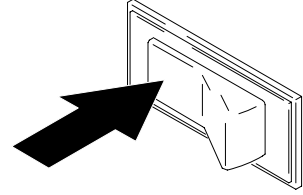

-
2. Perform Pressure Relief Procedure. Remove cup, empty and clean with soap and water.

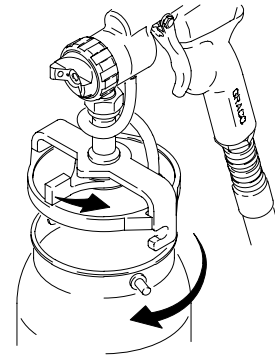

-
3. Remove air cap and nozzle and clean with water and brush.

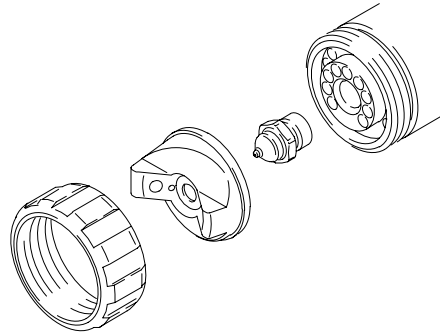

-
4. Clean fluid tube and nozzle housing with water and brush.

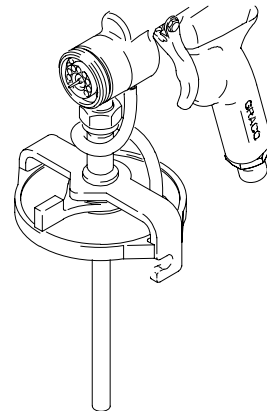

Parts for HVLP-Turbine Gun

Model Nos. 244113, 244115, 244117, 244118

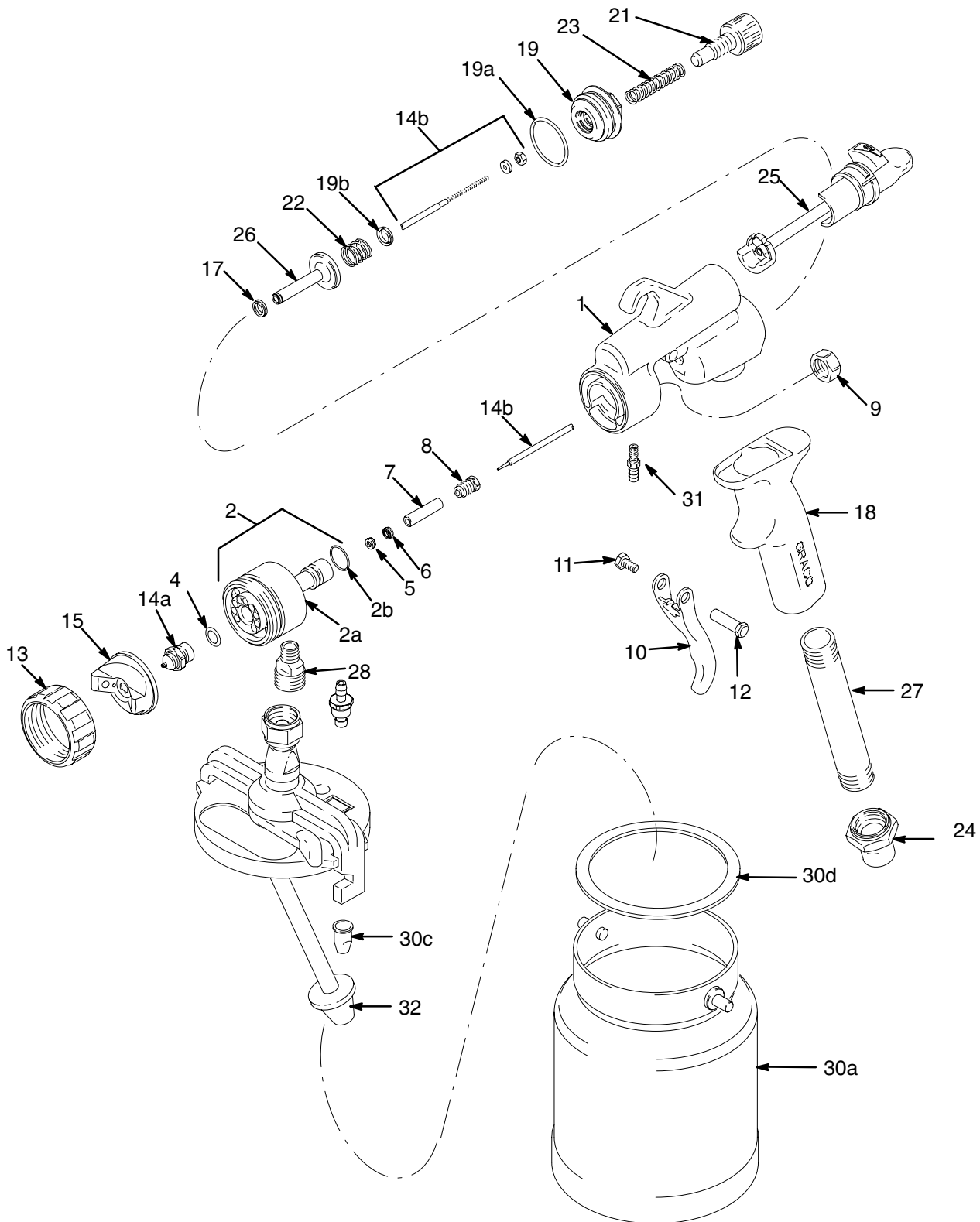

Parts for HVLP–Turbine Gun

Model Nos. 244113, 244115, 244117, 244118

Ref. No.	Part No.	Description	Qty.	Ref. No.	Part No.	Description	Qty.
1	244426	BODY, gun	1	25	243840	VALVE, air fan	1
2	244429	HOUSING, nozzle	1	26	243842	VALVE, air	1
2a	196414	HOUSING		27	196463	TUBE, handle	1
2b	112085	PACKING, o–ring	1	28	196468	FITTING, adapter	1
4	113137	PACKING, o–ring	1	30†	244130	CUP UNDER, kit	1
5	188494	SPREADER, u–cup,	1	30a†	M71667	CUP, 1 quart	1
6	188495	PACKING, u–cup	1	30b†	244133	KIT, air tube, 5-pack (not shown)	1
7	196438	SPACER, packing	1	30c†	244135	VALVE, duckbill	1
8	192352	SCREW, packing	1	30d†	240265	GASKET, cup	1
9	192348	NUT, hex; 1/2–20 UNF	1	31†	M70394	STEM, air	1
10	196439	TRIGGER	1	32	193218	STRAINER	1
11	203953	SCREW, cap, hex head	1	33	M70613	BRUSH, cleaning (not shown)	1
12	192272	PIN, pivot	1	34	070303	LUBRICANT, grease (not shown)	1
13	196415	RING, retaining, air cap	1	35	197448	TOOL, wrench (not shown)	1
14	244124	FLUID SET	1				
14a		NOZZLE, fluid	1				
14b		NEEDLE ASSY	1				
15	244226	HOUSING, air cap	1				
17	188493	PACKING, u–cup, gun	1				
18	196462	HANDLE, gun	1				
19	244428	HOUSING, valve, fluid	1				
19a	110066	PACKING, o–ring	1				
19b	110453	PACKING, u–cup	1				
21	196649	KNOB, fluid control	1				
22	114069	SPRING, compression	1				
23	114072	SPRING, compression	1				
24	196464	COUPLER, male	1				

*Not included on model 244113 or 244115.

†Not included on model 244115 or 244118.

Technical Data

Maximum inlet fluid pressure	50 psi (0.35 MPa, 3.5 bar)
Maximum inlet air pressure	10 psi (0.07 MPa, .7 bar)
Air inlet	Quick-disconnect
Fluid inlet	3/8 nps
Sound levels per ISO 3744	
Sound power level	less than 65.0 dB(A)
Sound pressure level	less than 65.0 dB(A)
Wetted parts	
Bare spray gun	stainless steel, aluminum
Spray gun cups	aluminum, polyethylene
2-quart accessory remote pressure pot	aluminum, polyethylene
2 ¹ / ₂ -gallon accessory remote pressure pot	steel with solvent-resistant finish, EPDM gasket (standard)

Graco Standard Warranty

Graco warrants all equipment manufactured by Graco and bearing its name to be free from defects in material and workmanship on the date of sale to the original purchaser for use. With the exception of any special, extended, or limited warranty published by Graco, Graco will, for a period of twelve months from the date of sale, repair or replace any part of the equipment determined by Graco to be defective. This warranty applies only when the equipment is installed, operated and maintained in accordance with Graco's written recommendations.

This warranty does not cover, and Graco shall not be liable for general wear and tear, or any malfunction, damage or wear caused by faulty installation, misapplication, abrasion, corrosion, inadequate or improper maintenance, negligence, accident, tampering, or substitution of non-Graco component parts. Nor shall Graco be liable for malfunction, damage or wear caused by the incompatibility of Graco equipment with structures, accessories, equipment or materials not supplied by Graco, or the improper design, manufacture, installation, operation or maintenance of structures, accessories, equipment or materials not supplied by Graco.

This warranty is conditioned upon the prepaid return of the equipment claimed to be defective to an authorized Graco distributor for verification of the claimed defect. If the claimed defect is verified, Graco will repair or replace free of charge any defective parts. The equipment will be returned to the original purchaser transportation prepaid. If inspection of the equipment does not disclose any defect in material or workmanship, repairs will be made at a reasonable charge, which charges may include the costs of parts, labor, and transportation.

THIS WARRANTY IS EXCLUSIVE, AND IS IN LIEU OF ANY OTHER WARRANTIES, EXPRESS OR IMPLIED, INCLUDING BUT NOT LIMITED TO WARRANTY OF MERCHANTABILITY OR WARRANTY OF FITNESS FOR A PARTICULAR PURPOSE.

Graco's sole obligation and buyer's sole remedy for any breach of warranty shall be as set forth above. The buyer agrees that no other remedy (including, but not limited to, incidental or consequential damages for lost profits, lost sales, injury to person or property, or any other incidental or consequential loss) shall be available. Any action for breach of warranty must be brought within two (2) years of the date of sale.

Graco makes no warranty, and disclaims all implied warranties of merchantability and fitness for a particular purpose in connection with accessories, equipment, materials or components sold but not manufactured by Graco. These items sold, but not manufactured by Graco (such as electric motors, switches, hose, etc.), are subject to the warranty, if any, of their manufacturer. Graco will provide purchaser with reasonable assistance in making any claim for breach of these warranties.

In no event will Graco be liable for indirect, incidental, special or consequential damages resulting from Graco supplying equipment hereunder, or the furnishing, performance, or use of any products or other goods sold hereto, whether due to a breach of contract, breach of warranty, the negligence of Graco, or otherwise.

FOR GRACO CANADA CUSTOMERS

The parties acknowledge that they have required that the present document, as well as all documents, notices and legal proceedings entered into, given or instituted pursuant hereto or relating directly or indirectly hereto, be drawn up in English. Les parties reconnaissent avoir convenu que la rédaction du présente document sera en Anglais, ainsi que tous documents, avis et procédures judiciaires exécutés, donnés ou intentés à la suite de ou en rapport, directement ou indirectement, avec les procédures concernées.

ADDITIONAL WARRANTY COVERAGE

Graco does provide extended warranty and wear warranty for products described in the "Graco Contractor Equipment Warranty Program".

Graco Phone Number

TO PLACE AN ORDER, contact your Graco distributor, or call this number to identify the distributor closest to you:
1-800-690-2894 Toll Free

All written and visual data contained in this document reflects the latest product information available at the time of publication.

Graco reserves the right to make changes at any time without notice.

MM 309317

Graco Headquarters: Minneapolis

International Offices: Belgium, China, Japan, Korea

GRACO INC. P.O. BOX 1441 MINNEAPOLIS, MN 55440-1441

www.graco.com

2/2002 Rev. 5/2006