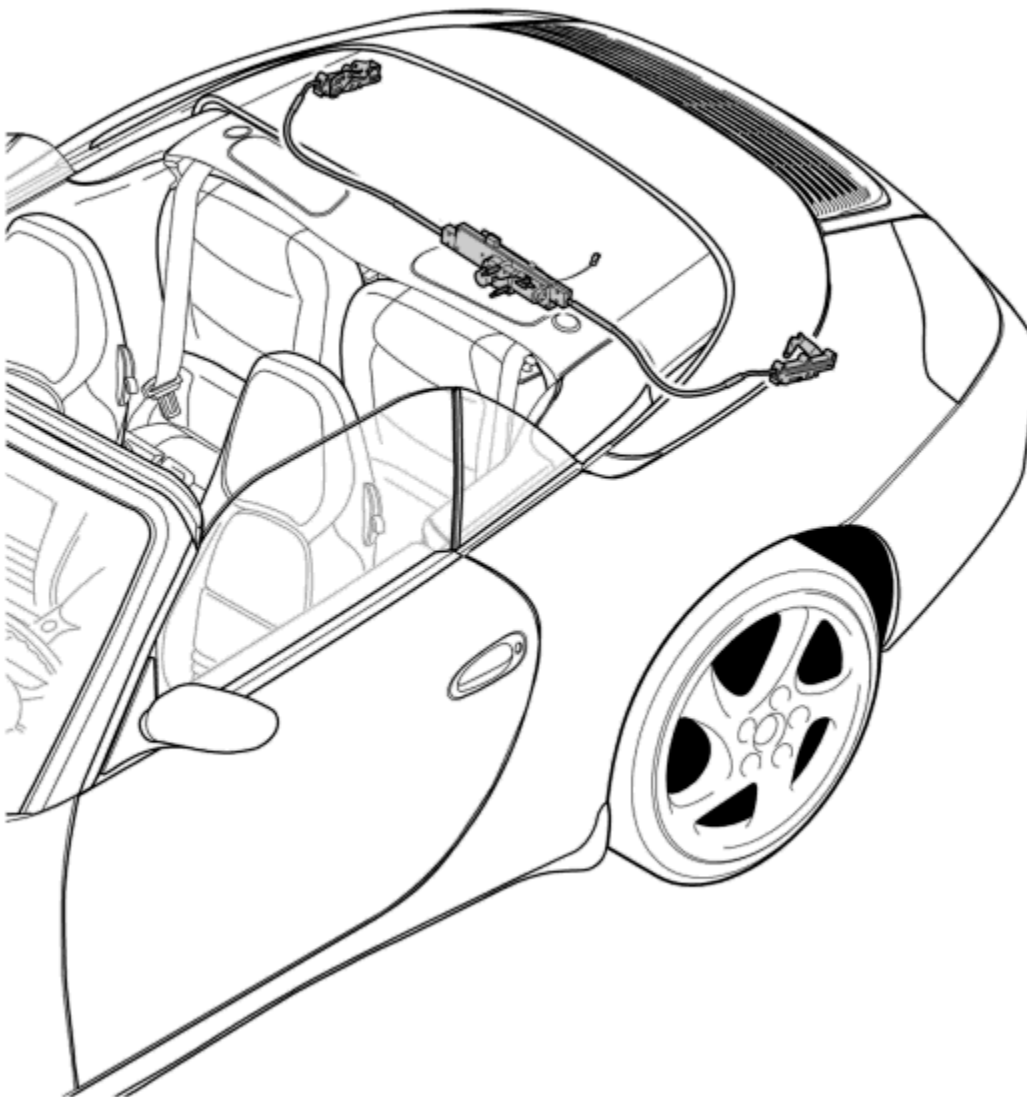

61 70 31 Converting motor for convertible-top compartment lid drive

- Removing motor for convertible-top compartment lid drive Stage 1 and 2
- Removing and installing bracket for stage 1 (Cabriolet with glass window)
- Converting and installing bracket for stage 2 (Cabriolet with flexible rear window)
- Converting microswitch for convertible-top compartment lid drive
- Installing motor for convertible-top compartment lid drive Stage 1 and 2
- Calibration values, pot. 2, convertible-top compartment lid
- Tools and materials
- Tightening torques

Illustrated on the 911 Carrera Cabriolet (996)

**Note**

- As of model year 2004 the bracket and motor Motor for convertible-top compartment lid drive has changed. This document describes the necessary conversion in stage 1: only for Cabriolet vehicles from model year 2002 up to and including 2003 (Cabriolet with glass window).
- When the Motor for convertible-top compartment lid drive is supposed to be replaced for Cabriolet vehicles up to and including model year 2001, the original installed bracket (ET No. 996.561.117.01) and the new bracket to be used (ET No. 996.561.207.01) must be mechanically processed and installed together. This conversion is more complex and is called stage 2.

Removing motor for convertible-top compartment lid drive Stage 1 and 2

1. Moving convertible top to service position
2. Removing carpet over the motor
 - To loosen the carpet, pull out the plastic clips with the special tool 21 => Tools and materials and take out the carpet.
3. Electric plug connection for microswitch
 - Disengage electric plug connection for microswitch -5- on support, unlock -A- and disconnect.

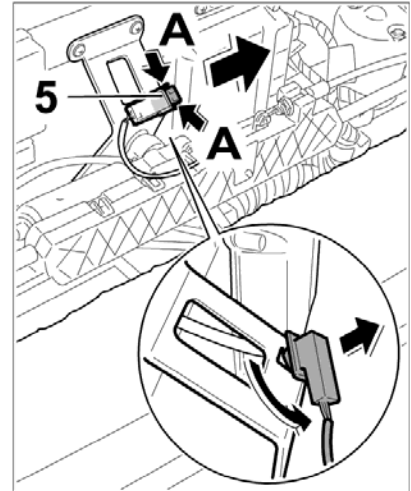

4. Removing motor from support
 - Loosen both fastening nuts -1- unlock the electric plug connection -2- and unplug at control unit.
 - Pull motor backwards out of the bracket.

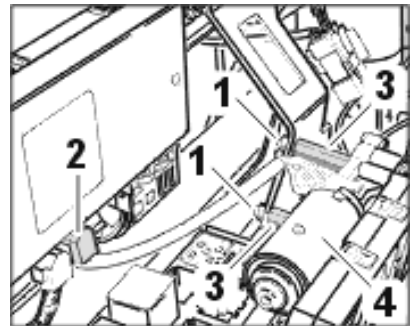

5. Removing motor from convertible top compartment lid drive
 - Loosen both hexagon thread bolts -3- and pull out.
 - Take out motor for convertible-top compartment lid drive -4- .

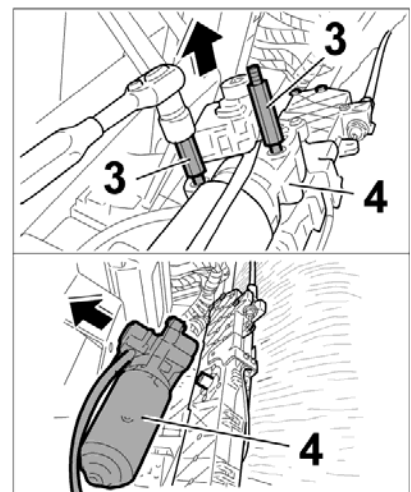

Removing and installing bracket for stage 1 (Cabriolet with glass window)



Note

- As of model year 2004 the bracket and motor Motor for convertible-top compartment lid drive has changed. This document describes the necessary conversion in stage 1: only for Cabriolet vehicles from model year 2002 up to and including 2003 (Cabriolet with glass window).

-A- Installed bracket for Cabriolet vehicles for model year 2002 up to and including 2003.

-B- Installed bracket for Cabriolet vehicles as of model year 2004, and if spare parts are needed, when the motor for convertible-top compartment lid drive must be replaced.

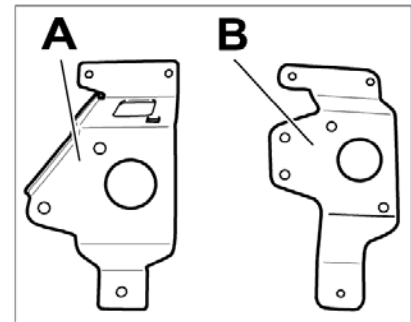

1. Removing the bracket **-A-**

- Unscrew the three fastening screws **-6-** for the bracket **-A-** for the convertible top compartment lid motor and take out the bracket.

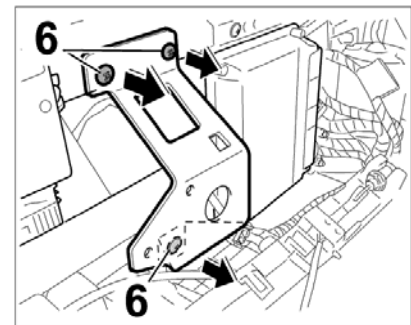

2. Installing bracket **-B-**

- Position new required bracket **-B-** and screw down the three fastening screws **-6-**.

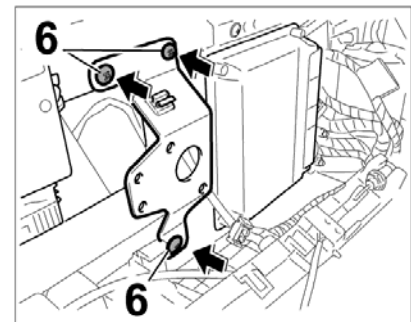

Converting and installing bracket for stage 2 (Cabriolet with flexible rear window)



Note

- When the Motor for convertible-top compartment lid drive is supposed to be replaced for Cabriolet vehicles up to and including model year 2001, the original installed bracket (ET No. 996.561.117.01) and the new bracket to be used (ET No. 996.561.207.01) must be mechanically processed and installed together. This conversion is more complex and is called stage 2.

1. Removing bracket for convertible top compartment lid motor

- Bore out the permanently riveted support **-1-** from the bracket 996.561.117.01.
- Modify the support using the listed dimensions.

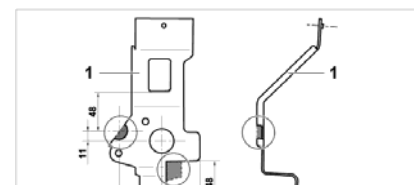

2. Bracket 996.561.207.01
 - c. Modify the support/bracket **-2-** using the listed dimensions.
3. Mounting the support **-1-** on the bracket
 - d. Rivet the support **-1-** on the bracket.
 - e. Install the bracket with the modified support **-1-**.

4. Installing the support **-1-** and bracket **-2-** together

The illustration shows the position of the DME control unit as of model year 2002.

- f. Position the modified bracket **-2-** behind the support **-1-**, push the M6x25 fastening screws (property class 8.8) **-10-** through the support **-1-** and bracket **-2-** and screw down both fastening nuts **-10A-**. Tightening torque for fastening nuts **-10A-** 9.7 Nm (7 ftlb.)

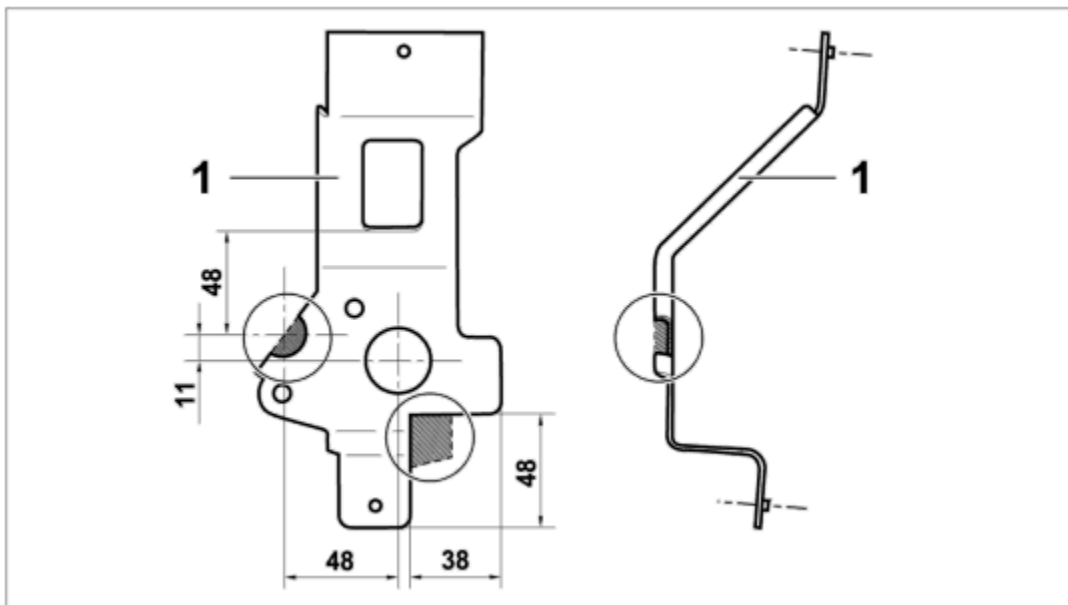
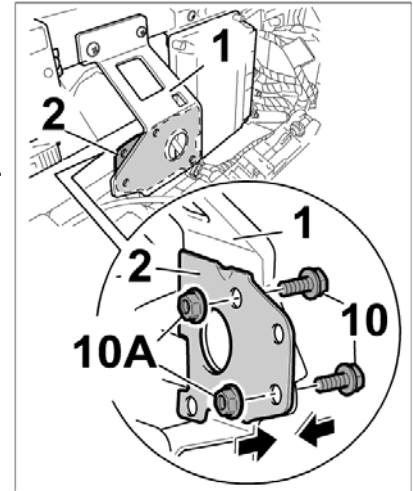

1 Support for convertible top compartment lid motor of bracket 996.561.117.01

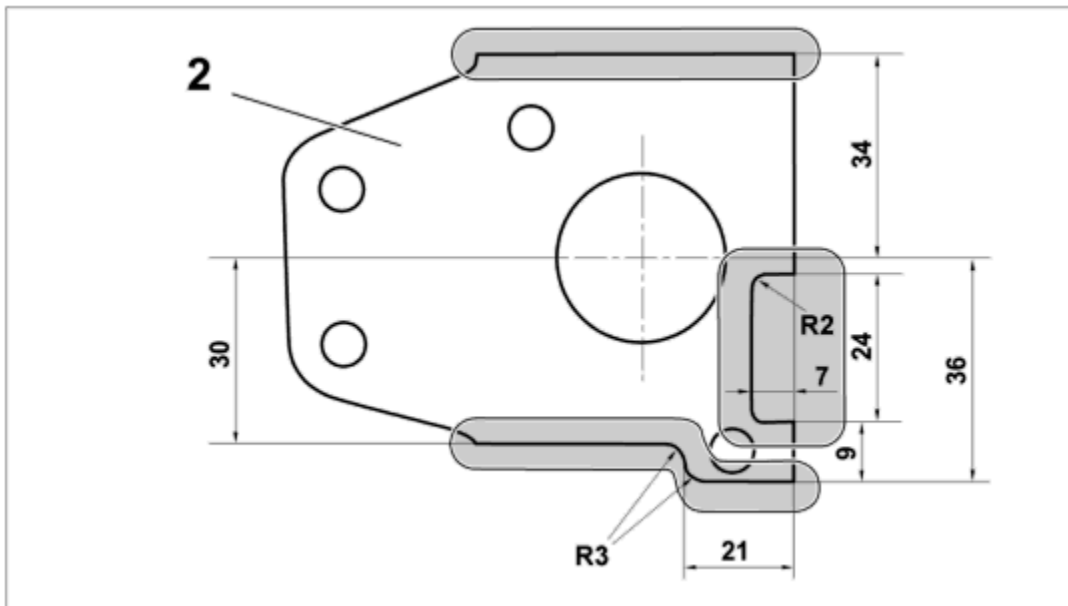

1 Bracket 996.561.207.01

Converting microswitch for convertible-top compartment lid drive



Note

- A new microswitch with support must be installed for the new motor mounting for the convertible-top compartment lid drive.
- **-A-** Old microswitch.
- **-B-** New microswitch.
- The microswitch is seated on the drive for the convertible top compartment lid.

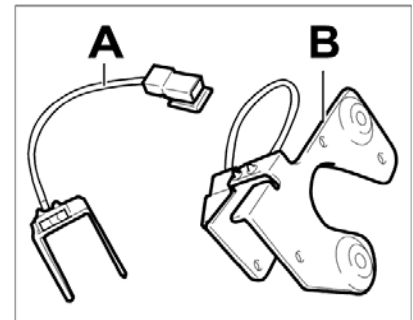

1. Removing the microswitch **-A-**

- Unscrew the fastening screw **-7-** and take the microswitch with support up and off.

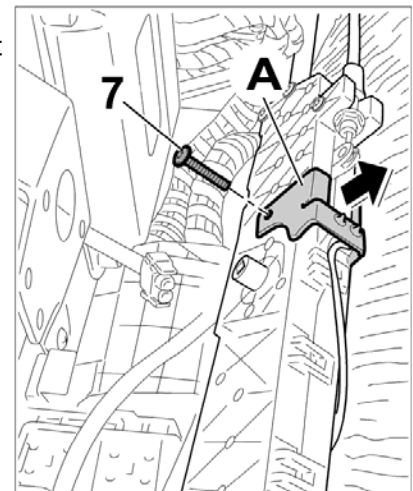

2. Installing microswitch -B-

- a. Position the new microswitch on the convertible top compartment lid drive and screw down the fastening screws -7, 8- .

Installing motor for convertible-top compartment lid drive Stage 1 and 2

1. Completely open convertible-top compartment lid

- Grasp convertible-top compartment lid above the brake light and pull backwards and up until the convertible top compartment lid is completely open.

2. Positioning the potentiometer

The potentiometer must be set to 6.2 kΩ before installing the motor.

- Push the potentiometer on the shaft and maintain the position of the lug **-A-** on the motor, do not clip the potentiometer on the motor.
- The potentiometer can be adjusted by pushing out and turning the shaft.

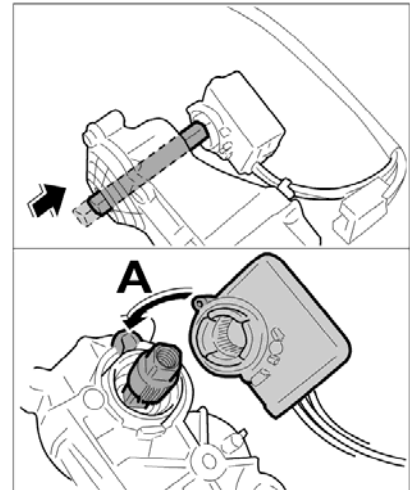

3. Setting the potentiometer

The potentiometer must be set to 6.2 kΩ before installing the motor.

- Connect a commercially available digital multimeter to pin 3 (blue/yellow) and pin 5 (red/black) of the potentiometer.
- Lift the potentiometer from the motor and turn on the teeth until it reaches a value of 6.2 kΩ.
- Clip the potentiometer on the motor.

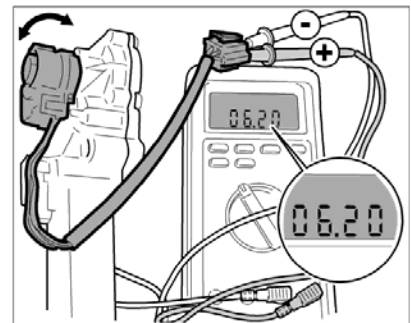

4. Hexagon socket head bolt for emergency operation of convertible top compartment lid

- Coat hexagon socket head bolt for emergency operation of convertible top compartment lid with screw locking compound and screw it in three turns (left-hand thread).

5. Using new studs

- **-A-** Old studs
- **-B-** New studs

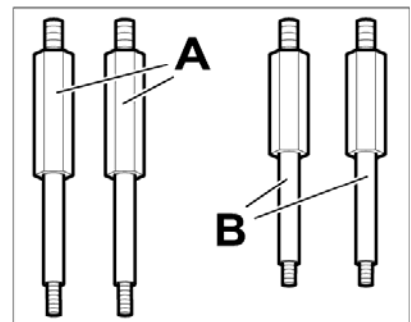

6. Screw down motor with studs

- Screw down the motor for convertible top compartment lid with both



new studs **-3- -B-** to drive for convertible top compartment lid.
Tightening torque for hexagon thread bolts **-3-** 6 Nm (4.5 ftlb.).

7. Installing motor

Illustration shows version, stage 2

- Push motor with potentiometer on the bracket and screw down the fastening nuts **-11-**. Fastening nuts **-11-** 10 Nm (7.5 ftlb.).

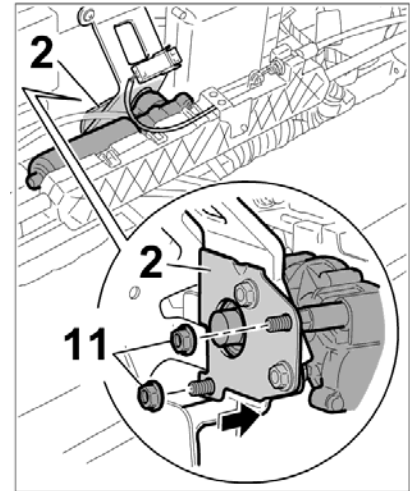

8. Plugging in electrical plug connections

- Insert electric plug connection for potentiometer **-2-** onto control unit until the connector is felt to engage.
- Insert electric plug connection for microswitch **-5-** and engage on the bracket.

9. Laying carpet over the motor

- Insert the carpet again and fasten with the plastic clips.

10. Moving convertible top from the service position

- Engage tension ropes.

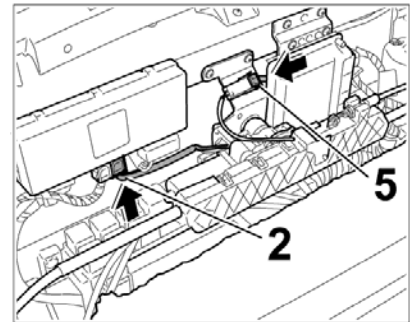

11. Calibrating the potentiometer

Once the motor has been installed, the potentiometer must be recalibrated with the Porsche System Tester 2.

- Select menu item "Convertible top". Select menu item "Calibrate" in the command line which then appears. Start calibration with the F7 key. Calibration can be started irrespective of whether the convertible top position is open or closed. The latching hook in roof frame 1 does not close during calibration.
- The values => Calibration values, pot. 2, convertible-top compartment lid between pot. 2, calibration value 1, and pot. 2, calibration value 4, are calculated as percentage by the convertible-top control unit.

Calibration values, pot. 2, convertible-top compartment lid

Designation	Dimension	Note
Pot. 2 calibration value 1	> 1.0 volt	Tester display must be greater than 1.0 volt
Pot. 2 calibration value 2	< 3.9 volts	Tester display must be less than 3.9 volts
Pot. 2 calibration value 3	< 3.9 volts	Tester display must be less than 3.9 volts
Pot. 2 calibration value 4	< 3.9 volts	Tester display must be less than 3.9 volts

Tools and materials

Item	Special tool designation	Explanation
1	Removal tool, universal 21	Gr. 2.4; Workshop Equipment Manual

Tightening torques

Location	Illustration	Thread	Tightening torque [Nm] (ftlb.)
Hexagon thread bolts for installing the drive	-3-	M5	6
Hexagon nut for installing the drive	-11-	M6	10

996310, 996311, 996610, 996611, 996630, 996631, 996620, 996621