

A&N Model Trucks



Aussie T610 SAR truck.
Resin kit, 1/24

Warning!

For the best results we highly suggest to use our photo-etched chassis for Aussie T610 trucks. But you still can use an Italeri's generic American chassis (except Volvo VN and Peterbilts).

Read carefully this instruction and please follow it during assembling, otherwise you could face problems with assembling the model.

Photo-etched parts have sharp edges, please be careful.

This model kit contains very small parts and is **not suitable for children**.

This model kit is for advanced modellers only!

You can download this instruction as PDF-file at the our site at «Instructions» section, or use QR-code on the last page.

Symbols:

 - glue parts;

 - do not glue parts;

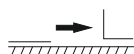
 - bend parts;

 - attention;

 - moving parts;

 - your choice;

 - cut;

! Basic guidelines for modification of Italeri's chassis

(skip this section and jump on page 7 if you use photo-etched chassis).

WARNING! We didn't test our cab kits with Italeri chassis, we can provide only basic dimensions for chassis.

1. Frame length.



2. Wheelbase and space between center of front wheels and front end of a frame

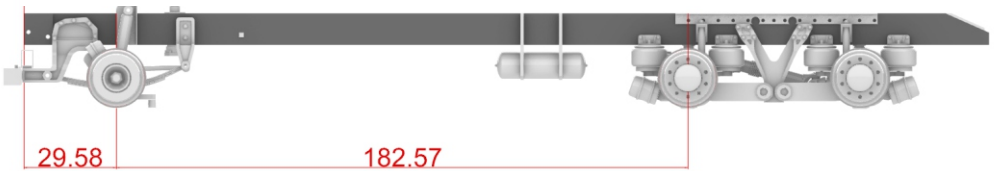

3. Dimensions for front suspension.

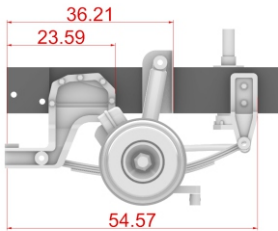

4. Dimensions for cab's supports (from front end of frame).

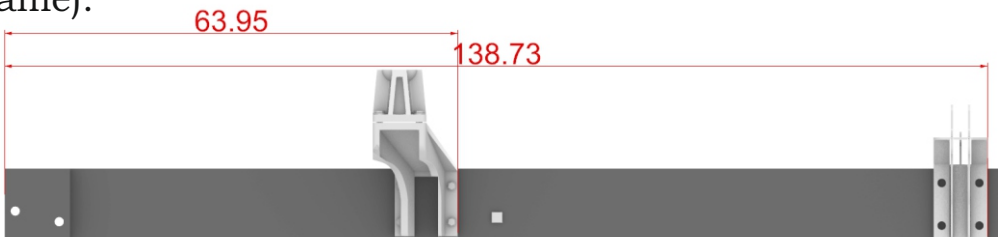



5. Max height of radiator.



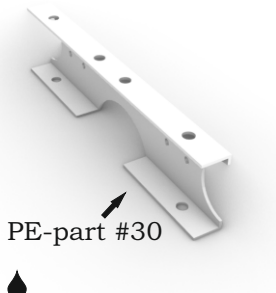

6. How to make cross-member for rear cab's support.

6.1.  

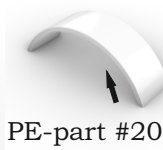

6.2.  



6.3.   x4

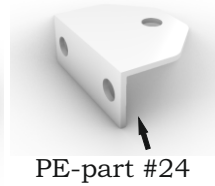

6.4. 

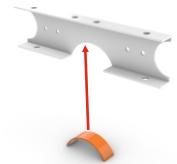

6.5. 

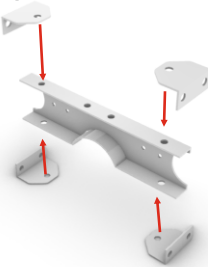

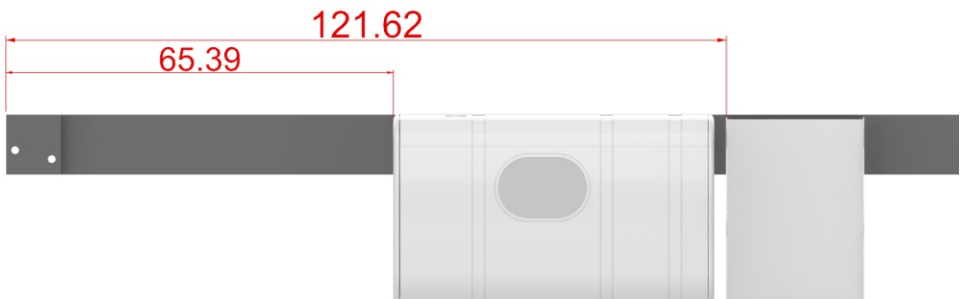

7. Space from front end of frame and front ends of tanks.

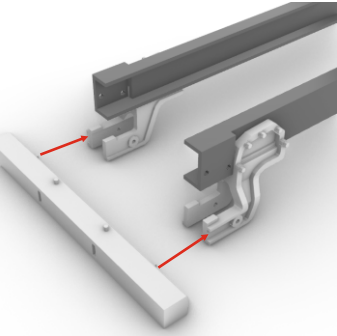

8. Front end of frame.

8.1. 



8.2. 

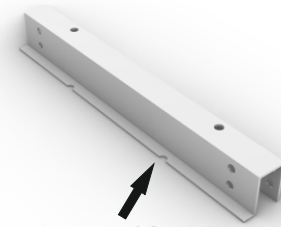

8.3. 

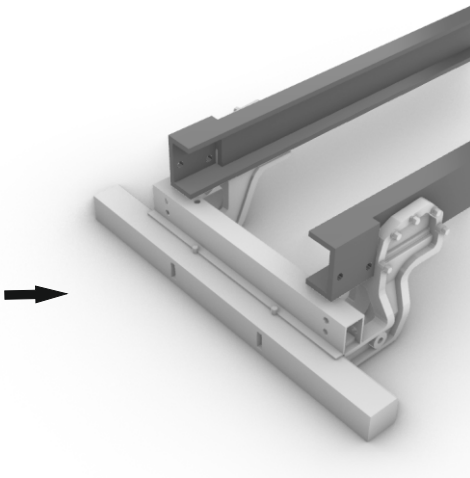
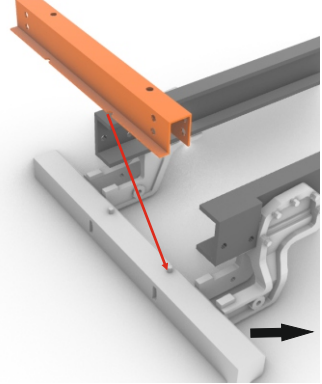

! Holes' numbers you can find on a paper sheet in our chassis kit.
! In case if you use Italeri chassis kit as donor, please refer previous section for dimensions.

Main section

1.  x2

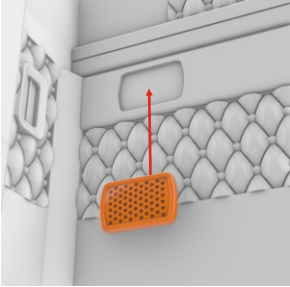

2.  x2

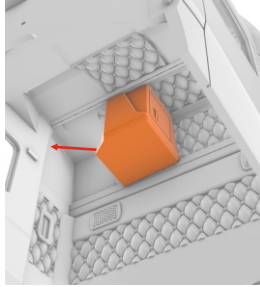

3.  x2

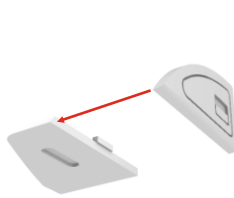

4.  x2

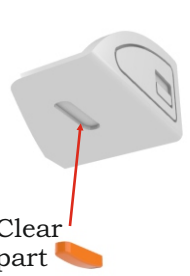

5.  x2

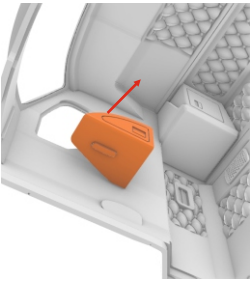

6.  x2

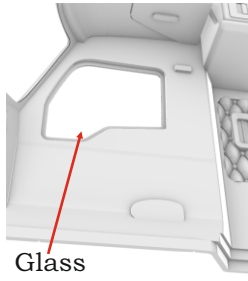

7.  x2

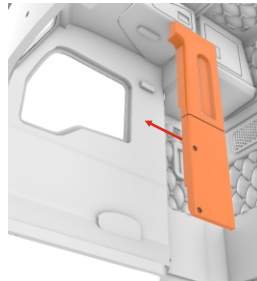

8.  x2

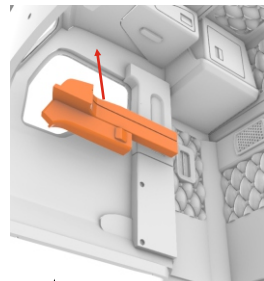

9.  x2

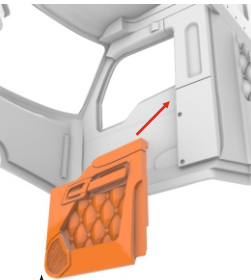

10. 

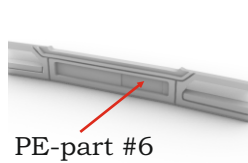

11. 

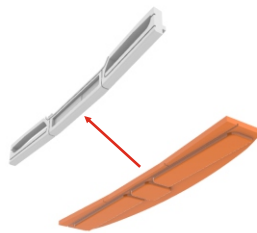

12. 

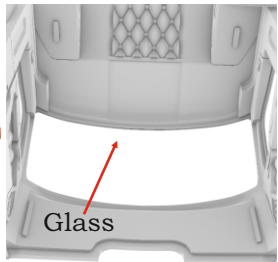

13. 

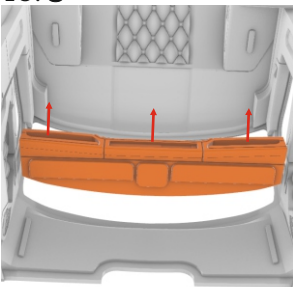

14.  x2

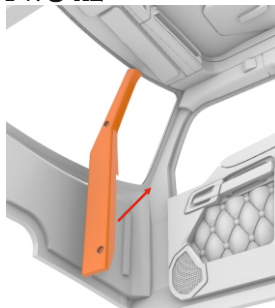

15.  x2

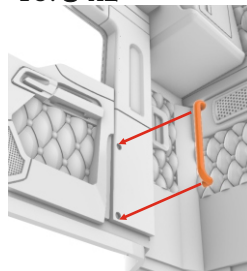

Aussie T610 SAR truck. Resin kit, 1/24

16. 

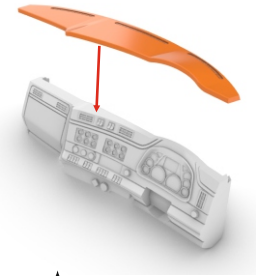

17. 

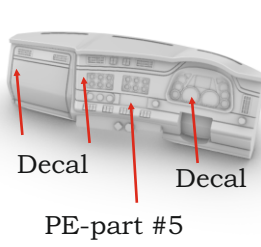

18. 

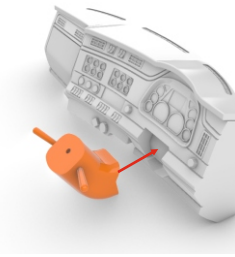

19. 

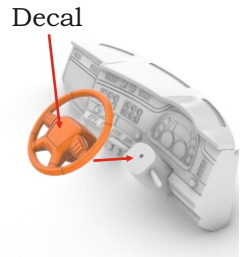

20. 

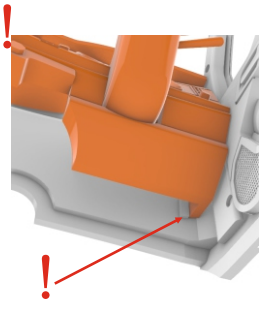
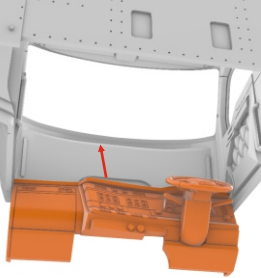

21.  x2

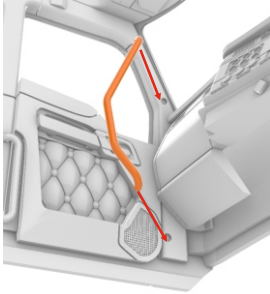

22.  x2

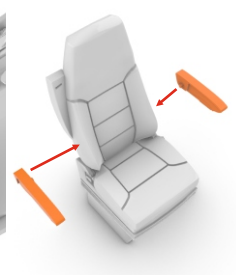

23.  x2

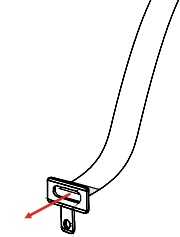

24.  x2

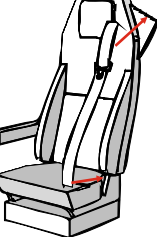

25. 

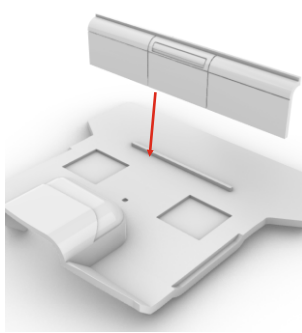

26. 

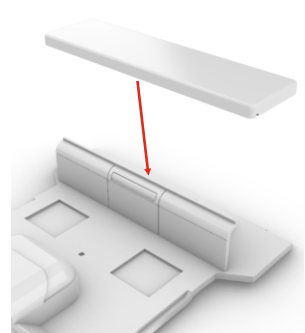

27. 

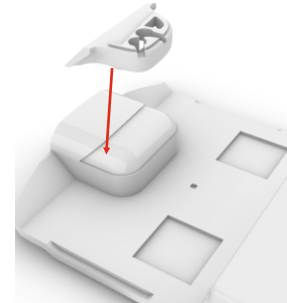

28.  x2



29. 

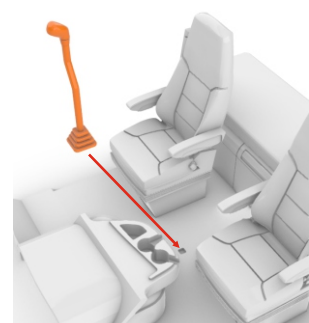

Aussie T610 SAR truck. Resin kit, 1/24

30.  x2

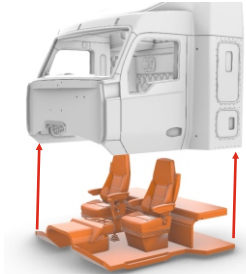

31.  x2

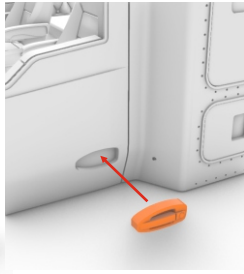

32.  x2



33.  x2

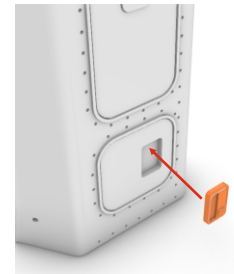

34.  x6



PE-part #22

35.  x6

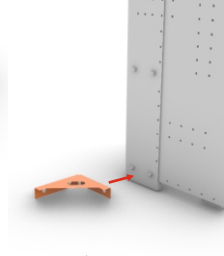

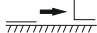
36.  x2



PE-part #23

37.  x2

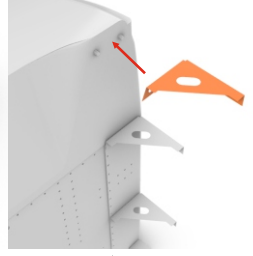

38. 

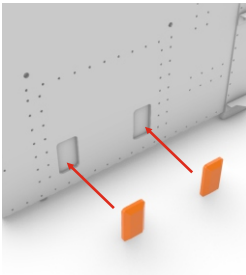

39. 

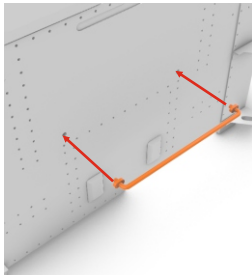

40. 

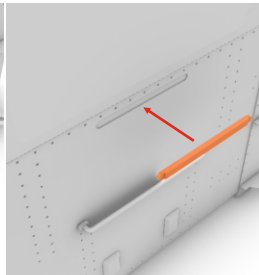

41.  x2

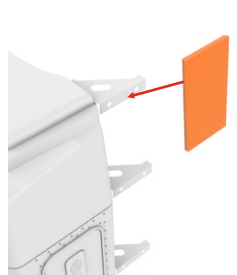

42.  x2

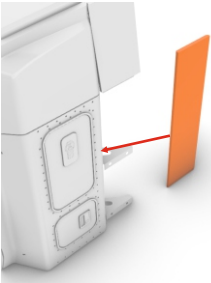

43.  x2



44.  x2

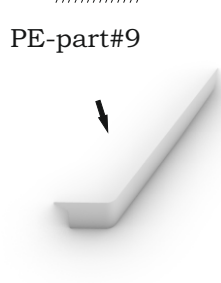

PE-part #9

45.  x2

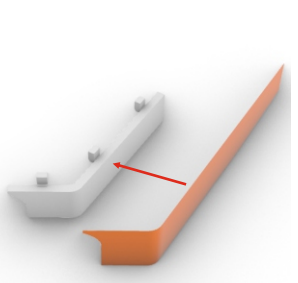

Aussie T610 SAR truck. Resin kit, 1/24

46.  x2

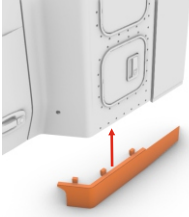

47.  x2

PE-part #54

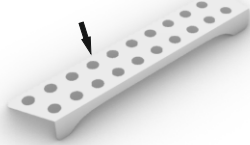

48.  x2

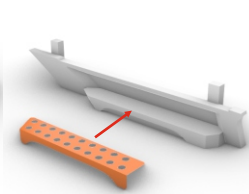

49.  x2



50. 

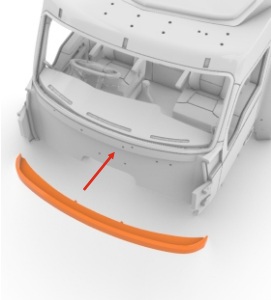

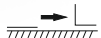
51.  x2

PE-part #16



52.  x2

PE-part #10

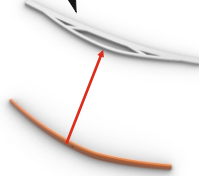

53.  x2

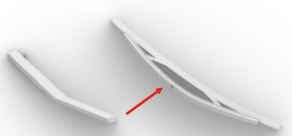

54. 

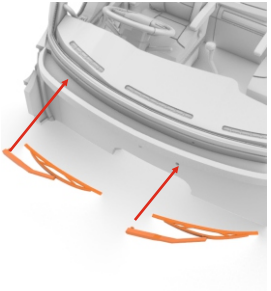

55. 

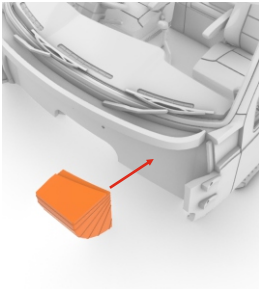

56.  x2

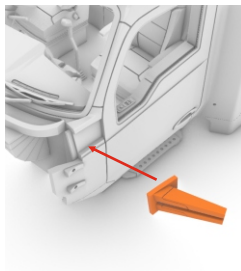

57.  x2

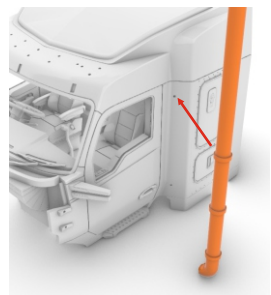

58. 



PE-parts #17, 18

59.  x2



60. 

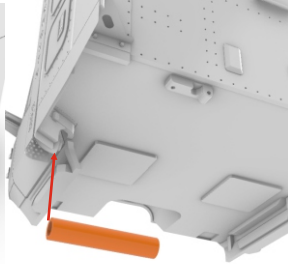

61. 

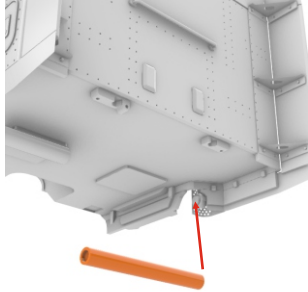

Aussie T610 SAR truck. Resin kit, 1/24

62.  x2

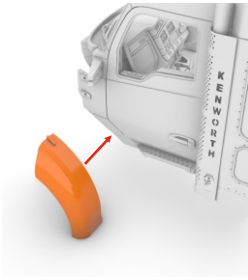

63.  x4

PE-part #50

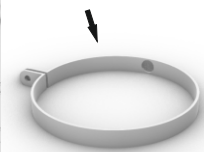

64.  x2

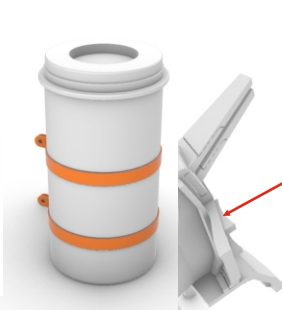

65.  x2

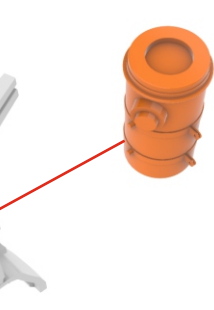

66.  x2

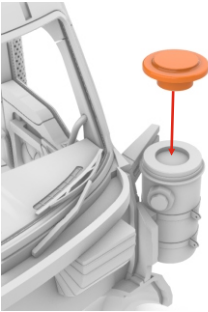

67. 

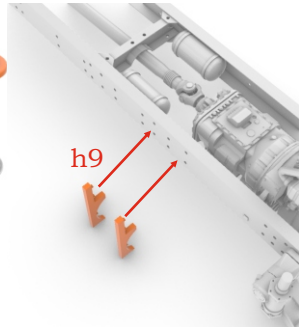

68. 

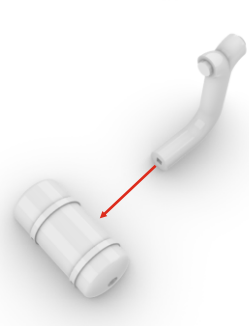

69. 

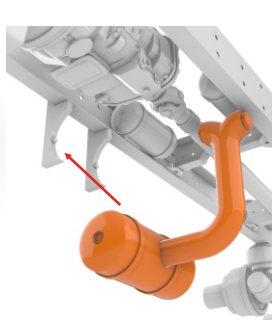

70. 



71. 

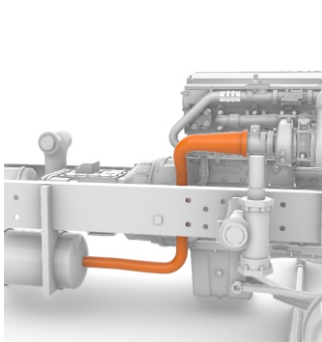

72.  x2

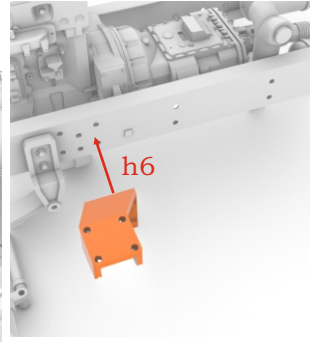

73.  x2

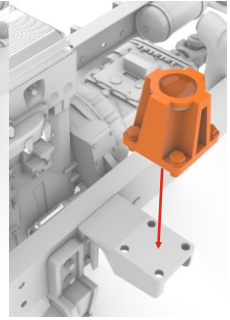

74. 



PE-parts #37, 38

75. 

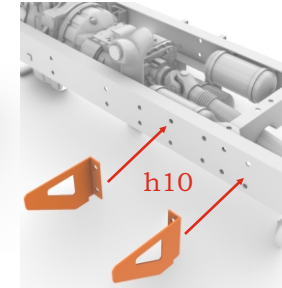

76.  x2

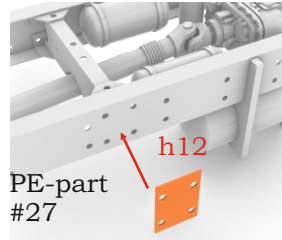

PE-part #27

77. 

PE-parts #28, 29

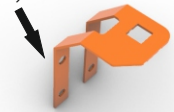

Aussie T610 SAR truck. Resin kit, 1/24

78. 🟦

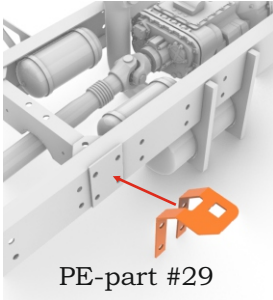

79. 🟦 x2

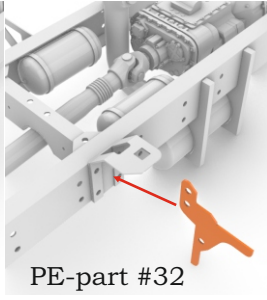

80. 🟦

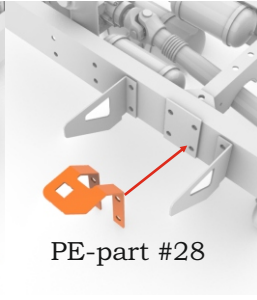

81. 🟦 x2

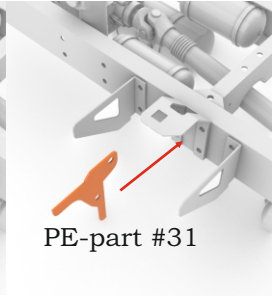

82. 🟦 x2

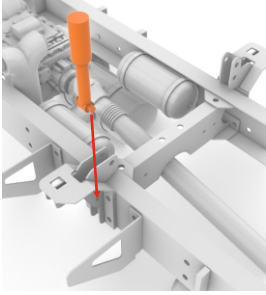

83. 🟦 x2

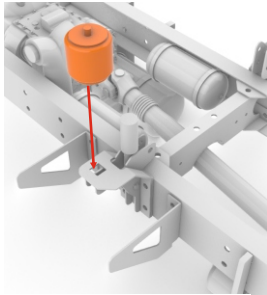

84.  x2

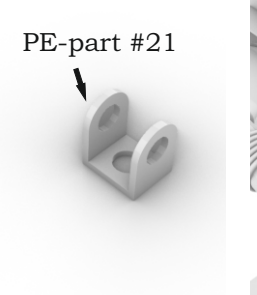

85. 🟦

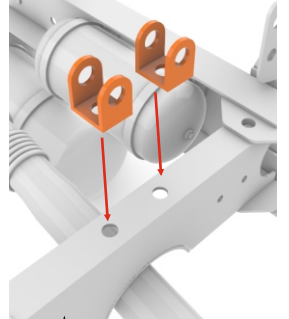

86. 🟦 x2

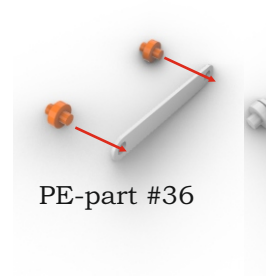

87. 🟦 x2

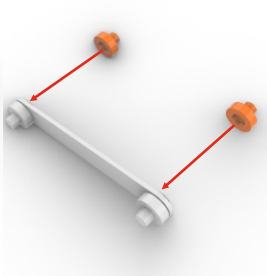

88. 🟦



89. 🟦

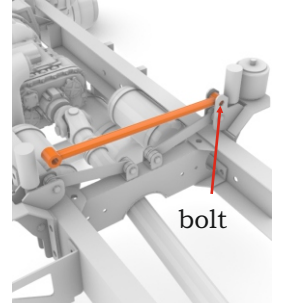

90. 🟦

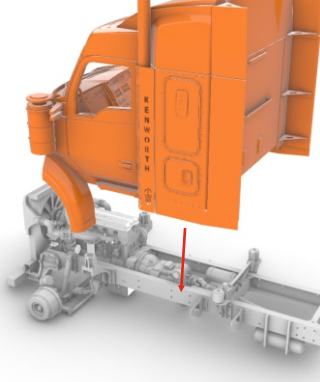

91. 🟦

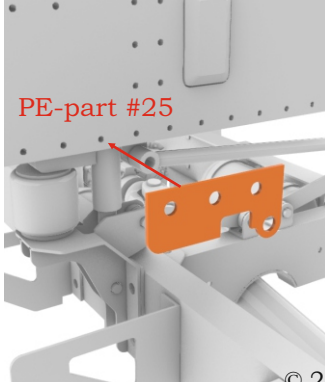

92. 🟦

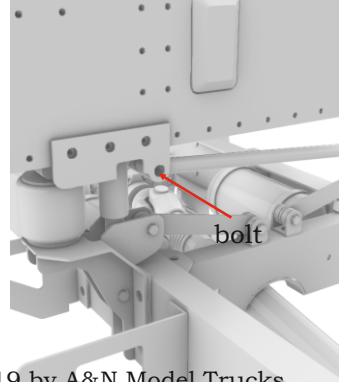

Aussie T610 SAR truck. Resin kit, 1/24

93. 🟰

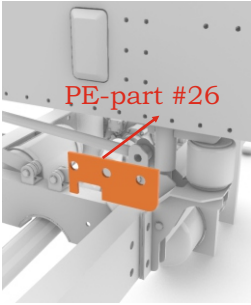

94. 🟰

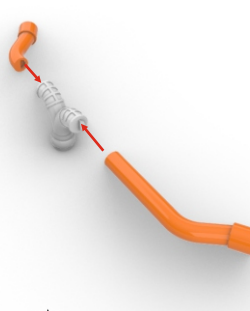

95. 🟰

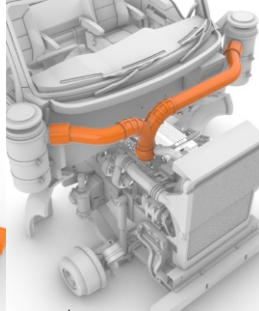

96. 🟰

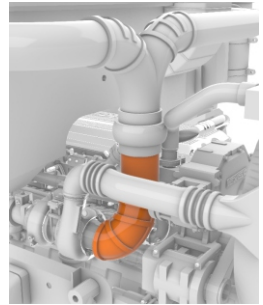

97. 🟰 x2

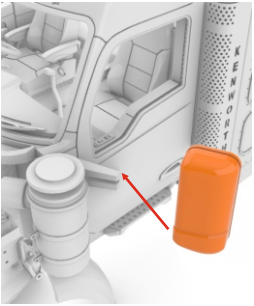

98. 🟰

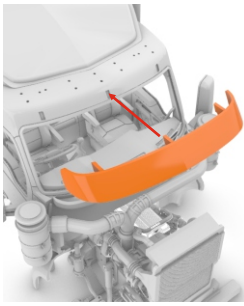

99. 🟰 x5

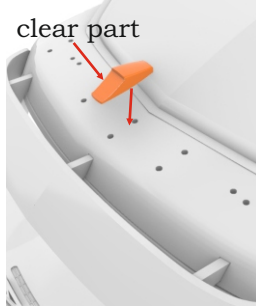

100. 🟰 x2

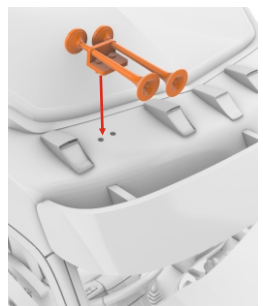

101. 🟰

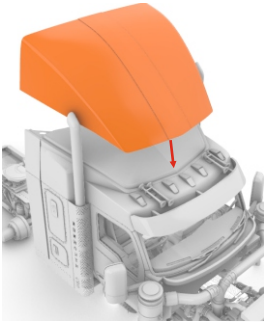

102. 🟰

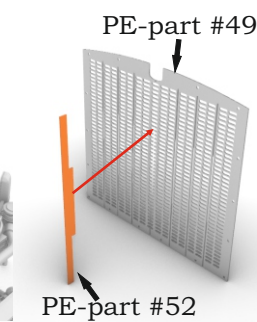

103. 🟰 x6

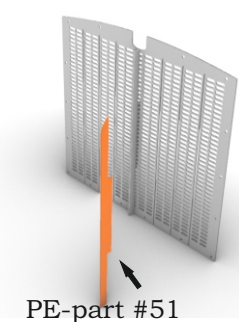

104. 🟰

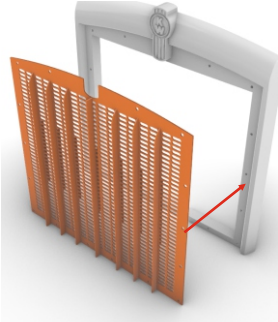

105. 🟰

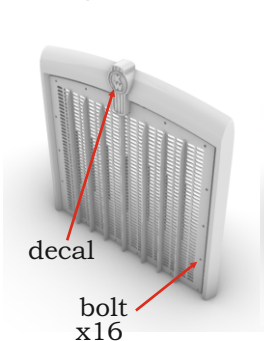

106. 🟰

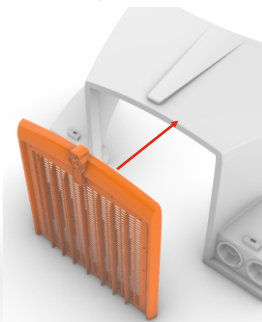

107. 🟰 x2



108. 🟰 x2

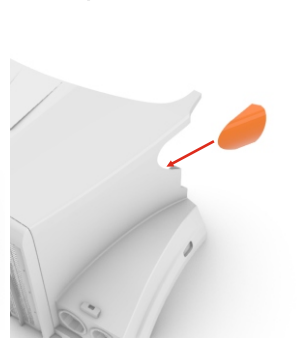

Aussie T610 SAR truck. Resin kit, 1/24

109.  x2

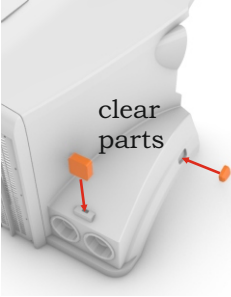

110.  x4

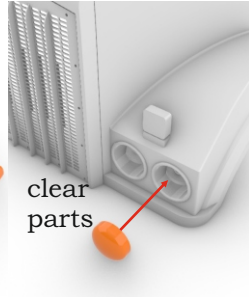

111.  x2

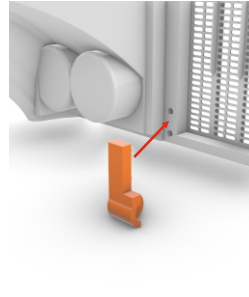

112. 

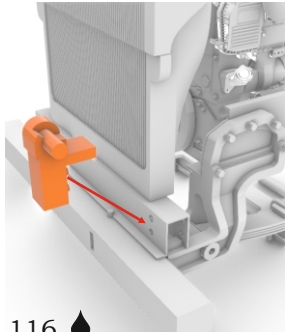

113. 

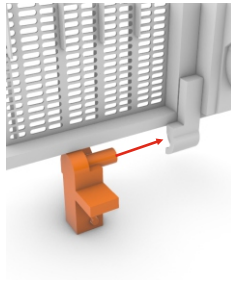

114.



115. 

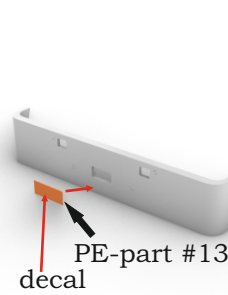

116. 

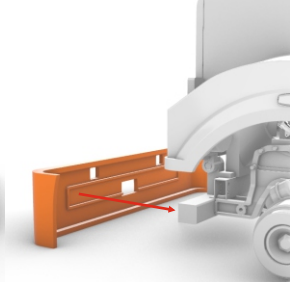

117. 



118.  x14

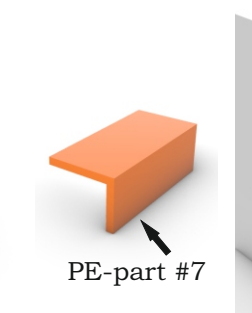

119.  x14

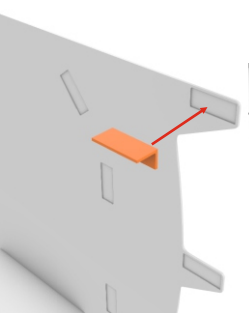

120. 

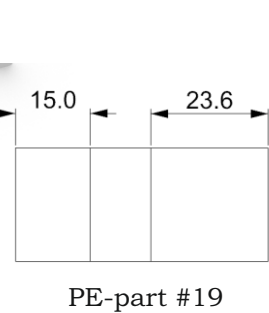

121. 

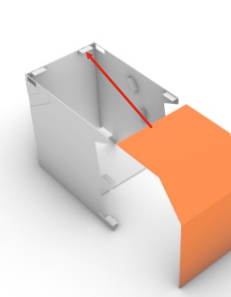

122.  x3

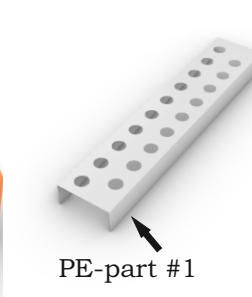

123. 

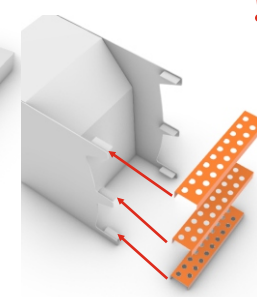

! For detailed photo-instruction how to make fuel tanks, visit our site -> instructions -> photo-instructions section.

Aussie T610 SAR truck. Resin kit, 1/24

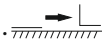
124.  x3

125.  x3

126.  x2

127.  x2

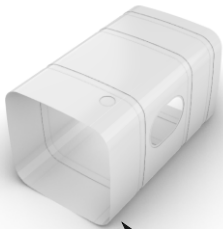

PE-parts
#40, 41, 42

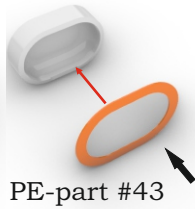
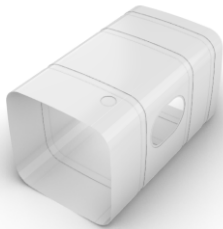

PE-part #43

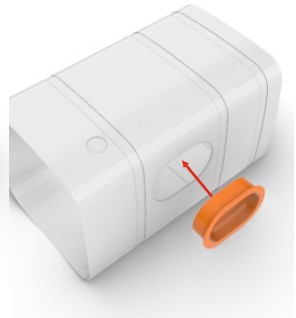

128. x8



Place styrene
inserts into a
tanks.

129.  x6

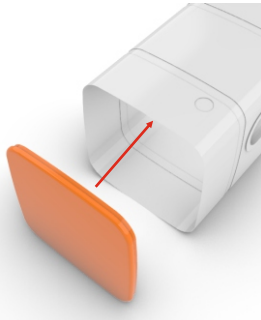

130.  x2



131.  x8

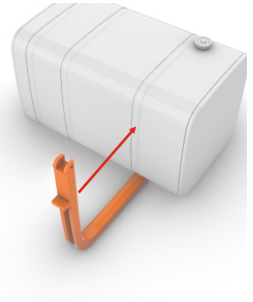

132. 

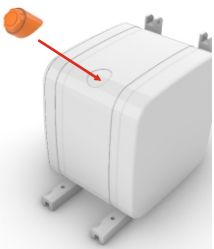

133.  x8

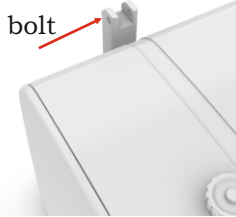

bolt

134.  x8

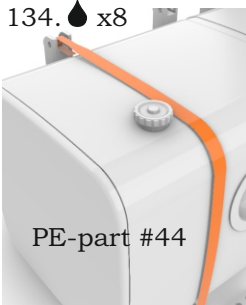

PE-part #44

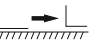
135. 

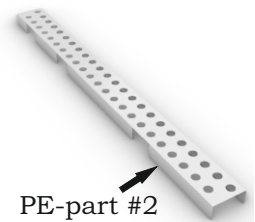

PE-part #2

136. 

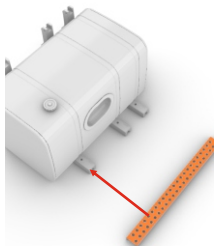

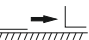
137. 

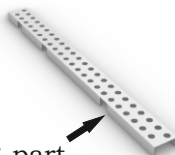

PE-part
#14, 47

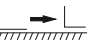
138.  x3

PE-part #46



139. 

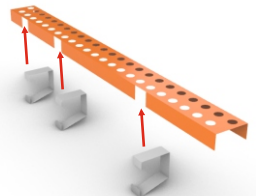

Aussie T610 SAR truck. Resin kit, 1/24

! Use battery box (frames 117-123) for leveling steps

140. 

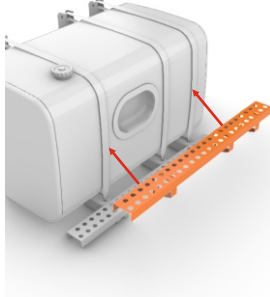

141.  x3

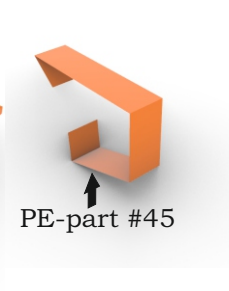

142. 

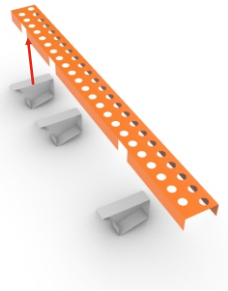

143. 

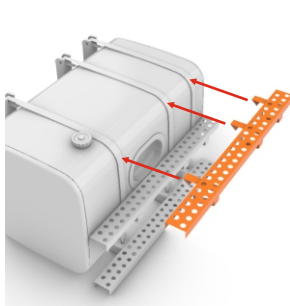

Repeat steps 135-143 for right side.

144.  x2

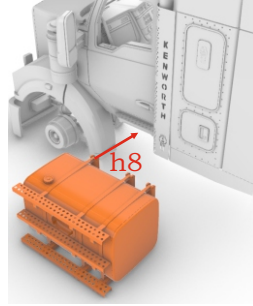

145. 

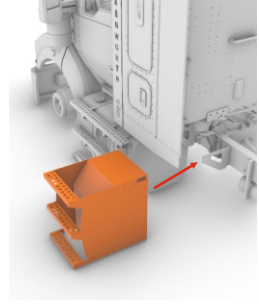

146. 

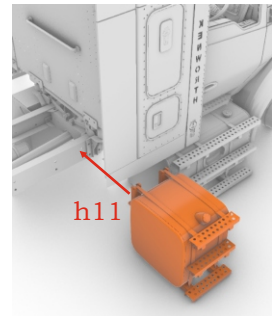

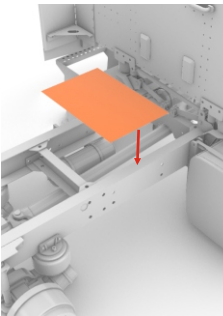

147. 

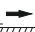
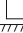

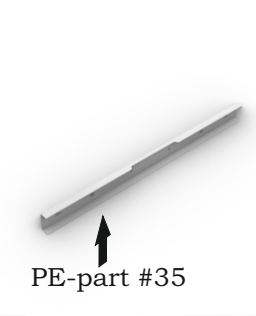
148.  

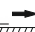

149.  

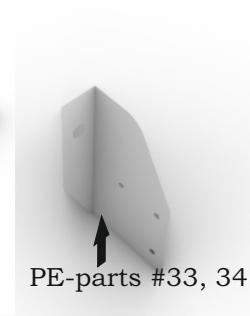

150.  x2

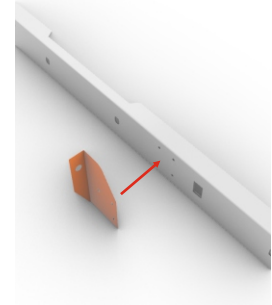

151.  x2

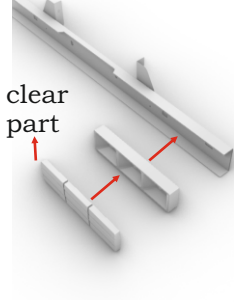

152. 

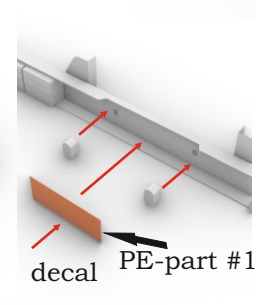

153. 

