



A PLACE TO CALL HOME



SUMMIT SERIES - INTERIOR PACKAGES

AT STUDIO SHED, WE PROVIDE END-TO-END DESIGN, MANUFACTURING AND INSTALLATION OF INTERIORS WITH OUR SUMMIT SERIES. THESE DWELLING SOLUTIONS CAN BE UTILIZED AS AN ADU, MULTI-GEN LIVING, OR EVEN A PERSONAL SANCTUARY. WHETHER YOU NEED A SINGLE BATHROOM OR A FULL KITCHEN & BEDROOM, WE'RE HERE TO HELP YOU REALIZE YOUR SPACE.

- MEDIUM BATHROOM**
- + PACKAGE OVERVIEW Pg. 4
- + BATHROOM COMPONENTS Pg. 5

- SMALL KITCHEN**
- + PACKAGE OVERVIEW Pg. 6
- + KITCHEN DETAILS Pg. 8
- + APPLIANCES Pg. 9
- + FINISH SELECTIONS Pg. 10-11

- MEDIUM KITCHEN**
- + PACKAGE OVERVIEW Pg. 7
- + KITCHEN DETAILS Pg. 8
- + APPLIANCES Pg. 9
- + FINISH SELECTIONS Pg. 10-11

- 476 SF ADU WITH BEDROOM**
- + PACKAGE OVERVIEW Pg. 12
- + FINISH SELECTIONS Pg. 10

- 684 SF ADU WITH BEDROOM**
- + PACKAGE OVERVIEW Pg. 13
- + FINISH SELECTIONS Pg. 10

- 1,000 SF ADU WITH BEDROOM**
- + PACKAGE OVERVIEW Pg. 14
- + FINISH SELECTIONS Pg. 10

- MINI-SPLIT & WATER HEATER** Pg. 16

- SHIPPING & DELIVERY** Pg. 17, 19

- INCLUSIONS CHECKLIST** Pg. 18-19

BRING YOUR DREAMS AND IDEAS INTO THE WORLD



MEDIUM BATHROOM

LET US FLUSH OUT THE DETAILS

- + FULL-SIZED 3-PIECE BATHROOM
- + AMERICAN STANDARD FIXTURES IN TWO FINISH COLORS
- + BUILT-IN FOGLESS FRAMELESS MIRROR MEDICINE CABINET
- + 100% WATERPROOF LUXURY VINYL PLANK FLOORING
- + INCLUDES ENERGY COMPLIANT WATER HEATER
- + DUCTLESS MINI-SPLIT FOR HEATING & COOLING



BATHROOM FIXTURES

- + AMERICAN STANDARD STUDIO LINE SHOWER BASE & ENCLOSURE
- + AMERICAN STANDARD FRAMELESS SHOWER DOORS
- + AMERICAN STANDARD STUDIO S LINE
 - + WATER-SAVING SHOWER HEAD
 - + WATER-SAVING HAND SHOWER + DIVERTER
 - + HIGH EFFICIENCY TOILET
 - + WATER EFFICIENT FAUCET
 - + METAL TOWEL BAR, TP HOLDER, ROBE HOOK, AND HAND TOWEL BAR
- + FAIRMONT DESIGNS WALL MOUNT STUDIO ONE VANITY
- + ANTI-FOG RECESSED MEDICINE CABINET WITH POWER OUTLETS

BATHROOM FLOOR



Abyss



Licorice



Poetry Grey



Brushed Nickel



Matte Black

FIXTURES

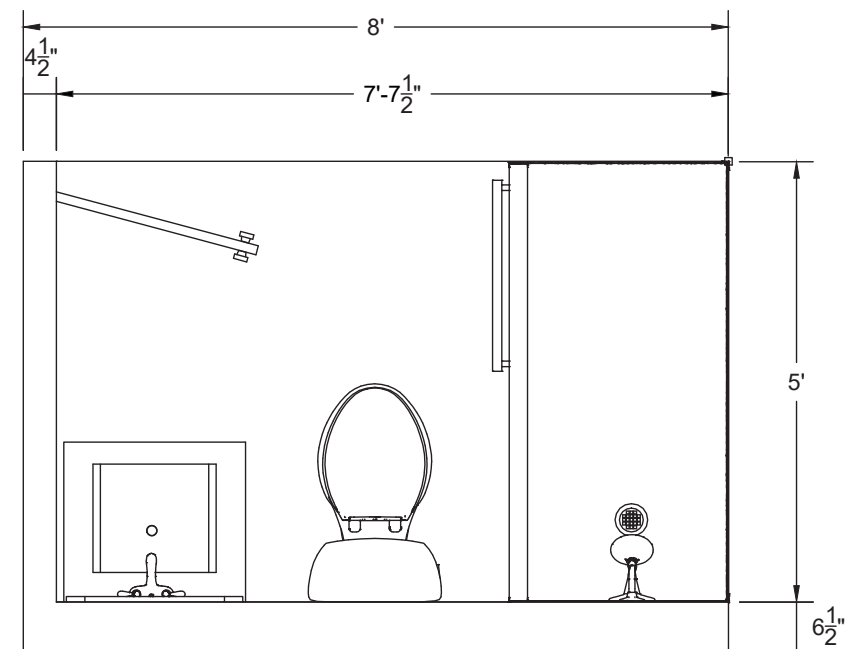



SMALL KITCHEN

A SMALL SPACE KITCHEN SOLUTION

- + THREE SUMMIT BRAND STAINLESS STEEL APPLIANCES
- + PREMIUM PLYWOOD CABINETS IN THREE PAINTED FINISHES
- + SOLID SURFACE COUNTERTOPS
- + KRAUS WORKSTATION STAINLESS STEEL SINK
- + INCLUDES MEDIUM BATHROOM



MEDIUM KITCHEN

EVERYTHING YOU NEED

- + FOUR SUMMIT BRAND STAINLESS STEEL APPLIANCES
- + PREMIUM PLYWOOD CABINETS
- + SOLID SURFACE COUNTERTOPS
- + KRAUS WORKSTATION STAINLESS STEEL SINK
- + INCLUDES MEDIUM BATHROOM



CABINET LAYOUT

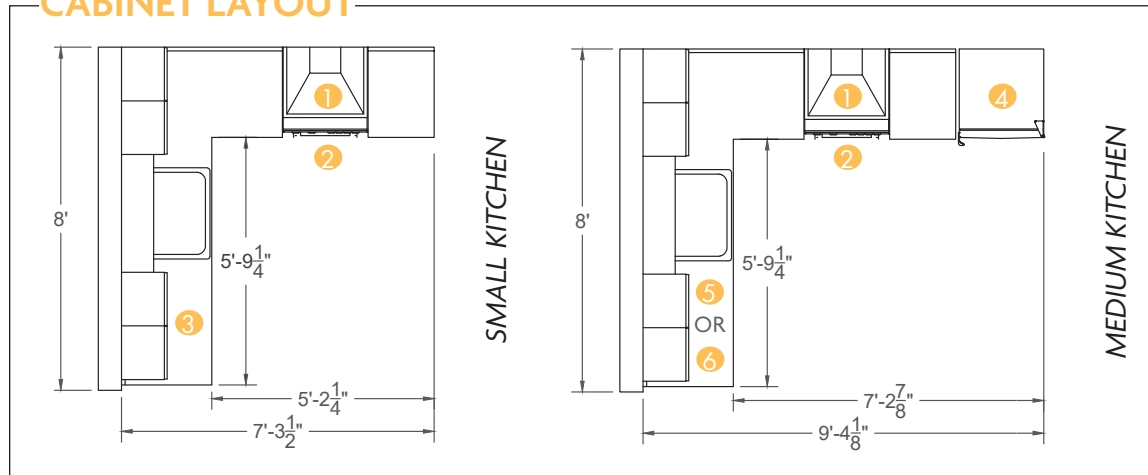

KITCHEN SINK

KRAUS KORE WORKSTATION

- + 25" DUAL MOUNT SINGLE BOWL SINK
- + 16 GAUGE STAINLESS STEEL
- + QUIET OPERATION WITH SOUND DAMPENING PADS
- + INCLUDES 5 PIECE CHEF'S KIT
 - + ROLL UP MULTI PURPOSE DISH RACK
 - + BAMBOO CUTTING BOARD
 - + STAINLESS STEEL BOTTOM GRID
 - + DRAIN ASSEMBLY WITH STRAINER
 - + DECORATIVE DRAIN COVER



INSINKERATOR BADGER 1

- + 1/3 HP DURA-DRIVE MOTOR
- + GALVANIZED STEEL GRIND SYSTEM

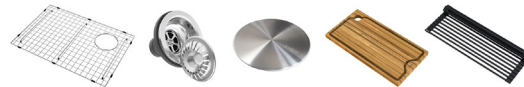

AMERICAN STANDARD STUDIO S FAUCET

- + CONTEMPORARY ONE-PIECE DESIGN MAKES FOR EASY CLEANING
- + DUAL SPRAY PULL DOWN SPRAY HEAD
- + MAGNETIC DOCKING HOLDS SPRAY HEAD SECURELY IN PLACE
- + CERAMIC DISC VALVE FOR DRIP FREE PERFORMANCE
- + 18" HEIGHT ALLOWS FOR EASY FILLING OF LARGE POTS AND PITCHERS
- + RE-TRAX ENSURES EASY RETRACTION OF SPRAY HEAD
- + PAUSE FUNCTION

APPLIANCES



EXHAUST FAN

INCLUDED

①

- + STAINLESS STEEL
- + INCLUDES TIMER & LIGHTS
- + 3 SPEED FAN SETTINGS



24" ELECTRIC RANGE

INCLUDED

②

- + CONVECTION, OVEN, BROILER
- + SMOOTH CERAMIC GLASS TOP
- + ADA - COMPLIANT



24" UNDERCOUNTER REFRIGERATOR

SMALL KITCHEN ONLY

③

- + REFRIGERATOR - FREEZER
- + OVER 5 CUBIC FEET
- + ADA - COMPLIANT



COUNTER DEPTH FULL SIZE FRIDGE

MEDIUM KITCHEN ONLY

④

- + BOTTOM FREEZER
- + 12.5 CUBIC FEET
- + ICE MAKER



24" DISHWASHER

MEDIUM KITCHEN OPTION

⑤

- + ENERGY STAR
- + QUIET OPERATION
- + FRONT CONTROLS















24" WASHER/DRYER

MEDIUM KITCHEN OPTION

⑥

- + FULL 15 LB CAPACITY
- + VENTLESS OPERATION
- + FRONT LOADING

AVAILABLE COLORS

CABINETS			HARDWARE	
				
High Gloss White	White Shaker	Grey Shaker	Brushed Nickel	Matte Black
COUNTERS			FIXTURES	
				
Silverstone	Merino Grey	Yuri Grey	Brushed Nickel	Matte Black
BATHROOM FLOOR				
				
Abyss	Licorice	Poetry Grey		

CABINETS AND COUNTERTOPS

RECOMMENDED COMBINATION

- + WHITE SHAKER CABINETS
- + MERINO GREY COUNTERTOPS
- + BRUSHED NICKEL HARDWARE
- + BRUSHED NICKEL FIXTURES

CABINETS  White Shaker	COUNTERS  Merino Grey
--	---



Image for cabinet representation only, actual layout & components vary.

RECOMMENDED COMBINATION

- + GREY SHAKER CABINETS
- + SILVERSTONE COUNTERTOPS
- + BRUSHED NICKEL HARDWARE
- + BRUSHED NICKEL FIXTURES

CABINETS  Grey Shaker	COUNTERS  Silverstone
--	--



Image for cabinet representation only, actual layout & components vary.

RECOMMENDED COMBINATION

- + HIGH GLOSS WHITE CABINETS
- + YURI GREY COUNTERTOPS
- + MATTE BLACK HARDWARE
- + MATTE BLACK FIXTURES

CABINETS  White Gloss	COUNTERS  Yuri Grey
---	---

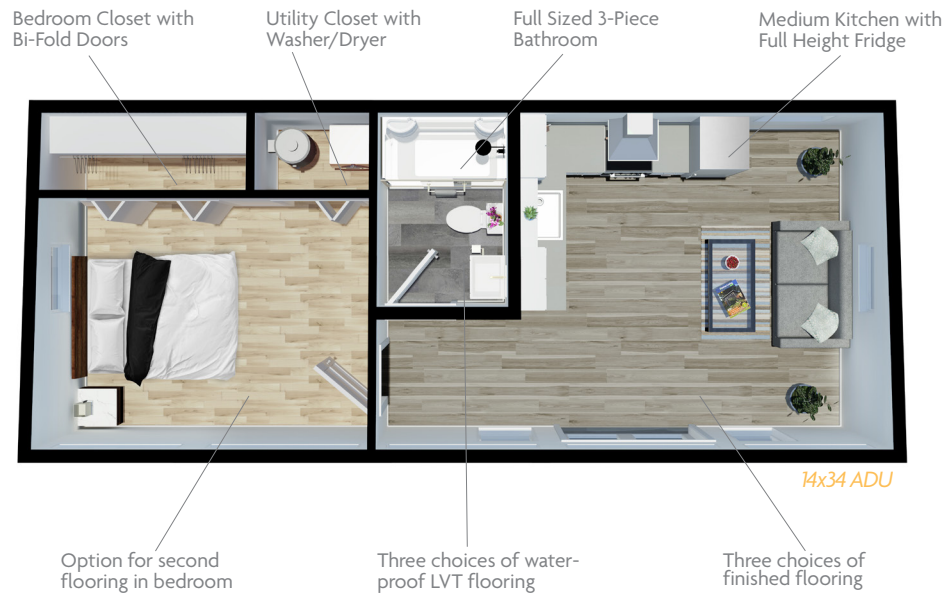

Image for cabinet representation only, actual layout & components vary.

REALIZE YOUR OWN BACKYARD SANCTUARY

BEDROOM FEATURES

Available for: 14 x 34 SUMMIT*



RECOMMENDED OPTION

14x34 ADU - 476 SQ. FT

- + MEDIUM BATHROOM
- + DIMENSIONED BEDROOM: 124 SQ FT**
- + DIMENSIONED CLOSET: 25.5 SQ FT**
- + MEDIUM KITCHEN
- + BEDROOM CLOSET WITH BI-FOLD DOORS
- + MINI-SPLIT SYSTEM HEATING & COOLING
- + UTILITY CLOSET WITH BI-FOLD DOORS
 - + WATER HEATER
 - + WASHER/DRYER



SHOWN WITH

*Bedroom only available for units 34+ wide
**Room area rounded to the nearest 1/2 sq ft

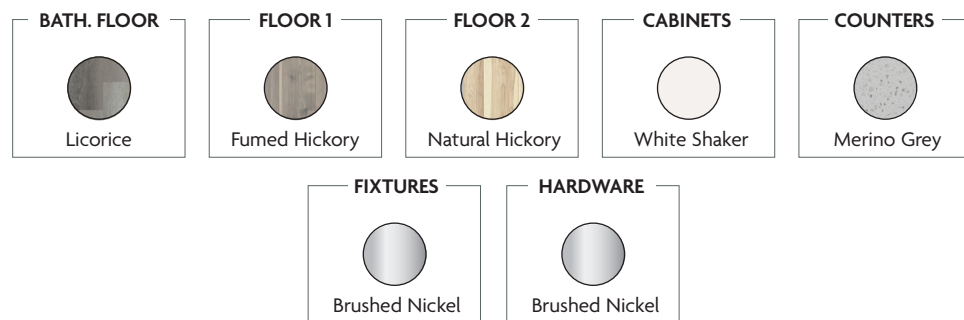

BEDROOM FEATURES

Available for: 16x, 18x, & 20x SUMMIT*



RECOMMENDED OPTION

18x38 ADU - 684 SQ. FT

- + MEDIUM BATHROOM
- + DIMENSIONED BEDROOM: 157 SQ FT**
- + DIMENSIONED CLOSET: 46 SQ FT**
- + MEDIUM KITCHEN
- + BEDROOM WALK-IN CLOSET
- + MINI-SPLIT SYSTEM HEATING & COOLING
- + UTILITY CLOSET WITH BI-FOLD DOORS
 - + WATER HEATER
 - + WASHER/DRYER



SHOWN WITH

*Bedroom only available for units 34+ wide
**Room area rounded to the nearest 1/2 sq ft

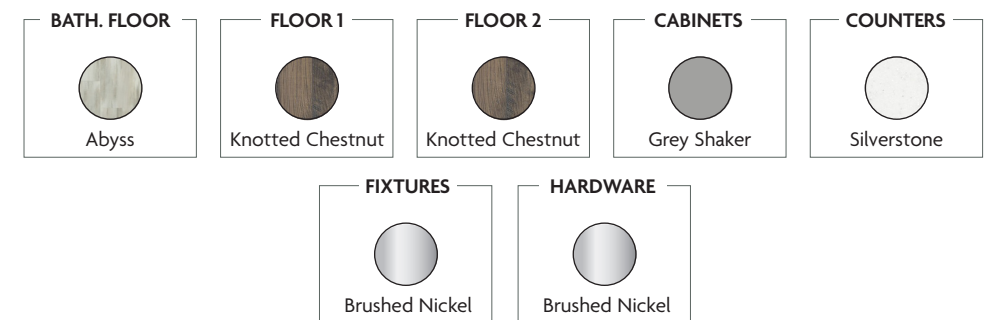

BEDROOM FEATURES

Available for: 16x, 18x, & 20x SUMMIT*

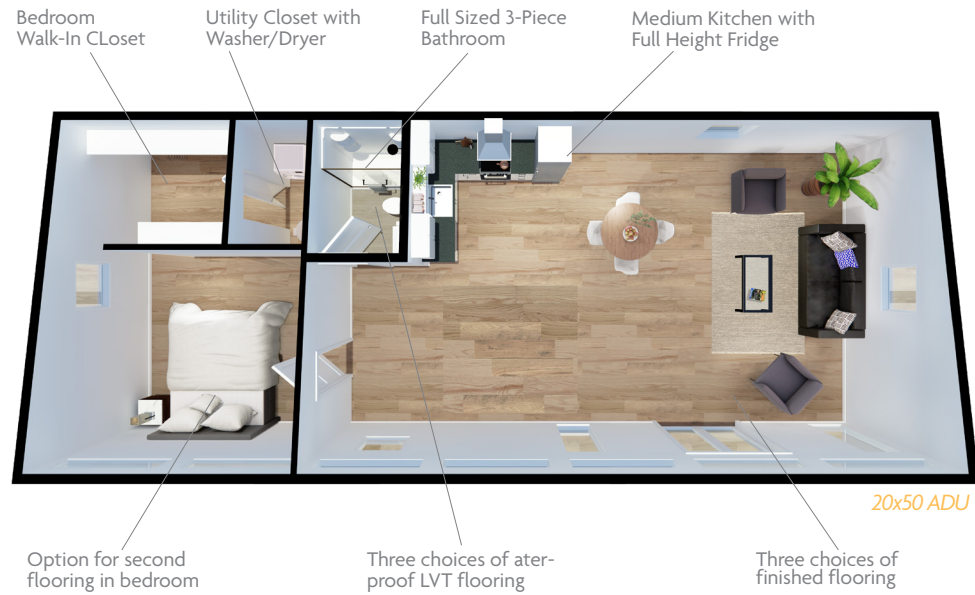

RECOMMENDED OPTION

20x50 ADU - 1,000 SQ. FT

- + MEDIUM BATHROOM
- + DIMENSIONED BEDROOM: 160 SQ FT**
- + DIMENSIONED CLOSET: 66 SQ FT**
- + MEDIUM KITCHEN COMPONENTS
- + BEDROOM WALK-IN CLOSET
- + MINI-SPLIT SYSTEM HEATING & COOLING
- + UTILITY CLOSET WITH BI-FOLD DOORS
 - + WATER HEATER
 - + WASHER/DRYER



SHOWN WITH

*Bedroom only available for units 34+ wide
**Room area rounded to the nearest 1/2 sq ft

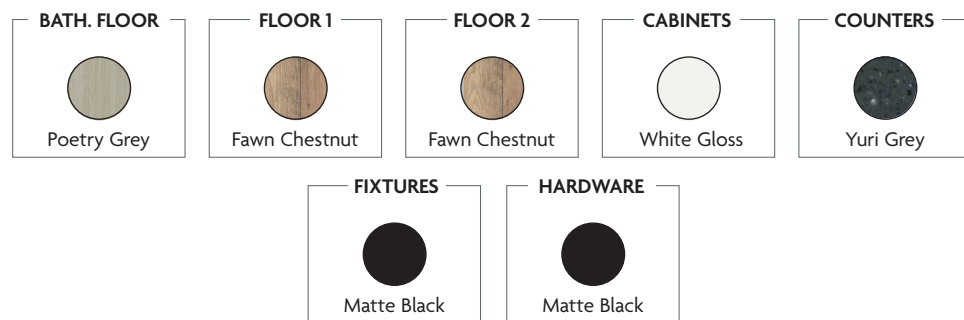

WANT TO SEE MORE?

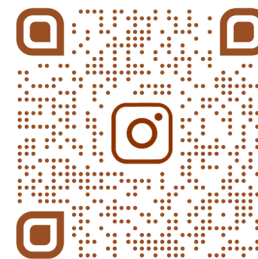

FOLLOW US

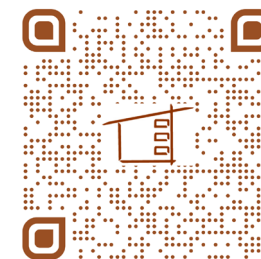

DESIGN YOUR OWN



SHARE US

HEATING & COOLING

MRCOOL DIY DUCTLESS MINI-SPLIT

- + ENERGY STAR
- + SMARTPHONE APP
- + REMOTE WITH FOLLOW ME FUNCTION
- + LOUVER POSITION MEMORY
- + DIGITAL ASSISTANT READY
 - + GOOGLE ASSISTANT
 - + AMAZON ALEXA
- + CORROSION RESISTANT CONDENSER FOR LONG LASTING PERFORMANCE IN COASTAL LOCATIONS

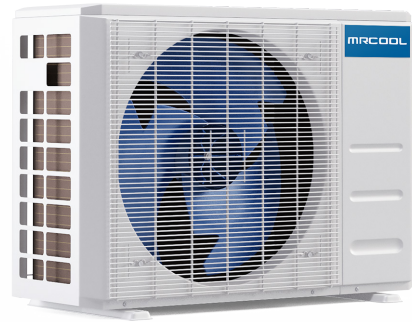

HEAT AND COOL YOUR SPACE WITH ONE UNIT

WATER HEATER

EXTERIOR GAS ON-DEMAND

- + RHEEM PERFORMANCE PLATINUM EXTERIOR GAS ON-DEMAND WATER HEATER
 - + ECONET MOBILE TECHNOLOGY CONTROL
 - + COMPATIBLE WITH STANDARD GAS LINE



- OR -

50 GALLON HEAT PUMP

- + RHEEM PERFORMANCE PLATINUM 50 GALLON HEAT PUMP WATER HEATER
 - + HYBRID ELECTRIC HEAT PUMP
 - + BUILT-IN WIFI ENABLED CONTROLS



WATER HEATER PROVIDED BASED ON ENERGY CALCULATIONS FOR YOUR PROJECTS' SPECIFIC CONSTRAINTS DETERMINED AT TIME OF PERMIT PLAN SET

PERMIT PLAN SET

LET US WORK OUT THE DETAILS - OUR PREDESIGNED INTERIOR PACKAGES AND READY-TO-GO DRAWINGS HELP STREAMLINE THE PROCESS TO GET YOU AN APPROVED PERMIT QUICKER.

Our interior packages allow you to skip the lengthy back-and-forth of a traditional design process without compromising your unique vision. Once you've selected the interior package to fit your needs, we can quickly assemble drawings, specifications, and details to efficiently acquire your permit.

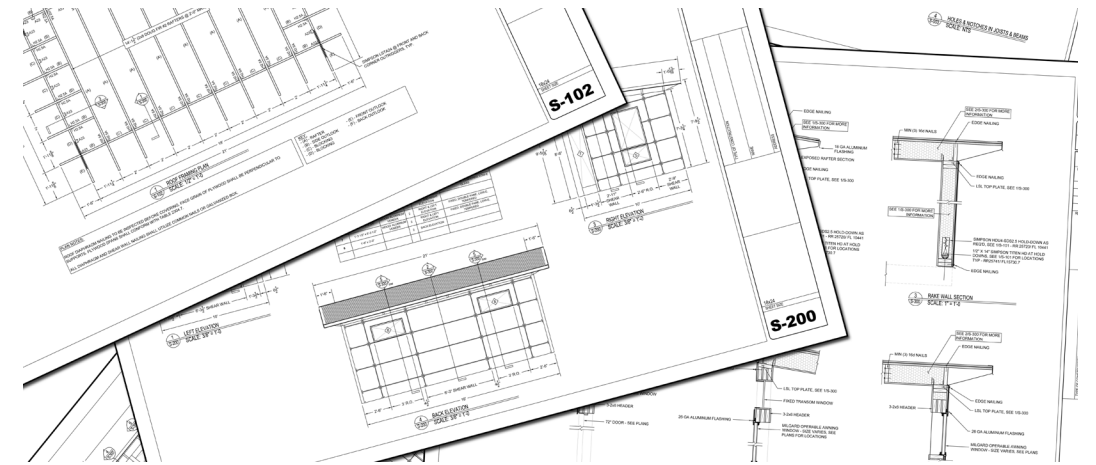

SHIPPING & DELIVERY

SHIPPING & DELIVERY IS HANDLED BY MULTIPLE 3RD PARTY CARRIERS. SEE PAGE 19 FOR DETAILS.

Shipment and delivery is handled by 3rd party carriers. Most interior components will be shipped with the shed at the time of shipment. Appliances and cabinets are delivered to the site direct from the manufacturer. These are delivered to site prior to installation based on the installer's schedule. All deliveries will be by appointment with the installer if certified installation is selected. Deliveries will require truck access and a signature from a person over the age of 18.

INSTALLATION

AVAILABLE WITH MULTIPLE INSTALLATION SOLUTIONS TO FIT YOUR LIFESTYLE, FROM DO-IT-YOURSELF (DIY) TO PREMIUM TURNKEY INSTALLATION OF YOUR STUDIO SHED.

If certified installation of the Lifestyle Interior package is purchased, the following materials will be installed by the certified third-party general contractor: fiberglass batt insulation, drywall (walls and ceiling), LVT flooring, MDF floor base, MDF interior door casing, exterior electrical sub-panel, wiring from sub-panel to outlets and lights, electrical trim, and interior/exterior lights. Drywall is not included if the Lifestyle Interior material package is purchased for DIY installation. Non-standard electrical or lighting, utilities/trenching, rough plumbing, final connection of electrical service to the sub-panel, decks/steps, spray foam insulation, or other work outside of the Studio Shed kit is not included. Customer is responsible for providing a power source within 150 feet for contractor during installation, for tools/equipment. Following completion, the contractor should be contacted directly for any punch list or warranty concerns, including door operation, window operation, or poor workmanship. Installation schedule and duration may vary by contractor. Additional charges may apply if any part of the Studio Shed kit is modified. If the Lifestyle Plus package (kitchen and/or bath) is purchased, all electrical and finish plumbing material and labor is included with the package, in addition to material and labor to install a ductless mini-split system and water heater. Additional time will be added to the duration of the project for inspections and sequencing of trades. Schedule may vary depending on contractor availability and resources, inspections, weather or other unforeseeable circumstances.

	 MEDIUM BATHROOM	 SMALL KITCHEN
BATHROOM		
Vanity	✓	✓
Medicine Cabinet - Fogless Mirror	✓	✓
Sink Faucet	✓	✓
Toilet	✓	✓
Rough In Valve	✓	✓
Shower Door	✓	✓
Shower Pan	✓	✓
Shower Enclosure	✓	✓
Shower Head	✓	✓
Hand Shower & Diverter	✓	✓
24" Towel Bar	✓	✓
TP Holder	✓	✓
Robe Hook	✓	✓
Hand Towel Holder	✓	✓
Bath Fan	✓	✓
Bath Switch	✓	✓
KITCHEN		
Countertops		✓
Cabinets		✓
25" Steel Sink		✓
Kitchen Sink Faucet		✓
Electric Range		✓
Undercounter Refrigerator		✓
Counter Depth Fridge		✓
Garbage Disposal		✓
Exhaust Fan		✓
Behind Stove Backsplash		✓
Dishwasher		
OTHER		
Washer/Dryer		
Bi-Fold Bedroom Closet Doors (14x only)		
Bi-Fold Utility Closet Doors		
Interior Door(s)	✓	✓
Mini-Split	✓	✓
Water Heater	✓	✓
Finish Plumbing	✓	✓
Roof Jack	✓	✓
Straps/Additional Fasteners	✓	✓
Condenser Pad	✓	✓
Furnishings		

 MEDIUM KITCHEN	 BEDROOM	 SHIPPING & DELIVERY
✓	✓	Studio Shed
✓	✓	Studio Shed
✓	✓	Studio Shed
✓	✓	Studio Shed
✓	✓	Studio Shed
✓	✓	Studio Shed
✓	✓	Studio Shed
✓	✓	Studio Shed
✓	✓	Studio Shed
✓	✓	Studio Shed
✓	✓	Studio Shed
✓	✓	Studio Shed
✓	✓	Studio Shed
✓	✓	Studio Shed
✓	✓	Studio Shed
✓	✓	Studio Shed
✓	✓	Studio Shed
✓	✓	Studio Shed
✓	✓	Studio Shed
✓	✓	Studio Shed
✓	✓	Studio Shed
✓	✓	Studio Shed
✓	✓	Studio Shed
✓	✓	Studio Shed
✓	✓	Studio Shed
✓	✓	Studio Shed
✓	✓	Studio Shed
✓	✓	Studio Shed
✓	✓	Studio Shed
OPT.	✓	Studio Shed
OPT.	✓	Direct Ship
✓	✓	Studio Shed
✓	✓	Studio Shed
✓	✓	Studio Shed
✓	✓	Studio Shed
✓	✓	Studio Shed
✓	✓	Studio Shed
✓	✓	Studio Shed
✓	✓	Studio Shed
✓	✓	Studio Shed
✓	✓	Studio Shed
✓	✓	Studio Shed
✓	✓	Studio Shed
✓	✓	Installer to Provide*
✓	✓	Installer to Provide*
✓	✓	Installer to Provide*
✓	✓	Installer to Provide*
✓	✓	Homeowner to Provide

www.studio-shed.com



1500 Cherry St. Suite S
Louisville, CO 80027
888.900.3933
M-SAT 8:30AM-5PM MST
studio-shed.com