

THE EDGING HANDBOOK

— VOL. 3 —

The Complete Guide

**Paver Restraints
Landscape Edgings
Specialty Edgings**



Provided by: *The Edging Experts*

Table of Contents

AN INTRODUCTION TO OLY-OLA.....PAGE 1

GUARANTEE & PROMISES.....PAGE 2

THE TRUTH ABOUT 'PLASTIC' EDGING.....PAGE 3

UNDERSTAND YOUR EDGING OPTIONS.....PAGE 4

PHOTOS - OUR EDGINGS IN USE.....PAGE 5

TECO-EDG™ SPECIALTY EDGING.....PAGE 6

PAYER RESTRAINTS.....PAGE 7-8

ROUND TOP EDGINGS.....PAGE 9-10

LOW PROFILE EDGINGS.....PAGE 11

ACCESSORIES & DISPLAYS.....PAGE 12

PRODUCT SPECIFICATIONS.....PAGE 13-14



About Oly-Ola

Established in 1978, our mission was simply to offer a quality edging line that was supported with a strong guarantee and excellent customer service. Recognizing the short-comings of the suppliers at that time, we chose to bring to market high-end, commercial grade edgings made of only the best quality raw materials. This new line of edging products boasted a thicker wall construction and was designed to hold up better during installation and withstand severe weather conditions. Our guarantee (the strongest in the industry, see page 2) gave professional contractors and suppliers the confidence they needed to place their trust in Oly-Ola's product line.

Over the years, customers have come to expect a higher level of quality and service from Oly-Ola than other manufacturers. From prompt shipping and delivery to follow-up calls on every order that leaves the warehouse, service is a way of life at Oly-Ola; where edging, and only edging, is our business! Over the years, we have been tested time and time again by the rising costs of raw materials and the increased presence of mass merchandisers in the market place. Oly-Ola has always stayed true to its promise of quality and, to this day, we do not sell our edgings to big box or chain stores. It is common knowledge that in order to service such a market, you need a very low cost product. To achieve that, it would be necessary to reduce overall thickness or use lower grade raw materials. Refusing to forgo quality, we continue to only sell through landscape distribution centers, landscape contractors, landscape architects and independent nursery/garden centers. Oly-Ola invites you to join our worldwide family!



Photo Credit: Amco 2000 - The Netherlands



"We have been stocking Oly-Ola's landscape edging for over 20 years. Just to see what else was out there, last year we switched to a competitive product. My installation crews quickly found that the quality of this alternate product was substandard compared to the Edg-King™ landscape edging. The sidewalls were thinner making it easier to cut, but this also made it more prone to cracking. It punctured and flattened very easily. It was not the landscape edging we hoped it would be and we quickly learned that it wasn't near the quality of Oly-Ola's landscape edging. We are back with Oly-Ola again this year and won't be jumping ship anytime soon."

John Buckley Jr.
Redwood Falls Nursery
Redwood Falls, MN



** Did you know...*

Oly-Ola Edgings, Inc. has been providing its high quality edgings since 1978 and has been entirely American made since the beginning.



Edgar Edg

High Quality Guaranteed

In business, you need suppliers you can count on. People who deliver on time, every time - not just when it is convenient. You need suppliers who stand behind their products and know how to "make good" if there is ever a problem. Since 1978, Oly-Ola has learned these lessons well. It's Oly-Ola's product you buy the first time but it's our service that makes you come back over and over again.



OUR QUALITY PROMISE

We do our best to make our edgings the finest in the landscape industry. Since we have satisfied customers and references available throughout the country, we know you will agree that our production staff does an excellent job. However, since our business is run by regular people (just like you and me), a very rare problem could occur in one of our products. The following guarantee covers all possibilities...

The Industry's Best Guarantee!

Oly-Ola's edgings are guaranteed for 20 years not to crack, rot, disintegrate, or self-destruct* from any weather conditions or manufacturing defects. If this ever occurs, Oly-Ola will replace 100% of the damaged material and, unlike most other product guarantees, Oly-Ola will also cover any freight charges involved and pay a fair industry labor rate to reinstall the edging.

* Damage to Oly-Ola's edging from hand or power tools is not covered (i.e. shovel, lawn mower, power edger, or snow blower damage). * Domestic orders only.

OUR SHIPPING PROMISE

We ship our edgings world-wide, always striving for the most efficient and reliable means. If there is ever a problem with a shipment, we make it our problem and work directly with the carrier to resolve it for you. If a shipment comes up short or damaged, mark it clearly on the freight bill and notify our sales office immediately. We will file the claim for you and make the proper adjustments.

We maintain a large inventory 12 months a year; therefore, there is no excuse for back-orders at Oly-Ola. Orders are shipped F.O.B. from our plant in Alsip, IL. Edging is shipped via common carrier of our choice unless specified by the customer. Orders received by 11AM CST may be shipped out that same day.



OUR EDGINGS ARE 100% RECYCLED

In order to provide our customers with environmentally responsible, as well as cost effective products, we only use reprocessed or recycled plastic materials to produce our edging. With all recycled materials, the more a material is used, ground up and reused, the more compounds begin to weaken and break down; as a result, reprocessed plastics can range greatly in quality. Therefore, it is extremely important to us that we only use high quality recycled materials obtained from environmentally-responsible suppliers. Our 100% recycled materials are "greener" than other 100% recycled edging products because:

- * Our expectations are high when it comes to choosing materials that will live up to our outstanding guarantee as well as our mission to be green.
- * We are very selective of the reprocessed material that goes into each and every one of our edging products.
- * The majority of our raw materials come from post-consumer plastics and are purchased from a consistent commercial supplier.



"Oly-Ola provides unmatched quality and excellent products along with prompt delivery. We have been very happy with Oly-Ola's products and would highly recommend them to anyone."

*Rob Grosteffon - Owner
Outdoor Landscape Imaging
Battlecreek, MI*

The Truth About 'Plastic' Edging



The edgings manufactured by Oly-Ola are generally referred to as 'plastic'. More specifically, our edgings are composed of medium density polyethylene (Poly) or MDPE and polyvinyl chloride (PVC).

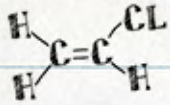

**NOT ALL PLASTIC EDGINGS ARE CREATED EQUAL!
WHAT EXACTLY ARE YOU SELLING/INSTALLING?**

WITH OLY-OLA, IT IS STRAIGHT FORWARD AND SIMPLE:

Our PVC products are made of 100% recycled high quality PVC with carbon black concentrate and impact modifier added to strengthen the material and increase UV protection.

Included in our PVC line: all of our paver restraints, Teco-Edg™ and our low-profile edging, Super-Edg™. High quality PVC is an excellent choice for these products due to its strength and rigidity.

Our Poly products are made of 100% recycled high quality MDPE with only carbon black concentrate added as a colorant and UV inhibitor.

Included in our poly line: all of our landscape edgings with the exception of the 6 inch Super-Edg™. MDPE, is the perfect choice for lawn edgings due to its pliable nature. It is the perfect balance of strength and flexibility.

YEP, IT IS THAT SIMPLE! With our edgings and paver restraints, there are no hidden additives or ingredients used to reduce cost and/or create the illusion of thickness or size. Not all other Poly or PVC edging manufacturers can say the same!

Oly-Ola is not the cheapest edging available and they never will be. We offer a legitimate commercial grade edging in an industry where every low quality imitation claims to be the same. But don't worry, we are here to help you sort through the good, the bad and the ugly, and help you make the best choice for your landscape projects.



↓ BEWARE!

Avoid retail grade edgings and/or cheap imitations.

When your reputation is at stake, you want a product that is designed to last, especially if you are serious about what you are selling/installing. We've all seen plastic edging sticking out of the ground or broken around a landscape bed. Likely, a poorly constructed edging that has failed due to exposure to the elements and is now unsightly, giving all plastic edgings a bad reputation. When a high quality product is installed properly, it should be nearly invisible and last for decades. Avoid poorly constructed edgings by looking for the tell tale signs.

Avoid companies that use low cost additives. *

Some currently available edgings are manufactured with rubber bi-products and other cheap additives such as chalk, talc, silica or saw dust. Manufacturers will try to get away with this in order to reduce the amount of higher cost plastic used in their product. Other companies add chemical foaming agents (CFAs) to impart a cellular or hollow structure to their product. As CFAs are heated, bubbles are formed and dispersed throughout the plastic. Similarly, the CFAs reduce the amount of plastic required, thus reducing weight and cost. The more CFAs added, the more porous the plastic. The most common CFAs are hydrochlorofluorocarbons, methylene chloride, methyl chloroform, carbon dioxide, and nitrogen. Such low cost additives weaken the strength of the chemical bonds and the product is then more likely to break down when exposed to the elements. Of course, few manufacturers are going to admit that they are cheapening their product with such additives. You will likely have to look for the tell tale signs.



THE TELL TALE SIGNS: WHAT YOU SHOULD BE LOOKING FOR WHEN CHOOSING AN EDGING PRODUCT FOR YOUR COMPANY...

Color: Look for edgings that are true in color as it is a good indication that no fillers are added. Oly-Ola's edgings are consistently a true black color. We do not pollute our material with fillers.

Wall Thickness: Wall thickness is a great indicator, but it is easy to fluff up a product by adding low cost fillers and blowing air into the material, so pay attention to the weight.

Weight: If it looks bulky but weighs very little, you can be sure it is a low density material made to appear bulkier by the use of additives.

Price: Be wary of price and seller. High quality costs more and is never found at discount stores.

Understand Your Edging Options

Today, there are many different options and materials that can be used to serve the same function. Called by many different names and marketed by many different companies, choosing the right landscape edging can be a daunting task. Each option has advantages and disadvantages. This side-by-side visual comparison may help you make a more informed decision about which option is best for your upcoming project(s).

EDGING OPTIONS	High Grade Poly	High Grade PVC	Steel	Aluminium	Concrete Curb	Wood Timber	Cement Block	Natural Stone	Hand Trim
Strong	✓	✓	✓	✓	✓	✓	✓	✓	✓
Durable or Long Lasting	✓	✓	✓	✓	✓	✓	✓	✓	✓
Flexible	✓	✓	✓	✓	✓	✓	✓	✓	✓
Safe, No Sharp Edges	✓	✓	✓	✓	✓	✓	✓	✓	✓
Will not Rust, Corrode or Erode	✓	✓	✓	✓	✓	✓	✓	✓	✓
UV Resistant	✓	✓	✓	✓	✓	✓	✓	✓	✓
Multiple Styles/Depths	✓	✓	✓	✓	✓	✓	✓	✓	✓
Holds Straight Lines	✓	✓	✓	✓	✓	✓	✓	✓	✓
Moderate Price Point	✓	✓	✓	✓	✓	✓	✓	✓	✓
Easily Reshaped	✓	✓	✓	✓	✓	✓	✓	✓	✓
Lightweight	✓	✓	✓	✓	✓	✓	✓	✓	✓
Not Labor Intensive to Install	✓	✓	✓	✓	✓	✓	✓	✓	✓
Low Maintenance	✓	✓	✓	✓	✓	✓	✓	✓	✓
Easy to form Logos/Patterns	✓	✓	✓	✓	✓	✓	✓	✓	✓
100% Recycled	✓	✓	✓	✓	✓	✓	✓	✓	✓
Does not Splinter, Chip or Rot	✓	✓	✓	✓	✓	✓	✓	✓	✓
Easy to Make Curves	✓	✓	✓	✓	✓	✓	✓	✓	✓
Resists Frost Heaving ¹	✓	✓	✓	✓	✓	✓	✓	✓	✓
Color Options Available	✓	✓	✓	✓	✓	✓	✓	✓	✓
Provides Mowing Edge	✓	✓	✓	✓	✓	✓	✓	✓	✓
Not Easily Damaged by Mowers, etc	✓	✓	✓	✓	✓	✓	✓	✓	✓
Natural Element	✓	✓	✓	✓	✓	✓	✓	✓	✓

¹ This comparison is the opinion of Oly-Ola and is based on the best and worst case scenarios.
 * This comparison assumes all applicable edgings to be commercial grade.
 † When installed properly using our staking recommendations and the overlap method.

Wood edgings, such as boards or timbers, are relatively inexpensive but over time, they will shift, rot and splinter whether or not the wood is treated.



Don't trip!

A few things to consider...



Ouch!

Steel may heave out of the ground due to freezing and thawing. The exposed edges can be sharp and rusted, resulting in a dangerous situation.



Weathered!



Lots of movement...

Cement blocks or stones are easy to install but roots, weeds and weather will cause them to move, which requires regular maintenance.



unsafe!

Our Edgings in Use

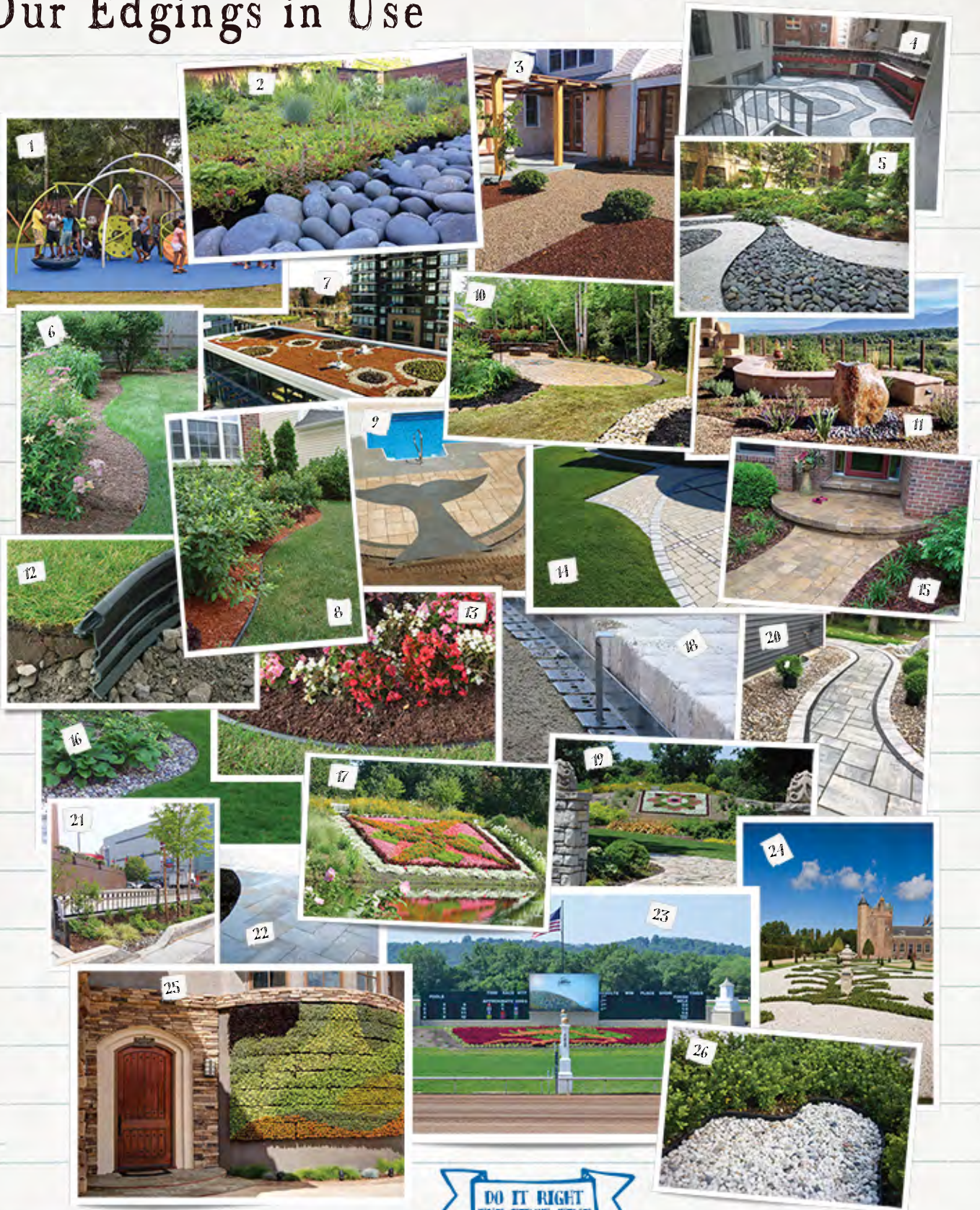

**DO IT RIGHT
THE FIRST TIME**

PHOTO DETAILS:

- 1 - Teco-Edg™ Gratiigny Plateau Park, Armando Rodriguez (Miami, FL) 2 - Teco-Edg™ project by Eco-Gardens (Chicago, IL) 3 - Teco-Edg™ project by Westrick & Co. (Provincetown, MA)
- 4,5 - Teco-Edg™ project by Town and Gardens Ltd. (Designed by Michael Franco (Long Island City, NY) 6 - Slim-Edg™ 7 - Teco-Edg™ project by Architek (Vancouver, BC Canada) 8 - Black Edg-Knight™
- 9,20 - Shallow Bric-Edg™ project by Sweeney Co. (Mechanicville, NY) 10 - Bric-Edg 11™ project by Saluda Hill Landscapes (Lexington, SC) 11 - Bric-Edg™ project by Taos Landscaping (Rancho de Taos, NM)
- 12,13 - Edg-King™ 14 - Bric-Edg™ project by Doyle Brick Paving (Elmhurst, IL) 15 - Bulldog-Edg™ project by Serenescapes, Inc. (South Bend, IN) 16 - Black Jack™
- 17,19 - Super-Edg™ - project by Wellfield Botanic Gardens (Elkhart, IN) 18 - Bric-Edg™ project by Kinley Systems (United Kingdom) 20 - Shallow Bric-Edg™
- 21 - Teco-Edg™ project by Triumph Construction (Brooklyn, NY) 22 - Bric-Edg 11™ 23 - Super-Edg™ project by Hyde Park Landscaping & Tree Service (Cincinnati, OH)
- 24,26 - Super-Edg™ project by Anevo 2000 (The Netherlands) 25 - Stone-Edg™ project by Greenscaped Buildings (San Diego, CA)

Teco-Edg™

Specialty Edge Restraint

Teco-Edg™ is the first of its kind and unlike any other edging available; a true "green" alternative. Although it was originally designed as an edge restraint for green roofs, the versatility of Teco-Edg™ allows it to be used for many more applications, such as permeable pavers, aggregate paths, vertical green walls, modular planting systems, synthetic turfs, poured rubber surfaces, concrete forming, and more...

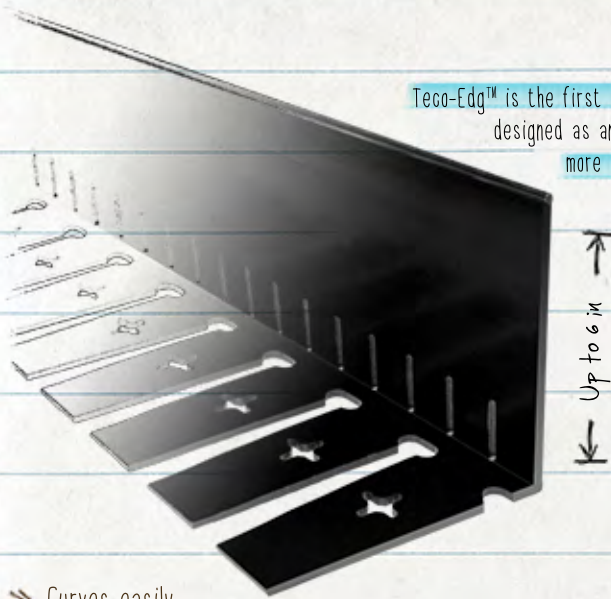

A few of its many uses!



- » Curves easily
- » Durable & weather tested to last the lifetime of your project
- » Available in flexible or rigid styles so it may be tailored to your design

Teco-Edg™ can be installed up against permeable pavers (as pictured below) or underneath them.

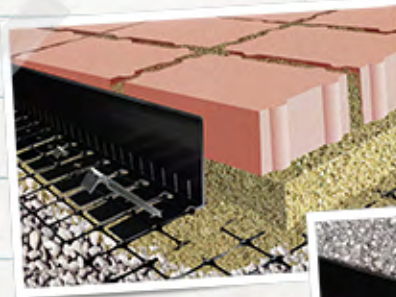

Effectively restrains aggregate material while allowing water to permeate.



It creates a clean, well defined edge for green roof installations.

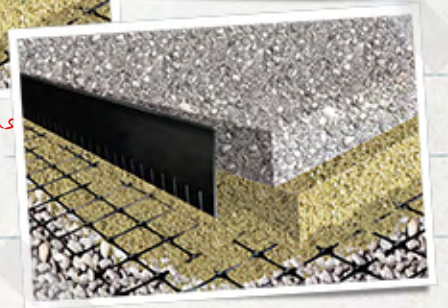

"We recommend Oly-Ola's Teco-Edg™ as a highly successful and integral component of the Green Infrastructure Bioswale Construction. Durable and easy to install!"

Matthew DiMittorio
JPL Corporation
Brooklyn, NY

Standard Sizes

H" X W"	LENGTH	STYLE
4 X 4 OR 6 X 6	10 FT	FLEXIBLE/RIGID

Comes standard with drainage slots and multi-purpose stake holes (optional upon request).

* Custom heights and widths may be available, speak with a sales associate for more details.



WITH THE PROPER PRECAUTIONS, A HEAT GUN OR TORCH CAN BE USED TO BEND OR FORM TECO-EDG™. OLY-OLA RECOMMENDS THIS METHOD TO FORM CORNERS. ADDITIONALLY, CORNER PIECES ARE AVAILABLE THAT CAN BE GLUED OR BOLTED INSIDE THE CORNER JOINT. THEY ARE SOLD SEPARATELY.



"We used the 4 inch Teco-Edg™ to border a flagstone walkway with limited space between the walkway, a small 12 inch planting area and the wall. In the past, we used 5 inch steel edging, but found Teco-Edg's linear pieces to be stronger, more rigid and easier to install. Because of the limited space, I appreciated Teco-Edg's "L"-shape design as it was easily installed underneath the flagstone."

John Sinnette
Eastwood Environmental Design & Development
Westerville, OH

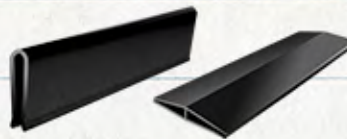

H-CLIP CONNECTOR & CONNECTING CAP

There are many options when it comes to connecting two lengths of Teco-Edg™. We offer PVC caps and H-Clips at an additional cost and they can be affixed with PVC glue to create a permanent hold. Wire or plastic zip ties can be used along with other fasteners. Additionally, Teco-Edg™ can be drilled and bolted for a less permanent connection.



Teco-Edg™ is made from 100% recycled post-consumer PVC and is 100% recyclable. In addition to other credits, Teco-Edg™ may contribute towards achieving higher Recycled Content credits in regards to the USGBC's LEED Rating System.

Paver Restraints

- * Solid PVC construction
- * No cutting required to make curves
- * No sharp edges
- * Due to their ideal 'L' shaped design, our restraints can be installed underneath or against the outside of pavers

BULLDOG-EDG™

The strongest paver restraint in Oly-Ola's line, Bulldog-Edg™ features a thicker PVC construction that makes it ideal for extra heavy-duty paver projects such as driveways and patios. Bulldog's one-piece design flexes without snapping or cutting to make tight curves. Its simple, yet effective, design makes it the ideal choice for serious professionals.

Available in 7.5 ft and 15 ft flexible lengths

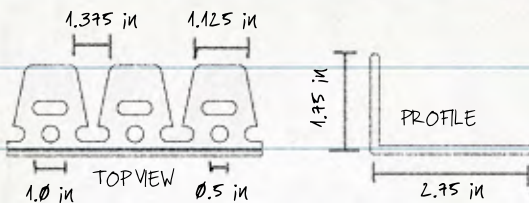

"Oly-Ola: great product, great people, great service!"

Mike Doyle - Owner
Doyle Brick Paving
Addison, IL

STONE-EDG™

We introduced the first 1 inch high PVC paver restraint as the ideal restraint for architectural hardscape stones such as travertine, flagstone, bluestone, tumbled marble, slate, granite, quartzite, and more. Stone-Edg™ is a smaller version of Bulldog-Edg™, an already great product; therefore, you know it is tough and flexible enough to handle all applications. It is a major time saver since there is no need to dig or score the ground during installation. And, as with all of Oly-Ola's paver restraints, Stone-Edg™ can be installed outside of or under the stones or pavers.

Available in 7.5 ft and 15 ft flexible lengths

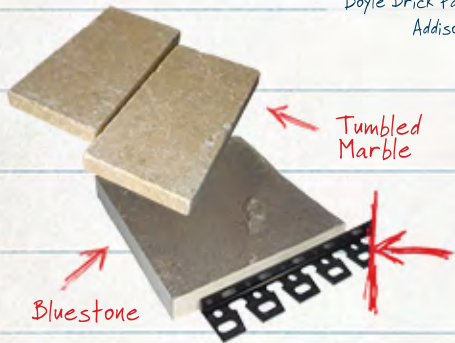

When using any stone 2 inches or thinner, you are going to want Stone-Edg™ for the job!

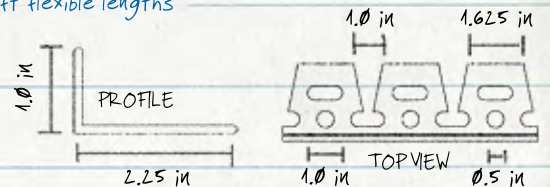

INSTALLATION BASICS



1. Outline the border of your walkway or patio to ensure an accurate and straight installation. Evenly layer a crushed rock base, compact it, and level it beyond the outline of the installation.



2. After the pavers have been set in place within the design, position the paver restraints along the outside perimeter of the installation. Make sure to set the restraints low enough, so that the soldier course is level with the rest of the brick.



3. Measure the final row of pavers before securing the paver restraints with Oly-Ola's 3/25 inch non-bending, steel anchoring stakes. Stake the restraint every two feet at minimum, using extra stakes when securing joints and curves. Do not make the mistake of using too few stakes, especially when the ground is exposed to cold temperatures.



4. Install the final row of pavers on top of the horizontal leg of the secured paver restraint. The restraint may also be installed up against the paver, with the horizontal leg on the outside, if the installation requires it.



5. Paver restraints hold the pavers permanently in place, keeping the pavers from shifting. When properly installed, the restraint should be barely visible or not visible at all.

Photos courtesy of Vaude Hey Company - Appleton, WI.



BRIC-EDG™

Introduced by Oly-Ola in 1992, Bric-Edg™ is the original 'L' shaped paver restraint. Its simple design was no accident. At the time of its introduction, no paver restraints were available that could be installed underneath the pavers and the available restraints did not allow for turf growth alongside the paver after installation. Improving upon an existing idea, it was determined that the 'L' shape was the best design to solve these problems. And, as with all of our products, this new restraint needed to be the strongest on the market; therefore, it was made of high grade PVC with no fillers or blown in material. Its success is evident by the many competitors who have since tried to copy the design. Today, Bric-Edg™ remains an industry leader.

Available in 7.5 ft and 15 ft Flexible or rigid lengths

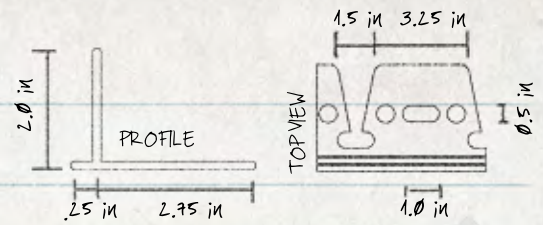

BRIC-EDG II™



Introduced shortly after the original Bric-Edg™, this restraint features the same design and construction but without the .25 inch lip along its backside. Bric-Edg II™ is a great option for landscapers who prefer installing the restraint on the outside of the paver.

Available in 7.5 ft and 15 ft Flexible or rigid lengths

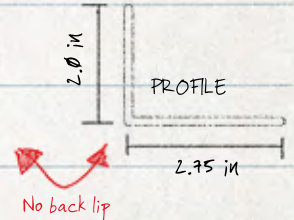

SINCE OUR PAVER RESTRAINTS ARE MADE OF TRUE PVC, THEY CAN BE HEATED WITH A PROPANE TORCH OR HEAT GUN AND THEN BENT TO FORM 90 DEGREE CORNERS AND OTHER ANGLES. BE SURE TO PRACTICE YOUR TECHNIQUE ON SCRAP PCECES BEFORE APPLYING IT IN THE FIELD.



"For almost 20 years, I have been using Oly-Ola's Bric-Edg™ on sidewalk and patio projects and I have never had a recall on any of the installations. The edging stays under the pavers and doesn't move out like the other edging products."

Brian Rice - Owner
Pavers Inc.
Brownsburg, IN

Shallow BRIC-EDG™

As a slightly smaller version of Bric-Edg™, Shallow Bric-Edg™ is the most cost effective paver restraint in our line. Its shallower vertical wall makes for a great fit when restraining shallow pavers, patio block, flagstone, and even slate. This style features the same key-hole cuts and 'L'-shape design as all of Oly-Ola's paver restraints, making it flexible and durable. This version is also available without the .25 inch backlip, ask for it as Shallow Bric-Edg II™. (picture is Shallow Bric-Edg™)

Available in 7.5 ft and 15 ft Flexible or rigid lengths

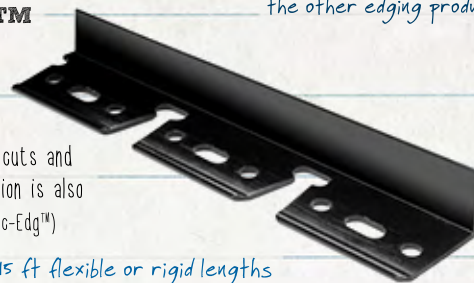

ALTERNATIVE INSTALLATION



Pictured here, Doyle Brick Paving of Addison, Illinois, and many others, have had a good deal of success preventing spike heaving by using this alternative installation method. We do not recommend using this installation method with low grade retail edgings!

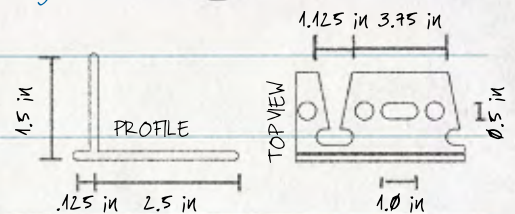

H-CLIP CONNECTOR
for paver restraints



It is not necessary to connect paver restraint pieces together if staked properly. However, our H-clip connector works great with PVC glue to create a permanent hold.

Round Top Edgings

Oly-Ola's round top edgings are ideal for dividing turf from planting areas, while keeping stone, mulch or bark in place. Round top edgings are easy to install, provide long lasting quality on the job, and result in high profitability for the professional landscape contractor.

- * Edging minimizes hand trimming and contains mulches within the bed area
- * If ever cut by mistake, there is no danger or damage to operator, pedestrians or equipment
- * Once installed properly with anchoring stakes, these round top edgings stay where they belong...in the ground



EDG-KING™

Introduced in 1978, Edg-King™ was the first true professional grade edging. Still Oly-Ola's finest round top edging, Edg-King™ features four horizontal grooves on its anchoring wall which eliminates frost heaving problems and helps keep the edging in the ground. You need not worry about kinking or the additional labor costs that go along with it. **Where others fail, Edg-King™ succeeds.**

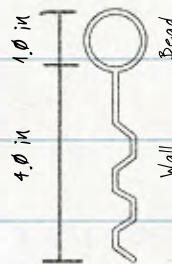

Available in 10 ft and 20 ft lengths

"Oly-Ola's Edg-King™ landscape edging is very popular with our landscape contractor customers. They love it! Since some of our competitors carry cheaply-made edging products, I will put Edg-King™ up against the cheaper product, and once a contractor sees the difference, they buy the Oly-Ola product every time. It's easy to get customers to switch from their old edgings to Edg-King."

Lisa King, General Manager
Valley Landscape Supply
Corvallis, MT

BLACK EDG-KNIGHT™

Stays in the ground!



Created in the likeness of Edg-King™, this similarly thick cousin is designed with a double V-lip anchoring wall; therefore, preventing frost heave better than any other V-lip style. Since Black Edg-Knight™ achieves the same great results as its predecessor, choosing between the two basically comes down to personal taste.

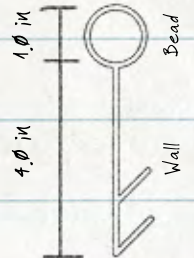
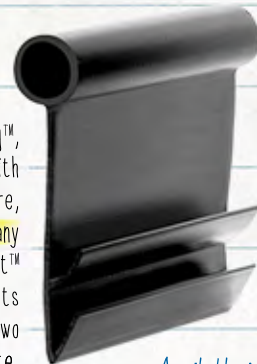

Available in 10 ft and 20 ft lengths



PROPER STAKING FOR POLY EDGINGS

* DO NOT DRIVE THE STAKE HEAD FLUSH TO THE EDGING.

LEAVE 2 INCHES OR MORE UNDRIVEN SO THAT THERE IS STAKE RESISTANCE ON BOTH SIDES OF THE EDGING.

Important!
Prevent frost heave!

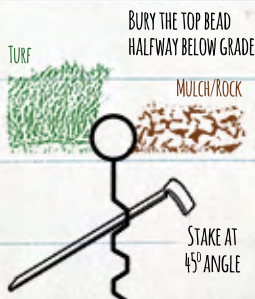

OVERLAP METHOD: GUARD AGAINST GAPPING AND FROST HEAVE

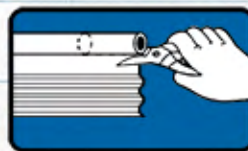

1. Cut off a 4 inch section of the round bead at the top of one of the edging pieces with a metal snip, utility knife or saw.

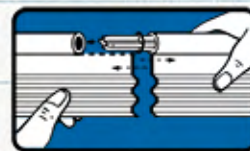

2. Use our exclusive crosslock connector to join the two sections, while overlapping the two pieces of edging.

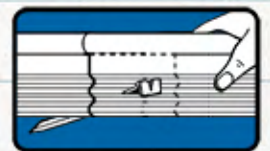

3. Drive 1 or 2 steel anchoring stakes through both sections at a 45 degree angle toward the turf or outside portion of the bed.

* This method should be used for all round top style edgings and for Slim-Edg™

BLACK JACK™



An alternative to Oly-Ola's popular Black Edg-Knight™ style, Black Jack™ is the industry's best of the single V-lip edgings. Without compromising quality, this edging was designed to be slightly smaller, making it a more economical option to help you win those close bids.

Available in 10 ft lengths, 20 ft lengths and 20 ft roll (pictured right)

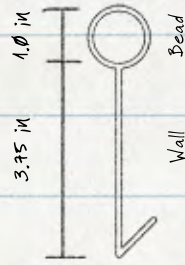

Black Jack™ is also available in a boxed and rolled version which includes 4 non-bending steel stakes and 1 crosslock connector. It is ideal for independent retail nursery and garden centers that want to carry a high quality, pre-packaged edging for their customers.



Economical & effective!

Photo Credit: Serenescapes, Inc. - Fort Wayne, IN

TRIM-LINE™



The solution for the landscaper who desires a profile smaller than the traditional round top. Trim-Line™ features a single V-lip anchoring wall and its half-inch round bead resists kinking.

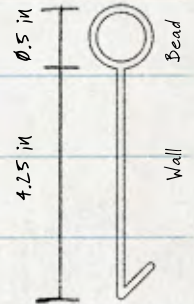

Available in 10 ft and 20 ft lengths

Avoid weak and unsightly joints by using the overlap method (see page 9), and by using Oly-Ola's tight fitting connector.



YOU CAN ROTATE OLY-OLA'S UNIQUE CONNECTOR TO ADJUST THE FIT. WHEN LOOKING AT THE CONNECTOR'S END, IT APPEARS AS A '+'. INSERTED INTO THE EDGING AS A PLUS SIGN WILL GIVE IT A TIGHTER FIT. ROTATE THE PLUG 45° AND INSERT THE PLUG AS AN 'X' (PICTURED RIGHT) AND YOU WILL GET A SLIGHTLY LOOSER FIT.



INSTALLATION BASICS



1. Outline the border of the edging to ensure an accurate and straight installation. Dig a 6 inch deep trench using a trenching machine or straight edge spade shovel.



2. Place edging into trench with the edging's top bead a half of an inch above the finished grade. Drive a few steel stakes at a 45 degree angle through the edging toward the trench wall to hold the edging in place. See 'Pro Tip' on page 9 about proper staking. Sparingly stake the edging until you are satisfied with your design.



3. Use Oly-Ola's overlap method when joining two pieces of edging together. See the illustration titled "Overlap Method: Guard Against Gapping and Frost Heave" on page 9.



4. Finish securing the edging with additional stakes. We recommend staking every two feet at minimum, using extra stakes when securing joints and curves. Do not make the mistake of using too few stakes, especially when the ground is exposed to cold temperatures.

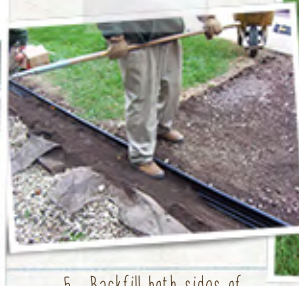

5. Backfill both sides of the edging. Compact the backfill material along the edging until the top of the edging is a half of an inch above grade. Clean up and remove excess material from the site.

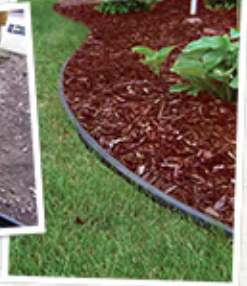

6. Properly installed landscape edgings form a clean, neat, almost invisible line between planting areas and turf or ground covers. Poly or PVC edgings have no sharp edges and are safe to install.

Photos courtesy of Van de Hey Company - Appleton, WI

Low Profile Edgings

- * The clean appearance provides a nearly invisible border and well defined bed line
- * No sharp edges; a safe alternative to metal, wood, and concrete edgings
- * Can be heated & formed to create logos and patterns
- * Easier to transport and install than metal edgings

SLIM-EDG™

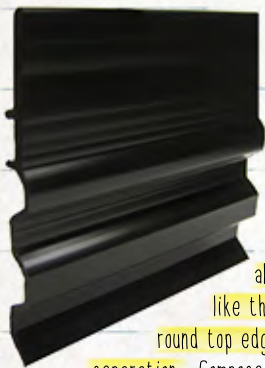

Slim-Edg™ is a combination of Super-Edg™ and Edg-King™. Its low profile top and grooved bottom offers superior frost heave resistance. This product was introduced as an alternative for customers who like the safety and function of our poly round top edgings but were looking for a nearly invisible separation. Composed of the same high quality material, Slim-Edg™ offers rigid strength from top to bottom, with no sharp edges.

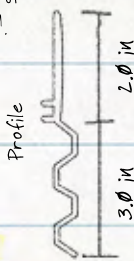

Available in 10 ft and 20 ft lengths



Connecting Cap



Joining two lengths of Slim-Edg™ together is as easy as 1, 2, 3...

SUPER-EDG™



Unlike any other edging on the market, Super-Edg™ features a 6 inch deep low profile design that makes it ideal for a variety of landscape applications, such as: defining flower beds, forming logos and patterns, and can be used above ground at the base of fences to save time and money while string trimming. Super-Edg's heavy-duty, 100% recycled PVC construction makes it safer and more economical than metal edging products. Super-Edg™ is manufactured with pre-cut slots for staking which are spaced every 2 feet.

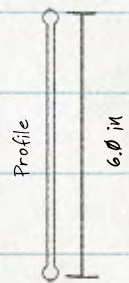

Connecting H-Clip

Available in 10 ft lengths, 20 ft lengths and 100 ft roll



Quilt Garden

Thanks to its durability, flexibility and light weight design, Super-Edg™ can be easily and safely used to create unique & beautiful landscape art (as pictured here by Wellfield Botanic Gardens - Elkhart, IN).



"In North Central Texas, Bermuda Grass is the lawn grass of choice. Bermuda Grass is hard to contain and laughs at 4 inch edgings. The only edging product we have been able to use successfully is Super-Edg™. Super-Edg™ requires little maintenance and outlasts all other landscape edgings by many years. Oly-Ola is a great company to work with and I cannot say enough good things about them."

NiLa Dowlearn - Owner
Wichita Valley Landscape
Wichita Falls, TX



* Additionally, our entire paver restraint line can be used as a low profile option. Bulldog-Edg™ makes for an excellent minimal effort bed divider.



Oly-Ola's LOW PROFILE EDGINGS CAN BE HEATED WITH A HEAT GUN OR TORCH AND THEN BENT TO FORM ANGLES. USE LESS HEAT WITH SLIM-EDG™ AND PRACTICE ON SCRAP PIECES BEFORE APPLYING IN THE FIELD.

Accessories

Connectors



Oly-Ola's exclusive crosslock connector is available for use with our round top style edgings. It provides a tight fit and eliminates gapping where two lengths are joined together (see page 9 & 10 for details).

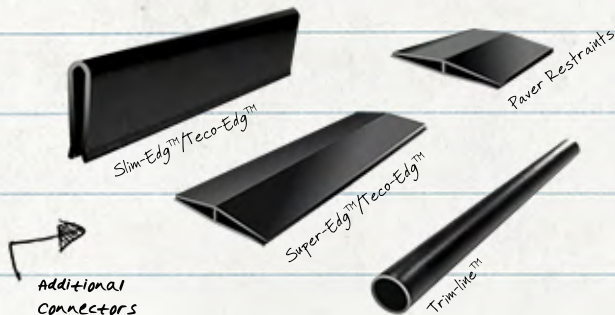

Available for Edg-King™, Black Edg-Knight™, & Black Jack™, our 90° corners are made of high density polyethylene and are designed to create a virtually seamless right angle when joining two pieces of edging together. Make sure you have these accessories available to sell along with your edging.

Steel Stakes

Oly-Ola's custom 9.25 in. non-bending steel stake is made to be used with all of our edging products, with the exception of Super-Edg™, which is installed with a special 14 in. steel stake (pictured above).

Product Displays

Oly-Ola product displays are designed to showcase our premium, contractor quality landscape edgings and paver restraints. These 'customer-friendly' displays give patrons the ability to see and feel for themselves the value of high quality Oly-Ola landscape edgings versus using lightweight boxed and rolled products found in the chain stores.

Attract Attention...



Increase Profits!



Floor Display Rack

- * Constructed of heavy-duty steel tubing with angled steel arms to hold edging in place
- * Easy to handle lengths - 10 ft. landscape edgings and 7.5 ft. paver restraints
- * Includes mounted signage and "How-to" literature
- * Built-in shelves to store/display accessories
- * Compact and weatherproof, can be placed indoor or outdoor

Counter Top Display

- * Eye-catching, bright design to attract attention
- * Constructed of durable cardboard which comes preassembled
- * Compact size takes up a minimal amount of counter space
- * Built-in literature holders for displaying informative tri-fold brochures
- * Designed with pre-cut slots to display the edging neatly and keep it in place
- * Comes labeled with edging samples and literature



indoor use only

Product Specifications

CBC = carbon black concentrate

BULLDOG-EDG™

STONE-EDG™

BRIC-EDG™



Packaging	15 foot - 6 pieces per bundle (30 ft.) 7.5 foot - 12 pieces per bundle/box (30 ft.)	15 foot - 6 pieces per bundle (30 ft.) 7.5 foot - 12 pieces per bundle/box (30 ft.)	15 foot - 6 pieces per bundle (30 ft.) 7.5 foot - 12 pieces per bundle/box (30 ft.)
Each Piece Includes	Paver restraint only - steel stakes and H-clips sold separately at discount	Paver restraint only - steel stakes and H-clips sold separately at discount	Paver restraint only - steel stakes and H-clips sold separately at discount
Material	Black rigid PVC, CBC and impact modifier	Black rigid PVC, CBC and impact modifier	Black rigid PVC, CBC and impact modifier
Average Wall Thickness	Vertical wall: .175 to .185 inches Horizontal leg: .145 to .155 inches	Vertical wall: .175 to .185 inches Horizontal leg: .145 to .155 inches	Vertical wall: .115 to .125 inches Horizontal leg: .110 to .120 inches
Dimensions Per Piece	Depth: 1.75 in. vertical wall Width: 2.75 in. horizontal leg	Depth: 1 in. vertical wall Width: 2.25 in. horizontal leg	Depth: 2 in. vertical wall Width: 3 in. horizontal leg
Weight	15 ft. piece: 5.6 lbs. bundle: 34 lbs. 7.5 ft. piece: 2.8 lbs. bundle: 34 lbs. 7.5 ft. box: 33 lbs. (incl. stakes/clips)	15 ft. piece: 3.4 lbs. bundle: 20 lbs. 7.5 ft. piece: 1.7 lbs. bundle: 20 lbs. 7.5 ft. box: 24 lbs. (incl. stakes/clips)	15 ft. piece: 5.2 lbs. bundle: 31 lbs. 7.5 ft. piece: 2.6 lbs. bundle: 31 lbs. 7.5 ft. box: 36 lbs. (incl. stakes/clips)
Connection Type	H-Clip - Use PVC glue for permanent hold	H-Clip - Use PVC glue for permanent hold	H-Clip - Use PVC glue for permanent hold
Can be Formed with Heat	Yes - heat gun or propane torch	Yes - heat gun or propane torch	Yes - heat gun or propane torch
Available Style(s)	flexible only	flexible only	flexible and rigid

Profile

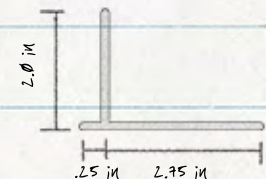
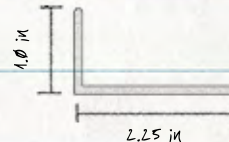
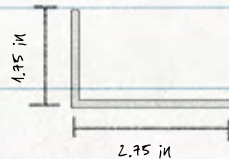

EDG-KING™

BLACK EDG-KNIGHT™

BLACK JACK™

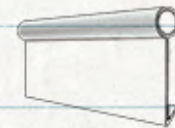
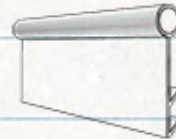
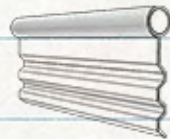

Packaging	5 pieces per flat bundle	5 pieces per flat bundle	5 pieces per flat bundle 20 foot boxed roll (sold as 6-pack or 32-skid)
Each Piece Includes	Edging only - steel stakes and crosslock connectors sold separately at discount	Edging only - steel stakes and crosslock connectors sold separately at discount	Edging only - steel stakes and crosslock connectors sold separately at discount
Material	Pure medium density polyethylene and 4% carbon black concentrate. With a melt factor under 2	Pure medium density polyethylene and 4% carbon black concentrate. With a melt factor under 2	Pure medium density polyethylene and 4% carbon black concentrate. With a melt factor under 2
Average Wall Thickness	.09 to .105 inches	.09 to .105 inches	.07 to .09 inches
Dimensions Per Piece	Length: 10 ft. or 20 ft. Height: 5 in.	Length: 10 ft. or 20 ft. Height: 5 in.	Length: 10 ft. or 20 ft. Height: 4.75 in.
Features	1 in. round top with 4 horizontal grooved wall	1 in. round top with double "V-Lip" wall	1 in. round top with single "V-Lip" wall
Connection Type	King Connector - Use Overlap Method	Jack/Knight Connector - Use Overlap Method	Jack/Knight Connector - Use Overlap Method
Can be Formed with Heat	Yes - heat gun or propane torch (no contact)	Yes - heat gun or propane torch (no contact)	Yes - heat gun or propane torch (no contact)
Weight	10 ft. piece: 3.4 lbs. 10 ft. bundle: 17 lbs. 20 ft. piece: 6.8 lbs. 20 ft. bundle: 34 lbs.	10 ft. piece: 3.4 lbs. 10 ft. bundle: 17 lbs. 20 ft. piece: 6.8 lbs. 20 ft. bundle: 34 lbs.	10 ft. piece: 2.8 lbs. 10 ft. bundle: 14 lbs. 20 ft. piece: 5.6 lbs. 20 ft. bundle: 28 lbs. 6-pack: 48 lbs. 32-skid: 306 lbs.

Profile

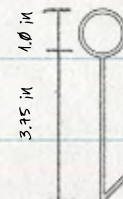
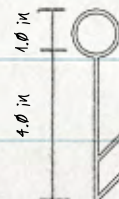
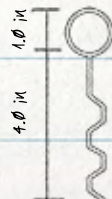

Landscape Architects:

Please remember to include our toll free number 1-800-EDGINGS (334-4444) when specifying our products.

⇒ For more detailed specifications, please visit us on the web @ www.olyola.com.

BRIC-EDG II™

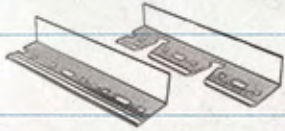

15 foot - 6 pieces per bundle (30 ft.)
7.5 foot - 12 pieces per bundle/box (30 ft.)

Paver restraint only - steel stakes and H-clips sold separately at discount

Black rigid PVC, CBC and impact modifier

Vertical wall: .115 to .125 inches
Horizontal leg: .110 to .120 inches

Depth: 2 in. vertical wall
Width: 2.75 in. horizontal leg

15 ft. piece: 5.2 lbs. bundle: 31 lbs.
7.5 ft. piece: 2.6 lbs. bundle: 31 lbs.
7.5 ft. box: 36 lbs. (incl. stakes/clips)

H-Clip - Use PVC glue for permanent hold

Yes - heat gun or propane torch

flexible and rigid (no back lip)

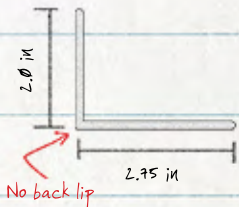

SHALLOW BRIC-EDG™



15 foot - 6 pieces per bundle (30 ft.)
7.5 foot - 12 pieces per bundle/box (30 ft.)

Paver restraint only - steel stakes and H-clips sold separately at discount

Black rigid PVC, CBC and impact modifier

Vertical wall: .09 to .110 in.
Horizontal leg: .09 to .110 in.

Depth: 1.5 in. vertical wall
Width: 2.625 in. horizontal leg

15 ft. piece: 4.2 lbs. bundle: 25 lbs.
7.5 ft. piece: 2.1 lbs. bundle: 25 lbs.
7.5 ft. box: 30 lbs. (incl. stakes/clips)

H-Clip - Use PVC glue for permanent hold

Yes - heat gun or propane torch

flexible and rigid

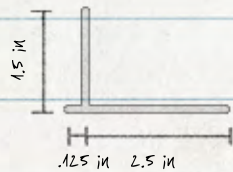

SHALLOW BRIC-EDG II™



15 foot - 6 pieces per bundle (30 ft.)
7.5 foot - 12 pieces per bundle/box (30 ft.)

Paver restraint only - Steel stakes and H-clips sold separately at discount

Black rigid PVC, CBC and impact modifier

Vertical wall: .09 to .110 in.
Horizontal leg: .09 to .110 in.

Depth: 1.5 in. vertical wall
Width: 2.5 in. horizontal leg

15 ft. piece: 4.2 lbs. bundle: 25 lbs.
7.5 ft. piece: 2.1 lbs. bundle: 25 lbs.
7.5 ft. box: 30 lbs. (incl. stakes/clips)

H-Clip - Use PVC glue for permanent hold

Yes - heat gun or propane torch

flexible and rigid (no back lip)

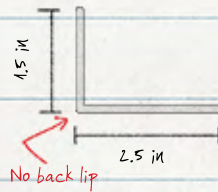

TECO-EDG™

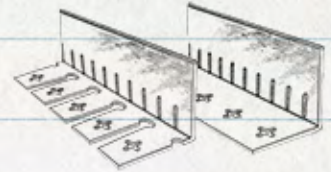

5 - 10 foot pieces per bundle (50 ft.)

Edge restraint only - steel stakes and connecting caps sold separately at discount

Black rigid PVC, CBC and impact modifier

.185 in. at elbow tapering to .130 in. at the tip (+/- .025 in.)

Depth: 4 or 6 in. vertical wall
Width: 4 or 6 in. horizontal leg

4X4 rigid/flexible pc: 8.75/7.5 lbs. bdl: 43.75/37.5 lbs.
6X6 rigid/flexible pc: 12.5/11.25 lbs. bdl: 62.5/56.25 lbs.

Cap or H-Clip - Use PVC glue for permanent hold

Yes - heat gun or propane torch (use caution on roof)

flexible and rigid

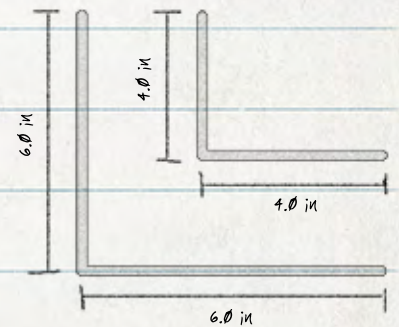

TRIM-LINE™

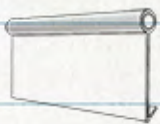

5 pieces per flat bundle

Edging only - steel stakes and connecting plugs sold separately at discount

Pure medium density polyethylene and 4% carbon black concentrate. With a melt factor under 2

.08 to .09 inches

Length: 10 ft. or 20 ft. Height: 4.75 in.

.05 in. round top and single "V-Lip" wall

Poly plug - Use Overlap Method

Yes - heat gun or propane torch (no contact)

10 ft. piece: 2.8 lbs. 10 foot bundle: 14 lbs.
20 ft. piece: 5.6 lbs. 20 foot bundle: 28 lbs.

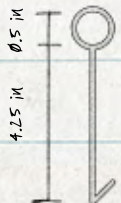

SLIM-EDG™

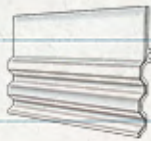

5 pieces per flat bundle

Edging only - steel stakes and connecting caps sold separately at discount

Pure medium density polyethylene and 4% carbon black concentrate. With a melt factor under 2

Top 2 inches: .20 to .30 in. Wall: .09 to .105 in.

Length: 10 ft. or 20 ft. Height: 5 in.

2 in. straight top with 4 horizontal grooved wall

Connecting Cap - Use Overlap Method

Yes - heat gun or propane torch (no contact)

10 ft. piece: 3.4 lbs. 10 foot bundle: 17 lbs.
20 ft. piece: 6.8 lbs. 20 foot bundle: 34 lbs.

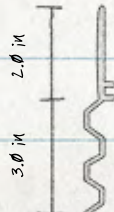

SUPER-EDG™

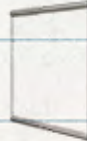

5 pieces per flat bundle
100 foot roll in carton (sold individually)

Edging only - stakes and H-clips sold separately
Carton - 25 steel stakes and 2 H-clips

Black rigid PVC, CBC and impact modifier

.115 to .130 inches

Length: 10 ft., 20 ft. or 100 ft. Height: 6 in.

28 in. X 28 in. X 7 in. carton for 100 ft. roll

H-Clip - Use PVC glue for permanent hold

Yes - heat gun or propane torch

10 ft. piece: 4.3 lbs. 10 foot bundle: 21.5 lbs.
20 ft. piece: 8.6 lbs. 20 foot bundle: 43 lbs.
Carton: 54 lbs. (includes stakes & H-clips)

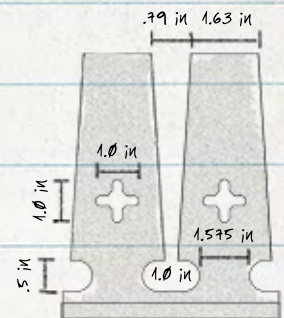
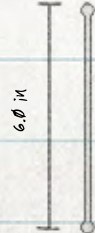

Teco-Edg: 6 in Top View

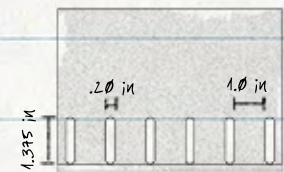

Teco-Edg: Interior Vertical Wall

*Drainage slots are flush with horizontal leg



LANDSCAPE ARCHITECTS:

1-800-EDGINGS (334-4647)

Please include our toll free number on all specifications so that we can better assist the contractor when bidding on a project.

This Book Belongs To:

OLY-OLA EDGINGS, INC..

124 E SAINT CHARLES RD - VILLA PARK, IL 60181

PHONE: (630) 833-3033 FAX: (630) 833-0816

E-MAIL: EDGINGS@OLYOLA.COM WEB: WWW.OLYOLA.COM

CALL TOLL FREE: 1-800-EDGINGS

MMXX

ME+00=BFF

Distributed by:

