



ACADEMY PARK

A LEGACY DECADES IN THE MAKING...
IN WILLIAMSON COUNTY



Williamson County Enrichment Center
Williamson County Performing Arts Center
Academy Park Gymnasium

WELCOME



Welcome to the Academy Park Campus in Franklin, Tennessee. The campus comprises the Williamson County Enrichment Center, the Williamson County Performing Arts Center and Academy Park Gymnasium along with the Williamson County Public Library and Renaissance High School.

The Enrichment Center and the Performing Arts Center sit on the land that once held the original Battleground Academy Campus. In fact, one of the original buildings, Coverdale Hall, has been renovated into the Performing Arts Center. We are proud to honor the past history of the land while embracing new opportunities for the community.

-Gordon Hampton, Director

Williamson County Enrichment Center

110 Everbright Avenue
Franklin, Tennessee 37064
(615) 786-0186

Mon-Wed-Fri: 8:00am - 7:00pm
Tue-Thur: 8:00am - 3:00pm
Sat-Sun: Closed



Williamson County Performing Arts Center

112 Everbright Avenue
Franklin, Tennessee 37064
(615) 786-0186

Academy Park Gymnasium

120 Everbright Avenue
Franklin, Tennessee 37064
(615) 786-0186



GENERAL INFORMATION

WILLIAMSON COUNTY ENRICHMENT CENTER PASSES

GENERAL ADMISSION

Youth/Adult (3-54) \$4.00
Senior (55+) \$ 1.00

ANNUAL PASSES

Single Pass (55+) \$50.00
Couple Pass \$75.00

General admission and all passes include daily access to the Senior Lounge (55+) and Enrichment Center Wellness Center plus access to certain activities at the Academy Park Gymnasium.

GENERAL CLASS FEE

Senior (55+) EC Pass Holder \$2.00
Senior (55+) Non-Pass Holder \$4.00

General class fee includes participation in Senior Group Fitness Classes, Open Art and Open Watercolor Studios. Additional fees may be incurred for other types of programs/supplies with instructors.

All existing department pass(es) are honored at the Enrichment Center for amenitiy use or access to ongoing Senior Fitness Classes (55+).

Non-Williamson-County-Residents may purchase passes for an additional fee, see website for details.

Reimbursable Programs

Williamson County Parks and Recreation partners with several insurance-based reimbursable programs. SilverSneakers®, Prime® and Silver&Fit® members qualify for free facility amenity use and access to ongoing fitness classes (Aqua Fitness, Group Fitness and Senior Fitness classes), where available. To find out if your health plan offers any of these programs visit silversneakers.com, TivityHealth.com or silverandfit.com.

We also participate in a program available to Tennessee residents who are insured members covered under an AARP® Medicare Supplement Insurance Plan insured by UnitedHealthcare Insurance Company (UnitedHealthcare).

For questions on how to use these programs in our facility; please see a front desk receptionist.

SilverSneakers® and Prime® are registered trademarks of Tivity Health, Inc. Silver&Fit® is a federally registered trademark of American Speciality Health Incorporated.

Military Eligibility

Williamson County residents who are Current US Military members, Disabled Veterans, and Veterans who were honorably discharged or generally discharged under honorable conditions that were involved in active duty service and their spouses may qualify for a free standard annual pass. To qualify, you must present proper military identification. Option of a Standard Annual Family Pass for dependent children offered for \$100

*See facility receptionist or visit wcparksandrec.com for additional information.

Residency Information

Any Williamson County resident will receive the resident rate fee(s). Proof of residency may be required including voter registration card or property tax receipt.

Rental Information

The Banquet Hall at the Williamson County Enrichment Center as well as the Performing Arts Center are available for private events. For rental information on the Enrichment Center or Performing Arts Center call (615) 786-0186.

Locker Service

Please do not leave personal belongings unattended in the facility. Patrons are encouraged to utilize the FREE locker service located at the front desk or in the wellness center to secure valuables.

Parking

Academy Park is a shared parking campus. ADA access is available in front of the Enrichment Center for drop-offs and pick-ups. General parking is available behind the Williamson County Public Library, on Everbright Street, in front of the Performing Arts Center and the parking lot across from the Academy Park Gymnasium.

Wellness Center

The Wellness Center is available exclusively to seniors from 8:00 a.m. to 7:00 p.m. on Monday, Wednesday, Friday and 8:00 a.m. to 3:00 p.m. on Tuesday and Thursday.

Adults, under 55, and teens may use the equipment after 3:00 p.m. until close and on Saturday and Sunday during regular operating hours.

The Wellness Center inside the Enrichment Center has a variety of fitness equipment to help you stay healthy. Equipment includes:

5 Hoist Weight Training Machines
4 True Treadmills
3 True Recumbent Bikes

2 True Upright Bikes
2 True Spectrum Trainers

1 Concept 2 Rowing Machine
Free Weights (3-25 lbs.)

For complete information about wellness center policies and age limits, please visit our website.

Bocce Ball/Pickleball Courts

These courts are available for public use when not in use for department activities. For court policies and reservation procedures visit our website. During facility hours, individuals may check out court equipment for free from the front desk of the Enrichment Center.

Use of Metal Detectors

Williamson County, Tennessee was the location of the historical Battle of Franklin occurring during the Civil War. The historical significance of Williamson County is an essential part of Williamson County, who strives to preserve the historical significance as well as the historical items that may be located on park property. For these reasons, the following policy concerning the use of metal detectors must be adhered.

The use of any mineral or metal detecting device capable of detecting the underground location of metal, geological, archaeological, or any historical objects or materials is strictly prohibited except for an individual engaged in a limited search for a lost item under supervision of a Park Superintendent. The destroying, digging, cutting, removing, defacement, alteration, or possession of any tree, shrub, or other plant or removal of any small item or materials is prohibited within any county park or upon any county property. Any recovered item(s) must be presented and reported to the Park Superintendent. All property found that is not the lost item described by the individual shall be turned over to the Park Superintendent and shall be deemed Williamson County property. Permission to use a metal detector to find lost items is granted in the sole discretion of the Parks and Recreation Director and any property that is damaged looking for the lost item shall be the responsibility of the individual.

Should permission be granted by Williamson County Parks and Recreation, the metal detectorists shall not disturb sprinkler heads, pipes, irrigation system components, or any other infrastructure above or below ground. Individuals damaging or destroying Williamson County property shall be responsible for all costs to repair or replace the property. Any permissible metal detecting shall not interfere with reserved activities, organized sporting activities, or other park users or activities. A hand tool for digging purposes is permitted. Holes shall be no more than six-inches in depth. Any holes created must be refilled immediately. Failure to comply with this condition will result in the revocation of metal detecting approval.

The following uses shall be exempted from the prohibitions contained in paragraph B, but shall still be subject to paragraph C.

1. A County approved archeological or historical investigation.
2. Educational based program or class.

3. State sponsored historical endeavors.

4. Request by a local law enforcement agencies conducting an investigation.

Any questions concerning this policy shall be directed to the Williamson County Parks and Recreation Dept.

Inclement Weather

For inclement weather updates on facility closures, call the Inclement Weather Hotline at (615) 591-8524. For class cancellations visit: www.wcparksandrec.com, key word: inclement weather. You may also receive up to date information by “liking” WCPR on Facebook or by following us on Twitter. For athletic rainout information, please call (615) 370-0209.

Unmanned Aerial Vehicles

PURPOSE: Due to safety and privacy concerns, the purpose of this policy is to provide clear guidelines for the recreational, commercial, and governmental use of unmanned aerial vehicles on or above Williamson County Parks and to ensure that the use of unmanned aerial vehicles does not threaten the safety or privacy of those using Williamson County Parks (“County Parks”). For the purpose of this policy, an unmanned aerial vehicle (“UAV”) is defined as an aircraft without a human pilot aboard, the flight of which is controlled either autonomously by on board computers or by the remote control of a pilot on the ground or in another vehicle or aircraft.

This policy is not intended to restrict legitimate operation of a UAV for a public purpose by or at the direction of a governmental unit in compliance with Federal Aviation Administration (“FAA”) rules and any applicable laws. Additionally, it is not the intent of this policy to preempt FAA rules, but to operate UAVs in conjunction and in accordance with this policy while recognizing the limitations in the FAA’s enforcement capabilities.

PROHIBITION: Unless otherwise exempt or permission is obtained, Williamson County Parks and Recreation Department prohibits the take-off, landing, and operation of UAVs, on or above any County Parks by the general public without the prior written authorization from the Williamson County Parks and Recreation Department. This prohibition extends to any devices launched or operated from a Williamson County owned park, as well as any launched from property outside Williamson County Parks.

PERMISSION: Should any individual or entity desire to use UAV’s on or above Williamson County Parks for the following purposes, written approval must first be granted by the Williamson County Parks and Recreation Director or his authorized representative:

- Use by registered licensed users on behalf of an athletic organization for the purposes of advertising. Use shall not be permitted while athletic events are being conducted or over any individual; and
- Educational purposes.

LIMITATIONS ON RECREATIONAL USE: Should permission be granted for use of a UAV for recreational purposes over County Park property, the UAV must weigh under fifty-five (55) pounds and the user shall comply with the following standards and rules:

- Register your UAV with the FAA and mark your UAV with your registration number;
- Fly the UAV under 400 feet and remain below any surrounding obstacles;
- Must maintain eyesight at all times, and use an observer to assist if needed;
- Never fly the UAV in the vicinity of manned aircraft;
- Do not fly over persons or moving vehicles and remain at least twenty-five (25) feet away from any individuals;
- Do not fly in adverse weather conditions such as high winds or reduced visibility;
- Do not fly if under the influence of alcohol or drugs; and
- Do not fly near or over sensitive infrastructure or property such as power stations, water treatment facilities, correctional facilities, or heavily traveled or private property.

Should a user receive permission, by operation of a UAV, the user is warranting to the Williamson County Parks and Recreation Department that the operator is competent and proficient in the operation of UAVs.

EXEMPTIONS: This policy shall not prohibit the use of any UAV by law enforcement, emergency response, public safety, or Williamson County agencies if the use is in accordance with the FAA rules and applicable laws and the use is to provide emergency response or law enforcement services.

FACILITY LAYOUTS

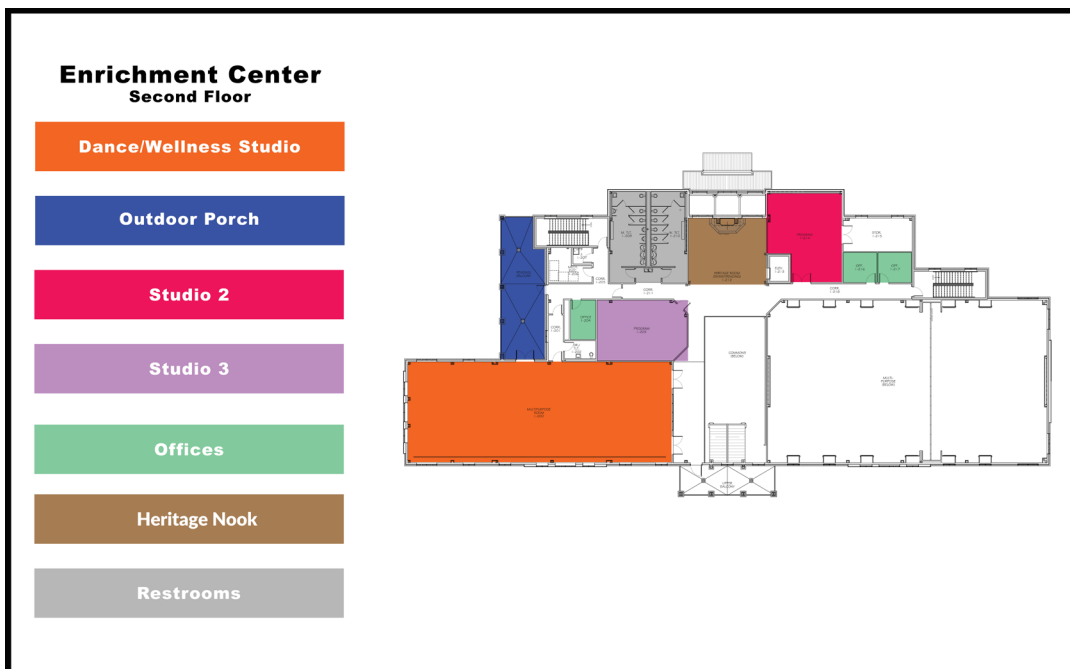
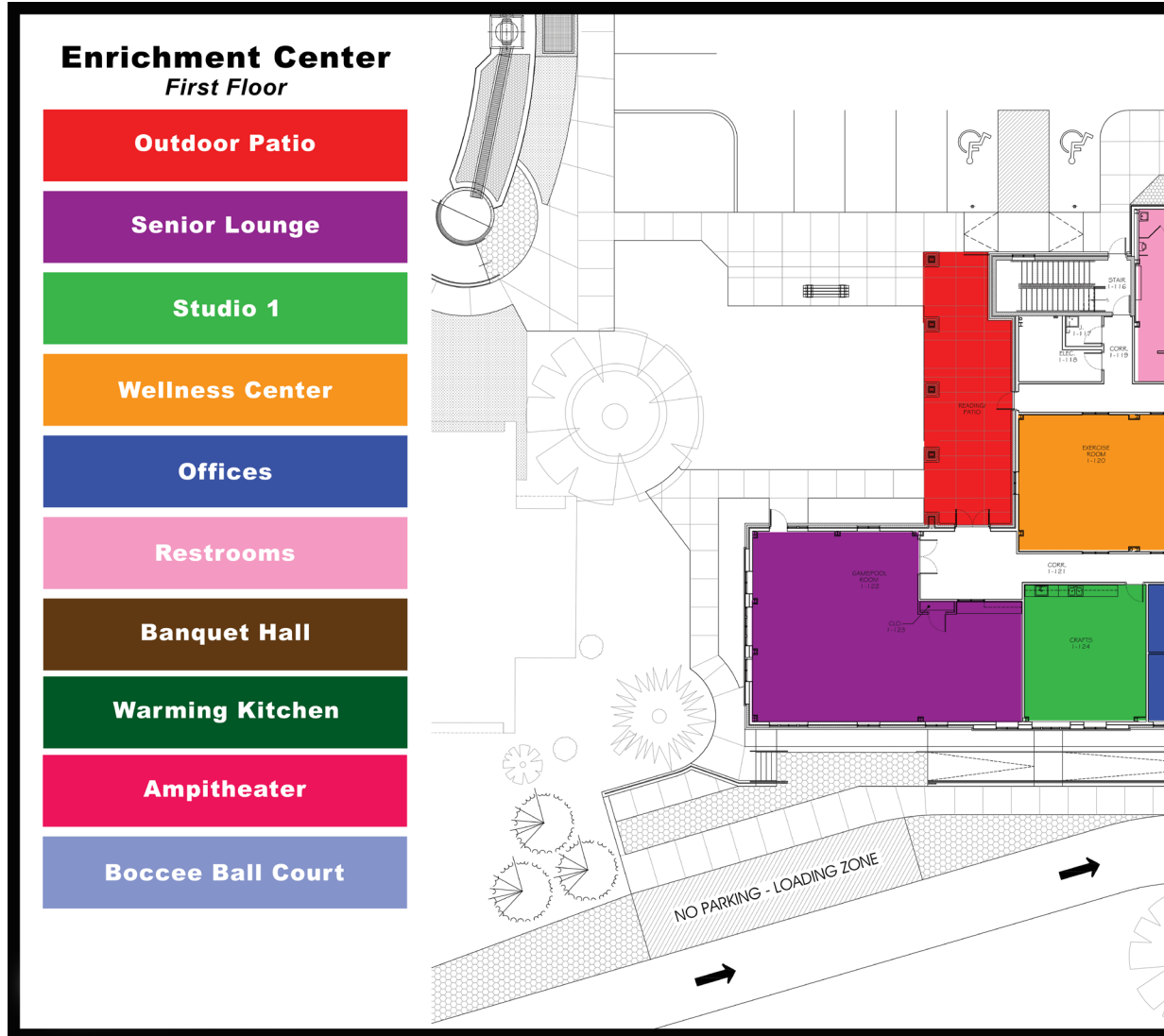

FACILITY LAYOUTS

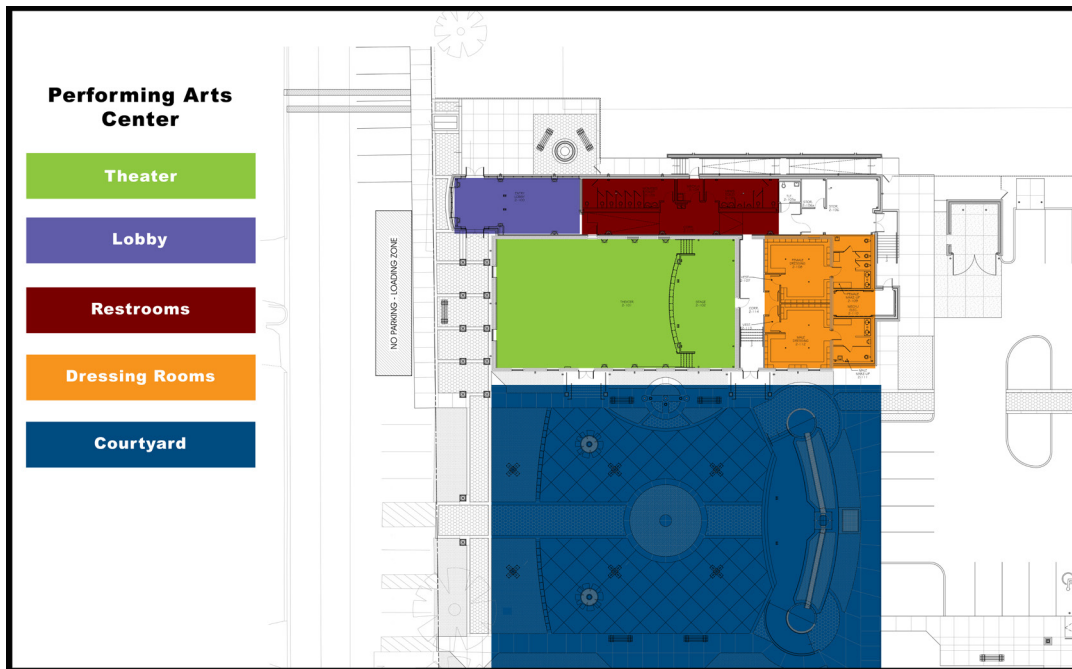
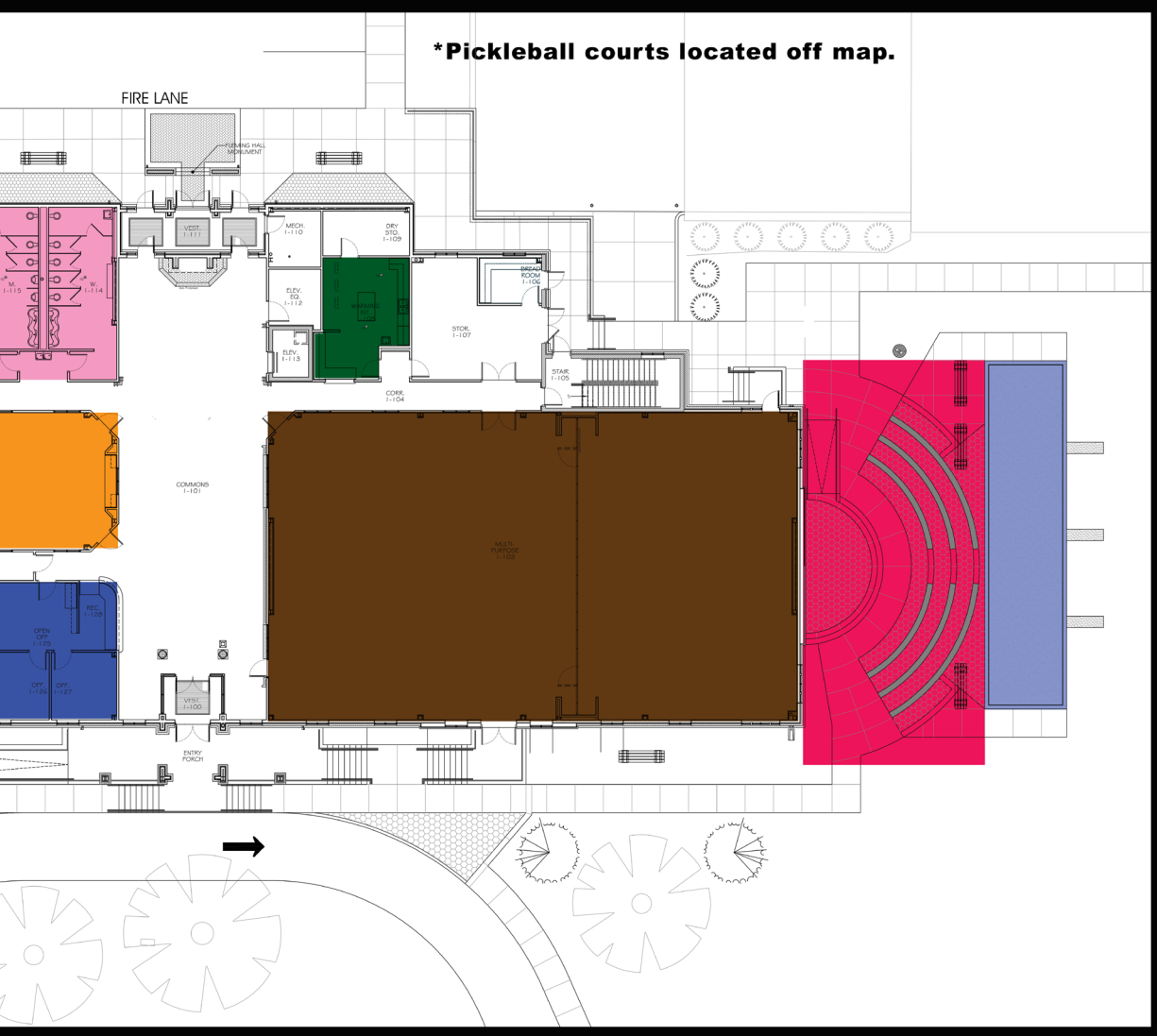



wcparksandrec.com