

The Magic of Play in the Magic City

DRAFT COPY

VERSION: 1.21.19

ALL ITEMS SUBJECT TO CHANGE

FINAL VERSION WILL BE AVAILABLE AT CONFERENCE



Alabama Recreation and Parks Association
2019 Annual Conference
Birmingham

CONTENTS

- 3 WELCOME LETTERS**
- 6 GENERAL INFORMATION**
- 7 BJCC**
- 8 SATURDAY | SUNDAY**
- 11 MONDAY**
- 13 TUESDAY**
- 17 EXHIBIT HALL INFORMATION**
- 18 EXHIBITOR LISTING**

SPONSORS





CITY OF BIRMINGHAM

MAYOR RANDALL L. WOODFIN

PUTTING PEOPLE FIRST



January, 2019

2019 ARPA Conference
The Sheraton Hotel
Birmingham, AL

Dear Friends,

As Mayor of the City of Birmingham, it is my pleasure to welcome you all to the 2019 Alabama Recreation and Park Association Conference. I am thrilled to have so many dedicated park and recreation professionals in the Magic City.

The Alabama Recreation and Parks Association represents more than 800 professionals delivering park, recreation and therapeutic recreation services in local, county, state, school district, private and agency settings. The benefits of Parks and Recreation are endless, serving individuals, our communities, our environment and our economy.

During your time here, please explore all that the city has to offer. From the steady growth of our commercial and industrial sectors, to the plethora of parks, green spaces, and recreation opportunities, you will find that the Magic City possesses a progressive spirit that's focused on putting people first.

Sincerely,

A handwritten signature in black ink that reads "R. L. Woodfin".

Randall L. Woodfin
Mayor, City of Birmingham



January 27, 2019

2019 Alabama Recreation and Parks Association Conference
Birmingham, Alabama

Greetings,



On behalf of the Birmingham City Council, it is my distinct pleasure to welcome each of you as you convene to hold the 2019 Alabama Recreation and Parks Association (ARPA) State Conference. We are excited that Birmingham has been selected to host your delegates and guests during this event.

The ARPA represents more than 800 professionals delivering park, recreation and therapeutic recreation services in local, county, state, school districts, private and agency settings. Parks and public lands serve an essential role in preserving natural resources and wildlife habitat, protecting clean water and clean air, and provide open space for current and future generations.

Parks provide an essential connection for citizens of all ages and abilities to the life-enhancing benefits of nature and the outdoors. This conference provides an excellent opportunity for sharing ideas, effective practices, and getting a pulse on what is happening in the park and recreation industry. It also reminds us that we all have a role to play in ensuring our parks provide a positive impact on health, happiness, quality of life, and encouragement for our youth to become the next generation of committed park stewards.

I extend sincere best wishes for a successful and productive conference.

Warmest regards,

A handwritten signature in black ink that reads "Valerie A. Abbott".

Valerie A. Abbott
President
Birmingham City Council



BIRMINGHAM PARK AND RECREATION

DIRECTOR

SHONAË EDDINS-BENNETT

BOARD MEMBERS

MONTAL MORTON, *President*
CARLY MILLER, *Vice-President*

LARRY D. COCKRELL
RONALD D. MITCHELL
WILLIAM A. PARKER

January 3, 2019

Alabama Recreation and Parks Association
2019 Annual State Conference
Birmingham, Alabama

Dear Friends:

As president of the Birmingham Park and Recreation Board, it gives me great pleasure to welcome the delegates of the 2019 Alabama Recreation and Parks Association (ARPA) Conference to Birmingham, where we believe in "The Magic of Play."

In my short tenure of service as a commissioner on the Birmingham Park and Recreation Board, I have gained an increased awareness of the out-sized role recreation plays in the health and economic stability of a city. The availability of inviting green spaces, walking trails, swimming pools, athletic facilities and programmed activities for all segments of the community who seek our services creates a vitality that permeates the businesses, schools and households that make neighborhoods exciting and unique.

During your stay, I ask that you please take the time to enjoy some of the local flavor of the city. That said, I am certain you will find much to pique your curiosity, quench your thirst, sate your appetite and satisfy your desire to shop. Our system of parks and trails is growing as we speak and offers the opportunity to convene with nature in ways that will leave you motivated and inspired. So take your educational sessions seriously, but set aside a little time to play.

Again, we look forward to acting as host to your gathering of accomplished professionals. And enjoy your stay.

Sincerely,

Montal Morton, President
Birmingham Park and Recreation Board

LEGION FIELD STADIUM

400 GRAYMONT AVENUE WEST • BIRMINGHAM, ALABAMA 35204 • (205) 254-2391 • (205) 254-2515 FAX

2019 ARPA CONFERENCE

GENERAL INFORMATION

REGISTRATION

ACROSS FROM EAST MEETING ROOM | EXHIBIT HALL

BIRMINGHAM-JEFFERSON COVENTION COMPLEX

Saturday | 3-5p

Sunday | 8a-4p

Monday | 7a-2p

Tuesday | 7:30a-3p

MEAL/SOCIAL FUNCTION TICKETS

The full delegate package includes entrance to the Exhibit Hall Reception on Sunday, Topgolf Social on Sunday, Blues, Brews, and BBQ Social at Birmingham Botanical Gardens on Monday and the Post Banquet Social on Tuesday. Additionally, individuals may purchase extra tickets during preregistration. Admittance to these events is by name badge or ticket only. Tickets will not be available for purchase on site for the Awards Banquet due to the meal guarantee requirements.

BADGE IDENTIFICATION

Admission to the Exhibit Hall, education sessions and socials will be name badge only. Delegates, speakers and exhibitors should wear their badges at all times while in conference attendance.

LOST AND FOUND

Questions regarding lost articles should be directed to the Registration Desk. Found articles should be left at the same locations.

EXHIBIT HALL

The conference exhibits will be located at Birmingham-Jefferson Convention Complex. Vendors and participants are a very important part of the conference. All registered delegates are encouraged to visit with them during the the following hours:

SUNDAY: 4:30-7p

MONDAY: 9a-1:30p and 11:30a-12:45p: Exhibit Hall Luncheon

CEU CREDIT

The educational sessions offered at the conference have been planned in accordance with Continuing Education Unit requirements. Delegates are allowed to attend any sessions they so wish. However, in order to obtain credit for multi-hour sessions, delegates must attend all sessions of the program. Credit will not be given if a delegate leaves prior to the conclusion of the session.

ARPA BOARD OF DIRECTORS

PRESIDENT: Summer Ammons

PRESIDENT ELECT: Billy Powell

PAST PRESIDENT: Drew Peterson

SECRETARY: Katrina Frazier

TREASURER: Sandi Wilson

CORPORATE REPRESENTATIVE: Luci Ray

CULTURAL DIVERSITY SECTION PRESIDENT: Willie Moore, III

DISTRICT 1 CHAIR: Gina Bryant

DISTRICT 2 CHAIR: Eric Scott

DISTRICT 3 CHAIR: David Primus, Jr.

DISTRICT 4 CHAIR: Ed Canady

DISTRICT 5 CHAIR: Laura Leigh Chesser

DISTRICT 6 CHAIR: Deirdre Womack

DISTRICT 7 CHAIR: Ella Austin-Mooney



BIRMINGHAM-JEFFERSON CONVENTION COMPLEX

2100 RICHARD ARRINGTON JR. BOULEVARD NORTH
BIRMINGHAM, AL 35203

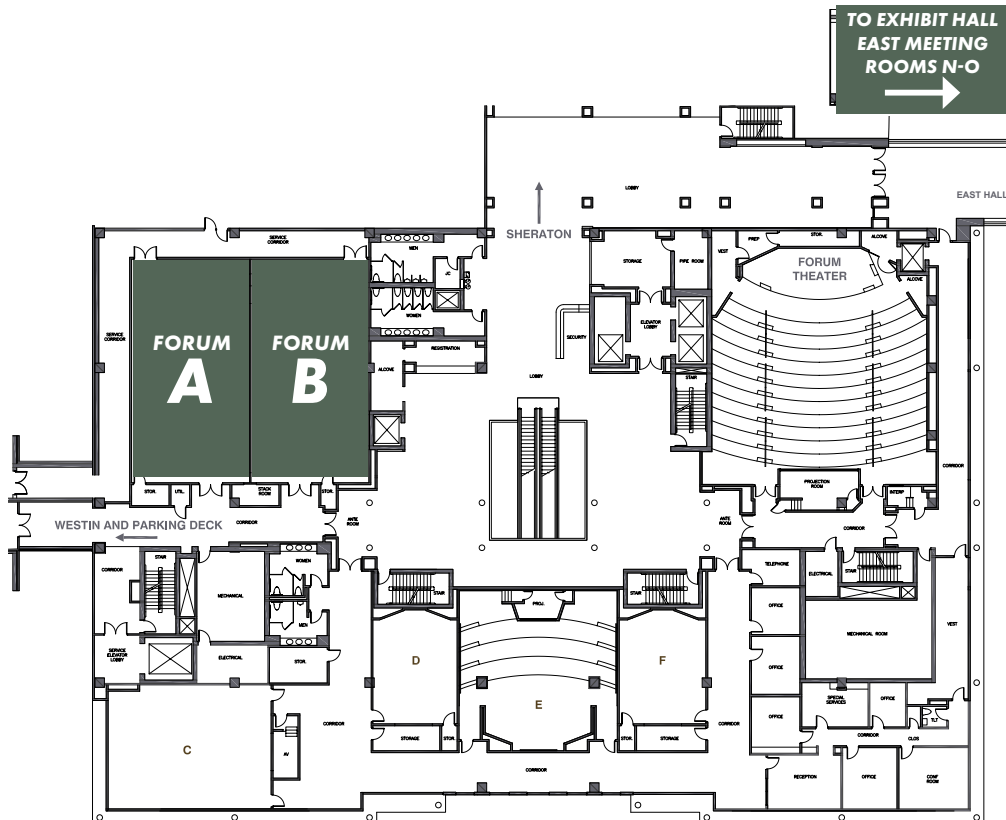

**FORUM BUILDING
2ND FLOOR**

**FORUM BUILDING
3RD FLOOR**

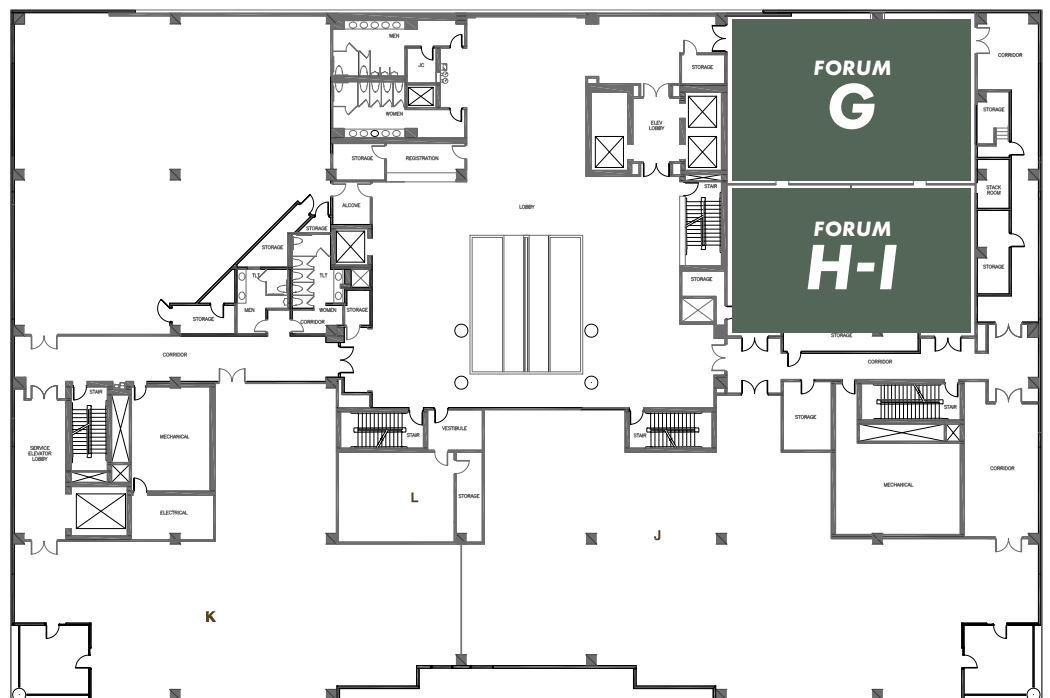

SATURDAY

3-5p

REGISTRATION - EXHIBIT HALL LOBBY

SUNDAY

8a-4p

REGISTRATION - EXHIBIT HALL LOBBY

9:30-10:30a EDUCATION SESSIONS

SESSION 101

COACH SAFELY ACT/HOUSE BILL 9

FORUM A

JAMEY DURHAM, ALABAMA DEPARTMENT OF PUBLIC HEALTH

The Coach Safely Act became the law in Alabama in April of 2018. We will discuss the law as it is written and what it means moving forward.

SESSION 103

TRENDS IN SENIOR PROGRAMMING

FORUM G

CAROLE TAYLOR, JAY LOGAN, BRADLEE COLBURN, TUSCALOOSA COUNTY PARA

This session will cover emerging trends in senior programming. A review of the latest in senior travel, socials, leisure classes and will be discussed.

10:45-11:45a EDUCATION SESSIONS

SESSION 105

SALINE CHLORINATION - IS IT RIGHT FOR YOU?

FORUM A

STEVEN JANORSCHKE, JANCO360

In this session we'll discuss what Saline Chlorination (salt chlorine) is and how it actually sanitizes your pool. We'll point out facts of salt systems vs. traditional chlorine methods, what to look for and what to look out for if you consider utilizing this technology. Is switching to salt right for your facility?

SESSION 102

OTPS CERTIFICATION

FORUM B

DUSTIN FACHISEUR, ALABAMA DEPARTMENT OF AGRICULTURE & INDUSTRIES

This session will cover how to become certified in Ornamental and Turf Pest Control. Additional topics include how to keep quality records and a few Dos and Don'ts.

SESSION 104

INVASIVE SPECIES IN ALABAMA

FORUM H-I

CHRIS MCKEE & MATTHEW BROCK, AL DEPARTMENT OF CONSERVATION AND NATURAL RESOURCES

This program will discuss invasive species that threaten Alabama ecosystems and the latest management trends.

SESSION 106

SPECIAL OLYMPICS AND YOUR PROGRAM

FORUM B

WARREN BOWRON, SPECIAL OLYMPICS

How Special Olympics can help build and/or become the starting point of your Therapeutic program. Becoming a partner with Special Olympics broadens your base of activities with all program participants.

SESSION 107

DIRECTORS ROUNDTABLE

FORUM H-I

ROBIN BROTHERS, DAN SMITH, TOMMIE AGEE, JACKIE BURCH, ARPA

This panel, led by several Park Directors will provide an overview of current issues and trends in parks and recreation from a director's perspective.

12-1p

1-2p

BREAK FOR LUNCH

EDUCATION SESSIONS

SESSION 108

PLAYGROUND PANEL

FORUM A

KOMPAN, LANDSCAPE STRUCTURES, GAMETIME

Hear from three industry leading manufacturers as they showcase their latest and greatest advances in all things play.

SESSION 110

REC SPORTS ROUNDTABLE

FORUM G

KENNY THOMPSON, SUMMER AMMONS, REC SPORTS COMMITTEE

Recreational sports issues and updates will be discussed as well as state tournaments, overview of rules and other areas of interest. Gain knowledge of events offered and how to get involved.

SESSION 109

CRISIS COMMUNICATION

FORUM B

SUZANNE HORSLEY, UNIVERSITY OF ALABAMA

This session will give tips for managing a crisis while working with the media, including how to talk on camera, how to handle negative questions, and how to work with the wide variety of media types that exist today.

SESSION 111

UTILITIES OPTIMIZATION

FORUM H-I

JIM DOYLE, INGENUITY OPTIMIZATION SERVICES

How to optimize utility billing for Parks and Recreation facilities.

2:15-3:15p

EDUCATION SESSIONS

SESSION 112

LEGAL ISSUES IN PARKS & RECREATION

FORUM A

MARC BRAKEFIELD, HUBBARD, MCILWAIN & BRAKEFIELD, P.C

Hear from Attorney Marc Brakefield regarding current legal issues in Parks & Recreation.

SESSION 114

CUSTOMER SERVICE IN A DIGITAL WORLD

FORUM G

SAM MORGAN, THE NINE AGENCY

How do you blend traditional customer service with an ever-changing digital world? We will discuss best practices to address ways to provide a fantastic customer experience on-line and off.

SESSION 113

PLAYGROUND MAINTENANCE: PROVIDING A SAFE ENVIRONMENT FOR ACTIVE, FUN PLAY

FORUM B

DAVID HILL, GAMETIME

For a playground to thrive, good maintenance is essential. Learn how to maximize your playground maintenance efforts by properly identifying and correcting potentially hazardous conditions.

SESSION 115

AMERICAN RED CROSS AQUATIC INFORMATION AND UPDATES

FORUM H-I

LINDSEY ROSS & MATT HAYNES, AMERICAN RED CROSS

This session will offer information and updates regarding American Red Cross aquatic classes and discuss aquatic programming including, but not limited to, Lifeguard Management programs, Learn-to-Swim and Aquatic Examiner Services. We will also discuss the partnership and benefits of the American Red Cross's relationship with Children's of Alabama.

3:30-4:30p

EDUCATION SESSIONS

SESSION 116

SPORTS TRAUMA & OVER USE PREVENTION FORUM A

JAY UMARVADIA, ANDREWS SPORTS MEDICINE

The development of STOP (Sports Trauma and Overuse Prevention) Sports Injuries was initiated by the American Orthopaedic Society for Sports Medicine (AOSSM) in early 2007. Members of the Society's Board of Directors, including STOP Sports Injuries co-campaign chair and renowned orthopaedic surgeon, James R. Andrews, MD, decided that the issue of overuse injuries in young athletes was becoming a critical issue for its members to address.

SESSION 118

HOW SAFE ARE YOUR LIGHTING POLES? FORUM G

WESLEY OLIPHANT, EXO GROUP LLC

This presentation will provide valuable lessons in recognizing the importance of a thorough, risk-based inspection program and the value of utilizing a structural health rating system to evaluate and prioritize critical maintenance dollar spending needed to keep these lighting safe.

SESSION 117

EMERGING SPORTS: DISC GOLF AND PICKLEBALL

FORUM B

**SAM BAILEY, OPELIKA PARKS & RECREATION
TOM MONROE, DISC GOLF ASSOCIATION**

Learn why Disc Golf and Pickleball are about to boom in your area.

SESSION 119

RSA AND YOU: THE PATH TO A SUCCESSFUL RETIREMENT

FORUM B

JACOB COOK, RETIREMENT SYSTEMS OF ALABAMA

Informative overview of Employees' Retirement System benefits including: retirement seminar information, active employee death benefit, Tier I & Tier II employment, state or local employment, retirement benefit formula, benefit options upon retirement eligibility and the RSA-1 deferred compensation program (457b).

Exhibit Hall Reception

Sunday, Jan 27 @ 4:30-7 pm

**Over 50 vendors featuring state-of-the-art equipment and needs for park & rec
See the latest amenities and register for drawings**

**Exclusive location for the Silent Auction and bidding
is open when the Exhibit Hall is open, closes @ 1 pm on Monday**

See Page 17 for Exhibitor listing

ARPA Social @ TOPGOLF

Sunday, Jan 27 @ 8-11 pm

Play for all skill levels

*chef driven menu, big screen TVs & music
three level venue with 65,000 sq ft
microchipped balls instantly score themselves*

Birmingham's hottest new sports entertainment



SUNDAY

MONDAY

7a-2p
8-9a

REGISTRATION - EXHIBIT HALL LOBBY **EDUCATION SESSIONS**

SESSION 201 - FEATURED SPEAKER

MAKING THE ECONOMIC CASE FOR PARKS AND RECREATION | PART 1 of 2

FORUM A

JOHN CROMPTON, TEXAS A&M UNIVERSITY

The economic contribution of parks and recreation to a community will be discussed under the following headings: Attracting tourists, businesses and affluent retirees; enhancing real estate values; reducing taxes; supporting the sporting goods industry; and reducing stress related health costs.

SESSION 203

TRENDS IN OUTDOOR PURSUITS WITHIN CAMPUS RECREATION

FORUM G

PAYTON JOYNER, UAB RECREATION

This session will cover trends in outdoor recreation offerings within the campus community with applications for parks and recreation agencies.

SESSION 202

ROLE OF SPORTS TOURISM FORUM B

DON DUKEMINEER, FOLEY SPORTS TOURISM

Teamwork: How all parties impact destinations through sports tourism. Discussion will revolve around the impact of sports tourism on communities, and how tourism agencies and recreation departments can successfully work together.

SESSION 204

VOLUNTEER MANAGEMENT FORUM H-I

SHERRY SCARBOROUGH, CHILDREN'S OF ALABAMA

Involving volunteers can add great value to what your organization does and support you to achieve your mission and strategic objectives.

9:15-10:15a OPENING GENERAL SESSION

EAST MEETING ROOMS N-O, BJCC

PRESIDING

PRESENTATION OF COLORS

NATIONAL ANTHEM

INVOCATION

OFFICIAL WELCOME

INTRODUCTION OF SPEAKER

KEYNOTE ADDRESS

DOOR PRIZE DRAWING & CLOSING

Summer Ammons, ARPA President

Birmingham Public Schools JROTC

Ms. Keonta Bonner

Reverend Larry Cockrell, Parks and Recreation Board Commissioner

The Honorable Randall L. Woodfin, Mayor of Birmingham

Gary Minor

"The Weather and More Stories," James Spann

Summer Ammons, ARPA President

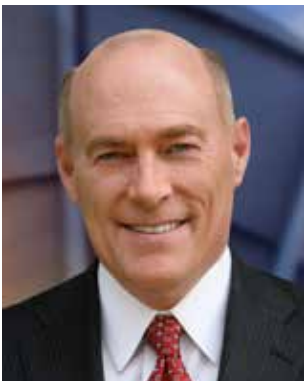

JAMES SPANN, CHIEF METEOROLOGIST, ABC 33/40

Being weather aware is a key component of any successful Park & Rec program. With over 40 years as a news anchor, ABC 33/40's Chief Meteorologist James Spann is a leading weather expert in Alabama with the most up to date weather forecasts. He has been awarded numerous top industry awards on the national and state level and was one of the first in the nation to become certified in broadcast meteorology.

Spann is known for his intricate knowledge of Alabama geography, which he demonstrates in his daily broadcasts. During severe weather events, he is known to urge viewers and listeners to "respect the polygon."

James and his wife Karen have been married for 37 years, and they have two sons. James leads Children's Worship every Sunday at Double Oak Community Church in Mount Laurel. In his spare time, he enjoys tennis and amateur radio.

10:30-11:30a EDUCATION SESSIONS

SESSION 205 - FEATURED SPEAKER

MAKING THE ECONOMIC CASE FOR PARKS AND RECREATION | PART 2 of 2

FORUM A

JOHN CROMPTON, TEXAS A&M UNIVERSITY

The economic contribution of parks and recreation to a community will be discussed under the following headings: Attracting tourists, businesses and affluent retirees; enhancing real estate values; reducing taxes; supporting the sporting goods industry; and reducing stress related health costs.

SESSION 207

LIFELONG LEARNING FOR MATURE ADULTS

FORUM H-I

JENNIFER ANDERSON, UNIVERSITY OF ALABAMA

A basic overview of UA's lifelong learning program will be shared with the attendees. A few do's and don'ts when working with an older audience including true to life stories. How to gain the buy-in of your older clientele. These tips will help to move the dynamics of your adult programming in a positive direction.

SESSION 206

OUTDOOR FITNESS: AN URBAN TREND FOR THE HEALTH AND WELLNESS OF RESIDENTS

FORUM B

SUZANNE QUINN, KOMPAN

The world is changing and physical activity levels have dropped and health care costs are rising. In this session, we will explore structured outdoor fitness, examine barriers and possible solutions. Attendees will walk away with outdoor fitness ideas for many different user groups.

SESSION 208

HOW TO GO GREEN IN PARKS

FORUM H-I

GAVIN ADAMS, ALABAMA DEPARTMENT OF ENVIRONMENTAL MANAGEMENT

Recycling in open spaces, special event recycling, commodity acceptance and the current state of the recycling industry in Alabama and beyond.

11:30a-12:45p LUNCH IN EXHIBIT HALL

1-2p

EDUCATION SESSIONS

SESSION 209 - FEATURED SPEAKER

THE SCIENCE AND THE ART OF PRICING RECREATION AND PARK SERVICES

FORUM A

JOHN CROMPTON, TEXAS A&M UNIVERSITY

The session will provide a framework to guide pricing decisions so prices can be raised without making customers mad. It draws on Dr. Crompton's extensive research and numerous consulting assignments relating to pricing over the past 40 years, and his experience as an elected councilman and mayor pro tem for the city of College Station, Texas. The session will use non-technical terminology to explain the multiple functions of pricing in the public sector; the appropriateness of various kinds of differential prices using both premiums and discounts; and behavioral pricing concepts that adapt prices to fit clienteles' perceptions of what is acceptable.

SESSION 211

LET IT SNOW

FORUM G

DIANE SHORT, GADSDEN PARKS & RECREATION

This session will cover a special event idea that can be used in day camps, senior groups, city wide, etc.

SESSION 210

INTENTIONAL COMMUNITY ENGAGEMENT

FORUM B

MORGAN RODGERS, ALPHARETTA PARKS AND RECREATION

Departments are being asked to be innovative; develop new, cutting edge programs and services; be more green and more efficient in our delivery. But, along with these requests, come budget and staff reductions. Intentional engagement of the community can help bridge the growing gap between expectations and resources.

SESSION 212

HOW TO INVOLVE ATHLETES WITH PHYSICAL DISABILITIES IN YOUR PROGRAMMING

FORUM G

MARGARET STRAN, UNIVERSITY OF ALABAMA

This session will provide an overview of adapted athletics programs and discuss the importance of and planning for including athletes with physical disabilities.

2-7p

FREE TIME | EXPLORE BIRMINGHAM

BIRMINGHAM

Visit www.birminghamal.org to make the most of your free time and see what all Birmingham has to offer!



**BIRMINGHAM
BOTANICAL GARDENS**

**Blues, Brews & BBQ
Birmingham Botanical Gardens
Monday, Jan 28 @ 7-11 pm**

Dance to the music of
The Sassy Brown Band and DJ Slim Robb
Enjoy BBQ with all the trimmings
Assorted beverages, fun and games

Transportation is provided. Meet at front lobby of Sheraton.

TUESDAY

7:30a-3p

REGISTRATION - EXHIBIT HALL LOBBY

8:30-9:15a

BUSINESS MEETING

ARPA will host a business meeting to provide the State of the State Address and Treasurer's Report to the membership. LEAD Certificates will be presented as well.

9:30-10:30a EDUCATION SESSIONS

SESSION 301 - FEATURED SPEAKER

MARKETING STRATEGY: FROM PRACTICAL TO PRACTICALLY INSANE | PART 1 of 2

FORUM A

**RYAN HEGRENESS & RICH NEUMANN
WESTMINSTER, COLORADO**

Pack programs, increase revenues, expand engagement and sell out events. Take your marketing efforts to new heights with practical marketing advice and practically insane case studies. This interactive workshop pairs proven strategies from the fields of business, psychology and behavioral economics with outrageous case studies from highly successful park and recreation campaigns.

SESSION 303

LACROSSE 101

FORUM G

SUSIE MARGOTTA & CHRIS DICKINSON, GREATER BIRMINGHAM YOUTH LACROSSE ASSOCIATION

How to start a lacrosse program (team) through school involvement.

SESSION 302

DOING MORE WITH LESS FORUM B

MICHAEL GLAZE, PBJC TRAINING AND ORGANIZATIONAL DEVELOPMENT

In Parks and Recreation, we will never have the biggest budgets or the massive staff that many private sector companies have. Despite this, we are still tasked with delivering exceptional services with less than exceptional resources. In this session, learn how to gain time and efficiency by streamlining existing processes and eliminating the waste.

SESSION 304

FLEET MAINTENANCE: KEYS TO KEEPING YOUR ORGANIZATION RUNNING

FORUM H-I

BRIAN JOHNSON, ALABAMA POWER COMPANY

If the vehicles and equipment needed to get the job done are down, the organization can come to a standstill. Here are six keys to fleet maintenance that will help keep your organization running.

10:45-11:45a EDUCATION SESSIONS

SESSION 305 - FEATURED SPEAKER

MARKETING STRATEGY: FROM PRACTICAL TO PRACTICALLY INSANE | PART 2 of 2

FORUM A

**RYAN HEGRENESS & RICH NEUMANN
WESTMINSTER, COLORADO**

See session description for Session 301 above. Attending both parts of this session is recommended, but not required. Part 2 features practically insane case studies that utilize the practical strategies presented in Part 1.

SESSION 307

ART IN THE PARKS

FORUM G

CRAIG WEDDERSPOON, UNIVERSITY OF ALABAMA

Public art is a distinguishing part of our public history and our evolving culture. It reflects and reveals our society, adds meaning to our cities and uniqueness to our communities. Learn tips of attracting the right stakeholders and key points in writing a RFP to add to the uniqueness of your community.

SESSION 306

WHERE YOUR SMART PHONE CAN TAKE YOU IN SOCIAL MEDIA

FORUM B

GEORGE EDMONDSON, SEED CREATIVE

Have smart phone and will travel with social media. How to use your phone for video and other tips.

SESSION 308

SILVERSNEAKERS: A PROGRAM FOR SENIORS THAT'S WORTH IT

FORUM H-I

BRENDA SENN, TIVITY HEALTH

SilverSneakers is a nationwide program that encourages and facilitates seniors to maintain better control of their health through physical activity. Learn how this program for active mature adults can benefit your programming and your bottom line.

11:45a-1:45p DISTRICT LUNCH MEETINGS

2-3p

EDUCATION SESSIONS

SESSION 309 - FEATURED SPEAKER

RELIEVE YOURSELF FROM CREATIVE CONSTIPATION | PART 1 of 2

FORUM A

**RYAN HEGRENESS & RICH NEUMANN
WESTMINSTER, COLORADO**

Two hour session. Whenever you hear about an innovative program or creative event, do you ever ask yourself, "Why didn't I think of that?" Arm yourself with the practical tools and techniques necessary to be a creative leader—not just a follower.

SESSION 311

MAKING ETHICAL DECISIONS

FORUM G

KIMBERLY ROBINSON, PBJC TRAINING AND ORGANIZATIONAL DEVELOPMENT

In civil service where profits are not the primary focus, ethical behavior is our accountability to the public. This class will explore how ethics plays a role in our work lives and how to make sound decisions whenever an ethically tricky situation is upon us.

SESSION 310

TRAILS FOR ACTIVE LIVING AND ECONOMIC DEVELOPMENT IN YOUR COMMUNITY

FORUM B

BRIAN RUSHING, UNIVERSITY OF ALABAMA

Learn about the national trends in trail development, how trails are enhancing quality of life and economic competitiveness in communities large and small, and how to approach planning and developing a trail network in your park or community. Also, discover a new program to help you understand the economic impact of your trails, as well as tools you can use to attract more users.

SESSION 312

RECREATIONAL TRAILS AND CONSERVATION FUND PROGRAM OVERVIEW

FORUM H-I

CRYSTAL DAVIS, ADECA

Secure funding for your agency! This session by ADECA will cover an overview and the application process for the Recreational Trails Program and Land and Water Conservation Fund Program.

3:15-4:15p

EDUCATION SESSIONS

SESSION 313

RELIEVE YOURSELF FROM CREATIVE CONSTIPATION | PART 2 of 2

FORUM A

**RYAN HEGRENESS & RICH NEUMANN
WESTMINSTER, COLORADO**

See session description for Session 309 above. This is the second part of a two hour session. Participants should plan to attend both parts.

SESSION 314

THREE PILLARS OF SUCCESSFUL ATHLETIC DEVELOPMENT

FORUM B

KENDELL JNO-FINN, M3 PERFORMANCE AND PHYSICAL THERAPY

Are we really doing what is best to accomplish the goals of both parents and children when it comes to sports? This presentation focuses on clarifying aspects in research and application of training, programming and athlete development. Professionals will leave with information vital to educating parents and colleagues on the why, when and how of athletic development.

5-5:45p

PAST PRESIDENTS' RECEPTION

2019 Awards Banquet
Tuesday, Jan 29
Reception 5:45-6:20p
Dinner and Awards 6:30-8:30p
Sheraton Hotel, Birmingham 4



Eddie Mae Johnson



Duke Smith

ARPA Post Banquet Social

sponsored by the

Cultural Diversity Section

Tuesday, Jan 29 at 8:30-11:30p

Sheraton Hotel, Birmingham 1

Let's dance the night away at The Cultural Diversity Section Social, honoring and celebrating the great works of the late Mrs. Eddie Mae Johnson, Birmingham Park & Recreation Department, and the late Mr. Duke Smith, Andalusia Parks & Recreation Department. These two individuals were founding members of the Ethnic Minority Society, now known as the Cultural Diversity Section.

Please join us as we pay homage to them and their families.

EXHIBIT HALL INFORMATION

THE EXHIBIT HALL WILL BE OPEN DURING THE FOLLOWING TIMES:

SUNDAY, JAN. 27 | 4:30-7P

MONDAY, JAN. 28 | 9-1P

DOOR PRIZES - FOOD AND BEVERAGES
SILENT AUCTION OPEN DURING EXHIBIT HALL HOURS

EXHIBIT HALL LAYOUT

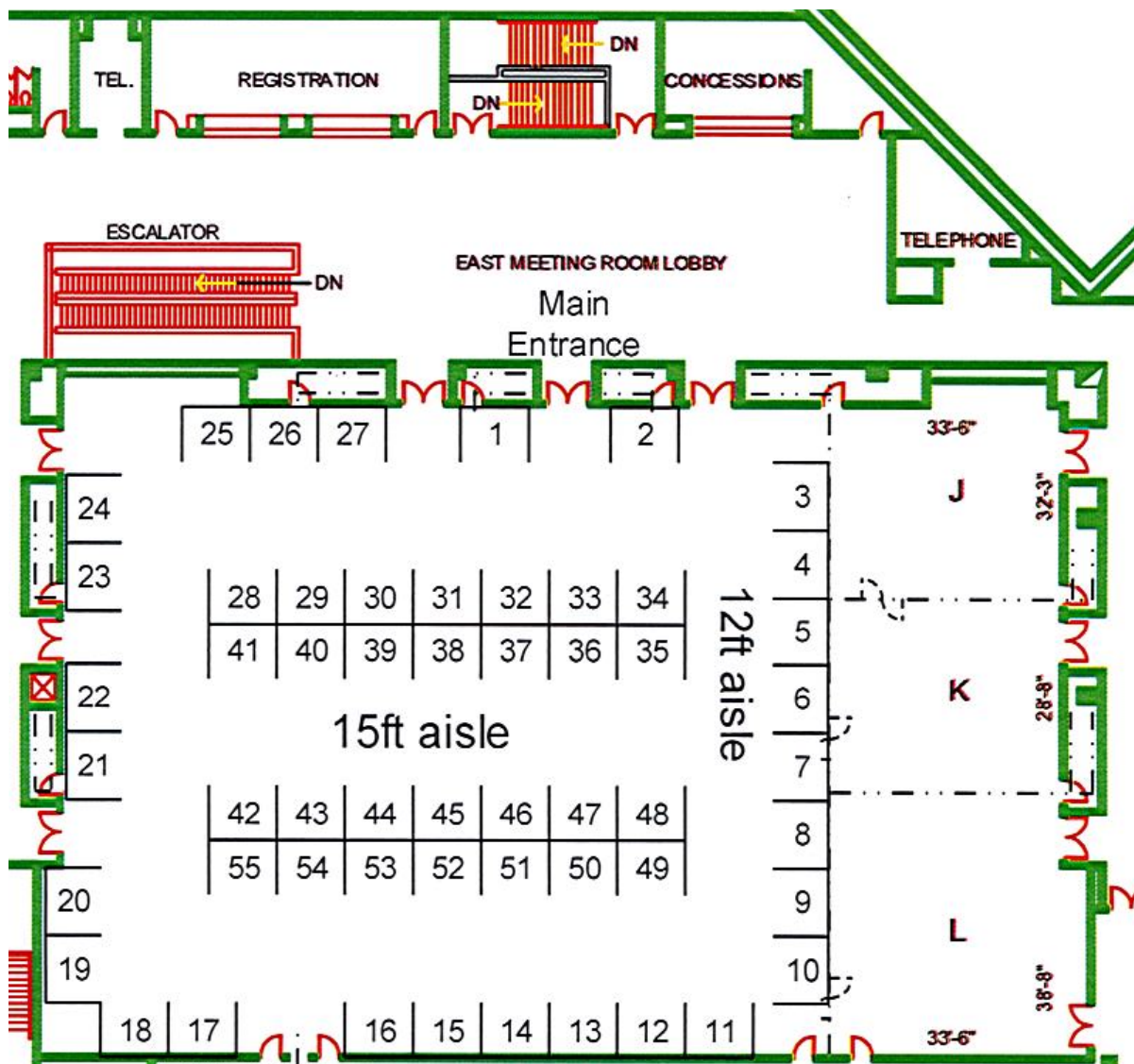

EXHIBITOR LISTING

1 JANCO360

Steven Janorschke
PO Box 660821
Birmingham, AL 35216
205.908.7415 | steven@janco360.com

Commercial Swimming Pool Chemicals and Equipment from a trusted company voted Alabama's BEST Pool Equipment Provider

3 DUFFIELD AQUATICS, INC.

Alison Youngblood
113 Metro Drive
Anderson, SC
864.226.5500 | ayoungblood@duffieldaquatics.com

Commercial swimming pool equipment & service

5 VERMONT SYSTEMS, INC.

John Willey
12 Market Place, Essex Junction, VT 05452
802-879-6993 | kathrynm@vermontsystems.com

Provides Premiere Recreation & Park Management software solutions with unparalleled support. RecTrac is a fully integrated, browser based, recreation management system.

7 DESCHAMPS MAT SYSTEMS INC.

Greg Scull
218 Little Falls Rd, Unit 12
Cedar Grove NJ 07009
973-928-3040 | assistant@mobi-mat-dms.com

ADA accessible beach mats and floating beach wheel chairs

9 AMERICAN CARNIVAL MART

Jennifer Ferguson
1317 Lindbergh Plaza Center Street
St. Louis, MO 63132
314.991.6818 | jennifer@funcarnival.com

Novelties for year round events; plastic eggs filled or unfilled for Easter egg hunt; prizes for egg hunts; trunk or treat supplies; Christmas stockings

2 MCKEE & ASSOCIATES ARCHITECTURE & INTERIOR DESIGN

631 South Hull Street
Montgomery, AL 36104
334.834.9933 | finley@mckeeassoc.com

Architecture and Interior Design

4 CXT

Jeff Chambers
3808 N Sullivan Rd, Bld. 7
Spokane, WA 99216
678.206.6426 | jchambers@lbfoster.com

Precast concrete restrooms and other park facilities

6 BARGE DESIGN SOLUTIONS, INC.

Chris Grace
3535 Grandview Parkway, Suite 500
Birmingham, AL 35243
chris.grace@bargedesign.com

Architectural/Engineering Services

8 AMERICAN TENNIS COURTS, INC.

Penny LeBlanc-Kasmia
1272 Bolton's Branch Drive
Mobile, AL 36606
251.476.4714 | penny@americantenniscourts.net

Tennis court construction

10 DISC GOLF ASSOCIATION

Tom Monroe
3520 Lynngate Circle
Hoover, AL 35216
205.979.2978 | pdgatom33@gmail.com

Disc golf targets and course design

11 TWIN STATES RECREATION, LLC

Max Maxwell
P.O. Box 732
Magnolia Springs, AL 36555
205.453.4321 | max@twinstatesrec.com

Parks and Playground equipment

13 PUNT, PASS AND KICK USA, INC.

Frank Wittenberg, CPRP
103 Wisteria Drive
Lafayette, AL 70506
337.501.8159 | office@ppkusa.com

Free youth football skills competition that promotes physical activity and the sport of football

15 AUBURN-OPELIKA TOURISM BUREAU

Anthony Terling
714 E. Glenn Avenue
Auburn, AL 36830

Showcasing the Auburn-Opelika areas for hosting future sporting events for youth, adults, seniors. Also, providing updates on sporting facilities we want to potentially build for hosting future events.

17 AMERICAN RAMP

Cody Degraffenreid
610 McKinley Avenue
Joplin, MO 64801
417.206.6816 | cody@americanrampcompany.com

Design and build skate parks, bike parks, pump tracks and bicycle playgrounds

19 TURFACE ATHLETICS

Glenn Lucas, Rodney Jones
750 W Lake Cook Rd, Suite 440
Buffalo Grove, IL 60089
847.353.2163 | glucas@profileproducts.com

12 USA SOFTBALL OF ALABAMA

Tracy Morgan
PO Box 231508
Montgomery, AL 36123
256.490.8924 | tracymorgan1112@gmail.com

A non-profit organization whose mission is to provide promotion, administration and enhancement of the sport of softball in Alabama, while offering opportunities for all ages and all levels to participate.

14 HUGHINS SOD

Lynn Anderson

16 BLISS PRODUCTS AND SERVICES, INC.

Greg Bliss
6831 S. Sweetwater Rd
Lithia Springs, GA 30122
800.248.2547 | info@blissproducts.com

Playground equipment & site furnishings.

18 KOMPAN, INC.

Katherine Ring, Luci Ray
605 Austin, TX 787523
737.402.7048 | katrin@kompan.com

Kompan is a world leader in playground and outdoor sport and fitness solutions. All of our solutions are backed by extensive research, user tested, and manufactured with the highest quality materials. Our universal solutions motivate play and movement for users of all ages and abilities.

20 ETRAK RECREATION SOFTWARE

616 Dr. Calvin Jones Hwy, Suite 100
919.453.1307 | chrisi@etrak.com

Recreation software

21 USA FOOTBALL

www.usafootball.com

Evolving and growing the sport of football, USA Football is setting the standards and best practices to advance coach and player development. USA Football promotes and drives smarter football nationwide

23 DIXIE BASEBALL/SOFTBALL

Warren Bowron

303 Cedar Drive

Enterprise, AL 36330

334.477.6047 | bowronw@yahoo.com

Baseball and softball promotions

25 GIFFEN RECREATION CO INC.

Jim Giffen

115D Hilltop Business Dr

Pelham, AL 35124

205.982.6233 | giffenrec@att.net

Commercial playground equipment & architectural site furnishings.

27 SHOCO MARINE

Brack Ward

PO Box 1825

Shelby, NC 28151

704.466.7111 | brack@shocomarine.com

Floating dock, PWC ports, kayak and canoe launch units

29 KELLIS TURFGRASS MANAGEMENT

Tim Lacy

PO Box 1375

Columbiana, AL 35051

205.215.4171 | tlacy@kellisvegetation.com

Turfgrass management services

22 RECREATIONAL CONCEPTS

Melanie Stewart

1151 S. Willow Ave., Suite D

Cookville, TN 38506

205.202.8677 | melanie@rec-concepts.com

Playgrounds, splashpads, pavilions, site amenities, synthetic grass

24 LOSE DESIGN

Whit Alexander

220 W. Crogan St., Suite 100

Lawrenceville, GA 30046

770.338.0017 | walexander@losedesign

Landscape architecture, engineering, architecture land planning

26 SAFEGUARD FORM & SYSTEMS

Cindy C. Conner

PO Box 9363, Columbus, GA 31908

706.391.4045 | cindy@safeguardservice.com

Print, apparel and promotional product

28 LOWER BROS CO, INC.

Linn Lower

PO Box 43026, Birmingham, AL 35243

205.967.3901 | linn@lowerbros.com

Construction of tennis courts, pickleball courts, basketball courts & running tracks

30 MUSCO SPORTS LIGHTING

Nick Mauer/Jimmy Jumper

100 1st Ave West

Oskaloosa IA 52577

641.673.0411 | nick.mauer@musco.com

Musco has shaped the history of sports lighting since 1976. The company's TLC for LED technology delivers unmatched light quality, control, efficiency and reliability.

31 KORKAT

Courtney Johns/Brittany Williams
221 Cable Industrial Way, Carrollton, GA 30117
770.214.9322 | courtneyj@korkat.com

Playground, dog park, shade structures, shelters and site amenities

33-34 J.A. DAWSON & CO.

Kight Jones
PO Box 1178 Pelham, AL 35124
205.663.5058 | kjones@jadawsonco.com

J.A. Dawson has been serving Alabama for over 40 years with design and construction of Gametime playgrounds, splash pads, shade and shelters, outdoor fitness and site furnishings.

36 BSN SPORTS

Nathan Devon
14460 Varsity Brands Way
Farmers Branch, TX 75244
972-406-3413 | ndevon@bsnsports.com

Sports equipment and apparel

38 RECDESK

Todd McEvoy
300 Plaza
Middleton, CT 06457
972.743.8633 | todd.mcevoy@recdesk.com

RecDesk is a cloud based recreation software that radically simplifies the way recreation organizations work with and manage the information that is important to them. The leader in easy to use recreation management software.

40 CHALLENGER SPORTS

Dan Growcolt
2700 Cumberland Pkwy SE, # 175
Atlanta, GA 30339
678.540.1587 | dgrowcolt@challengersports.com

Soccer camps, uniforms, tours & trainers

32 QUALITY TURF RENOVATION LLC

Steve Klopping
22339 W. Dale Lane Wittmann, AZ 85361
623.262.7775 | steve@qualityturfrenovation.com

Turf equipment

35 HUMPHRIES TURF SUPPLY

Amy Bailey
PO Box 39, Joppa, AL 35087
256.585.8760 | humphriesturf@otelco.net

Pro's Choice soil amendments, Sun Charge Systems charging stations, maintenance tools, Anderson's Fertilizer, chemicals, Red-Max, Echo, Shindaiwa equipment, athletic paint, New Stripe chalkers, chalk, safety

37 SUR-LINE TURF, INC.

Tommy Pasley
19637 Gorgas Road
Northport AL 35475
205.333.1776 | surline1@gmail.com

Athletic field construction/renovation
Golf Course construction/renovation

39 RIDDELL

www.riddell.com

Riddell is a leading manufacturer of football helmets, football pads, football helmet reconditioning, and related football sports equipment.

41 GOODWYN, MILLS & CAWOOD, INC.

John Bricken
2660 EastChase Lane Suite 200
Montgomery, AL 36117
334.315.1600 | john.bricken@gmcnetwork.com

Landscape Architecture, Architecture, and Professional Engineering and Planning Services for Parks and Recreation Facilities

42 PYRO SHOWS OF ALABAMA INC.

Danny Turner

PO Box 307

Adamsville, AL 35005

205.798.6620 | danny@pyroshows.com

Pyro Shows has been providing fireworks displays & special effects entertainment throughout the world for almost half a century, from neighborhood little league parks to Taiwan and everywhere in between. Provided 4th of July fireworks at the Washington Monument in Washington D.C. 13 times since 1995. No matter the size, Pyro executes each display with equal gusto, fun and professionalism.

45 HUNTSVILLE CVB

Mark McCarter

500 Church Street NW, Ste One

Huntsville, AL 35801

256.551.2334 | mccarter@huntsvilleal.org

The Huntsville/Madison County Convention & Visitors Bureau (CVB) is the official city/county agency which promotes Huntsville/Madison County as a tourist destination and convention site. The CVB works with an array of hospitality industry partners to market our destination to visitors of all types.

47 COACH SAFELY FOUNDATION

Kristin Miller, Drew Ferguson

2524 Arlington Ave

Birmingham, AL 35205

info@coachsafely.org | dferfusion@coachsafely.org

The Coach Safely Foundation is the provider of the Coach Safely course which educates coaches to help prevent youth sports injuries. The course was developed at the Andrews Research and Education Foundation and is compliant with AL Bill HB9 - The Coach Safely Act

49 SPORTS TURF COMPANY, INC.

Megan Roberts

1487 Black Dirt Road

Whitesburg, GA 30185

404.922.8574 | megan@sportsturf.net

Design, construction & renovation of athletic facilities, laser grading and surface installation for your athletic field, track or court

54 COWART MULCH PRODUCTS INC.

Mark Orlandella

185 Peachtree Industrial Blvd

Sugar Hill, GA 30518

770.932.6161 | mark@cowartinc.com

Mulch, pine nuggets, soils, rocks

43 SAF/TURFACE ATHLETICS

Brooklyn Dambach

750 W Lake Cook Road, Suite 440

Buffalo Grove, IL 60089

847.353.2156 | bdambach@profileproducts.com

For more than 50 years groundskeepers, coaches, and volunteers have relied on Turface Athletics and Turface products for field maintenance solutions that result in safer, playable fields. We offer the highest quality infield and turf conditioners, mound and plate packing clays, hands-on education and ongoing industry support, all backed by the best distributors in the business.

46 JEFCOAT RECREATION & CONSTRUCTION

Doyle Jefcoat

PO Box 6197

Pearl, MS 39288-6197

601.624.8351 | doyle@jefcoatrecreation.com

Playground & Recreation Equipment/Pavilions & Shelters/
Site Amenities/Splash Pads/Safety Surfacing/Fencing

48 GREAT SOUTHERN RECREATION

Abby Vance

2441-Q Old Fort Parkway #462

Murfreesboro, TN 37128

Ph: 800-390-8438 | abby@greatsouthernrec.com

We design, sell and build commercial playgrounds, splash pads, site amenities, pavilions, and sunshades.

53 HOWLETT EQUIPMENT

Jim Howlett

PO Box 58

Powell, TN 37849

865.938.3827 | howlettequip@frontiernet.net

Site furnishings

55 OUTDOOR ALUMINUM INC.

Eddie Spears

P.O. Box 118, Geneva, AL 36340

Ph: 334-684-2296 espears@outdooraluminum.com

Grandstands, bleachers, benches, picnic tables, press boxes and related outdoor seating

J.A. Dawson & Company

Your Total Recreation Resource

Celebrating 40 Years

of leading the recreation industry!

205.663.5058 www.jadawsonco.com



JANCO360 Inc.

COMPLETE AQUATIC SOLUTIONS

Save the Date!
2020 ARPA Annual Conference
Alabama Recreation & Parks Association



Renaissance Mobile Riverview Plaza Hotel
January 26-28, 2020
Mobile Convention Center