

June 16, 2010

Mr. Nelson Turcotte – Authorized Agent for Mr. Glen Goodman/John Turcotte – Mining
Clients #138136 and #203632 respectively
36 Kimberly Drive
Kapuskasing, Ontario, CANADA
P5N 1L5
Cell Phone – 1-705-367-6448
Home Phone – 1-705-335-4098
Facsimile – 1-705-337-0242

Provincial Recording Office
Geoscience Assessment Office
Ministry of Northern Development and Mines
933 Ramsey Lake Road
3rd Floor
Sudbury, Ontario, CANADA
P3E 6B5
Phone – 1-888-415-9845
Fax – 1-877-670-1555

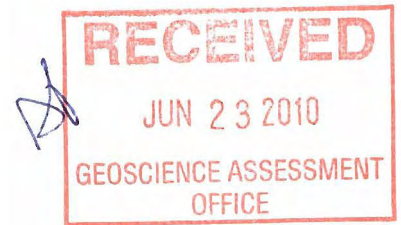

Attention: Provincial recorder or Stephanie – Administration

***Re: Filing 2009/2010 Assessment Work Performed on Mining Lands on Behalf of
Mr. Glen Goodman – Mining Client #138136, 309 Walker Street, P.O. Box 38,
Beardmore, Ontario, CANADA, P0T 1G0 and Mr. John Turcotte – Mining Client
#203632, Terrace Bay, Ontario***

To Whom It May Concern:

As the authorized agent for Mr. Glen Goodman and Mr. John Turcotte, I respectfully submit the Assessment Work Performed on Mining Lands for the Claim Group No: TB 4204002, which consists of 10 mining claim units located in the Township of Sandra, near the Town of Beardmore, Municipality of Greenstone, Ontario.

You will have on file, from June 13, 2007 a signed letter by Mr. Glen Goodman – owner of the Claim Group authorizing myself (future claim holder on this claim – transfer to be forwarded in near future) as authorized agent on any and all matters relating to and pertaining to the aforementioned Claim Group No. and its units. This letter was written and signed in 2007 but is still in affect. Hence, I am filing this assessment report.

During the August, 2009 period, the Claim Holders completed various work activities as assessment work required. The work included manual work, Mechanical Work, Overburden stripping (Bobcat 341D excavator and Bobcat T300 compact crawler loader), trenching (excavator) and prospecting (Mr. Goodman and Mr. John Turcotte).

We attach the required assessment report and you will see that our costs are greater than the required \$4,000 for the 10 claim units and, in fact, totals \$8,054.00.

It appears, that the Claim Holders have \$44 from 2008 assessment work and the filing of the 2008 assessment report with which we wish to combine with this work as well. I have not, though, reflected that \$44 credit within Section 6(B) of form 0241E in the Bank figure calculation of \$4,054.

I understand that this report is due at 4:30pm today – June 16, 2010 and I am faxing it prior to that time today to the office fax number provided by an administrative person in your office (Stephanie).

I will place, in regular Canada Post mail, tomorrow, the original report.

Should you have any questions on this submission, please do not hesitate to direct them to myself at 705-367-6448 or at home at 705-335-4098 or on my facsimile at 705-337-0242.

The report is being filed in the following format:

1. Form – Assessment Work Performed on Mining Lands – filled in and signed.
2. Attachment #1 – Printout from Excel Spreadsheet detailing the estimate and breaking it down finer than the Assessment Form allows
3. Attachment #2 – Overall site map showing claim group sitting in Withdrawal Order Lands – PLEASE NOTE – OUR CLAIMS WERE REGISTERED WELL BEFORE THE WITHDRAWAL ORDER CAME INTO AFFECT
4. Attachment #3 – Details from MNDM website – showing claim history and information
5. Attachment #4 – Detailed Map drawn showing stripping details or overall claim group (1:19,420 scale)
6. Attachment #5 – Detailed Map showing prospecting areas, stripping and general location of work area in 2009/2010 (1:5000 scale).
7. Attachment #6 – Workings Map showing sample locations and further details of area stripped and worked/prospected in 2009/2010 (1:500 scale).
8. Attachment #7 – Assay Results for 11 samples taken from claim group

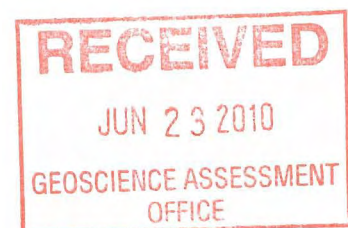

WORK COMPLETED

In August of 2009, Mr. Goodman completed prospecting work and further investigation on a vein/float indication found in the area. That is included on the Assessment Work Performed on Mining Lands – appropriate table within that form. Mr. Goodman took samples from this area in 2009 and then again in 2009 (month of May – see details on work report). A total of 11 samples were taken and shipped to a lab in Thunder Bay, Ontario.

On August 7th – see Assessment Form filled out, Mr. Goodman completed some prospecting work to layout area to be stripped using Bobcat equipment. Mr. Turcotte helped Mr. Goodman layout the area for stripping.

On August 8th and 9th, Mr. Goodman and Mr. John Turcotte, with some equipment operators (please see report) completed the following work on the claims:

- Walked claim group on North-South line at most easterly end of Claim Group...spending a good deal of time in the Northeast quarter.
- Samples taken, throughout the work zone which is of an “L” shape (see Attachment #6). This work zone is inundated with rock outcroppings and faults along with an interesting float indicator – which Mr. Goodman tried to trace. Several outcroppings showed some forms of “blue” or “smoky” quartz and where this was found, samples were taken. Samples were first loosened, at times, with the use of the excavator. But the finer samples were taken with a hammer and an axe.
- Float 2 Bobcat machines – rented from The Tower Kleber LP (Excavator and Track Loader) to the claim group site in order to expose rock. This particular area was on the East side of the river – to the east of the “72” road just south of the bridge.
- Stripping, in a large “L” shaped area was carried out (see Attachments #5 and #6). A general trenching area was uncovered by removing trees, vegetation and pushing up organics soil. Two samples were taken from that zone after washing the exposed bedrock off. A well pronounced stripped area was made within the moderately stripped overall area and this pronounced strip (10m wide x 32m long) is shown in Attachment #6. 2 samples were taken from this area.

The stripped areas were washed down thoroughly using small gas-driven Honda water pump. Other samples were taken throughout the overall “L” shaped work location.

In May of 2010, Mr. Goodman completed some prospecting effort in the Southeast corner of the Claim Group – near the public boat launch to the

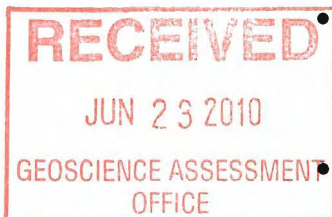

Namewaminikan River. That boat launch is accessed from the "72" year round road access.

- The 11 samples were retained and driven to Thunder Bay on June 4, 2010 for assay work by Accurassay. The results of these sample assays is included in Attachment #7.
- Please note – that most of the overburden is moss with brown sand including small rocks mixed in with blue clay.

Should you have any questions regarding this assessment work report, please do not hesitate to contact the writer.

Thank-you for your cooperation.

Yours truly,

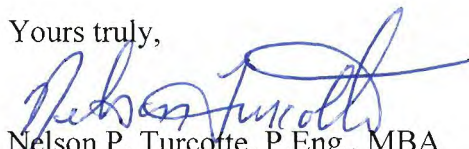

Nelson P. Turcotte, P.Eng., MBA
Authorized Representative of Mr. Glen A. Goodman

cc. Glen A. Goodman - Beardmore, Ontario and Mr. John Turcotte – Terrace Bay, Ontario

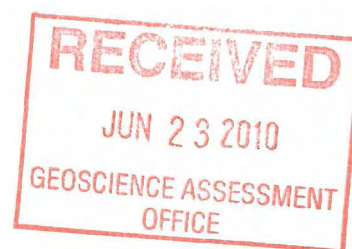

2.45182 Attachment #1 - Details on Estimate included in form 0241E

ATTACHMENT #1

CLAIM NO. TB 4204002 - 2010 ASSESSMENT WORK REPORT

DETAILS OF COSTS FOR WORK PERFORMED IN 2009/2010 ON CLAIM GROUP

15 June 10

PLEASE NOTE - PLEASE SEE ASSESSMENT REPORT FOR SUMMARIZATION

	Hourly Rate	Hours	Material	Summit	TOTAL	NOTES
	(\$/hr.)					
COSTS OF WORK PERFORMED						
Labor - Glen Goodman - August 8th and 9th, 2009	35	16			560	Drainage, site work, prep work
Labor - John Turcotte - August 7th, 2009	35	4			140	Prospecting, site work, prep work
Labor - Glen Goodman - August 8th and 9th, 2009	35	26			910	Site work, trenching, shoring, clearing, grubbing, rock crushing
Labor - John Turcotte - August 8th and 9th, 2009	35	10			350	Site work, shoring, washing
Labor - Glen Turcotte - August 8th and 9th	35	10			350	Site work, shoring, washing, operate trucks
Labor - Aaron Baillie - August 8th and 9th	25	10			250	Site work, shoring, washing, operate trucks
Labor - Nelson Turcotte - August 8th	35	6			210	Site work
Labor - Glen Goodman - prospecting - May 5/6, 2010	35	18			540	Prospecting - Northeast corner - checking outcroppings and looking for origin of fault
Labor - Glen Goodman - prospecting - May 10/11, 2010	35	12			420	Prospecting - Southeast corner
Labor - Glen Goodman - prospecting - May 18, 2010	35	6			210	Prospecting - Northeast corner
Labor - Glen Goodman - prepare rough estimate for report	35	4			140	
Nelson Turcotte - write report	35	6			210	
			Subtotal	\$	4,230	

ASSOCIATED COSTS

Rental 34 ID Excavator	80	18			1440	Rented from TMLP - no operator - we operated equipment
Bobcat T300 Machine - power backhoe loader machine	100	18			1800	Rent from High Falls C.S. construction - max 2 days
Flat tire from Beardmore to Site for 3 Bobcats - return empty					400	3 ID machine & 2 machines in and out (2 hrs)
Cost of Essay Work - 11 samples - 4000/1000 - Thunder Bay					225	estimated - sending invoice as at June 15, 2010
Power saw for 3 days					75	\$25/day cost
Water/Gas for saw, water pump, 4 hrs etc					10	15 gallons of gas
Hand - 2' trash pump rental - 2 days					100	Rented from Waverne Hydro Inc. at \$50/day
Fuel for Machine - 34 ID - 15 gallons - charges from WHI					90	15 gallons - backhoe from Waverne Hydro Inc.
Fuel for Machine - T300 - 15 gallons - charges from WHI					90	15 gallons - backhoe from Waverne Hydro Inc.
			Subtotal	\$	2,990	

TRANSPORTATION COSTS

Gas - John Turcotte - Terrace Bay to Beardmore - return August 7th and August 8th					140	400 kms - Terrace Bay to Beardmore (round trip) 1500
Gas - Nelson Turcotte - Kapuskasing to Beardmore - return August 7th and August 8th					192	520 kms - Kapuskasing to Beardmore (round trip) 1500
Gas - Aaron Baillie - Thunder Bay to Beardmore - 1000					140	400 kms @ \$35/km
Gas - Glen Goodman - Beardmore - Thunder Bay (nearly) - June 4, 2010					140	400 kms @ \$35/km
Gas for Glen's truck - 4 days in summer 2009 and 5 days in spring 2010					117	328 kms @ \$35/km
			Subtotal	\$	719	

FOOD AND LODGING COSTS

Food for John Turcotte - away from home August 7th - Beardmore					125	includes lunches for John Turcotte, Glen Goodman, Nelson Turcotte, Aaron Baillie and Glen Turcotte
			Subtotal	\$	125	

GRAND TOTAL \$ 6,054

OF ASSESSMENT WORK

CLAIM TB 4204002

NOTE: PLEASE SEE ASSESSMENT WORK REPORT FORM FOR DATES

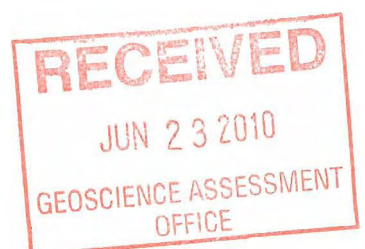

Attachment #2 - Claim No. TB 4204002
2009/10 Assessment Work

June 15, 2010

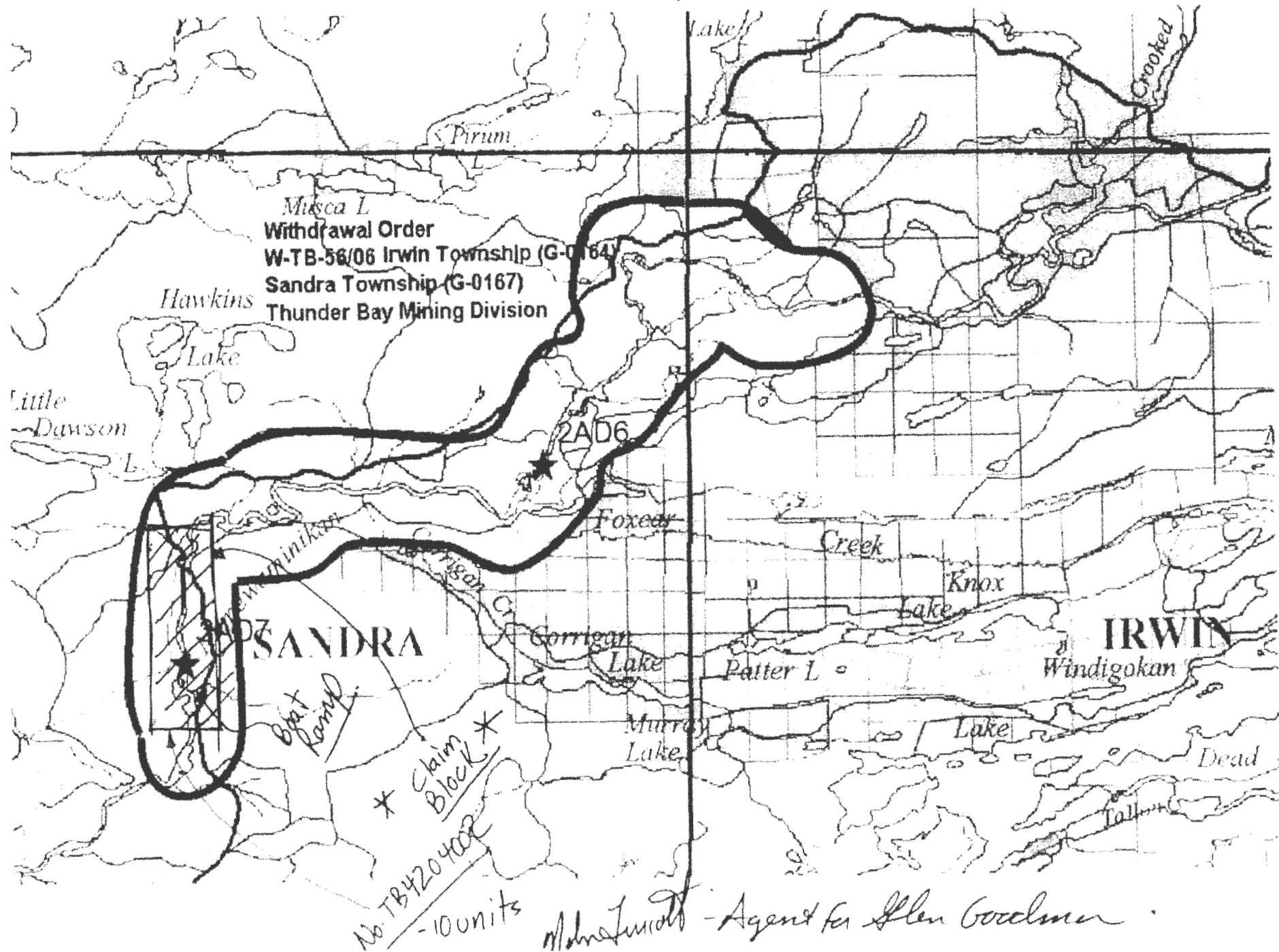

2.45182



MINISTRY OF NORTHERN DEVELOPMENT,
MINES AND FORESTRY

2-45182

- [Home](#)
- [Mines and Minerals](#)
- [Northern Development](#)
- [News](#)
- [Site Map](#)
- [Contact Us](#)

Attachment #3 - page 1
Claim Group History

Mining Claim Abstract

| [Main Menu](#) | [Back](#) |

THUNDER BAY - Division 40		Claim No: TB 4204002	Status: ACTIVE
Due Date:	2010-Jun-16	Recorded:	2005-Jun-16
Work Required:	\$ 3,956	Staked:	2005-Jun-08 12:30
Total Work:	\$ 12,044	Township/Area:	SANDRA (G-0167)
Total Reserve:	\$ 0	Lot Description:	
Present Work Assignment:	\$ 0	Claim Units:	10
Claim Bank:	\$ 0		

Claim Holders

Recorded Holder(s) Percentage

GOODMAN, GLEN ALEXANDER (66.67 %)

TURCOTTE, JOHN JOSEPH (33.33 %)

Client Number

138136

203632

Transaction Listing

Type	Date	Applied	Description	Performed Number
STAKER	2005-Jun-16		RECORDED BY LANCE, CAREY (D19771)	R0540.02322
STAKER	2005-Jun-16		LANCE, CAREY (156404) RECORDS 100.00 % IN THE NAME OF GOODMAN, GLEN ALEXANDER (138136)	R0540.02323
OTHER	2007-Jun-18		WORK PERFORMED (PRECUT, PROSP, PSTRIIP) \$ 4,172 APPROVED: 2007-NOV-14 Previously: 4615	Q0740.02067
WORK	2007-Jun-18	\$ 4,000	WORK APPLIED (PRECUT, PROSP, PSTRIIP) APPROVED: 2007-NOV-14	W0740.02067
WORK	2007-Jun-18	\$ 0	WR#W074001181 CORRECTION	W0740.01181

Attachment #3 - page 2
Claim Group History

CANC	2007-Nov-05	CANCELLED PURSUANT TO SUBSECTION 72(1) (B) OF THE MINING ACT R.S.O. 1990	C0740.04884
CANC	2007-Nov-05	NOTICE OF RE-OPENING (SUBSECTION 72. 1 (2) UNDER THE MINING ACT R. S. O. 1990.) POSTED 2007-NOV-06 - CHECK CLAIM MAP FOR ANY RESTRICTIONS TO STAKING	C0740.04896
CANC	2007-Nov-05	REINSTATED (CANCELLED IN ERROR)	C0740.05026
OTHER	2007-Nov-05	ENTRY - C074004896 ENTERED IN ERROR	U0740.00049
TRAN	2008-May-22	GOODMAN, GLEN ALEXANDER (138136) TRANSFERS 33.33 % TO TURCOTTE, JOHN JOSEPH (203632)	T0840.00273
OTHER	2008-Jun-03	WORK PERFORMED (ASSAY, PMAN, PROSP) \$ 7,872 APPROVED: 2008-SEP-15	<u>Q0840.01158</u>
WORK	2008-Jun-03 \$ 7,872	WORK APPLIED (ASSAY, PMAN, PROSP) APPROVED: 2008-SEP-15	<u>W0840.01158</u>
WORK	2009-Jun-15 \$ 172	WORK APPLIED	<u>W0940.01606</u>

Claim Reservations

-
- 01 400' surface rights reservation around all lakes and rivers
 - 02 Sand and gravel reserved
 - 03 Peat reserved
 - 04 Other reservations under the Mining Act may apply
 - 05 Including land under water
 - 06 Excluding road
-

- [Home](#)
- [Mines and Minerals](#)
- [Northern Development](#)
- [News](#)
- [Site Map](#)
- [Contact Us](#)



This site is maintained by the Government of Ontario, Canada.

- [Accessibility](#)
- [Privacy](#)
- [Important Notices](#)

Copyright information: © Queen's Printer for Ontario, 2008

2 · 45182

Attachment #6 - Working Map - 2009/2010 Claim Group #4204002

2.45182

N (astronomic)

200m NW to Namewaminikan River

general area
stripped
- some trees
remaining
- washed using
pumps and
500 gallon tanks

130m
→ east to
claim group
boundary
line

general terrain
→ bedrock
→ outcropping
→ sloping
→ up to
east.

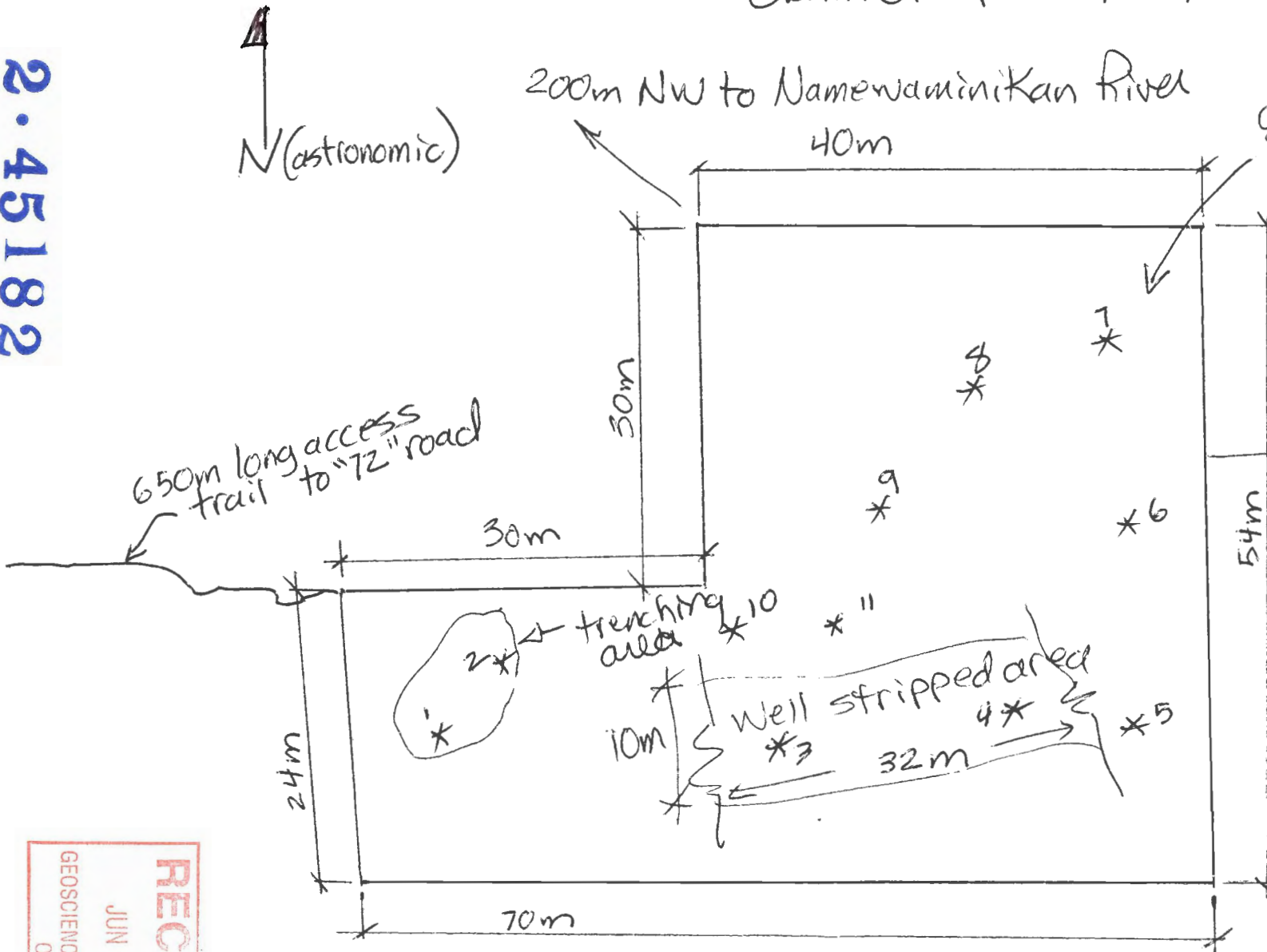

* - general location samples
[thru 11 taken]

Scale: 1:500

0 10m

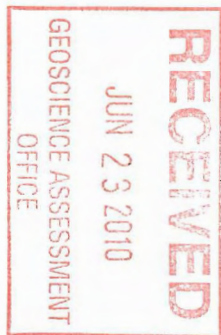

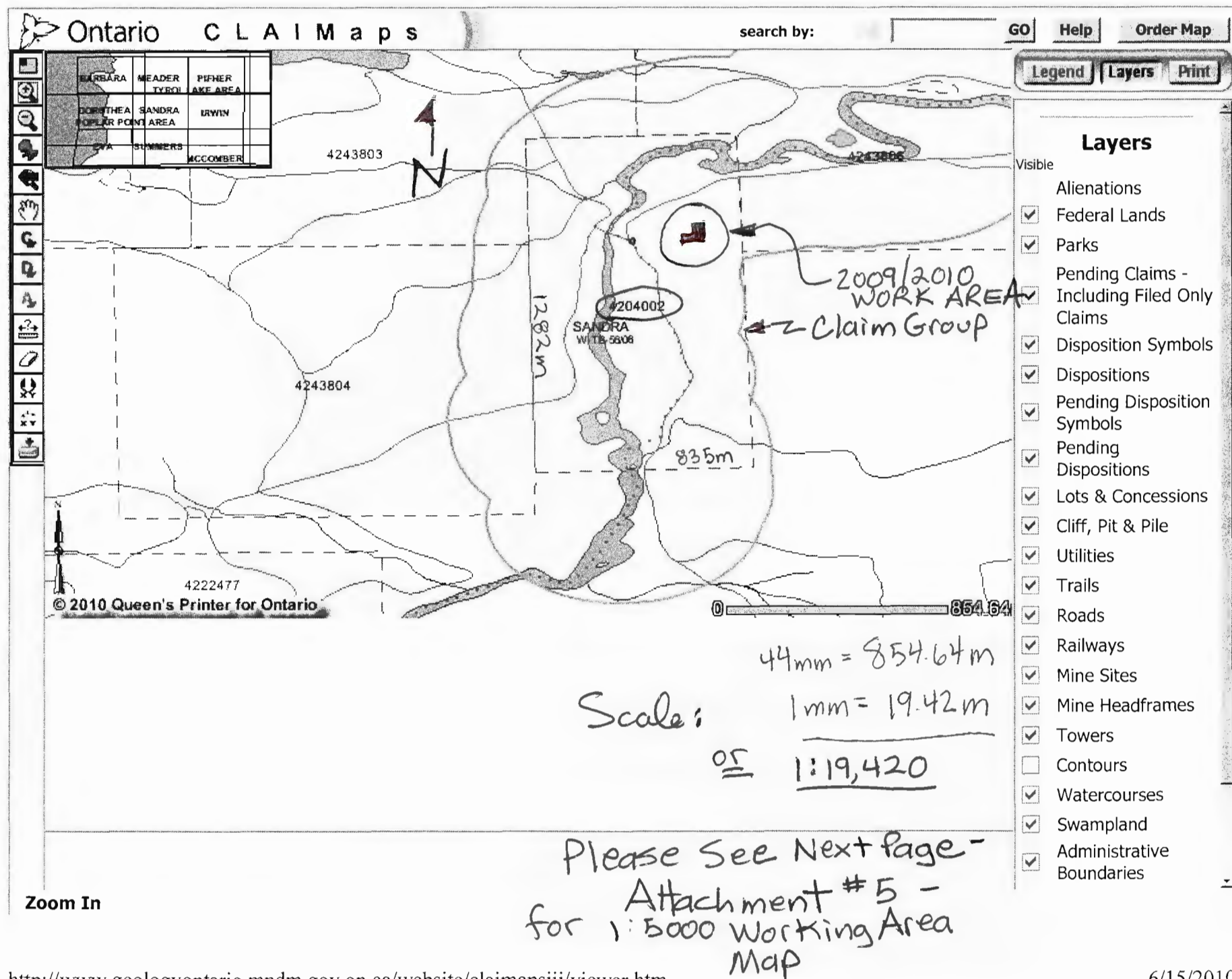

2.45182

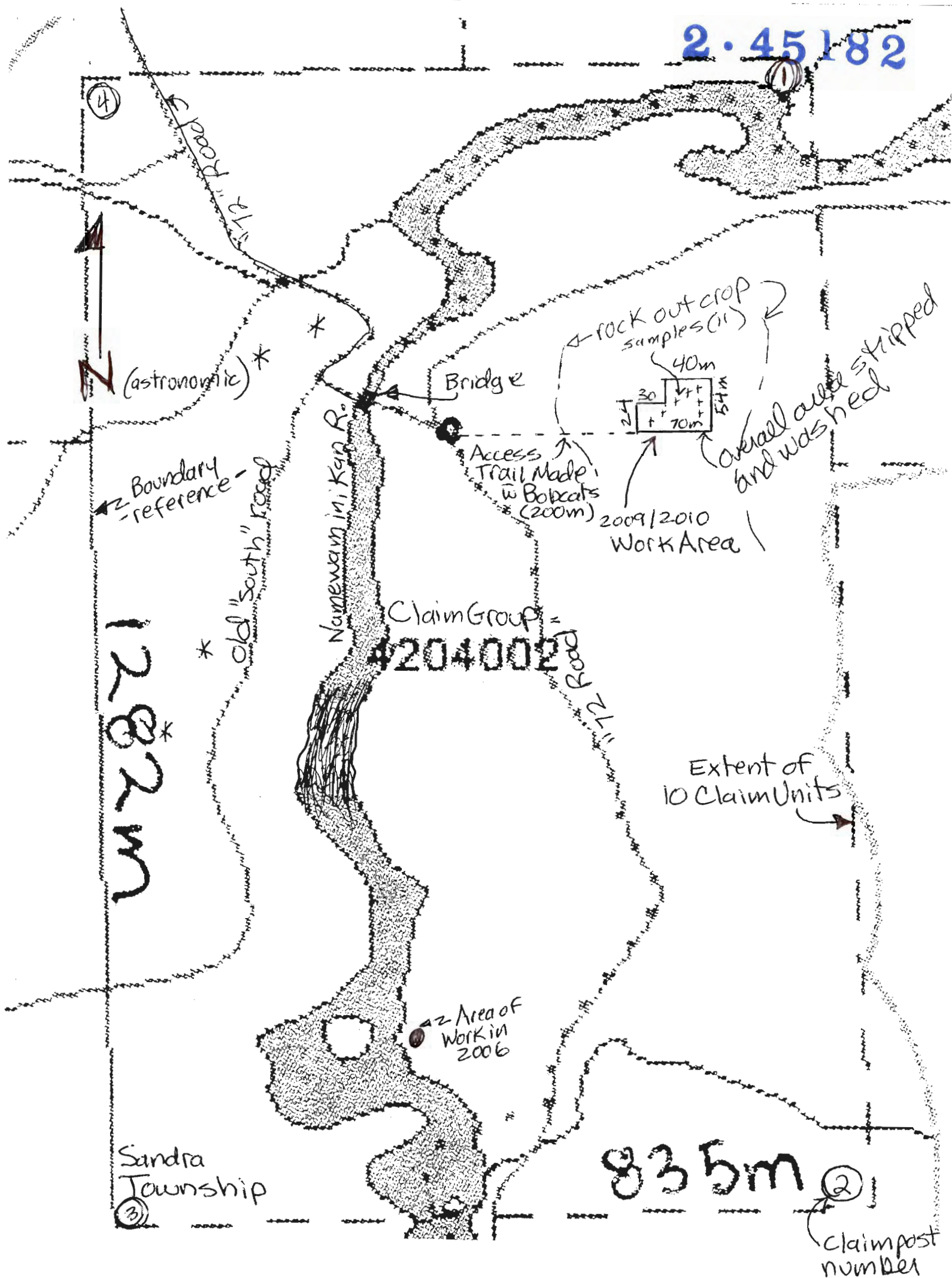

Attachment #5 - Claim Group 4204002

- Site Working Map - 2009/2010
Scale: 1:5000

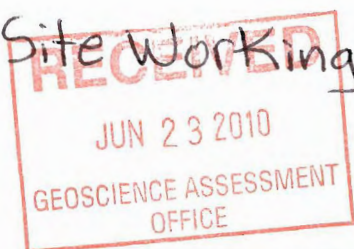

0 200m

- see Attachment #6 of workings 1:500 map

Drawn By N. Turcotte
June 15, 2010

Certificate of Analysis

Monday, June 14, 2010

Attachment # 7 - Assay Results

 Goodman, Glen
 309 Walker St
 Beardmore, On, CAN
 Ph#: 8752671

Date Received: 06/04/2010

Date Completed: 06/11/2010

Claim Group 4204002

Job #: 201042169

Reference:

Sample #: 11 Rock

Acc #	Client ID	Au ppb	Au oz/t	Au g/t (ppm)
153053	1	10	<0.001	0.010
153054	2	8	<0.001	0.008
153055	3	8	<0.001	0.008
153056	4	9	<0.001	0.009
153057	5	10	<0.001	0.010
153058	6	8	<0.001	0.008
153059 Dup	6	7	<0.001	0.007
153060	7	10	<0.001	0.010
153061	8	13	<0.001	0.013
153062	9	9	<0.001	0.009
153063	10	10	<0.001	0.010
153064	11	10	<0.001	0.010

PROCEDURE CODES: ALP1, ALFA1

Certified By:



Derek Demaniuk H.Bsc. Laboratory Manager

The results included on this report relate only to the items tested

The Certificate of Analysis should not be reproduced except in full, without the written approval of the laboratory

AL903-0748-06/14/2010 2:39 PM

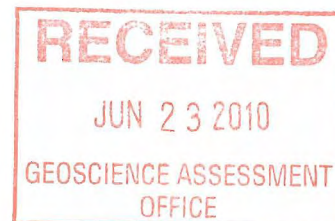

2.45182

October 24, 2010

Mr. Nelson Turcotte – Authorized Agent for Mr. Glen Goodman/John Turcotte – Mining
Clients #138136 and #203632 respectively
36 Kimberly Drive
Kapuskasung, Ontario, CANADA
P5N 1L5
Cell Phone – 1-705-367-6448
Home Phone – 1-705-335-4098
Facsimile – 1-705-337-0242

Mr. James MCCAULEY
Provincial Recording Office
Geoscience Assessment Office
Ministry of Northern Development and Mines
933 Ramsey Lake Road
3rd Floor
Sudbury, Ontario, CANADA
P3E 6B5
Phone – 1-888-415-9845
Fax – 1-877-670-1555

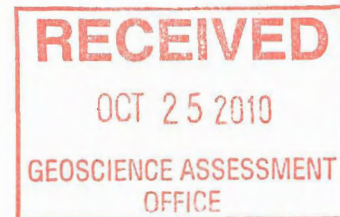

Attention: Mr. James Mcauley

Re: Glen Goodman (Client #138136) and John Turcotte (Client #203632) response to 45-Day Notice for Claim No. 4204002 in Sandra Township – near Beardmore, Ontario (transaction number W1040.01333)

Dear Mr. Mcauley:

Further to our telephone conversation on Friday the 22nd of October, I am writing as authorized representative to Glen Goodman and John Turcotte, Claim Holders of Claim Number TB4204002 in Sandra Township, near the Town of Beardmore, Municipality of Greenstone, Ontario.

This letter and attachments, in for the form of other pdf files, provides the following:

- Revised detailed sketch of the area stripped;
- Description of the rock types, mineralization and alteration in the area stripped;
- Description of the samples that were collected;
- Reformatted breakdown spreadsheet so that it is easier to read;

- More detail on the prospecting completed and
- Provision of a prospecting map showing the areas that were traversed prior to stripping.

Please note that we do not provide photographs of the stripped areas, despite the fact that we do agree they would be helpful but, of course, are not, otherwise, required. Therefore, here is what we have to offer:

1. Revised detailed sketch of the area stripped

Attachment #6 – Workings Map – 2009/2010 – Claim Group #TB4204002 was submitted in the June 16, 2010 report filed with the Ministry of Northern Development and Mines (“MNDM”). That particular map has a scale of 1:500. We resubmit Attachment #6, in the same 1:500 scale with more detail of the stripped area. We provide more detailed notes on the area stripped and the area trenched.

2. Description of the rock types, mineralization and alteration in the area stripped

Rock types found in both the area trenched and the area stripped included Copper Pyrite, Ceramic Pyrite and Smoky Blue Quartz. In addition in both the trenched area and stripped area, some minor showings of white quartz veins were discovered.

3. Description of the samples that were collected

Eleven samples, in total were taken and the approximate location of those samples is shown on Attachment #6, revised and included with this submission. Again the samples were a combination of Smoky Blue Quartz, Copper Pyrite and Ceramic Pyrite. Sample analysis was completed by Accurassay labs of Thunder Bay, Ontario and the results of those samples were published on June 11, 2010. Gold was sampled for. The Certificate of Analysis is included with this response and shown as Attachment #7.

4. Reformatted breakdown spreadsheet so that it is easier to read

The reformatted spreadsheet is included in the response email forwarded to you, just this evening, Sunday, October 24, 2010 and we have enlarged the rows and the text and I believe you will find that it is much more legible.

5. More detail on the prospecting completed

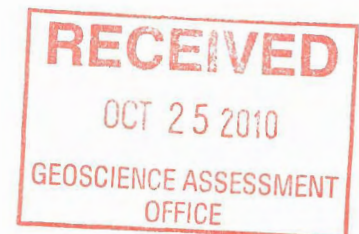

We have taken the Attachment #5 map submitted in June of this year and revised it by adding clarification of where the 7 days of prospecting occurred in the 2009 and 2010 period. Prospecting was conducted around the general 2009/2010 work area and from there – the prospectors moved east, approximately 130 m to the easterly most line of the Claim Group. At the east line, prospecting continued North and South for a total distance of approximately 320 metres in that North-South direction. Again any exposed rock seemed to resemble the same type of rock found in the 2009/2010 Work Area.

6. Provision of a prospecting map showing the areas that were traversed prior to stripping

Again, we have revised Attachment #5 by denoting the 2009/2010 prospecting areas and lines.

Lastly – we do resubmit the Assessment Work Performed on Mining Lands only to attempt to provide clarification of how we would like our Claim Units within the Claim Group applied and cut back should they have to be. However, one can see that our estimate of work is over \$8,000 – well over the \$4,000 required and hence do not anticipate a problem here.

Should you have any questions, please do not hesitate to contact me at cellular 705-367-6448 or at my office at 705-335-4098.

Thank-you for your cooperation and assistance.

Yours truly,

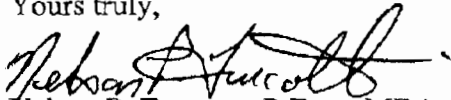

Nelson P. Turcotte, P.Eng., MBA

Authorized Representative of Mr. Glen A. Goodman and Mr. John J. Turcotte

cc. Glen A. Goodman - Beardmore, Ontario and Mr. John Turcotte – Terrace Bay, Ontario

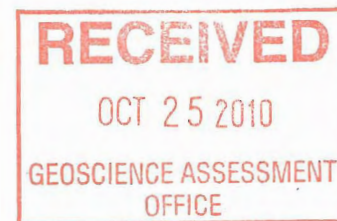

Attachment #6 (Oct. 24/10 revision) - Working Map - 2009/2010
Claim Group # TB4204002

Oct. 27/10

200m to
Namewamini Kan River

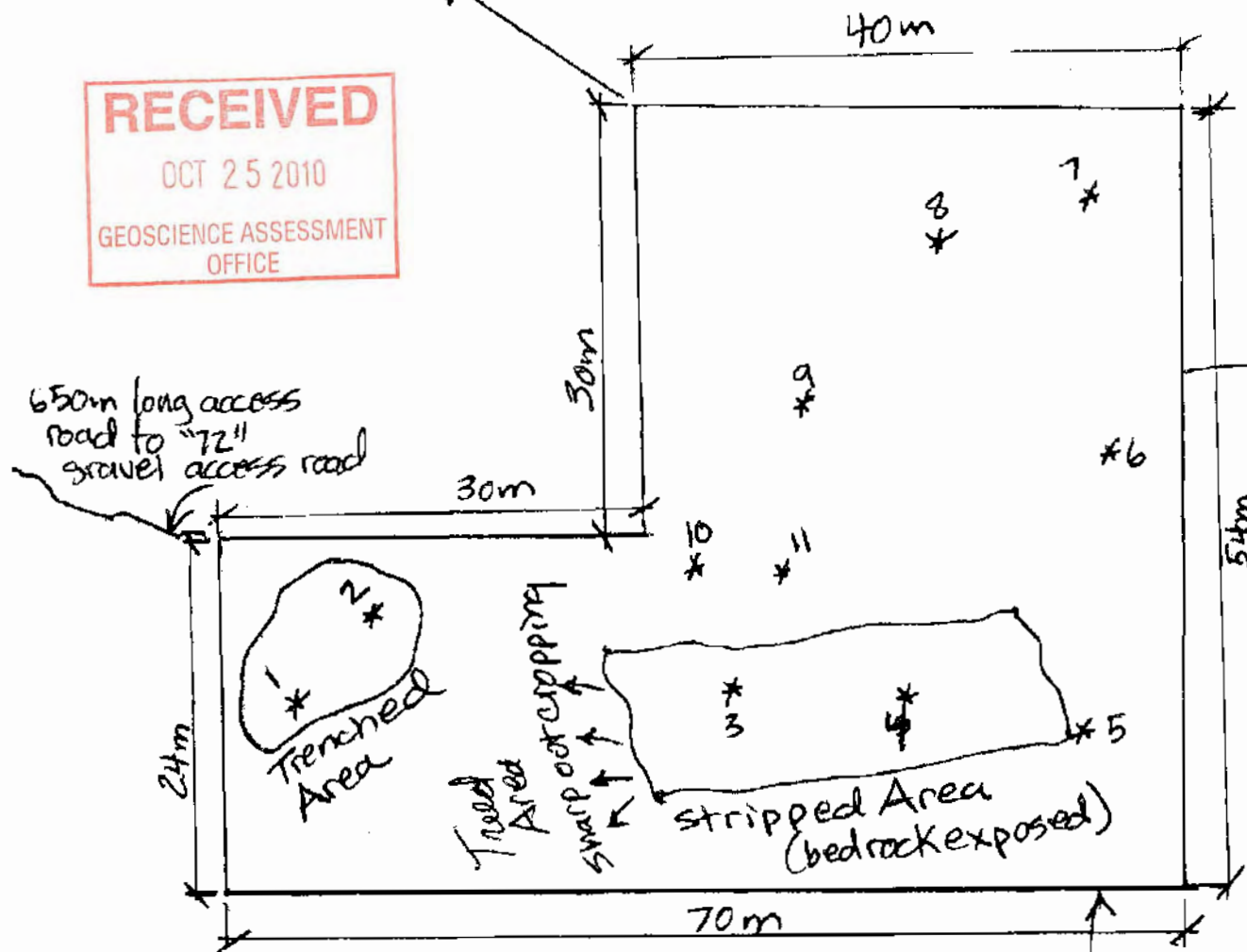
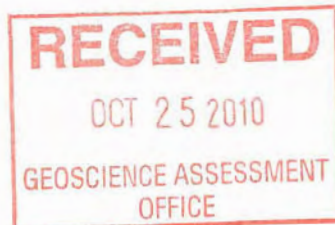

Details of Area Trenched

- fair amount of top soil removed
- some smoky blue quartz exposed
- random outcrops dispersed among areas of deep overburden cover
- small quartz veins exposed

130m east to claim group most easterly line, running North and South (see Attachment #5, revised) for area or line of prospecting

Details of Area Stripped

- 32m long in E-W direction
- 10m wide in N-S direction
- several trees removed
- Moss with shallow top soil removed
- 400 gallon plastic water tank used for cleaning of rock
- 2 samples removed
- copper pyrite and ceramic pyrite samples
- general E-W slight slope to bedrock surface
- some narrow strips of quartz exposed

General Overall Work Area

- trees and brush removed in scattered pattern
- Bobcat excavator used to expose bedrock and dig up some rock samples

Scale: 1:500

0 10m

Outline represents general overall work area

* Samples Taken

- see June 14, 2010 Accurassay sample results - Certificate of Analysis



1046 Gorham Street
Thunder Bay, ON
Canada P7B 5X5

Tel: (807) 626-1630
Fax: (807) 622-7571

www.accurassay.com
assay@accurassay.com

Certificate of Analysis

Monday, June 14, 2010

Attachment # 7 - Assay Results

Goodman, Glen
309 Walker St
Beardmore, On, CAN
Ph#: 8752671

Date Received: 06/04/2010

Date Completed: 06/11/2010

Claim Group
4204002

Job #: 201042169

Reference:

Sample #: 11 Rock

Acc #	Client ID	Au ppb	Au oz/t	Au g/t (ppm)
153053	1	10	<0.001	0.010
153054	2	8	<0.001	0.008
153055	3	8	<0.001	0.008
153056	4	9	<0.001	0.009
153057	5	10	<0.001	0.010
153058	6	8	<0.001	0.008
153059 Dup	6	7	<0.001	0.007
153060	7	10	<0.001	0.010
153061	8	13	<0.001	0.013
153062	9	9	<0.001	0.009
153063	10	10	<0.001	0.010
153064	11	10	<0.001	0.010

PROCEDURE CODES: ALP1, ALFA1

Certified By:

Derek Damianuk H.Bsc., Laboratory Manager

The results included on this report relate only to the items tested

The Certificate of Analysis should not be reproduced except in full, without the written approval of the laboratory

AL903-0748-06/14/2010 2:39 PM

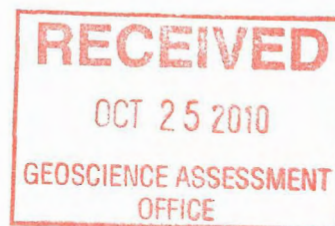

ATTACHMENT #1**CLAIM NO. TB 4204002 - 2010 ASSESSMENT WORK REPORT****DETAILS of COSTS FOR WORK PERFORMED in 2009/2010 on CLAIM GROUP**

October 22, 2010 - revised by enlarging text

(original with June 16, 2010 submission)

PLEASE NOTE - PLEASE SEE ASSESSMENT REPORT FOR SUMMARIZATION

	Hourly Rate (\$/hr.)	Hours	Materials	Sundries	TOTAL	NOTES
COSTS OF WORK PERFORMED						
Labor - Glen Goodman - August 6th and 7th, 2009	35	12			420	Prospecting, site layout, prep work
Labor - John Turcotte - August 7th, 2009	35	4			140	Prospecting, site layout, prep work
Labor - Glen Goodman - August 8th and 9th, 2009	35	16			560	Site work, trenching, stripping, washing, prospecting, rock breaking
Labor - John Turcotte - August 8th and 9th, 2009	35	16			560	Site work, stripping, washing
Labor - Carl Turcotte - August 8th and 9th	25	16			400	Site work, stripping, washing, operate bobcat
Labor - Aaron Baillie - August 8th and 9th	25	16			400	Site work, stripping, washing, operate bobcat
Labor - Nelson Turcotte - August 8th	35	6			210	Site work
Labor - Glen Goodman - prospecting - May 5/8, 2010	35	16			560	Prospecting - Northeast corner - checking outcropping and looking for origin of float
Labor - Glen Goodman - prospecting - May 10/11, 2010	35	12			420	Prospecting - Southeast corner
Labor - Glen Goodman - prospecting - May 18, 2010	35	6			210	Prospecting - Northeast corner
Labor - Glen Goodman - prepare rough notes/map for report	35	4			140	
Nelson Turcotte - write report	35	6			210	
			Subtotal		\$ 4,230	
ASSOCIATED COSTS						
Bobcat 341D Excavator	60	16			960	Rented from TKLP - no operator - we operated equipment
Bobcat T300 Machine - crawler loader/bucket machine	60	16			960	Float from High Falls G.S. construction site - use 2 days
Float time from Beardmore to Site for 2 Bobcats - return trips					400	\$100/machine x 2 machines x in and out (2 trips)
Cost of Assay Work - 11 samples - Accurassay - Thunder Bay					225	estimated - awaiting invoice as at June 15, 2010
Power saw for 3 days					75	\$25/day cost
Misc. Gas for saws, water pump, ATV etc.					30	5 gallons of gas
Honda - 3" trash pump rental - 2 days					150	Rented from Wolverine Hydro Inc. at \$75/day
Fuel for Machine - 341D - 15 gallons - charges from WHI					90	15 gallons - backcharge from Wolverine Hydro, Inc.
Fuel for Machine - T300 - 15 gallons - charges from WHI					90	15 gallons - backcharge from Wolverine Hydro, Inc.
			Subtotal		\$ 2,980	
TRANSPORTATION COSTS						
Gas - John Turcotte - Terrace Bay to Beardmore - return August 7th and August 9th					140	400km's - Terrace Bay to Beardmore return x .35/km
Gas - Nelson Turcotte - Kapuskasing to Beardmore - return August 7th and August 8th					182	520km's - Kapuskasing to Beardmore return x .35/km
Gas - Aaron Baillie - Thunder Bay to Beardmore - return					140	400 kms x \$.35/km
Gas - Glen Goodman - Beardmore - Thunder Bay (assays) - June 4, 2010					140	400 kms x \$.35/km
Gas for Glen's truck - 4 days in summer 2009 and 5 days in spring 2010					117	338 kms x \$.35/km
			Subtotal		\$ 719	
FOOD AND LODGING COSTS						
Food for John Turcotte - away from home August 7th, 8th and 9th					125	includes lunches for John Turcotte, Glen Goodman, Nelson Turcotte, Aaron Baillie and Carl Turcotte
			Subtotal		\$ 125	
			GRAND TOTAL		\$ 8,064	2009 assessment work claim TB 4204002
NOTE - PLEASE SEE ASSESSMENT WORK REPORT FORM FOR DATES						

Nelson Turcotte
 revised Oct. 24/10

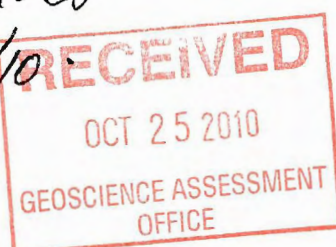



Scale: 1:5000