

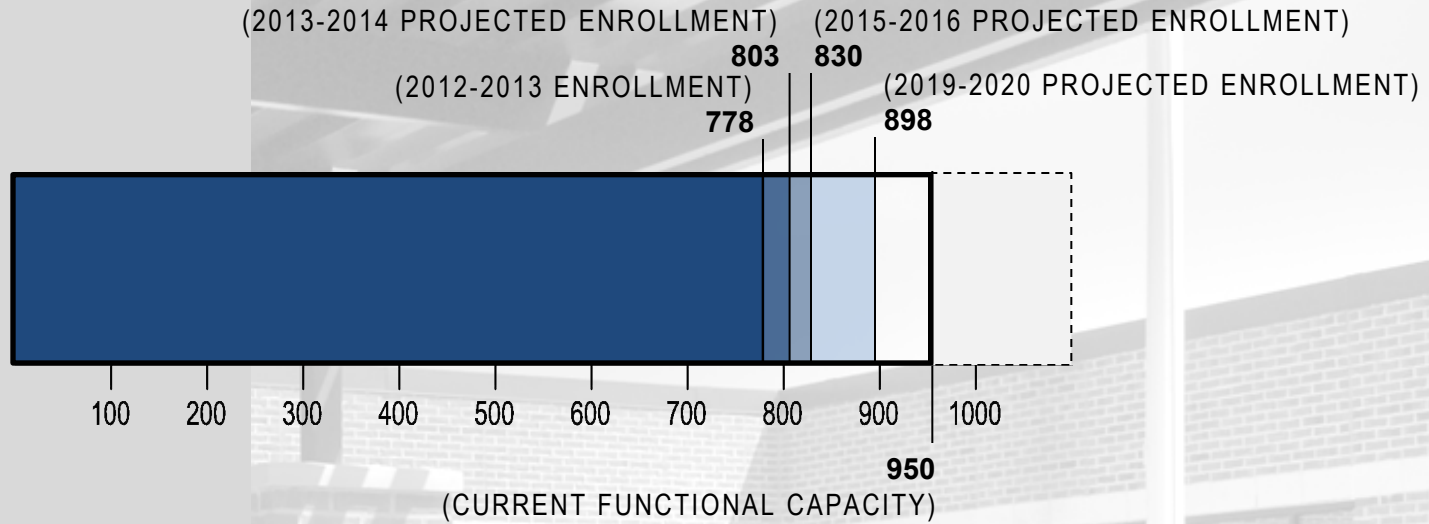

FACILITY SUMMARY



FACILITY

Original Construction : 2010
 Renovations: NONE
 Total Area: 114,461 SF

REFS

Quantity: NONE
 Total Area: N/A

UTILIZATION

Over-utilized: █
 Under-utilized: █

LEGEND:

- 1 Space used for teacher work/storage and for Rice University activities.
- 2 Empty teaching space.

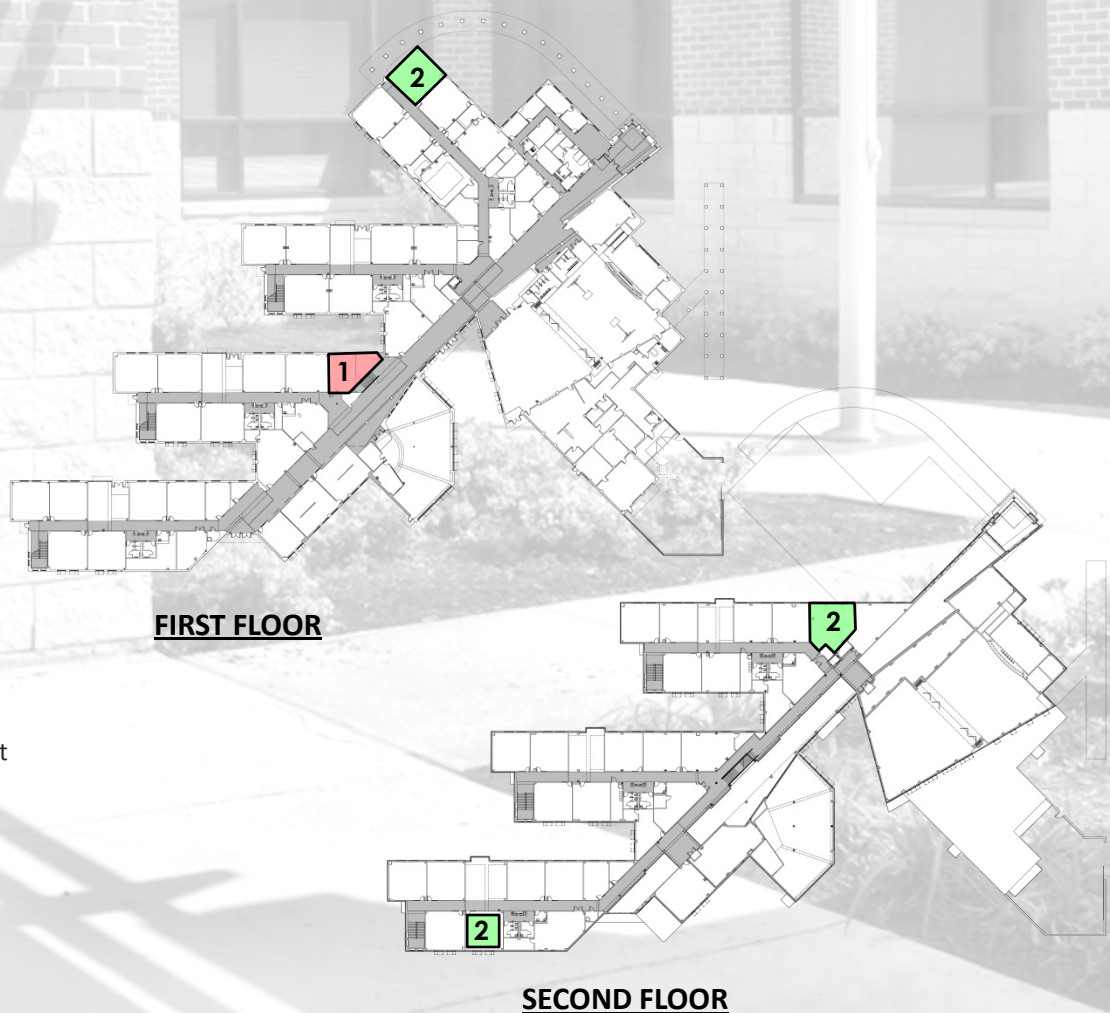

ADDITIONS

Currently, no additions are required to accommodate District Unifiers. An addition increasing student capacity shall not be required until after 2020, based on current growth rate projections.

EXISTING JULY 2012 PROGRAM

Space Name	Quantity	District Assigned Capacity	Program Comments
Grade Classrooms			
Kindergarten	6	22	
First Grade	6	22	
Second Grade	6	22	
Third Grade	6	24	
Fourth Grade	6	24	
Fifth Grade	6	28	One empty classroom
Cluster Programs			
Applied Skills			
Life Skills	3		Currently using two Pre-K classrooms. One used for Motor Lab. One empty Pre-K classroom this wing.
Adaptive Behavior			
Bilingual			
Deaf Ed			
Medical Needs			
SPARK			
PPCD – Co-Teach			
Elementary SCD			
PPCD SCD			
SPEAK Elementary			
SPEAK PPCD			
SPEAK Social			
SPEAK Transition			
STEPS/PPCD			
STEPS + PPCD			
Pre-K			
Kinder +			
PPCD			
Audiology			
Spanish Immersion			
Pre-K Resource			
Support Programs			
Science Lab	2		1 st floor lab used by Rice University & for teacher training. 2 nd floor multipurpose room being used as lab
Gymnasium	1		
Art Lab	1		Currently using applied skills classroom
Art Storage			
Learning Resource Center	1		
Motor Lab	1		
Resource Room	1		
Rice University Workroom	2		Currently using one workroom and one storage room
Flex/collaborative	6		One per grade level
Multi-purpose	2		Second floor multi-purpose room empty
Music	1		
Computer Lab	2		
Cafeteria	1		
P.E.			
Math Alt Instruction			
Literacy Alt Instruction			
ELT - ESL/GT			
Literacy Library	1		
Special Education			
Special Education Support			
Math Coach	1		Currently using 3 rd grade workroom
Literacy Coach			
RTI/Small Group Instruction			
After school activities			
Intervention/Tutor			
L.S.S.P			

EXISTING JULY 2012 PROGRAM

Space Name	Quantity	District Assigned Capacity	Program Comments
Support Programs (continued)			
Speech	1		
Diagnostician	1		
Distance learning			
Dyslexia/Behavioral			
Occupational therapy			
Broadcast/Production			
Guidance mentoring			
Learning lab			
ALT – Academic lead teacher			
Reading Coach	1		Currently using 2 nd grade workroom
Administration			
Lounge	1		
Lounge Storage			
Professional Development	1		Currently using 2 nd floor multi-purpose/science room
Workroom	1		
Grade Level Offices			
Mail	1		
Reception/waiting	1		
Registrar			
Secretary Office	1		
Principal Office	1		
Assistant Principal Office	1		
I.S.S.			
Testing			
PE Office	1		
Clinic	1		
Counselor	1		
Copy Room			
Conference	2		
Small Lounge			
Book Storage	1		
Lounge/supply storage			
Supply/workroom			
Record Storage	1		
Patrol Storage			
General Storage	3		
Grade Level Workrooms	3		
PTA/PTO Workroom	1		Currently using Pre-K classroom
School store			
Planning			
Assessment material storage	2		Currently stored in Counselor's office and in corridor storage room

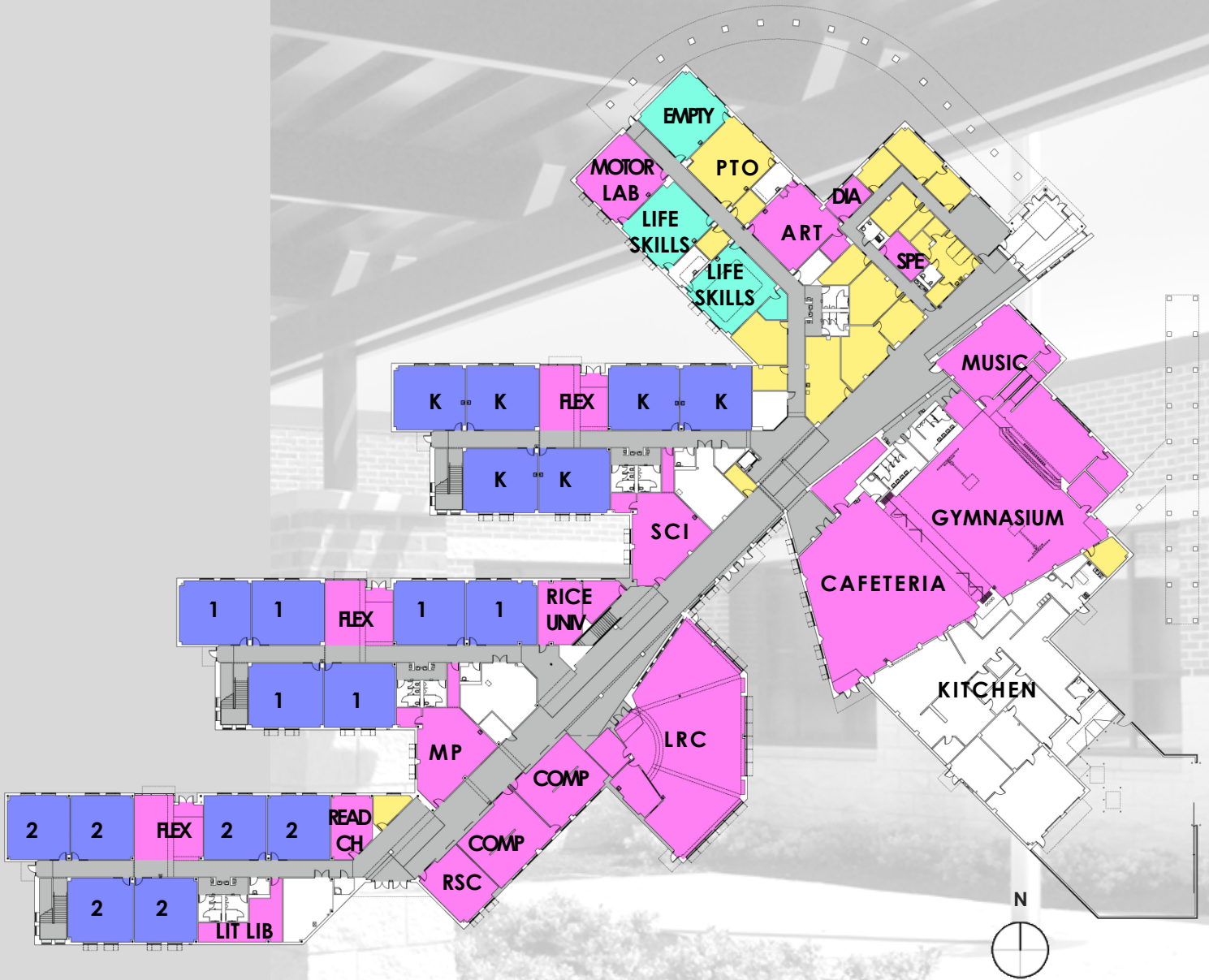

EXISTING PROGRAMMATIC USE (first floor)

PLAN LEGEND:

- Grade Classrooms (K-5)
- Cluster Programs
- Support Programs
- Administration

ACRONYMS:

- CH Coach
- COMP Computer
- DIA Diagnostician
- LIB Library
- LIT Literacy
- LRC Learning Resource Center
- MP Multipurpose
- PTO Parent/Teacher Organization
- RSC Resource
- SCI Science
- SPE Speech

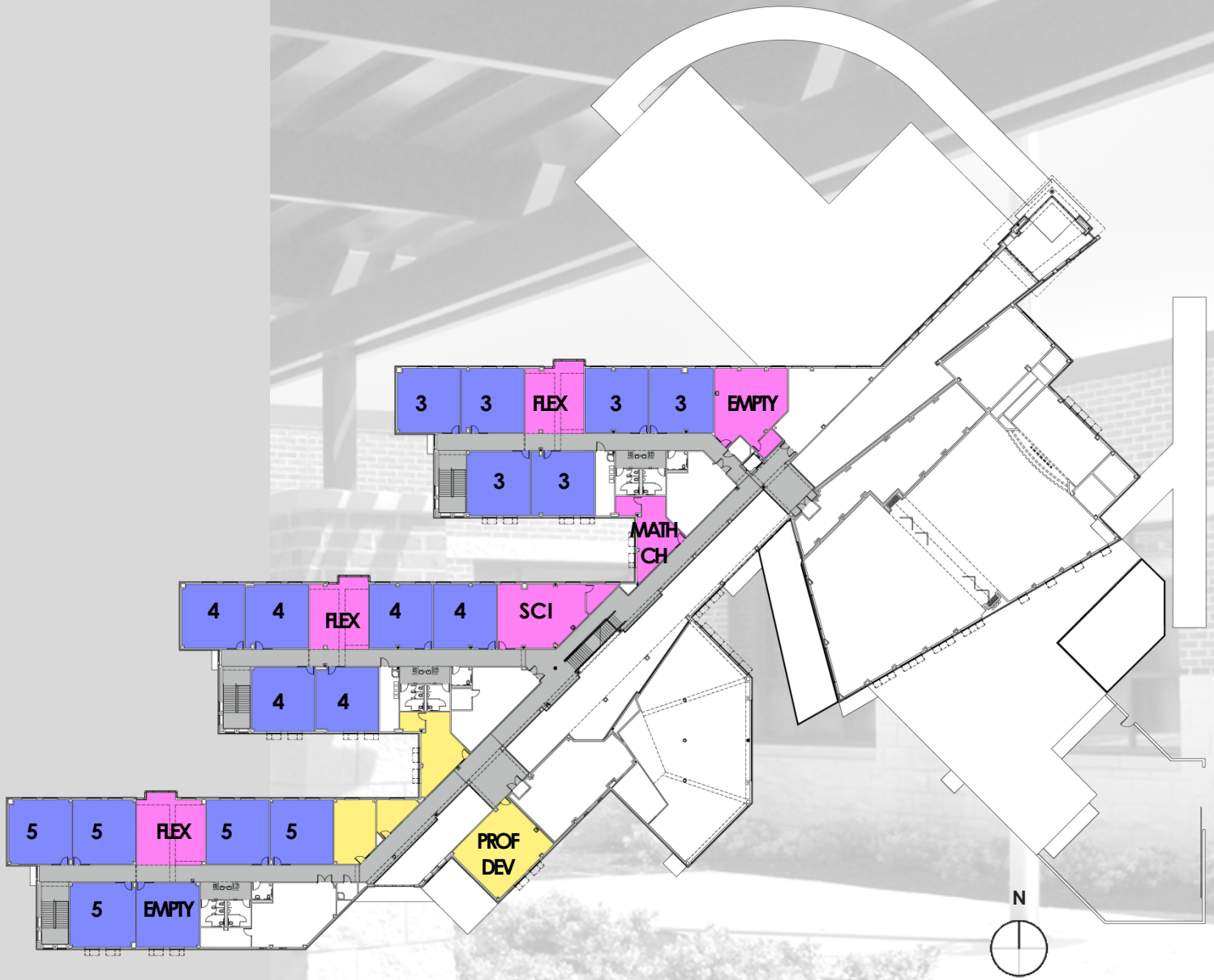

EXISTING PROGRAMMATIC USE (second floor)

PLAN LEGEND:

- Grade Classrooms (K-5)
- Cluster Programs
- Support Programs
- Administration

ACRONYMS:

- CH Coach
- DEV Development
- SCI Science

SITE UNIFIERS

ELEMENTARY UNIFIERS		YES	NO	COMMENTS
1	Exercise path			
2	ADA accessible playground equipment			
3	K-2 playground equipment			
4	3-5 playground equipment			
5	Curriculum based learning tool (Science)			
6	Curriculum based learning tool (Math)			
7	Outdoor learning space or garden			
8	Outdoor community hardtop courts			
9	Play field			
10	Sufficient parking spaces			No issues per Principal
11	Stacking for cars off thoroughfare			Currently use faculty lot for majority of stacking
12	Open air basketball pavilion			



FACILITY INTERIOR UNIFIERS

ELEMENTARY UNIFIERS		YES	NO	COMMENTS
Gymnasium				
13	Indoor play space for physical education			
14	Office			
15	Storage for PE equipment			
16	Motor Lab w/ storage			Currently adjacent to Life Skills
17	Sound system			
Specialty Instructional Spaces				
18	Music room ~ minimum of 750 sq ft			
19	Art room with water ~ minimum of 750 sq ft			
20	Science lab w/ water ~ minimum of 750 sq ft			
Cafeteria				
21	Core space capacity			
22	Sound system			
23	Acoustical treatment			
Library				
24	Core space capacity			
25	Secure access			
Instructional Classrooms				
26	Two dry erase boards in majority of classrooms			
27	Natural light in every classroom			
Collaborative/Flexible spaces				
28	Space for RTI, small group instruction ~ minimum of 350 sq ft			Currently use small workrooms
29	Student instructional planning & collab space per grade level			
30	Adult instructional, flexible collaborative spaces (Prof Dev)			
31	Magnetic instructional wall boards in flex collaborative spaces			
32	Designated PTO/PTA workroom			
Technology				
33	Wireless access points ~ one per classroom			30 existing access points
34	Web-based kiosks for learning (quantity based on capacity)			
35	One computer lab; 30 workstations for IT classes			
36	Designated MDF space			
Other				
37	Large mtg space (size dependent on capacity 65-100 staff)			Use staff development room
38	Faculty lounge w/ice, dishwasher, refrigerator and tables/chairs			
39	Secure space for testing materials with workspace & computer			Two spaces used; one secure. Need to add computer
40	Secure storage space for instructional/general materials			Additional first floor storage requested

SAFETY AND SECURITY UNIFIERS

ELEMENTARY UNIFIERS		YES	NO	COMMENTS
41	Security vestibule with direct access to the office			
42	Access control on all exterior doors			On majority of doors, but not all
43	Interior security cameras on all exterior doors			Poor video quality. On majority of doors, but not all
44	Security cameras for student management			
45	Parking lot lighting			
Signage				
46	Mark all exterior doors with reflective numbering			
47	Visitor check-in at all exterior doors			Only in main entry vestibule
48	Traffic flow for cars and buses			Post and panel directional signs
49	Parking areas for cars			
50	Drug, alcohol, tobacco and weapons free zone			
Fencing and Skirting				
51	Secure perimeter around playgrounds			
52	Secure HVAC and generators with locked gate/fencing			

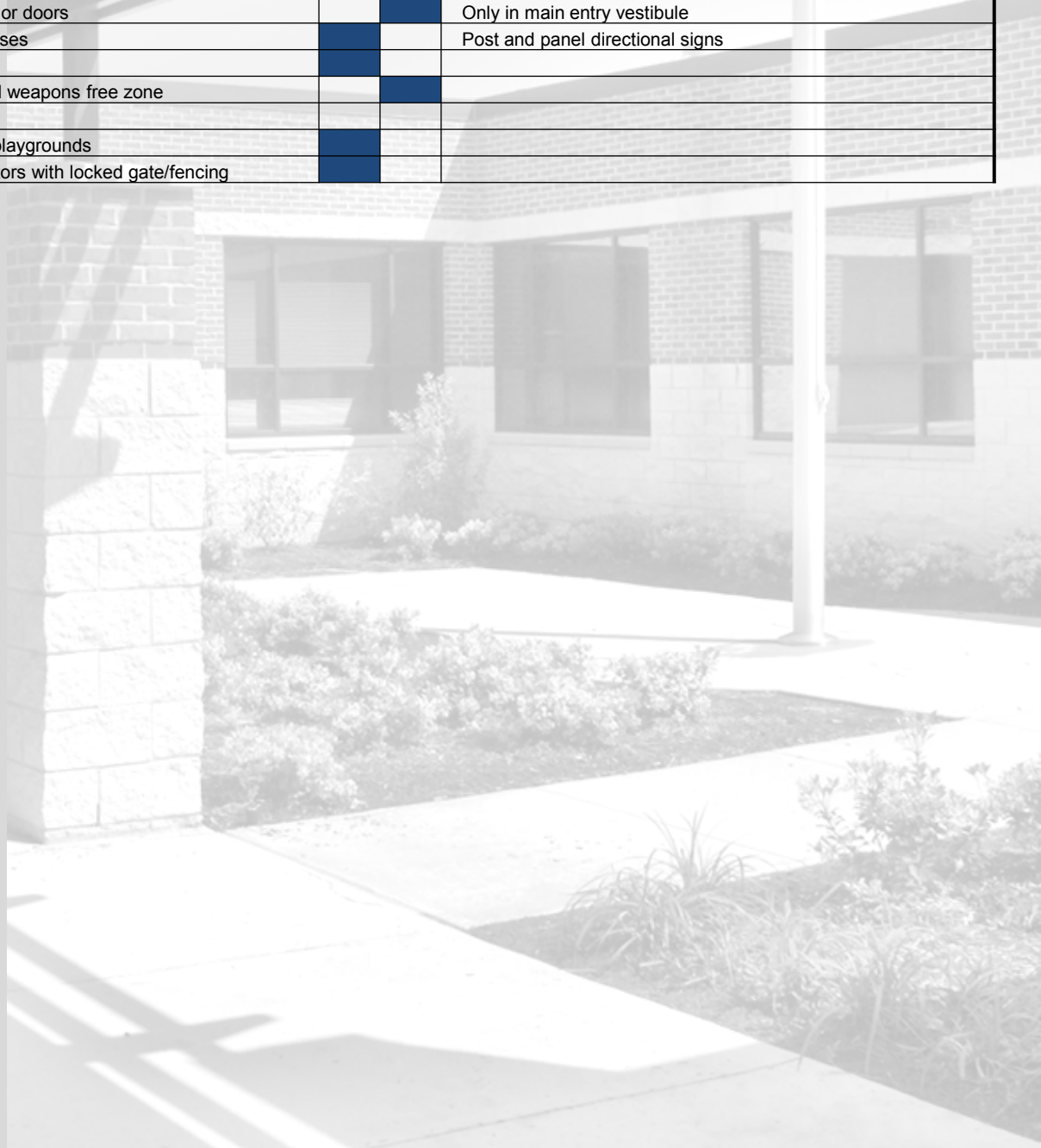



EXISTING SITE UNIFIERS

- | | |
|--|---------------------------------------|
| 1 Exercise path | 7 Outdoor learning space |
| 2 ADA accessible playground equipment | 8 Open community hardtop courts |
| 3 K-2 playground equipment | 9 Play field |
| 4 3-5 playground equipment | 10 Sufficient parking spaces |
| 5 Curriculum based learning tool (Science) | 11 Stacking for cars off thoroughfare |
| 6 Curriculum based learning tool (Math) | 12 Open air basketball pavilion |

EXISTING SAFETY AND SECURITY UNIFIERS (exterior)

- | | |
|--|--|
| 41 Security vestibule with direct access to the office * | 48 Traffic flow signage for cars and buses |
| 42 Access control on all exterior doors | 49 Parking area signage for cars |
| 43 Interior security cameras on all exterior doors | 50 Drug, alcohol, tobacco, weapons free zone signs |
| 44 Security cameras for student management * | 51 Secure perimeter around playgrounds |
| 45 Parking lot lighting | 52 Secure HVAC /generators with locked gates/fence |
| 46 Mark all exterior doors with reflective numbering | |
| 47 Visitor check-in signage at all exterior doors | |
- * Refer to page 1.7 for Unifier locations inside building.

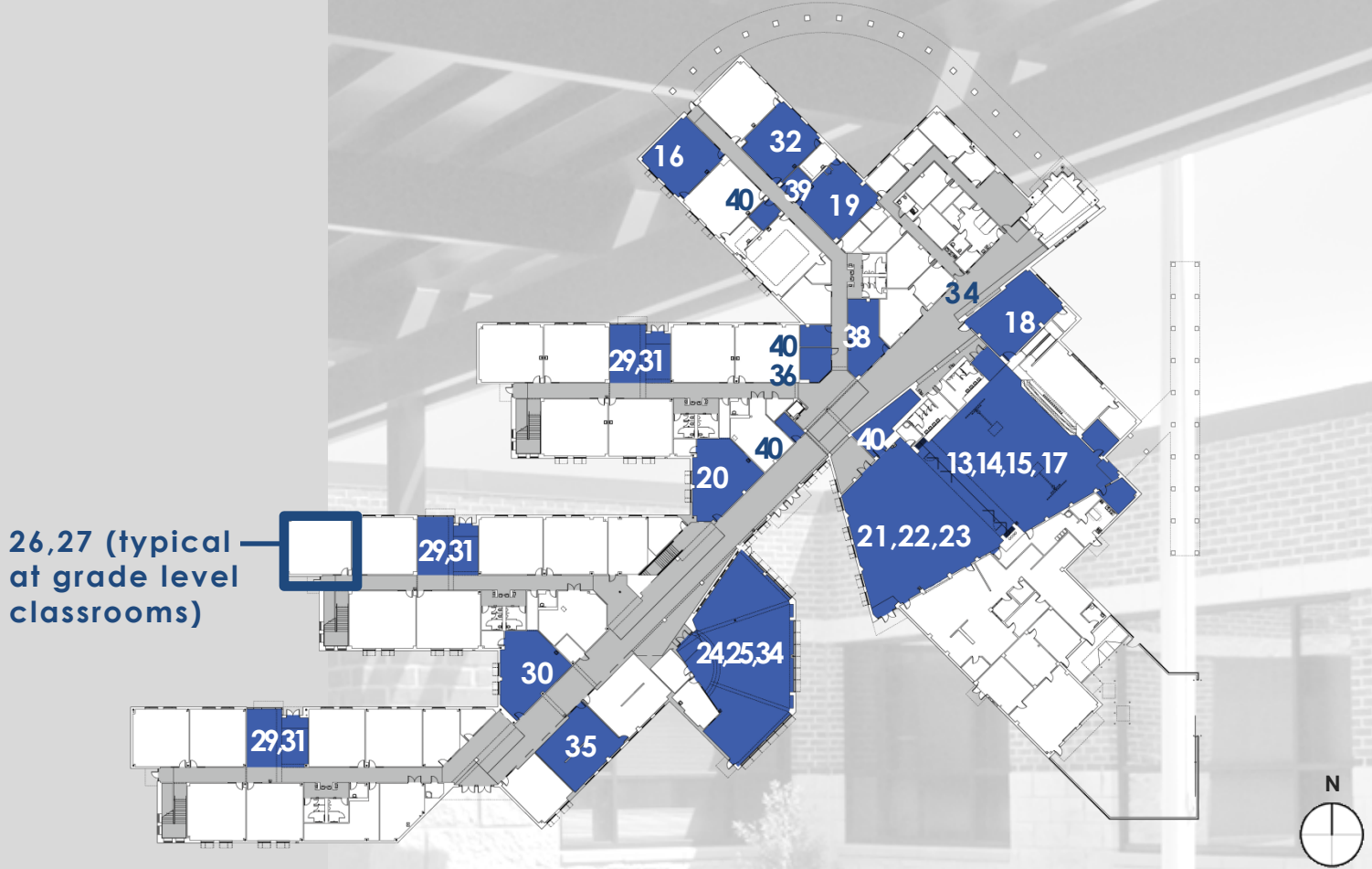

EXISTING FACILITY INTERIOR UNIFIERS (first floor)

- | | |
|--|--|
| 13 Indoor gym/play space for physical education | 27 Natural light in every classroom |
| 14 Gym Office | 28 350 SF space for RTI, small group instruction |
| 15 Storage for P.E. equipment | 29 Student instructional flex space per grade level |
| 16 Motor Lab with storage | 30 Adult instructional, flexible collaborative spaces |
| 17 Gym sound system | 31 Magnetic instructional wall boards |
| 18 750 min. SF music room | 32 Parent training workroom |
| 19 750 min. SF Art lab with water | 33 Wireless access points – one per classroom |
| 20 750 SF min. Science lab with water | 34 Web-based kiosks for learning |
| 21 Cafeteria core space capacity | 35 One computer lab ; 30 workstations for IT classes |
| 22 Cafeteria sound system | 36 Designated MDF space |
| 23 Cafeteria acoustical treatment | 37 Large staff meeting space |
| 24 Library core space capacity | 38 Faculty lounge w/ ice, refig, tables, chairs, etc. |
| 25 Library secure access | 39 Secure space for testing materials w/ computer |
| 26 Two dry erase boards in majority of classrooms | 40 Secure storage space for general materials |

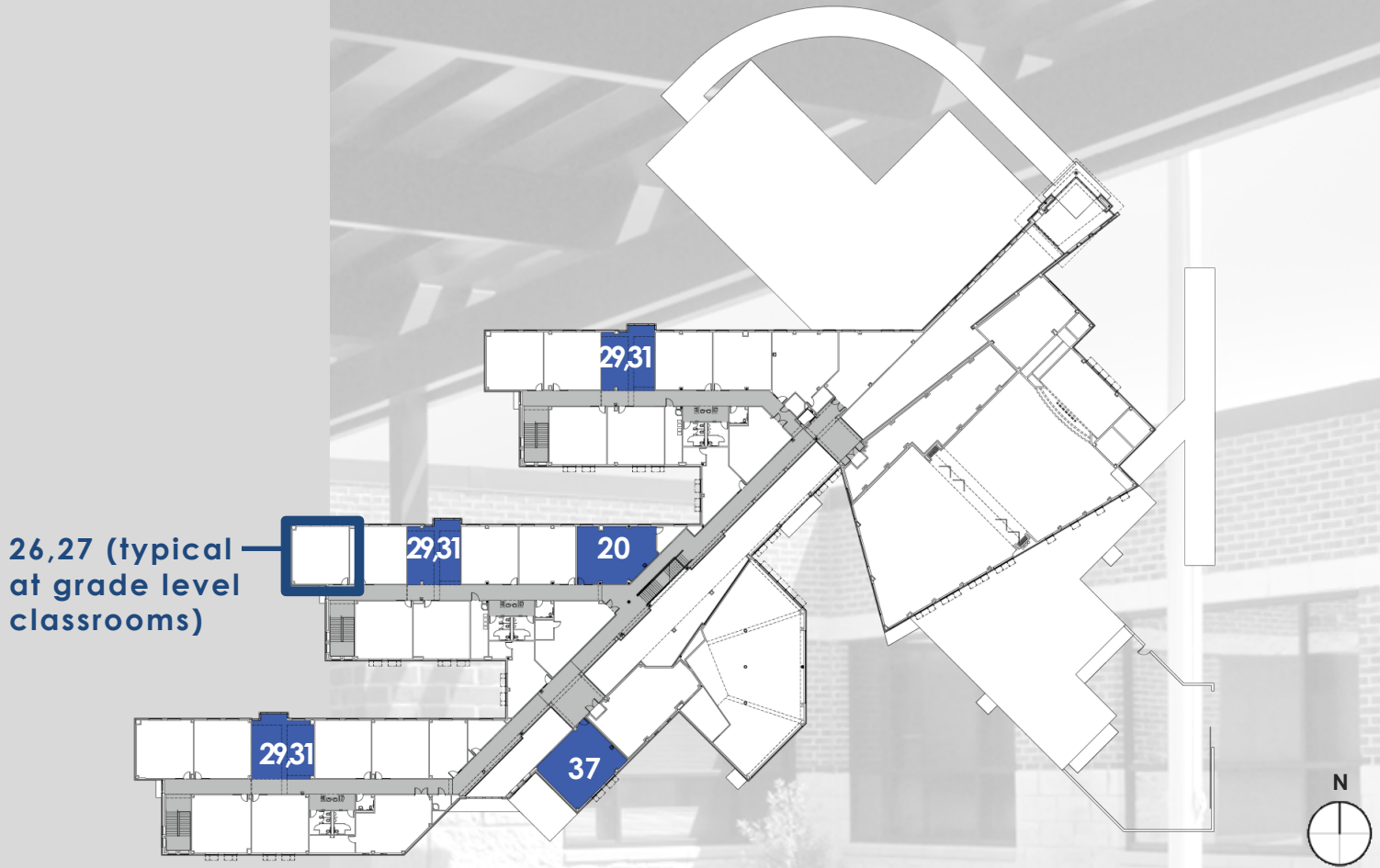

EXISTING FACILITY INTERIOR UNIFIERS (second floor)

- | | |
|--|--|
| 13 Indoor gym/play space for physical education | 27 Natural light in every classroom |
| 14 Gym Office | 28 350 SF space for RTI, small group instruction |
| 15 Storage for P.E. equipment | 29 Student instructional flex space per grade level |
| 16 Motor Lab with storage | 30 Adult instructional, flexible collaborative spaces |
| 17 Gym sound system | 31 Magnetic instructional wall boards |
| 18 750 SF min. music room | 32 Parent training workroom |
| 19 750 SF min. Art lab with water | 33 Wireless access points – one per classroom |
| 20 750 SF min. Science lab with water | 34 Web-based kiosks for learning |
| 21 Cafeteria core space capacity | 35 One computer lab ; 30 workstations for IT classes |
| 22 Cafeteria sound system | 36 Designated MDF space |
| 23 Cafeteria acoustical treatment | 37 Large staff meeting space |
| 24 Library core space capacity | 38 Faculty lounge w/ ice, refig, tables, chairs, etc. |
| 25 Library secure access | 39 Secure space for testing materials w/ computer |
| 26 Two dry erase boards in majority of classrooms | 40 Secure storage space for general materials |

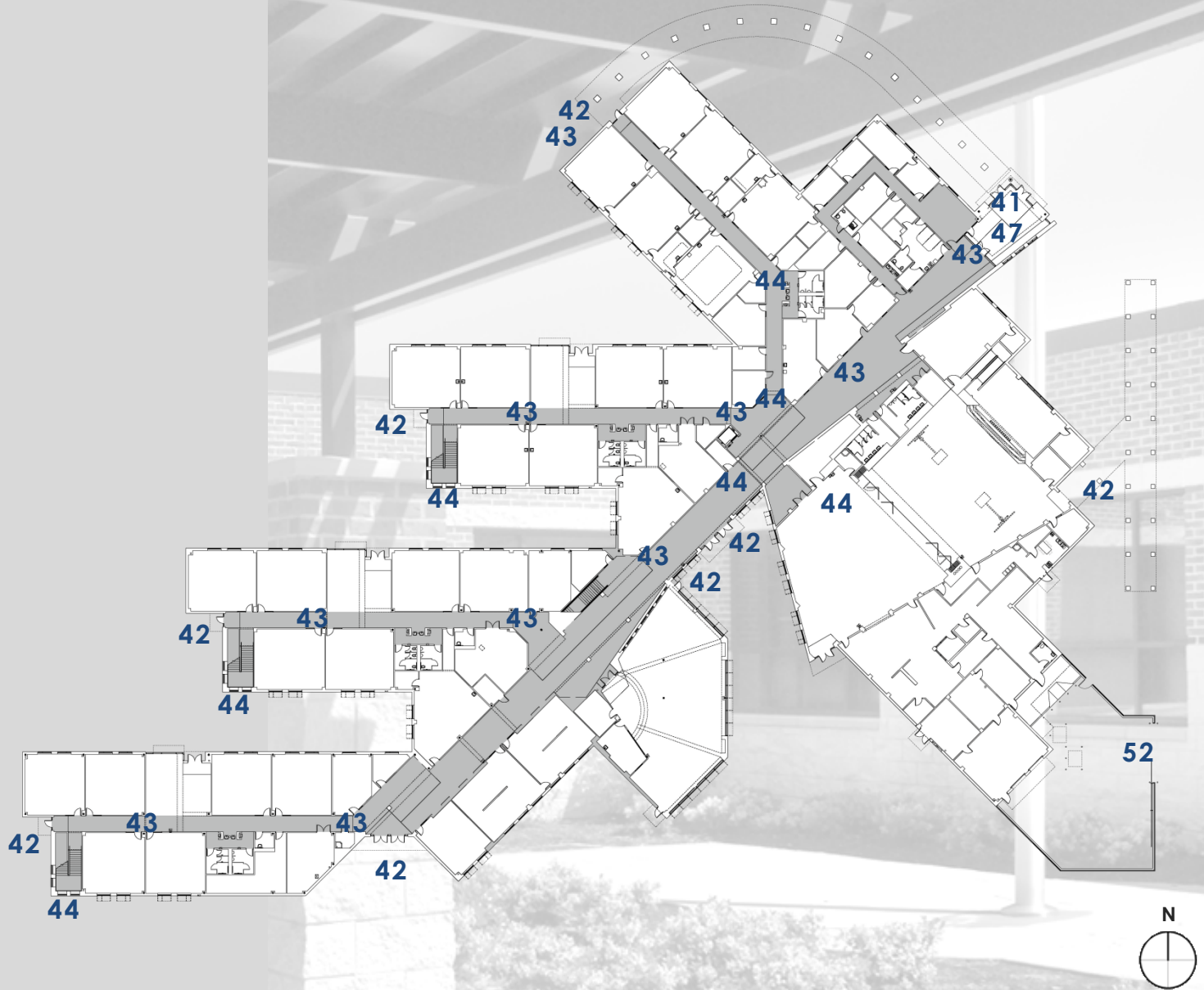

EXISTING SAFETY AND SECURITY UNIFIERS (interior)

- | | |
|---|---|
| 41 Security vestibule with direct access to the office | 48 Traffic flow signage for cars and buses * |
| 42 Access control on all exterior doors (Not all) | 49 Parking area signage for cars * |
| 43 Interior security cameras on all exterior doors (Not all) | 50 Drug, alcohol, tobacco, & weapons free zone signs |
| 44 Security cameras for student management | 51 Secure perimeter around playgrounds * |
| 45 Parking lot lighting * | 52 Secure HVAC /generators w/ locked gates/fence * |
| 46 Mark all exterior doors with reflective numbering | |
| 47 Visitor check-in signage at all exterior doors (Not all) | * Refer to page 1.5 for Unifier locations outside building. |

RECOMMENDED UNIFIERS

Site

- 1 Exercise path
- 8 Outdoor community hardtop courts
- 11 Auto stacking (proper capacity to ensure no vehicles in thoroughfare)
- 12 Open air basketball pavilion

Facility Interior

- 28 Space for RTI, small group instruction (350 SF)
- 33 One wireless access point in each classroom

Safety & Security

- 42 Access control on all exterior doors
- 43 Interior security cameras on all exterior doors
- 46 Mark all exterior doors with reflective numbering signage
- 47 Visitor check-in signage at all exterior doors
- 50 Drug, alcohol, tobacco, and weapons free zone signage

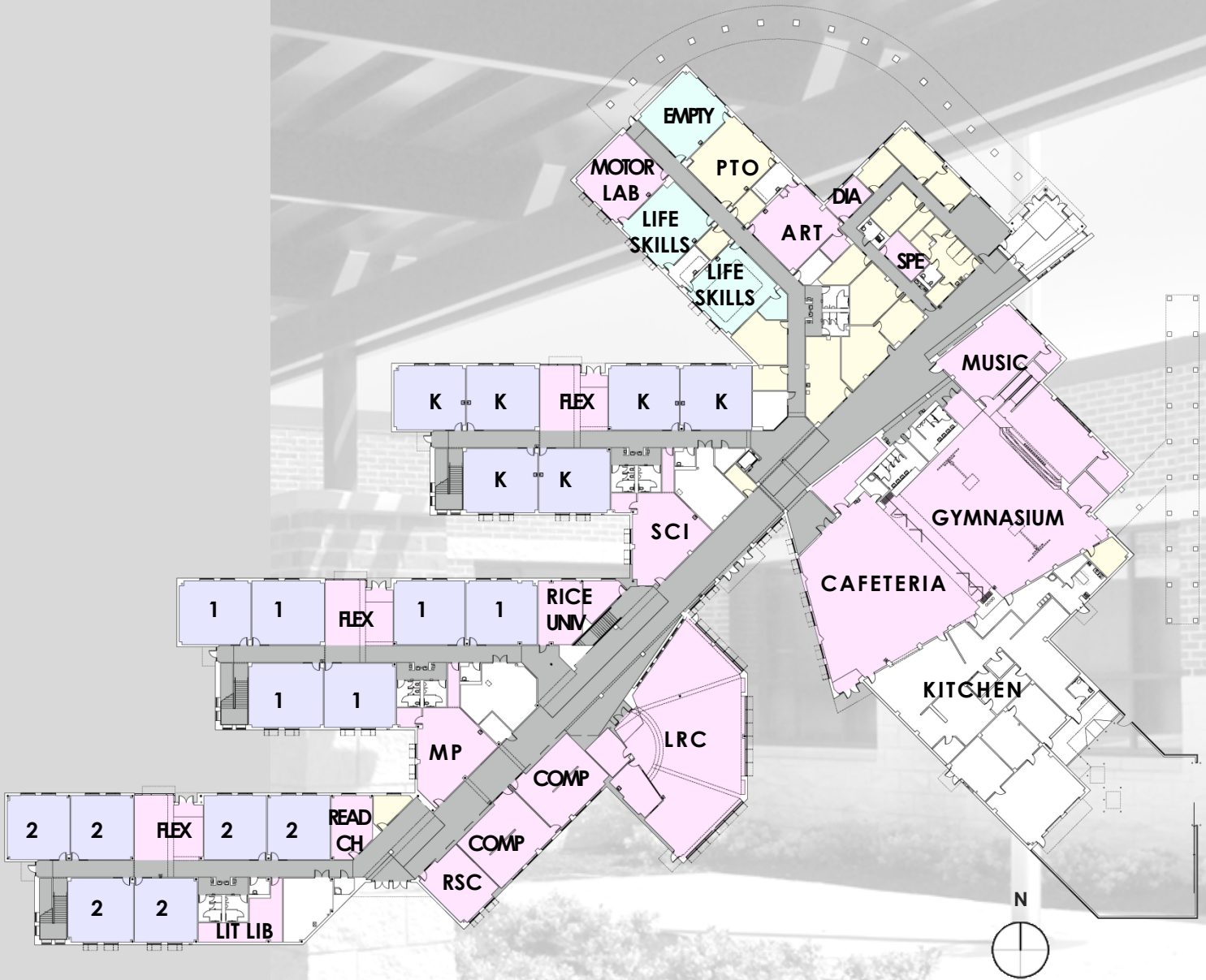

RECOMMENDED PROGRAMMATIC USE (first floor) **NO CHANGE**

PLAN LEGEND:

- Grade Classrooms (K-5)
- Cluster Programs
- Support Programs
- Administration

ACRONYMS:

- CH Coach
- COMP Computer
- DIA Diagnostician
- LIB Library
- LIT Literacy
- LRC Learning Resource Center
- MP Multipurpose
- PTO Parent/Teacher Organization
- RSC Resource
- RTI Response to Intervention
- SPE Speech

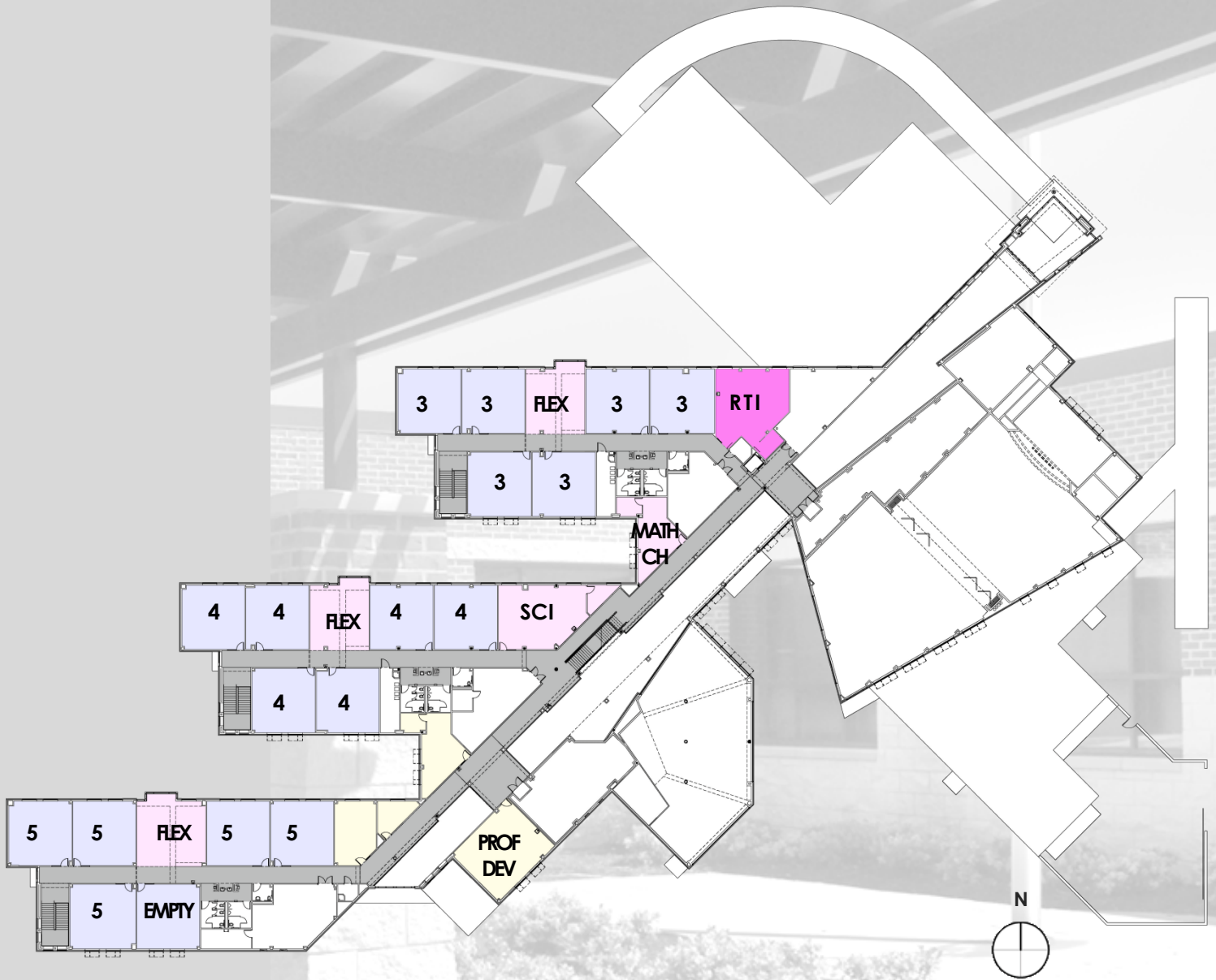

RECOMMENDED PROGRAMMATIC USE (second floor)

PLAN LEGEND:

- Grade Classrooms (K-5)
- Cluster Programs
- Support Programs
- Administration

ACRONYMS:

- CH** Coach
- DEV** Development
- SCI** Science



RECOMMENDED SITE UNIFIERS

- | | |
|---|--|
| 1 Exercise path | 7 Outdoor learning space (Relocated) |
| 2 ADA access. playground equipment (Relocated) | 8 Open community hardtop courts |
| 3 K-2 playground equipment | 9 Play field |
| 4 3-5 playground equipment | 10 Sufficient parking spaces |
| 5 Curriculum based learning tool (Science) | 11 Stacking for cars off thoroughfare |
| 6 Curriculum based learning tool (Math) | 12 Open air basketball pavilion |

RECOMMENDED SAFETY AND SECURITY UNIFIERS (exterior)

- | | |
|---|---|
| 41 Security vestibule w/ direct access to the office | 48 Traffic flow signage for cars and buses |
| 42 Access control on all exterior doors * | 49 Parking area signage for cars |
| 43 Interior security cameras on all exterior doors * | 50 Drug, alcohol, tobacco, weapons free zone signs |
| 44 Security cameras for student management | 51 Secure perimeter around playgrounds |
| 45 Parking lot lighting | 52 Secure HVAC /generators with locked gates/fence |
| 46 Mark all exterior doors with reflective numbering * | |
| 47 Visitor check-in signage at all exterior doors * | |
- * Refer to page 1.12 for Unifier locations inside building.

33 (typical at grade level classrooms)

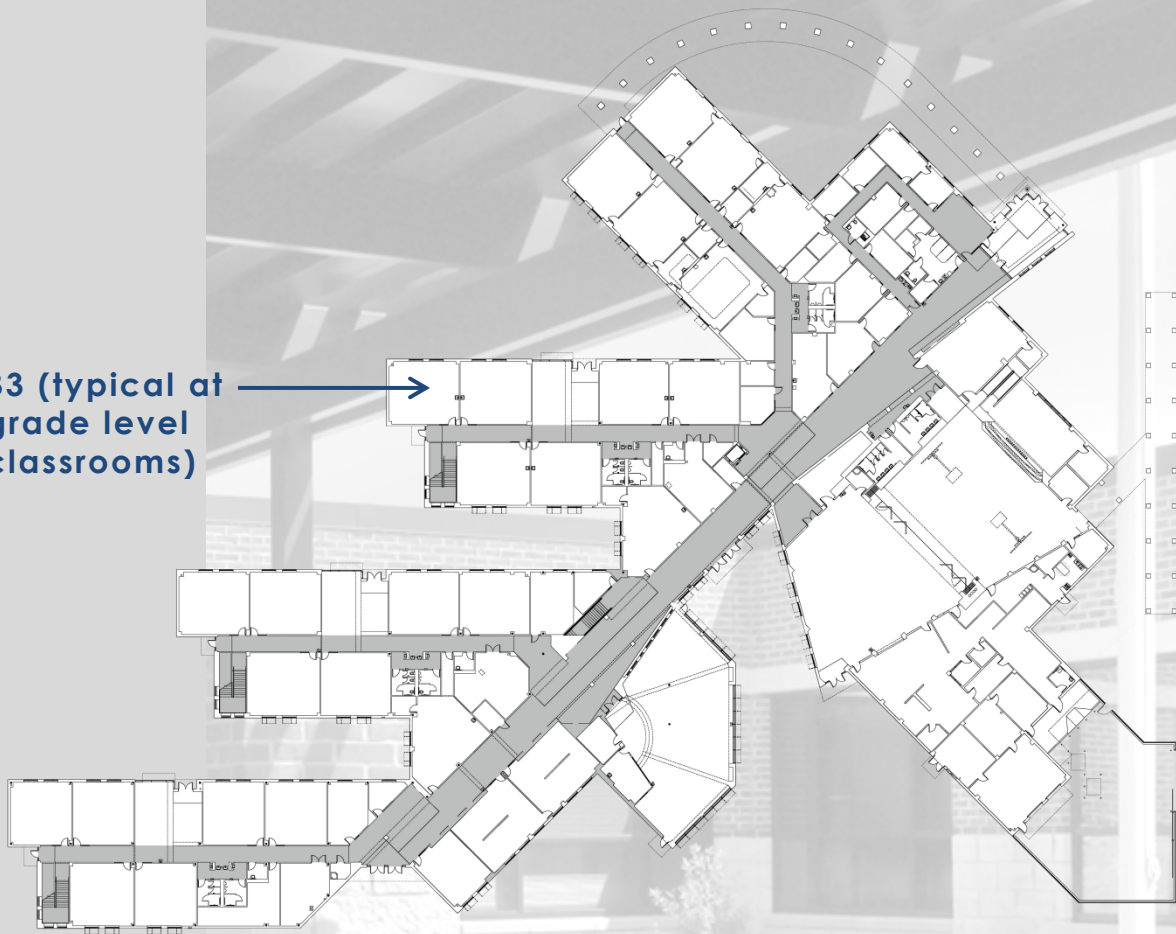

RECOMMENDED FACILITY INTERIOR UNIFIERS (first floor)

- | | |
|---|---|
| 13 Indoor gym/play space for physical education | 27 Natural light in every classroom |
| 14 Gym Office | 28 350 SF space for RTI, small group instruction |
| 15 Storage for P.E. equipment | 29 Student instructional flex space per grade level |
| 16 Motor Lab with storage | 30 Adult instructional, flexible collaborative spaces |
| 17 Gym sound system | 31 Magnetic instructional wall boards |
| 18 750 SF min. music room | 32 Parent training workroom |
| 19 750 SF min. Art lab with water | 33 Wireless access points – one per classroom |
| 20 750 SF min. Science lab with water | 34 Web-based kiosks for learning |
| 21 Cafeteria core space capacity | 35 One computer lab ; 30 workstations for IT classes |
| 22 Cafeteria sound system | 36 Designated MDF space |
| 23 Cafeteria acoustical treatment | 37 Large staff meeting space |
| 24 Library core space capacity | 38 Faculty lounge w/ ice, refig, tables, chairs, etc. |
| 25 Library secure access | 39 Secure space for testing materials w/ computer |
| 26 Two dry erase boards in majority of classrooms | 40 Secure storage space for general materials |

33 (typical at grade level classrooms)

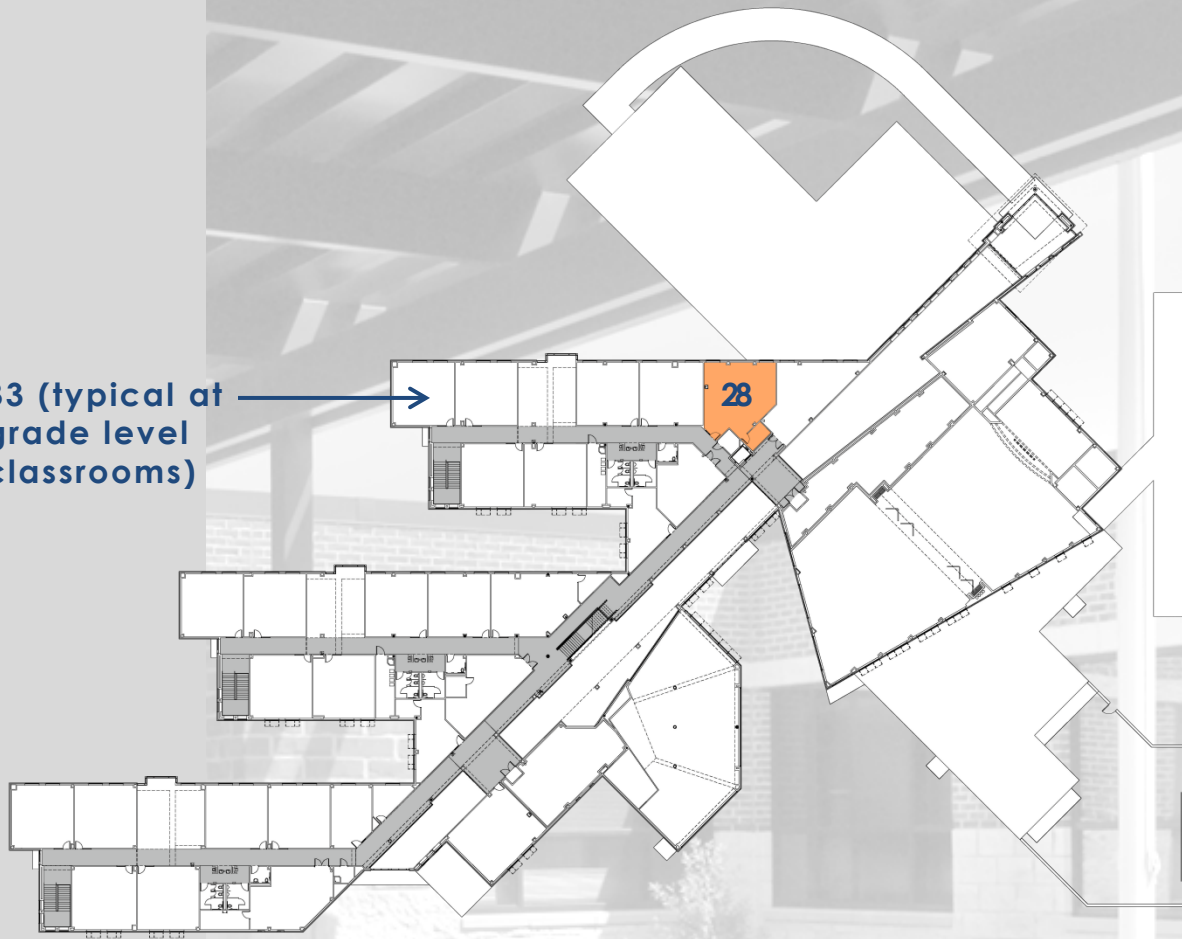

RECOMMENDED FACILITY INTERIOR UNIFIERS (second floor)

- | | |
|---|---|
| 13 Indoor gym/play space for physical education | 27 Natural light in every classroom |
| 14 Gym Office | 28 350 SF space for RTI, small group instruction |
| 15 Storage for P.E. equipment | 29 Student instructional flex space per grade level |
| 16 Motor Lab with storage | 30 Adult instructional, flexible collaborative spaces |
| 17 Gym sound system | 31 Magnetic instructional wall boards |
| 18 750 SF min. music room | 32 Parent training workroom |
| 19 750 SF min. Art lab with water | 33 Wireless access points – one per classroom |
| 20 750 SF min. Science lab with water | 34 Web-based kiosks for learning |
| 21 Cafeteria core space capacity | 35 One computer lab ; 30 workstations for IT classes |
| 22 Cafeteria sound system | 36 Designated MDF space |
| 23 Cafeteria acoustical treatment | 37 Large staff meeting space |
| 24 Library core space capacity | 38 Faculty lounge w/ ice, refig, tables, chairs, etc. |
| 25 Library secure access | 39 Secure space for testing materials w/ computer |
| 26 Two dry erase boards in majority of classrooms | 40 Secure storage space for general materials |

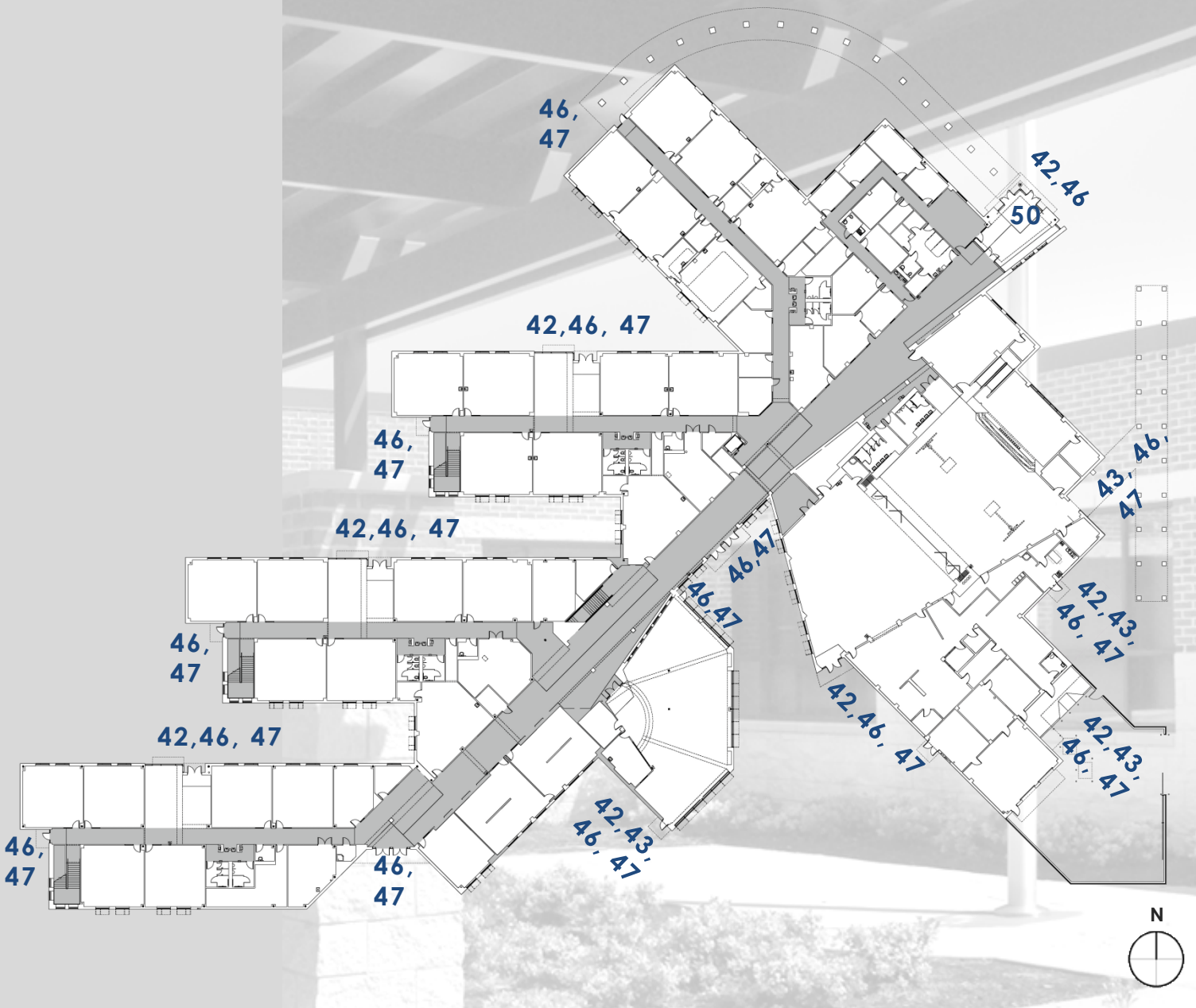

RECOMMENDED SAFETY AND SECURITY UNIFIERS (interior)

- 41 Security vestibule with direct access to the office
 - 42 Access control on all exterior doors
 - 43 Interior security cameras on all exterior doors
 - 44 Security cameras for student management
 - 45 Parking lot lighting
 - 46 Mark all exterior doors with reflective numbering
 - 47 Visitor check-in signage at all exterior doors
 - 48 Traffic flow signage for cars and buses
 - 49 Parking area signage for cars
 - 50 Drug, alcohol, tobacco, weapons free zone signs *
 - 51 Secure perimeter around playgrounds
 - 52 Secure HVAC /generators w/ locked gates/fence
- * Refer to pg 1.10 for Unifier locations outside building.

SITE ESTIMATE

Description		Unit Cost	Unit	Quantity	Total Cost Aug 2012 <i>(Incl soft cost)</i>	Total Cost Jan 2013 <i>(Incl soft cost)</i>	Total Cost Jan 2014 <i>(Incl soft cost)</i>
Site							
1	Exercise path - (6' wide x est. 1/4 mile, 2" asphalt surface, with 6" conc curb and 6" base)	\$98,000.00	Allowance	1	\$98,000	\$100,940	\$108,006
2	ADA accessible playground equipment - (one unit and access)	\$10,000.00	Ea.		\$0	\$0	\$0
3	K-2 playground equipment	\$50,000.00	Ea.		\$0	\$0	\$0
4	3-5 playground equipment	\$50,000.00	Ea.		\$0	\$0	\$0
5	Curriculum based learning tool (Science)	Incl in outdoor learning spaces line item below					
6	Curriculum based learning tool (Math)						
7	Outdoor learning spaces	\$95,000.00	Allowance		\$0	\$0	\$0
8	Outdoor community hardtop courts - asphalt surface	\$17,000.00	Ea.	1	\$17,000	\$17,510	\$18,736
9	Play field (minor grading, hydromulch and backstop)	\$10,000.00	Ea.		\$0	\$0	\$0
10	Sufficient parking spaces (does not Incl lights or drainage)	\$2,550.00	Space		\$0	\$0	\$0
11	Stacking for cars off thoroughfare (does not Incl lights or drainage)	\$8.00	Sqft	9500	\$76,000	\$78,280	\$83,760
12	Open air basketball pavilion (mtl. structure and conc. surface)	\$185,000.00	Ea.	1	\$185,000	\$190,550	\$203,889
SITE TOTAL ESTIMATE					\$376,000	\$387,280	\$414,390





ATASCOCITA SPRINGS ELEMENTARY SCHOOL

UTILIZATION & UNIFIERS STUDY

FACILITY INTERIOR ESTIMATE

Description		Unit Cost	Unit	Quantity	Total Cost Aug 2012 (Incl soft cost)	Total Cost Jan 2013 (Incl soft cost)	Total Cost Jan 2014 (Incl soft cost)
Gymnasium							
13	Indoor play space for physical education						
14	Office						
15	Storage for p.e. equipment						
16	Motor Lab with storage						
17	Sound system						
	Gymnasium Building Addition (unit cost assumes gymnasium type construction cost and tie-in to existing building)	\$210.00Sqft			\$0	\$0	\$0
Specialty Instructional Spaces							
18	Music room ~ minimum of 750 sq ft						
19	Art room with water ~ minimum of 750 sq ft						
20	Science lab w/ water ~ minimum of 750 sq ft						
	Specialty Instructional Spaces Building Addition (unit cost assumes small scale classroom type construction cost and tie-in to existing building)	\$185.00Sqft			\$0	\$0	\$0
Cafeteria							
21	Core space capacity - (unit cost assumes small scale cafeteria type construction cost and tie-in to existing building)	\$210.00Sqft			\$0	\$0	\$0
22	Sound system	\$15,000.00LS			\$0	\$0	\$0
23	Acoustical treatment	\$12.00Sqft			\$0	\$0	\$0
Library							
24	Core space capacity - Cost to include renovation of adjacent space and small scale addition to off-set captured space.		LS		\$0	\$0	\$0
25	Secure access - unit cost assumes enclosing library with walls to 9' high as needed (mtl stud, gyp bd, VWC).	\$75.00	Lnft @ 9' high		\$0	\$0	\$0
Instructional Classrooms							
26	Two dry erase boards in majority of classrooms - 12'x4'	\$500.00Ea.			\$0	\$0	\$0
27	Natural light in every classroom - 21" Solar Tube, roof curb, trim at existing location.	\$2,500.00Ea.			\$0	\$0	\$0
Collaborative/Flexible spaces							
28	Space for RTI, small group instruction ~ minimum of 350 sq ft						
29	Student instructional planning & collab space per grade level						
30	Adult instructional, flexible collaborative spaces (Prof Dev)						
31	Magnetic instructional wall boards in flex collaborative spaces - 12'x4'	\$1,750.00Ea.			\$0	\$0	\$0
32	Designated PTO/PTA workroom						
	General Building Addition Required to address Collaborative/Flexible Space Needs (unit cost assumes small scale classroom type construction cost and tie-in to existing building. Square foot total is total additional sqft required to address needs noted above.)	\$185.00Sqft			\$0	\$0	\$0
Technology							
33	Wireless access points - one per classroom	\$1,500.00Ea.		36	\$59,400	\$61,182	\$65,465
34	Web-based kiosks for learning (quantity based on capacity)	\$7,500.00Ea.			\$0	\$0	\$0
35	One computer lab with 30 workstations for IT classes - cost includes adding station to existing lab.	\$350.00Per Station			\$0	\$0	\$0
36	Designated MDF space - Create enclosure at each location and add dedicated HVAC unit.	\$35,000.00Ea.			\$0	\$0	\$0
Other							
37	Large mtg space (size dependent on capacity 65-100 staff)						
38	Faculty lounge w/ice, dishwasher, refrigerator and tables/chairs	\$1,100.00Ea.	Appliance		\$0	\$0	\$0
39	Secure space for testing materials with workspace & computer						
40	Secure storage space for instructional/general materials						
	General Building Addition Required to address "Other" Space Needs (unit cost assumes small scale general type construction cost and tie-in to existing building. Square foot total is total additional sqft required to address needs noted above.)	\$185.00Sqft			\$0	\$0	\$0
FACILITY INTERIOR TOTAL ESTIMATE					\$59,400	\$61,182	\$65,465



SAFETY AND SECURITY ESTIMATE

Description	Unit Cost	Unit	Quantity	Total Cost Aug 2012 <i>(Incl soft cost)</i>	Total Cost Jan 2013 <i>(Incl soft cost)</i>	Total Cost Jan 2014 <i>(Incl soft cost)</i>
Safety and Security						
41 Security vestibule with direct access to the office - cost assumes wall modifications, new walls, additional doors, additional lighting as needed, access control, and casework modifications. The estimated cost could vary per location.	\$50,000.00 Ea.			\$0	\$0	\$0
42 Access control on all exterior doors	\$5,000.00 Ea.		8	\$44,000	\$45,320	\$48,492
43 Interior security cameras on all entry doorways - Fixed Camera	\$3,500.00 Ea.		4	\$15,400	\$15,862	\$16,972
44 Security cameras for student management	\$3,500.00 Ea.			\$0	\$0	\$0
45 Parking lot lighting	\$3,500.00 Ea.			\$0	\$0	\$0
Signage						
46 Mark exterior doors with reflective numbering - wall plaque	\$40.00 Ea.		19	\$836	\$861	\$921
47 Visitor check-in - wall plaque	\$40.00 Ea.		15	\$660	\$680	\$727
48 Traffic flow for cars and buses - two post sign	\$250.00 Ea.			\$0	\$0	\$0
49 Parking areas for cars - two post sign	\$250.00 Ea.			\$0	\$0	\$0
50 Drug, alcohol, tobacco and weapons free zone - two post sign	\$250.00 Ea.		3	\$825	\$850	\$909
Fencing and Skirting						
51 Secure perimeter around playgrounds	\$9.00 Lnft			\$0	\$0	\$0
52 Secure HVAC and generators with locked gate/fencing	\$12.50 Lnft			\$0	\$0	\$0
SAFETY AND SECURITY TOTAL ESTIMATE				\$61,721	\$63,573	\$68,023
Miscellaneous						
Drug, alcohol, tobacco and weapons free zone - wall plaque	\$40.00 Ea.		1	\$44	\$45	\$48
MISCELLANEOUS TOTAL ESTIMATE				\$44	\$45	\$48
CAMPUS TOTAL				\$497,165	\$512,080	\$547,926

