

CASE

CONSTRUCTION



ATTACHMENTS FOR BACKHOE LOADERS

Tavinder Arora
Aftermarket Solutions

Contains confidential proprietary and trade secrets information of CNH Industrial. Any use of this work without express written consent is strictly prohibited.

CNH
INDUSTRIAL

18th November 2020

Loader Side Attachments



TABLE OF CONTENTS

Loader Side Attachments

Quick Coupler

1. Quick Coupler p.5

Buckets

2. Loader Side Buckets p.8
3. 4-in-1 Buckets p.10
4. 6-in-1 Buckets p.12
5. Light Material Buckets p.13
6. Side Dump Buckets p.14
7. High Dump Buckets p.15
8. Screening Buckets p.16

Forks

9. Pallet Forks p.19
10. Hook-on Forks p.20

Auger

11. Auger Drive and Bits p.22

Sweeper

12. Collector Sweeper p.30
13. Angle Broom p.32

Grapples

14. Grapple Bucket p.36
15. Grapple Bucket/Rake p.37
16. Manure Fork and Grab p.38
17. Scrap Grapple p.39
18. Grapple Forks p.40
19. Log Grapple p.41
20. Single Top Clamp Forks p.42
21. Double Top Clamp Forks p.43
22. Paddle Top Clamp Forks p.44
23. Loader Rake p.45
24. Stacking Rake p.46

Tree Attachments

25. Tree Spade p.48

Pole Planter

26. Pole Planter p.50

Snow Attachments

27. Snow Blower p.52
28. Snow Push p.54
29. Snow Blade p.55
30. Snow Plow p.56
31. V-Blade p.57

Agriculture Attachments

32. Bale Spear p.60
33. Box Scraper p.61

Misc Attachments

34. Boom p.62
35. Dozer Blade p.63
36. Grader p.64

Loader Side Attachments – Quick Coupler



Quick Coupler

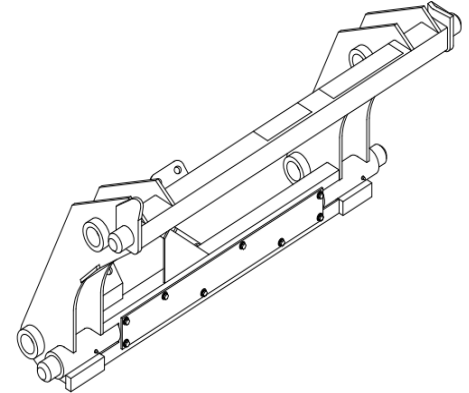



SPECIFICATIONS & FEATURES

Suitable for 570T/ST, B80B, 700, 770 EX 770 EX Magnum & 851EX

- Includes hydraulic Installation kit which utilizes existing loader hydraulics
- Load center of gravity is moved forward a maximum of 2" from the original pin-on position
- Female blank adapters - for existing attachments with straight back profile
- Third function jumper hose kit required to connect third function loader lines to coupler
- Allows for easy and precise adjustment of roll back stops
- Ensures proper interface between coupler and loader arms to help prevent coupler failure
- Equipped with push-block design which transmits shock loads through the loader
- Creates smooth coupling and uncoupling transitions on uneven terrain

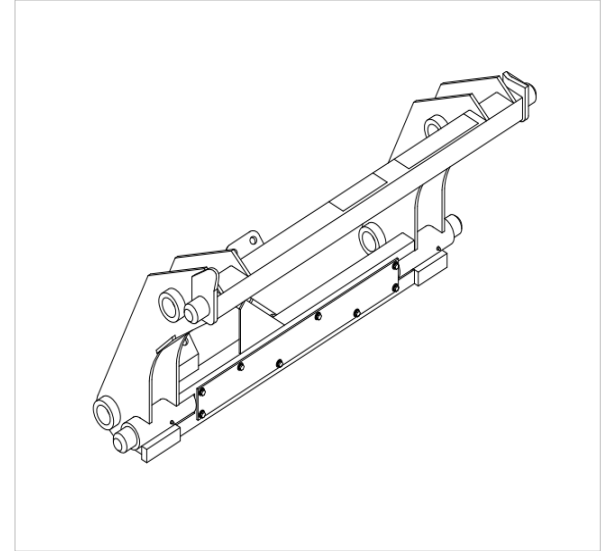

Quick Coupler



Mechanical Quick Coupler

Suitable for	Class	Description	CNHi Part Code	Weight
Case Backhoe Loaders (Loader end)	100	Mechanical Coupler	CNHi-100M	315 Lbs.

Hydraulic Quick Coupler

Suitable for	Class	Description	CNHi Part Code	Weight
Case Backhoe Loaders (Loader end)	100	Hydraulic Actuated Coupler	CNHi-100HV	400 Lbs.



Loader Side Attachments – Buckets

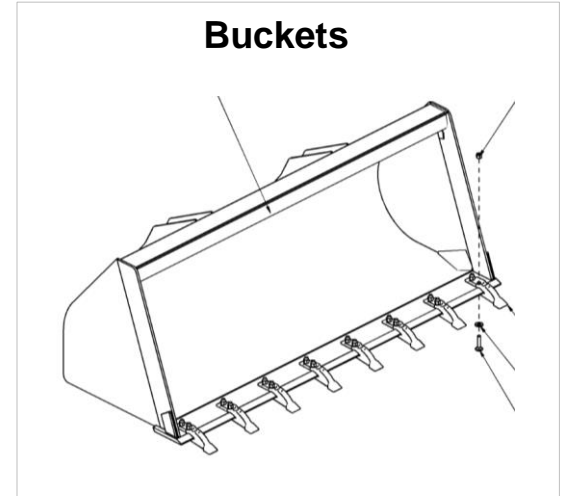

Loader Side Buckets

Standard Buckets – 570T/ST, 770 EX & 851EX



SPECIFICATIONS & FEATURES

- Bolt-on-Teeth
- Capacities Offered (cubic meter) – 1.0, 1.1 & 1.2
- Buckets offered for both Straight Loader Arm and Bend/Tool Carrier Loader Arm

Loader Side Buckets suitable for 570T, 570ST, B80B, 770, 770EX, 770EX MAG, 851EX					
Part Number	Capacity (Cubic Meter)	Width	Loader Arm Type	Tooth	No. of Teeth
47702523	1.0	90"	Standard/Straight	With Bolt on Teeth	8
51494866	1.0	90"	Bend / Tool Carrier Loader Arm	With Bolt on Teeth	8
47748493	1.1	90"	Standard/Straight	With Bolt on Teeth	8
51494869	1.1	90"	Bend / Tool Carrier Loader Arm	With Bolt on Teeth	8
47753280	1.2	90"	Standard/Straight	Without Tooth	NA
47721391	1.2	90"	Standard/Straight	With Bolt on Teeth	8
51494876	1.2	90"	Bend / Tool Carrier Loader Arm	Without Tooth	NA
51494872	1.2	90"	Bend / Tool Carrier Loader Arm	With Bolt on Teeth	8

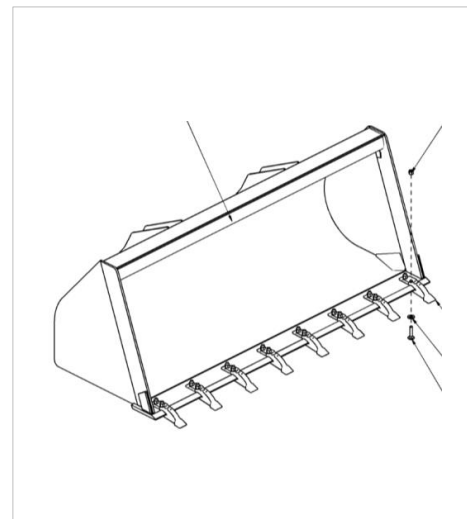

Loader Side Buckets

Standard Buckets – 580T/ST, 590ST & 695ST



SPECIFICATIONS & FEATURES

- Light but strong design to optimize machine performances
- Option Common Teeth available
- Capacity 1,00m³ (2250mm); 1,15m³ (2400mm)
- Available for 2 and 4 Wheels Steering Machines

Common Tooth



ESCO Tooth

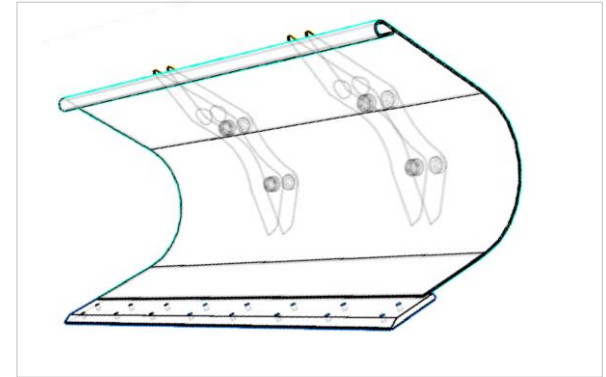
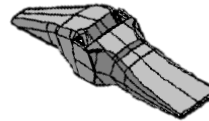

Standard Buckets		Steering	580 T		580 ST		590 ST		695 ST
			Straight Loader Arm	Tool Carrier	Straight Loader Arm	Tool Carrier	Straight Loader Arm	Tool Carrier	Tool Carrier
2250 mm	Welded Cutting Edge	2WS	85801040	87541320	85801040	87541320	85801040	87541320	-
	Bolted Common Teeth	2WS	37302070	47352249	37302070	47352249	37302070	47352249	-
	Welded ESCO Teeth	2WS	-	48067423	-	48067423	-	48067423	-
2400mm	Welded Cutting Edge	2WS & 4WS	-	85818863	-	85818863	-	85818863	85818863
	Bolted Common Teeth	2WS & 4WS	-	37306380	-	37306380	-	37306380	37306380
	Welded ESCO Teeth	2WS & 4WS	-	48067426	-	48067426	-	48067426	48067426

Loader Side Buckets

4-in-1 – 570T/ST, 770EX & 851EX



SPECIFICATIONS & FEATURES

- Ideal for site clean-up, grading, scraping, grappling, dozing, and brush removal
- Bolt-on-Teeth
- Capacities Offered – 1.0 cubic meter
- Buckets offered for both Straight Loader Arm and Bend/Tool Carrier Loader Arm

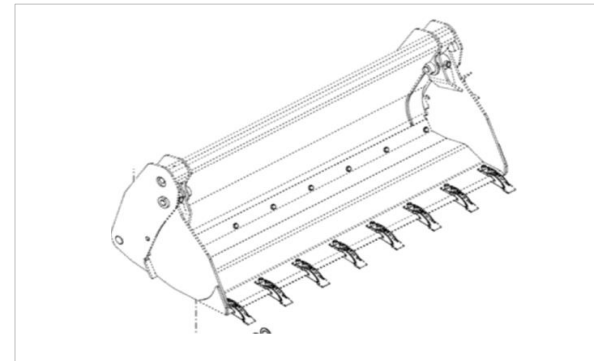

4-in-1 Buckets suitable for 570T, 570ST, B80B, 770, 770EX, 770EX MAG, 851EX

Part Number	Capacity (Cubic Meter)	Width	Loader Arm Type	Tooth	No. of Teeth
47649432	1.0	89"	Standard/Straight	With Bolt on Teeth	8
51486231	1.0	89"	Bend / Tool Carrier Loader Arm	With Bolt on Teeth	8



Loader Side Buckets

4-in-1 Bucket – 580T/ST, 590ST & 695ST



SPECIFICATIONS & FEATURES

- Design allows operator to see the area near the cutting edge
- Very versatile attachment
- Capacity 1,00m³ (2250mm); 1,15m³ (2400mm)
- Available with Cutting Edge or Weld on Teeth
- Connection Hoses included with the Kit
- Available for 2 and 4 Wheels Steering Machines

Common Tooth

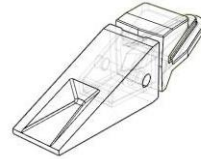

Smart Fit Tooth

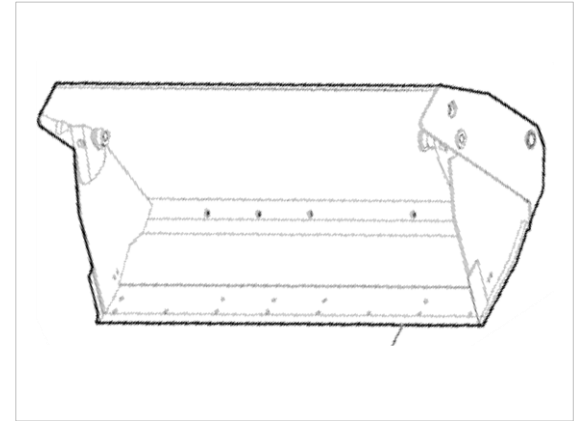

Standard Buckets		Steering	580 T		580 ST		590 ST		695 ST
			Straight Loader Arm	Tool Carrier	Straight Loader Arm	Tool Carrier	Straight Loader Arm	Tool Carrier	Tool Carrier
2250 mm	Bolt On Blade	2WS	48043934	48043025	48043934	48043025	48043934	48043025	-
	Welded Common Teeth	2WS	48043932	-	48043932	-	48043932	-	-
	Welded Smart Fit Teeth	2WS	-	48069328	-	48069328	-	48069328	-
2400mm	Bolt On Blade	2WS & 4WS	-	48043031	-	48043031	-	48043031	48043031
	Welded Smart Fit Teeth	2WS & 4WS	-	48069312	-	48069312	-	48069312	48069312

Loader Side Buckets

6-in-1 Bucket – 580T/ST, 590ST & 695ST



SPECIFICATIONS & FEATURES

- Design allows operator to see the area near the cutting edge
- Very versatile attachment
- Capacity 1,00m³ (2250mm); 1,15m³ (2400mm)
- Available with Cutting Edge or Weld on Teeth
- Connection Hoses included with the Kit
- Available for 2 and 4 Wheels Steering Machines
- Side shift Forks included

Common Tooth

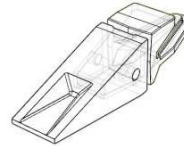

Smart Fit Tooth

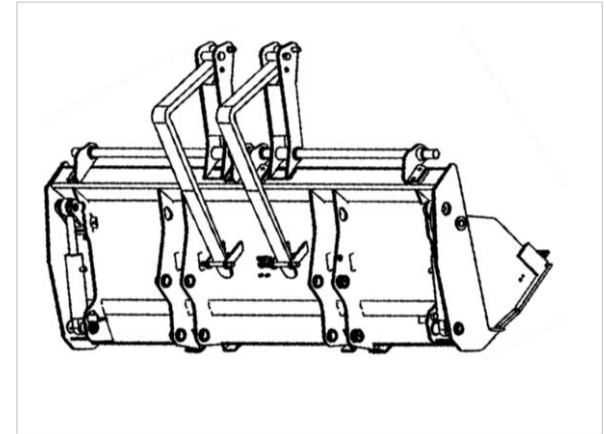

Standard Buckets		Steering	580 T		580 ST		590 ST		695 ST
			Straight Loader Arm	Tool Carrier	Straight Loader Arm	Tool Carrier	Straight Loader Arm	Tool Carrier	Tool Carrier
2250 mm	Bolt On Blade	2WS	48043932	48042838	48043932	48042838	48043932	48042838	-
	Welded Common Teeth	2WS	48043933	-	48043933	-	48043933	-	-
	Welded Smart Fit Teeth	2WS	-	48069332	-	48069332	-	48069332	-
2400mm	Bolt On Blade	2WS	-	48042981	-	48042981	-	48042981	-
		4WS	-	48043029	-	48043029	-	48043029	48043029
	Welded Smart Fit Teeth	2WS & 4WS	-	48069322	-	48069322	-	48069322	48069322

Loader Side Buckets ~ Light Material Buckets



SPECIFICATIONS & FEATURES

- Sloped bottom design allows for maximum fill capabilities and material retention
- Sloped bottom increases dump angle by 5 degree for more efficient dumping capabilities
- Minimum 50 yield steel construction
- Minimum 400 Brinell wear areas
- Optional visibility spill guard available
- Widths and cutting edge hole patterns drilled to OEM standard wear parts specification
- Available as pin-on or compatible with Quick Coupler System



Light Material Bucket		
CNHi Part Number	Weight (Lbs)	Capacity (m3)
CNH-LM-20	1,200	1.53
CNH-LM-25	1,235	1.91
Bolt-on Cutting Edge Included		

Loader Side Buckets ~ Side Dump Bucket



SPECIFICATIONS & FEATURES

- Designed for confined, hard to maneuver areas
- Supports capacity of 1 to 4 cubic yards
- Features left hand dump function (right hand is available upon request)
- Heavy duty design allows for full side dumping and angle backfilling
- Side shoot dumping angle of 45 degrees
- Features the sequence valve for lock/unlock of the bucket cradle and side dump function
- Center mounted lift hooks and bolt-on edges are standard
- Available as pin-on or compatible with JRB's Quick Coupler System
- Third function loader hydraulics and jumper hose kit required for operation



Side Dump Bucket			
CNHi Part Number	Width (Inches)	Weight (Lbs)	Capacity (m3)
CNH-SD-88	106"	1,450	0.67
CNH-LM-100	106"	1,595	0.76
CNH-SD-125	106"	1,835	0.96

Bolt-on Cutting Edge Included



Loader Side Buckets ~ High Dump Bucket



SPECIFICATIONS & FEATURES

- Designed for confined, hard to maneuver areas
- High Dump Bucket with Bolt on Cutting Edge - Capacity - 1.5 Cubic Yard Struck / 1.25 Cubic Yard Struck
- Weight: Approx. 2000 Lbs
- Cylinders: 2.5in Bore x 1.75in Rod x 16in Stroke Cushioned on both ends
- Dump Height Improvement: Dump height clearance is approximately equal to the height of the loader arm pins in the maximum raised position. Incremental dump height improvement is 0.8m (Bucket rolled out fully, tilted back approx. 20 degrees)
- Hoses: All internal hosing is supplied and routed to a central connection block, provided with fittings for connection to the machine. Jump hoses from the machine to the bucket are not provided. The dealer will size and place these during installation.
- Width: Standard width is 94in
- Other Capacities available: Heaped Capacities of 1.25YD, 1.5YD, 1.75YD, and 2YD are available, plus custom sizes.

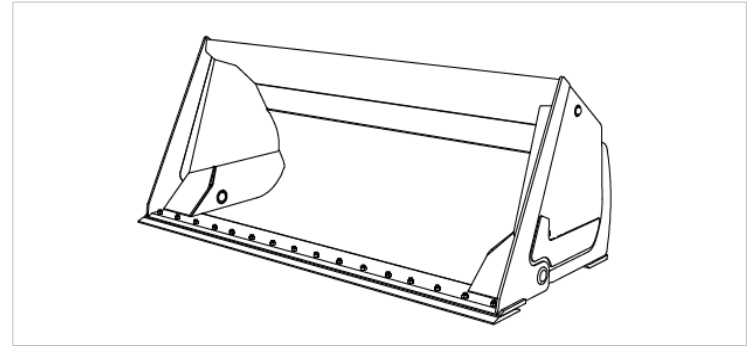

CNHi Part Number	Description
CNHi-HDB-150	High Dump Bucket for TLB/BHL



Loader Side Buckets ~ High Dump Bucket



SPECIFICATIONS & FEATURES

- Designed for confined, hard to maneuver areas
- High Dump Bucket with Bolt on Cutting Edge - Capacity - 1.5 Cubic Yard Struck / 1.25 Cubic Yard Struck
- Weight: Approx. 2000 Lbs
- Cylinders: 2.5in Bore x 1.75in Rod x 16in Stroke Cushioned on both ends
- Dump Height Improvement: Dump height clearance is approximately equal to the height of the loader arm pins in the maximum raised position. Incremental dump height improvement is 0.8m (Bucket rolled out fully, tilted back approx. 20 degrees)
- Hoses: All internal hosing is supplied and routed to a central connection block, provided with fittings for connection to the machine. Jump hoses from the machine to the bucket are not provided. The dealer will size and place these during installation.
- Width: Standard width is 94in
- Other Capacities available: Heaped Capacities of 1.25YD, 1.5YD, 1.75YD, and 2YD are available, plus custom sizes.

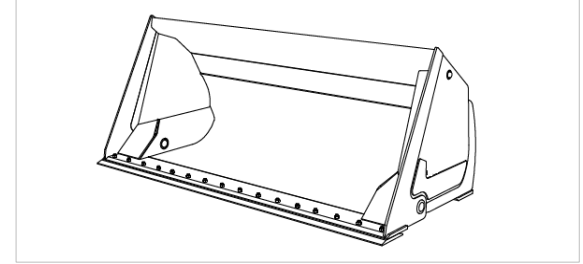

CNHi Part Number	Description
CNHi-HDB-150	High Dump Bucket for TLB/BHL



Loader Side Buckets ~ Screening Buckets



SPECIFICATIONS & FEATURES

- Inlet profile inclined to facilitate loading of the material to be screened
- Perimeter kit available in braided net or perforated sheet
- Integrated high-pressure relief valve that protects the motor against pressure peaks
- Hydraulic components protected by the frame and easy to access for possible inspections
- Double-turn ball bearing to fully support the screening basket

Application:

- Selection of pebbles along watercourses
- Filling of containment cages
- Selection of waste materials after a demolition
- Reclamation of stony soils
- Removal of stones along the beaches
- Separation of organic waste in landfill
- Aggregate recovery in building renovations



Loader Side Attachments – Forks



Forks



Pallet Forks



SPECIFICATIONS & FEATURES

- Tines: 2" x 4" tapered, forged steel, 48-inches of useable tooth
- Adjustment: 8 1/2" wide to 58" overall depth
- Standard brick guard
- Lock in position pin clips
- Solid fork rails
- ITA Class III rating, 8,440 lb. per pair of tines maximum capacity



Suitable for	Category	Part Number	Type	Carriage Width	Tine Length	Weight	Tine Size
Case Backhoe Loaders	Construction Utility Forks for QC Mount	87334961	Manual	60"	48"	364 Kgs	2" x 4"



Hook-on Forks



SPECIFICATIONS & FEATURES

- Suitable to be installed on 1.15m³ Bucket

Part Number	Part Description
87310363	FORK CONVERSION 4X1 TO 6X1 KIT L=2400 Suitable to be installed on 1.15m ³ Bucket

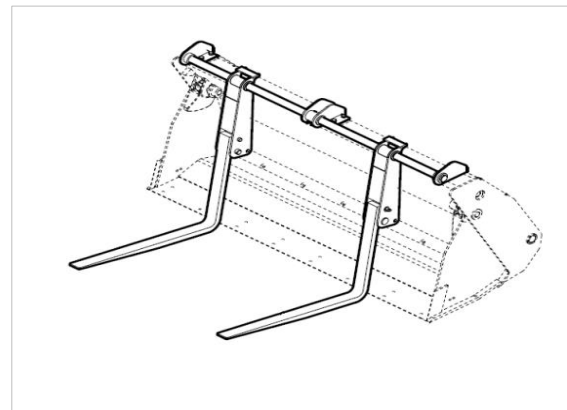

Loader Side Attachments – Augers



**Auger Drive
& Auger Bits**





Specifications	
Auger Model	CNHi-BHL-Auger
Flow (gpm)	28-40
RPM @ max flow	85
Max torque @ max flow and pressure (ft-lb)	5069
Planetary Gear Reduction	6.1:1; Planetary gearbox
Max auger diameter	36"
Output shaft	2" Hex



Auger Drives & Auger Bits

Cont...



Auger Drive Unit - Loader Mount		
CNHi Part Number	Part Description	Weight (Lbs)
87488594	AUGER DRIVE, CNHi-BHL-Dipper-Auger Drive unit with 2" hex output shaft (includes case drain plumbing)	700
Includes Auger Drive Unit, Mounting Bracket, Hoses and Flat Face Disconnects.		

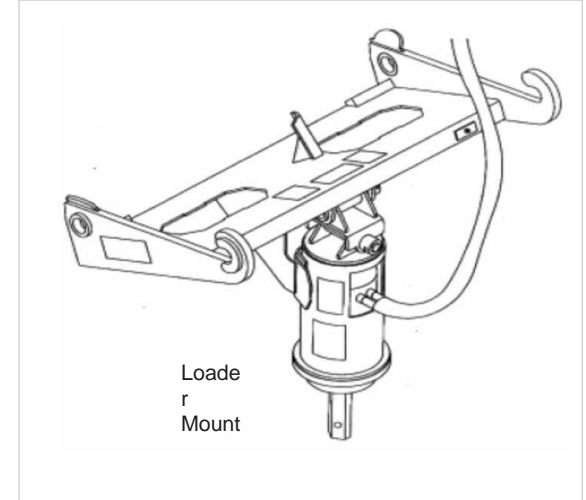

MODEL COMPATIBILITY	570LXT	570MXT	570NXT	580L/580SL/ 590SL	580M	580SM	580SM+	590SM	580N	580SN	580SN WT	590SN	REQ'D EQUIPMENT			
													LOADER AUX. HYD.	QUICK COUPLER	HOSE/ QD KIT	BI-DIR DIPPER AUX. HYD.
AUGER DRIVE, X5075H200 LOADER MOUNT	•	•	•	•	•	•	•	•	•	•	•	•	R	R	R	



HTF STYLE AUGERS

For tree and shrub planting

- Fabricated boring head
- Two-diameter design
- Hardened, bolt-on teeth
- Hardened “fishtail” point
- HD double flighting
- 4' overall length



HTF STYLE AUGERS - 2" Hex Couplers

CNHi Part Number	Description	Weight (Lbs)
9863642	18" X 4' Auger	144
9863643	24" X 4' Auger	198
9863644	30" X 4' Auger	264
9863645	36" X 4' Auger	349



HDF STYLE AUGERS

For light to moderate ground conditions

- Fabricated boring head
- Hardened bolt-on teeth
- Hardened “fishtail” point
- Heavy-duty double flighting
- 4' overall length



HDF STYLE AUGERS - 2" Hex Couplers		
CNHi Part Number	Description	Weight (Lbs)
9863626	6" X 4' Auger	40
9863627	9" X 4' Auger	86
9863628	12" X 4' Auger	115
9863629	15" X 4' Auger	136
9863630	18" X 4' Auger	176
9863631	24" X 4' Auger	278
9863632	30" X 4' Auger	325
9863633	36" X 4' Auger	443



HDC STYLE AUGERS

For difficult ground conditions, compacted soils, heavy clay, asphalt, frozen ground fracturable rock

- HD cast boring head
- Hardened, drive-in teeth
- Hardened “fishtail” point
- Heavy-duty double flighting
- 4' overall length



HDC STYLE AUGERS - 2" Hex Couplers

CNHi Part Number	Description	Weight (Lbs)
9863634	6" X 4' Auger	45
9863635	9" X 4' Auger	98
9863636	12" X 4' Auger	128
9863637	15" X 4' Auger	139
9863638	18" X 4' Auger	204
9863639	24" X 4' Auger	272
9863640	30" X 4' Auger	312
9863641	36" X 4' Auger	430



SRR ROCK AUGERS

For solid, fracturable rock, frozen ground and compacted soils

- Bullet style teeth
- Fabricated boring head
- HD single flighting
- 2" hexagon collar only
- 0.75" thick bottom flight and a hardface outer edge
- 4' overall length



SRR ROCK AUGERS - 2" Hex Couplers

CNHi Part Number	Description	Weight (Lbs)
47904378	6" X 4' Rock Auger	82
47904381	9" X 4' Rock Auger	110
47904382	12" X 4' Rock Auger	137
47904383	16" X 4' Rock Auger	171
47904384	18" X 4' Rock Auger	192
47904385	20" X 4' Rock Auger	239
47904386	24" X 4' Rock Auger	285
47904387	30" X 4' Rock Auger	315
47904388	36" X 4' Rock Auger	414

Auger Drives & Auger Bits



CNHi Part Number	Auger Adapters	Weight (Lbs)
9863646	2" hex female to 2-9/16" round male	16
87042596	2" hex female to 2" round male	10

CNHi Part Number	Auger Extensions	Weight (Lbs)
87042601	12" extension - 2" hex	20
87042602	24" extension - 2" hex	32
84514060	48" extension, 2" hex	57



Loader Side Attachments – Sweepers



Sweepers



Collector Sweeper

Cont...



SPECIFICATIONS & FEATURES

Application:

- Parking lot sweeping; City street sweeping; Construction site clean-up;
- Access road clean-up; County and state road sweeping

Specifications / Features

- CS High Dump Collector Sweeper with floating suspension
- 26" Diameter poly/wire combination brush
- Parallel arm floating suspension with 4 caster wheels allows sweeper to follow ground contour independent of loader
- High dump feature to dump into trucks and containers
- No chains, additional connections to the loader or electrical connections are required to dump
- Hopper dumps by reversing hydraulic flow
- Forward sweeping action into the front mounted collector hopper
- E-Z change brush pattern adjustment and floating brush Parking stands

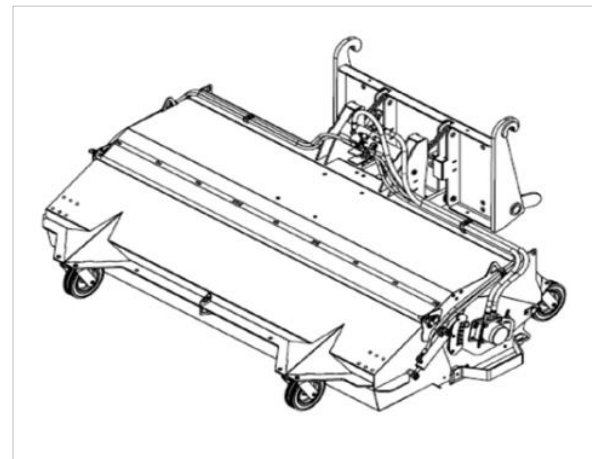

Requirement for Operation:

- Auxiliary hydraulics
- Quick coupler
- Auxiliary hose/quick disconnect kit (included with factory = installed couplers)

Collector Sweeper

Cont...



SPECIFICATIONS		
Sweep width	84"	96"
Drive motors	Dual	Dual
Overall width	99"	111"
Operating wt.	1547 lb.	1577 lb.
Brush diam.	26"	26"
Hopper cap.	.53 yd ³	.61 yd ³
Flow Range	26-50 gpm	26-50 gpm
Pressure Range – psi	2000–3500	2000–3500

Collector Sweeper - 7 Ft Wide x 26" Brush Diameter (Dual Motor)				
Description	Part Code	Overall Width	Hopper Capacity	Ship Weight (Lbs)
26" Diameter Brush Heads - Polypropylene & Wire Brush - Dual Motor 7 ft Hydraulic Bucket Sweeper Brush Head Dual Motor 26-50 GPM	CNHi-CS-BHL7	105"	0.53 yd ³	1513
Pin-on Mounting Assembly	CNHi-CS-MB			
Collector Sweeper - 8 Ft Wide x 26" Brush Diameter (Dual Motor)				
Description	Part Code	Overall Width	Hopper Capacity	Ship Weight (Lbs)
26" Diameter Brush Heads - Polypropylene & Wire Brush - Dual Motor 8 ft Hydraulic Bucket Sweeper Brush Head Dual Motor 26-50 GPM	CNHi-CS-BHL8	117"	0.61 yd ³	1608
Pin-on Mounting Assembly	CNHi-CS-MB			



Collector Sweeper



OPTIONAL EQUIPMENT - REPLACEMENT BRUSH SETS

Description	CNHi Part Number	Weight (Lbs)
GUTTER BRUSH KIT (Wire, Single - mounts right or left)	84274995	90
GUTTER BRUSH KIT (Poly, Single - mounts right or left)	84274997	90
DUST CONTROL KIT (25 gal. tank, nozzles, hose, wiring)	84274998	47
Poly/wire Brush set for 84" broom	84375438	134
Poly/wire Brush set for 96" broom	84376837	145

MODEL COMPATIBILITY	570LXT	570MX T	570NXT	580L/ 580SL/ 590SL	580M	580SM	580SM +	590SM	580N	580SN	580SN WT	590SN	REQ'D EQUIPMENT		
													LOADER AUX. HYD.	QUICK COUPLER	HOSE/ QD KIT
84" COLLECTOR BROOM	•	•	•	•	•	•	•	•	•	•	•	•	R	R	R
96" COLLECTOR BROOM				•	•	•	•	•	•	•	•	•	R	R	R





SPECIFICATIONS & FEATURES

Application: Street cleaning & parking lot maintenance, road maintenance clean-up, bridge deck clean-up, jobsite clean-up

- Parking stands
- Angles 30° right or left
- 32" brush diameter
- Adjustable broom head
- Integral nozzle mounting for water application
- 50/50 Poly/wire brush core
- Bolt together hood for simple, less costly replacement, if damaged
- Quick-change brush without breaking hydraulic lines
- Dual hydraulic motors
- Caster wheels – 4.80-8 tires

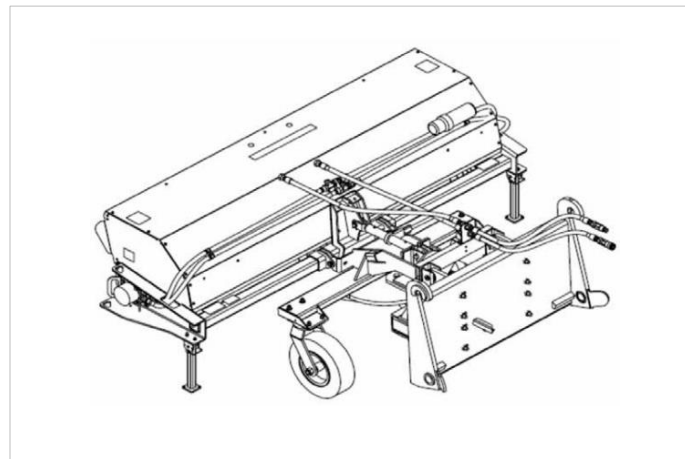

Requirement for Operation:

- Auxiliary hydraulics
- Quick coupler
- Auxiliary hose/quick disconnect kit (included with factory = installed couplers)

Angle Broom



Angle Sweeper - 8 Ft Length x 32" Brush Diameter (Polypropylene and Wire Brush QC 8 - with Manual Angle Change)

Description	Part Code	Ship Weight (Lbs)
QC 8 ft Hydraulic Drive Brush Head - Polypropylene and Wire Brush, GPM Range 20-36, PSI Range 2000-3500 (with Manual Angle Change)	CNHi-AS-BHL8	1612
Pin-on Mounting Assembly	CNHi-AS-MB	

OPTIONAL EQUIPMENT - REPLACEMENT BRUSH SETS

Description	CNHi Part Number	Weight (Lbs)
Poly/wire Brush set for 96" broom	84376840	196

MODEL COMPATIBILITY	570LXT	570MXT	570NXT	580L/ 580SL/ 590SL	580M	580SM	580SM +	590SM	580N	580SN	580SN WT	590SN	REQ'D EQUIPMENT		
													LOADER AUX. HYD.	QUICK COUPLER	HOSE/ QD KIT
96" ANGLE BROOM	•	•	•	•	•	•	•	•	•	•	•	•	R	R	R



Loader Side Attachments – Grapples



Grapples



Grapple Bucket



SPECIFICATIONS & FEATURES

- Profiles available in full, half-cutaway, or full-cutaway sides for and job application
- Optional screening available for maximum material retention
- Dual hydraulic cylinders allow independent actuation of each cylinder for clamping uneven loads
- Width and edge hole patterns drilled to OEM standard wear parts.
- Available as pin-on or compatible with Quick Coupler System
- Third function loader hydraulics and jumper hose kit for Quick Coupler required for operation. Bucket supplied with attachment side whip hoses

CNHi Part Number	Capacity (m3)	Weight (lbs)
CNHi-GB-100	0.76	1450
CNHi-GB-125	0.96	1525
CNHi-GB-150	1.15	1600

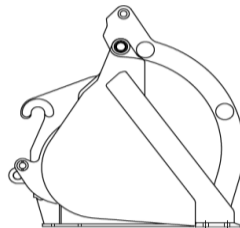
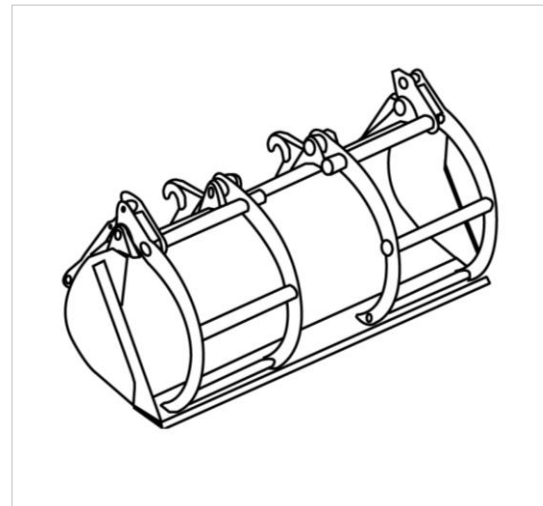

FULL SIDE

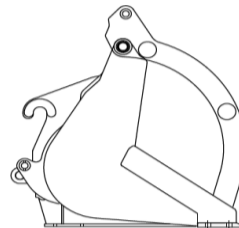

HALF SIDE

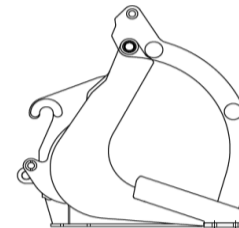

CUTAWAY



Grapple Bucket/Rake



SPECIFICATIONS & FEATURES

- Efficient design for loading tires, land clearing, and trash handling
- “C” - shaped radius excretes small debris through bottom shell
- Multi-tine grapples allow for better material retention
- Dual hydraulic cylinders allow independent actuation of each cylinder for clamping uneven loads
- Optional sidebars available
- Available as pin-on or compatible with Quick Coupler System
- Third function loader hydraulics and jumper hose kit required for operation



CNHi Part Number	Capacity (m3)	Weight (lbs)
CNHi-GBR-150	1.15	1850



Manure Fork and Grab



SPECIFICATIONS & FEATURES

- Provides excellent visibility
- Moves loose hay & manure and is ideal for moving brush and small branches
- Single auxiliary hydraulic circuit
- Dual cylinders
- Replaceable tines

CNHi Part Number	Width	Weight (lbs)
CNHi-MFG	96"	1725



Loader Side Buckets → Scrap Grapple



SPECIFICATIONS & FEATURES

- Hoses and quick disconnects included
- 3/8" plate webbing – full protection to the cylinders
- 46.3" opening for handling of bulky materials
- Grapples operate independently to accommodate uneven loads
- Bucket cylinders are cushioned to reduce stress on moving parts
- Pivot pins are larger in diameter and cover the width of each grapple, reducing side load

Requirement for Operation:

- Auxiliary hydraulics
- Quick coupler
- Auxiliary hose/quick disconnects kit (included with factory-installed quick couplers)

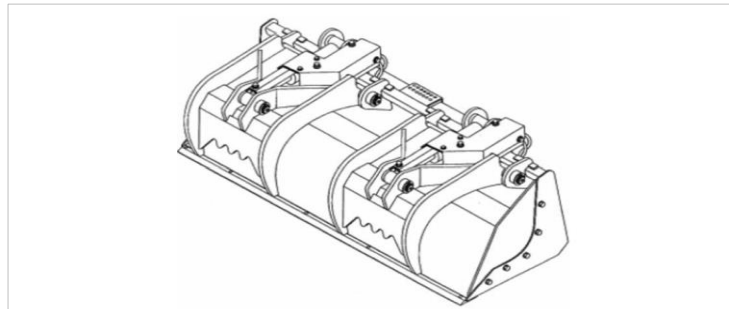

Description	CNHi Part Number	Weight (Lbs)
83" SCRAP GRAPPLE BUCKET	301094A1	1465

Applications:

Moves metal, concrete, paper, cardboard and other bulky material

MODEL COMPATIBILITY	570LXT	570MXT	570NXT	580L/ 580SL/ 590SL	580M	580SM & 580SM+	590S M	580N	580SN	580SN WT	590SN	REQ'D EQUIPMENT		
												LOADER AUX. HYD.	QUICK COUPLER	HOSE/ QD KIT
83" SCRAP GRAPPLE BUCKET	•	•	•	•	•	•	•	•	•	•	•	R	R	R



Grapple Forks



Model	BM0630
Overall Width(mm)	1480
Overall Length(mm)	2300
Overall Height(mm)	1350
Weight(kg)	1050
Max. Open Diameter(mm)	1500
Max. Hold Diameter(mm)	750
Min. Hold Diameter(mm)	635
Pressure(mpa)	16-21
Flow (l/min)	50-70
Fit Host Machine	3 Tons
Shape volume m3	6.19
Clamping Type	Staggered Tooth



Log Grapple



SPECIFICATIONS & FEATURES

- The product is an ideal tool for grappling all kinds of logs, which can not only grapple single log, but also grapple a pile of logs. The product is widely used for log-unloading and transporting operation in wood market and sea port with high convenience and efficiency.
- The product run by hydraulics is designed for wheel loader, it has the characters of large loading and flexible grappling without any damage to logs.
- The position-limiting block for turning bucket upwards and tipping bucket can be mounted according to the machine model.



Description	ORDER CODE
Log Grapple suitable for Case BHL 570ST	BM06A30



Single Top Clamp Forks



SPECIFICATIONS & FEATURES

- Provides added material retention in log and lumber handling
- High-strength, drop-forged tines provide extra support
- Optional floating tine design available for use in uneven terrain condition
- Cylinder mounted in clamp for maximum protection, visibility, and weight distribution
- Heat-treated pins and bushings
- Third function loader hydraulics and jumper hose kit for Quick Coupler required for fork operation. Forks supplied with attachment side whip hoses

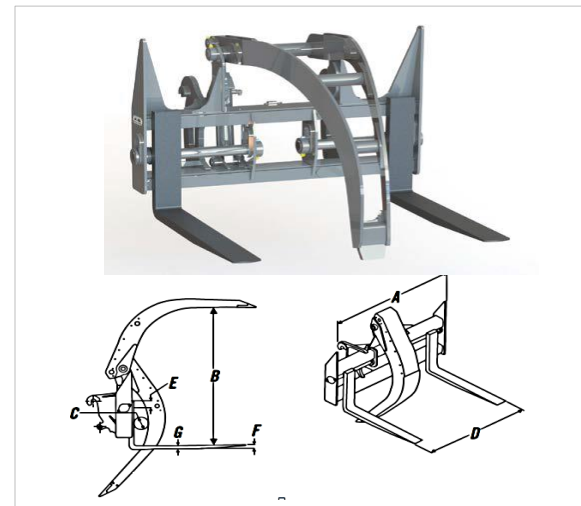

Single Top Clamp Fork							
Tine Type	"A" Frame Width	"B" Clamp Opening	"C" Clamp Minimum Opening	"D" Maximum Width Over Tines	"D" Minimum Width Over Tines	"F" Tine Size	"G" Capacity at 24" Load CTR
Rigid	61-1/4"	59"	6-3/4"	57-1/2"	33-1/2"	2" x 4" x 48"	8400 lbs.

Double Top Clamp Forks



SPECIFICATIONS & FEATURES

- Low profile carriage allows for increased site lines
- Withstands weight-shifting and stress loads beyond loader capacity
- High-strength, drop-forged tines provide extra support
- Optional floating tine design available for use in uneven terrain condition
- Heat-treated pins and bushings
- Custom tine lengths and carriage widths available
- Third function loader hydraulics and jumper hose kit for Quick Coupler required for fork operation. Forks supplied with attachment side whip hoses

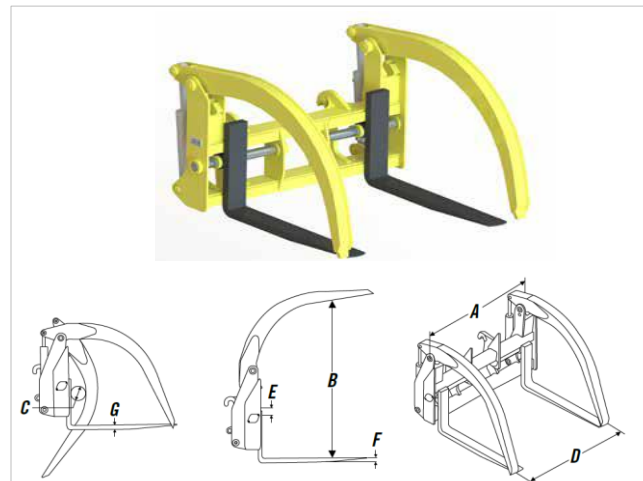

Double Top Clamp Forks

"A" Frame Width	"B" Clamp Opening	"C" Clamp Minimum Opening	"D" Maximum Width Over Tines	"D" Minimum Width Over Tines	"E" Float Travel	"F" Tine Size	"G" Capacity at 24" Load CTR
60"	62"	8-1/2"	57-3/4"	33-1/2"	4"	2" x 4" x 48"	8400 lbs.

Paddle Top Clamp Forks



SPECIFICATIONS & FEATURES

- Designed for maximum material retention and strength in loading and unloading logs, lumber, and palletized materials
- Ideal for picking and sorting applications
- High-strength steel tines
- Available with optional floating-tine design for uneven terrain conditions
- Heat-treated pins and bushings
- Custom tine lengths and carriage widths available
- Third function loader hydraulics and jumper hose kit for Quick Coupler required for fork operation. Forks supplied with attachment side whip hoses

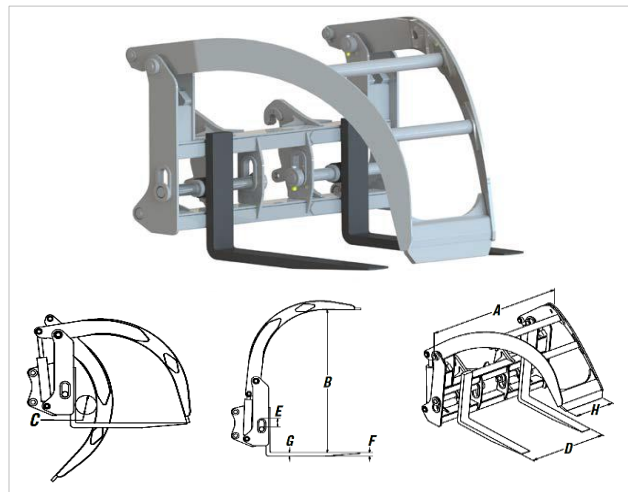

Paddle Top Clamp Fork

"A" Frame Width	"B" Clamp Opening	"C" Clamp Minimum Opening	"D" Maximum Width Over Tines	"D" Minimum Width Over Tines	"E" Float Travel	"F" Tine Size	"G" Capacity at 24" Load CTR
60"	62"	8-1/2"	57-3/4"	33-1/2"	4"	2" x 4" x 48"	8400 lbs.



Loader Rake



SPECIFICATIONS & FEATURES

- Designed for removing and piling brush in heavy land-clearing situations
- Available in various raking widths and capacities to match loader specifications
- Optional hydraulic clamps available to provide secure load control and increased load capacities
- Rakes available as pin-on or compatible with JRB's Quick Coupler System
- Third function loader hydraulics and jumper hose kit required for hydraulic clamp operation

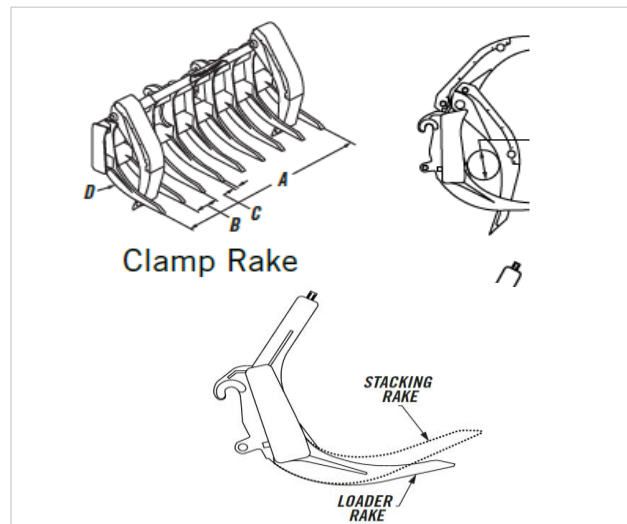

Loader Rake				
CNHi Part Number	Description	Raking Width (Inch)	No. of Tines	Weight (Lbs)
CNHi-LR-100	Loader Rake	92"	8	1,410
CNHi-LRC-100	Loader Rake with Clamps	92"	8	1,865

Stacking Rake



SPECIFICATIONS & FEATURES

- "C" Radius design allows for optimum stacking and loading of debris in heavy land clearing situations
- Alloy steel construction maximizes strength and durability
- Available in various raking widths and capacities to match loader specifications
- Optional hydraulic clamps available to provide secure load control and increased load capacities
- Rake available as pin-on or compatible with Quick Coupler System
- Third function loader hydraulics and jumper hose kit required for hydraulic

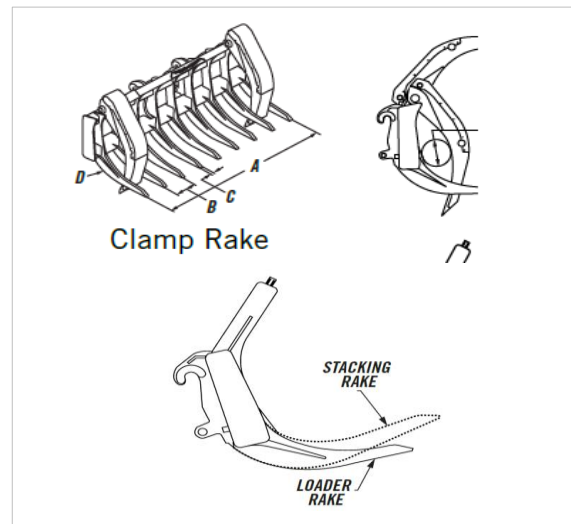

Stacking Rake

CNHi Part Number	Description	Raking Width (Inch)	No. of Tines	Weight (Lbs)
CNHi-SR-100	Stacking Rake	92"	8	1,588
CNHi-SRC-100	Stacking Rake with Clamps	92"	8	2,020



Loader Side Attachments – Tree Spade



Tree Spade



Tree Spade



SPECIFICATIONS & FEATURES

- 3 Blade
- 30 Degrees
- Inside Frame
- Joystick controller to operate the spade



Specifications			
Maximum Rootball Diameter	A	44.5"	(113cm)
Root Ball Depth	B	33.3"	(85 cm)
Working Height	C	60"	(152 cm)
Width (Closed)	D	110.9"	(282 cm)
Working Width (Open)	E	130.3"	(331 cm)
Open Gate Clearance	F	37.8"	(96 cm)
Inner Diameter (Max Trunk Size)	G	27.4"	(70 cm)
Lower Rootball Diameter	H	3.4"	(9 cm)
Closed Width	I	96.8"	(246 cm)
Overall Length	J	94.9"	(241 cm)
Machine Weight	M	2100 Lbs	(953 Kg)
Rootball Weight	W	1300 Lbs	(590 Kg)
Rootball Volume	V	10.8 ft3	(0.31 m3)
Rootball Diameter 2	A2	40.6"	(103 cm)
Rootball Diameter 3	A3	36.7"	(93 cm)
Rootball Diameter 4	A4	32.8"	(83 cm)
Rootball Diameter 5	A5	29"	(74 cm)
Rootball Depth 2	B2	30.2"	(77 cm)
Rootball Depth 3	B3	27"	(69 cm)
Rootball Depth 4	B4	23.9"	(61 cm)
Rootball Depth 5	B5	20.7"	(53 cm)
Rootball Height Spacing	S	3.1"	(8 cm)



Loader Side Attachments – Pole Planter



Pole Planter



Pole Planter



SPECIFICATIONS & FEATURES

- This attachment enables Standard Backhoe Loader Machine to Plant / Erect Road Side Lighting Poles, Electrical Cable Pole. The attachment is capable to picking the poles from their natural stacking.
- The adjustable Grab Arms can lift any lengths starting from 10 feet. Grab Arms are provided with durable rubber pads to ensure the proper grip on poles while operation.
- The 180 degree rotation facility of attachment helps in performing the operation with minimum workmen.
- Dual Hydraulic Grabs for stable and uniform grabbing designed for heavy duty & reliable operation.



APPLICATION

Industry: Construction, Power Transmission Industry and other industry with similar applications.

Railways: Rail track Side Pole Erection, Metro & other similar applications.



Loader Side Attachments – Snow Attachments



Snow Attachments



Snow Blower

Cont...



SPECIFICATIONS & FEATURES

Front dual-stage Snow Blower specially designed for combinations on big machinery such as loaders, Backhoe Loaders and Telehandlers.

- Equipped with high-performance piston hydraulic motor and torque limiter which prevents the possibility of accidental damages due objects hidden in the snow, such as stones or wood branches
- Interchangeable scraping knife in wear-resistant steel, side slides adjustable in height, icebreaker helices in HARDOX® metal to decrease as much as possible the wear caused by gravel and stones mixed with snow.

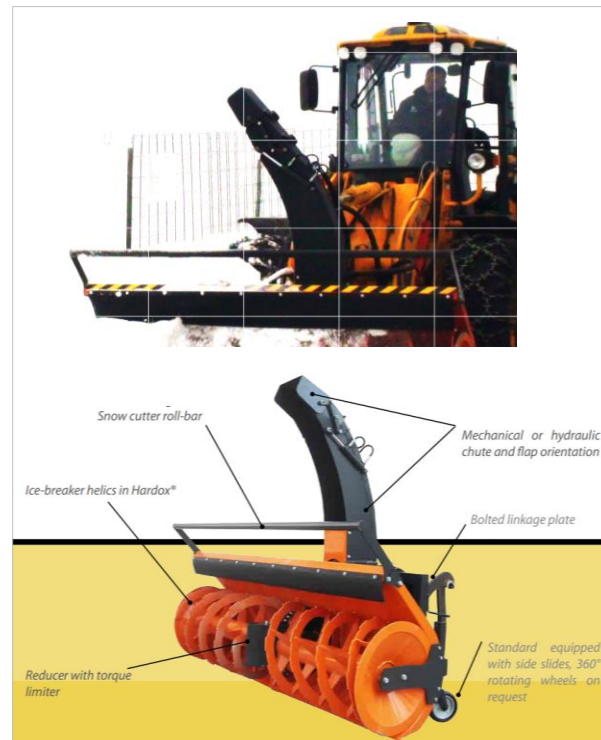

Snow Blower



SPECIFICATIONS & FEATURES

- Snow output chimney and flaps are powered mechanically as standard (Hydraulic Option available)
- Hydraulic “Tilt” System available as option - allows to tilt the snow blower 10 ° left/right so to remove snow optimally even in case of road surface not flat or to remove snow on the sidewalks without problem.
- The standard control box could be replaced with radio remote control allowing full hydraulic functions activation wirelessly.

Description	CNHi-2300 HD
Total width (mm)	2350
Working width (mm)	2300
Weight (Kg.)	950
I° and II° stage helixes diameter (mm)	630/550
Frontal height (mm)	1000
Minimum - maximum oil flow (l/1')	90-140
Minimum pressure (bar)	190
Maximum pressure (bar)	250
Edge chute rotation angle (°)	240



Snow Push



SPECIFICATIONS & FEATURES

Snow Push - 233 Series (3ft x 3ft)

- Moves large volumes of snow efficiently. Also ideal for waste water, manure, feed lot and flood cleanup
- Optional pull back kit draws back snow from buildings, fences and confined areas
- Optional bucket lip mount available for 10', 12' and 14' models



Snow Push - 3 Ft x 3Ft, Lift Capacity: <11,000 lbs; Operating Weight <20,000 lbs

CNHi Part Number	Description	Path Width	Working Height	Depth	Overall Width	Weight (Approx) Lbs
CNHi-23320	10' 233 Series 3x3 Snow Push	10'	41.3"	41.5"	125.5"	1,230
CNHi-23344	12' 233 Series 3x3 Snow Push	12'	41.3"	41.5"	149.5"	1,375
CNHi-23368	14' 233 Series 3x3 Snow Push	14'	41.3"	41.5"	173.5"	1,505



Snow Blade



SPECIFICATIONS & FEATURES

Snow Blade

Ideal for the largest skid steers and tractor backhoe loaders, this versatile snow blade has a much larger mold board for larger capacity and width's ranging from 84" to 144", hydraulic angle 35 degrees left/ right. This unit has options for a Steel, Rubber or Polyurethane cutting edges.

- Hydraulically angles 35 degrees in either direction
- Replaceable bolt-on wear edge
- Optional rubber edge
- Skid shoes with adjustable height
- Reinforced 7-gauge steel blade
- Spring loaded trip mechanism

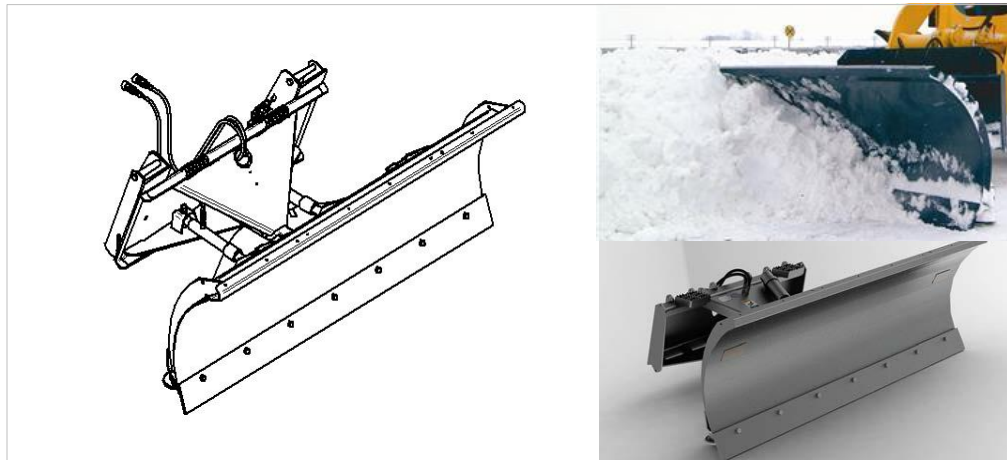

Snow Blades				
Lift Capacity: <9,000 lbs; Operating Weight <11,000 lbs				
Part Number	Height	Width	Cutting Width at 35°	Weight
CNHi-11520	32"	120"	98"	1393 Lbs.
CNHi-11520	32"	132"	108"	1473 Lbs.
CNHi-11520	32"	144"	118"	1558 Lbs.



Snow Plow



SPECIFICATIONS & FEATURES

- Designed for use with loaders and backhoes in tight, confined areas
- 35° plow angle in both directions
- Features two carbide wear shoes, two 3" bore, and 10" stroke cylinders
- 3/4" x 6" reversible AR425 steel edge
- Equipped with two heavy-duty adjustable trip springs
- Hydraulic angle available on plows
- Third function loader hydraulics and jumper hose kit required for plow angles
- Available as pin-on compatible with JRB's Quick Coupler System
- Third function hydraulics required for loader angle operation. Plow supplied with attachment side whip hoses.

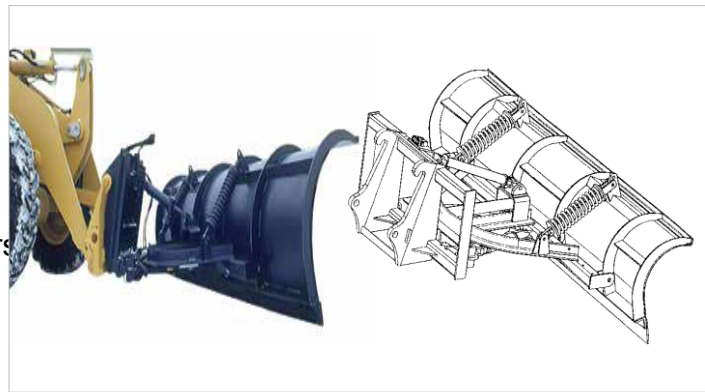

Snow Plow

Part Number	Description	Class	Height	Cutting Edge	Mold Board Thickness	Cutting Width at 35°	Spring Assembly	Weight
CNHi-10SPH	10' Hydraulic Angle Snowplow	10'	42"	3/4" x 6"	3/16"	98-1/4"	2	1510 lbs.
CNHi-11SPH	11' Hydraulic Angle Snowplow	11'	42"	3/4" x 6"	3/16"	108-3/25"	2	1600 lbs.
CNHi-12SPH	12' Hydraulic Angle Snowplow	12'	42"	3/4" x 6"	3/16"	118"	2	1650 lbs.





SPECIFICATIONS & FEATURES

- V-Type Snow Plow with 5 different possibilities of working setup: right or left 35° inclination, horizontal, wedge or spoon.
- The two robust wings can be independently moved by two double effect hydraulic cylinders provided of anti-shock valve.
- V-blade is standard equipped by horizontal self-leveling function, anti-shock system with clip return on two lower sectors of the knife, four rubber hoses and quick couplings for the hydraulic circuit supply (an electro-valve kit for machines with only 2 lines is available as option), marker flags and lamps kit complete with light' supports for road circulation. Each kind of linkage system is fixed to the blade thru bolted plate.

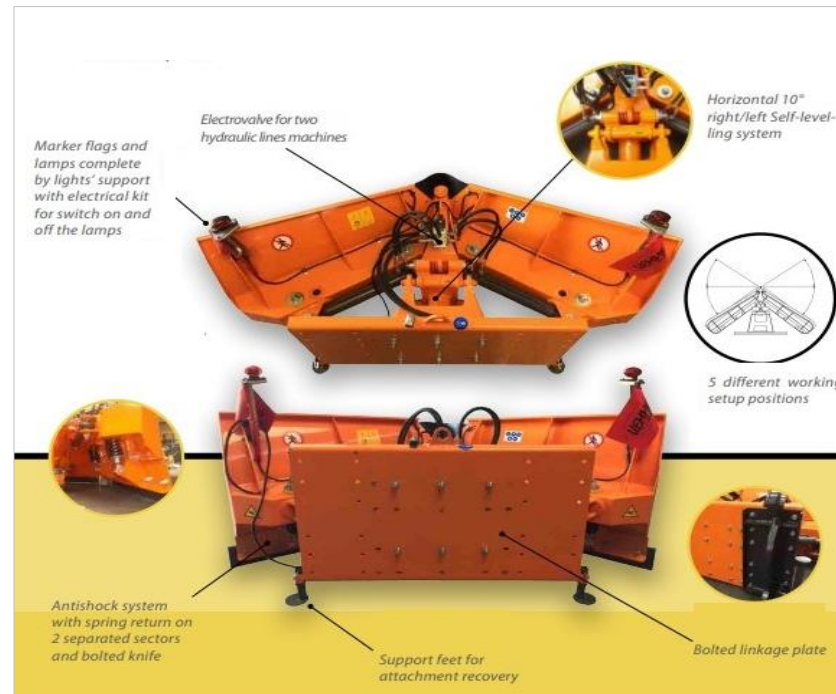

V- Blade



Models	LV 3000
Blade width (mm)	3000
Closed blade working width (mm)	2500
Weight (Kg.)	530
Self-levelling (°)	± 10
Blade opening and closure (°)	± 35
Antishock sectors (nr.)	2
Moldboard height (mm)	800/900

V-Blade	
CNHi Part Number	Description
CNHi-3000	Snow Plow V-Type CNHi-3000
CNHi-3000-FS	Floating System - with springs mechanical parallelogram for LV 3000
CNHi-3000-EV	Electro-valve - for the use of only 2 hydraulic lines
CNHi-3000-BS	2 side bolted slides for LV



Loader Side Attachments – Agriculture Attachments



Agriculture Attachments



Bale Spear



SPECIFICATIONS & FEATURES

- Main spears – dual tapered, forged, 2-1/8" dia x 49"
- Stabilizer spike – single 1-1/4" dia x 19"

Applications

- For bales up to 4,000 lbs. at 24" load center

Requirements for Operation

- Quick coupler (See page LBH-10)
- Rear counterweight recommended for 570LXT, 570MXT, 570NXT

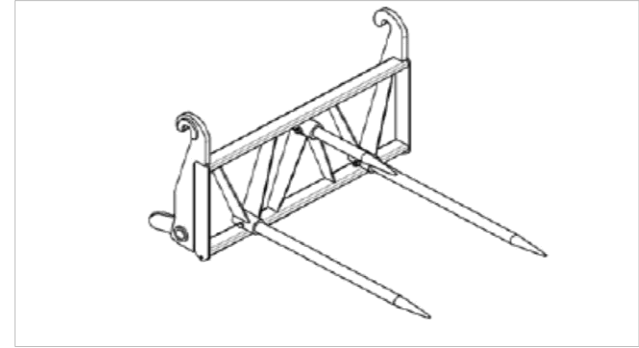

CNHi Part Number	Part Description	Weight (Lbs)
87473631	Bale Spear	277

MODEL COMPATIBILITY	570LXT	570MXT	570NXT	580L/580SL/590SL	580M	580SM	580SM+	590SM	580N	580SN	580SN WT	590SN	REQ'D EQUIPMENT		
													LOADER AUX. HYD.	QUICK COUPLER	HOSE/ QD KIT
Bale Spear	•	•	•	•	•	•	•	•	•	•	•	•		R	



Box Scraper



SPECIFICATIONS & FEATURES

- High-profile moldboard provides increased carrying capacity with minimal drag and great boiling action
- Double wall moldboard with heavy-duty side plates prevent twisting
- Hydraulically actuated scarifier increases ripping penetration
- Fits two- or four-wheel-drive machines
- Replaceable side plates on 88" model

Applications

- For fine grading and heavy-duty landscaping jobs; backfills, grades, excavates, rips and scarifies

Requirements for Operation

- 3-point hitch
- Rear remote auxiliary hydraulics

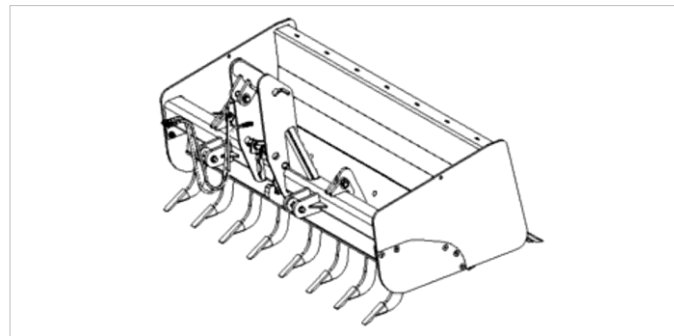

CNHi Part Number	Part Description	Weight (Lbs)
51570714	84" BOX SCRAPER	1565
51570718	88" BOX SCRAPER	1723

MODEL COMPATIBILITY	570LXT	570MXT	570NXT	580L/ 580SL/ 590SL	580M	580SM	580SM+	590SM	580N	580SN	580SN WT	590SN	REQ'D EQUIPMENT				
													LOADER AUX. HYD.	QUICK COUPLER	HOSE/ QD KIT	REAR REMOTE AUX HYD	3 POINT HITCH
84" BOX SCRAPER	•	•	•													R	R
88" BOX SCRAPER	•	•	•													R	R



Boom



SPECIFICATIONS & FEATURES

- Designed for long-reaching material handling applications involving lifting, loading, and positioning
- Superior efficiency in handling large-diameter precast pipes
- High-strength tubular steel construction
- Manually extendable
- Standard equipped with hook
- Available as pin-on or compatible with Quick Coupler System
- Capacity is based upon the hydraulic limitation or tip limitation of the machine



Boom		
CNHi Part Number	Description	Weight (Lbs)
CNHi-Boom-006	1 Section 6' Extension, 10t Hook Rating	610
CNHi-Boom-008	1 Section 8' Extension, 10t Hook Rating	745

Dozer Blade



SPECIFICATIONS & FEATURES

- Equipped with shockproof valve
- HB400 wear & tear steel bolted blade
- Blade Inclination 30 degrees – left/right



MODEL	Blade width (mm)	Working width (mm)	Weight (kg)	Hydraulic blade inclination (r/l)
CNHi - DB 270	2700	2330	450	±30°



Grader



SPECIFICATIONS & FEATURES

- Blade Width 2200 mm - 2700 mm with extension - complete with joystick for hydraulic control of tilt angle 26°
- Oscillation Angle 15°,
- Vertical Lift ±15 cm - Distributor Proportional
- Hydraulic Connection with Quick Coupler 3/4" to fit Backhoe Loader



MODEL	Blade width (mm)	Weight (Kgs)	Hydraulic Blade Inclination (r/l)	Hydraulic Blade Oscillation (r/l)	Blade Height (mm)
GR 220/270	2200/2700	780	±26°	±15°	540



Backhoe Side Attachments



TABLE OF CONTENTS

Backhoe Side Attachments

Quick Coupler

1. Manual Quick Coupler p.68
2. Hydraulic Quick Coupler p.69

Buckets

3. Backhoe Side Buckets p.74
4. Skeleton Buckets p.75
5. Ditch Cleaning Buckets p.76
6. Concrete Mixing Bucket p.77
7. Thumbs p.78

Hydraulic Breaker

8. Hydraulic Breaker p.81

Auger & Ripper

9. Auger Drive and Bits p.87
10. Ripper p.95

Construction Attachments

11. Cold Planer p.98
12. Selector Grab p.99
13. Hydraulic Plate Compactor p.101
14. Compaction Wheels p.104
15. Vibratory Roller p.105
16. Orange Peel Grapple p.106

Demolition Attachments

17. Crusher p.108
18. Pulverizer p.110
19. Shear p.112
20. Multi-Kit Universal Processor p.114

Trenchers

21. Trencher p.118
22. Drum Cutter p.120

Backhoe Side Attachments – Quick Couplers



Quick Couplers

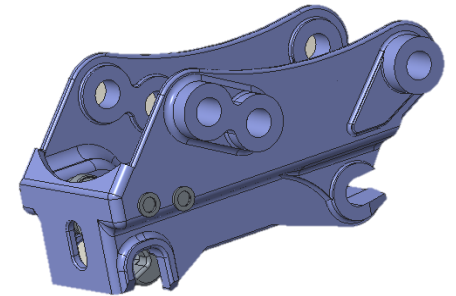

Manual / Pin Grab Quick Coupler



SPECIFICATIONS & FEATURES

- Manual Quick Coupler
- Heavy Duty construction
- Suitable to attach all CASE Buckets (Standard, Heavy Duty and Ditch Cleaning)
- Variable pin center design allows you to easily pick up and swap the bucket
- Very compact design
- Stronger and lighter to improve performance

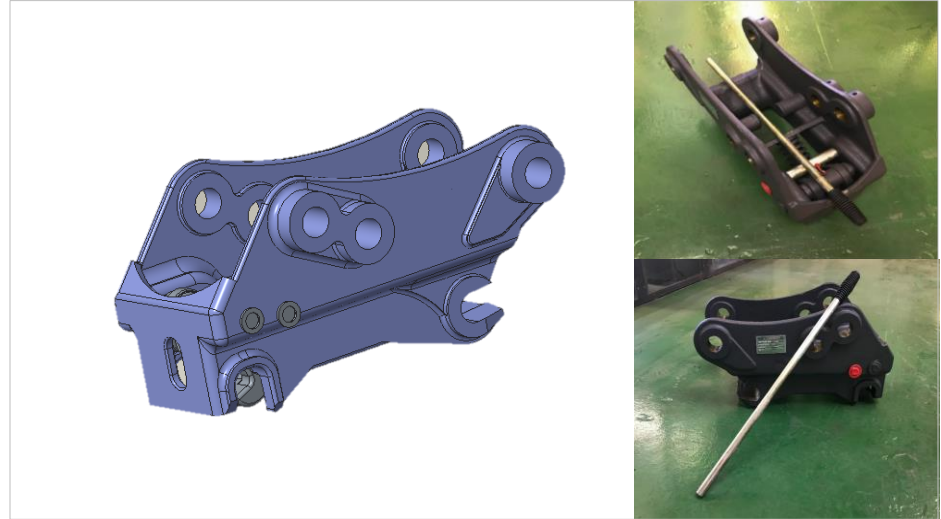

CNHi Part Number	Weight	Dimensions	Remarks
85801542	74 kgs	622 mm x 310 mm x 340 mm	Dummy Pins not included
710732019			Includes set (2 Nos) of Dummy Pins

Suitable for: 570T, 570ST, B80B, 770, 770EX, 770EX MAG, 851EX, 580T, 580ST, 590ST, 695ST, B90B, B100B, B110B, B115B



Hydraulic Quick Coupler



SPECIFICATIONS & FEATURES

- EN 474-1 & ISO 13031 Compliant
- Front & Rear Safety Lock
- High Strength Steel
- Low Maintenance – No Greasing Points



CNHi Part Number	Hydraulic Quick Coupler Description	Ship weight (Kgs)
51617382	Quick Coupler Suitable for Case Backhoe Loader 570ST	68
90333365	Hydraulic Piping Kit	

Suitable for: 570T, 570ST, B80B, 770, 770EX, 770EX MAG, 851EX, 580T, 580ST, 590ST, 695ST, B90B, B100B, B110B, B115B



Universal Quick Coupler



SPECIFICATIONS & FEATURES

- Suitable to attach all CASE and JCB Buckets (Standard, Heavy Duty)
- Very compact and flexible design
- Two Fixing Points to improve Digging Force or Speed
- Stronger and Lighter to improve performance

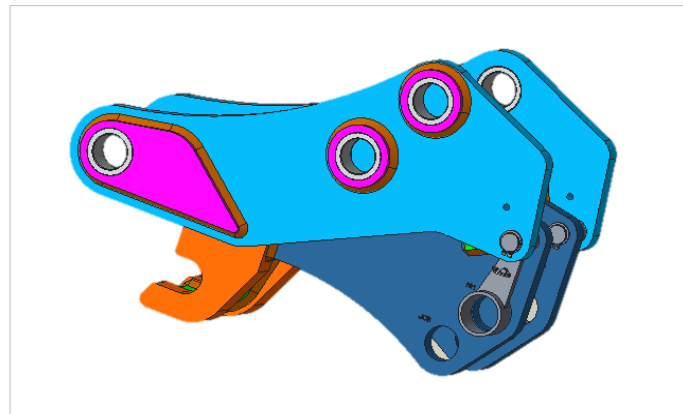

CNHi Part Number	Description	Suitable for
47997327	Universal Quick Coupler suitable for In Line Backhoes	570T, 570ST, B80B, 770, 770EX, 770EX MAG, 851EX, 580T, 580ST, 590ST, 695ST, B90B, B100B, B110B, B115B

CNHi Part Number	Description	Suitable for
47859903	Universal Quick Coupler suitable for DNA Backhoes	580 T/ST, 590ST & 695ST

Quick Coupler for 580N /580SN / 590SN



SPECIFICATIONS & FEATURES

- Suitable to attach all CASE and JCB Buckets (Standard, Heavy Duty)
- Very compact and flexible design
- Two Fixing Points to improve Digging Force or Speed
- Stronger and Lighter to improve performance

CNHi Part Number	Description	Suitable for
47959091	Universal Quick Coupler – 580N / 580SN DNA STD Backhoe	580N & 580SN - Standard Backhoe
47959113	Universal Quick Coupler – 580N / 580SN DNA Extended Backhoe	580N & 580SN - Extended Backhoe
47959114	Universal Quick Coupler – 590SN DNA Extended Backhoe	590SN - Extended Backhoe

Backhoe Side Attachments – Buckets



Buckets



Backhoe Side Buckets – 570T/ST, 770 EX & 851EX



SPECIFICATIONS & FEATURES

- Bolt-on-Teeth
- Widths Offered – 12”, 18”, 24”, 30” & 36”

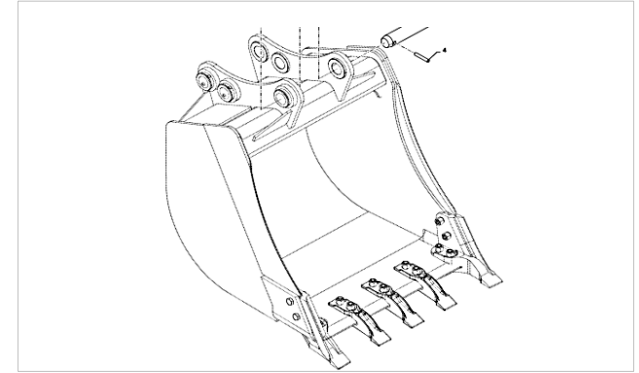

Backhoe Side Buckets suitable for 570T, 570ST, B80B, 770, 770EX, 770EX MAG, 851EX

Width	Capacity (m3)	Weight (Kgs)	CNHi Part Number - Welded	CNHi Part Number - Painted w/o Tooth Point	CNHi Part Number - Painted with Tooth Point	CNHi Part Number - Install
12"	0.08	134	47462182	47462184	47702354	47642885
18"	0.12	156	47462183	47462185	47702502	47642886
24"	0.18	183	47428117	47428120	47702504	47642887
30"	0.26	238	47778671	47778672	47864093	47778674
36"	0.3	271	47464915	47702507	47864047	47642889

Backhoe Side Buckets - 580T/ST, 590T/ST & 695ST



SPECIFICATIONS & FEATURES

- Straight side cutter to improve capacity;
- Suitable for Direct Fit, Mechanical QC and Universal QC Application
- Weld-on Esco / SMART FIT Teeth included

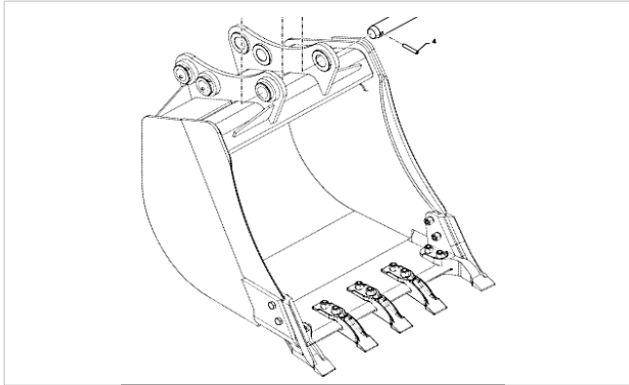

CNHi Part Number	Type	Suitable for	Width	No. of Teeth	Weight (Kgs)	Capacity m3
87593057	General Purpose	IN-LINE CYLINDER Backhoe – Common Teeth	305	3	110	0.07
87593197	General Purpose	IN-LINE CYLINDER Backhoe – Common Teeth	457	4	133	0.10
87592546	General Purpose	IN-LINE CYLINDER Backhoe – Common Teeth	610	4	151	0.14
87594495	General Purpose	IN-LINE CYLINDER Backhoe – Common Teeth	762	5	173	0.18
87594088	General Purpose	IN-LINE CYLINDER Backhoe – Common Teeth	910	6	195	0.22
87607818	Heavy Duty	IN-LINE CYLINDER Backhoe – Common Teeth	300	3	111	0.08
87607821	Heavy Duty	IN-LINE CYLINDER Backhoe – Common Teeth	450	4	137	0.10
87607824	Heavy Duty	IN-LINE CYLINDER Backhoe – Common Teeth	610	4	158	0.15
87607825	Heavy Duty	IN-LINE CYLINDER Backhoe – Common Teeth	760	5	176	0.19
87607827	Heavy Duty	IN-LINE CYLINDER Backhoe – Common Teeth	910	6	199	0.23
84476372	General Purpose	CASE DNA Backhoe – Esco Teeth	300	3	151	0.07
84476370	General Purpose	CASE DNA Backhoe – Esco Teeth	400	4	171	0.08
84476369	General Purpose	CASE DNA Backhoe – Esco Teeth	450	4	146	0.10
84476368	General Purpose	CASE DNA Backhoe – Esco Teeth	600	5	158	0.14
84476366	General Purpose	CASE DNA Backhoe – Esco Teeth	750	5	187	0.18
84476365	General Purpose	CASE DNA Backhoe – Esco Teeth	900	6	243	0.20
47524198	Heavy Duty	CASE DNA Backhoe – Smart Fit Teeth	400	3	90	0.08
47524199	Heavy Duty	CASE DNA Backhoe – Smart Fit Teeth	450	4	104	0.10
47524201	Heavy Duty	CASE DNA Backhoe – Smart Fit Teeth	600	5	112	0.14
47524203	Heavy Duty	CASE DNA Backhoe – Smart Fit Teeth	900	7	130	0.23

Skeleton Buckets



SPECIFICATIONS & FEATURES

- Heavy duty design with thick profiled ribs
- Well suited to rocky soils
- Optional gap width 50/75 mm

Attachment Description	Gaps
900 mm wide Skeleton Bucket suitable for CASE Backhoe Loader 570ST	50 mm or 75 mm gaps



Ditch Cleaning Bucket



SPECIFICATIONS & FEATURES

- Curved side cutter to improve digging;
- Suitable for Direct Fit, Mechanical QC and Universal QC Application
- Provided with Welded cutting Edge

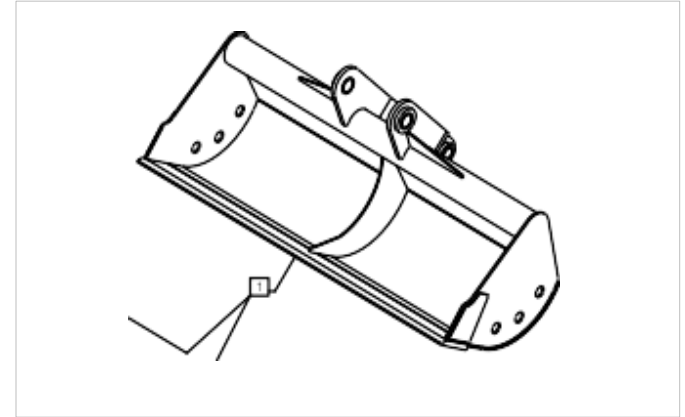

CNHi Part Number	Inline Cyl	Case DNA	DF	QCF	Univ QC	Width (MM) ↔ mm	Capacity (m3)	Weight (Kg) 	580T 580ST	590T 590ST	695T
73314751	-	✓	✓	✓	✓	1200	0.26	140	✓	✓	✓
73314754	-	✓	✓	✓	✓	1500	0.33	160	✓	✓	✓
85824356	✓	-	✓	✓	✓	1500	0.27	190	✓	✓	✓



Concrete Mixing Bucket



SPECIFICATIONS & FEATURES

Specially designed for intensive Site works.

This cost-effective attachment can mix a variety of materials like Concrete, Mortar, Sub-base material and Special soil.

Application: Small Construction, Sidewalks, Driveways, Footings, Landscaping.

- Bottom and helix made of wear resistant STEEL HB400
- Rounded fixed safety grill complete with bag breaker
- Electric valve, hydraulic hoses
- Electric connection kit, unloading pipe 1500mm length
- Attachment to the machine
- Elix made of STEEL HB400
- Bottom made of STEEL HB400
- Fixed safety rounded grill with bag breaker
- Electric valve
- Hydraulic hoses



- Electric connection kit
- Hydraulic opening of the bottom through cylinder with covered rod
- Unloading pipe

CNHi Part Number	Description
CNHi-CB-TLB-450	Concrete Mixing Bucket for TLB Capacity: 0.45 Cubic meter
CNHi-CB-TLB-600	Concrete Mixing Bucket for TLB Capacity: 0.60 Cubic meter





SPECIFICATIONS & FEATURES

- Low profile thumb storage for better visibility
- Grease zerks recessed for protection from the elements
- Multiple T1 steel fingers for rugged construction and longer wear life

Requirement for Operation:

- Bi-directional dipper auxiliary hydraulics
- Welding required

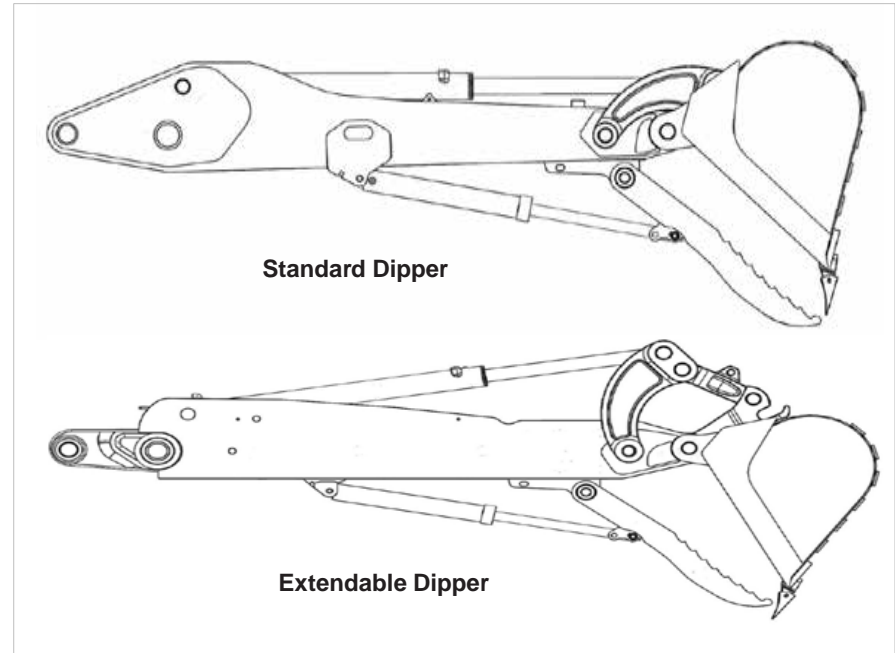

Thumbs



Description	CNHi Part Number	Weight (Lbs)
THUMB, STD Dipper w/HD Buckets	84315258	329
THUMB, STD Dipper w/Hi-CAP Buckets	84315259	350
THUMB, Extendable Dipper, w/HD Buckets	84315261	326
THUMB, Extendable Dipper w/Hi-CAP Buckets	84315262	348

Model Compatibility	580N	580 SN	580 SN WT	590 SN	Required Equipment			
					Loader Aux Hydraulics	Quick Coupler	Hose/QD Kit	Bi-Dir Dipper Aux. Hydraulics
THUMB, STD DIPPER - 84315258	•	•	•	•				R
THUMB, STD DIPPER - 84315259	•	•	•	•				R
THUMB, EXTENDABLE DIPPER - 84315261	•	•	•	•				R
THUMB, EXTENDABLE DIPPER - 84315262	•	•	•	•				R



Backhoe Side Attachments – Hydraulic Breaker



Hydraulic Breaker

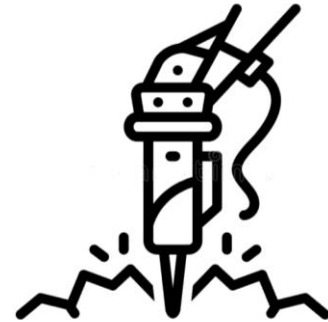



SPECIFICATIONS & FEATURES

- Hybrid Breaker
- Work Mode Selection – Power & Speed Mode
- Anti Blank Fire
- Internal Valve System
- Auto Lubrication System
- Housing Bottom Plate
- Breaker Paste
- Tie Rod with larger Diameter
- Large Capacity of Accumulator
- Longer Life of Accumulator Diaphragm
- Bolt Torque
- Heavy Duty Tool Pin (Large Size)



- High Tensile Wear Resistant Lower & Upper Bushes
- Side Gas Charging Port
- Air Supply Channel
- Housing Type – Closed Box
- Floating Power Cell System



Includes

- Breaker power cell and housing
- Breaker bracket
- Tools – 2 Nos
- Hose kit without quick coupling
- Gas charging kit
- Maintenance tool box
- Manual in English





Conical Moil Point

- Very good penetration
- Regular spread of wedge action
- No torsion effect

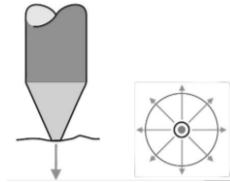

Application

- Concrete Breaking
- Highway Construction
- General Demolition

Chisel and Spades

- Very good spread of wedge action
- Good penetration
- Torsion effect (torsion is the twisting of an object due to an applied torque)

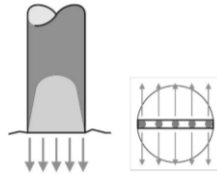

Application

- Trenching
- Cutting Casting Gates
- Breaking Oversize
- General Demolition

Blunt Tool

- Very good energy application
- Optimum breaking effect
- No torsion effect

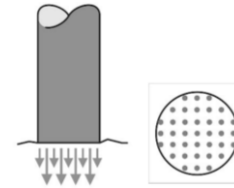

Application

- Secondary Breaking
- Breaking Oversize
- Slag Removal



Description		Units	CB61	CB62
CNHi Part Number			73391588	51575022
Operating Weight*		kg	366	441
Breaker Bracket Weight			111	111
Operating Pressure		kg/cm2	110~165	120~165
Port Relief Setting Pessure**		kg/cm2	175	175
Oil flow		lpm	29~60	34~68
Blow Rate	Power Mode	bpm	380~1000	380~900
	Speed Mode			
Tool Diameter		mm	70	75
Suitable Carrier		ton	3~6.5	4.5~8
Allowable Back Pressure		bar	43	44
<p>1* : Operating weight includes breaker bracket with 2 pins, one work tool and two hydraulic hoses. Operating weight is only indicative one for the purpose of sharing with Buyer and subject to change</p>				
<p>2. ** : Guide for carrier port relief valve pressure setting</p>				

Hydraulic Breaker



Description	CB61	CB62
ADDITIONAL TOOL		
Moil Point_Conical	73347274	51574843
Moil Point_Pyramid	73347275	51574844
Chisel_Cross Cut	73347276	51574845
Chisel In_Line	73347277	51574849
Flat End	73347278	51574850
Tamping Pad	73347279	51574851
Asphalt Cutter	73347280	51574852
SERVICE TOOL KITS		
Gas Charging Kit (Standard)	73347135	73347135
Gas Charging Kit (India)	51574857	51574857
Gas Cylinder	73347192	73347192
Gas Cylinder (India)	51574861	51574861



Backhoe Side Attachments – Auger & Ripper



Auger Drive &
Auger Bits



Ripper



Auger Drives & Auger Bits

Cont...



Specifications	
Auger Model	CNHi-BHL-Auger
Flow (gpm)	28-40
RPM @ max flow	85
Max torque @ max flow and pressure (ft-lb)	5069
Planetary Gear Reduction	6.1:1; Planetary gearbox
Max auger diameter	36"
Output shaft	2" Hex



Auger Drives & Auger Bits

Cont...



Auger Drive Unit - Dipper Mount		
CNHi Part Number	Part Description	Weight (Lbs)
87488595	AUGER DRIVE – CNHi-BHL-Dipper-Auger Drive unit with 2" hex output shaft (includes case drain plumbing)	500
Options for Dipper Auger Mount (order any one type - as applicable)		
87389736	PENDULUM MOUNT BRACKET (L/M-Series)	134
84367232	PENDULUM MOUNT BRACKET (N-Series)	92
87389737	CRADLE MOUNT BRACKET (L/M Series)	155
84366809	CRADLE MOUNT BRACKET (N-Series)	135
Includes Auger Drive Unit, Hoses, Case Drain Plumbing and Flat Face Quick Disconnects.		

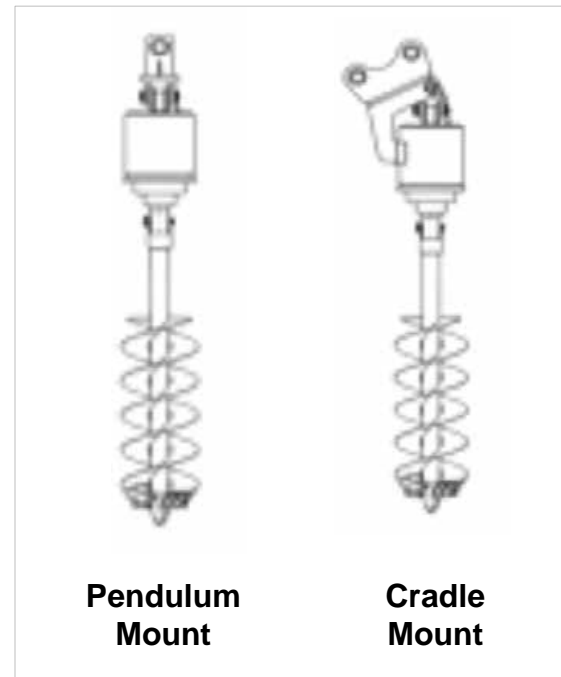



MODEL COMPATIBILITY	570LXT	570MXT	570NXT	580L/580SL/ 590SL	580M	580SM	580SM+	590SM	580N	580SN	580SN WT	590SN	REQ'D EQUIPMENT			
													LOADER AUX. HYD.	QUICK COUPLER	HOSE/ QD KIT	BI-DIR DIPPER AUX. HYD.
AUGER DRIVE, X5075H200 DIPPER MOUNT				•	•	•	•	•	•	•	•	•	R			



HTF STYLE AUGERS

For tree and shrub planting

- Fabricated boring head
- Two-diameter design
- Hardened, bolt-on teeth
- Hardened “fishtail” point
- HD double flighting
- 4' overall length



HTF STYLE AUGERS - 2" Hex Couplers

CNHi Part Number	Description	Weight (Lbs)
9863642	18" X 4' Auger	144
9863643	24" X 4' Auger	198
9863644	30" X 4' Auger	264
9863645	36" X 4' Auger	349



HDF STYLE AUGERS

For light to moderate ground conditions

- Fabricated boring head
- Hardened bolt-on teeth
- Hardened “fishtail” point
- Heavy-duty double flighting
- 4' overall length



HDF STYLE AUGERS - 2" Hex Couplers		
CNHi Part Number	Description	Weight (Lbs)
9863626	6" X 4' Auger	40
9863627	9" X 4' Auger	86
9863628	12" X 4' Auger	115
9863629	15" X 4' Auger	136
9863630	18" X 4' Auger	176
9863631	24" X 4' Auger	278
9863632	30" X 4' Auger	325
9863633	36" X 4' Auger	443



HDC STYLE AUGERS

For difficult ground conditions, compacted soils, heavy clay, asphalt, frozen ground fracturable rock

- HD cast boring head
- Hardened, drive-in teeth
- Hardened “fishtail” point
- Heavy-duty double flighting
- 4' overall length



HDC STYLE AUGERS - 2" Hex Couplers		
CNHi Part Number	Description	Weight (Lbs)
9863634	6" X 4' Auger	45
9863635	9" X 4' Auger	98
9863636	12" X 4' Auger	128
9863637	15" X 4' Auger	139
9863638	18" X 4' Auger	204
9863639	24" X 4' Auger	272
9863640	30" X 4' Auger	312
9863641	36" X 4' Auger	430



SRR ROCK AUGERS

For solid, fracturable rock, frozen ground and compacted soils

- Bullet style teeth
- Fabricated boring head
- HD single flighting
- 2" hexagon collar only
- 0.75" thick bottom flight and a hardface outer edge
- 4' overall length



SRR ROCK AUGERS - 2" Hex Couplers		
CNHi Part Number	Description	Weight (Lbs)
47904378	6" X 4' Rock Auger	82
47904381	9" X 4' Rock Auger	110
47904382	12" X 4' Rock Auger	137
47904383	16" X 4' Rock Auger	171
47904384	18" X 4' Rock Auger	192
47904385	20" X 4' Rock Auger	239
47904386	24" X 4' Rock Auger	285
47904387	30" X 4' Rock Auger	315
47904388	36" X 4' Rock Auger	414

Auger Drives & Auger Bits



CNHi Part Number	Auger Adapters	Weight (Lbs)
9863646	2" hex female to 2-9/16" round male	16
87042596	2" hex female to 2" round male	10
CNHi Part Number	Auger Extensions	Weight (Lbs)
87042601	12" extension - 2" hex	20
87042602	24" extension - 2" hex	32
84514060	48" extension, 2" hex	57



Ripper

Cont...



SPECIFICATIONS & FEATURES

Ripper is designed to provide powerful ripping ability in hard ground materials and the most demanding demolition applications

- Range from 4 to 75 ton excavators
- Apply all the power of your excavator at one point for maximum ripping efficiency
- Replaceable tooth and wear shroud (450 BHN)
- Added side wear protection to extend life of ripper (for excavators bigger than 14 tons)
- Extra thick steel shank for increased strength Ripper reduces excessive stresses on your excavator Reinforcing gussets for added durability



Ripper



Excavator Weight (Tons)	Model	Shank Thickness mm (in)	Approx Work Depth mm (in)	Weight kg (lbs)
4 - 10	RT08	90 (3.50)	660 (26.0)	145 (320)
10 - 14	RT14	102 (4.00)	813 (32.0)	245 (539)
14 - 22	RT18	114 (4.50)	940 (37.0)	450 (990)
24 - 30	RT30	114 (4.50)	1039 (41.0)	800 (1760)
30 - 38	RT38	130 (5.10)	1246 (49.0)	900 (1984)
38 - 52	RT52	130 (5.10)	1522 (60 .0)	1150 (2530)
52 - 75	RT75	160 (6.30)	1574 (62.0)	1750 (3857)



Backhoe Side Attachments – Construction Attachments



Selector Grab



Compaction Attachments





SPECIFICATIONS & FEATURES

- Mill on horizontal, vertical or sloped surfaces
- Constant planning depth
- Independent RH-LH depth adjustment
- Perfect surfaces with side-by-side passes



Standard Drum	Units	CNHi-PLB-350
Width	mm	350
	inch	14
Depth	mm	0 - 120
	inch	0 - 5
Width	mm	50 - 350
	inch	2-14
Max Depth	mm	150
	inch	6
Independent RH-LH depth adjustment		Standard
Minimum Distance from Curb	mm	50
	inch	2
Swinging support - Rotation Angle		118 Deg
Operating Weight	Kgs	530
	Lbs	1160
Required Oil flow	LPM	55-90
	GPM	15-24
Max. oil pressure	Bar	300
	PSI	4350



SPECIFICATIONS & FEATURES

Ideal for modern industrial demolition sites, and scrap and ferrous materials recycling professionals

- 360° Continuous hydraulic rotation.
- Adjustable shell opening/closing speed.
- Adjustable rotation speed.
- Safety Anti-falling valve block.
- Impact Stops on both bolt-on cutting edges.
- Bolt-on reversible cutting edge.



Selector Grab



Description	Unit	PMZ 08
Attachment weight	Kg	430
Maximum Jaw Opening [A]	mm	1540
Height [B]	mm	1115
Width [C]	mm	700
Grab Width in Closed Condition [D]	mm	920
Grab Height [E]	mm	940
Grabbing Force [Y]	ton.	4
Capacity	m3	0.25
Flow range	l/min	100-150
Max pressure	BAR	300
Max oil flow	l/min	50
Rotation max pressure	BAR	210
Rotation max oil flow	l/min	12

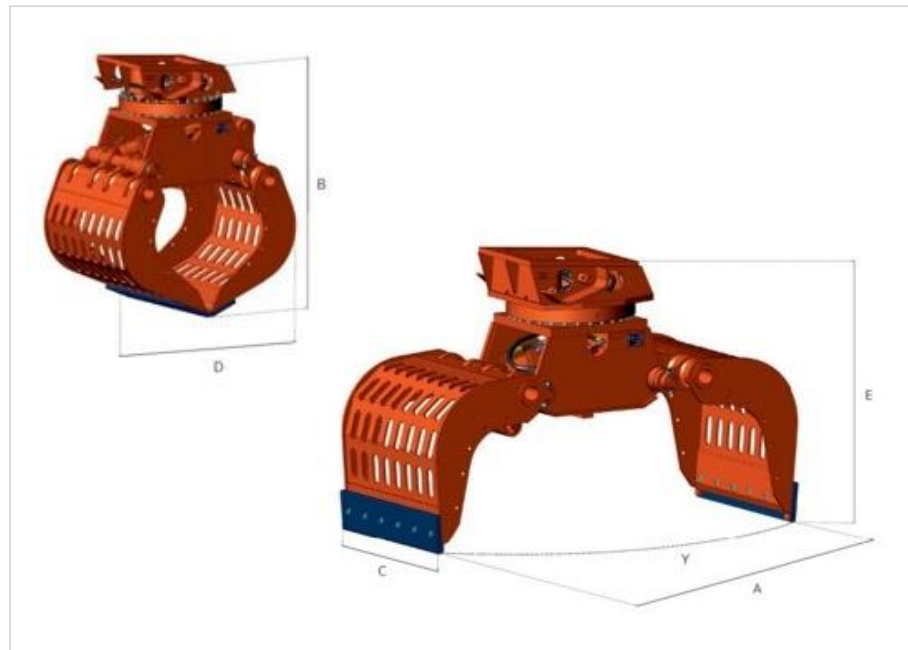

Hydraulic Plate Compactor



SPECIFICATIONS & FEATURES

- Direct-drive, heavy-duty gear motor
- Rubber shock mounts
- Box section base plate construction
- Angled shock mount suspension
- Thick formed base plate
- Flow control to prevent over speeding
- Virtually zero-maintenance oil bathed bearings
- Readily adaptable to other loader/backhoe brands

Applications

- Utilities, construction, road maintenance
- Ideal for slope compaction

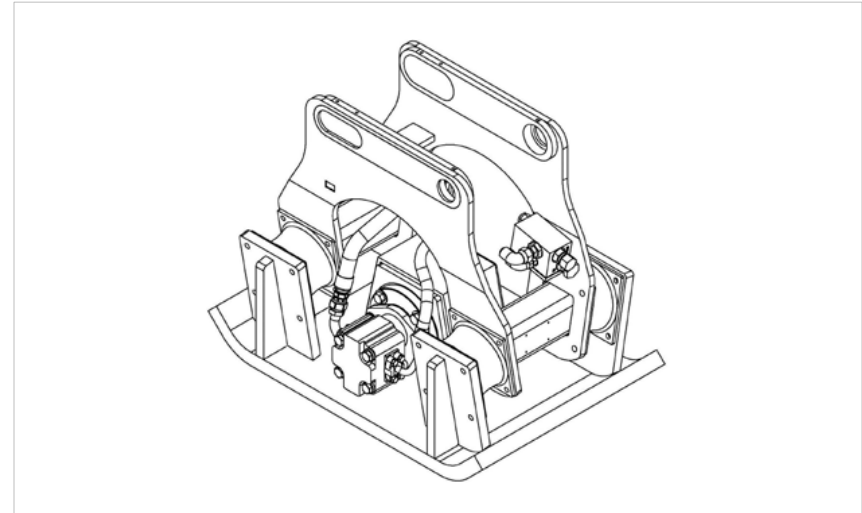

Requirements for Operation

- Uni- or bi-directional auxiliary hydraulics
- Pin/bushing/insert kit and hose kit specific to model series
- Dipper quick disconnect kit

Hydraulic Plate Compactor



SPECIFICATIONS	
Description	SC-60T
Impulse force (lb)	6400
Impulse force (kg)	2900
Cycles per min.	2100
Operating wt. (lbs)	875
Operating wt. (kg)	397
Base plate size (in)	24 x 26
Base plate size (mm)	610 x 660
Input flow (gpm)	12-25
Input flow (l/m)	45-95
Operating Pressure (psi)	1700-2100
Operating Pressure (bar)	117-145

Description	CNHi Part Number	Weight (Lbs)
SC-60T HYDRAULIC COMPACTOR	47808600	925
ADDITIONAL COMPONENTS (Hose kit and pin/bushing/insert kit required for complete unit)		
Hose kit for 580	51429129	6
Hose kit for 590	48015738	6
Pin/bushing/insert kit for M series	47451118	45
Pin/bushing/insert kit for N series	47808120	45

MODEL COMPATIBILITY	580M	580SM	590SM	580N	580SN	580SN WT	590SN	REQ'D EQUIPMENT		
								UNI OR BI-DIR AUX. HYD.	PIN/BUSHING KIT	DIPPER QD KIT*
SC-60T HYDRAULIC COMPACTOR	•	•	•	•	•	•	•	R	R	R

Hydraulic Plate Compactor



SPECIFICATIONS & FEATURES

- Plate Compactors provide the perfect combination of impulse force and frequency for handling trench and surface compaction needs.
- Each of the models are focused to the needs of the Contractor in road construction and repair, embankment preparation, utility and waste drain excavation backfill, as well as special needs in sheet, post, and plate driving for soil stabilization.
- Compactors provide features to enhance compaction effectiveness as well as to protect the owner's investment by limiting damaging forces resulting from operation and hydraulic impulses.



Description	TPC 350	TPC 1000	TPC 2K
Impulse Force (kg)	1,542	2,903	3,629
Operation Weight (kg)	238	429	590
Min. Carrier Weight (kg)	2,268	4,082	5,443
Max. Carrier Weight (kg)	6,350	12,701	18,144
Baseplate Width (mm)	476	597	610
Compaction Area (m3)	0.01	0.01	0.01
Vibrations per Minute	2,000	2,000	2,000
Max. Hydraulic Flow (Lpm)	95	95	151
Min. Hydraulic Flow (Lpm)	45	45	91
Max. Back Pressure (mb)	17237	17237	17237
Min. Hose Size (Inlet) (mm)	13	19	19
Min. Hose Size (Outlet) (mm)	13	19	19



Compaction Wheels



SPECIFICATIONS & FEATURES

- Compaction Wheels provide a cost effective, durable, and user friendly compaction method for use in most soils and trench conditions.
- Compaction Wheels are very effective in consolidating and condensing clay or fine mechanically stable (separates with difficulty) soils where other compaction means are ineffective.
- Compaction Wheel uses the machine force to compress columns of soil to achieve overall compaction, and unlike other compaction means this can be done in watery soil conditions.
- Compaction Wheels includes advanced design features to maximize life and minimize maintenance cost, maximizing your return on investment.
- Compaction Wheels do not require hydraulic connections with your machine protecting you primary investment, and require only minimal periodic maintenance to keep the product operational for years to come.



Description	Backhoe and Small Excavator		
	1000-12	1000-18	1000-24
Trench Width (Inches)	12	18	24
No. of Rims	2	3	4
Weight (Lbs)	520	740	980
Operating Weight (Lbs) *	750	970	1210
Wheel Diameter (Inches)	28	28	28
Shaft Diameter (Inches)	2.75	2.75	2.75
Min Machine (Lbs)	13000		
Max Machine (Lbs)	38000		
Machine Class (mT)	8 Ton		
	12 Ton		
Foot Type	Hardox Pad		



Vibratory Roller



SPECIFICATIONS & FEATURES

- Gives compaction in space where no other compactor reach
- Easy quick Compaction
- No labor required after compaction
- Plug n Play type

Applications

- Irrigation Canal
- Road
- Railway
- Trench
- Embankment
- Water Sewage



Description	CNHi-300
Drum Weight	400-450 Kgs
Drum Width	700 mm
Drum OD	600 mm
Area Covered in One Revolution	14 Sq. Feet



Orange Peel Grapple



SPECIFICATIONS & FEATURES

- Four Teeth
- Weight 250Kg
- Jaw Opening 1420mm
- Equipped with Hydraulic Rotation & Suspension Attachment

Applications

- Construction Sites
- Scrap Handling

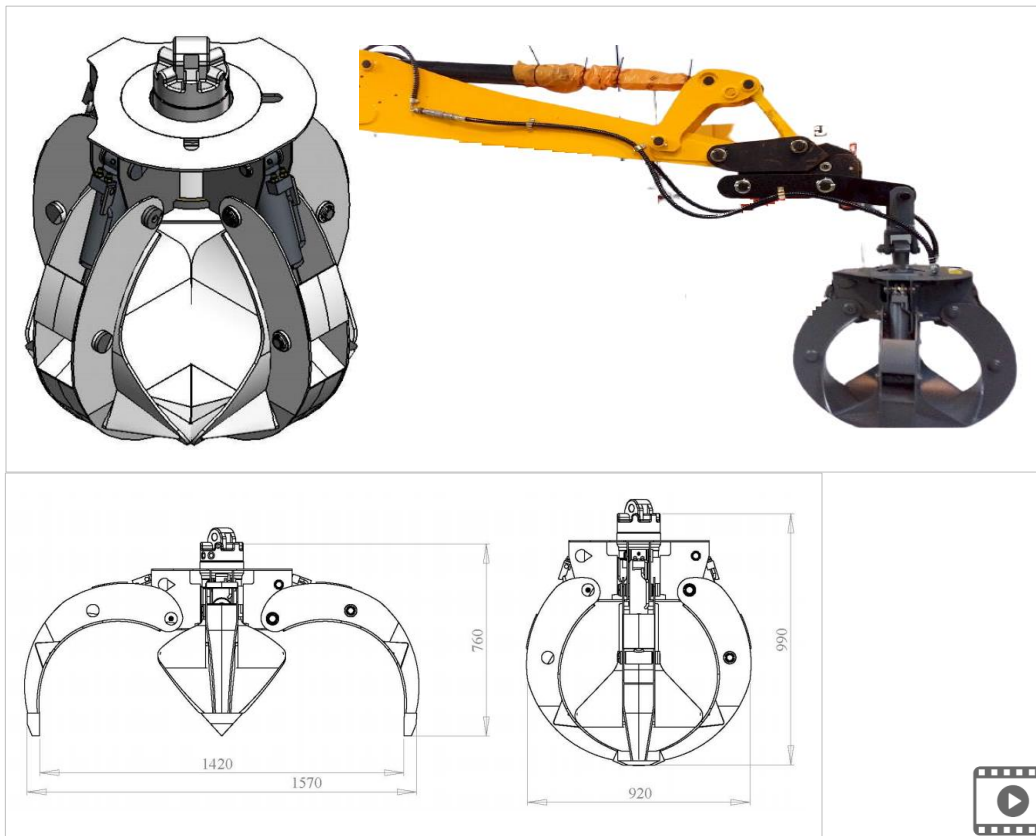

Backhoe Side Attachments – Demolition Attachments



Crusher & Pulverizer



Shear





SPECIFICATIONS & FEATURES

Ideal for the most delicate primary demolition phases, reinforced concrete structures and removal of materials at significant heights

- Adjustable rotation speed.
- 360° Continuous hydraulic rotation.
- Reversible and interchangeable blades for a consistent and perfect Rebar cut.
- Reverse cylinder for superior rod protection.
- Automatic speed multiplier valve to increase jaw cycle time.
- Interchangeable teeth for longer life of jaws.





Description	Unit	HC05ND
Attachment weight	Kg	550
Maximum Jaw Opening [A]	mm	480
Inner Force [X]	ton.	81
Outer Force [Y]	ton.	28
Length [B]	mm	1300
Width [C]	mm	50
	mm	140
Max Re-bar diameter	mm	20
Flow range	l/min	80-150
Max pressure	BAR	320
Rotation max oil flow	l/min	10
Rotation max pressure	BAR	120
Case drain		No

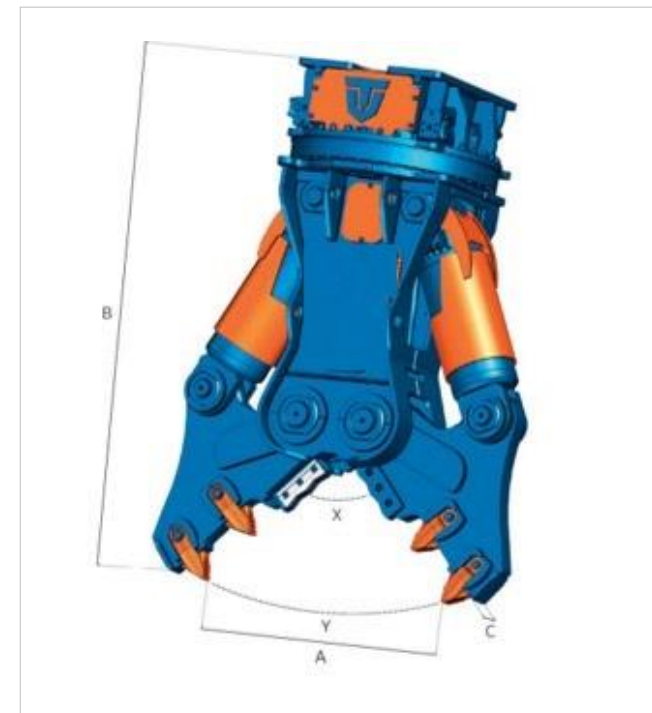



SPECIFICATIONS & FEATURES

Ideal for primary and secondary demolition phases. Accurate as a crusher and productive as a Pulverizer.

- 360° Continuous hydraulic rotation.
- Automatic speed multiplier valve to increase jaw cycle time.
- Adjustable rotation speed.
- Reverse cylinder for superior rod protection.
- Bolt-on Interchangeable teeth for longer jaw life.
- Reversible and interchangeable blades for a consistent and perfect Rebar cut.



Pulverizer

Cont...



Rotating		
Description	Unit	FR10
Attachment weight	Kg	900
Maximum Jaw Opening [A]	mm	655
Inner Force [X]	ton.	95
Outer Force [Y]	ton.	44
Length [B]	mm	1730
Width [C]	mm	360
	mm	140
Max Re-bar diameter	mm	25
Flow range	l/min	150-250
Max pressure	BAR	320
Rotation max oil flow	l/min	10
Rotation max pressure	BAR	140
Case drain		No

Fixed		
Description	Unit	F 07RD
Attachment weight	Kg	680
Maximum Jaw Opening [A]	mm	530
Inner Force [X]	ton.	105
Outer Force [Y]	ton.	43
Length [B]	mm	1345
Width [C]	mm	140
	mm	140
Max Re-bar diameter	mm	25
Flow range	l/min	60-120
Max pressure	BAR	320
Rotation max oil flow	l/min	
Rotation max pressure	BAR	
Case drain		

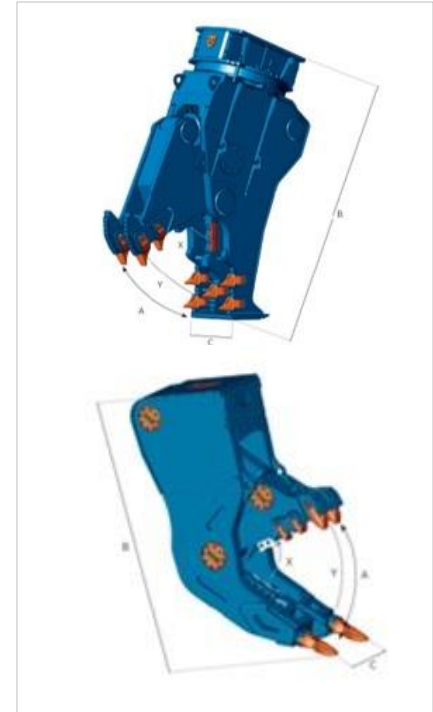



SPECIFICATIONS & FEATURES

Ideal for modern industrial demolition sites, and scrap and ferrous materials recycling professionals

- 360° Continuous hydraulic rotation.
- Automatic speed multiplier valve to increase jaw cycle time.
- Adjustable rotation speed.
- Reverse cylinder for superior rod protection and visibility.
- Reinforced thrust pad adjustment system.
- Adjustable, reversible and interchangeable blades by means of shims.
- Long life jaw alignment system.
- Wear plate for longer jaw life time.





Description	Unit	CS07 RS
Attachment weight	Kg	880
Maximum Jaw Opening [A]	mm	405
B	mm	370
C	mm	570
Length [L]	mm	2180
Inner Force [X]	ton.	236
Force at Center [Y]	ton.	99
Outer Force [Z]	ton.	55
Flow range	l/min	100-150
Max pressure	BAR	320
Rotation max oil flow	l/min	10
Rotation max pressure	BAR	140
Case drain		No

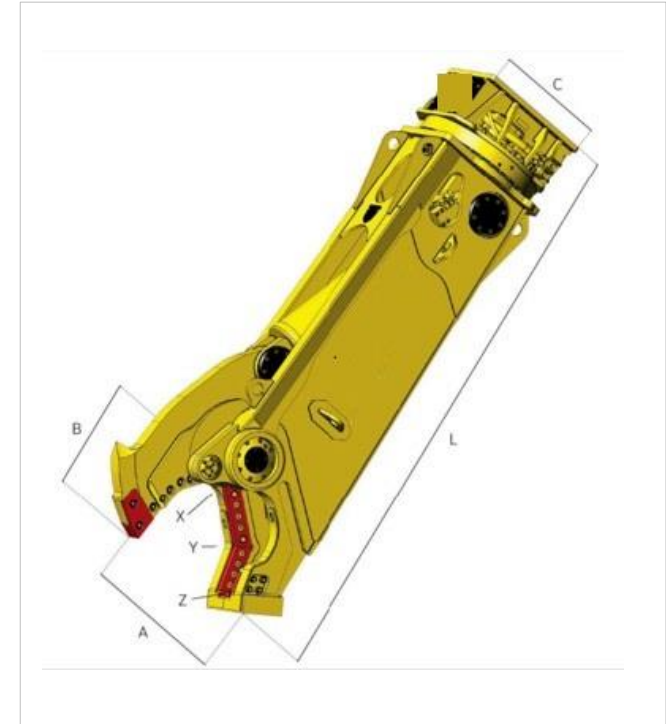

Multi Kit – Universal Processor



SPECIFICATIONS & FEATURES

The **MK SERIES MULTI KIT PULVERIZER** is a multifunctional equipment consisting of a universal body to which different demolition kits are hooked. Thanks to an innovative hydraulic release system without having to remove structural pins manually.

- Reinforced rotation motor
- Manual adjustment of rotation speed
- Locking/unlocking control device
- Speed multiplier valve
- Interchangeable blades and teeth



Multi Kit – Universal Processor



Description	Unit	MF 05
Attachment weight	Kg	530
Height [H]	mm	1500
Max pressure	BAR	320
Flow range	l/min	80-250
Rotation max pressure	BAR	120
Rotation max oil flow	l/min	10

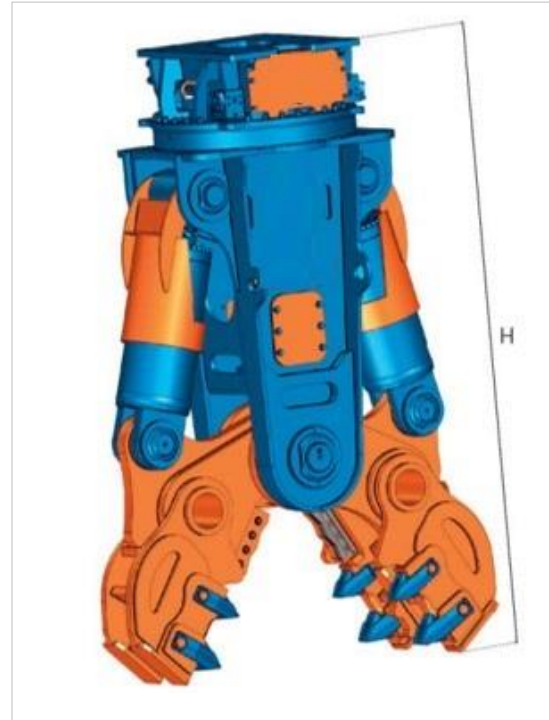



HC		
Description	Unit	MF 05
Attachment weight	Kg	160
Maximum Jaw Opening [A]	mm	570
Length [B]	mm	435
[C]	mm	50
[D]	mm	50
	mm	140
Inner Force [X]	ton.	120
Outer Force [Y]	ton.	49
Max Re-bar diameter	mm	25

FR		
Description	Unit	MF 05
Attachment weight	Kg	230
Maximum Jaw Opening [A]	mm	570
Length [B]	mm	435
[C]	mm	200
[D]	mm	330
	mm	140
Inner Force [X]	ton.	120
Outer Force [Y]	ton.	49
Max Re-bar diameter	mm	20

CS		
Description	Unit	MF 05
Attachment weight	Kg	185
Maximum Jaw Opening [A]	mm	225
Length [B]	mm	210
[C]	mm	50
[D]	mm	155
	mm	120
Inner Force [X]	ton.	85
Outer Force [Y]	ton.	35
Max Re-bar diameter	mm	25
Maximum I Beam Size	mm	120

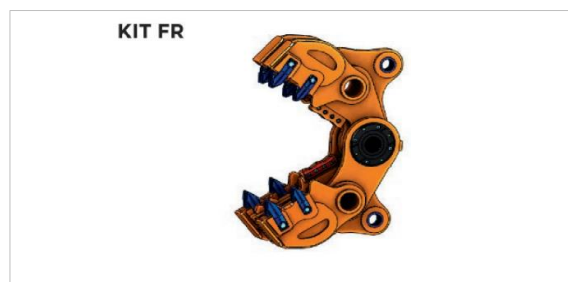
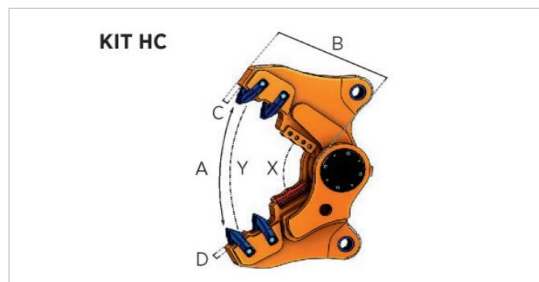

Backhoe Side Attachments - Trenchers



Trencher



Drum Cutter





SPECIFICATIONS & FEATURES

The **Trencher** is equipped with **Head Start Crumber system**, **Quality Planetary Drive & Eaton Hydraulic Motor**, **adjustable Skid Foot** and **Single Spoil removal Auger** for consistent digging depth.

Can be used for pipe laying for irrigation, underground power / communications, road repairs and general construction

- Head Start Crumber System with Steel Scraper Shoe begins Trenching with the Crumber down and save time by not having to get out of your machine
- Adjustable Skid Foot features 4 preset Digging Depths. Highly visible and can be seen from the cab. No spotter required
- Upto 1500mm dig depth & 300mm digging width with a 50.8mm chain 3 different chain options available: Earth, Combo, and Strong
- Standard Flow XD range features a compact, yet powerful Planetary Drive
- High flow XD models come with a 6K Eaton hydraulic motor
- Frame can be side shifted for digging close to permanent structures

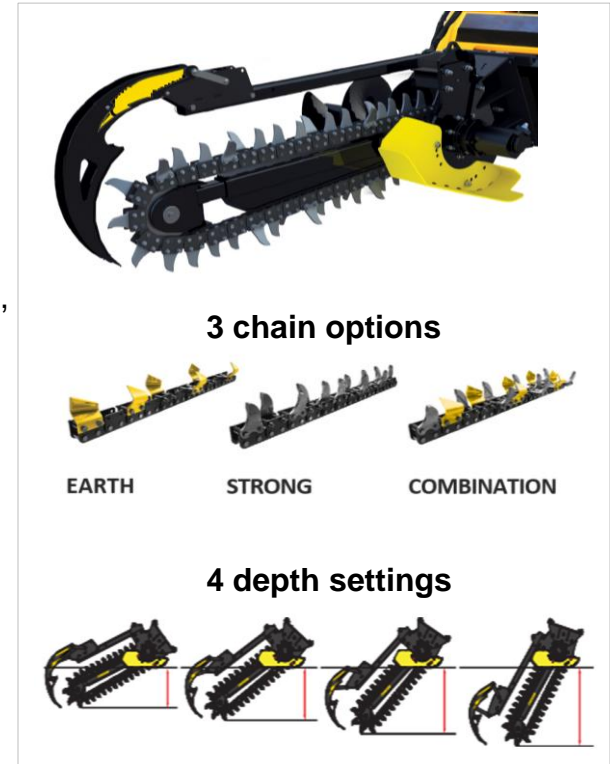

Trencher



Description	CNHi-T-900	CNHi-T-1200	CNHi-T-1200 HF	CNHi-T-1500 HF
Cutting Depth	Up to 900 mm	Up to 1200 mm	Up to 1200 mm	Up to 1500 mm
Cutting Width (mm)	150 / 200 /250 / 300	150 / 200 /250 / 300	150 / 200 /250 / 300	150 / 200 /250 / 300
Foot Depth Presets	450 / 600 / 750 / 900	600 / 800 / 1000 / 1200	600 / 800 / 1000 / 1200	750 / 1000 / 1250 / 1500
Recommended Flow (lpm)	60-115	60-115	105-170	105-170
Motor Type	2K Bell EATON	2K Bell EATON	6K Bell EATON	6K Bell EATON
Max Pressure - Do not exceed	240 Bar @ 60 lpm		240 Bar @ 130 lpm	
Max Flow - Do not exceed	95 lpm @ 200 bar		170 lpm @ 180 Bar	
Max Continuous Power	25 Kw (34 hp)		50 Kw (67 hp)	
Length (mm)	2225	2532	2532	2689
Horizontal Height (mm)	777	777	777	836
Width (mm)	1212	1212	1212	1138
Weight (kg) - 150mm Combo Chain	388	405	424	461
Skid Steer Loader: Std Flow	Ok	Ok	-	-
Skid Steer Loader: High Flow	Ok	Ok	Ok	Ok
Backhoe	Ok	Ok	Ok	Ok
Excavator: 3.5-8t	Ok	Ok	Ok	Ok



SPECIFICATIONS & FEATURES

Case Drum Cutters are ideal for Trenching, Profiling Rock and Concrete Walls, Tunneling, Quarrying, Demolition, Dredging, Finishing Operations and Underwater Works.

They are highly effective where conventional excavation systems are too weak and percussion systems have little effect.

Their quiet operation allows them to be put to work near sensitive areas (residential zones, hospitals, schools, bridges and infrastructures).

- Precise cut
- Low vibrations
- High performance
- Low noise level
- Deep and narrow trenches
- Underwater works
- Maintenance-free
- Milled material reused on site



Drum Cutter

Cont...



Description	Units	CNHi-DC-400
Recommended Excavator Weight	ton	6-12
	lbs	13000 - 26500
Weight without bracket (1)	kg	470
	lbs	1050
Hydraulic motor power	kW (hp)	37 (50)
Rotation torque	kNm	4,6
	lbf.ft	3390
Cutting force	kN	20,3
	lbf	4600
Max. pressure (2)	BAR	350
	psi	5100
Required oil flow	l/m	65 - 120
	gpm	17 - 32

THANK YOU!



Tavinder Pal Singh Arora

AMEA Aftermarket Attachments Business Manager

Cell: +91 95820 80913 | Email: tavinder.arora@cnhind.com