

Australian Green Building Industry Showcase



green building council australia



Australia
UNLIMITED



“This Australian Green Building Industry Showcase, is a joint publication developed by the Green Building Council of Australia and Austrade, which aims to showcase a selection of innovative Australian companies who are active in international markets and represent Australia’s world-class capability.”

Michael Abrahams

Executive Director, Australian Operations, Australian Trade Commission

Australian Green Building Industry Showcase

About Green Building Council of Australia

Launched in 2002, the Green Building Council of Australia (GBCA) is a national, not-for-profit organisation that is committed to developing a sustainable property industry for Australia by encouraging the adoption of green building practices. It is uniquely supported by both industry and governments across the country.

The Green Building Council's mission is to develop a sustainable property industry for Australia and drive the adoption of green building practices through market-based solutions.

Its key objectives are to drive the transition of the Australian property industry towards sustainability by promoting green building programs, technologies, design practices and operations as well as the integration of green building initiatives into mainstream design, construction and operation of buildings.

For more information

02 8239 6200 within Australia
+61 2 8239 6200 from outside Australia
info@gbca.org.au
www.gbca.org.au



About Austrade

The Australian Trade Commission – Austrade – is the Australian Government's trade and investment development agency.

Through a global network across 52 countries, Austrade assists Australian businesses to succeed in international business, attracts productive foreign direct investment into Australia and promotes Australia's education sector internationally.

Our role is to advance Australia's international trade and investment interests by providing information, advice and services.

Specifically, we:

- ▶ Assist Australian enterprises to capture increased export and overseas investment opportunities, including through administration of the Export Market Development Grants (EMDG) scheme and Trade Start partner program
- ▶ Attract productive foreign direct investment (FDI) into Australia, providing a range of services and information to international investors and working closely with state governments to streamline investment facilitation
- ▶ Promote the Australian education sector in international markets and assist Australian education and training providers with market information
- ▶ Assist international buyers to locate and identify the right Australian suppliers
- ▶ Provide advice to the Australian Government on its trade and investment policy agenda
- ▶ Deliver Australian consular, passport and other government services in designated overseas locations.

For more information

13 28 78 within Australia
+61 2 9392 2000 from outside Australia
greenbuilding@austrade.gov.au
www.austrade.gov.au





“Australia is undoubtedly leading the world in terms of green buildings. We have the tools and the industry leadership to drive the green agenda brick-by-brick, building-by-building. It is now our challenge to green our cities.”

Tony Arnel

Chairman, Green Building Council of Australia
 Chairman, World Green Building Council
 Victorian Building Commissioner & Plumbing Commissioner

Showcase Index

Air Change Australia	6	Living Green Designer Homes	47
ASPECT Studios	7	Lend Lease	48
Atlantis Corporation Pty Ltd	9	Marchese Partners International	50
Aurecon	11	Northrop Consulting Engineers	52
Bauwerk Colour	14	NOWarchitecture	54
BHI Architecture and Urban Design	15	Panelwall Pty Ltd	56
The Buchan Group	17	Phase Change Products Pty Ltd	57
BuildingIQ	19	PTW Architects	58
Cameron Chisholm Nicol	20	Ritek – Building Solutions Pty Ltd	61
Cox Architecture	22	Solahart Industries Pty Ltd	63
Cundall	25	Sinclair Knight Mertz	64
DMA Group Architects	27	STAR Water Solutions	67
ecospecifier Pty Ltd	28	Studio 505	68
EP&T Pty Ltd	29	Switch Automation	71
GHD	30	Thermotec Australia Pty Ltd	72
Good Environmental Choice Australia	32	Total Energy Solutions Pty Ltd	73
Group GSA	33	Umow Lai Pty Ltd	74
HASSELL	35	Viridis E3	76
Kann Finch Group	38	Weathertex	78
Kingspan Insulation Pty Ltd	40	Woods Bagot	79
LAB architecture studio Pty Ltd	42		
LAVA	44		

Air Change Australia

Air Change is an Australian company dedicated to developing sustainable technologies for improving indoor air quality. We design and manufacture Heating Ventilation and Air Conditioning (HVAC) systems which incorporate energy/heat recovery technology. This minimises the energy required to condition the outdoor air supply for the indoor environment. Our multi-awarded technology can be specified to achieve 6 Star Green Star & NABERS energy ratings and features in some of Australia's most prominent green buildings, offices, schools, gyms, indoor pools, retail, outlets and hospitals. Air Change energy recovery systems have also been exported to Asia, the Middle East and the Pacific regions.

Key Information

Award winning Australian company dedicated to developing innovative and energy efficient HVAC equipment built with it's unique heat recovery technology.

Contact

David Gartrell

Phone

+61 2 9531 4699

Email

davidgartrell@
airchange.com.au

Web

airchange.com.au

Address

12 Parraweena Road
Caringbah NSW 2229

Technologies & Capabilities

The core Air Change technology is it's unique internationally patented air to air heat/energy counterflow plate heat exchanger. The heat exchanger is an integral part of the entire innovative product range that can deliver up to 100 per cent fresh air using minimal additional energy. Due to the unique design of the Air Change plate heat exchanger very high temperature and moisture exchange efficiencies are achieved which can effectively reduce HVAC plant size and energy consumption by up to 50 per cent depending on prevailing climatic conditions. Air Change offers a range of packaged HVAC units that are designed and manufactured in Australia.

ESD Features

- Modified Variable Flow Primary Flow Chilled water system achieving 30 per cent improvement in overall chilled water plant energy efficiency
- 8 Energy efficient Air Handling Units are installed to deliver 100 per cent Outside Air Utilising energy recovery technology

Key Areas of Expertise

Building Technology / Products

- Energy Saving
- Energy Efficiency
- Indoor Environment Quality

Building Type

All

Typical International Business Partners/ Customers

Engineers
Specifiers
Agents / Distributors

Current Export Markets

Afghanistan, Australian Antarctic Territory, East Timor, Fiji, India, Indonesia, Macau, New Zealand

Target Export Markets

Afghanistan, British Antarctic Territory, Canada, East Timor, England, Germany, Indonesia, Ireland, Israel, Italy, Jordan, Kuwait, Netherlands Antilles, New Zealand, Oman, American Samoa, Scotland, Singapore, South Africa, Turkey, United Arab Emirates, United States of America, Virgin Islands, British Virgin Islands, Wales



ASPECT Studios

ASPECT Studios is committed to providing the best in creative design, for landscape architectural, urban design and interactive digital media projects. Our studios combine to promote a culture of excellence, and passion. We work as a multidisciplinary team, always learning and collaborating. We are innovators and leaders. We win awards, not just for what we design but for the way we think. The quality of our built and strategic work is proven and sustainability is central to our practice. We work across local, regional and international markets, and our clients include all levels of government, and the private sector.

Key Information

We're designers, we do sustainable landscape architecture.

Contact

Chris Razzell

Phone

Melbourne

+61 3 9417 6844

Shanghai

+86 21 5302 8555

Email

chrisr@aspect.net.au

Web

aspect.net.au

Address

30-32 Easey Street
Collingwood VIC 3066

Technologies & Capabilities

We have established design studios in Melbourne, Sydney and Shanghai with over 70 professional staff operating as a single studio. We are recognised by our peers and professional associations with over 30 professional awards in the last 3 years. Our work encompasses a broad diversity of projects, scopes and scales in both Australia and China. We excel in project management and innovative solutions. Our approach to sustainability recognises the potential that our designs offer the landscape, the people who use it and the client. Successful sustainable design finds a balance between ecological sensitivity, sound analysis and innovative design solutions.

Key Areas of Expertise

Master Planning

Landscape Design

Building Technology / Products

- ▶ Water capture, efficiency or reuse
- ▶ Use of recycled content / Materials

Building Type

Precincts / Communities

Commercial

Hospitals / Aged Care

Education & Science

Hotels & Resorts

Retail

Convention Centres

Government

Residential

Public Realm / Park

Typical International Business Partners/ Customers

Government – Public Sector

Project Developers

Private Sector Developers

Architects

Engineers

Current Export Markets

China

India

Target Export Markets

Vietnam

Profile continued >

ASPECT Studios



▲ Melbourne Convention Centre, VIC, Australia
6 Star Green Star – Convention Centre Design PILOT

Australian Green Building Project

Project name
Melbourne
Convention Centre

Project Type
Commercial

Project Location
Melbourne VIC

Project Partners
Plenary Group
Brookfield Multiplex
Contexx
NH and Woods Bagot
Architects
Direct Architects
JMP
Winward Structures
CJ Arms
Blyth Sanderson
Lincoln Scott
GTA Consultants

- ESD Features**
- › 6 Star Green Star Rating
 - › Bio retention swales remove water contaminants
 - › Passive irrigation
 - › Indigenous planting palette
 - › Pedestrian and cycle friendly
 - › Heritage design integration

International Green Building Project

Project name
Tianjin Eco City Park

Project Type
Public realm / park

Project Location
Tianjin, China

Project Partners
Vanke Tianjin Eco City
Community

- ESD Features**
- › China Construction Bureau, Green Building 3 Star Certified
 - › Permeable pavements
 - › Low water consumption
 - › Passive drainage
 - › Recycled material use
 - › Indigenous planting palette

Atlantis Corporation Pty Ltd

Key Information

Atlantis is the leading international provider of water management solutions. With offices and partners around the world we integrate consulting and the supply of innovative technologies to develop total environmental solutions for urban stormwater management.

Contact

Stephen Herd

Phone

+61 2 9417 8344

Email

stephen@atlantiscorp.com.au

Web

atlantiscorp.com.au

Address

*3/19-21 Gibbes Street
Chatswood NSW 2067*

Atlantis born out of landscaping architectural practices is today a provider of global environmental management solutions. With offices and partners across Australia, Europe, South America, Asia and Oceania we integrate consulting technical services and supply innovative technology capabilities in order to develop total environmental solutions in water management. Our track record is strong with proven expertise in developing designing implementing and supplying solutions to complex environmental projects around the world.

We provide total solutions for environmental landscape architecture in storm water management to solve flush flooding and provide global water solutions. We offer a comprehensive range of skills and expertise encompassing all facets of environmental storm water management and purification.

Benefit from the Atlantis experience – 30 years experience in ecological water management and industrial environmental design and manufacturing of products, 40 years of landscape architecture and nursery experience, present in over 45 countries.

Our Vision:

The Atlantis concept is to integrate urban development with nature, creating ecologically sustainable cities and communities. By combining air water flora and land to function in harmony with urban development water. The result is creating revolutionary green cities with natural ecosystems.

Profile continued >



Atlantis Corporation Pty Ltd

Technologies & Capabilities

- Ecological sustainable cities
- Prevent water shortage in cities and rural areas
- Eliminate contaminated water discharge into waterways or subsoil
- Capture storm water in cities to purify, store and recycle
- Save rainwater to recycle and supply potable water to cities and rural areas, fill aquifers or reuse it for irrigation
- Design and build ecological environmental streets, roads and highways

Key Areas of Expertise

Building Technology / Products
 Water Capture
 Efficiency or Reuse Building
 Use of recycled content
 Landscape Design

Building Type

Commercial
 Industrial
 Hospitals
 Hotels & Resorts
 Retail & Convention Centres
 Government
 Residential

Typical International Business Partners/ Customers

Government – Public Sector
 Project Developers
 Private Sector Developers
 Contractors
 Architects
 Engineers
 Specifiers
 Agents / Distributors

Current Export Markets

Asia, Oceania, Europe, North and South America, Africa and Indian ocean

Target Export Markets

Atlantis is open to any commercial enquiries



▲ Morilla Estate & Mona Museum Roof Garden, Hobart TAS

Australian Green Building Project

Project name
 Morilla Estate & Mona Museum Roof Garden

Project Type
 Commercial

Project Location
 Hobart TAS

Project Partners
 Allan Pwell Agencies
 Launceston

Architect
 Alan Powell

ESD Features
 4,500 sqm green roof

International Green Building Project

Project name
 Green vertical wall

Project Type
 Commercial

Project Location
 Bangkok

Project Partners
 LOXLEY

ESD Features
 First Gro wall installed in Thailand with our local partner

Aurecon

Aurecon has leading experts in the field of sustainable design with extensive experience across all disciplines and market groups. With offices located throughout Australia our Sustainability Group is able to assist a wide variety of clients in different regions. We are continuing to grow our team within Australia and internationally through our recent alliances. Our core strengths within individual trained disciplines have enabled Aurecon to develop a strong and holistic approach to sustainable design.

Key Information

Aurecon provides world-class engineering management and specialist technical services to government and private sector clients.

Contact

Jeff Robinson

Phone

+61 3 8683 1397

Email

Jeffrey.Robinson@
aurecongroup.com

Web

aurecongroup.com

Address

L12, 60 Albert Road
South Melbourne
VIC 3205

Technologies & Capabilities

The Aurecon Sustainability team has extensive skills and experience in the design of a wide range of contemporary hospitality entertainment commercial sporting and institutional projects with integrated ecologically sustainable design. We continue to provide ESD design consultancy for projects throughout Australia, New Zealand and South-East Asia. As a project partner Aurecon provides:

- › ESD solutions that are appropriate to local environments
- › Robust cost effective ESD design solutions that meet the project objectives
- › Proven efficient and effective ESD technology that adds value to the project that is financially responsible and accountable
- › Comprehensive simulation and modelling design software for lighting, day lighting, power and energy simulation, enhancing technical innovation while managing risk
- › In depth knowledge of Domestic and International rating protocols including Green Globe, LEED, NABERS and Green Star
- › Great communication with a positive team approach
- › A clear articulation of ESD objectives solutions and performance attributes
- › Creative and innovative contribution to the architectural design process. Commercial intelligence of the market response.
- › The projects that we have contributed to are among recognised leaders in sustainable development.

Key Areas of Expertise

Consulting Engineering
Project Management
Other – Technical Services
or Consultancy

Building Type

All

Typical International Business Partners/ Customers

Government – Public Sector
Project Developers,
Private Sector Developers,
Contractors, Architects

Current Export Markets

Bahrain, Central African
Republic, China, Hong
Kong, Indonesia, Macau,
Mozambique, Namibia,
New Zealand, Qatar,
Singapore, South Africa,
Thailand, Vietnam,
Zimbabwe

Target Export Markets

Hong Kong, Macau,
New Zealand, Qatar,
Singapore, South Africa,
Thailand, Vietnam

Profile continued >



Aurecon

International Green Building Project

Project name

Asteron Centre

Project Type

Commercial

Project Place

Wellington, New Zealand

Project Partners

One Featherston Street
Development Ltd

ESD Features

- › Storm water is harvested and reused for flushing toilets minimising stormwater runoff and potable water usage
- › The building will incorporate Wellington's largest heat pump chillers using waste heat from the cooling process to provide heating to the building and to preheat the domestic hot water. Additional heating for the domestic hot water uses heat pumps with an efficiency of more than 300 per cent
- › Air quality has been maximised by using 50 per cent more fresh air than Building Code minimums and the introduction of CO₂ sensors on the floors
- › Use of VOC and formaldehyde emitting products during building construction was minimised while PVC use has also been virtually eliminated
- › Occupancy and daylight sensors have been incorporated to minimise the amount of electric lighting reducing operating costs. This reduces electricity demand as well as reducing the load on the air conditioning system
- › Extensive use of energy metering combined with the computerised building management system will allow effective fine tuning of the buildings operation to minimise the use of energy and water
- › Construction waste is being recycled to the full extent possible.

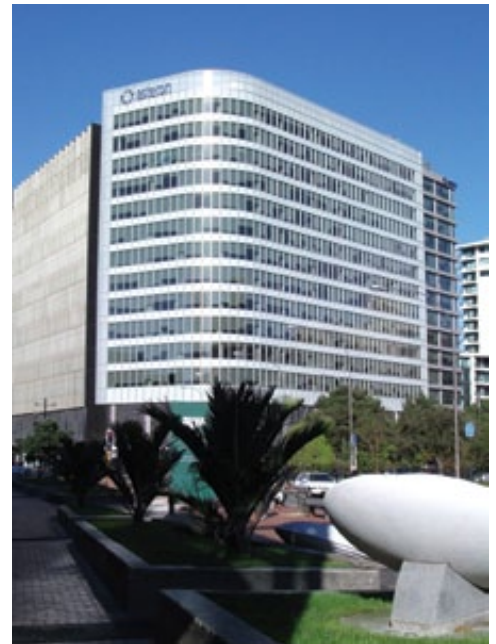

▲ Asteron Centre, Wellington. New Zealand

Australian Green Building Project

Project name

Bishops See

Project Type

Commercial

Project Location

Perth WA

Project Partners

Hawaiian / Brookfield

Multiplex

ESD Features

- Low temperature variable air volume air-conditioning system significantly reducing fan energy
- Water cooled high efficiency oil free magnetic bearing chillers coupled with oversized cooling towers
- High efficiency T5 lighting throughout the building
- Variable volume car park ventilation
- High performance low emissivity full height glazing
- Orientation of the building so the main axis runs east-west with external shading to the west, east and south
- A grey water system utilising sink and shower water discharge for toilet flushing. This system is the first design approved in a commercial building in WA
- Tenant bicycle storage facility located within the underground car park.



▲ Bishops See, Perth WA

BAUWERK Colour

BAUWERK offers exemplary modern lime paint in harmony with nature with an exquisite range of colours for both modern and traditional buildings. All base paints AND colouring pigments have been tested and are independently verified to meet the highest environmental criteria. Currently our main export markets are located in the Middle East where BAUWERK Paints are sold under the name of DMC natural paint.

Key Information

BAUWERK Colour produces award winning pure mineral paint for all wall surfaces that meet the highest environmental and aesthetic requirements.

Contact

Andreas Riedel

Phone

+61 8 9433 3860

Email

info@bauwerk.com.au

Web

bauwerk.com.au

Address

1/15 Emplacement Cres
Hamilton Hill WA 6163

Technologies & Capabilities

All BAUWERK paints and colours are free from toxins or hazardous materials. That makes it very easy for transport storage and application. A freshly painted room can be occupied again immediately without nauseous paint fumes. BAUWERK offers opportunities for retailers distributors and agents with tailored product ranges for particular markets including a complete Point of Sale System for retailers and licensing / JV agreements for manufacturers.

Key Areas of Expertise

Building Technology
/ Products

Indoor Environment Quality

Building Type

Commercial
Residential
Leading supplier
of paint for historic buildings

Typical International Business Partners/ Customers

Private Sector Developers
Contractors
Specifiers
Agents / Distributors

Current Export Markets

Germany
Kuwait
Saudi Arabia
United Arab Emirates
United States of America

Target Export Markets

Oman
Qatar
South Africa
South America
East Africa
Sudan
Syria

BAUWERK
COLOUR®

BHI Architecture and Urban Design

BHI has been established for 30 years as an Australian based architecture and urban design practice with regional and city offices having a high level commitment to quality and sustainable design. Internationally BHI maintains an office in Shanghai which supports a diverse range of projects throughout China. BHI maintains a certified Quality Management System to ISO 9001 Environmental Management to ISO 14001 and OH+S Management Systems. BHI is able to provide specialist design services including urban design, architecture, landscape design, interior design and heritage. BHI innovative design creates environmentally responsive green buildings, new towns and precincts that enhance community living.

Key Information

BHI is a multi disciplinary company offering best practice in ARCHITECTURE + URBAN DESIGN with a commitment to environmental design and building sustainable green communities buildings and infrastructure.

Contact

Mark Hitchcock

Phone

+61 416 212 582

Email

mark@bhia.com.au

Web

bhia.com.au

Address

77 Dunning Avenue
Rosebery Sydney
NSW 2018

Technologies & Capabilities

The diversity of experience from BHI demonstrates our capability to manage the planning, urban design and architecture processes. BHI brings together through an integrated process; planning, transportation, architecture, economics, landscaping and engineering and embracing design excellence. Project priorities are tracked through all stages of project delivery with design management systems ensuring design quality and optimisation of the client brief. Project management systems deliver effective projects that are within budget and programme with integrated BIM software for design and documentation. BHI has received numerous awards, including from the Australian Institute of Architects and has won a number of international competitions.

Key Areas of Expertise

Master Planning
Architecture
Landscape Design

Building Type

Precincts / Communities
Commercial
Industrial
Hospitals / Aged Care
Education & Science
Hotels & Resorts
Retail Convention Centres
Government
Residential

Typical International Business Partners/ Customers

Government – Public Sector
Project Developers
Private Sector Developers

Current Export Markets

China

Target Export Markets

China
Hong Kong
Taiwan

Profile continued >





International Green Building Project

Project name

West Tai Lake Science and Education Ecological City

Project Type

New City Development

Project Place

Changxing, China

Project Partners

Changxing Construction Department

ESD Features

- › Integration of existing villages
- › Urban agriculture
- › Connectivity of private and public transport including light rail access close to all population nodes as an integrated system
- › Integration of water from mountain to Tai Hu and high water quality
- › Balance of high density community hubs with open space and agriculture
- › Functions related to Economic future of Changxing
- › Low carbon footprint, low energy, self-sustaining
- › Environmentally sensitive design from the master plan scale to the detail building design.

Australian Green Building Project

Project name

Illawarra Employment + Teaching Campus

Project Type

Education and Residential facility

Project Place

Sydney NSW

Project Partners

Illawarra Technical and Further Education

ESD Features

- › Built form that established a campus style precinct of 100 000 sqm for 3000 students within the natural environmental context
- › 6 star rated concept assessment using GBCA Education rating tool
- › Maximizing natural daylight and ventilation opportunities through the internal Green atrium concept
- › Space heating / cooling using BMS
- › Use of chilled beam radiators coupled with air handling geothermal system
- › Storm water infiltration trenches permeable paving rooftop gardens
- › Grey /blackwater reuse systems thermally responsive high performance building envelope.



The Buchan Group

The Buchan Group began in Geelong in 1890 and is now recognised internationally for its innovative, integrated design and project delivery systems. It is one of the largest architectural groups in Australia, with almost 400 staff providing a multi disciplinary design service. It operates across a diverse range of project types in seven locations within Australia and New Zealand, as well as London, Dubai and Shanghai. Current and recent projects include large-scale mixed use developments, shopping centres, landmark 5-star hotel developments, 5-star resorts, 3-star hotels and high quality boutique apartment developments.

Key Information

Architecture,
Master Planning,
Interior Design, Graphics.

Contact

Bruce Shaw

Phone

+61 3 9329 1077

Email

bruce.shaw

@buchan.com.au

Web

buchan.com.au

Address

133 Rosslyn St
West Melbourne
VIC 3003

Technologies & Capabilities

Whilst the Buchan Group's core discipline is architectural design, we are a multi discipline group providing architectural design, master planning, interior design, graphic design and 3D visualisation services.

We can also integrate out-of-house design and industry professionals into our design processes – from structural, services and traffic engineers to landscape architects, town planners, lighting designers, marketing consultants and leasing agents – leading and co-ordinating these disciplines to realise the total design vision.

Key Areas of Expertise

Master planning
Architecture
Interior Design

Building Type

Precincts / Communities
Commercial
Industrial
Hospitals / Aged Care
Education & Science
Hotels & Resorts
Retail
Convention Centres
Government
Residential

Typical International Business Partners/ Customers

Government – Public Sector
Project Developers
Private Sector Developers
Contractors
Architects
Engineers
Specifiers

Current Export Markets

China, England, Japan,
New Zealand, Taiwan,
United Arab Emirates

Target Export Markets

China, England, France,
India, Ireland, Japan,
New Zealand, Scotland,
Taiwan, Wales,
United Arab Emirates.

Profile continued >



▲ West Mall, Chadstone Shopping Centre, VIC, Australia 5 Star Green Star – Retail Centre Design PILOT

Australian Green Building Project

Project name

West Mall, Chadstone Shopping Centre

Project Type

Retail

Project Place

Melbourne VIC

Project Partners

CFS Global Asset Management
The Gandel Group

ESD Features

- › First 5 Star Green Star – Retail Centre in Australia, adds 120 new tenancies and 15,160 sqm to existing centre. \$140m value
- › High-performance glass roof 300m long, with thermally broken frames
- › Sealed window displays minimise solar heat-load
- › Insulated pre-cast facades; double glazing; shading to entries
- › Exceptional public transport
- › Operational guides for building technology
- › Naturally lit mall; LED sensor-operated lighting
- › Hot layer air removal; night purging; high-efficiency air handling
- › Rainwater harvesting
- › Greenhouse gases reduced by 61 per cent
- › Potable water consumption reduced by 63 per cent.

BuildingIQ

BuildingIQ is the only building energy management software that can learn and forecast your building's energy requirements and continuously optimise your BMS settings to increase energy efficiency.

With our proprietary Predictive Energy Optimization™ technology you can:

- › Achieve a 10-30 per cent reduction in total energy spend by continuously maintaining high HVAC efficiency
- › Automate your participation in demand response programs and avoid peak day pricing penalties
- › Ensure occupant comfort
- › Increase your building's Energy Star LEED or NABERS ratings
- › Improve your property's valuation by increasing net operating income

Our software works with your existing building management system and best of all requires no capital outlays. It more than pays for itself out of cost savings.

Key Information

BuildingIQ is the only energy management system that predicts energy demand and directly adjusts heating ventilation and air conditioning (HVAC) system parameters to continuously optimise energy use.

Contact

Carmelo San Gil

Phone

+61 2 9360 0602

Email

carmelo@buildingiq.com

Web

buildingiq.com

Address

*19A Boundary St
Rushcutters Bay NSW 2011*

Technologies & Capabilities

Predictive Energy Optimization – BuildingIQ communicates with your building management system (BMS) and automatically reduces energy consumption while maintaining or improving tenant comfort. At the core of our system is a sophisticated thermal model that automatically learns your building's energy performance and then adapts to changes in internal or external conditions. BuildingIQ is the only system available today that factors in weather forecasts occupant comfort peak demand factors and demand response signals to minimize energy cost and consumption for building owners.

Key Areas of Expertise

Building Technology / Products

- › Energy Saving
- › Renewable Energy
- › Energy Efficiency

Building Type

Commercial, Education & Science, Retail, Convention Centres, Government

Customers

Government – Public Sector Project Developers, Private Sector Developers, Contractors, Specifiers, Agents / Distributors

Current Export Markets

United States of America

Target Export Markets

New Zealand, Singapore

International Green Building Project

Project name

Argonne National Laboratory

Project Type

Commercial

Project Place

Argonne Illinois USA

Project Partners

Argonne National Laboratory
U.S. Department of Energy

ESD Features

Installed BuildingIQ's Predictive Energy Optimization™ to reduce energy costs from HVAC systems.

Australian Green Building Project

Project name

Perth Council House

Project Type

Commercial/Historic Building

Project Place

Perth WA

Project Partners

City of Perth
Western Power

ESD Features

- › Installed BuildingIQ's Predictive Energy Optimization™ to reduce energy costs from HVAC systems
- › BuildingIQ generated significant overall energy savings on an ongoing basis, and reduced peak loads by up to 30 per cent.



Cameron Chisholm Nicol

Cameron Chisholm Nicol is a multi disciplinary company with design expertise in architecture, interior design, urban design and master planning.

CCN has developed a reputation for design excellence and client service with an extensive list of local, national and international clients many of whom have worked with CCN on a repeat basis in a variety of project disciplines including office, retail, hospitality, education, health, civic and cultural, and multi residential projects.

Key Information

Sustainability focussed architectural, master planning and interior design services.

Contact

Peter Keleman

Phone

+61 8 9322 1566

Email

*peter.keleman
@ccnwa.com.au*

Web

ccnwa.com.au

Address

*Level 3, Sheffield House
713 Hay St, Perth WA 6000*

Technologies & Capabilities

Through a collaborative, inclusive approach to architecture as place making, architecture for people, architecture that is based on sound commercial principles, CCN creates inspirational, sustainable architectural solutions.

CCN always aims to exceed the expectations of all stakeholders from client to community.

Key Areas of Expertise

Master Planning
Architecture
Interior Design

Building Type

Precincts / Communities
Commercial
Industrial
Health / Aged Care
Education & Science
Hotels & Resorts
Retail
Convention
Sporting & Entertainment
Facilities
Government
Residential

Typical International Business Partners/ Customers

Government – Public Sector
Project Developers
Private Sector Developers
Contractors
Architects

Current Export Markets

China
Hong Kong

Target Export Markets

China
South East Asia
India
Brazil



Australian Green Building Project

Project name

Cameron Chisholm Nicol Office Fitout – Sheffield House

Project Type

Commercial

Project Location

Perth WA

ESD Features

- › 4 Star Green Star – Interior Design Rating
- › 4.5 Star NABERS rating
- › 2010 AIA (WA) Sustainable Architecture Award
- › 2010 City Switch award for energy conservation
- › Heritage design integration

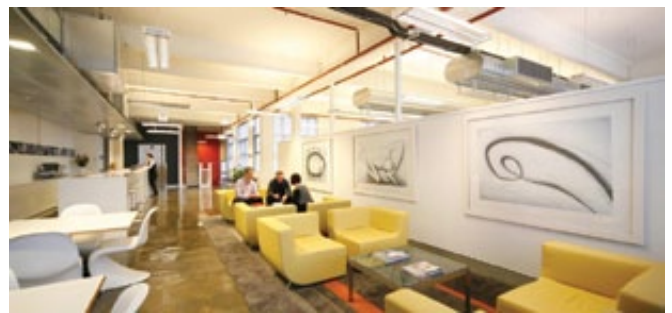

▲ Cameron Chisholm Nicol Office Fitout – 4 Star Green Star – Interior Design Rating

International Green Building Project

Project name

Carmel Retreat, California

Project Type

Hospitality

Project Location

Carmel Valley, California USA

Project Partners

Peninsula Hotel Group

ESD Features

Our approach was to focus on the complete guest experience to the finest levels of detail for our internationally recognised client. Our environmentally sensitive approach lead to architectural forms that responded to the climate, topography and heritage of the Carmel area whilst facilitating an unparalleled level of comfort and service.

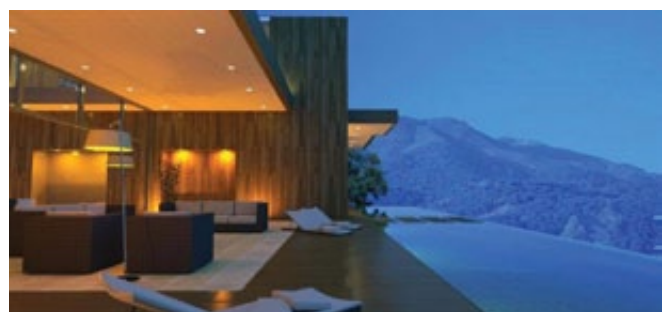

▲ Carmel Retreat, California

Cox Architecture

Cox Architecture is a major architecture, urban design and interior design practice with offices located throughout Australia. Our practice has won many Australian National and State Awards, and in 2010 won the World Architecture Festival Award for Transport Architecture for Singapore's Helix Bridge. Our 111 Eagle Street 50 storey tower in the Brisbane CBD is Australia's first 6 Star Green Star office tower (by design), and we have designed several 5 and 6 star office and public projects through our research and innovation.

Key Information

Cox Architecture integrates urban design, architecture and interior design into holistic environmental solutions encompassing the subtropical and tropical worlds.

Contact

Michael Rayner

Phone

+61 7 3210 0844

Email

michael.rayner@cox.com.au

Web

coxarchitecture.com.au

Address

Level 2
2 Edward Street
Brisbane QLD 4000

Technologies & Capabilities

Cox Architecture is accredited by the Green Building Council of Australia and applies the GBCA rating methodology to all of our projects. We have both environmental master planning and architecture expertise, and have been at the forefront of Government strategies to share energy and water across whole urban precincts. We have particular expertise in subtropical and tropical architecture, both in terms of innate design and advanced technologies harnessing and responding to climate.

Key Areas of Expertise

Master planning
Architecture
Interior Design

Building Type

Precincts / Communities
Commercial
Industrial
Hospitals / Aged Care
Education & Science
Hotels & Resorts
Retail
Convention Centres
Government
Residential

Typical International Business Partners/ Customers

Government – Public Sector
Project Developers
Private Sector Developers
Contractors
Architects
Engineers

Current Export Markets

Singapore
China
United Arab Emirates
Malaysia
India

Target Export Markets

Singapore
Indonesia
Malaysia
Vietnam
China
Hong Kong
Thailand
Cambodia
New Zealand
Laos



green building council australia
MEMBER 2010-2011

International Green Building Project

Project name

Helix Bridge

The Helix Bridge Singapore is formed by a unique double spiral structure which integrates canopy, deck and lighting with the structure. It is the world's first fully integrated pedestrian bridge. It is highly protective of people to the extremes of tropical climate, and encourages walking and exercise over car dependency. The strength of the 'DNA' structure – offered significant savings in steel tonnage and minimised deck thickness.

Project Type

Pedestrian Bridge

Project Location

Singapore

Project Partners

Urban Redevelopment Authority (Client), Arup (Structural Engineer) and Architects 61 (Joint Venture Architect)

ESD Features

- 20 per cent saving on steel
- Minimal embodied energy used in construction
- Integrated climate canopy and structure

Profile continued >



▲ Helix Bridge, Singapore

Cox Architecture



▲ One One One Eagle Street, 6 Star Green Star – Design and As built, 5 Star NABERS Rating

Australian Green Building Project

Project name

One One One Eagle Street

Project Type

Commercial

Project Partners

Client

GPT Group

Project Managers

Burns Bridge Sweett

Structural and

Civil Engineers

Arup

Managing Contractor

Leighton Contractors

Town Planner

Urbis

Services Engineers and ESD Consultant

WSP Lincolne Scott

Traffic Consultant

TTM Consulting (Qld) Pty Ltd

Landscape Consultant

Gamble McKinnon Green

Project Location

Brisbane QLD

ESD Features

- 6 Green Star – Design & As Built & 5 Star NABERS Energy Rating + 20 per cent

Innovative

Structural Solution

- Bio-mimicry
- > 10 per cent saving in materials, greater spans and a slender structure

Water Conservation

- Grey water recycling – saving up to 3.5 million litres of water per annum
- Trigenation – saving up to 6 million litres of water per annum

Energy Efficiency

- Trigenation, Hybrid VAV, lighting and energy control systems
- 45 per cent less Carbon ($60 \text{ kg/Co}_2/\text{m}^2$) than Australian Best Practice ($110 \text{ kg/Co}_2/\text{m}^2$)

Exceptional Indoor Environment

- Natural day light penetration
- Up to 150 per cent greater fresh air than Australian Standards
- Open & flexible floor plates
- Facilities – bicycle parking, showers and lockers



Cundall

Cundall is focussed on helping clients reduce their impact on the environment through leading and independent strategy, design delivery and operational sustainability services.

Key Information

Together we create change in the world.

Contact

Marlon Kobacker

Phone

+61 420 907 810

Email

m.kobacker@cundall.com.au

Web

cundall.com.au

Address

Level 1
48 Alfred St
Millson's Point
NSW 2060

Technologies & Capabilities

Our scope at planning stage forms the fundamentals of a project – what do we want to achieve in the project and how do we achieve it. We do this through:

- Project Sustainability Vision Workshop
- Project Sustainability Strategy
- Project Sustainability Target Setting
- Component Efficiency Target Setting

Our scope at design stage varies depending upon the procurement method and also Cundall's involvement. We can act as the ESD Consultant or as the overseeing Sustainability Consultant. We offer full ESD services including Green Star, NABERS, CBD energy modelling, LEED, BREEAM, Basix etc. Our scope at delivery stage is our most important stage. We work with the design and construction team offering training, education and Green Star As Built delivery.

ESD Features

The buildings feature a "mixed mode" environmental control strategy using natural ventilation coupled with low-energy air conditioning provided by passive chilled beams and low-level air supply system.

Key Areas of Expertise

Master Planning
Consulting Engineering
Technical Services and Consultancy

Building Technology / Products

- Water Capture Efficiency
- Use of recycled content / Materials Building

Technology / Products

- Energy Saving – Renewable Energy
- Indoor Environment Quality

Building Type

Precincts / Communities
Commercial
Industrial
Hospitals / Aged Care
Education & Science
Hotels & Resorts
Retail
Convention Centres
Government
Residential

Typical International Business Partners/ Customers

Government – Public Sector
Project Developers
Private Sector Developers
Contractors
Architects
Engineers
Specifiers
Agents / Distributors

Current Export Markets

China, Cyprus, England, Hong Kong, India, Libya, Macau, Malaysia, New Zealand, Northern Ireland, Oman, Papua New Guinea, Philippines, Poland, Qatar, Romania, Scotland, Singapore, South Africa, Spain, Thailand, Vietnam, Wales

Target Export Markets

Argentina, Bahrain, Brazil, Bulgaria, Costa Rica, Croatia, Estonia, Fiji, Ghana, Hungary, Indonesia, Israel, Japan, Kazakhstan, Republic of South Korea, Latvia, Lebanon, Lithuania, Maldives, Mexico, Moldova, Morocco, Netherlands, New Caledonia, Nicaragua, Russian Federation, Slovakia, Slovenia, Sri Lanka, Tanzania, Tunisia, Turkey, Ukraine, Uzbekistan

Profile continued >

CUNDALL



green building council australia
MEMBER 2010-2011

Cundall

International Green Building Project

Project name
Vodafone World Headquarters

Project Type
Commercial

Project Location
Newbury

Project Partners
Vodafone UK

ESD Features
The buildings feature a “mixed mode” environmental control strategy using natural ventilation coupled with low-energy air conditioning provided by passive chilled beams and low-level air supply system.

Australian Green Building Project

Project name
Westfield Sydney

Project Type
Mixed Use

Project Location
Sydney NSW

Project Partners
Westfield Pty Ltd

ESD Features
Featuring 10 separate Green Star submissions in all, the project vision is to showcase sustainable refurbishment at the highest level targeting a 50 per cent reduction in energy to bring the project in line with the City of Sydney’s 2030 plan. To achieve this the development incorporates sophisticated facade design integrated with efficient building services. The project is targeting an 80 per cent reduction in potable water consumption by both maximising efficiency as well as harvesting and recycling waste water to supply non-potable demand. To minimise embodied energy materials have been selected with a high recycled content and from natural sources.



▲ 100 Market St, Sydney 6 Star Green Star – Office Design v2. This is part of a larger redevelopment for Westfield Sydney.

DMA Group Architects

DMA was established in 1998 to provide professional, quality and personal design services to our clients. Founding director David Millis is an architect with over 30 years experience worldwide. DMA has been working consistently on design projects in China since 2005. We have been awarded for design excellence over the years and in 2008 received recognition of our export achievements as an award winner in the Telstra and Business Club Australia 'Win Business Gold in China' initiative.

We are committed to ESD in our design work and David Millis is a GBCA registered professional.

Key Information

DMA are a Brisbane based professional design firm specialising in urban design (master planning), architecture and interior design.

Contact

David Millis

Phone

+61 7 3367 8601

Email

design@dmagroup.com.au

Web

dmagroup.com.au

Address

221 Hale Street
Brisbane QLD 4000

Technologies & Capabilities

We have experienced, talented staff who are committed to the company's philosophy of providing design excellence and quality, personal service. We have staff who are fluent in Mandarin, Cantonese, Hakka and Malay and we have strong connections with design institutes throughout China.

We are flexible in our approach and able to travel overseas at short notice to service our clientele. We are keen to build on our success in China and extend into other developing countries in the region.

Key Areas of Expertise

Master Planning
Architecture
Interior Design

Building Type

Precincts / Communities,
Commercial, Industrial,
Hotels & Resorts, Retail,
Residential

Typical International Business Partners/ Customers

Government – Public Sector
Project Developers
Private Sector Developers,
Contractors
Architects
Engineers

Current Export Markets

China

Target Export Markets

China, Cambodia, Laos,
Thailand, Malaysia, India,
Sri Lanka, Vietnam

International Green Building Project

Project name

Dalian Electric Power
Bureau Offices

Project Type

Commercial

Project Location

Dalian, China

Project Partners

Client

Dalian Electric Power Bureau

Local design institute

UD Fangan Dalian

ESD Features

- ▶ DMA won an international design competition in 2010 and are currently working on the project design, and toward a construction start in 2012
- ▶ ESD principles will include an energy saving twin wall facade, a green roof and grey water treatment and reuse.



▲ Dalian Electric Power Bureau Offices, Dalian China

ecospecifier Pty Ltd

ecospecifier global is an eco-product certification company, with an international network of online knowledge and databases including over 6000 eco-products and featuring our unique GreenTag® program, a world first life cycle and BIM based eco-product rating and certification service.

The leading global source of sustainable development and life-cycle assessed green product information, ecospecifier global does the green materials research for you, delivering innovative sustainable product solutions categorised according to rating scheme compliance such as Green Star®, LEED®, BREEAM®, Green Mark and Estidama. ecospecifier helps reduce the time and costs of implementing Best Practice green buildings and developments.

We also have a world leading green building design consulting team as well as "Green Intelligence" education and training programs for green professionals and sales teams.

Key Information

Delivering certified and verified green products and information facilitating green buildings and green intelligence as well as saving green professionals time.

Contact

David Baggs

Phone

+61 7 3399 9686

Email

david.baggs@ecospecifier.org

Web

ecospecifier.com.au
ecospecifier.com

Address

60 Burrai Street
Morningside QLD 4170



Technologies & Capabilities

- › GreenTag® Life Cycle Assessment Certification and Rating – ecolabelling program that includes:
 - › Bronze Silver Gold or Platinum rating logo
 - › Product LCA Scorecard Graphics
 - › Environmental Product Declaration LCA reporting
 - › Green Building Rating Tool Policy Development and compliance assessment
 - › BIM based rapid eco-profiling of Buildings and infrastructure
 - › As a Type 1 Ecolabel, GECA-certified products and services are independently assessed and verified by a third party.
 - › 'Green Intelligence' education and training services – seminar based and inhouse training for both green building professionals and manufacturers

- › ecospecifier global include consulting services leading edge sustainability policy strategy advice, integrative design facilitation and assessment of green buildings and materials
- › David Baggs delivers powerful keynote and other presentations on sustainability green building and materials intelligence.

ESD Features

- › Unique Eco-product Certification recognised in several countries
- › Green product and project consulting
- › Free access databases linking products to international green building rating tools
- › Free technical datasheets, brochures and other product downloads – containing unique green intelligence suitable for all.

Key Areas of Expertise

Technical Services and Consultancy

Building Type

All

Typical International Business Partners/ Customers

Manufacturers, Agents / Distributors, Government – Public Sector Project, Developers, Private Sector Developers, Contractors, Architects, Designers, Engineers, Specifiers

Current Export Markets

China, Indonesia, Malaysia, New Zealand, Philippines, Singapore, South Africa, Thailand, United Arab Emirates, Vietnam

Target Export Markets

Canada, Denmark, England, Finland, France, Germany, Greece, Hong Kong, Ireland, India, Italy, Netherlands, Northern Ireland, Poland, Portugal, Scotland, Spain, Sweden, Switzerland, Turkey, United States of America, Wales



green building council australia
MEMBER 2010-2011

EP&T Pty Ltd

Founded in 1993 in Australia, EP&T Global provides energy conservation and environmental solutions in the built environment space to reduce energy, water and waste usage, while helping with compliance and branding.

Our unique technologies called the EDGE Intelligent System® are being used by over 57 per cent of the premium and A Grade building owners across Australia, and have assisted two major Australian property companies gain world #1 status in the Dow Jones Sustainability World Index in 2007, 2009 and 2010.

Key Information

EP&T Global is a specialist in energy conservation and environmental solutions.

Contact

Keith Gunaratne

Phone

+61 2 8422 6000

Email

keith.g@eptglobal.com

Web

eptglobal.com

Address

6/358 Eastern Valley Way
Chatswood NSW 2067

Technologies & Capabilities

- › Delivering energy and water conservation targets in a compressed time frame by combining intelligent technologies and human intelligence
- › Guaranteed sustained cost and utility reductions through our risk mitigation and cost negative business model
- › Help clients to use real information to improve their brand

Key Areas of Expertise

Building Technology / Products

- › Energy Efficiency
- › Water savings

Building Type

Precincts / Communities
Commercial
Industrial
Hospitals / Aged Care
Education & Science
Hotels & Resorts
Retail
Convention Centres
Government
Residential

Typical International Business Partners/ Customers

Government – Public Sector
Project Developers
Private Sector Developers
Contractors
Architects
Engineers
Specifiers
Agents / Distributors

Current Export Markets

United Kingdom
United Arab Emirates

Target Export Markets

Hong Kong, Japan, Korea,
Thailand, Indonesia, Europe

Australian Green Building Project

Project name

Stockland Property Group

Project Type

Office & Retail

Project Location

Australia wide

Project Partners

EP&T Global & Stockland
Property Group

ESD Features

Energy and water savings
across office and retail
shopping centres
across Australia.

Project name

Charter Hall

Project Type

Office & Retail

Project Location

Australia wide

Project Partners

EP&T Global & Charter Hall
Asset Services Ltd

ESD Features

Energy and water Savings
across office and retail
shopping centres
across Australia.



GHD

GHD is one of the world's leading engineering, architecture and environmental consulting companies.

Wholly-owned by its people, GHD is focused exclusively on client success. Our network of 6000 professionals collaborate to deliver sustainable outcomes to communities and clients in the global markets of water, energy and resources, environment, property and buildings, and transportation.

GHD is committed to sustainable development, safety and innovation. We care for the well-being of our people, communities and the environments in which we operate.

Key Information

GHD is one of the world's leading engineering, architecture and environmental consulting companies.

Contact

Colin Berriman

Phone

+61 3 8687 8000

Email

colin.berriman@ghd.com

Web

ghd.com

Address

Level 15, 133 Castlereagh St
Sydney NSW 2000

Key Areas of Expertise

Master planning
Architecture
Interior Design
Consulting Engineering
Quantity Surveying
Project Management
Technical Services or
Consultancy
Landscape Design

Building Type

Precincts / Communities
Commercial
Industrial
Hospitals / Aged Care
Education & Science
Hotels & Resorts
Retail
Convention Centres
Government
Residential

Typical International Business Partners/ Customers

Government – Public Sector
Project Developers
Private Sector Developers
Contractors
Architects
Engineers

Current Export Markets

China
New Zealand
UK
Canada
India
Ireland
Qatar
USA
Chile
Philippines
UAE



International Green Building Project

Currently in design, the United Nations new headquarters for Vietnam will be a leading example of sustainable building design for the region. The project is a pilot test for the Vietnamese Green Building Council rating scheme 'LOTUS' and is aspiring for the highest rating possible, similar to a 6 Star Green Star building in Australia. GHD is providing all engineering and design services as an integrated single team: architecture, interior design, building engineering, structural engineering and ESD consultation.

Project name

Green One United Nations House, Vietnam

Project Type

Commercial

Project Location

Hanoi, Vietnam

ESD Features

- › High performance facades
- › On site renewable energy generators
- › Intelligent energy store systems
- › Natural ventilation and lighting
- › Rainwater harvesting
- › Energy efficient.

Australian Green Building Project

GHD was engaged to design and document a new 5 Star Green Star office building for Yarra Valley Water.

The scope included architecture, interiors, mechanical engineering, electrical engineering, hydraulics and ESD consultation.

Designed to assimilate principles relating to solar exposure on the site and daylight penetration, the building incorporates a self-sealing high performance façade that substantially reduces the carbon emissions associated with its operation.

Project name

Yarra Valley Water HQ

Project Type

Commercial

Project Location

Sydney NSW

ESD Features

- › Low energy comfort control – Displacement ventilation system
- › Integrated structural and climate control systems
- › Hollowcore and displacement ventilation system
- › Individual comfort control for occupant adjustable floor grilles
- › Building protected from Summer heat load
- › Natural ventilation and lighting
- › Internal client control.



▲ Green One United Nations House, Vietnam



▲ Yarra Valley Water HQ, 5 Star Green Star – Office Design v2

Good Environmental Choice Australia

Key Information

Good Environmental Choice Australia (GECA) is an independent, not-for-profit organisation that runs Australia's internationally recognised life cycle based environmental product certification program for a wide range of consumer and building products and services and administers the 'Environmental Choice Australia' ecolabel.

Contact

Judy Hollingworth

Phone

+61 2 8399 2720

Email

judy@geca.org.au

Web

geca.org.au

Address

Sydney Office
Suite G01, 15 Belvoir Street
Surry Hills NSW 2010

Good Environmental Choice Australia (GECA) is Australia's leading product certification body, with over 200 manufacturers licensed to display the GECA Ecolabel on more than 2,200 products.

The Environmental Choice Australia Ecolabel is awarded to products that meet clear voluntary environmental performance standards.

Since 2001 it has provided architects, manufacturers, designers, building industry, sustainability and procurement professionals with independent assurance that products and services deliver better environmental outcomes. GECA's was the first third-party ecolabel on the Australian market and remains the most widely recognised.

Certification with GECA delivers global relevance as it is the only Australian member of the Global Ecolabelling Network (GEN).

Technologies & Capabilities

GECA's 41 standards include 30+ product standards, 5 service standards and 8 standards for building and interiors.

Four of GECA's building and interiors standards are recognised by the Green Building Council of Australia (GBCA) for Green Star Accreditation:

- > Furniture and fittings
- > Carpets
- > Flooring coverings
- > Panel boards

GECA standards are based on international best practice; are multi criteria and LCA-based, and developed in accordance with ISO14024.

As a Type 1 Ecolabel, GECA-certified products and services are independently assessed and verified by a third party.

As a GEN member, GECA can assist Australian manufacturers and suppliers achieve international certification in affiliated countries.

Key Areas of Expertise

Technical Services or Consultancy
Building Technology / Products – Green

Building Type

All

Typical International Business Partners/Customers

Manufacturers, Government – Public Sector
Project Developers, Private Sector Developers,
Contractors, Architects, Engineers, Specifiers
Agents / Distributors, Sustainability Managers
ESD Consultants, Procurement Professionals

Current/Target Export Markets

GECA licensees export to Pacific Rim countries; North America, EU member countries

GECA endeavours to facilitate fast-track or reciprocal certification of its licensees' products in those regions through its membership of the Global Ecolabelling Network



Group GSA

Multi-disciplinary, architectural practice with expertise in town planning, interior design, architecture and landscape architecture. The Sydney office currently comprises of 105 staff members. Brisbane office 15 and Melbourne office 5. GroupGSA has affiliated offices in Canberra, Darwin and overseas in the USA, India, China, Vietnam and Brazil. All members of staff are well versed in the principles of environmental sustainability which is incorporated into the decision making process and all aspects of design across all disciplines.

Key Information

Dynamic client focused town planning, architecture, interior design and landscape architectural firm capable of work of any size and any location in the world.

Contact

Michael Mandl

Phone

+61 2 9361 4144

Email

mmandl@groupgsa.com

Web

groupgsa.com

Address

Level 7, 80 William Street
East Sydney NSW 2011

Technologies & Capabilities

GroupGSA has the capacity to service town planning, interior design, landscape architecture and architectural projects of any scale, virtually in any country. Whilst GroupGSA has affiliated offices in various countries, their reputation is in researching and partnering with compatible organisations in other countries and tailor the team to the requirements of the scope or services brief.

Key Areas of Expertise

Master planning
Architecture
Interior Design
Consulting Engineering
Project Management
Landscape Design

Building Type

Precincts / Communities
Commercial
Industrial
Hospitals / Aged Care
Education & Science
Hotels & Resorts
Retail
Convention Centres
Government
Residential
Transport

Typical International Business Partners/ Customers

Government – Public Sector
Project Developers
Private Sector Developers
Contractors

Current Export Markets

China
India
USA
Brazil
Vietnam

Target Export Markets

China
Vietnam
Brazil

Profile continued >



Group GSA

International Green Building Project

Project name

Beijing Olympics Shooting Centre

Project Type

Public sporting facility

Project Location

Beijing, China

Project Partners

John Andreas, Watermark
Jin Xu, Beijing Art & Science, Architectural Decoration, Engineering Ltd

ESD Features

- › Geothermal resources are tapped to assist in heating water / air for reticulation via heating pump system within the grandstands /concourse concrete slabs
- › The 10°– 12° stable temperature of the earth is used as a modifier of air by reticulation within pipes
- › The Armoury is used as an air modifier by allowing air movement through the bullets room for pre-conditioning the air for use within the office above
- › Solar collectors provided additional energy
- › Temporary stands and awnings are designed to be re-used.
- › Water is harvested and reticulated for use in the landscape.

Australian Green Building Project

Project name

Hastie Australia

Project Type

Commercial

Project Location

Sydney NSW

Project Partners

ISIS
Hastie Australia

ESD Features

- › 5 Star Green Star – Office Interiors v1.1 rating from GBCA
- › Low VOC's and Fordaldehyde materials
- › Heat exchange unit to service/assist with A/C load – first time used in Australia
- › Utilisation of existing base building infrastructure where possible
- › Various low energy use initiatives
- › 4.5 Star NABERS Energy rating
- › Low water use initiatives
- › Materials have been selected with a high recycled content and from natural sources.



▲ Beijing Olympics Shooting Centre, China



▲ Hastie Australia, Homebush Bay NSW
5 Star Green Star – Office Interiors v1.1

HASELL

HASELL is a network of international design studios located in Australia, China, Singapore and Thailand. Each has the flexibility and autonomy to service local clients with the advantages of our integrated culture, combined resources and collective experience. A multi disciplinary design practice we are structured around the key disciplines of architecture interior design, landscape architecture and planning with integrated sustainability and urban design capabilities. An interdisciplinary organisation HASELL combines learning experience and research from all disciplines to inform our design work. A broad range of design work is undertaken from transport hubs to ecocities, hotels to restaurants, residential to commercial workplace.

Key Information

HASELL is an international interdisciplinary design practice specialising in architecture interior design landscape architecture and planning with integrated sustainability and urban design capabilities.

Contact

Peter Duncan

Phone

+86 21 6887 8777

Email

pduncan@hassell.com.cn

Web

hassell.com.au

Address

Level 2
88 Cumberland Street
Sydney NSW 2000

Building 8, Xing Fu Ma Tou
1029, South Zhongshan
Road, Huangpu District
Shanghai China 200011

Technologies & Capabilities

HASELL has undertaken projects throughout Australia and New Zealand, Asia and the Pacific, Europe and the Middle East. Currently HASELL employs over 1000 staff across twelve design studios. The 2011 BD World Architecture Top 100 Survey ranked HASELL Australasia's number one architectural design practice. We are proud to have won more than 800 design awards. Our strong position is as a result of the expertise, design talent and commitment we offer our clients. Our scale provides the capacity to achieve great outcomes and deliver a broad range of projects from small crafted commissions to complex developments.

Key Areas of Expertise

Master Planning
Architecture
Interior Design
Landscape Urban Design

Building Type

All

Typical International Business Partners/ Customers

Government – Public Sector
Project Developers
Private Sector Developers

Current Export Markets

China
Hong Kong
Indonesia
Malaysia
Singapore
Thailand
United Arab Emirates
Vietnam
United Kingdom

Target Export Markets

Europe

Profile continued >

HASELL



green building council australia
MEMBER 2010-2011

HASSELL

International Green Building Project

Project name

Alibaba Headquarters

Project Type

Commercial

Project Location

Hangzhou, China

Project Partners

ZIAD

Institute of Architectural

Design and Research

Zhejiang Province

CNBM Hangzhou Design

& Research Institute

China Academy of Arts

ESD Features

- Benchmark for the modern workplace in China
- Campus-style layout comprising 150,000 sqm of flexible open plan office space and central courtyard
- Design of building based on concepts of connectivity clarity and community
- Productive and healthy environment
- Passive design principles include external sun shading and openable windows.



▲ Alibaba Headquarters, Hangzhou, China

HASSELL



▲ ANZ Centre, Melbourne VIC

Australian Green Building Project

Project name
ANZ Centre

Project Type
Commercial

Project Location
Melbourne VIC

Project Partners
Lend Lease Design

ESD Features

- ▶ Awarded 6 Star Green Star – Office Design rating from GBCA – Registered to achieve Green Star – Office As Built and Office Interiors ratings
- ▶ ‘Urban campus’ development of 83 600 sqm demonstrating leadership in sustainability and workplace design
- ▶ Largest single-tenanted commercial office building in Australia incorporating sustainable energy water and waste management systems
- ▶ Design focused on central common with a hierarchy of shared spaces an openness fostering interaction and a rich variety of settings providing scale and complexity.

Kann Finch Group

Kann Finch have offices, clients, staff and projects spanning Australia, Asia and the Middle East. We deliver sustainable built environments where people thrive everyday whether they're working, learning, living or at play. We value long and healthy relationships with clients due to our dedication to understanding their requirements and commitment to fulfilling them. Our multi disciplinary design documentation and delivery services cover architecture, interior design, facility planning and master planning of commercial, residential, industrial, community, government and hospitality projects.

Key Information

Kann Finch brings together 50 years of multi disciplinary design excellence encompassing architecture, interior design, master planning and facilities planning.

Contact

Michael Gaston

Phone

+61 2 9299 4111

Email

michael.gaston
@kannfinch.com.au

Web

kannfinch.com.au

Address

Mezzanine Level
50 Carrington Street
Sydney NSW 2000

Technologies & Capabilities

Clients from around the world tell us it is our comprehensive range of expertise and experience along with our collaborative, innovative and responsive approach that distinguishes Kann Finch. We strongly believe in sustainable design principles and strong technical proficiency which are and have been embedded into our projects for almost 50 years that also sets us apart. Our interiors division deliver efficient functional workplaces with cultural content. We have been long standing leaders in facility planning, developing workshop strategies and needs analysis for current and future uses which explains our longevity in a competitive market. The majority of our Interiors staff are accredited GBCA Professionals.

Key Areas of Expertise

Master Planning
Architecture
Interior Design

Building Type

Precincts / Communities
Commercial
Industrial
Hospitals / Aged Care
Education & Science
Hotels & Resorts
Retail
Convention Centres
Government
Residential

Typical International Business Partners/ Customers

Government – Public Sector
Project Developers
Private Sector Developers
Contractors
Architects
Engineers

Current Export Markets

Bahrain
China
India
Kazakhstan
Oman
Pakistan
Tajikistan
United Arab Emirates

Target Export Markets

Hong Kong
Saudi Arabia
Singapore



Australian Green Building Project

Project name
ISIS Melbourne

Project Type
Commercial

Project Location
Melbourne VIC

Project Partners
ISIS Projects

ESD Features

- › Material selection
- › Finishes selection (with approved life cycle and longevity)
- › Furniture selection of certified products
- › Workstation layout (perimeter with natural light and minimal walls).



International Green Building Project

Project name
Masdar City

Project Type
Masterplan: residential, hospitality, commercial

Project Location
United Arab Emirates

Project Partners
Lava Architects

ESD Features

- › Unique 'sunflower umbrella' elements which shade the outdoor space during the day and capture solar heat then close at night and release the heat
- › Powered entirely by renewable energies with zero emissions and zero waste
- › Rainwater is captured by roof gardens for use (Recycled grey water)
- › Daylight and shading carefully optimised for each perimeter zone and act as transitional spaces providing a thermal buffer between external (ambient) and internal (conditioned) spaces.

Kingspan Insulation Pty Ltd

Kingspan Insulation is a market leading manufacturer of innovative ultra-thin flexible insulation products and super high performance rigid insulation products for building fabric and building services applications.

Key Information

Kingspan Insulation is a world leader in innovative thermal insulation products.

Contact

Tony Ede

Phone

+61 488 487 979

Email

tony.ede@insulation.
kingspan.com

Web

kingspaninsulation.com.au

Address

44 Millrose Drive
Malaga WA 6090

Technologies & Capabilities

Kingspan Insulation has a vast product range including super high performance rigid Kooltherm® insulation; flexible fibre-free reflective insulation AIR-CELL®; high performance rigid Therma® insulation

Key Areas of Expertise

Building Technology / Products

- › Energy saving
- › Energy Efficiency
- › Building Materials

Building Type

All

Typical International Business Partners/ Customers

Private Sector
Developers Contractors
Architects
Engineers
Specifiers
Agents / Distributors

Current Export Markets

Bahrain, Indonesia, Republic of South Korea, Kuwait, Malaysia, New Zealand, Oman, Saudi Arabia, Singapore, South Africa, Thailand, United Arab Emirates, Vietnam

Target Export Markets

Argentina, China, Colombia, Fiji, Hong Kong, India, Japan, Macau, Papua New Guinea, Peru, Philippines, Southern and East Africa, Sri Lanka, Taiwan, United States of America



International Green Building Project

Project name

Toyota Spare Parts Division Warehouse

Project Type

Commercial/Industrial

Project Location

Jakarta Indonesia

Project Partners

PT Solartek

ESD Features

- › Kingspan AIR-CELL delivered significant thermal performance delivering comfort for the workers in the building
- › Kingspan AIR-CELL also delivered advanced fire safety to ensure the safety of the warehouse and its valuable contents.



Australian Green Building Project

Project name

Retrovison Retail Centre

Project Type

Commercial/Retail

Project Location

Bunbury WA

Project Partners

Theo Mathews Architect

ESD Features

- › Kingspan AIR-CELL exceeded the minimum BCA Section J requirements by applying innovative measures
- › Beacuse of the various building construction elements Kingspan AIR-CELL was able to provide a different solution which suited each construction type.



LAB architecture studio Pty Ltd

LAB architecture studio is an international practice pursuing insightful, innovative and dynamic projects through the particular circumstances of each individual commission. As architects and urban designers our principle aim is to provide the spatial imagination necessary for designing innovative and sustainable projects within the framework of real-world constraints and opportunities. LAB operates by processes of critical interrogation meaning that nothing is pre-supposed and everything is worthy of consideration. Our belief is that there are no fixed or repeatable formulas for the creation of successful projects but there is the demand for an attentive, intelligent and considered exploration that posits and tests an array of possibilities – reformulating and reconfiguring the opportunities.

Key Information

LAB architecture studio is a design driven architecture and urban design office working locally and internationally on a diverse range of projects.

Contact

Daniel Wolkenberg

Phone

+61 3 9612 1026

Email

dwolkenberg@labarchitecture.com

Web

labarchitecture.com

Address

*Level 4 / 325 Flinders Lane
Melbourne VIC 3000*

Technologies & Capabilities

LAB considers environmental sustainability to be integral to the design of buildings and cities and one of the many essential overlays that inform our designs. Therefore sustainable strategies are assessed and adopted on a project-specific basis according to their effectiveness and design synergies with the building's formal and organisational logic. LAB utilises a wide variety of software tools ranging from sophisticated 3D parametric BIM and environmental analysis packages to more orthodox 2D drafting tools. Programs such as Ecotect and IES analysis tools are used to continually evaluate and optimise environmental conditions such as solar control, overshadowing and ventilation to maximise the design's environmental performance.

Key Areas of Expertise

Master Planning
Architecture
Interior Design

Building Type

Precincts / Communities Commercial
Education & Science, Hotels & Resorts,
Retail Convention Centres, Government,
Residential, Master Planning, Mixed-use

Typical International Business Partners/Customers

Government – Public Sector Project
Developers, Private Sector Developers,
Contractors, Architects, Engineers

Current Export Markets

China, India, United Arab Emirates,
Saudi Arabia

Target Export Markets

Brazil, Czech Republic, Denmark, England,
Finland, Former Yugoslav Republic of
Macedonia, Germany, Greece, Hungary,
Ireland, Italy, Japan, Netherlands, North Africa,
Norway, Singapore, South Africa, South
America, Spain, Sweden, Switzerland, Wales



green building council australia
MEMBER 2010-2011

International Green Building Project

Project name

Xitaihu 2020 sustainable masterplan

Project Type

218ha mixed use masterplan for a new city centre

Project Location

Wujin, Changzhou City
Jiangsu China

Project Partners

SIADR (Shanghai Institute of Architectural Design & Research)

ESD Features

- › High density mixed use activity corridors and nodes provide a flexible and efficient series of urban cores
- › A local transit network connects the site to the regional rail link. An extensively rehabilitated water network integrates activity zones and waterfronts with riparian environmental zones
- › Connective open space network with local green hierarchies
- › Environmental modelling for solar access, visibility and wind performance used throughout the iterative design process.



Australian Green Building Project

Project name

Federation Square Atrium and Labyrinth

Project Type

Cultural / Commercial

Project Location

Melbourne VIC

Project Partners

Bates Smart Architects
Federation Square Management
State Government of Victoria

ESD Features

- › The Labyrinth is an underground passive cooling system made of 1600 sqm corrugated concrete fin walls which substitutes mechanical air conditioning in the Atrium. The thermal mass of the Labyrinth heats/cools outside air to a constant temperature
- › The Atrium acts as one large thermal chimney drawings pre-cooled/heated air from the labyrinths.



LAVA

LAVA was founded in 2007 by Chris Bosse, Tobias Wallisser and Alexander Rieck with offices in Sydney, Shanghai, Stuttgart and Abu Dhabi.

LAVA operates as a unique think tank with offices and networks placed strategically worldwide and was formed by some of the most experienced and forward thinking architects from around the globe.

LAVA won the UN partnered ZEROprize Award for the reskinning proposal of a 1960s building and an international competition to design the centre of Masdar, the world's first zero carbon city.

Bosse was a key designer on the Beijing Watercube whilst at PTW architects and won an AR award in 2007.

Key Information

LAVA is a visionary architecture and design firm combining digital workflow, contemporary materials and the latest digital fabrication technologies with the aim of achieving MORE WITH LESS: more architecture with less material/energy/time/cost.

Contact

Chris Bosse

Phone

+61 2 9280 1475

Email

bosse@l-a-v-a.net

Web

www.l-a-v-a.net

Address

72 Campbell Street
Surry Hills NSW 2010

Technologies & Capabilities

LAVA can do everything from pop up installations, to furniture to masterplans and urban centres, from futuristic buildings made out of PET bottles to retrofitting aging 60s icons, to future hotel rooms, houses and airports.

LAVA explores frontiers that merge future technologies with patterns of organisation found in nature and believes this will result in a smarter, friendlier, more socially and environmentally responsible future.

LAVA is a visionary architecture firm specialising in creating unforgettable destinations with the aim of building more with less. More space more, beauty, more amenity, more sustainability with less money, less material, less time, and less energy footprint.

Key Areas of Expertise

Master planning
Architecture
Interior Design

Building Type

All

Typical International Business Partners/ Customers

Government – Public Sector
Project Developers
Private Sector Developers
Contractors
Architects

Current Export Markets

China, Germany, Kazakhstan, Republic of South Korea, Netherlands, Qatar, Saudi Arabia, Singapore, United Arab Emirates, United States of America, Vietnam, United States, Mexico, Thailand, Sweden, Taiwan

Target Export Markets

Cambodia, China, Fiji, French Polynesia, Hong Kong, India, Indonesia, Japan, Republic of South Korea, Laos, Macau, Malaysia, New Caledonia, New Zealand, Pakistan, Papua New Guinea, Philippines, Polynesia, Samoa, Singapore, Sri Lanka, Taiwan, Thailand, Vietnam





International Green Building Project

Project name

Masdar City Centre
(in progress)

LAVA won an international competition to design the city centre of Masdar UAE the world's first zero carbon, zero waste city powered entirely by renewable energy sources. LAVA's design includes a plaza, five-star hotel, long stay hotel, a convention centre and entertainment complex and retail facilities. The idea behind LAVA's concept is the use, inspiration, and adaptation of nature's organisational principles and the plans combine innovative design and sustainability.

Project Type

Civic, hotel, plaza, retail city centre in world's first eco city

Project Location

Masdar UAE

Project Partners

Kahn Finch Group

Structure

Arup

Umbrellas

SL Rasch

Climate

Transsolar

Landscape

EDAW

ESD Features

- › Solar powered sunflower umbrellas that provide moveable shade in the day, store heat, then close and release the heat at night
- › Building facade angles that can be altered to offset or optimise solar glare
- › Materials on wall surfaces respond to changing temperatures and contain minimal embedded energy
- › Water features can be stored underground during the day and at night trickle or flow strongly, triggered by passersby
- › Interactive light poles, inspired by the oasis fire, transform the plaza into a 3D interactive media installation
- › Interactive, heat sensitive technology activates lighting in response to pedestrian traffic and mobile phone usage
- › Roof gardens integrate food production, energy generation, water efficiency and the reuse of organic food waste.

Profile continued >

LAVA



Australian Green Building Project

Project name

Tower Skin (Visionary Project)

What began as a speculative proposal to re-shape the University of Technology Sydney tower evolved into a broader system for re-purposing inefficient and outdated buildings to avoid demolition and rebuild. LAVA developed a simple, cost effective and easily constructed building skin to transform the identity, sustainability and interior comfort of a tired icon.

A building is wrapped with three-dimensional lightweight, high performance composite mesh textile. Surface tension allows the membrane to freely stretch around walls achieving maximum visual impact with minimal material effort.

LAVA
Laboratory for Visionary Architecture

Project Type

Educational refit

Project Location

Sydney NSW

Project Partners

Sustainability concept:
Ross Harding from
Advanced Environmental

Structural advice:

Prof Max Irvine

Membrane advice:

Daniel Cook, Mak Max

ESD Features

- › 'Cocoon' acts a high performance 'micro climate' that generates energy, collects water, improves day lighting and uses available convective energy to power the towers' ventilation and distribution requirements
- › Direct user control of localized environmental comfort by opening single glazing bays to boost ventilation flows that feed from a core of centralised conditioned air
- › During rain events water is collected locally across the skin to contribute and offset the towers existing water loads
- › Convective energy draws vertically to the top of the tower generating energy that in turn reduces energy loads for inbound air conditioning
- › Solar energy is collected annually to off set night energy requirements of the skin and existing building loads during the day
- › Localised user control makes use of the external convective energy to supply air and control temperature within the interior.

Living Green Designer Homes

Living Green challenges the way we live by providing alternatives to standard building and construction methods. By using the latest in sustainable and lightweight building products, cost efficient design principles and encouraging a reduced building footprint, Living Green Designer Homes achieves quality homes with superior energy efficiency.

Key Information

Living Green Designer Homes – Challenging the way we live.

Contact

Craig Riddle

Phone

+61 2 4368 2889

Email

enquiries@lgdh.com.au

Web

livinggreendesignerhomes.com.au

Address

*Bula Place
Bensville NSW 2251*

Technologies & Capabilities

At Living Green Designer Homes we went back to the basics of construction, completely re-designing and re-engineering the construction process. After a solid 2 year research and development program we now have approved a pre-engineered and repeatable manufacturing based system that enables us to produce all of our designs and any custom designs in a controlled environment whereby we can continually improve procedures, minimise waste and maximise on detail and quality.

Key Areas of Expertise

Building Technology / Products

- › Water Capture
- › Efficiency or Reuse
- › Energy Saving
- › Renewable Energy
- › Energy Efficiency
- › Use of recycled content / materials
- › Indoor Environment Quality

Building Type

Precincts / Communities
Commercial
Industrial
Hospitals / Aged Care
Education & Science
Hotels & Resorts
Retail
Convention Centres
Government
Residential

Typical International Business Partners/ Customers

Government – Public Sector
Project Developers
Private Sector Developers
Contractors
Architects
Engineers
Specifiers
Agents / Distributors

Target Export Markets

China, Japan, Malaysia, Hong Kong, Indonesia, South Korea, New Zealand, Papua New Guinea, Philippines, Singapore, Thailand



Lend Lease

Lend Lease creates innovative and sustainable property solutions, forging partnerships and delivering maximum benefits to clients, investors and communities. Sustainability has always been an integral part of our culture and through design and investment in new technologies, we are delivering the next generation of sustainable property solutions.

With more than 18,000 employees and a geographical network that spans across Australia, Asia, Europe and the Americas, the company is committed to creating and building innovative and sustainable solutions, forging partnerships and delivering strong investment returns.

Key Information

Lend Lease is a leading international property and infrastructure group, with strong development, investment management, project and construction management and asset and property management capabilities.

Contact

Mann Young

Phone

+65 6319 4781

Email

mann.young@lendlease.com

Web

www.lendlease.com

Address

30 The Bond
30 Hickson Road
Millers Point NSW 2000



Technologies & Capabilities

Lend Lease's project management, design and construction business has extensive experience in designing and delivering sustainable buildings. In Australia, this amounts to one in seven of Australia's Green Star certified buildings. The company's team includes more than 100 Green Star Accredited Professionals.

Lend Lease's projects have incorporated numerous sustainable initiatives including blackwater treatment plants, co-and tri-generation power systems, chilled beam air-conditioning technology, light-reflecting mirror systems and green walls. In Australia, the company's in-house design and technical specialists, offer expertise on new products, materials and construction technologies and ecologically sustainable design. These skills enable the business to assess the environmental sustainability of a project at every stage of design and delivery, and have also led the team to provide expertise to clients, governments and other consultants across the globe, including Italy, Russia and the UK.

Lend Lease is proud to be a founding member of the US, Australia and UK Green Building Councils, and is committed to supporting existing and emerging Green Building Councils in all its countries of operation.

Key Areas of Expertise

Master planning, Architecture, Interior Design, Consulting Engineering, Quantity Surveying, Project Management, Technical Services or Consultancy, Developer, Contractor, Landscape Design

Building Technology / Products

Water Capture, Efficiency or Reuse, Energy Saving, Use of recycled content / Materials, Indoor Environment Quality

Building Type

All

Typical International Business Partners/ Customers

Government – Public Sector Project Developers, Private Sector Developers, Contractors, Architects, Engineers

Current Export Markets

Asia, America, Europe, Middle East

Target Export Markets

Cambodia, China, Fiji, French Polynesia, Hong Kong, India, Indonesia, Japan, Republic of South Korea, Laos, Macau, Malaysia, New Caledonia, New Zealand, Pakistan, Papua New Guinea, Philippines, Polynesia, Samoa, Singapore, Sri Lanka, Taiwan, Thailand, Vietnam

International Green Building Project

Project name

313@somerset

Project Type

Retail

Project Location

Singapore

ESD Features

Lend Lease opened its A\$1 billion retail development, 313@somerset, on Orchard Road, in December 2009.

The centre received the highest sustainability recognition in Singapore receiving a Green Mark Platinum Award from the Singapore Building and Construction Authority. 313@somerset will achieve greater than 30% reduction in energy consumption compared to a standard Singapore code compliant building.

Other initiatives include renewable energy for sustainable car park operations and a detailed carbon footprint analysis and reduction strategy.

Australian Green Building Project

Project name

Darling Quarter

Project Type

Commercial / mixed use

Project Partners

Sydney Harbour Foreshore Authority

Project Location

Sydney NSW

ESD Features

Darling Quarter's commercial development (Commonwealth Bank Place) demonstrates a commercial building with world class environmental accreditations. Commonwealth Bank Place has received a 6 Star Green Star –Office Design v2 certified rating with the Green Building Council of Australia and is currently targeting a 6 Star Green Star Office As Built v3 rating. The sustainable initiatives include chilled beam technology, trigeneration plant that generates electricity, heat and cooling, blackwater treatment plant and a rainwater harvesting tank.



▲ 313@somerset, Singapore



▲ Darling Quarter, Sydney NSW

Marchese Partners International

Marchese partners are one of Australia's leading architects & interior designers of multi unit residential mixed use & retirement living projects. With over 16 years experience in the Australian development market we continue to set new bench marks for residential and retirement living projects. We provide a unique service by being able to offer both architecture and interior design services with not only aesthetically pleasing results but practical solutions that are also environmentally sustainable.

Key Information

Marchese partners are a dynamic firm of architects urban designers & interior designers that provides exceptional service to developers right across the globe in the residential retirement & aged care industries.

Contact

Stewart Dean

Phone

+61 7 3211 2600

Email

*sdean@
marchesepartners.com.au*

Web

marchesepartners.com

Address

*L14 46 Edward Street
Brisbane QLD 4000*

Technologies & Capabilities

Marchese partners are design leaders in the multi residential and retirement fields. Equally at home as the lead consultant or working as a member of a team. We have built a reputation within the industry as a team player focusing on delivery of our clients goals and requirements. We believe we can offer an invaluable service and deliver unique sustainable projects that respond well to their surroundings.

Key Areas of Expertise

Master Planning
Architecture
Interior Design

Building Type

Precincts
Communities
Aged Care
Hotels & Resorts
Multi Unit Residential

Typical International Business Partners/ Customers

Government – Public Sector
Project Developers
Private Sector Developers

Current Export Markets

China
United States of America

Target Export Markets

China
India
Malaysia
Singapore

Australian Green Building Project

Project name

Mernda Retirement Living Village

Project Type

Retirement living

Project Location

Melbourne VIC

Project Partners

Stockland
AECOM
GBCA

ESD Features

- Aiming to be the first Green Star rated retirement village in Australia
- Optimised site orientation
- Minimised greenhouse emissions
- Alternative transportation options
- Water & energy efficiency
- Environmentally sustainable materials
- Environmental management systems
- Innovative strategies & technology solutions.



▲ Mernda Retirement, Melbourne, VIC Living Village

Northrop Consulting Engineers

Northrop Engineers was established in 1976. Today we provide a range of engineering consulting services with offices in Sydney, Canberra, Newcastle, Western Sydney, South Coast, Brisbane and Singapore. The Company is governed, owned and managed by our senior engineers. Our people have an excellent track record in delivering sustainable multi-discipline engineering works through being pro-active and understanding the needs of all project stakeholders. We endeavour to find the appropriate solutions that enhance the project's environmental, economic and social outcomes.

Key Information

Northrop sustainability business facilitates an integrated sustainable outcome in built environment.

Contact

Geoff Absalom

Phone

+61 2 6285 1822

Email

rajnavis@northrop.com.au

Web

northrop.com.au

Address

15 Aintree Court
Phillip ACT 2606

Technologies & Capabilities

Northrop Sustainability is our specialist environmental design group. Our projects include precinct, office, retail, residential, education; industrial and health care design solutions. We have demonstrated strong leadership in our Green Star submissions and NABERS certifications and we are now breaking new ground for mixed use Sustainable Communities.

Key Areas of Expertise

Consulting Engineering
Master Planning
Project Management
Technical Services or
Consultancy

Building Type

Precincts / Communities
Commercial
Industrial
Hospitals / Aged Care
Education & Science
Hotels & Resorts
Retail Convention Centres
Government Residential

Typical International Business Partners/ Customers

Government – Public Sector
Project Developers
Private Sector Developers
Contractors Architects
Engineers

Current Export Markets

Singapore

Target Export Markets

Bahrain, Brunei,
Darussalam, Hong Kong,
India, Philippines, Qatar,
Sri Lanka, Taiwan, Thailand,
United Arab Emirates

Australian Green Building Project

Project name

Loop Precinct

Project Type

Mixed Use Development

Project Location

Canberra ACT

Project Partners

Rock Development Group

ESD Features

- > Aiming for a 6 Star Green Star Design and As Built rating
- > Integrated rainwater and waste water treatment system
- > Electric vehicle plug-in points
- > Large scale grid connected photovoltaics
- > Geothermal HVAC system
- > Naturally ventilated office retail & residential spaces
- > Waste reduction and recovery
- > Pedestrian friendly communal spaces & integrated residential services.



green building council australia
MEMBER 2010-2011



▲ Loop precinct, aiming to become one of Australia's first 6 Star Green Star – Communities.

◀ Charles Stuart University's (CSU) Thurgoona, 6 Star Green Star – Office Design v2



NOWarchitecture

NOWarchitecture is a specialist sustainability architecture and design practice based in Melbourne, Victoria Australia. With over 26 years of experience the practice has undertaken a wide variety of commercial, institutional, industrial and residential projects throughout Victoria and interstate. NOWarchitecture is renowned for its innovative and elegant aesthetics and industry leading work particularly in sustainable development and education. NOWarchitecture are lateral-thinkers achieving high quality outcomes through constant research and attention to Client requirements. Specialist skills provide for low cost integration of environmental sustainability through a holistic design approach which emphasises passive systems for cost efficient construction and operational costs.

Key Information

Expert architectural consultants specialising in Ecologically Sustainable Design cost-efficient low-energy buildings Architectural Design and Master Planning.

Contact

Neville Cowland

Phone

+61 3 8412 8200

Email

neville@nowarchitecture.com

Web

nowarchitecture.com

Address

46 St David Street
Fitzroy VIC 3065

Technologies & Capabilities

NOWarchitecture offer architectural services and sustainability consultancy for all project stages from master planning to commissioning including interior architecture and graphic design. Our architectural consultancy is fundamentally linked to iconic Environmentally Sustainable Design. We have over 20 years 3D CADD technology experience, each project is undertaken to budget and within time limits to produce elegant logical efficient high quality buildings. Extended environmental modelling, integrated at design stage, provides information for improved low energy buildings. We have been recognised with awards from the United Nations, Association of Australia, Australian Institute of Architects, Timber Design Council, the Steel Institute and Victorian Government.

Key Areas of Expertise

Architecture

Building Type

Precincts / Communities
Commercial
Education & Science
Hotels & Resorts
Residential
Community Facilities
Other

Typical International Business Partners/ Customers

Private Sector Developers
Architects

Current Export Markets

India

International Green Building Project

Project name

Kodi Mosque

Project Type

Institutional / Community

Project Location

Kodi, Karnataka, India

Project Partners

Bearly Group
Paradigm Architects



Australian Green Building Project

Project name

Meadows Primary School

Project Type

Education / Community

Project Location

Broadmeadows VIC

Project Partners

Department of Education and Early Childhood Development

ESD Features

- Aiming for a 6 Green Star – Education v1 rating
- Passive earth-coupled cooling system using water tanks
- 600,000 litres of under-slab water storage.



▲ Meadows Primary School, Broadmeadows VIC

Panelwall Pty Ltd

Panelwall's philosophy is to produce quality products with the highest Green Credentials. All of our products are designed as modular solutions to maximise flexibility while utilising the most cost effective and environmentally sustainable materials to suit each of our product lines. We have invested significantly in product research and development and implemented quality systems including ISO 14001:2004 FSC Chain of Custody and AFS Chain of Custody to ensure the highest levels of environmental controls. We now offer a wide range of quality fully demountable and modular commercial partitions linings storage and furniture solutions.

Where possible our components are manufactured using either entirely recycled materials or materials with a high level of recycled content. Our baseline system which uses prefinished particleboard panels incorporates over 85 per cent (by mass) pre and post consumer recycled materials. Every component's raw material has been selected on the basis that it has a viable recycling process.

Key Information

The eco friendly office partition.

Contact

Robert Wall

Phone

+61 418 657 205

Email

rwall@panelwall.com.au

Web

panelwall.com.au

Address

Unit 1
63 Norman Street
Peakhurst NSW 2210

Technologies & Capabilities

- › Solid wall partitions
- › Free standing pavilion offices
- › Wideline Glazed Partitions (100mm)
- › Double Glazed Partitions (100mm)
- › Narrow line Glazed Partitions (45mm)
- › Slim line Glazed Partitions (25mm)
- › Solid Aluminium Framed and Frameless
- › Doors (sliding and swing)
- › Modular Storage Systems and Shelving
- › Modular Commercial Joinery
- › Financial Trading Desks and Workstations.

Key Areas of Expertise

Building Technology / Products

- › Indoor Environment Quality

Building Type

Commercial
Retail
Convention centres
Government

Typical International Business Partners/ Customers

Other
Interior Designers

Current Export Markets

Singapore

Target Export Markets

United States of America

Australian Green Building Project

Project name

VicUrban Commercial Office Fitout

Project Type

Commercial Office Fitout

Project Location

Melbourne VIC

Project Partners

Equiset, BVN

ESD Features

- › Demountable Solid Partition
- › Demountable Glazed Partition
- › Demountable Sliding Door System
- › Demountable Swing Door System
- › 100 per cent Recyclable
- › 100 per cent Reusable
- › 0.05 per cent Waste
- › 6 Star Fitout



Phase Change Products Pty Ltd

Phase Change Products Pty Ltd (PCP) is highly experienced in the development and application of Phase Change Materials (PCMs). PCMs are able to provide passive thermal heat reservoirs for a large and expanding variety of industries and applications include where: solar energy or waste heat might be harnessed; temperatures may need to be stabilized for critical periods of time; and/or the cost of energy from active sources like electrical power grid or stand alone diesel power generation is variable and lends itself to optimisation. In these instances PCM may provide a safe reliable and cost effective solution.

Key Information

We manufacture phase change materials (PCMs) that store and release energy at various temperatures. PCMs can be used for thermal storage for energy savings and temperature stabilisation.

Contact

Keith Coakley

Phone

+61 8 9324 8555

Email

*keith.coakley
@pcpaustralia.com.au*

Web

pcpaustralia.com.au

Address

*57 Havelock Street
West Perth WA 6005*

Technologies & Capabilities

PCM technology is not new and has been used with mixed success and in limited applications for over 50 years. PCP now has over 15 years of accumulated knowledge development and expertise to offer industries and householders specific PCMs for specific applications in an environment where both the direct and indirect costs of energy show no signs of either decreasing or even stabilising. PCP is based in Perth, Western Australia from where it currently conducts all PCM manufacturing and development. Organisations and industries around the world are familiar with PCP products and PCP continues an active marketing and consultative program with existing and prospective clients. PCP also develops in-house new and unique application initiatives which it then introduces to the relevant industry sectors.

Key Areas of Expertise

Building Technology / Products

- › Energy Saving
- › Renewable Energy
- › Energy Efficiency

Building Type

Industrial Hospitals / Aged Care
Education & Science
Hotels & Resorts

Typical International Business Partners/ Customers

Private Sector Developers

Current Export Markets

China
India
United States of America



PTW Architects

Architectural innovation and a sound reputation for high standards of design and planning are the principles PTW Architects has consistently delivered since inception as Peddle Thorp & Walker in Sydney 1889. Currently employing approximately 194 people PTW Architects has offices in Sydney, Beijing, Hanoi Ho Chi Minh City and Shanghai. With a well-respected reputation for excellence in architecture and master planning over a diversity of building types we create buildings where commercial objectives are balanced with cultural and public uses, leading to the enhancement of the public realm and a city's facilities.

Key Information

Architectural innovation and a sound reputation for high standards of design and planning are the principles PTW Architects has consistently delivered.

Contact

Laraine Sperling

Phone

+61 2 9232 5877

Email

lsperling@ptw.com.au

Web

ptw.com.au

Address

Level 17,
9 Castlereagh Street
Sydney NSW 2000

Technologies & Capabilities

Using computer aided design and drafting, PTW Architects maintain a state of the art computer network. A suite of up-to-date software allows the efficient production of architectural documentation and high quality presentations. We utilise the latest AutoCad Revit Series to produce 2D drawings as well as 3D Building Information Models (BIM). BIM allows us to produce coordinated drawings from a 3D model that reduce clashes and RFIs on site; we can also schedule and analyse BIMs over time (4D) and for cost (5D) leading on to post-construction facilities management.

Key Areas of Expertise

Master Planning
Architecture
Interior Design

Building Type

All

Typical International Business Partners/ Customers

Government – Public
Sector Project Developers
Private Sector
Developers
Contractors

Current Export Markets

China
Japan
United Arab Emirates
Vietnam

Target Export Markets

Taiwan

PTW



green building council australia
MEMBER 2010-2011



▲ Beijing 2008 Olympics, Watercube – National Swimming Centre

International Green Building Project

Project name

Beijing 2008 Olympics
Watercube – National
Swimming Centre

Project Type

Sport/Aquatic/Olympic

Project Location

Beijing China

Project Partners

CSCEC
PTW
CCDI
ARUP

ESD Features

- Maximising natural light and capturing solar energy to heat the interior spaces and pools
- Rainwater harvesting recycling efficient filtration and backwash systems
- ETFE cladding ensures the centre is well lit during the day with appropriate levels of internal daylight visual connection and visual comfort
- Energy recovery systems like heat recovery from warm exhaust air for warming up the cold outside air (fresh air supply).

Profile continued >



▲ 30 The Bond, Sydney NSW. Photography by: John Marmara

Australian Green Building Project

Project name

30 The Bond

Project Type

Commercial

Project Location

Sydney NSW

Project Partners

Concept Architect
Lend Lease Design
Collaborating Architect
PTW Architects

ESD Features

- › Achieved a 5 Star Green Star – Office v1 As Built rating
- › Australia's first CBD office building to commit to a 5 star Australian Building Greenhouse Rating from DEUS (formerly SEDA)
- › Australia's first large scale commercial installation of passive chilled beams
- › Australia's first healthy premium/A grade CBD office building utilising a single pass air system
- › The first premium/A grade CBD office to install a roof garden
- › Innovative remediation techniques in the stabilisation treatment of gas works wastes.

Ritek – Building Solutions Pty Ltd

Ritek – Building Solutions are a manufacturer of eco-innovative and sustainable building solutions supplying Australia and international markets for over 25 years. Ritek products include innovative roof and wall systems for domestic residential commercial and industrial building applications. Ritek has a significant customer portfolio ranging from local architectural designers through to major housing and commercial building projects. Ritek technology is available for licensing and opportunities exist for UAE, Qatar, India and USA markets.

Key Information

Ritek – Building Solutions are a manufacturer of innovative and sustainable roof and wall systems.

Contact

Peter Kelly

Phone

+61 7 5472 2500

Email

peter_kelly@ritek.net.au

Web

ritek.net.au

Address

19 Lowermill Road
Cooroy QLD 4563

Technologies & Capabilities

Products: Ritek® Building systems for the future.

Ritek Roof Systems

Ritek Ecotek and Custom Roof Panel Systems utilise the strength of BlueScope Colorbond Thermatech steel to produce an all-inclusive pre-finished composite roof system incorporating structure insulation and ceiling finish in one easy to install highly efficient and attractive panel. With a huge selection of colours and finishes together with superior spanning capability the Ritek roof panels (straight curved and multi-curved) are ideal for most building designs and applications.

Ritek Wall Systems

Ritek® XL Wall and XL Thermal Wall Systems replace traditional block pre-cast and formwork techniques with a simple to install pre-finished innovative wall system which provides rapid assembly high structural and fire integrity and minimal on-site waste. The Ritek XL Thermal Wall System incorporates a highly efficient thermal insulation to maximise energy efficiency of buildings.

Key Areas of Expertise

Building Technology / Products

- › Water capture efficiency
- › Reuse building
- › Use of recycled content
- › Indoor Environment Quality
- › Developer Contractor
- › Renewable energy
- › Energy efficiency

Building Type

All

Typical International Business Partners/Customers

Private Sector Developers
Contractors

Current Export Markets

Saudi Arabia

Target Export Markets

China, India, Qatar, United Arab, Emirates,
United States of America

Profile continued >



green building council australia
MEMBER 2010-2011

Ritek – Building Solutions Pty Ltd

International Green Building Project

Project name

Ritek – Sample Villa

Project Type

Residential Housing

Project Location

Riyadh Saudi Arabia

Project Partners

EBRAM Investments

ESD Features

Ritek XL Thermal Wall and Ritek XL Wall Systems used to construct a sample “sales” villa as part of a major housing development.

- Insulated walls up to R3.6 Concrete core walls providing thermal comfort.
- No site waste
- Minimal installation time and resources



Australian Green Building Project

Project name

The Ecovillage

Project Type

Residential

Project Location

Currumbin QLD

Project Partners

Chris Walton

ESD Features

The Ecovillage at Currumbin was awarded the world's finest example of sustainable urban development and best residential subdivision. It also won the HIA Greensmart Building of the year award using Ritek's Custom Roof Panel in their “Living Laboratory”. The roof was concave and was used to harvest rainwater and to provide thermal comfort to the building's occupants.



Solahart Industries Pty Ltd

Solahart pioneered solar water heating in Australia in 1953. Now as a leading manufacturer of solar hot water systems in Australia, Solahart have supplied to over 80 countries worldwide. Installing a Solahart for your hot water needs will have a huge impact on your water heating energy use. It's one of the best things you can do to reduce your greenhouse gas emissions and beat rising energy costs.

Key Information

Manufacture renewable solar water solutions both domestic and commercial.

Contact

Denis Avery

Phone

+61 8 9351 4600

Email

denis.avery
@solahart.com.au

Web

solahart.com

Address

112 Pilbara Street
Welshpool Perth WA 6106

Technologies & Capabilities

Continuous improvement. One of the keys to our success over the years has been the relentless pursuit of innovation. Research and development is a critical part of our business. We have developed a "Centres of Excellence" approach for advanced technologies with dedicated R&D people in Welshpool WA and Rydalmere NSW. These include industry-leading specialists in material science performance testing and enamelling technology. Through international recruitment we've built a strong team committed to developing the next generation of solar water heaters. It's our aim to make solar water heating as accessible as any conventional water heater. We want to make sure that whatever the setting – a house a block of units or huge industrial plant solar water heating is the most cost-effective water heating option across the board from installation to running costs maintenance and longevity.

Key Areas of Expertise

Building Technology / Products

- › Energy Saving
- › Renewable Energy
- › Energy Efficiency

Building Type

All

Typical International Business Partners/ Customers

Government – Public Sector
Project Developers
Private Sector Developers
Contractors
Architects
Engineers
Specifiers
Agents / Distributors

Current Export Markets

Solahart Industries can service any market with qualified partners

International Green Building Project

Project name

Saadiyat Island, Abu Dhabi

Project Type

Commercial

Project Location

Abu Dhabi

Project Partners

Ecoval Middle East

ESD Features

Supplied 3500 solar systems to construction village delivering over one million litres of hot water daily free from the sun.

Sinclair Knight Mertz

Sinclair Knight Merz (SKM) is a leading projects firm, with global capability in strategic consulting, design and delivery. It operates in three regions: Asia Pacific, the Americas and EMEA (Europe, Middle East & Africa), deploying some 6,500 people from more than 40 offices, and serving the buildings and infrastructure, mining and metals, power and energy and water and environment sectors.

We continually strive to help our people reach their full potential, engaging them in challenging and inspiring projects that shape industries and build nations.

Key Information

Achieve outstanding client success.

Contact

Phillip Roös

Phone

+61 3 8668 6004

Email

proos@globalskm.com

Web

globalskm.com

Address

Level 11
452 Flinders Street
Melbourne VIC 3000

Technologies & Capabilities

SKM provides a range of professional services which enhance the environmental sustainability of buildings and infrastructure.

- › Active and passive design optimising energy efficiency and indoor environment quality
- › Distributed energy systems, including cogeneration, trigeneration, solar and wind
- › Dynamic computer simulation to predict the future performance of facilities
- › Certification against rating systems including Green Star, BREEAM and LEED
- › Materials selection to minimise life cycle environmental impacts
- › Designs incorporating water efficiency, improved stormwater quality and alternative water sources, including rainwater, greywater and blackwater
- › Site climate assessment and Master Planning
- › Energy and water auditing of operational facilities.

Key Areas of Expertise

Master planning
Architecture
Interior Design
Consulting Engineering
Quantity Surveying
Project Management
Technical Services or Consultancy

Building Type

All

Typical International Business Partners/Customers

Government – Public Sector Project Developers, Private Sector Developers, Contractors, Architects, Engineers, Specifiers

Current Export Markets

Czech Republic, England, Wales, Scotland, Northern Ireland, Ireland, Singapore, Malaysia, Chile, New Zealand, Indonesia, United Arab Emirates, China, Hong Kong, India, Pakistan, Thailand, Philippines, Solomon Islands

Target Export Markets

All





International Green Building Project

Project name
MediaCityUK

Project Type
Precinct

Project Location
Manchester, United Kingdom

Project Partners
Peel Media

ESD Features

- › 'Excellent' BREEAM Communities rating
- › District trigeneration system (electricity, heating and cooling from natural gas)
- › Transporting construction materials using barges on the Manchester ship canal to reduce carbon emissions
- › Heat exchange with the thermal mass of the Manchester ship canal
- › Use of the Manchester ship canal in stormwater management to avoid the conventional practice of sending stormwater to sewer
- › Extension of existing public transport infrastructure
- › Cyclist facilities.

Sinclair Knight Mertz

Australian Green Building Project

Project name

Swinburne University of Technology – AMC Building

Project Type

Education

Project Location

Melbourne VIC

Project Partners

Wilkinson Eyre Architects

ESD Features

- Targeted 5 Star Green Star – Education rating
- Phase Change Material (PCM) storage of coolth
- Air-to-air heat exchangers
- Internal atrium to improve day lighting
- Passive external shading
- Greywater recycling
- Rainwater & stormwater harvesting
- Cyclist facilities
- Trigeneration (electricity, heating and cooling from natural gas)
- Adiabatic water efficient heat rejection units
- Environmentally sustainable materials
- Radiant cooling provided by passive chilled beams;
- Underfloor delivery of heating, ventilation and cooling.



▲ Swinburne University of Technology, Melbourne, VIC, Australia
Targeted 5 Star Green Star – Education

STAR Water Solutions

STAR Water Solutions Pty Ltd is the exclusive worldwide licensee for Reactive Filter Media technologies for treatment and re-use of stormwater industrial and agricultural wastewaters. The company was established in 2008 following an extensive research and development program from which the technology was developed.

Key Information

Manufacturers and suppliers of stormwater industrial and agricultural wastewater treatment technologies.

Contact

Christopher Rochfort

Phone

+61 2 9460 2722

Email

chris@starwater.com.au

Web

starwater.com.au

Address

701-703/107 Walker St
North Sydney NSW 2060

Technologies & Capabilities

Reactive Filter Media technology is used in a wide range of applications from low impact urban development to sustainable industry and agricultural applications. The technology is available in bulk or in treatment devices such as filter systems and filter bales. The technology can usually be manufactured in most urban environments and uses a high proportion of recycled content.

Key Areas of Expertise

Building Technology

- › Water Capture Efficiency

Products

- › Use of recycled content materials

Building Type

Precincts / Communities
Industrial Government
Residential

Typical International Business Partners/ Customers

Government – Public Sector
Project Developers
Agents / Distributors

Current Export Markets

Canada
United States of America

Target Export Markets

England
France
India
Indonesia
New Caledonia
Poland
Singapore
South America

International Green Building Project

Project name

Peace Arch Visitor Centre

Project Type

Government Building

Project Location

British Columbia Canada

Project Partners

Cascade Environment
Van der Zalm
& Associates inc

ESD Features

Used high proportion of recycled content. Manufactured locally under license in British Columbia. Treated parking lot run-off to protect nearby streams and lakes.

Australian Project

Project name

Manly Council Stormwater Treatment & re-use project

Project Type

Recreational – beachside

Project Location

Manly Sydney

Project Partners

Manly Council
EC Sustainable Environment Consultants

ESD Features

Treated roadside run-off for re-use. Used high proportion of recycled content. Protected beach from stormwater run-off. Save Manly Council significant cost by potable water substitution. Uses no energy during treatment.



Studio 505

Studio 505 seeks to open a new realm for design. We are continuously striving to not just design buildings and structures but to recast the perception of our worlds.

An architecture and design studio based in Melbourne and working around the world, the studio team and our network of makers, thinkers and consultants bring together a vast and intriguing selection of possibilities. We are committed to delivering exemplary innovation, elegant integration and sophisticated responses within the complex maelstrom of the design world.

Key Information

An architecture and design studio based in Melbourne and working around the world, the studio team and our network of makers, thinkers and consultants bring together a vast and intriguing selection of possibilities.

Contact

Rachel Freeman

Phone

+61 3 9670 2322

Email

mail@studio505.com.au

Web

studio505.com.au

Address

395 Little Lonsdale Street
Melbourne VIC 3000

China Office

Changzhou

Technologies & Capabilities

Studio 505 has advanced delivery capabilities that span across 2D & 3D Architectural Documentation, Building Information Modelling (BIM), advanced technical modelling, high end visualisations and animations. The studio has specialist teams fluent in Rhinoceros, Revit, AutoCAD, 3DSMax, VRay, and the Adobe CS5 Suite.

Key Areas of Expertise

Architecture

Building Type

Commercial
Hospitals / Aged Care
Hotels & Resorts
Retail
Convention Centres
Government
Residential
New Build

Current Export Markets

China
Singapore
Malaysia

Target Export Markets

China
Singapore
Malaysia

Typical International Business Partners/ Customers

Government – Public Sector
Project Developers
Private Sector Developers
Contractors
Architects
Engineers

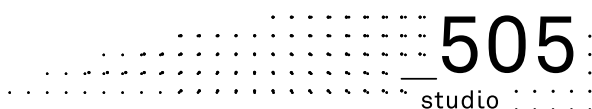



▲ Pixel, Melbourne VIC Australia, 6 Star Green Star – Office Design v3

Studio 505

Australian Green Building Project

Project name

Pixel

Project Type

Commercial

Project Location

205 Queensberry Street
Carlton VIC 3053

Project Partners

Consultant Team:

Client

Grocon Pty Ltd

Structural Engineer

VDM Pty Ltd

Building Services

& ESD Engineer

Umow Lai & Associates

Contractor

Grocon Constructors

Landscape Design

University of Melbourne

Carbon Analysis

RMIT University Centre
for Design

Building Surveyor

PLP Building Surveyors
& Consultants

Fire Engineering Services

Aurecon

Maintenance Access

Consultants

Vertigo

Acoustic Engineer

Marshall Day Acoustics

Access Consultant

Blythe-Sanderson Group

Cost Planner

Slattery Australia

Town Planning

Meredith Withers and
Associates Pty Ltd

Grey Water Analysis

CSIRO

Embodied Carbon Analysis

CSIRO

Construction Team:

Builder

Grocon Constructors

Construction Manager

Grocon Constructors

Developer

Grocon (Victoria Street)

Project Manager

Grocon (Victoria Street)

ESD Features

- › 6 Star Green Star rating
- › Aiming to achieve the highest environmental rating for US LEED and UK BREEAM
- › Carbon Neutral
- › Water Balanced
- › 100 per cent Fresh Air System
- › Ammonia Refrigeration
- › Chilled Structure
- › Native Grass Green Roof
- › Tracking Photovoltaics
- › Vertical Axis Wind Turbines
- › Reed Bed Grey Water Filters
- › Reliance on Natural Daylight
- › Green 'Pixelcrete' Concrete
- › Gas Fired Absorption Chillers
- › Extensive Recycling
- › Free Night Cooling
- › Vacuum Toilets
- › Bio-Gas Energy
- › High Performance Facade

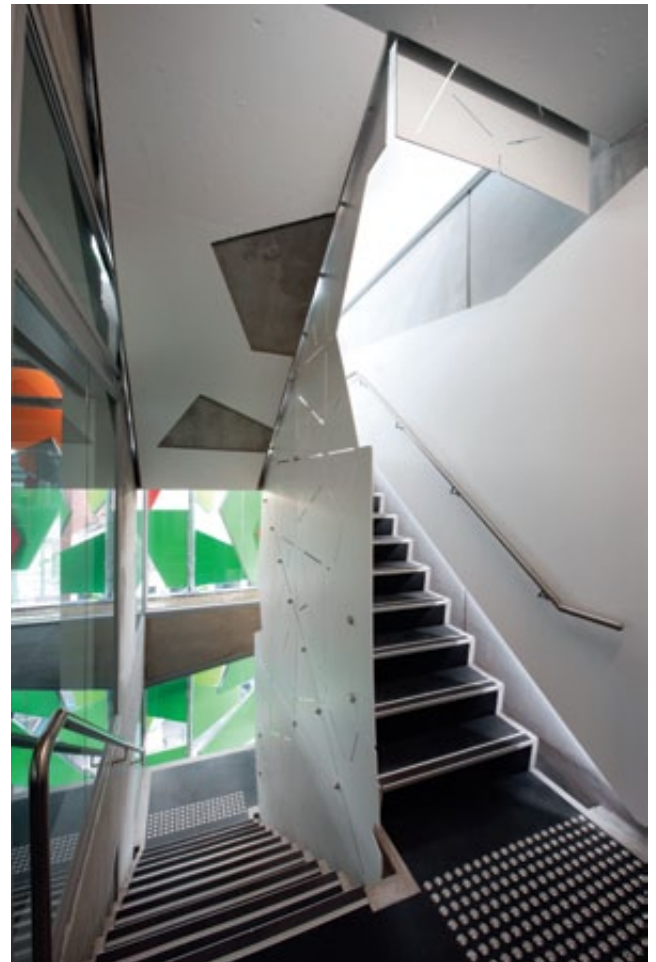

▲ Pixel, Melbourne VIC Australia, 6 Star Green Star – Office Design v3

Switch Automation

Switch Automation is a leading green automation and building intelligence platform for homes, apartments and commercial buildings. We help our clients lower their building's environmental impact and achieve the highest possible green building ratings by monitoring, measuring and controlling energy consumption. The Switch Automation platform is cloud-based allowing buildings and homes to be monitored and controlled from anywhere.

Key Information

Creating the smartest buildings and homes on the planet.

Contact

Deborah Noller

Phone

+61 2 8399 1919

Email

dnoller@switchautomation.com

Web

switchautomation.com

Address

2/46 Balfour Street
Chippendale NSW 2008

Technologies & Capabilities

The brains of the Switch Automation platform are on the internet or in 'the cloud'. This means you can monitor your building live via the internet wherever you are. It also frees you from the need to backup data or install expensive and unreliable hardware systems that are out of date within a few years and require replacement. Switch is constantly improving our platform and our regular upgrades are delivered via the internet without you having to do anything. The Switch IP based platform is based on a single backbone cable and offers both technical and cost benefits controlling everything from security and intercom to lighting and air-conditioning. This approach reduces cabling costs and complexity making installation simpler, cheaper and less resource intensive than traditional systems.

Key Areas of Expertise

Building Technology/
Products

Building Type

Precincts/Communities
Commercial Industrial
Hospitals/Aged Care
Education & Science
Hotels & Resorts
Retail
Convention Centres
Government
Residential
All

Typical International Business Partners/ Customers

Government – Public Sector
Project Developers
Private Sector Developers
Contractors

Current Export Markets

New Zealand

Target Export Markets

Bahrain
Brunei
Darussalam
China
Hong Kong
India
Kuwait
Oman
Qatar
Saudi
Arabia
Singapore
United Arab Emirates



Thermotec Australia Pty Ltd

Thermotec Australia was established in 1987 and has become a leading supplier of both Thermal & Acoustic insulation products to the building and construction industries. Thermotec's 4-Zero pipe insulation and NuWrap 5 Acoustic pipe wrap are commonly specified on most commercial projects in Australia. Thermotec also manufactures E-therm which is a reflective foil/foam/foil thin insulation that can be used as a 3 in 1 product replacing sarking and fibre products as well as giving a BCA section J compliant 'thermal break' when used on steel framed buildings.

Key Information

Australian manufacturer established 1987 of Green Star compliant Thermal & Acoustic Insulation products used in Building & Construction.

Contact

Michael Acraman

Phone

+61 2 9771 6400

Email

michael@thermotec.com.au

Web

thermotec.com.au

Address

168 Carrington Street
Revesby NSW 2212

Technologies & Capabilities

Thermotec Australia is the number one manufacturer of direct extruded closed cell polyethylene foam products. Thermotec is able to OEM manufacture products for "own brand" distribution. All products are tested to the appropriate Australian Building Standards and are BCA compliant.

Key Areas of Expertise

Technical services and consultancy

Building Technology / Products

- › Water capture efficiency or reuse building
- › Use of recycled content / materials

Technology / Products

- › Energy saving – renewable
- › Energy efficiency
- › Indoor environment quality

Building Type

All

Typical International Business Partners/ Customers

Government – Public Sector
Project Developers
Private Sector Developers
Contractors
Architects
Engineers
Specifiers
Agents / Distributors

Current Export Markets

New Zealand
United Arab Emirates

Target Export Markets

Argentina, Chile,
Cook Islands, Fiji Norfolk,
Island Papua New Guinea

International Green Building Project

Project name
Jumeira Beach Residential

Project Type
Residential

Project Location
Dubai

Project Partners

Kinetics Middle East LLC

ESD Features

- › Flooring Insulation made from 50 per cent recycled product
- › Acoustic and thermal properties
- › No ozone depleting substances used in manufacture or composition
- › Long life expectancy of product

Australian Project

Project name
Gold Coast Hospital

Project Type
Commercial

Project Location
Southport, Gold Coast

Project Partners
Christopher Contracting Pty Ltd

ESD Features

- › CA compliant product
- › No ozone depleting substances used in manufacture or composition of product
- › No VOCs.



Total Energy Solutions Pty Ltd

TES is an International Energy Services Company (ESC) assisting major government commercial and industrial facilities (new and existing) to reduce their energy water and greenhouse gas emissions. We operate throughout Australia and China from our offices in Brisbane, Sydney, Melbourne and Shanghai. TES services include expert energy efficiency and management consulting, energy star rating assessments and certifications, design and construction, energy performance contracting on-site maintenance of generation plants and Build Own Operate and Maintain (BOOM). TES personnel have over 100 years of combined experience in achieving energy and water savings for clients of 20–50 per cent with savings guaranteed for up to 10 years.

Key Information

TES – saving you money and delivering your greenhouse gas reduction plan.

Contact

Wynne Henderson

Phone

+61 7 3857 9696

Email

wynne@tesaustralia.com.au

Web

tesaustralia.com.au

Address

Level 1 Building 3
10 - 18 Banfield Street
Chermside QLD 4032

Technologies & Capabilities

TES have the in-house core expertise to design and integrate multiple technologies for energy savings projects including Cogeneration and Trigeneration plants (fuelled by natural gas and bio gas), HVAC systems, hot water systems, BMS systems, lighting and lighting controls, water and waste water management systems, and renewable energy technologies, including solar photovoltaic and Solar Hot Water. TES provides turnkey services for new major mixed use multi-site developments including concept and detailed design, installation, operation and on-site maintenance of Central Energy Plants adopting multi-gen technologies to achieve the highest energy star ratings with the lowest carbon footprint.

Key Areas of Expertise

Consulting Engineering
Project Management

Building Technology / Products

- › Water Capture Efficiency or Reuse Building
- › Energy Saving
- › Renewable Energy
- › Energy Efficiency

Building Type

Precincts / Communities
Commercial, Industrial, Hospitals / Aged Care, Education & Science, Hotels & Resorts, Retail Convention Centres
Government

Typical International Business Partners/ Customers

Government – Public Sector
Project Developers, Private Sector Developers, Contractors, Architects, Engineers, Specifiers, Agents / Distributors

Current and Target Export Markets

China

International Green Building Project

Project name

Yue Yang Hospital

Project Type

Healthcare

Project Location

Shanghai PRC

Australian Green Building Project

Project name

The Ark, Coca Cola Centre
North Sydney

Project Type

Commercial Building

Project Location

North Sydney NSW

ESD Features

- › 770 kWe Trigeneration Plant producing electricity chilled water and hot water
- › Trigeneration Plant configured to provide Emergency Power for the building
- › Export of surplus electricity to other sites on the distribution network
- › Achieved 6 Star Green Star.



Umow Lai Pty Ltd

We are a professional multi disciplinary building services engineering and sustainability consultancy that is synonymous with design innovation, quality cost effective solutions and principles of sustainability. Founded in Melbourne in 1991 Umow Lai now employs over 150 staff in Melbourne, Sydney and Brisbane. The firm provides planning, design and documentation and contract administration consulting services for new and refurbished building projects in the following industry sectors:

- › Health & Aged Care
- › Office & Commercial
- › Government
- › Education
- › Research & Laboratory
- › Justice
- › Sport & Recreation
- › Residential
- › Telecommunications
- › Data Centres
- › Retail
- › Civic & Municipal

Key Information

Engineering Sustainable Environments.

Contact

Ken Loh

Phone

+61 3 9249 0288

Email

ken.loh@umowlai.com.au

Web

umowlai.com.au

Address

Level 4, 10 Yarra Street
South Yarra Melbourne
VIC 3141

Technologies & Capabilities

Umow Lai's sustainability group is the largest and most active sustainability group in Australia. The group has achieved significant recognition from the Green Building Council of Australia, NABERS and other independent bodies for their innovative designs which provide a benchmark for the design of sustainable buildings of the future. Led by Director and Principal Sustainability Consultant Shane Esmore the group comprises 22 Green Star Accredited Professionals, 3 Green Star Associates, 1 Green Star Assessor, 6 NABERS Accredited Assessors, 2 LEED Accredited Professionals and 1 BREEAM Assessor

Key Areas of Expertise

Master Planning
Consulting Engineering

Building Type

All

Typical International Business Partners/ Customers

Government – Public Sector
Corporate
Private Sector Developers
Architects
Engineers

Current Export Markets

China
Hong Kong
Malaysia
United Arab Emirates
Vietnam

Target Export Markets

China
Hong Kong
Malaysia
Philippines
Singapore



International Green Building Project

Project name

Vanke

Project Type

Commercial

Project Location

Dougguan
Guangzhou China

Project Partners

Consulting Engineers

Umow Lai

Developer

Vanke Shenzhen China

Architect

Zava Ltd Zimbabwe

Structural Engineer

China National Engineering
Research Centre for Human
Settlements

ESD Features

- › Wind Turbines
- › Solar Thermal Dish Power
- › Solar Cooling
- › Thermal Updraft Tower Ventilation
- › Green Roof and Wetlands

Australian Green Building Project

Project name

Pixel Building

Project Type

Commercial

Project Location

Melbourne VIC

Project Partners

Consulting Engineers

Umow Lai

Architect

Studio 505

Developer

Grocon

ESD Features

- › Achieved a 6 Star Green Star – Office Design v3 rating
- › Extreme low energy design of the services systems
- › Excellent daylight and indoor environment quality
- › Potable water used for drinking only with all other water supplies coming from recycled sources
- › Native grass green roof and living edge grey water wetlands
- › Generated wind and solar renewable energy to fully offset operational and embodied carbon
- › Biogas from vacuum toilet waste used to heat domestic hot water
- › Targeting 6 Star Green Star – Office As Built v3 and Office Interiors v1.1 rating.



▲ Pixel, Melbourne VIC Australia, 6 Star Green Star – Office Design v3

Viridis E3

Viridis E3 is an environmentally sustainable development and property consultancy which assists businesses and projects to achieve and exceed their environmental goals. Viridis E3 specialises in delivering cost-effective environmentally sustainable development and property consultancy services for a broad range of public and private sector clients.

Key Information

Greening the built environment.

Contact

Warren Overton

Phone

+61 2 6285 2388

Email

woverton@ve3.com.au

Web

ve3.com.au

Address

Level 2
2 Mort St
Civic ACT 2601

Technologies & Capabilities

Our services span the lifecycle of a project or property development. Our expert team provides: strategic environmental and policy advice; scoping technical project and environmental services from design through to construction; and long-term environmental asset life cycle enhancement. Our industry and business training and corporate change management services complement our technical and design advice.

Key Areas of Expertise

Other – Technical Services or Consultancy

Building Type

All

Typical International Business Partners/ Customers

Government – Public Sector
Project Developers
Private Sector Developers
Engineers

Current Export Markets

China
New Zealand
South Africa
United Arab Emirates

Target Export Markets

Cambodia
East Timor
French Polynesia
Ghana
India
Indonesia
Malaysia
Papua New Guinea
Philippines
Polynesia
Samoa Solomon Islands
Somalia Southern and East
Africa
Sudan
Swaziland
Taiwan
Thailand
Tonga
Tuvalu
Uganda
Vanuatu
Vietnam
Zambia
Zimbabwe



International Green Building Project

Project name

Portside

Project Type

Commercial

Project Location

Cape Town South Africa

Project Partners

Agama Energy

First National Bank

ESD Features

Project is targeting

4 Star Green Star Design

(at early concept phase)

Australian Green Building Project

Project name

Santos Place Brisbane

Project Type

Commercial

Project Location

Brisbane QLD

Project Partners

Hutchinson Builders

FKP

ESD Features

- Achieved 6 Star Green Star – Design and As Built ratings
- Trigeration system
- Low embodied energy materials
- High efficiency lighting and HVAC system
- Water harvesting.



▲ Santos Place Brisbane, Brisbane QLD. 6 Star Green Star – Design and As Built

Weathertex

As a 100 per cent Australian owned and operated company Weathertex is proud to deliver sustainable and durable reconstituted timber products. Weathertex produces 100 per cent of its product from sustainable new growth Australian hardwood in an ISO 9001 certified process. All hardwood sourced for production of Weathertex products comes from local growth forests within 150 kilometers of the Weathertex site.

Key Information

Manufacturer of Australian natural timber structural building products for both residential and commercial applications.

Contact

Paul Read

Phone

+61 2 4980 3100

Email

pread@weathertex.com.au

Web

weathertex.com.au

Address

Masonite Road
Raymond Terrace
NSW 2324

Technologies & Capabilities

As Australia is proving itself as a global leader in the area of climate change mitigation, Weathertex is turning negatives into BIG positives.

Who would have thought that a factory would return carbon savings by producing a product that contains more carbon than what is emitted during its production.

Weathertex can proudly boast that its products have a negative carbon footprint.

Building Type

Commercial such as
Hospitals and Aged Care
Hotels and Resorts
Convention Centres
Government
Residential

Typical International Business Partners/ Customers

Private Sector Developers
Contractors Architects
Specifiers
Agents / Distributors

Current Export Markets

Belgium
Fiji
France
Polynesia

Germany
Indonesia
Italy
Netherlands
New Caledonia
New Zealand
Papua New Guinea
Philippines
Norway
Reunion Seychelles
Singapore
Solomon Islands
Vanuatu
Vietnam

Target Export Markets

French Polynesia
Hong Kong India
Japan
Republic of South Korea
Laos
Malaysia



Woods Bagot

Woods Bagot is a global design studio specialising in the design and planning of facilities across three key sectors: Education, Science and Health. Lifestyle. Workplace.

Our multi disciplinary team of highly skilled individuals provide services in architecture, consulting, interior design and urban design.

We offer access to a network of specialists across five regions: Asia, Australia, Europe, the Middle East and North America.

Woods Bagot operates as one global studio. Enabled by global technology solutions and a commitment to working without boundaries, our clients benefit from our international expertise, supported by a local studio that understands the regional cultural context.

PUBLIC, Woods Bagot's research brand, was created to enable staff, clients and collaborators to input into the future direction of global architecture and design. It was established to bring a formal focus to our applied and theoretical research. Research that underpins our approach and sets benchmarks for our sectors.

Key Information

Woods Bagot is a global leader in design and consulting underpinned by research.

Contact

Mark Kelly

Phone

+61 3 8646 6600

Email

mark.kelly@woodsbagot.com

Web

woodsbagot.com

Address

Podium Level 1,
3 Southgate Avenue
Southbank VIC 3006

Technologies & Capabilities

Woods Bagot was one of the first adopters of BIM technology in Australia with the introduction of ArchiCAD in the late 1990s. Since that time Woods Bagot has delivered some of the largest model-based projects in the Southern Hemisphere (including the Melbourne Convention and Exhibition Centre) and has actively applied parametric design methodologies and tools (Generative Components Rhino Grasshopper) to key projects in all regions it operates.

Key Areas of Expertise

Master Planning
Architecture
Interior Design

Building Type

Precincts / Communities
Commercial Industrial
Hospitals / Aged Care
Education & Science
Hotels & Resorts
Retail Convention Centres
Government
Residential
All

Typical International Business Partners/ Customers

Government – Public Sector
Project Developers
Private Sector Developers
Contractors

Current Export Markets

Albania, Azerbaijan, Bahrain, Belize, Brazil, Bulgaria, Cape Verde, China, Croatia, Cyprus, Czech Republic, England, France, French Polynesia, Georgia, Greece, Hong Kong, India, Indonesia, Ireland, Kuwait, Libya, Macau, Malaysia, Maldives, Mauritius, New Caledonia, New Zealand, Nigeria, Papua New Guinea, Qatar, Russian Federation, Saudi Arabia, Serbia and Montenegro, Singapore, Spain, Sri Lanka, Taiwan, United Arab Emirates, United States of America, Vietnam

Target Export Markets

Woods Bagot can service any market with qualified partners.

Profile continued >

**WOODS
BAGOT™**



Woods Bagot



Australian Green Building Project

Project name

Melbourne Convention and Exhibition Centre

Project Type

Civic

Project Location

Melbourne VIC

Project Partners

NH Architecture

Plenary

ESD Features

A 6 Star Green Star – Convention Centre PILOT rating by GBCA – a world first for convention centres and the 6th building in Australia to achieve a 6 Star rating. The Centre will be the world's first 6 Green Star rated convention centre underpinned by an investment in black water treatment and water conservation. The project will also comprise an AUD 1 billion integrated mixed-use precinct in a single stage of development. The integrated precinct comprises:

- › 66 000 sqm Convention Centre integrated with the existing Melbourne Exhibition Centre
- › Pedestrian bridge across the Yarra River
- › 12 storey, 5 star Hilton Hotel
- › 18 000 sqm riverfront promenade of lifestyle retail incorporating cafes bookstores and tourism retail
- › 50 000 sqm of premium brand retail complex that will be one of the largest single stage retail developments ever completed in the Melbourne CBD
- › An investment in public spaces including a partnership with the National Trust for a revitalised Maritime Museum.

**WOODS
BAGOT™**



International Green Building Project

Project name

Qatar Science and Technology Park

Project Type

Science & Research

Project Location

Doha, Qatar

Project Partners

Qatar Foundation

ESD Features

- › Thermal comfort
- › Natural light
- › Double skin metal and glass external wall zone which assists the control of heat gain and reflects light back into interior spaces reducing the loading of artificial lighting required deep in the building
- › Double glazed high performance window systems were also utilised to reduce the amount of heat loading on the building.

Disclaimer

This brochure has been prepared as a general overview. It is not intended to provide an exhaustive coverage of the green building industry in Australia. The information is made available on the understanding that the Australian Trade Commission (Austrade) and Green Building Council of Australia (the parties) are not providing professional advice. Therefore, while all care has been taken in the preparation of the report, the parties do not accept responsibility for any losses suffered by persons relying on the information contained in the report or arising from any error or omission in the report. Any person relying on this information does so entirely at their own discretion and the parties strongly recommend the reader obtain independent professional advice prior to acting on this information.

Commonwealth Copyright ©Commonwealth of Australia 2011

This work is copyright. Apart from any use as permitted under the Copyright Act 1968, no part may be reproduced by any process without prior written permission from the Commonwealth of Australia, available through the Australian Trade Commission (Austrade). Requests and inquiries concerning reproduction and rights should be addressed to Austrade, GPO Box 5301, Sydney NSW 2001 or by email to info@austrade.gov.au

