

AutoCAD 2017 for Mac Preview Guide

User Interface	2
Tool Sets	3
Custom Tool Set Panels	7
Toolbar	9
File Tabs	10
Quick View Panel	11
Layout Tabs	11
Status Bar	12
Properties Window	13
Layers Palette	14
Importing PDF Files	14
IMPORT Command	15
PDFIMPORT/-PDFIMPORT Command	17
Publish to PDF	19
Associative Centerlines and Center Marks	21
Text Editor Visor	24
Parametric Menu	25
Multiple AutoCAD Sessions	26
Full Screen	27
License Manager	28
Autodesk Account Sign-In	29
2D Graphics	30
Delete Key	31
Hatch Layer	32
TEXTEDIT Command	32
Rendering	32
Offline Help	32

User Interface

Significant changes have been made to the user interface for AutoCAD 2017 for Mac.

- The tool sets have been redesigned for better organization and to provide access to more tools.
- A toolbar has been added above the drawing window containing frequently used commands such as New Drawing, Save, Open, Undo, Redo, and Print.
- File tabs provide an easy way for you to access all the open drawings in the application.
- Layout and model tabs are now available in the lower-left corner under the drawing area, to easily switch between the Model and the existing layouts.
- The Status Bar has been updated and is now in line with the Model and Layout tabs.
- The layer tools have been added to the Properties window for easy access and the Properties window is part of the application frame.
- The Layers palette contains more layer properties.
- The command line is anchored at the bottom of the drawing area.

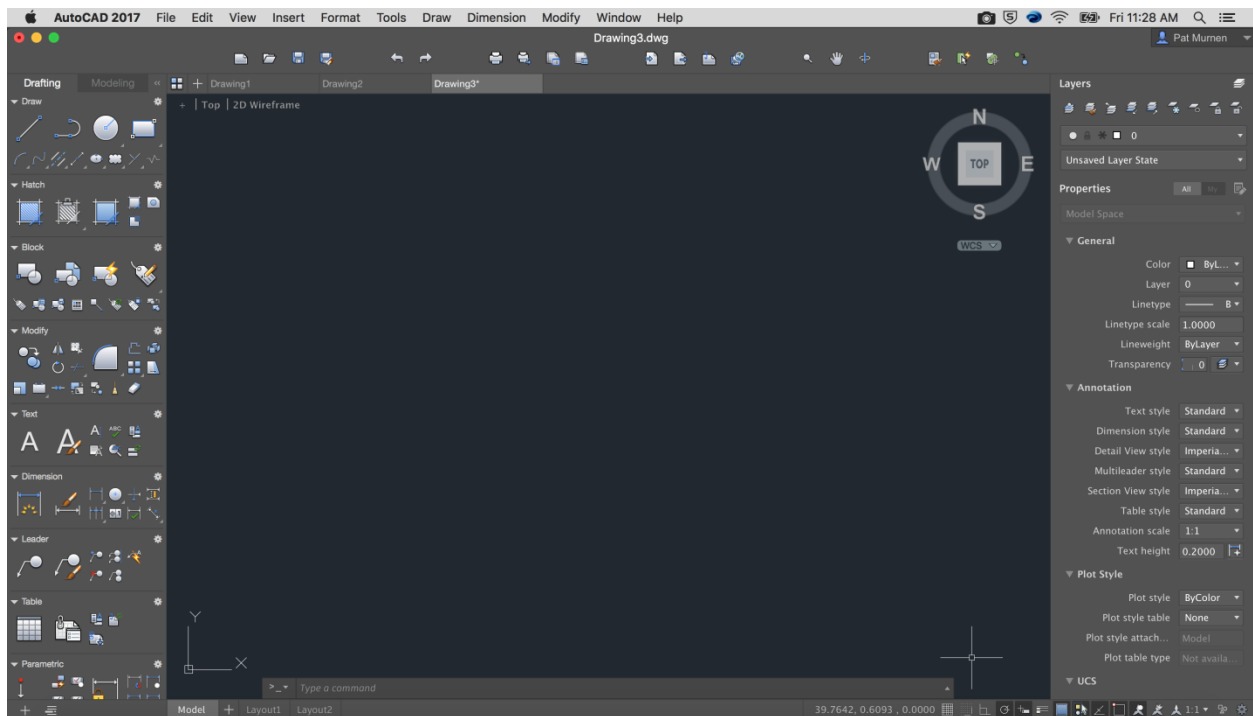

Tool Sets

The tool sets are divided into two tabs: Drafting and Modeling.

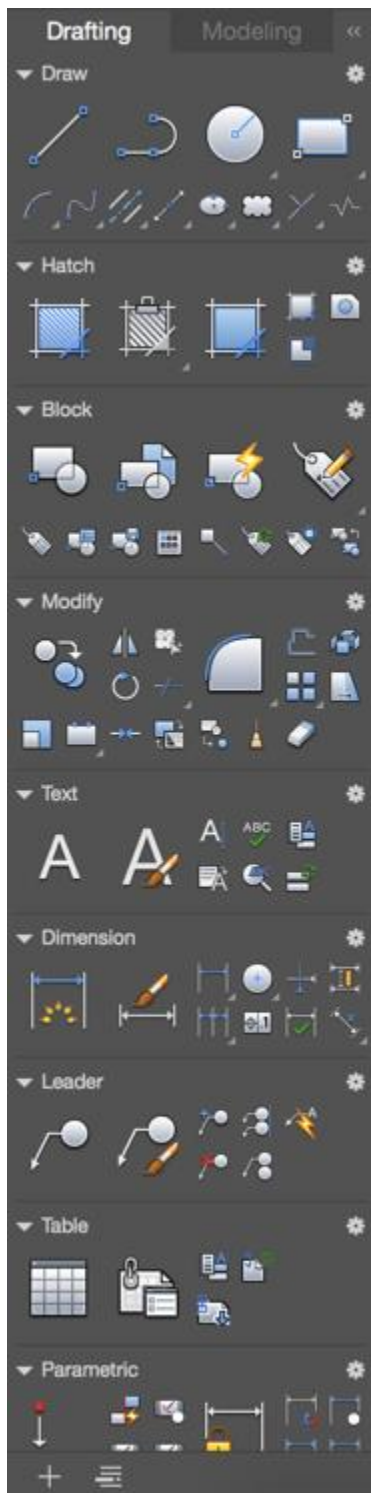

Note: AutoCAD LT does not contain the Modeling tab.

Each tab contains predefined standard panels, grouping related commands together. Click  on any standard panel to select which commands to show or hide from that set.

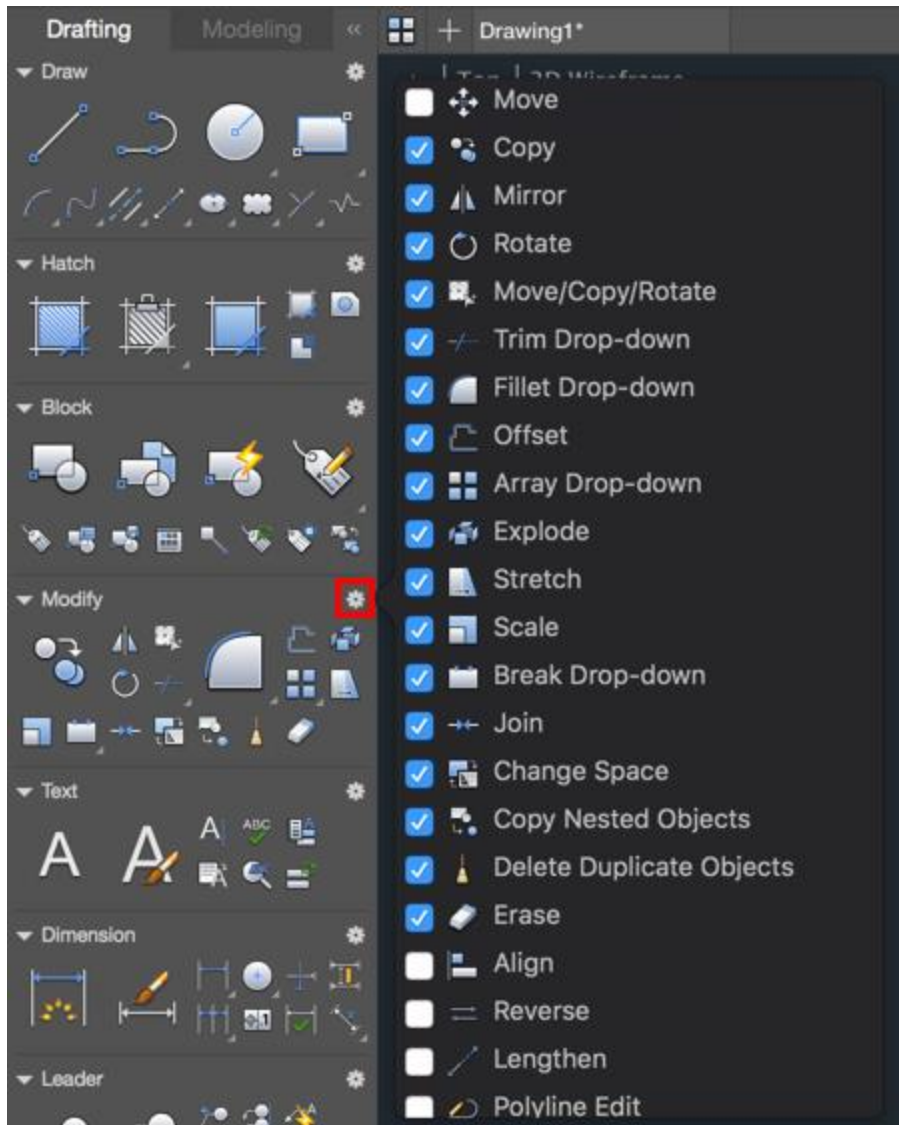

You can change the order of the panels on a tool set.

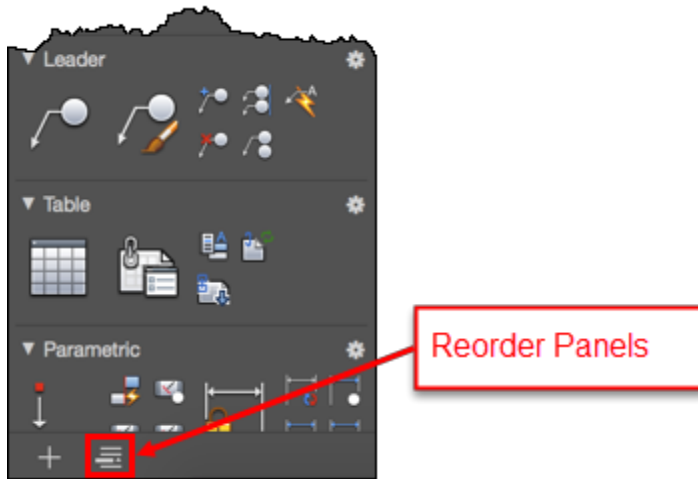

Drag the panel titles to define the order.

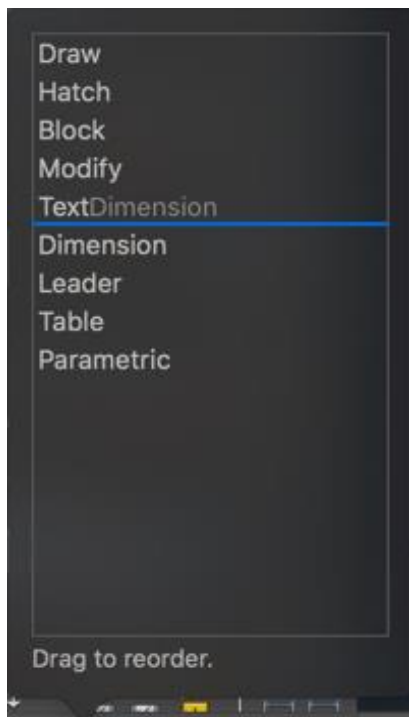

Collapse a panel when not using the controls. The title for the panel is still visible so you can expand the panel when needed.

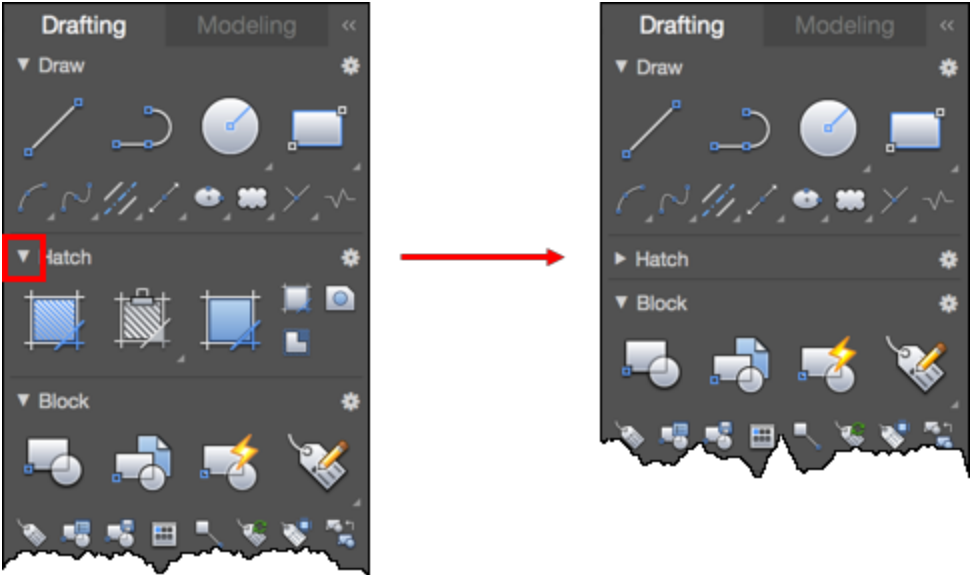

Switch between two different tool set widths, the mini tool sets and full size tool sets.



The mini tool sets use small icons for all commands.

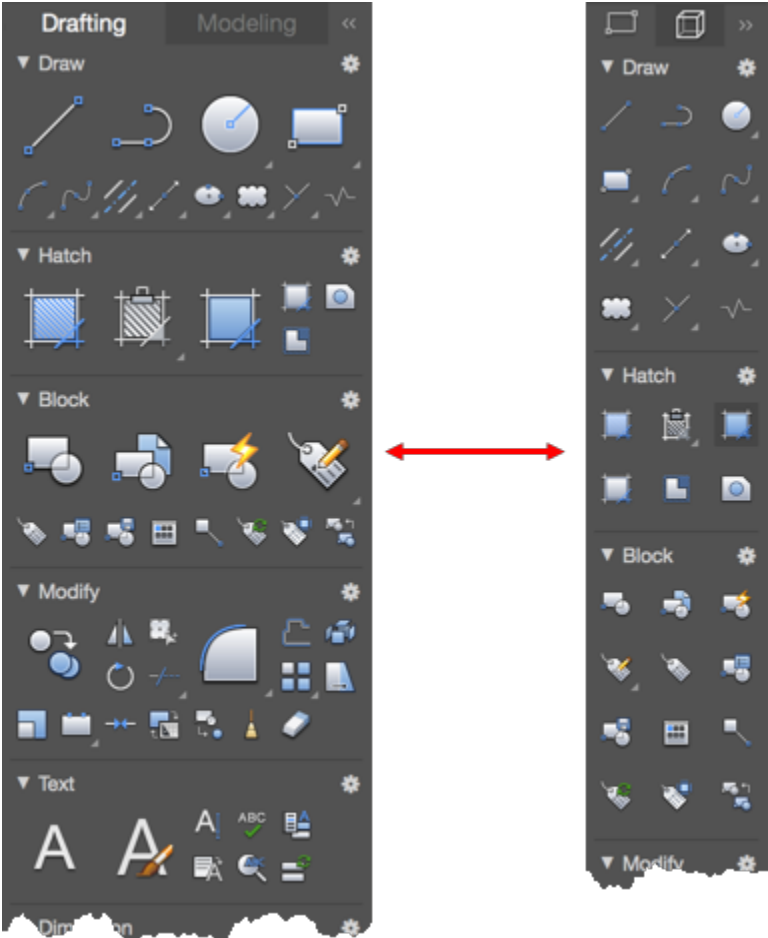

Custom Tool Set Panels

You can create custom tool sets. Click the plus sign (+) at the bottom of the tool set.

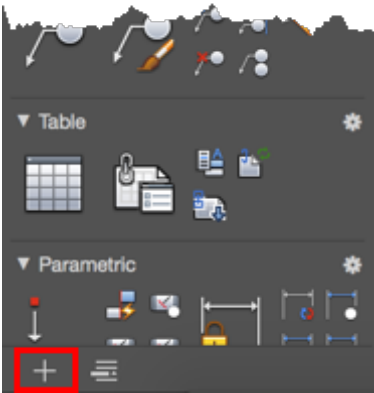

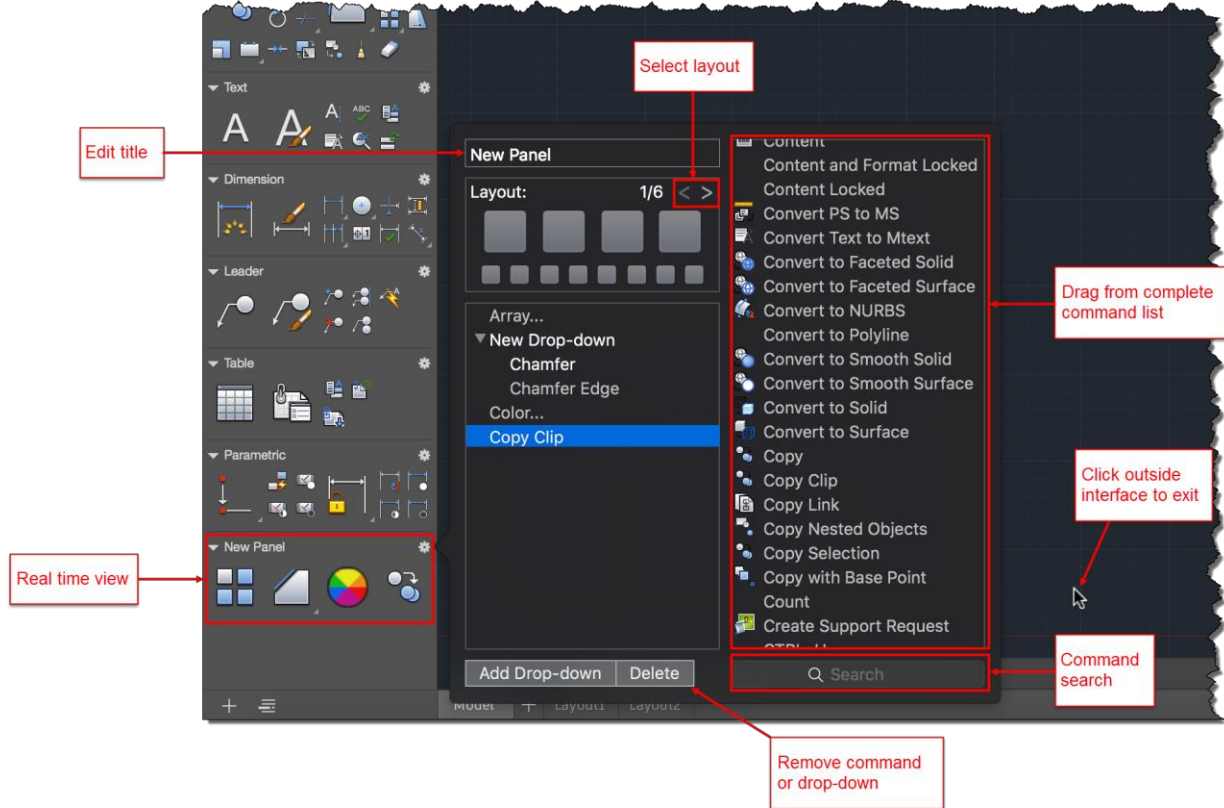

Enter a panel title, select the icon layout, and add commands and dropdowns.



While creating your custom tool set:

- Drag commands from the full command list to the preview panel.
- Hover over a command to see the command name and description.
- Use Shift or Command to select multiple commands to add to the tool set.
- Easily add a dropdown and drag commands under the dropdown to create a subset of icons.

Notes:

- All changes happen in real time so you can immediately see the changes made.
- To edit your custom panel later, click  on the panel to return to this view.
- To delete a custom panel, move the mouse over the panel to see the  button. Click  to delete the custom panel.
- Standard tool sets can't be deleted.

Toolbar

A toolbar has been added above the drawing window. This toolbar contains frequently used commands such as New Drawing, Save, Open, Undo, Redo, and Print.

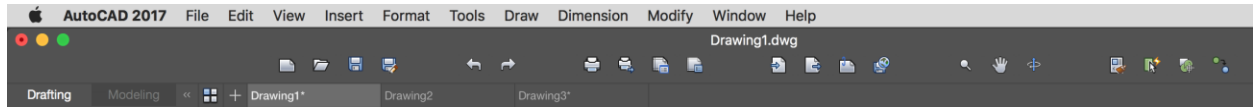

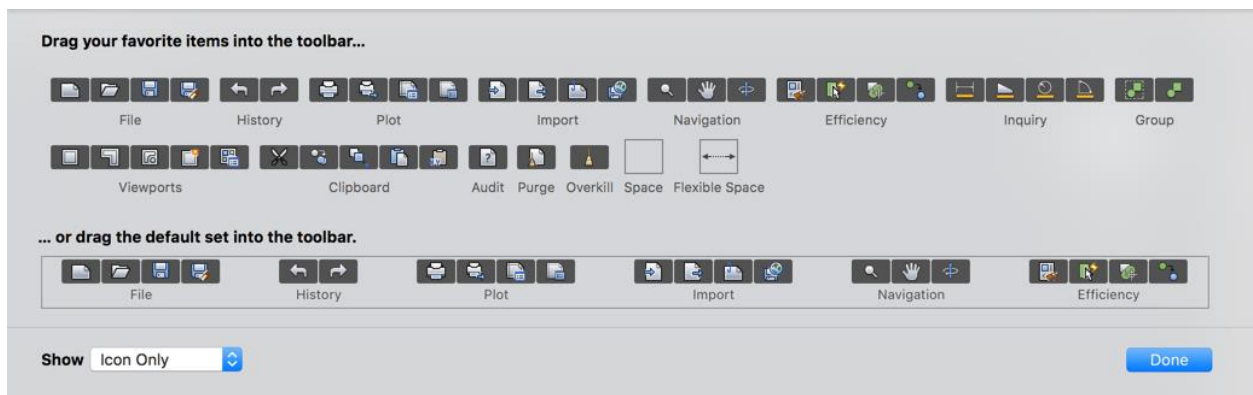
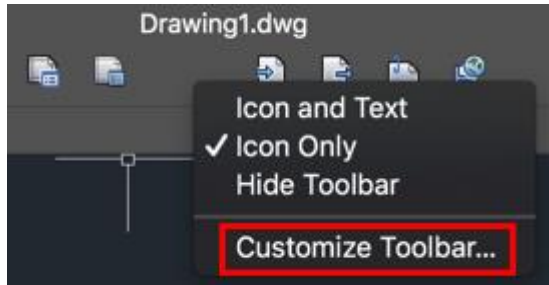

Right-click on the toolbar to show labels, hide the toolbar, or to customize.

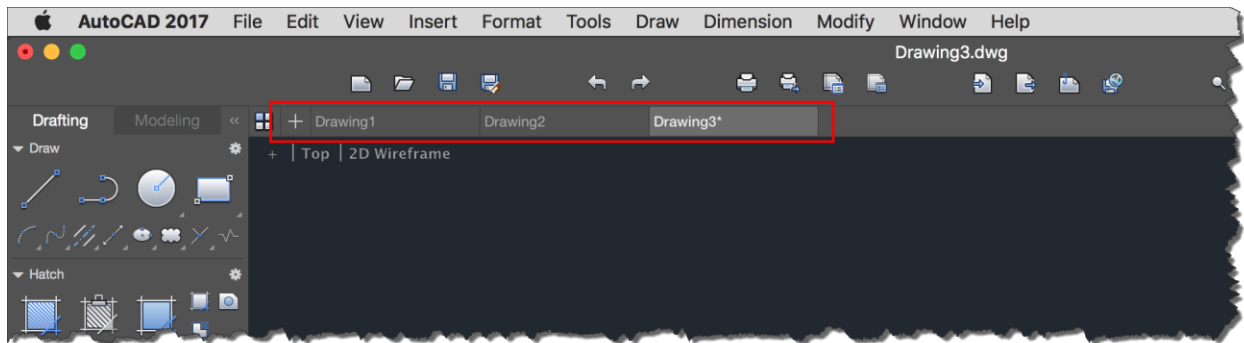

File Tabs

File tabs provide an easy way for you to access all the open drawings in the application.



- Clicking the plus sign (+) on the file tabs bar opens a new drawing. If a default template isn't specified in Preferences, you can select a template. That template is used as the default from that point on.
- Use Control+TAB to navigate through the file tabs.
- Right-click on the file tabs to access the shortcut menus that have options to open, close, or save drawings.
- Click  to open the Quick View where you can preview and switch between open drawings and layouts in an open drawing.

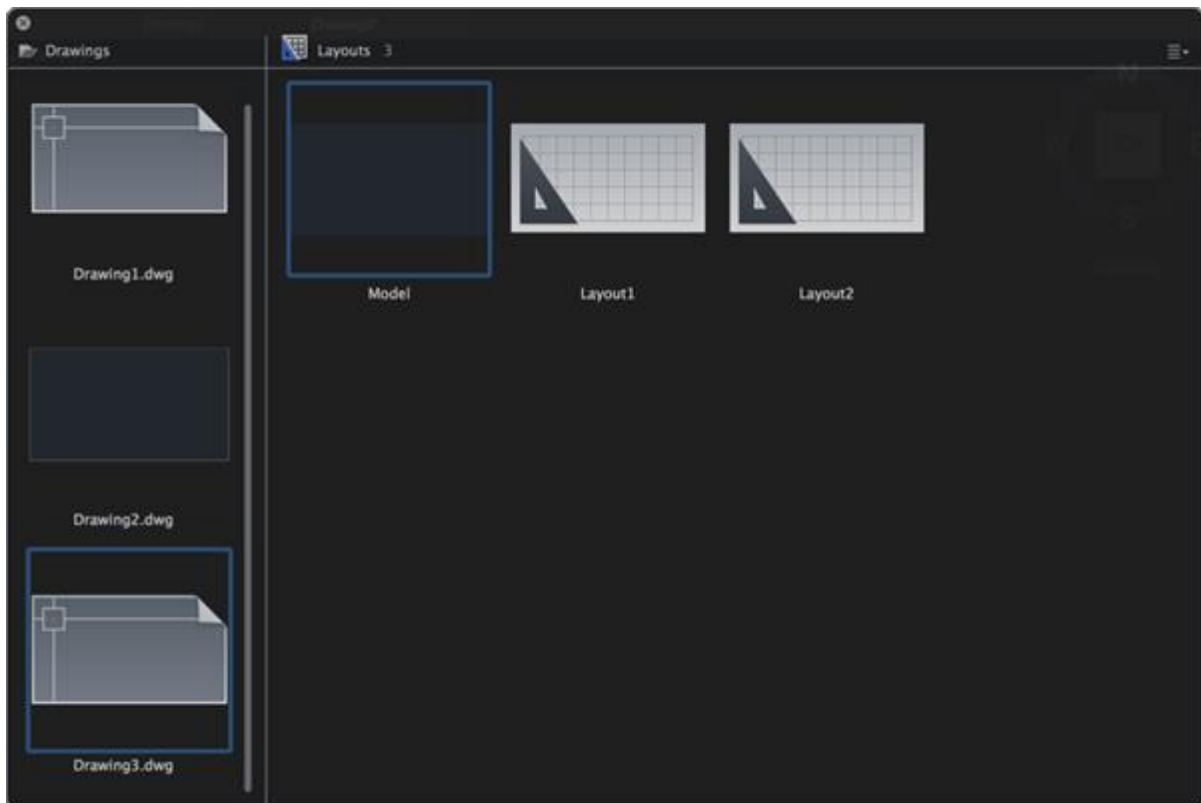

Quick View Panel

You can now select and delete multiple layouts on the Quick View panel.

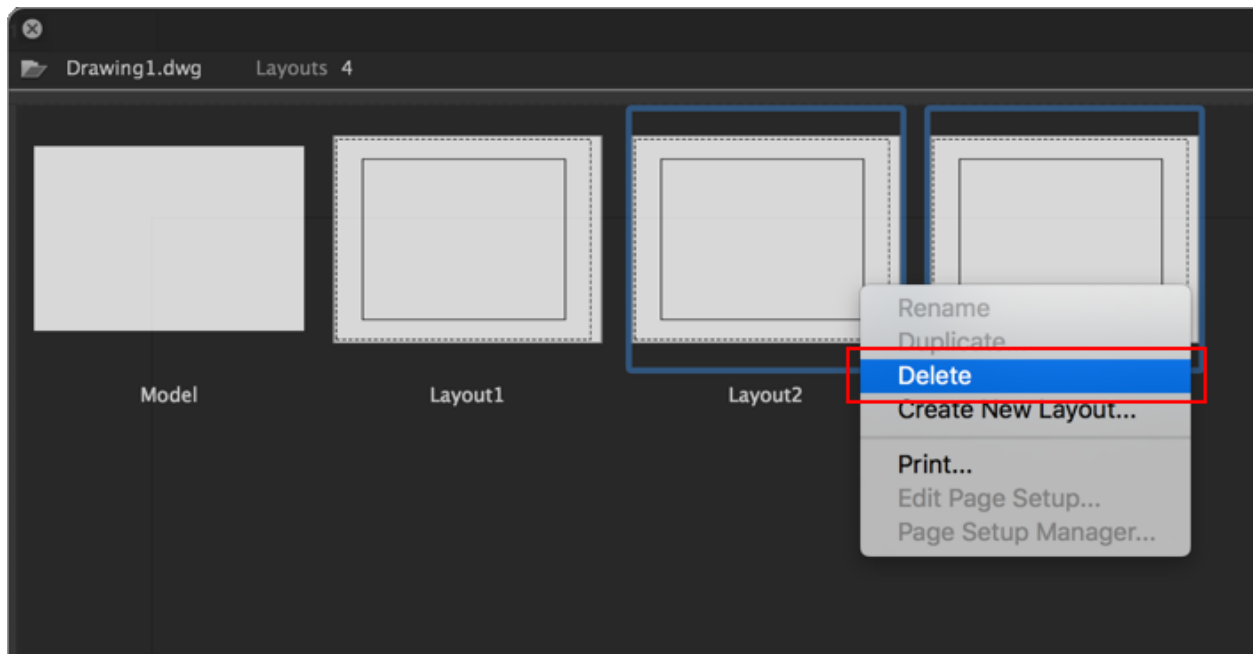

Layout Tabs

Use the layout tabs, located in the lower-left corner under the drawing area, to easily switch between the model and the existing layouts.

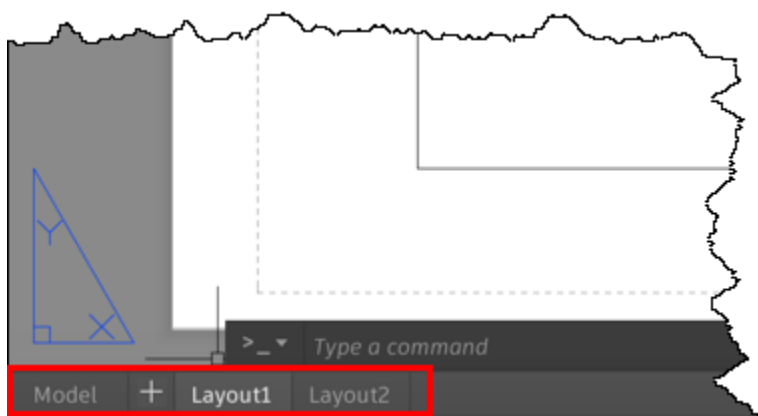

- Click **+** to create a layout.
- Drag any layout tab to change the order listed.
- Right-click a layout tab to rename, delete, or copy.
- Press **command+** to switch to the next tab or **command +[** to switch to the previous tab.

Status Bar

The Status Bar has been updated and is now in line with the Model and Layout tabs. **Command+6** toggles the display of the Status Bar along with the Model and Layout tabs.

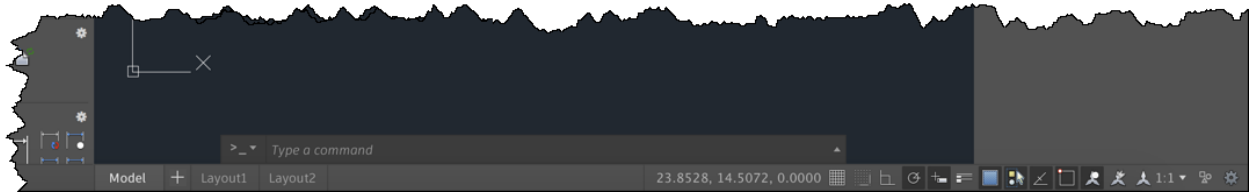

Click  to display or hide commands on the Status Bar.

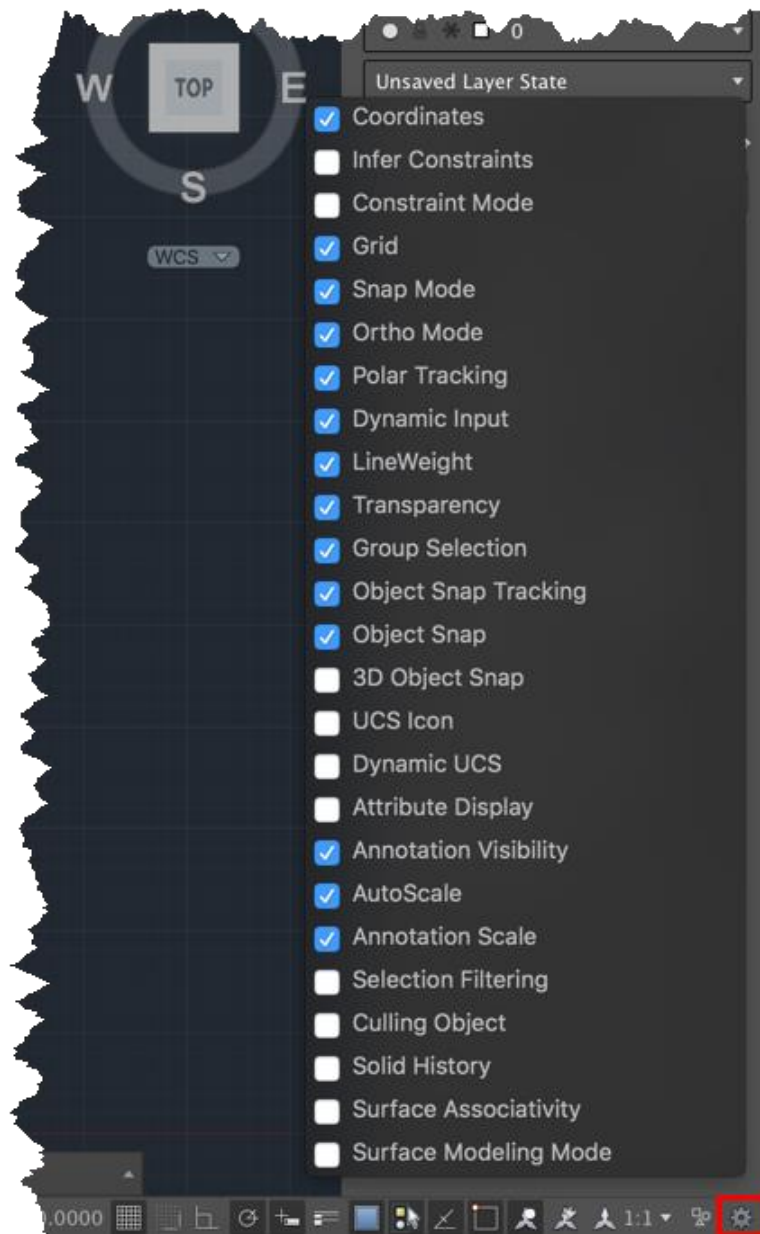

Properties Window

The Properties window is now part of the application frame. It can be turned off or on and you can change the width. Layer controls are added to the top of the Properties window for easy access.

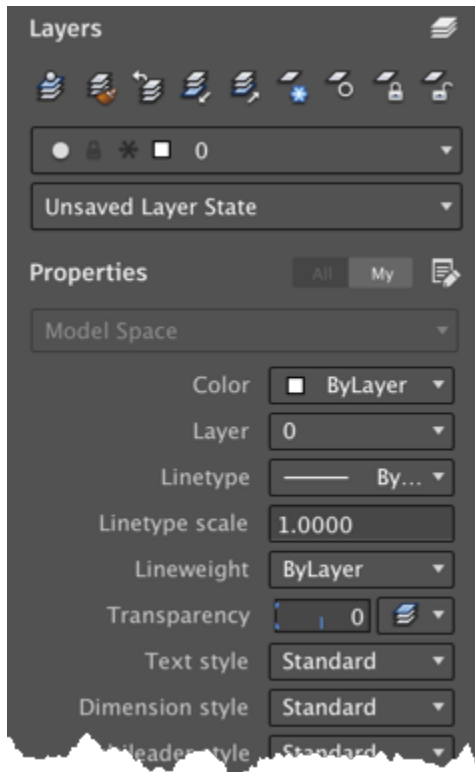

Layers Palette

If you need to see more layer properties than what are included on the Properties window, you can open the Layers palette by any of these methods:

- Click the button in the upper right of the Properties window.

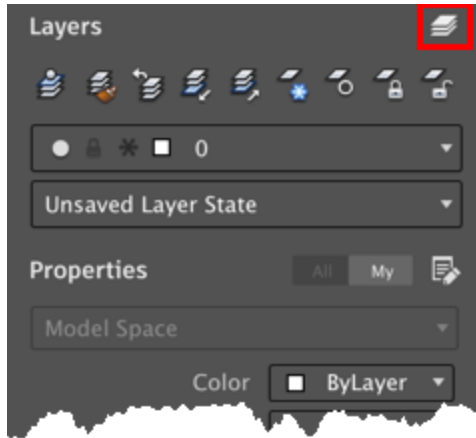

- Press **Command+4**
- Select Window menu > Layers.

More properties are now included on the Layers palette.

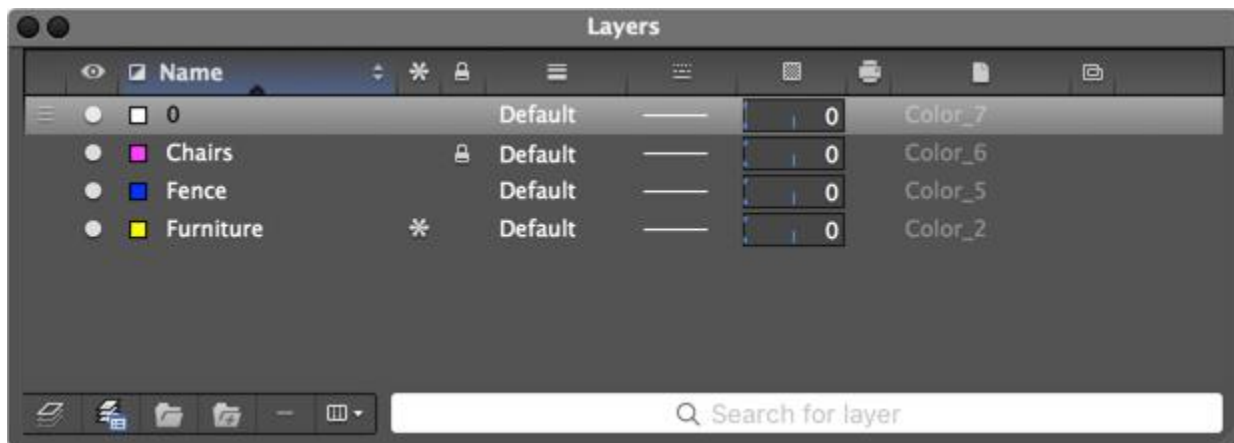

Importing PDF Files

PDF files are a common way of publishing and sharing design data for review and markup. AutoCAD currently supports creating PDF files as a publishing output for AutoCAD drawings. PDF files can be attached to drawings, which can be used as a reference when collaborating on projects. In AutoCAD 2017 for Mac, you can import the geometry, TrueType text, and raster images from a specified page in a PDF file, or from all or part of an attached PDF underlay.

IMPORT Command

The Import tool, available from the Toolbar and File Menu, enables you to import geometry from a PDF page into the current drawing as AutoCAD objects.

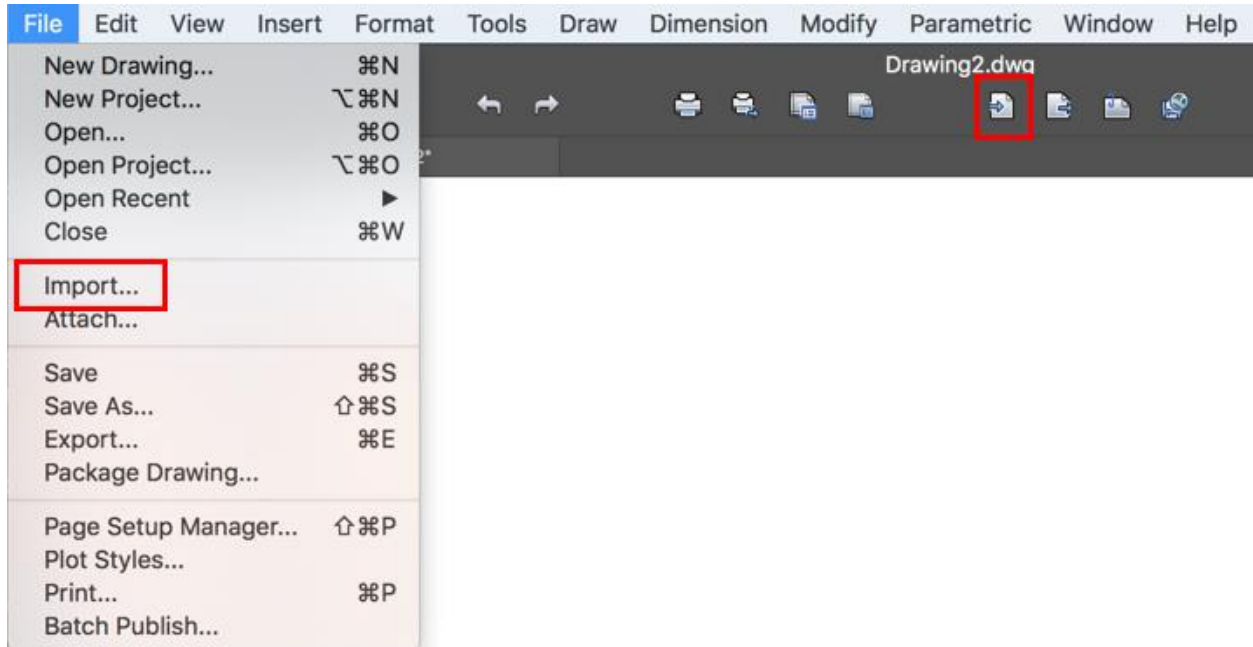

In the Import File dialog, you see that PDF has been added to the list of supported file formats.

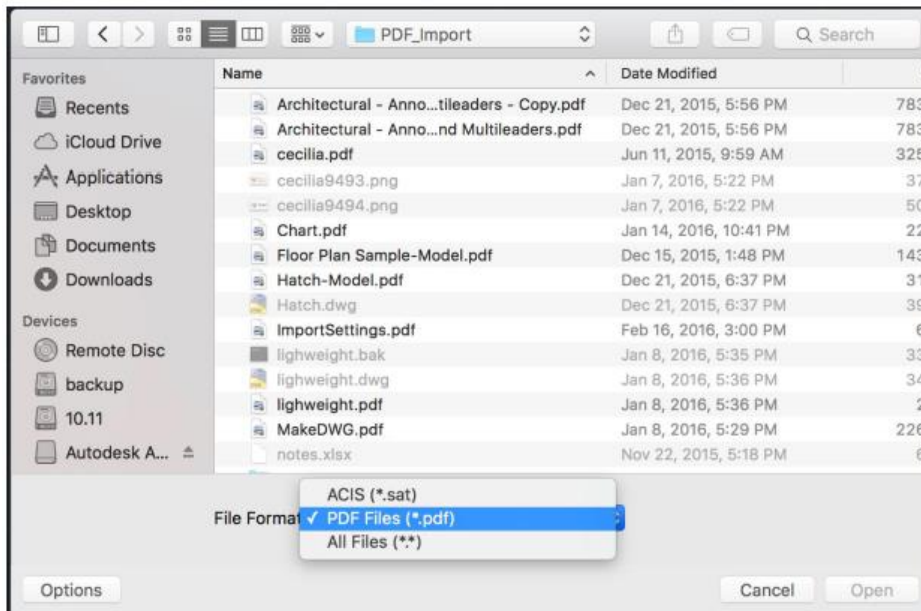

After a PDF file type is selected, the Import PDF dialog is displayed and allows you to:

- Choose which page from the selected PDF file to import
- Specify the Scale, Rotation, and Insertion point of the imported geometry
- Control what type of data is imported from the PDF (Geometry, Solid fills, Text, and Raster objects)
- Control how layers are assigned to imported objects
- Set different postprocessing options for imported geometry

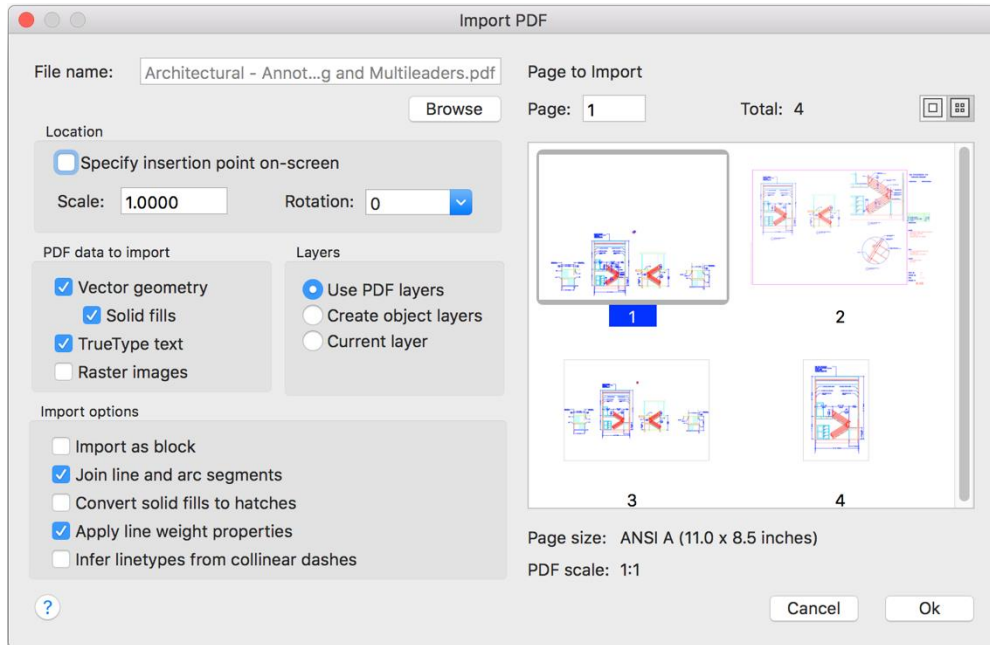

Raster images are extracted as PNG files and attached to the drawing.

The “Convert solid fills to hatches” check box joins 2D solids with coincident edges and converts them into hatch objects. Note that this option increases the processing time.

The “Apply lineweight properties” check box applies the lineweights in the PDF to the extracted geometry. When cleared, all imported geometry is assigned AutoCAD’s default lineweight.

The “Infer linetypes from collinear dashes” check box looks at collections of collinear dash and dot segments and replaces them with a single polyline. A dashed PDF_IMPORT linetype is created and applied to the polyline and assigned a linetype scale based on the length of the dashes. This setting reduces the number of objects and makes it easier to edit the geometry, but some fidelity is lost. If cleared, each segment in a dashed line is imported as a separate pline.

In the Application tab of the Preferences dialog, you can specify the file location for image files that are extracted from the PDF and attached to the drawing. The default path is in the PDF Images folder which

is relative to the location of PDF file being imported. The path can be either absolute or relative.

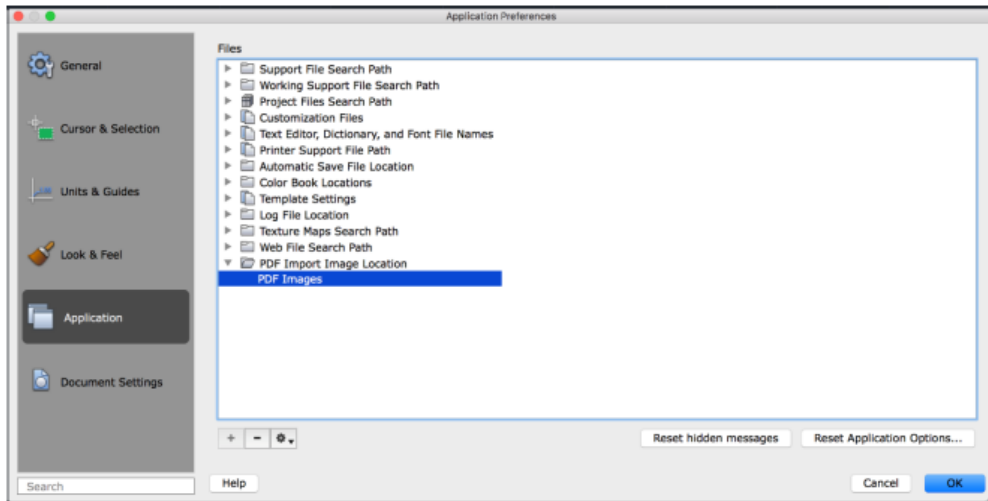

The PDF file format doesn't recognize SHX text. When drawings with SHX fonts are plotted to PDF, the PDF stores that data as geometry (not text), so the SHX text is imported as geometry. Text with TrueType fonts are imported as text objects.

PDFIMPORT/-PDFIMPORT Command

The new PDFIMPORT command (–PDFIMPORT if using command line access) offers an alternate way for you to import PDF geometry into the current drawing. The initial options provide a choice either to select an attached PDF underlay, or to specify a PDF file.



If you choose the File option, the Import PDF dialog is displayed just as when you use the IMPORT command.

If you select an attached PDF underlay, you can specify a rectangular or polygonal boundary around the objects you want to import, or you can import everything.

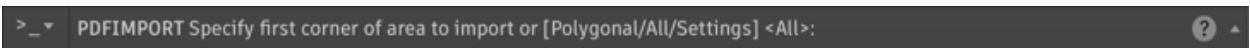

You can also choose to keep, detach, or unload the PDF underlay after the objects are imported.



The Settings option in the PDFIMPORT command displays a dialog that provides the same settings as those in the Import PDF dialog.

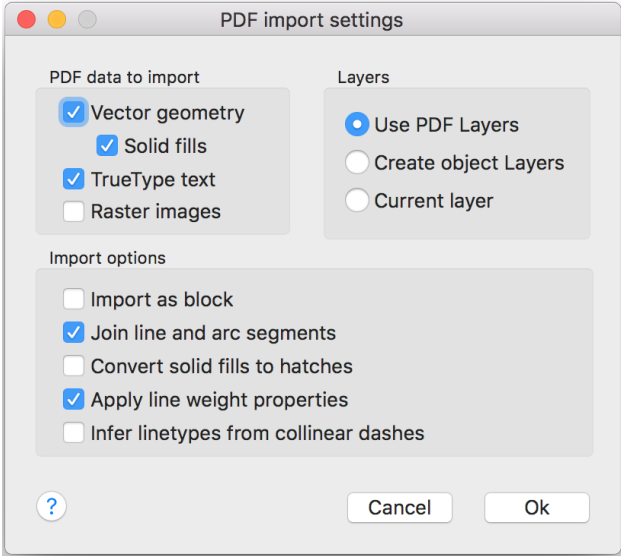

If you select a PDF underlay that is attached to the current drawing, you can access the Import PDF tool from the visor of PDF Underlay.

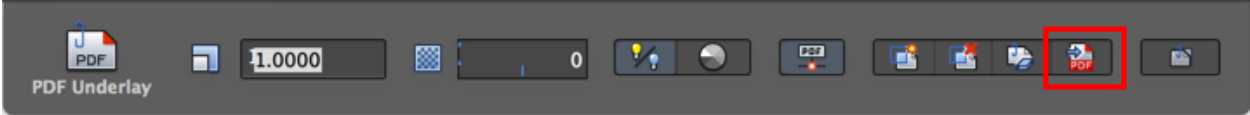

Publish to PDF

Buttons are now available to add the current drawing and remove the model space sheet from the list for publishing. The dialog is also now resizable.

Publishing is updated with PDF.pc3 support. You can now pick one of the five predefined PDF presets when plotting your drawings to PDF. These presets provide a way to quickly set different PDF output options that fit various purposes.

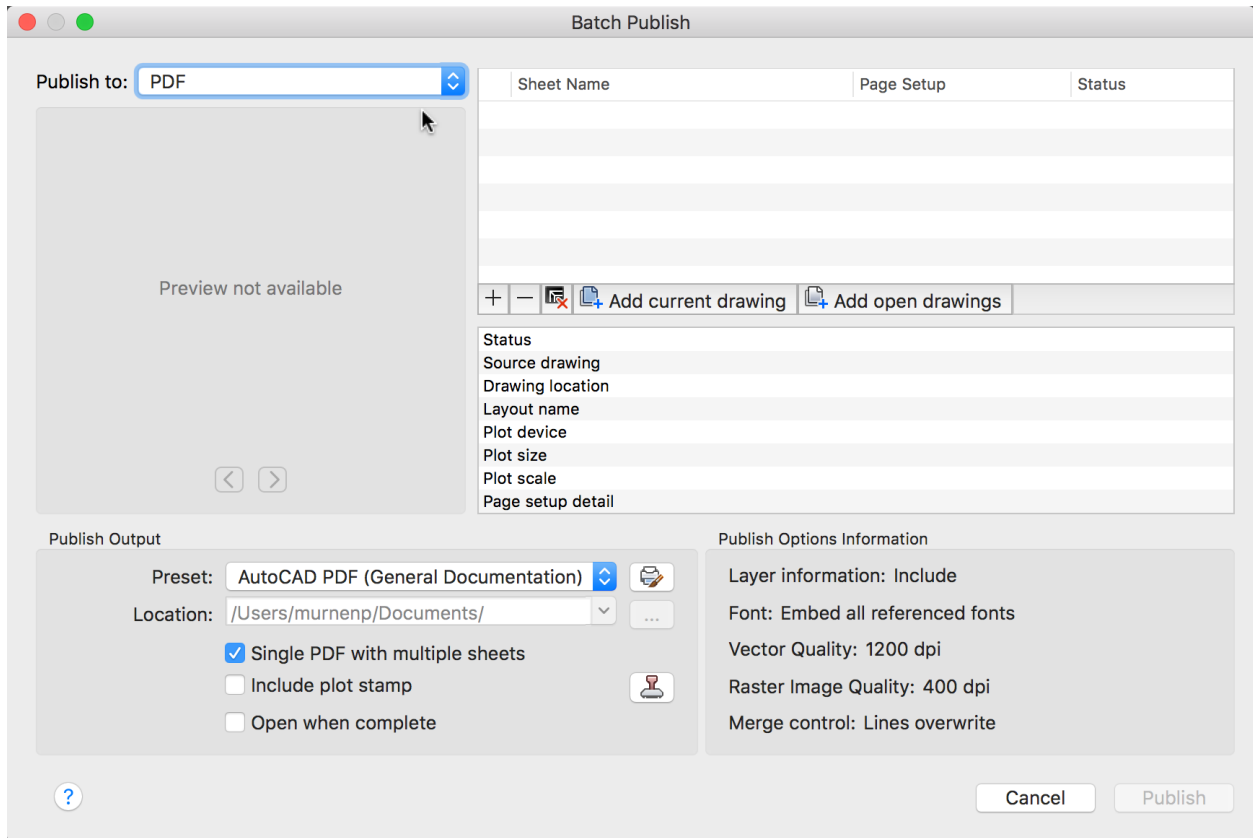

Click PDF Options to modify the individual settings.

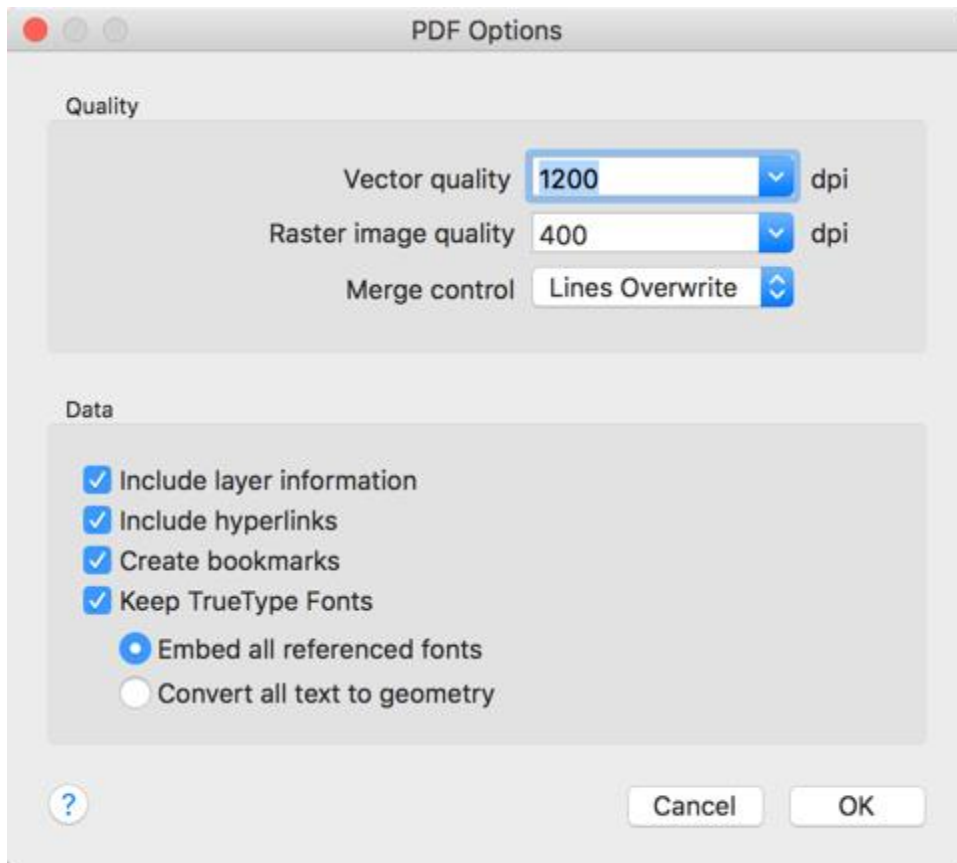

Layers are now available in the output PDF, and multi-sheet PDF supports different paper size for the sheets.

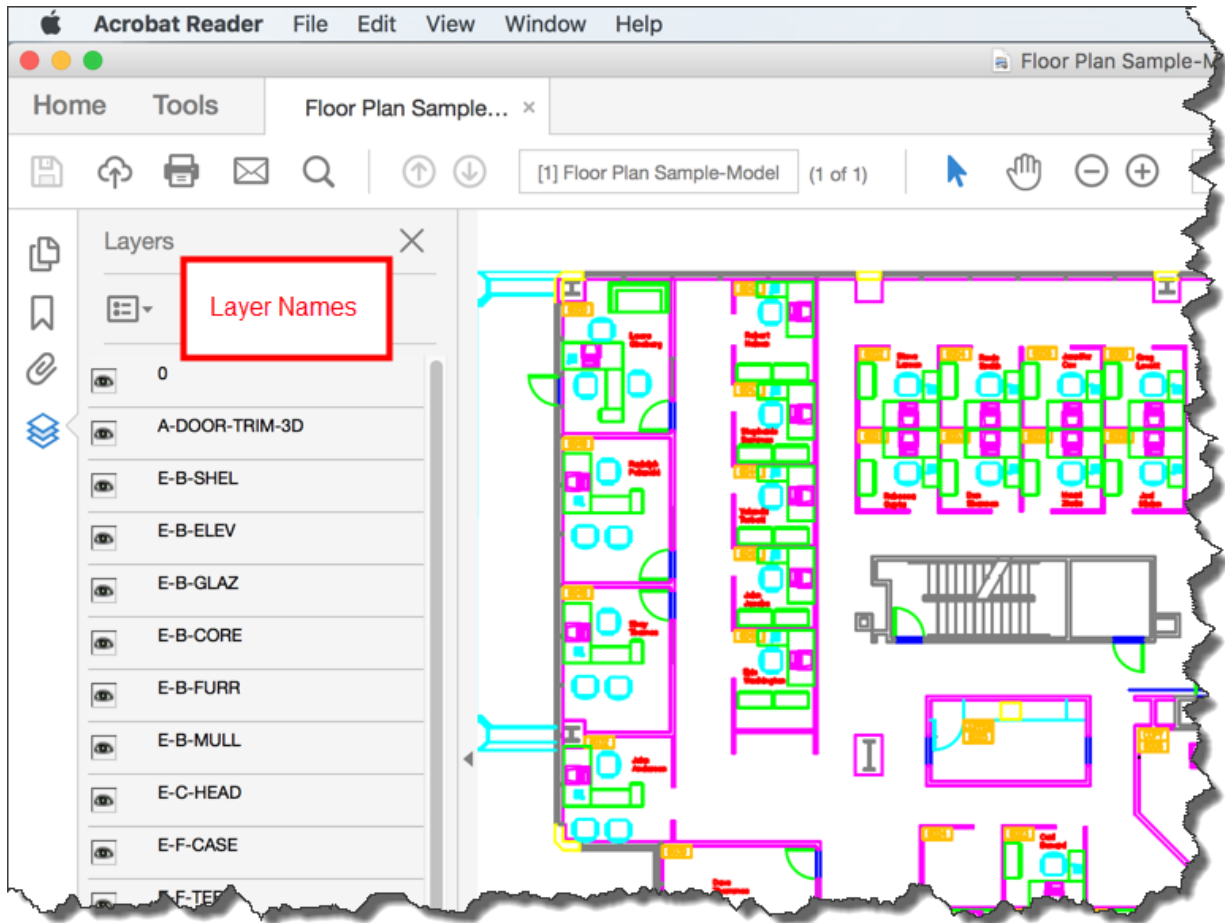

Associative Centerlines and Center Marks

AutoCAD 2017 for Mac offers powerful new tools for creating and editing centerlines and center marks. You can access the Center Mark and Centerline tools from the Draw Menu or on the Dimension panel of the Drafting tab tool set.

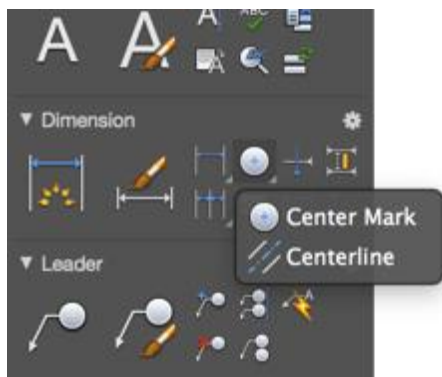

The Centerline tool creates centerline geometry of a specified linetype in association with selected lines and polylines. The Center Mark tool creates an associative center mark at the center of a selected circle, arc, or polygonal arc. If you move the associated objects, the centerlines and center marks update accordingly.

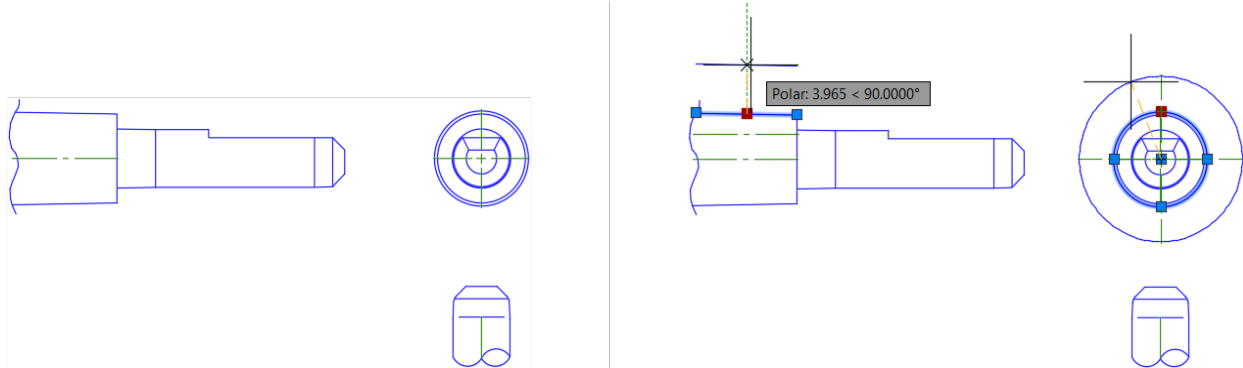

You can disassociate centerlines and center marks from objects using the CENTERDISASSOCIATE command. Use the CENTERREASSOCIATE command to reassociate centerlines and center marks with selected objects.

The following system variables control the appearance of centerlines and center marks:

CENTEREXE – Controls the length of extension line overshoots for centerlines and center marks.

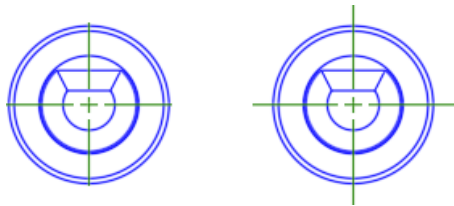

CENTERMARKEXE – Determines whether extension lines are created for center marks.

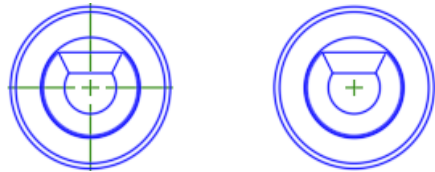

CENTERLAYER – Specifies the layer on which centerlines and center marks are created.

CENTERLTYPE – Specifies the linetype used by centerlines and center marks.

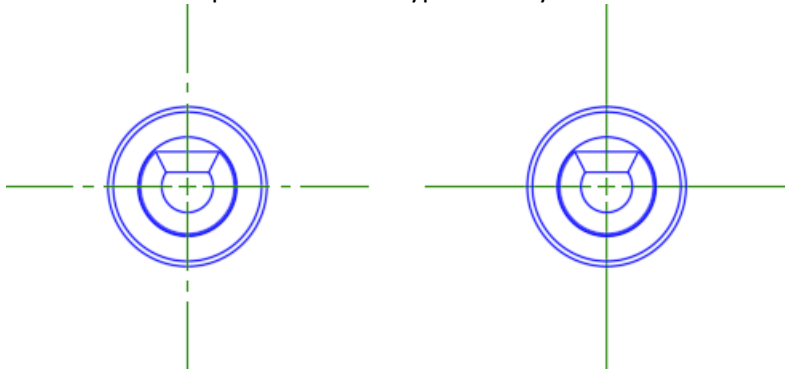

CENTERLTSCALE – Sets the linetype scale used by centerlines and center marks.

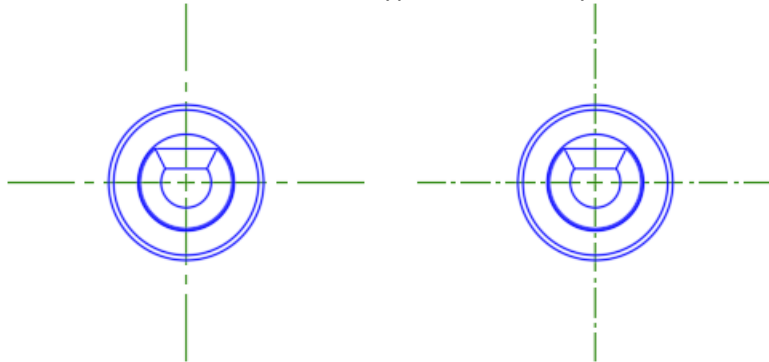

CENTERCROSSSIZE – Determines the size of the central cross for center marks.

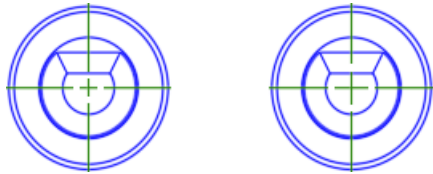

CENTERCROSSGAP – Determines the extension line gap between the central cross and the extension lines of center marks.

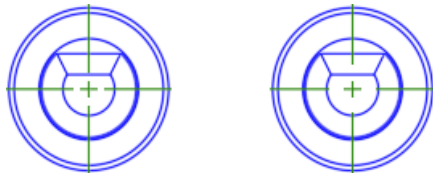

You can modify centerlines and center marks with their grips. A multifunctional grip menu offers more controls.

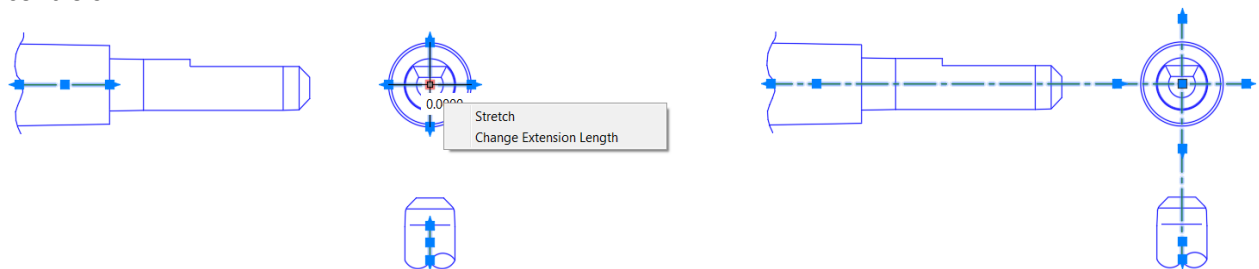

You can use the Properties window to view and edit centerline and center mark properties.

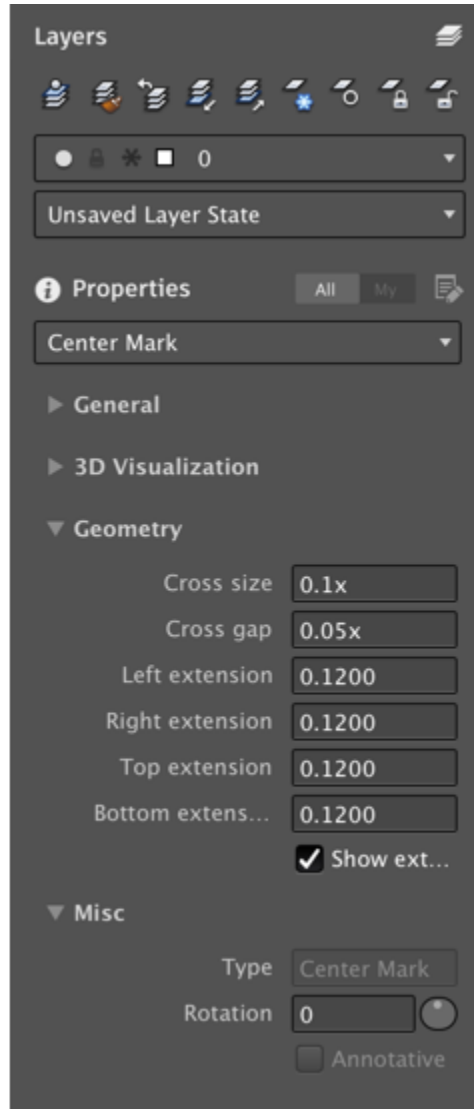
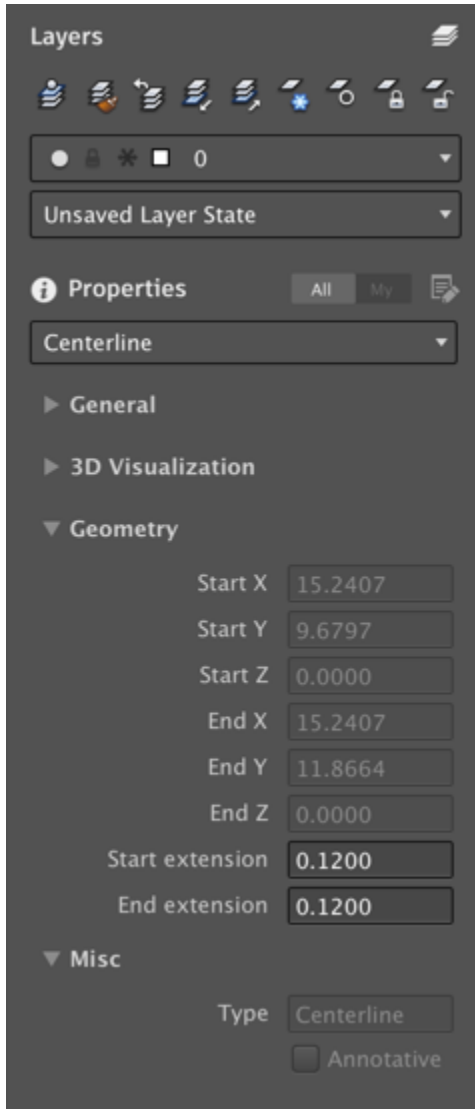

Use the CENTERRESET command to reset the extension lines of a center mark or centerline object to the current value of CENTEREXE.

Text Editor Visor

The Text Editor visor now has buttons for formatting text as stacked, superscript, or subscript.

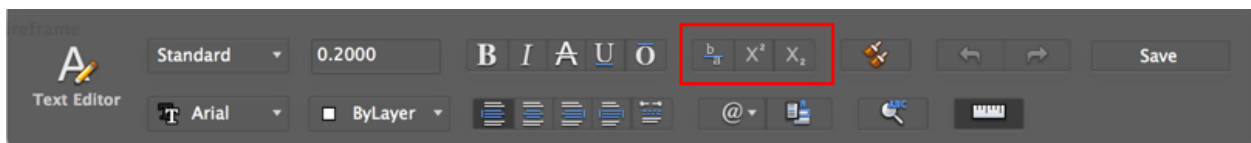

Parametric Menu

The Parametric menu is now a submenu under the Tools menu.

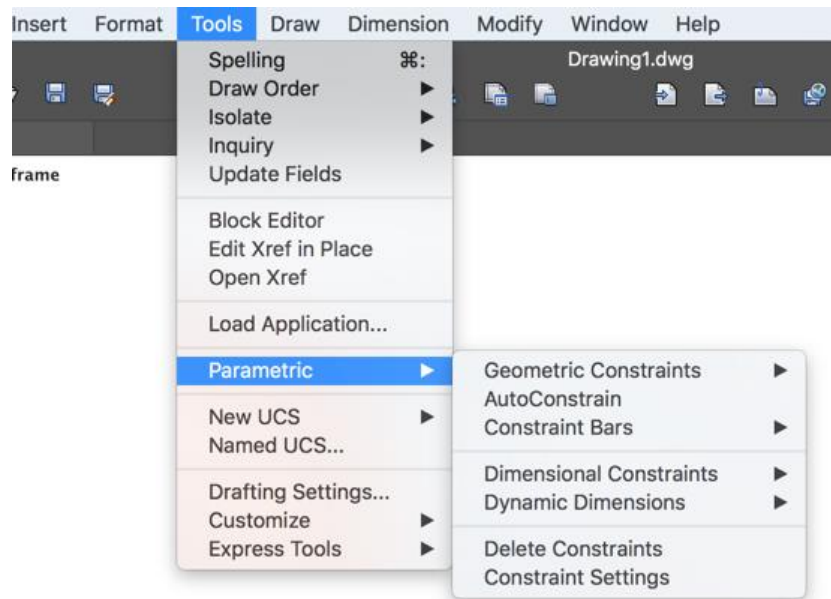

Multiple AutoCAD Sessions

If you have a session of AutoCAD running and want to open another, there are a couple ways you can open another session.

In AutoCAD, right-click on the file tab of the drawing you want to open in another session and click Move to New Session. This option is available if you have more than one drawing open.

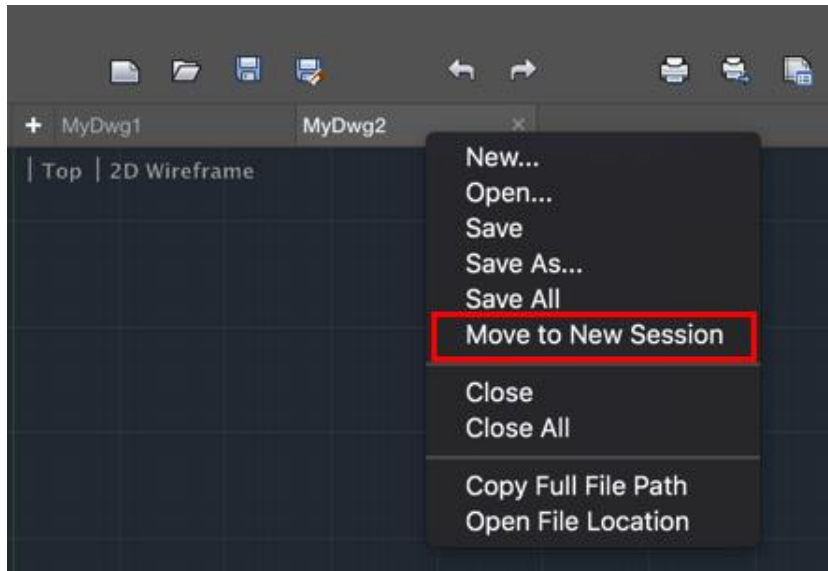

You can also right-click on the AutoCAD launch icon and select New AutoCAD Session.

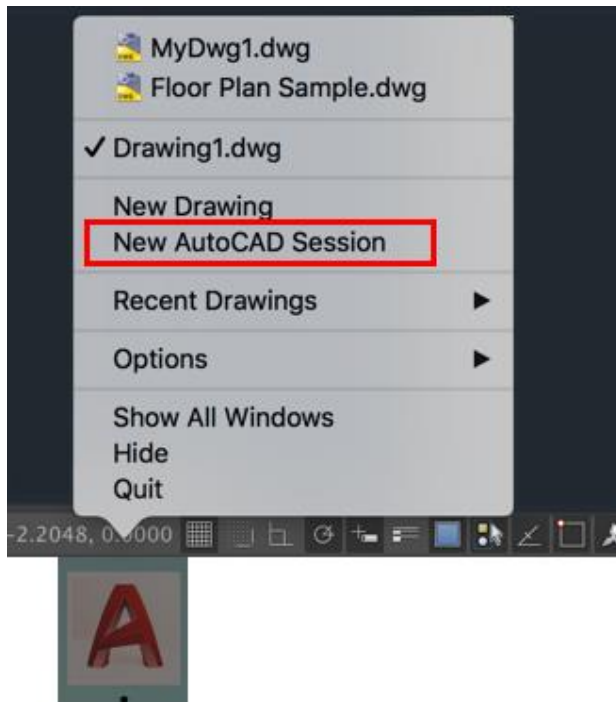

You can then arrange the sessions so you can see the drawings side by side.

Full Screen

AutoCAD 2017 for Mac now supports OSX native Full Screen mode. You can switch to and from Full Screen using these methods:

- **Command+0** or **Command+Ctrl+F**
- The Full Screen button in the top left of the drawing window



To use the split view with AutoCAD, hold the Full Screen button and drag AutoCAD 2017 for Mac to the right or left side of the screen.

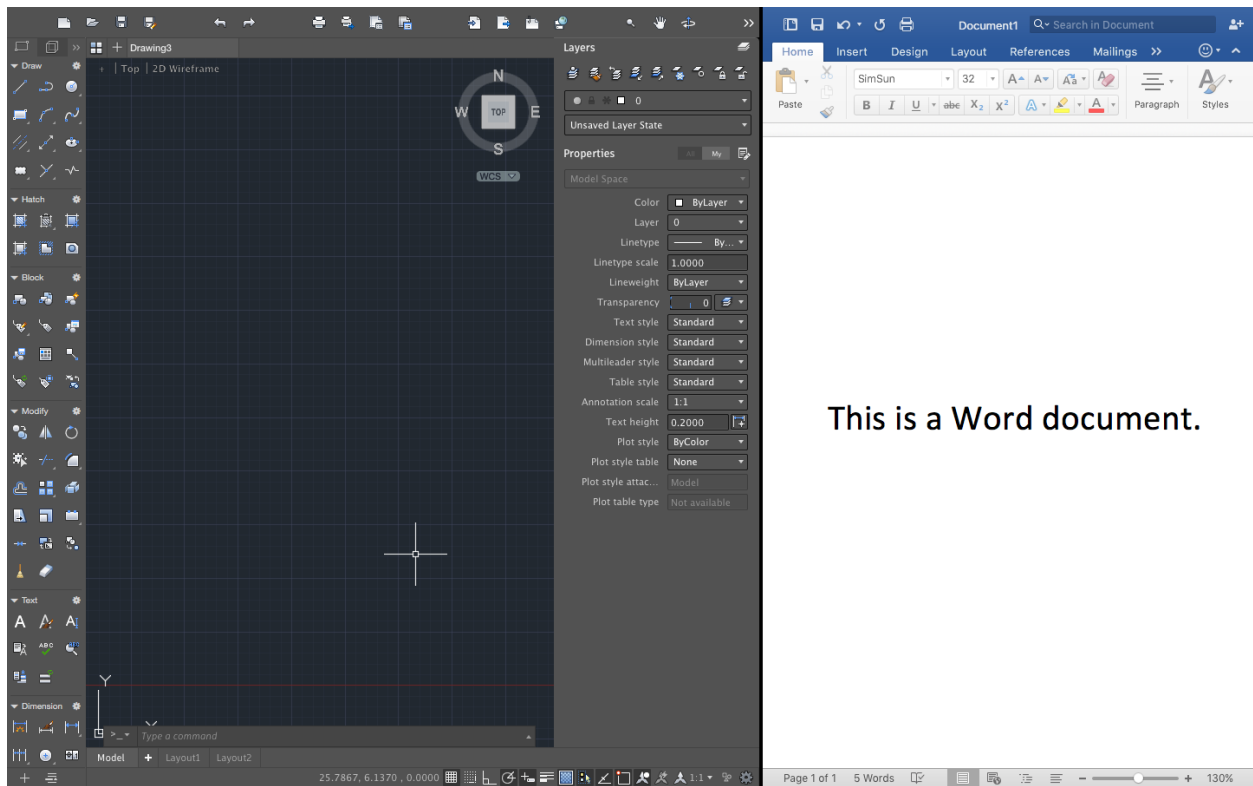

License Manager

AutoCAD 2017 for Mac introduces a new License Manager making it easier to change between license types and save your work when a network license loses connection with the License Manager.

You no longer choose your license type and enter a serial number during the install process. Instead, you select it when you first launch AutoCAD. You choose between standalone (Enter a Serial Number) and network (Use a Network License).

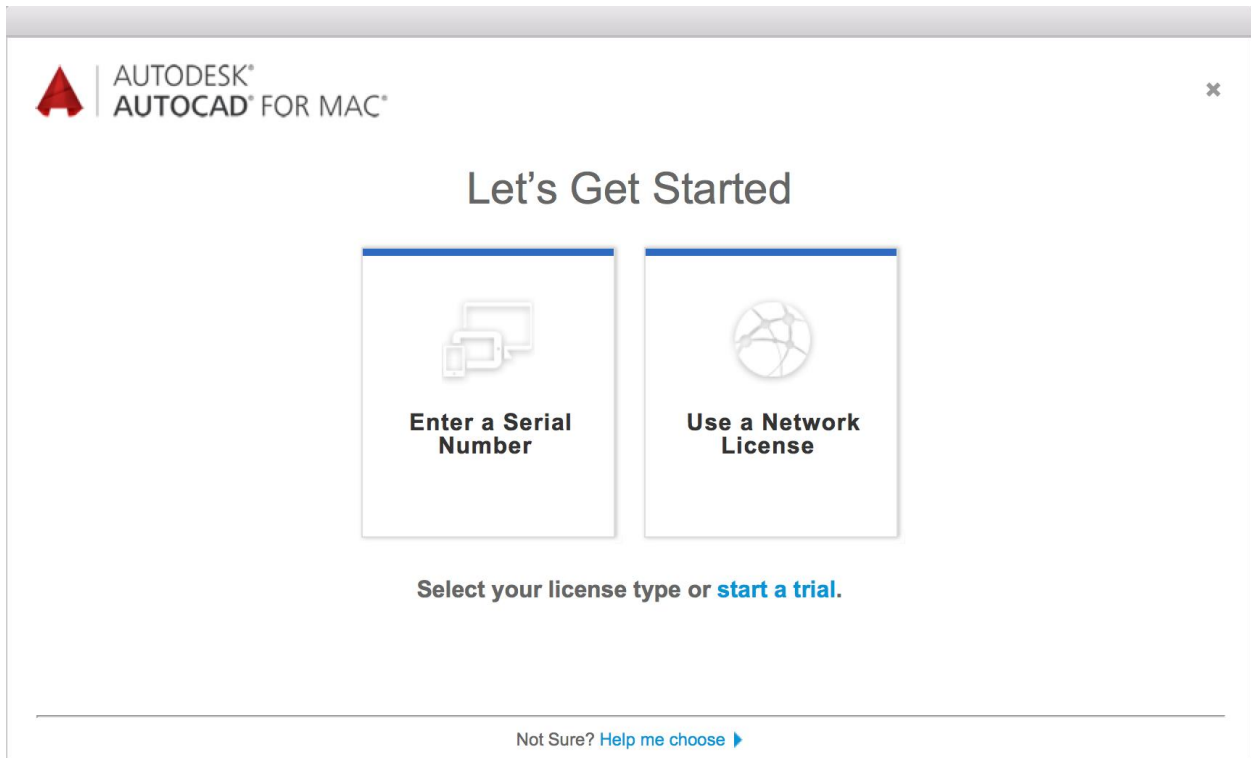

A button in the About box provides access to the License Manager where you can view information about the software license and installed Plug-ins, Add-ons, and Extensions. You can also change the type of license. For example, you can change from a network license or standalone (serial number) to another license type.

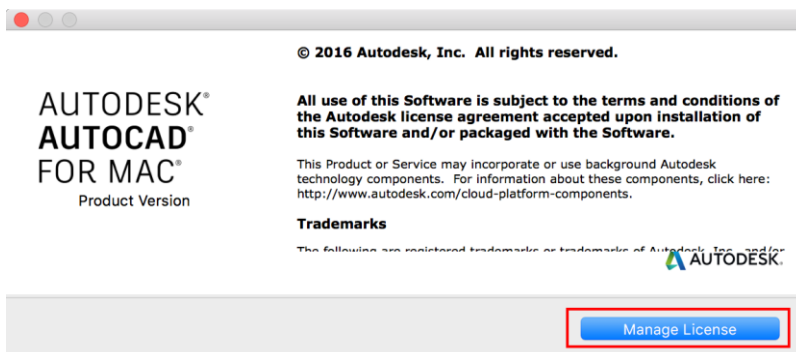

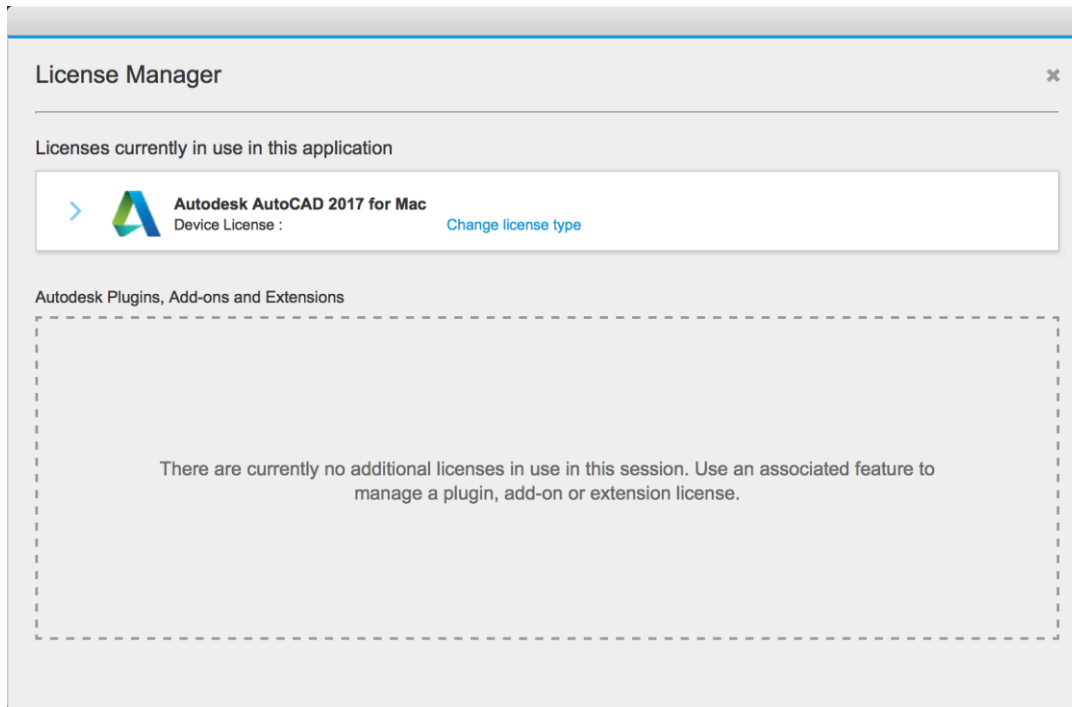

If you are using a network license and you lose your connection to the license server, a message is displayed indicating that the connection was lost. In the message, you can choose to have AutoCAD save your drawings and then shut down, or, while time is still available, you can go back to AutoCAD to manually save your work. The timer to automatically shut down AutoCAD doesn't start until you dismiss the message.

Autodesk Account Sign-In

Sign in to your Autodesk account in the upper-right corner of the application window.

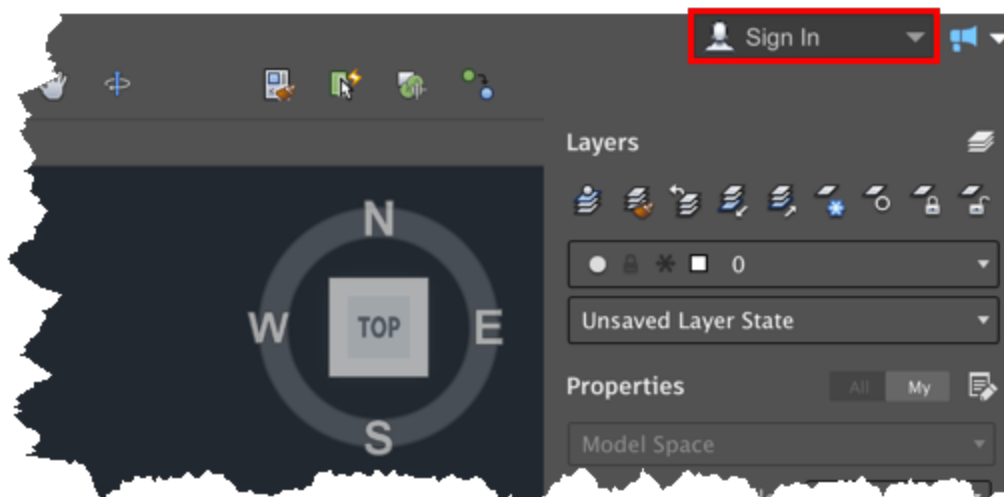

Once in your account you can:

- Manage your license and purchase options.
- View Autodesk account details in the AutoCAD Preferences dialog.
- Launch the A360 Desktop App to sync files in the cloud.

2D Graphics

The appearance, selection, and performance of 2D geometry continues to improve in AutoCAD 2017 for Mac.

In previous releases of AutoCAD, the preview of objects as they were being created, moved, or copied, could appear jagged.

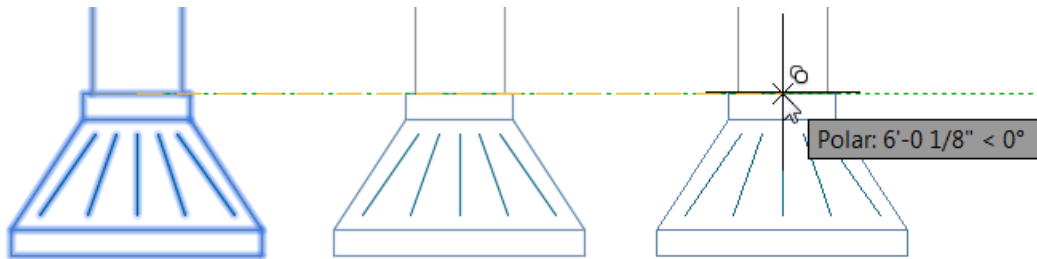

In AutoCAD 2017 for Mac, line smoothing is supported during the preview of the just as they will appear after the operation is completed.

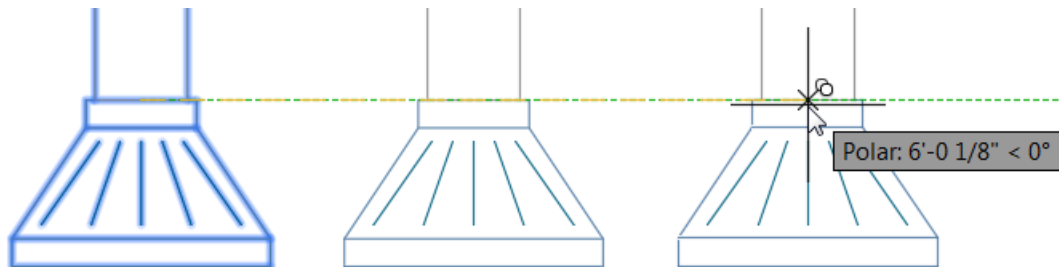

In previous releases of AutoCAD, lines with DOT linetypes could be difficult to see even with lineweights applied. AutoCAD 2017 for Mac supports the lineweight display of DOT linetypes as shown.



In addition, linetypes with dash and dot combinations display round dots, unlike previous releases that represented dots with very short dashes.



This also results in a more accurate display of selection highlighting.

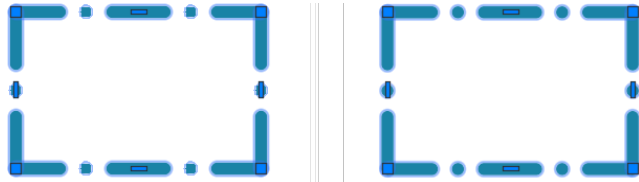

Delete Key

A message now displays if you try to delete selected objects using the Delete Key when the PICKFIRST system variable is set to zero.

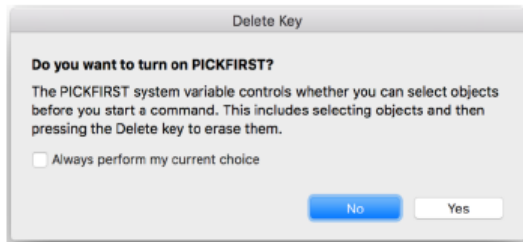

You can avoid displaying the message in the future by selecting the option to always perform your current choice. You can turn all hidden messages back on in the preferences.

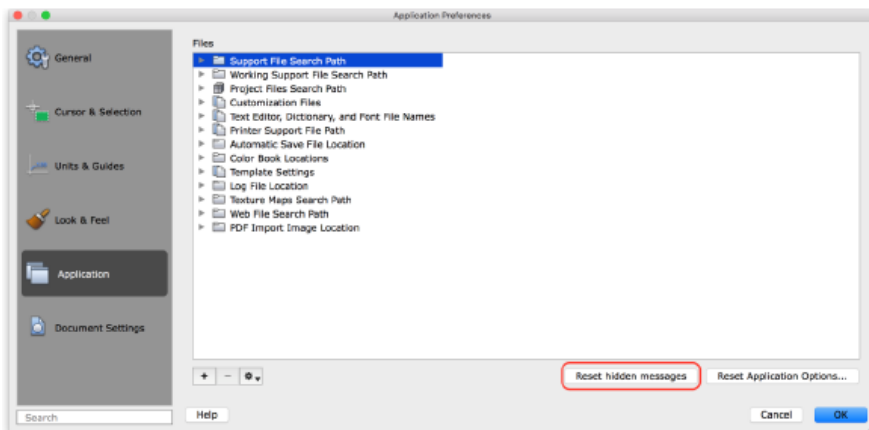

Hatch Layer

The HPLAYER system variable has been expanded to allow you to specify a non-existing layer and set it as default for new hatches and fills.

TEXTEDIT Command

The TEXTEDIT command includes a new Mode option (TEXTEDITMODE system variable) to enable you to edit multiple text objects without having to restart the command. When the Multiple option is selected, TEXTEDIT repeats, which enables you to continue selecting text objects for editing. An Undo option within Multiple mode lets you undo previous editing operations.

Rendering

Rendering is no longer available in AutoCAD 2017 for Mac. The A360 online rendering service is available using the RENDERONLINE command.

Offline Help

Offline Help is no longer part of the installation. This decreases the size of the install package making it quicker to download. Offline Help will be available to install separately but is not available for AutoCAD 2017 for Mac.