

Automotive Data Solutions Inc.

INSTALL GUIDE

ADS-TB-CH6

CH6

AVAILABLE FOR: ADS-TB

Doc. No.: ##7984##

CHRYSLER

Jeep

 DODGE

NOTICE: The manufacturer will accept no responsibility for any electrical damage resulting from improper installation of this product, be that either damage to the vehicle itself or to the installed device. This device must be installed by a certified technician. This guide has been written for properly trained technicians; a certain level of skill & knowledge is therefore assumed. Please review the Installation Guide carefully before beginning any work.

ADS-TB-CH6

Doc. No.: ##7984## 20110914

INSTALL TYPE SELECTION

MAKE	MODEL	YEAR	INSTALL TYPE	DATA IMMOBILIZER BYPASS	DATA/MUX STARTER CTRL
CHRYSLER	300M	99-04	1	•	
	Concorde	99-04	1	•	
	LHS	99-01	1	•	
	Neon	00-05	1	•	
	Pacifica	04-08	1	•	•
	PT Cruiser	01-05	1	•	
	Sebring Sedan/Convertible	01-06	1	•	
	Town & Country	01-03	2	•	
	Town & Country	04-07	1	•	•
	Voyager	01-03	2	•	
DODGE	Caravan/Grand Caravan	01-03	2	•	
	Caravan/Grand Caravan	04-07	1	•	•
	Dakota	01-04	1	•	
	Durango	01-03	1	•	
	Intrepid	99-04	1	•	
	Ram Pickup	02-05	1	•	
	SRT 4	03-05	1	•	
	Stratus Sedan	01-06	1	•	
	SX 2.0	03-05	1	•	
JEEP	Grand Cherokee	99-04	1	•	
	Liberty	02-07	1	•	
	TJ	01-06	1	•	
	Wrangler	01-06	1	•	
PLYMOUTH	Neon	00-01	1	•	

ADS-TB-CH6

Doc. No.: ##7984## 20110914

TYPE 1 - WIRE CROSS REFERENCE CHART

MAKE	MODEL	YEAR	IGNITION	J1850
			WIRE COLOR	WIRE COLOR
CHRYSLER	300M	99-04	Blue/White	Violet/Yellow
	Concorde	99-04	Blue/White	Violet/Yellow
	LHS	99-01	Blue/White	Violet/Yellow
	Neon	00-05	Blue/White	Violet/Yellow
	Pacifica	04-08	Pink/Gray	White/Violet
	PT Cruiser	01-05	Blue/Black	Violet/Yellow
	Sebring Sedan/Convertible	01-06	Blue/White	Violet/Pink
	Town & Country	01-07	Pink/White	White/Violet
	Voyager	01-03	Pink/White	White/Violet
	DODGE	Caravan/Grand Caravan	01-07	Pink/White
Dakota		01-04	LtGreen/Black	Violet/Yellow
Durango		01-03	LtGreen/Black	Violet/Yellow
Intrepid		99-04	Blue/White	Violet/Yellow
Ram Pickup		02-03	LtGreen/Black	Violet/White
Ram Pickup		04-05	Pink/Gray	White/Violet
SRT 4		03-05	Blue/White	Violet/Yellow
Stratus Sedan		01-06	Blue/White	Violet/Pink
SX 2.0		03-05	Blue/White	Violet/Yellow
JEEP	Grand Cherokee	99-04	Blue/White	Yellow/Violet or Violet/Black
	Liberty	02-04	Blue	Yellow/Violet or Violet/Black
	Liberty	05-07	Pink/LtGreen	White/Violet
	TJ	01-04	Blue	Violet/Yellow
	TJ	05-06	Pink/White	White/Violet
	Wrangler	01-04	Blue	Violet/Yellow
	Wrangler	05-06	Pink/White	White/Violet
PLYMOUTH	Neon	00-01	Blue/White	Violet/Yellow

ADS-TB-CH6

Doc. No.: ##7984## 20110914

TYPE 1 - WIRING DIAGRAM

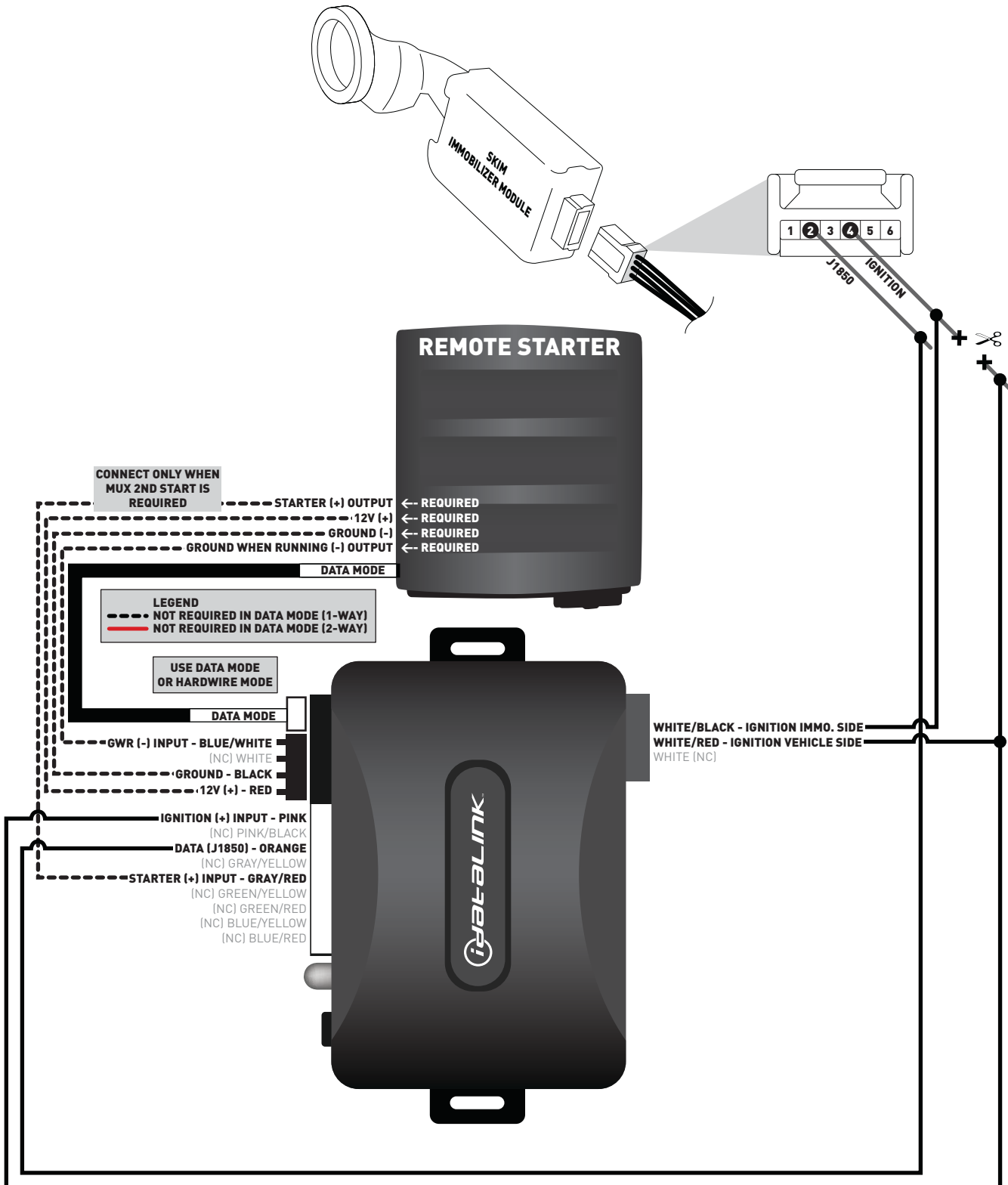

ADS-TB-CH6

Doc. No.: ##7984## 20110914

TYPE 2 - WIRING DIAGRAM

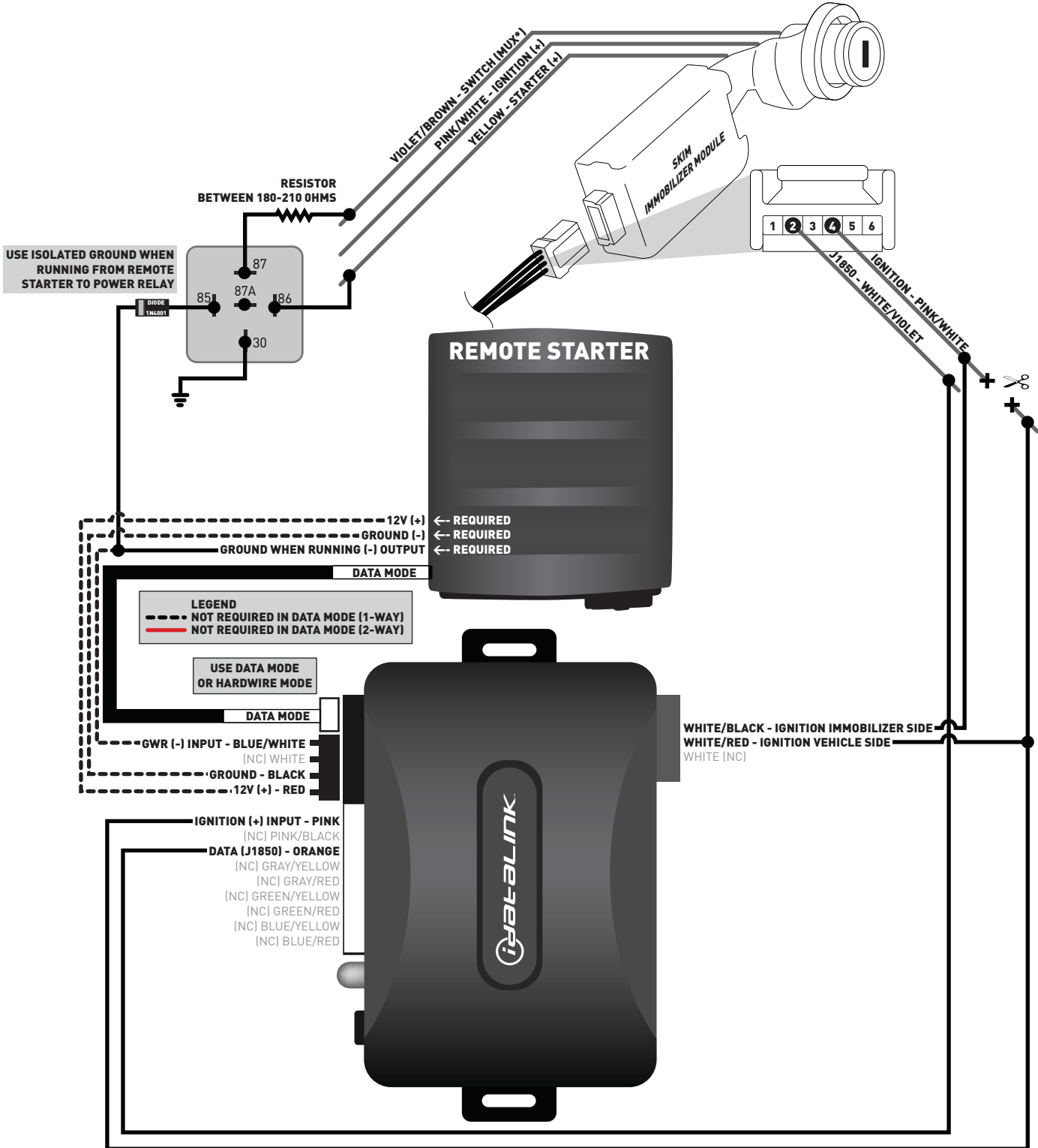



ADS-TB-CH6

Doc. No.: ##7984## 20110914

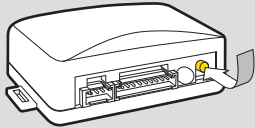
INSTALLATION MODE SELECTION

1  Press and release programming button to select installation mode.

 LED flashes (1X) once = DATA MODE
 LED flashes (2X) twice = STANDARD HARDWIRE MODE

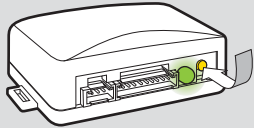
2  Press and hold programming button until LED turns solid GREEN to register selection.

! After registration, follow Factory Reset Procedure to change installation mode and restart this procedure.

MODULE PROGRAMMING PROCEDURE

1  Insert key into ignition.

2  Turn key to ON position.

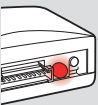
3  LED will turn solid RED.

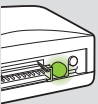
4  Wait, it may take up to **20 seconds**. LED will turn solid GREEN then will turn OFF.

5  Turn key to OFF position.

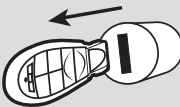
6  Remove key.

7 Module Programming Procedure completed.

ADS-TB-CH6

Doc. No.: ##7984## 20110914

IDENTIFY VEHICLE YEAR

1

Locate the Vehicle Identification Number (VIN) and identify the 10th character.



2

Match the VIN's 10th character to its corresponding year.

L → 1990	S → 1995	Y → 2000	5 → 2005	A → 2010
M → 1991	T → 1996	1 → 2001	6 → 2006	B → 2011
N → 1992	V → 1997	2 → 2002	7 → 2007	C → 2012
P → 1993	W → 1998	3 → 2003	8 → 2008	D → 2013
R → 1994	X → 1999	4 → 2004	9 → 2009	E → 2014

MODULE DIAGNOSTICS

LED STATUS	DIAGNOSTICS		
	DURING PROGRAMMING	DURING REMOTE START	WITH IGNITION OFF
Flashing RED	Missing/wrong information from firmware or vehicle	Incorrectly programmed	Incorrectly programmed or connected
Solid RED	Waiting for more vehicle information	Incorrectly programmed	Not programmed waiting for more vehicle information
Flashing GREEN	Additional steps required to complete programming	Correctly programmed and operational	False ground when running status from remote starter
Solid GREEN then OFF	Correctly programmed	Reset in progress	Reset in progress
OFF	No activity or already programmed	Invalid ground when running status from remote starter	At rest and ready for a remote start sequence

FACTORY RESET PROCEDURE

1

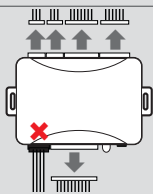

DISCONNECT all connectors from module **EXCEPT** the black 4-PIN standard or optional data connector.

2

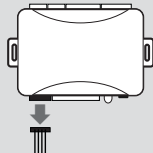

DISCONNECT black 4-PIN standard or optional data connector.

3

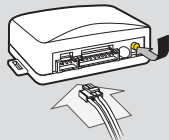

PRESS AND HOLD programming button while connecting either 4-PIN standard or optional data connector.

4

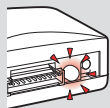

When LED flashes red, **RELEASE** programming button.

5

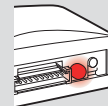

LED will turn solid red for 2 seconds.

RESET COMPLETED.

6

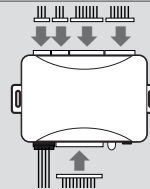

RECONNECT all connectors.

7

Repeat programming procedure.



Failure to follow procedure may result with a DTC or a CHECK ENGINE error message.