

BELIZE

NEW!

6-DAY ITINERARY
EXPLORE A VIBRANT REEF
NOW OFF UNESCO'S
ENDANGERED LIST

PLUS

EXTEND YOUR TIME
TO SEE MAYA
RUINS & MORE

ABOARD NATIONAL GEOGRAPHIC QUEST | 2019 & 2020



Lindblad
Expeditions



NATIONAL
GEOGRAPHIC™



DEAR TRAVELER,

The eastern coast of Mesoamerica is little known and rarely visited via the sea. Since the days of the ancient Maya, who flourished along this coast some 1,500 years ago, civilization has had relatively little impact. Much of the region remains genuine wilderness, with large expanses of dense tropical forest, miles of wild rivers, abundant bird life—and the largest coral reef systems in North America.

Stretched along this coast are literally hundreds of islands and atolls. No cruise lines venture here; *National Geographic Quest* is the only way to get here, and the perfect platform for exploring. Using our fleet of Zodiacs, kayaks and paddle boards, you'll have the opportunity to explore crystalline waters, and land on isolated cays, some inhabited by seabird colonies, others mere patches of sugar-white sand with a scatter of palm trees. The snorkeling is immensely satisfying, and for those who want to and are certified to scuba dive, *National Geographic Quest* is the perfect live-aboard, complete with all the gear you need. We'll discover jungle rivers, too, and mangrove lagoons—to give you the most complete sense of incredible diversity of ecosystems here.

On the human side, there's fascinating diversity as well—with Belize's dual nature as a Central American and a Caribbean country, and the fuzzy territorial distinctions between Belize and Guatemala. The region contains many cultures and languages, and a rich history—it was part of the great Maya civilization. You'll have the opportunity to explore the storied ruins of Tikal, one of the most famous and extensive of the Maya sites. And, go off the beaten track to discover beautiful Yaxhá.

As you'll see ahead, our team has developed and refined an itinerary to deliver the best of the region's natural and archaeological wonders for you—providing many great opportunities for you to see, do and learn.

I hope you will choose to join us.

All the best,



Sven-Olof Lindblad

SPECIAL OFFER:

Book by **December 31, 2018** and receive **FREE ROUND TRIP** economy group airfare between Miami / Guatemala City or save \$350 as air credit. Plus, upgrade to Business Class for just \$550. See page 13 for details.

A NATURAL SUCCESS STORY

It's an inspirational tale for anyone interested in preserving the world's natural wonders.

In 1996, the Belize Barrier Reef—the largest barrier reef system in the Northern Hemisphere—was designated a UNESCO World Heritage Site. In 2009, it was added to the List of World Heritage in Danger, largely due to the detection of coral bleaching, as well as mangrove cutting and excessive development.

No longer. This year, the Belize Barrier Reef was removed from the list of endangered world heritage sites, as UNESCO determined it no longer faced threats from development. In recent years, the Belize government placed a moratorium on oil exploration around the reef and added protections for coastal mangrove forests. And, as you'll see ahead, our expedition puts you at the heart of it—to experience the reef in all its natural splendor.



Much of Belize, in fact remains genuine wilderness, with large expanses of dense tropical forest, miles of wild rivers, and abundant bird life. The Cockscomb Basin Wildlife Sanctuary is internationally recognized as the world's first jaguar reserve. Join us to hike one of the many nature trails with our naturalists, photograph colorful tropical plants, scan the forest for

exotic birds, and be on the lookout for the tracks of deer, tapirs, wild cats and other wildlife.

Clockwise from top left: Schools of tropical fish swimming in the reef; diver exploring the vibrant coral reef, Half Moon Caye, Lighthouse Reef, Turneffe Atoll, Belize; red-footed booby.

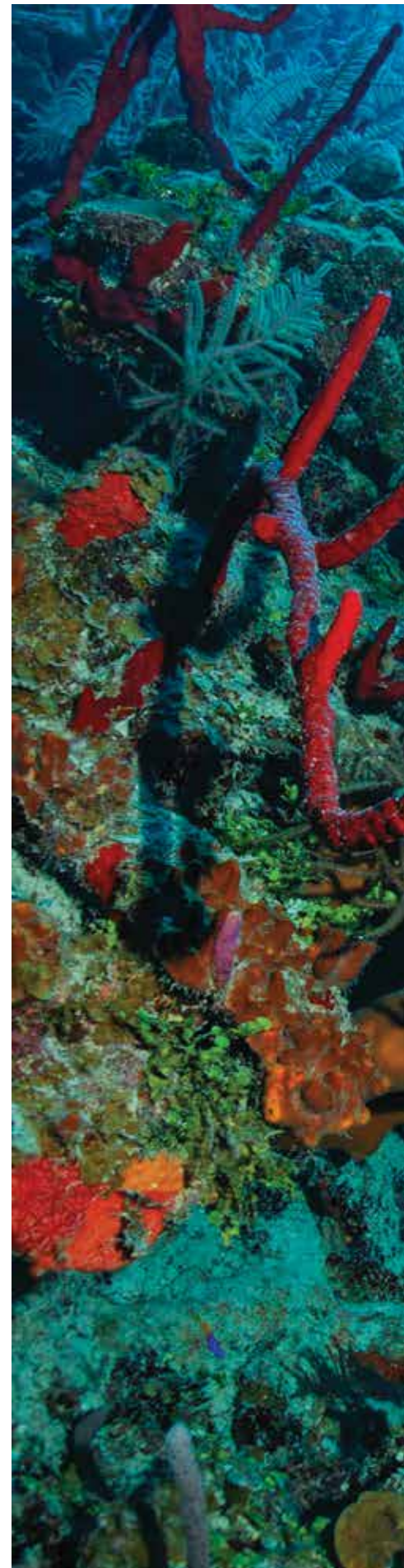



INTO THE BLUE OF BELIZE

The Belize Barrier Reef, a UNESCO World Heritage site and the largest reef system in the Northern Hemisphere, reveals hundreds of species of fish, marvelous sea turtles, graceful rays, gentle manatees, and over 90 varieties of coral. As only a small percentage of the reef has been studied, researchers believe hundreds, even thousands more species could be discovered in this protected zone.

*Right to left: Paddleboarding at sunset; scuba diver with a torch observing sea fan coral (*Gorgonia flabellum*); National Geographic Quest.*





National Geographic Quest is the only expedition ship exploring the Mesoamerican Reef, giving you otherwise impossible access to turquoise lagoons and white-sand beaches, too. And *National Geographic Quest* is equipped with a fleet of onboard tools—snorkel gear for every guest, Zodiacs, kayaks, stand-up paddleboards—so you can experience this vibrant habitat up-close, and with all your senses.

Snorkeling crystal clear waters in Half Moon Caye, Lighthouse Reef.

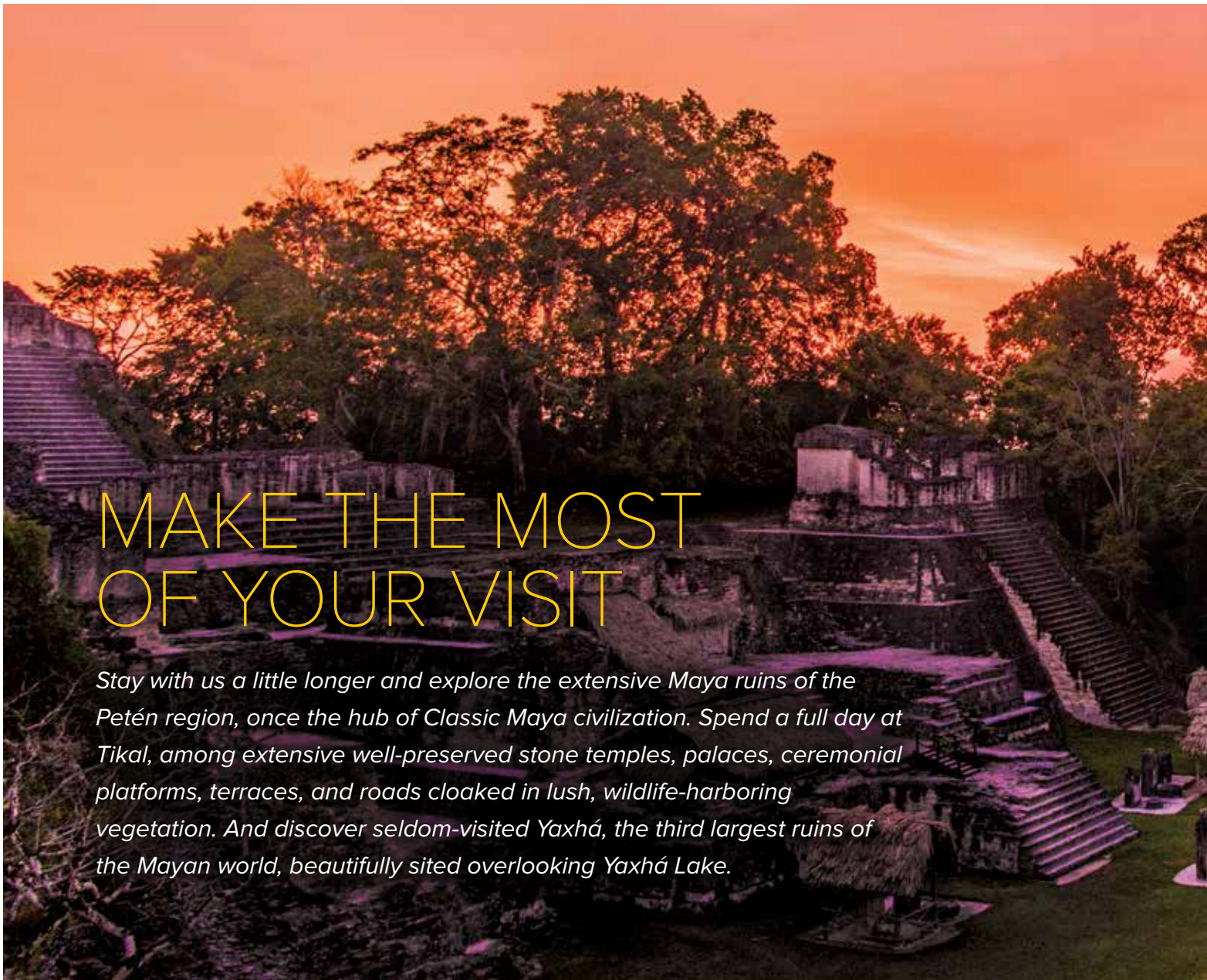

MAKE THE MOST OF YOUR VISIT

Stay with us a little longer and explore the extensive Maya ruins of the Petén region, once the hub of Classic Maya civilization. Spend a full day at Tikal, among extensive well-preserved stone temples, palaces, ceremonial platforms, terraces, and roads cloaked in lush, wildlife-harboring vegetation. And discover seldom-visited Yaxhá, the third largest ruins of the Mayan world, beautifully sited overlooking Yaxhá Lake.



Hike into the Maya Biosphere Reserve amid giant ceiba trees—the sacred tree of the Mayas—and with the help of experienced naturalists search for 400+ species of birds, howler and spider monkeys, tapirs, tree frogs and more.

Clockwise from top: Temple 1 in Tikal; aerial view of the Hotel Camino Real Tikal; gartered trogon; spider monkey





Spend three nights at the beautiful Hotel Camino Real Tikal, your home base while you explore the Maya culture and ruins. Nestled in the rain forest, enjoy the many different species of birds while on an optional bird walk with your naturalist or relax on a sunset boat ride on Petén Itza Lake.

▶ SEE WHAT YOU'LL EXPERIENCE AT [EXPEDITIONS.COM/TIKAL](https://www.expeditions.com/tikal)

A VOYAGE TO BELIZE: WILDLIFE, REEFS, AND RIVERS

6 DAYS/5 NIGHTS—ABOARD NATIONAL GEOGRAPHIC QUEST

PRICES FROM: \$3,850 to \$6,040 (See pages 10-11 for complete pricing)

Discover the tropical wonders of Belize on a voyage along the country's remote southern coast. Snorkel the colorful corals of the Belize Barrier Reef, explore the lush jungles on foot, and cruise coastal rivers in Zodiacs.

EXPEDITION OVERVIEW

- ▶ Set out from the state-of-the-art *National Geographic Quest* to kayak and paddleboard turquoise lagoons, and board Zodiacs to cruise wildlife-rich coastal rivers.
- ▶ Spot turtles, rays, and rainbow-colored fish while snorkeling or diving the coral gardens of the Belize Barrier Reef.
- ▶ Join a naturalist for a hike in Cockscomb Basin Wildlife Sanctuary, the world's first jaguar reserve.



DAY 1: DEPART US/GUATEMALA/ PUERTO BARRIOS/ EMBARK NATIONAL GEOGRAPHIC QUEST

Arrive in Guatemala City and connect with our charter flight to Puerto Barrios, where we'll embark the *National Geographic Quest*. Meals: (D)

DAY 2: MONKEY RIVER, BELIZE/LAUGHING CAYE NATIONAL PARK

Sail the southern coast of Belize to the mouth of Monkey River and board Zodiacs to cruise inland through the Belizean jungle, in search of toucans, green iguanas, and myriad bird species. This afternoon, anchor in Laughing Bird Caye National Park, home to idyllic sandy isles and a portion of the Belize barrier reef. Take to the water by snorkel, kayak, or stand-up paddleboard. For scuba divers, incredible dive opportunities abound (additional cost). (B,L,D)

DAY 3: BELIZE BARRIER REEF

Enjoy a full day to further explore the reef, second only to Australia's Great Barrier Reef in terms of biodiversity. Don a mask and fins and dive

into turquoise waters to encounter sea turtles, swirling schools of tropical fish, and harmless nurse sharks. Conditions permitting, we'll go ashore for a beach barbecue this afternoon or evening. (B,L,D)

DAY 4: COCKSCOMB BASIN WILDLIFE SANCTUARY/ MANATEE OR SITTEE RIVER

Spend the morning discovering the Cockscomb Basin Wildlife Sanctuary, the world's first jaguar reserve. Join our naturalists for a hike along one of the reserve's many nature trails to photograph tropical plants, scan the treetops for winged wonders, and spot the tracks of tapirs and jungle cats. Visit a Maya handicraft center, then cruise the mangrove forests of the Manatee or Sittée River. (B,L,D)

DAY 5: LIGHTHOUSE REEF

Sail to Lighthouse Reef and go snorkeling, paddleboarding, diving, or kayaking inside its fringing reef. The shallow lagoon is dotted with hundreds of coral patches that harbor parrotfish, butterflyfish, octopus, and other marine species. (B,L,D)



DAY 6: PUERTO SANTO TOMAS, GUATEMALA

Disembark in Puerto Santo Tomas and catch our charter flight to Guatemala City, where you'll connect with your flight home. (B)

EXPEDITION DATES:

2019 Feb. 13, 18, 23, 28; Mar. 5.

2020 Feb. 13, 18, 23, 28

EXTEND YOUR STAY AND VISIT THE RUINS OF THE MAYA WORLD

9 DAYS/8 NIGHTS—ABOARD NATIONAL GEOGRAPHIC QUEST
PRICES FROM: \$5,760 to \$9,890

Venture to the ancient Maya ruins of Tikal to explore the stories and archaeological sites of the stone temples swathed in the rain forest teeming with wildlife.

DAY 6: PUERTO SANTO TOMÁS, GUATEMALA/DISEMBARK/ FLORES

Disembark the *National Geographic Quest* this morning for our charter flight to Flores. Lunch at a picturesque restaurant overlooking Lake Petén Itzá, before transferring to the Hotel Camino Real Tikal. Check-in on arrival, then take a birdwatching walk with our naturalists or sunset boat ride on the lake. (B, L, D)



DAY 7: TIKAL NATIONAL PARK

Today is dedicated to exploring Tikal, a UNESCO World Heritage site and one of the largest and most impressive archaeological sites and urban centers of the pre-Columbian Maya civilization. Delve deep into Maya history and architecture as you explore the many temples, including Temple I, which rises 154 feet from the jungle floor. (B, L, D)

DAY 8: YAXHÁ

Visit Yaxhá, the third largest ruin in the Maya world, beautifully situated on a ridge overlooking Yaxhá Lake. One of the few Maya sites still known by its Mayan name, “green waters,” Yaxhá

is spread over nine plazas and contains hundreds of structures, dozens of stelae, multiple pyramid temples and ball courts. Stop at a traditional Guatemalan restaurant for lunch today. (B, L, D)



DAY 9: FLORES/GUATEMALA CITY/HOME

We'll end our journey in Flores. (B)

EXPEDITION DETAILS

2019 DATES: Feb. 13, 18, 23, 28; Mar. 5

SEE EVEN MORE - ADD A POST EXTENSION TO ANTIGUA, GUATEMALA

2 DAYS/2NIGHTS

\$750 per person & \$900 solo price

DAY 1: FLORES/GUATEMALA CITY/ANTIGUA

Depart on our charter flight to Guatemala City this morning. Upon arrival, join your local guide and land leader for a visit to either the National Museum of Archaeology and Ethnology or the Museum of Textiles, followed by lunch at a local restaurant. Transfer to Antigua, where you'll walk with your guide to the Monastery of La Merced, the Main Plaza, and Arco de Santa Catalina. In the late afternoon, you'll have the option to visit a jade factory and the local handicraft market. Check in to the beautiful Camino Real Antigua Hotel, located in the Colonial City within blocks of the Central Plaza, and have dinner at the hotel this evening. (B, L, D)

DAY 2: ANTIGUA

Depart this morning for a tour of a Guatemalan coffee estate. Return to Antigua for lunch at a local restaurant, followed by free time to explore Antigua's picturesque main plaza, historic buildings,

cobblestone streets and markets. Dinner this evening is a feast of traditional Guatemalan fare such as plato chapin, puyazo, salimbuco and pepian, at the Posada don Rodrigo, followed by a traditional dance performance, accompanied by live marimba music. (B, L, D)



DAY 3: ANTIGUA/GUATEMALA CITY/HOME

Transfer to Guatemala City for flights home. (B)

EXPEDITION DETAILS

2019 DATES: Feb. 18, 21, 23, 26, 28, Mar. 3, 5, 8, 10, 13



NATIONAL GEOGRAPHIC QUEST

CAPACITY: 50 cabins accommodating 100 guests.

REGISTRY: United States. **OVERALL LENGTH:** 238 feet.

The *National Geographic Quest*, launched in 2017, is designed with over 50 years of expedition heritage and built in the U.S.A, setting a new standard in exploration and comfort.

PUBLIC AREAS: Global gallery; fitness center; LEXspa; lounge with full service bar and facilities for films and presentations; observation deck; mudroom with lockers for expedition gear, and a partially covered sundeck with chairs and tables. Our “open bridge” provides guests an opportunity to meet our officers and captain and learn about navigation.

MEALS: Served in single seatings with unassigned tables for an informal atmosphere and easy mingling. Breakfast and lunch are wide selection buffets with chef action stations, while dinners are primarily served plated. Menu emphasizes local fare.

CABINS: All cabins face outside with windows or portholes, private facilities and climate controls. Category 4 cabins have step-out balconies.

EXPEDITION EQUIPMENT: A fleet of 8 Zodiacs and 24 kayaks, Remotely Operated Vehicle (ROV), hydrophone, splash-cam, underwater video camera, video microscope, paddleboards, snorkeling gear for all guests (where applicable).

SPECIAL FEATURES: Guest internet access, elevator, Lindblad-National Geographic certified photo instructor, a video chronicler, undersea specialist and a ship physician.

WELLNESS: The vessel is staffed by a Wellness Specialist and features a gym with an elliptical machine, treadmill, exercycles, handweights and resistance bands. Treatments in the LEXspa are available by appointment.



Top to bottom: National Geographic Quest; library and photo kiosk lounge, the hub of the expedition community; Lounge.



Left to right: The dining room provides views and outstanding cuisine; Category 3 cabin; Category 4 cabin with lower single beds (which can be converted to a Queen) and a private step-out balcony; select cabins connect via an inside doorway.

CATEGORY 1: Main Deck #301-306 Cabins feature two lower single beds that can convert to a Queen, a writing desk and two portholes.

CATEGORY 2: Main Deck #307-315 Cabins feature two lower single beds that can convert to a Queen, a writing desk and two portholes.

CATEGORY 3: Upper Deck #201-206 Cabins feature two lower single beds that can convert to a Queen, a writing desk and two large view windows.

CATEGORY 4: Upper Deck #207-229 Cabins feature two lower single beds that can convert to a Queen, a writing desk, sliding glass door, and small, private balcony.

CATEGORY 5 (SUITE): Observation Deck #101-108 Cabins feature two lower single beds that can convert to a Queen, large view windows, an expanded bathroom, writing desk, ample storage space, and a convertible sofa bed to accommodate a third person.

NOTE: Sole Occupancy cabins are available in Categories 1 and 2 only. Third person rates are available in Category 5 cabins at one half the double occupancy rate.

Connecting Cabins via internal doorway access: Main Deck: #312-314, #311-315, #306-308, #305-307; Upper Deck: #224-226, #225-227

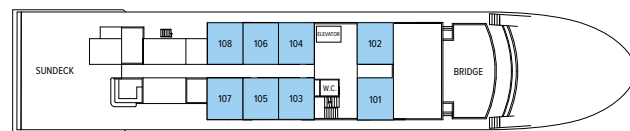

OBSERVATION DECK

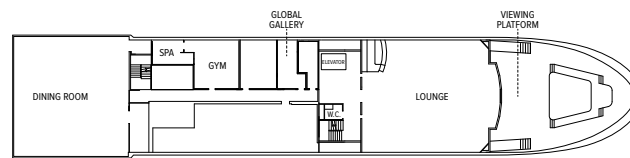

LOUNGE DECK



UPPER DECK

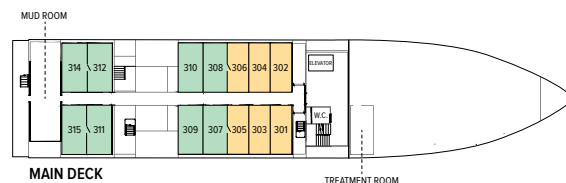

MAIN DECK

Prices are per person, double occupancy unless indicated as solo.

ITINERARY	YEAR	CAT. 1	CAT. 2	CAT. 3	CAT. 4	CAT. 5 SUITE	CAT. 1 SOLO	CAT. 2 SOLO	ADVANCE PAYMENT	NOTE
A Voyage to Belize: Wildlife, Reefs, Rivers Page 8	2019	\$3,850	\$4,110	\$4,380	\$4,630	\$5,360	\$5,650	\$6,040	\$750	Miami/Guatemala City/Miami - Economy from \$475.00; Business from \$1050.00 USD. Subject to change..
Belize to Tikal: Reefs, Rivers & Ruins of the Maya World Page 9	2019	\$5,760	\$6,180	\$6,600	\$7,030	\$8,180	\$8,640	\$9,270	\$750	Miami/Guatemala City/Miami - Economy from \$475.00; Business from \$1050.00 USD. Charter flight - Flores/Guatemala City: \$275.00. Subject to change.

OUR EXCLUSIVE SPECIALISTS ENHANCE YOUR EXPERIENCE

From marine life to wildlife and to Maya culture, our team—naturalists, undersea specialists, photography experts, even knowledgeable locals—will do whatever it takes to make sure you miss none of the marvels of the reef, rain forest and ruins. Our staff is always accessible—on deck, and during activities, cocktails, and meals.

Staff guiding guests through their snorkeling experience in the reef.

Shaylyn Potter, Undersea Specialist

The *National Geographic Quest* provides unique access to the Belize Barrier Reef, and our undersea specialist, an integral member of the expedition team, provides access to the deep for all, including those who neither snorkel nor dive. Diving with video equipment, she captures the vivid life beneath the ship for all to enjoy at engaging video presentations in the dry comfort of the ship's lounge.



David Cothran, Naturalist, Certified Photo Instructor

For many, visiting the important sites of the Maya world is a once-in-a-lifetime opportunity. And your Lindblad-National Geographic certified photo instructor will help you tell the story. He'll help you with camera settings and the basics of composition, and help you get great shots of swift-moving or elusive birds and monkeys.



Richard Hansen, National Geographic Expert

Archeologist, anthropologist and National Geographic expert Richard Hansen specializes in the early Maya and will be joining the Feb. 23, 2019 departure.



Exclusive performance

Enjoy a private concert by the internationally renowned Garifuna Collective. Visit expeditions.com/garifuna to see more!



TAKE ADVANTAGE OF OUR SPECIAL OFFERS

RECEIVE FREE ROUND-TRIP AIRFARE BETWEEN MIAMI/GUATEMALA CITY:

Book by Dec. 31, 2018 and receive Free economy group airfare from Miami/Guatemala City or a \$350 air credit. *On voyages with complimentary air offers, airfare is based on economy group flights that must be ticketed by Lindblad Expeditions. In the case that Lindblad's group or charter flights are no longer available at time of booking, we reserve the right to issue a credit. All offers are valid for new bookings only, subject to availability at the time of booking, and may not be combined with other offers and pre- and post-extensions. Call for details.*

BRINGING THE KIDS: We believe sharing an expedition with your kids or grandkids is a life-enhancing experience. So take \$500 off for each child under the age of 18.

BACK-TO-BACK SAVINGS: Save 10% on any consecutive journeys taken on board one of our expedition ships. This savings is applicable on voyage fares only, and are not valid on extensions or airfare.

TRAVELING AS A GROUP: Save 5% when traveling as a group of 8 or more people. Take advantage of these great savings, while enjoying traveling with your friends and family. This savings is applicable to voyage fares only, and is not valid on extensions or airfare. Deposit, final payments, and cancellation policies for group travel vary from our regular policies.

INCLUSIVE PRICING

We include just about everything you have the opportunity to do as part of your expedition aboard ship and ashore. The only things not included are those of a personal nature—alcohol, internet usage, tips to the crew, wellness treatments and other specialized arrangements.

ABOARD SHIP

- ✓ All meals & non-alcoholic beverages
- ✓ Cappuccinos, lattes & complimentary refillable water bottle
- ✓ 24-hour coffee, tea & soda on demand
- ✓ Hors d'oeuvres & snacks during lounge recap
- ✓ Fitness center
- ✓ Fully stocked library
- ✓ The guidance & company of our expedition staff

ASHORE

- ✓ Meals on land, as indicated in itinerary
- ✓ Special access permits, park fees, port taxes
- ✓ Transfers to & from group flights
- ✓ The expertise of our expedition staff

ACTIVITIES

- ✓ All excursions
- ✓ Zodiac & kayak explorations
- ✓ Snorkeling & paddleboarding (where indicated)
- ✓ Lectures & presentations in the lounge

Photo Credits: Steffen Binke, imagebroker, Marc Cappelletti, Richard Eaker, Eric Guth, Blend Images/Alamy, Sven-Olof Lindblad, Michael Manning, Jeff Mauritzen, John Michaels/Alamy, Norbert Probst/imagebroker, Max Seigal, Seaphotoart/Alamy, Aleksandar Todorovic, David Vargas.

RESERVATION INFORMATION

Terms & Conditions: For complete terms and conditions please visit www.expeditions.com/terms

Costs Include: Charter flights to/from Puerto Barrios (Santo Tomas), Guatemala; Five nights' accommodations aboard ship; three hotel nights in Tikal; all accommodations aboard ship or in hotels per itinerary or similar, all meals and non-alcoholic beverages aboard ship, meals on land as indicated accompanied by non-alcoholic beverages, air transportation where indicated as included, shore excursions, sightseeing and entrance fees, special access permits, transfers to and from group flights, use of kayaks, taxes and service charges, services of a ship physician and services of our expedition staff. Unused services or items included in our programs are non-refundable.

Not Included: International air transportation (unless otherwise indicated); charter flight from Flores to Guatemala City; extensions, passport, visa, immigration fees, meals not indicated, alcoholic beverages, travel protection plan, items of a personal nature, such as e-mail, voyage DVD, laundry.

Airfare: For all programs, airfare is an additional cost unless otherwise indicated. Sample airfares are subject to change. We will gladly assist in making your air arrangements for a \$50 per person service fee.

Reservations: To reserve your place, an advance payment of \$750 is required at the time of reservation.

Travel Protection Plan: We strongly recommend that you take advantage of our Travel Protection Plan. This plan offers comprehensive coverage to protect you from cancellation fees, costs incurred due to trip delays/interruption, medical assistance, and damaged or lost baggage, and provides medical assistance and evacuation during your travels. Our Travel Protection Plan is available for U.S. and Canadian residents only, and may be purchased any time prior to final payment due date. Travel Protection premiums are non-refundable once plan is purchased.

Responsibility and Other Terms & Conditions: Certain provisions concerning, among other things, limitations of Lindblad Expeditions' and the National Geographic Society's liability for loss of property, injury, illness or death during the voyage will be provided to all guests on the ship's ticket sent prior to departure, and are also available on our website at www.expeditions.com/terms, or upon request. By registering for a trip, the guest agrees to all such terms and conditions.

Note: Itineraries and prices listed in this brochure are valid as of publication date, and are subject to change. Under normal conditions, the total expedition cost is guaranteed at the time of booking. However, the published price is determined far in advance of initial departure on the basis of then-existing projections of fuel and other costs. In the event we determine that current costs create an unsustainable financial model, including but not limited to increases in the price of fuel, currency fluctuations, increases in government taxes or levies, or increased security costs, we reserve the right to pass on these costs to you, to cover such unexpected increases. We will always provide a transparent accounting of the reason for such an increase in costs.

Cancellation Policy: Cancellation penalties may apply after payment is received. Please visit www.expeditions.com/terms for complete cancellation policies.

©2018 Lindblad Expeditions

Lindblad Expeditions and the Eye are the trademarks of Lindblad Expeditions. All rights reserved.

NATIONAL GEOGRAPHIC and the Yellow Border are the trademarks of the National Geographic Society. All rights reserved.

Photo Credits: Steffen Binke, imagebroker, Marc Cappelletti, Richard Eaker, Eric Guth, Blend Images/Alamy, Sven-Olof Lindblad, Michael Manning, Jeff Mauritzen, John Michaels/Alamy, Norbert Probst/imagebroker, Max Seigal, Seaphotoart/Alamy, Aleksandar Todorovic, David Vargas.

For Reservations:

Contact your travel advisor or Lindblad Expeditions

1.800.EXPEDITION (1.800.397.3348)

Reservation Hours: Monday – Friday 9am – 10pm ET

Saturday & Sunday 10am – 5pm ET

Lindblad Expeditions, Inc., 96 Morton Street, New York, NY 10014

Phone: 212.261.9000 • Fax: 212.265.3770

email: explore@expeditions.com For additional information and online reservations, visit us on the Web: www.expeditions.com



96 Morton Street
New York, NY 10014

PRSR STD
U.S. POSTAGE
PAID
LINDBLAD
EXPEDITIONS

Account Number:



1.800.EXPEDITION | WWW.EXPEDITIONS.COM

♻️ Printed on 10% recycled content paper with soy-based inks. We recommend that you pass this along for others to enjoy or recycle.

MAY-108

FLY FREE TO FREELY EXPLORE

Book by **December 31, 2018** and receive **FREE ROUND TRIP** economy group airfare between Miami / Guatemala City. or a \$350 air credit.

