

W.A. Baum Co. Inc.

Blood Pressure Equipment Catalog

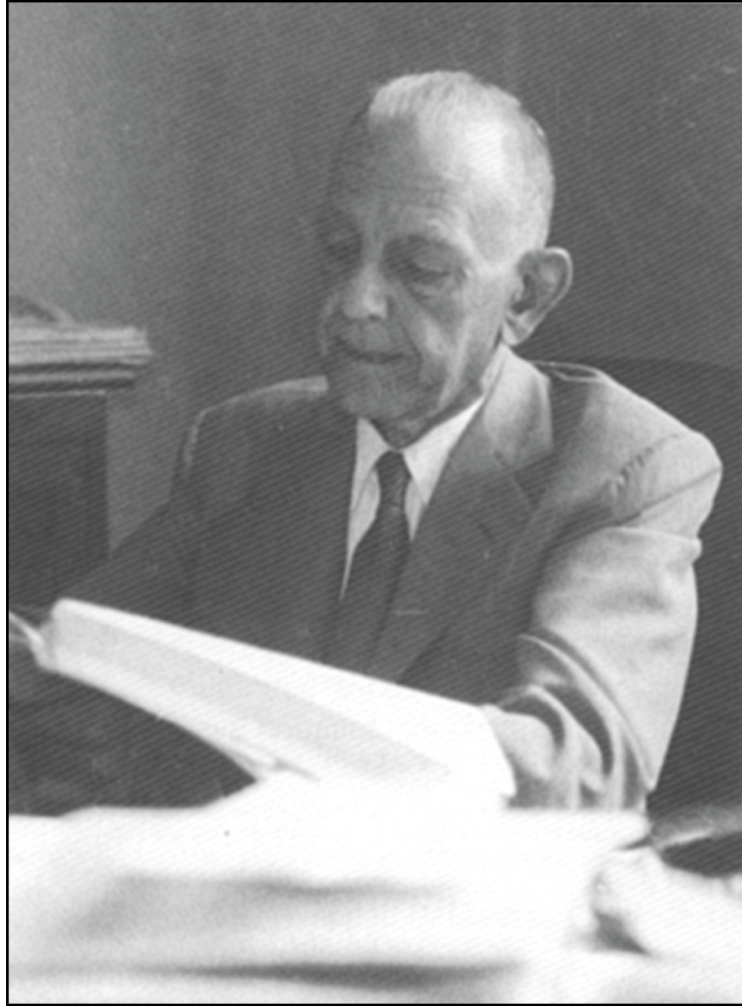

Contents	Pages
Stethoscopes	3
Portable Instruments	4
Mobile Instruments	5
Wall Mounted Instruments	6
Complete Inflation Systems	7
Inflation System Components	8 - 9
Aneroid Inflation Systems/Components	10
NIBP Monitor Cuffs and Bags	11 - 13
Accessories	14 - 15
Schematic Diagrams	15 - 17
Test Kits / Testing for Accuracy	18
Lever Lock Insertion Instructions	18
ISO & CE Certificates	19
Guarantees	20



William Anthony Baum
1890- 1964

Today's Baumanometer® instruments still function on the immutable law of gravity and are the result of continued development over the years. Cases and housings are precision diecast or extruded metal. Mylar® clad cartridge tubes are fully recessed in metal scales. These calibrated tubes have a wide bore to prevent separation of the mercury column and are held securely in protective metal housings by spring tension. A stainless steel nozzle clip in the mercury reservoir keeps mercury in place during handling and transport.

These are just a few of the hundreds of improvements made since 1916 - many of them hidden from view but all contributing to the production of instruments of unsurpassed accuracy and dependability. Reliable measurement of blood pressure depends, as it always has, on correct technique, correct cuff size and an instrument of known accuracy. We have been providing instruments of known accuracy since 1916.

W.A. Baum Co. Inc.

Stethoscopes

The Baum Sprague Rappaport Type Stethoscope



2700

- Designed to meet a wide variety of auscultatory demands.
- Built to our unique specifications.

FEATURES:

- Chrome plated zinc chestpiece and rotatable chrome plated brass binaural.
- Modular adult and pediatric diaphragms, large, medium and small bell receivers provide an extended range of auscultatory frequencies in one versatile stethoscope.
- Thick walled non-latex tubing leads directly from the chestpiece to each ear to provide improved acoustic separation.
- Includes three types of eartips.
- Tubing color is black and includes a name tag/diaphragm replacement tool.

Packaged Dimensions: 10¼" L x 5¼" W x 1⅓" H **Packaged Weight:** 0.84 lbs.

SPRAGUE RAPPAPORT TYPE STETHOSCOPE ORDERING INFORMATION:

Cat. No.	Length	Tubing Color	Chestpiece
2700	30 inches	Black	Chrome Plated Zinc

The Baum Stainless Steel Dual Head Stethoscope



2720

- Designed for general healthcare applications.
- Built to our unique specifications.
- Offers outstanding acoustics.

FEATURES:

- Precision machined stainless steel dual head chestpiece, valve stem and binaural.
- A dual binaural spring is incorporated inside the tubing to reduce bulk and weight.
- Non-chill rings are fitted to the diaphragm and the bell receivers for added patient comfort.
- Soft eartips ensure a comfortable, correct fit.
- Single lumen black non-latex tubing.
- Extra eartips and a replacement diaphragm are included.

Packaged Dimensions: 10¼" L x 5¼" W x 1⅓" H **Packaged Weight:** 0.58 lbs.

DUAL HEAD STETHOSCOPE ORDERING INFORMATION:

Cat. No.	Length	Tubing Color	Chestpiece
2720	31 inches	Black	Stainless Steel

The Baum Stainless Steel Cardiology Stethoscope



2730

- Designed for cardiology.
- Built to our unique specifications.
- Delivers superior acoustic sensitivity.

FEATURES:

- Precision machined stainless steel dual head chestpiece, valve stem and binaural.
- A dual binaural spring is incorporated inside the tubing to reduce bulk and weight.
- Non-chill rings are fitted to the diaphragm and deep cone shaped bell receivers for patient comfort.
- Soft eartips ensure a comfortable, correct fit.
- Two separate channels in one piece of black non-latex tubing.
- Extra eartips and a replacement diaphragm are included.

Packaged Dimensions: 11¾" L x 6⅓" W x 1½" H **Packaged Weight:** 0.78 lbs.

CARDIOLOGY STETHOSCOPE ORDERING INFORMATION:

Cat. No.	Length	Tubing Color	Chestpiece
2730	27 inches	Black	Stainless Steel

Portable Instruments

Baumanometer® Desk Model



0320

FEATURES:

- 300 mmHg clinical sphygmomanometer for portable use.
- Meets the American National Standard ANSI/AAMI SP-10 for accuracy and performance.
- Available with Latex or **Non-Latex** components.
- Diecast case and cover made of lightweight aluminum alloy.
- **Mylar® Clad Calibrated Glass Cartridge Tube.**

ORDERING INFORMATION:

Includes: Calibrated® V-Lok® Inflation System and 25" of Straight Tubing.

Finish: Neutral Gray textured baked enamel

Instrument Dimensions: 13½" L x 4 ¼" W x 2" H

Packaged Dimensions: 15" L x 4½" W x 2¼" H

Cuff Color: Medium Blue

Instrument Weight: 2.69 lbs.

Packaged Weight: 3.10 lbs.

Cat. No.	Non-Latex	Cuff Size	Inflation System	Calibration
● 0320	0320NL	Adult	Calibrated® V-Lok®	300 mmHg
0321	0321NL	Child/Small Adult	Calibrated® V-Lok®	300 mmHg
0322	0322NL	Infant	Calibrated® V-Lok®	300 mmHg
0323	0323NL	Newborn	Calibrated® V-Lok®	300 mmHg
0324	0324NL	Thigh	Calibrated® V-Lok®	300 mmHg
0325	0325NL	Large Arm	Calibrated® V-Lok®	300 mmHg
0333	0333NL	<i>None (with 25 inches of straight tubing only).</i>		300 mmHg

MYLAR® CLAD CALIBRATED GLASS CARTRIDGE TUBE

Safe: Several layers of clear Mylar® film have been applied to strengthen the tube and maintain its structural integrity even if the glass is broken.

Baum Desk Aneroid

FEATURES:

- Easy to read
- Convenient desk-top design
- Medical grade clinical manometer for precise blood pressure measurements
- Complies with ANSI/AAMI SP-10 for accuracy and performance (1% full scale + / - 3 mmHg)

ORDERING INFORMATION:

Includes: Calibrated® V-Lok® Inflation System, 25" of Straight Tubing and a Steel Stand.

Steel Stand Finish: Neutral Gray with non-skid base.

Packaged Dimensions: 10⅝" L x 7¼" W x 7½" D

Cuff Color: Medium Blue

Packaged Weight: 3.25 lbs.



0920

Cat. No.	Non Latex	Cuff Size	Inflation System	Calibration
● 0920	0920NL	Adult	Calibrated® V-Lok®	300 mmHg
0921	0921NL	Child/Small Adult	Calibrated® V-Lok®	300 mmHg
0922	0922NL	Infant	Calibrated® V-Lok®	300 mmHg
0923	0923NL	Newborn	Calibrated® V-Lok®	300 mmHg
0924	0924NL	Thigh	Calibrated® V-Lok®	300 mmHg
0925	0925NL	Large Arm	Calibrated® V-Lok®	300 mmHg

Baum Pocket Aneroid

FEATURES:

- Medical grade clinical sphygmomanometer.
- Diecast zinc manometer housing.
- Precision low friction movement with twin pre-seasoned phosphor-bronze diaphragm capsules.
- Complies with ANSI/AAMI SP-10 for accuracy and performance(1% full scale + / - 3 mmHg).

ORDERING INFORMATION:

Includes: Calibrated® V-Lok® Inflation System and Zippered Case.

Finish: Warm Gray textured baked enamel

Packaged Dimensions: 8½" L x 4⅞" W x 2½" H

Cuff Color: Medium Blue

Packaged Weight: 1.05 lbs.

Cat. No.	Non Latex	Cuff Size	Inflation System	Calibration	Holder
● 1050	1050NL	Adult	Calibrated® V-Lok®	300 mmHg	Zippered Case
1051	1051NL	Child/Small Adult	Calibrated® V-Lok®	300 mmHg	Zippered Case
1052	1052NL	Infant	Calibrated® V-Lok®	300 mmHg	Zippered Case
1053	1053NL	Newborn	Calibrated® V-Lok®	300 mmHg	Zippered Case
1054	1054NL	Thigh	Calibrated® V-Lok®	300 mmHg	None
1055	1055NL	Large Arm	Calibrated® V-Lok®	300 mmHg	Zippered Case



1050

Mobile Instruments

Baumanometer® Standby® Model



0250

FEATURES:

- 300 mmHg clinical sphygmomanometer for mobile use. (Calibrated at a 20° angle.)
- Meets the American National Standard ANSI/AAMI SP-10 for accuracy and performance.
- Available with Latex or **Non-Latex** components.
- Diecast aluminum body, diecast zinc oval base.
- Cast iron 4 wheel base w/ 2 1/2" diameter casters
- Integral cuff storage compartment.
- **Mylar® Clad** Calibrated Glass Cartridge Tube.

ORDERING INFORMATION:

Includes: Calibrated® V-Lok® Inflation System, 8 feet of Extendex® Tubing, Cast Iron 4 Wheel Base

Finish: Neutral Gray textured baked enamel

Packaged Dimensions: 28" L x 22" W x 5" H

Cuff Color: Medium Blue

Packaged Weight: 25.5 lbs.

Cat. No.	Non-Latex	Cuff Size	Inflation System	Cuff Holder
● 0250	0250NL	Adult	Calibrated® V-Lok®	Integrated Holder
0251	0251NL	Child/Small Adult	Calibrated® V-Lok®	Integrated Holder
0252	0252NL	Infant	Calibrated® V-Lok®	Integrated Holder
0253	0253NL	Newborn	Calibrated® V-Lok®	Integrated Holder
0254	0254NL	Thigh	Calibrated® V-Lok®	Integrated Holder
0255	0255NL	Large Arm	Calibrated® V-Lok®	Integrated Holder
0233	0233NL	<i>None (with 8ft. Extendex® Tubing and 4-Wheel Base only).</i>		

MYLAR® CLAD CALIBRATED GLASS CARTRIDGE TUBE

Safe: Several layers of clear Mylar® film have been applied to strengthen the tube and maintain its structural integrity even if the glass is broken.

Effective: Large bore tube (5 mm) prevents separation of mercury and is 25% larger than required by Federal specifications.

Durable: Cartridge tube end faces are flame-glazed to prevent chipping; ceramic graduation marks are fused to the glass for permanence. The entire tube is carefully annealed to eliminate both longitudinal and ring strain.

Guaranteed: Free replacement of the cartridge tube if it is ever broken.

CALIBRATED® V-LOK® INFLATION SYSTEM

Accurate: The Calibrated® V-Lok® system clearly indicates whether or not the correct size cuff is being used. The center of the bladder is clearly marked on the inner and outer surfaces of the cuff for correct application on either the right or left limb.

Comfortable: Cuffs conform to the shape of the limb and have no hard, stiff edges.

Durable: Baum cuffs are made of tightly woven, heat set Dacron™ polyester fabric. They are double stitched at critical points for long wear and treated with an effective anti-microbial agent.

Non-Latex: Available for those who are hypersensitive to natural rubber latex.

Guaranteed: Latex and **Non-Latex** inflation bags, bulbs and tubing are guaranteed for five years.

Baum Roll-By® Mobile Aneroid

FEATURES:

- 300 mmHg clinical sphygmomanometer for mobile use.
- Meets the American National Standard ANSI/AAMI SP-10 for accuracy and performance.
- Available with Latex or **Non-Latex** components.
- Unique, low reflection, high contrast scale and red pointer to increase visibility and reduce parallax error.
- Diecast aluminum 5-wheel base (20" dia.) with 2" hooded casters and 2 lb. cast iron weight for increased stability.
- Manometer housing is mounted at a 20° angle for ease of viewing.
- Heavy gauge machined aluminum tubing.

ORDERING INFORMATION:

Includes: Calibrated® V-Lok® Inflation System, 8 feet of Extendex® Tubing, 5 Wheel Base and Large Circular Basket

Finish: Neutral White ABS plastic

Packaged Dimensions: 22" L x 21 1/2" W x 15 1/2" H

Cuff Color: Medium Blue

Packaged Weight: 17.70 lbs.

Cat. No.	Non-Latex	Cuff Size(s)	Inflation System	Cuff Holder
● 1150	1150NL	Adult	Calibrated® V-Lok®	Large Circular Basket
1151	1151NL	Child/Small Adult	Calibrated® V-Lok®	Large Circular Basket
1152	1152NL	Infant	Calibrated® V-Lok®	Large Circular Basket
1153	1153NL	Newborn	Calibrated® V-Lok®	Large Circular Basket
1154	1154NL	Thigh	Calibrated® V-Lok®	Large Circular Basket
1155	1155NL	Large Arm	Calibrated® V-Lok®	Large Circular Basket
● 1170	1170NL	Adult, Child, and Large Arm	Calibrated® V-Lok®	Large Circular Basket
1140	1140NL	Roll-By® Manometer Only		



1150

Wall Mounted Instruments

Baumanometer® Wall Unit 33



0850

FEATURES:

- 300 mmHg swivel-type (110° arc) clinical sphygmomanometer for wall mounting.
- Meets the American National Standard ANSI/AAMI SP-10 for accuracy and performance.
- Available with Latex or **Non-Latex** components.
- Extruded aluminum alloy manometer housing with diecast zinc top and base.
- 3 convenient cuff storage options available: large basket, small basket or stainless steel wall clip.
- **Mylar® Clad Calibrated Glass Cartridge Tube.**

ORDERING INFORMATION:

Includes: Calibrated® V-Lok® Inflation System, 8 feet of Extendex® Tubing and Wall Basket.

Instrument Finish: Neutral White

Cuff Color: Medium Blue

Basket Color: Neutral White

Instrument Dimensions: 14³/₄" L x 2¹/₂" W x 3" H

Instrument Weight: 2.25 lbs.

Packaged Dimensions: 17" L x 7" W x 4" H

Packaged Weight (w/basket): 4.20 lbs.

Cat. No.	Non-Latex	Cuff Size	Inflation System	Holder
● 0850	0850NL	Adult	Calibrated® V-Lok®	Wall Basket (Powder-Coated Steel)
0851	0851NL	Child/Small Adult	Calibrated® V-Lok®	Wall Basket (Powder-Coated Steel)
0852	0852NL	Infant	Calibrated® V-Lok®	Wall Basket (Powder-Coated Steel)
0853	0853NL	Newborn	Calibrated® V-Lok®	Wall Basket (Powder-Coated Steel)
0854	0854NL	Thigh	Calibrated® V-Lok®	Wall Basket (Powder-Coated Steel)
0855	0855NL	Large Arm	Calibrated® V-Lok®	Wall Basket (Powder-Coated Steel)
0833	0833NL	None (with 8 ft. Extendex® Tubing Only).		No Wall Basket.
● 0870	0870NL	w/8ft. Extendex® Tubing, Large Storage Basket (2422) & three complete Calibrated® V-Lok® Inflation Systems (Adult, Child/Small Adult and Large Arm) packed in one carton.		

2420 Wall Basket (Powder-Coated Steel)

Dimensions: 6¹/₂" W x 7" H x 3³/₄" D

2422 Large Wall Basket (Powder-Coated Steel)

Dimensions: 9³/₄" W x 7" H x 3³/₄" D

MYLAR® CLAD CALIBRATED GLASS CARTRIDGE TUBE

Safe: Several layers of clear Mylar® film have been applied to strengthen the tube and maintain its structural integrity even if the glass is broken.

Effective: Large bore tube (5 mm) prevents separation of mercury and is 25% larger than required by Federal specifications.

Durable: Cartridge tube end faces are flame-glazed to prevent chipping; ceramic graduation marks are fused to the glass for permanence. The entire tube is carefully annealed to eliminate both longitudinal and ring strain.

Guaranteed: Free replacement of the cartridge tube if it is ever broken.

CALIBRATED® V-LOK® INFLATION SYSTEM

Accurate: The Calibrated® V-Lok® system clearly indicates whether or not the correct size cuff is being used.

The center of the bladder is clearly marked on the inner and outer surfaces of the cuff for correct application on either the right or left limb.

Comfortable: Cuffs conform to the shape of the limb and have no hard, stiff edges.

Durable: Baum cuffs are made of tightly woven, heat set Dacron™ polyester fabric. They are double stitched at critical points for long wear and treated with an effective anti-microbial agent.

Non-Latex: Available for those who are hypersensitive to natural rubber latex.

Guaranteed: Latex and **Non-Latex** inflation bags, bulbs and tubing are guaranteed for five years.

Baum Wall Aneroid

FEATURES:

- 300 mmHg swivel-type (110° arc) clinical sphygmomanometer for wall mounting.
- Meets the American National Standard ANSI/AAMI SP-10 for accuracy and performance.
- Available with Latex or **Non-Latex** components.
- Neutral White ABS plastic manometer with chrome plated steel bracket.
- Unique high contrast scale and red pointer increase visibility and reduce parallax error.
- 2 convenient cuff storage options available: large basket or small basket.

ORDERING INFORMATION:

Includes: Calibrated® V-Lok® Inflation System, 8 feet of Extendex® Tubing and Wall Basket.

Instrument Finish: Neutral White ABS Plastic

Cuff Color: Medium Blue

Basket Color: Neutral White

Instrument Dimensions: 6¹/₄" L x 6¹/₄" W x 4" H

Instrument Weight: 1.10 lbs.

Packaged Dimensions: 10⁵/₈" L x 7¹/₄" W x 7¹/₂" H

Packaged Weight: 3.25 lbs.

Cat. No.	Non-Latex	Cuff Size	Inflation System	Holder
● 0950	0950NL	Adult	Calibrated® V-Lok®	Wall Basket (Powder-Coated Steel)
0951	0951NL	Child/Small Adult	Calibrated® V-Lok®	Wall Basket (Powder-Coated Steel)
0952	0952NL	Infant	Calibrated® V-Lok®	Wall Basket (Powder-Coated Steel)
0953	0953NL	Newborn	Calibrated® V-Lok®	Wall Basket (Powder-Coated Steel)
0954	0954NL	Thigh	Calibrated® V-Lok®	Wall Basket (Powder-Coated Steel)
0955	0955NL	Large Arm	Calibrated® V-Lok®	Wall Basket (Powder-Coated Steel)
0960	0960NL	Adult	Calibrated® V-Lok®	No Wall Basket
0933	0933NL	None (with 8 ft. Extendex® Tubing Only).		No Wall Basket.
● 0970	0970NL	w/8ft. Extendex® Tubing, Large Storage Basket (2422) & three complete Calibrated® V-Lok® Inflation Systems (Adult, Child/Small Adult and Large Arm) packed in one carton.		

2420 Wall Basket (Powder-Coated Steel)

Dimensions: 6¹/₂" W x 7" H x 3³/₄" D

2422 Large Wall Basket (Powder-Coated Steel)

Dimensions: 9³/₄" W x 7" H x 3³/₄" D



0950

W.A. Baum Co. Inc.

Baum Complete Inflation Systems

Baum Calibrated® V-Lok® Inflation System

Accurate: The Calibrated® V-Lok® system clearly indicates whether or not the correct size cuff is being used. The center of the bladder is clearly marked on the inner and outer surfaces of the cuff for correct application on either the right or left limb.

Comfortable: Cuffs conform to the shape of the limb and have no hard, stiff edges.

Durable: Baum cuffs are made of tightly woven, heat set Dacron™ polyester fabric. They are double stitched at critical points for long wear and treated with an effective anti-microbial agent.

Non-Latex: Available for those who are hypersensitive to natural rubber latex.

Guaranteed: Latex and Non-Latex inflation bags, bulbs and tubing are guaranteed for five years.



1830

The Baum Bariatric Inflation System

The Baum Bariatric Inflation System is curved, easy to apply and conforms naturally to a conical limb.

The result is correct application of the cuff and even compression of the artery.

Comprises a custom-made, curved Dacron® Polyester Cuff, natural rubber Latex or Non-Latex Inflation Bag,

Large size Latex or Non-Latex Bulb and Baum Air-Flo® Control Valve.

Cat. No.

Description

1830

Bariatric Inflation System

1830NL

Bariatric Non-Latex Inflation System



46 - 66 cm

Cuff Color Options

Standard Adult Cuff Color: Medium Blue

Color Coded Cuffs: Newborn-Gray; Infant-Tan; Child-Dark Green; Adult-Medium Blue; Large Arm-Scarlet; Thigh-Dark Brown

CALIBRATED® V-LOK® INFLATION SYSTEMS ORDERING INFORMATION:

Comprises Cuff, Latex or Non-Latex Inflation Bag, Latex or Non-Latex Bulb and Air-Flo® Control Valve

Cat. No.	Non-Latex	Size	Inflation System	Limb Circumference
● 1820	1820NL	Adult	Calibrated® V-Lok®	25 cm to 35 cm
● 1821	1821NL	Child/Small Adult	Calibrated® V-Lok®	18 cm to 26 cm
1822	1822NL	Infant	Calibrated® V-Lok®	10 cm to 19 cm
1823	1823NL	Newborn	Calibrated® V-Lok®	6 cm to 11 cm
1824	1824NL	Thigh	Calibrated® V-Lok®	46 cm to 66 cm
● 1825	1825NL	Large Arm	Calibrated® V-Lok®	33 cm to 47 cm



1820

Decorated Calibrated® V-Lok® Inflation Systems

Comprises Cuff, Latex or Non-Latex Inflation Bag, Latex or Non-Latex Bulb and Air-Flo® Control Valve. The cuffs are Medium Blue in color and are available in Child and Infant Sizes *only*.

DECORATED CALIBRATED® V-LOK® INFLATION SYSTEMS ORDERING INFORMATION:

Cat. No.	Non-Latex	Size	Inflation System	Limb Circumference
1821 D	1821DNL	Child	Decorated Calibrated® V-Lok	18 cm to 26 cm
1822 D	1822DNL	Infant	Decorated Calibrated® V-Lok	10 cm to 19 cm



1821D

Calibrated® V-Lok® Inflation System Sets

Each set contains three or more complete Calibrated® V-Lok® Inflation Systems for rapid, one-step interchangeability of sizes to serve hospital needs (Hospital Set), general clinical or family practice (Clinical Set), or pediatric applications (Pediatric Set).

Packed in a snap-lock storage unit of high density polyethylene.

For use with all manual blood pressure instruments.

ORDERING INFORMATION:

Cat. No.	Non-Latex	Description	Sizes Included
1800	1800NL	Hospital Set	Adult, Child/Small Adult, Infant, Newborn, Large Arm & Thigh
1801	1801NL	Clinical Set	Infant, Child/Small Adult, Large Arm
1803	1803NL	Pediatric Set	Newborn, Infant, Child/Small Adult

Note: Custom Sets can be made up for individual requirements. Order as Cat. No. 1805 or 1805NL specifying desired Inflation System Sizes.

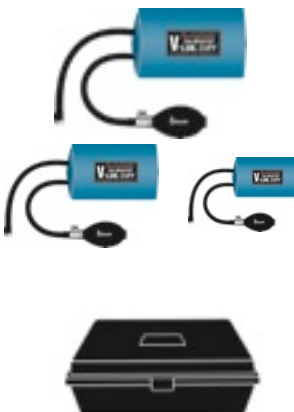

Baum Inflation System Components

Baum Bulb and Air-Flo® Control Valve

This pressure source for all sphygmomanometers consists of the Baum Latex or **Non-Latex** Bulb and Air-Flo® Control Valve.



1890

The Baum Air-Flo® Control Valve

- Instantly responsive.
- Smooth operating and long wearing.
- Conical valve seat is integral with the valve body, it cannot loosen and cause leakage.
- Valve body is solid brass, first nickel then chrome plated.
- All key interior parts are stainless steel for corrosion-free, non-stick operation.

These are just some of the features which make the Baum Air-Flo® Control Valve the standard by which others are judged.

BAUM BULB AND AIR-FLO® CONTROL VALVE ORDERING INFORMATION:

Cat. No.	Non-Latex	Description
● 1890	1890NL	Bulb and Air-Flo® Control Valve
● 1891	1891NL	Bulb only
● 1892		Air-Flo® Control Valve only



1893

Baum Large Bulb and Air-Flo® Control Valve

- Designed to inflate large inflation systems rapidly.
- Latex and **Non-Latex** bulbs are guaranteed for five years.

Caution: Do not attempt to store in Kompak or Desk Model instruments.

Ordering Information:

Cat. No.	Non-Latex	Description
1893	1893NL	Large Bulb only
1894	1894NL	Large Bulb and Air-Flo® Control Valve

Note: All Latex items are natural rubber Latex.

Inflation Bags (Double Tube)

- Available in Latex or **Non-Latex**.
- Made of smooth, soft, dipped natural rubber latex or neoprene for seamless construction.
- Anti-oxidants and anti-ozonants are added to the mixture to prevent accelerated aging.
- Latex and **Non-Latex** inflation bags are guaranteed for five years.

INFLATION BAG (DOUBLE TUBE) ORDERING INFORMATION:

Cat. No.	Non-Latex	Size	Description	Dimensions
● 1840	1840NL	Adult	Inflation Bag	12 cm x 23 cm
1841	1841NL	Child/Small Adult	Inflation Bag	9 cm x 18 cm
1842	1842NL	Infant	Inflation Bag	6 cm x 12 cm
1843	1843NL	Newborn	Inflation Bag	2.5 cm x 5 cm
1844	1844NL	Thigh	Inflation Bag	18 cm x 36 cm
1845	1845NL	Large Arm	Inflation Bag	15 cm x 33 cm

Note: All Latex items are natural rubber Latex.

Inflation Bags (Single Tube)

- Available in Latex or **Non-Latex**.
- Made of smooth, soft, dipped natural rubber latex or neoprene for seamless construction.
- Anti-oxidants and anti-ozonants are added to the mixture to prevent accelerated aging.
- Latex and **Non-Latex** inflation bags are guaranteed for five years.

INFLATION BAG (SINGLE TUBE) ORDERING INFORMATION:

Cat. No.	Non-Latex	Size	Description	Dimensions
1840SS	1840SSNL	Adult	Inflation Bag	12 cm x 23 cm
1841SS	1841SSNL	Child/Small Adult	Inflation Bag	9 cm x 18 cm
1842SS	1842SSNL	Infant	Inflation Bag	6 cm x 12 cm
1843SS	1843SSNL	Newborn	Inflation Bag	2.5 cm x 5 cm
1844SS	1844SSNL	Thigh	Inflation Bag	18 cm x 36 cm
1845SS	1845SSNL	Large Arm	Inflation Bag	15 cm x 33 cm

Note: All Latex items are natural rubber Latex.



1840



1840SS

Baum Inflation System Components

Calibrated® V-Lok® Cuff

Accurate: The Calibrated® V-Lok® system clearly indicates whether or not the correct size cuff is being used. The center of the bladder is clearly marked on the inner and outer surfaces of the cuff for correct application on either the right or left limb. Hook and loop fasteners are used to provide the optimal number of open-close cycles.

Comfortable: Cuffs conform to the shape of the limb and have no hard, stiff edges.

Durable: Baum cuffs are made of tightly woven, heat set Dacron™ polyester fabric. They are double stitched at critical points for long wear and treated with an effective anti-microbial agent.

Non-Latex: Available for those who are hypersensitive to natural rubber latex.

Guaranteed: Latex and **Non-Latex** inflation bags, bulbs and tubing are guaranteed for five years.

Cuff sizes are made to fit dimensions of corresponding size inflation bags for limb circumference shown.

Cuff Color Options

Standard Adult Cuff Color: Medium Blue

Color Coded Cuffs: Newborn-Gray; Infant-Tan; Child-Dark Green; Adult-Medium Blue; Large Arm-Scarlet; Thigh-Dark Brown

CALIBRATED® V-LOK® CUFF ORDERING INFORMATION:



1870

Cat. No.	Size	Calibrated® V-Lok®	Limb Circumference
● 1870	Adult	Cuff Only	25 cm to 35 cm
1871	Child/Small Adult	Cuff Only	18 cm to 26 cm
1872	Infant	Cuff Only	10 cm to 19 cm
1873	Newborn	Cuff Only	6 cm to 11 cm
1874	Thigh	Cuff Only	46 cm to 66 cm
1868	Large Arm	Cuff Only	33 cm to 47 cm

Decorated Calibrated® V-Lok® Cuff

ORDERING INFORMATION:



1871D

Cat. No.	Size	Calibrated® V-Lok®	Limb Circumference
1871D	Child	Decorated Cuff Only	18 cm to 26 cm
1872D	Infant	Decorated Cuff Only	10 cm to 19 cm

Calibrated® V-Lok® Cuff & Inflation Bag (Double Tube)

ORDERING INFORMATION:

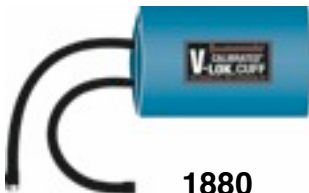

1880

Cat. No.	Non-Latex	Size	Calibrated® V-Lok®	Limb Circumference
● 1880	1880NL	Adult	Cuff and Inflation Bag	25 cm to 35 cm
1881	1881NL	Child/Small Adult	Cuff and Inflation Bag	18 cm to 26 cm
1882	1882NL	Infant	Cuff and Inflation Bag	10 cm to 19 cm
1883	1883NL	Newborn	Cuff and Inflation Bag	6 cm to 11 cm
1884	1884NL	Thigh	Cuff and Inflation Bag	46 cm to 66 cm
1869	1869NL	Large Arm	Cuff and Inflation Bag	33 cm to 47 cm

Note: All Latex items are natural rubber Latex.

Calibrated® V-Lok® Cuff & Inflation Bag (Single Tube)

ORDERING INFORMATION:



1880SS

Cat. No.	Non-Latex	Size	Calibrated® V-Lok®	Limb Circumference
1880SS	1880SSNL	Adult	Cuff and Inflation Bag	25 cm to 35 cm
1881SS	1881SSNL	Child/Small Adult	Cuff and Inflation Bag	18 cm to 26 cm
1882SS	1882SSNL	Infant	Cuff and Inflation Bag	10 cm to 19 cm
1883SS	1883SSNL	Newborn	Cuff and Inflation Bag	6 cm to 11 cm
1884SS	1884SSNL	Thigh	Cuff and Inflation Bag	46 cm to 66 cm
1869SS	1869SSNL	Large Arm	Cuff and Inflation Bag	33 cm to 47 cm

Note: All Latex items are natural rubber Latex.

Decorated Calibrated® V-Lok® Cuff & Inflation Bag

ORDERING INFORMATION:

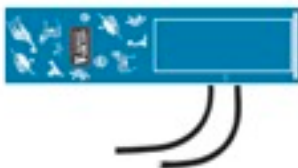

1881D

Cat. No.	Non-Latex	Size	Calibrated® V-Lok®	Limb Circumference
1881D	1881DNL	Child	Decorated Cuff & Bag	18 cm to 26 cm
1882D	1882DNL	Infant	Decorated Cuff & Bag	10 cm to 19 cm

Note: All Latex items are natural rubber Latex.

Baum Aneroid Inflation Systems/Components

Aneroid Calibrated® V-Lok® Inflation System

The Aneroid Calibrated® V-Lok® Inflation System consists of a Latex or **Non-Latex** bulb, Air-Flo® control valve, Latex or **Non-Latex** bag and Calibrated® V-Lok® Cuff.

Accurate: The Calibrated® V-Lok® system clearly indicates whether or not the correct size cuff is being used. The center of the bladder is clearly marked on the inner and outer surfaces of the cuff for correct application on either the right or left limb. Hook and loop fasteners are used to provide the optimal number of open-close cycles.

Comfortable: Cuffs conform to the shape of the limb and have no hard, stiff edges.

Durable: Baum cuffs are made of tightly woven, heat set Dacron™ polyester fabric. They are double stitched at critical points for long wear and treated with an effective anti-microbial agent.

Non-Latex: Available for those who are hypersensitive to natural rubber latex.

Guaranteed: Latex and **Non-Latex** inflation bags, bulbs and tubing are guaranteed for five years.

Aneroid cuffs available only in Medium Blue Dacron®. Cuff sizes are made to fit dimensions of corresponding size inflation bags for limb circumference shown. No connectors are included.

Note: All Latex items are natural rubber Latex.



1820AC

Aneroid Calibrated® V-Lok® Inflation System

ORDERING INFORMATION:

Cat. No.	Non-Latex	Size	Calibrated® V-Lok®	Limb Circumference
● 1820AC	1820ACNL	Adult	Aneroid Inflation System	25 cm to 35 cm
1821AC	1821ACNL	Child/Small Adult	Aneroid Inflation System	18 cm to 26 cm
1822AC	1822ACNL	Infant	Aneroid Inflation System	10 cm to 19 cm
1824AC	1824ACNL	Thigh	Aneroid Inflation System	46 cm to 66 cm
1825AC	1825ACNL	Large Arm	Aneroid Inflation System	33 cm to 47 cm



1870AC

Aneroid Calibrated® V-Lok® Cuffs

ORDERING INFORMATION:

Cat. No.	Size	Calibrated® V-Lok®	Limb Circumference
1870AC	Adult	Aneroid Cuff only	25 cm to 35 cm
1871AC	Child/Small Adult	Aneroid Cuff only	18 cm to 26 cm
1872AC	Infant	Aneroid Cuff only	10 cm to 19 cm
1874AC	Thigh	Aneroid Cuff only	46 cm to 66 cm
1868AC	Large Arm	Aneroid Cuff only	33 cm to 47 cm



1840AC

Aneroid Inflation Bags (Double Tube)

- Made of smooth, soft, dipped natural rubber latex or neoprene for seamless construction.
- Anti-oxidants and anti-ozonants are added to the mixture to prevent accelerated aging.

ORDERING INFORMATION:

Cat. No.	Non-Latex	Size	Description	Dimensions
● 1840AC	1840ACNL	Adult	Aneroid Inflation Bag	12 cm x 23 cm
1841AC	1841ACNL	Child/Small Adult	Aneroid Inflation Bag	9 cm x 18 cm
1842AC	1842ACNL	Infant	Aneroid Inflation Bag	6 cm x 12 cm
1844AC	1844ACNL	Thigh	Aneroid Inflation Bag	18 cm x 36 cm
1845AC	1845ACNL	Large Arm	Aneroid Inflation Bag	15 cm x 33 cm



1880AC

Aneroid Calibrated® V-Lok® Cuff & Bag (Double Tube)

ORDERING INFORMATION:

Cat. No.	Non-Latex	Size	Calibrated® V-Lok®	Limb Circumference
1880AC	1880ACNL	Adult	Aneroid Cuff & Inflation Bag	25 cm to 35 cm
1881AC	1881ACNL	Child/Small Adult	Aneroid Cuff & Inflation Bag	18 cm to 26 cm
1882AC	1882ACNL	Infant	Aneroid Cuff & Inflation Bag	10 cm to 19 cm
1884AC	1884ACNL	Thigh	Aneroid Cuff & Inflation Bag	46 cm to 66 cm
1869AC	1869ACNL	Large Arm	Aneroid Cuff & Inflation Bag	33 cm to 47 cm



1880SSAC

Aneroid Calibrated® V-Lok® Cuff & Bag (Single Tube)

ORDERING INFORMATION:

Cat. No.	Non-Latex	Size	Calibrated® V-Lok®	Limb Circumference
1880SSAC	1880SSACNL	Adult	Aneroid Cuff & Inflation Bag	25 cm to 35 cm
1881SSAC	1881SSACNL	Child/Small Adult	Aneroid Cuff & Inflation Bag	18 cm to 26 cm
1882SSAC	1882SSACNL	Infant	Aneroid Cuff & Inflation Bag	10 cm to 19 cm
1884SSAC	1884SSACNL	Thigh	Aneroid Cuff & Inflation Bag	46 cm to 66 cm
1869SSAC	1869SSACNL	Large Arm	Aneroid Cuff & Inflation Bag	33 cm to 47 cm

Baum NIBP Monitor Cuffs and Bags

Threaded Adapter Products

Threaded Adapters are **not** sold separately. They do **not** have a Catalog Number.

Calibrated® V-Lok® Cuff

Accurate: The Calibrated® V-Lok® cuff clearly indicates whether or not the correct size cuff is being used. The center of the bladder is clearly marked on the inner and outer surfaces of the cuff for correct application on either the right or left limb. Hook and loop fasteners are used to provide the optimal number of open-close cycles.

Comfortable: Baum cuffs conform to the shape of the limb and have no hard, stiff edges.

Durable: Baum cuffs are made of tightly woven, heat set Dacron™ polyester fabric. They are double stitched at critical points for long wear and treated with an effective anti-microbial agent.

Guaranteed: Latex and **Non-Latex** inflation bags, bulbs and tubing are guaranteed for five years.

Cuff sizes are made to fit dimensions of corresponding size inflation bags for limb circumference shown.

Standard Adult Cuff Color: Medium Blue

Color Coded Cuffs: Newborn-Gray; Infant-Tan; Child-Dark Green; Adult-Medium Blue; Large Arm-Scarlet; Thigh-Dark Brown

Inflation Bag

Seamless bags are available in Latex or **Non-Latex**. Latex bags are made of dipped natural rubber Latex. Sizes are specified by name. Dimensions are given in centimeters.

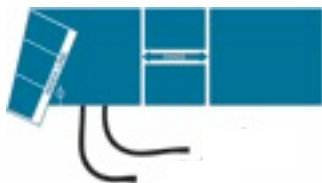

1880TA

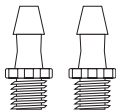

Cuff & Bag w/2 Threaded Adapters (Double Tube)

The Double Tube Threaded Adapter Series fits connectors for GE / Critikon, Dinamap and Invivo Monitors

Comprises Calibrated® V-Lok® Cuff, double tube inflation bag and 2 Threaded Adapters.

ORDERING INFORMATION:

Cat. No.	Non-Latex	Size	Calibrated® V-Lok®	Limb Circumference
1880TA	1880TANL	Adult	Cuff and Inflation Bag	25 cm to 35 cm
1881TA	1881TANL	Child/Small Adult	Cuff and Inflation Bag	18 cm to 26 cm
1882TA	1882TANL	Infant	Cuff and Inflation Bag	10 cm to 19 cm
1884TA	1884TANL	Thigh	Cuff and Inflation Bag	46 cm to 66 cm
1869TA	1869TANL	Large Arm	Cuff and Inflation Bag	33 cm to 47 cm



1880SSTA



Cuff & Bag w/1 Threaded Adapter (Single Tube)

The Single Tube Threaded Adapter Series fits connectors for Welch Allyn Atlas, Medrad & Criticare Monitors

Comprises Calibrated® V-Lok® Cuff, single tube inflation bag and 1 Threaded Adapter.

ORDERING INFORMATION:

Cat. No.	Non-Latex	Size	Calibrated® V-Lok®	Limb Circumference
1880SSTA	1880SSTANL	Adult	Cuff and Inflation Bag	25 cm to 35 cm
1881SSTA	1881SSTANL	Child/Small Adult	Cuff and Inflation Bag	18 cm to 26 cm
1882SSTA	1882SSTANL	Infant	Cuff and Inflation Bag	10 cm to 19 cm
1884SSTA	1884SSTANL	Thigh	Cuff and Inflation Bag	46 cm to 66 cm
1869SSTA	1869SSTANL	Large Arm	Cuff and Inflation Bag	33 cm to 47 cm

Baum NIBP Monitor Cuffs and Bags

Luer Lock Products

Luer Locks are **not** sold separately. They do **not** have a Catalog Number.

Calibrated® V-Lok® Cuff

Accurate: The Calibrated® V-Lok® cuff clearly indicates whether or not the correct size cuff is being used. The center of the bladder is clearly marked on the inner and outer surfaces of the cuff for correct application on either the right or left limb. Hook and loop fasteners are used to provide the optimal number of open-close cycles.

Comfortable: Baum cuffs conform to the shape of the limb and have no hard, stiff edges.

Durable: Baum cuffs are made of tightly woven, heat set Dacron™ polyester fabric. They are double stitched at critical points for long wear and treated with an effective anti-microbial agent.

Guaranteed: Latex and **Non-Latex** inflation bags, bulbs and tubing are guaranteed for five years.

Cuff sizes are made to fit dimensions of corresponding size inflation bags for limb circumference shown.

Standard Adult Cuff Color: Medium Blue

Color Coded Cuffs: Newborn-Gray; Infant-Tan; **Child**-Dark Green; **Adult**-Medium Blue; **Large Arm**-Scarlet; **Thigh**-Dark Brown

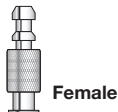
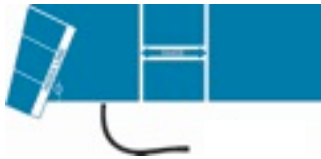

1880SSLL

Inflation Bag

Seamless bags are available in Latex or **Non-Latex**. Latex bags are made of dipped natural rubber Latex. Sizes are specified by name. Dimensions are given in centimeters.

Cuff & Bag w/1 Female Luer Lock (Single Tube)

The Single Tube Luer Lock Adapter Series fits connectors for Datascope, Colin / Mediana, Colin / Omron, B.Braun & Mennen Monitors

Comprises Calibrated V-Lok® Cuff, single tube inflation bag and 1 female Luer Lock.

ORDERING INFORMATION:

Cat. No.	Non-Latex	Size	Calibrated® V-Lok®	Limb Circumference
1880SSLL	1880SSLLNL	Adult	Cuff and Inflation Bag	25 cm to 35 cm
1881SSLL	1881SSLLNL	Child/Small Adult	Cuff and Inflation Bag	18 cm to 26 cm
1882SSLL	1882SSLLNL	Infant	Cuff and Inflation Bag	10 cm to 19 cm
1884SSLL	1884SSLLNL	Thigh	Cuff and Inflation Bag	46 cm to 66 cm
1869SSLL	1869SSLLNL	Large Arm	Cuff and Inflation Bag	33 cm to 47 cm

Rectus Type Connector Products

Rectus Connectors are **not** sold separately. They do **not** have a Catalog Number.

Calibrated® V-Lok® Cuff

Accurate: The Calibrated® V-Lok® cuff clearly indicates whether or not the correct size cuff is being used. The center of the bladder is clearly marked on the inner and outer surfaces of the cuff for correct application on either the right or left limb. Hook and loop fasteners are used to provide the optimal number of open-close cycles.

Comfortable: Baum cuffs conform to the shape of the limb and have no hard, stiff edges.

Durable: Baum cuffs are made of tightly woven, heat set Dacron™ polyester fabric. They are double stitched at critical points for long wear and treated with an effective anti-microbial agent.

Guaranteed: Latex and **Non-Latex** inflation bags, bulbs and tubing are guaranteed for five years.

Cuff sizes are made to fit dimensions of corresponding size inflation bags for limb circumference shown.

Standard Adult Cuff Color: Medium Blue

Color Coded Cuffs: Newborn-Gray; Infant-Tan; **Child**-Dark Green; **Adult**-Medium Blue; **Large Arm**-Scarlet; **Thigh**-Dark Brown

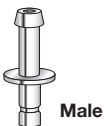

1880SSOC

Inflation Bag

Seamless bags are available in Latex or **Non-Latex**. Latex bags are made of dipped natural rubber Latex. Sizes are specified by name. Dimensions are given in centimeters.

Cuff & Inflation Bag w/1/Male Rectus Connector (Single Tube)

The Single Tube Rectus Type Adapter Series fits connectors for Mindray, HP, Agilent, Philips, Tyco-Nelcor, Siemens, Mediana, Colin, Draeger, Criticare, Mennen, Kontron, Spacelabs, Witt and Analogic monitors.

Comprises Calibrated V-Lok® Cuff, single tube inflation bag and 1 Rectus Connector.

ORDERING INFORMATION:

Cat. No.	Non-Latex	Size	Calibrated® V-Lok®	Limb Circumference
1880SSOC	1880SSOCNL	Adult	Cuff and Inflation Bag	25 cm to 35 cm
1881SSOC	1881SSOCNL	Child/Small Adult	Cuff and Inflation Bag	18 cm to 26 cm
1882SSOC	1882SSOCNL	Infant	Cuff and Inflation Bag	10 cm to 19 cm
1884SSOC	1884SSOCNL	Thigh	Cuff and Inflation Bag	46 cm to 66 cm
1869SSOC	1869SSOCNL	Large Arm	Cuff and Inflation Bag	33 cm to 47 cm

Baum NIBP Monitor Cuffs and Bags

Colder Connector Products

Colder Connectors are **not** sold separately. They do **not** have a Catalog Number.

Calibrated® V-Lok® Cuff

Accurate: The Calibrated® V-Lok® cuff clearly indicates whether or not the correct size cuff is being used. The center of the bladder is clearly marked on the inner and outer surfaces of the cuff for correct application on either the right or left limb. Hook and loop fasteners are used to provide the optimal number of open-close cycles.

Comfortable: Baum cuffs conform to the shape of the limb and have no hard, stiff edges.

Durable: Baum cuffs are made of tightly woven, heat set Dacron™ polyester fabric. They are double stitched at critical points for long wear and treated with an effective anti-microbial agent.

Guaranteed: Latex and **Non-Latex** inflation bags, bulbs and tubing are guaranteed for five years.

Cuff sizes are made to fit dimensions of corresponding size inflation bags for limb circumference shown.

Standard Adult Cuff Color: Medium Blue

Color Coded Cuffs: Newborn-Gray; Infant-Tan; Child-Dark Green; Adult-Medium Blue; Large Arm-Scarlet; Thigh-Dark Brown

Inflation Bag

Seamless bags are available in Latex or **Non-Latex**. Latex bags are made of dipped natural rubber Latex. Sizes are specified by name. Dimensions are given in centimeters.

1880MFCC

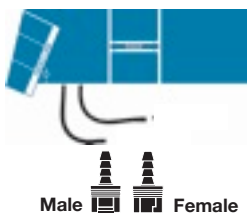

Cuff & Inflation Bag w/ 1 Male & 1 Female Colder Connector (Double Tube)

The Double Tube M/F Colder Connector Series fits connectors for GE / Datex - Ohmeda monitors.

Comprises Calibrated V-Lok® Cuff, double tube inflation bag, 1 male and 1 female Colder Connector.

Cat. No.	Non-Latex	Size	Calibrated® V-Lok®	Limb Circumference
1880MFCC	1880MFCCNL	Adult	Cuff and Inflation Bag	25 cm to 35 cm
1881MFCC	1881MFCCNL	Child/Small Adult	Cuff and Inflation Bag	18 cm to 26 cm
1882MFCC	1882MFCCNL	Infant	Cuff and Inflation Bag	10 cm to 19 cm
1884MFCC	1884MFCCNL	Thigh	Cuff and Inflation Bag	46 cm to 66 cm
1869MFCC	1869MFCCNL	Large Arm	Cuff and Inflation Bag	33 cm to 47 cm

1880FFCC

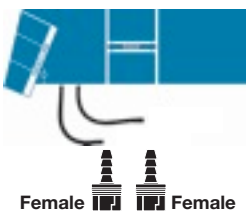

Cuff & Inflation Bag w/ 2 Female Colder Connectors (Double Tube)

The Double Tube F/F Colder Connector Series fits connectors for GE / Marquette monitors.

Comprises Calibrated V-Lok® Cuff, double tube inflation bag, and 2 female Colder Connectors.

Cat. No.	Non-Latex	Size	Calibrated® V-Lok®	Limb Circumference
1880FFCC	1880FFCCNL	Adult	Cuff and Inflation Bag	25 cm to 35 cm
1881FFCC	1881FFCCNL	Child/Small Adult	Cuff and Inflation Bag	18 cm to 26 cm
1882FFCC	1882FFCCNL	Infant	Cuff and Inflation Bag	10 cm to 19 cm
1884FFCC	1884FFCCNL	Thigh	Cuff and Inflation Bag	46 cm to 66 cm
1869FFCC	1869FFCCNL	Large Arm	Cuff and Inflation Bag	33 cm to 47 cm

1880SSCC

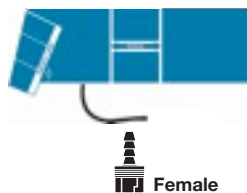

Cuff & Inflation Bag w/ 1 Female Colder Connector (Single Tube)

The Single Tube F Colder Connector Series fits connectors for Welch - Allyn / Protocol & Nonin monitors.

Comprises Calibrated V-Lok® Cuff, single tube inflation bag, and 1 female Colder Connector.

Cat. No.	Non-Latex	Size	Calibrated® V-Lok®	Limb Circumference
1880SSCC	1880SSCCNL	Adult	Cuff and Inflation Bag	25 cm to 35 cm
1881SSCC	1881SSCCNL	Child/Small Adult	Cuff and Inflation Bag	18 cm to 26 cm
1882SSCC	1882SSCCNL	Infant	Cuff and Inflation Bag	10 cm to 19 cm
1884SSCC	1884SSCCNL	Thigh	Cuff and Inflation Bag	46 cm to 66 cm
1869SSCC	1869SSCCNL	Large Arm	Cuff and Inflation Bag	33 cm to 47 cm

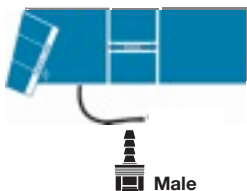

1880SSMC

Cuff & Inflation Bag w/ 1 Male Colder Connector (Single Tube)

The Single Tube M Colder Connector Series fits connectors for Nihon - Kohden monitors.

Comprises Calibrated V-Lok® Cuff, single tube inflation bag, and 1 male Colder Connector.

Cat. No.	Non-Latex	Size	Calibrated® V-Lok®	Limb Circumference
1880SSMC	1880SSMCNL	Adult	Cuff and Inflation Bag	25 cm to 35 cm
1881SSMC	1881SSMCNL	Child/Small Adult	Cuff and Inflation Bag	18 cm to 26 cm
1882SSMC	1882SSMCNL	Infant	Cuff and Inflation Bag	10 cm to 19 cm
1884SSMC	1884SSMCNL	Thigh	Cuff and Inflation Bag	46 cm to 66 cm
1869SSMC	1869SSMCNL	Large Arm	Cuff and Inflation Bag	33 cm to 47 cm

Accessories

Baumanometer® Mylar® Clad Glass Cartridge Tubes

Made to fit Baumanometer® blood pressure instruments; to order, specify by catalog number and model name. See Mylar® Clad Cartridge Tube Guarantee on page 20.



2300

ORDERING INFORMATION:

Cat. No.	Description
2100	260 mmHg for Kompak, Hi/Lo®
2200	300 mmHg for Standby®
2300	300 mmHg for Desk Model, Panel Wall Model, Wall Unit 33

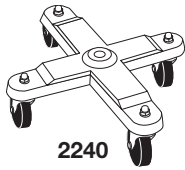

2240

Stand By® Accessories

ORDERING INFORMATION:

Cat. No.	Description
2230	Ball Handle only
2240	4-Wheel Base (with Handle & 2½" casters)
2241	One Caster w/Lock Washer and Cap Nut
2244	Set of 4 Casters (2½") for #2240



1132

Roll-By® Accessories

ORDERING INFORMATION:

Cat. No.	Description
1131	Roll-By® Replacement pole
1132	Roll-By® Basket with mounting bracket
1141	Roll-By® Manometer crystal
1142	Roll-By® Handle with mounting screws
1145	Roll-By® Base weight (2 lbs.)
1146	Roll-By® 5 wheel base assembly
1147	Roll-By® Set of five casters
1148	Roll-By® Single caster
1149	Roll-By® Large Circular Basket with mounting bracket
2904	4 inches straight tubing w/connector
2904 NL	4 inches Non-Latex straight tubing w/connector



1149



2420

Wall Instrument Accessories

Wall Baskets

Inflation System Wall Baskets are available in Neutral White (standard).

ORDERING INFORMATION:

Cat. No.	Description	Material	Size
2420	Inflation System Wall Basket	Nylon Coated Steel	6½" W x 7" H x 3¾" D
2422	Large Inflation System Basket	Nylon Coated Steel	9¾" W x 7" H x 3¾" D

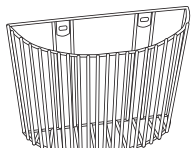

2422

Wall Clip

ORDERING INFORMATION:

Cat. No.	Description	Material	Size
2421	Inflation System Wall Clip	Stainless Steel	2⅞" W x 4" H x 2" D

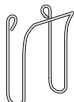

2421

Accessories



2000

Service Kit

The Baumanometer® Service Kit contains a selection of replacement cartridge tubes, small tools, a comprehensive Service Manual and an assortment of the most frequently ordered repair parts packed in a high density polyethylene case.

A Customized Service Kit can be ordered at the regular price. When ordering, please indicate the specific Baumanometer® instrument models that you have. The Kit will then contain repair parts suited to those specific instruments.

ORDERING INFORMATION:

Cat. No.	Description
2000	Baumanometer® Service Kit

Latex & Non-Latex Tubing

All tubing is available in Latex or Non-Latex. In ordering tubing for our various models, follow this guide:

Desk Model, Desk Aneroid, Kompak Model & Hi/Lo®	2 ft. straight tubing
Wall Unit 33, Wall Aneroid, Standby®, Roll-By® & Panel Wall Model	8 ft. Extendex® tubing

STRAIGHT TUBING



2911

ORDERING INFORMATION:

Cat. No.	Non-Latex	Description
2911	2911NL	Straight Tubing, per ft.
2900		Straight Tubing, 100 ft. Reel (6 or less pieces, 10 ft. min. length)
2950	2950NL	Straight Tubing, 50 ft. Reel (3 or less pieces, 10 ft. min. length)



2910

EXTENDEX® TUBING

ORDERING INFORMATION:

Cat. No.	Non-Latex	Description
2910	2910NL	Extendex® Tubing (8 ft) with connectors

Note: All Latex items are natural rubber Latex.

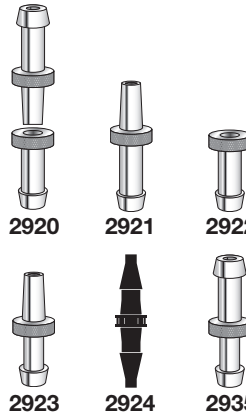

2920

2921

2922

2923

2924

2935

Connectors

ORDERING INFORMATION:

Cat. No.	Description
2920	Tubing Connectors, set (#2921 and #2922)
2921	Tubing Connector, male only
2922	Tubing Connector, female only
2923	Tubing Connector, for Extendex®, male only
2924	Straight Connector
2935	Tubing Connector, Extendex® to Straight Tubing

Schematic Diagrams

REPAIR PARTS FOR BAUM POCKET ANEROID MODEL

ORDERING INFORMATION:

Cat. No.	Description
1041	Baum Pocket Aneroid Manometer Crystal
1042	Baum Pocket Aneroid Chrome Bezel

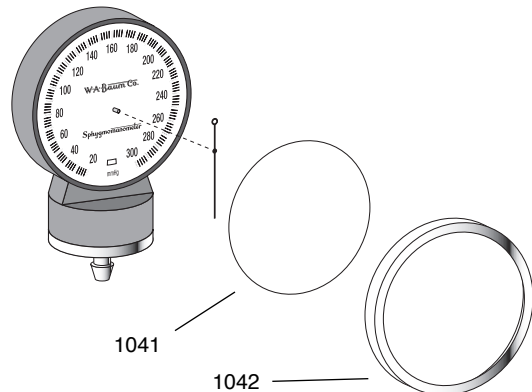

W.A. Baum Co. Inc.

Schematic Diagrams

REPAIR PARTS FOR BAUMANOMETER® DESK MODEL

ORDERING INFORMATION:

Cat. No. Description

2136	Leaf spring for lock push plate for Desk Model
2140	Knurled cap complete for Desk Model
2142	Diaphragm filter for Desk Model
2143	Leather cap washer for Desk Model
2145	Silicone rubber tube washer for Desk Model
2150	Complete reservoir and bracket assembly for Desk Model
2154	Bracket screw for Desk Model
2300	Mylar® Clad Cartridge Tube for Desk Model (300 mmHg)
2320	Cover Only for Desk Model
2330	Case Only for Desk Model
2331	Hinge Post, right hand for Desk Model
2332	Hinge Post, left hand for Desk Model
2333	Screw for hinge post for Desk Model
2334	Hinge posts, pair, with screws for Desk Model
2335	Lock push plate for Desk Model
2337	Complete lock for Desk Model
2338	"Z" Spring for cover for Desk Model
2370	Scale only for Desk Model
2430	Bulb holder for Desk Model

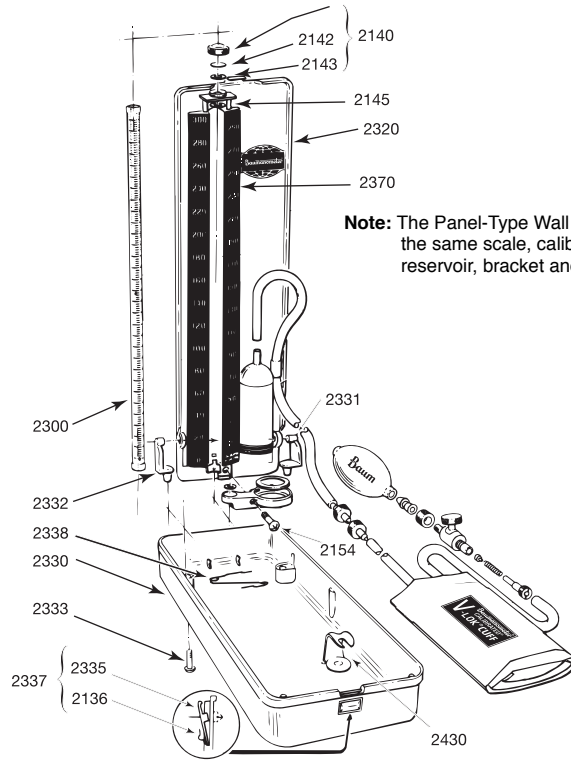

REPAIR PARTS FOR NEW STYLE BAUMANOMETER® STANDBY® MODEL

ORDERING INFORMATION:

Cat. No. Non-Latex Description

2200	Mylar® Clad Cartridge Tube for Standby® Model (300 mmHg)
2233NS	Hinge cap for Standby® Model
2242	Diaphragm filter for Standby® Model
2243	Leather cap washer for Standby® Model
2245	Silicone rubber tube washer for Standby® Model
2250	2250NL Complete reservoir for Standby® Model
2270NS	Scale only for Standby® Model
2271NS	2271NSNL Complete scale unit (includes scale unit, reservoir and calibrated tube) for Standby® Model
2272NS	Screws for scale (2) for Standby® Model
2290	Standard base only for Standby® Model
2291	Extra 3 lb. weight only for Standby® Model
2292	Tie rod (complete with hex nut, metal washer and wing nut) for Standby® Model
2295NS	Body only for Standby® Model
2296	9" spacer for Standby® Model
2840	Knurled cap complete for Standby® Model

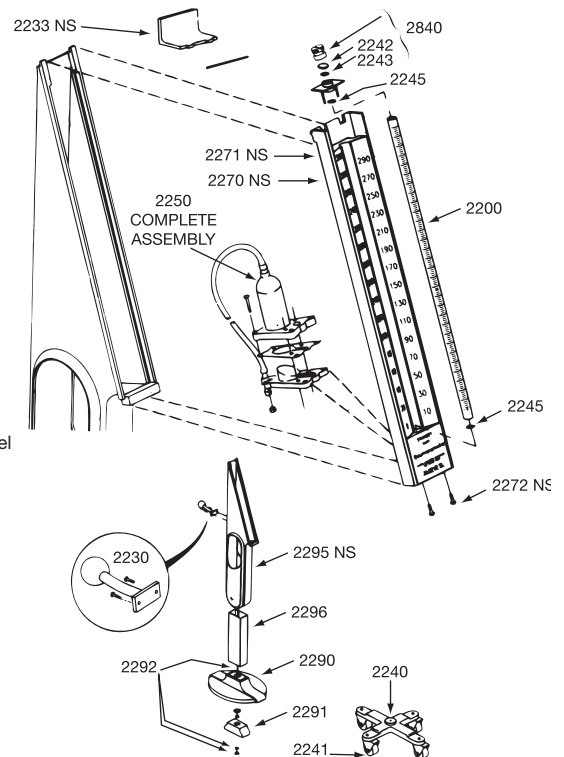

STANDBY® MODEL ACCESSORIES

2230	Ball handle for Standby® Model
2231	Ball Knob for Standby® Model
2240	4-Wheel base assembly for Standby® Model
2241	Caster for 4-wheel base with lock washer and cap nut for Standby® Model
2244	Set of 4 casters (2 1/2") for 2240 for Standby® Model

Schematic Diagrams

REPAIR PARTS FOR BAUMANOMETER® WALL UNIT 33

ORDERING INFORMATION:

Cat. No. **Non-Latex** Description

2145	Silicone rubber tube washer for Wall Unit 33
2242	Diaphragm filter for Wall Unit 33
2243	Leather cap washer for Wall Unit 33
2300	Mylar® Clad Cartridge Tube for Wall Unit 33 (300 mmHg)
2420	Inflation system wall basket
2421	Stainless steel clip type holder for inflation system
2833	Top swivel screw for Wall Unit 33
2834	Bottom swivel washer for Wall Unit 33
2836	Connector (reservoir-to-Extendex®) for Wall Unit 33
2840	Knurled cap complete for Wall Unit 33
2850	2850NL Complete reservoir for Wall Unit 33
2851	Mounting bracket with 1 top swivel screw and mounting anchors and screws for Wall Unit 33
2852	Mounting screws, pair for Wall Unit 33
2853	Mounting anchors, pair for Wall Unit 33
2854	Nylon hanging clip for Wall Unit 33
2910	2910NL Extendex® tubing, with connector

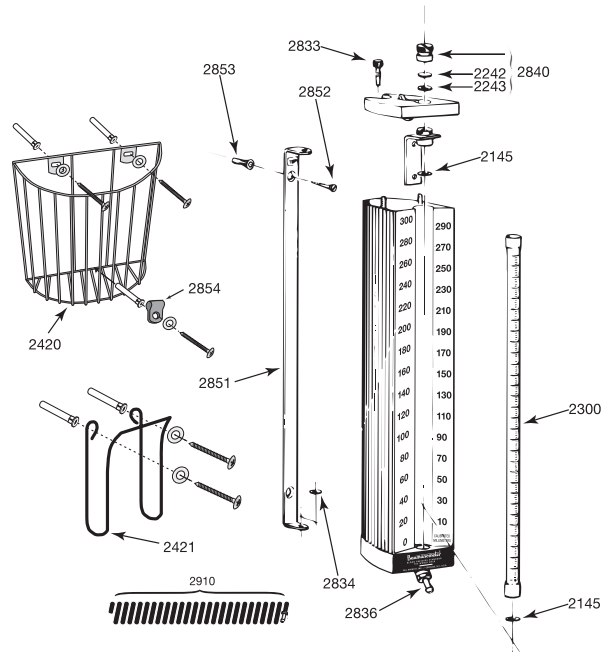

REPAIR PARTS FOR BAUM WALL ANEROID MODEL

ORDERING INFORMATION:

Cat. No. **Non-Latex** Description

0930	Baum Wall & Desk Aneroid Manometer Only
1141	Crystal for Baum Wall & Desk Aneroid
0945	Bracket for Baum Wall & Desk Aneroid
2852	Mounting Screws
2853	Wall Anchors
2910	2910NL Extendex® tubing, with connector
2904	2904NL 4 inches straight tubing w/connector

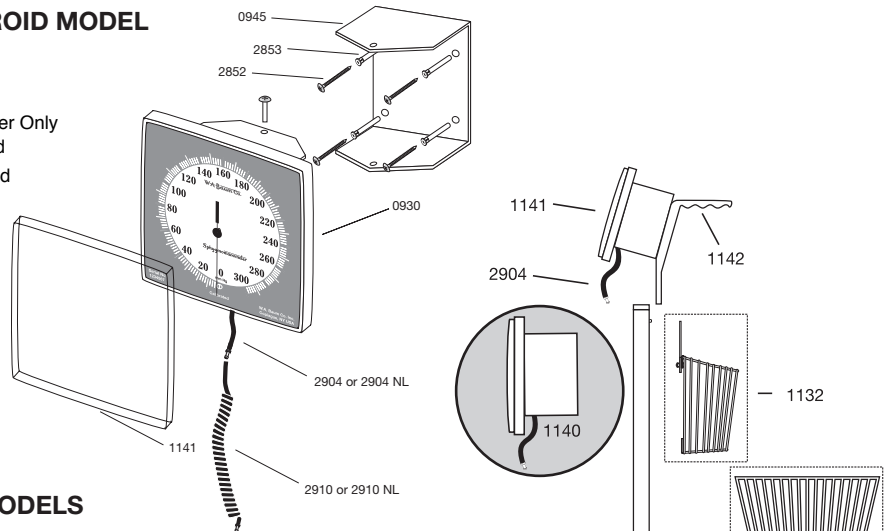

REPAIR PARTS FOR BAUM ROLL-BY MODELS

ORDERING INFORMATION:

Cat. No. **Non-Latex** Description

1131	Roll-By® Replacement Pole
1132	Roll-By® Small Basket with mounting bracket
1140	1140NL Roll-By® Manometer Only
1141	Roll-By® Manometer crystal
1142	Roll-By® Handle with mounting screws
1145	Roll-By® Base Weight (2 lbs.)
1146	Roll-By® 5 wheel base assembly
1147	Roll-By® Set of five casters
1148	Roll-By® Single Caster
1149	Roll-By® Large Circular Basket with mounting bracket
2904	2904NL 4 inches straight tubing w/connector
2910	2910NL Extendex® tubing, with connector

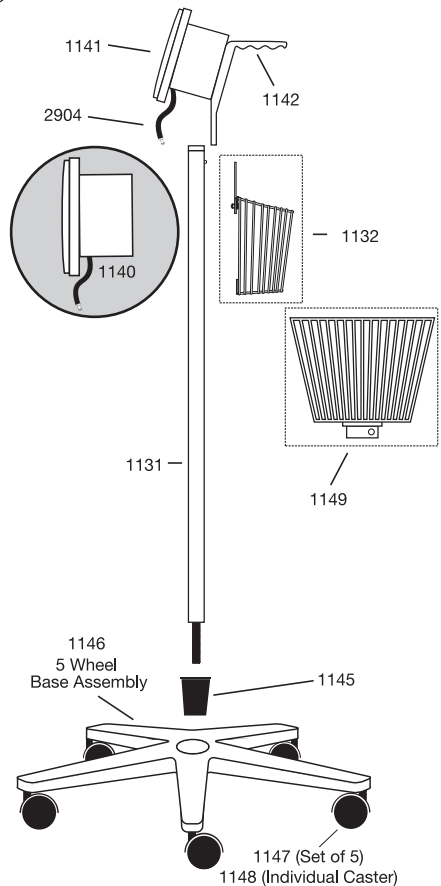

Testing for Accuracy

TESTING INSTRUMENT ACCURACY

Your goal is to test instrument accuracy, not the process of blood pressure measurement. You will need a Baumanometer® instrument (mercury-gravity standard) and a "Y" connector with an inflation bulb and valve attached (see below for Test Kit ordering information). Connect one leg to the Baumanometer® instrument and the other to the blood pressure instrument to be tested.

Note: Cuffs and Bags are not used when conducting this test.

The Pressure Standard

A Baumanometer® instrument is functioning correctly and should be used as the pressure standard if:

1. The mercury meniscus is at zero with no pressure applied to the instrument.
2. The instrument is in a vertical position. **Note:** The Standby model is calibrated at a 20° angle
3. The instrument responds promptly to pressure changes.

Any two Baumanometer® instruments, regardless of age, will provide accurate linear pressure readings at every pressure level if they meet the stated criteria for a correctly functioning manometer.

Test Procedure

Check each instrument to be sure that it is at zero. Slowly inflate the instruments to 250 mmHg and compare the readings. They should be the same, however a deviation of +/- 3 mmHg is acceptable. Repeat this procedure at 200 mmHg, 150 mmHg, 100 mmHg, 50 mmHg and 0 mmHg. If the deviation is greater than +/- 3 mmHg at any of these points, the instrument being tested is inaccurate and needs adjustment or repair.

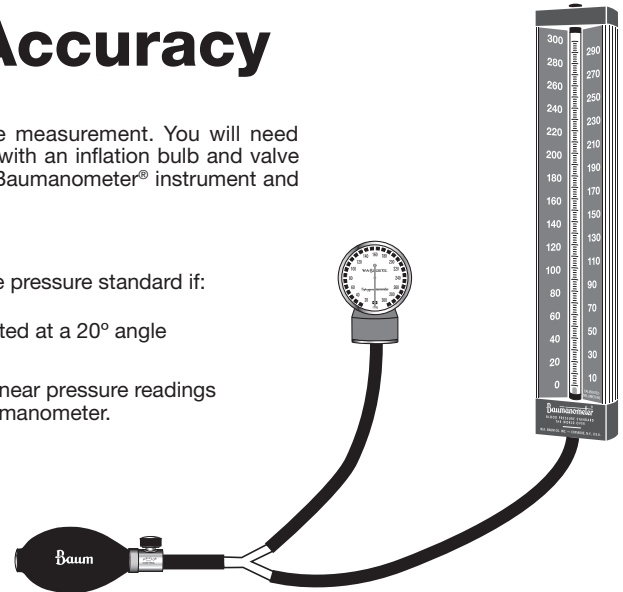

Diagram of a Wall Unit 33 connected to an aneroid with a "Y" Connector.
See below for Test Kit ordering information.

NOTES ON ANEROID DEVICES

"Remember, the mere fact that the needle points to zero on the dial of the aneroid manometer when the compression cuff is deflated does not necessarily mean that the instrument is accurate over the entire pressure range."

Primer Of Clinical Blood Pressure Measurement by George E. Burch, M.D. and Nicholas P. DePasquale, M.D.

"The readings on the dial at different pressures should check with those of a properly constructed and perfectly functioning mercury manometer. The fact that the pointer indicates zero may be no guarantee of accuracy over the whole pressure range."

American Heart Association, Recommendations for Human Blood Pressure Determinations by Sphygmomanometers.

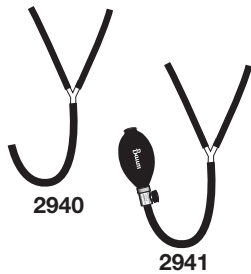

Test Kit

Calibration "Y" connector (To use your Baumanometer® instrument as a standard for pressure measurement).

ORDERING INFORMATION:

Cat. No.	Non-Latex	Description
2940	2940NL	Calibration "Y" connector with 1 ft. #2911 or #2911NL tubing on each leg
2941	2941NL	Calibration "Y" connector with 1 ft. #2911 or #2911NL tubing on each leg with #1890 or #1890NL Bulb and Air-Flo® Control Valve

Note: When used with a "Y" connector, any Baumanometer® instrument can be used to check the accuracy of any other blood pressure device.

Lever Lock Insertion Instructions

PURPOSE

To prevent tampering with the cartridge tube release lever and accidental release of mercury.

PROCEDURE

Push lever 'A' forward (toward the chrome plated cap 'B') and insert lever lock 'C' as shown in diagram.

NOTE: Additional lever locks are available free of charge.

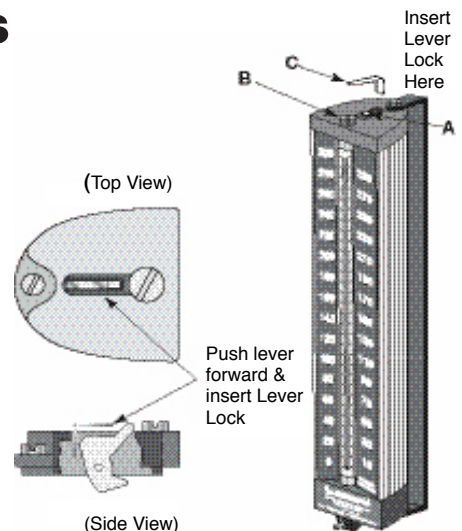

ISO & CE CERTIFICATES



 **W.A. Baum Co., Inc.**
620 Oak Street
Copiague, NY 11726
U.S.A.

EC REP **Hawksley & Sons**
Marlborough Road
Lancing, West Sussex BN15 8TN
UK

CE 0197

W.A. Baum Co. Inc.

Guarantees

Baumanometer® Instruments

Every Baumanometer® instrument is a precisely calibrated true gravity manometer. It is guaranteed to be and remain scientifically accurate. The entire apparatus is guaranteed against defects in workmanship and material for a period of one year from date of purchase. This guarantee is invalid when other than genuine Baumanometer® parts are used.

Baum Aneroid Instruments

Every Baum Aneroid instrument is guaranteed against defects in workmanship and material for a period of one year from date of purchase. This guarantee is invalid when other than genuine W.A. Baum parts are used.

We recommend that every aneroid instrument be checked for accuracy periodically by following our "Testing Instrument Accuracy" procedure to determine if it needs adjustment. Adjustments will be made to Baum Aneroid instruments without charge when returned, postage prepaid, unless the instrument has been damaged in shipment, tampered with or abused.

Baum Stethoscopes

Baum Stethoscopes are guaranteed against defects in workmanship and material for a period of five years from date of purchase. During the guarantee period, stethoscope repair or replacement will be made without charge when returned, postage prepaid, unless it has been damaged in shipment, tampered with or abused.

Mylar® Clad Calibrated Cartridge Tube

We guarantee the free replacement of the Calibrated Cartridge Tube if it is ever broken.

Bags, Bulbs & Tubing

Latex and **Non-Latex** inflation bags, bulbs and tubing are guaranteed for five years.

Baumanometer, Standby, V-Lok, Extendex, Calibrated, Hi/Lo, Roll-By and Air-Flo are registered trademarks of W.A. Baum Co., Inc.

W.A. Baum Co., Inc.
620 Oak Street
Copiague, NY 11726 USA
www.wabaum.com

Toll Free: 1-888-281-6061
Tel: 631-226-3940
Fax: 631-226-3969
Email: info@wabaum.com



W.A. Baum Co., Inc.
620 Oak Street
Copiague, NY 11726
U.S.A.



Hawksley & Sons
Marlborough Road
Lancing, West Sussex BN15 8TN
UK

CE 0197

W.A. Baum Co. Inc.