

ENERGIZE  
our

NEIGHBORHOODS



CITY of BOISE

# BOISE NEIGHBORHOOD INTERACTIVE

OCTOBER 14, 2017 | THE GROVE HOTEL



Image courtesy of Boise City Department of Arts and History | Welcome to Boise by Ward Hooper

## WELCOME



### MAYOR DAVID H. BIETER

Every great city is built around great neighborhoods. And great neighbors are what make great neighborhoods possible.

That's what all of you are – great neighbors. By being part of the Boise Neighborhood Interactive, you are helping us identify opportunities to align resources, make measurable change and create more vibrant and connected neighborhoods. It's part of our Energize Our Neighborhoods, which is a long-term strategy for keeping Boise unique and vibrant by creating collaboration between neighbors, public and private partners, and the city.

Your work to improve your neighborhood puts you on the front lines of our efforts to make Boise the most livable city in the country.

Thank you for engaging and all you do to be a great neighbor.

Sincerely,

A handwritten signature in blue ink that reads "David Bieter". The signature is fluid and cursive, written over a white background.

Mayor

## KEYNOTE SPEAKER

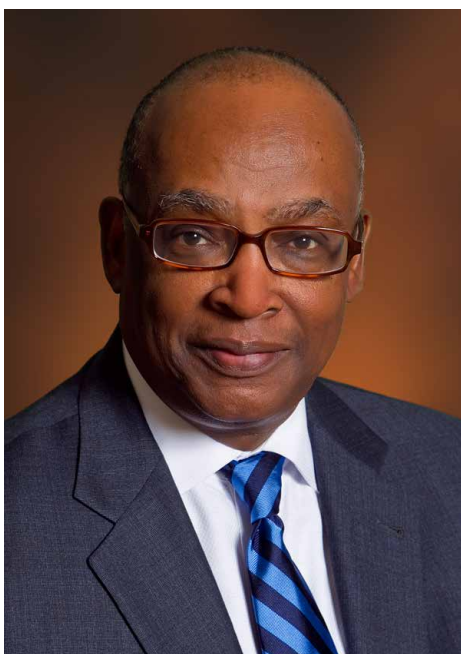

### NORMAN B. RICE

Norman B. Rice was appointed to the Casey Family Programs Board of Trustees in June 2012 and became vice chair in June 2017. He is the former president and CEO of The Seattle Foundation, one of the nation's largest community foundations. He also is former president and chief executive officer of the Federal Home Loan Bank of Seattle.

From 1990 - 1997, Rice served two terms as mayor of Seattle. He holds degrees in communications and public administration from the University of Washington and honorary doctorates from Cornish College of the Arts, Seattle University, University of Puget Sound and Whitman College.

In 2017, Rice received the Alumnus Summa Laude Dignatus Award, the highest honor bestowed upon a University of Washington graduate, recognizing a legacy of achievement and service built over a lifetime.

# CITY *of* BOISE

## BOISE NEIGHBORHOOD INTERACTIVE

### MORNING SESSION

---

8:00 – 8:30 a.m.	Registration
8:30 – 8:40 a.m.	Opening Ceremony   Boise Police Honor Guard
8:40 – 8:50 a.m.	Welcome
8:50 – 9:30 a.m.	Opening Address   Mayor Norm Rice
9:30 – 9:45 a.m.	Break
9:45 – 10:45 a.m.	Breakout Session #1
10:45 – 11:00 a.m.	Break
11:00 a.m. – 12:00 p.m.	Breakout Session #2

### LUNCH

---

12:00 – 1:00 p.m.	Lunch Buffet and Entertainment   Megan Bryant
-------------------	---

**MEGAN BRYANT** is a variety comedian, an improv instructor, and the mother of 4 young kiddos. She is the creator of Idaho Laugh Fest, Idaho's premier comedy festival, and the co-founder of Zip Zap Zop, an improv training company. Bryant is an award-winning author of the autobiography, "Not My Plan."



### AFTERNOON SESSION

---

1:15 – 2:15 p.m.	Breakout Session #3
2:15 – 2:30 p.m.	Break
2:30 – 3:30 p.m.	Breakout Session #4
3:30 – 4:00 p.m.	Event closing



## BREAK OUT SESSION 1 | 9:45-10:45 a.m.

### **BUILDING THE CITY: AN INTRODUCTION TO DEVELOPMENT IN BOISE**

---

Room: Ivy

Come learn about the development review process the City of Boise uses to guide the look, location, and types of development in the city. This session includes a discussion on the planning documents and processes used by the Planning & Development Services Department.

Panelists:

- **HAL SIMMONS** is Boise's Planning Director. He also served as Boise's Chief Comprehensive Planner. He directed the rewrite of the Boise Comprehensive Plan in 1993-96, oversaw the 2011 Comprehensive Plan rewrite and has been involved in a variety of master plan efforts.
- **LEON LETSON** is an Associate Planner with the City of Boise and a member of the Energize Our Neighborhoods management team. He is also the current President of the Idaho Chapter of the American Planning Association and has worked in planning and community development for more than 10 years.

### **WELCOME HOME: BOISE'S NEIGHBORHOOD HISTORY**

---

Room: Clearwater

Panelists will provide an overview of some of Boise's signature neighborhoods, such as the North and West Ends, Vista and Randolph-Robertson. Each neighborhood offers something unique to its residents, from historic architecture to a defining sense of place. Come learn what it means to live in one of Boise's vibrant neighborhoods and how you can discover your own neighborhood's history.

Panelists:

- **TULLY GERLACH** is a collection development librarian at the Boise Public Library. He holds a Masters of Applied Historical Research from Boise State University, and served as the City Historian from 2007-2009.
- **SARAH SCHAFFER** received her Master's Degree in Architecture from the University of Nebraska-Lincoln and has over 17 years of experience in architecture and planning. She is the manager of Design Review and Historic Preservation for the City of Boise.
- **BARBARA PERRY-BAUER** is a historian and preservationist with a passion for all things Boise. She is a founding member of TAG Historical Research and Consulting and the author of South Boise Scrapbook: A Neighborhood History.

## **GROWING YOUR COMMUNITY THROUGH VOLUNTEERS: TIPS TO RECRUIT, TRAIN AND RETAIN**

Room: Riverfork

What makes our communities special? How do we recruit and engage volunteers? Today's communities recognize the importance and impact of bringing in volunteers. In this session, we will share tips for recruiting, training and retaining volunteers through activities and discussions. Participants will walk away with an action plan, guide and project descriptions.

Panelists:

- **MIKE STEFANCIC** is the President of the Vista Neighborhood Association and the Assistant Director of the Service-Learning Program at Boise State University. As a community facilitator, he brings people together by leveraging his Master's Degree in Education to help individuals create learning experiences from their engagement with the community.
- **KIRSTIN MANN** is the Project Coordinator at Serve Idaho: The Governor's Commission on Service and Volunteerism. She was previously the AmeriCorps VISTA Leader at the Idaho Hunger Relief Task Force. Kirstin has a B.A. in Political Science from North Carolina State University and graduated with a Master's in Public Administration from Boise State University.



### **IN THE KNOW**

Sign up for the City of Boise's weekly e-newsletter. 'In the Know' features the latest news and information about services, upcoming events, important meetings and other key opportunities to be involved.

Sign up today at [CITYOFBOISE.ORG](http://CITYOFBOISE.ORG).



## **NEIGHBORHOOD RESOURCES IN RESPONSE TO CRIMINAL ACTIVITY**

Room: Whitewater

Crime and Safety are important to every neighborhood. What local resources and tools are available to assist you with your neighborhood crime and code violation issues? Our panel guests include Boise Police, Code Enforcement, and neighborhood leaders who have dealt with criminal activity including arson and graffiti. These panelists are ready to address your neighborhood crime concerns.

Panelists:

- **CAPTAIN RON WINEGAR** has been a Boise Police Department Officer since 1993, serving as Community Outreach Division Captain from 2014-2017, and Patrol Division Captain since 2017.
- **OFFICER DENA GAMBREL** started employment with the City of Boise in 2000 as a Patrol Officer and then as a Senior Department Specialist for the Neighborhood Contact Officers in the Community Outreach Division. For the last thirteen years she has been a Code Enforcement Officer with Planning & Development Services.
- **KEN JENKINS** is the Support Services/Training Manager for Ada County Juvenile Court Services, where he supports Probation and Detention officers working with troubled youth and their families. A longtime member and former Vice-President of the Idaho Crime Prevention Association (ICPA), Ken has strongly supported the varied and critical missions of ICPA.
- **ROBERT "TRUMAN" KEITH** has over 39 years of journalism experience, serving in multiple positions with the Sacramento Bee early in his career and ultimately retiring as the Assistant Distribution Manager in 2001 after 21 years with the Idaho Statesman. In retirement, Truman volunteers at the Old Pen, Idaho Botanical Gardens and State Historical Museum.



### **NEIGHBORHOOD INVESTMENT**

Applicants for the City of Boise's **Neighborhood Investment Program** funds must attend a ZoomGrants Workshop. Learn more at: [EnergizeOurNeighborhoods.org](http://EnergizeOurNeighborhoods.org)

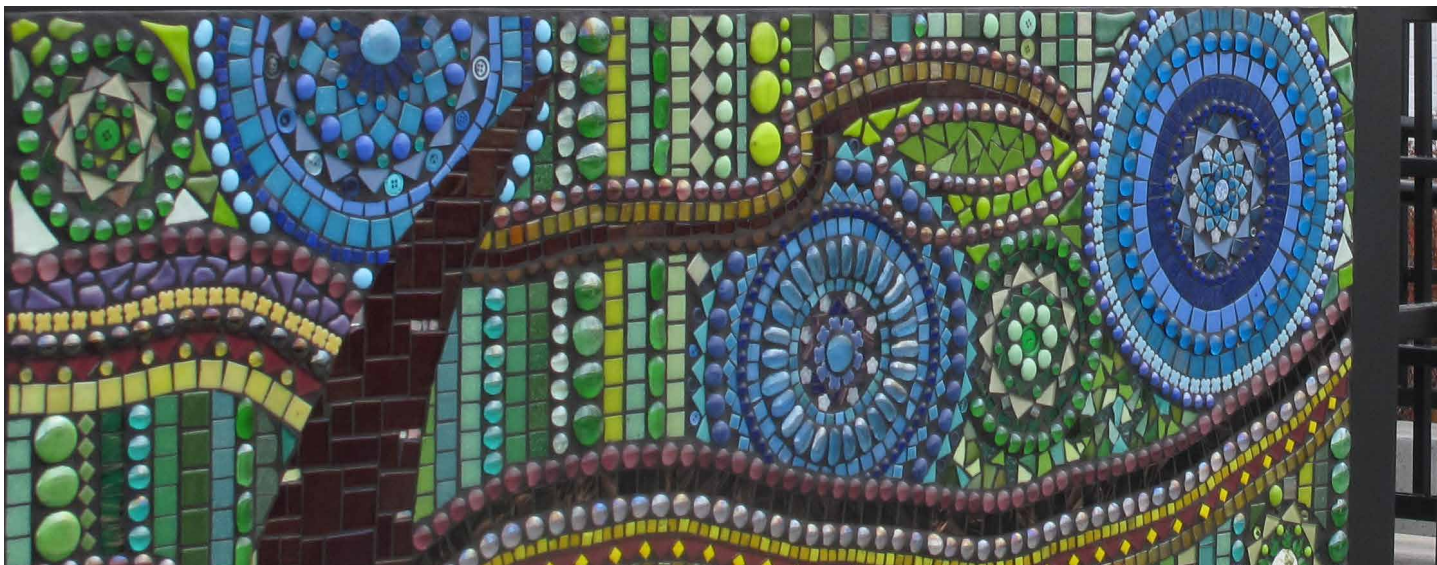

Image courtesy of Boise City Dept of Arts & History. Dream Tree by Reham Aarti

## BREAK OUT SESSION 2 | 11:00 a.m.- 12:00 p.m.

### INTERACTING WITH PUBLIC AGENCY LEADERSHIP

---

Room: Ivy

Join officials from the Ada County Highway District, City of Boise and Valley Regional Transit for an interactive discussion and opportunity to learn how citizens can best work with public agencies.

Panelists:

- **MARYANNE JORDAN** has served on the Boise City Council since 2003. She is a former President of the West Valley Neighborhood Association and spent five years on the Boise City Planning & Zoning Commission. Maryanne was also appointed to Boise's District 17 seat in the Idaho Legislature during 2015.
- **ELAINE CLEGG** was elected to the Boise City Council in 2003. She has worked for Idaho Smart Growth since 1998, where she specializes in providing community assistance by working directly with over 20 Idaho communities. She has completed policy, zoning and pedestrian/bicycle action plans that support smarter growth through land use and transportation integration in areas around the State.
- **JIM HANSEN** is an Ada County Highway District Commissioner. He is also a professional coach and consultant who works with organizations and business leaders as they navigate change. Jim was elected to the Idaho Legislature three times representing southeast Boise. He also founded United Vision for Idaho, an organization focused on coalition organizing and leadership development.

- **KELLI BADESHEIM** is the executive director of Valley Regional Transit, the regional public transportation authority for Ada and Canyon counties in Idaho. She is on the board of the Community Planning Association of Southwest Idaho (COMPASS), as well as serving as president of the board of the Community Transportation Association of Idaho (CTAI).

### NURTURING VIBRANT NEIGHBORHOODS THROUGH PUBLIC ART

---

Room: Clearwater

Art in public places adds meaning, stories, and beauty to our public environment. Panelists will share their experiences with creating art for public spaces and engaging the community to develop opportunities to increase vibrancy and culture in neighborhoods.

Panelists:

- **AMY WESTOVER** is a native of Boise Idaho. Her sculpture, works on paper and kiln-formed glass have been exhibited in many galleries and museums, including the 2001 and 2013 Idaho Triennials at the Boise Art Museum, The Bullseye Gallery in Portland, Oregon as well as The New Mexico Museum of Contemporary Art in Sante Fe.
- **RONNIE MARLER** is president of West Bench Neighborhood Association (WBNA) and leads by the mantra that "Those who show up make the decisions." He led the WBNA in their efforts with Boise City and other agencies to develop master plans for Spaulding and Fairmont parks.

## **ROUNDTABLE DISCUSSION: NEIGHBORHOOD ASSOCIATION LEADERSHIP**

Room: Riverfork

This is an opportunity to share and discuss the challenges of working with and for your neighborhood: How to engage your neighbors? How to know you're representing what they want? What to do when you have a divided neighborhood? Three experienced leaders from diverse neighborhoods will share what they've learned through their leadership experiences and offer ideas for addressing challenges.

Panelists:

- **DREW ALEXANDER** has been the President of the Lusk District Neighborhood Association (LDNA) since 2015. LDNA's current priorities include developing the identity of the neighborhood, working with stakeholders to improve connectivity (especially for pedestrians and cyclists), and ensuring that near-term growth is compatible and attractive. Drew is the Capital Planner for Boise State University.
- **ANNE HAUSRATH** has been active in her North End neighborhood and the City of Boise since the early 80s. She played a leadership role in protecting Hulls Gulch. Anne served 2 terms on Boise City Council, 1992-1999. Today she serves on the NENA Board and is Chair of their Transportation Committee.
- **RANDY JOHNSON** has been a resident of the Central Bench Neighborhood for 7 years, and on the CBNA board for 4 years, serving as president for the last two years. He has focused on bringing the neighborhood together through small-scale community events, helped coordinate the creation of Franklin Park, and begun the process of creating a neighborhood plan.



### **HOME IMPROVEMENT LOANS**

The City of Boise offers low interest loans to qualified applicants.

[HCD.CITYOFBOISE.ORG/HOUSING](http://HCD.CITYOFBOISE.ORG/HOUSING)

## **MORE THAN FACEBOOK: A SOCIAL MEDIA EXPERIENCE**

Room: Whitewater

Embark on a journey that will take you from MySpace to Nextdoor. You will learn about the multitude of social media outlets, how to use them effectively, and how to inspire engagement from online to in-person.

Panelists:

- **LUCAS HENKEN**: After graduating from the University of Puget Sound in May of 2016 with a BS in Economics, Lucas decided to return home to Boise. He worked on a Senate campaign and is now a Community Development Coordinator with Housing and Community Development at the City of Boise.
- **TIFFANY ROBB** has lived in the East End of Boise for 8 years. She has served as: East End Neighborhood Association President, East End Neighborhood Association Communication Chair, Roosevelt Elementary PTA President, Boise at Home Neighborhood Liaison, Boise Neighborhood Association Network Co-collaborator/ organizer, Boise's Babies & Tots (a parenting social nonprofit) Founder, Heart and Home Hospice volunteer.
- **LEON LETSON** is an Associate Planner with the City of Boise and a member of the Energize Our Neighborhoods management team. He is also the current President of the Idaho Chapter of the American Planning Association and has worked in planning and community development for more than 10 years.





## BREAK OUT SESSION 3 | 1:15 - 2:15 p.m.

### MOVING PEOPLE: TRANSPORTATION IN BOISE

---

Room: Ivy

Street design has a direct and noticeable impact on the livability of Boise's communities. Real mobility choices means that all citizens have the option to bike, walk, ride, or drive in safety and comfort. Join panelists for a lively discussion of transportation innovations, improvements, and planning strategies designed to optimize infrastructure and bring value and vibrancy to neighborhoods.

Panelists:

- **DAREN FLUKE** has 25 years of experience in land use and transportation planning. In 2013, he became the city's Comprehensive Planning Manager and led the development of the Transportation Action Plan. Daren is a member of the American Institute of Certified Planners, a board member of the Treasure Valley Cycling Alliance, and recently completed his third term as the president of the Idaho Chapter of the American Planning Association.
- **ROB MASON** has lived in Boise's Sunset neighborhood since 2013, and has been active in neighborhood associations for the past decade. He currently is the Sunset Neighborhood Association's vice-president, the chair of its transportation committee and a founding member of the Boise Bike Boulevard Coalition. Rob is passionate about addressing low-stress bicycle transportation issues throughout Boise.

- **JUSTIN LUCAS**, AICP, is ACHD's Planning and Programming Manager and is responsible for all of ACHD's short, mid, and long-range planning efforts. He has worked extensively in both land use and transportation planning in the Treasure Valley for the last ten years.
- **JEFF JACOBS** is a board certified Pedorthist and owner of Foot Dynamics, a comfort shoe store and clinic located in Boise, Idaho. Jeff moved to Boise in 2008 to enjoy the lifestyle of a small walkable/bikeable city. He has been very active in promoting bicycle and pedestrian issues and has served on the ACHD stakeholder's committee studying bicycle lane concepts for downtown.

### HOUSING ON THE HORIZON

---

Room: Clearwater

The housing market (rental and ownership) has been hot for quite some time. This session will focus on future trends, market analysis, and city loan products that may assist in purchasing a house.

Panelists:

- **CAM JOHNSON** has been on the board of the East End Neighborhood Association for the last 13 years and served as vice president for part of that time. He is a Realtor® with 14 years' experience and a small business owner in the bar and restaurant business.



- **RYAN PERECZ** has over a decade of experience selling real estate in the Treasure Valley. He is a dedicated professional with a passion for helping his fellow citizens and neighbors achieve financial stability and realize the excitement of homeownership.
- **RHIANNON AVERY** has served with the City of Boise for five years, working with federal funds received from the U.S. Department of Housing and Urban Development (HUD). Rhiannon is an adjunct professor at Boise State University, and previously worked for Terry Reilly Health Services.
- **BRAD SMITH** has been with the Ada County Assessor's Office for more than 20 years. The Assessor's Office assesses properties at market value. Brad started out as a residential appraiser, moved quickly into the commercial valuation department and has been the Appraisal Division supervisor for the last 9 years.

## FINDING THE CURE FOR COMMUNITY: (WHY) WON'T YOU BE MY NEIGHBOR?

Room: Whitewater

New scientific research reaffirms how deeply our relationships and ties to community are vital to our health and stability. With "neighbors" now cited as the No. 2 reason a person opts to move, what can you do to cultivate real connections in your communities?

Panelist:

- **JEN PICCOTTI** is the Chief Operating Officer of ManagIn, and the multifamily industry's leading educator and authority on resident retention, employee retention and reputation management. Jen earned her BBA Production Operations Management from Boise State University, and MS Quality Assurance from California State University, Dominguez Hills.



**Activity Guide**  
PARKS AND RECREATION  
YOUTH, TEEN & ADULT RECREATION  
FALL 2017

**YOUTH, TEEN + ADULT RECREATION**  
LEARN MORE AT [CITYOFBOISE.ORG](http://CITYOFBOISE.ORG).

## ROUNDTABLE DISCUSSION: HOSTING GREAT NEIGHBORHOOD GATHERINGS

Room: Riverfork

Representatives from various neighborhood associations will share what they have done to ensure fun, well attended gatherings. Will you share your ideas too? Let's learn from each other to make all our neighborhoods great!

Panelists:

- **ELIZABETH LESTER BARNES** has been on the board of the South Boise Village Neighborhood association for the past seven years and has served as the president for three years. A lecturer at Boise State University, Elizabeth loves to connect her students with the community and uses service learning as a pedagogical tool in all of her classrooms.
- **DEBBIE ARNHOLS** moved to Warm Springs Mesa 11 years ago from northern Virginia and became involved in her Neighborhood Association in order to learn more about the Mesa. Debbie is the Mesa Board Treasurer and is involved in planning and helping with other social activities that bring the neighborhood together.
- **LINDSEY BARNES** has been a Boise resident and lived on the Mesa for 10 years. She became active with the Neighborhood Association Board soon after moving to Boise and has helped write several successful Neighborhood Reinvestment Grants for the Mesa and plan many annual family activities for residents.
- **RANDY JOHNSON** has been a resident of the Central Bench Neighborhood for 7 years, and on the CBNA board for 4 years, serving as president for the last two years. He has focused on bringing the neighborhood together through small-scale community events, helped coordinate the creation of Franklin Park, and begun the process of creating a neighborhood plan.

## CONNECT YOUR NEIGHBORHOOD

### FREE RESOURCES

The Energize Our Neighborhoods Toolkit has free community engagement resources to help connect your neighborhood.

[ENERGIZEOURNEIGHBORHOODS.ORG](http://ENERGIZEOURNEIGHBORHOODS.ORG)

### EMERGENCIES: BENEFITS OF STAYING CALM, SURVIVAL TIPS, AND VALUE ADDED SERVICES

---

Room: Ivy

Emergency experts from the Ada County Paramedics, Idaho Office of Emergency Management, Boise Fire Department, Ada County Emergency Management and the Ada County Highway District will provide the information and tools necessary for dealing with crisis in the modern age. Attendees will learn how to be prepared, what to do and the benefits of staying calm in an emergency medical, extreme weather, fire related or household crisis.

Panelists:

- **TIMOTHY MORGAN** is a Licensed Professional Engineer with more than 15 years of professional experience in the planning, development, engineering design and construction industry. He is ACHD's Deputy Director and is responsible for all maintenance and operations of 4,869 lane miles of roadway, 130 team members and an annual budget of \$30 million.
- **MYLA JEFFRIES** attended college at Utah State University and Idaho State University where she graduated with her degree in Emergency Management. Myla previously worked for the Idaho Office of Emergency Management and currently works at Ada County Emergency Management. She specializes in social media for emergency management and assists other county emergency managers breaking into the social media world.
- **LINDA SCOPELLITI** has worked for Ada County Paramedics since 1998. She has been an Assistant Supervisor/Captain for the past 10 years. Linda was formerly a member of the Hazardous Materials Medical team and has received Weapons of mass destruction, live agent training with the Department of Homeland Security/FEMA.
- **ROY BOEHM** is the Public Education Coordinator for the Boise Fire Department. He has over 26 years of experience working in Fire Service Operations, Training and Fire Prevention. Roy is a Certified Fire and Explosives Investigator and holds International Code Council (ICC) certifications as a Fire Inspector I.
- **JERRY MCADAMS** is a Senior Captain in the Fire Prevention Division of the Boise Fire Department. He has a total of 17 years in the fire service. He currently serves as a Fire Investigator and Wildfire Mitigation Specialist. Jerry is a board member for the International Association of Wildland Fire and serves on the editorial board for Wildfire Magazine.

- **ELIZABETH DUNCAN** is the Public Affairs Officer for the Idaho Office of Emergency Management (IOEM), the state's emergency management agency. Duncan oversees a group of forty state of Idaho agency Public Information Officers who can be activated to respond with public information during emergencies. The Public Information Emergency Response Team (PIER) is a resource of the state of Idaho and plays an integral public information role during disasters.

### OPEN SPACE & COMMUNITY GARDENS

---

Room: Whitewater

Growing healthy communities through gardens and forming strong connections to the natural environment are valuable recreational activities that contribute to community development, environmental awareness, positive social interaction, and that support increased local food production and food security. Join panelists for an in-depth exploration of opportunities to engage the community around these topics.

Panelists:

- **LISA DUPLESSIE** is the Education Manager/Executive Director at Boise Urban Garden School and the Foothills Learning Center. She also coordinates the City of Boise's community garden program. Her background is in elementary education and urban agriculture. Lisa is very passionate about local food and loves that kids her programs serve have access to excellent place-based education.
- **MARTHA BRABEC** graduated from Boise State University in 2014 with a Master's Degree in Biology, where she studied the impacts of climate change on sagebrush. Her work with the City of Boise focuses on managing open space reserves using the best available science. She was previously employed at the U.S. Geological Survey as an ecologist with a focus on large post-fire rehabilitation projects.
- **JAYNA MOTZKUS** is the current Treasurer for the Borah Neighborhood Association and Co- Manager of the Borah Community Garden. She has been a Borah Neighborhood resident for 25 years and is employed by Bank of America N.A. as an Assistant Vice President in Wholesale Credit Products.

## AGE-FRIENDLY CITIES

Room: Clearwater

The global population is aging. By 2050, people ages 60 and older will represent 22% of the global population. This demographic shift has prompted many communities, including Boise, to engage in age-friendly planning and programming with the goal of creating environments that encourage active aging by optimizing opportunities for health, participation and security.

In 2015, as a component of the Lasting, Innovative, and Vibrant (LIV) city initiative, the City of Boise contracted with the BSU Center for the Study of Aging to conduct an age-friendly city assessment. It gathered information from older adults, caregivers of older adults, and agencies providing services to older adults in Boise about assets and barriers to healthy aging. Eight specific community aspects, from open spaces to transportation to social engagement, communications and community services, were explored. Participants also made suggestions for making the City of Boise more age-friendly.

This panel will share the study findings and engage the audience in envisioning a city friendly to all ages.

Panelists:

- **DIANE RONAYNE** has been a community activist and volunteer in Boise since 1982. She served on the Boise Arts Commission and Boise Planning and Zoning Commission. Diane was the founding secretary of Boise Neighborhood Alliance, and is active in East End Neighborhood Association. She has helped found or lead 13 Boise nonprofits, including Boise at Home, where she has served since 2013.
- **ROSEANNE SWAIN** is the Recreation Superintendent for the City of Boise and is responsible for Idaho Ice World, Warm Springs and Quail Hollow Golf Courses, Adult and Youth programming, Adaptive Recreation, Senior Center and Special Projects. Roseanne was the City's lead in collaboration with Boise State University to develop a study addressing needs of the older adults in the community.
- **SHIRL BOYCE** has working in land use and comprehensive planning, assisting local governments as SE Idaho Regional Director, State Planning & Community Affairs and Bureau Chief, and Bureau of State Planning & Community Affairs. For the past twenty years, Shirl has served as head of what is now the Boise Valley Economic Partnership.

## ROUNDTABLE DISCUSSION: HOW NEIGHBORHOODS WORK TO COLLABORATE

Room: Riverfork

Neighbors and neighborhoods increasingly want to work together on larger issues facing our community. Come hear about three new collaborative initiatives as well as discuss issues you are concerned about that impact our neighborhoods and need our voice.

Panelists:

- **DEANNA SMITH** has served on East End Neighborhood Association's Board since 1999, including 6 years as President. Professionally she has worked as a community advocate and technical advisor on a variety of community related issues from energy to transportation to land use for over 30 years.
- **ROB MASON** has lived in Boise's Sunset neighborhood since 2013, and has been active in neighborhood associations for the past decade. He currently is the Sunset Neighborhood Association's vice-president and is the chair of its transportation committee.
- **SHEILA GRISHAM** moved to Boise 23 years ago. She has been involved in PTA's, fundraisers and the East End Neighborhood Association. She loves Boise's Historic Districts and everything they have to offer and is passionate about preserving Boise's history.
- **TIFFANY ROBB** has lived in the East End of Boise for 8 years. She has served as: East End Neighborhood Association President, East End Neighborhood Association Communication Chair, Roosevelt Elementary PTA President, Boise at Home Neighborhood Liaison, Boise Neighborhood Association Network Co-collaborator/ organizer, Boise's Babies & Tots (a parenting social nonprofit) Founder, Heart and Home Hospice volunteer.



## STAY IN TOUCH



# #IAMBOISE



# #IAMBOISE



# #IAMBOISE

## SOCIAL MEDIA

FACEBOOK 

Follow Us: The City of Boise

Friend Us: Melinda Energize Our Neighborhoods

INSTAGRAM 

city\_of\_boise

TWITTER 

@CityOfBoise

@MayorBieter

#IAMBOISE

**#IAMBOISE** celebrates YOU for helping make Boise the city we all love. Take and share your pictures using #IAMBOISE to show us how you are Boise.

## E-NEWSLETTER

IN THE KNOW

Sign up for the City of Boise's weekly e-newsletter. "In the Know" features the latest news and information about services, upcoming events, important meetings and other key opportunities to be involved.

Sign up at [CITYOFBOISE.ORG](http://CITYOFBOISE.ORG)

## LEARN MORE

CITY OF BOISE

[CITYOFBOISE.ORG](http://CITYOFBOISE.ORG)

ENERGIZE OUR NEIGHBORHOODS

[ENERGIZEOURNEIGHBORHOODS.ORG](http://ENERGIZEOURNEIGHBORHOODS.ORG)

# NEIGHBORHOOD TOURS



Central Addition LIV District

## EXPLORING BOISE'S BOUNDARIES

The City of Boise will offer a series of neighborhood tours called "Exploring Boise's Boundaries." The series will begin with five downtown tours. Each tour starts at 4:00 p.m. and ends at 5:30 p.m. at a local gathering spot. Registration is required. There is a maximum of 20 people per tour. Go to [EnergizeOurNeighborhoods.org](http://EnergizeOurNeighborhoods.org) for more information.

### REDEFINING DOWNTOWN: A DOWNTOWN WALKING SERIES

- October 18: Cultural and Warehouse District
- October 25: Old Boise and Eastside Neighborhood
- November 1: Central Addition LIV District
- November 7: River Street Neighborhood
- November 15: Westside Neighborhood



## OUR SPONSORS

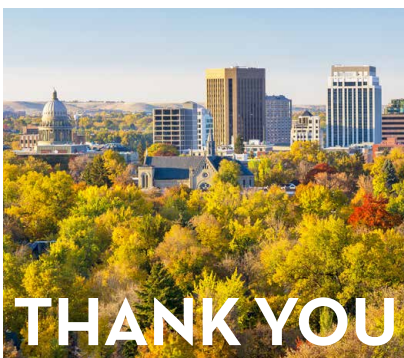

- Ada County Emergency Management (ACEM)
- Ada County Highway District (ACHD)
- Ada County Paramedics
- Boise Fire Department
- Boise State University
- Cam Johnson with Windermere Real Estate
- Idaho Office of Emergency Management (IOEM)
- Idaho Power
- Morris Hill Neighborhood Association
- Ryan Percz with Amherst Madison/Legacy Real Estate
- Serve Idaho
- Zamzows

# GROVE HOTEL MEETING ROOMS

## 2<sup>nd</sup> FLOOR Meeting Space

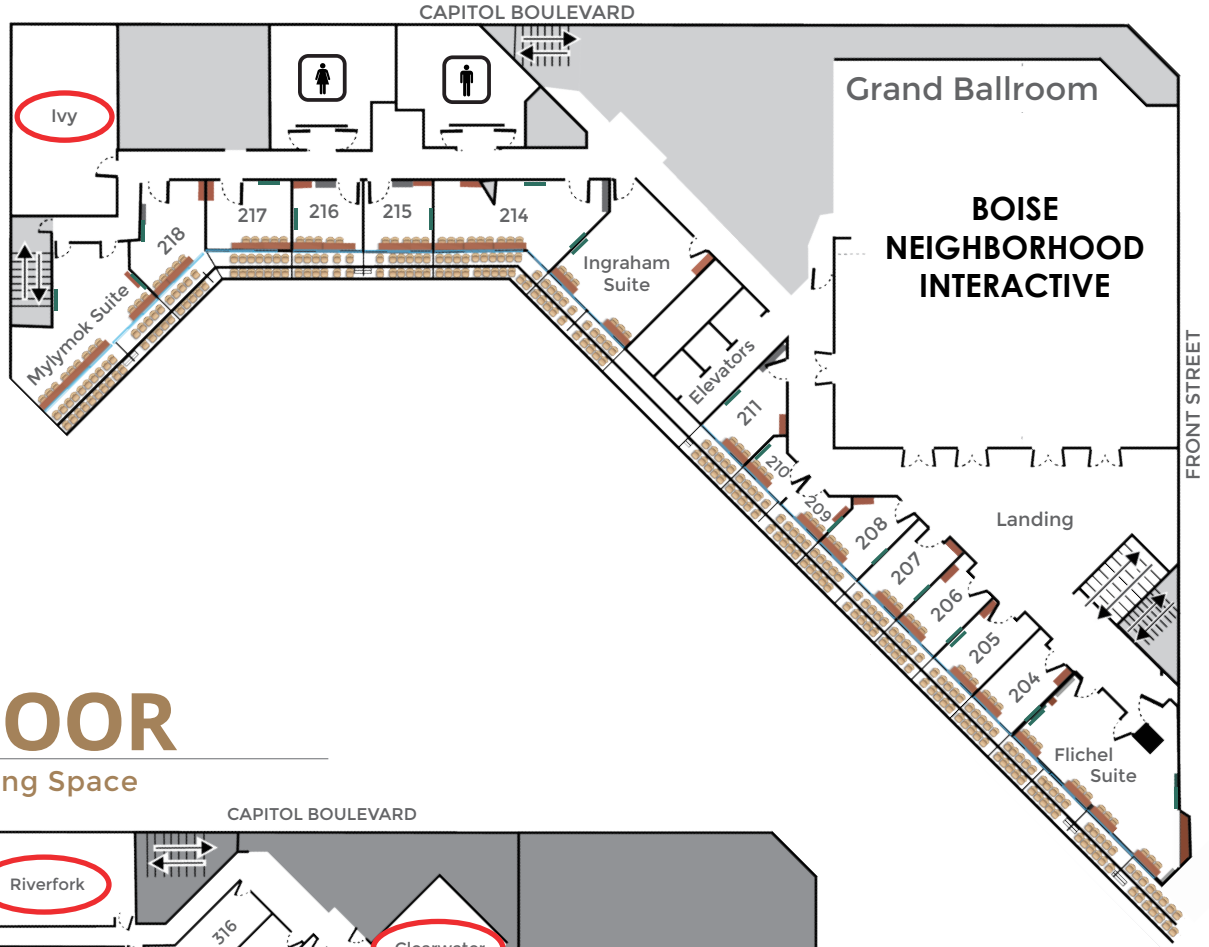

## 3<sup>rd</sup> FLOOR Meeting Space



# NOTES



## **ENERGIZE OUR NEIGHBORHOODS**

City of Boise  
150 N. Capitol Blvd  
Boise, ID 83702

[CITYOFBOISE.ORG](http://CITYOFBOISE.ORG)

[ENERGIZEOURNEIGHBORHOODS.ORG](http://ENERGIZEOURNEIGHBORHOODS.ORG)