



# ORDER ONLINE & WIN!



2 TRIPS



2 BBQS



6 TRAVELING SUITCASES

4 TELEVISIONS



7 DYSON VACUUM CLEANERS



4 NESPRESSO COFFEE MACHINES



1 ATV



800 TIM HORTONS GIFT CARDS



20 dollars

400 GAS GIFT CARDS



4 PREPAID VISA CARDS

From June 1 to 30, 2018 **ORDER ONLINE** on the TW website and get a chance to win one of many prizes!

See inside for details.

**+ 1200 PRIZES, 1 IN 3 ODDS OF WINNING!**

**TAKE ALSO ADVANTAGE OF HUNDREDS OF DISCOUNTS**

HALOGEN SEALED BEAMS, RECTANGULAR



**679<sup>ea</sup>** 12.8V, 50W. H4651  
12.8V, 35W. H4656



SPRING BRAKE, COMBO 3030

**59<sup>99</sup>** With Clevis. HD3030C



BRAKE DRUM

**82<sup>99</sup>**

Balanced, Equivalent to 3600A. X60794





From June 1 to 30, 2018, for every \$500 **order made on the [www.tw-distribution.com](http://www.tw-distribution.com) website**, get an electronic participation coupon giving you a chance to win one of many prizes!

**1**

### ***Sign up***

To participate, complete your registration now at [www.tworderandwin.com](http://www.tworderandwin.com).

**2**

### ***Order online***

From June 1 to 30, **for every \$500\*** order made on the [www.tw-distribution.com](http://www.tw-distribution.com) website, **you will receive an electronic participation coupon.**

**3**

### ***Win!***

Discover your coupons at [www.tworderandwin.com](http://www.tworderandwin.com).

\* Not applicable for the following suppliers: Alemite, Capital Gear, Hall-Chem, MS Gregson, Recochem, SCN, Shell. Certain conditions may apply, please **contact your TW sales representative** for more details.



**1 SIGN UP**

**2 ORDER ONLINE**

**3 WIN!**

**Grote**

**BACK UP ALARM**

**19<sup>99</sup>** Econ. mod. 97 dB. **73040**



**10<sup>99</sup>**

Black Heavy Duty Ties, Pack of 100, Black, 15", 120 lbs. **83-6029**

**37<sup>99</sup>**

Heat Shrinkable Butt Connectors, Pack of 100, Blue. **83-2350**

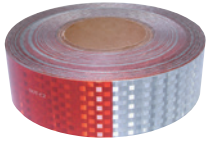

**84<sup>99</sup>**

Conspicuity Tape Alternating 7" Silver & 11" Red, 2" X 150' Roll. **41160**



**162<sup>99</sup>**

LED headlamp 4X6 low beam. **94421-5**



**274<sup>99</sup>**

Low Profile LED Mini Light Bar, 17", 12V, Amber, permanent mount, SAE J845. **76983**

**BRITEZONE LED WORK LAMP**

**32<sup>99</sup>** Round, 1600 Raw Lumens. **BZ101-5**



**ACE**  
Manufacturing & Parts Co.  
American Made Clutches Since 1967

**QUICK CHANGE HINGE CLUTCH BRAKE**

**21<sup>99</sup>** 2". **B201**



**EZ PEDAL CLUTCHES**



**549<sup>99</sup>** 14" X 1.75", 8 Springs, 3 Pad, 900 lb/ft torque. **EZ107237-8CB**

**599<sup>99</sup>** 15.5" X 2", Ceramic 4 Pad. **EZ208925-82B**

**699<sup>99</sup>** 15.5" x 2", 10 Springs, 6 Pad, 2050 lb/ft torque. **EZ208391-93H**

**699<sup>99</sup>** 15.5" X 2", Ceramic 6 Pad. **EZ208925-82H**

**789<sup>99</sup>** 15.5" X 2", Ceramic 6 Pad. **EZ208925-32H**

**COMPLETE CLUTCH INSTALLATION KIT**

**179<sup>99</sup>** RT Series. **AK2468B**



**CONMET**

**TRUTURN® BRAKE DRUMS**

**126<sup>99</sup>** 16.5" X 5". **10014756**

**129<sup>99</sup>** 16.5" X 5", Equivalent to 3710X. **10020147**

**129<sup>99</sup>** 16.5" X 6", Equivalent to 3687X. **10033071**

**139<sup>99</sup>** 16.5" X 8.625". **10012097**



**HUB ASSEMBLIES**

**194<sup>99</sup>** Trailer, TN axle. **10082250**

**249<sup>99</sup>** Trailer, TP axle. **10082254**

**299<sup>99</sup>** PRESET™ Hub Piloted, Drive R. **10082217**

**314<sup>99</sup>** PRESET™ Rear axle, short stud. **10082216**

**337<sup>99</sup>** PRESET™D trailer, TP axle. **10082229**



**289<sup>99</sup>** Air Disc Rotor. **10018609**



**ORDER ONLINE & WIN!**



**SIGN UP**



**ADJUSTABLE BRACE**

**6<sup>99</sup>** Medium Carrier, 26" to 41".  
1006-1613



**TRAILER DOOR GASKET**

**8<sup>99</sup>** 3/4" X 168".  
1404-6998-168



**12<sup>49</sup>**

Roof bow, Alu. I-Beam, Manac-style, 1-13/16" X 1-1/8" X 98,25".  
1304-8761



**SANDSHOES**

**9<sup>99</sup>** Solid axle, 8-13/16" X 1-7/8". 1002-1304-KIT



**19<sup>99</sup>** 10" X 10", hollow axle, cotter pin. 1001-7171-KIT-H-F

**25<sup>99</sup>** 10" X 10", cotter pin, solid axle. 1001-7171-KIT-S-F

**CRANK HANDLES**

**5<sup>49</sup>** 9-1/8". 1003-6857

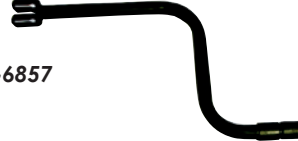

**6<sup>29</sup>** 17". 1003-6863

**25<sup>99</sup>**

Pin Assembly for Twistlock, Retractable. 1105-3533-INNER



**8<sup>29</sup>**

Latch For Pinlock Non Handed. 1108-3633-18



**174<sup>99</sup>**  
CentriFuse® Brake Drum, 89 lbs. 89996B

**HUB-SEALS**

**GRIT GUARD™**

**31<sup>99</sup>** Trailer Axle. 372-7097



**31<sup>99</sup>** Trailer Axle. 372-7099

**31<sup>99</sup>** Trailer Axle. 372-7098

**39<sup>99</sup>** Drive Axle. 392-9131

**VOYAGER®**

**32<sup>99</sup>** Trailer Axle. 373-0123



**31<sup>99</sup>** Trailer Axle. 373-0143

**43<sup>99</sup>** Front Axle. 383-0164

**43<sup>99</sup>** Front Axle. 393-0173



**55<sup>99</sup>**

Zip-Torq® Axle Fasteners, "P" Parallel Trailer. 400-4723



**14<sup>99</sup>**

Hub Cap. 343-4009



**TRICO®**



**WINDSHIELD WASHER PUMP**

**10<sup>99</sup>** 11-100

**TRICO FORCE® HIGH PERFORMANCE BEAM WIPER BLADES**

**13<sup>99</sup> ea** 14". 25-140  
15". 25-150  
16". 25-160  
17". 25-170  
18". 25-180  
19". 25-190  
20". 25-200  
21". 25-210

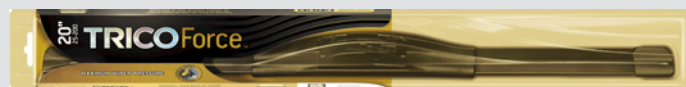

**15<sup>99</sup> ea** 22". 25-220  
24". 25-240

**20<sup>99</sup> ea** 26". 25-260  
28". 25-280



**AIR FILTERS**

**89<sup>99</sup>**  
P142807

**153<sup>99</sup>**  
P608306

**57<sup>99</sup>**  
P534816

**67<sup>99</sup>**  
P625287



**LUBE SPIN-ON FILTERS**

**26<sup>99</sup>**  
P553000

**34<sup>99</sup>**  
P559000



**8<sup>99</sup>**

Stainless Steel Seal Clamps, 5" O.D.  
X007785



**HEAVY DUTY PRESSURIZED COOLANT RESERVOIR**

**329<sup>99</sup>** Mack, Volvo 2018-08.  
603-5505



**COOLANT RESERVOIRS**

**279<sup>99</sup>**  
International 2013-01.  
603-5103

**199<sup>99</sup>**  
Freightliner 2018-08.  
603-5203

**269<sup>99</sup>**  
International 2018-03.  
603-5105

**129<sup>99</sup>**  
Freightliner Business Class M2 2012,  
Freightliner M2 106 2017-12. 603-5207

**69<sup>99</sup>**  
Freightliner 2007-01.  
603-5201

**99<sup>99</sup>**  
Kenworth 2016-13,  
Peterbilt 2015-06.  
603-5402

**229<sup>99</sup>**  
Kenworth 2018-08,  
Peterbilt 2018-08.  
603-5403



**109<sup>99</sup>**  
Air Brake Service Kit,  
Large Assortment.  
ABFR-KIT-2

**COUPLER ASSEMBLIES**

**2<sup>99</sup>** 3/8" Hose, 1/4"  
Pipe. 1492-6C

**4<sup>69</sup>** 1/2" Hose, 1/4"  
Pipe. 1492-8C

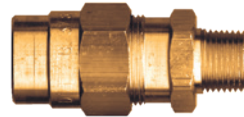

**UNIONS**

**1<sup>69</sup>** 3/8". 1462-6

**5<sup>99</sup>** 1/2". 1493-8C



**COUPLINGS**



**3<sup>99</sup>** DOT 1/4 T. PC1462-4

**4<sup>39</sup>** DOT 3/8 T. PC1462-6



**99<sup>99</sup>**

Air Disc Brake Pads, for One Axle, Bendix SK/ SN7, ADB22X Models, Replaces Bendix 802078, Abex ADB1369. **GBADP1369**



**SINGLE BRAKE SHOES**



- 14<sup>99</sup>** Reman. Rockwell Q, Standard. **GBE4515Q23STD**
- 15<sup>49</sup>** Reman. Rockwell Q-Plus, Standard. **GBE4707Q23STD**
- 16<sup>49</sup>** Reman. Rockwell Eaton ESII, Standard. **GBE4709E223STD**

**BRAKE KITS**

Include Brake Hardware



- 37<sup>99</sup>** Reman. Rockwell Q, Standard. **GBEK4515Q23STD**
- 38<sup>99</sup>** Reman. Rockwell Q-Plus, Standard. **GBEK4707Q23STD**
- 41<sup>99</sup>** Reman. Rockwell Eaton ESII, Standard. **GBEK4709E223STD**



**AIR SPRINGS**

**124<sup>99</sup>**

W01-358-8050

**149<sup>99</sup>**

W01-358-8708

**132<sup>99</sup>**

W01-358-8713

**130<sup>99</sup>**

W01-358-8755

**119<sup>99</sup>**

W01-358-9122

**114<sup>99</sup>**

W01-358-9265

**109<sup>99</sup>**

W01-358-9270

**112<sup>99</sup>**

W01-358-9780



**LIFESEAL+ SPRING BRAKES**

**114<sup>99</sup>** Long Stroke. **LCP3030L**

**126<sup>99</sup>** Standard Stroke. **LCP3030**



**GENUINE AUTOMATIC SLACK ADJUSTERS, STRAIGHT ARM**

**84<sup>99</sup> ea**

5-1/2" - 6-1/2", 1-1/2", 10 Splines. **40010143**

5-1/2" - 6-1/2", 1-1/2" - 28 Splines. **40010141**

5-1/2", 1-1/2" - 10 Splines. **40010155**

5-1/2", 1-1/2", 28 Splines. **40010211**

6", 1-1/2", 28 Splines. **40010212**

6", 1-1/2", 10 Splines. **40010216**

**89<sup>99</sup> ea**

**SELF-SETTINGS**

5-1/2", 1-1/2", 28 Splines. **40020211**

6", 1-1/2", 28 Splines. **40020212**

6", 1-1/2", 10 Splines. **40020216**

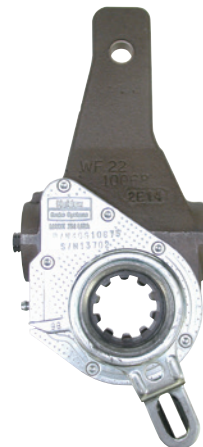





**ORDER ONLINE**



**WIN!**



**619<sup>99</sup>**

Fifth Wheel No-Slack® II Rebuild Kit, 6 Kits Combined In One. **KIT-RX-67NTL**



**999<sup>99</sup>**

Fifth Wheel Top Plate 7000 Series. **SLTPL7000**



**COMPLETE FIFTH WHEEL ASSEMBLIES 7000 SERIES, 24" SLIDE LENGTH**

**PIN & BUSHING KITS**

**119<sup>99</sup>**

One-Piece Bushing. **KIT-PIN-191**

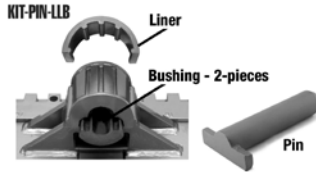

Two-Piece Bushing. **KIT-PIN-LLB**

**229<sup>99</sup>**

Repair Kit for 6000/7000 Series, Left Side. **KIT-RPR-6000L**



**1249<sup>99</sup>**

6-3/4" Fifth Wheel Height. **SL7LWB675024**

7-1/4" Fifth Wheel Height. **SL7LWB725024**

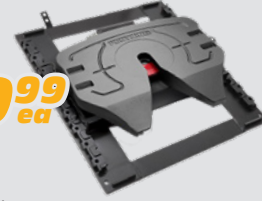

**409<sup>99</sup>**

Engine Water Pump, 2007-04 Volvo, VN Series, Cummins ISX Diesel. **45054HD**



**FLEETRANNER® HD BELTS**

**23<sup>99</sup>** K060637HD

**41<sup>99</sup>** K081055HD

**43<sup>99</sup>** K081065HD

**74<sup>99</sup>** K120858HD

**49<sup>99</sup>** K120911HD

**HEAVY DUTY BELT TENSIONERS**



**127<sup>99</sup>** 38587



**149<sup>99</sup>** 38667

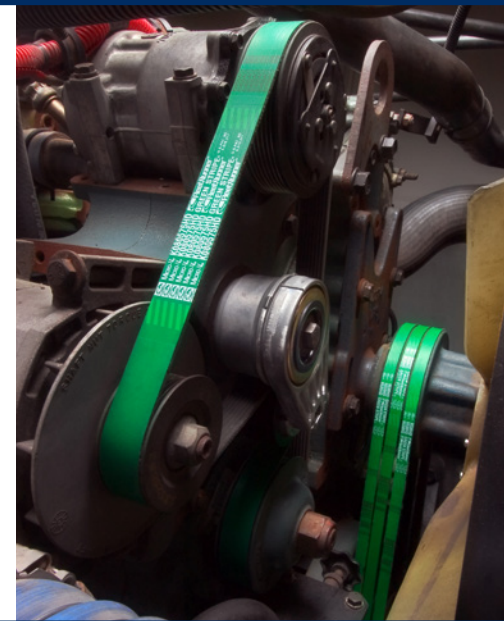

**62<sup>99</sup>**

HID Bulb D2S. **D2S**



**HALOGEN SEALED BEAMS, RECTANGULAR**

**67<sup>99</sup>** 12.8V, 50W. **H4651**  
**ea** 12.8V, 35W. **H4656**



**HALOGEN BULBS**

**65<sup>99</sup>**

**H11-55**

**75<sup>99</sup>**

55W, 13.2V. **H11-55BP**



**NIGHTHAWK BULBS**

**17<sup>99</sup>** 9007NHBP

**34<sup>99</sup>** H11-55NHBP2



**ORDER  
ONLINE &  
WIN!**



**SIGN UP**



**LED M/C**

**5<sup>39</sup>**

2.5", Red.  
**10250R**



**5<sup>69</sup>**

2.5", Yellow.  
**10250Y**

**14<sup>99</sup><sub>ea</sub>**

2.5", Red. **10275R**  
2.5", Yellow. **10275Y**

**MARKER LED LAMPS**

**4<sup>59</sup><sub>ea</sub>**

2.5", Red. **1050**  
2.5", Yellow. **1050A**



**1<sup>39</sup>**

Reflectorized Marker &  
Clearance Lamp, Red.  
**10205R**



**24<sup>99</sup>**

Charge Air  
Connectors  
With SS Rings,  
4" I.D., 6" Long.  
**7715-0002**

**SILICONE COOLANT HOSES**

**52<sup>99</sup>** 2.5" I.D. X 36". **5515-250**

**59<sup>99</sup>** 3" I.D. X 36". **5515-300**

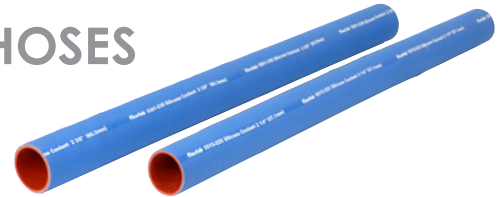

**SILICONE HEATER HOSES, BLUE**

**72<sup>99</sup>** 0.625" X 25'.  
**5526-062X25**

**77<sup>99</sup>** 0.75" X 25'.  
**5526-075X25**

**134<sup>99</sup>** 0.625" X 50'.  
**5526-062X50**

**144<sup>99</sup>** 0.75" X 50'.  
**5526-075X50**



**PREMIUM  
23,000 LBS  
AIR DISC  
BRAKE PADS**



**132<sup>99</sup>**

For One Axle, Meritor Ex225  
Elsa (HZ), Replaces Meritor  
Kit2252H2BE and DA.  
**DSHP1311**



**149<sup>99</sup>**

For One Axle, Bendix SK/ SN7,  
ADB22X Models, Replaces  
Bendix K070796, Abex ADB1369.  
**DSHP1369**



**149<sup>99</sup>**

For One Axle, Bendix SB/  
BN7 Models, Replaces  
Bendix 5013257.  
**DSHP1203**





**STEEL WHEELS**

**109<sup>99</sup>** Statesman Wheel, 22.5" X 8.25", 82 lbs, White. **50308PKWHT21**

**269<sup>99</sup>** ESW Steel Wheel, Dual Mounting, 22.5" X 8.25", Grey, 108 lbs, 130 PSI, Hub Piloted. **29300PKWHT21**



**10-HOLE WHEEL-GUARD SEPARATOR PLATE**

**3<sup>19</sup>** 22 mm dia. Studs, 285.75 mm B/C. **590-3**



**AUTOMATIC SLACK ADJUSTERS**



**84<sup>99</sup> ea** 5.5" Arm - 10 Splines 1.5". **AS1132**  
 6.0" Arm - 10 Splines 1.5". **AS1133**  
 5.5" Arm - 28 Splines 1.5". **AS1140**  
 6.0" Arm - 28 Splines 1.5". **AS1141**



**BRAKE DRUM**

**164<sup>99</sup>** Equivalent to 89996B, 88 lbs. **80000-018**



**BRAKE DRUMS**

**97<sup>99</sup>** 16.5" X 7". **3600A**  
**99<sup>99</sup>** 16.5" X 7", Balanced. **3600AX**  
**164<sup>99</sup>** 16.5" X 6", Balanced. **3687X**



**199<sup>99</sup>** 16.5" X 8.62", Balanced. **3807AX**

**ALUMINUM WHEELS**

**229<sup>99</sup>** 22.5" X 8.25", Machined. **AH22501-10M**  
**249<sup>99</sup>** 22.5" X 8.25", Polished. **AH22501-10P**



**149<sup>99</sup>** Drawbar, 3". **DB-100FQ1**



**244<sup>99</sup>** Adjustment Tool. **TF-TLN-5001**

**MARK V LANDING GEAR SET**

**494<sup>99</sup>** With Weightsaver Skid Foot. **LGS-3A115**

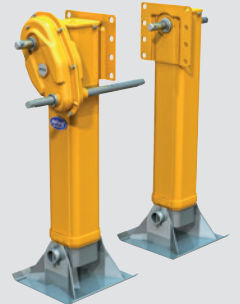

**REBUILD KITS**

**124<sup>99</sup>** Gearbox, Mark V Series. **RK-11287**



**374<sup>99</sup>** Fifth Wheel Rebuild Kit, Top Plate, Left. **RK-351-A-L**



**MARK V CRANKS**

**8<sup>39</sup>** 9.12". **XA-V-90-0**  
**9<sup>59</sup>** 17". **XA-V-90-10**



**TIMKEN**

**MILEMATE BEARING SETS**

- 37<sup>99</sup>** 572/580. **SET401**
- 45<sup>99</sup>** 592A/594A. **SET403**
- 30<sup>99</sup>** HM212049/ HM212011. **SET413**
- 46<sup>99</sup>** HM218210/ HM218248. **SET414**



**SET-RIGHT® COMMERCIAL VEHICLE HUB REBUILD KITS**

- 104<sup>99</sup>** SET427/428, with Spacer Kit. **FFTC1**
- 152<sup>99</sup>** SET429/430, with Spacer Kit. **RDTC1**
- 189<sup>99</sup>** SET432, with Spacer Kit. **TPTC1**



**KINEDYNE®**

**28<sup>99</sup>**

Ratchet Chain Binder, Fits 3/8" to 1/2" Chain, Standard. **10035HD**



**WINCH STRAPS**

- 15<sup>49</sup>** 3" x 30', with Chain Anchor. **323040**
- 15<sup>49</sup>** 4" x 30', with Delta Ring. **423010**
- 19<sup>99</sup>** 4" x 30', with Chain Anchor. **423040**



**GRADE 70 CHAINS**

- 39<sup>99</sup>** 3/8" X 16'. **10038-16BX**
- 45<sup>99</sup>** 3/8" X 20'. **10038-20BX**
- 59<sup>99</sup>** 3/8" X 25'. **10038-25BX**



**RUBBER TARP TIES**

- 065** 10" / 14. **2210NR**
- 069** 15" / 19. **2215NR**
- 085** 21" / 50. **2221NR**
- 115** 31" / 35. **2231NR**
- 169** 41" / 45. **2241NR**



**KIT MASTERS**

**GOLD TOP FAN CLUTCH REPAIR KITS**

- 464<sup>99</sup>** Single Pulley Bearing. **14-256-1**
- 464<sup>99</sup>** 2 Pulley Bearings. **14-256**
- 739<sup>99</sup>** 2-Speed 2 Pulley Bearings. **24-256**



**NEW FAN CLUTCH**

**481<sup>99</sup>**  
BorgWarner/Kysor Style. **8801N**



**427<sup>99</sup>**

Fan Clutch Repair Kit, 9.5", HT/S Series. **9500HP**



**122<sup>99</sup>**

3-Way Valve, NO-NC, 125NPTF, 12VDC. **3282**

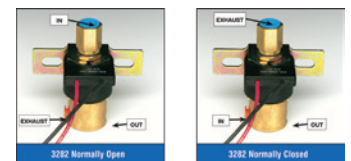

**OUR TRUSTED PRIVATE BRAND**



**BATTERIES**



- 99<sup>99</sup>\*** 950 CCA, 12V, Commercial (Stud). **31S**
- 124<sup>99</sup>\*** 1060 CCA, 12V, Commercial (Stud). **31SHD**
- 194<sup>99</sup>\*** AGM Battery, 800 CCA 200RC 12V, Commercial (Dual terminals, post and stud). **8A31S**
- 219<sup>99</sup>\*** 1050 CCA, 12V, Commercial. **4DHD**
- 264<sup>99</sup>\*** 1400 CCA, 12V, Commercial. **8DHD**

**BRAKE DRUMS**



- 137<sup>99</sup>** 105 lbs, Equivalent to 2983C. **X60114**
- 82<sup>99</sup>** Balanced, Equivalent to 3600A. **X60794**
- 119<sup>99</sup>** Equivalent to Gunitite 3887 and Webb 63680F. **X61132**
- 149<sup>99</sup>** Balanced, Equivalent to 3807X. **X61367**

*\*Price paid with return of equivalent scrap battery. Otherwise, a \$15 core charge will be added to the purchase price.*



**SPRING BRAKES, COMBO 3030**

- 59<sup>99</sup>** With Clevis. **HD3030C**
- 69<sup>99</sup>** With Clevis, Long Stroke. **HD3030C-LS**



**DIESEL PARTICULATE FILTERS**



- |  |  |   |   |
|--|--|---|---|
| <b>1629<sup>99</sup></b><br>Cummins.<br><b>HD0001</b>                  | <b>1749<sup>99</sup></b><br>Cummins.<br><b>HD0002</b>                  | <b>1719<sup>99</sup></b><br>Cummins.<br><b>HD0012</b>     | <b>1739<sup>99</sup></b><br>Cummins.<br><b>HD0017</b>     |
| <b>2169<sup>99</sup></b><br>Navistar / International.<br><b>HD0020</b> | <b>2159<sup>99</sup></b><br>Navistar / International.<br><b>HD0021</b> | <b>2079<sup>99</sup></b><br>Volvo/ Mack.<br><b>HD0024</b> | <b>1759<sup>99</sup></b><br>Volvo/ Mack.<br><b>HD0025</b> |

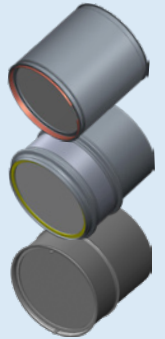

**VALVES - AIR TANK PRESSURE PROTECTION**



- 22<sup>99</sup>** 3/8 NPTM, 3/8 NPTF, Black. **AC157**
- 24<sup>99</sup>** 1/2 NPTM, 3/8 NPTF, Black. **AC159**
- 23<sup>99</sup>** 1/2 NPTM, 3/8 NPTF, Red. **AC160**
- 24<sup>99</sup>** 1/2 NPTM, 1/4 NPTF, Red. **AC192**

**264<sup>99</sup>**

Lift Axle control Modules, Air Actuated with Check Valve. **AC116**

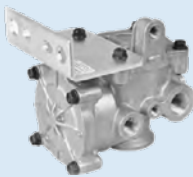

**3-WAY DASH VALVES**

**54<sup>99</sup> ea**

- 1/4 PTC, Fifth Wheel Slide. **AC182**
- 1/4 PTC, Suspension Dump. **AC183**



**ALUMINIUM FUEL TANK CAPS W/ THERMAL & PRESSURE RELIEF, VENTING**

- 39<sup>99</sup>** Float Style Fuel Tank Cap - 8NPLS, Venting, (Western Star), 3". **HD8110**
- 40<sup>99</sup>** Float Style Fuel Tank Cap - 5.5 Special, Venting (Kenworth), 3". **HD8120**



**3-WAY AIR TOGGLE VALVES W/FITINGS**

- 24<sup>99</sup>** 1/4 PTC, Application: Volvo, Kenworth. **AC170**
- 29<sup>99</sup>** Air-Electric with PTC Fittings, Application: Kenworth, Volvo. **AC173**





**ORDER ONLINE & WIN!**



**SIGN UP**



**MERITOR**

**ECU TCS  
2 VALVES**

**524<sup>99</sup> 759<sup>99</sup>**  
S4005001010 S4005001030

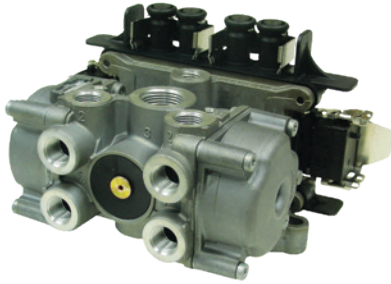

**52<sup>99</sup>**

Sensor Cable, Right Angle,  
0.9 m Long (3'). **955336**

**AUTOMATIC  
SLACK ADJUSTERS**

**69<sup>99</sup> ea** 10 Splines, 6". **R803106**  
28 Splines, 5.5". **R803110**  
28 Splines, 6". **R803112**



**SHOCK ABSORBERS**



**GAS-MAGNUM 60**



**35<sup>99</sup> 32<sup>99</sup> 33<sup>99</sup> 33<sup>99</sup>**  
66607 66608 66636 66893

**GAS-MAGNUM 65**



**53<sup>99</sup> 55<sup>99</sup> 54<sup>99</sup> 53<sup>99</sup>**  
65148 65416 65419 65490



**12<sup>99</sup>**

Anti-Seize  
Lubricant, Brush-  
Top Can, 454 g.  
**76764**



**0<sup>99</sup>**

Fifth Wheel  
Grease Pack  
Display.  
**01010**



**14<sup>99</sup>**

Right Stuff®  
Gasket  
Maker.  
**30874**



**11<sup>49</sup>**

High  
Temperature  
Thread  
Sealant,  
50 ml. **59234**



**12<sup>99</sup>**

Anaerobic Flange  
Sealant. **51550**



**THREADLOCKERS**

**20<sup>99</sup> ea**

Blue, Removable Strength, 36 ml. **24240**  
Red, Permanent Strength, 36 ml. **26240**





**319<sup>99</sup>**  
LED Rotating Beacon  
8 Yellow.  
126-67024A-8



**46<sup>99</sup>**  
Mirror Heated,  
7" X 16",  
with LED  
124-6364LED



**37<sup>99</sup>**  
Work Light, Hand inspect lamp LED  
recharg, 10" X 2.25". 151-77455XV

**LED WORKLIGHTS**

**31<sup>99</sup>**  
4.5", Round,  
9-Diode, 27W.  
300-390F-8



**55<sup>99</sup>**  
4.5" X 4.5",  
Square, Flood.  
300-3161F-8



**31<sup>99</sup>**  
4" X 4", Square,  
9-Diode, 27W.  
300-391F-8



**172<sup>99</sup>**  
5" X 5".  
123-LED63511-8



**LIFETIME WARRANTY\***

**AIR PASS MUD FLAPS**



**27<sup>99</sup>**  
24" x 24".  
N2424APF

**34<sup>99</sup>**  
24" x 30".  
N2430APF

**39<sup>99</sup>**  
24" x 36".  
N2436APF

**POLY FENDERS**  
24" Width, 76" Length.

**179<sup>99</sup>**  
Black. NF180PX

**249<sup>99</sup>**  
Yellow. NF180PX-6

**249<sup>99</sup>**  
Orange. NF180PX-4

**249<sup>99</sup>**  
Blue. NF180PX-7

**249<sup>99</sup>**  
Red. NF180PX-5

**319<sup>99</sup>**  
White. NF180PX-3

**LIFETIME WARRANTY\***



**342<sup>99</sup>**  
Silver. NF180PX-2

\* Contact Nu-Line for warranty details.



**HUBCAPS**



**16<sup>99</sup>** Steer Axle,  
6 holes. 1612  
**9<sup>99</sup>** Trailer Axle,  
6 holes. 1643

**SCOTSEAL PLUS XL**

**26<sup>99</sup>** Front Axle.  
35058

**26<sup>99</sup>** Trailer Axle.  
42627

**34<sup>99</sup>** Front Axle.  
43761

**25<sup>99</sup>** Trailer Axle.  
46300

**35<sup>99</sup>** Drive Axle.  
47691



**BEARING SETS**

**29<sup>99</sup>** 572/580. SET401

**31<sup>99</sup>** 592A/594A. SET403

**24<sup>99</sup>** HM212049,  
HM212011. SET413

**37<sup>99</sup>** HM218210,  
HM218248. SET414

**39<sup>99</sup>** HM518445,  
HM518410. SET415

**81<sup>99</sup>** 6461A/6420.  
SET423



**ORDER  
ONLINE  
& WIN!**



**SIGN UP**

**7-WAY SOCKET BREAKERS**

**6<sup>99</sup>**  
15-720



**20<sup>99</sup>**  
With 20 Amp  
Breaker, Sta-Dry®.  
15-762



**5<sup>99</sup>**  
7-Way Plug. 15-730



**PHILIPS**

**ARCTIC SUPERFLEX™  
CABLES**

**1<sup>99</sup>**  
7 Conductors, 1/12,  
6/14 ga. .570 O.D., 250'.  
3-623

**0<sup>69</sup>**  
2/14 ga. -65°C.  
3-653



**PERMACOIL CABLE  
ASSEMBLIES, ABS**

**87<sup>99</sup>**  
15', ABS,  
LECTRAFLEX®.  
30-2071

**81<sup>99</sup>**  
15'.  
30-4621



**TSE-REX** Rapid Exchange push rods

**TSE-REX™  
RAPID EXCHANGE PUSH  
RODS SYSTEMS WITH VCT™**

- 79<sup>99</sup>** 2.5" Stroke OMNI VCT TANDEM. 3030TVR2
- 84<sup>99</sup>** 3" Stroke OMNI VCT TANDEM. 3030TVR3
- 109<sup>99</sup>** 2.5" Stroke ULTRALIFE Plus VCT TANDEM. 3030TVR2ULP
- 116<sup>99</sup>** 3" Stroke ULTRALIFE Plus VCT TANDEM. 3030TVR3ULP

**SELF-SETTING  
AUTOMATIC  
SLACK  
ADJUSTERS**



**76<sup>99</sup>**  
*ea*

- Drive, 5.5" 28 Splines. 07100
- Curved, 6" 10 Splines. 07110
- Trailer, 6" 28 Splines. 07115
- Trailer, 6" 10 Splines. 07125
- Mack, 6" 28 Splines. 07130
- Trailer, 5.5" 28 Splines. 07135
- Trailer, 5.5" 10 Splines. 07140
- Drive, 5.5" 10 Splines. 07145
- Drive, 6" 28 Splines. 07155
- Drive, 5.5" 10 Splines. 07235

**PUSH ROD KITS**

Threaded Includes Jam Nut Installed

- 5<sup>59</sup>** 5.75" (B), Standard 5" trailer axle. K575
- 5<sup>59</sup>** 6.31" (B), SAF axle. K631
- 5<sup>59</sup>** 7.06" (B), Meritor large diameter axle. K706
- 6<sup>99</sup>** 9.75" (B), Intraax/Vantraax. K975
- 8<sup>99</sup>** 15" (B), Universal fully threaded. K150

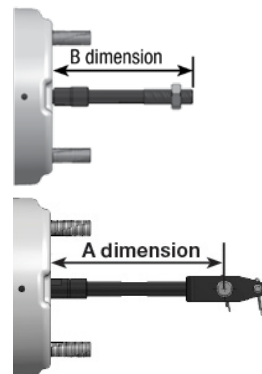

**PUSH ROD KITS, FIXED CLEVIS**

- 12<sup>99</sup>** 11" (A). K110-130
- 12<sup>99</sup>** 11" (A). K110-138
- 10<sup>99</sup>** 2.25" (A). K225-130
- 11<sup>99</sup>** 6.8" (A). K680-102
- 10<sup>99</sup>** 6.8" (A). K680-130
- 11<sup>99</sup>** 6.8" (A). K680-138





**STROBES**

- 97<sup>99</sup>** Pulsator® LED. 212650-02SB
- 127<sup>99</sup>** Pulsator® 551. 211820-02



**HANGER BEARING**

- 62<sup>99</sup>**
- 1710/SPL250.  
5003323



**U-JOINT ASSEMBLIES**

- 39<sup>99</sup>** 1710. 5-280X
- 87<sup>99</sup>** 1810. 5-281X
- 49<sup>99</sup>** 1710 H/R. 5-675X
- 95<sup>99</sup>** 1810 H/R. 5-676X
- 86<sup>99</sup>** SPL170-4X
- 127<sup>99</sup>** SPL250-3X



**National<sup>®</sup> Oil Seals**

**OIL BATH SEALS**

**GEN II**

- 28<sup>99</sup>** Rear Axle. 370003A
- 21<sup>99</sup>** Trailer Axle. 370025A



**5 STAR GOLD**

- 24<sup>99</sup>** Front Axle. 380001A
- 33<sup>99</sup>** Rear Axle. 380003A
- 24<sup>99</sup>** Trailer Axle. 380025A



**TANKER PRODUCTS AVAILABLE AT TW!**

CHEMICAL · PETROLEUM · PNEUMATIC · VACUUM





# ORDER ONLINE & WIN!



**1 SIGN UP**  
at [www.tworderandwin.com](http://www.tworderandwin.com)



**2 ORDER ONLINE**  
Every \$500 order made online gives you a chance to win



**3 WIN!**  
1 in 5 odds of winning

## POLY FENDER



**LIFETIME WARRANTY\***

**179<sup>99</sup>**

24" Width, 76" Length, Black.  
**NF180PX**



\* Contact Nu-Line for warranty details.

## EZ PEDAL CLUTCH



**699<sup>99</sup>**

15.5" X 2", Ceramic 6 Pad.  
**EZ208925-82H**



## STEEL WHEEL



**69<sup>99</sup>**

10 holes, 120 PSI,  
22.5" X 8.25", 73 lbs.  
**28408X**



## ALUMINUM WHEEL



**229<sup>99</sup>**

22.5" X 8.25",  
Machined.  
**AH22501-10M**



While we strive for accuracy in product description and pricing, we cannot be held responsible for technical or typographical errors which may appear in this flyer. Prices are subject to change without notice. Transportation expenses may apply. Environmental charges may apply to certain products. All taxes are extra. We reserve the right to limit quantities. Available at your TW distribution centre or on order.