

Post Size Tie Length	Item#	Bag Qty.	Case Qty.	Weight Each
-------------------------	-------	-------------	--------------	-------------

FENCE TIES (STEEL) – 12 GA. CUT & HOOKED – ZINC COATED

1 3/8" - 5 1/2"	15201	100	2,000	.02 lbs.
1 5/8" - 6 1/2"	15206	100	2,000	.02 lbs.
1 7/8" - 7 1/2"	15202	100	2,000	.02 lbs.
2 3/8" - 8 1/2"	15203	100	2,000	.02 lbs.
Barb Arms 12"	15221	100	2,000	.03 lbs.

FENCE TIES (STEEL) – 11 GA. CUT & HOOKED – ZINC COATED

1 5/8" - 6 1/2"	15210	100	2,000	.03 lbs.
1 7/8" - 7 1/2"	15212	100	2,000	.03 lbs.
2 3/8" - 8 1/2"	15214	100	2,000	.03 lbs.
2 7/8" - 9 1/2"	15215	100	2,000	.02 lbs.

FENCE TIES (STEEL) – 9 GA. CUT & HOOKED – ZINC COATED*

1 5/8" - 6 1/2"	15240	100	1,000	.04 lbs.
1 7/8" - 7 1/2"	15241	100	1,000	.04 lbs.
2 3/8" - 8 1/2"	15242	100	1,000	.05 lbs.
2 7/8" - 9 1/2"	15252	100	1,000	.05 lbs.

ALUMINUM – 9 GA. CUT & HOOKED

1 7/8" - 6 1/2"	15263	100	3,700	.01 lbs.
2 3/8" - 8 1/4"	15264	100	3,100	.02 lbs.
2 7/8" - 9 1/4"	15268	100	2,600	.02 lbs.
10 1/2"	15272	100	1,000	.02 lbs.

ALUMINUM – 6 GA. CUT & HOOKED

1 5/8" - 6 1/4"	15265	100	2,300	.02 lbs.
2 3/8" - 8 1/4"	15266	100	1,800	.03 lbs.

STRAIGHT STEEL TIES – ZINC COATED

12 GA. - 7"	15281		2,850	.02 lbs.
-------------	-------	--	-------	----------

*1.2 oz. zinc coating available – special order
– Call for pricing –

Size	Item#	Box Qty.	Box Weight
------	-------	-------------	------------

HOG RINGS – STEEL – ZINC COATED

12 1/2 GA.	15301	5,600	25 lbs.
9 GA. BOE	15290	2,700	25 lbs.
10 GA. #1	15302	3,300	25 lbs.
9 GA.	15303	2,100	25 lbs.
9 GA. Class III	15303-10	2,100	25 lbs.

HOG RINGS - ALUMINUM

9 GA.	15300	6,600	25 lbs.
-------	-------	-------	---------

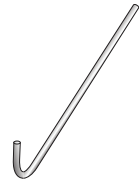
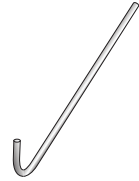

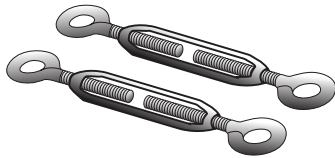
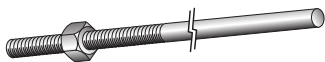
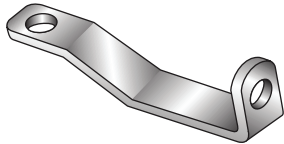
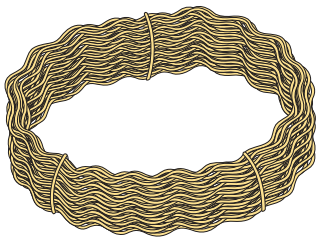
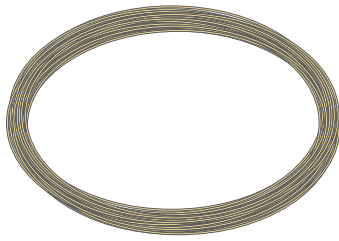

Size	Item#	Roll Weight	Feet Per Roll
------	-------	-------------	---------------

GALVANIZED TENSION WIRE

6 GA.	15401	100 lbs.	1,017
7 GA.	15402	100 lbs.	1,197
9 GA.	15403	100 lbs.	1,705
9 GA.	15403	50 lbs.	850
10 GA.	15404	100 lbs.	2,057
11 GA.	15405	100 lbs.	2,582
12 GA.	15406	100 lbs.	3,369
14 GA.	15407	100 lbs.	5,858
18 GA.	15408	100 lbs.	16,620

Sold in full rolls only

7 GAUGE GALVANIZED COIL SPRING

Commercial	15421	100 lbs.	1,197
------------	-------	----------	-------

15422 & 15423 meet ASTM A824 Type II and Galvanized per ASTM A817, Type II, Classes 3 & 4

Class 3 — 0.9 oz.	15422	100 lbs.	1,197
Class 4 — 1.2 oz.	15423	100 lbs.	1,197

Sold in full rolls only

Size	Item#	Sack Qty.	Weight Each
------	-------	-----------	-------------

TRUSS TIGHTENER

Heavy	15801	50	.70 lbs.
Pressed Steel	15802	50	.24 lbs.

TRUSS ROD – THREADED WITH NUT

5/16" x 10 1/2'	15701	25	2.90 lbs.
5/16" x 12'	15702	25	3.30 lbs.

Full 3/8" Truss Rod Import, 2 oz — Meets ASTM F 626

3/8" x 12'	15702-F626	25	4.73 lbs.
------------	------------	----	-----------

5/16" Truss Rod, Domestic, 1.2 oz — Meets ASTM F 626

5/16" x 12'	15702-F626D	25	3.30 lbs.
-------------	-------------	----	-----------

For 20 ft. rods, call for pricing.

TURNBUCKLE

5/16" x 3 1/2" Aluminum Body	15901	20	.30 lbs.
3/8" x 6" Galvanized Iron Body	15902	20	.50 lbs.

Item#	Size	Sack Qty.	Weight Each
-------	------	-----------	-------------

EYE BOLT, HOOK BOLT, BARBED WIRE STRETCH BOLT

15603	3/8" x 6" eye	100	.25 lbs.
15641	5/16" x 6" hook	100	.13 lbs.
15642	3/8" x 6" hook	100	.20 lbs.
15661	(5/16" x 5" Wire Stretching)	100	.11 lbs.



Galvanized with nuts

Item#	Size x Length	Hole Size	Qty Per Box
-------	---------------	-----------	-------------

LAG SHIELDS

25320	1/4" x 1"	1/2"	50
25322	3/8" x 1 3/4"	5/8"	50
25327	5/16" x 1 3/4"	1/2"	50
25328	3/8" x 2 1/2"	5/8"	50

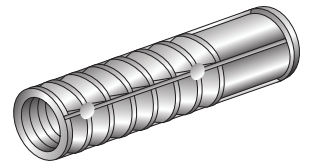

Use in conjunction with lag bolts (lag bolts not included)

Item#	Hole Size	Length	Qty Per Box
-------	-----------	--------	-------------

SLEEVE ANCHORS

25351	5/16"	1 1/2"	100
25352	3/8"	1 7/8"	50
25353	3/8"	3"	50
25349	1/2"	2 1/4"	25
25350	1/2"	3"	25
25348	1/2"	4"	25
25370	5/8"	3"	25

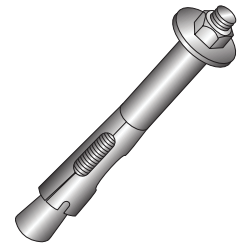

- No special tools needed
- Insert anchor
- Tighten with wrench

Item#	Size	Sack Qty.	Weight Each
-------	------	-----------	-------------

ROUND FENCE POST FLANGE WITH FOUR 1/4" HOLES

16820	For 1 3/8" O.D.	25	.60 lbs.
16821	For 1 5/8" O.D.	25	.64 lbs.
16822	For 1 7/8" O.D.	25	.80 lbs.
16823	For 2 3/8" O.D.	25	.96 lbs.



FENCE POST FLANGE – FLAT PLATE, GALVANIZED, 5/8" HOLES, 1/4" THICK

16830	6" x 6"	25	2.56 lbs.
16831	8" x 8"	25	4.56 lbs.
16825	3" x 6"	25	1.28 lbs.

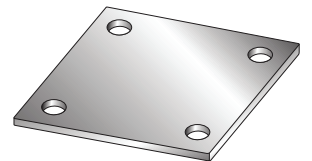

◇ Call for prices

LAG BOLTS

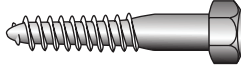

Size	Item#	Qty	Weight
		Per Box	Each
1/4" x 1 1/2"	10478	100	.021 lbs.
1/4" x 2"	10479	100	.027 lbs.
1/4" x 2 1/2"	10480	100	.032 lbs.
1/4" x 3"	10481	100	.038 lbs.
5/16" x 1 1/2"	10482	100	.037 lbs.
5/16" x 2"	10483	100	.046 lbs.
5/16" x 2 1/2"	10484	100	.055 lbs.
5/16" x 3"	10485	100	.064 lbs.
3/8" x 1 1/2"	10486	100	.053 lbs.
3/8" x 2"	10487	100	.066 lbs.
3/8" x 2 1/2"	10488	50	.078 lbs.
3/8" x 3"	10489	50	.091 lbs.
3/8" x 4"	10490	50	.116 lbs.
3/8" x 4 1/2"	10490-10	50	.129 lbs.
3/8" x 5"	10490-20	50	.141 lbs.
3/8" x 6"	10490-30	50	.166 lbs.
1/2" x 1 1/2"	10491	50	.110 lbs.
1/2" x 2"	10492	50	.133 lbs.
1/2" x 2 1/2"	10493	50	.155 lbs.
1/2" x 3"	10494	50	.178 lbs.
1/2" x 4"	10495	50	.112 lbs.
1/2" x 6"	10497	50	.157 lbs.

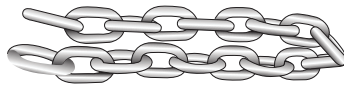

GALVANIZED CHAIN — PROOF COIL, UNTESTED

Size	Item#	Sack Qty.	Weight Each
3/16"	16001	250	100 lbs.
1/4"	16002	150	100 lbs.
5/16"	16003	100	100 lbs.

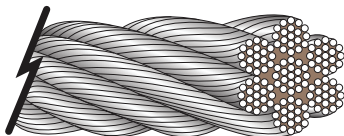

7 x 19

GALVANIZED CABLE — 3/8", 7 STRAND, COMMON CABLE

Size	Construction	Item#	Reel
			Quantity
3/8"	7 x 19	15430	500'
3/8"	1 x 7	15429-10	500'

Other quantities and diameters available on special order.

Meets specification RR-W-410E for wire rope.

AEROSOL SPRAY PAINT

Item#	Color	Size oz/can
83249	Silver	12
83233	Gloss White	12
83235	Semi-Gloss Black	12
83236	Gloss Black	12
83266	Grey Primer	12
83285	Rustoleum Red Oxide Primer	20
83286	Rustoleum 2185 Cold Galv.	20



BFC TOUCH-UP AIR DRY ACRYLIC ENAMEL

84610-BK05	Black BKO5	12
84610-GN13	Dark Green GN13	12
84610-BR21	Terra Brown BR21	12

Can be used on powder coated iron and chain link products

CEMENT — CONCRETE MIX

Item#	Size / Pallet Quantity
16126-94	Portland 94 lb. bag - 40 per pallet
16130-90	Concrete Mix 90 lb. bag - 35 per pallet
16130-60	Concrete Mix 60 lb. bag - 56 per pallet
16158-94	Quikrete Portland 94 lb. bag - 35 per pallet
16151-60	Red-E-Crete Concrete Mix 3500 PSI 60 lb. bag - 56 per pallet
16151-90	Red-E-Crete Concrete Mix 3500 PSI 90 lb. bag - 35 per pallet

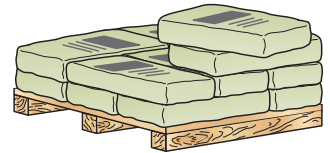

Add .50 per bag for delivery

QUICK SETTING GROUT 50 LB. PAIL — 36 PER PALLET

Item#	Brand
16119	ReadySet
16121	SuperSet
16122	Quik-Rok



16119



16121



16122

Quick setting grout, sets fence in 30 minutes.



Single Helical Coil

REGULAR SECURITY (BTO) - SINGLE COIL

BARBED TAPE OBSTACLE (BTO), STAINLESS STEEL WITH GALVANIZED CORE WIRE; 33 LOOPS PER ROLL

Size	Item#	Rolls Per Box	Roll Weight
18" Diameter SINGLE COIL	15525	5	11 lbs.
24" Diameter SINGLE COIL	15527	5	17 lbs.

- Coverage: 50' per roll with 18" attachment spacing.
- Single coil is available in 30" diameters.



Standard Barb

MEDIUM SECURITY (BTO) - MAZE (CONCERTINA)

REINFORCING MATERIAL .098 DIAMETER, GALVANIZED WIRE, CL III FIN 2. 76 BARBS, 3 CLIPS PER LOOP; 31 LOOPS PER ROLL
BARBED TAPE OBSTACLE (BTO), STAINLESS STEEL

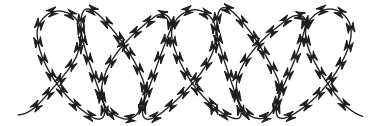

Maze (Concertina)

Size	Item#	Rolls Per Box	Roll Weight
18" Diameter CONCERTINA CROSS TYPE WIRE (CB-65)	15548-S Galv.	4	11 lbs.

- Coverage: 15' per roll with 12" attachment spacing, 3 clips, 31 loops

CONCERTINA CROSS TYPE WIRE (CB-65)

24" Diameter CONCERTINA COIL	15543	5	17 lbs.
---------------------------------	-------	---	---------

- Coverage: 20' per roll with 16" attachment spacing. 3 clips, 31 loops.

HIGH SECURITY (BTO) - SUPERMAZE

BARBED TAPE OBSTACLE (BTO), STAINLESS STEEL TAPE, 12" SPACING, 5 CLIPS PER LOOP; 51 LOOPS PER ROLL

Size	Item#	Rolls Per Box	Roll Weight
30" Diameter Concertina Coil			

STAINLESS CORE WIRE	15545	3	32 lbs.
GALVANIZED CORE WIRE	15545-SGALV	3	32 lbs.

- Coverage: 25' per roll with 12" attachment spacing. 5 clips, 51 loops.
- Double Coil (24"/ 30") is available along with many other sizes & combinations.

BARBED WIRE — 5" x 12 1/2 GA

Style	Item#	Weight	Feet Per Roll
Domestic			
2 point - Class I	15497	78 lbs.	1,320
4 point - Class I	15498	85 lbs.	1,320
4 point - Class III	15500	85 lbs.	1,320
Imported			
2 point	15521	78 lbs.	1,320
4 point	15522	85 lbs.	1,320

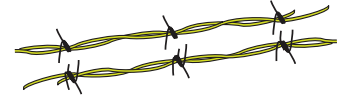

BARBLESS BARBED WIRE — 12 1/2 GA

Domestic			
Barbless - Class I	15506	60 lbs.	1,320
Imported			
Barbless	15524	60 lbs.	1,320

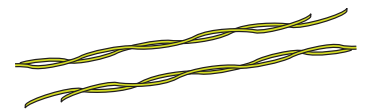

Style	Item #	Bundle Weight
-------	--------	---------------

FENCE STAYS — 9 1/2 GA.

36"	15531	34 lbs.
42"	15532	38 lbs.
48"	15533	42 lbs.

FENCE STAYS — 9 1/2 GA. Class 3 Zinc

36"	15531-10	34 lbs.
42"	15532-10	38 lbs.
48"	15533-10	42 lbs.

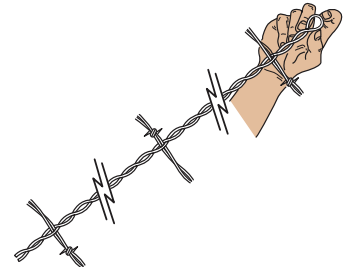

NIXALITE BIRD CONTROL

Style	Item#	Description
Model S Nixalite	15558	4' strips only

Mounting hardware included: 2 clips and washers per 4' piece with 2 drive screws for steel or iron. Other nails or screws may be required to mount on other surfaces.

Other models available: Contact your sales representative.

These stainless steel needle strips are long lasting, easy to install and virtually maintenance free. Used for small birds, swallows, pigeons, and seagulls. Excellent human intruder deterrent.

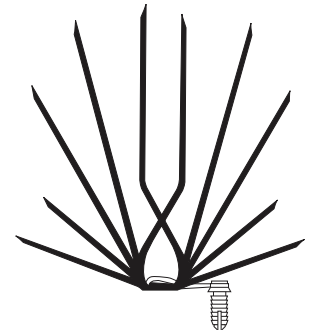

Material: 302 stainless steel **Other Lengths:** 24", 16", 12"
Base Strip: 1/4" wide, flexible by special order

1265 N. CUYAMACA ST. EL CAJON, CA 92020 619-449-0333	13111 DAHLIA ST. FONTANA, CA 92337 909-350-9040	8530 UNSWORTH AVE. SACRAMENTO, CA 95828 916-381-4065	8937 SAN FERNANDO RD. SUN VALLEY, CA 91352 818-504-3700	10010 PORTLAND AVE. TACOMA, CA 98445 253-535-5500
--	---	--	---	---

BottomLock

82 Slats Per Bag

LiteLink

DECORATIVE VERTICAL CHAIN LINK SLAT
1 Bag = 10 feet

ECONOMICAL VERTICAL CHAIN LINK SLAT
1 Bag = 10 feet

BottomLock & LiteLink both use bottom rail lock

7 STANDARD COLORS — PDS is available in:

Brown (10) Tan (50) Redwood (40) White (20) Green (30) Black (70) Gray (90) Sky Blue (60)

Sky Blue (60) & Royal Blue (602) — Available by special order only.

All 3½ foot heights are now the same price as 4 foot heights.

Item#	Fence Height	Wt (lbs) Per Bag
61180	3'	7
61181	3½'	8
61182	4'	9
61183	5'	11
61184	6'	13
61185	7'	15
61186	8'	17
61187	10'	22
61188	12'	26

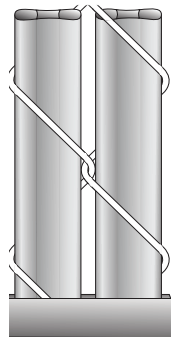

- Slat width 1-3/32" wide slat fits both
- 11 GA. and 9 GA.
- Manufacturer's 25-year limited warranty
- Slat is 3½" short of nominal length

Item#	Fence Height	Wt (lbs) Per Bag
61162	3'	4
61163	3½'	5
61164	4'	6
61165	5'	7
61166	6'	9
61167	7'	10
61168	8'	11
61169	10'	14
61170	12'	17

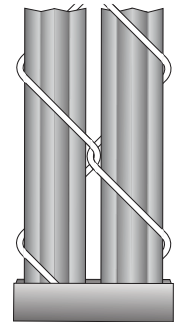

- One convenient size works for
- 9, 11, 11½ and 12 gauge wire
- Shipped in a compact 2" high by 6" wide box
- Slat is 3½" short of nominal length

Item#	Fence Height	Wt (lbs) Per Bag
61101	3'	8
61102	3½'	9
61103	4'	10
61104	5'	12
61105	6'	14
61106	7'	16
61107	8'	18

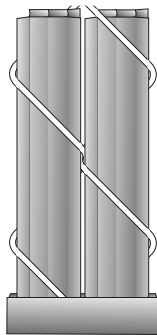

- Maximum height is 8'
- Bottom leveling channel
- Manufacturer's 25-year limited warranty
- Slat is 3½" short of nominal length

Item#	Fence Height	Wt (lbs) Per Bag
60703	3'	8
60702	3½'	9
60704	4'	10
60705	5'	12
60706	6'	14
60707	7'	16
60708	8'	18

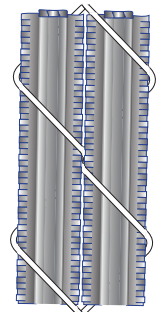

- For heights exceeding 8',
- 2 half sizes are recommended
- No locking systems needed
- Manufacturer's 25-year limited warranty
- Slat is 2" short of nominal length

PLASTICLINK SLATS — 2 3/8" WIDE

Item#	Fence Height	Wt (lbs) Per Bag
60724	4'	32
60725	5'	40
60726	6'	47
60727	7'	55
60728	8'	62
60730	10'	77
60732	12'	90

- Priced per bag
- 106 pieces per bag = 25 foot coverage
- Manufacturer's 25-year limited warranty
- Available in less bag quantities
- Call for pricing: Item #50348-

HEDGELINK

Item#	Fence Height	Wt (lbs) Per Box
61116	4'	18
61117	5'	23
61118	6'	27
61119	7'	32
61119-10	8'	36
61119-120	10'	45
61115	12'	54

- One size fits both 2" and 2 1/4" mesh
- 10 lineal ft per box / 82 Hedge-Slats per box
- 16 ga. braided galv. wire / 3-mil PVC green
- DO NOT MIX Hedge-Link with any other Hedge product

SAFETY TOP CAP

Item#	Feet
61155-80	40 - 2,000'
	2,000' +

- Stocking Colors: Yellow only
- 40' per bag / 5 pieces at 8' each with 3 hole punched with 15 hog rings.
- 25 lbs. per bag.

- Available by special order only:

Red (45) White (20) Green (30)
Dark Blue (602) Brown (10) Black (70)

- 6 week lead time.

- Additional charge for special color

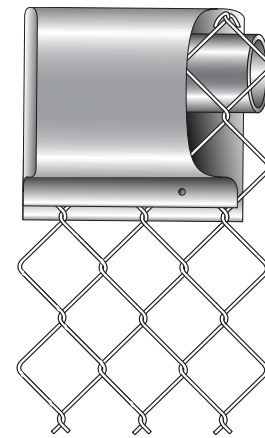

Safety Top Cap

CORRUGATED STEEL SHEET, 28 GAUGE

Item#	Size	Bundle Qty.	Weight Each
16839	6' x 26"	150	8.4 lbs.
16840	8' x 26"	150	11.2 lbs.
16841	10' x 26"	100	14.0 lbs.
16842	12' x 26"	100	16.8 lbs.

- 26 gauge available on special order

Mesh Designs



WOOD SNOW FENCE

Item#	Height	Description	Feet Per Roll	Weight Per Roll
50313-048	4'	Stained FLAT TOP	50	74 lbs.

Approx. Mesh Size [•] Call for quantity discounts
ALPI - 3" x 1 1/2"

ALPI 4' — SAFETY & SHOW FENCING

44501	4'	Orange - 4' ALPI	100	28 lbs.
-------	----	------------------	-----	---------

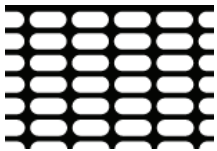

4' BARRIER FENCE ROLLS - ORANGE

44517-ORN	4' x 1 1/2" x 2 1/2"	Mesh	100	11 lbs.
44514-ORN	4' x 3 1/2" x 1 1/2" BEACON PLUS	Mesh	100	12.3 lbs.

HIGH DENSITY
POLYETHYLENE

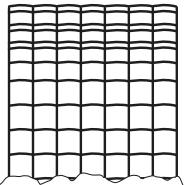

Debris Net

DEBRIS NET ROLLS - HIGH DENSITY POLYETHYLENE

44550-10	4'	Orange	150	17 lbs.
----------	----	--------	-----	---------

- Heavy reinforced selvage edges top & bottom
- Versatile Fabric
- Crowd control
- Other colors available: Red (15) Dark Green (20) Bright Blue (25) Black (30)

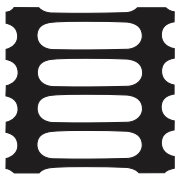

Mesh Size
3" x 1 1/2"

NORDIC PLUS II — SNOW FENCE

44532	4'	Orange - 4'	100	46 lbs.
44532-10	4'	Black - 4'	100	46 lbs.



Mesh Size
1 1/2" x 1 1/2"

SENTRY SECURA — SAFETY FENCE — DIAMOND PATTERN

44260	4'	4' Orange Diamond mesh	50	30 lbs.
44262	6'	6' Orange Diamond mesh	50	45 lbs.

- Sentry Secura is also available in 5'

WINDSCREENS FOR

Outdoor Tennis Courts Indoor Tennis Courts Yard Fences
Baseball Fields Overhead Shade Crowd Control Snow Fences

OPEN, CLOSED POLYPROPYLENE WINDSCREEN

Open Mesh

Item# 60600- B (Black) G (Green)

Open Mesh available in 6', 9', 12'; special heights on request:

Closed Mesh

Item# 60601- B (Black) G (Green)

Closed Mesh available in 6', 9', 12'; special heights on request:

Characteristics: A light-weight material with less than 1% shrinkage, initial high tensile strength and the greatest abrasive resistance. Black color has extra long life due to greater ultraviolet resistance and can be used for shade.

POLYETHELENE STANDARD PRIVACY ROLLS

		Roll Length	Height
Item#	60600-15	150'	5' 8"
Item#	60600-20	150'	7' 8"

- Can be cut on site.
- Standard Privacy Rolls — About 90% density with a woven edge.

VINYL WINDSCREEN

Item# 60602-

13 - ounce available in 5', 7'6", 10' (5' is seamless).

Color: (B) Black, (G) Green

Characteristics: A solid opaque material giving privacy with sound-reflecting qualities.

A deluxe fabric for indoor or outdoor courts.

13 - ounce available in 6', 8'11", 11'11" (6' is seamless).

Color: Gray, Blue, Brown, Beige, White, Black, Gray (Special heights quoted upon request).

STANDARD FEATURES ON WINDSCREEN PRODUCTS

Reinforced hems, brass grommets every foot, no special cutting price for gates, transoms, or short panels.

1265 N. CUYAMACA ST. EL CAJON, CA 92020 619-449-0333	13111 DAHLIA ST. FONTANA, CA 92337 909-350-9040	8530 UNSWORTH AVE. SACRAMENTO, CA 95828 916-381-4065	8937 SAN FERNANDO RD. SUN VALLEY, CA 91352 818-504-3700	10010 PORTLAND AVE. TACOMA, CA 98445 253-535-5500
--	---	--	---	---

OPTIONAL FEATURES ON WINDSCREEN PRODUCTS

Item#
60604-00
Reinforcing tape — A horizontal tape with grommets every foot is recommended for panels over 6' in height. Tape is centered.
60605-00
Windholes — Vents located in top half of panels every 10' on center. (a) Rectangular reinforced holes for polypropylene. (b) Circular reinforced holes for solid vinyl and polyester.
60606-00
Tabs — A flap with grommets sewn on the back of panels.

NETTING

Barrier Netting available in 25' x 100', 25' x 150', 6'6" x 150' and 12'6" x 150' bales.

Item#	Size
60612-10	25' x 100'
60612-15	25' x 150'
60612-05	6'6" x 150'
60612-20	12'6" x 150'

Color: Dark Green

Characteristics: 1" mesh olefin fibers for use at golf courses, baseball fields, etc.

All Purpose Netting available in custom sizes.

Color: Black

Characteristics: Heavy-duty 1 7/8" square nylon weather-treated netting for baseball cages and all other athletic areas.

Bound on all four sides with 1/4" polypropylene black rope.

ATTACHING MATERIALS

#1503	Wire rope for lacing center tape (250' length)
#1504	Polyethylene lacing for perimeter