

The following information has been provided to show minimum requirements for permit quality drawings. Drawings are to be to scale and provide enough information to build the structure and confirm code and city regulation compliance. Graph paper is acceptable. See [Deck Renovation Bulletin](#).

Site Plans

Site plans must show setbacks, buildings and structures so that zoning regulations pertaining to lot coverage and setbacks to property lines can be reviewed.

Zoning Bylaw

Please refer to the appropriate zone designation for required setbacks and lot coverage restrictions.

Section 4.9 Yards and Projections

*Note: covenants, easements and rights-of-ways should also be indicated on the site plan. See [Deck Renovation Bulletin](#). This information can be obtained through a title search, which can be obtained through [BC Land Title and Survey \(LTSA\)](#) webpage or 1-877-577-5872.

Surveys and Existing Records

The Building Department may require a survey prepared by a certified professional to confirm existing setbacks, covenant boundaries or easements.

Existing records may be obtained from Development Services to assist in determining sitting or existing permit records. Visit [Property File Information](#) on our website or contact 250-490-2501 for more information.

For all requests be sure to provide the [Request Form](#). Fees to request files, copying and for File Search Letters (Comfort Letters) will be required accordingly. Please allow a minimum of 1 business day to review your file. You will be contacted when it is ready to be viewed.

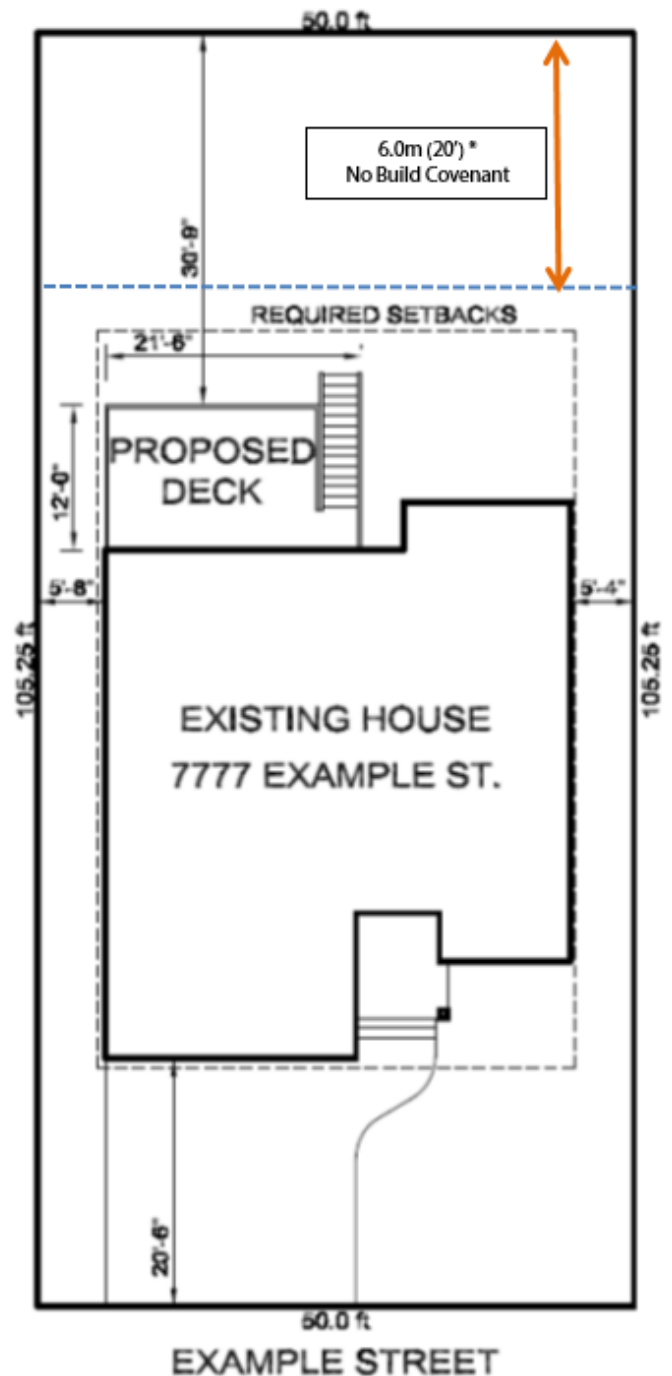

Site Plan example
Scale 1:200m or 1/16" minimum

Foundation Plan

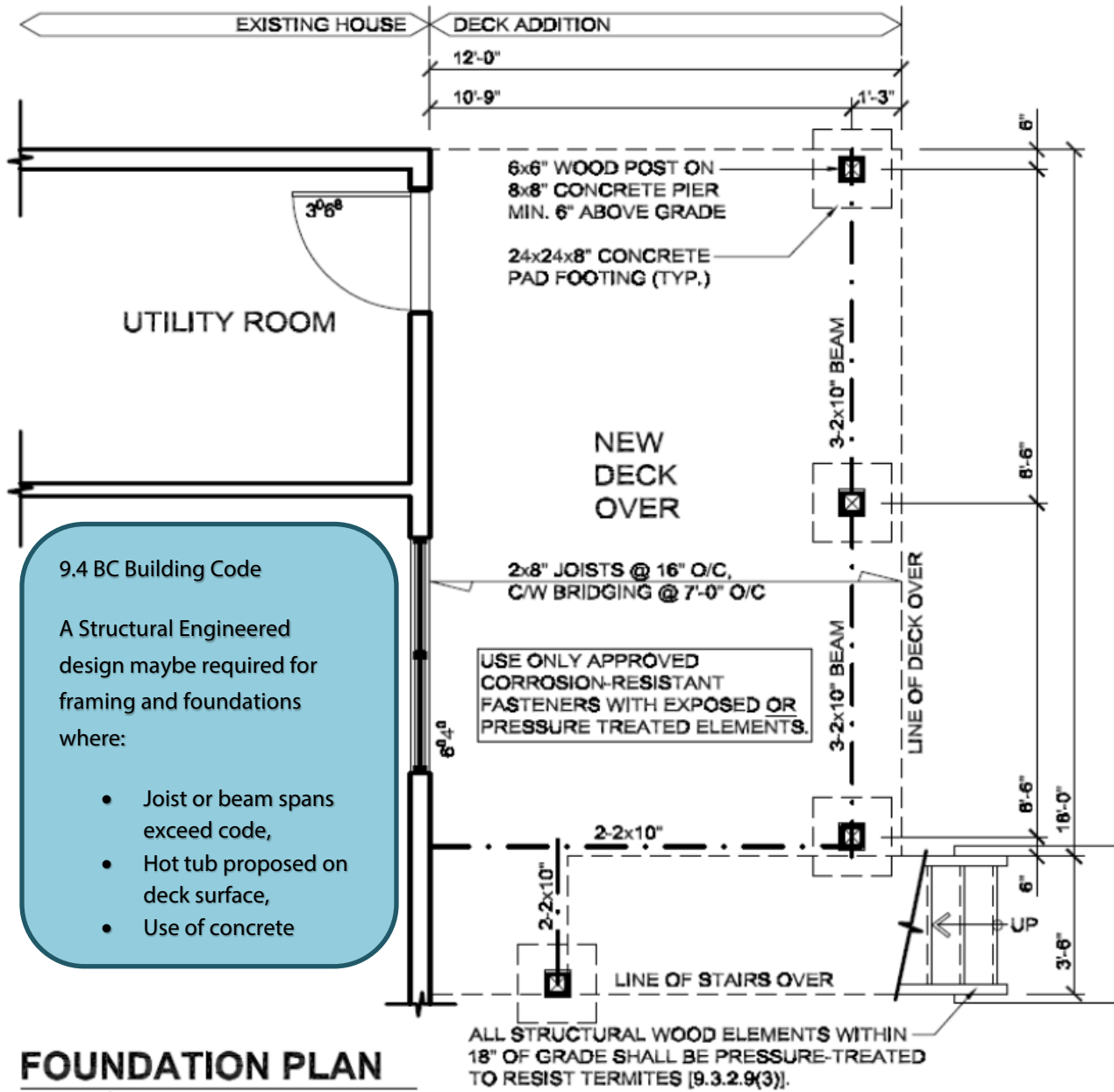

Deck Plan

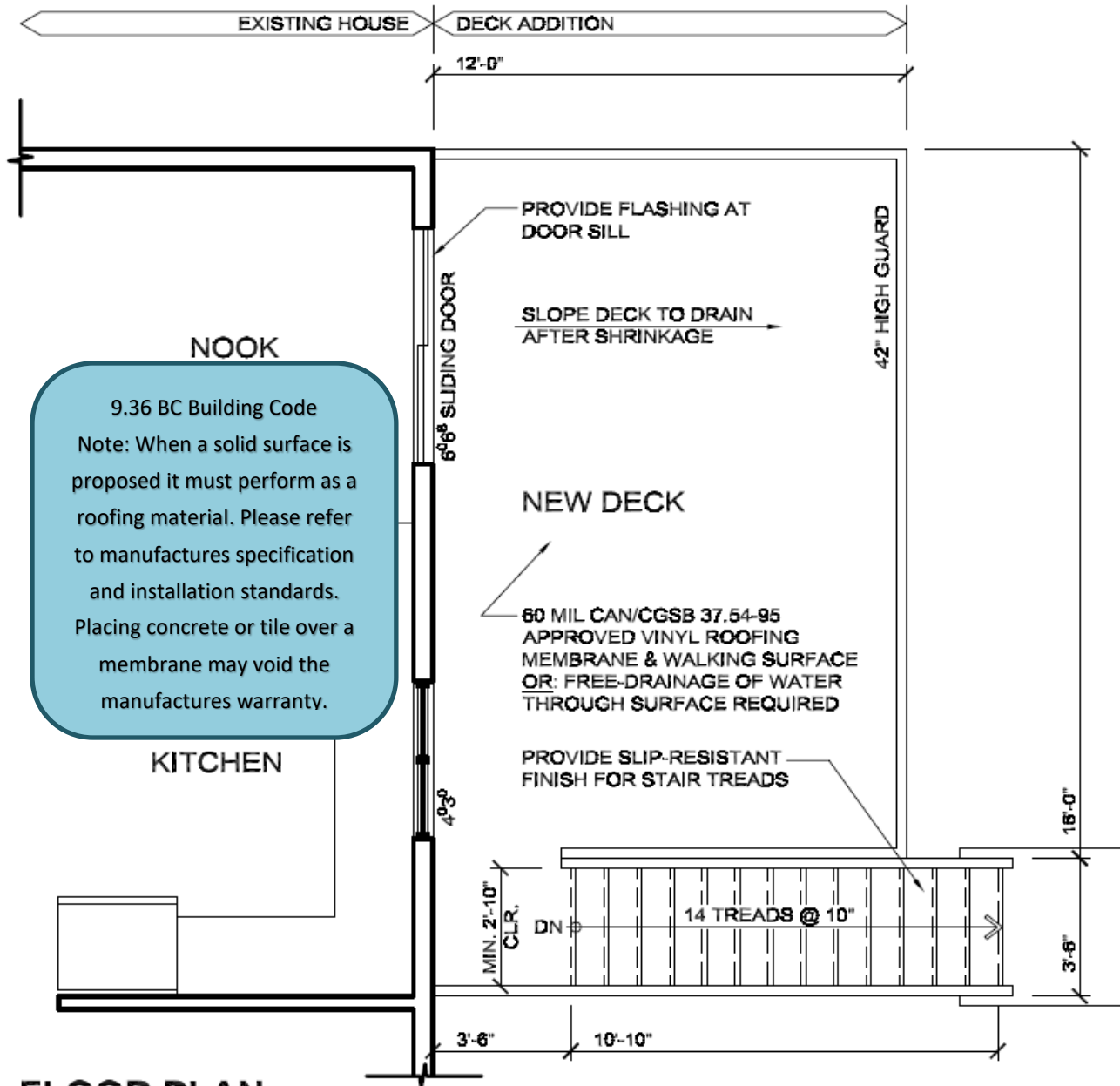

9.36 BC Building Code
 Note: When a solid surface is proposed it must perform as a roofing material. Please refer to manufactures specification and installation standards. Placing concrete or tile over a membrane may void the manufactures warranty.

FLOOR PLAN

SCALE: 1/4" = 1'-0"

**Note: Actual plans must be drawn on minimum 11x17" size paper. Plans must NOT be drawn on graph or lined paper.

Cross Section

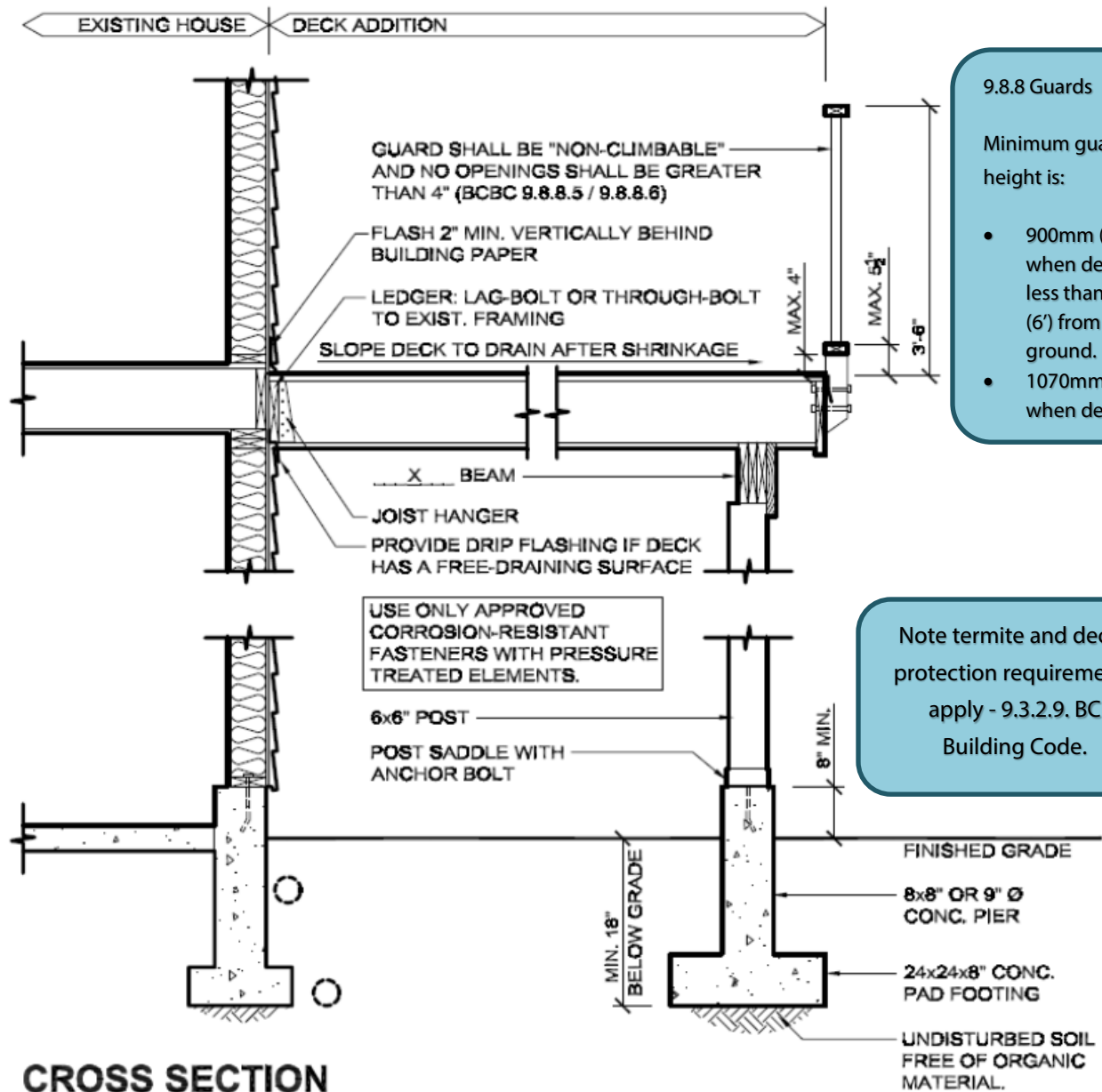

9.8.8 Guards

Minimum guard height is:

- 900mm (36") when deck less than 1.8m (6') from ground.
- 1070mm (42") when deck

Note termite and decay protection requirements apply - 9.3.2.9. BC Building Code.

CROSS SECTION

SCALE: 1/8" = 1'-0"

9.8.8.2 Glass Guards

The use of glass as the main structural component of a guard must be designed by an Engineer. See [Glass Guardrail Bulletin](#).

Vented Deck Assembly

This is an example only. The City of Penticton takes no responsibility for the design or the compliance with the BCBC.

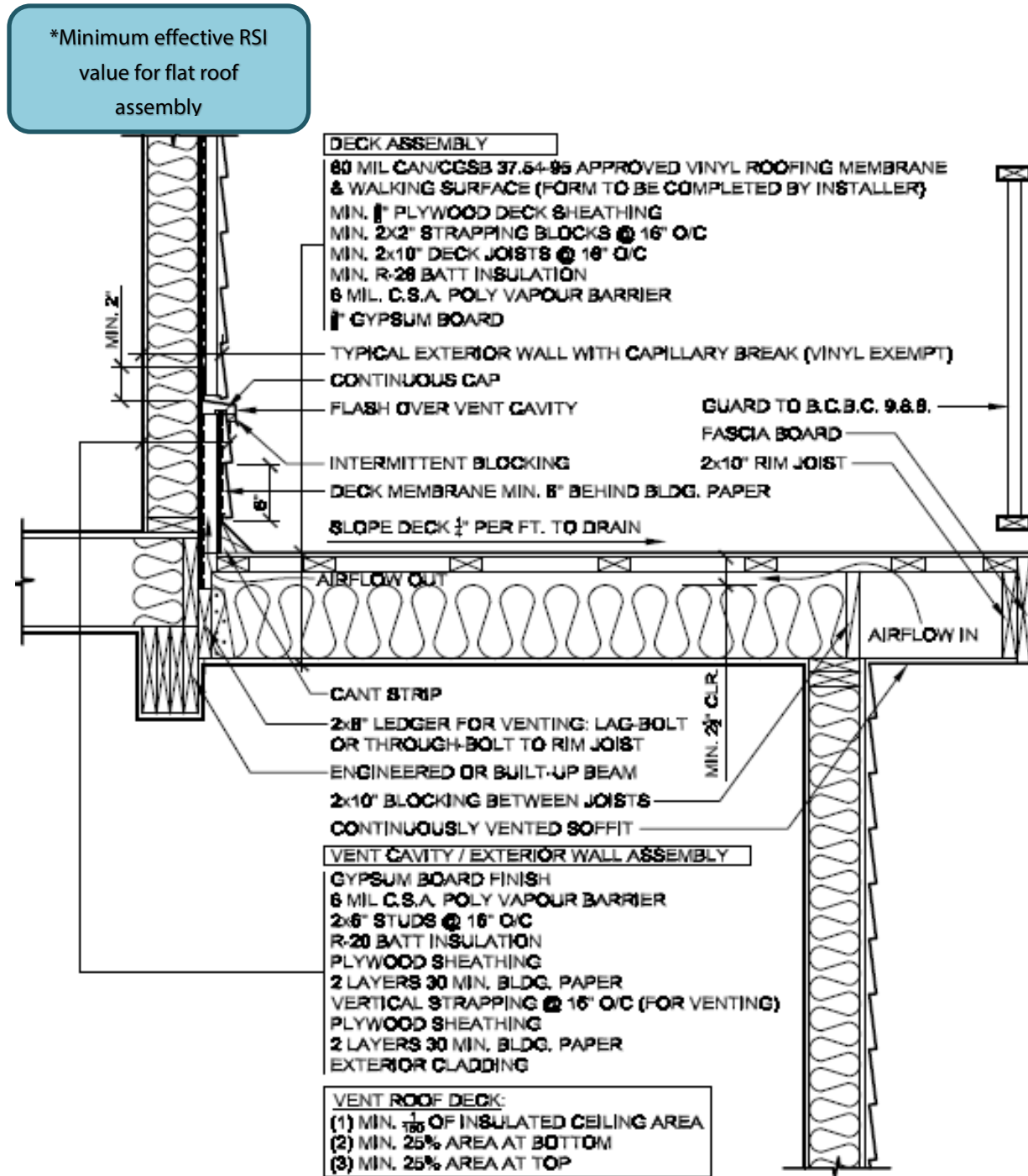

Deck Drawing Examples

Please note: Building Bulletins and handouts are prepared to provide convenient information for customers, and should not be considered a replacement for reviewing the bylaw or associated legal documents. If there is any contradiction between this guide and relevant municipal bylaws and/or applicable codes, please refer to the bylaws and/or codes for legal authority.