

# BURNDY® STOCKING PACKAGE



Hi-Line Utility Number	BURNDY Number	Description
------------------------	---------------	-------------

**Tools**

BYHIW716ENF	HIW716ENF	ENFORCER® Hydraulic Impact Wrench with 7/16 Quick Chuck
BYPAT444SLI	PAT444SLI	PATRIOT® 11-Ton C-Head Dieless Battery Actuated Crimper
BYPAT46LWSLI	PAT46LWSLI	PATRIOT® 15-Ton C-Head Battery Actuated Hydraulic Crimper
BYPAT750LI	PAT750LI	PATRIOT® 12-Ton C-Head Battery Operated Crimper
BYPATCUT129LI	PATCUT129LI	PATRIOT® Battery Actuated Cable Cutter, ACSR/CU/AL, Latch Head
BYPATCUT1500LI	PATCUT1500LI	PATRIOT® Battery Actuated Cable Cutter, for Copper (hard drawn) up to 750 kcmil, Copper (soft drawn) 1000 kcmil, Aluminum 1500 kcmil
BYPATCUT2156LI	PATCUT2156LI	PATRIOT® Battery Actuated Cable Cutter, ACSR/AL/CU/REBAR/EHS, Latch Head
BYPATCUT245LI	PATCUT245LI	PATRIOT® Battery Actuated Cable Cutter, 2.45" CU/AL, Latch Head
BYPATMD14603A1	PATMD14603A1	PATRIOT® IN-LINE® 6-Ton Tool, Crimp Jaw (BG/D3 grooves); ACSR & GUY Cut Jaws; (2) Makita 3.0Ah Batteries; 120V AC Charger
BYPATMD34603A1	PATMD34603A1	PATRIOT® IN-LINE® 6-Ton Tool, Crimp Jaw (O/D3 grooves); ACSR & GUY Cut Jaws; (2) Makita 3.0Ah Batteries; 120V AC Charger
BYPATMD68LW	PATMD68LW	PATRIOT® IN-LINE® 6-Ton Tool, Crimp Jaw (O/D3 grooves); (2) Makita 3.0Ah Batteries; 120V AC Charger
BYPATMD68LWWCJ	PATMD68LWWCJ	PATRIOT® IN-LINE® 6-Ton Tool, Crimp Jaw (O/D3 grooves); ACSR Cut Jaw, (2) Makita 3.0Ah Batteries; 120V AC Charger
BYPATMD6LW	PATMD6LW	PATRIOT® IN-LINE® 6-Ton Tool, Crimp Jaw (BG/D3 grooves); (2) Makita 3.0Ah Batteries; 120V AC Charger
BYPATMD6LWWCJ	PATMD6LWWCJ	PATRIOT® IN-LINE® 6-Ton Tool, Crimp Jaw (BG/D3 grooves); ACSR Cut Jaw, (2) Makita 3.0Ah Batteries; 120V AC Charger
BYPATMDCUTGLWJAW	PATMDCUTGLWJAW	PATRIOT® IN-LINE® 6-ton EHS Guy Wire Cut Jaw; cuts up to 3/8"
BYPATMDCUTLWJAW	PATMDCUTLWJAW	PATRIOT™ IN-LINE™ 6-ton ACSR Cut Jaw, cuts up to 556.5
BYY35	Y35	12-Ton Self-Contained Compression Tool
BYY60LW	Y60LW	60-Ton Remote Compression Head, with Base

**P Dies**

BYP342	P342	Compression Die, 15-Ton, Index 342
BYP34ART	P34ART	Compression Die, 15-Ton, Index 300
BYP39ART	P39ART	Compression Die, 15-Ton, Index 301
BYP39RT	P39RT	Compression Die, 15-Ton, Index 24
BYP40ART	P40ART	Compression Die, 15-Ton, Index 474
BYP40RT	P40RT	Compression Die, 15-Ton, Index 25
BYP44ART	P44ART	Compression Die, 15-Ton, Index 302
BYP44RT	P44RT	Compression Die, 15-Ton, Index 27
BYP724	P724	Compression Die, 15-Ton, Index 724
BYPKR	PKR	Compression Die, 15-Ton, Index KR
BYPU998	PU998	Compression Die, 12-Ton, Index 998
BYPUADP-1	PUADP-1	U-Die Adapter, For Use in 15-Ton Tool

Hi-Line Utility Number	BURNDY Number	Description
------------------------	---------------	-------------

**U Dies**

BYU168	U168	Compression Die, 12-Ton, Index 168 208
BYU249	U249	Compression Die, 12-Ton, Index 249
BYU28ART	U28ART	Compression Die, 12-Ton, Index 298
BYU28RT	U28RT	Compression Die, 12-Ton, Index 15
BYU31ART	U31ART	Compression Die, 12-Ton, Index 299
BYU31RT	U31RT	Compression Die, 12-Ton, Index 18
BYU34ART	U34ART	Compression Die, 12-Ton, Index 300
BYU34RT	U34RT	Compression Die, 12-Ton, Index 20
BYU39ART-2	U39ART-2	Compression Die, 12-Ton, Index 936
BYU39RT	U39RT	Compression Die, 12-Ton, Index 24
BYU654	U654	Compression Die, 12-Ton, Index 654
BYU655	U655	Compression Die, 12-Ton, Index 655
BYU997	U997	Compression Die, 12-Ton, Index 997
BYUC	UC	Compression Die, 12-Ton, Index C
BYUD	UD	Compression Die, 12-Ton, Index D
BYUD3	UD3	Compression Die, 12-Ton, Index D3
BYUDIEKITCU	UDIEKITCU	Die Kit, 15 Sets 12-Ton U-Dies, For Copper
BYUN	UN	Compression Die, 12-Ton, Index N
BYUO	UO	Compression Die, 12-Ton, Index O

**W Dies**

BYW161	W161	Compression Die, 6-Ton, Index 161
BYW163	W163	Compression Die, 6-Ton, Index 163 505
BYW164	W164	Compression Die, 6-Ton, Index 164 275
BYW165	W165	Compression Die, 6-Ton, Index 165 205 287 339
BYW166	W166	Compression Die, 6-Ton, Index 166 206 459
BYW243	W243	Compression Die, 6-Ton, Index 243
BYW245	W245	Compression Die, 6-Ton, Index 245
BYW26RT	W26RT	Compression Die, 6-Ton, Index 13
BYW28K	W28K	Cutting Die, 4-4/0 ACSR/CU/AL, For 6-Ton
BYW2CRT	W2CRT	Compression Die, 6-Ton, Index 10
BYW31ART	W31ART	Compression Die, 6-Ton, Index 299
BYW5CRT	W5CRT	Compression Die, 6-Ton, Index 7
BYW660	W660	Compression Die, 6-Ton, Index 660
BYW702	W702	Compression Die, 6-Ton, Index 702
BYWDIEKITAL	WDIEKITAL	Die Kit, 12 Sets 6-Ton W-Dies, For Aluminum
BYWDIEKITCU	WDIEKITCU	Die Kit, 12 Sets 6-Ton W-Dies, For Copper
BYWK737	WK737	Compression Die, 6-Ton, Index 635
BYWKK	WKK	Compression Die, 6-Ton, Index KK

# IMPORTANT NOTES:

Unless noted, product is not recommended for use on energized lines.

## Notes for battery operated crimpers and cutters:

It is recommended that battery be removed when changing jaws, changing dies or storing tool in case.

Select battery operated tools are available in alternate versions :

- Nickel Metal Hydride
- AC
- DC
- 250 Volt

Contact Customer Service for further information:

US: 1-800-346-4175

Canada: 1-800-387-6487

International: 1-603-647-5299

## Battery Tool Accessories:

BAT18VLI: 3.0Ah Li-Ion battery  
BAT18V5AHLI: 5.0Ah Li-Ion battery  
PATCHGRIL: 120V-AC Charger  
PATCHGRILDC: 12/24V-DC Charger

PT208620: Lanyard  
PT10074020: Wrist Strap for PATMDLW

W28K (6-ton): Cutter die, 4-4/0 CU/AL, ACSR  
WDA8300 (6-ton): Range taking die, 4-500 CU Str. and #2-4/0 CU Flex  
WDC4500 (6 ton): Range taking die, #8-300 AL, #6-400 CU Str, and #2-4/0 CU Flex

P15K (15-ton): Cutter die, max. diameter 1.2"  
PUADP1 (15-ton): U-die Adapter



**PATRIOT® SERIES with EP★ ENHANCED POWER**

BURNDY® PATRIOT® Tools are designed to accept an expanded range of Makita 18V Lithium-Ion Batteries, identified by Makita Star Power. Multi-Ah Capability provides the user with more choices and flexibility than ever before. Accepts large capacity 6Ah to smaller capacity 2Ah batteries.

More **POWER**, More **FLEXIBILITY**, More **PRODUCTIVITY**

## PLEASE NOTE:

Prior models, tools **WITHOUT** the EP Enhanced Power mark, will only accept Makita 18V 3.0Ah batteries.

**Do not force any other size battery into the tool.**  
**Damage caused by doing so will void the warranty.**



Stocking Package, Tools & P Dies .....	2
Stocking Package, U & W Dies .....	3
Important Notes .....	4
Battery Tool Accessories .....	4
Battery Crimpers	
PAT46LWS, 15 Ton, C-Head .....	6
PAT750, 12 Ton, C-Head .....	7
PAT444S, 11 Ton, C-Head, Dieless .....	8
PATMD-LW, 6 Ton, IN-LINE®, Scissor Action .....	9
Hand Operated Crimpers	
Y35, 12 Ton, C-Head .....	10
Remote Operated Crimpers	
Y60LW, 60 Ton, Latch Head .....	11
12 Ton U Dies	
For 35 and 750 Tool Series; 46 Series with PUADP1 Adapter .....	12
12 Ton U Die Kits; Copper, Aluminum, Copper Wide, HYGROUND® .....	13
W Dies	
For MD/PATMD, 500, and 600 Series .....	14
W Die Kits; Copper, Aluminum .....	15
Battery Cutters	
PATCUT2156, 10 Ton, Latch Head .....	16
PATCUT129, 7 Ton, Latch Head .....	17
PATCUT245, 6 Ton, Latch Head .....	18
PATMDCUTLW, 6 Ton, Scissor Action .....	19
PATMD-LW ACSR Kits, 6 Ton, Scissor Action .....	20
PATMD-LW GUY Kits, 6 Ton, Scissor Action .....	21
PATCUT1500, Mechanically Driven, CU/AL .....	22
Hydraulic Impact Wrenches	
HIW-ENF Variable Torque, 7/16" Quick Chuck .....	23
PATMD-LW Custom Configuration Brochure	
Custom Configurations Template .....	24
Features & Benefits Graphic .....	25
Specifications & Capacities Tables .....	26
Interchangeable Jaws & Accessories .....	27
Reference Section	
Expanded Ranges	
444S and 644 Series, 11 Ton .....	29
Die Index Reference .....	30
Policies	
Tool Center .....	31
Limited Warranty .....	31
Repair Policy .....	31
Return Procedure .....	31



Battery Crimpers



Die Sets



Hand Operated Crimpers



Remote Powered Crimpers



Battery Cutters



## **PATRIOT® 15 Ton, C-Head**

Hydraulic Self-Contained, 18V Lithium-Ion

**Tool Series:** PAT46LWS

- 2" jaw opening
- Used with P dies; U dies with PUADP1 adapter (sold separately)
- Light weight, scoop style C-head with 355° head rotation
- Overmolded, ergonomic handle
- Improved ergonomic balance
- Includes 2 batteries, charger, and polymer carrying case
- **EP Enhanced Power** — tools accept 2.0, 3.0, 4.0, 5.0, and 6.0Ah Makita batteries

### **For Use On:**

**Copper - #8 AWG Str. - 1500 kcmil**

Code Cable, Navy Cable, Flexible, Extra Flexible  
1/2" - 1" Ground Rods

**Terminals, grounding:**

to 500 kcmil; YGA, YGHA, YGF

**Terminals, uninsulated:**

#8 - 1500 kcmil; YA, YA-2N, YA-L, YA-LB, YA-TC, YA-2LN,  
YAB-4N, YAV-L, YAV-RS, YA-TC-FX

**Terminals, insulated:**

#8 - 2/0 AWG; YAEV-L, YAEV-H, YAEV-RS, YAEV-RH

**Splices:**

#8 - 1500 kcmil; YS, YS-T, YS-L, YS-LB, YST, YSP-T,  
YGS, YGHS

**Taps:**

#14 - 1000 kcmil; YH, YCHC  
to 4/0 AWG; YC-C

**Taps, grounding:**

to 500 kcmil; YGHC-C, YGHP-C, YGHR-C

**Aluminum - #8 AWG - 1250 kcmil**

Code Cables

**Terminals:** YA-A, AYP, AYPO

**Splices:** YS-A, YS-AT, YRB

**Taps:** YFD, YFN, YFO, YFR

**ACSR** - see Overhead Transmission & Distribution Sections H & I  
of the current BURNDY® Master Catalog



### **Specifications:**

Output Force:	15 Tons
Tool Weight:	18.9 lbs
Size:	18.00" x 14.00" x 3.00"
Die Style:	P and U style (with PUADP1)
Jaw Opening:	2.00"
Operating Voltage:	18 V-DC Lithium-Ion
Recharge Time:	30 minutes (3.0Ah) 45 minutes (5.0Ah)
Warranty:	5 year limited warranty Lifetime warranty on INFINITY DRIVE® 3 year on batteries and charger

### **Accessories:**

P15K:	Cutter Die, max. diameter 1.2"
PUADP1:	U Die Adapter
BAT18VLI:	3.0Ah Li-Ion battery
BAT18V5AHLI:	5.0Ah Li-Ion battery
PATCHGRLL:	120V-AC Charger
PATCHGRLLDC:	12/24V-DC Charger
PT208620:	Lanyard
FORCEGAUGE1215:	Force Test Gauge

### **Variations:**

PAT46LWSLI	with 3.0Ah Li-Ion batteries
PAT46CLWSLI	with rubber covered head (3.0Ah)
PAT46LWSL5	with 5.0Ah Li-Ion batteries
PAT46CLWSL5	with rubber covered head (5.0Ah)

See Important Notes page at start of Catalog.

**PATRIOT® 12 Ton, C-Head**  
Hydraulic Self-Contained, 18V Lithium-Ion

**Tool Series:** PAT750

- 1.65" jaw opening
- Used with U dies
- C-head with 355° head rotation
- Patented T-Track alignment guide for HYGROUND® as well as other asymmetrical connectors
- Includes 2 batteries, charger, and polymer carrying case
- **EP Enhanced Power** — tools accept 2.0, 3.0, 4.0, 5.0, and 6.0Ah Makita batteries

**For Use On:**

**Tension Sleeves**

Copper	#8 sol. - 500 kcmil
Aluminum	#8 sol. - 587.2 kcmil
ACSR	#4 - 556.5 kcmil

**Taps**

Copper	#14 sol. - 500 kcmil
Aluminum	#8 - 500 kcmil

**Aerial Cable**

Copper	#6 - 500 kcmil
--------	----------------

**Terminals & Splices**

Copper	#8 - 750 kcmil
Aluminum	#8 - 750 kcmil
ACSR	#4 - 556 kcmil

**HYGROUND® (Compression Grounding)**

Copper	#8 - 500 kcmil
Ground Rods	1/2" - 1" diameter



*Wide U-dies (sold separately) can be used with long barrel terminals and splices saving time and labor!*



**Specifications:**

Output Force:	12 Tons
Tool Weight:	15.7 lbs
Size:	15.75" x 13.50" x 3.50"
Die Style:	U style
Jaw Opening:	1.65"
Operating Voltage:	18 V-DC Lithium-Ion
Recharge Time:	30 minutes (3.0Ah) 45 minutes (5.0Ah)
Warranty:	5 year limited warranty Lifetime warranty on INFINITY DRIVE® 3 year on batteries and charger

**Accessories:**

BAT18VLI:	3.0Ah Li-Ion battery
BAT18V5AHLI:	5.0Ah Li-Ion battery
PATCHGRLI:	120V-AC Charger
PATCHGRLLDC:	12/24V-DC Charger
PT208620:	Lanyard
FORCEGAUGE1215:	Force Test Gauge

**Variations:**

PAT750LI	with 3.0Ah Li-Ion batteries
PAT750CLI	PAT750LI with rubber covered head (3.0Ah)
PAT750KLI	PAT750LI with KEARNEY™ style head (3.0Ah)
	used with KEARNEY™ WH1 and WH2 and BURNDY U dies with KUADP adapter (sold separately)
PAT750L5	with 5.0Ah Li-Ion batteries
PAT750CL5	PAT750L5 with rubber covered head (5.0Ah)

**See Important Notes page at start of Catalog.**

**PATRIOT® 11 Ton, C-Head, Dieless**  
**Hydraulic Self-Contained, 18V Lithium-Ion**

**Tool Series:** PAT444S

- New C-Head style for easy access and increased flexibility
- Dieless System with range taking capability
- 355° Head rotation
- Ergonomically balanced
- Includes 2 batteries, charger, and polymer carrying case
- **EP Enhanced Power** — tools accept 2.0, 3.0, 4.0, 5.0, and 6.0Ah Makita batteries

**For Use On:**

Copper #4 - 1000 kcmil Code & Flex

**Terminals:** YA-L, YA-2LN, YA, YA-2N, YA-L-2TC, YAB-4N,  
YA-L-TC, YA-2L, YA-4N, YAV, YAZ, YA-L-FX, YA-FXB,  
YBA, YAG

**Splices:** YS-L, YS, YS-T

Copper #4 - 1000 kcmil Code; #2 - 777 kcmil Flex

**HYPLUG™:** YE-P, YE-P-FX, YEV-P-FX

Aluminum #4 AWG - 1000 kcmil

**Terminals:** YA-A, YA-A-TN

**Splices:** YS-A

**HYPLUG™:** AYP, AYPO

ACSR, AAC, AAAC, ACAR #4 AWG - 556.6 kcmil

**Splices:** YDS-RL, YDS-RLNI

**Cable Pulling Heads:** YCP-L

#6 AWG - 1000 kcmil (copper & aluminum)

*See Expanded Range details in Reference Section*

**Variations:**

PAT444SLI with 3.0Ah Li-Ion batteries  
PAT444SL5 with 5.0Ah Li-Ion batteries

Connections are UL Listed to UL 486A-486B on  
Copper and Aluminum terminals and splices

Comply with ANSI C119.4 on YDS-RL and YDS-RLNI Splices  
(ACSR, AAC, AAAC, ACAR)

Qualified for use on YCP-L Compression Pulling Heads



**Specifications:**

Output Force:	11 Tons
Tool Weight:	16 lbs
Size:	16.9" x 13.7" x 3.2"
Die Style:	Dieless
Operating Voltage:	18 V-DC Lithium-Ion
Recharge Time:	
3.0Ah	30 minutes
5.0Ah	45 minutes
Warranty:	5 year limited warranty
	Lifetime warranty on INFINITY DRIVE®
	3 years on batteries and charger

**Accessories:**

BAT18VLI:	Hi-capacity LI Makita battery (3.0Ah)
BAT18V5AHLI:	Hi-capacity LI Makita battery (5.0Ah)
PATCHGRLI:	120V-AC Makita charger
PATCHGRLLDC:	12/24V-DC Makita charger
FORCEGAUGE11:	Force Test Gauge



**Unique 444S Crimp  
Embossment**

**See Important Notes page at start of Catalog.**



## PATRIOT® 6 Ton, Scissor Action

Hydraulic Self-Contained, 18V Lithium-Ion

Tool Series: PATMD-LW

- Light weight, compact and ergonomic design
- Interchangeable scissor action crimping and cutting jaws
- Safety trigger lock and locking jaw tabs
- LED Worklight
- **EP Enhanced Power** — tools accept 2.0, 3.0, 4.0, 5.0, and 6.0Ah Makita batteries

Crimp Capacity		
Connector Type	Conductor Type	Range
Terminals & Splices	Copper	#8 AWG - 500 kcmil
Terminals & Splices	Flex Copper	#8 AWG - 350 kcmil
Terminals & Splices	Aluminum (AAC)	#8 AWG - 350 kcmil
Full-Tension	ACSR	#10 - 4/0 AWG
Taps	Copper	#10 - 2/0 AWG
Taps	AAC or ACSR	#14 - 4/0 AWG
Stirrups	ACSR	#6 - 4/0 AWG

### Variations:

**PATMD6LW:** BG and D3 grooves, 3.0Ah batteries, AC charger  
**PATMD68LW:** O and D3 grooves, 3.0Ah batteries, AC charger  
**PATMD66LW:** D3 groove only, 3.0Ah batteries, AC charger

**PATMD6LW5:** BG and D3 grooves, 5.0Ah batteries, AC charger  
**PATMD68LW5:** O and D3 grooves, 5.0Ah batteries, AC charger  
**PATMD66LW5:** D3 groove only, 5.0Ah batteries, AC charger

Standard Crimp/Cut Kits are available supplied with both crimping and cutting jaws. (See separate pages in Cutters Section.)

Customize a tool kit with up to 3 jaws and optional accessories.  
Contact Customer Service at 1-800-346-4175.

### Interchangeable Jaw Assemblies:

**PATMD6LWJAW** Crimp jaw with BG and D3 grooves  
**PATMD68LWJAW** Crimp jaw with O and D3 grooves  
**PATMD66LWJAW** Crimp jaw with D3 groove only  
**PATMDCUTLWJAW** Cutting jaw with ACSR blades  
**PATMDCUTCLWJAW** Cutting jaw with CU/AL blades  
**PATMDCUTGLWJAW** Cutting jaw with GUY blades



### Specifications:

Output Force:	6 Tons
Tool Weight:	6.7 lbs
Length:	
PATMD6LW	18.73"
PATMD68LW	18.73"
PATMD66LW	17.85"
Die Style:	W and X (with crimping jaws)
Operating Voltage:	18 V-DC Lithium-Ion
Recharge Time:	
3.0Ah	30 minutes
5.0Ah	45 minutes
Warranty:	5 year limited warranty Lifetime warranty on INFINITY DRIVE® 3 years on batteries and charger

### Accessories:

**BAT18VLI:** Hi-capacity LI Makita battery (3.0Ah)  
**BAT18V5AHLI:** Hi-capacity LI Makita battery (5.0Ah)  
**PATCHGRLL:** 120V-AC Makita charger  
**PATCHGRLLDC:** 12/24V-DC Makita charger  
**W28K:** Cutter Dies (cuts 4-4/0 CU, AL, ACSR)  
**WDIETREE:** W-die holder for 6 die sets  
**CASEWDIES:** W-die case holder for 12 die sets  
**TOOLBAGMDLI:** Tool bag (included with tool)

See Important Notes page at start of Catalog.

## HYPRESS™ 12 Ton, C-Head

Hydraulic Self-Contained, Hand Operated

**Tool Series:** Y35

- 180° head rotation
- Uses BURNDY U style dies (sold separately)
- Body and handles rubber covered for impact protection
- Trigger controlled ram release

### For Use On:

Copper #8 str. - 500 kcmil code cable

#### Grounding Terminals:

YGH, YGHA, YGF

#### Grounding Splices:

YGS, YGHS

Copper #8 str. - 500 kcmil and up to 3/4" ground rod

#### Grounding Taps:

YGHC-C, YGHP-C, YGHR-C

Copper #8 str. - 750 kcmil code cable, N30 - N500 Navy cable, flexible, and extra flex

#### Terminals (Bare):

YA, YA-2N, YA-L, YA-LB, YA-2LN

#### Terminals (Insulated):

YAEV-L, YAEV-H, YAEV-RS, YAEV-RH

#### Splices to 400 kcmil only:

YS, YS-T, YS-L, YS-LB, YSV-L, YSM

Aluminum #8 str. - 750 kcmil code cable

#### Terminals:

YA-A, AYP, AYPO

#### Splices to 350 kcmil only:

YSA, YRB, YS-AT

**ACSR** - see Overhead Transmission & Distribution Sections  
H & I of the current BURNDY® Master Catalog



### Specifications:

Output Force:	12 Tons
Tool Weight:	13.5 lbs
Size:	23.25" x 4.75" x 2.75"
Die Style:	U style
Warranty:	5 year limited warranty

### Variations:

Y35	Standard C-Head tool (rubber covered body and handles only)
Y352	Y35 with rubber covered head, body, and handles

### Accessories:

PT2972:	Steel Carry Case (included with tool)
Y35/Y39REPKITA:	Seal Repair Kit
PT292792	12 ton Force Gauge

Remote Operated Crimper  
60 Ton, Latch Head, Light Weight

**60 Ton, Latch Head, Remote Powered**  
**Single Acting Light Weight Hydraulic Tool**

**Tool:** Y60LW

- Remote power operated
- Used with BURNDY L, wide L style dies, and HPS/Fargo-equivalent 60 ton dies
- Base stand and metal carry case (for head only) included
- Side lift handle

**For Use On:**

Copper 300 - 2000 kcmil Str. Code Cable

**Terminals:** YA, YA-2N, YA-4N, YA-L, YA-2LN, YA-LB

**Splices:** YS, YST, YS-L, YS-T, YSP-T

Aluminum 250 - 2000 kcmil Str. Code Cable

**Terminals:** YA-A

**Splices:** YS-A, YS-AT

**Transmission & Distribution Connectors:**

**Tension Sleeves:**

Copper: 1/0 str. - 1000 kcmil

Aluminum: 1/0 str. - 2300 kcmil

ACSR: 1/0 str. - 2156 (84/19 str.) kcmil

**Aerial:**

Copper: 4/0 str. - 2500 kcmil

Aluminum: 3/0 str. - 2500 kcmil

**Types:** YTS, YTN, YNS, YNA, YNT, YNTA, YNU, YDS,  
YDN, YCS, YCA, YCU



*Wide L-dies (sold separately) can be used to save time and labor! Indicator marks on die set for ease of aligning connector properly. L725W shown.*



**Specifications:**

Output Force:	60 Tons
Tool Weight:	43.0 lbs
Size:	12.93" x 8.06" x 8.06"
Die Style:	L style (standard or wide style); HPS/Fargo-equivalent 60 ton dies
Operating Pressure:	10,000 PSI
Warranty:	5 year limited warranty

**Variations:**

Y60LW

Standard Remote Latch Head tool

**Accessories:**

Y60LWSTAND:

Metal stand for Y60LW (included with tool)

Y60LWCASE:

Steel carry case for Y60LW head (included with tool)

*See Gas or Electric Pumps and Hydraulic Hoses;  
Pump Accessories for other necessary equipment.*



*Y60LW pictured on  
Y60LWSTAND  
(included with tool purchase)*

## 12 Ton U Dies\*

For 35 and 750 Tool Series;  
46 Series with PUADP1 Adapter

\* Non-tension U-type 12 ton dies for YA, YS, YA-A, YS-A style connectors

\*\* Wide dies are intended for use on long barrel terminals and splices  
(YA/YS) only.

Die Sets sold separately; U Die Kits also available; see following page

Note: N/A = not applicable



U28RT Die Set

Wire Size	Copper	Copper Wide Die**	Aluminum
#8 AWG	U8CRT	U8CRTW	U8CABT
#6 AWG	U5CRT	U5CRTW	U6CABT
#4 AWG	U4CRT	U4CRTW	U4CABT
#3 AWG	U3CRT	U3CRTW	N/A
#2 AWG	U2CRT	U2CRTW	U2CABT
#1 AWG	U1CRT1	U1CRT1W	U1CART
1/0 AWG	U25RT	U25RTW	U25ART
2/0 AWG	U26RT	U26RTW	U26ART
3/0 AWG	U27RT	U27RTW	U27ART
4/0 AWG	U28RT	U28RTW	U28ART
250 kcmil	U29RT	N/A	U29ART
300 kcmil	U30RT		U30ART
350 kcmil	U31RT		U31ART
400 kcmil	U32RT		U32ART
500 kcmil	U34RT		U34ART
535 Flex	U38XRT		N/A
600 kcmil	U36RT		U36ART
750 kcmil	U39RT		U39ART2
777 Flex	U44XRT		N/A

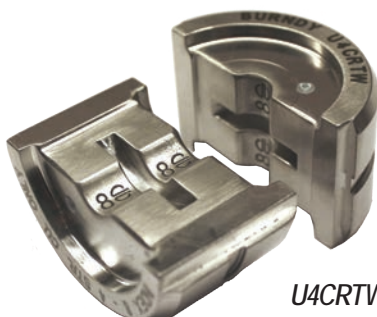

U4CRTW Wide Die Set



CASEUDIES15 die box is available  
(sold separately) holding up to 15 "U"  
style (standard or wide) die sets; dies not  
included.



12 Ton U Die Kits  
For 35 and 750 Tool Series; 46 Series with PUADP1 Adapter

**12 Ton U Die Kits**  
For 35 and 750 Tool Series;  
46 Series with PUADP1 Adapter

**UDIEKITCU** and **UDIEKITAL** include 15 sets of "U" dies and die case. These stainless steel color coded dies are for crimping YA, YS, YA-A, and YS-A types of connectors, ranging from #6 AWG through 750 kcmil.

**UDIEKITCUW** includes 9 sets of wide stainless steel color coded dies for crimping long barrel YA and YS types of connectors up to 4/0 AWG. The wide dies require only one crimp compared to 2 for the standard width dies.

Note: N/A = not applicable

**UDIEKITHYGRD**



Wire Size	UDIEKITCU includes	UDIEKITCUW includes	UDIEKITAL includes
#8 AWG	N/A	U8CRTW	N/A
#6 AWG	U5CRT	U5CRTW	U6CABT
#4 AWG	U4CRT	U4CRTW	U4CABT
#2 AWG	U2CRT	U2CRTW	U2CABT
#1 AWG	U1CRT1	U1CRT1W	U1CART
1/0 AWG	U25RT	U25RTW	U25ART
2/0 AWG	U26RT	U26RTW	U26ART
3/0 AWG	U27RT	U27RTW	U27ART
4/0 AWG	U28RT	U28RTW	U28ART
250 kcmil	U29RT	N/A	U29ART
300 kcmil	U30RT		U30ART
350 kcmil	U31RT		U31ART
400 kcmil	U32RT		U32ART
500 kcmil	U34RT		U34ART
600 kcmil	U36RT		U36ART
750 kcmil	U39RT		U39ART2
Die Case	CASEUDIES15	CASEUDIES15	CASEUDIES15

**UDIEKITHYGRD** includes 8 dies sets. Seven die sets are used to install the BURNDY® HYGROUND® irreversible compression grounding connectors; the U2CABT die set is for pre-crimping 1/2", 5/8" and 3/4" ground rods for increased rotational resistance. The UDIEKITHYGRD also includes the **CASEUDIES8** die case.

**UDIEKITHYGRD includes**

UC, UO, U997, PU998, U1011, U1104, U1105, U2CABT (Ground rod pre-crimp die), and CASEUDIES8 die case

## W Dies

For MD/PATMD, 500, and 600 Tool Series

- \* These sizes (250 - 500) are not recommended for use with MD6 & MD7 Series tools due to high handle force.
- \*\* For PAT600 and Y500CTHS only.
- \*\*\* Use of W249 will not produce a UL Listed connection.

Note: N/A = not applicable

Suitable for use on YA, YS, YA-A, YS-A type non-tension connectors.

Die Sets sold separately; W Die Kits also available; see following page



W25RT Die Set

Wire Size	Copper (-VT)	Copper (-RT)	Aluminum
#8 AWG	W8CVT	W8CRT	X8CART
#6 AWG	W5CVT	W5CRT	W161
#4 AWG	W4CVT	W4CRT	W162
#3 AWG	N/A	W3CRT	N/A
#2 AWG	W2CVT	W2CRT	W239
#1 AWG	W1CVT	W1CRT1	W163
1/0 AWG	W25VT	W25RT	W241
2/0 AWG	W26VT	W26RT	W245
3/0 AWG	W27VT	W27RT	W166
4/0 AWG	W28VT	W28RT	W660
250 kcmil	W29VT*	W29RT*	W249***
300 kcmil	W30VT*	W30RT*	N/A
350 kcmil	W31VT*	W31RT*	W31ART*
400 kcmil	W32VT*	W32RT*	N/A
450 kcmil	W33VT*	W33RT*	N/A
500 kcmil	W34VT*	W34RT*	N/A
600 kcmil	N/A	W36RT**	N/A

VT = "V" profile die for reduced handle force when using MD6/MD7 series tools; Twin die (includes both halves)  
RT = Round die (circumferential); Twin die (includes both halves)



**WDIETREE** available (sold separately);  
holds up to 6 "W" style die sets (dies not included)



**CASEWDIES** die box  
available (sold separately);  
holds up to 12 "W" or "X"  
style die sets (dies not included)

**W Dies**  
For MD/PATMD, 500, and 600 Tool Series

**W Die Kits**  
For MD/PATMD, 500, and 600 Tool Series

\* These sizes (250 - 500) are not recommended for use with MD6 & MD7 Series tools due to high handle force.

\*\* Use of W249 will not produce a UL Listed connection.

Note: N/A = not applicable

Suitable for use on YA, YS, YA-A, YS-A type non-tension connectors.



**CASEWDIES**  
*included with die kits;  
also sold separately  
(dies not included)*

Wire Size	WDIEKITCU for Copper includes	WDIEKITAL for Aluminum includes
#8 AWG	W8CRT	X8CART
#6 AWG	W5CRT	W161
#4 AWG	W4CRT	W162
#2 AWG	W2CRT	W239
#1 AWG	W1CRT1	W163
1/0 AWG	W25RT	W241
2/0 AWG	W26RT	W245
3/0 AWG	W27RT	W166
4/0 AWG	W28RT	W660
250 kcmil	W29RT*	W249**
350 kcmil	W31RT*	W31ART*
500 kcmil	W34RT*	N/A
Die Case	CASEWDIES	CASEWDIES

## PATRIOT® 10 Ton, Latch Head

ACSR up to 2156 kcmil

Hydraulic Self-Contained, 18V Lithium-Ion

**Tool Series:** PATCUT2156

- 180° head rotation
- Durable hardened steel blades
- Specialized latch head for mid-span cuts
- Mechanical ram release with no power consumption
- Includes 2 batteries, charger, and polymer carrying case
- **EP Enhanced Power** — tools accept 2.0, 3.0, 4.0, 5.0, and 6.0Ah Makita batteries

### For Use On:

Copper/Aluminum Cable:	up to 2"
ACSR:	up to 2156 kcmil
Ground Rod:	up to 3/4"
Rebar:	up to 5/8"
Soft Steel Bolts:	up to 3/4"
Standard Guy:	up to 9/16"
EHS Guy:	up to 9/16"

### Variations:

PATCUT2156LI	with 3.0Ah battery
PATCUT2156L5	with 5.0Ah battery



### Specifications:

Output Force:	10 Tons
Tool Weight:	15.5 lbs
Size:	16.50" x 13.50" x 3.38"
Operating Voltage:	18 V-DC Lithium-Ion
Recharge Time:	30 minutes (3.0Ah) 45 minutes (5.0Ah)
Warranty:	5 year limited warranty (excluding blades) Lifetime warranty on INFINITY DRIVE® 3 year on batteries and charger

### Accessories:

BAT18VLI:	3.0Ah Li-Ion battery
BAT18V5AHLI:	5.0Ah Li-Ion battery
PATCHGRLI:	120V-AC Charger
PATCHGRLLDC:	12/24V-DC Charger
PT208620:	Lanyard
CUT200BLMVBL:	Replacement Moving Blade
CUT200BLSTA:	Replacement Fixed (Stationary) Blade

See Important Notes page at start of Catalog.



**PATRIOT® 7 Ton, Latch Head**  
Copper/Aluminum up to 1.29" O.D.  
Hydraulic Self-Contained, 18V Lithium-Ion

**Tool Series:** PATCUT129

- 180° head rotation
- Overmolded handle and ergonomic design
- One-handed operation for advance, retract and hold
- Latch head design for interference free closure for mid-span cuts
- Includes 2 batteries, charger, and polymer carrying case
- **EP Enhanced Power** — tools accept 2.0, 3.0, 4.0, 5.0, and 6.0Ah Makita batteries

**For Use On:**

Copper/Aluminum Cable: up to 1.29"

ACSR: up to 1113 kcmil

Ground Rod: up to 5/8"

Rebar: up to 1/2"

Soft Steel Bolts: up to 5/8"

Standard Guy: up to 1/2"

EHS Guy Strand: up to 3/8"

**Variations:**

PATCUT129LI with 3.0Ah battery  
PATCUT129L5 with 5.0Ah battery



**Specifications:**

Output Force:	7 Tons
Tool Weight:	10.2 lbs
Size:	14.50" x 13.50" x 3.50"
Operating Voltage:	18 V-DC Lithium-Ion
Recharge Time:	30 minutes (3.0Ah) 45 minutes (5.0Ah)
Warranty:	5 year limited warranty (excluding blades) Lifetime warranty on INFINITY DRIVE® 3 year on batteries and charger

**Accessories:**

BAT18VLI:	3.0Ah Li-Ion battery
BAT18V5AHLI:	5.0Ah Li-Ion battery
PATCHGRLL:	120V-AC Charger
PATCHGRLLDC:	12/24V-DC Charger
PT208620:	Lanyard
PT10037388:	Replacement Moving Blade
PT10037384:	Replacement Fixed Blade

See Important Notes page at start of Catalog.

## **PATRIOT® 6 Ton, Latch Head**

Copper/Aluminum up to 2.45" O.D.

Hydraulic Self-Contained, 18V Lithium-Ion

### **Tool Series: PATCUT245**

- 180° head rotation
- Cuts up to 2.45" diameter copper/aluminum cable
- Specialized latch style cutting head for interference-free closure for mid-span work
- Ergonomic design, overmolded handle
- Includes 2 batteries, charger, and polymer carrying case
- **EP Enhanced Power** — tools accept 2.0, 3.0, 4.0, 5.0, and 6.0Ah Makita batteries



### **For Use On:**

Copper/Aluminum Cable: Up to 2.45" O.D.

For Copper and Aluminum cable only. Do not cut steel, ground rod, rebar or guy wire.

### **Variations:**

PATCUT245LI with 3.0Ah battery  
PATCUT245L5 with 5.0Ah battery

### **Specifications:**

Output Force:	6 Tons
Tool Weight:	13.7 lbs
Size:	18.13" x 13.50" x 3.50"
Operating Voltage:	18 V-DC Lithium-Ion
Recharge Time:	30 minutes (3.0Ah) 45 minutes (5.0Ah)
Warranty:	5 year limited warranty (excluding blades) Lifetime warranty on INFINITY DRIVE® 3 year on batteries and charger

### **Accessories:**

BAT18VLI:	3.0Ah Li-Ion battery
BAT18V5AHLI:	5.0Ah Li-Ion battery
PATCHGRLI:	120V-AC Charger
PATCHGRLLDC:	12/24V-DC Charger
PT208620:	Lanyard
PT10038657:	Replacement Moving Blade
PT10040663:	Replacement Fixed Blade

See Important Notes page at start of Catalog.

## PATRIOT® IN-LINE® 6 Ton, Scissor Action

Hydraulic Self-Contained, 18V Lithium-Ion

Tool Series: PATMDCUTLW

- Light weight, compact and ergonomic design
- Interchangeable scissor action crimping and cutting jaws
- Safety trigger lock and locking jaw tabs
- LED Worklight
- **EP Enhanced Power** — tools accept 2.0, 3.0, 4.0, 5.0, and 6.0Ah Makita batteries

Cutting Capacities	ACSR (26/7)	Aluminum (AAC)	Copper (soft drawn)	Guy Wire (EHS)
ACSR Blade	556.6 kcmil	636 kcmil	350 kcmil	-
CU/AL Blade	-	636 kcmil	600 kcmil	-
GUY Blade	-	-	-	3/8"

### Variations:

PATMDCUTLW:	ACSR Cutting Jaw, 3.0Ah batteries, AC charger
PATMDCUTLW5:	ACSR Cutting Jaw, 5.0Ah batteries, AC charger
PATMDCUTCLW:	CU/AL Cutting Jaw, 3.0Ah batteries, AC charger
PATMDCUTCLW5:	CU/AL Cutting Jaw, 5.0Ah batteries, AC charger
PATMD60003A1:	GUY Cutting Jaw, 3.0Ah batteries, AC charger
PATMD60005A1:	GUY Cutting Jaw, 5.0Ah batteries, AC charger

Standard Crimp/Cut Kits are available supplied with both crimping and cutting jaws. (See separate pages in Cutters Section.)

Customize a tool kit with up to 3 jaws and optional accessories.  
Contact Customer Service at 1-800-346-4175.

### Interchangeable Jaw Assemblies:

PATMD6LWJAW	Crimp jaw with BG and D3 grooves
PATMD68LWJAW	Crimp jaw with O and D3 grooves
PATMD66LWJAW	Crimp jaw with D3 groove only
PATMDCUTLWJAW	Cutting jaw with ACSR blades
PATMDCUTCLWJAW	Cutting jaw with CU/AL blades
PATMDCUTGLWJAW	Cutting jaw with GUY blades



### Specifications:

Output Force:	6 Tons
Tool Weight:	7.2 lbs
Length:	19.25"
Operating Voltage:	18 V-DC Lithium-Ion
Recharge Time:	
3.0Ah	30 minutes
5.0Ah	45 minutes
Warranty:	5 year limited warranty
	Lifetime warranty on INFINITY DRIVE®
	3 years on batteries and charger

### Accessories:

PATMDCUTACSRKIT:	ACSR Replacement Blades (2 per kit)
PATMDCUTCUALKIT:	CU/AL Replacement Blades (2 per kit)
PATMDCUTGUYKIT:	GUY Replacement Blades (2 per kit)
BAT18VLI:	Hi-capacity LI Makita battery (3.0Ah)
BAT18V5AHLI:	Hi-capacity LI Makita battery (5.0Ah)
PATCHGRLL:	120V-AC Makita charger
PATCHGRLLDC:	12/24V-DC Makita charger
W28K:	Cutter Dies (cuts 4-4/0 CU, AL, ACSR)
WDIETREE:	W-die holder for 6 die sets
CASEWDIES:	W-die case holder for 12 die sets
TOOLBAGMDLI:	Tool bag (included with tool)

See Important Notes page at start of Catalog.

**PATRIOT® 6 Ton, Scissor Action**  
Hydraulic Self-Contained, 18V Lithium-Ion

**Tool Series: PATMD-LW ACSR Kits**

- Light weight, compact and ergonomic design
- Interchangeable scissor action crimping and cutting jaws
- Safety trigger lock and locking jaw tabs
- LED Worklight
- **EP Enhanced Power** — tools accept 2.0, 3.0, 4.0, 5.0, and 6.0Ah Makita batteries

Crimp Capacity		
Connector Type	Conductor Type	Range
Terminals & Splices	Copper	#8 AWG - 500 kcmil
Terminals & Splices	Flex Copper	#8 AWG - 350 kcmil
Terminals & Splices	Aluminum (AAC)	#8 AWG - 350 kcmil
Full-Tension	ACSR	#10 - 4/0 AWG
Taps	Copper	#10 - 2/0 AWG
Taps	AAC or ACSR	#14 - 4/0 AWG
Stirrups	ACSR	#6 - 4/0 AWG

ACSR Blade Cutting Capacity	
Conductor Type	Maximum Size
ACSR (26/7)	556.6 kcmil
Aluminum (AAC)	636 kcmil
Copper	350 kcmil

**Variations\*: all listed include AC Charger**

PATMD6LWWCJ: BG & D3, ACSR Cutter, 3.0Ah batteries  
 PATMD68LWWCJ: O & D3, ACSR Cutter, 3.0Ah batteries  
 PATMD66LWWCJ: D3 only, ACSR Cutter, 3.0Ah batteries

PATMD6LW5WCJ: BG & D3, ACSR Cutter, 5.0Ah batteries  
 PATMD68LW5WCJ: O & D3, ACSR Cutter, 5.0Ah batteries  
 PATMD66LW5WCJ: D3 only, ACSR Cutter, 5.0Ah batteries

\*Add DC suffix to catalog numbers for DC charger in place of AC charger.

**Interchangeable Jaw Assemblies:**

PATMD6LWJAW Crimp jaw with BG and D3 grooves  
 PATMD68LWJAW Crimp jaw with O and D3 grooves  
 PATMD66LWJAW Crimp jaw with D3 groove only  
 PATMDCUTLWJAW Cutting jaw with ACSR blades



**Specifications:**

Output Force:	6 Tons
Tool Weight:	6.7 lbs (crimper) & 7.2 lbs (cutter)
Length:	
PATMD6LW	18.73"
PATMD68LW	18.73"
PATMD66LW	17.85"
PATMDCUTLW	19.25"
Die Style:	W and X (with crimping jaws)
Operating Voltage:	18 V-DC Lithium-Ion
Recharge Time:	
3.0Ah	30 minutes
5.0Ah	45 minutes
Warranty:	5 year limited warranty
	Lifetime warranty on INFINITY DRIVE®
	3 years on batteries and charger

**Accessories:**

PATMDCUTACSRKIT:	ACSR Replacement Blades (2 per kit)
BAT18VLI:	Hi-capacity LI Makita battery (3.0Ah)
BAT18V5AHLI:	Hi-capacity LI Makita battery (5.0Ah)
PATCHGRLLI:	120V-AC Makita charger
PATCHGRLLDC:	12/24V-DC Makita charger
W28K:	Cutter Dies (cuts 4-4/0 CU, AL, ACSR)
WDIETREE:	W-die holder for 6 die sets
CASEWDIES:	W-die case holder for 12 die sets
TOOLBAGMDLI:	Tool bag (included with tool)

See Important Notes page at start of Catalog.



**PATRIOT® 6 Ton, Scissor Action**  
Hydraulic Self-Contained, 18V Lithium-Ion

**Tool Series: PATMD-LW GUY Kits**

- Light weight, compact and ergonomic design
- Interchangeable scissor action crimping and cutting jaws
- Safety trigger lock and locking jaw tabs
- LED Worklight
- **EP Enhanced Power** — tools accept 2.0, 3.0, 4.0, 5.0, and 6.0Ah Makita batteries

Crimp Capacity		
Connector Type	Conductor Type	Range
Terminals & Splices	Copper	#8 AWG - 500 kcmil
Terminals & Splices	Flex Copper	#8 AWG - 350 kcmil
Terminals & Splices	Aluminum (AAC)	#8 AWG - 350 kcmil
Full-Tension	ACSR	#10 - 4/0 AWG
Taps	Copper	#10 - 2/0 AWG
Taps	AAC or ACSR	#14 - 4/0 AWG
Stirrups	ACSR	#6 - 4/0 AWG

GUY Blade Cutting Capacity	
Conductor Type	Maximum Size
Guy Wire (EHS)	3/8"

**Variations\*: all listed include AC Charger**

PATMD16003A1: BG & D3, GUY Cutter, 3.0Ah batteries  
 PATMD36003A1: O & D3, GUY Cutter, 3.0Ah batteries  
 PATMD26003A1: D3 only, GUY Cutter, 3.0Ah batteries

PATMD16005A1: BG & D3, GUY Cutter, 5.0Ah batteries  
 PATMD36005A1: O & D3, GUY Cutter, 5.0Ah batteries  
 PATMD26005A1: D3 only, GUY Cutter, 5.0Ah batteries

\*Change A to D in catalog numbers for DC charger in place of AC charger.

**Interchangeable Jaw Assemblies:**

PATMD6LWJAW: Crimp jaw with BG and D3 grooves  
 PATMD68LWJAW: Crimp jaw with O and D3 grooves  
 PATMD66LWJAW: Crimp jaw with D3 groove only  
 PATMDCUTGLWJAW: Cutting jaw with GUY blades



**Specifications:**

Output Force: 6 Tons  
 Tool Weight: 6.7 lbs (crimper) & 7.2 lbs (cutter)  
 Length:  
 PATMD6LW 18.73"  
 PATMD68LW 18.73"  
 PATMD66LW 17.85"  
 PATMD60003A1 19.25"  
 Die Style: W and X (with crimping jaws)  
 Operating Voltage: 18 V-DC Lithium-Ion  
 Recharge Time:  
 3.0Ah 30 minutes  
 5.0Ah 45 minutes  
 Warranty: 5 year limited warranty  
 Lifetime warranty on INFINITY DRIVE®  
 3 years on batteries and charger

**Accessories:**

PATMDCUTGUYKIT: GUY Replacement Blades (2 per kit)  
 BAT18VLI: Hi-capacity LI Makita battery (3.0Ah)  
 BAT18V5AHLI: Hi-capacity LI Makita battery (5.0Ah)  
 PATCHGRLL: 120V-AC Makita charger  
 PATCHGRLLDC: 12/24V-DC Makita charger  
 W28K: Cutter Dies (cuts 4-4/0 CU, AL, ACSR)  
 WDIETREE: W-die holder for 6 die sets  
 CASEWDIES: W-die case holder for 12 die sets  
 TOOLBAGMDLI: Tool bag (included with tool)

See Important Notes page at start of Catalog.

**PATRIOT® Battery Actuated  
Cable Cutter for Copper & Aluminum**  
Mechanically Driven, 18V Lithium-Ion

**Tool Series:** PATCUT1500

- Variable speed trigger
- Forward/Reverse switch features a locking position
- Large, strategically placed, non-skid bumper
- LED Worklight
- Large, new cutting blade design
- Includes 1 battery, charger, and case
- **EP Enhanced Power** — tools accept 2.0, 3.0, 4.0, 5.0, and 6.0Ah Makita batteries

**For Use On:**

**Aluminum:** up to 1500 kcmil

**Copper Flex:** up to 1250 kcmil

**Copper (soft drawn):** up to 1000 kcmil

**Copper (hard drawn):** up to 750 kcmil

**Do Not Cut Steel or ACSR**

**Variations:**

PATCUT1500LI with 3.0Ah Li-Ion battery  
PATCUT1500L5 with 5.0Ah Li-Ion battery  
PATCUT1500LCB tool, no charger or battery



**Specifications:**

Tool Weight:	8.1 lbs with battery
Size:	15.5" x 6.0" x 4.38"
Operating Voltage:	18 V-DC Lithium-Ion
Recharge Time:	
3.0Ah	30 minutes
5.0Ah	45 minutes
Warranty:	
	3 year limited warranty (excluding blades)
	3 years on battery and charger

**Accessories:**

BAT18VLI:	Hi-capacity LI Makita battery (3.0Ah)
BAT18V5AHLI:	Hi-capacity LI Makita battery (5.0Ah)
PATCHGRLL:	120V-AC Makita charger
PATCHGRLLDC:	12/24V-DC Makita charger
CASEPATCUT1500:	Polymer carrying case
PT208620:	Lanyard

See Important Notes page at start of Catalog.

## ENFORCER® Hydraulic Impact Wrench

Variable Torque; 7/16" Quick Chuck

Tool Series: HIW-ENF

- Industry exclusive torque selector allows switching between 200 and 515 ft-lb torque settings
- Dual spool selector for Open and Closed systems
- Cartridge style valves for greater accuracy
- Internal safety relief valve

### Variations:

HIW716ENFKIT2	Wrench, eyelet, flat face couplers
HIW716ENFKIT3	Wrench, flat face couplers
HIW716ENFTG	Wrench, trigger guard
HIW716ENFTGKIT1	Wrench, trigger guard, flat face couplers



*HIW716ENFTGKIT1 Hydraulic Impact Wrench  
shown with trigger guard, adaptors and couplers*

*See our line of DOMINATOR Auger Bits*



### Specifications:

Chuck Type:	7/16" Quick Change
Opt. Pressure:	750-2000 PSI
Flow Range:	4-12 GPM
Opt. Flow Range:	4-8 GPM
Weight:	6.0 lbs
Torque:	515 ft-lbs
Size:	9.00" x 7.75" x 3.12"
Warranty:	5 year limited warranty

### Accessories:

HIW716ENFTGKIT:	Trigger guard assembly kit
LPHTADPMMOP66	SAE #6 to 3/8" NPT male-to-male adapter for use with couplers listed below ( <i>2 required</i> )
LPHTHTMANOSE66	3/8" male coupler (flat face) with 3/8" NPT (female thread) ( <i>1 per tool; 2 per hose</i> )
LPHTHTMABODY66	3/8" female coupler (flat face) with 3/8" NPT (female thread) ( <i>1 per tool; 2 per hose</i> )
LPHTHOSNCR66668	3/8" X 8' hose set
LPHTHOSNCR666610	3/8" X 10' hose set
LPHTADPSMFOP66	SAE swivel adapter ( <i>2 required</i> )

\*(Recommended quantity for use with HIW716ENF)

*See Low Pressure Hydraulic Accessories  
for additional options*

Get Only What You Want

**CUSTOMIZE**

A Light Weight

**PATRIOT® IN-LINE® 6-TON  
PATMD-LW SERIES**

**BATTERY ACTUATED CRIMPER/CUTTER**

Build your own tool kit with  
up to 3 jaws and optional accessories  
using the table below:

PATMD	X	X	X	XX	X	X
	JAW 1	JAW 2	JAW 3	BATTERY	CHARGER	CASE/BAG
	1 CRIMPER, BG/D3 2 CRIMPER, D3 ONLY 3 CRIMPER, O/D3 4 CUTTER, ACSR 5 CUTTER, CU/AL 6 CUTTER, EHS GUY	0 NO JAW 1 CRIMPER, BG/D3 2 CRIMPER, D3 ONLY 3 CRIMPER, O/D3 4 CUTTER, ACSR 5 CUTTER, CU/AL 6 CUTTER, EHS GUY	0 NO JAW 1 CRIMPER, BG/D3 2 CRIMPER, D3 ONLY 3 CRIMPER, O/D3 4 CUTTER, ACSR 5 CUTTER, CU/AL 6 CUTTER, EHS GUY	00 NO BATTERIES 03 3.0 AH (QTY 2) 05 5.0 AH (QTY 2)	0 NO CHARGER A 120V-AC CHARGER D 12V-DC CHARGER	0 NO CASE/BAG 1 UTILITY BAG 2 HARD CASE
<b>PATMD</b>	<b>1</b>	<b>3</b>	<b>6</b>	<b>03</b>	<b>A</b>	<b>1</b>
(FIXED VALUE)	CRIMPER, BG/D3	CRIMPER, O/D3	CUTTER, EHS GUY	3.0 AH (QTY 2)	120V-AC CHARGER	UTILITY BAG
THESE VALUES MUST BE IN ASCENDING ORDER						
EXCEPTIONS: IF TWO JAWS ARE NEEDED, JAW 3 MUST BE ZERO (I.E. NOT INCLUDED) IF ONE JAW IS NEEDED, BOTH JAWS 2 AND 3 MUST BE ZEROS (I.E. NOT INCLUDED)						
*Example Catalog Number: PATMD13603A1						
*NOTE: FINAL CATALOG NUMBER MAY DIFFER IF DETERMINED THAT CONFIGURATION ALREADY EXISTS.						

Contact your local BURNDY Salesperson  
or Customer Service for assistance.



## Features & Benefits 6 Ton PATMD-LW Series

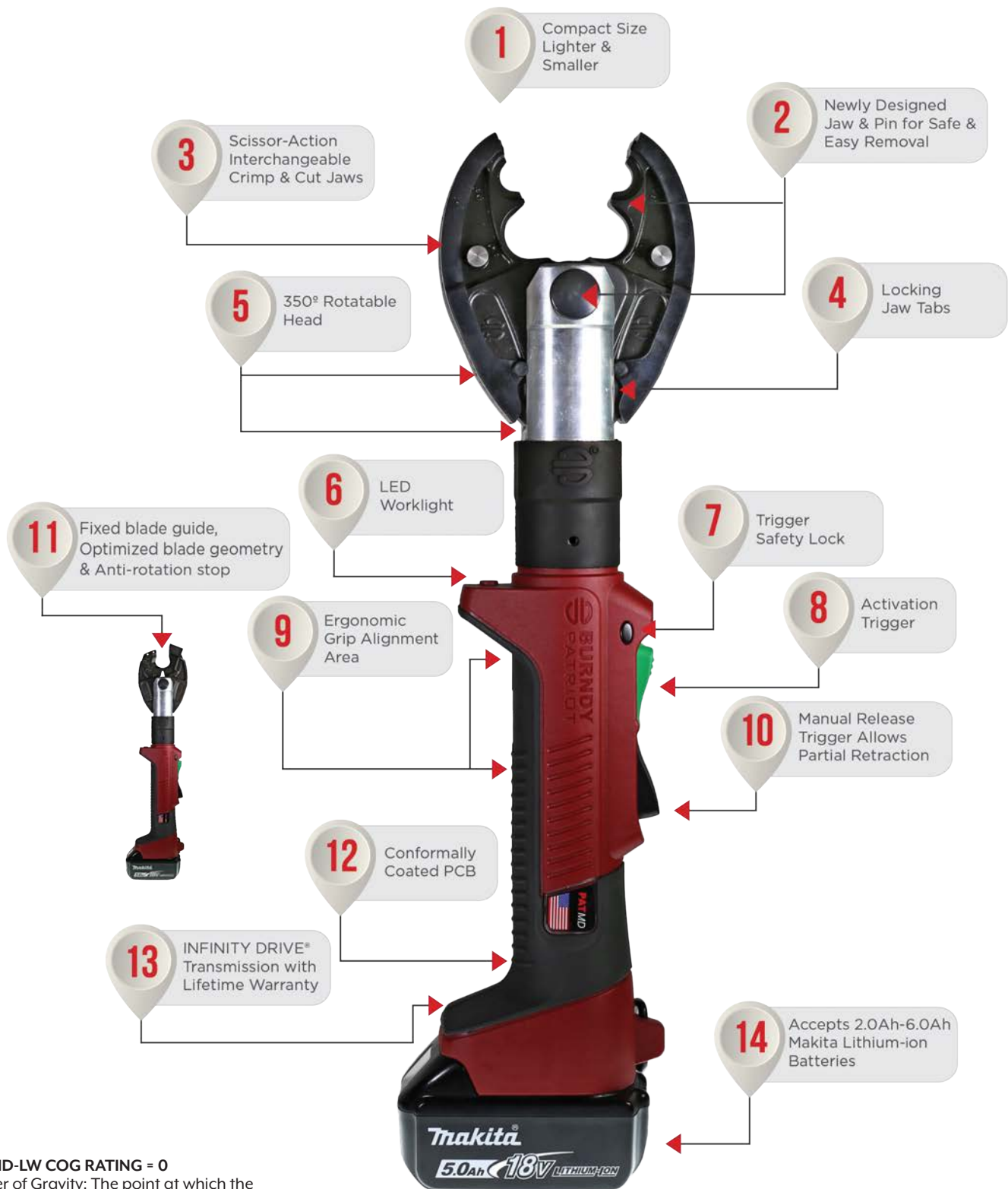

### PATMD-LW COG RATING = 0

Center of Gravity: The point at which the entire weight of a body is centered, so that if supported at this point, the body would remain in equilibrium. A COG rating of zero means the tool is designed to be perfectly balanced if held in the grip area.

Designed, Tested and Assembled in New Hampshire, U.S.A.

**SPECIFICATIONS**

Output Force	6 Tons
Tool Weight	6.7 lbs (crimper) 7.2 lbs (cutter)
Length	18.73" (crimper) 19.25" (cutter)
Die Style	W and X (with crimping jaws)
Operating Voltage	18 V-DC Lithium-ion
Crimps per Charge (4/0 AWG, typical)	220 (3.0Ah) 400 (5.0Ah)
Recharge Time	30 minutes (3.0Ah) 45 minutes (5.0Ah)
Warranty	5 year limited warranty Lifetime warranty on INFINITY DRIVE® 3 years on batteries and charger



**TRUST THE BURNDY® ENGINEERED SYSTEM**

CRIMPING CAPACITIES	TERMINALS & SPLICES	FULL-TENSION SLEEVES	TAPS	STIRRUPS
Copper	#8 AWG - 500 kcmil	#8 AWG - 2/0 AWG	#10 AWG - 2/0 AWG	
Copper Flex	#8 AWG - 350 kcmil			
Aluminum (AAC)	#8 AWG - 350 kcmil	#6 AWG - 4/0 AWG	#14 AWG - 4/0 AWG	#2 AWG - 4/0 AWG
ACSR		#10 AWG - 4/0 AWG	#14 AWG - 4/0 AWG	#6 AWG - 4/0 AWG

CUTTING CAPACITIES	ACSR (26/7)	ALUMINUM (AAC)	COPPER (SOFT DRAWN)	GUY WIRE (EHS)
ACSR Jaw	556.5 kcmil	636 kcmil	350 kcmil	
CU/AL Jaw		636 kcmil	600 kcmil	
GUY Jaw				3/8"

**CRIMPING  
JAWS:**



PATMD6LWJAW  
BG & D3



PATMD68LWJAW  
O & D3



PATMD66LWJAW  
D3 Snub-nose

**CUTTING  
JAWS:**



PATMDCUTLWJAW  
ACSR



PATMDCUTCLWJAW  
CU/AL



PATMDCUTGLWJAW  
GUY

**Battery Options:**  
(2) 3.0Ah, (2) 5.0Ah, or None



BAT18VLI (3.0Ah)



BAT18V5AHLI (5.0Ah)

**Charger Options:**  
120V AC, 12V DC, or None



PATCHGRLI (AC)



PATCHGRLIDC (DC)

**Packaging Options:**  
Vinyl Utility Bag, Plastic Hard Case, or None



TOOLBAGMDLI



PT500251SI

**W-Dies, Die Kits, Die Box, & WDIENTREE:**  
(All Sold Separately)



WDIENTREE  
(dies sold separately)



WDIEKITCU Copper Kit  
WDIEKITAL Aluminum Kit  
CASEWDIES Die Box Only

## Reference Section

**Expanded Ranges  
Die Index Reference  
Policies**



The following connectors are range taking when crimped onto code conductor using the 644 & 444S Series of tools:

### COPPER

Copper HYLUG™ & HYLINK™ Connectors Types YA, YA-L, YAB, YS, YS-L, YST, YS-T, YSP-T			
Catalog No.		Standard Wire Size	Expanded Wire Range
Terminal*	Splice**		
YA3C- YA2C- YA1C-	YS3C- YS2C- YS1C-	#3 AWG #2 AWG #1 AWG	#3 - #4 AWG #2 - #4 AWG #1 - #4 AWG
YA25- YA26- YA27- YA28-	YS25- YS26- YS27- YS28-	1/0 AWG 2/0 AWG 3/0 AWG 4/0 AWG	1/0 - #4 AWG 2/0 - #4 AWG 3/0 - #2 AWG 4/0 - #1 AWG
YA29- YA30- YA31- YA32- YA34-	YS29- YS30- YS31- YS32- YS34-	250 kcmil 300 kcmil 350 kcmil 400 kcmil 500 kcmil	250 kcmil - 1/0 AWG 300 kcmil - 2/0 AWG 350 kcmil - 3/0 AWG 400 kcmil - 4/0 AWG 500 kcmil - 4/0 AWG
YA36- YA39- YA40-	YS36- YS39- YS40-	600 kcmil 750 kcmil 800 kcmil	600 - 250 kcmil 750 - 500 kcmil 800 - 500 kcmil
YA44-	YS44-	1000 kcmil	1000 - 750 kcmil

\* 1 Crimp

\*\* 1 Crimp per side

### ALUMINUM

Aluminum HYLUG™ & HYLINK™ Connectors Types YA-A & YS-A (Copper or Aluminum Conductor)			
Catalog No.		Standard Wire Size	Expanded Wire Range
Terminal*	Splice**		
YA4CA- YA2CA- YA1CA-	YS4CA- YS2CA- YS1CA-	#4 AWG #2 AWG #1 AWG	#4 - #6 AWG #2 - #6 AWG #1 - #2 AWG
YA25A- YA26A- YA27A- YA28A-	YS25A- YS26A- YS27A- YS28A-	1/0 AWG 2/0 AWG 3/0 AWG 4/0 AWG	1/0 - #1 AWG 2/0 - #1 AWG 3/0 - #1 AWG 4/0 - #1 AWG
YA29A- YA30A- YA31A- YA32A- YA34A-	YS29A- YS30A- YS31A- YS32A- YS34A-	250 kcmil 300 kcmil 350 kcmil 400 kcmil 500 kcmil	250 kcmil - 1/0 AWG 300 kcmil - 2/0 AWG 350 kcmil - 3/0 AWG 400 kcmil - 4/0 AWG 500 kcmil - 4/0 AWG
YA36A- YA39A- YA40A-†	YS36A- YS39A- YS40A-†	600 kcmil 750 kcmil 800 kcmil	600 - 250 kcmil 750 - 500 kcmil 800 - 500 kcmil
YA44A-†	YS44A-†	1000 kcmil	1000 - 750 kcmil

\* 1 Crimp

\*\* 1 Crimp per side

† Not applicable for PAT644 Series or Y644HSXT.  
For use with only the 444S Series.



PAT444SL5

Expanded conductor ranges shown on this page are applicable when using the 644 & 444S Series of tools only.



Y644HSXT



## DIE INDEX REFERENCE

This chart provides a cross reference between die index numbers marked on BURNDY® Compression Connectors and corresponding BURNDY® Die Sets used with the various BURNDY® Installation Tools.

This is the only way to have complete connections with The BURNDY® Engineered System.

A die index number has been assigned to each required groove configuration. A prefix letter is used to indicate the specific installation tool for which the die has been designed, as shown.

### DIE PROFILES

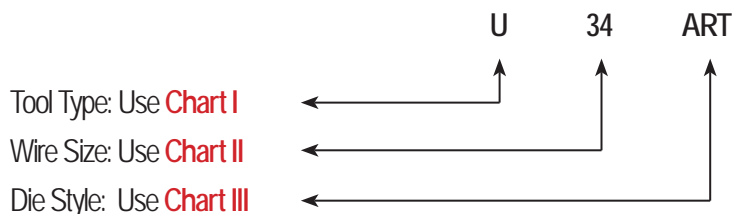
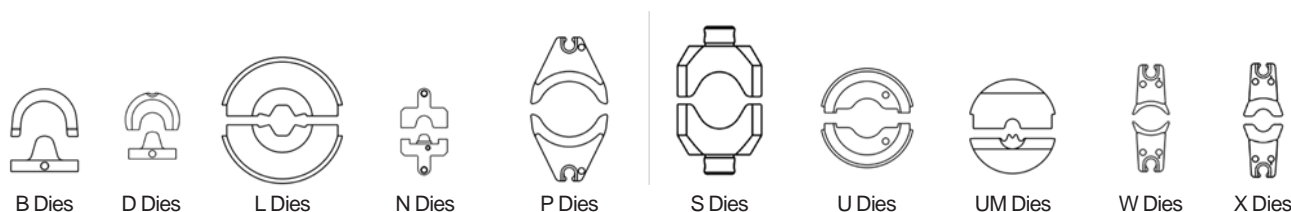

### CHART I - Tool Type

<b>B</b> = Y34BH	<b>U</b> = 35 and 750 Series, 46 Series w/PUADP1 U-die Adapter
<b>D</b> = Y29BH	
<b>L</b> = 60 Series	<b>UM</b> = OEM840NCP, 750 Series, 46 Series w/PUADP1 U-die Adapter
<b>N</b> = M8ND	
<b>P</b> = 46 Series	<b>W</b> = MD and PATMD Series, PAT500SJ, PAT600
<b>S</b> = Y45	<b>X</b> = MD6 and MD7 Series, OUR840

### CHART II - Wire Size

<b>12</b> = #12 AWG	<b>27</b> = 3/0
<b>10</b> = #10 AWG	<b>28</b> = 4/0
<b>8C</b> = #8 AWG	<b>29</b> = 250 kcmil
<b>6C</b> = #6 AWG	<b>30</b> = 300 kcmil
<b>5C</b> = #5 AWG	<b>31</b> = 350 kcmil
<b>4C</b> = #4 AWG	<b>32</b> = 400 kcmil
<b>3C</b> = #3 AWG	<b>34</b> = 500 kcmil
<b>2C</b> = #2 AWG	<b>36</b> = 600 kcmil
<b>1C</b> = #1 AWG	<b>39</b> = 750 kcmil
<b>25</b> = 1/0	<b>44</b> = 1000 kcmil
<b>26</b> = 2/0	

Or **INDEX NUMBER**: Example U312 = **312** Die Index

### CHART III - Die Style

**A** = Aluminum  
**R** = Round (circumferential)  
**T** = Twin Die (both halves)

Footnotes for the chart in the following pages:

- ① - Cat. No. Y35P3 Adapter is required to use "Y34PR" type indenters with "U" type nest dies in 35 and 750 Series
- ② - Cat. No. PT6515 Adapter is required to use "U" type dies in Y45
- ③ - Cat. No. PUADP1 Adapter is required to use "U" type dies in 46 Series
- ④ - These sizes (250 - 500 kcmil) are not recommended for use with MD6 & MD7 Series tools due to high handle force
- ⑤ - Hexagonal crimp
- ⑥ - Die 302 recommended for 1.84 O.D. barrel

## Installation Tools

The BURNDY® Engineered System features the most complete line of installation tools in the electrical industry. Available in various styles: battery actuated, mechanical, full cycle ratchet, self contained hydraulic, remote controlled hydraulic, along with power actuated pumps, hoses and accessories. BURNDY has the options to suit your needs. BURNDY tools are designed to integrate with the complete line of BURNDY connectors. Whether you are a small contractor working with #22 wire or a large utility working with 2500 kcmil conductor, there is a BURNDY tool available to do the job.

The benefits of the BURNDY® Engineered System are many, the most significant benefit being reliability. There is nothing more important to the electrical industry today than reliability. It represents the one area that leads to economical installations that will endure for the life of the installation.

## Tool Center

An important element of the BURNDY® Engineered System is the BURNDY Tool Center, located at 150 Burndy Road, Littleton, NH 03561, (800-426-8720 or 603-621-4499). This center provides advice and information on the operation, maintenance and repair of BURNDY tools. The repair center is staffed with specialized technicians who provide the best possible service for all BURNDY tools, pumps and accessories.

BURNDY designed and produced the first self contained hydraulic compression electrical connector installation tool in 1934. In our continuing efforts to provide the highest quality and highest value connection systems, we offer the current BURNDY tool policy.

## Limited Warranty

The majority of BURNDY tools are warranted to be free of defects in materials and workmanship for a period of five (5) years from the date of shipment. See specific tool page for length of warranty. If inspection by a certified technician shows the trouble is caused by defective workmanship or material, BURNDY will repair or (at our option) replace the tool.

This Warranty does not apply where:

- Repairs or alterations have been made or attempted by others
- Repairs are required because of normal wear and tear
- The tool has been abused, misused or improperly maintained
- The use of any non-BURNDY product has resulted in damage to the tool

## Return Procedure

All tools sent to the BURNDY Tool Center (1-800-426-8720) or an authorized repair center must be accompanied by a purchase order with detailed bill to and ship to address authorizing repair. Requests for repair charges before work is done must be stated on the purchase order. All tools sent to the BURNDY Tool Center or an authorized repair center as a warranty claim must be accompanied by a proof of purchase such as a BURNDY invoice or invoice from any BURNDY distributor.

All tools must be shipped at the owner's expense, prepaid. BURNDY pays for the return freight, same surface freight as received. Airfreight returns will be returned same way collect for non-warranty repair and prepaid for warranty repairs.

This warranty and repair policy supercedes all previous policies and is in effect as of January 1, 2010.

## Repair Policy

All non-warranty repaired tools are completely reconditioned and receive a limited 1-year warranty. Non-warranty repair returns tools to like-new condition at a maximum cost of 40% of a new tool. A nominal service charge of \$5 is applied to all repairs to cover shop supplies, oil disposal and other miscellaneous services not covered as part of the standard repair.

If the decision is made not to repair, a handling charge of \$25.00 will be applied plus return freight costs.



**WHEN FACING THE UNPREDICTABLE,  
YOU'RE NOT ALONE...**

** BURNDY HAS YOUR BACK!**

**PROFESSIONAL GRADE  
TOOLS YOU KNOW  
TOOLS YOU TRUST**

### **BURNDY Contact Information:**

**Customer Service Department  
7 Aviation Park Drive  
Londonderry, NH 03053  
1-800-346-4175  
1-800-451-4956 (Technical Services)**

**Tool Service Center  
Littleton Industrial Park  
Littleton, NH 03561  
1-800-426-8720**

**[www.burndy.com](http://www.burndy.com)**

