

LITTLE WONDER®

C5BLOWER

MODELS: 99170-06-01
SH265 KOHLER

99170-03-01
SP170 SUBARU

NOTICE

VIS

VISO

Do not use E15 or E85 fuel (or fuel containing greater than 10% ethanol) in this product. It is a violation of federal law and will damage the unit and void your warranty.



Ne pas utiliser d'essence E15 ou E85 (ou un carburant contenant plus de 10 % d'éthanol) dans ce produit. Une telle utilisation représente une violation de la loi fédérale et endommagera l'appareil et annulera la garantie.

No utilice combustibles E15 o E85 (ni combustibles que contengan más de 10 % de etanol) con este producto. Esto constituye una violación a la ley federal, dañará la unidad y anulará la garantía.

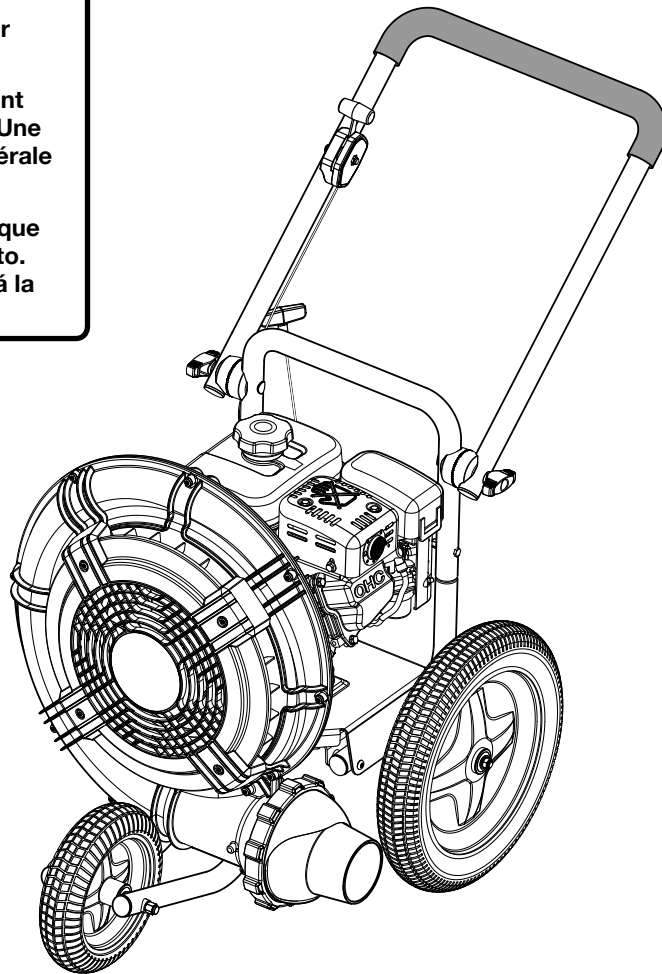

CALIFORNIA PROPOSITION 65



WARNING: Cancer and Reproductive Harm - www.P65Warnings.ca.gov.



ADVERTENCIA: Cáncer y Daño Reproductivo - www.65Warnings.ca.gov.

WARNING

The engine exhaust from this product contains chemicals known to the State of California to cause cancer, birth defects or other reproductive harm.

ADVERTENCIA

El estado de California hace saber que los gases de escape de este producto contienen productos químicos que producen cáncer, defectos de nacimiento y otros daños en el proceso de reproducción humana.

IMPORTANT!

It is a violation of California Public Resource Code Section 4442 or 4443 to use or operate the engine on any forest-covered, brush-covered or grass-covered land unless the engine is equipped with a spark arrestor, as defined in Section 4442, maintained in effective working order or the engine is constructed, equipped, and maintained for the prevention of fire.

To acquire a spark arrestor for your unit, see your Engine Service Dealer.

Please refer to the engine manufacturer's information included with the machine.

Labeled power ratings are supplied by the engine manufacturer in accordance with SAE testing and gross/net power rating standards (J1940, J1995, J1349).

LITTLE WONDER C5 BLOWER

TABLE OF CONTENTS

IMPORTANT MESSAGE

On behalf of everyone at Little Wonder, we would like to thank you for your purchase of a Little Wonder C5 Blower. This manual provides the information necessary for safe and efficient operation and service. For your safety, it is critically important that you read and understand this entire manual before operating your blower.

Customer Support Information:

You can seek assistance from our Customer Support Group if you have questions assembling this product or have any questions regarding the controls, operation, or maintenance of this machine:

Website: <https://www.littlewonder.com/contact/>

Phone: 1-877-596-6337 (Toll-free) (215)357-5110

Hours: Monday through Friday 8:00am - 5:00pm , ET

OR Write to:

LITTLE WONDER
SCHILLER GROUNDS CARE, INC.
1028 STREET ROAD, P.O. BOX 38
SOUTHAMPTON, PA 18966

TABLE OF CONTENTS	FIGURES	PAGE
TABLE OF CONTENTS.....		2
SYMBOLS.....		3- 4
GENERAL SAFETY RULES		5
SPECIFIC SAFETY RULES.....		6
LABELS.....		7
ASSEMBLY		8
OPERATION		9-12
MAINTENANCE.....		13-17
TROUBLESHOOTING		18
PARTS SECTION.....		19- 23
WARRANTY.....		24

MANY USES:

The extreme versatility offered by LITTLE WONDER'S line of blowers makes them ideally suited for a wide variety of jobs; blowing leaves, grass clippings, thatch, blowing tennis courts dry, cleaning large driveways, stadiums, parking lots and other hard surfaces, and countless other jobs.





This Operator's Manual is part of the machine. Suppliers of both new and secondhand machines must make sure that this manual is provided with the machine.









SYMBOLS

LITTLE WONDER C5 BLOWER

The following signal words and meanings are intended to explain the levels of risk associated with this product.

SYMBOL	SIGNAL	MEANING
	DANGER:	Indicates an imminently hazardous situation, which, if not avoided, will result in death or serious injury.
	WARNING:	Indicates a potentially hazardous situation, which, if not avoided, could result in death or serious injury.
	CAUTION:	Indicates a potentially hazardous situation, which, if not avoided, may result in minor or moderate injury.
	NOTICE:	(Without Safety Alert Symbol) Indicates important information not related to an injury hazard, such as a situation that may result in property damage.

Some of the following symbols may be used on this product. Please study them and learn their meaning. Proper interpretation of these symbols will allow you to operate the product better and safer.

SYMBOL	NAME	EXPLANATION
	Safety Alert Symbol	Indicates a potential personal injury hazard.
	Read Operator's Manual	To reduce the risk of injury, user must read and understand operator's manual before using this product.
	Eye and Hearing Protection	Always wear eye protection with side shields marked to comply with ANSI Z87.1 along with hearing protection.
	Keep Bystanders Away	Keep all bystanders at least 50 ft. away.
	Ricochet	Thrown objects can ricochet and result in personal injury or property damage.
	Air Inlet Cover	Do not run unit if the air inlet cover becomes damaged or unsecured in any way.
	Long Hair	Risk of long hair being drawn into air inlet.
	Loose Clothing	Risk of loose clothing being drawn into air intake.

NOTICE !!!

Unauthorized modifications may present **extreme** safety hazards to operators and bystanders and could also result in product damage.

Schiller Grounds Care, Inc. strongly warns against, rejects and disclaims any modifications, add-on accessories, or product alterations that are not designed, developed, tested, and approved by Schiller Grounds Care, Inc., Engineering Department. Any Schiller Grounds Care, Inc., product that is altered, modified or changed in any manner not specifically authorized after original manufacture including the addition of "after-market" accessories or component parts not specifically approved by Schiller Grounds Care, Inc. will result in the Schiller Grounds Care, Inc., Warranty, being voided.

Any and all liability for personal injury and/or property damage caused by any unauthorized modifications, add-on accessories, or products not approved by Schiller Grounds Care, Inc., will be considered the responsibility of the individual(s) or company designing and/or making such changes. Schiller Grounds Care, Inc., will vigorously pursue full indemnification and costs from any party responsible for such unauthorized post-manufacture modifications and/or accessories should personal injury and/or property damage result.

Schiller Grounds Care, Inc.

1028 Street Road
Southampton, PA 18966 U.S.A
Phone: 215-357-5110
Fax: 215-357-8045

MODEL NUMBER

SERIAL NUMBER

MODEL NUMBER: This number appears on sales literature, technical manuals and price lists.

SERIAL NUMBER: This number appears only on your unit. It contains the model number followed consecutively by the serial number. Use this number when ordering parts or seeking warranty information.



WARNING:

READ AND UNDERSTAND ALL INSTRUCTIONS.

Failure to follow all instructions listed below may result in electric shock, fire and/or serious personal injury.

READ ALL INSTRUCTIONS

- Do not allow children or untrained individuals to use this unit.
- Do not start or operate the engine in a confined space, building, near open windows, or in other unventilated space where dangerous carbon monoxide fumes can collect. Carbon monoxide, a colorless, odorless, and extremely dangerous gas, can cause unconsciousness or death.
- Always wear eye protection with side shields marked to comply with ANSI Z87.1, along with hearing protection. Failure to do so could result in objects being thrown into your eyes and other possible serious injuries.
- Keep all bystanders, children, and pets at least 50 ft. away.
- Wear heavy long pants, long sleeves, boots, and gloves. Do not wear loose fitting clothing, short pants, sandals, jewelry of any kind, or go barefoot.
- To reduce the risk of injury associated with objects being drawn into rotating parts, do not wear loose clothing, scarves, neck chains, etc.
- Secure long hair so it is above shoulder level to prevent entanglement in any rotating parts.
- Do not operate this unit when you are tired, ill, or under the influence of alcohol, drugs, or medication.
- Do not operate in poor lighting.
- Keep all parts of your body away from any moving parts and all hot surfaces of the unit.
- Wear a face filter mask in dusty conditions to reduce the risk of injury associated with the inhalation of dust.
- Check the work area before each use. Remove all objects such as rocks, broken glass, nails, wire, or string which can be thrown or become entangled in the machine.
- Keep firm footing and balance. Do not overreach. Overreaching can result in loss of balance or exposure to hot surfaces.
- Before storing, allow the engine to cool.
- Empty fuel tank into a container approved for gasoline and restrain the unit from moving before transporting in a vehicle.
- To reduce the risk of fire and burn injury, handle fuel with care. It is highly flammable.
- Do not smoke while handling fuel.
- Mix and store fuel in a container approved for gasoline.
- Mix fuel outdoors where there are no sparks or flames.
- Select bare ground, stop engine, and allow to cool before refueling.
- Loosen fuel cap slowly to release pressure and to keep fuel from escaping around the cap.
- Tighten the fuel cap securely after refueling.
- Wipe spilled fuel from the unit. Move 30 ft. away from refueling site before starting engine.
- Never attempt to burn off spilled fuel under any circumstances.
- Use only identical manufacturer's replacement parts and accessories. Use of any other parts may create a hazard or cause product damage.
- Maintain the unit per maintenance instructions in this Operator's Manual.
- Inspect the unit before each use for loose fasteners, fuel leaks, etc. Replace damaged parts.
- Do not use on a ladder, rooftop, tree, or other unstable support. Stable footing on a solid surface enables better control of the blower in unexpected situations.
- Before cleaning, repairing, or inspecting, shut off the engine and make certain all moving parts have stopped. Disconnect the spark plug wire, and keep the wire away from the plug to prevent starting.
- Service on the blower must be performed by qualified repair personnel only. Service or maintenance performed by unqualified personnel could result in injury to the user or damage to the product.

LITTLE WONDER C5 BLOWER

SPECIFIC SAFETY RULES

- Refer to the *Operation* instructions later in this manual for proper position during blower operation and additional information.
- To reduce the risk of hearing loss associated with sound level(s), hearing protection is required.
- To reduce the risk of injury associated with contacting rotating parts, stop the engine before installing or removing attachments. Always disconnect the spark plug before performing maintenance or accessing any movable parts.
- Do not point the blower nozzle in the direction of people or pets.
- Never run the unit without the blower tubes installed.
- Never place objects inside the blower tubes.
- Use only as directed in this operator's manual.
- Never use blower near fires, fireplaces, hot ashes, barbecue pits, etc., which may cause fire to spread.
- Prolonged periods of operation can cause circulatory problems in the user's hands due to vibration. For such use, it may be appropriate to use a product having an anti-vibration feature.

FUELING

- Fuel is highly flammable. Take precautions when using to reduce the chance of serious personal injury.
- Store fuel in a cool, well-ventilated area, safely away from spark and/or flame-producing equipment.
- Store fuel in containers specifically designed for this purpose.

- Only refuel outdoors and do not smoke while refueling.
- Add fuel before starting the engine. Never remove the cap of the fuel tank or add fuel while the engine is running or when the engine is hot.
- Do not smoke while handling fuel.
- Loosen fuel cap slowly to release pressure and to keep fuel from escaping around the cap.
- Tighten the fuel cap securely after refueling.
- Wipe spilled fuel from the unit. Move 30 feet away from refueling site before starting engine.
- Never attempt to burn off spilled fuel under any circumstances.
- To reduce the risk of fire and burn injury, handle fuel with care. It is highly flammable.
- If fuel is spilled, do not attempt to start the engine but move the machine away from the area of spillage and avoid creating any source of ignition until fuel vapors have dissipated.
- Replace all fuel tank and container caps securely.
- Empty fuel tank into a container approved for gasoline and restrain the unit from moving before transporting in a vehicle.
- When draining the fuel tank, use an approved fuel storage container in a well-ventilated area.
- Save these instructions. Refer to them frequently and use them to instruct others who may use this tool. If you loan someone this tool, loan them these instructions also.

SAFETY DECALS

An important part of the safety system incorporated in this blower is the warning labels found on the blower. Replace labels if damaged or illegible.



LITTLE WONDER C5 BLOWER

ASSEMBLY

UNPACKING

This product has been shipped completely assembled.

- Carefully remove the product and any accessories from the box. Make sure that all items listed in the packing list are included.

⚠ WARNING:

Do not use this product if it is not completely assembled or if any parts appear to be missing or damaged. Use of a product that is not properly and completely assembled could result in serious personal injury.

- Inspect the product carefully to make sure no breakage or damage occurred during shipping.
- Do not discard the packing material until you have carefully inspected and satisfactorily operated the product.
- If any parts are damaged or missing, please call 1-877-596-6337 for assistance.

PACKING LIST

Blower Assembly

4-Cycle Engine Lubricant

Operator's, Parts, & Safety Manual

NOTE: Read and remove all hang tags and store with the Operator's, Parts, & Safety Manual.

⚠ WARNING:

If any parts are damaged or missing do not operate this product until the parts are replaced. Use of the product with damaged or missing parts could result in possible serious personal injury.

⚠ WARNING:

Do not attempt to modify this product or create accessories not recommended for use with this tool. Any such alteration or modification is misuse and could result in a hazardous condition leading to possible serious personal injury.

⚠ WARNING:

To prevent accidental starting that could cause serious personal injury, always disconnect the engine spark plug wire from the spark plug when assembling parts.

⚠ WARNING:

Do not attempt to lift the unit by the handle assembly. If it is necessary to lift the blower, always grasp by the frame. Use proper lifting techniques to avoid back injury.

RAISING/ADJUSTING THE HANDLE

See Figure 1.

To raise the handle:

- Turn handle knobs counterclockwise to loosen.
- Grasp handle and lift up and back to the desired position.
- Turn handle knobs clockwise to securely lock the handle in place.

To adjust handle position:

- Turn off blower.
- Loosen handle knobs.
- Grasp handle and rotate forward or backward to the desired position.
- Lock handle knobs.

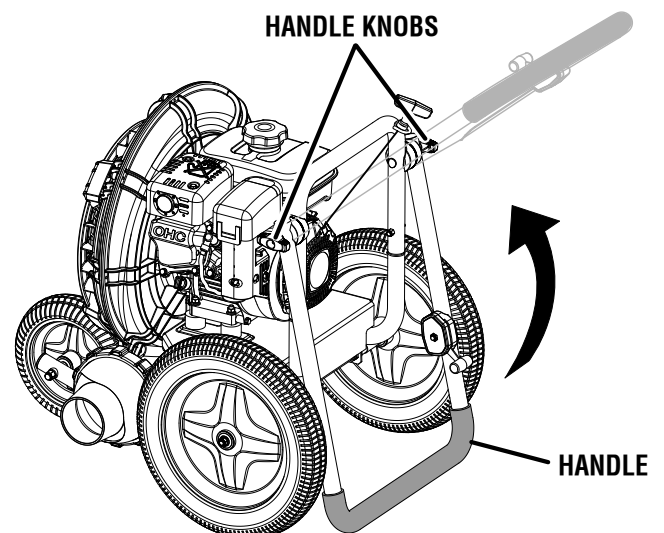

FIGURE 1



WARNING:

Do not allow familiarity with product to make you careless. Remember that a careless fraction of a second is sufficient to inflict serious injury.



WARNING:

Always wear eye protection with side shields marked to comply with ANSI Z87.1, along with hearing protection. Failure to do so could result in objects being thrown into your eyes and other possible serious injuries.

NOTICE:

This product is not equipped with a spark arrestor and cannot be used on U.S. forest lands; in addition, product users must comply with Federal, State, and local fire prevention regulations. Check with appropriate authorities. Refer to accompanying engine manual for maintenance and replacement parts.

APPLICATIONS

You may use this product for the purposes listed below:

- Clearing patios and other debris from your lawn
- Keeping decks and driveways free from grass clippings, leaves, pine needles, and other debris

CHECKING/ADDING LUBRICANT

See Figure 2.

NOTICE:

Attempting to start the engine before it has been properly filled with lubricant will result in equipment failure.

Engine lubricant has a major influence on engine performance and service life. For general, all-temperature use, SAE 10W-30 is recommended. Always use a 4-stroke motor lubricant that meets or exceeds the requirements for API service classification SJ.

NOTE: Non-detergent or 2-stroke engine lubricants will damage the engine and should not be used.

- Unscrew the oil cap/dipstick and remove.
- Wipe dipstick clean and re-seat in hole; do not re-thread.
- Remove dipstick again and check lubricant level. Lubricant level should fall between the hatched areas on the dipstick.
- If level is low, add engine lubricant until the fluid level rises to the upper portion of the dipstick.
- Replace and secure the oil cap/dipstick.

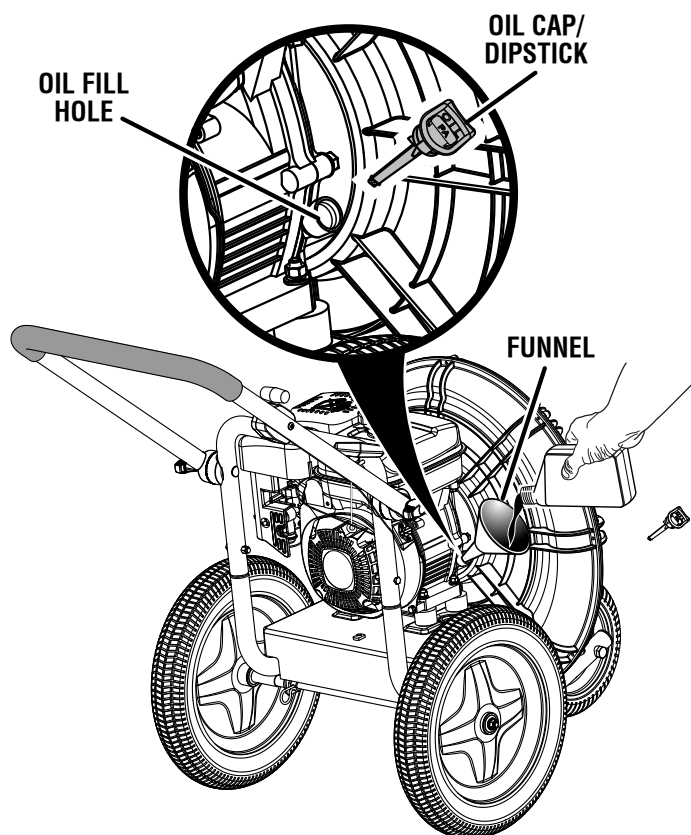

FIGURE 2

OXYGENATED FUELS

NOTICE: Do not use E15 or E85 fuel (or fuel containing greater than 10% ethanol) in this product. It is a violation of federal law and will damage the unit and void your warranty.

NOTE: Fuel system damage or performance problems resulting from the use of an oxygenated fuel containing more than the percentages of oxygenates stated below **are not covered under warranty.**

Ethanol. Gasoline containing up to 10% ethanol by volume (commonly referred to as E10) is acceptable. **E15 and E85 are not.**

LITTLE WONDER C5 BLOWER

OPERATION

CHECKING/ADDING FUEL

See Figure 3.

WARNING:

Gasoline and its vapors are highly flammable and explosive. To prevent serious personal injury and property damage, handle gasoline with care. Keep away from ignition sources, handle outdoors only, do not smoke while adding fuel, and wipe up spills immediately.

WARNING:

Always shut off engine before fueling. Never add fuel to a machine with a running or hot engine. Move at least 30 ft. from refueling site before starting engine. Do not smoke and stay away from open flames and sparks. Unsafe handling of fuel could result in serious personal injury.

When adding gas, make sure the unit is sitting on a flat, level surface. If the engine is hot, let the blower cool before adding gas. **ALWAYS** fill the fuel tank outdoors with the machine turned off.

- Remove the fuel cap slowly.
- Fill the fuel tank to 1 in. below the top of the fuel neck.
- Replace and secure the fuel cap.
- Wipe spilled fuel from the product.

NOTE: It is normal for smoke to be emitted from a new engine during first use.

NOTE: Always use unleaded gasoline with a pump octane rating of 86 or higher. Never use old, stale, or contaminated gasoline, and do not use an oil/gas mixture. Do not allow dirt or water into the fuel tank.

Do not use E85 fuel.

STARTING/STOPPING THE ENGINE

Sees Figure 4 - 6.

NOTICE:

On a level surface with the engine off, check the lubricant level before each use.

To start the engine:

- Check all fluid levels (lubricant and gas).
- Turn the fuel valve to the **ON** position.

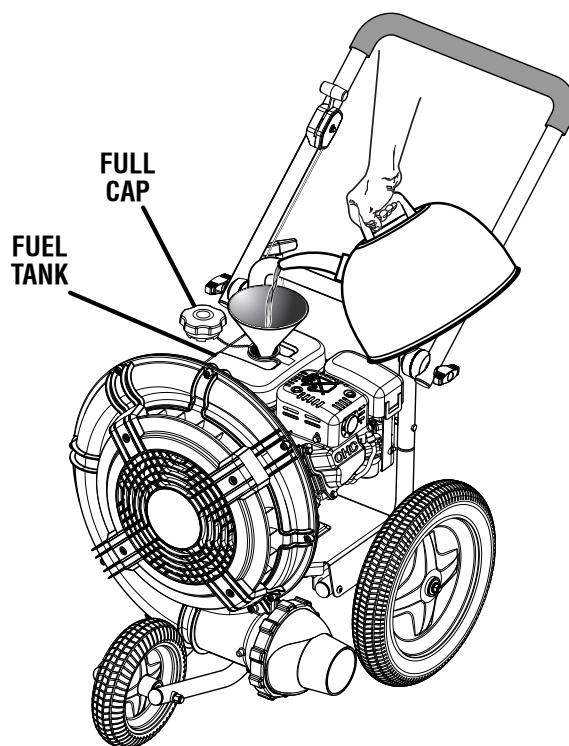

FIGURE 3

- Place the on/off switch in the **ON** position.
- Push the choke lever to the choke position.
- Set the throttle lever 1/3 of the way to the full (👉) position.
- Pull the starter grip and rope sharply until engine attempts to run (no more than 4 pulls).
- Push the choke lever to the half position.
- Hold the blower securely by grasping the handle below the throttle lever (see figure 5).
- Grasp the starter grip and pull slowly until resistance is felt. Give the starter grip a short, brisk pull to start the engine.
NOTE: Do not allow the grip to snap back after starting; return it gently to its original place.
- Allow the engine to run for 10 seconds, then push the choke lever to the right for the run position.

To stop the engine:

- To stop the engine, set the throttle lever to the slow position.
- Put the on/off switch in the **OFF** position.
- Turn the fuel valve to the **CLOSED** position.

⚠ WARNING:

While operating and storing, keep at least 3 feet of clearance on all sides of this product, including overhead. Allow a minimum of 30 minutes of “cool down” time before storage. Heat created by muffler and exhaust gases can be hot enough to cause serious burns and/or ignite combustible objects.

OPERATING THE BLOWER

See Figures 7 - 8.

⚠ WARNING:

Do not position the blower tube where it will blow debris towards people, pets, open windows or other objects in the area. Flying debris may result in serious personal injury or property damage.

This product has a blower tube on the side of the product that can be swivelled to change air flow direction.

NOTE: Do not start the blower until the blower tube has been adjusted to the desired position.

Adjusting the blower tube/air direction:

- Grasp the adjustment ring with both hands and turn counterclockwise to loosen.
- Turn the blower tube to the “up position” to reduce windrowing or to push heavy piles over to continue moving debris.
- Turn the blower tube to the “side position” to form windrows or piles.
- Turn the blower tube to the “forward position” to blow debris along a curb or wall.
- Tighten blower tube in place by turning the adjustment ring clockwise.

General usage tips:

NOTICE:

Always operate your product in compliance with all applicable laws and ordinances.

- Start the blower. Refer to **Starting/Stopping the Engine** earlier in this manual.
- To keep from scattering debris, blow around the outer edges of a debris pile. Never blow directly into the center of a pile.
- Operate power equipment at reasonable hours only — not early in the morning or late at night when people might be disturbed. Comply with the times listed in local ordinances.

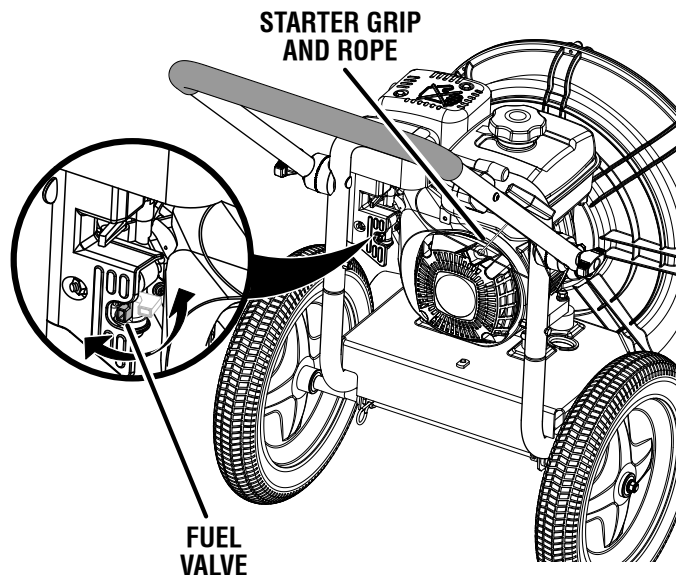

FIGURE 4

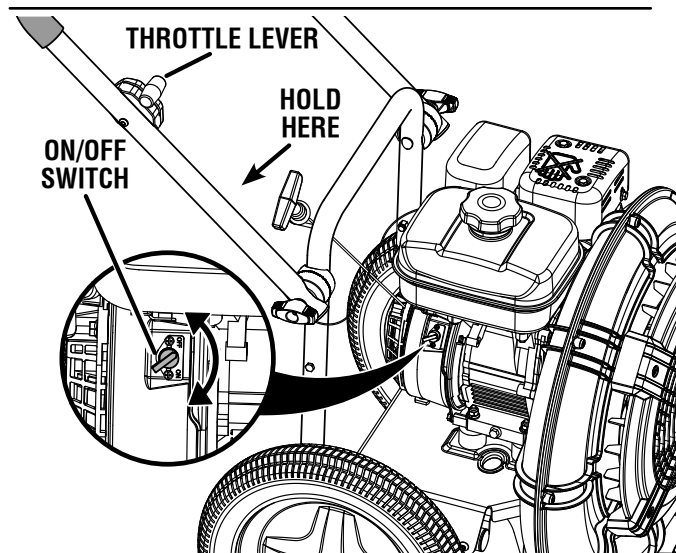

FIGURE 5

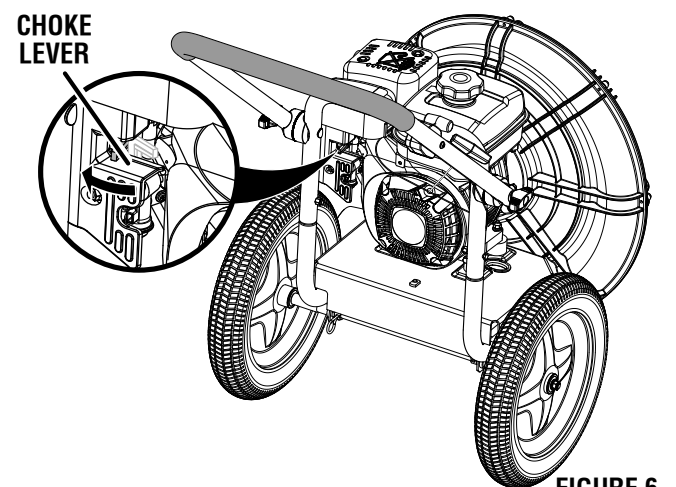

FIGURE 6

LITTLE WONDER C5 BLOWER

OPERATION

- To reduce sound levels, limit the number of pieces of equipment used at any one time.
- Operate blower at the lowest possible throttle speed to do the job.
- Check your equipment before operation, especially the muffler, air intakes, and air filters.
- Use rakes and brooms to loosen debris before blowing. In dusty conditions, slightly dampen surfaces when water is available.
- Conserve water by using power blowers instead of hoses for many lawn and garden applications, including areas such as gutters, screens, patios, grills, porches, and gardens.
- Watch out for children, pets, open windows, or freshly washed cars, and blow debris safely away.
- After using blowers or other equipment, CLEAN UP! Dispose of debris properly.

SLOPE OPERATION

WARNING:

Use extra care when operating on slopes. Evaluate the risks involved before operating on a slope.

- Slopes are a major factor related to slip and fall accidents that sometimes lead to severe injury or death. All slopes require extra caution.
- Do not operate on slopes if uneasy or uncertain. Ultimate responsibility for safe operation on slopes rests with the operator.
- Do not operate on steep slopes. Poor footing could cause a slip and fall accident. Keep all movement on slopes slow and gradual.
- Do not operate near drop-offs, ditches or embankments. You could lose your footing or balance or drive the machine off the edge.
- Always be sure of your footing.
- Watch for holes, ruts, rocks, hidden objects, or bumps which can cause you to slip or trip. Uneven terrain could cause a slip and fall accident. Tall grass can hide objects.

HIGH ALTITUDE OPERATION

Specific modifications are needed for high-altitude operation. Please contact your authorized service center for important information regarding these modifications. Operating this engine without the proper altitude modification may increase the engine's emissions and decrease fuel economy and performance.

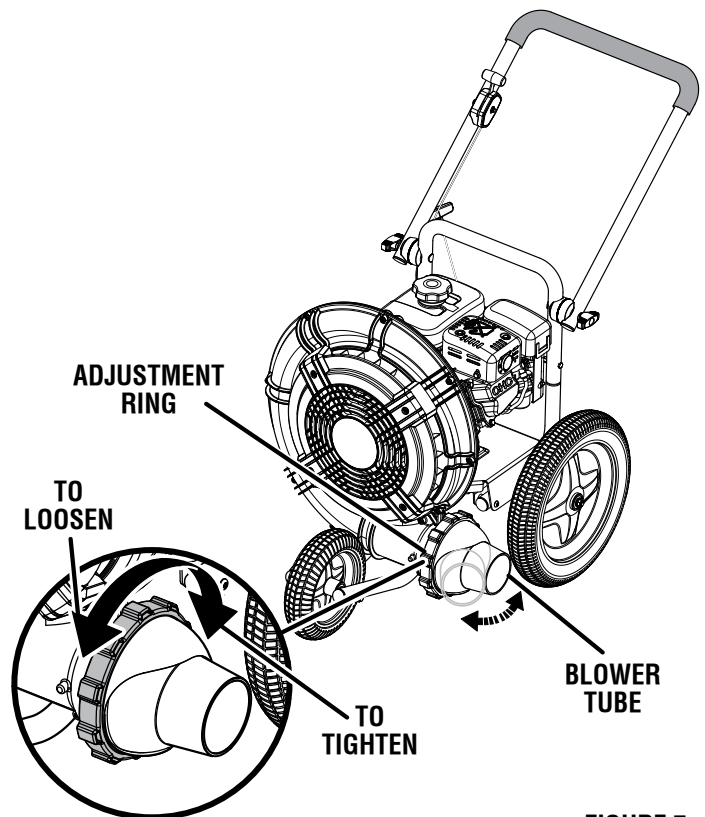

FIGURE 7



FIGURE 8

WARNING:

When servicing, use only identical replacement parts. Use of any other parts can create a hazard or cause product damage.

WARNING:

Always wear eye protection with side shields marked to comply with ANSI Z87.1, along with hearing protection. Failure to do so could result in objects being thrown into your eyes and other possible serious injuries.

WARNING:

Before inspecting, cleaning, or servicing the machine, shut off engine, wait for all moving parts to stop, and disconnect spark plug wire and move it away from spark plug. Failure to follow these instructions can result in serious personal injury or property damage.

NOTICE:

This product is not equipped with a spark arrester and cannot be used on U.S. forest lands; in addition, product users must comply with Federal, State, and local fire prevention regulations. Check with appropriate authorities. Refer to accompanying engine manual for maintenance and replacement parts.

GENERAL MAINTENANCE

Avoid using solvents when cleaning plastic parts. Most plastics are susceptible to damage from various types of commercial solvents and may be damaged by their use. Use clean cloths to remove dirt, dust, lubricant, grease, etc.

WARNING:

Do not at any time let brake fluids, gasoline, petroleum-based products, penetrating lubricants, etc., come in contact with plastic parts. Chemicals can damage, weaken or destroy plastic which could result in serious personal injury.

CHECKING/CLEANING AIR FILTER

See Figure 9.

For proper performance and long life, keep air filter clean. See engine manual for details

CHANGING ENGINE LUBRICANT

See Figure 10.

- Remove the oil cap/dipstick.
- Place a container underneath the oil drain plug to collect used lubricant as it drains.
- Unscrew the oil drain plug and remove.
- Allow lubricant to drain completely.

NOTE: Drain the lubricant while the engine is still warm but not hot. Warm lubricant will drain quickly and more completely.



WARNING:

Do not change engine lubricant while it is hot. Accidental contact with hot engine lubricant could result in serious burns.

- Reinstall the oil drain plug and tighten securely.
- Refill with lubricant following the instructions in the **Checking/Adding Lubricant** section.
- Reinstall the oil cap/dipstick.

NOTE: Used lubricant should be disposed of at an approved disposal site. See your local oil retailer for more information.

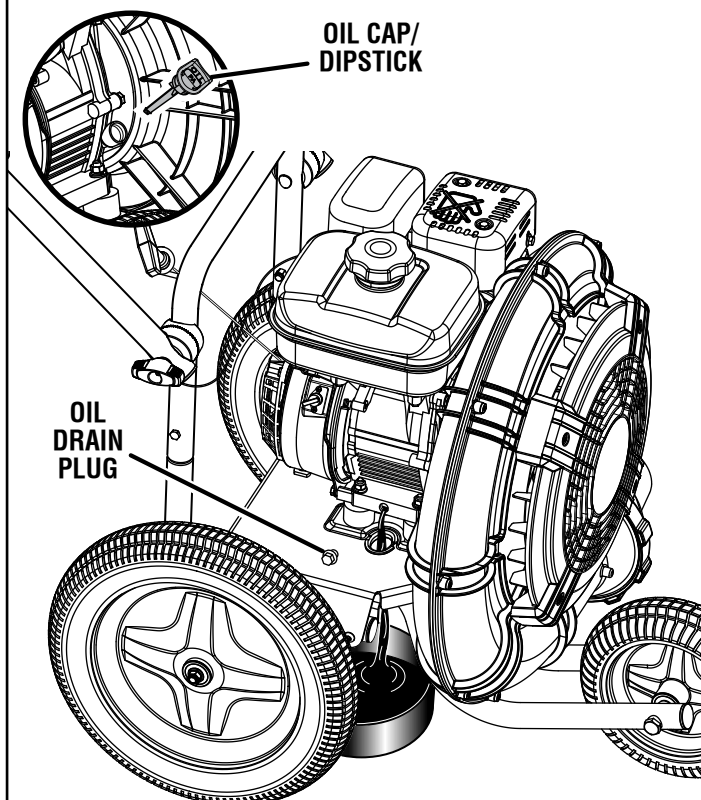

FIGURE 10

SPARK PLUG MAINTENANCE

See Figure 11.

For replacement spark plug, see Product Specifications earlier in this manual or the accompanying engine manual, if applicable. Use an exact replacement and replace annually, or more frequently if necessary.

NOTICE:

Be careful not to cross-thread the spark plug. Cross-threading will seriously damage the product.

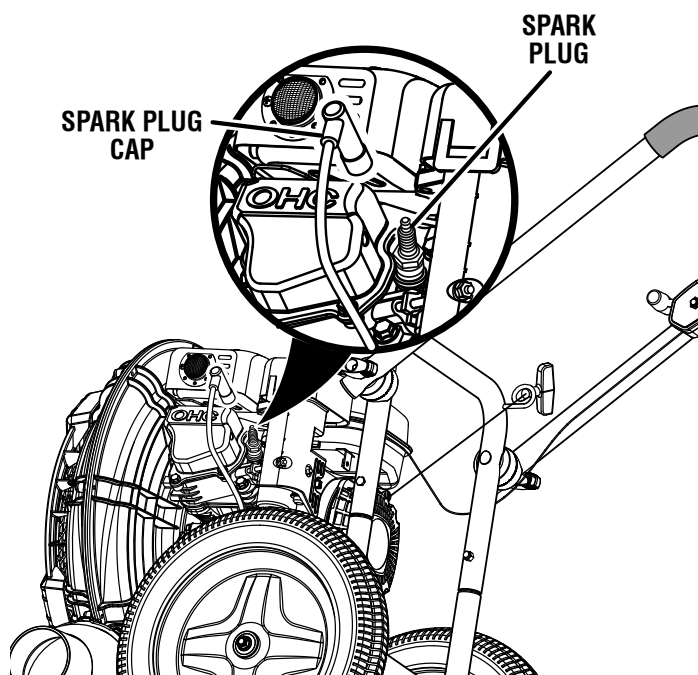

FIGURE 11

CLEANING THE EXHAUST PORT AND MUFFLER

Depending on the type of fuel used, the type and amount of lubricant used, and/or your operating conditions, the exhaust port and muffler may become blocked with carbon deposits. If you notice a power loss with your gas-powered products, you may need to remove these deposits to restore performance. We highly recommend that only qualified service technicians perform this service.

LITTLE WONDER C5 BLOWER

FAN REMOVAL AND INSTALLATION

WARNING

Before performing any type of maintenance on the machine, stop engine, wait for all parts to stop moving and disconnect spark plug. Failure to follow this instruction could result in personal injury or property damage.

FAN REMOVAL AND INSTALLATION

TOOLS REQUIRED

- 5/16" Wrench
- T20 (Torx) driver
- 1/2" torque wrench and wrench
- 3/4" wrench (if fan seized onto crankshaft)
- 1/2"-13 x 5" long Grade 5 or better bolt (if fan seized on crankshaft)
- Loctite Silver LB 8150 anti-seize compound

NOTE: Subaru and Kohler models use different parts for fan replacement. The Subaru kit uses a 2" long black bolt, and the Kohler kit uses a 1.75" long yellow zinc bolt. The Kohler kit uses a spacer; the Subaru does not use a spacer.

INSTRUCTIONS:

1. Remove spark plug wire from spark plug and turn fuel shutoff to the "OFF" position. Always ensure the fan is not moving before performing any maintenance.
2. Remove the housing cover bolts and nuts using a T20 driver and 5/16" wrench. Remove housing cover from machine.
3. Remove the bolt that secures the fan to the engine crankshaft using a 1/2".
4. If the fan does not slide off the crankshaft, the fan 1/2"-13 threads on fan hub. Use a 3/4" wrench to turn a 1/2"-13 x 5" long grade 5 (or better) bolt into the hub threads to jack or push the fan off the machine.
5. Clean crankshaft internal threads with degreaser. Use compressed air and a clean rag to remove degreaser and any metal fragments on internal threads.
6. Apply Loctite Silver LB8150 anti-seize compound to the crankshaft.
7. Install the spacer **8 (Kohler only)** on the crankshaft. Ensure that the inner curved edge of the spacer slides onto the crank shaft first, such that it mates to the curved end of the crank shaft. Replace damaged or worn fan assembly **7**. Fan assembly **7** includes Items **4 - 6** in parts list.
8. Slidelock-washer **2** and washer **3** onto new bolt **1** as shown in illustrated parts list.
9. Torque bolt to 20-30 ft-lbs. using a 1/2" torque wrench.
10. Reinstall housing cover and tighten bolts and nuts using a T20 driver and 5/16" wrench.
11. Reattach spark plug wire to spark plug.
12. After installation, wait 24 hours before starting machine. Loctite must fully cure before the machine is used.

FAN REMOVAL AND INSTALLATION

LITTLE WONDER C5 BLOWER

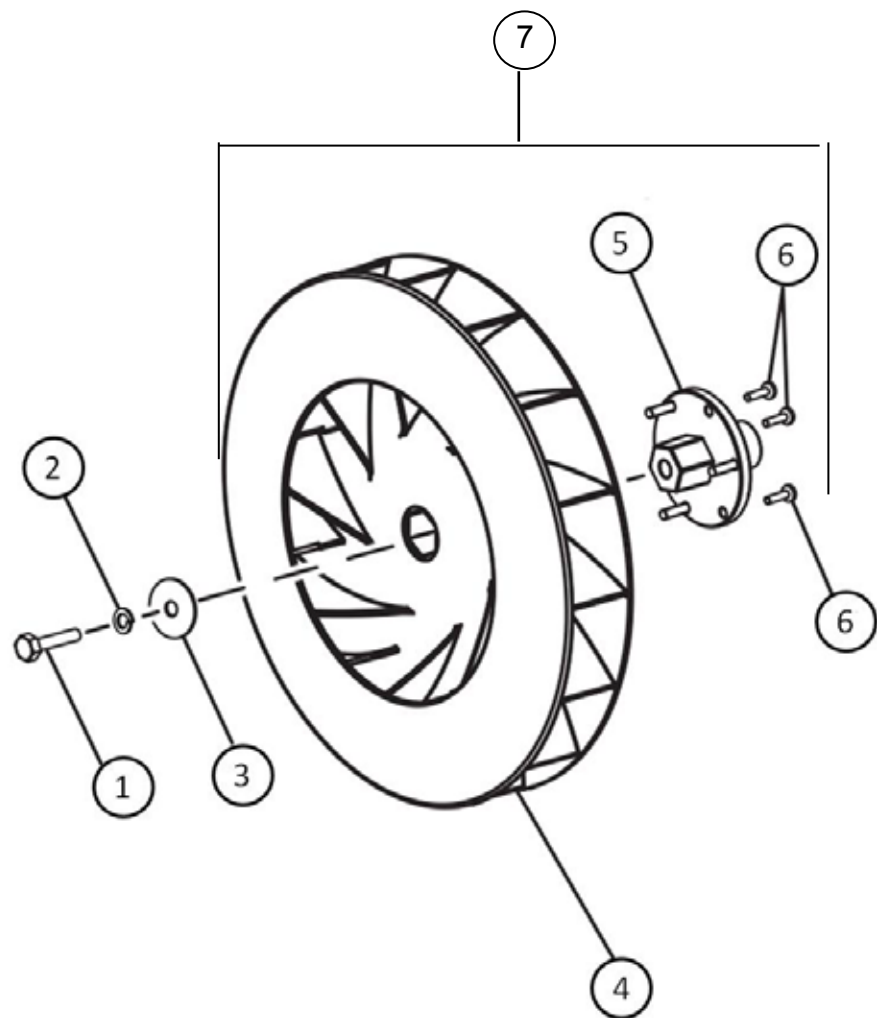

Item	Part No.	Description	Kit Number for Part	QTY
1	664002003(Subaru Only)	Bolt, 5/16-24 x 2.00" Hex, GR8 black	4177215	1
	4177482 (Kohler Only)	Bolt, 5/16-24 x 1.75" Hex GR8 yellow	4177215	1
2	638678002	Washer, Lock, 5/16	4177215	1
3	638966001	Washer, 5/16", Heavy	4177215	1
4	524646001	Impeller	Included in 4177244	1
5	306813001	Impeller Adapter	Included in 4177244	1
6	661830001	Screw, 1/4-15x32 mm T30 Pan Hd	Included in 4177244	3
7 Exploded view pictured	4177244	S-ASSEMBLY, FAN	4177215	1
8 Not pictured	4175052 (KOHLER ONLY)	Spacer, Fan	4177215	1

LITTLE WONDER C5 BLOWER

MAINTENANCE

MAINTENANCE SCHEDULE

Maintenance Items	Each use	Weekly	50 hrs	200 hrs	500 hrs	1000 hrs
Clean engine and check nuts and bolts	X					
Check and refill engine lubricant	X					
Change engine lubricant (initial change) ²	X					
Change engine lubricant			X (Every 100 hours)			
Clean spark plug			X			
Clean air filter			X			
Replace air filter element				X		
Replace fuel tank filter			X (Every 100 hours)			
Clean and adjust spark plug and electrodes				X		
Replace spark plug					X	

1. These items should only be carried out by an authorized service center.
2. If a separate engine manual is provided, please follow the maintenance schedule provided in the engine manual instead of the maintenance information listed below.

NOTE: If you are not sure how to perform any of the maintenance items listed above, take the unit to an authorized service center to have the maintenance item performed.

TRANSPORTING

- Turn on/off switch to **OFF**.
- Turn the fuel valve to the **OFF** position.
- Make sure engine and exhaust of unit is cool.
- Empty the fuel tank.
- Do not drop or strike unit or place under heavy object.

STORAGE WARNING

To prevent possible explosion or ignition of vaporized fuel, do not store equipment with fuel in tank or carburetor in an enclosure with open flame (for example, a furnace or water heater pilot).

Before the equipment is put into storage for any period exceeding 30 days, the following steps should be completed.

1. Drain all fuel from the fuel tank and fuel lines.
2. Start the engine and run until all the fuel is used from the carburetor float bowl and the engine stops.
3. While the engine is still warm, drain the crankcase oil and replace with the proper weight oil corresponding to the season the equipment will be next used.
4. Remove the spark plug and squirt a small amount of engine oil into the cylinder. Slowly pull the starter a few times to distribute oil in the cylinder and reinstall the spark plug.
5. Check oil level again and top off if necessary. See engine manual for details.

To put the equipment into service after an extended period of storage.

1. Check for loose parts and tighten if necessary.
2. Fill the fuel tank and then check the engine oil level. Top off if necessary. See engine manuals for details.
3. Start the engine and check for fuel leaks. Repair any leaks before operating the unit.

TROUBLESHOOTING

LITTLE WONDER C5 BLOWER

IF THESE SOLUTIONS DO NOT SOLVE THE PROBLEM, CONTACT YOUR AUTHORIZED SERVICING DEALER.

PROBLEM	CAUSE	REMEDY
Engine fails to start	No fuel in tank	Fill tank.
	Spark plug shorted or fouled	Replace spark plug.
	Spark plug is broken (cracked porcelain or electrodes broken)	Replace spark plug.
	Ignition lead wire shorted, broken, or disconnected from spark plug	Replace lead wire or attach to spark plug.
	Ignition inoperative	Contact authorized service center.
Engine hard to start	Water in gasoline or stale fuel mixture	Drain entire system and refill with fresh fuel.
	Engine is under or over choked	Adjust choke as necessary.
	Weak spark at spark plug	Contact authorized service center.
Engine lacks power	Dirty air filter	Clean or replace air filter.

PARTS SECTION

LITTLE WONDER C5 BLOWERS

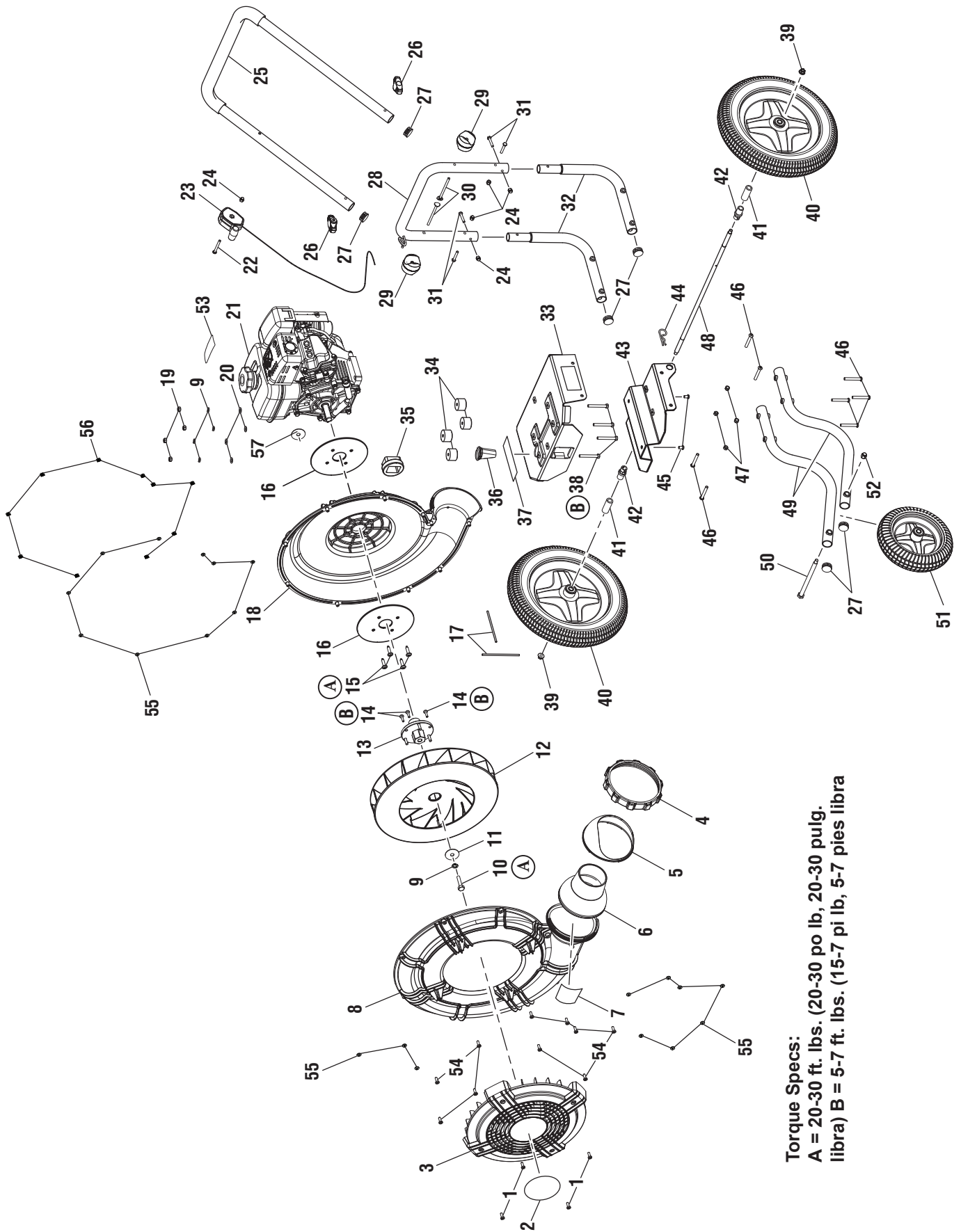

Torque Specs:
A = 20-30 ft. lbs. (20-30 po lb, 20-30 pulg. libra)
B = 5-7 ft. lbs. (15-7 pi lb, 5-7 pies libra)

LITTLE WONDER C5 BLOWERS –PARTS LIST

Key Part No.	Part Number	Description	Qty	Key Part No.	Part Number	Description	Qty
1	664004001	Screw (1/4-15 x 3/4 in.)	4	30	661568005	Handle Bolt (1/4-20 x 4 in.)	2
2	940748020	Logo Label	1	31	660643001	Bolt (1/4-20 x 1.53 in.)	4
3	524640001	Blower Screen	1	32	310970002	Lower Handle	2
4	524644001	Adjustment Ring	1	33	310020001	Engine Plate Assembly	1
5	524643001	Blower Adjustment Ring	1	34	679008002	Engine Spacer	4
6	524647001	Blower Tube	1	35	570116001	Isolator (Rubber)	1
7	940947012	Danger Label	1	36	524648001	Oil Fill Funnel	1
8	524645001	Front Blower Housing	1	37	940947011	Warning Label	1
9	638678002	Lock Washer (5/16)	5	38	660591015	Bolt (5/16-18 x 2-1/2 in., Hex Hd.)	4
10	664002003	Bolt (5/16-24 x 2 in., Hex Hd.)	1	39	679071001	Flange Nut (3/8-16)	2
	4177482	Bolt (5/16-24 x 1.75 in., Hex Hd.)	1	40	310482002	Wheel (16 x 2-3/4 in.)	2
11	638966001	Washer (5/16)	1	41	524639001	Axle Spacer	2
12	4177215	S-FAN, C5FAN KIT	1	42	524035001	Axle Bushing	2
13	306813001	Impeller Adaptor	1	43	300307003	Support Plate Assembly	1
14	661830001	Screw (1/4-15 x 31.75 mm, T30 Torx Pan Hd.)	3	44	679070001	Hitch Pin (3/4 in.)	1
15	T661829001	Bolt (5/16 24 x 1-1/4 in Flange Button Hd.)	4	45	664006006	Screw (5/16-18 x 1/2 in., Button Hd.)	2
16	4175122.7	Mounting Plate	2	46	664006005	Screw (5/16-18 x 2-1/4 in., Button Hd.)	8
17	621075002	Steel Rod	2	47	678259003	Lock Nut (5/16-18)	4
18	524642001	Rear Blower Housing	1	48	621301002	Axle	1
19	679450003	Hex Nut (5/16-18)	4	49	303475002	Front Fork Tube Assembly	2
20	638882001	Washer (5/16)	4	50	661020002	Bolt (1/2 in. Shoulder x 3/8-16, Hex Hd.)	1
21	4174949	Engine (Kohler, SH265) (99170-06-01)	1				
21	4163472	Engine (Subaru, SP170) (99170-03-01)	1	51	310482003	Wheel (10 x 2-3/4 in.)	1
22	661501009	Screw (1/4-20 x 2.27 in T30 Torx Pan Hd.)	1	52	678259006	Cap Lock Nut (3/8-16)	1
23	308842009	Throttle Lever and Cable	1	53	940872003	Fuel Label (E85)	1
24	679466001	Cap Lock Nut (1/4-20)	5	54	T662285001	Screw (#10-24 x 1-1/4 in, T25 Torx Hd.)	10
25	310843004	Upper Handle	1	55	636628001	Washer (#10-24)	20
26	311194001	Hand Knob Assembly (1/4-20)	2	56	T662284001	Nylon Insert Nut (#10-24)	10
27	524638001	End Cap (32 mm)	6	57	4175052	Spacer, Nozzle (Kohler)	1
28	310970003	Upper Frame Assembly	1				
29	310019001	Handle Adjustment Assembly	2				

NOTE A: Schiller Grounds Care will not provide engines as replacement parts. Engines are covered through the engine manufacturer's warranty. Consult the accompanying engine manual or contact our service department for assistance.

LITTLE WONDER C5 SOUFFLANTES – LISTE DES PIECES

Núm. ref.	Núm. pièce	Description	Cant	Núm. ref.	Núm. pièce	Description	Cant
1	664004001	Vis (1/4-15 x 3/4 po)	4	31	660643001	Boulon (1/4-20 x 1,53 po)	4
2	940748020	Étiquette de logo	1	32	310970002	Poignée inférieure	2
3	524640001	Tamis de soufflante	1	33	310020001	Ensemble de plaque moteur	1
4	524644001	Bague de réglages	1	34	679008002	Entretien de moteur	4
5	524643001	Bague de réglages de soufflante	1	35	570116001	Sectionneur (caoutchouc)	1
6	524647001	Tuyau de la soufflante	1	36	524648001	Orifice de remplissage d'huile	1
7	940947012	Plaque de danger	1	37	940947011	Étiquette d'avertissement	1
8	524645001	Boîtier du souffleur avant	1	38	660591015	Boulon (5/16-18 x 2-1/2 po, six pans)	4
9	638678002	Rondelle frein (5/16)	5	39	679071001	Écrou à épaulement (3/8-16)	2
10	664002003	Boulon (5/16-24 x 2 po, six pans) Subaru	1	40	310482002	Muele (16 x 2-3/4 po)	2
4177482		Boulon (5/16-24 x 1-3/4 po, six pans) Kohler	1	41	524639001	Entretien d'axe	2
11	638966001	Rondelle (5/16)	1	42	524035001	Douille de essieu	2
12	4177215	Ventilateur	1	43	300307003	Ensemble de plaque de support	1
13	306813001	Adaptateur pour ventilateur	1	44	679070001	Axe de blocage (3/4 po)	1
14	661830001	Vis (1/4-15 x 31,75 mm)	3	45	664006006	Vis (5/16-18 x 1/2 po, tête ronde)	2
15	T661829001	Boulon (5/16 24 x 1-1/4 po tête flasque)	4	46	664006005	Vis (5/16-18 x 2-1/4 po, tête ronde)	8
16	4175122.7	Plaque de montage	2	47	678259003	Écrou de blocage (5/16-18)	4
17	621075002	Tige de acier	2	48	621301002	Axe	1
18	524642001	Boîtier arrière de la soufflante	1	49	303475002	Fourche	2
19	679450003	Écrou hexagonal (5/16-18)	4	50	661020002	Boulon à épaulement (1/2 po x 3/8-16, six pans)	1
20	638882001	Rondelle (5/16)	4	51	310482003	Muele (10 x 2-3/4 po)	1
21	4163472	Moteur (Kohler, SH265) (99170-06-01)	1	52	678259006	Écrou de blocage de capuchon (3/8-16)	1
21	4163472	Moteur (Subaru, SP170) (99170-03-01)	1	53	940872003	Étiquette de carburant (E85)	1
22	661501009	Vis (1/4-20 x 2.27 po T30 tête bombée Torx)	1	54	T662285001	Vis (#10-24 x 1-1/4 po, T25 Torx)	10
23	308842009	Palanca del acelerador y et câble	1	55	636628001	Rondelle (#10-24)	20
24	679466001	Écrou de blocage de capuchon (1/4-20)	5	56	T662284001	Écrou de blocage (#10-24)	10
25	310843004	Poignée supérieure	1	57	4175052	Entretien, buse. (Kohler)	10
26	311194001	Ensemble de bouton de poignée (1/4-20)	2				
27	524638001	Capuchon d'extrémité (32 mm)	6				
28	310970003	Ensemble de cadre supérieur	1				
29	310019001	Ensemble de réglage de poignée	2				
30	661568005	Boulon de la poignée (1/4-20 x 4 po)	2				

NOTE A : Schiller Grounds Care ne fournit pas de moteurs dans ses pièces détachées. Les moteurs sont couverts par la garantie du fabricant de moteurs. Consulter le manuel du moteur inclus ou contacter notre département de service après-vente pour toute assistance.

LITTLE WONDER C5 SOPLADORA – LISTA DE PIEZAS

Num. de lég.	Num. de réf.	Description	Qté	Num. de lég.	Num. de réf.	Description	Qté
1	664004001	Tornillo (1/4-15 x 3/4 pulg.)	4	32	310970002	Mango inferior	2
2	940748020	Etiqueta del logotipo	1	33	310020001	Conjunto de placa de motor	1
3	524640001	Pantalla de la sopladora	1	34	679008002	Espaciador del motor	4
4	524644001	Anillo de ajuste del rayo	1	35	570116001	Isolator (goma)	1
5	524643001	Anillo de ajuste del rayo de sopladora	1	36	524648001	Embudo de llenado de aceite	1
6	524647001	Tubo de la sopladora	1	37	940947011	Etiqueta de advertencia	1
7	940947012	Etiqueta de peligro	1	38	660591015	Perno (5/16-18 x 2-1/2 pulg., cabezal hex.)	4
8	524645001	Alojamiento de la sopladora delantero	1	39	679071001	Tuerca de brida (3/8-16)	2
9	638678002	Arandela de seguridad (5/16)	5	40	310482002	Rueda (16 x 2-3/4 pulg.)	2
10	664002003	Perno (5/16-24 x 2 pulg hex, Subaru	1	41	524639001	Espaciador de eje	2
	4177482	Perno (5/16-24 x 1-3/4 pulg hex. Kohler	1	42	524035001	Buje de eje	2
11	638966001	Arandela (5/16)	1	43	300307003	Conjunto de placa de soporte	1
12	4177215	Impulsor	1	44	679070001	Pasador del enganche (3/4 pulg.)	1
13	306813001	Adaptador de impulsor	1	45	664006006	Tornillo (5/16-18 x 1/2 pulg, cabeza de botón)	2
14	661830001	Tornillo (1/4-15 x 31,75 mm T30 cabeza	3	46	664006005	Tornillo (5/16-18 x 2-1/4 pulg., cabeza de botón)	8
15	T661829001	Perno (5/16 24 x 1-1/4 pulg, cabeza de brida.	4	47	678259003	Tuerca de seguridad (5/16-18)	4
16	638965001	Placa de montaje	2	48	621301002	Eje	1
17	621075002	Barra del acero	2	49	303475002	Conjunto de la horquilla delantera	2
18	524642001	Alojamiento trasero del soplador	1	50	661020002	Perno de cuello grueso (1/2 pulg. x 3/8-16, cabezal hex.)	1
19	679450003	Tuerca hexagonal (5/16-18)	4	51	310482003	Rueda (10 x 2-3/4 pulg.)	1
20	638882001	Arandela (5/16)	4	52	678259006	Tuerca de seguridad de tapa (3/8-16)	1
21	4174949	Motor (Kohler, SH170)..(99170-06-01)	1	53	940872003	Etiqueta de combustible (E85)	1
21	4163472	Motor (Subaru, SP170)..(99170-03-01)	1	54	T662285001	Tornillo (#10-24 x 1-1/4 pulg, T25 Torx)	10
22	661501009	Tornillo (1/4-20 x 2,27 pulg T30 cabeza tronc.	1	55	636628001	Arandela (#10-24)	20
23	308842009	Palanca del acelerador y cable	1	56	T662284001	Tuerca de seguridad (#10-24)	10
24	679466001	Tuerca de seguridad de tapa (1/4-20)	5	57	4175052	Espaciador, inyector..(Kohler)	1
25	310843004	Mango superior	1				
26	311194001	Conjunto de perilla del mango (1/4-20)	2				
27	524638001	Tapa extremo (32 mm)	6				
28	310970003	Conjunto superior de la base	1				
29	310019001	Conjunto el ajuste de mango	2				
30	661568005	Perno del mango (1/4-20 x 4 pulg.)	2				
31	660643001	Perno (1/4-20 x 1,53 pulg.)	4				

NOTA A: Schiller Grounds Care no proporcionará los motores como repuestos. Los motores están cubiertos por medio de la garantía del fabricante del motor. Consulte el manual adjunto del motor o comuníquese con nuestro departamento de servicio para recibir ayuda al respecto.

LITTLE WONDER®

2 YEAR RESIDENTIAL WARRANTY
90 DAY LIMITED COMMERCIAL AND RENTAL WARRANTY
FOR LITTLE WONDER C5 BLOWER

This LITTLE WONDER C5 Blower is warranted against defects in material and workmanship for a period of two (2) years for residential usage and 90 days for commercial or rental usage, from the date of purchase under the following terms and conditions. Residential usage means use of the product on the same lot as your home. Use at more than one location is considered commercial use and the commercial use limited warranty would apply.

LITTLE WONDER will repair or replace, at its option, any part or parts of the product found to be defective in material or workmanship during the warranty period. Warranty repairs and replacements will be made without charge for parts or labor. All parts replaced under warranty will be considered as part of the original product, and any warranty on the replaced parts will expire coincident with the original product warranty. If you think your LITTLE WONDER C5 blower is defective in material or workmanship, you must return it to a registered dealer with a valid sales receipt or to our factory at 1028 Street Rd., Southampton, PA 18966. Transportation charges to ship your product to us or a registered dealer must be borne by you.

Engines for all gasoline powered products are warranted separately by the engine manufacturer. Therefore, there are no warranties made, expressed or implied, for engines for gasoline powered products by LITTLE WONDER.

LITTLE WONDER assumes no responsibility in the event that the product was not assembled or used in compliance with any assembly, care, safety or operating instructions contained in the Operator's Manual or information accompanying the product. This limited warranty does not cover damages or defects due to normal wear and tear, lack of reasonable and proper maintenance, failure to follow operating instructions or Operator's Manual, misuse, lack of proper storage or accidents, nor does it cover routine maintenance parts and service. This limited warranty does not cover any defects due to repairs or alterations made to the product made by anyone other than LITTLE WONDER or its registered dealers.

You must maintain your LITTLE WONDER C5 Blower by following the maintenance procedures described in the operator's manual. Such routine maintenance, whether performed by you or a registered dealer, is at your expense.

LITTLE WONDER MAKES NO EXPRESS OR IMPLIED WARRANTIES, REPRESENTATIONS, OR PROMISES EXCEPT THOSE CONTAINED HEREIN. THERE ARE NO OTHER WARRANTIES, INCLUDING WARRANTIES OF MERCHANTABILITY AND FITNESS FOR A PARTICULAR PURPOSE. ALL WARRANTIES OTHER THAN THE EXPRESS WARRANTY SET FORTH ABOVE ARE SPECIFICALLY DISCLAIMED. THE DURATION OF ANY IMPLIED WARRANTY, INCLUDING MERCHANTABILITY AND FITNESS FOR A PARTICULAR PURPOSE, IS LIMITED TO THE DURATION OF THIS WRITTEN LIMITED WARRANTY. LITTLE WONDER DISCLAIMS ALL LIABILITY FOR INDIRECT, INCIDENTAL AND/OR CONSEQUENTIAL DAMAGES IN CONNECTION WITH THE USE OF THE LITTLE WONDER BLOWER PRODUCTS COVERED BY THIS WARRANTY. SOME STATES DO NOT ALLOW LIMITATIONS ON HOW LONG AN IMPLIED WARRANTY LASTS AND/OR DO NOT ALLOW THE EXCLUSION OR LIMITATION OF INCIDENTAL OR CONSEQUENTIAL DAMAGES, SO THAT ABOVE LIMITATIONS AND EXCLUSIONS MAY NOT APPLY TO YOU. THIS WARRANTY GIVES YOU SPECIFIC LEGAL RIGHTS, AND YOU MAY ALSO HAVE OTHER RIGHTS WHICH VARY FROM STATE TO STATE.

LITTLE WONDER®
SCHILLER GROUNDS CARE, INC.
1028 STREET ROAD, P.O. BOX 38
SOUTHAMPTON, PA 18966
PHONE 877-596-6337 • FAX 215-357-8045
www.littlewonder.com