

LUSSO

Capsule Machine

Instruction Manual & Guarantee

Dualit®

Since 1945

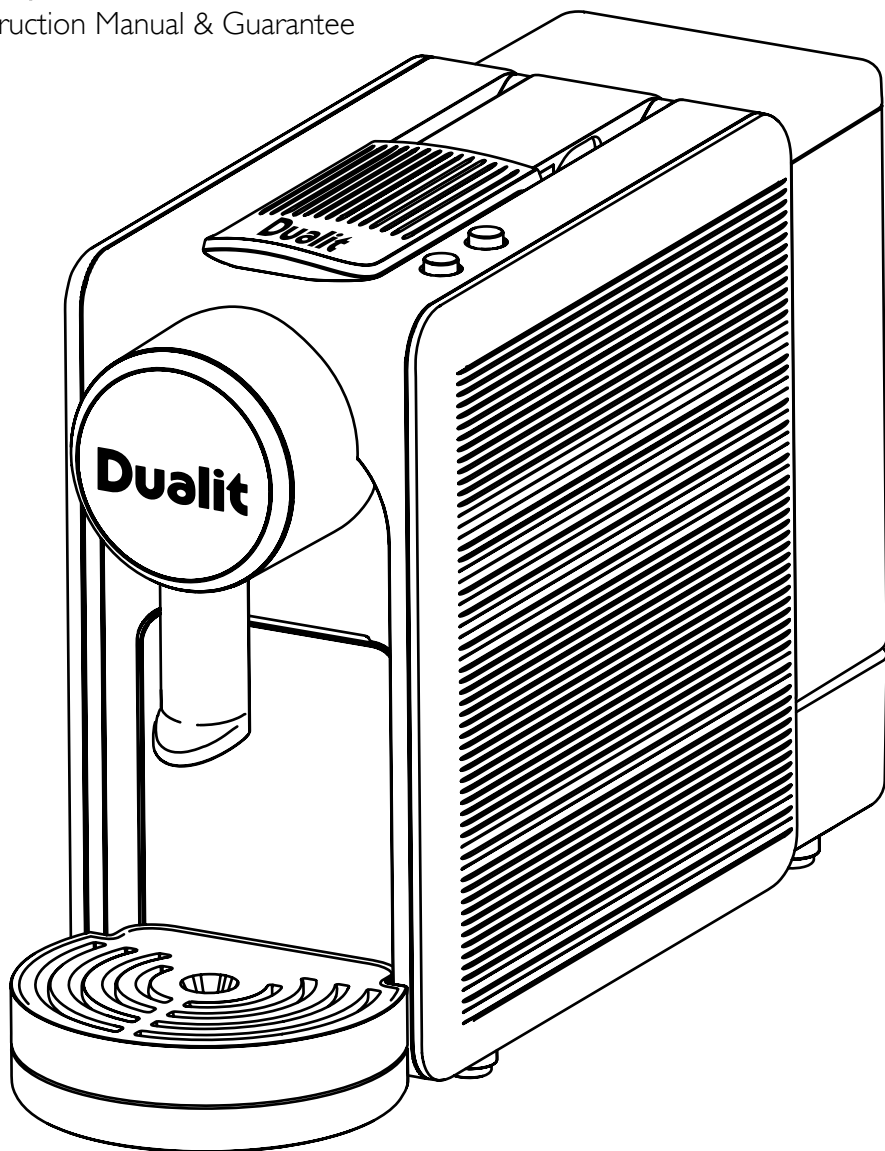
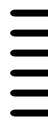

YOUR LUSSO CAPSULE MACHINE

High pressure capsule machines, such as your new Dualit Lusso Capsule Machine, require constant care and maintenance to prolong their life.

Please remember to:

- **Rinse through before first use and after every use.**
- **Descale your machine on a regular basis.**



PERFECT PARTNER

(SOLD SEPARATELY - EXCEPT IN DUALIT LUSSO CINO)



MILK FROTHER

www.dualit.com/milk-frother



DUALIT TEA
& COFFEE CAPSULES

www.dualit.com/capsules

DON'T FORGET TO REGISTER YOUR LUSSO	WWW.DUALIT.COM/REGISTER	Register ✓ my appliance
	OR BY POST	

Unpack the box with care, keeping all the packaging materials until you are satisfied everything is present and in working order. Once satisfied remove any tags from the appliance body and recycle the packaging appropriately. Do not remove tags from the cord. You may wish to keep the box to store your appliance.

All illustrations are for representation only, your model may have a different appearance from illustrations shown.

CONTENTS

Safety precautions _____	04
Before first use _____	05
Know your Lusso Capsule Machine _____	06
Setting up _____	08
Programmable dosing memory _____	09
Daily use _____	10
Cleaning - after each use _____	12
Descale regularly _____	13
Troubleshooting _____	14
Barista Training & Coffee Guide _____	16
Fine Tea Tasting Notes & Tea Guide _____	17
Guarantee _____	18

**JOIN THE
CAPSULE CLUB**

- Quick re-order
- Great taste, great rewards
- Be inspired

WWW.DUALIT.COM/CAFECUB



IMPORTANT SAFETY PRECAUTIONS



READ ALL INSTRUCTIONS

BEFORE USING THE LUSSO CAPSULE MACHINE. KEEP THESE INSTRUCTIONS FOR FUTURE REFERENCE.

IMPORTANT SAFEGUARDS

- **THIS IS AN ATTENDED APPLIANCE. Do not leave unattended during use, unplug after each use (risk of fire if an unattended appliance is left operating).**
- This appliance must not be used by children younger than 8 years old and persons with very extensive and complex disabilities. Children aged 8-14 years and persons with reduced physical, sensory or mental capabilities or lack of experience and knowledge shall not use this appliance, unless they are supervised and have been given instruction concerning the use of the appliance in a safe way and understand the hazards involved. Children shall not play with the appliance. Cleaning and user maintenance shall not be made by children unless they are older than 8 and supervised. Keep the appliance and its cord out of reach of children less than 8 years old.
- This appliance is intended for indoor household use only. If the appliance is used improperly or for professional or semi-professional purposes or if it is not used according to these instructions the Guarantee becomes invalid and Dualit refuses any liability for damage caused.
- This appliance is intended to be used in households and similar applications such as working environments including staff kitchen areas in shops and offices, farm houses, clients in hotels, motels, bed and breakfasts and other residential environments.

Electrical safety

- Ensure that the voltage of the appliance corresponds to that of the mains supply.

- **WARNING:** This appliance must be earthed.
- Unplug the appliance from the mains before cleaning or maintaining.
- Do not operate this appliance with a damaged cord or plug. If the supply cord is damaged, it must be replaced by Dualit Ltd, its service agent or a similarly qualified person in order to avoid a hazard.
- Do not pull the power supply cable over sharp edges, clamp it or allow it to hang down. It should not be allowed to come into contact with hot or damp surfaces.
- Never touch the cable with wet hands.
- This appliance conforms to directive 89/336 CEE regarding electromagnetic compatibility.
- Dualit does not recommend using extension cables as they may cause damage or accidents.

General safety

- Do not use if dropped, damaged or cracked.
- The use of accessory attachments not recommended by Dualit may result in fire, electric shock or injury to persons.
- Do not touch the metal parts when the appliance is in use, as this may cause burns or scalding.
- Do not place the appliance on a polished wood surface, it could damage the wood.
- Do not place on a tray, metal tray, surface that may collect liquid or other metal surface during use.
- Do not operate on an uneven surface.
- Do not place the appliance over or close to sources of heat such as electric rings, hot ovens or open flames.
- Do not use the appliance without water as this may cause damage to the pump/boiler.
- Do not leave the appliance in a room with a temperature below 0°C, as any water remaining in the appliance could freeze and cause damage.

- **Before refilling the water tank, unplug the appliance from the mains. Never remove the water tank whilst plugged in.**
- Do not overfill the water tank.
- Do not use sparkling water (with carbon dioxide).
- Never fill the tank with hot or boiling water.
- Only use the appliance with the drip tray correctly fitted.
- Do not immerse in water or other liquids.
- If there is internal water leakage, do not operate the capsule machine and unplug it at once in order to avoid electric hazard.
- **Please note, condensation under the machine is normal.**
- We recommend that the appliance is plugged into a socket that has no other appliance connected to it. Failure to do this may cause an overload, trip a circuit breaker or blow a fuse. Preferably the socket outlet should be protected by a residual current device (RCD)
- Hot water hazard. Avoid direct contact with hot water. Unplug the appliance from the mains to allow to cool before cleaning, maintaining or moving. For details, please refer to cleaning section.
- Always close the lever completely and never lift it during operation. Do not put fingers into the capsule compartment or the capsule shaft. Danger of injury!
- Do not come into contact with the coffee outlet, risk of scalding.
- Never use a damaged or deformed capsule. Water could flow around the capsule when not perforated by the blades and damage the appliance.
- This appliance operates with the Dualit and Nespresso® capsules.
- Turn the appliance and main power off when not in use.

Nespresso® trademark is owned by Société des Produits Nestlé S.A

- Do not use a scouring pad or abrasive cleaner on the main body.
- Never put the appliance or part of it in a dishwasher.

SAVE THESE INSTRUCTIONS

In the interest of improving products, Dualit Ltd. reserves the right to change the product specification without prior notice. All illustrations are for representation only, your model may vary from illustrations shown.

INSTRUCTIONS ON ENVIRONMENT PROTECTION



Do not dispose of this product in the usual household garbage at the end of its life cycle. Please hand it over to a collection point for the recycling of electrical and electronic appliances. The symbol on the product, the instruction of use or the packaging will inform you about the methods of disposal. The materials are recyclable as mentioned on its marking. By recycling, material recycling or other forms of re-utilization of old appliances you are making an important contribution to protect our environment. Please enquire at the community administration for the authorised disposal location.

IMPORTANT: BEFORE FIRST USE THE LUSSO COFFEE MACHINE MUST BE FLUSHED THROUGH WITH WATER BEFORE THE FIRST USE.

1. Follow the instructions as if priming the appliance, ensuring no capsule is inside.
2. Extract 5 shots through the machine, this will rinse the internals ready for your first drink.
3. The water tank must be washed with warm soapy water, then rinsed and dried.

KNOW YOUR LUSSO CAPSULE MACHINE

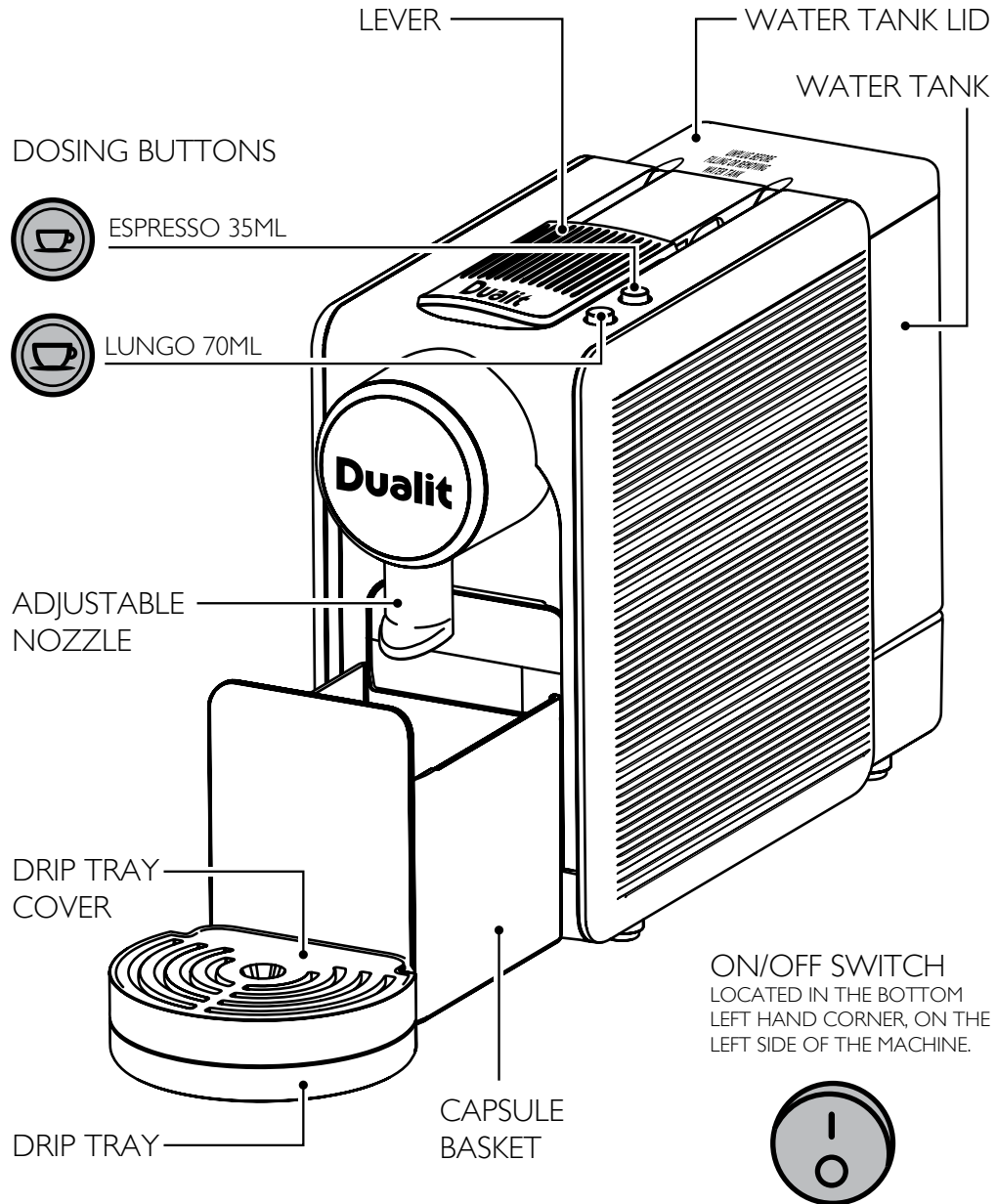

MAINS POWER CORD

Ensure the mains power cord plug is attached correctly by aligning with the socket and pushing firmly into place.

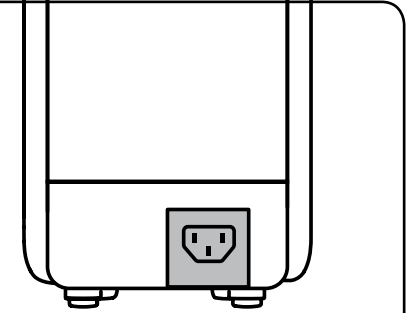
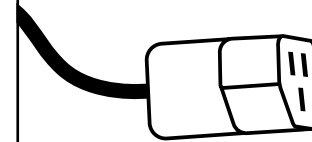

Back of machine

FOR ULTIMATE CONVENIENCE

Dualit. LUSSO.

COMPATIBLE WITH DUALIT & NESPRESSO® CAPSULES

Buy Dualit capsules from supermarkets, cookshops and order online

For stockist details and online ordering visit
DUALIT.COM/CAPSULES

SETTING UP

To achieve optimum performance from your capsule machine follow this procedure. **SAFETY INSTRUCTION: Never lift the lever whilst the beverage is being extracted. Water will be HOT.**

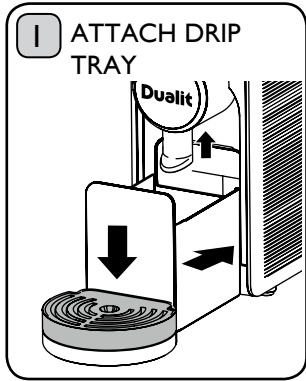

Ensure the drip tray is located correctly, ensuring the nozzle is pushed up.

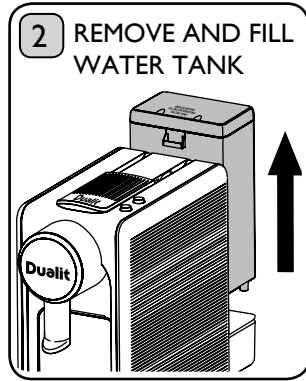

Pull the water tank up and carry to the tap. **Do not overflow or fill whilst attached to the capsule machine.**

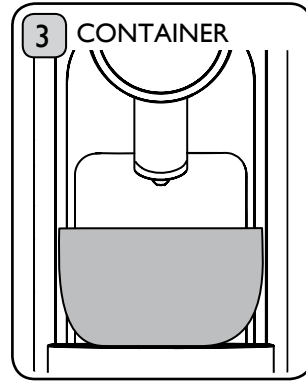

Place a container or large cup under the nozzle.

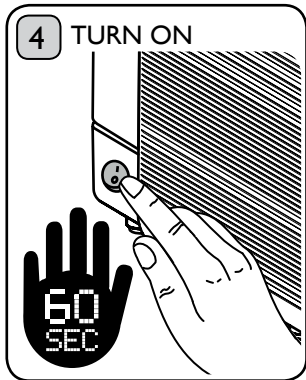

Plug in the power cord
Press the 'ON' button and wait approximately 60 seconds until the 2 dosing buttons illuminate white and stop flashing.

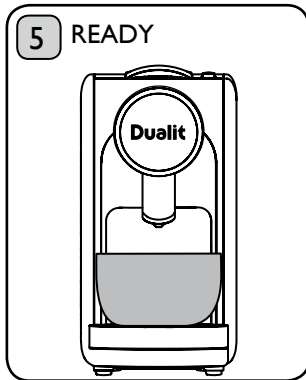

Once the machine beeps, the machine is ready to use.

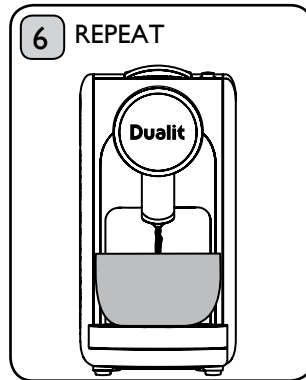

Extract 5 shots through the machine, this will rinse the internals ready for your first drink.

PROGRAMMABLE DOSING MEMORY

Switch on the capsule machine. Open the lever fully and insert a fresh capsule. Close the lever fully and wait until the dosing buttons illuminate, stop flashing and you hear a beep.

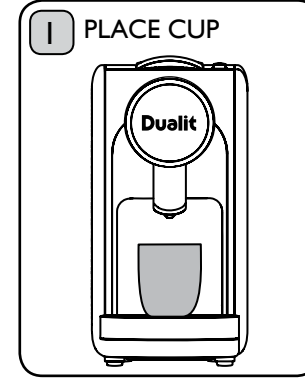

Place a small or large cup on the cup platform.

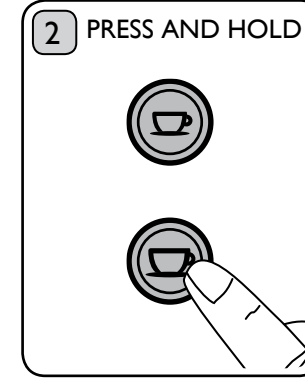

Press and hold a dosing button until the desired amount of tea or coffee has been dispensed and then release. See tea and coffee volumes below.

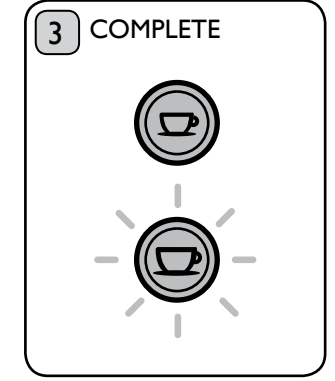

The dosing button has now been programmed to dispense your chosen quantity of tea or coffee. Once you have completed this process, simply press the button for further cups.

COFFEE - The factory setting of the machine is programmed to 35ml for the Espresso button and 70ml for the Lungo button. Note, there is a minimum of extraction of 15mm.

TEA - Reprogramme your Lungo button before making your first cup of tea. We recommend using 1 capsule (depending on your strength and taste preference) for a tea cup (150-180ml). For a mug (250ml) we recommend using 2 capsules and setting your dose to 125ml.

DAILY USE

To achieve optimum performance from your capsule machine follow this procedure.

SAFETY INSTRUCTION: Never lift the lever whilst the beverage is being extracted. Water will be HOT.

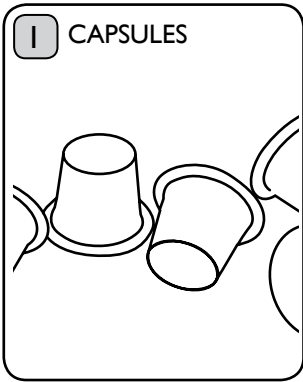

NX® coffee capsules and Fine Tea capsules are available directly from supermarkets, independent retailers, online at www.dualit.com/capsules and Dualit Sales: 01293 652500 (UK delivery only).

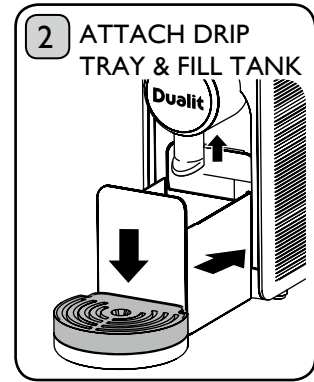

Unplug before filling or removing the water tank. Ensure the drip tray is located correctly and then remove and fill the water tank.

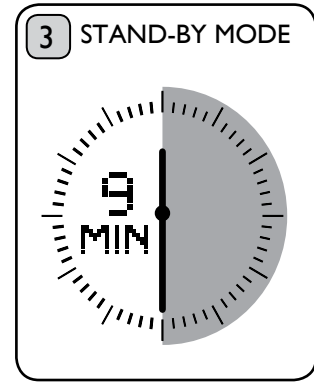

If the machine has been switched 'ON,' it will enter stand-by mode after 9 minutes of inactivity.

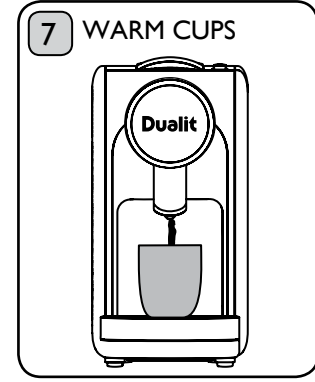

For best results, warm the cups and flush before your first drink.

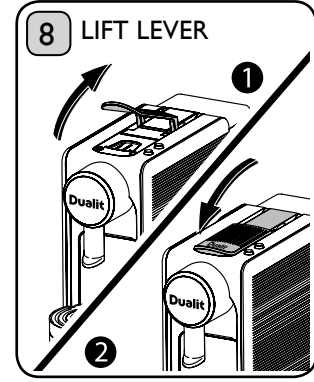

Lift the lever fully and insert the capsule. Then close the lever fully.

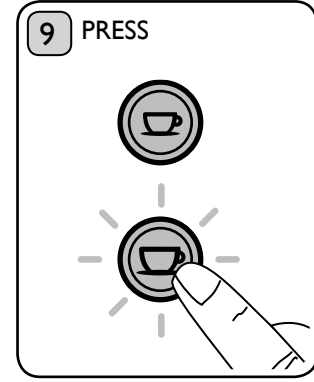

Press the chosen dosing button for the quantity of tea or coffee you have already programmed.

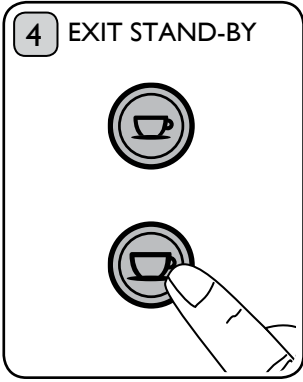

Exit stand-by mode by pressing either of the dosing buttons or by opening the lever. Your capsule machine is ready to use when the dosing buttons illuminate and stop flashing.

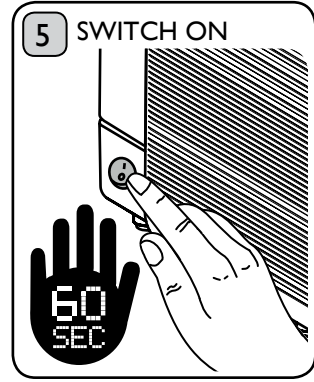

If the capsule machine is switched off, press the On/Off button and wait until the dosing buttons illuminate and stop flashing. The machine will beep when ready.

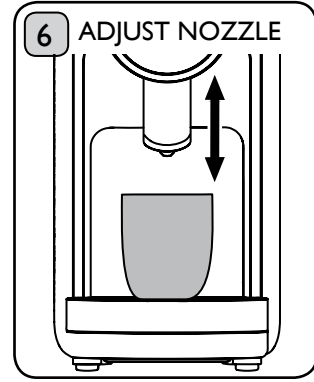

Place a small or large cup on the cup platform and adjust the nozzle to the required height.

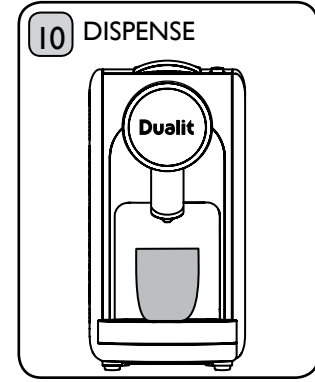

The dispensing process is automatically stopped once the coffee has been prepared.

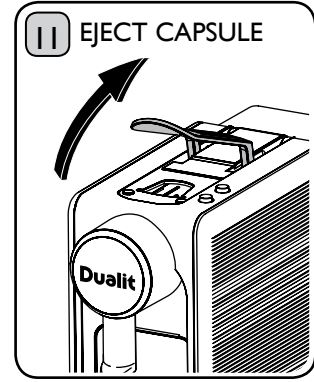

Lift the lever fully to eject the capsule. **Do not leave capsules in the chamber.**

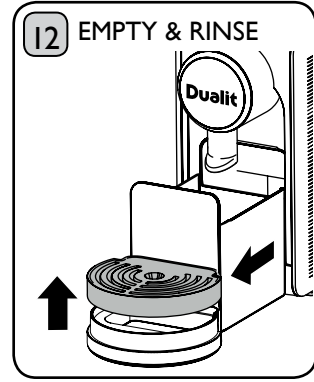

The capsule collection container and drip tray must be removed, emptied and rinsed out regularly. See Cleaning on page 12

CLEANING - AFTER EACH USE

BEFORE CLEANING, MAKE SURE THE MACHINE IS SWITCHED OFF, UNPLUGGED AND ALLOWED TO COOL.

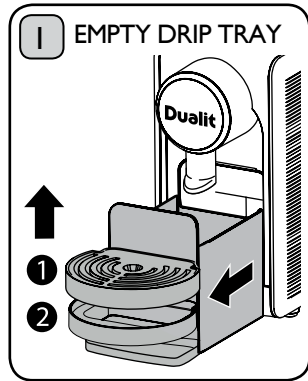

Empty the drip tray regularly. Ensure the nozzle is pushed up and pull the capsule basket out of the machine. Lift off the drip tray and drip tray cover.



Empty any liquid into the sink, that may have collected in the capsule basket, using the side wall of your sink to retain the capsules.

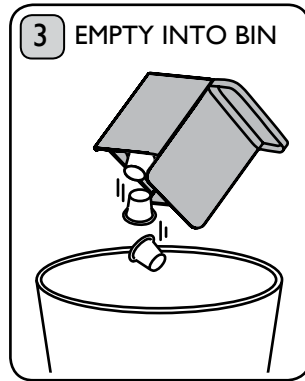

Dispose of the used capsules left in the capsule basket.

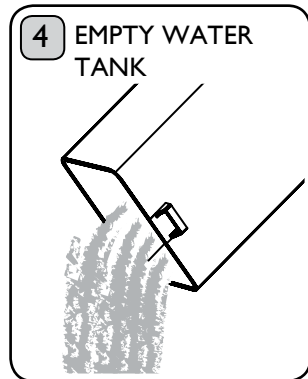

Empty and rinse out after each session and refill with fresh water just before you make your next beverage.

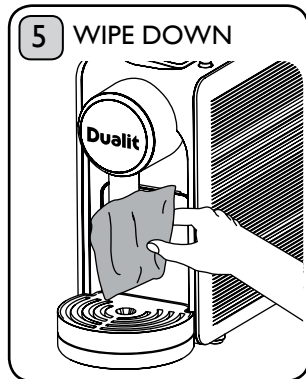

Wipe down the body and nozzle of the capsule machine, with a damp non abrasive cloth.

DESCALE REGULARLY

IMPORTANT NOTICE: PRODUCT FAILURE DUE TO THE BUILD UP OF LIMESCALE IS NOT COVERED BY GUARANTEE - DESCALE REGULARLY.

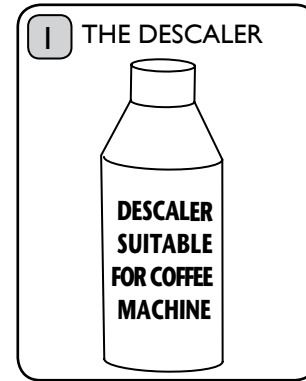

Ensure the descaling product is suitable for coffee machines. **DESCALE ONCE A MONTH IN HARD WATER AREAS**

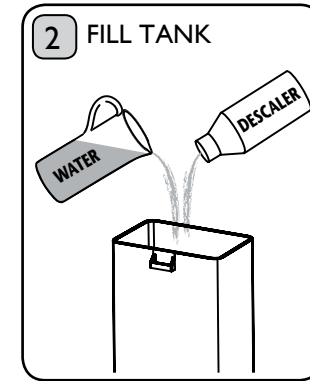

Remove the water tank and fill the water tank with the descaling solution. **FOLLOW THE INSTRUCTIONS ON THE PACK.**

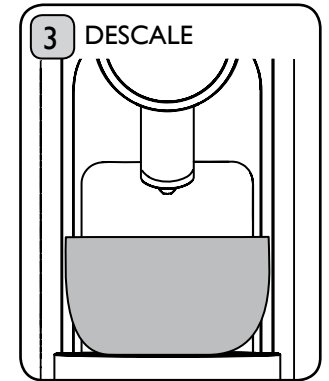

Place a large container on the drip tray. Dispense through brewhead. Continue until the tank is empty.

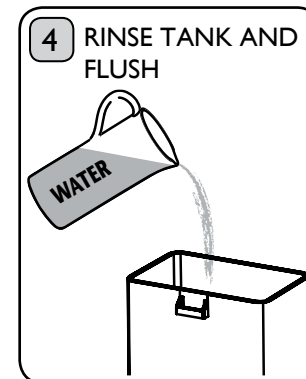

Rinse the water tank and fill with fresh water. Operate as if making tea or coffee and **flush at least one full tank of water through the machine.** This will remove any traces of the descaling solution. Place the water tank back into position.

TROUBLESHOOTING GUIDE



POSSIBLE CAUSE(S)	SOLUTION(S)
THE CAPSULE MACHINE DOES NOT TURN ON	
The unit may not be properly connected to the power supply.	<ol style="list-style-type: none"> 1. Check the plug is in the socket and the switch is turned on. 2. Check and replace the fuse if necessary. Note: in order to open the plug, remove the label to reveal the screw. 3. Check the mains power cord is tight (see page 7) 4. The machine may be in stand-by mode. You can exit stand-by mode by pressing any dosing button or opening the lever.
THE CAPSULE MACHINE IS NOT DISPENSING TEA OR COFFEE	
The dosing buttons illuminate without flashing, but no tea or coffee is dispensed.	<ol style="list-style-type: none"> 1. The nozzle could be blocked. Follow the Cleaning instructions on page 12. 2. The inserted capsule could be faulty. Wait a few moments before opening the lever and then try again with another capsule. 3. Ensure that the lever is properly closed and the the capsule basket is empty.
MY MACHINE IS MAKING A LOUD NOISE OR EXTRACTION HAS STOPPED MID USE	
You may have run out of water (the machine is making a noise and the dosing buttons are flashing).	Turn the machine off and remove the water tank. Refill with fresh water and then place the tank back onto the machine. Follow instructions on page 10-11 using a new capsule before dispensing.
MY EXTRACTION IS SLOW	
Dualit Lusso has infuse plus technology.	This is normal operation as the slow extraction allows the coffee to infuse for longer, resulting in a deeper and fuller flavour.
MY CAPSULE MACHINE IS LEAKING	
There is water beneath the capsule machine.	<ol style="list-style-type: none"> 1. There will be a small amount of condensation forming underneath the capsule machine after making numerous beverages. This is safe and does not mean the machine is leaking. 2. Ensure that the water tank has been correctly inserted. When refilling with water, always switch off the capsule machine and only then remove and refill the water tank. Otherwise, water could leak from the appliance. If you still feel the capsule machine is leaking, please contact Dualit on (+44) 01293 652500.

MY DRIP TRAY IS FILLING UP TOO QUICKLY	
This may be due to the soft close system which relies on water pressure.	This is normal operation and does not affect taste.
MY CAPSULE MACHINE IS MAKING A WHISTLING NOISE	
There is a slight whistling noise after tea or coffee is dispensed.	This is not a fault. It is the sound of normal lowering of the pressure in the control valve.
NO CREMA	
Little to no crema is produced.	<ol style="list-style-type: none"> 1. Each time coffee is dispensed, essential oil is deposited in the nozzle. Descale and follow instructions on page 13. 2. Use Dualit or Nespresso® capsules 3. Check your capsules are in date. Stale coffee affects crema and taste.
THE NOZZLE IS BLOCKED	
Water has stopped flowing through the nozzle.	Ensure that the water tank is filled with water. Each time tea or coffee is dispensed, essential oil is deposited in the nozzle. Descale and follow instructions on page 13.
FACTORY SETTINGS	
1. What is the factory setting of the capsule machine?	1. The factory setting of the machine is programmed to 35ml for the Espresso button and 70ml for the Lungo button.
2. Can I reset the capsule machine to its factory settings?	2. Yes. Please follow the 'Programmable Dosing Memory' on page 9.
DOSING BUTTONS	
1. What happens if I repeatedly press the dosing button while tea or coffee is being dispensed?	1. The capsule machine interrupts the dispensing of the tea or coffee prematurely.
2. Is the programmable dosing memory deleted when the appliance is unplugged?	2. No, the programming is not affected by unplugging the appliance.
3. The dosing buttons flash for a long time. When is the capsule machine ready to use?	3. It takes a little time for the capsule machine to achieve the optimum water temperature (approx. 30-60 seconds). Once it does, the dosing buttons will illuminate, the machine will beep and will be ready to dispense tea or coffee.
CAPSULES	
1. The capsule does not drop automatically into the capsule basket when I lift the lever.	2. The capsule basket could be full. Please empty it.
2. The capsule can't be inserted correctly.	2. The capsule basket could be full. Please empty it.

BARISTA TRAINING

The Dualit Lusso Coffee machine brings coffee shop style coffee into your home, Let's start with a quick training session and turn you, the coffee drinker, into a barista...

THE PERFECT COFFEE

You are looking for an espresso with a 2-3mm crema and a rich, dark brown colour underneath (the exact colour will depend on the capsule you have chosen).

- It should have a taste that is full of flavour (whether mild and subtle or rich and strong) and should not be bitter. It should stay hot to the bottom of the espresso.
- The Dualit Lusso Capsule Machine is designed to produce an optimum Espresso volume of 35ml.
- If you would like a longer drink, use the Lungo dosing button or extract a second Espresso.
- If you are making an Americano, dispense your desired amount of hot water into your cup first, then extract your 35ml shot of coffee on top. This preserves the crema.

To make even more types of coffee please consider our Dualit Milk Frother. This is available directly from www.dualit.com/milk-frother or Dualit sales on 01293 652 500 (UK delivery only).

COFFEE GUIDE

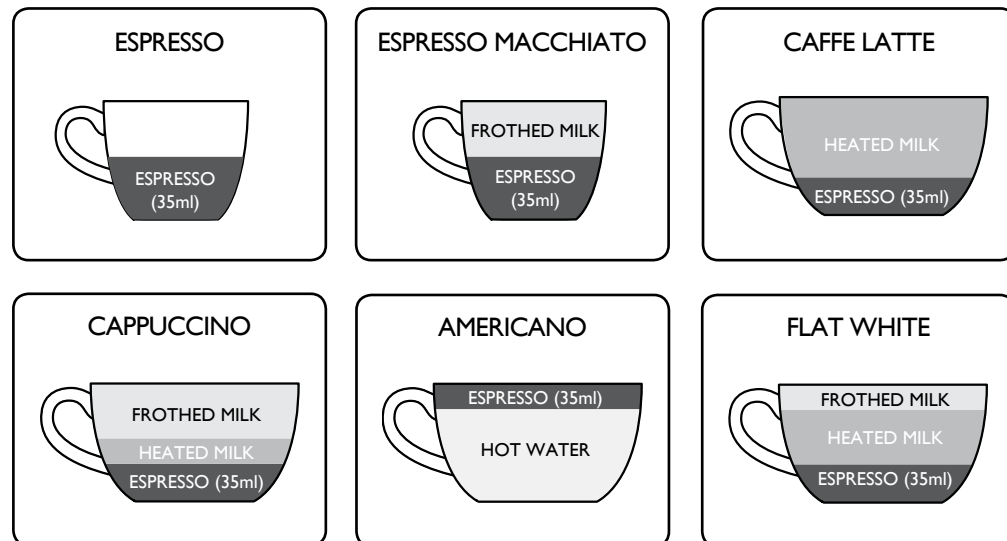

FINE TEA TASTING NOTES

ENGLISH BREAKFAST *Exceptionally Luxurious & Smooth*

Hand plucked unique blend from the highlands alongside the East African Rift Valley. Awaken your senses with its bright golden colour and sunshine taste.

EARL GREY *Elegant & Refreshing*

We have taken this quintessential tea and redeveloped it for the 21st Century to give it an unbelievable taste. The distinctive qualities of this premium black tea delicately flavoured with aromatic bergamot are enhanced by advanced capsule technology.

GREEN TEA *Naturally Pure & Delicious*

Experience the deliciously smooth flavours and remarkable freshness of our pure Green Tea. High quality, young hand plucked leaves, single origin sourced from tea gardens in Kenya.

BLACKCURRANT INFUSION *Irresistible Fruit Explosion*

If you like fruit infusions, this takes them to a whole new level. Bursting with lively fruit flavours, this is an irresistible and velvety taste explosion.

PEPPERMINT INFUSION *A Soothing & Uplifting Infusion*

This pure Peppermint Infusion is a taste revolution that is both soothing & uplifting, with unparalleled freshness. A classic digestif, known for its revitalising benefits.

TEA GUIDE

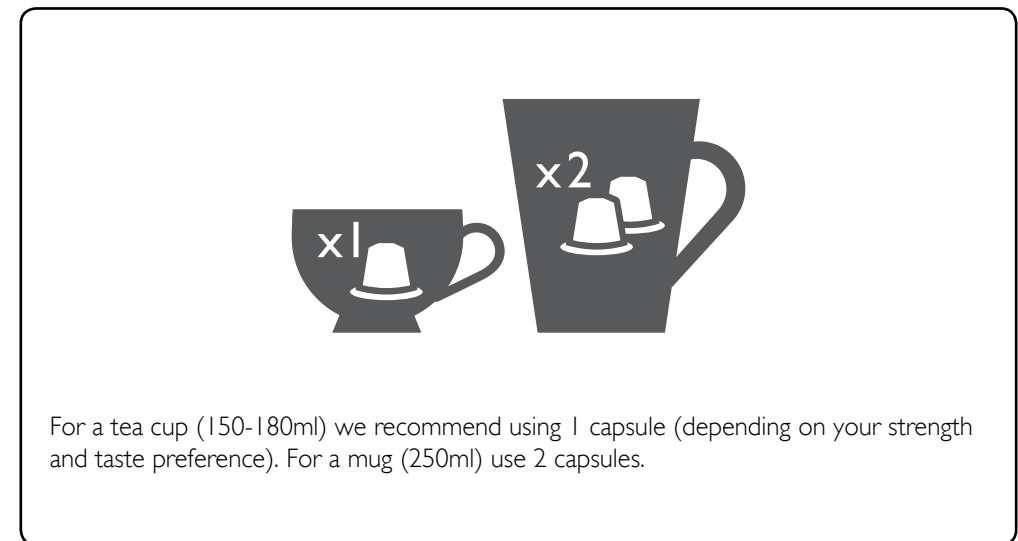

GUARANTEE

This appliance is of excellent quality and construction. However, if any defects in materials or workmanship do appear during the relevant guarantee period, we will, at our discretion, either repair or replace the defective parts, free of charge, subject to the terms and conditions of our Guarantee shown below.

This Guarantee covers both parts and labour. Carriage is not included.

Your Guarantee period is as follows:

- 1 year

This Guarantee provides benefits which are additional to, and do not affect, your statutory rights. This Guarantee does not cover the cost of returning the product to the dealer from whom it was purchased or to ourselves. This Guarantee applies only to products sold and located in mainland Great Britain. It does not cover liability in respect of or replacement of plugs, cables or fuses and also does not cover defects due to:

- Failure to use or maintain product in accordance with Dualit's instructions.
 - The product being connected to an unsuitable electricity supply.
 - Accidental damage to or abuse or misuse of the product.
 - Product modification except by Dualit or approved agent.
 - Dismantling of or interference with the product.
 - Theft or attempted theft of the product.
- Before returning any product under this Guarantee, please check that:
- You have followed the product instructions correctly.
 - Your mains electricity supply is functional.
 - The defect is not due to a blown fuse.

If you wish to claim under this Guarantee you should:

- Send the product, postage or carriage paid, to the dealer from whom it was purchased or to Dualit direct.
- Ensure that the product is clean and packed carefully (preferably in its original carton).
- Enclose details of your name, address and telephone number and when and where the product was purchased, together with proof of purchase (e.g. a till receipt).
- Give exact details of the nature of the defect.

This Guarantee does not cover any other claims whatsoever, including, without limitation, any liability for incidental, indirect or consequential damage, nor does it cover any claims for conversion or modification or for the costs of repair carried out by any third party without the prior consent of Dualit. If replacement parts are fitted to the product this will not extend the period of the Guarantee.

For further advice contact the Dualit customer helpline on +44 (0)1293 652 500 (09:00 to 17:00 Monday to Friday).

Alternatively, email Dualit at info@dualit.com or visit www.dualit.com



Dualit *Fine Tea*

Dualit *Origins Cafe*

DualitNX®

TEA & COFFEE CAPSULES

Our patented tea & coffee capsules and ESE pods provide something for every taste and occasion. We use the finest coffee beans and tea leaves, carefully sealed in individual servings. Convenient and mess-free, for excellent results every time.

Order your tea & coffee at
www.dualit.com/capsules



DON'T FORGET
TO REGISTER
YOUR LUSSO

WWW.DUALIT.COM/REGISTER

OR BY POST



Register ✓
my appliance



Dualit®

JOIN THE CAFÉ CLUB

Quick re-order

Great taste, great rewards

Be inspired

WWW.DUALIT.COM/CAFECCLUB



Dualit Limited County Oak Way Crawley West Sussex RH11 7ST
Telephone: +44(0)1293 652 500 Facsimile: +44(0)1293 652 555
Email: info@dualit.com Web: www.dualit.com



GB-C