

Product: SKID STEER LOADER

Model: 236B SKID STEER LOADER HEN

Configuration: 236B 246B 252B 262B SKID STEER LOADER HEN00001-06749 (MACHINE) POWERED BY 3044C Engine

Disassembly and Assembly

C3.4 Engines for Caterpillar Built Machines

Media Number -KENR6941-04

Publication Date -01/03/2012

Date Updated -01/03/2012

i02639276

Flywheel Housing - Remove and Install

SMCS - 1157-010

Removal Procedure

Table 1

| Required Tools | | | |
|----------------|-------------|--------------------------------------|-----|
| Tool | Part Number | Part Description | Qty |
| A | - | Guide Stud (M10 x 1.25 by 100 mm) | 2 |

Start By:

- A. Remove the flywheel. Refer to Disassembly and Assembly, "Flywheel - Remove".

NOTICE

Keep all parts clean from contaminants.

Contaminants may cause rapid wear and shortened component life.

NOTICE

Care must be taken to ensure that fluids are contained during performance of inspection, maintenance, testing, adjusting and repair of the product. Be prepared to collect the fluid with suitable containers before opening any compartment or disassembling any component containing fluids.

Dispose of all fluids according to local regulations and mandates.

1. Support the engine.

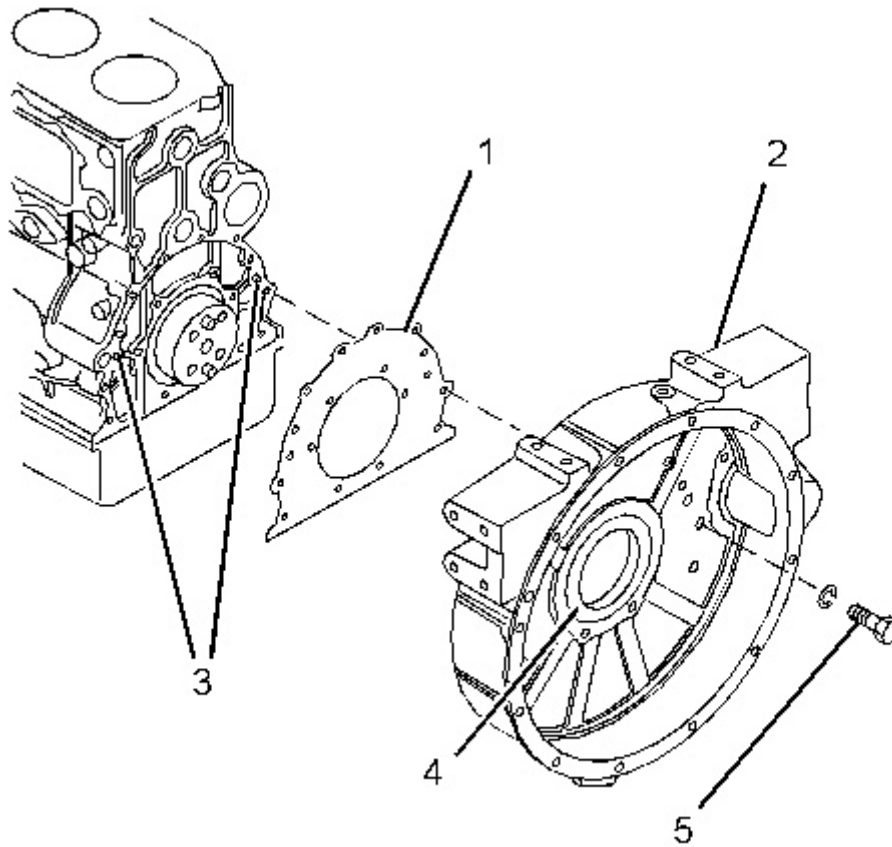

Illustration 1

g01335374

Typical example

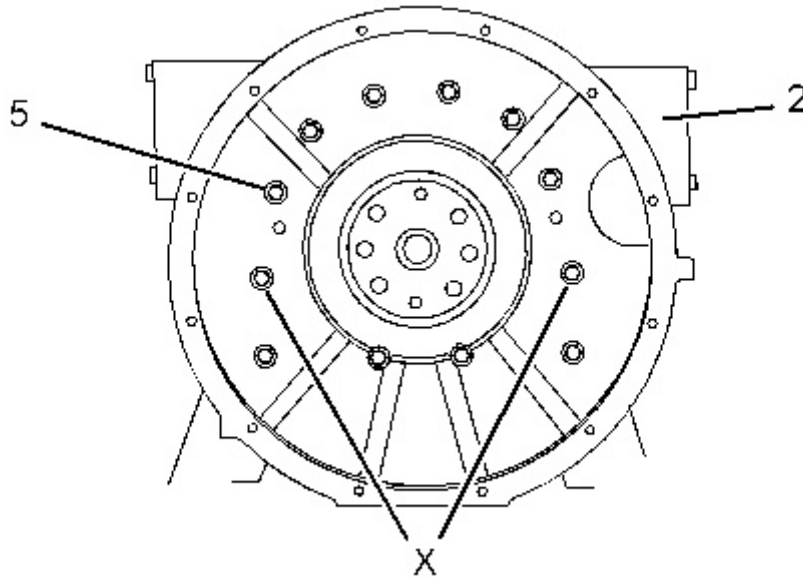

Illustration 2

g01366220

Typical example

2. Remove two bolts (5) from positions (X) on flywheel housing (2) .
 3. Install Tooling (A) to positions (X) on flywheel housing (2) .
 4. Attach a suitable lifting device to flywheel housing (2). The weight of the flywheel housing is approximately 32 kg (71 lb).
 5. Remove the remaining bolts (5) .
 6. Carefully remove flywheel housing (2) from dowels (3) and from the cylinder block.
- Note:** If necessary, tap the flywheel housing with a soft faced hammer in order to separate the flywheel housing from the cylinder block.
7. Remove joint (1) .
 8. Remove crankshaft rear seal (4) from flywheel housing (2) .

Installation Procedure

Table 2

| Required Tools | | | |
|----------------|-------------|--------------------------------------|-----|
| Tool | Part Number | Part Description | Qty |
| A | - | Guide Stud (M10 x 1.25 by 100 mm) | 2 |
| B | 8T-5096 | Dial Indicator Group | 1 |

NOTICE

Keep all parts clean from contaminants.

Contaminants may cause rapid wear and shortened component life.

1. Ensure that the mating surfaces of the cylinder block and the flywheel housing are clean and free from damage.
-

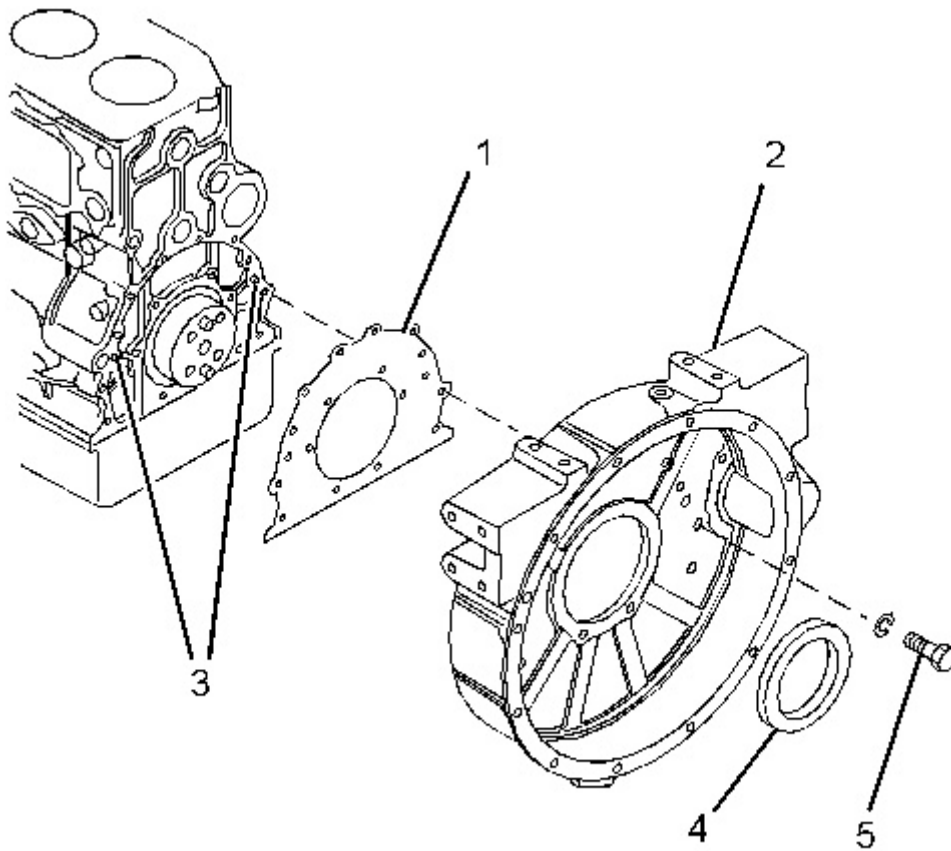

Illustration 3

g01335383

Typical example

2. Inspect dowels (3) in the cylinder block. If necessary, replace the dowels.
-

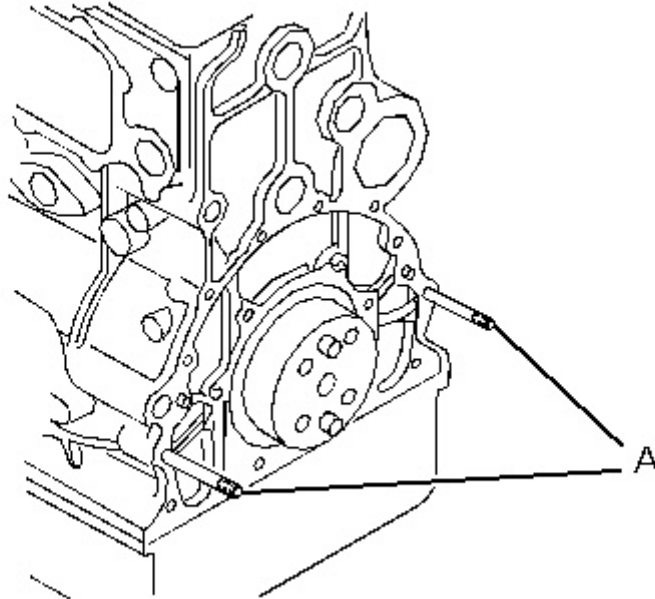

Illustration 4

g01335381

3. Install Tooling (A) to the cylinder block.
4. Install a new joint (1) to the cylinder block.
5. Install a suitable lifting device to flywheel housing (2). The weight of the flywheel housing is approximately 32 kg (71 lb).
6. Use the lifting device to align flywheel housing (2) with Tooling (A). Install the flywheel housing to the cylinder block.
7. Install bolts (5) finger tight.
8. Remove Tooling (A). Install the remaining bolts (5) .
9. Tighten bolts (5) to a torque of 35 N·m (26 lb ft).
10. Remove the lifting device.
11. Use Tooling (B) to check the alignment of the flywheel housing with the crankshaft. Refer to Systems Operation, Testing and Adjusting, "Flywheel Housing - Inspect".
12. Install a new crankshaft rear seal (4). Refer to Disassembly and Assembly, "Crankshaft Rear Seal - Install".

End By: Install the flywheel. Refer to Disassembly and Assembly, "Flywheel - Install".

Thank you very much for your reading. Please Click Here. Then Get COMPLETE MANUAL. NO WAITING



NOTE:

If there is no response to click on the link above, please download the PDF document first and then click on it.