

Dear Customer,

Welcome to the Mahindra family of Thinking Machines.

Congratulations! You are now a proud owner of Mahindra Centuro.

Centuro is an Intelligent Machine that will create a new milestone in the evolution of motorcycles. The intelligence of Centuro is due to many extraordinary features found in various combinations across the three variants O1, O2 & O3.

The **O3 variant** has a premium, attractively designed **Flip key with Remote** that makes you the envy of all other bike owners. It is equipped with an **Intelligent MCi-5 (Micro Chip Ignited 5 Curve) engine** that responds to your need for power and mileage as per your command. The **“Guide Lamps”** stay on even after you switch off the ignition keeping your path illuminated. Locating the Bike's ignition lock in the dark becomes easy with the LED light in the key.

In addition to these features the **O2 Variant** comes with the **“Find-Me”** lamps that help you easily locate your bike in crowded parking lots with just a click of a button. It is loaded with an **Anti-Theft System** that comes with an inbuilt Engine Immobilizer that sounds an alarm and locks the engine when someone tries to steal your bike.

The top-end **O1 variant** has all these features and also includes a stylish **Digital Dashboard** which comes with a white back light and a **Distance to Empty** Indicator that allows you to know approx. distance you can travel once your bike hits reserve. The **Service Reminder** indicator tells you when your bike is due for service.

We are with you to ensure that you enjoy many happy miles on the Mahindra Centuro. Your motorcycle is a product of Mahindra Two Wheelers's advanced engineering and exhaustive testing to deliver Comfort, Safety, Reliability and Optimum performance. This booklet will guide you to the basic operation, routine maintenance and service policy of Mahindra Centuro. Please spend time to read this booklet carefully which will let you know the proper care and maintenance of your Centuro. This is essential for trouble free operation and optimum performance.

All Authorized outlets of Mahindra Two Wheelers are well equipped to handle all your service requirements and will be glad to provide you further information and assistance for the same.

NOTE :-

- Information contained in this owner's guide is based on the latest product information available at time of approval for printing. Mahindra Two Wheeler Limited reserve the rights to make changes at any time without notice & without incurring any obligation.
- Accessories shown may not be part of standard equipment.
- This Owner Guide can be referred to for Centuro and all its variants for functional, operational and maintenance information.
- No part of this publication may be reproduced without prior written consent of Mahindra Two Wheelers Limited.
- All copyrights reserved with the company.

OWNER IDENTIFICATION

Owner's Name : _____

Address : _____

City : _____ State : _____ Country : _____

Mobile No.: _____ Tel. No. : _____

E-mail : _____

Frame No.: _____ Colour : _____

(Stamped on the right side of the steering stem of the chassis.)

Engine No.: _____

(Stamped on the lower side of the LH crankcase.)

Key No.: _____ Battery Make : _____

Battery Sr. No.: _____ Battery Mfg. Code : _____

Date of Regn.: _____ Dealer Code : _____

STAMP OF AUTHORIZED DEALER

MAINTAINING YOUR CENTURO

Warranty :

Quality of Centuro vehicles is guaranteed through a comprehensive warranty policy that covers a period of 2 years or running of 30,000 km, whichever is earlier from the date of sale. Details of warranty terms and conditions and warranty registration card is included in this owner's guide.

Maintenance :

The ownership experience of any automotive product is strongly affected by usage and maintenance. A vehicle is a machine and is subject to wear and tear during daily use as well as damage resulting from accidents, adulterated fuel etc. We strongly advise you to read this owner's guide carefully and follow the maintenance schedules to ensure optimum performance of the machine.

Mahindra Two Wheelers recommended servicing schedules :

We offer you 6 free services. Later on periodic program of paid services is specially designed to keep your vehicle in perfect running condition during daily use. This owner's guide includes instructions and coupons for availing the company recommended servicing schedule. The coupons will be accepted at all Authorized Mahindra Two wheelers dealerships and service centres.

It has been a constant endeavor from Mahindra Two Wheelers to provide the best care and service for your motorcycle. Remember that your Mahindra Two Wheeler dealer is just a call away. The Technicians at Mahindra Two Wheeler dealer are thoroughly trained and our workshops have 'State of Art' equipments to take care of your vehicle.

So make sure to take your Centuro to the nearest Mahindra Two Wheeler dealer for regular service and check-ups.

We understand your vehicle more than anybody else.

We strongly urge you to practice safe driving and please do remember to wear helmet while riding.

Wishing you a happy and safe ride.

Thank you.

Warm Regards,

Customer Care

Mahindra Two Wheelers Limited,

D-1 Block, Plot No. 18/2(Part) M.I.D.C.,

Chinchwad, Pune - 411 019.

E-mail Id : customercare@mahindra2wheelers.com

Help Line No.: 1800 233 8883 (Toll Free)

CONTENTS :

DESCRIPTION	PAGE NO.
MOTORCYCLE IDENTIFICATION	1
TECHNICAL SPECIFICATION	3
SAFETY GUIDELINES	5
SAFE LOADING AND ACCESSORIES	7
DAILY SAFETY CHECKLIST	8
RECOMMENDED USAGE GUIDELINES	9
PART LOCATION	11
PART FUNCTION	14
● IGNITION SWITCH	14
● DIGITAL INSTRUMENT PANEL	15
● ANALOG INSTRUMENT PANEL	17
● WOW FEATURES	18
● RIGHT HANDLE BAR CONTROL	20
● LEFT HANDLE BAR CONTROL	21
● FUEL COCK	22
● FUEL TANK	23
TYRE	24
BATTERY	25
INSPECTION BEFORE RIDING THE VEHICLE	26
STARTING THE ENGINE	26
RIDING	28
BRAKING	29
PARKING	29
MAINTENANCE GUIDELINES	30

CONTENTS :

DESCRIPTION	PAGE NO.
MAINTENANCE SCHEDULE	33
ENGINE OIL	35
MAINTENANCE	37
● SPARK PLUG	37
● OIL FILTER SCREEN & CENTRIFUGAL FILTER	39
● AIR CLEANER	40
● CARBURETTOR	42
● CLUTCH	43
● FRONT BRAKE ADJUSTMENT	44
● REAR BRAKE ADJUSTMENT	45
● DRIVE CHAIN	46
● FRONT WHEEL REMOVAL	48
● REAR WHEEL REMOVAL	49
● BRAKE WEAR INDICATOR	50
BASIC TROUBLE SHOOTING	51
WARRANTY	
WARRANTY REGISTRATION CARD	
SERVICE RECORD SHEETS	
DELIVERY CERTIFICATE	
FREE SERVICE COUPONS	
SERVICE ADVICE SHEETS	
CERTIFICATE OF FITNESS	

MOTORCYCLE IDENTIFICATION

Frame No. (Alpha Numeric 17 digit)

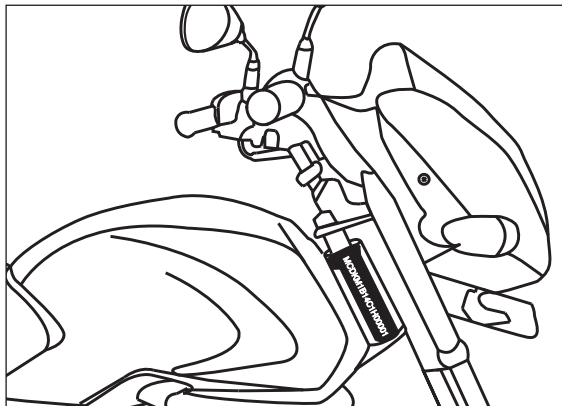

Frame No. Location- Stamped on the right side of the steering stem of the chassis .

VIN NUMBER - 17 DIGIT																
1	2	3	4	5	6	7	8	9	10	11	12	13	14	15	16	17
M	C	D	K	G	1	B	1	4	D	1	A	0	0	0	0	1
WMI Code			Model Code		Drive	Engine	Transmission	Year Code		Plant Code	Month Code	Production Serial No				

VIN - Vehicle Identification Number

Engine No. (Alpha Numeric 11 digit)

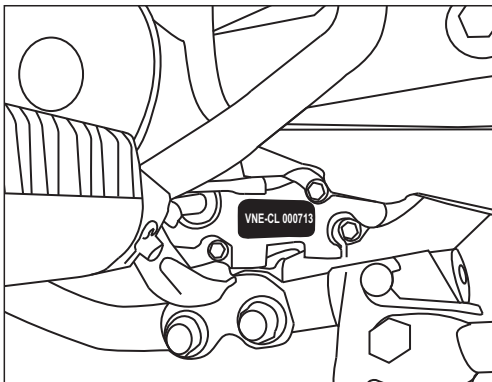

Engine No. Location- Stamped on the lower side of the LH crankcase .

Electric & Kick start

1	2	3	4	5	6	7	8	9	10	11
V	N	E	D	A	0	0	0	0	0	1
Model Code	Engine	Year Code	Month Code	Serial No						

Kick start

1	2	3	4	5	6	7	8	9	10	11
U	B	E	D	A	0	0	0	0	0	1
Model Code	Engine	Year Code	Month Code	Serial No						

TECHNICAL SPECIFICATIONS

Dimensions	Overall Length	: 2030 mm
	Overall Width	: 740 mm
	Overall Height	: 1111 mm
	Wheelbase	: 1265 mm
	Minimum Ground Clearance	: 173 mm
Weight	Kerb Weight (With 90% Fuel, Tools etc.)	: 120 kg
Capacities	Engine Oil - First Fill	: 1000 ml [Castrol Activ 4T]
	Engine Oil - Service Fill	: 900 ml [(SAE 20W40 SL-JASO MA)]
	Fuel Tank	: 12.7 Liters
Engine	Max Power	: 8.5 N.m@ 5500 rpm
	Bore And Stroke	: 52.4 x 49.5 mm
	Compression Ratio	: 9.6 : 1
	Displacement	: 106.7 cm ³
	Spark Plug (Standard)	: MICO UR4AC
	Spark Plug Gap	: 0.7 mm
	Valve Clearance (Cold)	: Intake : 0.05±0.03 mm Exhaust : 0.05±0.03 mm
	Idle Speed	: 1400 ± 100 rpm

Chassis And Suspension

Chassis Type	:	Tubuler
Front Suspension	:	Telescopic and coil spring
Rear Suspension	:	Swing arm and shock absorber with coil spring

Power Transmission

Primary Reduction	:	3.722 : 1
Final Reduction	:	3.154 : 1
Gear Ratio, 1 st	:	3.182 : 1
2 nd	:	1.706 : 1
3 rd	:	1.238 : 1
4 th	:	0.958 : 1

Electrical	Alternator Output	:	90W -Kick start, 110W-Electric start
Lights	Head Lamp	:	12V 35/35W (HS1)
	Tail / Brake light	:	LED
	Turn Signal Indicator	:	12V, 10W
	Number Plate Bulb	:	12V, 5W
	Fuse Capacity	:	10A, 15A

ITEM	SPECIFICATION
Starting System	Electric And Kick Start/Kick start
Speedometer	Digital / Analogue
Wheels	Alloy Wheel/Spoke wheel
Battery	12V 2.5Ah-Kick start/12V 6Ah-Electric start
Tyre Size - Front	2.75 - 18 4 PR, 42P
Rear	3.00 - 18 6 PR, 52P

SAFETY GUIDELINES :

Importance of Safety :

Your motorcycle can provide many years of service and pleasure - if you take responsibility for your own safety and understand the challenges that you can meet on the road.

There is much that you can do when you ride to protect yourself. You will find many helpful recommendations throughout this booklet. Few most important are -

- a) Always wear a Helmet
- b) Make yourself easy to see
- c) Ride within your limits.

Mahindra Two Wheelers urges you to practise safe riding. Here are few tips :

- Familiarize yourself thoroughly with your motorcycle by reading this Owner's Guide and follow operating instructions especially about starting, acceleration and braking your vehicle.
- Initially, before riding in regular traffic practise riding in an uncongested area.
- Stay within speed limits dictated by road, weather and traffic conditions. Riding at a proper speed and avoiding unnecessary acceleration is important for your safety, better fuel consumption, smooth operation and longevity of your vehicle.

Helmets & Eye Protection :

Wearing helmet is most important because it offers, if it occurs, the best protection against head injuries. A helmet should fit your head comfortably and securely. Always wear a face shield or goggles to protect your eyes and help your vision.

Additional Riding Safety:

Sturdy footwear with non slip soles to help protect your feet and ankles. Leather gloves to keep your hands warm and help to prevent blisters, cuts & burns.

A motorcycle riding suit or jacket for comfort as well as protection.

- If it is must to ride during heavy or light rain, to avoid skidding exercise greater caution.
- To avoid injury to the brain caused by head injury in accidents, always wear a helmet (conforming to appropriate specified standards) and other protective apparel such as gloves, footwear etc.
- When faced with speed breakers, wet roads and potholes, slow down your vehicle to avoid loss of control and mechanical damage to your motorcycle.
- During braking, use both front and rear brakes simultaneously, rear little harder to retain control.
- Always follow the traffic rules.
- Always carry documents of vehicle registration, insurance, PUC certificate and a valid driving license with you.

WARNING : Not wearing a helmet increases the possibility of serious injury or death in a crash. Be sure you and your pillion rider also always wears a helmet, and preferable eye protection and other protective apparel while riding.

SAFE LOADING AND ACCESSORIES :

General guidelines to help you to decide how to equip your motorcycle and how to load it safely :

- Check that both tyres are properly inflated, with recommended air tyre pressure.
- Ensure all luggage and accessories are secure for stable handling.
- Do not carry items that protrude through the vehicle and affect vehicle performance and operation.
- Do not carry children or pets on the front.
- Do not modify the motorcycle. It has been designed carefully by our experts and any modification may adversely impact on it's safety and performance.

Loading Guidelines :

Your motorcycle is primarily intended for transporting you and a passenger.

If you wish to carry cargo, check with your Mahindra Two Wheelers dealer for advice.

Improper loading of your motorcycle can affect its stability and handling. Even if your motorcycle is properly loaded, you should ride at reduced speed whenever carrying cargo.

DAILY SAFETY CHECKLIST :

For assured safety and to save time & money in future before riding be sure to check the following:-

- There is enough fuel in the tank to cover your planned journey, and there is no fuel leakage.
- Engine oil level is adequate.
- Throttle operation and it's return is smooth.
- Steering lock is operating well.
- Brakes are not dragging.
- All electricals (lights and horn) are working.
- Center stand and side stand are at fully up position.
- Tyres have correct air pressure, adequate tread depth and no cracks/cuts on tyre.
- Rear view mirrors are positioned to give good rear visibility.

RECOMMENDED USAGE GUIDELINES :

Running in Procedure :

It is important to drive your vehicle properly during initial 1000 km to ensure longevity and hassle free running. New engine components initially wear in quickly.

Please follow underneath instructions during "Running-In" period :

- Do not exceed a speed limit of 50 km/h
- Avoid full throttle operation, and rapid acceleration.
- After you start the engine, run it at idle for a minute to enable the oil to lubricate entire the engine.

Cleaning Procedure :

- Avoid spraying water under high pressure at the following areas :
 - ◆ Wheel hubs, Silencer outlet.
 - ◆ Ignition switch, handlebar switches and other electrical parts.
 - ◆ Underseat storage.
- After cleaning, rinse the motorcycle thoroughly with plenty of clean water to avoid corrosion by residual detergent.
- Dry the motorcycle, start the engine and let it run for several minutes.
- Test the brakes before riding in traffic. Applications of brakes several times may be necessary to restore normal braking performance.

CAUTION :

Immediately after washing the motorcycle Braking performance may be impaired.

General Tips For Maximizing Fuel Efficiency :

While your Centuro has been designed to give maximum fuel efficiency of its specifications, it is important to understand that fuel efficiency is affected by several extraneous factors i.e. rider usage habits, road conditions, traffic, wind flow etc.

- Ensure tyre pressure is maintained as per manufacturer's recommended levels. Different tyre pressures are recommended for single seat and double seat. Observe them carefully. (Page No. 24)
- Front and Rear brakes should have the right amount of free play.
- Engine oil should be changed religiously as recommended in the maintenance schedule.
- Always use choke for cold start.
- Total weight on the two wheeler makes a big difference to mileage, avoid overloading.
- While filling the tank to full fill in the morning as petrol expands during the day as atmospheric temp. increase & may spill.
- Keep your two wheeler clean and dust free.
- Do not fill fuel to the brim of the tank as there can be spillage and petrol can expand and overflow.
- Fill petrol from busy and well known petrol stations where quality and quantity are assured.
- Do not rev the engine, unnecessarily.
- Try and avoid congested roads as far as possible, even if it means you have to take a slightly longer route.
- Go gentle on the throttle.

PART LOCATION

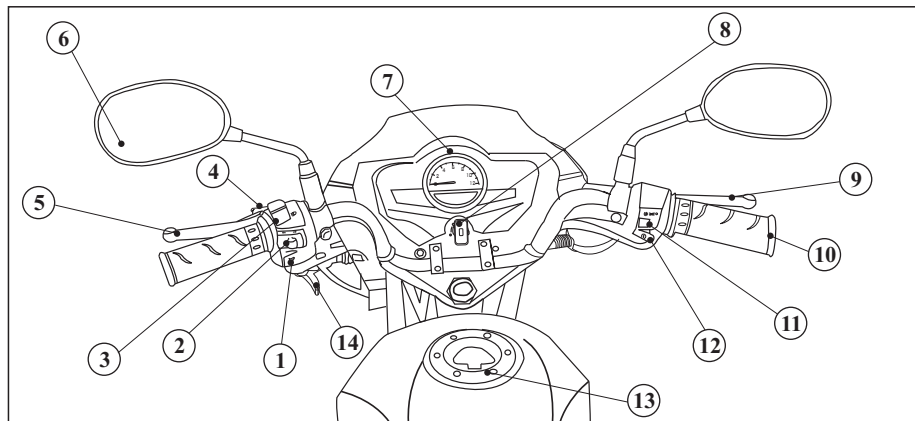

1. Horn switch

2. Turn signal switch

3. Head light dimmer switch

4. Pass light switch

5. Clutch lever

6. Rear view mirror

7. Instrument panel

8. Ignition switch

9. Front brake lever

10. Throttle grip

11. Head light switch

12. Self start switch

13. Lid fuel tank

14. Choke Lever

LEFT SIDE VIEW

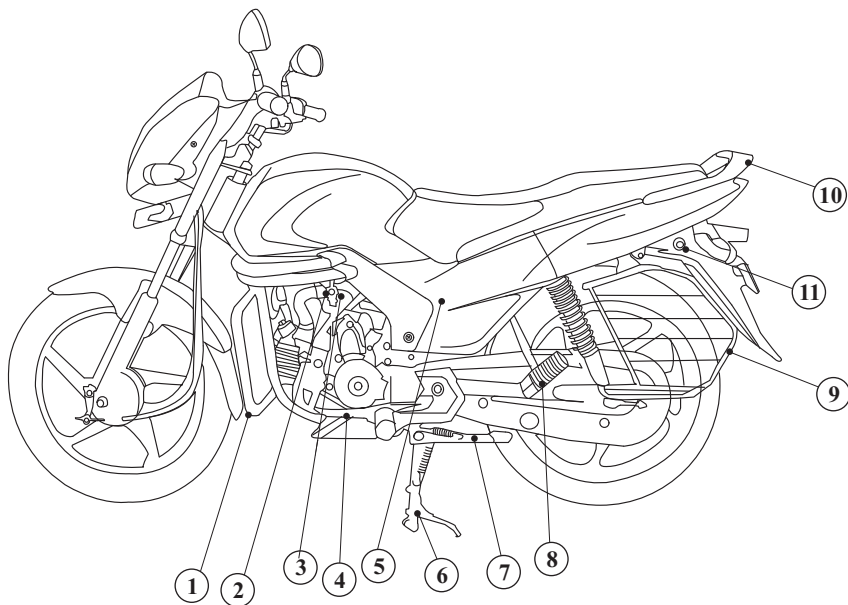

1. Crash guard

2. Fuel cock

3. Carburettor

4. Gear shift pedal

5. LH Side cover

6. Main stand

7. Side stand

8. Pillion foot rest

9. Saree guard

10. Gabrail

11. Seat Lock

RIGHT SIDE VIEW

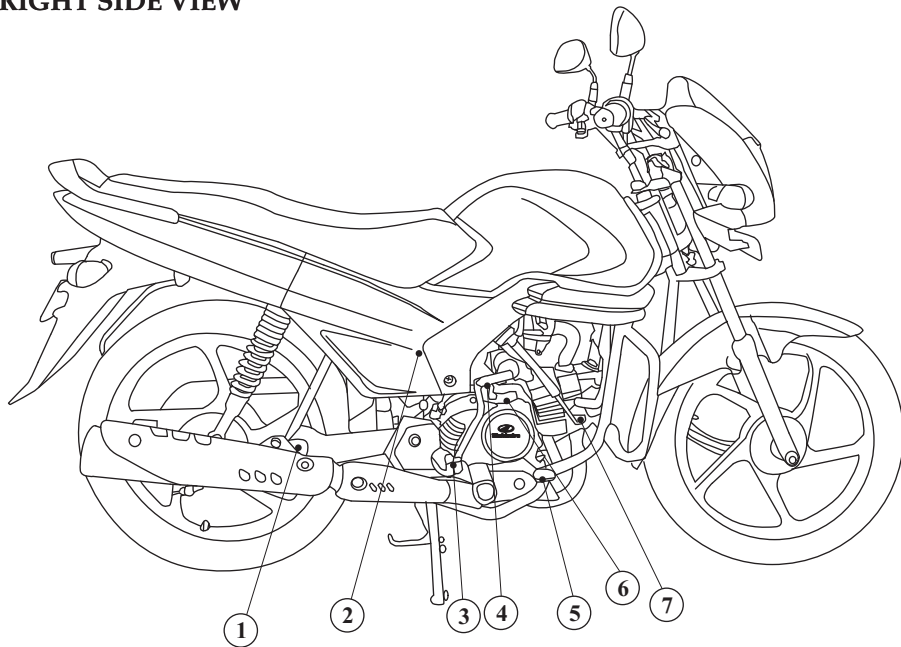

- 1. Pillion foot rest
- 2. RH Side cover
- 3. Rider foot rest

- 4. Kick starter pedal
- 5. Rear break pedal
- 6. Oil filler cap / dipstick

- 7. Spark plug

PART FUNCTION IGNITION SWITCH

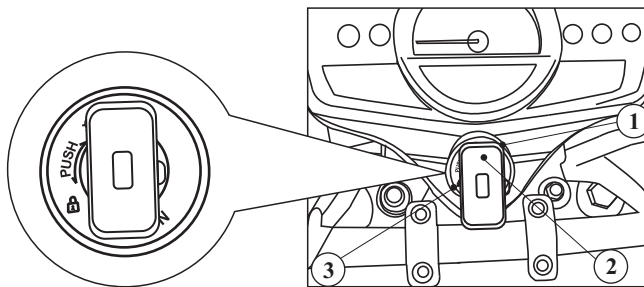

1. Ignition switch
2. Ignition key
3. Steering lock position

Key Position	Function	Key Removal
ON	The engine can be started. Turn signal lights, Horn, Stop light and fuel indicator can be operated.	Key can not be removed.
OFF	Engine can not be started. Lights and indicators can not be operated.	Key can be removed.
LOCK	Steering is locked.	Key can be removed.

DIGITAL INSTRUMENT PANEL

OPERATING CONTROLS :

Digital Speedo Meter displays the various aspects as described below :

It is necessary to switch 'ON' the ignition to view the various functions.

- 1) Odometer : Indicates accumulated distance covered (in km)
- 2) Digital Speedometer : Indicates driving speed (in km/ h)
- 3) Fuel meter : Centuro fuel tank capacity is approx. 12.7 litres, for fuel indication there are nine bars available in speedometer. Fuel indication displayed in the speedometer is an indicative reading. Refill indication - when 1 bar display starts blinking, it is the indication to the rider to refill the tank as soon as possible.
- 4) R.P.M. : Once the vehicle is started (in idle or in running condition) the needle in the speedometer indicates the engine RPM.
- 5) High beam indicator : Indicates that headlight is on high-beam. When engine is running.
- 6) Turn signal indicator : Flashes when turn signal button is operated.
- 7) Neutral Indicator : Glows when gear is in neutral.

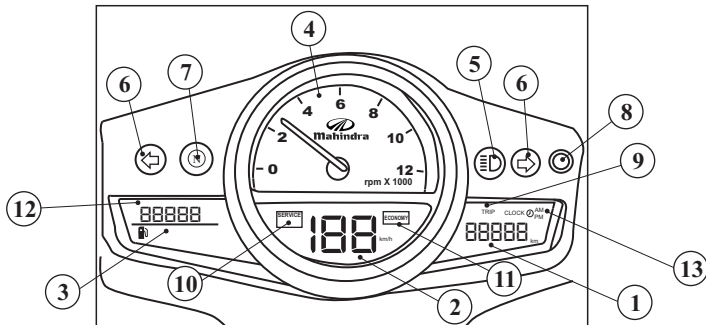

Digital Instrument panel has two main buttons, namely 'Mode' and 'Set'

- 8) Reset button :- By pressing the switch for 1~2 sec the mode can be selected. (i.e. Odo-trip-Clock.)
- 9) Trip :- Display shows 'Trip' icon. The Trip Meter shows the distance traveled since it was last reset to 'zero'. For resetting, After entering into trip mode, trip meter will be reset to 0.0 km after pressing the switch for 2~3 sec.
- 10) Service indicator :- This service indicator reminds the specified service schedule to the user.
- 11) Economy Warning :- This is an indication to the user to drive the bike in economy range (30~50 km/hr.)
- 12) DTE :- This feature indicates an approximate range which the user can drive the vehicle before the fuel exhausts to an unusable level. The DTE indication starts just before to manual reserve in fuel tank. The LCD screen for DTE indication will be blank if the fuel is above reserve capacity.
- 13) Clock :- In clock mode, press the button in speedometer for > 2 sec to entering into clock set mode. Press the button > 2 sec to shift to hour, minute, & second mode. Change hours, minute and seconds by in that mode (digital blinks)and press button < 1sec to increment. Leaving the button without pressing > 5 sec saves the reading and come to normal.

ANALOG INSTRUMENT PANEL

OPERATING CONTROLS :

Analog Speedometer displays the various aspects as described below :

It is necessary to switch 'ON' the ignition to view the various functions.

- 1) Speedometer : Indicates driving speed (in km/ h)
- 2) Odometer : Indicates accumulated distance covered (in km)
- 3) Fuel meter : Centuro fuel tank capacity is approx. 12.7 litres , for fuel indication there is 'F' mark for full indication 'E' mark for empty indication. Fuel indication displayed in the speedometer is only an indicative reading. Refill indication - when needle enter 'red' band. It is the indication to the rider to refill the tank as soon as possible.
- 4) Neutral Indicator : Glows when gear is only in neutral.
- 5) Turn signal indicator: Flashes when turn signal button is operated.
- 6) High beam indicator: Indicates that headlight is on high-beam.

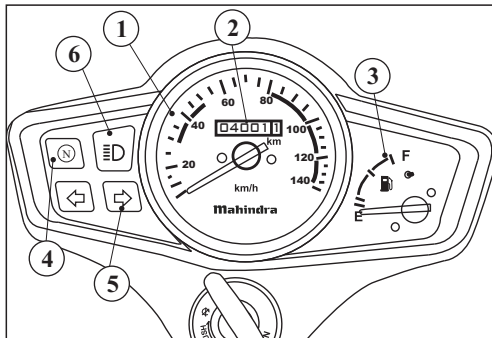

WOW FEATURES

There are three version in model , Details are given below :-

Sr.	Features	O1 version	O2 version	O3 version
1.	Immobilizer	✓	✓	
2.	Lead Me	✓	✓	
3.	Follow Me	✓	✓	✓
4.	Folder Key	✓	✓	✓
5.	LED Torch	✓	✓	✓
6.	DTE	✓		
7.	Service Indicator	✓		

There are total seven WOW features, as given below :-

DTE (Distance To Empty): (applicable only for O1 variant)

This 'DTE' is displayed in left most corner of the LCD(Liquid Crystal Display) in the speedometer. This feature indicates an approximate range which the user can drive the vehicle before the fuel exhausts to an unusable level. The DTE indication starts only when vehicle comes to reserve quantity of fuel. The LCD screen for DTE indication will be blank if the fuel is above reserve capacity.

Lead Me To Vehicle: (Applicable only for O1 and O2 variant)

This feature is to help the user of the vehicle to locate his/her vehicle at a crowded parking area. The Key Fob which is attached with the ignition key has 3 buttons viz, Lead me to vehicle, Mute and LED. These features works around 35m from vehicle vicinity and in line of sight of the vehicle.

Note:- Features below works when ignition key is in OFF condition.

1. Press Lead me to vehicle button Side indicators of our vehicle blink twice along with an audible alarm
2. Press Mute button Side indicators only blink twice (No audible alarm)
3. Press LED button Light glows in the key fob whenever this button is pressed.

Follow Me Lamp: (Applicable for all variants)

This feature illuminates the surrounding area of the vehicle for a short duration of 10 seconds after ignition key is turned OFF. The pilot lamp (LEDs) and tail lamp is operated for 10 seconds in this condition.

Note:- This feature will not work in H/L switch off condition.

Engine Immobilizer: (Applicable for O1 and O2 variant)

This feature is for preventing unauthorized starting of engine with a user who is not having a valid ignition key. When an invalid key is used, an audible alarm is activated and engine cannot be started. Only an user who is having a valid key can start the engine.

Service Indicator: (applicable only for O1 variant)

This feature is indicated in LCD (Liquid Crystal Display) in speedometer. This service indicator reminds the specified service schedule to the user.

Flip Key: (applicable for all variants)

This is a foldable key and operates with a pres of a mechanical knob in the key fob.

Key Torch: (applicable for all variants)

This is a feature given in a key fob for customer's conveniences in dark conditions. By pressing torch button in key fob, the torch inbuilt in the same will glow.

Note:- Excessive use of key torch may lead to reduce the life of key torch battery.

RIGHT HANDLE BAR CONTROL

Right handle bar control switch consists of Starter button (1) and Head light 'ON - OFF' switch (2).

Starter Button (1)

Located below the headlight switch. Before operating/pressing this button make sure that the gear is in neutral position by using ignition key, switch 'ON' the ignition. Then press the starter button. When pressed, the starter motor cranks the engine.

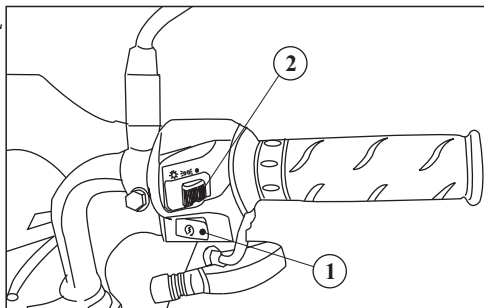

CAUTION: Do not press the electric starter button for more than 3 seconds at a time. Release the starter button for approximately 10 second before pressing it again. To avoid damage to engine parts release this button immediately after engine has started, and do not press the button again.

Head Light Switch (2)

When the switch knob is turned to “” position while engine is running, head light, tail light, licence plate light and meter light will be 'ON'.

When the switch knob is turned to “” position while engine is running, meter light, position light, licence light and tail light will be "ON". Head light will be “OFF”.

When the knob is turned to “●” position - Head light, Tail light & Speedometer light remain 'OFF'.

LEFT HANDLE BAR CONTROL

Left handle bar control switch consists of Pass light switch (1), Head light dimmer Switch (2), Turn signal switch (3) and Horn button (4).

Pass light Switch (1)

When pressed gives an indication for passing ahead.

Functions when 1) Head light is 'OFF'.

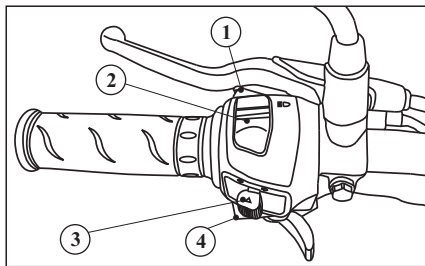

2) Head light is 'ON' and in low beam.



Headlight Dimmer Switch (2)

Select "  " for high beam and "  " for low beam

Turn Signal Switch (3)

Move the turn signal switch towards "  " to signal a right turn and towards "  " to signal a left turn. To turn off turn signal bring the switch to center.

Horn Button (4)

Press the horn button to sound the horn.

FUEL COCK

Fuel cock (1) is located on the left side of the motorcycle at the lower side of the fuel tank.

OFF - When the fuel cock is in 'OFF' position, fuel does not flow from fuel tank to carburettor.

- Whenever the motorcycle is not in use ensure to keep cock always in 'OFF' position .

ON - In 'ON', position fuel will flow from the fuel tank to the carburettor.

RESERVE - At 'RES', fuel will flow from the reserve fuel supply to the carburettor.

It is advised to use the reserve fuel only when the main supply has gone off.

WARNING - Before riding the motorcycle, it is necessary to understand how to operate fuel cock , to avoid sudden stoppage of the vehicle in traffic, due to no fuel supply .

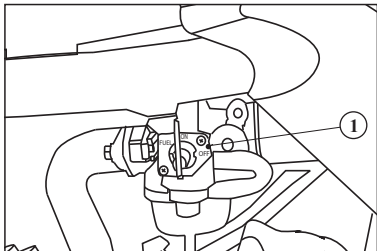

RES POSITION

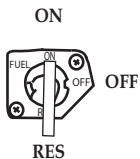

OFF POSITION

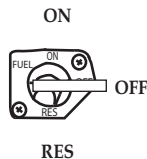

ON POSITION

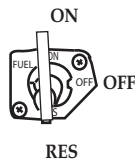

FUEL TANK

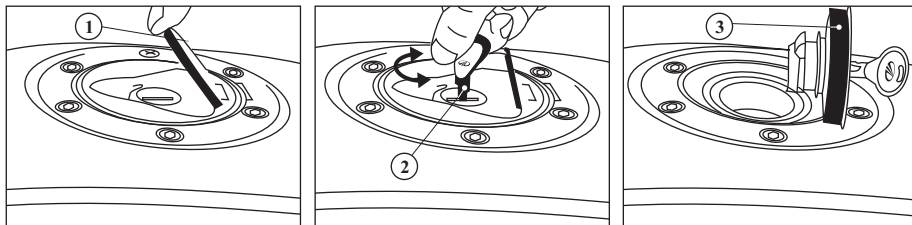

Capacity of fuel tank is 12.7 liters. including reserve supply.

To open the fuel tank cap (3)

1. Open the flap (1)
2. Insert the ignition key (2)
3. Turn the key clockwise and open the lid as shown in illustration.

To close and lock the fuel tank cap, just press the cap and remove the key.

WARNING :-

- Refill petrol in well ventilated area and engine stop condition as petrol is highly inflammable.
- After refilling close the tank cap properly.
- To avoid evaporation of petrol and deterioration of paint gloss due to ultra violet rays and heat of sunlight, always park your motorcycle in covered parking.

TYRE

For maximum road grip, stability, riding comfort, performance and longevity of the tyre. Optimum air pressure in the tyre of your Centuro is important. You should check tyre pressure regularly and adjust them immediately to the optimum if necessary. The tyre pressure should be checked when the tyres are cold and before you drive for long distance.

Tyre sizes and recommended tyre pressure :

Tyre size		Front	Rear
Wheel		2.75 - 18 - 4PR, 42P	3.00 - 18 - 6PR, 52P
Cold tyre pressure kg/cm ² (Psi)	Solo	1.75 kg/cm ² (24-Psi)	2.25 kg/cm ² (32-Psi)
	With pillion rider	1.75 kg/cm ² (24-Psi)	2.50 kg/cm ² (35-Psi)

WARNING - ● Improper tyre air pressure may result in abnormal tyre wear, poor road grip and adversely affect the wheel balance, suspension performance and vehicle handling.

BATTERY

It is not necessary to check the battery electrolyte level or add distilled water as the battery is a maintenance-free (sealed) type. If your battery seems weak and/or is leaking electrolyte (causing hard starting or other electrical troubles), visit your Authorised Mahindra Two Wheeler dealer.

NOTE: Your battery is maintenance-free type and can be permanently damaged if the cap strip is removed.



This symbol on the battery means that this product must not be treated as household waste.

NOTE: Battery contains lead, which is a hazardous material and if improperly disposed, can be harmful to the environment and human health.

Always return the used maintenance-free battery to Authorised Mahindra Two Wheeler dealer.

WARNING :- The battery gives off explosive hydrogen gas during normal operation. A spark or flame can cause the battery to explode with enough force to kill or seriously hurt you. Wear protective clothing and a face shield or have a skilled mechanic do the battery maintenance.

KEEP CHILDREN AWAY FROM THE BATTERY.

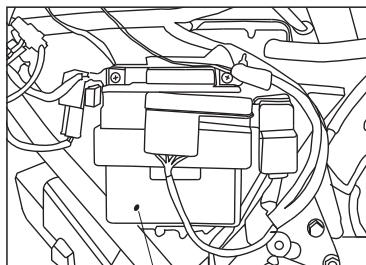

1

Self Start - 6Ah

Kick Start - 2.5Ah

INSPECTION POINTS BEFORE RIDING THE VEHICLE

1. **Fuel level** - Ensure that sufficient quantity of fuel is present in the tank. Check for leaks.
2. **Engine oil level** - Top up if required.
3. **Front and Rear brakes** - Check for operation . Adjust if required (Page No. 43 & 44)
4. **Throttle** - Check for free play and smooth operation in all steering positions.
5. **Tyres** - Check tyre air pressure, correct if necessary and check for condition of the tyres.(Page No. 24)
6. **Lights and Horn** - Check headlight (Hi-Low beam), tail/stop light, turn signal lights

WARNING - ● Inspect your vehicle every day before you start it's engine. This is important for your safety, as serious damage or accident of your vehicle and also your time and expenses can be saved.

STARTING THE ENGINE (KICK START)

- Make sure to keep transmission in neutral.
- Turn the fuel cock ON/RES as per availability of fuel quantity (Page No. 22).
- Switch 'ON' the ignition(Page No. 14).
- Operate the choke lever (1) to make it 'ON' as illustration No. 1 (Page No. 27).
(Choke operation is not required when engine is sufficiently hot.)
- With your foot , push the kick lever down slowly until you feel resistance and then step down briskly.
- Don't accelerate the vehicle if the choke is in 'ON' condition.
- As soon as engine starts, ensure choke lever is in its original position.
- If the engine fails to start after repeated attempts, hold the throttle 1/8 ~ 1/4 position and push the kick lever down slowly until you feel resistance and then step down briskly.

STARTING THE ENGINE (SELF START)

- Make sure to keep the gear in neutral position.
- Turn the fuel cock ON/RES as per fuel level in the petrol tank.
- Switch "ON" the ignition
- To operate choke push the choke lever to the other side, as shown in illustration No. 1. Choke operation is not required when engine / atmospheric temp. is warm.
- Press the starter switch (2) to start the engine as shown in illustration No. 2 and release the starter switch immediately when engine starts.
- Do not keep the electric starter pushed for more than 3 seconds at a time . Release the starter button for approximately 10 seconds before pressing it again.
- If the engine fails to start after repeated attempts, hold the throttle 1/8 - 1/4 open and press then starter button.

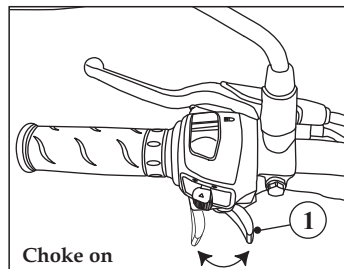

Illustration No. 1

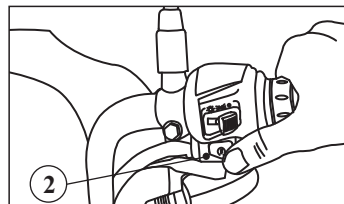

Illustration No. 2

CAUTION-

- Never run the engine in a closed area. The exhaust contains poisonous carbon monoxide gas.
- To start the vehicle first time in the morning or having not used the vehicle for long duration, for smooth & quick start, choke operation is advised.

RIDING

- Please go through motorcycle safety guidelines (Page No. 5) before you ride
- After the engine is sufficiently warm, the motorcycle is ready for riding.
- While the engine is in idling, press the clutch lever fully and press the gearshift pedal slightly to shift the vehicle from neutral into 1st gear (low gear).
- Release the clutch lever slowly, and simultaneously & gradually open the throttle to increase engine speed. For smoother positive acceleration, proper co-ordinated operation of throttle and clutch lever is necessary.
- As motorcycle attains a moderate speed, close the throttle fully & fully press the shift to 2nd gear by pressing the gear shift pedal little further. Release the clutch lever slowly and simultaneously & gradually open the throttle.
- Repeat the sequence for shifting to 3rd and 4th gear.

Recommended gear shifting speed	
1 st gear	0-10 km/h
2 nd gear	10-20 km/h
3 rd gear	20-30 km/h
4 th gear	30km/h and above

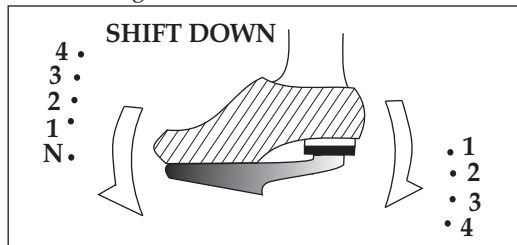

CAUTION- • Before shifting gears, always press the clutch lever fully and completely close the throttle, otherwise the related engine parts or gears may get damaged.

BRAKING

- To control speed of your vehicle & while shifting gears close the throttle completely and gradually apply both rear and front brakes simultaneously.

- CAUTION-**
- Independent use of rear or front brake reduces the overall braking efficiency. In extreme conditions braking with only rear or front brakes may lock the wheel which would result in skidding or toppling of vehicle.
 - Braking performance is affected adversely with wet surfaces, loose surfaces, and over heating of brake drum due to unnecessary continuous application of brakes. For safety, exercise extreme caution while braking and also at turning. Do not accelerate while turning.

PARKING

- After stopping the motorcycle, turn the ignition switch to "OFF" position
- While parking your vehicle, use of the main stand is preferred for firm support.
- Lock the steering and remove key.

- CAUTION-**
- Park the motorcycle on firm, level ground to prevent toppling of the vehicle.
 - While parking on side stand put the vehicle in first gear.

MAINTENANCE GUIDELINES :

Basics of Two Wheeler maintenance -

Following are the basics for maintaining your two wheeler. Please also refer to the detailed maintenance schedule given in this Owner's Guide.

- Check fuel lines and connections to ensure that there are no leakages.
- Spark plug must be inspected periodically and cleaned thoroughly.
- Check engine oil level and if necessary top -up / replace with recommended grade and quantity.
- Always use genuine oil as recommended by manufacturer.
- Always maintain recommended tyre pressure.
- Check and clean air filter element periodically.
- Ensure brakes are working well (i.e. not dragging or binding).

If your vehicle is going to remain unused for a long time, some steps for maintenance need to be taken. Before storing your vehicle following the instructions will prevent it from rusting and other possible damage / hazards.

- Clean the vehicle thoroughly.
- Empty all fuel from the fuel tank pipes and carburettor bowl.
- Remove the spark plug and put several drops of 4T oil into the cylinder. Crank the engine slowly several times to coat the cylinder wall with oil and reinstall the spark plug.
- Put the vehicle on a box/main stand such that both wheels are raised off the ground. Spray oil on all unpainted metal surfaces to prevent rusting. Avoid getting oil on rubber parts / brake liners.
- Lubricate control cables.
- Cover the entire vehicle neatly. Please ensure that the area where vehicle is stored is well ventilated and free from any source of flame or spark.
- Remove battery from vehicle & ensure that electrolyte level is in between upper & lower level.
- Ensure the battery is fully charged, before reuse.
- Keep the battery away from rain, moisture and direct sunlight. Store it in cool, dry and safe place.

Preparation For Bringing It Back Into Regular Use :

- Clean the vehicle.
- Check electrolyte level in the battery, charge if necessary and install it in the vehicle.
- Make sure the spark plugs are tightly fitted.
- Fill the tank with fuel.
- Change the engine oil.
- Go through the daily safety checklist (Page No. 08).
- Check and if required, inflate tyres to recommended air pressure.

MAINTENANCE SCHEDULE

I : Inspect, C : Clean, R : Replace, A : Adjust, L : Lubricate, O : Oil change, T : Top-up
E : Emission check, D : Drain

FREQUENCY ITEM		WHICH EVER COMES FIRST	FREE SERVICE PERIOD						Refer to Page
		SERVICES	1 st	2 nd	3 rd	4 th	5 th	6 th	
		MONTHS	1st to 4th service coupons are valid for 365 days from the date of purchase.				5th to 6th service coupons are valid for 540 days from the date of purchase.		
		KM	500-750	2500-3000	4500-5000	6500-7000	8500-9000	10500-11000	
**	Fuel lines		I	I	I	I	I	I	
**	Throttle operation		I,A	I,A	I,A	I,A	I,A	I,A	
**	Carburettor		D,A	D,A	D,A	D,A	D,A	D,A	
**	Air cleaner		C	C	C	C	C	R	39 & 40
**	Spark plug		I,C,A	I,C,A	I,C,A	I,C,A	I,C,A	R	36 & 37
***	Valve clearance		I,A	I,A	I,A	I,A	I,A	I,A	
**	Engine oil		O	I,T	O	I,T	O	I,T	34 & 35
***	Engine oil Strainer screen		C		C		C		38
***	Engine oil Centrifugal filter		C		C		C		38
***	Clutch		I,A	I,A	I,A	I,A	I,A	I,A	
**	Drive chain		I,C,L,A	I,C,L,A	I,C,L,A	I,C,L,A	I,C,L,A	I,C,L,A	
**	Brake system		C,A	C,A	C,A	C,A	C,A	C,A	
**	Brake light switch		I,A	I,A	I,A	I,A	I,A	I,A	
**	Brake shoe wear		I,A	I,A	I,A	I,A	I,A	I,A	
*	Battery		I	I	I	I	I	I	

The vehicle must be serviced at every 2000-2500 km or within 90 days (which ever is earlier) from the date of previous service.

MAINTENANCE SCHEDULE

FREQUENCY ITEM		WHICH EVER COMES FIRST	FREE SERVICE PERIOD						Refer to Page
		SERVICES	1 st	2 nd	3 rd	4 th	5 th	6 th	
		MONTHS	1st to 4th service coupons are valid for 365 days from the date of purchase.				5th to 6th service coupons are valid for 540 days from the date of purchase.		
		KM	500-750	2500-3000	4500-5000	6500-7000	8500-9000	10500-11000	
**	Head light focus		I,A	I,A	I,A	I,A	I,A	I,A	
**	Main/Side stand		L	L	L	L	L	L	
***	Wheel / Tyres		I	I	I	I	I	I	
**	Front Suspension oil		I	I	I	I	I	I	
***	Steering head bearing		I	I,A	I	I,A	I,L,A	I	
**	Fasteners		I	I	I	I	I	I	
**	Muffler (Cat.vervort)				I,E			I,E	
**	Idle speed		I	I	I	I	I	I	

- 1) Service more frequently when riding in dusty area
- 2) For higher odometer reading, repeat at the frequency.
- 3) Motorcycle must be serviced every 2000-2500 km or within 90 days(Which ever is earlier) from the date of previous service.

- * Can be done by the customer himself.
- ** We recommend that these items are to be attended by Authorized Mahindra Two Wheelers service centre.
- *** These items must be attended only by Authorised Mahindra Two Wheelers service centre as they require special tools/Expertise/lubricants.

ENGINE OIL

Engine oil level check -

Check engine oil level everyday before operating the motorcycle. The oil filler cap/dip stick (1) is provided at the right crankcase cover as shown in the illustration. Oil level must be maintained between upper and lower level mark.

Procedure for checking engine oil level -

- Park the motorcycle on main stand and on level ground.
- Remove filler cap/dip stick and wipe it clean.
- Reinserting the dipstick (w i t h o u t screwing dipstick in to crankcase.) and then check oil level.
- If required top up the oil upto upper level mark of the dip stick with the specified oil. Do not overfill.
- During oil change, quantity of oil to be filled is 900 ml.
- After inspection, screw the filler cap / dip stick to RH crankcase

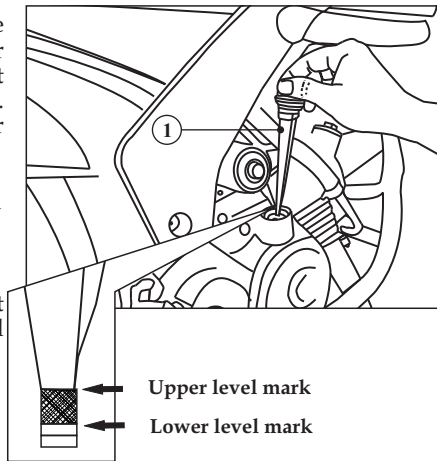

Recommended Engine oil:- Castrol Activ 4T (SAE 20W40 SL-JASO MA)

WARNING -● Do not run the vehicle with insufficient / without any oil as it can cause serious damage to the engine.

- Excessive oil filling can cause malfunctioning of spark plug.
- Engine oil quality and quantity is a major factor affecting the performance and life of the engine. Always use MTWL recommended engine oil.

ENGINE OIL CHANGE

Engine oil quality and quantity are the major factors affecting performance of vehicle and engine service life . Hence it is important to change engine oil as per maintenance schedule.

- Before carrying out engine oil change operation previous oil must be drained completely. To ensure rapid & complete draining first make engine warm by idling it for few minutes & then stop the engine & put the vehicle on main stand.
- Remove the dipstick (1) and drain Plug (2).
- After oil has drained completely , reinstall the drain plug .
- Check condition of sealing washer (3) and replace if necessary.
- Fill **900 ml** recommended engine oil through dipstick opening .
- Reinstall the dip stick.
- Start the engine and allow it to idle for few minutes.
- Stop the engine.
- Check for any oil leakage from the engine.
- After few minutes, check oil level by dip stick (reinsert dipstick in crankcase without screwing in it) It should be at the upper level mark of dipstick.

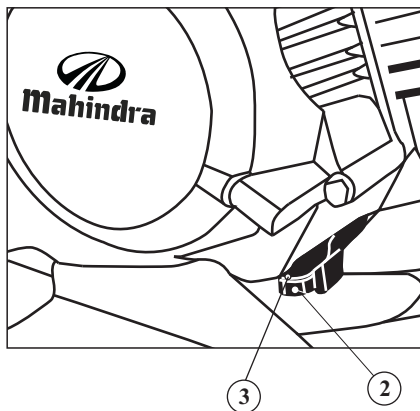
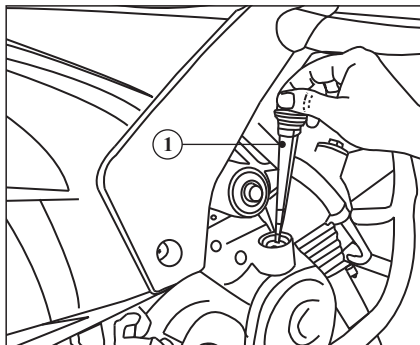

MAINTENANCE

SPARK PLUG:

Standard plug is "MICO UR4AC "

Spark plug gap specification : 0.7 mm

To remove spark plug -

- Disconnect the spark plug cap (1)
- Remove the spark plug using a spark plug spanner (2) & (3).

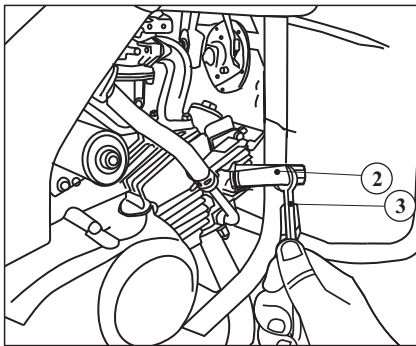
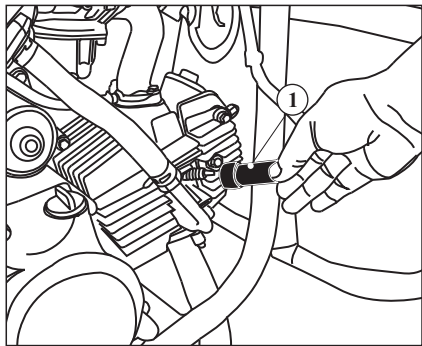

- Visually inspect the spark plug electrode (5) for wear. The electrode should not be eroded. If electrode or insulator tip appear unusually fouled or burnt, contact your Authorised Mahindra Two Wheelers service centre. Discard the spark plug if there is apparent wear or if the insulator is cracked or chipped. Clean deposits of carbon or fouled plug with a plug cleaner or with wire brush.
- Using a feeler gauge (7). Make sure the spark plug gap (6) is 0.7 mm. If adjustment is necessary, bend the side electrode (5) carefully.
- With the plug washer attached, first to prevent cross-threading thread the spark plug in by hand till it is fully seated.
- To compress the washer using spark plug wrench tighten the spark plug 1/8 to 1/4 turn after the plug seat. If it is a new spark plug, it should be tightened 1/2 to 3/4 turn.
- Connect the plug cap & reinstall the centre cover and luggage box.

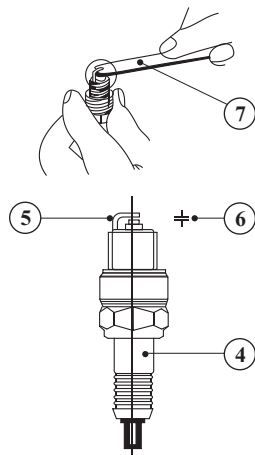

- 4) Spark plug
- 5) Electrodes
- 6) Spark plug gap
- 7) Feeler gauge

- CAUTION:**
- The spark plug must be tightened securely. An improperly tightened plug can become very hot and possibly damage the engine parts.
 - Never use a spark plug of an improper specification.
 - Ordinary plug spanner should not be used.
 - Spark plug should be removed only when engine is cold.

OIL FILTER SCREEN & CENTRIFUGAL FILTER

Clean oil filter screen and centrifugal filter as specified in the maintenance schedule

- Drain the engine oil throughly (Page No.35).
- Remove kick lever , Muffler , disconnect the clutch cable and remove the engine RH crankcase cover (1).
- Remove centrifugal filter cover (2) and with clean petrol clean centrifugal oil filter (3).
- Remove the oil filter screen (4) & wash it in clean petrol and then reinstall.
- Reinstall centrifugal oil filter cover , engine RH crank case cover, muffler, kick lever and connect the clutch cable. Fill engine oil as described on Page No.35.

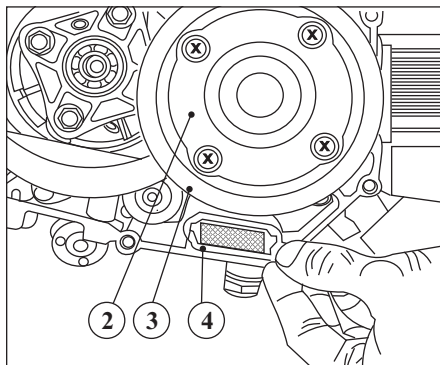
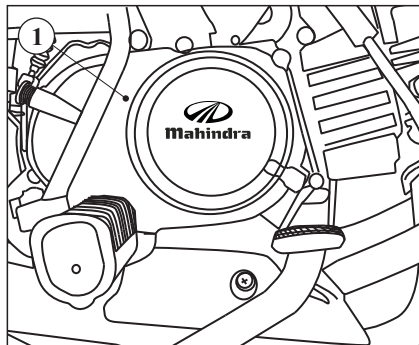

AIR CLEANER

The air cleaner must be serviced at regular intervals as advised in maintenance schedule.

When riding in dusty area more frequent servicing is recommended.

- Remove seat (1).
- Remove the LH side cover (2) by removing screws (3) , (4)

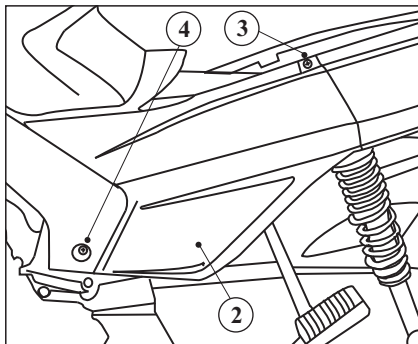
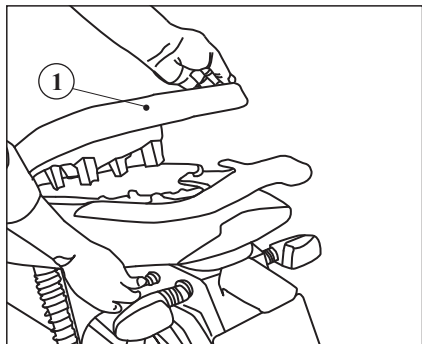

- Remove air filter cover (5) by removing 5 screws (6)
- Take out the air cleaner assembly (7).
- Wash the element in non-flammable or high flash point solvent like kerosene/diesel & squeeze out the excess .
- Soak the air cleaner element in clean oil and squeeze out the excess oil.
- To install the air cleaner element , reverse the removal procedure.

CAUTION: Never use petrol or low flash point solvents for cleaning the air cleaner element. A fire or explosion can result.

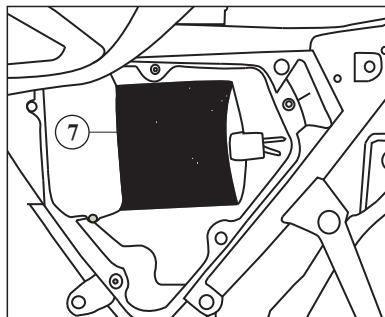
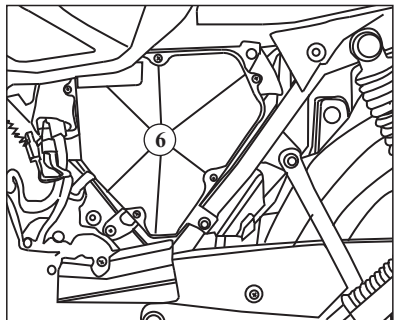

CARBURETTOR

Idle speed

Idle speed - 1400 RPM 0 ± 100

- Engine must be warm before setting idle speed. To warm up the engine 10 minutes of stop and go riding is sufficient.
- After warming up, put the motorcycle on main stand.
- Adjust the idle speed by throttle screw(1). To increase idle speed, turn the screw clock wise and to decrease the idle speed, turn the screw anti clockwise.

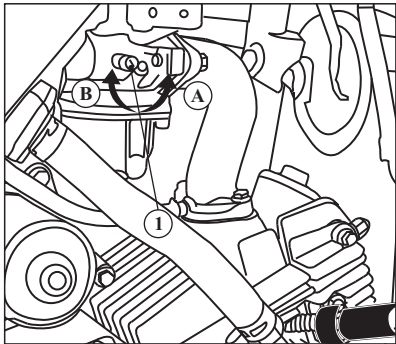

A) To decrease idle speed

B) To increase idle speed

CAUTION: Idle speed may not be stable inspite of frequent idle setting, due to faults in intake systems other than carburettor. Visit your Authorised Mahindra Two Wheeler dealer for proper diagnosis and rectification.

CLUTCH

Clutch adjustment may be required if

- 1) Motorcycle stalls while shifting gear.
 - or
 - 2) Clutch slips (Acceleration to lag behind the engine speed)
- Adjust the free play (1) to 2 ~ 5 mm at clutch lever (2) as shown, by loosening the lock nut (3) and turning the adjusting nut to obtain the specified play.
 - Tighten the lock nut and confirm the play.
 - Start the engine, press in the clutch lever and shift the gear from neutral to first. Make sure that engine does not stall or the vehicle does not creep.
 - Release the clutch lever gradually and open the throttle. The motorcycle should start moving smoothly and accelerate in accordance with the engine speed.

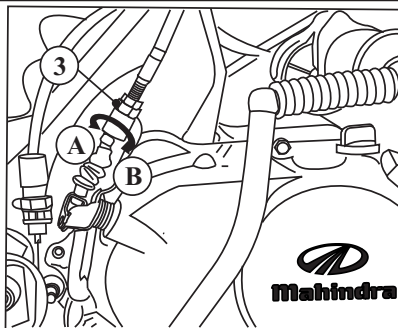
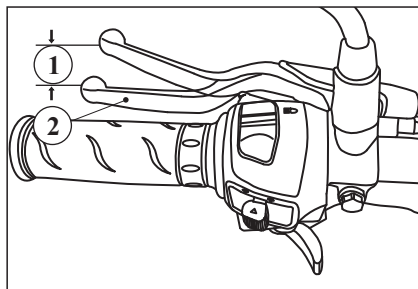

A) Decrease Free Play

B) Increase Free Play

CAUTION: Even after adjusting free play properly, clutch slips or there is difficulty in shifting gear, visit your Authorised Mahindra Two Wheeler dealer.

FRONT BRAKE ADJUSTMENT

Front brake free play(1) at front brake lever end should be 5 ~ 10 mm.

- Press the front brake lever in and measure the distance before the brake starts to take the load.
- For reducing free play, turn the adjusting nut (2) clockwise (A).
- For increasing free play, turn the adjusting nut anticlockwise (B).
- Apply brake and check for free wheel rotation when brake is released.

NOTE: If proper adjustment is not obtained by above method, visit Mahindra Two Wheelers Authorised dealer.

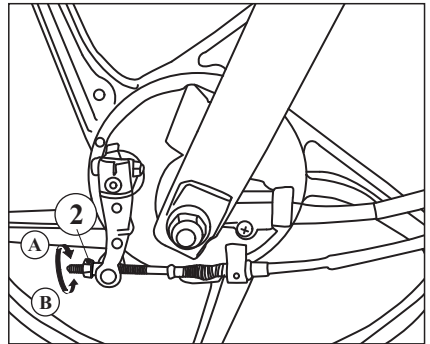
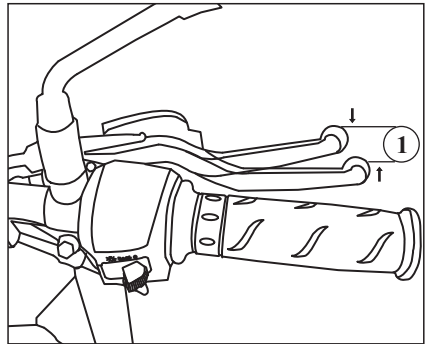

CAUTION: Ensure that cut out of adjusting nut is seated in brake arm pin properly after adjustment of free play.

REAR BRAKE ADJUSTMENT

Rear brake pedal free play(1) should be between 5 ~10 mm.

- Place the motorcycle on main stand and measure free play of rear brake pedal before brake starts to take the load.
- For reducing free play, turn the adjusting nut (2) clockwise (A).
- For increasing free play, turn the adjusting nut (2) anti clockwise (B).
- Apply brake and check for free wheel rotation when brake is released.

NOTE: If proper adjustment is not obtained by above method, visit Mahindra Two Wheelers Authorised dealer.

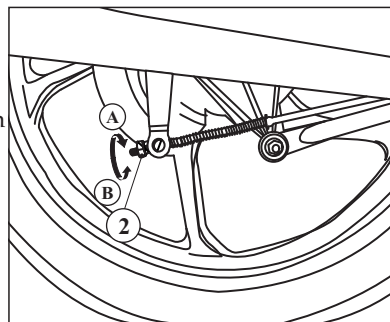
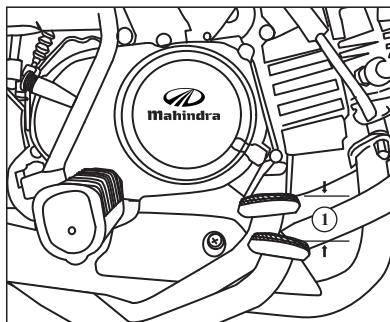

CAUTION: Ensure that cut out of adjusting nut is seated in brake arm pin properly after adjustment of free play.

DRIVE CHAIN

The service life of drive chain is dependant on proper lubrication and adjustment. Poor maintenance can cause premature wear or damage to the drive chain and sprocket. Drive chain should be checked and lubricated as a part of pre ride inspection. Refer maintenance schedule (Page No.33)

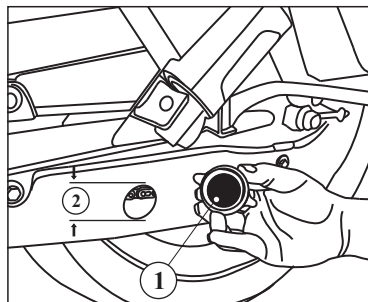

Inspection

- Shift the transmission in neutral. Turn the engine off, place the motorcycle on its main stand. Remove the rubber grommet (1) from drive chain cover .
- Check the drive chain slack (2) by hand, the vertical movement. It should be approximately 20 ~ 30 mm.
- Rotate the rear wheel and observe the slack at various positions. Chain may be found tight in particular section due to some links kinked or binding. Binding can frequently be eliminated by Lubrication.
- Replace excessively worn out or damaged sprockets and chain.

NOTE -

- Under severe usage or if vehicle is being used in unusually dusty areas , more frequent maintenance is required.
- Never use new drive chain with worn or damaged sprockets as this results in rapid chain wear.

Drive Chain Adjustment

- Loosen the rear axle nut (1) and the sleeve nut (2).
- To increase or decrease the chain slack , turn adjusting nut (3) on both right and left chain adjusters. Align chain adjuster index mark (4) with same scale gradation on both sides of swing arm.
- Tighten sleeve nut and rear axle nut .
Recheck chain slack.

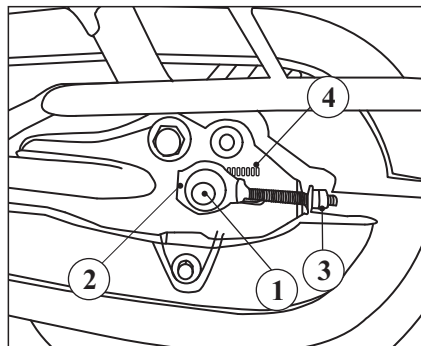

NOTE - ● Because of repositioning of rear wheel while adjusting chain slack, rear brake pedal free play gets affected. Check rear brake pedal free play and adjust it if necessary.

Lubrication

- Shift the gear to neutral. Turn off the engine. Place the motorcycle on it's main stand. Rotate rear wheel slowly and apply liberal amount of SAE 90 oil or chain lubricant .

NOTE - ● Proper lubrication and maintenance of drive chain as recommended in maintenance schedule would ensure high performance and longer service life.

- Ensure that chain lock plate open end is installed in the opposite direction of chain rotation.

FRONT WHEEL REMOVAL

- Lift the front wheel off the ground by placing a support block under the engine.
- Remove the speedometer cable (1) by unscrewing lock screw (2)
- Disconnect the front brake cable by removing brake adjuster nut (3) from the brake arm.
- Remove front brake anchor plate (4) from LH suspension.
- Remove the axle nut (5). Pull out the axle and remove the wheel

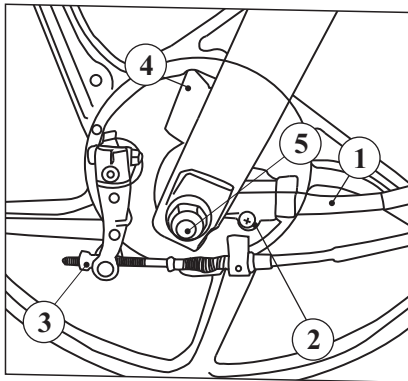

FRONT WHEEL FITMENT

- Reverse the removal procedure.
- Rotate the wheel and check speedometer operation.

Axle Nut Torque - 5.5 kgf-m

REAR WHEEL REMOVAL

- To raise the rear wheel off the ground place a support under engine .
- Remove the rear brake adjusting nut (1) and disconnect the brake rod (2) from the brake arm (3) by pushing down the brake pedal.
- By removing the lock nut. (6) disconnect the torque link (4) from brake plate (5).
- Remove the axle nut (7).Pull out the axle and remove the wheel

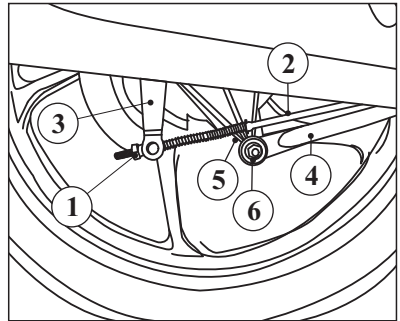

REAR WHEEL FITMENT

- Reverse the removal procedure.
- Adjust the rear brake.
- Apply brake several times and check free wheel rotation when brake is released .

Axle Nut Torque - 5.5 kgf-m

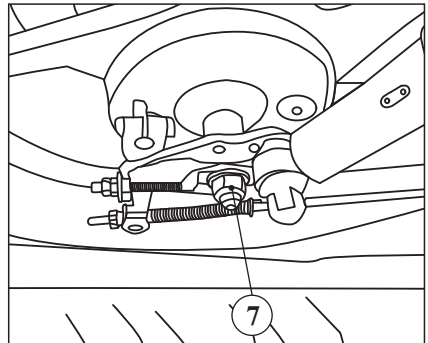

BRAKE WEAR INDICATORS

- On application of brake, an arrow (1) fixed to brake arm (2) moves towards the reference mark (3) on the brake plate.
- If the arrow on the brake arm aligns with the reference mark on the brake plate, on full application of brake , then the brake shoes must be replaced.

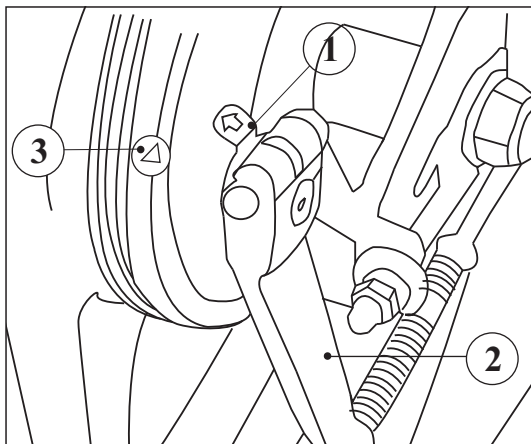

BASIC TROUBLE SHOOTING

CHECK / OBSERVATION	CAUSE	REMEDY
● Engine Fails To Start / Stops Suddenly		
A) Fuel system		
Check the fuel in fuel tank.	Empty	Refill
↓ Available		
Check whether petrol reaching to carburettor	Not reaching	<ul style="list-style-type: none"> → Check fuel cock position → Turn "ON / RES" if "OFF" → Clogged fuel filter → Replace → Defective fuel cock → Contact Authorised MTWL service center.
↓ Reaching carburettor		
Try spark test		
B) No spark at spark plug		
Check Ignition switch	" OFF " Position	Turn switch "ON"
↓ Ignition "ON"		
Check spark at Spark plug	No/Weak Spark	<ul style="list-style-type: none"> → Covered with carbon/oil → Clean and take advice of MTWL service centre. → Damaged/Worn out plug → Replace → Loose wiring connection → Secure firmly.
↓ Good spark		
Consult authorised MTWL Dealer / service center		

(MTWL - Mahindra Two Wheelers Ltd.)

CHECK / OBSERVATION

CAUSE

REMEDY

• Poor Pick-up

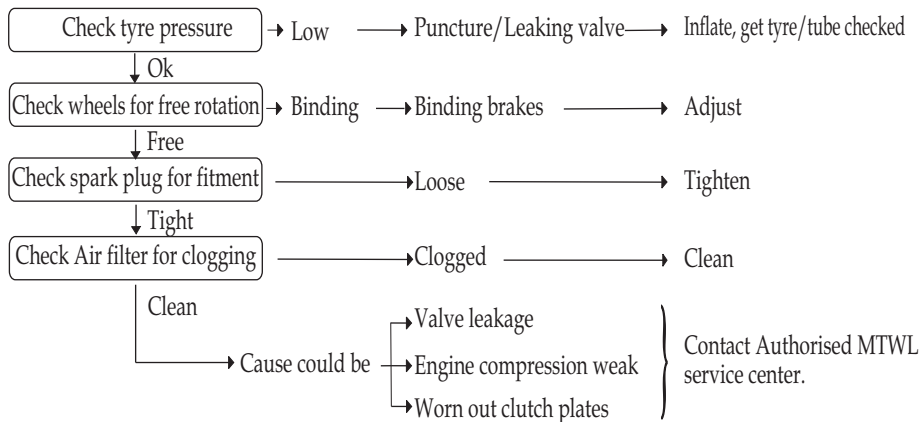

• Poor Braking

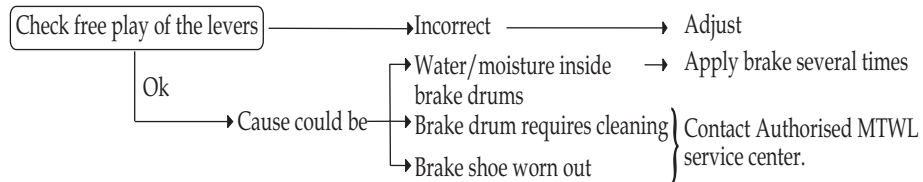

CHECK / OBSERVATION

CAUSE

REMEDY

• Excessive Petrol Consumption

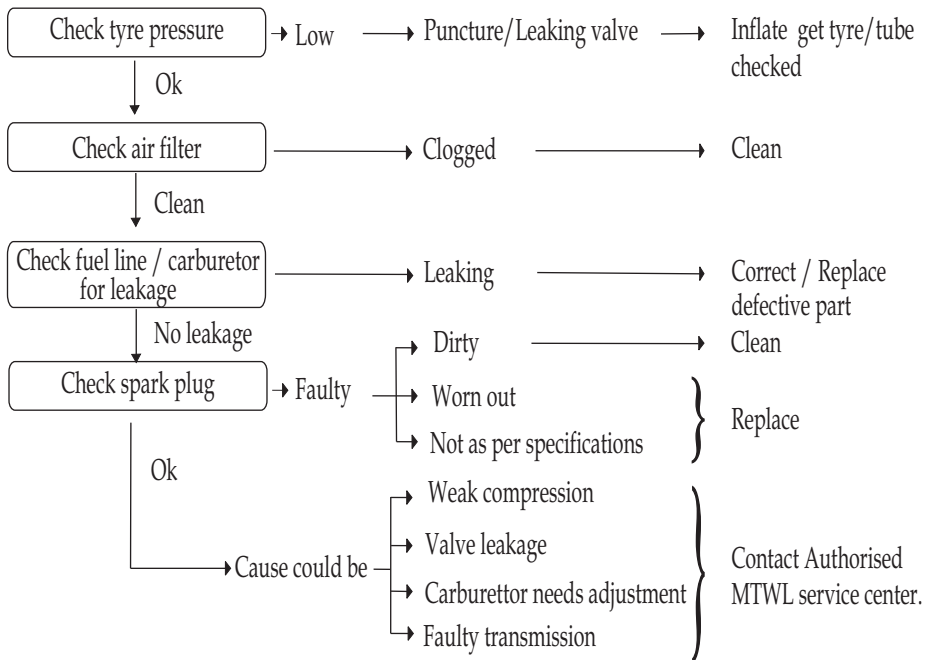

CHECK / OBSERVATION	CAUSE	REMEDY
• Electrical Faults Headlight does not glow	Fused bulb	Replace
	Loose wiring connections	Check visually if unable to locate
	Faulty switch	} → Contact Authorised MTWL service center.
	Faulty generator	
Horn does not sound	Fuse blown	Replace & get electrical circuit checked by Authorised MTWL service center.
	Faulty switch	} → Contact Authorised MTWL service center.
	Faulty horn	
	Battery discharged	
	Loose connections	
Brake light does not glow	Fused bulb	Replace
	Faulty/wrongly adjusted stoplight switch	} → Contact Authorised MTWL service center.
	Loose connections	
Instrument panel / Tail light does not glow	Faulty switch / Loose connections	→ Contact Authorised MTWL service center.
	Bulb fused	→ Replace

CHECK / OBSERVATION

CAUSE

REMEDY

Self starter not working	<ul style="list-style-type: none">→ Faulty self starter switch→ Faulty stop light switch→ Faulty starter relay→ Faulty starter motor→ Loose connections→ Battery discharged→ Fuse blown	<ul style="list-style-type: none">→ Contact Authorised MTWL service center.→ Replace & get electrical system checked by Authorised MTWL service center.
Battery discharged	<ul style="list-style-type: none">→ Excessive use of self starter / horn / lights→ Faulty charging circuit→ Battery life is over	<ul style="list-style-type: none">→ Avoid excessive usage→ Contact Authorised MTWL service center.
Turn signals not working	<ul style="list-style-type: none">→ One or more bulbs fused→ Loose connections→ Faulty switch→ Faulty relay	<ul style="list-style-type: none">→ Replace→ Contact Authorised MTWL service center.

WARRANTY

Scope:

This warranty is given only to the Centuro motorcycles manufactured by Mahindra Two Wheeler Ltd. and sold by their Authorised dealers, after pre-delivery inspection , to be free from any defect in manufacturing or fitment of part / parts.

Terms And Conditions:

- 1) Mahindra Two Wheelers Ltd. undertakes either to repair or replace (whichever is necessary) only such parts (not the entire assembly), if it is revealed upon their inspection , that they have failed due to manufacturing defect/s through their Authorised outlets “ Free of charge “ during a period of 2 years or running of 30,000 km, whichever is earlier from the date of sale.
- 2) Customer must produce the motorcycle along with this manual to any of the Authorised service outlet, enabling them to verify and furnish proper details.
- 3) Mahindra Two Wheelers Ltd reserves the right to make any modification or improvement in design or to add any improvement on vehicle at any time , without prior notice and without obligation to install the same on vehicle previously supplied or sold. Replacement of the vehicle is not warranted. Also, condition of this warranty is subjected to alteration without any notice.
- 4) Battery Warranty - Applicable as per the warranty terms of Battery Manufacturer which is mentioned in the Battery Warranty Card. Customer can directly claim battery warranty from local battery dealer by presenting battery warranty card.

The warranty becomes void in the following cases:

1. Free services are not availed as per specified schedule.
2. Subsequent paid services are not followed as per the recommended schedule.

The warranty is not applicable to -

1. Normal maintenance operations like brake and clutch adjustments , cleaning of fuel systems , engine tune-up or such other adjustments.
2. Vehicle failure due to misuse , improper lubrication , over loading , lack of maintenance and accidents.
3. Parts subjected to normal wear and tear like brake shoes, spark plug, Clutch plates, drive chain and sprocket .
4. Replacement of electrical items like bulbs and rubber components , 'o' ring, bellows filters , gasket etc.
5. In case of front and rear shock absorbers , subjective feeling of hard/ soft operation of shock absorbers is not covered under warranty.
6. Painted parts : Only blistering, chipping, flaking of the color covered under warranty. However, the final authority for decision will be the company.
7. Chrome plated parts as they are likely to catch rust in coastal areas or acidic environment or due to neglect. Only peel off of the chrome film will be accepted under warranty.
8. Oxidation of crankcase and cylinder head , surface rusting of cylinder block etc.
9. Vehicles repairs by "unauthorised workshop"

10. Use of non genuine spare parts , engine oil and fitment of accessories not recommended by company.
11. Vehicle used for any competition or race etc.
12. Damages occurred in riots , strikes and natural calamities.
13. The proprietary items like tyres , tubes , battery , spark plug since they are directly handled by respective manufacturers and are subjected to their warranty terms and conditions . In all such cases , the decision of the respective manufacturer will be the final and binding on all concerned.
14. This warranty is given by Mahindra Two Wheelers Ltd. for Centuro and no other person, including the dealer or its his agent or employee is authorised to extend or enlarge scope.
15. Decision regarding warranty settlement shall be taken by Mahindra Two Wheelers Ltd. and shall be final and binding on all concerned , subject to Pune jurisdiction only.

Mahindra

MAHINDRA TWO WHEELERS LIMITED

COUPON NO. : CC

MODEL : **CENTURO**

WARRANTY REGISTRATION CARD

CUSTOMER'S NAME : _____

ADDRESS : _____

_____ PIN : _____

PHONE NO. : _____ MOBILE NO. : _____

E-mail : _____

FRAME NO. : _____ ENGINE NO. : _____

BATTERY MAKE : _____ BATTERY SR. NO. : _____

DATE OF SALE : _____ REGN. NO. : _____

DEALER CODE : _____ DEALER NAME & CITY : _____

(CUSTOMER'S SIGNATURE)

(DEALER'S STAMP AND SIGNATURE)

1) MAIL TO : WARRANTY MANAGEMENT CELL, MAHINDRA TWO WHEELERS LIMITED, PLOT NO. 2, INDUSTRIAL AREA NO. 1,
PITHAMPUR, DIST. DHAR - 454775 (M.P.)

PRE-DELIVERY INSPECTION CHECK LIST (TO BE PERFORMED BY DEALER)

- | | |
|---|--|
| <input type="checkbox"/> CHECK ENGINE OIL LEVEL | <input type="checkbox"/> BOTH WHEELS FREE ROTATION |
| <input type="checkbox"/> FUEL SYSTEM - CHECK SYSTEM FOR LEAKAGE. | <input type="checkbox"/> MOVEMENT OF STEERING OPERATION IN ALL POSITIONS. |
| <input type="checkbox"/> CHECK CLUTCH OPERATION AND FREE PLAY. | <input type="checkbox"/> THROTTLE OPERATION : CHECK FOR FREE PLAY AND SMOOTH RETURN. |
| <input type="checkbox"/> INSTALL FULLY CHARGED BATTERY. | <input type="checkbox"/> START THE ENGINE IF REQUIRED, ADJUST IDLE RPM (1400 RPM \pm 100) AFTER INITIAL WARMUP |
| <input type="checkbox"/> CHECK ALL ELECTRICALS FOR ITS PROPER FUNCTIONING. | <input type="checkbox"/> TEST RIDE FOR DRIVEABILITY. |
| <input type="checkbox"/> HEADLIGHT FOCUSING, ADJUST IF NECESSARY. | <input type="checkbox"/> CHECK SMOOTH GEAR OPERATION. |
| <input type="checkbox"/> BOTH WHEEL NUTS AND BOLTS FOR TIGHTNESS | <input type="checkbox"/> NO ABNORMAL NOISE WHILE TEST RIDE. |
| <input type="checkbox"/> FRONT / REAR CUSHION MOUNTING BOLTS FOR TIGHTNESS. | <input type="checkbox"/> SPEEDOMETER AND ODOMETER FUNCTION. |
| <input type="checkbox"/> ENGINE FOUNDATION FOR TIGHTNESS. | <input type="checkbox"/> SCRATCHES AND DAMAGES. |
| <input type="checkbox"/> BOTH BRAKES FOR SMOOTH OPERATION AND RETURN. | |
-

INFORMATION TO CUSTOMER (TO BE EXPLAINED BY DEALER)

- | | |
|---|--|
| <input type="checkbox"/> WARRANTY POLICY / FREE SERVICE POLICY. | <input type="checkbox"/> SAFER RIDING ADVICE |
| <input type="checkbox"/> IMPORTANCE OF PERIODICAL MAINTENANCE/SCHEDULE. | <input type="checkbox"/> BATTERY MAINTENANCE |
| <input type="checkbox"/> OIL FILLING PROCEDURE & OIL LEVEL. | <input type="checkbox"/> TYRE PRESSURE |
| <input type="checkbox"/> STARTING PROCEDURE (SELF & KICK) | <input type="checkbox"/> EXPLAIN CHOKE OPERATION |
| <input type="checkbox"/> OPERATION OF ALL SWITCHES/GAUGES. | <input type="checkbox"/> VEHICLE PARKING & LOCKING |
| <input type="checkbox"/> THROTTLE OPERATION (EMPHASIS ON GRADUAL OPENING) | <input type="checkbox"/> RUNNING-IN PERIOD AND PRECAUTIONS |

COLD START - USE CHOKE AND SELF START & AVOID SUDDEN THROTTLE OPENING.

CUSTOMER'S SIGNATURE

DEALER'S STAMP & SIGNATURE

Mahindra

MAHINDRA TWO WHEELERS LIMITED

COUPON NO. : CC

MODEL : **CENTURO**

WARRANTY REGISTRATION CARD

CUSTOMER'S NAME : _____

ADDRESS : _____

_____ PIN : _____

PHONE NO. : _____ MOBILE NO. : _____

E-mail : _____

FRAME NO. : _____ ENGINE NO. : _____

BATTERY MAKE : _____ BATTERY SR. NO. : _____

DATE OF SALE : _____ REGN. NO. : _____

DEALER CODE : _____ DEALER NAME & CITY : _____

(CUSTOMER'S SIGNATURE)

(DEALER'S STAMP AND SIGNATURE)

2) DEALER COPY :

Mahindra

MAHINDRA TWO WHEELERS LIMITED

COUPON NO. : CC

MODEL : **CENTURO**

WARRANTY REGISTRATION CARD

CUSTOMER'S NAME : _____

ADDRESS : _____

_____ PIN : _____

PHONE NO. : _____ MOBILE NO. : _____

E-mail : _____

FRAME NO. : _____ ENGINE NO. : _____

BATTERY MAKE : _____ BATTERY SR. NO. : _____

DATE OF SALE : _____ REGN. NO. : _____

DEALER CODE : _____ DEALER NAME & CITY : _____

(CUSTOMER'S SIGNATURE)

(DEALER'S STAMP AND SIGNATURE)

3) CUSTOMER COPY :

SERVICE RECORD SHEET

To be Filled by Supervisor

Free Service	km range	Date	km Reading	Job Card No.	Servicing Dealer (Sign. & Stamp)
I	500 - 750				
II	2500 - 3000				
III	4500 - 5000				
IV	6500 - 7000				
V	8500 - 9000				
VI	10500 - 11000				
PAID	12500 - 13000				
PAID	14500 - 15000				
PAID	16500 - 17000				
PAID	18500 - 19000				
PAID	20500 - 21000				

SERVICE RECORD SHEET

To be Filled by Supervisor

Paid Service	km range	Date	km Reading	Job Card No.	Servicing Dealer (Sign. & Stamp)
PAID	22500 - 23000				
PAID	24500 - 25000				
PAID	26500 - 27000				
PAID	28500 - 29000				
PAID	30500 - 31000				

REMARKS (IF ANY) :-

Note : It is mandatory to avail all free and paid services as per the recommended schedule to be eligible for the warranty benefits. Please ensure that each paid service is availed within 90 days from the date of previous service or as per the recommended schedule, whichever is earlier.

DELIVERY CERTIFICATE :

Frame No. :

Engine No.:

- Above vehicle was inspected / test driven by me / my representative at the time of delivery and found to be acceptable and free from any operational/visual defects
- A copy of owners manual containing 6 free service coupons, warranty certificate and a tool kit was given to me along with the vehicle.
- I understand that my warranty claims if any, will be considered by the manufacturer in accordance with the specified scope and limit of the warranty.

Place:

Date:

Customer Signature

Date of sale :

Dealer Name & Address :

Customer name :

Address :

(To be retained by selling dealer)

1st

1st SERVICE - FREE

500-750 km

FREE SERVICE COUPON



500-750 km OR 365 DAYS FROM DATE OF PURCHASE WHICHEVER IS EARLIER

This coupon entitles the holder to the service schedule overleaf. Free of Charge.

DATE OF DELIVERY

Cost of oil and petrol extra

COUPON NO. : CP

CUSTOMER'S NAME

DATE OF SERVICE

ENGINE NO.

km

FRAME NO.

DATE OF SALE

MAHINRA REGN. NO.

DATE OF SERVICE

km

REGN. NO.

SELLING DEALER CODE

SERVICING DEALER CODE

A.S.C.'s Stamp & Sign.

Certified that the work narrated overleaf is carried out to my entire satisfaction.

Customer's Signature

Service Centre's Stamp & Signature

1st SERVICE - FREE

1. Wash the vehicle and blow dry it with compressed air.
2. Clean fuel strainer and check fuel lines for leakages and free fuel flow.
3. Clean oil filter screen and rotor oil filter.
4. Replace engine oil.
5. Clean air filter element.
6. Clean and adjust spark plug.
7. Drain the carburettor bowl and adjust if required.
8. Adjust idling speed.
9. Inspect throttle operation and free play.
10. Inspect clutch for free play and adjust if necessary.
11. Inspect fasteners and tighten them to the specified torque.
12. Inspect front & rear suspension.
13. Inspect spokes and adjust if necessary.
14. Inspect valve clearance, adjust if necessary.
15. Inspect, clean and lubricate drive chain, adjust if necessary.
16. Lubricate main stand and side stand.
17. Check battery electrolyte and top up if necessary with distilled water.
18. Check headlight focus and adjust if necessary.
19. Check brake light switch function, adjust if necessary.
20. Inspect brake shoe wear, adjust if necessary.
21. Inspect steering for smooth operation.
22. Check tyre pressure, inflate if necessary.
23. Clean the vehicle and deliver.

2nd

2nd SERVICE - FREE

2500-3000 km

FREE SERVICE COUPON



2500-3000 km OR 365 DAYS FROM DATE OF PURCHASE WHICHEVER IS EARLIER

This coupon entitles the holder to the service schedule overleaf. Free of Charge.

DATE OF DELIVERY

Cost of oil and petrol extra

COUPON NO. : CP

DATE OF SERVICE

CUSTOMER'S NAME

ENGINE NO.

km

FRAME NO.

DATE OF SALE

MAHINRA REGN. NO.

DATE OF SERVICE

km

REGN. NO.

SELLING DEALER CODE

SERVICING DEALER CODE

A.S.C.'s Stamp & Sign.

Certified that the work narrated overleaf is carried out to my entire satisfaction.

Customer's Signature

Service Centre's Stamp & Signature

2nd SERVICE - FREE

1. Wash the vehicle and blow dry it with compressed air.
2. Clean fuel strainer and check fuel lines for leakages and free fuel flow.
3. Inspect and top-up engine oil.
4. Clean air filter element.
5. Clean and adjust spark plug.
6. Drain the carburettor bowl and adjust if required.
7. Adjust idling speed.
8. Inspect throttle operation and free play.
9. Inspect clutch for free play and adjust if necessary.
10. Inspect fasteners and tighten them to the specified torque.
11. Inspect front & rear suspension.
12. Clean brake drums and lubricate brake system (brake cam and pedal).
13. Inspect spoke and adjust if necessary.
14. Inspect valve clearance, adjust if necessary.
15. Inspect, clean and lubricate drive chain, adjust if necessary.
16. Lubricate main stand and side stand.
17. Check battery electrolyte and top up if necessary with distilled water.
18. Check headlight focus and adjust if necessary.
19. Check brake light switch function, adjust if necessary.
20. Inspect brake shoe wear, adjust if necessary.
21. Inspect steering head bearing and adjust if necessary.
22. Check tyre pressure, inflate if necessary.
23. Clean the vehicle and deliver.

3rd

3rd SERVICE - FREE

4500-5000 KMS

FREE SERVICE COUPON



4500-5000 km OR 365 DAYS FROM DATE OF PURCHASE WHICHEVER IS EARLIER

This coupon entitles the holder to the service schedule overleaf. Free of Charge.

DATE OF DELIVERY

Cost of oil and petrol extra

COUPON NO. : CP

DATE OF SERVICE

CUSTOMER'S NAME

ENGINE NO.

km

FRAME NO.

REGN. NO.

DATE OF SALE

MAHIN REGN. NO.

A.S.C.'s Stamp & Sign.

DATE OF SERVICE

km

SELLING DEALER CODE

SERVICING DEALER CODE

[Signature Box]

[Stamp & Signature Box]

Certified that the work narrated overleaf is carried out to my entire satisfaction.

Customer's Signature

Service Centre's Stamp & Signature

3rd SERVICE - FREE

1. Wash the vehicle and blow dry it with compressed air.
2. Clean fuel strainer and check fuel lines for leakages and free fuel flow.
3. Clean oil filter screen and rotor oil filter.
4. Replace engine oil.
5. Clean air filter element.
6. Clean and adjust spark plug.
7. Drain the carburettor bowl and adjust if required.
8. Adjust idling speed.
9. Inspect throttle operation and free play.
10. Inspect clutch for free play and adjust if necessary.
11. Inspect fasteners and tighten them to the specified torque.
12. Inspect front & rear suspension.
13. Inspect spoke and adjust if necessary.
14. Inspect valve clearance, adjust if necessary.
15. Inspect, clean and lubricate drive chain, adjust if necessary.
16. Lubricate main stand and side stand.
17. Check battery electrolyte and top up if necessary with distilled water.
18. Check headlight focus and adjust if necessary.
19. Check brake light switch function, adjust if necessary.
20. Inspect brake shoe wear, adjust if necessary.
21. Inspect steering for smooth operation.
22. Check tyre pressure, inflate if necessary.
23. Clean the vehicle and deliver.

4th

4th SERVICE - FREE

6500-7000 km

FREE SERVICE COUPON



6500-7000 km OR 365 DAYS FROM DATE OF PURCHASE WHICHEVER IS EARLIER

This coupon entitles the holder to the service schedule overleaf. Free of Charge.

DATE OF DELIVERY

Cost of oil and petrol extra

COUPON NO. : CP

DATE OF SERVICE

CUSTOMER'S NAME

ENGINE NO.

km

FRAME NO.

DATE OF SALE

MAHINRA REGN. NO.

REGN. NO.

DATE OF SERVICE

km

SELLING DEALER CODE

SERVICING DEALER CODE

A.S.C.'s Stamp & Sign.

Certified that the work narrated overleaf is carried out to my entire satisfaction.

Customer's Signature

Service Centre's Stamp & Signature

4th SERVICE - FREE

1. Wash the vehicle and blow dry it with compressed air.
2. Clean fuel strainer and check fuel lines for leakages and free fuel flow.
3. Inspect and top-up engine oil.
4. Clean air filter element.
5. Clean and adjust spark plug.
6. Drain the carburettor bowl and adjust if required.
7. Adjust idling speed.
8. Inspect throttle operation and free play.
9. Inspect clutch for free play and adjust if necessary.
10. Inspect fasteners and tighten them to the specified torque.
11. Inspect front & rear suspension.
12. Clean brake drums and lubricate brake system (brake cam and pedal).
13. Inspect spoke and adjust if necessary.
14. Inspect valve clearance, adjust if necessary.
15. Inspect, clean and lubricate drive chain, adjust if necessary.
16. Lubricate main stand and side stand.
17. Check battery electrolyte and top up if necessary with distilled water.
18. Check headlight focus and adjust if necessary.
19. Check brake light switch function, adjust if necessary.
20. Inspect brake shoe wear, adjust if necessary.
21. Inspect steering head bearing and adjust if necessary.
22. Check tyre pressure, inflate if necessary.
23. Clean the vehicle and deliver.

5th

5th SERVICE - FREE

8500-9000 km

FREE SERVICE COUPON



8500-9000 km OR 540 DAYS FROM DATE OF PURCHASE WHICHEVER IS EARLIER

This coupon entitles the holder to the service schedule overleaf. Free of Charge.

DATE OF DELIVERY

Cost of oil and petrol extra

COUPON NO. : CP

CUSTOMER'S NAME

DATE OF SERVICE

ENGINE NO.

km

FRAME NO.

DATE OF SALE

MAHINRA REGN. NO.

REGN. NO.

DATE OF SERVICE

km

SELLING DEALER CODE

SERVICING DEALER CODE

A.S.C.'s Stamp & Sign.

Certified that the work narrated overleaf is carried out to my entire satisfaction.

Customer's Signature

Service Centre's Stamp & Signature

5th SERVICE - FREE

1. Wash the vehicle and blow dry it with compressed air.
2. Clean fuel strainer and check fuel lines for leakages and free fuel flow.
3. Clean oil filter screen and rotor oil filter.
4. Replace engine oil.
5. Clean air filter element.
6. Clean and adjust spark plug.
7. Drain the carburettor bowl and adjust if required.
8. Adjust idling speed.
9. Inspect throttle operation and free play.
10. Inspect clutch for free play and adjust if necessary.
11. Inspect fasteners and tighten them to the specified torque.
12. Inspect front & rear suspension.
13. Inspect spoke and adjust if necessary.
14. Inspect valve clearance, adjust if necessary.
15. Inspect, clean and lubricate drive chain, adjust if necessary.
16. Lubricate main stand and side stand.
17. Check battery electrolyte and top up if necessary with distilled water.
18. Check headlight focus and adjust if necessary.
19. Check brake light switch function, adjust if necessary.
20. Inspect brake shoe wear, adjust if necessary.
21. Inspect steering for smooth operation.
22. Check tyre pressure, inflate if necessary.
23. Clean the vehicle and deliver.

6th

6th SERVICE - FREE

10500-11000 km

FREE SERVICE COUPON



10500-11000 km OR 540 DAYS FROM DATE OF PURCHASE WHICHEVER IS EARLIER

This coupon entitles the holder to the service schedule overleaf. Free of Charge.

DATE OF DELIVERY

Cost of oil and petrol extra

COUPON NO. : CP

DATE OF SERVICE

CUSTOMER'S NAME

ENGINE NO.

km

FRAME NO.

DATE OF SALE

MAHIN REGN. NO.

REGN. NO.

DATE OF SERVICE

km

SELLING DEALER CODE

SERVICING DEALER CODE

A.S.C.'s Stamp & Sign.

Customer's Signature

Service Centre's Stamp & Signature

Certified that the work narrated overleaf is carried out to my entire satisfaction.

6th SERVICE - FREE

1. Wash the vehicle and blow dry it with compressed air.
2. Clean fuel strainer and check fuel lines for leakages and free fuel flow.
3. Inspect and top-up engine oil.
4. Replace air filter element.
5. Replace spark plug.
6. Drain the carburettor bowl and adjust if required.
7. Adjust idling speed.
8. Inspect throttle operation and free play.
9. Inspect clutch for free play and adjust if necessary.
10. Inspect fasteners and tighten them to the specified torque.
11. Inspect front & rear suspension.
12. Clean brake drums and lubricate brake system (brake cam and pedal).
13. Inspect spoke and adjust if necessary.
14. Inspect valve clearance, adjust if necessary.
15. Inspect, clean and lubricate drive chain, adjust if necessary.
16. Lubricate main stand and side stand.
17. Check battery electrolyte and top up if necessary with distilled water.
18. Check headlight focus and adjust if necessary.
19. Check brake light switch function, adjust if necessary.
20. Inspect brake shoe wear, adjust if necessary.
21. Inspect steering head bearing and adjust if necessary.
22. Check tyre pressure, inflate if necessary.
23. Clean the vehicle and deliver.

Mahindra

MAHINDRA TWO WHEELERS LIMITED

Pune Office : D-1 Block, Plot No. 18/2 (Part), M.I.D.C.,
Chinchwad, Pune - 411 019. (India)
Phone : (020) 6733 6733
Fax : (020) 6733 6700

Works :

Plot No. 2, Industrial Area No. 1,
Mhow-Neemuch Road, Pithampur,
Dist. Dhar - 454 775 (M.P.)
Tel.: (07292) 427208 / 09 Fax : (07292) 253087

FORM - 22

**INITIAL CERTIFICATE OF COMPLIANCE WITH POLLUTION STANDARDS,
SAFETY STANDARDS OF COMPONENTS AND ROAD WORTHINESS**

[Rules 47 (g), 115, 124(2), 126A and 127(1), 127(2)]

Certified that the following vehicle complies with the provisions of the Motor Vehicle Act 1988 and the rule made thereunder, including the following mass emission norms :

Brand Name of the Vehicle : **CENTURO**

Chassis No.:

Engine No.:

Sub-rule, No. of rule 115 : (1) (2) (i) (12) (13) & (14) (F), (G)

Emission Norms : Bharat Stage - III

For **MAHINDRA TWO WHEELERS LIMITED**

Date



Quality Assurance Division

Mahindra

MAHINDRA TWO WHEELERS LIMITED

Pune Office : D-1 Block, Plot No. 18/2 (Part), M.I.D.C.,
Chinchwad, Pune - 411 019. (India)
Phone : (020) 6733 6733
Fax : (020) 6733 6700

Works :

Plot No. 2, Industrial Area No. 1,
Mhow-Neemuch Road, Pithampur,
Dist. Dhar - 454 775 (M.P.)
Tel.: (07292) 427208 / 09 Fax : (07292) 253087

FORM - 22

**INITIAL CERTIFICATE OF COMPLIANCE WITH POLLUTION STANDARDS,
SAFETY STANDARDS OF COMPONENTS AND ROAD WORTHINESS**

[Rules 47 (g), 115, 124(2), 126A and 127(1), 127(2)]

Certified that the following vehicle complies with the provisions of the Motor Vehicle Act 1988 and the rule made thereunder, including the following mass emission norms :

Brand Name of the Vehicle : **CENTURO**

Chassis No.:

Engine No.:

Sub-rule, No. of rule 115 : (1) (2) (i) (12) (13) & (14) (F), (G)

Emission Norms : Bharat Stage - III

For **MAHINDRA TWO WHEELERS LIMITED**

Date



Quality Assurance Division

