

Chatham Collection

Convertible Crib

Model No. 5417-0521



THANK YOU – You’ve purchased a fine furniture item from Bassett. We have designed our furniture with you, the Bassett guest in mind. Our clear, easy to follow, step by step instructions will guide you through the project from start to finish. Feel confident that this will be a fun and rewarding project. The final product will be a quality piece of furniture that will go together smoothly and give years of enjoyment.

Bed rails and toddler bed rail kit sold separately.

All Bassett cribs are designed to meet the highest safety standards and comply with all U.S. regulations.

Assembly Instructions For Crib

Bassett Juvenile Product Division
Bassett, Virginia 24055
Made in China

Model No: 5417-0521

Distributed in the U.S.A. by:
Bassett Furniture Industries, Inc.
Juvenile Division
P.O. Box 626
3525 Fairystone Park Highway
Bassett, Virginia 24055, USA
E-mail: juvenile@bassettfurniture.com



▲ WARNING: Read all instructions before assembling this product. **KEEP INSTRUCTIONS FOR FUTURE USE.**

CUSTOMER SERVICE

If you are missing parts or have any questions about this product, contact us first. You can also order parts by writing to the address above. Include the product model number, color, and a brief description of the part.
Call 1-800-308-7485

CARE AND CLEANING

DO NOT scratch or chip the finish. **DO NOT** use abrasive chemicals for cleaning. Clean with mild soap on a soft rag. Rinse and dry thoroughly. If the crib is to be stored, store in a cool dry place and carefully package all original hardware to protect from loss.

TOOLS AND INSTALLATION

Tools Necessary: Allen Key (included).
Flathead Screwdriver (not included).

Note: To assemble product we recommend using two adults.

NOTE: When inserting bolts, turn clockwise until tight. Then loosen 1/2-3/4 of a turn. After crib is completely assembled, return to each bolt and tighten. Use wax or soap on all bolts to facilitate assembly.

IMPORTANT SAFETY INFORMATION FOR CRIBS

▲ WARNING: Infants can suffocate on soft bedding.
Never add a pillow or comforter. Never place additional padding under an infant.

▲ WARNING: Failure to follow these warnings and the assembly instructions could result in serious injury or death.

▪To reduce the risk of **SIDS**, pediatricians recommend healthy infants be placed on their backs to sleep, unless otherwise advised by your physician.

Strangulation Hazard:

- Strings can cause strangulation! **DO NOT** place items with a string around a child's neck, such as hood strings or pacifier cords. **DO NOT** suspend strings over a crib or attach strings to toys.
- To help prevent strangulation tighten all fasteners. A child can trap parts of the body or clothing on loose fasteners.
- DO NOT** place crib near window where cords from blinds or drapes may strangle a child.

Fall Hazard:

- When child is able to pull to a standing position, set mattress to lowest position and remove bumper pads, large toys and other objects that could serve as steps for climbing out.
- When child is able to climb out or reaches the height of 35 in. (90 cm), the crib shall no longer be used, and the child should be placed in a youth or regular bed.
- Check this product for damaged hardware, loose joints, missing parts or sharp edges before and after assembly and frequently during use. **DO NOT** use crib if any parts are missing, damaged or broken. Contact Bassett Furniture Industries, Inc. for replacement parts and instructional literature if needed. **DO NOT** substitute parts.
- DO NOT** use a water mattress with this crib.
- If refinishing, use a non-toxic finish specified for children's products.
- Follow warnings on all products in a crib.
- Never use plastic shipping bags or other plastic film as mattress covers because they can cause suffocation.
- Infants can suffocate in gaps between crib sides and a mattress that is too small.

IMPORTANT SAFETY INFORMATION FOR CRIBS

CAUTION: ANY MATTRESS USED IN THIS CRIB MUST BE AT LEAST 27-1/4 INCHES BY 51-5/8 INCHES WITH A THICKNESS NOT EXCEEDING 6 INCHES.

WARNING

- Do not use this crib if the enclosed or attached instructions cannot be strictly adhered to. Do not use this crib if the child is able to climb out unaided or is taller than 90 cm. Do not place cords, straps or similar items that could become wound around the child's neck in or near this crib. Ensure that the sides are properly latched or locked in place when the crib is occupied. The mattress used with this crib should not be more than 15 cm thick and should be of such length and width that the gap between the mattress and the sides of the crib is not more than 3 cm when the mattress is pushed into the corner of the crib.
- Parents should inspect the crib regularly -- before putting the child in the crib each day -- and confirm that every component of the crib is properly and securely in place.

**▲WARNING:
ENTRAPMENT/STRANGULATION
HAZARD**

Infants have died in toddler beds from entrapment and strangulation. Failure to follow these warnings and the assembly instructions could result in serious injury or death.

NEVER use bed with children under 15 months.

NEVER place bed near windows where cords from blinds or drapes may strangle a child.

- The mattress intended for use on the bed shall be a full-size crib mattress having minimum dimensions of 51-5/8 in. (1310 mm) in length, 27-1/4 in. (690 mm) in width and 4 in. (100 mm) in thickness, not exceeding 6 in. (152 mm) in thickness.
- If guardrails are used as the mattress containment means, guardrail(s) provided must be used to avoid the formation of a gap between the mattress and the bed that could cause an entrapment.
- DO NOT** place bed near windows where cords from blinds or drapes may strangle a child.
- DO NOT** place items with a string, cord, or ribbon around a child's neck, such as hood strings or pacifier cords.
- DO NOT** suspend strings over a toddler bed for any reason.
- A child using the toddler or day bed shall be at least 15 months of age and shall not weigh more than 50 lbs. (22.7 kgs.).

Hardware Identification

For ease of identification, hardware pieces should match each step in the Instruction Manual.

Hardware Step # 1

(AA) Allen Wrench (1 piece)

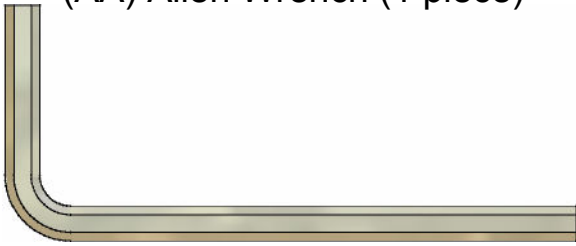

(BB) 1-3/4 inch bolts (x 4 pieces)



Hardware Step # 2

(AA) Allen Wrench (1 piece)



(CC) 2-1/2 inch bolts (x 2 pieces)



(DD) K.D. Barrel nut (x 2 pieces)



Hardware Step # 3

(AA) Allen Wrench (1 piece)

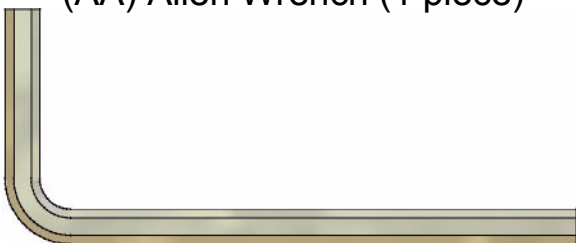

(BB) 1-3/4 inch bolts (x 4 pieces)



Hardware Identification

For ease of identification, hardware pieces should match each step in the Instruction Manual.

Hardware Step # 4

(AA) Allen Wrench (1 piece)

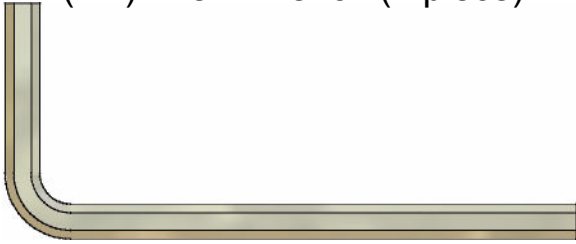

(EE) Filler bolts (x 16 pieces)

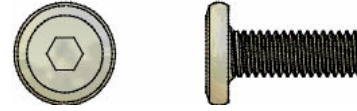

Hardware Step # 5

(AA) Allen Wrench (1 piece)

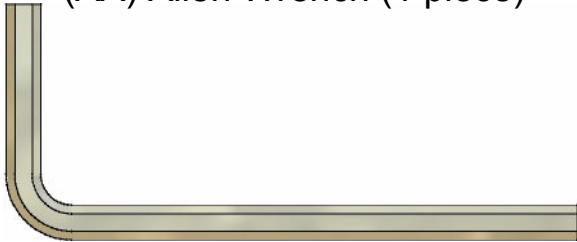

(BB) 1-3/4 inch bolts (x 4 pieces)



(EE) Filler bolts (x 16 pieces)



Hardware Identification

For ease of identification, hardware pieces should match each step in the Instruction Manual.

Hardware Step # 6

(AA) Allen Wrench (1 piece)

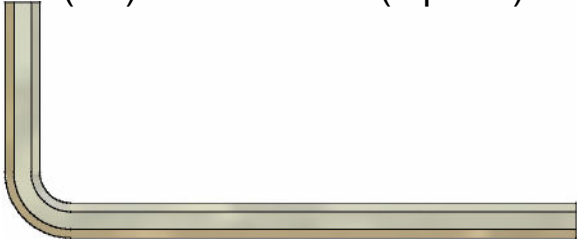

(BB) 1-3/4 inch bolts (x 8 pieces)

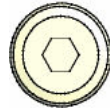

(EE) Filler bolts (x 12 pieces)



Hardware Step # 7

(AA) Allen Wrench (1 piece)



(EE) Filler bolts (x 4 pieces)



Item Identification

For ease of identification, all parts are labeled to correspond to the Step number in which the part is used.

Step #7 Full Size Bed
(Page 16 of 16)

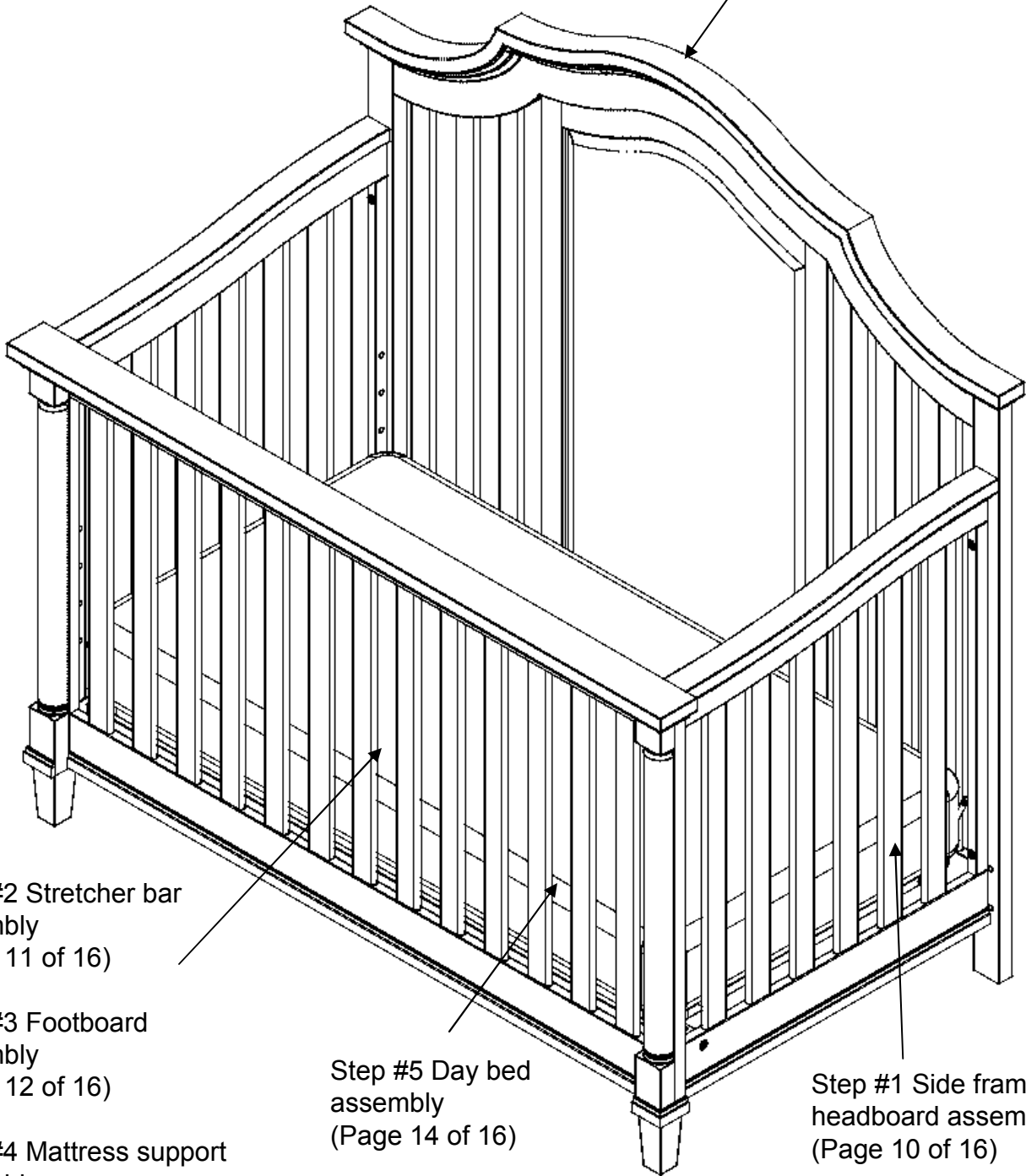

Step #2 Stretcher bar
assembly
(Page 11 of 16)

Step #3 Footboard
assembly
(Page 12 of 16)

Step #4 Mattress support
assembly
(Page 13 of 16)

Step #5 Day bed
assembly
(Page 14 of 16)

Step #6 Toddler bed
assembly
(Page 15 of 16)

Step #1 Side frame &
headboard assembly
(Page 10 of 16)

STEP #1

LEFT & RIGHT SIDE FRAME AND HEADBOARD ASSEMBLY

Hardware needed for Step #1:

(AA) Allen Wrench (1 piece)

(BB) 1-3/4 in. Bolts (x 4 pieces)

Left Side Frame (x 1)

Right Side Frame (x 1)

Headboard (x 1)

•NOTE: Do not fully tighten at this time.

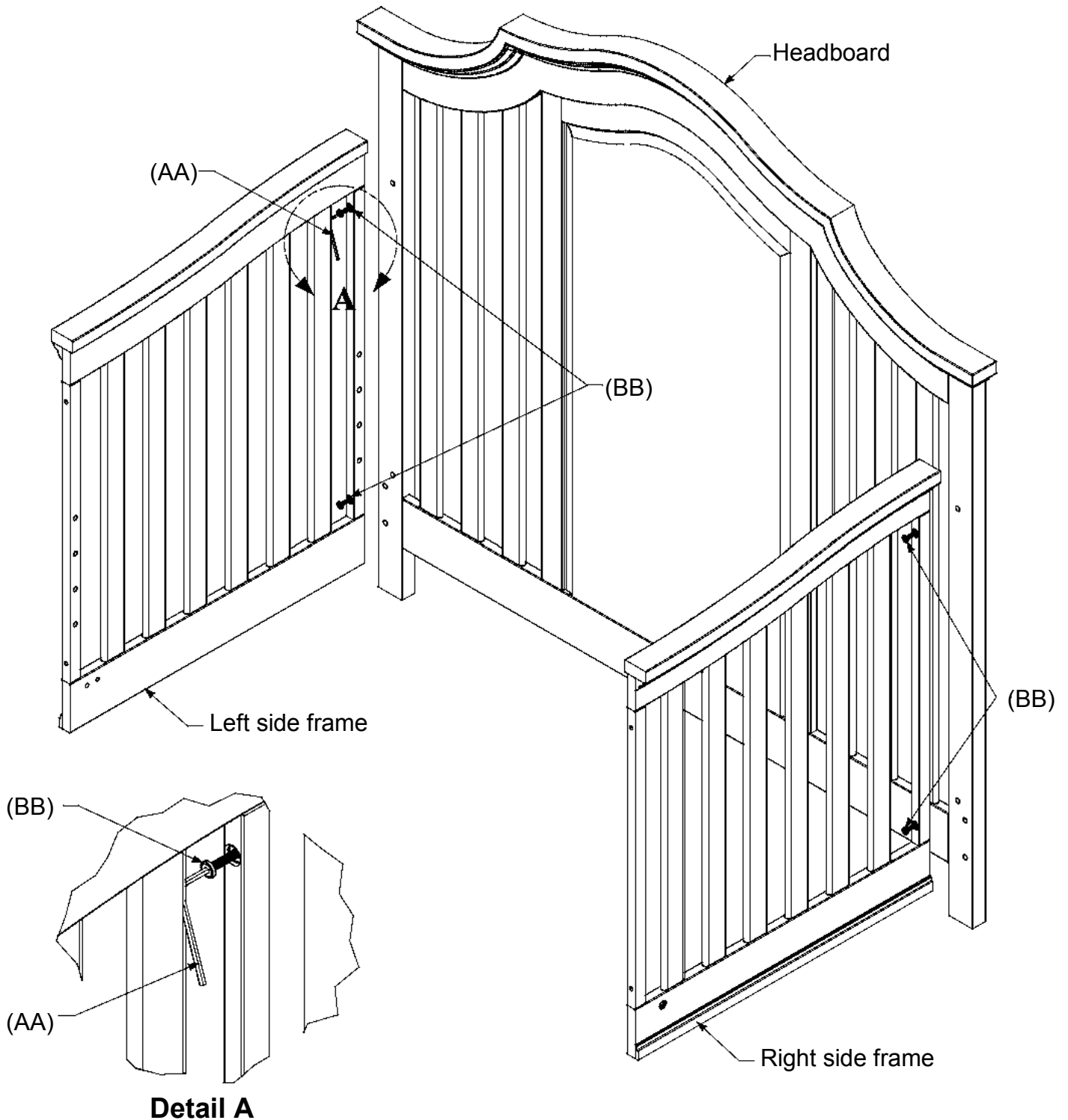

STEP #2

STRETCHER BAR ASSEMBLY

Stretcher Bar (x 1)

- Insert barrel nuts into holes in stretcher bar
- Align threaded hole in barrel nut with bolt (CC)
- NOTE: Slot on barrel nut (DD) faces outward
- NOTE: Do not fully tighten at this time.

Hardware needed for Step #2:

(AA) Allen Wrench (1 piece)

(CC) 2-1/2 in. Bolts (x 2 pieces)

(DD) K.D. Barrel Nuts (x 2 pieces)

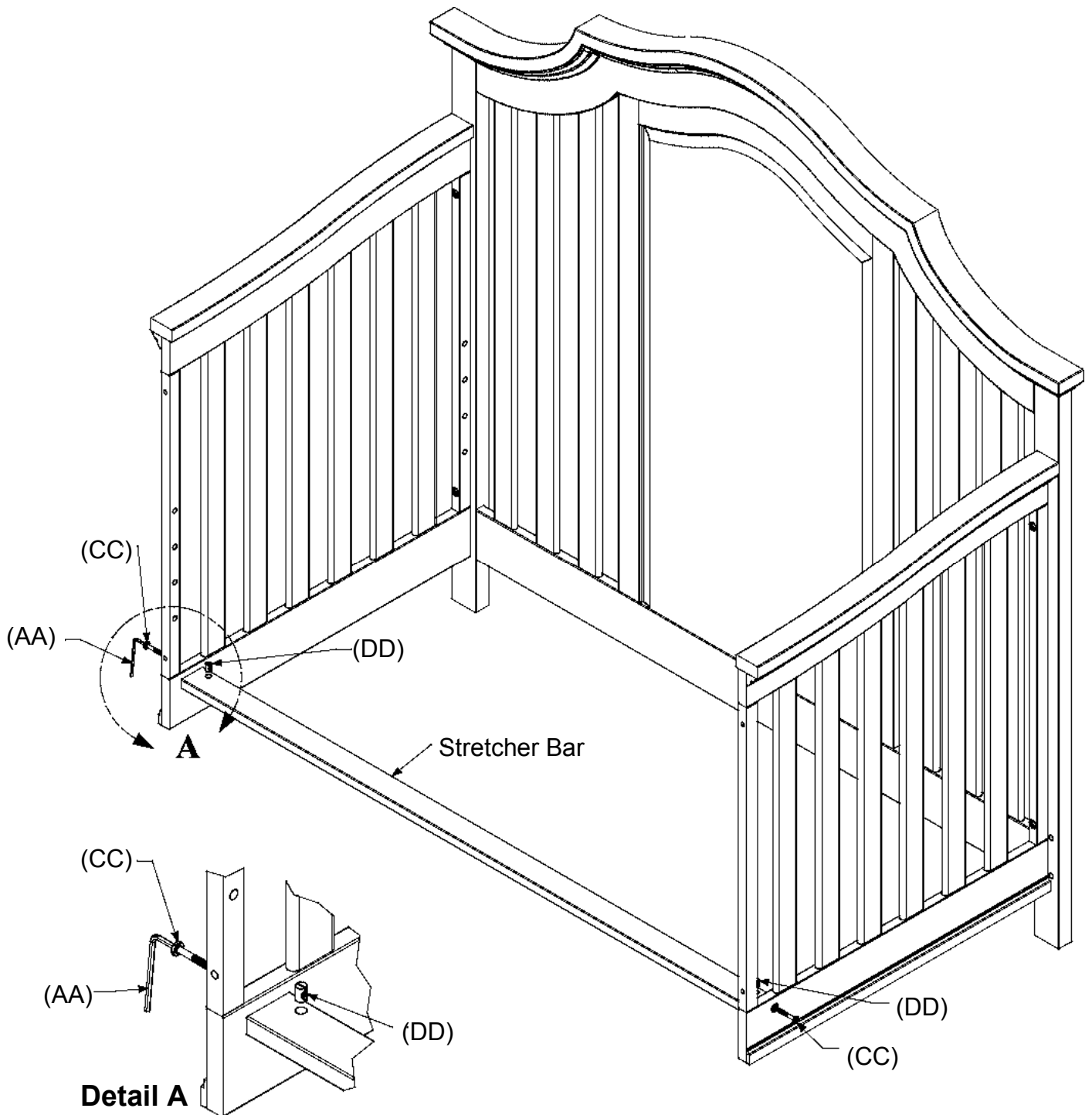

STEP #3

FOOTBOARD ASSEMBLY

Footboard (x 1)

Hardware needed for Step #3:

(AA) Allen Wrench (1 piece)

(BB) 1-3/4 in. Bolts (x 4 pieces)

•NOTE: Do not fully tighten at this time.

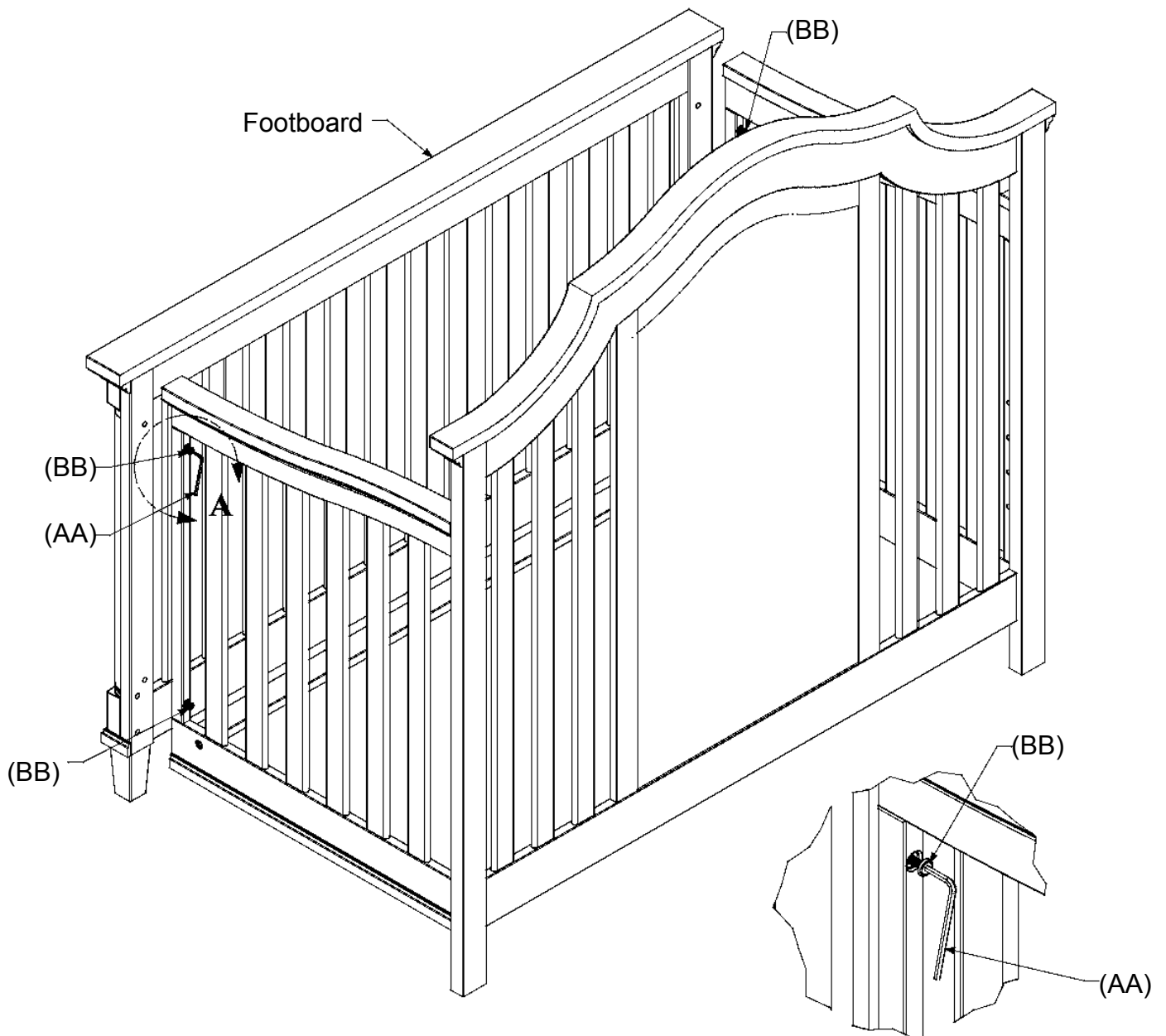

Detail A

STEP #4

MATTRESS SUPPORT ASSEMBLY

Hardware needed for Step #4:

(AA) Allen Wrench (1 piece)

(EE) Filler Bolts (x 16 pieces)

Mattress Support (x 1)

•NOTE: Attach mattress support to desired location at same level on all 4 corners to ensure mattress support is level.

•NOTE: Top level for Infants.

•Mattress Support in top level for initial assembly.

•NOTE: Insert 1 (EE) bolt into every remaining hole, after mattress support is in place.

▲WARNING: After crib is completely assembled, return to each bolt and tighten to snug fit. **DO NOT** over tighten.

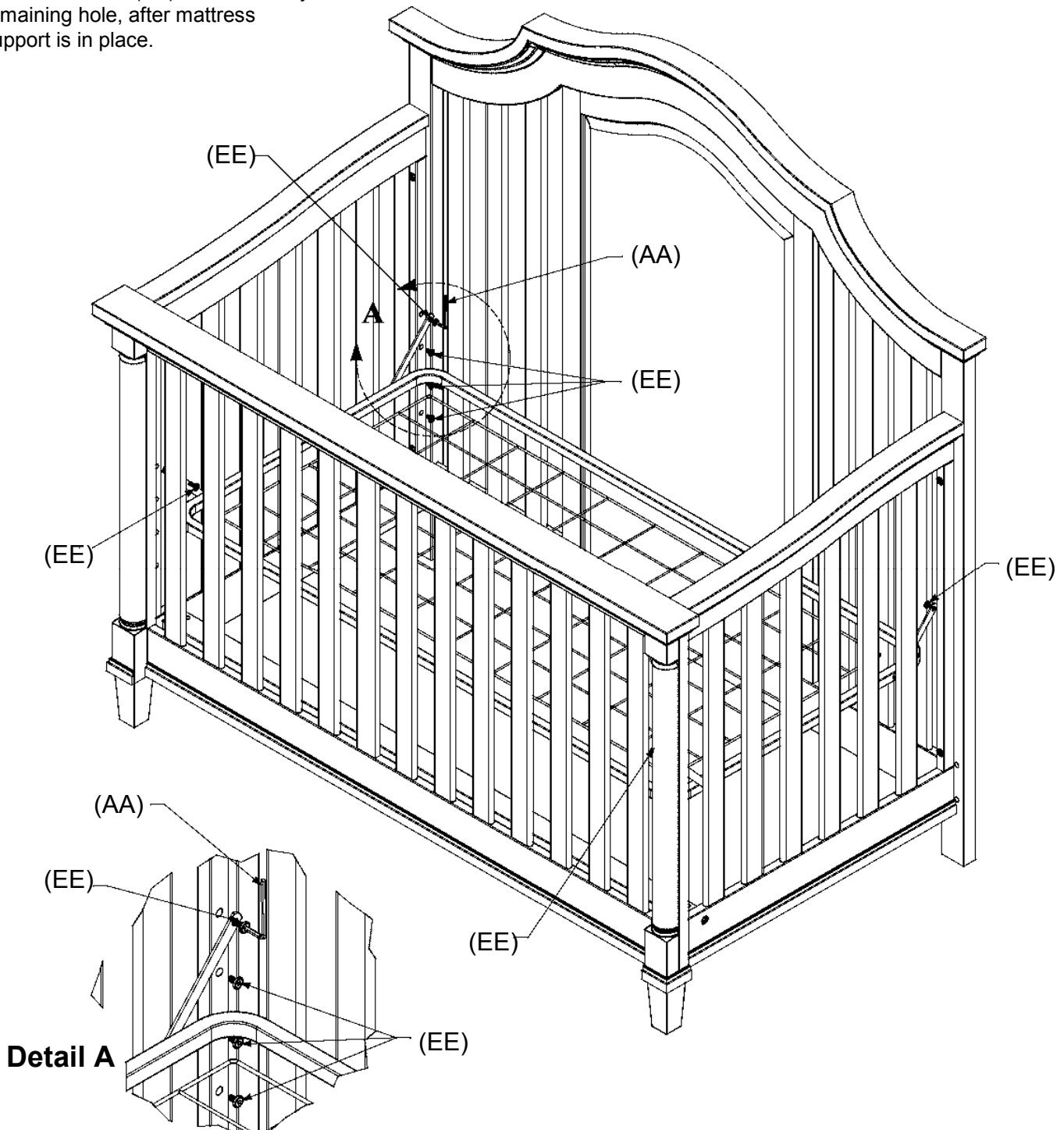

STEP #5

DAY BED ASSEMBLY

Left Day Bed Post (x 1)

Right Day Bed Post (x 1)

Starting from the crib, unscrew and detach the footboard from the crib. If mattress support is not in the lowest position, unscrew mattress support bolts and move it to the lowest position.

Hardware needed for Step #5:

(AA) Allen Wrench (1 piece)

(BB) 1-3/4 in. Bolts (x 4 pieces)

(EE) Filler Bolts (x 16 pieces)

NOTE: Insert 1 (EE) bolt into every remaining hole, after mattress support is in place.

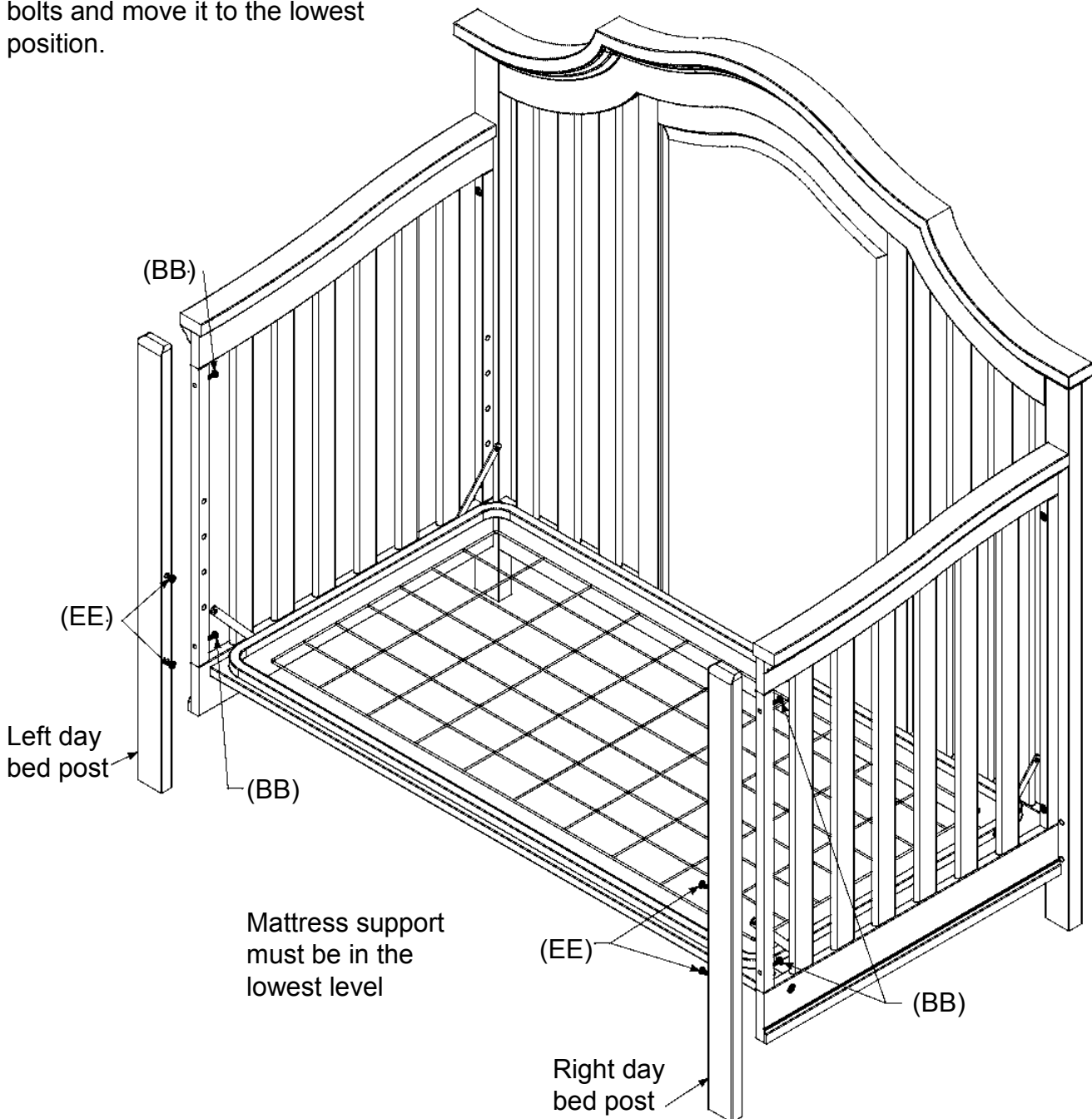

STEP #6

TODDLER BED ASSEMBLY

- Left Day Bed Post (x 1)
- Right Day Bed Post (x 1)
- Toddler Guard Rail (x 1) (Sold Separately)

Starting from the crib, unscrew and detach the footboard from the crib. If mattress support is not in the lowest position, unscrew mattress support bolts and move it to the lowest position.

Hardware needed for Step #6:

- (AA) Allen Wrench (1 piece)
- (BB) 1-3/4 in. Bolts (x 8 pieces)
- (EE) Filler Bolts (x 12 pieces)

NOTE: Insert 1 (EE) bolt into every remaining hole, after mattress support is in place.

NOTE: (BB) bolts included with toddler kit.

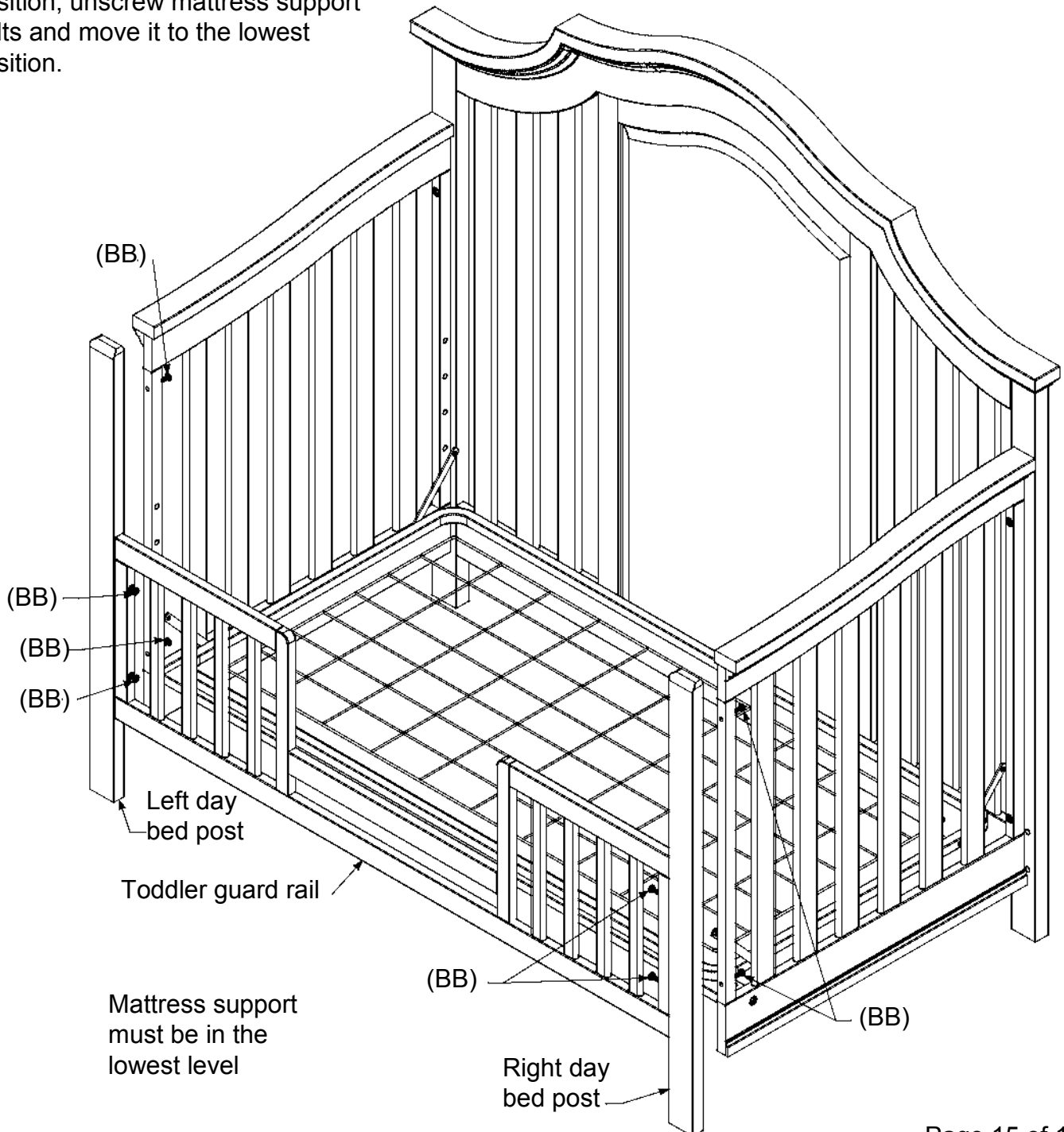

STEP #7

FULL SIZE BED INSTRUCTIONS

Full size bed rails (x 1 pair) (Sold separately)

Hardware needed for Step #7:

(AA) Allen wrench (1 piece)

(EE) Filler bolts (x 4 pieces)

Note: (EE) Filler bolts & Hardware included with bed rails

From the crib, detach all bolts from the footboard. Then detach all bolts from the headboard. Insert (2) (EE) filler bolts in top holes of headboard & footboard & tighten to snug fit. To attach bed rail, insert (2) machine bolts with lock washer & flat washer through holes in side rails into bushings in headboard and tighten with allen wrench. Repeat this procedure on all four areas for proper full-size bed hook-up.

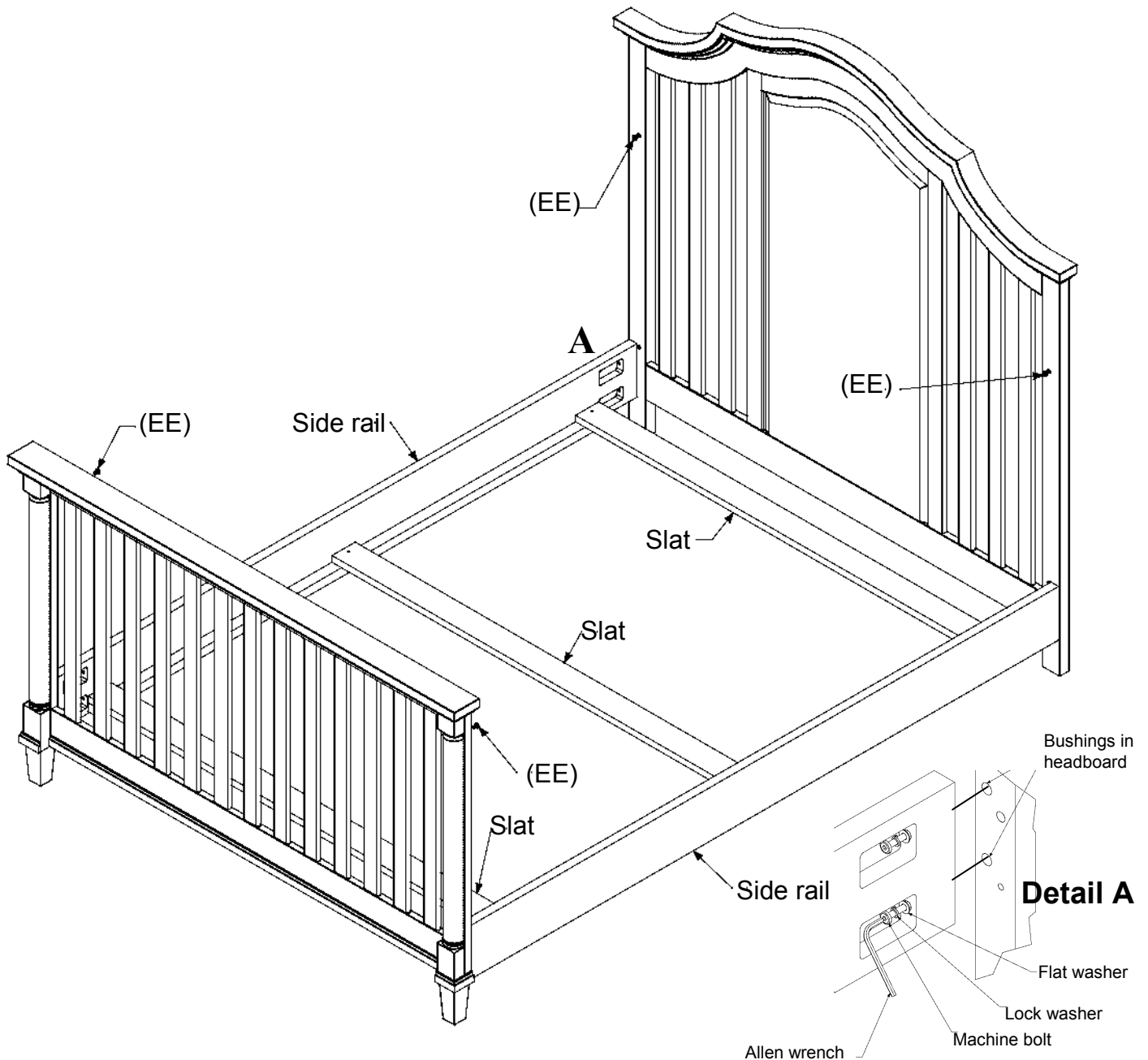

IMPORTANT: Store away all extra parts to this “crib”, “toddler bed”, that you are not using for possible future use, as you may wish to convert again. Always store the assembly directions in the pouch attached to the mattress support.