

PRODUCTS PROVIDED BY ROTHOBLAAS

CLIMA CONTROL 80

MEMBRANE WITH VARIABLE DIFFUSION

Vapour check polyamide (PA) film with polypropylene (PP) reinforcing layer.

dimensions (H x L) : **1,5 x 50 m**

- ① **top layer:** vapour check PA film
- ② **bottom layer:** non-woven PP fabric



SEAL BAND

SINGLE-SIDED TAPE FOR INDOOR USE.

Hydrorepellant impregnated paper support, acrylic glue and separation layer.



SPEEDY BAND

UNIVERSAL SINGLE-SIDED TAPE WITHOUT SEPARATION LAYER.

Polyethylene (PE) support with acrylic glue and reinforcing grid.



FLEXI BAND

UNIVERSAL SINGLE-SIDED HIGH-ADHESIVE TAPE.

Polyethylene (PE) support with acrylic glue, reinforcing grid and separation layer.



ROLLER

Pressure rollers.



PRIMER/PRIMER SPRAY

Universal foundations for acrylic adhesive tapes.



TEST CONFIGURATIONS

1 MEMBRANE + MEMBRANE

CLIMA CONTROL 80 + SEAL BAND

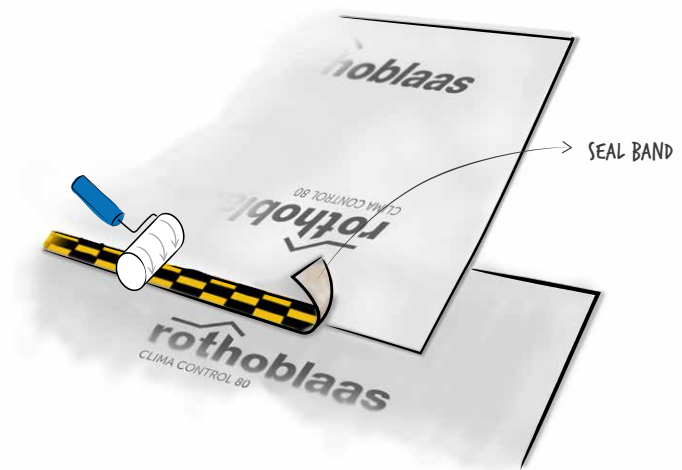

2 MEMBRANE + OSB

CLIMA CONTROL 80 + SPEEDY BAND

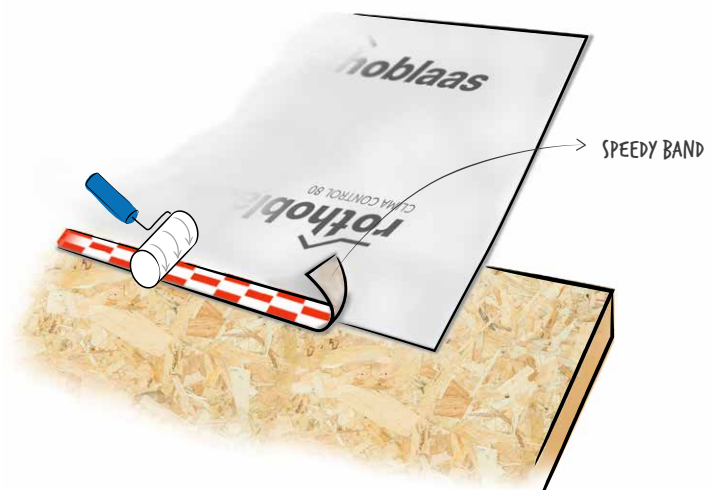

3 MEMBRANE + CONCRETE

CLIMA CONTROL 80 + FLEXI BAND

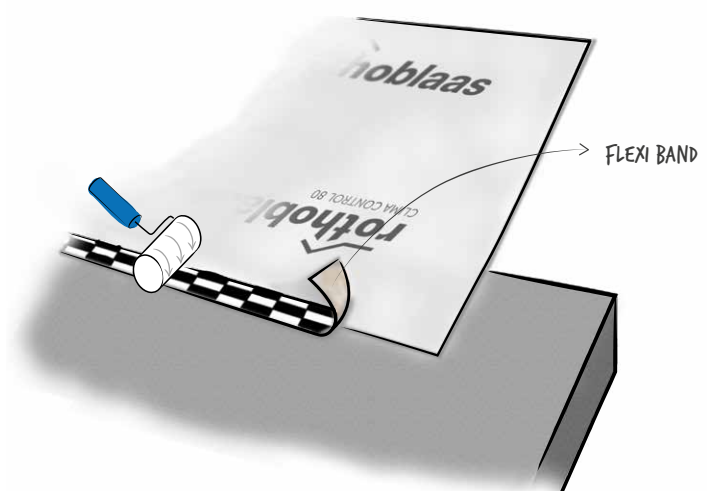

INSTALLATION INSTRUCTIONS

1 INSTALLING THE MEMBRANE

Unroll the membrane and attach with galvanised staples that are at least 10 mm wide and 8 mm long at a spacing of 20–30 cm. Overlap the membrane by at least 10 cm onto adjacent structural elements so that it can later be made airtight.

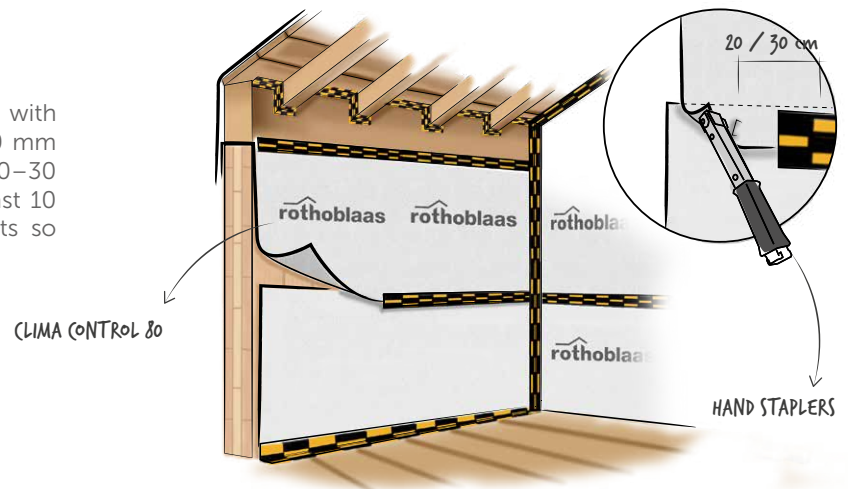

2 OVERLAPPING THE MEMBRANES

Overlap the membranes by about 15 cm. The printed markings are an aid to orientation.

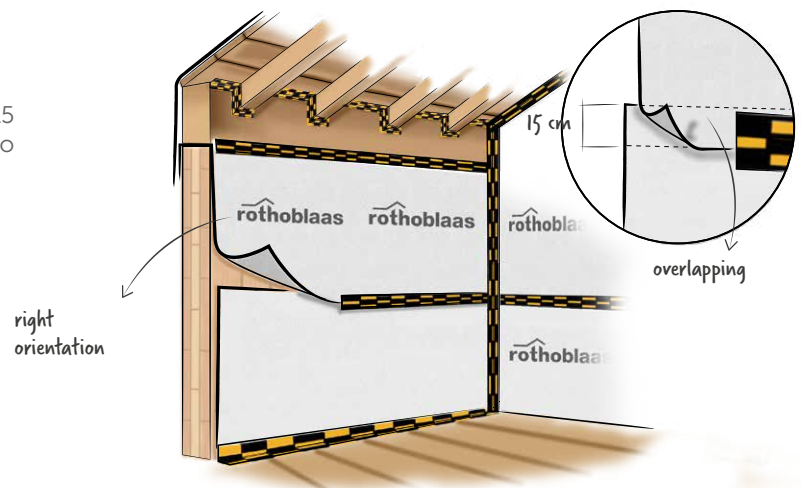

3 SEALING OVER THE OVERLAPS

Apply Rotho Blaas adhesive tape (**SEAL BAND**) centrally to the overlap and stick it down bit by bit so that it is load and wrinkle free. Make the bond stick well using the Rotho Blaas rigid rubber roller (**ROLLER**).

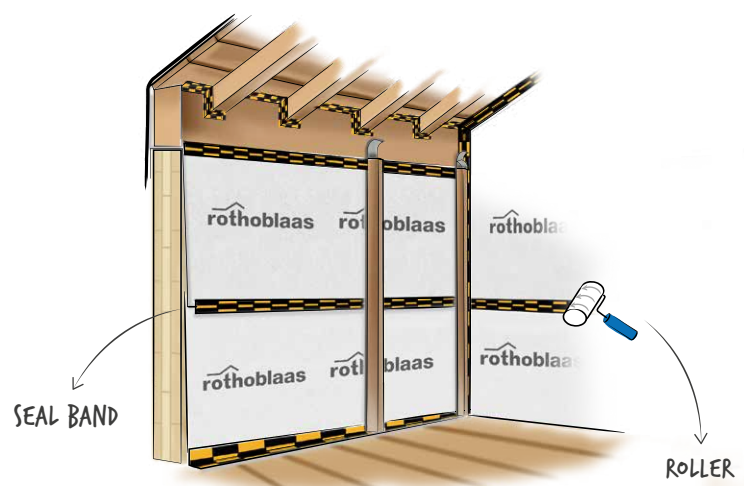

4 SEALING INDOOR BASE JOINT

Clean the substrates to be bonded. Apply **SEAL BAND** in the middle, align. Peel off the slit backing strips one after another, press down. Make sure sufficient of the adhesive surface of band is applied to the substrates to be bonded.

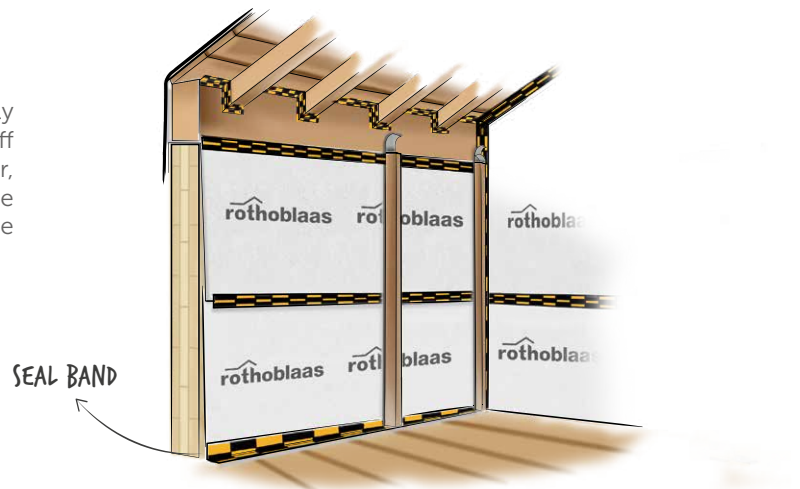

5 STICKING TO SMOOTH, NON-MINERAL SUBSURFACES (OSB)

Clean the substrate and, if necessary, perform a bonding test. Install **CLIMA CONTROL 80** membrane with a stress relief loop to remove tension (as shown in the figure). Apply **SPEEDY BAND** in the middle and glue it evenly, making the tape adhere well to the membrane and to the wall surface. Make the bond stick well using the Rotho Blaas rigid rubber roller (**ROLLER**).

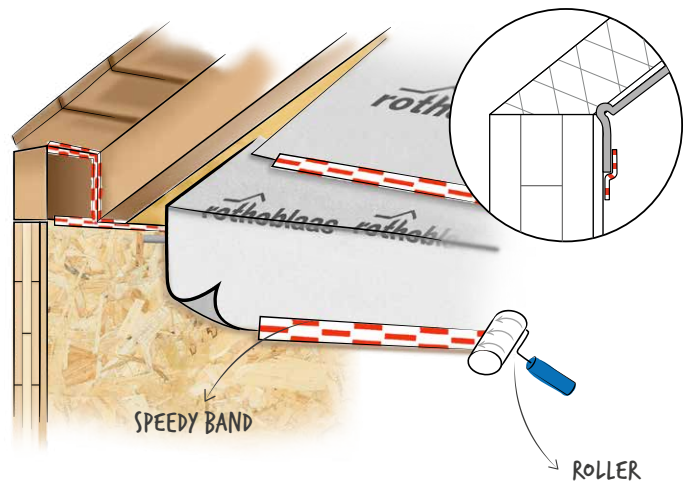

6 STICKING TO ROUGH OR MINERAL SUB-SURFACES (CONCRETE)

Clean the substrate and, if necessary, perform a bonding test. Install **CLIMA CONTROL 80** membrane with a stress relief loop to remove tension (as shown in the figure). Apply the **UNIVERSAL PRIMER** to ensure correct adhesion of the tape on the surface and wait 5 to 10 minutes for drying. Apply **FLEXI BAND** in the middle and glue it evenly, making the tape adhere well to the membrane and to the wall surface. Make the bond stick well using the Rotho Blaas rigid rubber roller (**ROLLER**).

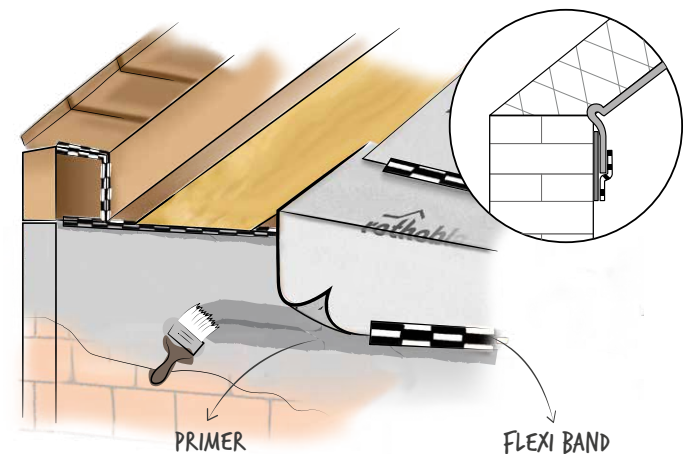

Rotho Blaas SRL

Via dell'Adige N.2/1 | 39040, Cortaccia (BZ) | Italy
Tel: +39 0471 81 84 00 | Fax: +39 0471 81 84 84
info@rothoblaas.com | www.rothoblaas.com

