



OAP 6A AREA 2 CONTEST

SATURDAY, MARCH 31, 2018

College Station High School
4002 Victoria Ave
College Station, TX 77845

Phone: (979) 694-5800
Fax: (979) 694-5865



CONTEST MANAGER:
JULIA MISHLER 214-288-7521
jmishler@csisd.org

Schedule

- 7:00 AM - 1:00 PM *Rehearsals*
1:15 PM *Directors'/Judges' Meeting*
2:00 PM *Contest begins and runs back-to-back*

Judge Information- Please overnight your scripts as soon as possible. Do not send the script as a registered letter requiring a signature. It could cause a delay.

Perry Crafton
5800 Brodie Ln #1035
Austin, Texas 78745

Allen Otto
8010 Sharpcrest St
Houston, Texas 77036

Ezekiel Morgan
2910 Reed Rd #421
Houston, Texas 77051

Please bring the following items with you to rehearsal:

1. Entry fee: Check made out to CSHS Theatre for \$645.
2. A signed copy of the "Community Standards Compliance Form"
3. Integrity script
4. Music Log
5. Proof of royalty payment
6. Publisher permission to produce the play
7. UIL permission for set additions
8. UIL approval for a play not on the approved list

In addition, please use the attached instructions and program template to send your program copy to larryedwardrobinson@gmail.com AND jmishler@csisd.org.

A few things about our contest:

1. Please arrive at CSHS at the Fine Arts Entrance (map attached). You will see your contest host waiting for you.
 - a. If you end up on Victoria Ave., turn right on Barron (at the light).
 - b. If you end up on Barron, it will be past the light (going South from HWY 6) on your right.
2. Each school will be assigned a student host to assist with the day. Each student host will escort you to and from the theatre as well as your holding room.
3. Your holding rooms are empty classrooms. Please bring mirrors and any other items needed to accommodate using a classroom. It is imperative that the room is left in the same condition it was found.

4. If you would like Chic-Fil-A lunch catered and delivered for your company, use this link to order: goo.gl/forms/aJMC4HFTjfFBVmtj1. An invoice is available upon request if required by your district.
5. Schools will wait in the Makeup Room until the previous school has completed strike. Once the stage is cleared, you will walk from SR to SL gather your set pieces and begin timed set up. The UIL set is located upstage.
6. After your performance, you will strike SL into the Set Shop. The site crew will strike the unit set. Once strike time has been completed, please load out from the back Fine Arts Door.
7. You are welcome to attend the performances of the other schools, please remember the shows will run back-to-back with no late seating allowed. No food or drink is allowed in the theatre.
8. After the judge has deliberated, the awards ceremony will be held in the theatre. Your contest host or a member will alert you – plan on being in the theatre approximately 30 minutes after the end of the final show. Please be on time and show proper sportsmanship.
9. Before leaving your holding room for the final time, please make sure you have cleared your classroom of all trash (place it in the hallway) and put the room back the way it was left. You will not be allowed to leave until you have cleared with your student host and/or the Contest Manager.

Rehearsal Order

Schools should unload at least 30 minutes prior to rehearsal time. Each school will have 50 minutes uninterrupted, with the last 10 minutes of the hour reserved for strike and to load-in of the next school. Performance times are approximate. Plays will run back-to-back. *Once all plays are submitted in the MACH system, I will send an email with the titles in performance order.* ***If you would like to drop off your items Friday evening, please email Mrs. Mishler to make arrangements.**

Rehearse	Official Draw	Perform
7:00 am	Bi-District B, School A	2:00 pm
8:00 am	Bi-District B, School B	3:00 pm
9:00 am	Bi-District B, School C	4:00 pm
10:00 am	Bi-District A, School C	5:00 pm
11:00 am	Bi-District A, School B	6:00 pm
12:00 pm	Bi-District A, School A	7:00 pm

Please text Mrs. Mishler at 214-288-7521 when you arrive at CSHS.

Tech Information

- There are 15 light areas and 3 color washes (RGB) that run on an ETC Ion board. All areas are assigned to subs for easier use. Areas 1-5 extend.
- There is an LED lit cyc available.
- Please bring a flash drive to record your cues.
- You will be given your spike tape color when you arrive.
- The sound system will operate 2 CDs, with an input to run a iPod, iPad, or laptop.
- Both lights and sound will be operated from the booth.
- Clear Com Headsets are available for all schools to use - three (3) in the booth, one (1) SR, and one (1) SL.

If you plan to use a haze/fog machine, please notify Mrs. Mishler before your rehearsal and be prepared to test the device outside with her or a school official prior to your rehearsal time to ensure the consistency of the haze/fog will not set off the super-sensitive fire alarm system.

OAP Set Storage

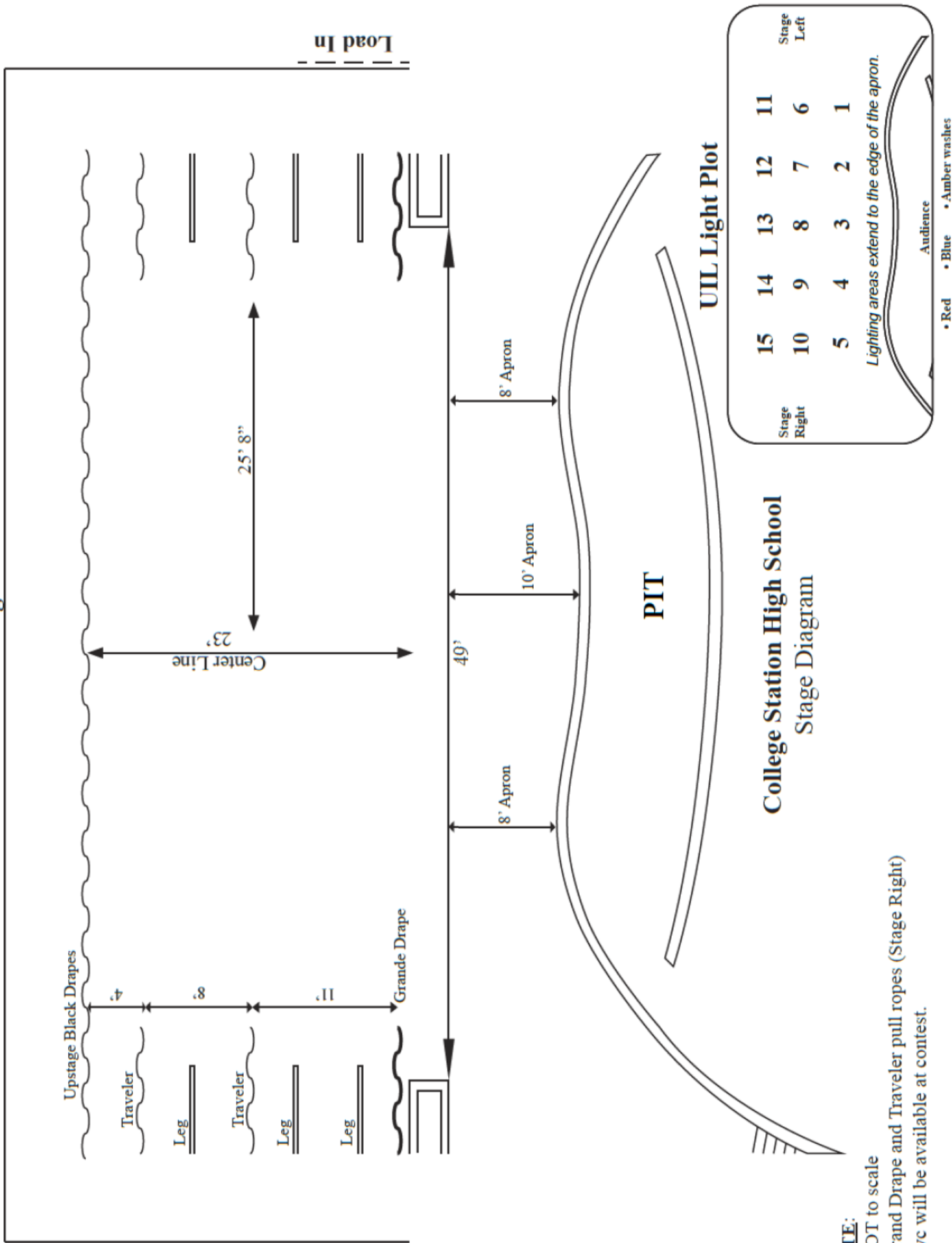

College Station High School Stage Diagram

15	14	13	12	11
10	9	8	7	6
5	4	3	2	1
Stage Right				Stage Left

Lighting areas extend to the edge of the apron.

Audience

• Red • Blue • Amber washes

NOTE:

- NOT to scale
- Grand Drape and Traveler pull ropes (Stage Right)
- Cyc will be available at contest.

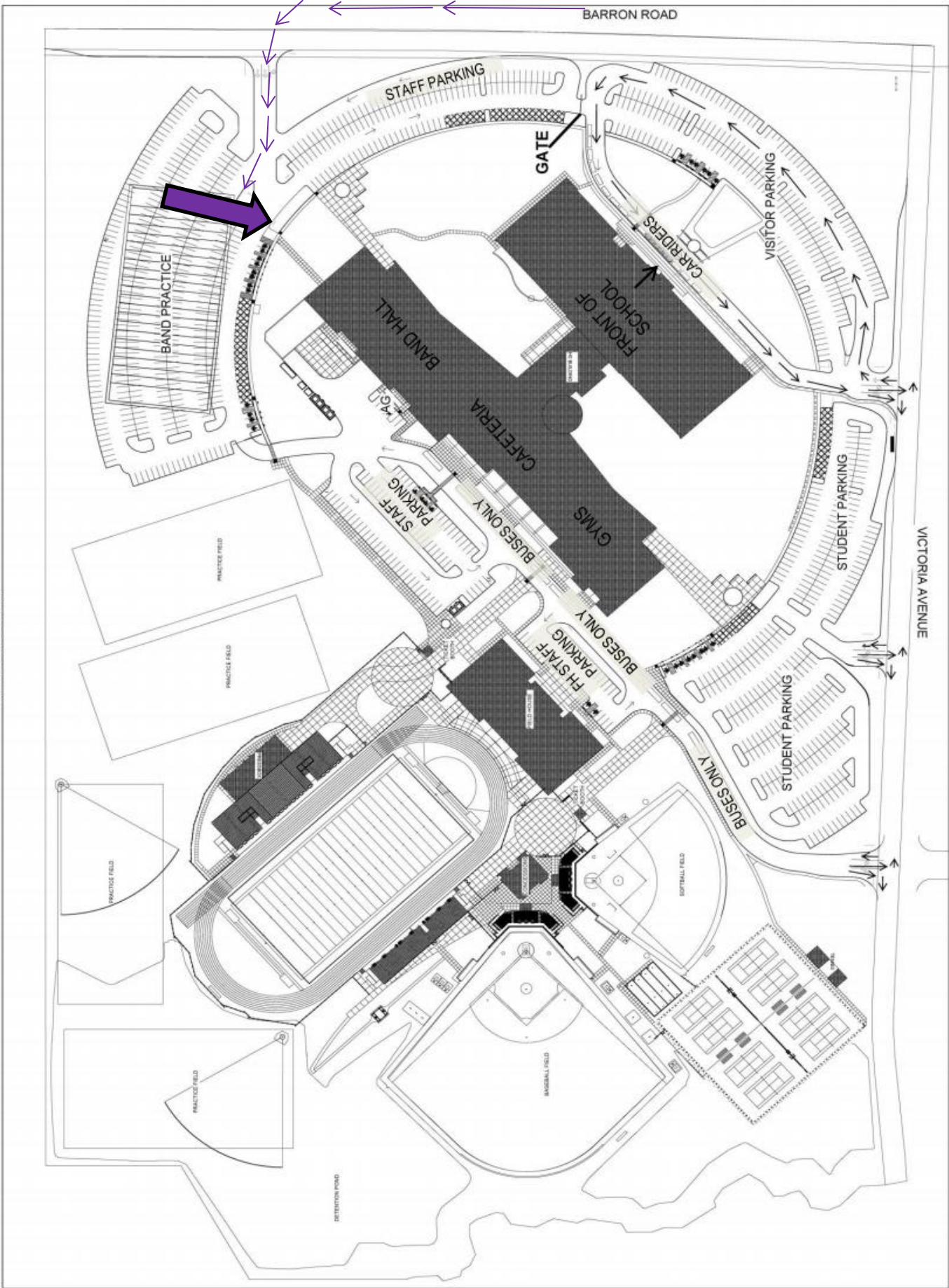

BARRON ROAD

STAFF PARKING

GATE

VISITOR PARKING

BAND PRACTICE

BAND HALL

FRONT OF SCHOOL

CAR RIDERS

CAFETERIA

GYM

STUDENT PARKING

VICTORIA AVENUE

STAFF PARKING

BUSES ONLY

BUSES ONLY

FH STAFF PARKING

BUSES ONLY

STUDENT PARKING

BUSES ONLY

PRACTICE FIELD

PRACTICE FIELD

PRACTICE FIELD

PRACTICE FIELD

SOFTBALL FIELD

BASEBALL FIELD

DETENTION POND

FRACKIN HIGH SCHOOL
Buddy Drowned in Denmark

By Puck Oberon, Translated by Racine Corneille

**Scene: A very bad concentration camp in Poland
in 1492 after Columbus landed**

Produced by special arrangement with the Hysterical Publishing Company

CAST

Wendy BirdmannKasey Chester
Buddy BonebreakerSamantha Kail
Zsa-Zsar GaborJesse Thomason
Evar GaborKullen Potter
Moritz on a CrackerIan McLellan
Georg LemonadeAustin Britton
Baldbelly Man-ChildJustin Chavez
Ernst NobelRodrigo Sanchez
Headmaster SunchokeLogan Pitts
Herr StiflipPhillip Pipkin
Thea TrawlerLauren Barnes
Martha BessieJordyn Rogers
Professor GutgrinderBecca Aycock
Ilse/Mrs. SchmidtBlair Rayburn
The ManDavorian Marion

CREW

Mia Rook (Stage Manager)
Taylor Watson (Backstage)
Bethany Pitchford (Lights)
Dana Smyres (Lights)
John Soza (Sound)

ALTERNATES

Tatym Harris-Shaw
Shelby Cannon
Emma Hyde

Directed by
The Blonde and Mr. Green, the Custodian

18 point ALL CAPS

FRACKIN HIGH SCHOOL

Type program copy in **Arial**. Note where it is **bold** and note where it is *italicized*. Note ALL CAPS

Buddy Drowned in Denmark

24 point Bold and Italicized

By Puck Oberon, Translated by Racine Corneille

Do not put "Time" and "Place." Incorporate them into one phrase for "Scene."

There are periods, not dashes. Please use periods.

Scene: A very bad concentration camp in Poland in 1492 after Columbus landed

Produced by special arrangement with the Hysteric Publishing Company

10 point

CAST

Wendy Birdmann	Kasey Chester
Buddy Bonebreaker	Samantha Kail
Zsa-Zsar Gabor	Jesse Thomason
Evar Gabor	Kullen Potter
Moritz on a Cracker	Ian McLellan
Georg Lemonade	Austin Britton
Baldbelly Man-Child	Justin Chavez
Ernst Nobel	Rodrigo Sanchez
Headmaster Sunchoke	Logan Pitts
Herr Stiflip	Phillip Pipkin
Thea Trawler	Lauren Barnes
Martha Bessie	Jordyn Rogers
Professor Gutgrinder	Becca Aycocok
Ilse/Mrs. Schmidt	Blair Rayburn
The Man	Davorian Marion

ALL CAPS AND BOLD!

Character names come first to the left followed by periods leading up to actor names. Do not type either in ALL CAPS. Use periods, not dashes.

Identify your crew members by job in parentheses following their names.

CREW

Mia Rook (Stage Manager)
Taylor Watson (Backstage)
Bethany Pitchford (Lights)
Dana Smyres (Lights)
John Soza (Sound)

ALTERNATES

Tatym Harris-Shaw
Shelby Cannon
Emma Hyde

Directed by

The Blonde and Mr. Green, the Custodian

Unless otherwise noted, the body of the program copy can be typed in 12 or 14 point Arial.