

## COMPACT BLUMOTION and COMPACT hinges A complete face frame program

Blum's COMPACT hinges program has proven itself as the high quality solution for face frame cabinets for over 30 years and continue to provide the quality of motion you have come to expect from Blum hardware.

COMPACT BLUMOTION hinges have the soft closing mechanism integrated directly in the hinge cup. They are available for most overlay face frame applications or door styles.



### Deactivation option

The BLUMOTION function can be easily deactivated on one of the hinges, allowing small or light doors to close with the same high quality of motion.



### Interchangeability

COMPACT BLUMOTION hinges are interchangeable with current COMPACT hinges so there is no need to change existing setups or workflows.



### Overload safety feature

This feature protects the hinge from damage if the door is slammed and maintains the BLUMOTION soft closing for the life of the hinge.

## Hinges



### COMPACT BLUMOTION and COMPACT hinges overview



#### 38N COMPACT BLUMOTION for partial overlay

Partial overlay hinges with a 105° opening angle and 7/16" cup depth



#### 39C/38C COMPACT BLUMOTION for full overlay

39C: Full overlay hinges with a 110° opening angle and 1/2" cup depth

38C: Full overlay hinges with a 107° opening angle and 7/16" cup depth



#### 38B COMPACT BLUMOTION face mount hinges for full overlay

Full overlay face mount hinges with a 107° opening angle and 7/16" cup depth



#### 38N COMPACT hinges for partial overlay

Partial overlay hinges with a 105° opening angle and 7/16" cup depth



#### 39C/38C COMPACT hinges for full overlay

39C: Full overlay hinges with a 110° opening angle and 1/2" cup depth

38C: Full overlay hinges with a 107° opening angle and 7/16" cup depth



#### COMPACT 33 hinges

Economical two-piece assembly hinges with a 110° opening angle and 1/2" cup depth

**Screw-on**

Use #6 wood screws

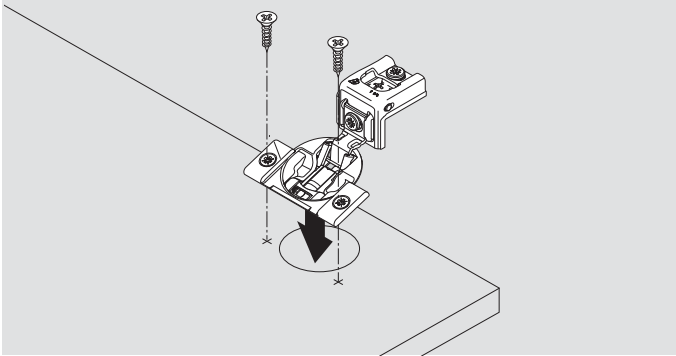

**Press-in**

Pre-attached Ø8 dowels installed with Blum knock-in tool or MINIPRESS with COMPACT insertion ram

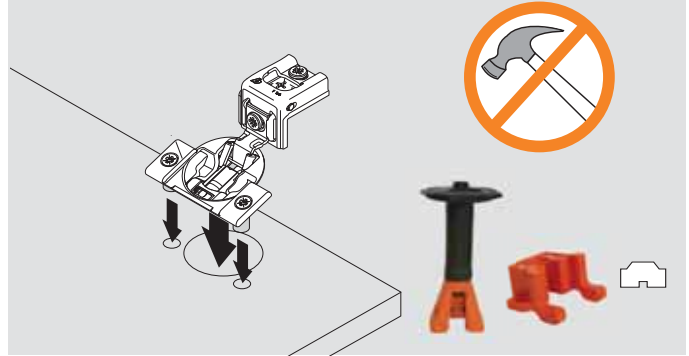

**Mounting plate attachment**

**38N series – wraparound/edge mount**

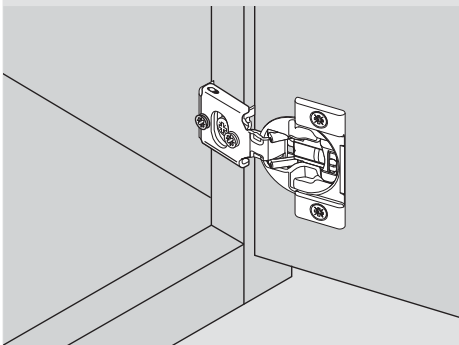

**39C/38C series – wraparound**

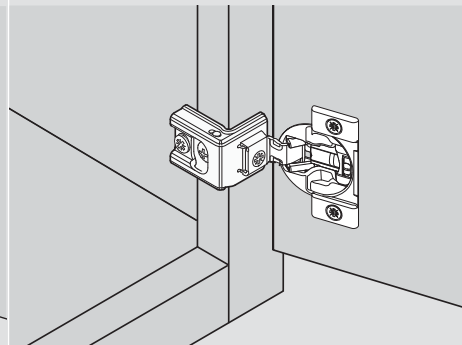

**38B series – face mount**

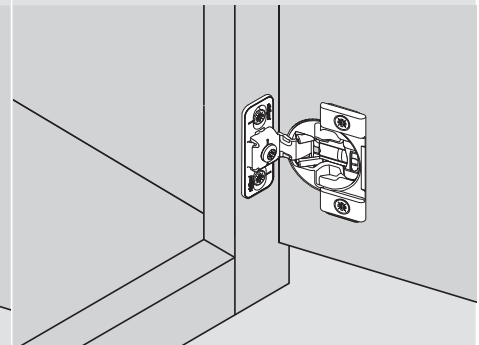

**Minimum reveal**

A minimum reveal per door is required to keep the door from binding and varies depending on door thickness.

See minimum reveal table for each hinge.

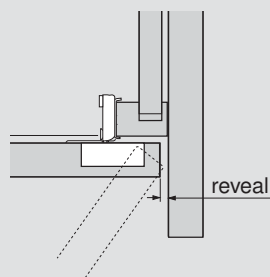

**Hinge cup centerpoint**

Hinge cup centerpoint and MINIPRESS/MINIDRILL setback position is 20.5 (13/16") for COMPACT BLUMOTION hinges

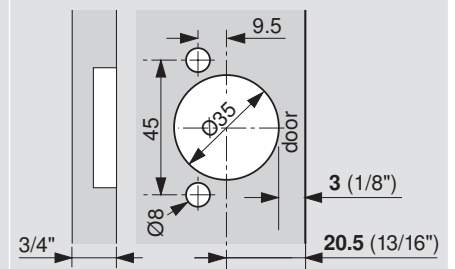

**NOTE:** Maximum door thickness 3/4"

**Hinges per door**

This chart can serve as a guide for determining the number of hinges per door. Note that door weight can also determine the number of hinges required.

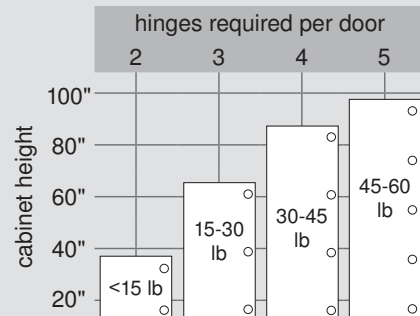

**NOTE:** The distance between the top and bottom hinges must be greater than the width of the door

## Three-dimensional adjustment

### Side adjustment

Rotate the front cam screw to increase or decrease door overlay ( $\pm 1/16"$ )

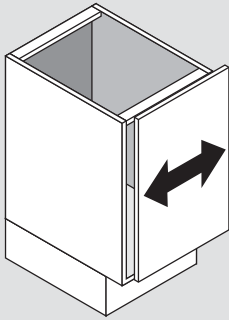

### Height adjustment

Loosen installation screws to adjust door position ( $\pm 1/8"$ ), then retighten

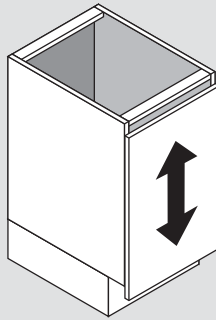

### Depth adjustment

Rotate the rear cam screw to adjust door gap ( $+ 3/32"$ ,  $- 1/32"$ )

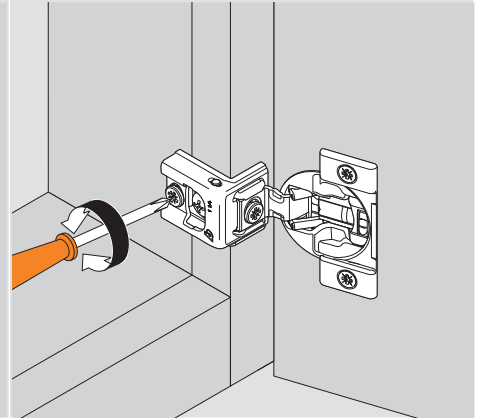
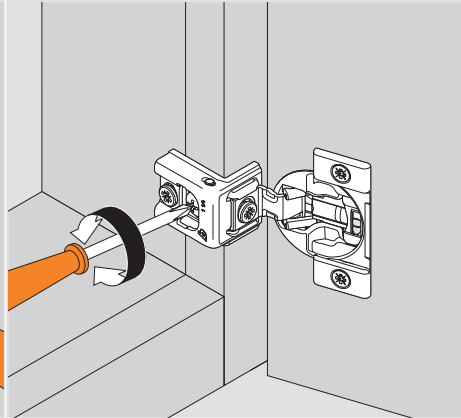
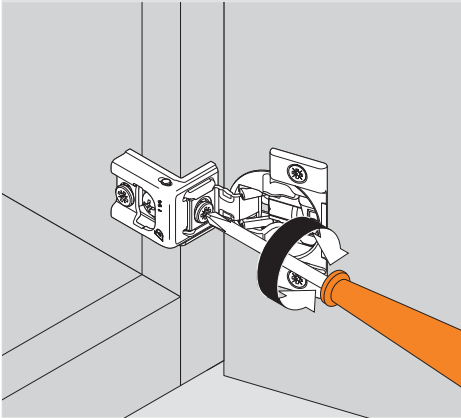
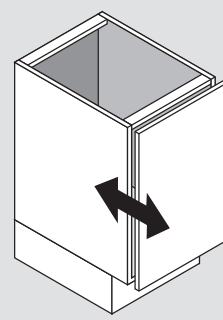

## BLUMOTION deactivation

### Deactivation switch on the hinge cup

For small or light doors, the BLUMOTION can be deactivated on one of the hinges. COMPACT BLUMOTION comes in the activated position, marked with a "I". The deactivated position is marked with a "0".

Door must be closed once for the deactivation to be complete. To reactivate, move switch back to the original position "I".

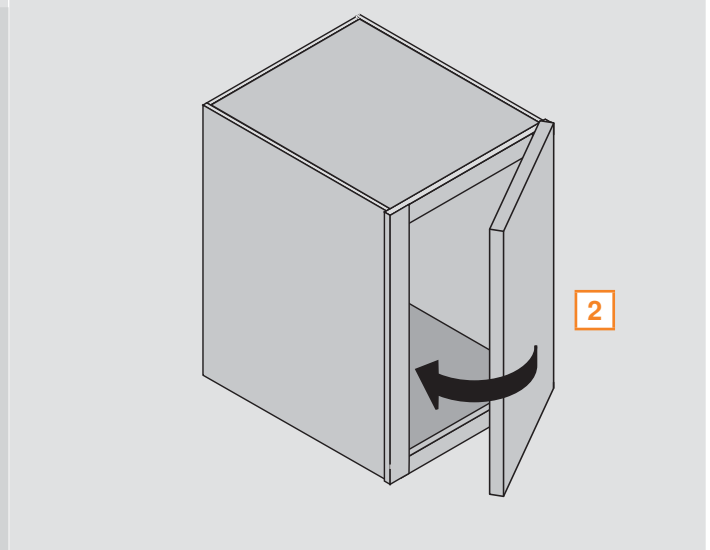
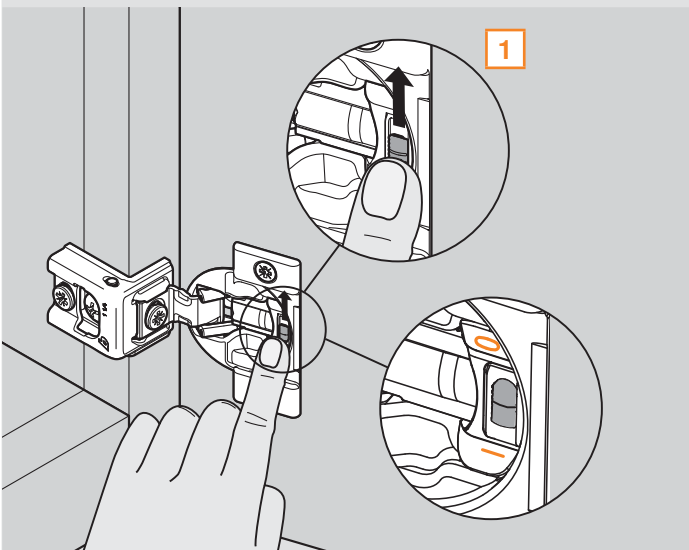

### Conditions for tests

Blum, Inc. does a great deal of testing to ensure that the quality of our hardware is consistent with the usual high standards that our customers have come to expect from Blum. For this reason we have rigorous testing procedures which are carried out from the development stage through production. Blum's internal testing standards are based on practical applications of our products and are more stringent than what is required by ANSI/BHMA.

Cycle test	
<b>Specifications</b>	<ul style="list-style-type: none"> <li>Door size – 23-5/8" height, 23-5/8" width, 3/4" thickness</li> <li>Door weight –14.3 lb for cycle tests</li> <li>Door weight – 18.5 lb for load and over push tests</li> <li>Boring distance – 3 mm</li> </ul>
<b>Distance between hinges</b>	<ul style="list-style-type: none"> <li>16-15/16"</li> </ul>
<b>Hinge and mounting plate attachment</b>	<ul style="list-style-type: none"> <li>Hinges are mounted to test blocks and attached to test door and stand with clamps</li> <li>Test blocks for door: Particle board</li> <li>Test blocks for mounting plate: Particle board</li> </ul>

Cycle test			
	<b>Without load</b> <ul style="list-style-type: none"> <li>100,000 opening and closing for all COMPACT</li> </ul>		<b>With load</b> <ul style="list-style-type: none"> <li>11 lb extra weight is applied for 100,000 opening and closing cycles</li> </ul>
	<b>Positive test result</b>		

Load test			
	<b>Static load</b> <ul style="list-style-type: none"> <li>67 lb applied ten times for five seconds, each at 45° opening angle</li> </ul>		<b>Dynamic load</b> <ul style="list-style-type: none"> <li>44 lb extra weight applied for fifty opening and closing cycles</li> </ul>
	<b>Positive test result</b>		

Over push test		
	<b>Without load</b> <ul style="list-style-type: none"> <li>COMPACT hinges – Increasing forces up to 11 lb applied for a total of forty times for five seconds each</li> </ul>	
	<b>Positive test result</b>	