

**LOCATION MAP**

SCALE: NONE

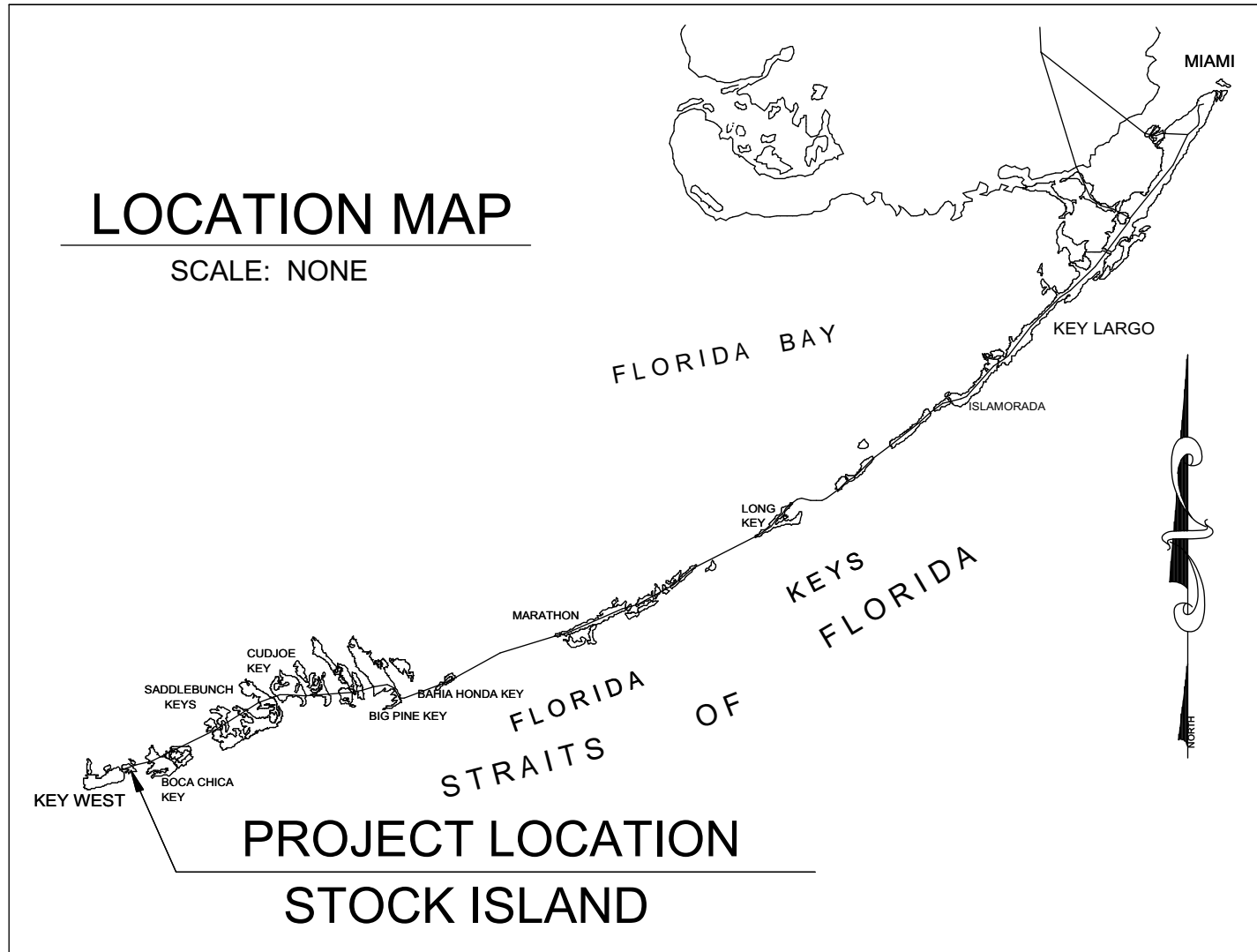

**PROJECT LOCATION  
STOCK ISLAND**

**SHEET INDEX**

- LA-01: MASTER LANDSCAPE PLAN
- LA-02: DEMOLITION PLAN
- LA-03: COMMUNITY BUILDING AREA PLANTING PLAN
- LA-04: PARKING LOT #1 AND PERIMETER PALM PLANTING PLAN
- LA-05: PARKING LOT #2 AND NATURE WALK PLANTING PLAN
- LA-06: PLANT SCHEDULE AND PLANTING DETAILS
- LA-07: SPECIFICATIONS

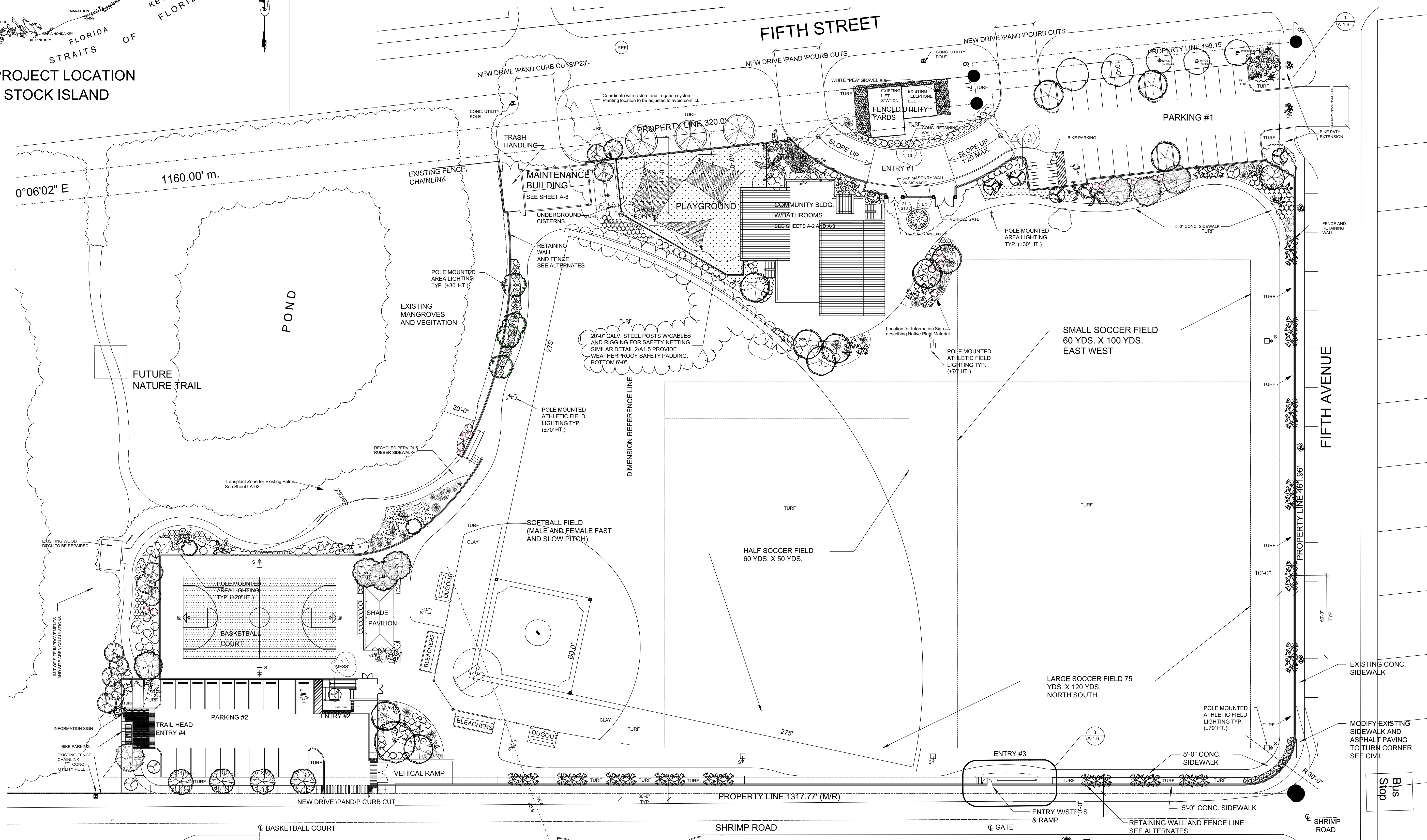
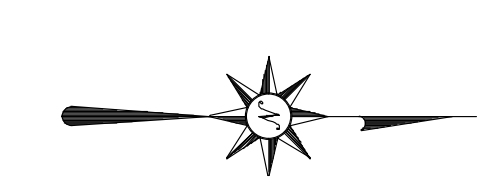

**MASTER LANDSCAPE PLAN**

SCALE: 1"=30'

**BERNSTEIN PARK  
STOCK ISLAND  
MONROE COUNTY, FLORIDA**

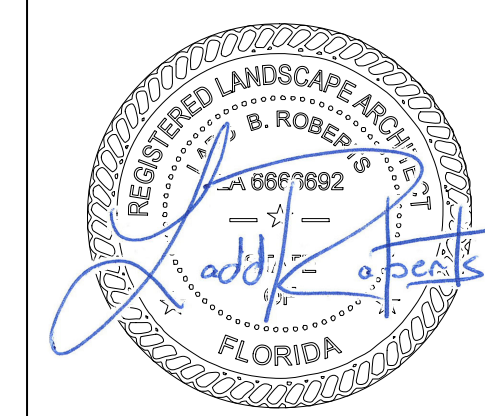

**LANDWISE  
DESIGN**

**Mitchell Planning & Design, Inc.**

15450 SE 103rd Place Road  
Ocala, Florida 32179  
352.288.0401/305.509.0966  
mitchellplanningdesign@gmail.com

Revisions:

12-31-14 D.D.
06-01-15 CD's
06-19-15 BLDG. DEPT.
10-05-15 BIDDING

Date:	06.01.15
Scale:	As Noted
File:	13-BH-003
Drawn:	BM
Checked:	LR
Sheet:	

**LA:01**



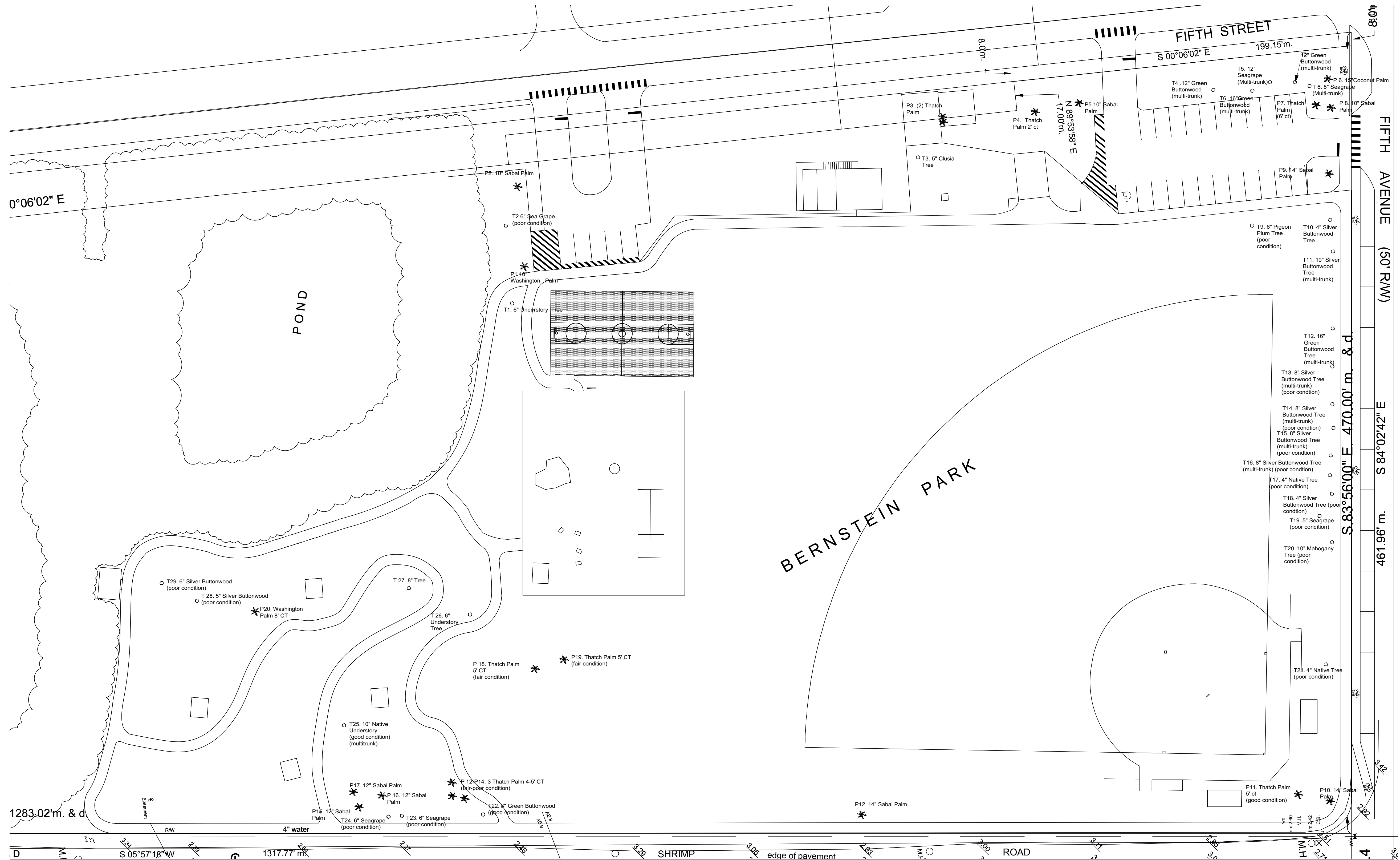
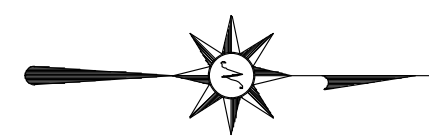

**NOTE:**

1. RELOCATE ALL NATIVE THATCH PALMS TO AREA AS NOTED ON SHEET LA-05. LOCATIONS TO BE FIELD DETERMINED.
2. RELOCATE ANY SABAL PALMS IF POSSIBLE TO RELOCATION AREA AS NOTED ON SHEET LA-05.
3. LANDSCAPE CONTRACTOR SHALL ROOT PRUNE ALL PLANT MATERIAL DEEMED AVAILABLE FOR TRANSPLANT A MINIMUM OF 90 DAYS PRIOR TO DIGGING.
4. DATA FOR DEMOLITION PLAN TAKEN FROM REVIEW OF AERIAL PHOTOGRAPHS AND GOOGLE EARTH IMAGERY. CONDITION OF PLANT MATERIAL PROPOSED FOR RELOCATION MUST BE FIELD VERIFIED.

**EXISTING TREE LIST**

ID	COMMON NAME	CONDITION	STATUS	ID	COMMON NAME	CONDITION	STATUS	ID	COMMON NAME	CONDITION	STATUS
T1	Understory Tree (6")	Unknown	Remove	T11	Silver Butonwood (4")	Multi	Remove	T24	Seagrape (6")	Poor	Remove
P1	Washington Palm	Invasive	Remove	T12	Green Butonwood (16")	Multi	Remove	P15	Sabal Palm (12")	Good	Relocate if Possible
T2	Sea Grape (6")	Poor	Remove	T13	Silver Butonwood (8")	Poor - multi	Remove	P16	Sabal Palm (12")	Good	Relocate if Possible
P2	Sabal Palm (10")	Fair	Relocate if Possible	T14	Silver Butonwood (8")	Poor - multi	Remove	P17	Sabal Palm (12")	Good	Relocate if Possible
T3	Clusia	Good	Remove	T15	Silver Butonwood (8")	Poor - multi	Remove	T25	Native Unknown	Good Multi	Relocate if Possible
P3	Thatch Palm (2)	Good	Remain In Place	T16	Silver Butonwood (8")	Poor - multi	Remove	P18	Thatch Palm (5' CT)	Fair	Relocate if Possible
P4	Thatch Palm (2' CT)	Good	Relocate	T17	Native Unknown	Poor	Remove	P19	Thatch Palm (5' CT)	Fair	Relocate if Possible
P5	Sabal Palm (10")	Good	Relocate if Possible	T18	Silver Butonwood (4")	Poor - multi	Remove	T26	Native Unknown (6")	Unknown	Remove
T4	Green Butonwood (12")	Good	Remain In Place	T19	Seagrape (5")	Poor	Remove	T27	Native Unknown (8")	Unknown	Remove
T5	Seagrape (12")	Fair - multi	Remove	T20	Mahogany (10")	Poor	Remove	P20	Washington Palm	Invasive	Remove
T6	Green Butonwood (16")	Good	Remain In Place	T21	Native Unknown	Poor	Remove	T28	Silver Butonwood (5")	Poor	Remove
T7	Green Butonwood (16")	Good	Remain In Place	P10	Sabal Palm (14")	Fair	Relocate if Possible	T29	Silver Butonwood (6")	Poor	Remove
P6	Coconut Palm	Good	Remain In Place	P11	Thatch Palm (5' CT)	Good	Relocate				
T8	Seagrape (8")	Fair - multi	Remove	P12	Sabal Palm (14")	Fair	Relocate if Possible				
P7	Thatch Palm (6'CT)	Good	Remain In Place	T22	Green Butonwood (8")	Good	Remove				
P8	Sabal Palm (10")	Good	Remain In Place	P12	Thatch Palm (4-5' CT)	Fair to Poor	Relocate if Possible				
P9	Sabal Palm (14")	Good	Relocate if Possible	P13	Thatch Palm (4-5' CT)	Fair to Poor	Relocate if Possible				
T9	Pigeon Plum (6")	Poor	Remove	P14	Thatch Palm (4-5' CT)	Fair to Poor	Relocate if Possible				
T10	Silver Butonwood (4")	Good	Remove	T23	Seagrape (6")	Poor	Remove				

**DEMOLITION PLAN**

SCALE: 1"=30'

**BERNSTEIN PARK  
STOCK ISLAND  
MONROE COUNTY, FLORIDA**

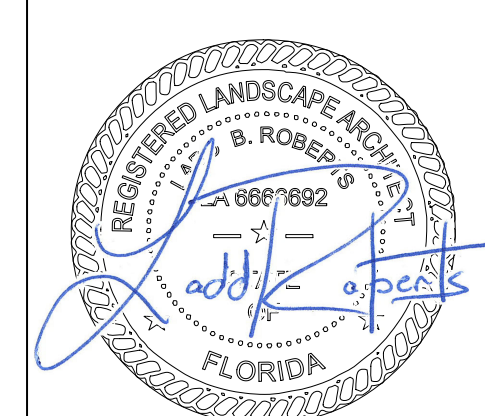

**LANDWISE  
DESIGN**

**Mitchell Planning & Design, Inc.**

15450 SE 103rd Place Road  
 Ocklawaha, Florida 32179  
 352.288.0401/305.509.0966  
 mitchellplanningdesign@gmail.com

**Revisions:**

12-31-14 D.D.
06-01-15 CD's
06-19-15 BLDG. DEPT.
10-05-15 BIDDING

Date:	06.01.15
Scale:	As Noted
File:	13-BH-003
Drawn:	BM
Checked:	LR
Sheet:	

**LA:02**









NEW DRIVE IPAND PCURB CUTS

PROPERTY LINE 199.15'

PARKING #1

PARKING LOT ISLANDS TO BE TURF WITH MULCH RINGS INSTALLED AROUND THE TREES. MINIMUM DIAMETER OF MULCH RING 5'.

BIKE PARKING

BIKE PATH EXTENSION

FENCE AND RETAINING WALL

5'-0" CONC. SIDEWALK TURF

FIFTH AVENUE

PROPERTY LINE 461.96'

**PARKING LOT 1 PLANTING PLAN**

SCALE: 1"=10'

**PLANT LEGEND:**

ID	Common Name	ID	Common Name	ID	Common Name	ID	Common Name	ID	Common Name	ID	Common Name	
AC	Cinnecord Acacia	DR	Royal Poincianna	SP	Sabal Palm	AVT	Arbicola Trinette	CMEB	Natal Plum Emerald Blanket	MCP	Muhly Grass	
BSA	Gumbo Limbo	GSA	Lignum Vitae	SW	Mahogany	BA	Sea Oxeye Daisy	DE	Golden Dewdrop cv "Sapphire Shower's"	PN	Wild Coffee	
CD	Pigeon Plum	KF	Black Ironwood	THR	Florida Thatch Palm	BSO	Bougainvillea "Sundown Oranger"	ELS	Golden Creeper	SM	Bay Cedar	
CE	Green Buttonwood	PE db	Alexander Palm	TR II	Florida Thatch Palm	CAM	Natal Plum	GD	Blolly	SRSS	Silver Saw Palmetto	
CE EX	Green Buttonwood	RP	Royal Palm			CA QE	Queen Emma	GP	Blanket Flower	STA	Necklace Pod	
CE S	Silver Buttonwood	HV	Spindle Palm	SHRUBS			CF	Fiddlewood	HL	Keys Lily	STJ	Dwarf Porterweed
CGU	Small Leaf Clusia	MFSS	Simpson Stopper	AG	Sea Lavender	CI	Horizontal Cocoplum	HP	Firebush	ZF	Cardboard Palm	
CO	Satinleaf	PSS	Buccaneer Palm	AP	White Swamp Milkweed	CI	Cocoplum	HPC	Dwarf Firebush	ZP	Coontie	

**PARKING LOT 1 & PERIMETER PLANTING PLANS**

SCALE AS NOTED

**NOTE:**

1. SABAL PALMS TO BE PLANTED IN A SERIES OF 3 PALMS PER GROUP.
2. SPACING WITHIN GROUP 6 TO 8', STAGGERED HEIGHTS.
3. ON FIFTH AVENUE EACH GROUP OF THREE PALMS TO BE PLANTED 50' FROM MIDDLE PALM TO MIDDLE PALM.
4. ON SHRIMP ROAD EACH GROUP OF THREE PALMS TO BE PLANTED 30' FROM MIDDLE PALM TO MIDDLE PALM.



**Mitchell Planning & Design, Inc.**

15450 SE 103rd Place Road  
Ocala, Florida 32179  
352.288.0401/305.509.0966  
mitchellplanningdesign@gmail.com

**Revisions:**

12-31-14 D.D.
06-01-15 CD's
06-19-15 BLDG. DEPT.
10-05-15 BIDDING

Date: 06.01.15  
Scale: As Noted  
File: 13-BH-003  
Drawn: BM Checked: LR  
Sheet:

**LA:04**

**PERIMETER PLANTING PLAN**

SCALE: 1"=20'

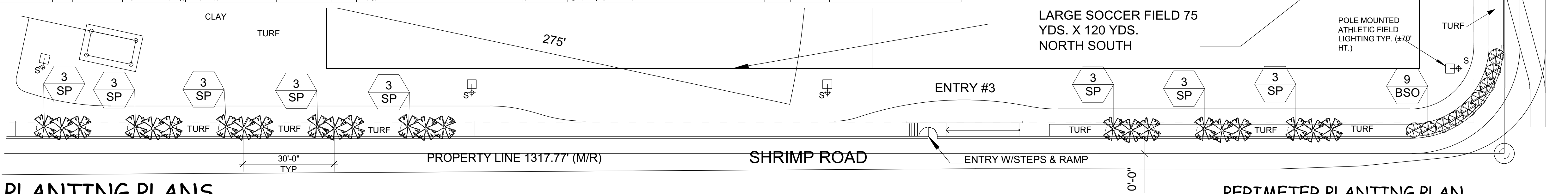

**BERNSTEIN PARK  
STOCK ISLAND  
MONROE COUNTY, FLORIDA**



**PLANT LEGEND:**

ID	Common Name	ID	Common Name	ID	Common Name	ID	Common Name	ID	Common Name	ID	Common Name
AC	Cinnecord Acacia	DR	Royal Poincianna	SP	Sabal Palm	AVT	Arbicola Trinette	CMEB	Natal Plum Emerald Blanket	MCP	Muhly Grass
BSA	Gumbo Limbo	GSA	Lignum Vitae	SW	Mahogany	BA	Sea Oxeye Daisy	DE	Golden Dewdrop cv "Sapphire Shower's"	PN	Wild Coffee
CD	Pigeon Plum	KF	Black Ironwood	THR	Florida Thatch Palm	BSO	Bougainvillea "Sundown Oranger"	ELS	Golden Creeper	SM	Bay Cedar
CE	Green Buttonwood	PE db	Alexander Palm	TR II	Florida Thatch Palm	CAM	Natal Plum	GD	Blolly	SRSS	Silver Saw Palmetto
CE EX	Green Buttonwood	RP	Royal Palm			CA QE	Queen Emma	GP	Blanket Flower	STA	Necklace Pod
CES	Silver Buttonwood	HV	Spindle Palm	SHRUBS		CF	Fiddlewood	HL	Keys Lily	STJ	Dwarf Porterweed
CGU	Small Leaf Clusia	MFSS	Simpson Stopper	AG	Sea Lavender	CIH	Horizontal Cocoplum	HP	Firebush	ZF	Cardboard Palm
CO	Satinleaf	PSS	Buccaneer Palm	AP	White Swamp Milkweed	CI	Cocoplum	HPC	Dwarf Firebush	ZP	Coontie

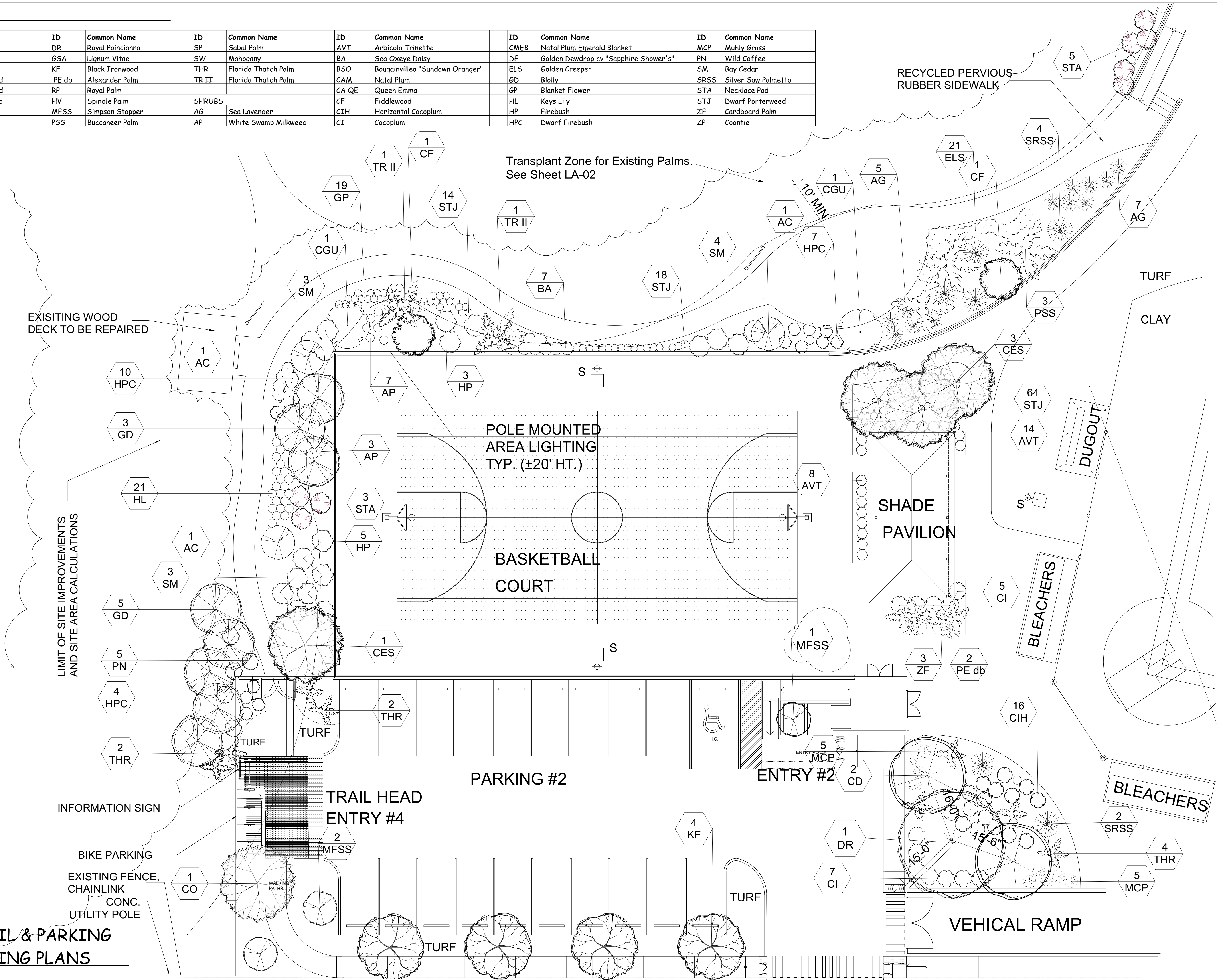

**NATURE TRAIL & PARKING  
LOT 2 PLANTING PLANS**

SCALE: 1"=10'

**BERNSTEIN PARK  
STOCK ISLAND  
MONROE COUNTY, FLORIDA**

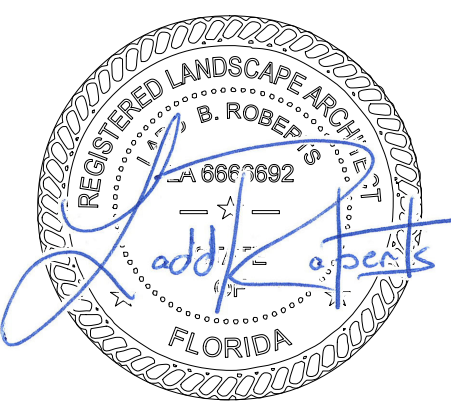

**LANDWISE  
DESIGN**

**Mitchell Planning & Design, Inc.**  
 15450 SE 103rd Place Road  
 Ocklawaha, Florida 32179  
 352.288.0401/305.509.0966  
 mitchellplanningdesign@gmail.com

Revisions:

12-31-14 D.D.
06-01-15 CD's
06-19-15 BLDG. DEPT.
10-05-15 BIDDING

Date: 06.01.15  
 Scale: As Noted  
 File: 13-BH-003  
 Drawn: BM Checked: LR  
 Sheet:

**LA:05**



**PLANT SCHEDULE:**

TREES AND PALMS						
ID	Quantity	Latin Name	Common Name	Spacing	Scheduled Size	Notes
AC	3	Acacia choriophyllia	Cinnecord Acacia	As Shown On Drawing	6-8' PH, 2" cal. min	Yellow Florwer, Butterfly attractor, fragrant
BN	1	Bismarckia nobilis "Silver"	Silver Bismark Palm	As Shown On Drawing	12 - 14', PH	Florida #1, Specimen
BSA	4	Bursera simaruba	Gumbo Limbo	As Shown On Drawing	14-16', PH, 5" cal.	Florida #1, Native Tree
CD	11	Coccoloba diversifolia	Pigeon Plum	As Shown On Drawing	14-16', PH, 5" cal.	Florida #1, Native Tree
CE	2	Conocarpus erectus	Green Buttonwood	As Shown On Drawing	14-16', PH, 5" cal.	Florida #1, Native Tree
CE EX	3	Conocarpus erectus	Green Buttonwood	As Shown On Drawing	Existing	Existing to remian, requires Tree Protection Zone
CES	4	Conocarpus erectus sericeus	Silver Buttonwood	As Shown On Drawing	14-16', PH, 5" cal.	Florida #1, Native Tree
CGU	2	Clusia guttifera	Small Leaf Clusia	As Shown On Drawing	6-8' PH, 2" cal. min	Native, Florida #1, Butterfly attractor
CO	4	Chrysophyllum oliviforme	Satinleaf	As Shown On Drawing	14-16', PH, 5" cal.	Florida #1, Native Tree
DR	1	Delonix regia	Royal Poincianna	As Shown On Drawing	14-16', PH, 5" cal.	Florida #1
GSA	4	Guaicum sanctum	Lignum Vitae	As Shown On Drawing	8-10', PH, FG	Native, Florida #1
KF	5	Krugiodendron ferreum	Black Ironwood	As Shown On Drawing	14-16', PH, 5" cal.	Native, Florida #1, Add Organic Matter to back fill material
PE db	4	Ptychosperma elegans	Alexander Palm	As Shown On Drawing	18-20', PH, FG, double	Florida #1
RP	3	Royestonia regia	Royal Palm	As Shown On Drawing	14' CT, 24 OA, 20" DBH	Native, Florida #1,
HV	2	Hyophorbe verschaffeltii	Spindle Palm	As Shown On Drawing	6-8', PH	Florida #1, Field Grown
MFSS	6	Myrcianthes graqrans var. "Simpson Stopper"	Simpson Stopper	As Shown On Drawing	6-8', PH, standard	Fragrant Native, Specimen, Florida #1
PSS	3	Pseudophoenix sargentii	Buccaneer Palm	As Shown On Drawing	6-8', PH	Florida #1
SP	53	Sabal Palmetto	Sabal Palm	As Shown On Drawing	14 - 20' OA Varied	Native, staggered heights, straight trunk
SW	3	Swietenia mahagoni	Mahogany	As Shown On Drawing	14-16', PH, 5" cal.	Florida #1, Sun
THR	11	Thrinax radiata	Florida Thatch Palm	As Shown On Drawing	8-14' PH	Field grown, Florida #1, staggered heights
TR II	3	Thrinax radiata	Florida Thatch Palm	As Shown On Drawing	10-12', PH	Native, Florida #1, FG, Double
SHRUBS AND GROUND COVERS						
ID	Quantity	Latin Name	Common Name	Spacing	Scheduled Size	Notes
AG	30	Argusia Gnaphalodes	Sea Lavender	3'0" OC	18 to 24" spread, container	Native, Grey Foliage
AP	25	Asclepias perennis	White Swamp Milkweed	As Shown On Drawing	3 gal.	Butterfly attractor/life cycle plant, larval host plant
AVT	22	Arbicola variegated "Trinette"	Arbicola Trinette	2'6" OC	24 to 30" spread, container	Florida #1, Sun
BA	7	Borrchia arborescens	Sea Oxeye Daisy	2'6" OC	18 to 24" spread, container	Native, Florida #1, Yellow Flower, ground cover
BSO	9	Bougainvillea "Sundown Orange"	Bougainvillea "Sundown Oranger"	6'0" OC	15 gal., trellis	Florida Fancy
CAM	16	Carrissa macrocarpa	Natal Plum	2'6" OC	18 to 24" spread, container	Full, Florida Fancy
CA QE	2	Crinum augustum "Queen Emma"	Queen Emma	As Shown On Drawing	36 to 40" Spread, container	Accent Plant, Florida #1
CF	2	Citharexylum fruticosum	Fiddlewood	As Shown On Drawing	36 to 40" Spread, container	Native, Florida #1
CIH	71	Chrysobalanus icaco "Horizontal"	Horizontal Cocoplum	3'0" OC	18 to 24" spread, container	Native, Florida #1
CI	55	Chrysobalanus icaco	Cocoplum	4'0" OC	24 to 30" spread, container	Native, Florida #1
CMEB	88	Carrissa macrocarpa "Emerald Blanket"	Natal Plum Emerald Blanket	2'6" OC	12 to 18" spread, container	Full, Florida Fancy
DE	4	Duranta erecta	Golden Dewdrop cv "Sapphire Shower's"	As Shown On Drawing	7 gal, Standard	Native, Florida #1
ELS	80	Ernodea littoralis	Golden Creeper	2'0" OC	1 gal	Native ground cover, drought tolerant, butterfly attractor
GD	11	Guaipira discolor	Blolly	As Shown On Drawing	40 to 48", height, container	Native, Florida #1
GP	19	Gallarda pulchella	Blanket Flower	1'6" OC	1 gal	Native Groundcover, Red/Yellow Daisy Flowers, annual
HL	21	Hymenocallis latifolia	Keys Lily	2'0" OC	1 gal	Also known as "Key's Lily", Sun, Florida #1
HP	8	Hamelia patens	Firebush	As Shown On Drawing	36 to 40" Spread, container	Native, Florida #1
HPC	75	Hamelia patens "Compacta"	Dwarf Firebush	2'6" OC	12 to 18" spread, container	Native, Florida #1
MCP	55	Muhlenbergia capillaries	Muhly Grass	2'6" OC	3 gal.	Native
PN	5	Psychotria nervosa	Wild Coffee	As Shown On Drawing	18 to 24" spread, container	Native, Florida #1
SM	26	Suriana maritima	Bay Cedar	3'6" OC	24 to 30" spread, container	Native, Florida #1
SRSS	16	Serenoa repens "Silver Saw"	Silver Saw Palmetto	As Shown On Drawing	36 to 40" Spread, container	Native, Silver Form
STA	29	Sophora tomentosa	Necklace Pod	4'0" OC	18 to 24" spread, container	Native, Florida #1, sun
STJ	187	Stachytarpheta jamaicensis	Dwarf Porterweed	1'6" OC	1 gal	Native Groundcover, Purple, Butterfly attractor
ZF	3	Zamia furfuracea	Cardboard Palm	As Shown On Drawing	36 to 40" Spread, container	Florida #1
ZP	19	Zamia pulmia	Coontie	3'0" OC	18 to 24" spread, container	Native, Florida #1

**GENERAL NOTES:**

**TURF:**

1.0 Aloha Seashore Pasapalum. It is the responsibility of the Landscape contractor to field verify turf areas. There are two distinct details for turf installation depending upon whether the location is in the landscape area or Sports field, please see Details above.

1.1 All sod and synthetic turf details and specifications are for BIDDING PURPOSES ONLY. Final materials and specifications shall be determined prior to construction and shall be coordinated with Monroe County staff and project design team.

**MULCH: FloriMulch.**

1.0 Mulch shall be applied to a minimum depth of three inches in planting beds and around trees. Mulch shall taper down to soil level at the base of trees and shrubs.

1.1 During processing, raw materials shall be stacked and stored in curing piles for no less than 120 days.

1.2 Mulch shall be made entirely from the above ground portion wood and bark of the Melaleuca Quinquenervia Tree. It shall not contain more than 10% (by volume) bark and shall not contain roots or root pieces. Shreds and chips shall not be larger than 3/4 inch diameter and 1 1/2 inch in length. Mulch shall be free of weed seeds, soil and on other organic or inorganic material.

1.3 Prior to its final processing, mulch will have been inspected and certified by the Florida Department of Agriculture and Consumer Services, Division of Plant Industry, as free of burrowing nematodes. All proofs of delivery shall bear the official State of Florida stamp of inspection and verification.\*

**PLANT SCHEDULE & PLANTING DETAILS**

SCALE: 1"= AS NOTED

**TURF DETAILS:**

FOR ADDITIONAL INFORMATION SEE ADDENDUM SPECIFICATIONS.

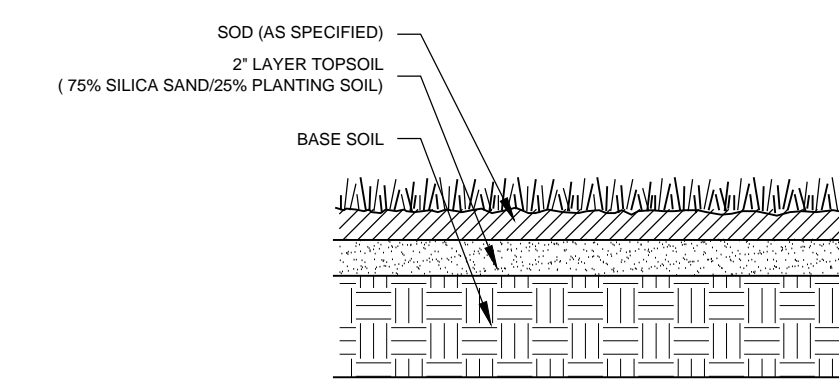

**SODDING DETAIL (Landscape)**

ALL AREAS TO BE SODDED TO RECEIVE 2" TOP LAYER OF SILICA SAND/PLANTING SOIL AS INDICATED.

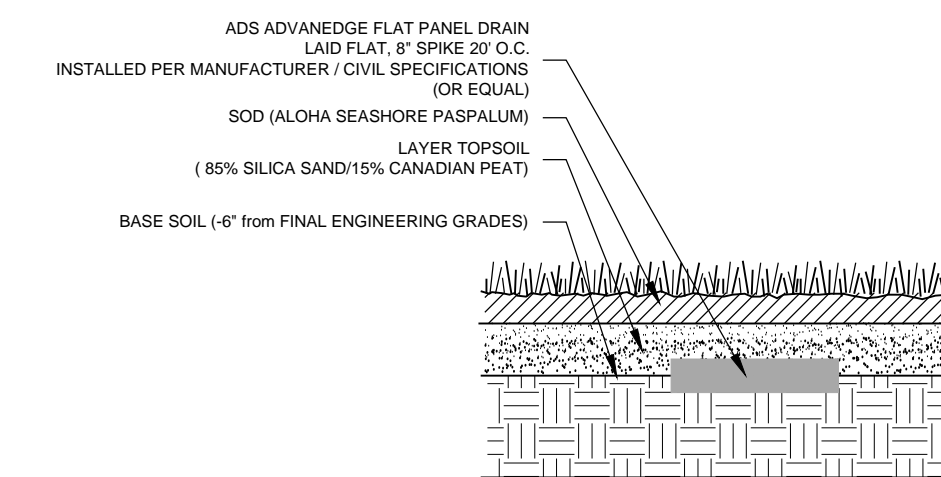

**SODDING DETAIL (Sports Field)**

INSTALL PER WRITTEN SPECIFICATIONS.

**PLANTING DETAILS:**

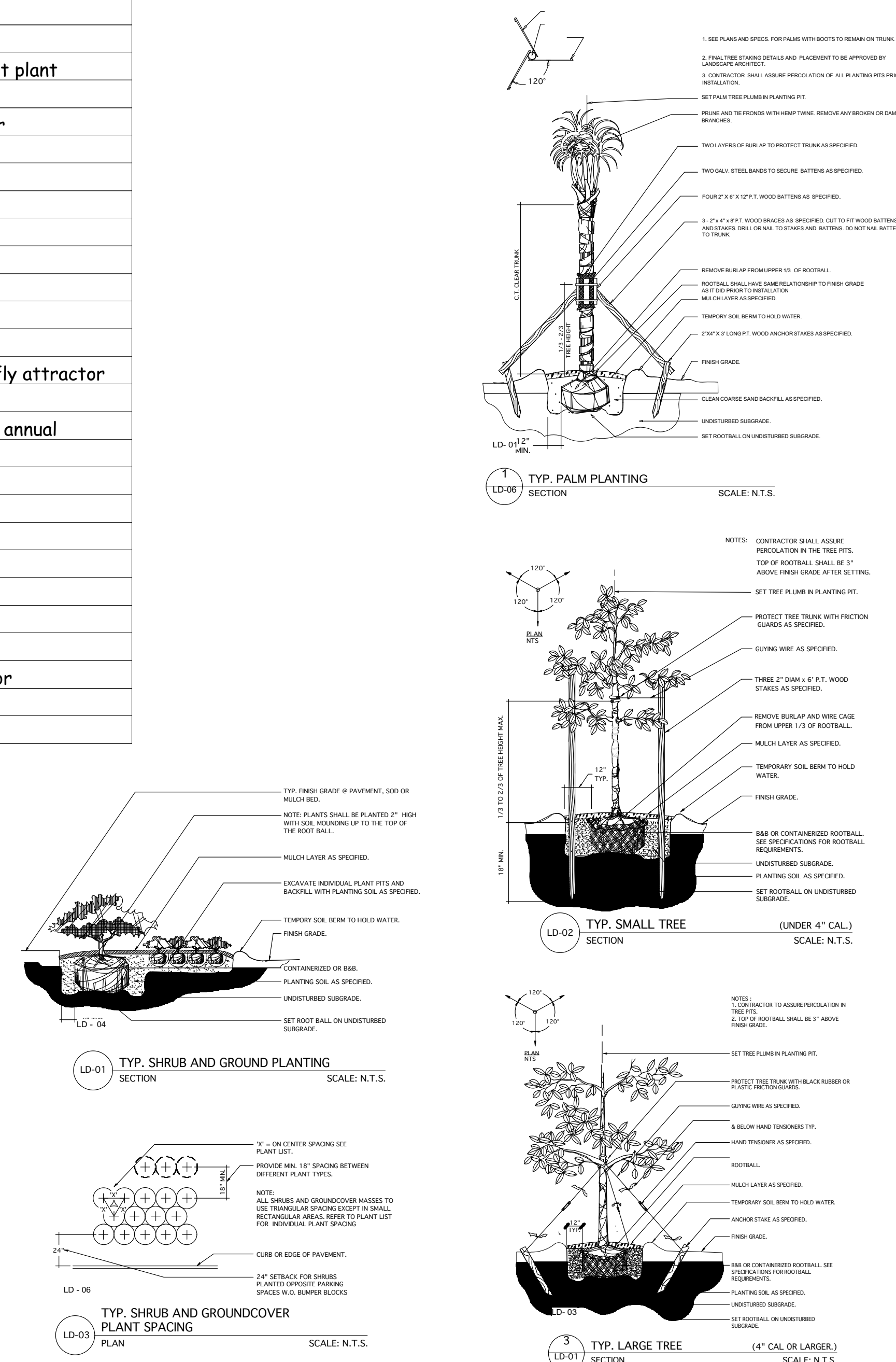

**BERNSTEIN PARK  
STOCK ISLAND  
MONROE COUNTY, FLORIDA**

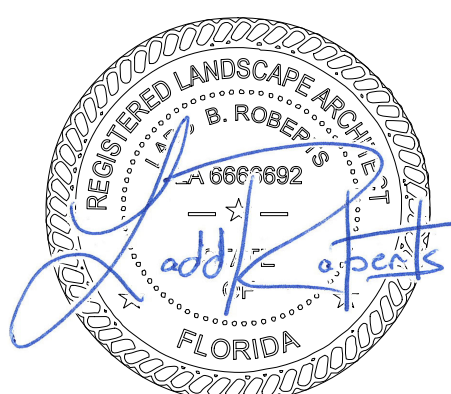

**LANDWISE DESIGN**

**Mitchell Planning & Design, Inc.**  
 15450 SE 103rd Place Road  
 Ocala, Florida 32179  
 352.288.0401/305.509.0966  
 mitchellplanningdesign@gmail.com

**Revisions:**

12-31-14 D.D.
06-01-15 CD's
06-19-15 BLDG. DEPT.
10-05-15 BIDDING

Date: 06.01.15  
 Scale: As Noted  
 File: 13-BH-003  
 Drawn: BM Checked: LR  
 Sheet:

**LA:06**



# LANDSCAPE SPECIFICATIONS AND NOTES

- LANDSCAPE NOTES ARE ALL INCLUSIVE. ALL QUESTIONS CONCERNING THE LANDSCAPE PLAN, DETAILS, AND SPECIFICATIONS SHALL BE DIRECTED TO THE LANDSCAPE DESIGNER (305) 509-0966.
- PLANT COUNT TOTALS IN THE PLANT MATERIALS LIST ARE FOR THE CONVENIENCE OF THE LANDSCAPE CONTRACTOR. BIDDERS SHALL VERIFY ALL PLANT COUNTS WITH THE SPECIFIED QUANTITIES SHOWN ON THE LANDSCAPE PLAN. THE LANDSCAPE CONTRACTOR SHALL BE RESPONSIBLE FOR ALL MATERIALS DRAWN ON THE PLAN.
- REVIEW THE GENERAL NOTES, PLANT MATERIAL LIST, PLANS, DETAILS, AND WRITTEN SPECIFICATIONS (IF PROVIDED). THE LANDSCAPE CONTRACTOR SHALL BE RESPONSIBLE FOR IMPLEMENTING THE LANDSCAPE PLAN AS DRAWN AND DIRECTED BY THE NOTES AND SPECIFICATIONS. CONTACT THE LANDSCAPE DESIGNER WHEN SIGNIFICANT FIELD CHANGES REQUIRE PLAN REVISION AND BEFORE MAKING MATERIAL SUBSTITUTIONS.
- PRIOR TO SUBMITTING THE BID, THE LANDSCAPE CONTRACTOR SHALL VISIT THE SITE TO BECOME FAMILIAR WITH EXISTING CONDITIONS.
- STAKE ALL TREES AND PALMS. SEE TREE OR PALM PLANTING DETAIL.
- ONLY PRUNE TREES AND PALMS TO REMOVE DEAD OR DAMAGED BRANCHES / FRONDS - OR TO COMPENSATE FOR ROOT LOSS CAUSED BY TRANSPLANTING. MAKE CERTAIN TO RETAIN THE PLANT MATERIAL'S NATURAL FORM WHEN PRUNING. NEVER INSTALL ANY TREE OR PALM THAT HAS HAD THE CENTRAL GROWTH LEADER DAMAGED.
- WHERE PLANTING AREAS ABOUT PAVEMENT, FINISHED SOIL LEVEL SHALL BE THREE INCHES (3") BELOW TOP OF PAVEMENT.
- ALL PLANTING AREAS SHALL RECEIVE MULCH AT THE RATE OF 1 CUBIC YARD PER 110 SF. OF AREA (THIS EQUALS A 3" MULCH DEPTH) - UNLESS OTHERWISE NOTED. SEE LANDSCAPE MATERIALS LIST FOR SPECIFICATIONS.
- KEEP MULCH SIX INCHES (6") BACK FROM ALL TREE AND PALM BASES.
- ALL REQUIRED MATERIAL SHALL BE THE RESPONSIBILITY OF THE LANDSCAPE CONTRACTOR UNTIL FINAL PROJECT ACCEPTANCE, BUT NO LESS THAN A PERIOD OF THIRTY (30) DAYS. THE CONTRACTOR SHALL BE RESPONSIBLE FOR REPLACING ANY PLANT MATERIAL WHICH IS DAMAGED DUE TO INADEQUATE GUYING OR STAKING, AT NO ADDITIONAL COST TO THE OWNER. THE CONTRACTOR SHALL REMOVE ALL STAKING MATERIALS THE END OF THE WARRANTY PERIOD AND DISPOSE OF PROPERLY OFFSITE. RELOCATED MATERIALS AND OWNER SUPPLIED MATERIALS ARE EXEMPT.  
RE-MULCHING: THE CONTRACTOR IS RESPONSIBLE FOR RE-MULCHING 3 MONTHS AND 6 MONTHS AFTER THE INITIAL INSTALLATION TO ENSURE AND MAINTAIN 3" MINIMUM THICKNESS OF MULCH TO COMPENSATE FOR COMPACTION, SETTLING AND RUN-OFF.
- AFTER THE PROJECT IS ACCEPTED, THE LANDSCAPE CONTRACTOR SHALL SUPPLY THE OWNER WITH A TWELVE (12) MONTH WARRANTY COVERING THE PLANT MATERIAL (ENSURING PLANT HEALTH AND SATISFACTORY GROWTH) AND A COMPLETE MAINTENANCE PROGRAM TO BE FOLLOWED DURING AND AFTER THE WARRANTY PERIOD. IT IS UNDERSTOOD THAT THE WARRANTY IS TO BE INCLUSIVE OF ALL LABOR, MATERIALS AND EQUIPMENT NECESSARY FOR THE REPLACEMENT OF ANY PLANT MATERIALS REQUIRED. WARRANTY IS INTENDED TO COVER DEFECTS AND UNSATISFACTORY GROWTH CAUSED BY NO FAULT OF THE OWNER. DURING THE WARRANTY PERIOD THE LANDSCAPE CONTRACTOR SHALL MAKE EVERY REASONABLE EFFORT TO REPLACE ANY DEAD, DYING OR DISEASED MATERIAL WITHIN A PERIOD OF 10 WORKING DAYS. DURING THE WARRANTY PERIOD THE LANDSCAPE CONTRACTOR WILL NOT BE HELD RESPONSIBLE FOR THEFT, VANDALISM, OR UNUSUAL ACTS OF GOD.
- THE LANDSCAPE CONTRACTOR IS ADVISED TO CALL SUNSHINE STATE ONE (1-800-432-4770) TO FIELD LOCATE EXISTING UTILITIES AND SECURE A PERMIT NUMBER PRIOR TO BEGINNING WORK. USE DUE CAUTION AROUND THE UTILITIES. THE LANDSCAPE CONTRACTOR SHALL BE HELD RESPONSIBLE FOR ANY DAMAGE DONE TO EXISTING UTILITIES.
- THE LANDSCAPE CONTRACTOR SHALL BE RESPONSIBLE FOR STAKING ALL PLANT MATERIALS IN THE FIELD IN ACCORDANCE WITH THE LANDSCAPE PLANS FOR APPROVAL BY THE OWNER PRIOR TO EXCAVATION AND INSTALLATION. THE LANDSCAPE CONTRACTOR SHALL PROVIDE STAKES OR FLAGS TO INDICATE LOCATIONS OF INDIVIDUAL PALMS/TREES. THE OWNER RESERVES THE RIGHT TO MAKE FIELD ADJUSTMENTS TO PLANT LAYOUT AS PART OF THIS REVIEW. FAILURE BY THE LANDSCAPE CONTRACTOR TO OBTAIN LAYOUT APPROVAL FROM THE OWNER PRIOR TO INSTALLATION MAY RESULT IN THE REMOVAL AND REINSTALLATION OF MATERIALS BY THE CONTRACTOR AT NO ADDITIONAL COSTS TO THE OWNER. THE LANDSCAPE CONTRACTOR SHALL CALL TO SCHEDULE THE INSPECTION FOUR (4) WORKING DAYS IN ADVANCE.
- THE OWNER WILL NOT REVIEW ANY CHANGE ORDER REQUESTS FROM THE LANDSCAPE CONTRACTOR RELATED TO 'EXTRA' WORK PERFORMED WITHOUT PRIOR WRITTEN AUTHORIZATION FROM THE OWNER.
- THE LANDSCAPE CONTRACTOR IS RESPONSIBLE FOR THE PREPARATION OF SOILS WITHIN ALL PLANTING AREAS INCLUSIVE OF PROVIDING ALL IMPORTED SOIL MATERIALS, SOIL AMENDMENTS, SOIL CONDITIONERS AND FERTILIZERS AS REQUIRED.
- THE LANDSCAPE CONTRACTOR IS RESPONSIBLE FOR ERADICATING WEEDS WITHIN THE LIMITS OF ALL PLANTING AREAS PRIOR TO BEGINNING LANDSCAPE INSTALLATION. PERENNIAL WEEDS AND GRASSES TO BE REMOVED INCLUDE, BUT ARE NOT LIMITED TO: NUT GRASS, PUNCTURE VINE, MORNING GLORY, DOG FENNEL, TORPEDO GRASS, BERMUDA GRASS, BAHIA GRASS, KIKUYU GRASS, CRAB GRASS, CARPET GRASS, SEDGE AND OTHER NOXIOUS AND/OR INVASIVE WEEDS. THE SITE IS TO BE MAINTAINED WEED FREE THROUGHOUT PLANTING OPERATIONS.
- THE LANDSCAPE CONTRACTOR IS RESPONSIBLE FOR BED PREPARATION TO SCARIFY AND LOOSEN SOILS IN ALL PLANTING AREAS TO A MINIMUM DEPTH OF 4". IN THE PROCESS OF BED PREPARATION ALL UNACCEPTABLE MATERIALS INCLUDING, BUT NOT LIMITED TO, FOREIGN DEBRIS, CONSTRUCTION WASTE, ROOTS, CONCRETE, ASPHALT, PETROLEUM AND ROCKS GREATER THAN 1/2" DIA. ON AVERAGE ARE TO BE REMOVED.
- THE LANDSCAPE CONTRACTOR SHALL PROVIDE THE OWNER WITH RECORD COPIES OF ALL SHIPPING RECEIPTS FOR ALL MATERIALS, DELIVERED TO THE PROJECT SITE. DELIVERY OF ALL FERTILIZER AND SOIL AMENDMENT MATERIALS MUST BE IN ORIGINAL, UNOPENED CONTAINER'S BEARING MANUFACTURER'S GUARANTEED CHEMICAL ANALYSIS, NAME, TRADE MARK AND CONFORMANCE WITH STATE LAW.
- THE CONTRACTOR SHALL STORE ALL MATERIALS IN AN AREA TO BE DETERMINED BY THE OWNER. ALL EXCESS STORED MATERIALS MUST BE REMOVED PRIOR TO FINAL ACCEPTANCE FROM THE OWNER.
- THE LANDSCAPE CONTRACTOR SHALL INSURE ADEQUATE VERTICAL DRAINAGE IN ALL PLANT BEDS AND PLANTERS. VERTICAL DRILLING THROUGH HARDPAN, ROCK AND / OR COMPACTED FILL SHALL BE ACCOMPLISHED TO INSURE DRAINAGE.

- THE LANDSCAPE CONTRACTOR SHALL REFER TO THE FOLLOWING REFERENCES IN DETERMINING COMPLIANCE WITH BEST PRACTICES:
    - FLORIDA NURSERYMEN AND GROWER'S ASSOCIATION (FN&A) STANDARDS.
    - FLORIDA TURF GRASS ASSOCIATION'S (FT&A) STANDARDS.
    - FLORIDA DEPARTMENT OF AGRICULTURE, BUREAU OF PLANT INDUSTRY, "GRADES AND STANDARDS FOR NURSERY PLANTS", LATEST EDITION.
    - "CABLING, BRACING AND GUYING STANDARDS FOR SHADE TREES" AS PUBLISHED BY THE NATIONAL ARBORIST ASSOCIATION (NAA).
    - ANSI: A300-1995 STANDARDS AS ESTABLISHED BY THE TREE, SHRUB AND OTHER WOODY PLANT MAINTENANCE STANDARD PRACTICE.
    - ANSI: Z60.1-AMERICAN STANDARD FOR NURSERY STOCK.
    - "STANDARD PLANT NAMES" AS ESTABLISHED BY HORTUS III.
  - THE OWNER REFERS THE RIGHT TO DEFER ANY AND ALL REVIEW RESPONSIBILITIES RELATED TO LANDSCAPE TO THE PROJECT LANDSCAPE DESIGNER OR OTHER AUTHORIZED AGENT.
  - THE CONTRACTOR IS RESPONSIBLE FOR PROTECTING AND MAINTAINING ALL PLANT MATERIAL TO REMAIN WITHIN THE LIMITS OF CONSTRUCTION AS INDICATED ON THE PLANS. EXISTING TREES TO REMAIN SHALL BE UNDISTURBED AND PROTECTED BY BARRICADES ERECTED AT THE PERIMETER OF THE TREE DRIP LINE. NO VEHICLE SHALL TRAVERSE THIS AREA NOR SHALL ANY STORAGE OF MATERIALS OR EQUIPMENT BE PERMITTED WITHIN THIS PROTECTED AREA. THE CONTRACTOR SHALL BEAR THE SOLE RESPONSIBILITY OF REPLACEMENT FOR ANY DAMAGE TO PROTECTED MATERIALS CAUSED BY CONSTRUCTION ACTIVITY WITHOUT ADDITIONAL COSTS TO THE OWNER.
  - SHOULD THE LANDSCAPE CONTRACTOR BE REQUIRED TO REPLACE ANY DAMAGED, DISEASED, DYING OR DEAD PLANT MATERIAL IT IS UNDERSTOOD THAT THE REPLACEMENT MATERIAL IS TO BE OF THE SAME SPECIES, SIZE AND QUALITY AS THAT ORIGINALLY SPECIFIED AND APPROVED BY THE OWNER. REPLACEMENT WITH ALTERNATE MATERIALS WILL BE PERMITTED ONLY WITH PRIOR WRITTEN APPROVAL FROM THE OWNER. THE CONTRACTOR WILL BE RESPONSIBLE FOR THE REMOVAL OF ALL MATERIALS AND LEAVING THE IMPACTED AREA CLEAN FOLLOWING ANY REMEDIAL ACTION.
  - AT THE END OF THE WARRANTY PERIOD THE OWNER RESERVES THE RIGHT TO HAVE THE CONTRACTOR REPLACE ANY DECLINING MATERIAL OR REQUEST AN EXTENSION OF UP TO NINETY DAYS ON ANY SPECIFIC MATERIAL.
  - THE LANDSCAPE CONTRACTOR SHALL INSTALL PLANT MATERIALS USING THE BEST HORTICULTURAL PRACTICES:
    - PROTECT PLANT MATERIAL FROM DAMAGE DURING DELIVERY, STAGING AND INSTALLATION.
    - DO NOT INSTALL PLANT MATERIALS IN TEMPERATURES LESS THAN 35 DEGREES FAHRENHEIT.
    - DO NOT INSTALL PLANT MATERIALS IN WINDS IN EXCESS OF 30 MILES PER HOUR.
    - DO NOT WILLFULLY INSTALL PLANT MATERIAL IF DEEMED SITE CONDITIONS WILL IMPEDE THE ABILITY OF PLANT MATERIAL TO THRIVE WITHOUT NOTIFYING OWNER OF CONCERNS PRIOR TO INSTALLATION.
    - PERFORM ALL WORK IN ACCORD WITH ALL APPLICABLE LAWS, CODES AND REGULATIONS INCLUSIVE OF ALL PERMITS AND INSPECTIONS REQUIRED BY FEDERAL, STATE AND LOCAL JURISDICTIONS.
    - DO NOT DROP PLANT MATERIAL.
    - LIMIT THE AMOUNT OF PLANTS TO BE INSTALLED PER DAY TO THOSE THAT CAN ADEQUATELY BE WATERED IN THE SAME DAY.
    - CAREFULLY REMOVE CONTAINERIZED PLANTS FROM THEIR CANS TO AVOID BREAKING THE ROOTBALL. CONTAINERS SHOULD ONLY BE REMOVED IMMEDIATELY PRIOR TO INSTALLATION AND PLANTS SHOULD BE IMMEDIATELY WATERED AFTER PLACEMENT.
    - PLANT MATERIAL MUST BE INSTALLED AT CORRECT ELEVATION IN RELATION TO FINISH GRADE AS INDICATED ON THE PLANTING DETAILS AFTER SETTLING. PLANTS SET AT INCORRECT ELEVATIONS WILL NEED TO BE RAISED OR LOWERED ACCORDINGLY AT NO ADDITIONAL COST TO THE OWNER.
    - PLANTING PITS FOR PALMS MUST BE EXCAVATED TO THE DIMENSIONS SPECIFIED ON THE PLANTING DETAILS. FOLLOWING PLANTING AREA IMMEDIATELY SURROUNDING PLANT IS TO BE TAMPED FIRM AND USE WATER JET TECHNIQUE TO REMOVE ALL AIR POCKETS REPEATING AS REQUIRED.
    - APPLY MULCH IN EVEN LAYER TO DEPTH SHOWN ON DETAIL. DO NOT PLACE MULCH WITHOUT THE APPROVAL OF THE OWNER THAT WEED REMOVAL AND FINE GRADING REQUIREMENTS HAVE BEEN MET.
    - CONTINUOUSLY MONITOR STATUS OF INSTALLED MATERIALS AND MAKE MODIFICATIONS, CLEAN-UPS AND REPLACEMENTS AS REQUIRED.
- BED PREPARATION & MULCH FOR EXISTING TREES & SHRUBS:**
- ALL PLANTING AREAS SHALL RECEIVE MULCH AT THE RATE OF 1 CUBIC YARD PER 110 SF. OF AREA (THIS EQUALS A 3" MULCH DEPTH) - UNLESS OTHERWISE NOTED. SEE LANDSCAPE MATERIALS LIST FOR SPECIFICATIONS.
  - KEEP MULCH SIX INCHES (6") BACK FROM ALL TREE & PALM BASES AND THREE INCHES (3") BACK FROM ALL SHRUB BASES.
  - RE-MULCHING: THE CONTRACTOR IS RESPONSIBLE FOR RE-MULCHING 3 MONTHS AND 6 MONTHS AFTER THE INITIAL INSTALLATION TO ENSURE AND MAINTAIN 3" MINIMUM THICKNESS OF MULCH TO COMPENSATE FOR COMPACTION, SETTLING AND RUN-OFF.
  - THE LANDSCAPE CONTRACTOR IS RESPONSIBLE FOR ERADICATING WEEDS WITHIN THE LIMITS OF ALL PLANTING AREAS PRIOR TO BEGINNING LANDSCAPE INSTALLATION. PERENNIAL WEEDS AND GRASSES TO BE REMOVED INCLUDE, BUT ARE NOT LIMITED TO: NUT GRASS, PUNCTURE VINE, MORNING GLORY, DOG FENNEL, TORPEDO GRASS, BERMUDA GRASS, BAHIA GRASS, KIKUYU GRASS, CRAB GRASS, CARPET GRASS, SEDGE AND OTHER NOXIOUS AND/OR INVASIVE WEEDS. THE SITE IS TO BE MAINTAINED WEED FREE THROUGHOUT PLANTING OPERATIONS.
  - APPLY MULCH IN EVEN LAYER TO DEPTH SHOWN ON DETAIL. DO NOT PLACE MULCH WITHOUT THE APPROVAL OF THE OWNER THAT WEED REMOVAL AND FINE GRADING REQUIREMENTS HAVE BEEN MET.
- FERTILIZER TABLETS:** 21 GRAM, SLOW RELEASE, 'AGRIFORM' PLANTING TABLET AS MANUFACTURED BY SIERRA CHEMICAL COMPANY THAT CONSISTS OF THE FOLLOWING PERCENTAGES BY WEIGHT : 20% NITROGEN, 10% PHOSPHORIC ACID AND 5% POTASH. APPLY AT A RATE PER MANUFACTURER'S RECOMMENDATION OR THE FOLLOWING MINIMUMS:
- ONE TABLET PER 1/2" OF TREE CALIPER.
  - ONE TABLET PER 1 GALLON SHRUB CONTAINER.
  - TWO TABLETS PER 3 GALLON SHRUB CONTAINER.
  - THREE TABLETS PER 5 GALLON SHRUB CONTAINER.
  - FOUR TABLETS PER 7 GALLON SHRUB CONTAINER.
  - FIVE TABLETS PER 10 GALLON SHRUB CONTAINER.

## LANDSCAPE TREE & PALM FERTILIZATION PROGRAM:

STARTER FERTILIZER: APPLY ATLANTIC 1308 FERTILIZER '3-24-0' MIX [www.atlanticfec.com] (305) 247-8800 OR APPROVED EQUAL AT A RATE OF: 6oz FOR 3 GALLON CONTAINER, 12oz FOR 7 GALLON CONTAINER, 2 lbs FOR 15 GALLON CONTAINER.

APPLY POLYSTART [ www.helenachemical.com ] (305) 245-0433 OR APPROVED EQUAL AT A RATE OF: (1) 5 GALLON BUCKET PER PLANT AT INSTALLATION

"PALM SPECIAL" FERTILIZER CONTAINING ADDITIONAL MAGNESIUM AND A COMPLETE MICRONUTRIENT ("TRACE MINERAL") AMENDMENT SHALL BE APPLIED FOUR (4) TIMES PER YEAR AT A RATE OF 1/2 LB OF FERTILIZER PER 2 FEET OF OVERALL HEIGHT, UP TO 15 LBS FOR MATURE SPECIMENS GREATER THAN 30' IN HEIGHT.

DRY GRANULAR FERTILIZER SHOULD BE BROADCAST UNDER THE CANOPY OF THE PALM, BUT SHOULD NOT BE PLACED UP AGAINST THE TRUNK WHERE NEWLY EMERGING ROOTS MAY BE INJURED. NITROGEN AND POTASSIUM RATES IN THE FORMULATION SHOULD BE EQUIVALENT, AND AT LEAST SOME OF BOTH ELEMENTS SHOULD BE AVAILABLE IN SLOW RELEASE FORM. THE BLEND SHOULD ALSO CONTAIN MAGNESIUM AT ABOUT 1/3 THE RATE OF THE NITROGEN AND POTASSIUM.

## LANDSCAPE MATERIALS

**ANTI-DESSICANT:** 'WILT-PRUF', 'DOWWAX', 'FOLIGARD' OR OWNER APPROVED EQUAL. APPLY BE MANUFACTURER'S RECOMMENDATIONS.

**BURLAP:** BURLAP USED IN ALL 'B&B' NURSERY STOCK MUST BE OF 100% BIODEGRADABLE, NATURAL FIBER PER ANSI Z-60.1. ABSOLUTELY NO SYNTHETIC FABRIC (i.e. LENO) WILL BE PERMITTED. ALL B&B MATERIAL SHALL BE SOURCED FROM NURSERIES ASSOCIATED WITH 'ROOTS PLUS'.

**FRICTION GUARD:** NEW, MINIMUM 1/2" INSIDE DIAMETER, REINFORCED, 2-PLY, BLACK RUBBER HOSE.

**GUY WIRE:** WIRE SHALL BE 10 GAUGE ANNEALED, GALVANIZED IRON. EACH WIRE IS TO BE DEMARCATED WITH WHITE SURVEYOR'S TAPE OR 1/2" DIA. WHITE TUBING.

**OSMOCOTE:** TIME CONTROL RELEASE FERTILIZER AS MANUFACTURED BY SIERRA CHEMICAL COMPANY.

**MULCH:** SEE PLANT SCHEDULE FOR SPECIFICATIONS.

**PEAT:** MILLED CANADIAN SPAGNUM PEAT, MIN. 90% ORGANIC, LOW SALT, LOW ALKALINITY, LIGHT BROWN AND FIBROUS, FREE OF ROCKS AND EXCESSIVE STICKS. CONSISTENT pH LEVEL BETWEEN 4.0 AND 5.0. HAVING NO PARTICLES GREATER THAN 1/2" DIAMETER.

**TOPSOIL:** HOMESTEAD TOPSOIL WITH 60/70% INLAND MUCK AND 20/30% SAND.

**PERLITE:** COARSE OR NO. 2 PERLITE, FREE OF WEEDS AND IMPURITIES.

**PRE-EMERGENT HERBICIDE:** COMMERCIAL GRADE, COMBINATION OF SURFLAN AND GALLERY WITH A DYE MARKER. APPLY PER MANUFACTURER'S RECOMMENDATIONS.

**SAND:** MEDIUM-COARSE SAND GRADE CORTONA, FREE DRAINING, WITH FINE PLUS VERY FINE RATION NOT TO EXCEED 25% BY VOLUME.

**TREE GUYS:** 'TREE SAVER' AS MANUFACTURED BY LAWSON LANDSCAPE PRODUCTS.

**TREE STAKES:** NEW, MINIMUM 2" DIA. X 8'-0" PRESSURE TREATED LODGE POLE PINE POINTED AT ONE END. A MINIMUM OF 50% OF POLE IS TO BE IMBEDDED.

**TREE TIES:** 'CINCH TIES', 32" AS MANUFACTURED BY V.I.T. PRODUCTS INC.

**TRIPLE SUPER PHOSPHATE:** GRANULAR COMMERCIAL GRADE, 42-47% P205.

**TURNBUCKLES:** 6" LONG, GALVANIZED STEEL TO BE HAND TIGHTENED.

**REWETTING AGENT:** 'SATURAITD' AS MANUFACTURED BY FLORIKA E.S.A. CORP.

# SPECIFICATIONS

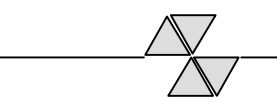

**BERNSTEIN PARK  
STOCK ISLAND  
MONROE COUNTY, FLORIDA**

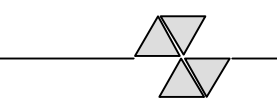
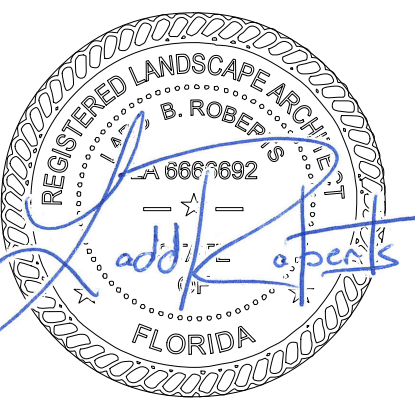

**Mitchell Planning & Design, Inc.**

15450 SE 103rd Place Road  
 Ocala, Florida 32179  
 352.288.0401/305.509.0966  
 mitchellplanningdesign@gmail.com

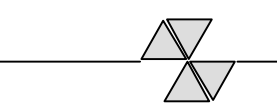

Revisions:

12-31-14 D.D.
06-01-15 CD's
06-19-15 BLDG. DEPT.
10-05-15 BIDDING /

Date:	06.01.15
Scale:	As Noted
File:	13-BH-003
Drawn:	BM
Checked:	LR
Sheet:	

**LA:07**



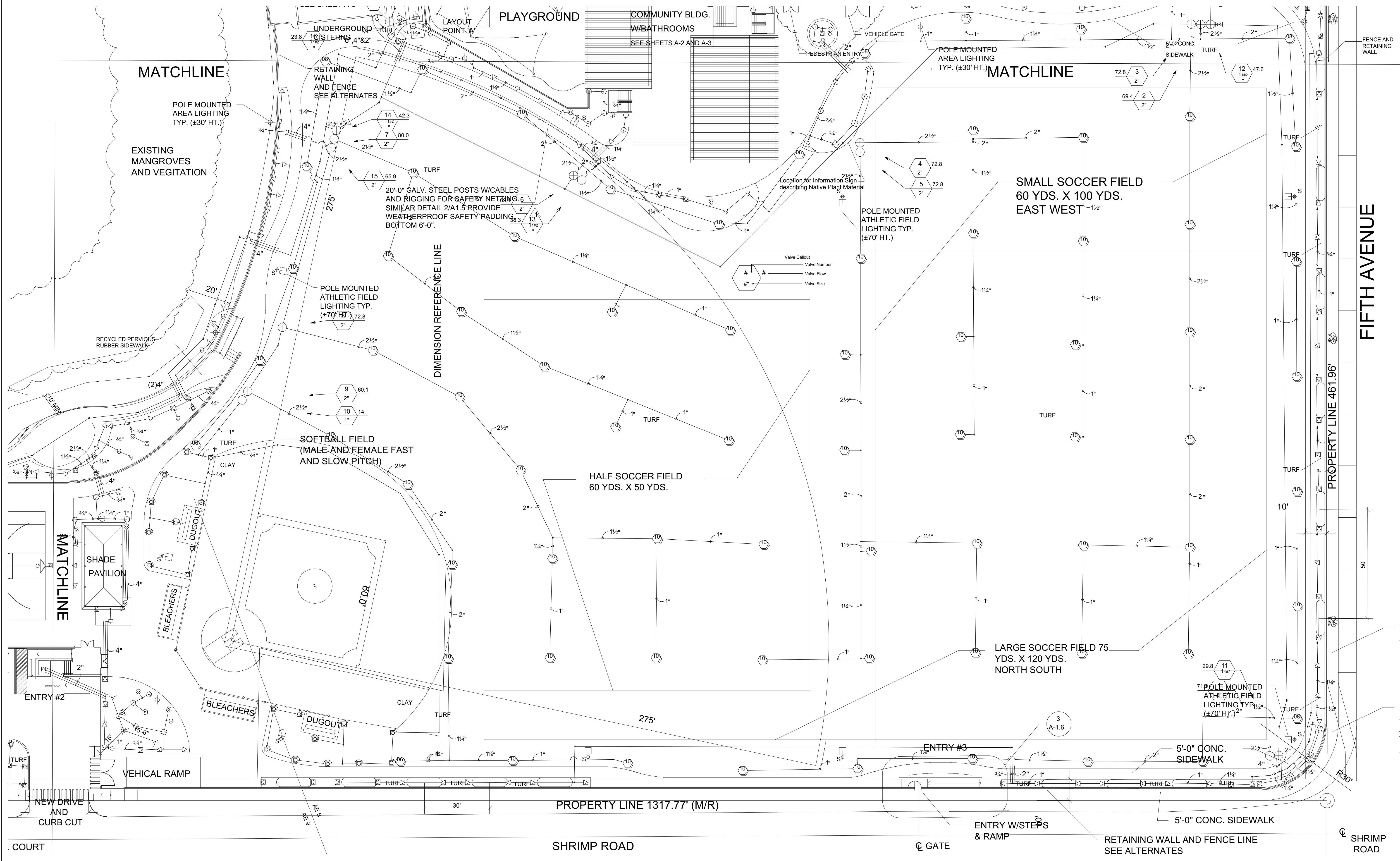
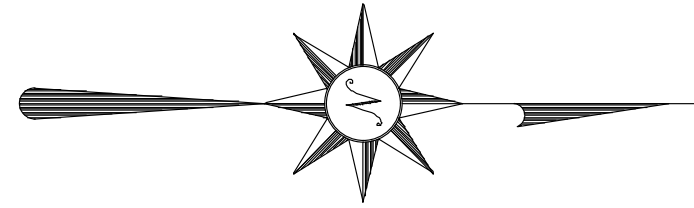

**BERNSTEIN PARK**  
**STOCK ISLAND**  
**MONROE COUNTY, FLORIDA**

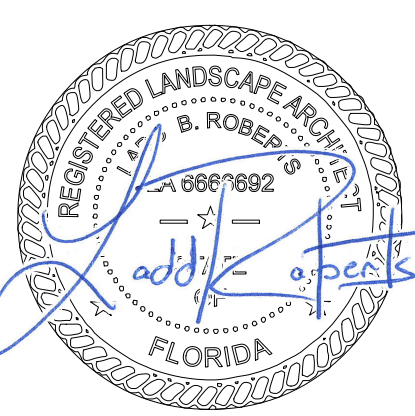

**LANDWISE**  
DESIGN

**Mitchell Planning & Design, Inc.**  
 15450 SE 103rd Place Road  
 Ocklawaha, Florida 32179  
 352.288.0401/305.509.0966  
 mitchellplanningdesign@gmail.com

Revisions:

12-31-14 D.D.
06-01-15 CD's
06-19-15 BLDG. DEPT.
10-05-15 BIDDING

Date:	06.30.15
Scale:	As Noted
File:	10-H-002
Drawn:	JAC
Sheet:	

**IRRIGATION LAYOUT BALL FIELDS AND SIDEWALK PERIMETER PLAN**

SCALE: 1"=20'

**IRR:01**







# IRRIGATION SCHEDULE

SYMBOL	MANUFACTURER/MODEL/RADIUS	QTY	ARG	PSI	GPM
☐	Rain Bird RD-06-P30-NP 15 Strip Series 55 4x15"	55	EST	30	0.61
☐	Rain Bird RD-06-P30-NP 15 Strip Series 1 4x15"	1	LCS	30	0.49
☐	Rain Bird RD-06-P30-NP 15 Strip Series 1 4x15"	1	RCS	30	0.49
☐	Rain Bird RD-06-P30-NP 15 Strip Series 13 4x30"	13	SST	30	1.21
☐	Rain Bird RD-06-P30-NP 5 Series MPR 3 5"	3	180	30	0.20
☐	Rain Bird RD-06-P30-NP 8 Series MPR 9 8"	9	180	30	0.52
☐	Rain Bird RD-06-P30-NP 8 Series MPR 10 8"	10	90	30	0.26
☐	Rain Bird RD-06-P30-NP 8 Series MPR 4 8"	4	120	30	0.35
☐	Rain Bird RD-06-P30-NP 10 Series MPR 1 10"	1	360	30	1.58
☐	Rain Bird RD-06-P30-NP 10 Series MPR 9 10"	9	180	30	0.79
☐	Rain Bird RD-06-P30-NP 10 Series MPR 13 10"	13	90	30	0.39
☐	Rain Bird RD-06-P30-NP 10 Series MPR 2 10"	2	120	30	0.53
☐	Rain Bird RD-06-P30-NP 12 Series MPR 1 12"	1	360	30	2.60
☐	Rain Bird RD-06-P30-NP 12 Series MPR 3 12"	3	180	30	1.30
☐	Rain Bird RD-06-P30-NP 12 Series MPR 7 12"	7	90	30	0.65
☐	Rain Bird RD-06-P30-NP 12 Series MPR 5 12"	5	120	30	0.87
☐	Rain Bird RD-06-P30-NP 15 Series MPR 4 15"	4	180	30	1.85
☐	Rain Bird RD-06-P30-NP 15 Series MPR 11 15"	11	90	30	0.92
☐	Rain Bird RD-06-P30-NP 15 Series MPR 2 15"	2	120	30	1.23
☐	Rain Bird RD-06-P30-NP 8 Series VAN 2 8"	2	Adj	30	
☐	Rain Bird RD-06-P30-NP 10 Series VAN 1 10"	1	Adj	30	
☐	Rain Bird RD-06-P30-NP 12 Series VAN 1 12"	1	Adj	30	
☐	Rain Bird RD-12-P30-NP 15 Strip Series 27 4x15"	27	EST	30	0.61
☐	Rain Bird RD-12-P30-NP 15 Strip Series 1 4x15"	1	LCS	30	0.49
☐	Rain Bird RD-12-P30-NP 15 Strip Series 3 4x15"	3	RCS	30	0.49
☐	Rain Bird RD-12-P30-NP 15 Strip Series 20 4x30"	20	SST	30	1.21
☐	Rain Bird RD-12-P30-NP 5 Series MPR 1 5"	1	180	30	0.20
☐	Rain Bird RD-12-P30-NP 8 Series MPR 8 8"	8	180	30	0.52
☐	Rain Bird RD-12-P30-NP 8 Series MPR 11 8"	11	90	30	0.26
☐	Rain Bird RD-12-P30-NP 8 Series MPR 1 8"	1	120	30	0.35
☐	Rain Bird RD-12-P30-NP 10 Series MPR 4 10"	4	180	30	0.79
☐	Rain Bird RD-12-P30-NP 10 Series MPR 4 10"	4	90	30	0.39
☐	Rain Bird RD-12-P30-NP 10 Series MPR 5 10"	5	120	30	0.53
☐	Rain Bird RD-12-P30-NP 12 Series MPR 5 12"	5	180	30	1.30
☐	Rain Bird RD-12-P30-NP 12 Series MPR 8 12"	8	90	30	0.65
☐	Rain Bird RD-12-P30-NP 12 Series MPR 5 12"	5	120	30	0.87
☐	Rain Bird RD-12-P30-NP 15 Series MPR 7 15"	7	180	30	1.85
☐	Rain Bird RD-12-P30-NP 15 Series MPR 1 15"	1	90	30	0.92
☐	Rain Bird RD-12-P30-NP 10 Series VAN 4 10"	4	Adj	30	
☐	Rain Bird RD-06-P30-NP R-VAN-1724 23"	1	CST	40	0.01
☐	Rain Bird RD-06-P30-NP R-1318 17"	8	180	40	0.92
☐	Rain Bird RD-06-P30-NP R-1318 17"	8	90	40	0.46
☐	Rain Bird RD-06-P30-NP R-1724 23"	2	120	40	0.87
☐	Rain Bird RD-06-P30-NP R-1724 23"	3	90	40	0.87
☐	Rain Bird RD-06-P30-NP 5 Series Stream6 1'x10"	180	30	0.50	
☐	Rain Bird RD-06-P30-NP w/MaxjetARC/RFR09H 0.40 5"	19	90	30	
☐	Rain Bird PCT-10 Bubbler 1"	34	360	30	.17
SYMBOL	MANUFACTURER/MODEL/DESCRIPTION	QTY	PSI		
	Rain Bird 5004-MPR-NP 25"	12	45		
	Turf Rotor, 4 0" Pop-Up, Plastic Riser, Matched Precipitation Rotor (MPR nozzle), Arc and Radius as per Symbol 24 ft x 24 ft 30 ft x 30 ft 36 ft x 36 ft				

## IRRIGATION NOTES:

- THE PLANS AND DRAWINGS ARE DIAGRAMMATIC OF THE WORK TO BE PERFORMED. SOME COMPONENTS MAY BE SHOWN OUTSIDE THE WORK AREA FOR CLARITY. THE WORK SHALL BE EXECUTED IN A MANNER TO AVOID CONFLICTS WITH UTILITIES AND OTHER ELEMENTS OF CONSTRUCTION, INCLUDING LANDSCAPE MATERIALS. ALL DEVIATIONS FROM THE PLANS SHALL BE APPROVED BY THE OWNER'S REPRESENTATIVE BEFORE BEING INSTALLED. THE CONTRACTOR SHALL NOT FULLY INSTALL ANY ASPECT OF THE IRRIGATION SYSTEM AS SHOWN ON THE PLANS AND DRAWINGS, WHEN IT IS OBVIOUS IN THE FIELD THAT OBSTRUCTIONS, GRADE DIFFERENCES, OR DISCREPANCIES EXIST THAT MIGHT NOT HAVE BEEN KNOWN DURING THE DESIGN OF THE IRRIGATION SYSTEM. IN THE EVENT THAT NOTIFICATION OF THE CONFLICT IS NOT APPROVED BY THE OWNER'S REPRESENTATIVE, THE CONTRACTOR WILL ASSUME FULL RESPONSIBILITY FOR ALL REVISIONS.
- THE IRRIGATION SYSTEM SHALL BE INSTALLED IN ACCORDANCE WITH THE PLANS, IRRIGATION SYSTEM SPECIFICATIONS AND ALL CONTRACT DOCUMENTS. THE CONTRACTOR SHALL COMPLY WITH ALL PREVAILING LOCAL CODES, ORDINANCES, AND REGULATIONS.
- CONTRACTOR SHALL VERIFY ALL SITE CONDITIONS, INCLUDING UTILITY LOCATIONS, BEFORE INSTALLATION OF THE IRRIGATION SYSTEM. ALL UTILITIES AND STRUCTURES MAY NOT BE SHOWN ON THE PLANS - CONTRACTOR TO VERIFY. COORDINATE ALL IRRIGATION SYSTEM CONSTRUCTION WITH EXISTING AND NEW PLANTINGS TO AVOID CONFLICT OR INTERFERENCE WITH LOCATION OF PIPING, SLEEVING, CABLES, AND SERVICE UTILITIES. THE CONTRACTOR IS RESPONSIBLE FOR COORDINATING INSTALLATION WITH ALL OTHER CONSTRUCTION ON SITE, ESPECIALLY LANDSCAPE INSTALLATION. IRRIGATION SYSTEM SHALL BE RELOCATED AT NO ADDITIONAL COST FOR ANY CONFLICT WITH LANDSCAPE INSTALLATION OR ANY OTHER SITE CONSTRUCTION OR EXISTING CONDITIONS. ALL COMPONENTS THAT ARE NOT CONTAINED WITHIN THE SPECIFIC AREAS SHOWN OR CALLED OUT ON THE DRAWINGS WILL NOT BE ACCEPTED. ALL PIPING AND OTHER COMPONENTS ARE TO REMAIN WITHIN THE PROPERTY OF THE OWNER.
- WHERE EXISTING OR NEW TREES, LIGHT STANDARDS, SIGNS, ELECTRONIC CONTROLLERS AND/OR OTHER OBJECTS ARE AN OBSTRUCTION TO AN IRRIGATION SPRINKLER'S PATTERN, THE COMPONENT AND PIPING SHALL BE RELOCATED AS NECESSARY TO OBTAIN PROPER COVERAGE OF AN IRRIGATION SPRINKLER'S PATTERN. THE COMPONENT AND PIPING SHALL BE RELOCATED AS NECESSARY TO OBTAIN THE PROPER COVERAGE WITHOUT DAMAGING THE OBSTRUCTION. OWNER'S REPRESENTATIVE SHALL DETERMINE WHETHER AN OBSTRUCTION OCCURS OR NOT.
- COMPONENT SPACING ARE MAXIMUM. DO NOT EXCEED SPACING SHOWN OR NOTED ON THE PLANS. COMPONENT SPACING MAY BE ADJUSTED TO ACCOMMODATE CHANGES IN TERRAIN AND PLANTING LAYOUT AS LONG AS THE MODIFIED SPACING DO NOT EXCEED THE SPACING SHOWN IN THE PLANS, UNLESS SHOWN OTHERWISE, CONTRACTOR SHALL PROVIDE 100% COVERAGE.
- ALL MATERIALS AND EQUIPMENT SHOWN SHALL BE NEW AND INSTALLED AS DETAILED ON THE PLANS. IF THE DRAWINGS DO NOT THOROUGHLY DESCRIBE THE TECHNIQUES TO BE USED, THE INSTALLER SHALL FOLLOW THE INSTALLATION METHODS AND INSTRUCTIONS RECOMMENDED BY THEIR MANUFACTURER.
- THE LOCATION OF THE IRRIGATION MAINLINE SHALL BE IDENTIFIED IN THE FIELD AND APPROVED BY THE OWNER'S REPRESENTATIVE BEFORE INSTALLATION.
- IRRIGATION CONTRACTOR SHALL ADJUST ALL SPRINKLERS, CONTROLLER AND OTHER DEVICES TO OBTAIN SPECIFIED OPERATING PARAMETERS, INCLUDING COVERAGE, OPERATING PRESSURE, FLOW RATES AND OPERATION TIME, AS INDICATED ON THE DRAWINGS AND IN THE IRRIGATION SYSTEM SPECIFICATIONS.
- CONTRACTOR TO PROVIDE INSTALLATION SHOP DRAWINGS AND MANUFACTURER PRODUCT INFORMATION FOR ALL IRRIGATION COMPONENTS. ALL INSTALLATIONS SHALL BE AS RECOMMENDED BY MANUFACTURERS. THE QUANTITIES SHOWN IN THE LEGENDS AND SYMBOL SHEETS SHALL NOT BE USED FOR BIDDING PURPOSES. THE CONTRACTOR WILL BE RESPONSIBLE FOR CONDUCTING A COMPREHENSIVE MATERIALS TAKEOFF TO DETERMINE THE ACTUAL QUANTITIES OF MATERIAL NECESSARY TO EXECUTE THE WORK DESCRIBED IN THE DOCUMENTS.
- ALL TRENCHES SHALL BE BACKFILLED WITH CLEAN, DEBRIS-FREE MATERIALS. CLEAN SAND SHALL BE USED FOR BEDDING MATERIAL IF PARENT SOIL CANNOT BE ADEQUATELY RID OF ROCK AND OTHER EXTRANEOUS DEBRIS. PULLING PIPE SHALL BE PROHIBITED.
- ALL SOLVENT WELDING SHALL BE PRECEDED BY PRIMING OF THE FITTINGS AND PIPE AS RECOMMENDED BY THE MANUFACTURER.
- IRRIGATION CONTRACTOR TO LABEL ALL VALVE BOX COVERS WITH THE CORRESPONDING CONTROLLER ZONE NUMBER. NUMBERING SIZE 1". PROVIDE TAGS TO ALL VALVES AS SHOWN PER DETAILS.
- CONTRACTOR TO PLACE TREE MAJZETS AT OUTER EDGE OF ROOT BALL, NOT OUTER EDGE OF PLANTING HOLE.
- ALL WIRES SPLICES IN 14 GAUGE WIRE TO BE MADE WITH KING TAN WIRE CONNECTORS. ALL WIRE SHALL BE UL RATED FOR DIRECT BURIAL.
- LOCATE ALL VALVES WITHIN 5'-0" FROM EDGE OF PAVEMENT.
- ALL IRRIGATION LINES UNDER PAVEMENT SHALL BE INSTALLED WITHIN SCH 40 PVC SLEEVES AS NOTED. IRRIGATION CONTROL WIRING SHALL HAVE IT'S OWN SEPARATE SLEEVE UNLESS NOTED OTHERWISE.
- THE IRRIGATION CONTRACTOR SHALL BE DIRECTLY RESPONSIBLE FOR ALL SLEEVING, UNLESS OTHERWISE NOTED.
- ALL UNSIZED PIPE SHALL BE 3/4".
- IRRIGATION CONTRACTOR SHALL HAVE ALL ZONE FLOWS LEARNED BY THE CONTROLLER AND HAVE CONTROLLER CAPABLE OF OPERATING AUTOMATIC SHUT DOWN OF THE SYSTEM IN A EXCESSIVE FLOW EVENT.
- IRRIGATION LATERAL LINES TO BE BURIED AT A DEPTH OF 18" UNLESS NOTED OTHERWISE.
- IRRIGATION MAINLINES TO BE BURIED AT A DEPTH OF 24" UNLESS NOTED OTHERWISE.
- ALL COMPONENTS INSTALLED BY THE IRRIGATION CONTRACTOR, SHALL BE LOCATED ON THE "AS-BUILT" DRAWINGS. THE LOCATION WITH A REFERENCE TO A FIXED POINT AND DEPTH BELOW FINISH GRADE OF THE IRRIGATION MAINLINE, CONTROL VALVES AND ISOLATION VALVES SHALL BE NOTED ON THE "AS-BUILT" DRAWINGS.
- THE IRRIGATION CONTRACTOR SHALL PROVIDE THE PUMPING STATION AND CONNECT TO THE DISCHARGE PIPE OF THE CISTERN PROVIDED BY OTHERS. OWNER SHALL PROVIDE 230 VOLT SINGLE PHASE ELECTRIC SERVICE AT PUMP LOCATION. IRRIGATION CONTRACTOR SHALL BE RESPONSIBLE FOR CONNECTION OF THE ELECTRICAL SERVICE TO THE PUMP AND IRRIGATION CONTROLLER. IRRIGATION CONTROLLER TO BE INSTALLED IN PUMP STATION ENCLOSURE. IRRIGATION CONTRACTOR TO INSTALL RAIN BIRD FS200P FLOW SENSOR IN THE GROUND PRIOR TO THE FIRST CONTROL VALVE AND CONNECT TO THE IRRIGATION CONTROLLER.
- ALL MAINLINE CHANGE OF DIRECTION FITTINGS TO BE THRUST BLOCKED.

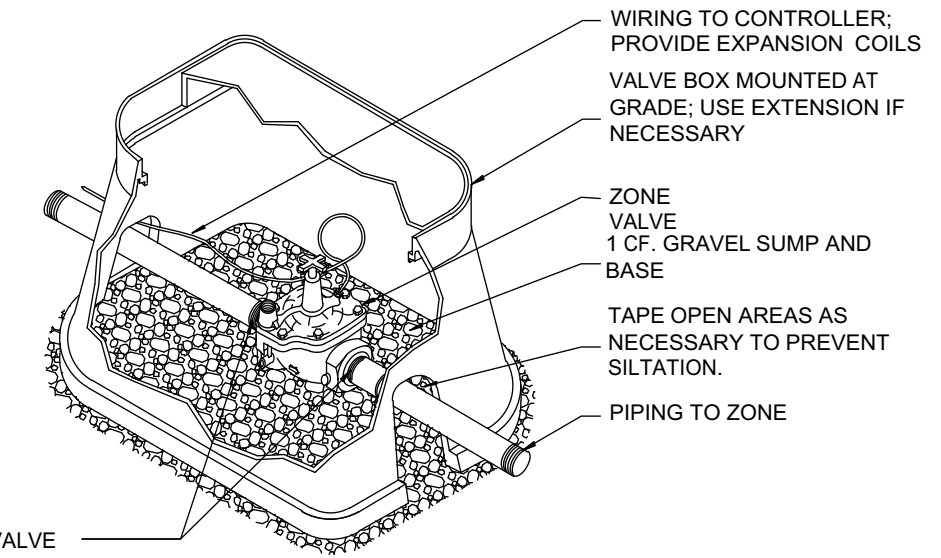
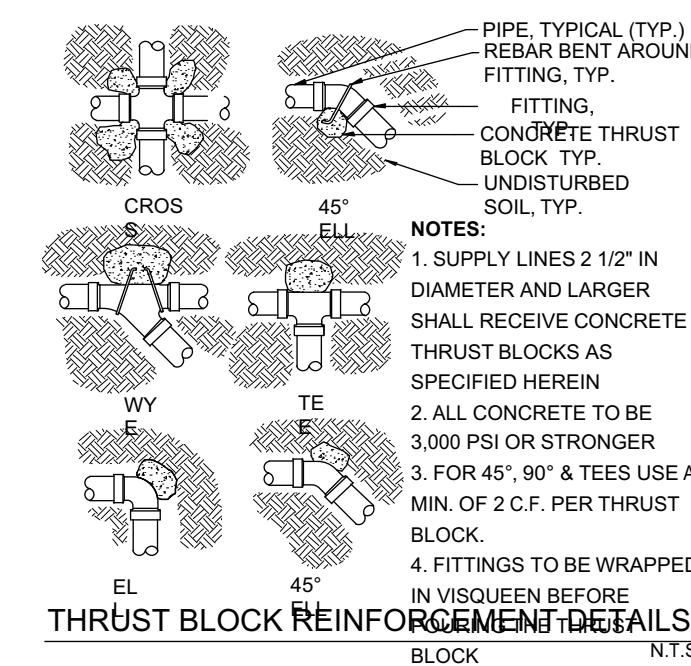
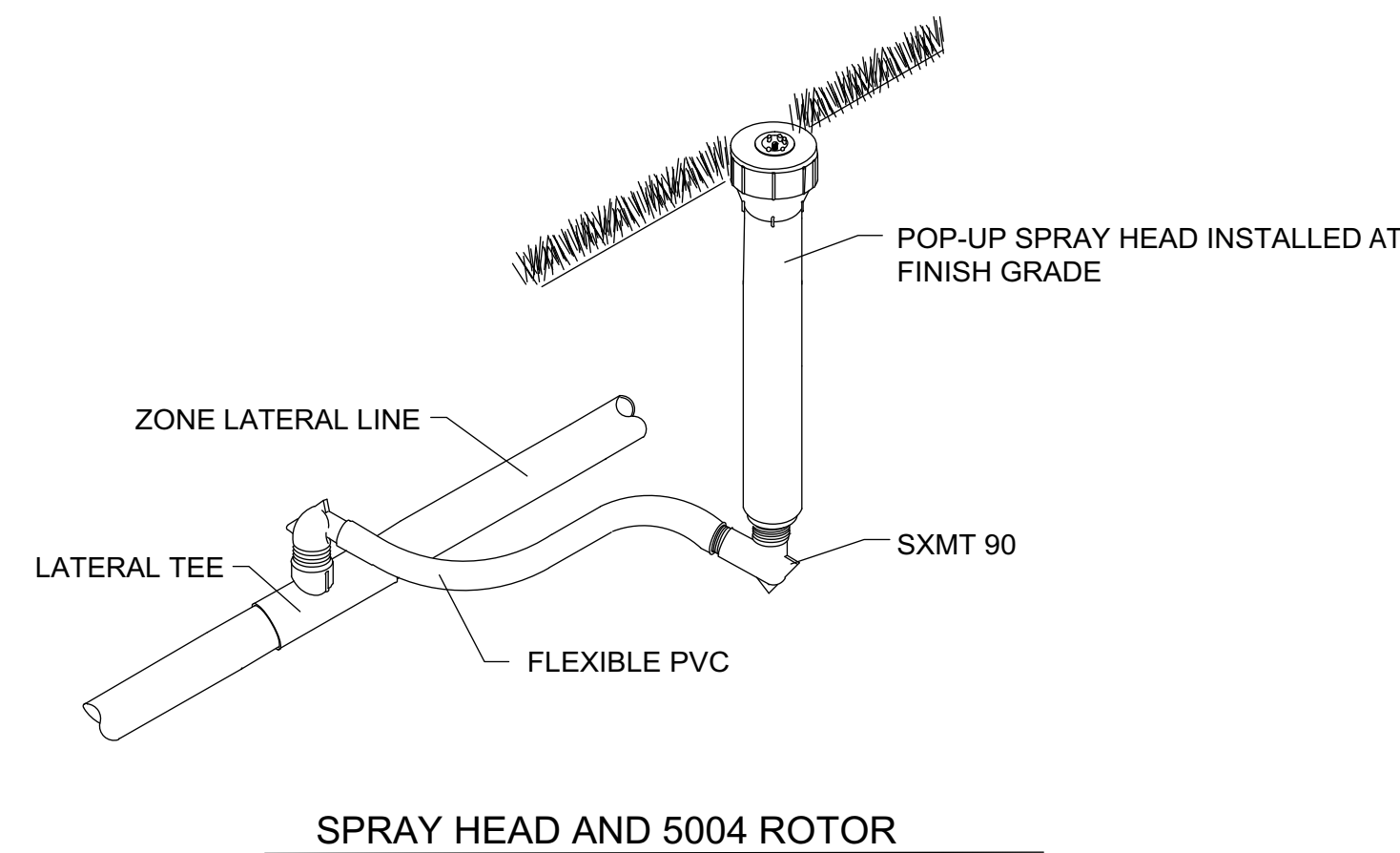

SCH. 80 NIPPLES OUT OF VALVE

INSTALL EACH VALVE TAP IN A VERTICAL ORIENTATION TO ASSURE THE PROPER VALVE DEPTH.

## ZONE VALVE INSTALLATION DETAIL

SCALE: NTS

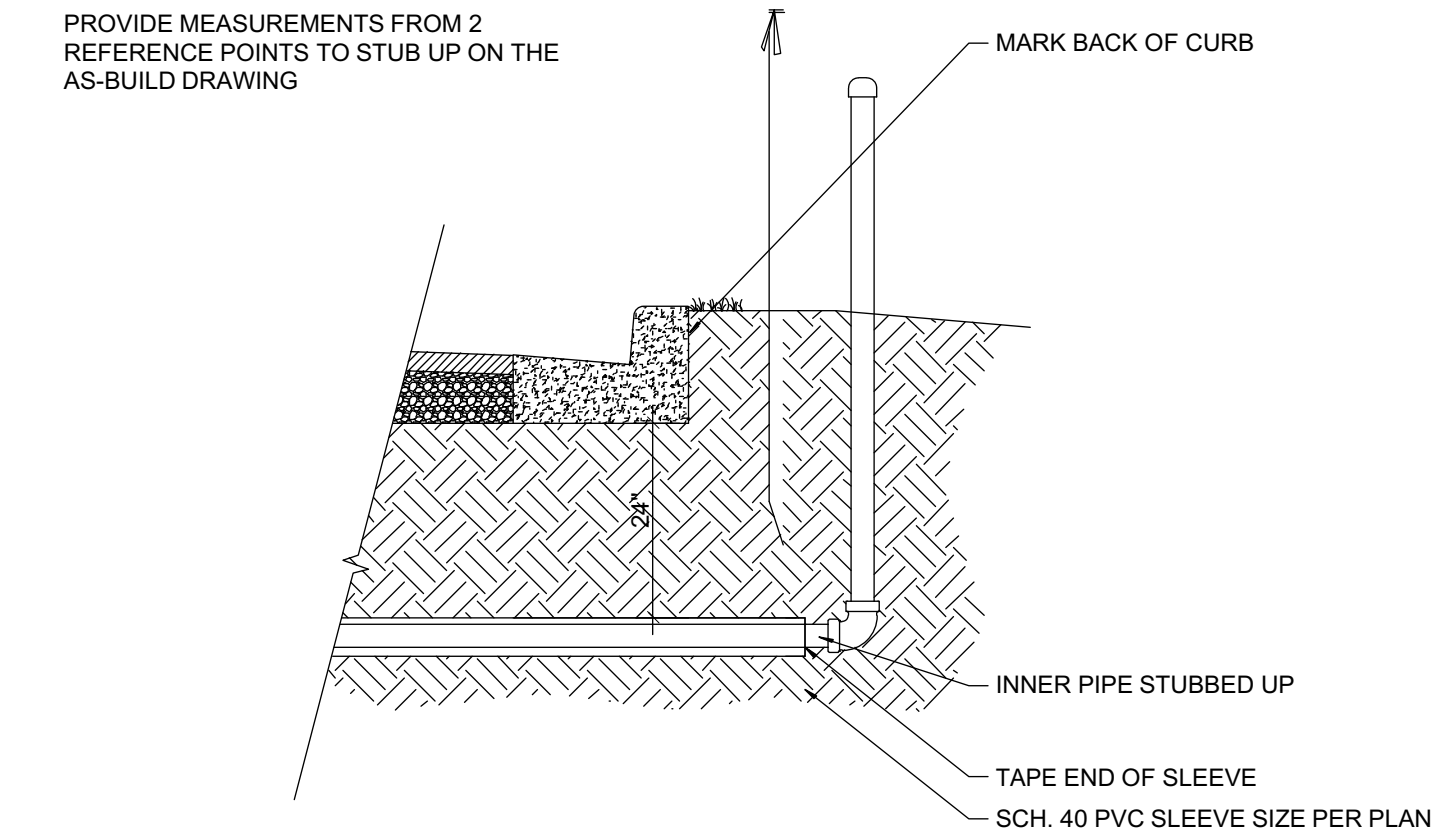

## SLEEVING ROUGH-IN DETAIL

SCALE: NTS

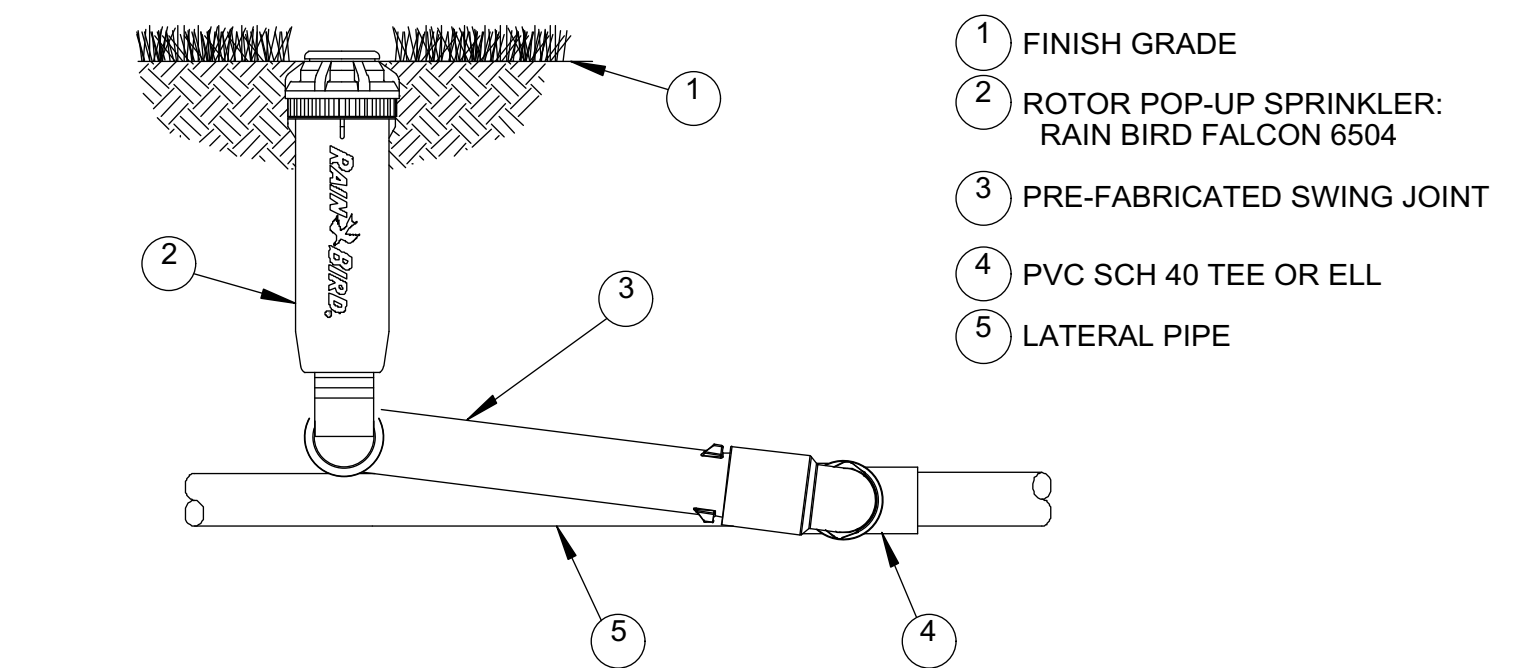

## FALCON ROTOR DETAIL

SCALE: NTS

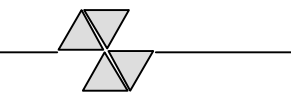
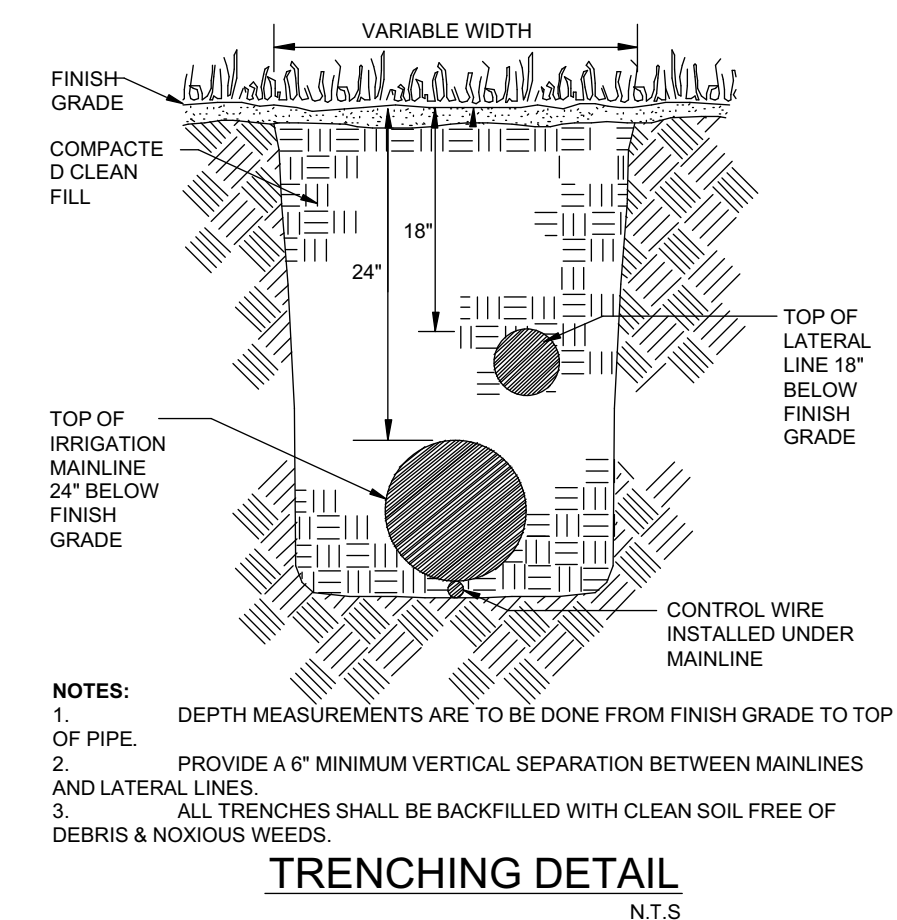

BERNSTEIN PARK  
STOCK ISLAND  
MONROE COUNTY, FLORIDA

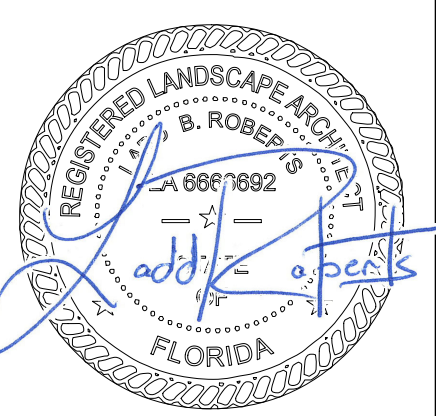

LANDWISE  
DESIGN



Mitchell Planning & Design, Inc.

15450 SE 103rd Place Road  
Ocklawaha, Florida 32179  
352.288.0401/305.509.0966  
mitchellplanningdesign@gmail.com

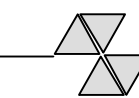

Revisions:

12-31-14 D.D.
06-01-15 CD's
06-19-15 BLDG. DEPT.
10-05-15 BIDDING

Date:	06.30.15
Scale:	As Noted
File:	10-H-002
Drawn:	JAC
Sheet:	

IRR:03