

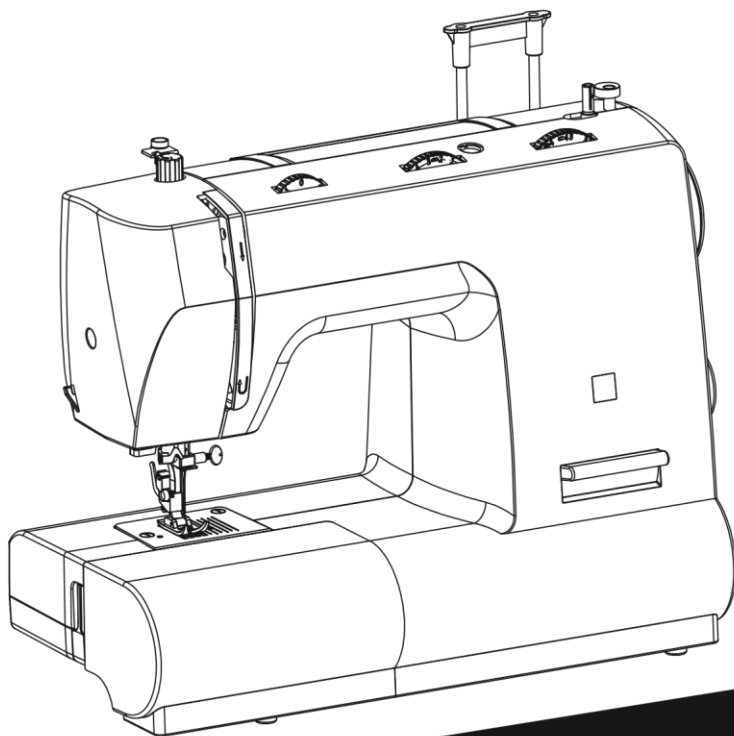

Empisal

Instruction Manual Designer 800 Sewing Machine





Congratulations on purchasing our Empisal Designer 800 Sewing Machine.

Each unit is manufactured to ensure safety and reliability. Before using this appliance for the first time, please read the instruction manual carefully and keep it for future reference.

Features of the machine include:

- 4-step buttonhole
- 108 stitch functions
- Adjustable stitch length: 4mm
- Adjustable stitch width: 5mm
- Built-in LED light
- Thread tension dial
- Three needle positions at right, middle or left
- Shuttle hook system
- Front loading bobbin
- Removal extension table
- Storage compartment
- Thread cutter
- Foldable handle
- Twin needle facility
- Easy changing presser foot
- Needle plate with guide lines
- Manual reverse lever
- Power switch
- Soft machine cover included
- Measurement guide on machine
- Adjustable pressure for presser foot
- Self-uncoupling bobbin winder
- Accessories included
- Versatile utility stitches



IMPORTANT SAFETY INSTRUCTIONS

When using an electrical appliance, basic safety precautions should always be followed, including the following:

Read all instructions before using this sewing machine.

DANGER -To reduce the risk of electric shock:

1. This appliance should never be left unattended when plugged in.
2. Always unplug this appliance from the electric outlet immediately after using and before cleaning.

WARNING -To reduce the risk of burns, fire, electric shock, or injury to persons:

1. Do not allow to be used as a toy. Close attention is **required** when this appliance is used by or near children.
2. Use this appliance only for its intended use as described in this manual. Use only attachments recommended by the manufacturer as contained in this manual.
3. Never operate this appliance if it has a damaged cord or plug, if it is not working properly, if it has been dropped or damaged, or dropped into water. Return the appliance to the nearest authorized dealer or service centre for examination, repair, electrical or mechanical adjustment.
4. Never operate the appliance with any air openings blocked. Keep ventilation openings of the sewing machine and foot controller free from accumulation of lint, dust, and loose cloth.

5. Keep fingers away from all moving parts. Special care is required around the sewing machine needle.
6. Always use the proper needle plate. The wrong plate can cause the needle to break.
7. Do not use bent needles.
8. Do not pull or push fabric while stitching. It may deflect the needle causing it to break.
9. Switch the sewing machine off ("0") when making any adjustments in the needle area, such as threading needle, changing needle, threading the bobbin, or changing presser foot, and the like.
10. Always unplug sewing machine from the electrical outlet when removing covers, lubricating, or when making any other user servicing adjustments mentioned in the instruction manual.
11. Never drop or insert any object into any opening.
12. Do not use outdoors.
13. Do not operate where aerosol spray products are being used or where oxygen is being administered.
14. To disconnect, turn all controls to the off ("0") position, then remove plug from outlet.
15. Do not unplug by pulling on cord. To unplug, grasp the plug, not the cord.

SAVE THESE INSTRUCTIONS

This sewing machine is intended for household use only.



List of contents

Parts diagram.....	2-3
Accessories.....	4
Fitting the snap-in sewing table and spool pin	5
Connecting machine to power source.....	6
Two-step presser foot lever/ Adjusting the presser foot pressure.....	7
Attaching the presser foot holder.....	8
Winding the bobbin.....	9
Inserting bobbin.....	10
Changing the needle	11
Threading the upper thread.....	12
Thread tension.....	13
Bringing up the lower thread	14
Reverse sewing/ Removing the work/ Cutting the thread.....	15
Matching needle I fabric I thread.....	16
How to choose your pattern.....	17
Straight stitching and needle position	18
Zigzag sewing.....	19
How to sew 4-step buttonholes.....	20
3-step zigzag.....	21
Stitch selection.....	22
Smocking stitch.....	23
Practical stitches	24
Darning	25
Attaching lace.....	26
Applique.....	27
Twin needle.....	28
Patch work.....	29
Maintenance	30
Trouble shooting guide.....	31-32
Storing and servicing the machine.....	33
Warranty.....	34



Parts diagram

1. Thread tension dial
2. Presser foot pressure
3. Thread take-up lever
4. Thread cutting
5. Presser foot
6. Needle plate
7. Sewing table and accessory box
8. Bobbin stopper
9. Stitch length dial
10. Stitch width dial
11. Stitch display
12. Reverse sewing lever

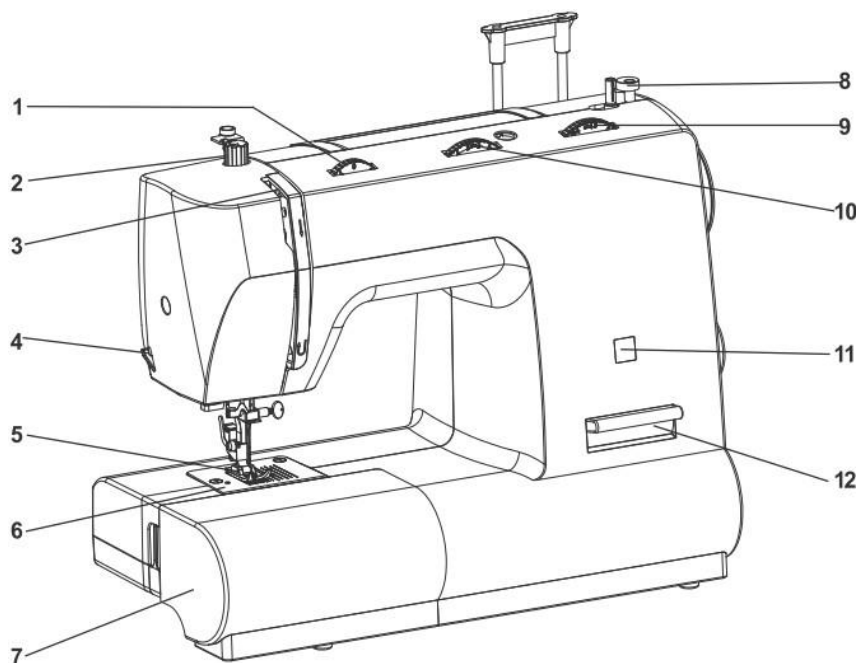



Parts Diagram

- 13. Upper thread guide
- 14. Presser foot lever
- 15. Handle
- 16. Bobbin winder
- 17. Spool pin
- 18. Handwheel
- 19. Pattern selector dial
- 20. Power switch
- 21. Main plug socket
- 22. Bobbin thread guide

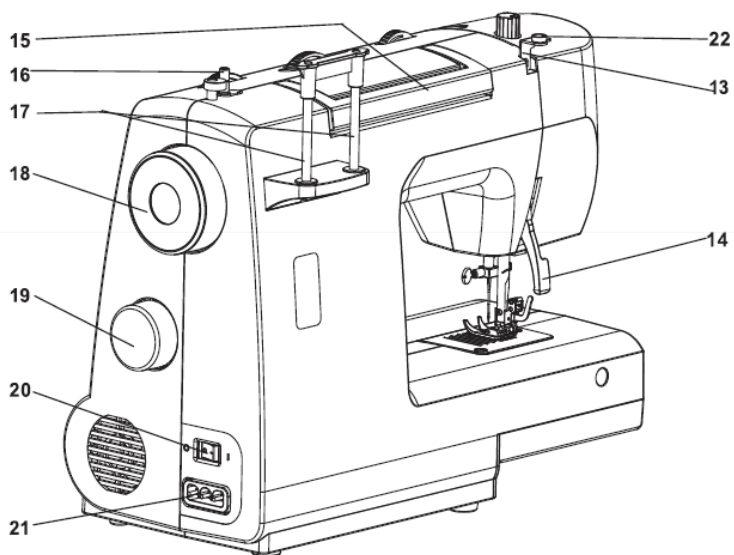



Accessories

Standard accessories

- a. 4-step Buttonhole foot
- b. Butterfly shape screwdriver
- c. Seam ripper/brush
- d. Lubricate oil
- e. Needle x 3 pcs
- f. Bobbins x 3 pcs
- g. Twin needle
- h. Screwdriver(small)
- i. Screwdriver(large)
- j. Edge/Quilting guide
- k. Embroidering plate

- l. Spool holder
- m. All-purpose foot

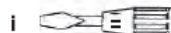
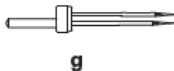
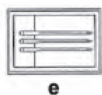
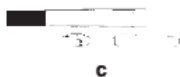
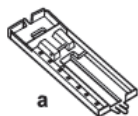



Fitting the snap-in sewing table and spool pin



Hold the snap-in sewing table horizontal, and push it in the direction of the arrow. (1)

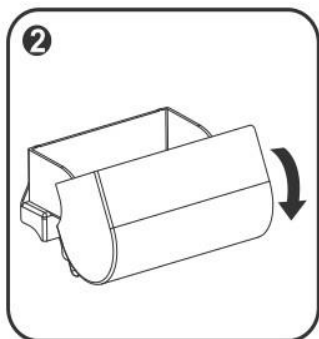

The inside of the snap-in sewing table can be utilized as an accessory box.

To open, lift up at the point of the arrow. (2)

Fitting the spool pin

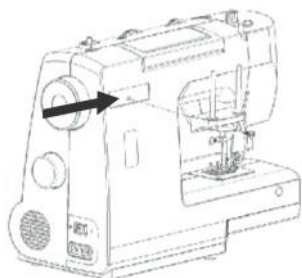

Install The Spool pin

1. Take out the spool pin from the poly foam.
2. Loosen the screw M4X18 as shown.
3. Install the spool pin as illustrated then tighten the screw.



Connecting machine to power source

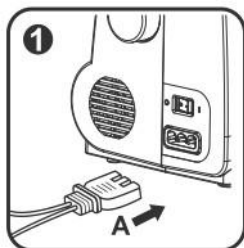

Caution:

Always make sure that the machine is unplugged from the power source and the main switch is on "OFF" when the machine is not in use and before inserting or removing parts.

- This machine is equipped with a polarized plug which must be used with an appropriate electrical outlet.
- Connect the machine to a power source as illustrated (1&2).
- The power switch is located above the terminal box. Your machine will not operate unless this switch is on "I". (1)
- The sewing light turns on automatically when the main switch is on "I".

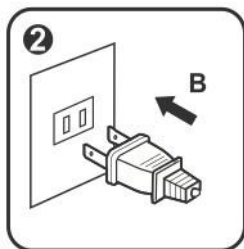

-To start the machine, press the foot control (3). The speed of the machine is regulated by the amount of pressure exerted on the foot control.

Attention:

Consult a qualified electrician if in doubt as to connect machine to power source. Unplug power cord when machine is not in use.

Only the supplied foot control should be used with this machine, use of any other control will void the warranty.

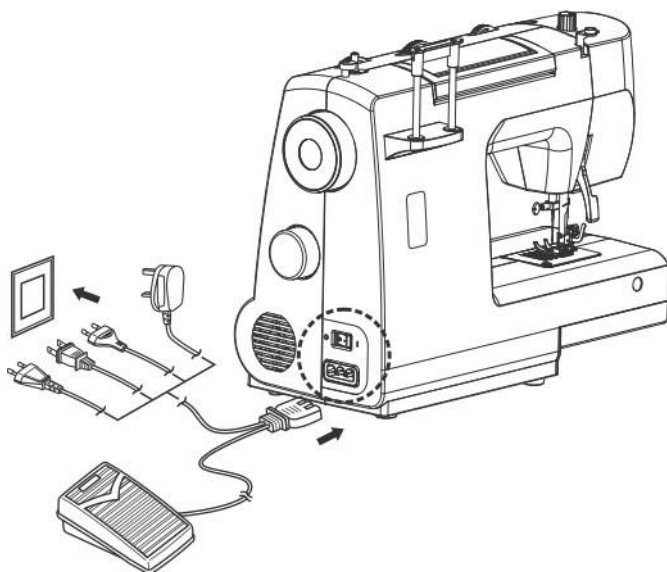



Two-step presser foot lever

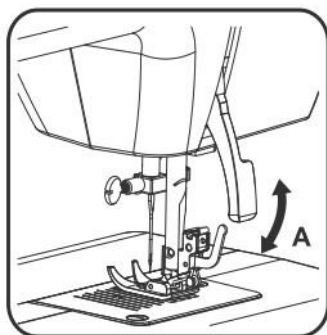

When sewing several layers or thick fabrics, the presser foot can be raised to a second stage for easy positioning of the work. (A)

Adjusting the presser foot pressure

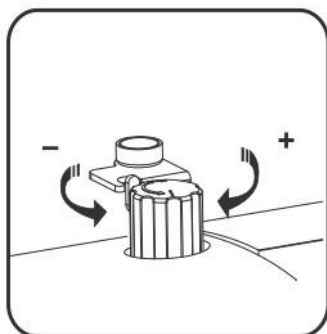

The presser foot pressure of the machine has been pre-set and requires no particular readjustment according to the type of fabric (light-or-heavy weight).

However, if you need to adjust the presser foot pressure, turn the presser foot pressure dial as shown to the left.

For sewing very thin fabric, loosen the pressure by turning the dial counter clockwise, and for heavy fabric, tighten by turning it clockwise.

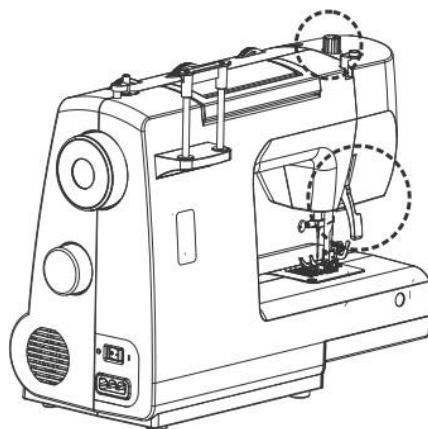

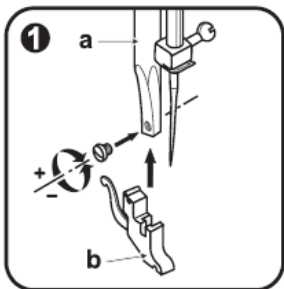

Attaching the presser foot holder

•Attention:

Turn the power switch to "OFF" before carrying out any of the operations below.

Raise the needle to its highest position and raise the presser foot lever. Attach the presser foot holder (b) to the presser foot bar (a). (1)

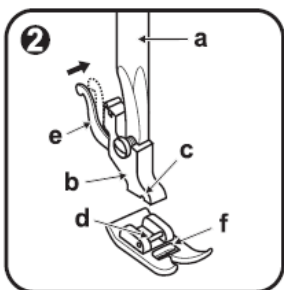

Attaching the presser foot:

Lower the presser foot holder (b) until the cut-out (c) is directly above the pin (d). (2)

Lower the presser foot holder (b) and the presser foot (f) will engage automatically.

Removing the presser foot:

Raise the presser foot.

Release the pressure foot by raising lever (e) located at the back of the foot holder. (3)

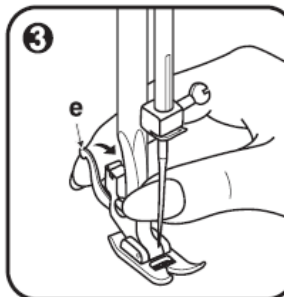

Attaching the seam guide:

Attach the seam guide (g) in the slot as illustrated. Adjust the distance as required for hems, pleats, etc..... (4)

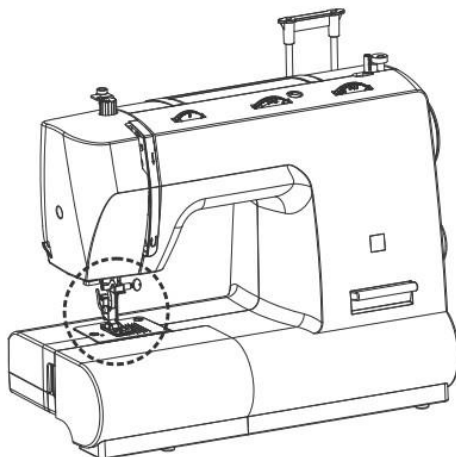
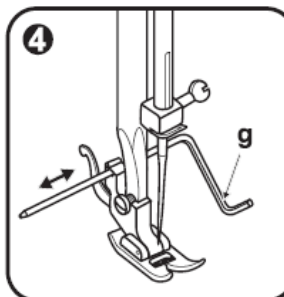



Winding the bobbin

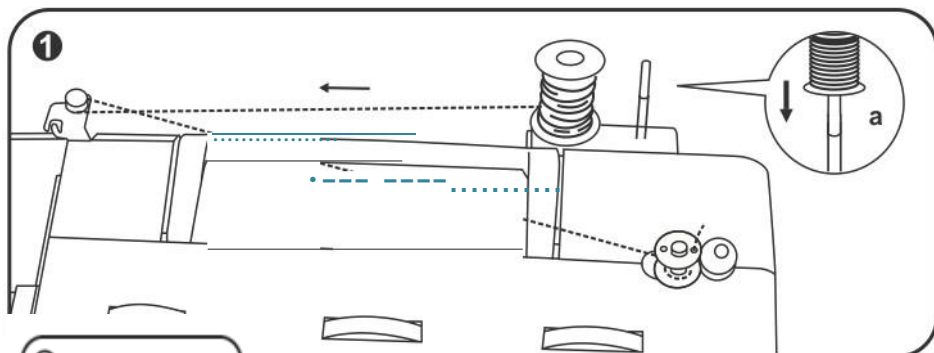

Place an empty bobbin on the bobbin winder spindle.

Take the thread from the spool through the bobbin winder tension disc. (1)

Wind the thread a few times by hand around the empty bobbin in a clockwise direction. Push the bobbin to the right towards the bobbin winding position. (2)

Press the foot control gently. The bobbin will stop winding when it is full. Push the bobbin to the left to "sewing position" and remove it.

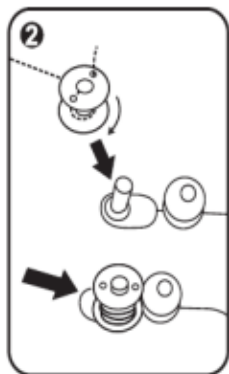

— Please Note:

When the bobbin winder spindle is in "bobbin winding" position, the machine will not sew and the hand wheel will not turn. To start sewing, push the bobbin winder spindle to the left (sewing position).

a. Spool pin

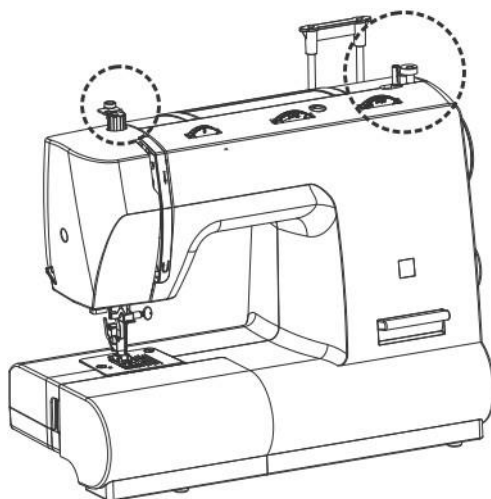



Inserting the bobbin

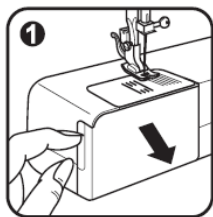

■ Attention:

Turn power switch to "OFF" before inserting or removing the bobbin.

When inserting or removing the bobbin, the needle must be fully raised.

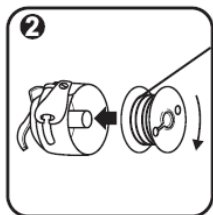

Open the hinged cover. (1)

Hold the bobbin case with one hand. Insert the bobbin so that the thread runs in a clockwise direction (arrow). (2)

Pull the thread through the slot, down and to the left until it enters the delivery eyelet (rectangular opening) under the tension spring. (3)

Hold the bobbin case by the hinged latch. (4)

Insert the bobbin case fully into the shuttle race and release the latch. Make sure that the metal finger fits into the notch at the top of the race cover. (5)

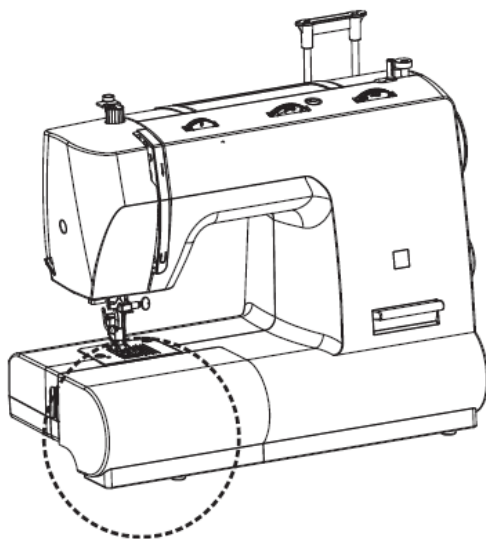
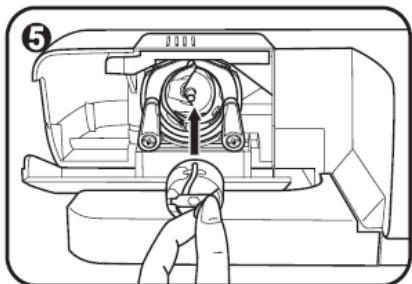
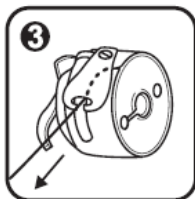



Changing the needle

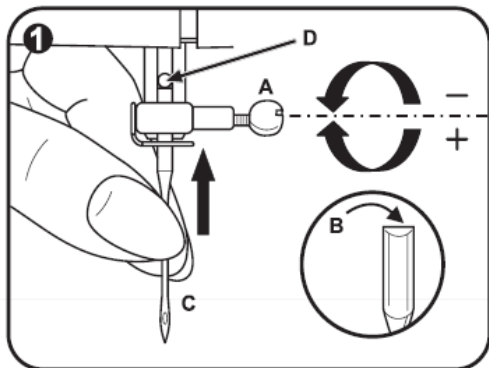

■ Caution:

Turn power switch to "OFF" before inserting or removing the needle.

Replace the needle at the first sign of thread breakage or skipped stitches. Select the correct type and size of needle for the fabric to be sewn. Turn the balance wheel towards you until the needle is at its highest position. Loosen the needle clamp screw (A) and tighten again after inserting the new needle. (1)

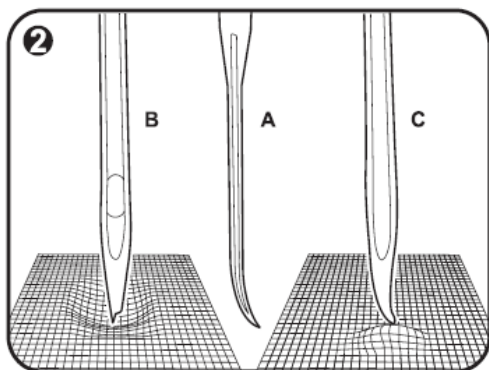

The flat side of the needle shaft should be facing away from you (B). Push the needle up (C) into the needle clamp as far as it will go (D).

Tighten the needle clamp screw firmly. The sewing needle must always be straight and sharp for smooth sewing.

Replace the needle (2) if it is bent (A), blunt (B) or the point is damaged (C).

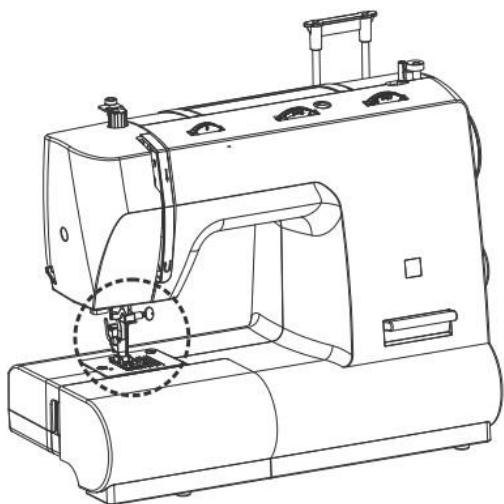

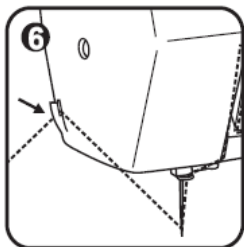
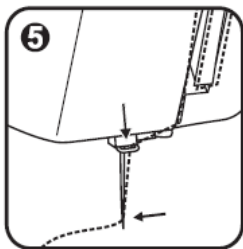
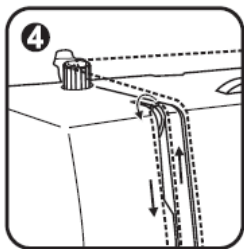
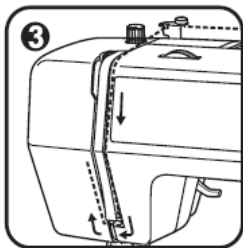
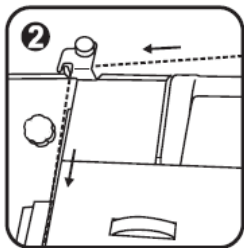

Threading the upper thread

Caution:

Before threading, turn power switch to "OFF".

Raise the needle bar to its highest position. Follow exactly the numbered threading sequence illustrated below. If you skip a step or fail to properly engage the thread in any of the thread guides, the machine will not sew properly. (1-5)

Continue to draw the thread down and into the needle bar thread guide. Insert the thread through the eye of the needle from front to back. Leave about 10 cm (4") of thread loose behind the needle. (6)

- a. Spool pin
- b. Spool holder

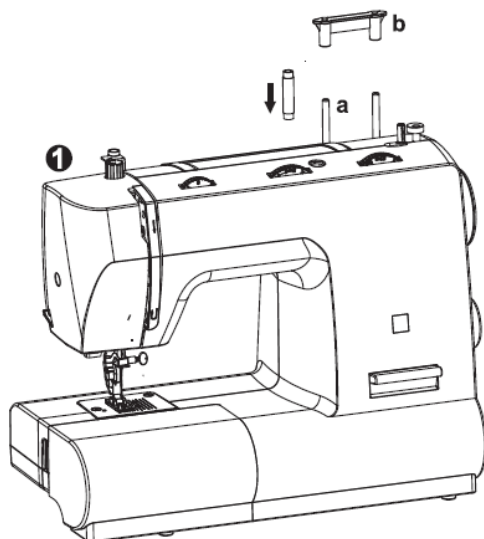



Thread tension

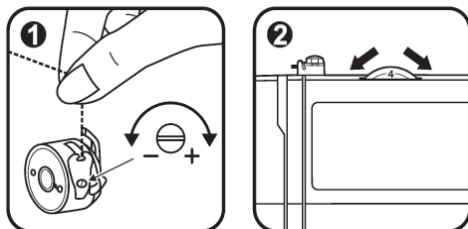

Note:

The bobbin thread tension has been adjusted at the factory and readjustment is usually not required.

Lower thread tension

To test the bobbin thread tension, remove the bobbin case and bobbin from the machine and hold the bobbin case suspended by the thread. Shake it once or twice. If the tension is correct, the thread will unwind by about an inch or two. If the tension is too tight, it will not unwind. If the tension is too loose, the thread will unwind for more than two inches.

To adjust, turn the small screw on the side of the bobbin case. (1)

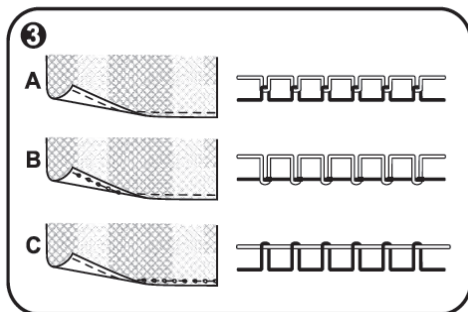

Upper thread tension

Basic thread tension setting: "4". (2)

To increase the tension, turn the dial up to a higher number. To reduce the tension, turn the dial to a lower number.

- A. Normal thread tension.
- B. Thread tension too loose.
- C. Thread tension too tight.

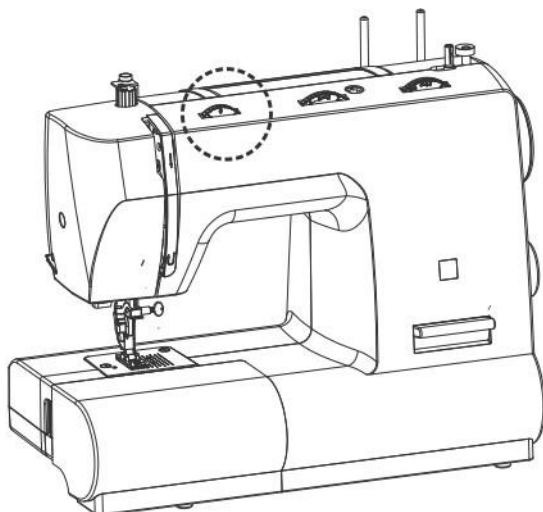



Bringing up the lower thread

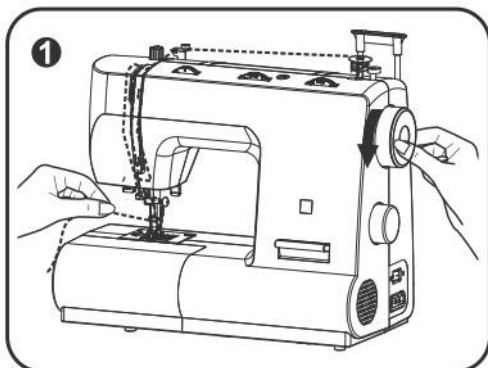

Hold the upper thread with the left hand. Turn the handwheel towards you with your right hand until the needle goes down and comes up again to its highest position. (1)

-Lightly draw the needle thread forming a loop with the bobbin thread. The upper thread should have caught the lower thread in a loop.

- Pull the needle thread toward you and the lower thread will come up from the bobbin in a large loop. (2)

Pull about 15 cm. (6") of both threads away from you under the presser foot.

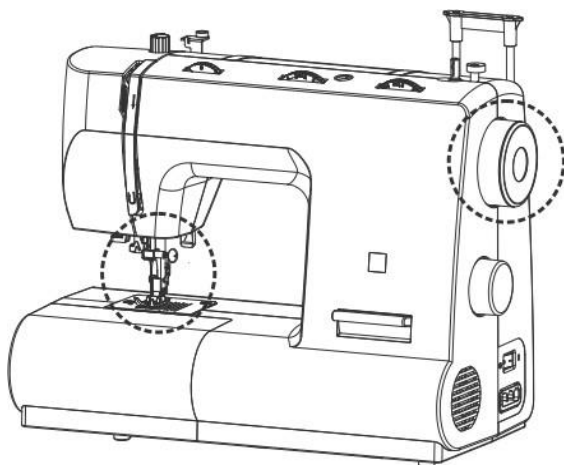
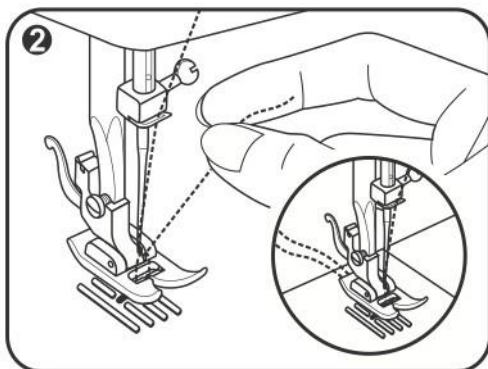



Reverse sewing

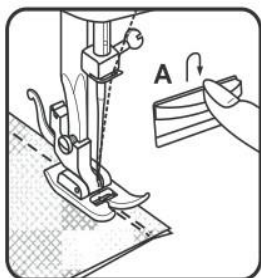

Reverse sewing is used for locking the end of seams and where reinforcement is needed. At the end of seam, press down the reverse sewing lever and touch the foot control lightly. Sew a few reverse stitches. Release the lever and the machine will sew forwards again (A).

Removing the work

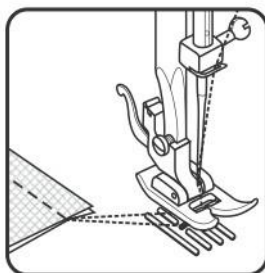

Turn the handwheel towards you to bring the thread take up lever to its highest position. Raise the presser foot and draw the fabric away from you.

Cutting the thread

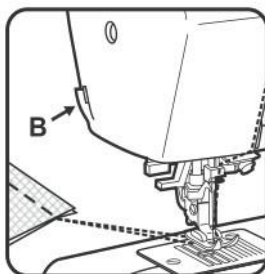

Hold the threads behind the presser foot. Using both hands, guide them to the slit (B) at the rear of the presser bar and press down to cut the thread. You can also use the thread cutter on the side of the machine.

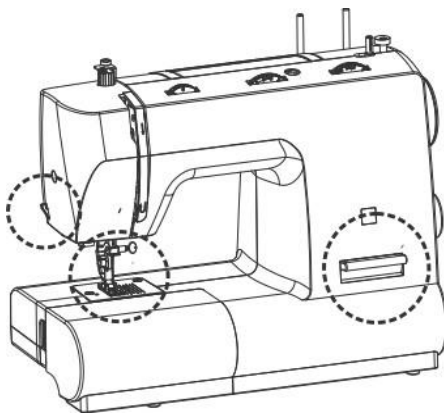



Matching needle / fabric / thread

NEEDLE, FABRIC, THREAD SELECTION GUIDE

NEEDLE SIZE	FABRICS	THREAD
9-11(65-75)	Lightweight fabrics-thin cottons, voile, serge, silk, muslin, Oiana, interlocks, cotton knits, tricots, jerseys, crepes, woven polyester, shirt & blouse fabrics.	Light-duty thread in cotton, nylon or polyester.
12(80)	Medium weight fabrics-cotton, satin, kettlclote, sailcloth, double knits, lightweight woollens.	Most threads sold are medium size and suitable for these fabrics and needle sizes. Use polyester threads on synthetic materials and cotton on natural woven fabrics for best results. Always use the same thread on top and bottom.
14(90)	Medium weight fabrics-cotton duck, woollen, heavier knits, terrycloth, denims.	
16(100)	Heavyweight fabrics-canvas, woollens, outdoor tent and quilted fabrics, denims, upholstery material (light to medium).	
18(110)	Heavy woollens, overcoat fabrics, upholstery fabrics, some leathers and vinyls.	Heavy duty thread, carpet thread. (Use heavy foot pressure -large numbers.)

IMPORTANT: Match needle size to thread size and weight of fabric

NEEDLE, FABRIC SELECTION

NEEDLES	EXPLANATION	TYPE OF FABRIC
HA x 1 15 x 1	Standard sharp needles. Sizes range thin to large. 9 (65) to 18 (110)	Natural woven fabrics-wool, cotton, silk, etc. Qiana. Not recommended for double knits.
15 x 1/705H (SIN)	Semi-ball point needle, scarfed 9 (65) to 18 (110)	Natural and synthetic woven fabrics, polyester blends. Knits-polyesters, interlocks, tricots, single and double knits. Can be used instead of 15 x 1 for sewing all fabrics.
15 x 1/705 HS (SUK)	Full ball point needle 9 (65) to 18 (110)	Sweater knits, Lycra, swimsuit fabric, elastic.
130 PCL	Leather needles. 12 (80) to 18 (110)	Leather, vinyl, upholstery. (Leaves smaller hole than standard large needle.)

Note:

1. Twin needles, can be purchased for utility and decorative work.
2. When sewing with twin needles, the stitch width dial should be set at less than "2.5".
3. European needles show sizes 65, 70, 80 etc. American and Japanese needles show size 9, 11, 12 etc.
4. Replace needle often (approximately every other garment) and / or at first thread breakage or skipped stitches.



How to choose your pattern

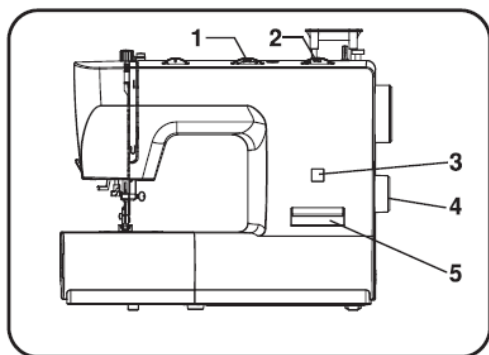

For straight stitch select pattern "A" with pattern selector dial (4). Adjust the stitch length with the stitch length dial (2). You may choose any needle position, by turning the stitch width dial (1).

For zigzag stitch, select pattern "B" with pattern selector dial (4). Adjust the stitch length (2) and stitch width {1} according to the fabric being used.

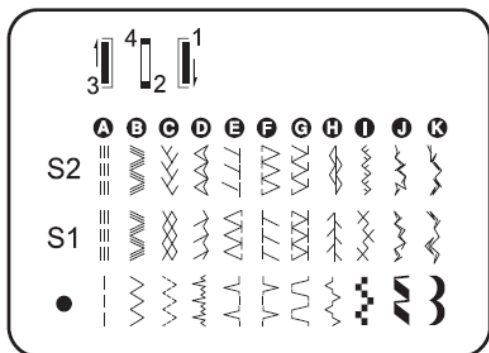

To obtain any of the patterns on the upper row, turn the stitch length dial to "S2", select the pattern desired with pattern selector dial, and adjust the stitch width with the stitch width dial.

To obtain any of the patterns on the second row, turn the stitch length dial to "S 1", select the pattern desired with pattern selector dial, and adjust the stitch width with the stitch width dial.

To obtain any of the other patterns shown in the third row on the stitch selection panel, select the letter above the stitch with the pattern selector dial. Adjust the stitch length and the stitch width with the control dials according to the result desired.

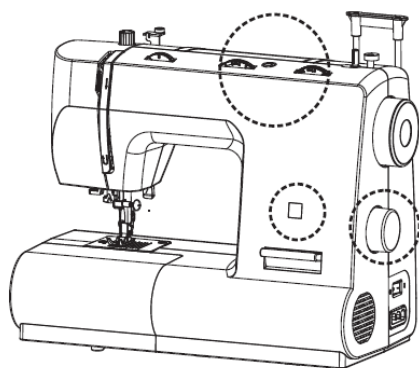

1. Stitch width dial
2. Stitch length dial
3. Stitch display
4. Pattern selector dial
5. Reverse sewing lever



Straight stitching and needle position

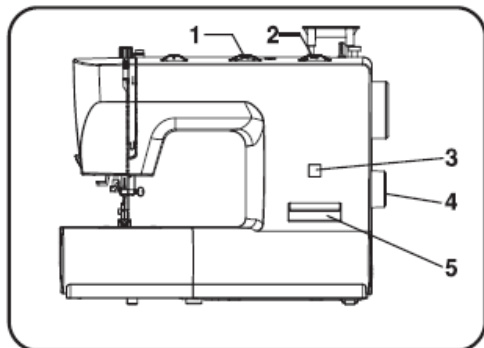

Turn the pattern selector dial so that the stitch display shows the straight stitch position.

Generally speaking, the thicker the fabric, thread and needle, the longer the stitch should be.

Choose your needle position, from left position to right needle position by changing the stitch width dial (1) from "0" to "5".

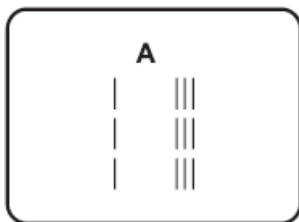

1. Stitch width dial
2. Stitch length dial
3. Stitch display
4. Pattern selector dial
5. Reverse sewing lever

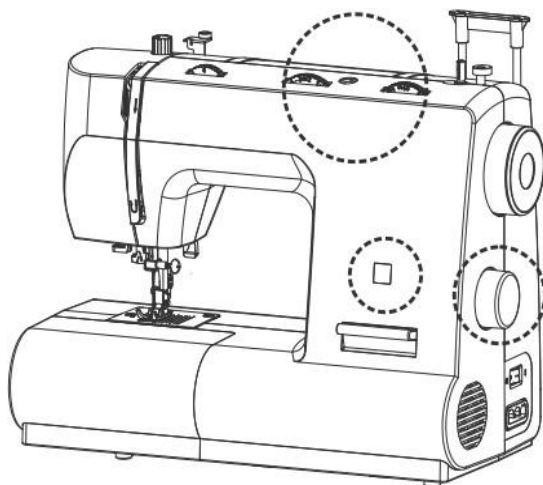



Zigzag sewing

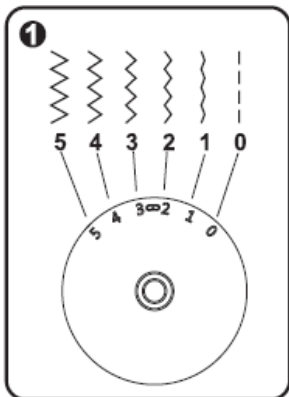

Turn the pattern selector dial to "8".

Function of stitch width dial.

The maximum zigzag stitch width for zigzag stitching is "5"; however, the width can be reduced on any pattern. The width increases as you move zigzag dial from "0" - "5". For twin needle sewing, never set the width wider than "3.5". (1)

Function of stitch length dial while zigzagging

The density of zigzag stitches increase as the setting of stitch length dial approaches "0". Neat zigzag stitches are usually achieved at "3.5" or below. (2)

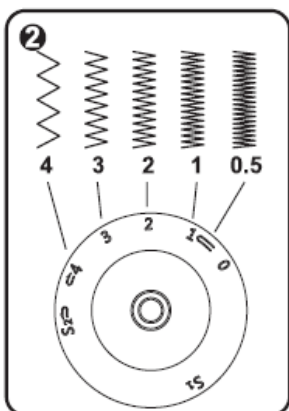

Satin stitch

When the stitch length is set between "0" - "1", the stitches are very close together producing the "satin stitch" which is used for making buttonholes and decorative stitches.

Sewing thin fabrics:

When sewing very thin fabrics, it is suggested that you use interfacing on the backside of the fabric.

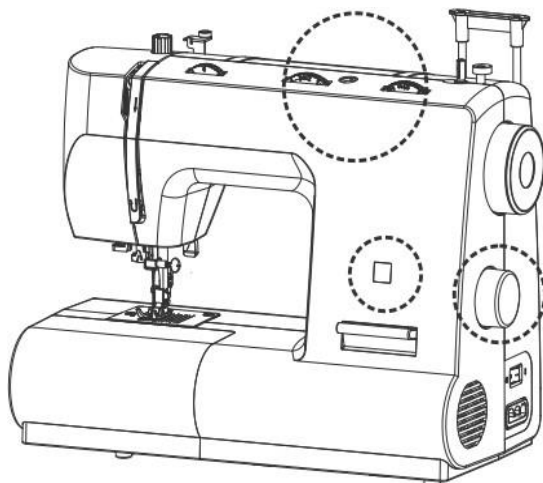



How to sew 4-step buttonholes

Prepare

Take off the all-purpose foot and attach the buttonhole foot.

Measure diameter and thickness of button and add 0.3 cm (1/8") for bar tacks; mark buttonhole size on fabric.

Place fabric under the foot, so that marking on the buttonhole foot aligns with starting marking on fabric. Lower the foot, so that the buttonhole centre line marked on the fabric aligns with the centre of the buttonhole foot.

Adjust the stitch length dial between "0.5-1" to set stitch density.

Note:

Density varies according to the fabric.

Always test sew a buttonhole on the fabric you are using to sew the buttonhole.

Follow the 4-step sequence changing from one step to another with the stitch pattern selector dial. Take care not to sew too many stitches in steps 2 and 4. Use seam ripper and cut buttonhole open from both ends towards the middle.

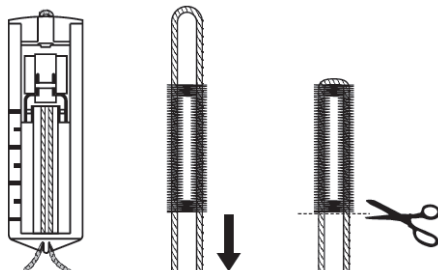
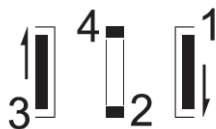
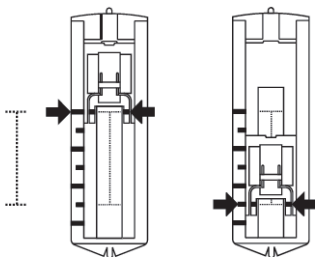
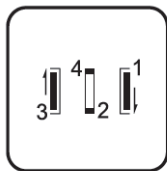
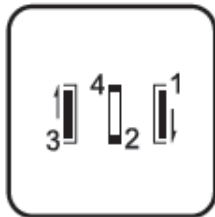
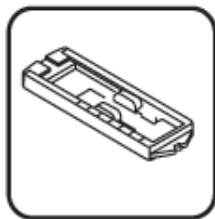



3-step zigzag

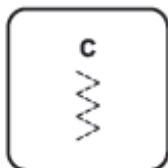

Sewing on lace and elastic, darning, mending, reinforcing edges. Set

the machine as illustrated. Pattern selector on "C".

Place patch in position. The stitch length can be shortened to produce very close stitches. (1)

When mending tears, it is advisable to use a piece of backing fabric to reinforce. The stitch density can be varied by adjusting the stitch length. First sew over the centre and then overlap on both sides. Depending on the type of fabric and damage, sew between 3 and 5 rows. (2)

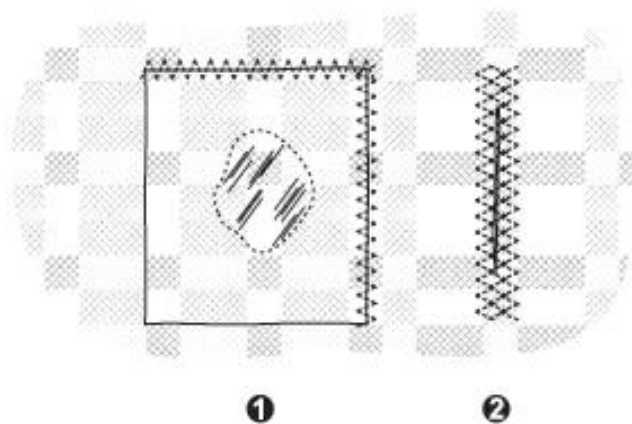



Stitch selection

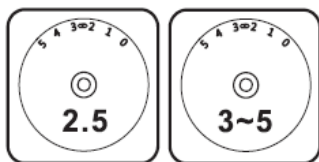

1

2

Triple straight stitch: (1/3) Pattern selector on "A". For hardwearing seams.

Turn the stitch length dial to "S1".

The machine sews two stitches forwards and one stitch backwards. This gives triple reinforcement.

Triple zigzag: (2/4) Pattern selector on "8".

For hardwearing seams, hems and decorative seams.

Turn the stitch length dial to "S1".

Adjust the stitch width dial to between "3" and "5". Triple zigzag is suitable for firm fabrics like denim, corduroy, etc.

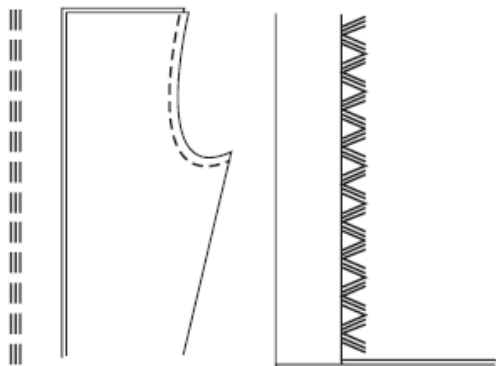

3

4



Smocking stitch

Seams, hems, T-shirts, underwear, etc. Set

the machine as illustrated.

This stitch can be used for all types of jersey as well as for woven fabrics. (1)

Sew at 1 cm (1/4") from the fabric edge and trim the surplus fabric. (2)

Pattern selector on "C".

Turn the stitch length dial to "S1".

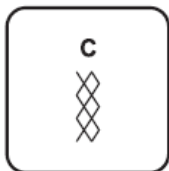

1



2



Practical stitches



Set the machine as illustrated.

Turn the switch width dial and stitch length dial to suit the fabric.



Shell hem (A)

For decorative edges.

Suitable for edges on sheer, fine and stretch fabrics. The larger stitch should go just over the edge of the fabric to create the shell effect.



Crescent stitch (B)

For a delicate edge finish along the edge of fabric.

Stitch length should be set from "0.5" - "1.0".



Rampart (C)

For flat joining seams, sewing on elastic and visible hems. This stitch can be used for firm, thicker fabrics.

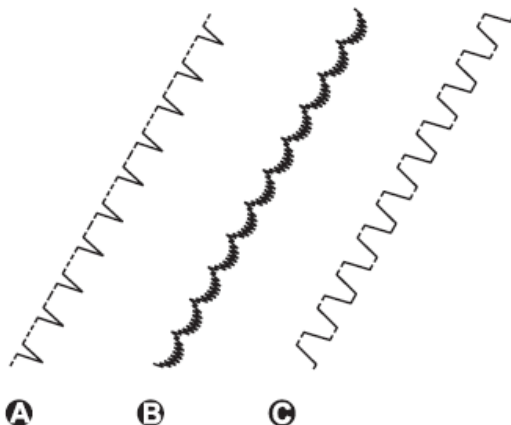



Darning



Turn stitch length dial to the desired length.

Turn stitch selector to straight stitch, centre needle position.

Position the fabric to be darned under the presser foot together with the under laying fabric to be used.

Lower the presser foot and alternately sew forward or reverse using the lever.



Repeat this motion until the area to be darned is filled with rows of stitching.



For reverse sewing instructions, see page 16.

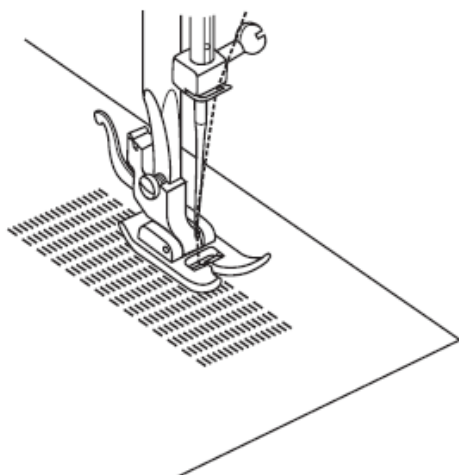
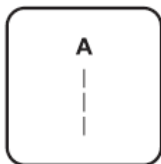



Attaching lace

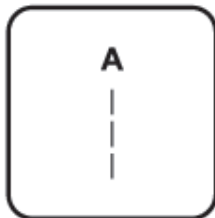

Turn stitch length dial to the desired length.

- Turn the stitch selector to straight stitch, centre needle position.
- Fold in the edge of the fabric (approximately 6 mm 1/4").
- Place the lace under the folded edge of the fabric allowing it to underlap the fabric slightly as required by the pattern of the lace.
- Sew on the edge of the fabric fold.
- You can add a decorative touch by using the satin stitch to sew the lace.

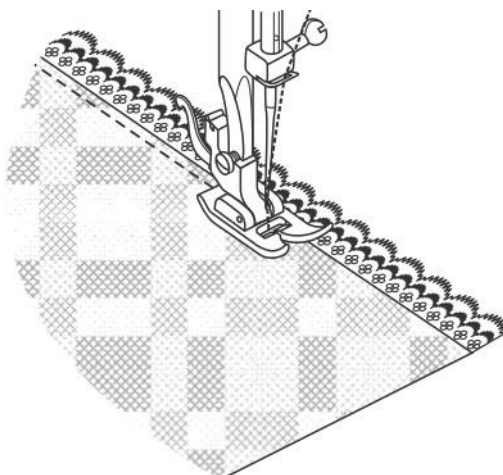



Applique

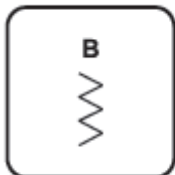

- Turn stitch length dial to the desired length.
- Turn pattern selector dial to zigzag.
- Select a narrow zigzag width.
- Cut out the applique design and baste it to the fabric.
- Sew slowly around the edge of the design.
- Trim excess material outside the stitching. Make sure not to cut any stitches.
- Remove the basting thread.
- Tie top and bottom thread under the applique to avoid unravelling.

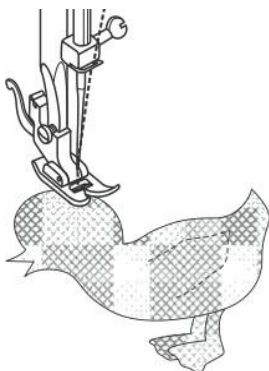



Twin needle



- Turn stitch length dial to the desired stitch length.

- Turn stitch selector to straight stitch, centre needle position, width setting "2.5".

- Make sure that the two threads used to thread the twin needle
- are of the same weight. You can use one or two colours.



- Insert the twin needle in the same way as single needle. Flat side of needle should face away from you.

- Follow instructions for single needle threading. Thread each needle separately.

- Please note:

- When sewing with twin a needle, always proceed slowly, and make sure to maintain a low speed to ensure quality stitching.

- When using twin needle on zigzag make sure the stitch width dial is set between "0" and "2.5". Do not use twin needle at setting

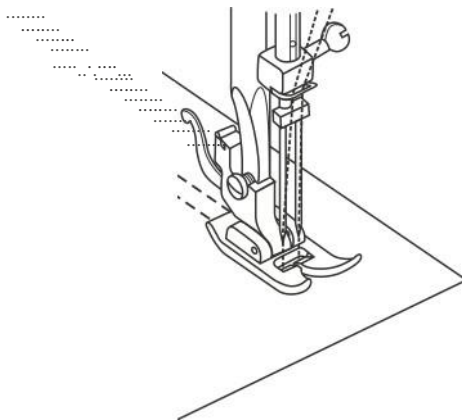
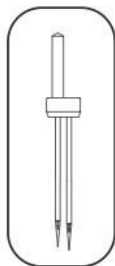
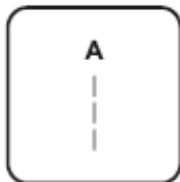



Patchwork



These stitches are used to join two pieces of fabric while leaving a space between their edges.



1. Fold over the edges of the two pieces of fabric for the hem and baste the edges to a thin piece of paper leaving a small space between them.

2. Set the Pattern selector on **"G"**.

Turn the stitch length dial to **"S1"**.

3. Stitch along the edge, pulling both threads slightly when beginning to sew.

* Use thicker than normal thread for sewing.



4. After sewing, remove the basting and the paper. Finish by tying knots on the reverse side at the beginning and the end of the seams.

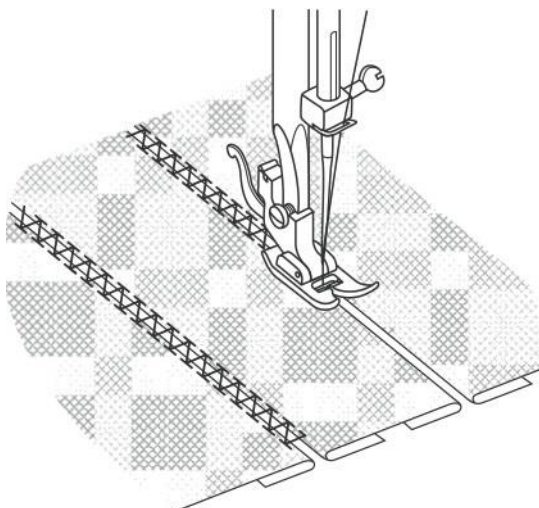
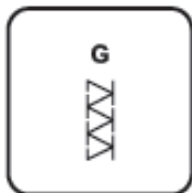



Maintenance

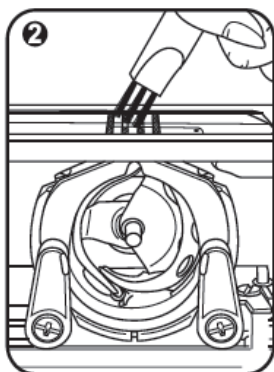
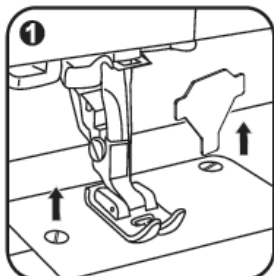

Caution:

Always make sure that the machine is unplugged from power source and the main switch is on "0" before inserting or removing any parts and before cleaning.

Remove the stitch plate:

Turn the hand wheel until the needle is fully raised. Open the hinged front cover and unscrew the needle plate screw with the screw driver. (1)

Cleaning the feed dog:

Remove the bobbin case and use the brush supplied to clean the whole area. (2)

Cleaning and lubricating the hook:

Remove the bobbin case. Snap the two hook retaining arms (a) outwards. Remove the hook race cover (b) and the hook (c) and clean with a soft cloth. Lubricate at the points (d) (1-2 drops) with sewing machine oil. Turn the hand wheel until the hook race (e) is in the left position.

Replace the hook race cover and snap back the two hook retaining arms. Insert the bobbin case and bobbin and replace the stitch plate.

Important: Fabric fluff and threads must be removed regularly. Your machine should be serviced at regular intervals at one of our service agencies.

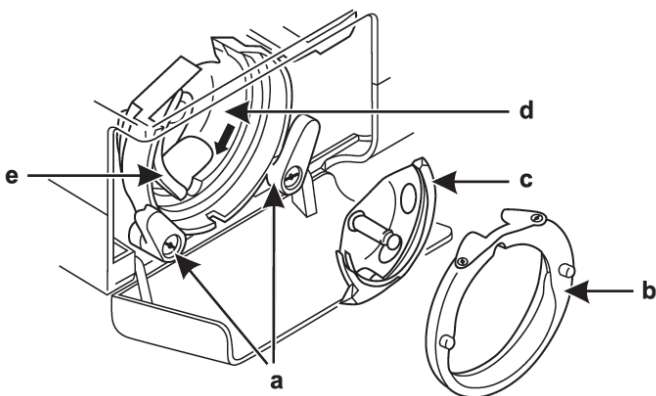



Troubleshooting guide

Problem	Cause	Correction
Upper thread breaks	<ol style="list-style-type: none">1. The machine is not threaded correctly2. The thread tension is too tight3. The thread is too thick for the needle4. The needle is not inserted correctly5. The thread is round wound the spool holder pin6. The needle is damaged	<ol style="list-style-type: none">1. Rethread the machine2. Reduce the thread tension (lower number)3. Select a larger needle4. Remove and reinsert the needle (flat side towards the back)5. Remove the reel and wind thread onto reel6. Replace the needle
Lower thread breaks	<ol style="list-style-type: none">1. The bobbin case is not inserted correctly2. The bobbin case is threaded wrongly3. The lower thread tension is too tight	<ol style="list-style-type: none">1. Remove and reinsert the bobbin case and pull on the thread. The thread should pull easily2. Check both bobbin and bobbin case3. Loosen lower thread tension as described
Skipped stitches	<ol style="list-style-type: none">1. The needle is not inserted correctly2. The needle is damaged3. The wrong size needle has been used4. The foot is not attached correctly	<ol style="list-style-type: none">1. Remove and reinsert needle (flat side towards the back)2. Insert a new needle3. Choose a needle to suit the thread and fabric4. Check and attach correctly
Needle breaks	<ol style="list-style-type: none">1. The needle is damaged2. The needle is not correctly inserted3. Wrong needle size for the fabric4. The wrong foot is attached	<ol style="list-style-type: none">1. Insert a new needle2. Insert the needle correctly (flat side towards the back)3. Choose a needle to suit the thread and fabric4. Select the correct foot
Loose stitches	<ol style="list-style-type: none">1. The machine is not correctly threaded2. The bobbin case is not correctly threaded3. Needle/ fabric/ thread combination is wrong4. Thread tension wrong	<ol style="list-style-type: none">1. Check the threading2. Thread the bobbin case as illustrated3. The needle size must suit the fabric and thread4. Correct the thread tension



Seams gather or pucker	<ol style="list-style-type: none">1. The needle is too thick for the fabric2. The stitch length is wrongly adjusted3. The thread tension is too tight	<ol style="list-style-type: none">1. Select a finer needle2. Readjust the stitch length3. Loosen the thread tension
Uneven stitches, uneven feed	<ol style="list-style-type: none">1. Poor quality thread2. The bobbin case is wrongly threaded3. Fabric has been pulled	<ol style="list-style-type: none">1. Select a better quality thread2. Remove bobbin case and rethread and insert correctly3. Do not pull on the fabric while sewing, let it be taken up by the machine
The machine is noisy	<ol style="list-style-type: none">1. The machine must be lubricated2. Fluff or oil have collected on the hook or needle bar3. Poor quality oil has been used4. The needle is damaged	<ol style="list-style-type: none">1. Lubricate as described2. Clean the hook and feed dog as described3. Only use good quality sewing machine oil4. Replace the needle
The machine jams	<ol style="list-style-type: none">1. Thread is caught in the hook	<ol style="list-style-type: none">1. Remove the upper thread and bobbin case, turn the hand wheel backwards and forwards by hand and remove the thread remnants. Lubricate as described



STORING THE MACHINE

Store the machine in its box or in a clean, dry place. Never wrap the power cord around the machine.

SERVICING THE MACHINE

If the unit is not operating correctly, please check the following:

You have followed the instructions correctly.

The wall socket is switched on.

That the mains power supply is ON.

That the plug is firmly in the mains socket.

If the machine still does not work after checking the above:

- Consult the retailer for possible repair or replacement. If the retailer fails to resolve the problem and you need to return the machine, make sure that:

The unit is packed carefully back into its original packaging.

Proof of purchase is attached.

A reason is provided for why it is being returned.

If the supply cord is damaged, it must be replaced by the manufacturer or an authorised service agent, in order to avoid any hazard. If service becomes necessary within the warranty period, the machine should be returned to an approved Home of Living Brands (Pty) Limited service centre. Servicing outside the warranty period is still available, but will, however, be chargeable



**PLEASE AFFIX YOUR PROOF OF PURCHASE/RECEIPT HERE
IN THE EVENT OF A CLAIM UNDER WARRANTY
THIS RECEIPT MUST BE PRODUCED
WARRANTY**

1. Home of Living Brands (Pty) Ltd (“Home of Living Brands”) warrants to the original purchaser of this product (“the customer”) that this product will be free of defects in quality and workmanship which under normal personal, family or household use and purpose may manifest within a period of 1 (one) year from the date of purchase (“warranty period”).
2. Where the customer has purchased a product and it breaks, is defective or does not work properly for the intended purpose, the customer must notify the supplier from whom the customer bought the product (“the supplier”) thereof within the warranty period. Any claim in terms of this warranty must be supported by a proof of purchase. If proof of purchase is not available, then repair, and/or service charges may be payable by the customer to the supplier.
3. The faulty product must be taken to the supplier's service centre to exercise the warranty.
4. The supplier will refund, repair or exchange the product in terms of this warranty subject to legislative requirements. This warranty shall be valid only where the customer has not broken the product himself, or used the product for something that it is not supposed to be used for. The warranty does not include and will not be construed to cover products damaged as a result of disaster, misuse, tamper, abuse or any unauthorised modification or repair of the product.
5. This warranty will extend only to the product provided at the date of the purchase and not to any expendables attached or installed by the customer.
6. If the customer requests that the supplier repairs the product and the product breaks or fails to work properly within 3 (three) months of the repair and not as a result of misuse, tampering or modification by or on behalf of the customer, then the supplier may replace the product or pay a refund to the customer.
7. The customer may be responsible for certain costs where products returned are not in the original packaging, or if the packaging is damaged. This will be deducted from any refund paid to the customer.

HOME OF LIVING BRANDS (PTY) LTD (JOHANNESBURG)
JOHANNESBURG TEL NO. (011) 490-9600
CAPE TOWN TEL NO. (021) 552-5161
DURBAN TEL NO. (031) 792-6000

www.homeoflivingbrands.com