



**2014 MIRAGE**

**Owner's Handbook**



PLEASE PLACE COPIES OF THE FOLLOWING ITEMS IN THE POCKET BELOW:

1. Pre-Delivery Inspection Form (Customer Copy)
2. Triple Diamond Delivery Checklist (Customer Copy)
3. Salesperson or Key Dealership Contact's Business Card



Thank you for buying a Mitsubishi Mirage. There's no doubt you've already realized how well your car drives on the open road. What you may not know is all the great features that help your car perform the way it does. In the pages ahead we're going to run through the basics and prepare you for the road.

We'd also love to hear from you about your overall Mitsubishi experience. If you haven't already, please log on to [www.MitsubishiSSISurvey.com](http://www.MitsubishiSSISurvey.com) and tell us how we did. This will help us make sure your next visit is that much better.

We hope you will visit the Mitsubishi Owner's site where we store the latest Mitsubishi news and special offers. Here you can also keep track of your car's warranty and servicing needs, get Roadside Assistance Information and tap into other owner-centric details. Just log on to [www.MitsubishiCars.com/ownersonly](http://www.MitsubishiCars.com/ownersonly).

## Table of Contents

Driver's View .....	Page 2-3
Controls .....	Page 4
Own the Road .....	Page 5
Technology .....	Page 6-7
Audio System.....	Page 8
Bluetooth® (if equipped)....	Page 9
Navigation System (if equipped).....	Page 10-11
FAQ's.....	Page 12-13



### Driver's View

- 1** Ignition Switch (DE Model only) ..... Page 3
- 2** Side Mirror Adjustment..... Page 4
- 3** Climate Controls..... Page 4
- 4** Headlights ..... Page 4
- 5** Windshield Wiper Lever..... Page 4
- 6** Cruise Control (if equipped) ..... Page 5
- 7** Multi Information Display (MID)..... Page 5
- 8** ASC Off Switch..... Page 6
- 9** Start/Stop Engine Switch  
(if equipped with F.A.S.T.-key)..... Page 7
- 10** Audio Remote Control Switches  
(if equipped)..... Page 8
- 11** Bluetooth® Controls (if equipped) ..... Page 9
- 12** Navigation System (if equipped)..... Page 10-11

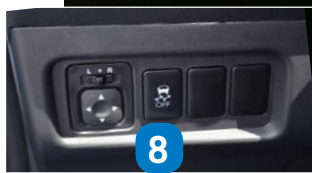



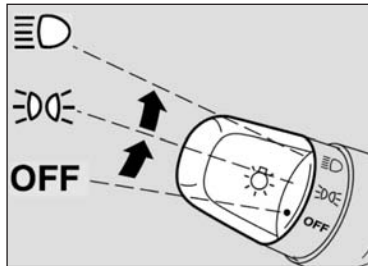

## CONTROLS

### Regular Headlights



-  Headlights and other lights on.
  -  Parking, tail, front and rear sidemarker lights, license plate and instrument panel lights on.
  - OFF** All lights off
- Pull lever toward driver to activate high beams.

### Windshield Wipers

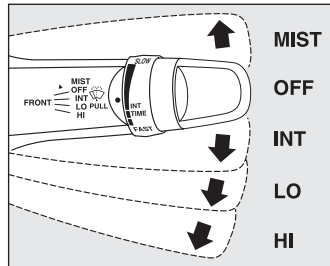

- MIST** — The wipers will operate once.
- OFF** — OFF
- INT** — Intermittent (Speed sensitive)
- LO** — Slow
- HI** — Fast

### Automatic Air Conditioning

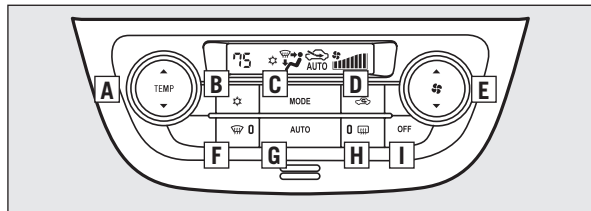

- A** - Temperature control switch
- B** - Air conditioning switch
- C** - MODE switch
- D** - Air selection switch
- E** - Blower speed selection switch
- F** - Defogger switch
- G** - AUTO switch
- H** - Electric rear window defogger switch
- I** - OFF switch

### Rear Window Wiper and Washer

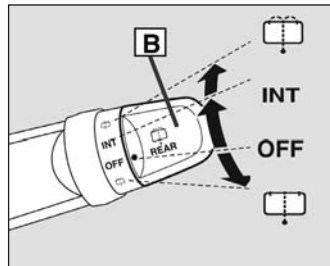

- Turn the knob **B** to operate the rear window wiper.
- The wiper operates continuously for several seconds then operates intermittently at intervals of about 8 seconds.
- Washer fluid is sprayed, the wiper will automatically operate 2 or 3 times.

### Side Mirror Adjustment

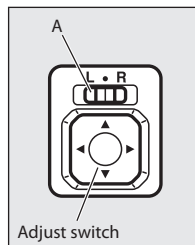

The outside rearview mirrors can be adjusted when the ignition switch is in the "ON" or "ACC" position or the operation mode is put in ON or ACC.

Move the lever (A) to the same side as the mirror you wish to adjust.

## Cruise Control (if equipped)

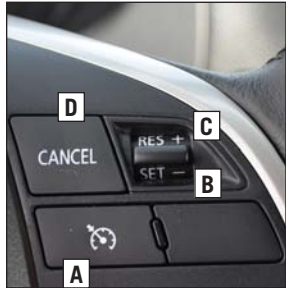

- A** - CRUISE CONTROL ON/OFF switch  
Used to turn on and off the cruise control.
- B** - SET - switch  
Used to reduce the set speed and to set the desired speed.
- C** - RES + switch  
Used to increase the set speed and to return to the original set speed.
- D** - CANCEL switch  
Used to deactivate the set speed driving.

### NOTE:

When operating the cruise control switches, press the cruise control switches correctly. The set speed driving may be deactivated automatically if two or more switches of the cruise control are pressed at the same time.

## Temperature Indicator Lamp Operation

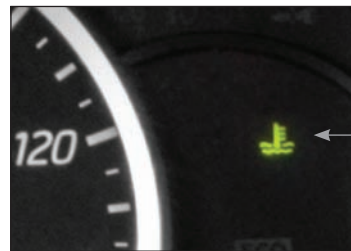

1. Temperature Indicator Lamp Illuminated Green
- When the temperature indicator lamp is illuminated Green this indicates the engine has not reached normal operating temperature.

**NOTE:** This will result in cooler heater outlet temperatures until engine reaches normal operating temperatures.

2. Temperature Indicator Lamp Off
- When the temperature indicator lamp is Off this indicates the engine is at normal operating temperature.
3. Temperature Indicator Lamp Illuminated Red
- When the temperature indicator is illuminated Red this indicates the engine is overheating.

**NOTE:** If the engine is overheating, find a safe place to park the vehicle, then shut the engine off and call Roadside Assistance as continued driving could cause the engine to fail.

**Multi Information Display Switch** Each time you lightly press the multi-information display switch (A), the display switches in the following order.

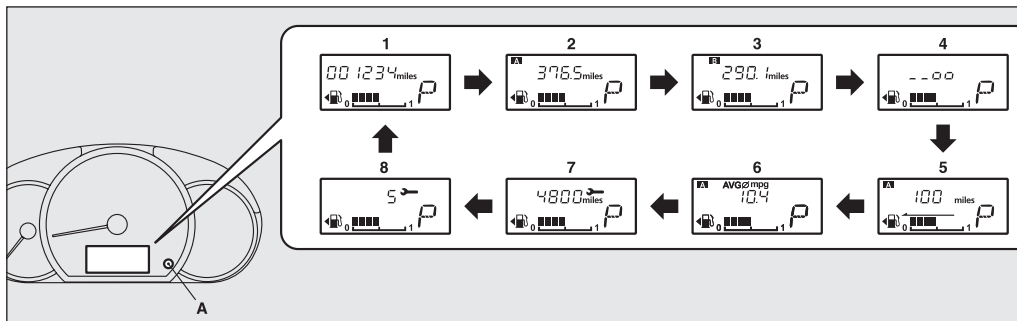

### NOTE

- When the ignition switch or the operation mode is in OFF, the driving range display and average fuel consumption display are not displayed.
- While driving, the service reminder is not displayed even if you operate the multi-information display switch.

- 1- Odometer
- 2- Trip odometer **A**
- 3- Trip odometer **B**
- 4- Instrument panel light dimmer control
- 5- Driving range display
- 6- Average fuel consumption display
- 7- Service reminder (distance)
- 8- Service reminder (month)

### Setting the Clock

1. Press and hold the ⏸ button and the clock display flashes.
2. Press the ⏩ or ⏪ button to adjust the “hours” digit.  
If you keep pressing the button, fast-forward begins.
3. When the “hours” digit is adjusted, press the ⏸ button to flash the “minutes” digit.  
Press the ⏩ or ⏪ button to adjust the “minutes” digit.  
If you keep pressing the button, fast-forward begins.
4. When the time is set, press the ⏸ button to stop the clock display from flashing.



### Setting the Clock with Navigation (if equipped)

You can set various settings related to the clock.

1. Touch the **CLOCK** key. The Clock screen is displayed.
2. Touch the desired menu item to set.

**On-screen Clock** key: Sets whether to display the clock on the screen.  
**Clock Format (24h)** key: Sets to **ON** to change the clock to 24-hour format.  
 Turn off to change the clock to 12-hour format.



### Active Stability Control (ASC) Off Switch

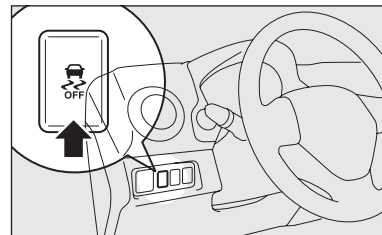

You can deactivate the system by pressing down the “ASC OFF” switch for 3 seconds or longer. When the ASC is deactivated, the indicator will turn on. To reactivate the ASC, momentarily press the “ASC OFF” switch; the indicator is turned off.

ECO indicator



This indicator will be displayed when fuel efficient driving is achieved.

### Tire Pressure Monitoring System (TPMS)



The Tire Pressure Monitoring System light illuminates when one or more of your tires is significantly under inflated. Please note that changes in the outside temperature may decrease tire pressure causing the TPMS light to turn on. If the TPMS light remains illuminated, check your tire pressure.

If the warning light illuminates, take the necessary measures referring to the owner’s manual.



## Keyless Entry System

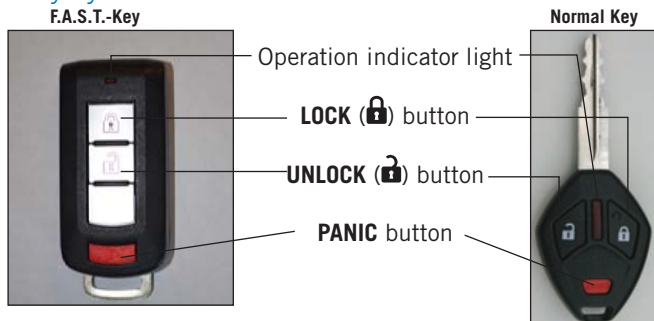

While carrying the F.A.S.T.-key, press the driver's door lock/unlock switch **A**.

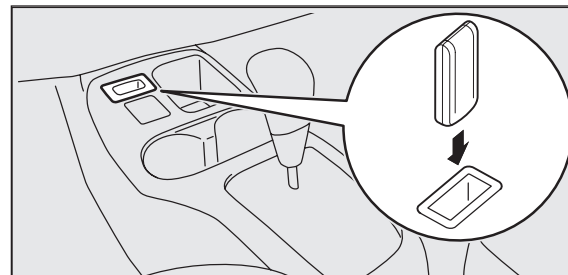

### If the F.A.S.T.-key is not operating properly

Remove the key from the F.A.S.T.-key remote and unlock the door manually. Then, insert the F.A.S.T.-key into the key slot in the instrument panel. Starting the engine and changing the operation mode should be now possible. Remove the F.A.S.T.-key from the key slot after starting the engine or changing the operation mode.

## Start/Stop Engine Switch (if equipped with F.A.S.T.-key)



While carrying the F.A.S.T.-key within the operating range, the Start/Stop button can be used to start the engine.

- Move the selector lever in "P" position and hold the brake pedal down, push the Start/Stop button.
- To stop the engine, stop the vehicle completely and move the selector lever in "P" then press the Start/Stop button.
- **\* If you have to bring the engine to an emergency stop while driving, press and hold the Start/Stop button for 3 seconds or more, or press it quickly 3 times or more.**
- If you press the Start/Stop button without depressing the brake pedal, you can change the operation mode in the order of OFF, ACC, ON, OFF.
- If the engine cannot be started or the operation mode cannot be changed, check the position of the F.A.S.T.-key or the battery performance of the F.A.S.T.-key.



### To enter frequencies into the memory (AM/FM)

1. Press **A** to turn on the audio system.
2. Press **B** to select the desired band (AM/FM).
3. Press **C** to Seek Station
4. Hold down one of the Memory select buttons **D** (1-6) until it beeps in order to save that station to memory.

### Audio Remote Control Button (if equipped)

**SEEK**  
Change station or track



**MODE**  
Change the audio source

### USB and iPod Input (if equipped)

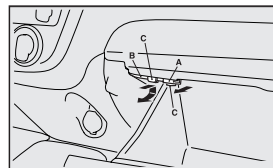

#### To connect a USB memory device

1. Park your vehicle in a safe place and turn the ignition switch to the "OFF" position or put the operation mode in OFF.
2. Open the glove compartment and remove the connector cable **A**, **B** from clips **C**.
3. Connect a commercially available USB connector cable **D** to the USB memory device **E**.
4. Connect the commercially available USB connector cable **D** to the vehicle's connector cable **B**. Be sure to hold the terminal part **A** of the connector cable as shown in the illustration.
5. Fix the connector cable **A**, **B** on the clips.

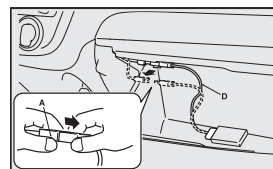
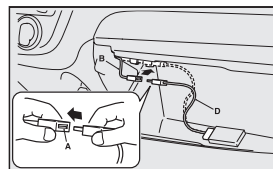
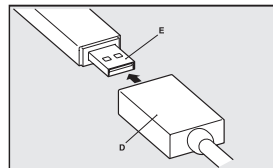

#### To remove

1. Turn the ignition switch to the "OFF" position or put the operation mode in OFF.
2. Remove the commercially available USB connector cable **D**. Be sure to hold the terminal part **A** of the connector cable as shown in the illustration.
3. Fix the connector cable on the clips and close the glove compartment.

**NOTE:** Please refer to your Owner's Manual for more detailed information on how to use your audio system.

## Bluetooth® Controls (if equipped)

For a list of compatible Bluetooth devices, please go to <http://www.mitsubishicars.com/owners>

If your vehicle is equipped with a Navigation System, you can find a list of compatible Bluetooth devices at

<http://www.mitsubishi-motors.com/en/products/mmes/index.html>



- A** **SPEECH button:**  
Change to voice recognition
- B** **PICK-UP button:**  
Answer an incoming call
- C** **HANG-UP button**  
End a call or voice recognition

## Bluetooth® Settings

When you touch the [Bluetooth] key from the Settings menu, you can set various functions related to the Bluetooth feature.

### Activating Bluetooth® feature

1. Stop your vehicle in a safe area, put the gearshift lever in the “N” (Neutral) position (manual transaxle), or the selector lever in the “P” (PARK) position (continuously variable transmission (CVT)), and pull the parking brake lever.
2. Press the **SPEECH** button.
3. Say “Setup.”
4. Say “Pairing Options.”
5. The voice guide will say “Select one of the following: pair, edit, delete, or list.” Say “Pair.”

### Using your Bluetooth® Mobile Phone with this Unit

When the connection with your Bluetooth mobile phone is established, the following functions are available on this unit:

- Listening to your telephone calls on the vehicle speakers.
- Making a call using the keypad screen, using the phonebook data downloaded from your mobile phone, using the Call History (incoming/outgoing call records), or using the Handset Memory (speed dial).

- This system supports the following Bluetooth profiles:
- Hands-free Profile (HFP)
- Phonebook Access Profile (PBAP)

### Selecting Telephone mode

1. Press the [MENU] button to display the Main menu screen.
  2. Touch the [Phone] key to select Telephone mode.
- The telephone screen is displayed →

### Telephone settings

To use your Bluetooth mobile phone with this system, register (pair) it with the system and wirelessly connect it to the system.



### Registering your mobile phone (Pairing)

You can register up to 5 mobile phones.

1. Turn on the power of the mobile phone you want to register.
2. Touch the [Pair Phone] key to display the Pair Phone screen.
3. Perform the following operations on your mobile phone:
  - Perform the Bluetooth device search operation.
  - Specify the device named “Car-Navi” to register this system to your mobile phone.
4. When the PIN (Pass key) input prompt is displayed on your mobile phone, enter the same code as the PIN (Pass key) set to this unit. If a selection function prompt is displayed on your mobile phone, select the “Handsfree” function. When the pairing operation completes, the registered mobile phone is set as the current phone, and the display returns to the Telephone screen.

### To delete the telephone registration

1. Touch the [Paired Phones] key.
2. Touch the desired device key you want to delete.
3. Touch the [Delete] key.
4. Touch the [Yes] key. The registration is deleted.

### Connecting to your mobile phone

1. Touch the [Paired Phones] key to display the Paired Phones screen.
2. Touch the key for the device you want to use.
3. Touch the [Connect] key.

## Search for a Location

### Selecting your Home location

To navigate to your Home location, first you need to save it. Search for your address or browse the map and when the Cursor ( ) is at the desired location, tap **^ MORE** and select **SAVE AS HOME**.

Now that the Home location is set, you can quickly navigate to it:

- To select the Home location, do one of the following:
  - Press and hold the **DEST** button to the right of the screen for more than 1.5 seconds.
  - If you are in the Navigation menu, tap **DEST** and then tap **HOME**.
- A full screen map appears with the selected point in the middle. If necessary, tap the map somewhere else to modify the destination. The Cursor ( ) appears at the new location. Tap **NEXT** to confirm the destination, or tap **BACK** to select a different destination.
- After a short summary of the route parameters, the map appears showing the entire route. The route is automatically calculated. Tap **^ MORE** to modify route parameters, or tap **GO** and start your journey.



**Way Points** – Once you have set a destination, you can enter additional stops along the way called Way Points. For details on how to set Way Points refer to your Navigation Owner’s Manual.

**Saving Addresses** - To save an address, first enter the address into the system. Then touch **Address Book** and confirm location to be stored. Touch **Set to Address Book** to complete.

## Selecting the destination from your Favorites

You can select a location that you have already saved as a Favorite to be your destination. Adding a location to the list of Favorite destinations is described on page 56 of the Navigation Manual.

- Access the list of Favorites:
  - If you are on the Map screen, tap **≡** to open the Quick menu.
  - If you are in the Navigation menu, tap **DESTINATION**.
- Tap **FAVORITES**. The list of Favorite destinations is displayed.

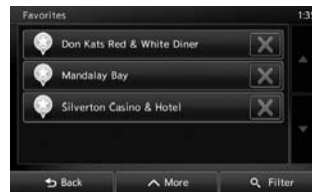

- Tap the Favorite that you want to set as your destination. If necessary, browse down to see more of the list or tap **FILTER** and enter a few letters from the name of the Favorite destination.
- A full screen map appears with the selected point in the middle. If necessary, tap the map somewhere else to modify the destination. The Cursor ( ) appears at the new location. Tap **NEXT** to confirm the destination, or tap **BACK** to select a different destination.
- After a short summary of the route parameters, the map appears showing the entire route. The route is automatically calculated. Tap **^ MORE** to modify route parameters, or tap **GO** and start your journey



## Entering an Address

To enter an address as the destination, do as follows:

1. If you are on the Map screen, tap **MENU** to return to the Navigation menu.
2. In the Navigation menu, tap the following buttons: **DESTINATION, FIND ADDRESS**
3. By default, the Navigation proposes the country and state where you are. If needed, tap **COUNTRY**, enter the first few letters of the destination country or state on the keyboard, and select one from the list. If you select a country without a state, you can search for a city/town in all its states.



4. Select a new city/town:
  - a. Tap **CITY**. The city/town of your current location is offered by default. For a local search, tap ✓ to accept it, otherwise continue with entering the destination city/town name.
  - b. Start entering the name of the city/town on the keyboard.
  - c. Find the city/town you need:
    - The most likely city/town name is always shown in the input field. To accept it, tap ✓.
    - If the desired name does not show up, the names that match the string appear in a list after entering a couple of characters. Select the city/town from the list.



5. Enter the street name:
  - a. Tap **STREET**.
  - b. Start entering the street name on the keyboard.
  - c. Find the street you need:
    - The most likely street name is always shown in the input field. To accept it, tap ✓.
    - If the desired name does not show up, the names that match the string appear in a list after entering a couple of characters. Select the street from the list.



6. Enter the house number:
  - a. Tap **<HOUSE NUMBER>**.
  - b. Enter the house number on the keyboard.

**Q: Is my phone compatible with the factory Mitsubishi Bluetooth® Hands Free System?**

A: Check the list of compatible phones, [www.mitsubishicars.com/owners](http://www.mitsubishicars.com/owners) to see if the phone is Bluetooth® supported.

**Q. Why doesn't my device (USB, iPhone, Bluetooth® Audio, etc.) work?**

A: You need to press the Mode button to select the appropriate device you want to use.

**Q: How do I use Bluetooth® Audio (if equipped)?**

A: Please refer to your Owner's Manual for instructions.

**Q: Why does my Anti-Lock Braking System (ABS) make a noise?**

A: Each time your vehicle is started and driven a short distance, you will hear the sound of the ABS motor operating from the right front engine compartment. This is the normal sound the Anti-Lock Braking System makes when performing a self check.

**Q: Why does the Audio System take so long to upload my music from my audio music device?**

A: The Mitsubishi system can read multiple device structures in order to catalog the music files for easy playing and listening. Depending on the amount of music you have on your device, this may take a few minutes.

**Q: How can I play music from my portable music player through the stereo system in my vehicle when equipped with the Bluetooth® Phone System?**

A: Once your device is paired to the Bluetooth Phone System, you can stream music from your device to your vehicles sound system. No wires or cords. Your music stops and restarts at the same song when you exit and when you re-enter the vehicle. Voice commands are not available.

**Q: Why can't I control the music track selection via voice commands?**

A: The Mitsubishi system uses AVRCP 1.3 (Audio/Video Remote Control Profile) which does support song information (title, artist, track, etc.). However, you must have a device that also supports AVRCP 1.3 to supply that information to the Mitsubishi system.

**Q: My Mirage has a 12 V accessory outlet. What devices can I plug in to it?**

A: This outlet is protected with a 15 amp fuse. Always check the current draw rating of any device prior to use in the vehicle. If the device is rated above 10 amps, this could lead to circuit overload and the electrical fuse opening (no current flow).

**Q: How can I get the MPG stated on the window sticker?**

- A: Vehicle driving styles will greatly affect MPG. Avoid sudden abrupt starts from a stop and let the vehicle coast to the traffic light. Both of these styles will increase mileage and reduce brake lining wear.
- Vehicles are designed to achieve the best fuel mileage when they are driven at the speed limits on the freeway. Avoid driving over 65 mph.
  - Under inflated tires will increase rolling resistance and will reduce fuel mileage. Check tire pressure frequently to increase miles per gallon. Proper tire pressure also ensures optimum tire performance (including tire wear.)

**Q: Why does my check engine light come on after I put gas in my car?**

- A: There are many reasons why your check engine light may illuminate. Before calling your dealership, make sure the fuel cap is fully engaged and you have heard three clicks when tightening it. After checking and hearing three clicks and the light is still on, contact your dealership.

**Q: How do I use the emergency key when the F.A.S.T.-key battery or vehicle battery is run down?**

- A: If your Mirage is equipped with a One Touch Start button and the door does not open, take the key out from the fob and unlock the front passenger door manually. Put the key back into the fob and insert it into the slot provided below the Climate Control Switches. Starting the engine and charging the operation mode should now be possible. Remove the F.A.S.T.-key from the key slot after starting the engine or charging the operation mode.



**2014 MIRAGE**

**[www.mitsubishicars.com](http://www.mitsubishicars.com)**