



Dresden STEM Merit Badge Clinic 2020 Scouts BSA Program Details

Rainbow Council
Boy Scouts of America
George S. McGee Service Center
921 South State St.
Lockport, IL 60441



Clinic Only: August 8th, 2020

Opening Ceremony: 7:50 AM

Program: 8:00AM – 3:30PM

Lunch Provided by Dresden Station

Activity Badge Included

Cost \$10.00 per Scout

Adults – Free, but must register.

All Inclusive Camping Weekend

Including COPE and Shooting Sports

August 7th – 9th, 2020

August 7th: 6:00 PM, Check in at Rainbow Scout Reservation

August 8th: Clinic 6:30 AM – 3:30 PM

Buses transport participants to and from Dresden Station. - Lunch Provided by Dresden Station

Activity Badge Included

Free Class B T-Shirt Provided by Exelon (*Youth Only*)

All Food will be Provided

August 9th: Camp Clean-up 10:00 AM, Checkout

Cost \$50.00

All Participants Must Register

Mandatory BSA Health Form parts A & B, AND WAVIER

“NO HEALTH FORM OR WAVIER, NO PARTICIPATION”

NO CAMPING EQUIPMENT PROVIDED, BRING YOUR OWN EQUIPMENT





Dresden STEM Merit Badge Clinic 2020 Scouts BSA Program Details

Rainbow Council
Boy Scouts of America
George S. McGee Service Center
921 South State St.
Lockport, IL 60441



New For 2020

Adult Leader Training at Dresden Merit Badge Clinic

Based on survey results of adult leaders present during 2019 MBC.

Knots and Lashings

Adult Leaders can register and learn their favorite scouting knots. Rainbow Council Training team will help you learn basic, advanced knots, and lashings. This will be an all-day class. All material provided.

Fee \$10

Morning session (Knots)
8:00 AM – 11:30 PM

Afternoon session (Lashings)
12:00 PM – 3:00 PM

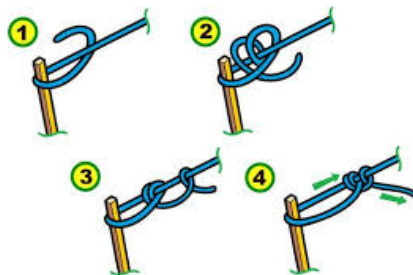

Orienteering and/or Geocaching

Fee \$10

Rainbow Council Training team will get you set up to learn Orienteering and Geocaching.

Orienteering will teach you the basics of compass and topographic map skills.

Geocaching is an outdoor recreational activity, in which participants use a Global Positioning System receiver or mobile device and other navigational techniques to hide and seek containers, called "geocaches" or "caches", at specific locations marked by coordinates all over the world.

All other material will be provided. This will be an all-day course.

Morning session (Orienteering)
8:00 AM – 11:30 PM

Afternoon session (Geocaching)
12:00 PM – 3:00 PM

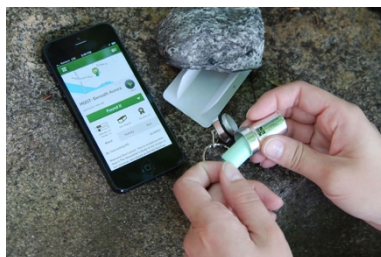

** Limited Class Sizes **

** No Guarantee of class size or availability. **



Dresden STEM Merit Badge Clinic 2020

Scouts BSA Program Details

Rainbow Council
 Boy Scouts of America
 George S. McGee Service Center
 921 South State St.
 Lockport, IL 60441



Merit Badges Offered

Nuclear Science	Fire Safety
American Labor	Electricity
Electronics	Medicine
Bird Study	Finger Printing
Plumbing	Engineering
Automotive Maintenance	Traffic Safety
Farm Mechanics	First Aid (Eagle Required)
Orienteering	Safety
	Geocaching



Merit Badges, Merit Badge Counselors, and Pre-Requisites

All Scouts must have a Signed *BLUE CARD* from there Scoutmaster to participate for all Merit Badges (NO EXCEPTIONS)

Merit Badge & Counselor	Class Size	AM PM All Day	Pre-Requisites (Pre-Work) (Must be completed by Scouts prior to event. Evidence must be provided: Photo, Video, Documentation, ETC.)
Bird Study Lou Magers	5	AM PM	Pre-Work: Scoutmaster Approval and prepared/signed blue card. Pre-Work Requirements: #2 and #8. What to Bring: Bird drawing with parts labeled. Picture of a bird feeder, bird bath, or bird. habitat. Merit Badge Card and desire to learn. Requirements covered at Dresden: 1 - 1½ hour in the classroom and then spend the remainder of the time in the field looking for 20 birds.
Lt. Nick Doerfler Coal City Fire Dept Fire Safety	25	All Day	Pre-Work: Scoutmaster Approval and prepared/signed blue card. Pre-Work Requirements: #6a – Draw home fire escape plan. Create home fire drill schedule, and conduct home fire drill. What to Bring: Your home fire-escape plan and fire drill schedule. Merit Badge Card and desire to learn. Requirements covered at Dresden: Rest of Requirements
American Labor Ryan Barrie	15	AM PM	Pre-Work: Scoutmaster Approval and prepared/signed blue card. Fill out your portion of the blue card in advance (name, troop, etc.) Pre-Work Requirements: With your counselor’s and parent’s approval and permission, visit the office or attend a meeting of a local union, a central labor council, or an employee organization, or contact one of these organizations via the internet. Then do EACH of the following: (a) Find out what the organization does. (b) Share the list of issues and concerns you made for requirement 1. Ask the people you communicate with which issues are of greatest interest or concern to them and why.

Dresden STEM Merit Badge Clinic 2020

Scouts BSA Program Details

Rainbow Council
 Boy Scouts of America
 George S. McGee Service Center
 921 South State St.
 Lockport, IL 60441



American Labor Ryan Barrie	15	AM PM	1. (c) Draw a diagram showing how the organization is structured, from the local to the national level, if applicable.
First Aid Krista Schulte MSN/BSN/RN	15	AM PM	Pre-Work: Scoutmaster Approval and prepared/signed blue card. Pre-Work Requirements: #1 Satisfy your counselor that you have current knowledge of all First-aid requirements for Tenderfoot, Second Class, and First-Class ranks. (Copy, Photo, of/or Scout Book Sign-off), #2.d., Prepare a first-aid kit for your home. Display and discuss its contents with your counselor. Scout should be ready to fill out worksheet, be prepared to discuss, and participate. Scouts are expected to read First Aid Merit Badge Handbook prior to arrival.
Electricity Ray Papach	25	AM PM	Pre-Work: Scoutmaster Approval and prepared/signed blue card. Fill out your portion of the blue card in advance (name, troop, etc.) Pre-Work Requirements: # 2 Complete an electrical home safety inspection of your home, using the checklist found in this pamphlet or one approved by your counselor. Discuss what you find with your counselor. # 8 Make a floor plan wiring diagram of the lights, switches, and outlets for a room in your home. Show which fuse or circuit breaker protects each one. What to Bring: Completed home electrical safety inspection (req. #2) and (req. #8) Merit Badge Blue Card and desire to learn.
Electronics Scott Patterson	20	AM PM	Pre-Work: Scoutmaster Approval and prepared/signed blue card. Fill out your portion of the blue card in advance (name, troop, etc.) Pre-Work Requirements: NONE
Nuclear Science Tom Leffler	25	All Day	Pre-Work: Scoutmaster Approval and prepared/signed blue card. Pre-Work Requirements: #1a, tell what radiation is. #1b, Describe radiation hazards to humans, environment, wildlife. Explain the difference between radiation exposure & contamination, discussing radiation risks from nuclear power, medical radiation, and background radiation including radon. Explain the ALARA principle & measures required by law to minimize these risks. #1c, Describe the radiation hazard symbol; explain where it should be used; Tell why & how people must use radiation or radioactive materials carefully. #2a, Tell the meaning of the following: atom, nucleus, proton, neutron, electron, quark, isotope; alpha particle, beta particle, gamma ray, X-ray; ionization, radioactivity, and radioisotope. #3b, Name three particle accelerators and describe several experiments that each accelerator performs. <u>I will give a multiple-choice quiz on the stuff above and if they get a passing score. I will sign off those requirements.</u> What to Bring: Be able to speak about the pre-req's that were completed and have a desire to learn! And...your blue card! Requirements covered at Dresden: The rest of the requirements & cool experiments
Medicine Jon Micetich O.D. Mike Meyers RN Retired	25	AM PM	Pre-Work: Scoutmaster Approval and prepared/signed blue card. Pre-Work Requirements: A signature on blue card from a scoutmaster or assistant scoutmaster showing proof the scout participated #10. Serve as a volunteer at a health-related event or facility in your community (e.g. blood drive, "health fair", blood pressure screening, etc.) approved by your counselor. What to Bring: Merit Badge Blue Card and desire to learn. Requirements covered at Dresden: Rest of the requirements with hands on experiences.
Farm Mechanics John Cairns Jr.	10	AM PM	Pre-Work: Scoutmaster Approval and prepared/signed blue card. Fill out your portion of the blue card in advance (name, troop, etc.) Pre-Work Requirements: #1.d. Describe what a material safety data sheet (MSDS) is and tell why it is used. Obtain the MSDS for any engine coolant, oil, grease, fuel, hydraulic or transmission fluid, or other flammable or hazardous materials you use in meeting the requirements for this merit badge. Scouts should review this requirement and its components and be prepared to discuss. It is strongly recommended that Scouts bring any notes or supporting documents they may have to help show the counselor that they have prepared for discussion of these items. #2.b. Scouts should also bring their drawing required in 2B ready to share with the counselor during the discussion time in the class. #5 Visit an implement dealer. Interview the dealer technician or service manager for hints on good preventive maintenance. Ask why it is important, the costs, and what causes wear or damage. Report what you learn. Requirement 5 will NOT be covered in the class,



Dresden STEM Merit Badge Clinic 2020

Scouts BSA Program Details

Rainbow Council
 Boy Scouts of America
 George S. McGee Service Center
 921 South State St.
 Lockport, IL 60441



Farm Mechanics John Cairns Jr.	10	AM PM	<p>HOWEVER, Scouts who can bring documented proof of completing any of the components of this requirement will have an opportunity to share with the counselor their accomplishments and potentially be signed off if the work meets the satisfaction of the merit badge counselor, (saying you did it is not enough, you need to bring proof), I will sign off on the requirement.</p> <p>#7. Find out about three career opportunities in farm mechanics. Pick one and find out the education, training, and experience required for this profession. Discuss this with your counselor, and explain why this profession might interest you. Scouts should review this requirement and its components and be prepared to discuss. It is strongly recommended that Scouts bring any notes or supporting documents they may have to help show the counselor that they have prepared for completion of this requirement.</p>
Finger Printing Sgt. Tanya Paquette Grundy County Sherriff	15	PM	<p>Pre-Work: Scoutmaster Approval and prepared/signed blue card. Pre-Work Requirements: None. What to Bring: Desire to learn. Requirements covered at Dresden: Rest of the requirements with hands on experience. Also, open questions and discussions about life experiences in law enforcement.</p>
Traffic Safety Sgt. Tanya Paquette Grundy County Sherriff	15	AM	<p>Pre-Work: Scoutmaster Approval and prepared/signed blue card. Pre-Work Requirements: None. What to Bring: Desire to learn. Requirements covered at Dresden: Rest of the requirements with hands on experience. Also, open questions and discussions about life experiences in law enforcement.</p>
Plumbing Tom Ditchfield	15	AM PM	<p>Pre-Work: Scoutmaster Approval and prepared/signed blue card. Pre-Work Requirements: None. What to Bring: Work clothes, long sleeve shirt and denim pants are mandatory do to nature of work. Must be a minimum of 14 years of age at time of event. Use of power equipment under strict supervision. Desire to learn. Requirements covered at Dresden: All of the requirements with hands on experience. Also, open questions and discussions about how important piping and safety are in a Nuclear Power plant.</p>
Automotive Maintenance TBA	10	AM PM	<p>Pre-Work: Scoutmaster Approval and prepared/signed blue card. Pre-Work Requirements:</p> <p>#2.h., Find out the requirements for your state's emissions and safety inspections (as applicable), including how often a vehicle needs to be inspected.</p> <p>#2.i., Explain the importance of registering a vehicle and find out the annual registration fee for renewing your family car's registration.</p> <p>#4.c., Explain why wheel alignment is important to the life of a tire. Explain caster, camber, and toe-in adjustments on wheel alignment.</p> <p>#4.e., Explain how to dispose of old tires in accordance with local laws and regulations.</p> <p>#8.a., Diagram and explain the parts of the electrical system.</p> <p>#9.a., Diagram the drive train and explain the different parts.</p> <p>#11.a., Determine the value of three different vehicles you are interested in purchasing. One must be new and one must be used; the third vehicle can be new or used. For each vehicle, find out the requirements and cost of automobile insurance to include basic liability and options for collision, comprehensive, towing, and rental car. Using the three vehicles you chose and with your merit badge counselor's assistance, complete the operation/maintenance chart provided in the merit badge pamphlet. Use this information to determine the operating cost per mile for each vehicle, and discuss what you learn with your counselor.</p> <p>#11.b., Choose a car cleaner and wax product for a vehicle you want to clean. Explain clear-coat paint and the precautions necessary for care. Clean the vehicle, both inside and out, and wax the exterior. Use a vinyl and rubber protectant (on vinyl tops, rubber door seals, sidewalls, etc.) and explain the importance of this protectant.</p> <p>#12., Find out about three career opportunities in the automotive industry. Pick one and find out the education, training, and experience required for this profession. Discuss this with your counselor, and explain why this profession might interest you.</p>
Automotive Maintenance TBA	10	AM PM	



Dresden STEM Merit Badge Clinic 2020

Scouts BSA Program Details

Rainbow Council
 Boy Scouts of America
 George S. McGee Service Center
 921 South State St.
 Lockport, IL 60441



<p>Engineering</p> <p>Tom Mohr Joe Kopazck</p>	<p>25</p>	<p>AM PM</p>	<p>Pre-Work: Scoutmaster Approval and prepared/signed blue card. Pre-Work Requirements:</p> <p>#1: Select a manufactured item in your home (such as a toy or a appliance) and, under adult supervision and with the approval of your counselor, investigate how and why it works as it does. Find out what sort of engineering activities were needed to create it. You can find information on http://www.howstuffworks.com/</p> <p>#5a. Use the systems engineering approach to make step-by-step plans for your next campout. List alternative ideas for such items as program schedule, campsite, transportation and costs. Tell why you made the choices you did and what improvements were made.</p> <p>#5b. Make an original design for a piece of patrol equipment. Use the systems engineering approach to help you decide how it should work and look. Draw plans for it.</p> <p>What to Bring: Merit Badge Card and desire to learn.</p> <p>Requirements covered at Dresden: Rest of requirements and some fun experiments</p>
<p>Safety</p> <p>Brian Paisker Dresden Station Site Safety Professional</p>	<p>15</p>	<p>AM PM</p>	<p>Pre-Work: Scoutmaster Approval and prepared/signed blue card. Pre-Work Requirements.</p> <p>#1 Explain what safety is and what it means to be safe. Then prepare a notebook to include: (a) Newspaper, internet (with parent's or guardian's permission), or other articles, facts, and statistics showing common types and causes of injuries in the home and in the workplace, and how these injuries could be prevented (b) Newspaper, internet (with parent's or guardian's permission), or other articles, facts, and statistics showing common types of crime and ways to avoid being a crime victim (c) A paragraph or more, written by you, explaining how a serious fire, accident, or crime could change your family life (d) A list of safe practices and safety devices currently used by your family, such as safety practices used at home, while working, and while driving</p> <p>#2 Do the following: (a) Using a safety checklist approved by your counselor, make an inspection of your home. Identify any hazards found and explain how these can be corrected. (b) Review and develop your family's fire prevention plan. Review your family's emergency action plan for fire in your home. As you develop these plans with family members, share with them facts about the common causes of fire in the home, such as smoking, cooking, electrical appliances, and candles.</p> <p>#6 Plan and complete a safety project approved by your counselor for your home, school, place of worship, place of employment, or community.</p>
<p>Railroading</p> <p>Kevin Bach</p>	<p>15</p>	<p>All Day</p>	<p>Pre-Work: Scoutmaster Approval and prepared/signed blue card. Pre-Work Requirements:</p> <p>#1. Do THREE of the following: (a) Name three types of modern freight trains. Explain why unit trains are more efficient than mixed freight trains. (b) Name one Class I or regional railroad. Explain what major cities it serves, the locations of major terminals, service facilities and crew change points, and the major commodities it carries. (c) Using models or pictures, identify 10 types of railroad freight or passenger cars. Explain the purpose of each type of car. (d) Explain how a modern diesel or electric locomotive develops power. Explain the terms dynamic braking and radial steering trucks. Do the following:</p> <p>#2. (a) Explain the purpose and formation of Amtrak. Explain, by the use of a timetable, a plan for making a trip by rail between two cities at least 500 miles apart. List the times of departure and arrival at your destination, the train number and name, and the type of service you want. (b) List and explain the various forms of public/mass transit using rail.</p>



Dresden STEM Merit Badge Clinic 2020

Scouts BSA Program Details

Rainbow Council
 Boy Scouts of America
 George S. McGee Service Center
 921 South State St.
 Lockport, IL 60441



Orienteering Lynn Zumstein	10	AM	<p>Pre-Work: Scoutmaster Approval and prepared/signed blue card. Pre-Work Requirements/Post work Requirements:</p> <p>#7 With your parent’s permission*, go to www.geocaching.com. Type in your city and state to locate public geocaches in your area. Share with your counselor the posted information about three of those geocaches. Then, pick one of the three and find the cache.</p> <p>#8 Do ONE of the following: (a) If a Cache to Eagle® series exists in your council, visit at least three of the locations in the series. Describe the projects that each cache you visit highlights, and explain how the Cache to Eagle® program helps share our Scouting service with the public. (b) Create a Scouting-related Travel Bug® that promotes one of the values of Scouting. “Release” your Travel Bug into a public geocache and, with your parent’s permission, monitor its progress at www.geocaching.com for 30 days. Keep a log, and share this with your counselor at the end of the 30-day period. (c) Setup and hide a public geocache, following the guidelines in the <i>Geocaching</i> merit badge pamphlet. Before doing so, share with your counselor a three-month maintenance plan for the geocache where you are personally responsible for those three months. After setting up the geocache, with your parent’s permission, follow the logs online for 30 days and share them with your counselor. You must archive the geocache when you are no longer maintaining it. (d) Explain what Cache In Trash Out (CITO) means, and describe how you have practiced CITO at public geocaches or at a CITO event. Then, either create CITO containers to leave at public caches, or host a CITO event for your unit or for the public.</p> <p>#9 Plan a geohunt for a youth group such as your troop or a neighboring pack, at school, or your place of worship. Choose a theme, set up a course with at least four waypoints, teach the players how to use a GPS unit, and play the game. Tell your counselor about your experience, and share the materials you used and developed for this event.</p> <p style="text-align: center;">❖ <u>This badge cannot be completed at Dresden</u> ❖ <u>These requirements may need to be completed after the merit badge clinic</u></p> <p><u>This Merit Badge is Experimental for Dresden MBC</u></p>
Geocaching Lynn Zumstein	10	PM	<p>Pre-Work: Scoutmaster Approval and prepared/signed blue card. Pre-Work Requirements/Post work Requirements:</p> <p>#7 Do the following:</p> <p>Take part in three orienteering events. One of these must be a cross-country course. After each event, write a report with (1) a copy of the master map and control description sheet, (2) a copy of the route you took on the course, (3) a discussion of how you could improve your time between control points, and (4) a list of your major weaknesses on this course. Describe what you could do to improve.</p> <p>#8 Do ONE of the following:</p> <p>Set up a cross-country course that is at least 2,000 meters long with at least five control markers. Prepare the master map and control description sheet. Set up a score orienteering course with at least 12 control points and a time limit of at least 60 minutes. Set point values for each control. Prepare the master map and control description sheet.</p>



Dresden STEM Merit Badge Clinic 2020

Scouts BSA Program Details

Rainbow Council
 Boy Scouts of America
 George S. McGee Service Center
 921 South State St.
 Lockport, IL 60441



Orienteering Lynn Zumstein	10	PM	<p>#9 Act as an official during an orienteering event. This may be during the running of the course you set up for requirement 8.</p> <p>#10 Teach orienteering techniques to your patrol, troop, or crew.</p> <ul style="list-style-type: none"> ❖ <u>This badge cannot be completed at Dresden</u> ❖ <u>These requirements may need to be completed after the merit badge clinic</u> ❖ <u>This Merit Badge is Experimental for Dresden MBC</u>
-------------------------------	----	----	---

General Information

Rainbow Council, Boy Scouts of America and Exelon Generation, Dresden Nuclear Power Station have been in partnership for several years providing youth the opportunity/education of Science – Technology – Engineering - Math (STEM). Dresden Station provides professional experts that can provide their experience and expertise to the STEM program. Not all merit badges are STEM, but are hobbies of employees and outside professionals.

Dresden Station Unit 1 was the first privately financed nuclear power plant in the United States. Unit 1 is a Boiling Water Reactor (BWR) by General Electric and began operation in 1960 creating 197 MW of electricity. Dresden Unit 1 was retired in 1978. Unit 1 is currently at SAFSTOR (SAFe STORAGE) status.

Dresden Station Units 2 and Unit 3 began operating in 1970 and are Boiling Water Reactor (BWR-3) designed by General Electric. Each unit produces 940 MW of electricity respectively, enough electricity for 1.5 million homes. Both units are designed to operate for 2 years continuously providing carbon free electricity before re-fueling. Dresden Station employs approximately 600 full time personal.

Rainbow Council is chartered by the Boy Scouts of America and serves communities in Will, Grundy, and Kankakee counties. Rainbow Council is located in Lockport, IL at the George S. McGee Service Center. Rainbow Scout Reservation is located on 700-acre scout reservation near Morris, IL. The camp is open year-round supporting all Scout programs and maintains nationally accredited camp status.





Dresden STEM Merit Badge Clinic 2020

Scouts BSA Program Details

Rainbow Council
Boy Scouts of America
George S. McGee Service Center
921 South State St.
Lockport, IL 60441



Scouts BSA and Camping at Rainbow Scout Reservation

All registered Scouts BSA are encouraged to take advantage of this camping opportunity. There will be many program activities available for scouts attending camp. All youth participants must attend Merit Badge Clinic and ride the buses to and from Dresden Station. **Adults/Parents and Troop Leaders shall be responsible** for providing supervision at camp during the entire event. Provisional camping will be provided for any registered Scout BSA, parent/guardian shall plan and notify the clinic coordinator of provisional campers. Provisional scouts will be assigned to a troop/group to camp with. This will be a Jamboree style camping event. If your troop would like to camp alone we will have a couple campsites reserved. Mandatory Boy Scouts of America health form section A and B and Activity Consent Form must be turned in to medical staff upon check-in. **HEALTH RECORDS WILL BE DESTROYED AFTER EVENT**, so send copies. Scouts will be required to register for weekend camping at www.rainbowcouncil.org. No camping equipment will be provided. **ALL participants must have a completed waiver filled out and signed to camp at RSR during this event. A copy of waiver is on page 17 of this guide.**

- ❖ **If your scout does not arrive with their troop, they must be accompanied by a parent/guardian to the office to check in to ensure all paperwork is complete.**

Transportation

Transportation is being provided to Dresden Station by charter bus. These are 66 passenger school buses and transport the scouts/adults in the morning and afternoon. **Every scout must realize the importance of being prompt for arriving at designated bus stops.** Troop Leaders/Parents/Adults, Rainbow Scout Reservation Staff, and Dresden MBC Volunteers will make every attempt to ensure youth/adults are on buses for transportation. **PLEASE discuss with your scout the importance of paying attention to bus schedule and details.**

Bus Schedule

Morning of Saturday, August 8th, 2020
Bus load @ Rainbow Council to Dresden Station
6:30 AM – 7:00 AM

Afternoon of Saturday, August 10th, 2019
Bus load @ Dresden Station to Rainbow Council
3:30 PM – 4:00 PM



Round Trip from Dresden Station to Rainbow Scout Reservation



Dresden STEM Merit Badge Clinic 2020

Scouts BSA Program Details

Rainbow Council
Boy Scouts of America
George S. McGee Service Center
921 South State St.
Lockport, IL 60441



Clinic Only (PARKING)

Guest will be allowed to park wherever they choose, guest can park in the employee lot. Please be aware of postings and traffic control devices as you enter station property. The training building parking lot will be closed to traffic.

General Program Description for Camp activities

The program is constantly being developed for activities at camp by Dresden Merit Badge Committee. Examples are but not limited to: Movie and popcorn in Dining Hall Friday night, Touch a Truck experience, Rifle and Shotgun shooting, COPE course, waterfront activities (if trained staff is available), and fellowship. The program is organized by a dedicated group of volunteers and cannot guarantee availability of program. Rainbow Council would remind all campers that no program nor lunch will be offered at Rainbow Scout Reservation camp during Merit Badge Clinic hours. No camping equipment will be provided.



Adults/Leaders

Adults/Leaders are encouraged to attend the clinic and camping program. There is no fee for Adults/Leaders attending Clinic Only and lunch at Dresden Station will be provided. Adults/Leaders are required to register at www.rainbowcouncil.org. All adults (Guardians/Parents) are encouraged to take Youth Protection training at www.scouting.org. Adults/Leaders attending camp must register. The fee will be \$50, all-inclusive with food provided. Adults/Leaders are welcome to participate during camp activities but youth come first.

Adults/Leaders will not receive activity badge or class B t-shirt. Dresden Station provides youth with class B t-shirt and activity badge. No part of the camping fee pays for this added benefit. All Adults/Leaders attending camp must take Youth Protection training, **this is mandatory.** Proof of YPT training will be required during check-in. Adults can stay back at camp if they choose. No program or food will be available during Clinic Hours between 7:35 AM – 6:30 PM at Rainbow Scout Reservation. Volunteer opportunities are available to adults that can provide labor/skill at camp to repair/clean/maintain the property. Lunch can be provided to those wishing to volunteer at camp. Must notify event coordinator in advance before closing of registration. No camping equipment will be provided.



Dresden STEM Merit Badge Clinic 2020

Scouts BSA Program Details

Rainbow Council
Boy Scouts of America
George S. McGee Service Center
921 South State St.
Lockport, IL 60441



Additional Program

RSR Shooting Sports

If your Scout enjoys Shooting Sports, Rifle and Shotgun will be offered during open program. There is no additional fee. **Participants' must fill out consent/waiver form on page 17 of leader's guide.** The consent/waivers will be collected during safety briefing Friday evening at RSR. **No waiver/consent form, No Shooting.** Mandatory safety brief is required. Ranges will operate on a first come first serve basis. Adults are welcome, but youth come first. RSR staff, Shooting Sports staff, and Dresden Merit Badge Committee will have discretion of closing ranges due to inclement weather and closing regardless of posted schedule. Shooting Sports staff has discretion to refuse service to participants.





Dresden STEM Merit Badge Clinic 2020

Scouts BSA Program Details

Rainbow Council
Boy Scouts of America
George S. McGee Service Center
921 South State St.
Lockport, IL 60441



RSR COPE Course

Scouts must be 13 years of age to participate.

If your Scout likes to Climb, Repel, Zip Line, or Canopy this is for them. This is optional. Participants must fill out consent/waiver form on page 17 of leader's guide. The consent/waivers will be collected during safety briefing Friday evening at RSR. **No waiver/consent form, No COPE.** There is always a possibility that not all parts of COPE course will be open based on availability of qualified supervision. All participants must fill out mandatory waiver and turn it in during check-in. BSA health form required parts A, B, and C. Mandatory safety brief is required. Safety brief will be given at COPE field as participants arrive for activity. Inclement weather could affect COPE course and close the program. RSR staff, COPE staff, and Dresden Merit Badge Committee will have discretion of closing COPE Course due to inclement weather and closing regardless of posted schedule. COPE staff has discretion to refuse service to participants.





Dresden STEM Merit Badge Clinic 2020

Scouts BSA Program Details

Rainbow Council
Boy Scouts of America
George S. McGee Service Center
921 South State St.
Lockport, IL 60441



Waterfront

Rainbow Scout Reservation waterfront may be open for swimming during open program if Aquatics director is available. Swim checks are mandatory and buddy system will be enforced. current year Swim tags from 201 summer camp will be accepted. BSA health form required parts A, B, and C. Inclement weather could affect Waterfront and close open swimming. RSR staff, Waterfront staff, and Dresden Merit Badge Committee will have discretion and determination of inclement weather. *Waterfront will only be open with an approved Aquatics Director and Staff.*



Trading Post

Rainbow Scout Reservation Trading Post will be open during program on Saturday and Sunday. Snacks, Drinks, and Scouting items will be available for purchase during this time.

Food

Special Dietary Needs at RSR

Any Adult/Leader/ or Scout that has special dietary needs, shall contact RSR food coordinator for this event. Adult/Leader/ or Scout must submit written request for special dietary needs no later than July 26th, 2020. Please fill form out on page 16 of leaders guide and return to food coordinator. Scanned PDF file is preferred. Two weeks before registration closure. Do not contact Rainbow Council directly, contact event specialist(s) on page 10 of this guide specifically the food coordinator. Make sure any correspondents have “Dresden MBC DIET” in subject field of e-mails. In some rare cases, it may be necessary for the camper/scout/adult to bring some food items, which can then be prepared by the camp staff.

Written requests can be sent to:

ATTN: Patty Provanve
Pattyp88@sbcglobal.net
Cell Phone: (815) 955-3900

RSR Furnished Meals

Friday Evening - Cracker Barrel
Saturday - Breakfast and Dinner
Sunday – Breakfast
Ice water will be available at all times.

Dresden Furnished Meals

Saturday – Lunch w/drink
Vending machines onsite



Dresden STEM Merit Badge Clinic 2020

Scouts BSA Program Details

Rainbow Council
Boy Scouts of America
George S. McGee Service Center
921 South State St.
Lockport, IL 60441



Disclaimer

All payments are final. No refunds will be offered except for extreme conditions. Dresden Merit Badge Clinic Committee will determine all refunds if any. Merit Badges are subject to change based on Counselor availability. No guarantee of open program(s) at scout reservation. Rainbow Council and Dresden Merit Badge Committee will do its best to recruit trained volunteers for open program for all participants. No guarantee for any open program activities will be made. No special dietary needs will be made at Dresden Station. All scouts should read Merit Badge handbook for respective badge sold at Rainbow Council Scout Shop, or respective Councils Scout Shop prior to arrival to clinic.

Registration Closes July 26th, 2020 at Midnight

Contact Information

**Exelon Generation
Dresden Nuclear Power Station
Main Contact**

Bryan W. Schulte
Event Coordinator
Instrument Maintenance Department
Control System Technician
(815) 416-2296, 3396
Bryan.Schulte@exeloncorp.com

Personal
Cell Phone: (815) 405-1374
bryanschulte@comcast.net

**Exelon Generation
Dresden Nuclear Power Station**

Dean J. Walker
Assistant Coordinator
Senior Regulatory Specialist
Dresden Regulatory Assurance
(815) 416-2812
Dean.Walker@exeloncorp.com

Personal
Cell Phone: (815) 274-0955

**Rainbow Council
Boy Scouts of America**

George S McGee Service Center
921 South State St.
Lockport, IL 60441
(815) 942-4450

www.rainbowcouncil.org

Jarvis Franklin
STEM Staff Advisor
jarvis.franklin@scouting.org

Patty Provance
Food Coordinator/Chef
Pattyp88@sbcglobal.net
Cell Phone: (815) 955-3900
Home: 815-634-8739





Dresden STEM Merit Badge Clinic 2020

Scouts BSA Program Details

Rainbow Council
 Boy Scouts of America
 George S. McGee Service Center
 921 South State St.
 Lockport, IL 60441



Dresden Merit Badge Clinic 2020 Schedule - Saturday

<u>Morning AM</u> August 8 th , 2020 <i>Bus Schedule</i> <i>Load buses 6:30-7:00AM</i> <i>(Arrival to Dresden) No Later Than 7:30 AM</i>	<u>Afternoon PM</u> August 8 th , 2020 <i>Bus Schedule</i> <i>(Departure from Dresden) 3:30 PM – 4:00 PM</i>
7:35 AM Morning Flags Flag Ceremony Led by Waupacan Lodge Scout Oath and Scout Law	11:30 AM – 12:00 PM LUNCH Training Building Cafeteria Lunch Provided by Dresden Station
7:40 AM – 8:00 AM Classroom Orientation Scouts and Guest locate Classrooms	
8:00 AM – 11:30 AM Morning Merit Badge Session	12:00 PM – 3:30 PM Afternoon Merit Badge Sessions
Half Day AM Sessions Electricity, Electronics, Medicine, Bird Study, Finger Printing, Plumbing, Safety, Engineering, Automotive Maintenance, Traffic Safety, Farm Mechanics, First Aid, American Labor, Geocaching	Half Day Afternoon Sessions Electricity, Electronics, Medicine, Bird Study, Finger Printing, Plumbing, Safety, Engineering, Automotive Maintenance, Traffic Safety, Farm Mechanics, First Aid, American Labor, Orienteering
All Day Sessions 8:00AM – 3:30 PM Half Hour Lunch Nuclear Science Fire Safety - Railroading	
Control Room/Plant Simulator Tours every 20-30 minutes Security Simulator – All Day in commons area	
** Automotive Maintenance and Farm Mechanics is located on the East side of station property. ** **Schedule subject to change.**	



Dresden STEM Merit Badge Clinic 2020

Scouts BSA Program Details

Rainbow Council
 Boy Scouts of America
 George S. McGee Service Center
 921 South State St.
 Lockport, IL 60441



Dresden Merit Badge Clinic 2020 Schedule: Rev 0

Friday August 7 th , 2020	Saturday August 8 th , 2020		Sunday August 9 th , 2020
Check-In RSR (Verify Scout Schedule) (Collect Health Forms and waivers for ALL camping) 6:00 pm – 10:30 pm	5:45 am Reville Wake-Up Call		8:00 am – 8:15 am Chapel Service Dining Hall
6:00 pm – 9:00 pm Camp Set-Up	6:00 am – 6:30 am Breakfast (Dining Hall)		8:15 am – 9:15 am Breakfast Dining Hall
Program Activity Movie and popcorn 8:00 pm Dining Hall	6:30 am – 7:00 am Buses Arrive and load at RSR (Begin Transport to Dresden)		9:15 am – 9:40 am Dining Hall Clean-Up
Cracker Barrel 9:00 pm – 10:00 pm Dining Hall	7:35 am Opening Ceremony at Dresden		10:00 am – 11:00 am Break Camp Scouts Dismissed
11:00 pm (Taps) Lights Out	8:00 am – 3:30 pm Dresden Merit Badge Clinic		11:00 am – 12:00 Camp inspection Staff and Waupecan Lodge
	3:30 pm – 4:00 pm (Buses Begin Transport Back to RSR) 4:30 PM Buses are done		
	4:30 pm 6:30 pm Free Time/Open Program	4:30 – 6:30 PM Trading Post Open	
	4:30 PM Range Safety Brief at Range's		
	6:30 pm – 7:30 pm Dinner (Dining Hall)		
	7:30 pm – 8:00 pm Dining Hall Clean-up		
	7:30 PM Range Safety Brief Dining Hall		
	8:00pm – 10:00 pm Free Time/Open Program		
	10:00 pm – 10:30 pm Ice Cream and Root Beer Floats		Shooting Sports Safety Brief Will <u>Only</u> be held twice. 4:30 PM at Range Facility. 7:30 PM at Dining Hall (Saturday ONLY)
	11:00 pm (Taps) Lights Out		COPE Safety Briefing Will take place at COPE field. Participants will have a safety briefing as they arrive for participation. (Saturday Only)

** Schedule subject to change. **



Dresden STEM Merit Badge Clinic 2020

Scouts BSA Program Details

Rainbow Council
Boy Scouts of America
George S. McGee Service Center
921 South State St.
Lockport, IL 60441

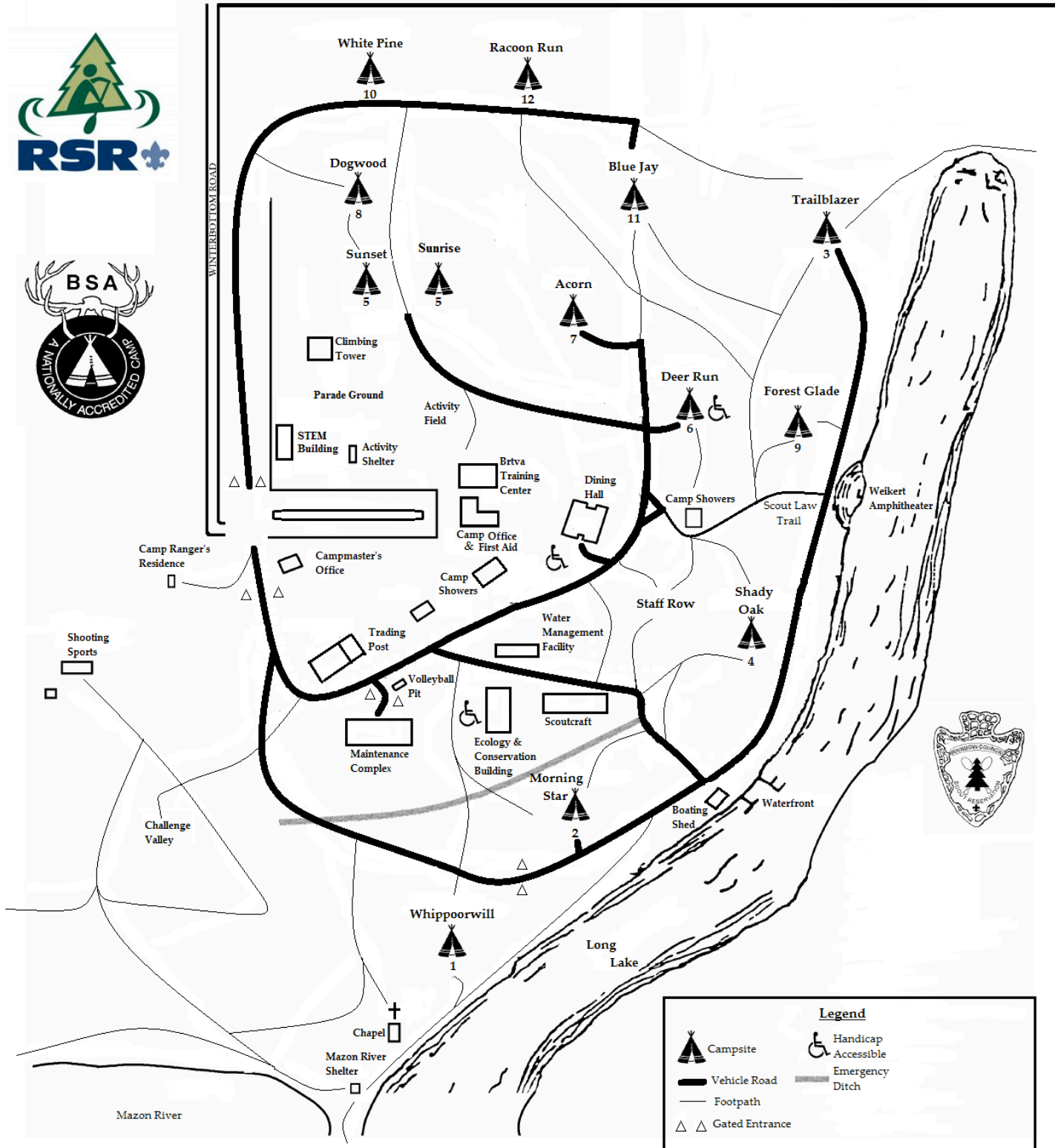



Dresden STEM Merit Badge Clinic 2020

Scouts BSA Program Details

Rainbow Council
 Boy Scouts of America
 George S. McGee Service Center
 921 South State St.
 Lockport, IL 60441



(Dresden ONLY) Dietary Needs Form

Rainbow Scout Reservation strives to serve its campers nutritious meals which meet or exceed all applicable requirements and standards. The variety of foods available at meals is usually adequate to suit the nutritional needs of most campers. In order to meet the needs of participants who have special dietary requirements due to allergies, food intolerances, or other health issues, as well as those who have religious dietary requirements, it is necessary to obtain as much information as possible prior to arrival at camp. Please be as specific regarding exact nature and severity of any allergy or intolerance. This information is necessary to determine whether the individual can simply avoid eating certain foods, whether we need to assess all ingredients in every food, or whether offending foods can or cannot be stored or served where they may contact the individual or things he or she may eat. Additionally, extra time may be required to obtain special foods such as gluten-free breads or vegetarian, vegan entrees or foods made in nut free environments. While RSR attempts to provide meals, which meet these special needs as much as possible, it is still the responsibility of the individual to avoid those foods which he or she is unable to eat. In some rare cases, it may be necessary for the camper to bring some food items, which can then be prepared by the camp staff.

Please Print Legibly

Date of Request:

Name:	
Council:	
Troop:	
Leaders Name:	
Parents Name:	
Main Phone # Contact Person:	
Allergies (yes/no) What is Allergy(s)	Yes No Allergy:
Severity of Allergy(s)	Circle One Moderate Strong Severe

Dietary Needs:	Circle One Vegan Diabetic
Other: Please Explain	
Parent/Guardian Signature and Date:	

Please attached additional page(s) as needed. Please print legibly.



Dresden STEM Merit Badge Clinic 2020

Scouts BSA Program Details

Rainbow Council
Boy Scouts of America
George S. McGee Service Center
921 South State St.
Lockport, IL 60441



ACTIVITY CONSENT FORM AND APPROVAL BY PARENTS OR LEGAL GUARDIAN

FORMULARIO DE CONSENTIMIENTO Y APROBACIÓN DE ACTIVIDAD POR PARTE DE LOS PADRES DE FAMILIA O TUTORES

The recommended use of this form is for the consent and approval for Cub Scouts, Boy Scouts, Varsity Scouts, Venturers, and guests to participate in a trip, expedition, or activity. It is required for use with flying plans.

El uso recomendado de este formulario es para obtener el consentimiento y aprobación para Cub Scouts, Boy Scouts, Varsity Scouts, Venturers, e invitados para participar en un viaje, expedición o actividad. Es obligatorio para su uso con planes de vuelo.

First name of participant Nombre del participante		Middle initial Inicial del segundo nombre	Last name Apellido	
Birth date (month/day/year) Fecha de nacimiento (mes/día/año)			Age during activity Edad al momento de realizar la actividad	
Address Domicilio				
City Ciudad	State Estado		Zip Código postal	
Has approval to participate in (name of activity, orientation flight, outing trip, etc.) Tiene la aprobación para participar en (nombre de la actividad, vuelo de orientación			Dresden Merit Badge Clinic/Camping	
			From De	to a
			(Date) (fecha)	(Date) (fecha)

INFORMED CONSENT, RELEASE AGREEMENT, AND AUTHORIZATION

I understand that participation in Scouting activities involves the risk of personal injury, including death, due to the physical, mental, and emotional challenges in the activities offered. Information about those activities may be obtained from the venue, activity coordinators, or local council. I also understand that participation in these activities is entirely voluntary and requires participants to follow instructions and abide by all applicable rules and the standards of conduct.

In case of an emergency involving my child, I understand that efforts will be made to contact me. In the event I cannot be reached, permission is hereby given to the medical provider to secure proper treatment, including hospitalization, anesthesia, surgery, or injections of medication for my child. Medical providers are authorized to disclose protected health information to the adult in charge and/or any physician or health care provider involved in providing medical care to the participant. Protected Health Information/Confidential Health Information (PHI/CHI) under the Standards for Privacy of Individually Identifiable Health Information, 45 C.F.R. §§160.103, 164.501, etc. seq., as amended from time to time, includes examination findings, test results, and treatment provided for purposes of medical evaluation of the participant, follow-up and communication with the participant's parents or guardian, and/or determination of the participant's ability to continue in the program activities.

With appreciation of the dangers and risks associated with programs and activities including preparations for and transportation to and from the activity, on my own behalf and/or on behalf of my child, I hereby fully and completely release and waive any and all claims for personal injury, death, or loss that may arise against the Boy Scouts of America, the local council, the activity coordinators, and all employees, volunteers, related parties, or other organizations associated with any program or activity.

NOTE: The Boy Scouts of America and local councils cannot continually monitor compliance of program participants or any limitations imposed upon them by parents or medical providers. List any restrictions imposed on a child participant in connection with programs or activities below and counsel your child to comply with those restrictions.

List participant restrictions, if any: None

CONSENTIMIENTO INFORMADO, CONVENIO DE EXONERACIÓN Y AUTORIZACIÓN

Entiendo que la participación en actividades Scouting implica el riesgo de lesiones personales, incluyendo la muerte, debido a los retos físicos, mentales y emocionales en las actividades que se ofrecen. Se puede obtener información sobre dichas actividades en la sede, con los coordinadores de la actividad o el concilio local. También entiendo que la participación en estas actividades es totalmente voluntaria y requiere que los participantes sigan instrucciones y acaten todas las reglas y normas de conducta pertinentes.

En caso de que mi hijo se vea involucrado en una emergencia, entiendo que se realizarán esfuerzos para contactarme. En caso de que yo no pueda ser localizado, por este medio otorgo permiso al proveedor de servicios médicos para garantizar el tratamiento adecuado, incluyendo hospitalización, anestesia, cirugía o inyecciones de medicamentos para mi hijo. Los proveedores de servicios médicos están autorizados a revelar información médica protegida al adulto a cargo, médico o proveedor de servicios médicos involucrado en la prestación de atención médica para el participante. La Información de salud protegida/Información médica confidencial (PHI/CHI, por sus siglas en inglés) bajo los Estándares de privacidad de información médica individualmente identificable, 45 C.F.R. §§ 160.103, 164.501, etc., y siguientes, como se enmiendan de vez en cuando, incluyen resultados de reconocimientos médicos, resultados de pruebas y el tratamiento proporcionado para fines de evaluación médica del participante, seguimiento y comunicación con los padres o tutor legal del participante, o determinación de la capacidad del participante para continuar en las actividades del programa.

Con reconocimiento de los peligros y riesgos asociados con los programas y actividades incluyendo preparativos y transportación hacia y desde la actividad, en mi propio nombre o en nombre de mi hijo, por este conducto eximo total y completamente, y renuncio a cualquiera y toda reclamación por lesiones personales, muerte o pérdidas que puedan surgir, a la organización Boy Scouts of America, el concilio local, los coordinadores de la actividad y todos los empleados, voluntarios, grupos involucrados, u otras organizaciones asociadas con cualquier programa o actividad.

NOTA: La organización Boy Scouts of America y los concilios locales no pueden vigilar continuamente el cumplimiento de los participantes del programa o cualquier limitación impuesta sobre ellos por los padres o proveedores de servicios médicos. Enumerar más abajo las restricciones impuestas a un niño participante en relación con los programas o actividades.

Restricciones del participante, si existen: Ninguna

Participant's signature Firma del participante		Date Fecha
Parent/guardian printed name Nombre con letra de molde del padre de familia/tutor		Date Fecha
Parent/guardian signature Firma del padre de familia/tutor		Date Fecha
Area code and telephone number (best contact and emergency contact) Código de área y número telefónico (primer contacto y contacto de emergencia)		Email (for use in sharing more details about the trip or activity) Correo electrónico (para informar más detalles sobre el viaje o actividad)
Contact the adult leader with any questions: Póngase en contacto con el líder adulto si es que tiene preguntas:		
Name Nombre	Phone Teléfono	Email Correo electrónico



BOY SCOUTS OF AMERICA®

680-673
2014 Printing