



PLATINUM

Coach House[®]™



Beautiful. Practical. Durable. That's the Coach House® Platinum™ Luxury Touring Motorhome. Thanks to its patented *seamless fiberglass shell* — unique in the RV industry — the Platinum™ is built to last. Inside this tough exterior, you will find plenty of living room, loads of storage room and even a private bathroom with a separate shower. This beauty is available in four distinct models with a variety of convenient floor plans. The Coach House Platinum sets a new standard in Luxury Touring Motorhomes.

NOT TOO BIG, NOT TOO SMALL

Coach House, Inc. was founded in 1985 with one goal in mind: To make a high-quality *driveable* motorhome. The Coach House Platinum is spacious enough to contain all the amenities of home — with a full 6 feet, 3 inches of interior headroom — yet small enough to give any driver confidence behind the wheel.

OUR FORD FOUNDATION

Platinum quality starts with the Ford E-450 Super Duty chassis. Its V-10 engine, dual rear wheels, heavy-duty suspension and steel frame rails make it the ideal platform for a luxury RV. Merging into freeway traffic, passing on an uphill grade, or towing a car or boat, you will appreciate the power of the Triton V-10, 6.8-liter engine (or the optional 6.0-liter diesel). With the automatic 5-speed Torq-shift transmission with tow haul mode, it drives like a luxury car.

A FIRM FRAMEWORK

The Platinum's sturdy construction starts with a framework of heavy-gauge 1.5-inch square-tube steel or aluminum, welded by hand and bolted permanently to the chassis. A 1-inch-thick engineered subfloor, wrapped in baked-enamel aluminum underneath, completes the platform to which we attach our innovative one-piece body.



Our one-piece reinforced fiberglass shell is so innovative, it has been granted a U.S. Patent.

A SEAMLESS SHELL

The entire body of the Coach House Platinum is formed in a special rotating mold, resulting in a solid, one-piece fiberglass body with a white gel-coated surface. The structure is reinforced with high-tech composite stringers, much like the ones used in luxury motor yachts. Certainly, it would be easier and less expensive for us to manufacture the body in pieces — but our one-piece construction adds longer-term value to your investment.

THE COMFORTS OF HOME

The Platinum is more than just a powerful vehicle with a strong foundation — it's your home! And all the amenities you would expect in a home are right here:

- A fully-equipped galley that can handle everything from a quick snack to a gourmet meal, thanks to its microwave/convection oven, three-burner LP stove, double porcelain kitchen sink, refrigerator/freezer, solid-surface countertops and abundant storage.
- A full bathroom with stand-up glass shower, his-and-her medicine cabinet and porcelain commode.
- A motorized sofa-bed that takes you from daytime entertaining to nighttime slumbering at the push of a button (in most models).
 - A 13,500-Btu ducted roof air conditioner with heat strip, and a 30,000-Btu furnace.
 - Storage, storage, and more storage: Abundant cabinets hold your food, clothes and travel needs.



The powerful Ford E-450 Super Duty chassis is shown here with the steel frame and generator in place.

STANDARD FEATURES

From the electric retractable entrance step to the heavy-duty trailer hitch, the Coach House Platinum will delight you with its well-thought-out convenience features — *all standard*. Here are just some of them:

- A flat-panel color TV on a swivel arm, plus surround sound for TV, DVD, VCR, CD and AM/FM radio.
- A generator, so you can enjoy Coach House comfort off-road, without a hookup.
- Ride-Rite air spring suspension system.
- Trailer hitch.
- Outside shower with hot and cold water.
- A slide-out tray holding *two* auxiliary coach batteries (with room for a third), plus an emergency start switch that lets you crank the engine with the coach batteries.
- *Two* thermostat-controlled Fantastic roof vent fans.
- Primary windows (Thermo-Pane).
- Optima leather-touch driver and passenger seats.
- A lockable exterior storage compartment for golf clubs or other bulky items.
- Day/night shades with coordinated valances, giving soft, filtered light by day, and total privacy at night.
- Plenty of 110-volt electrical receptacles inside and out.
- Carbon monoxide, LP gas and smoke detectors, plus a fire extinguisher, to help ensure your safety.
- A 68-pound concealed and protected propane tank.
- Universal utility hookups that get you in and out of campsites quickly and easily.
- A central panel from which you monitor fluid and battery levels and control the pump and generator.
- A 110v/12v 45-amp charger-converter that automatically keeps your coach batteries charged when you operate the generator or connect to an electrical hookup.
- And much, much more!



Auxiliary battery tray.



Generator.



Outside shower.



Central monitor panel.



Power sofa-bed.

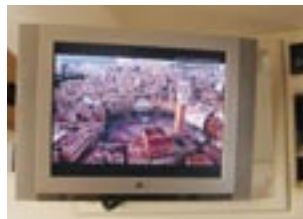

Flat-panel TV.

OPTIONAL ENHANCEMENTS

Even though the Coach House Platinum is loaded with standard features, there are ample options available for you to truly personalize your motorhome. You may choose from among the following:

- Appearance enhancements, including premium and full-body exterior paint.
- A box awning designed for one-person operation — or to make your life even easier, an electric awning.
- Electronic conveniences, such as an automatic satellite dish (stationary or in-motion) or a GPS system.
- A back-up video camera with color monitor.
- A security alarm and/or floor safe.
- Electrical upgrades, including a solar battery charger or a power inverter, .
- Hydraulic leveling jacks (standard on 272XL).
- And more!

PEACE OF MIND

Inside every Coach House is 21 years of experience building fine motorhomes. Whether it's the strength of our fiberglass or the thickness of our plywood, we build value into every facet of every vehicle we manufacture. And we stand behind our work. Every component of your Platinum motorhome is covered by a warranty: The Coach House conversion and the Ford drivetrain are covered for 3 years or 36,000 miles, whichever comes first. The appliances and fixtures are covered by their respective manufacturers for varying terms. Warranty service is available nationwide, or at the Coach House plant in Nokomis, Florida.

SEE FOR YOURSELF

The best way for you to see how well the Coach House Platinum is built is to visit your local Coach House dealer or visit our factory for a personal tour. Factory tours are available weekdays by appointment. Please call ahead.

Inside the Luxury Touring Motorhome



LEFT:
View forward shows living area of the Coach House Platinum, with flat-panel TV mounted over driver's compartment.

BELOW LEFT:
Bathroom features a stand-up shower and a porcelain commode, just like home.

BELOW RIGHT:
Galley features plenty of storage. Sinks and stove can be covered when not in use.

■ FLOOR PLAN: 261XL SD ■ DECOR: Fusion



■ FLOOR PLAN: 261XL SD ■ DECOR: Fusion



■ FLOOR PLAN: 272XL FD ■ DECOR: Fusion

**FUSION
(CONTEMPORARY)**

Cabinets

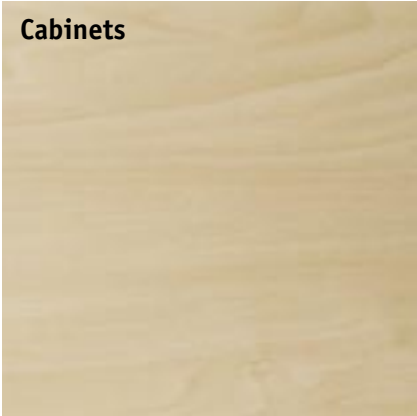

Upholstery

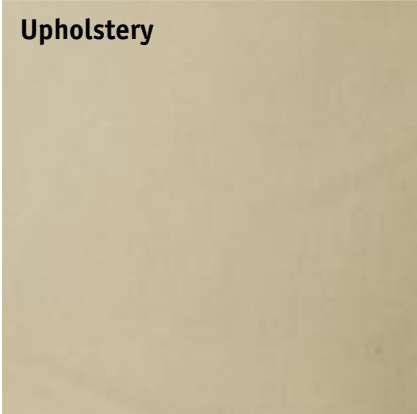

Bedroom



Valances



**SANIBEL
(TRANSITIONAL)**

Cabinets



Upholstery

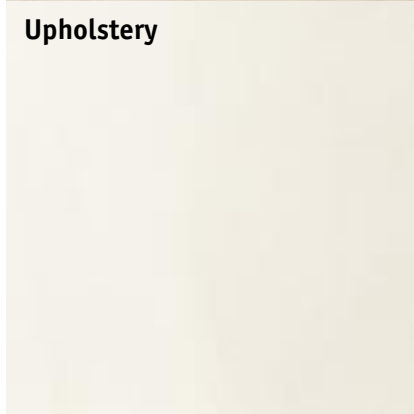

Bedroom



Valances

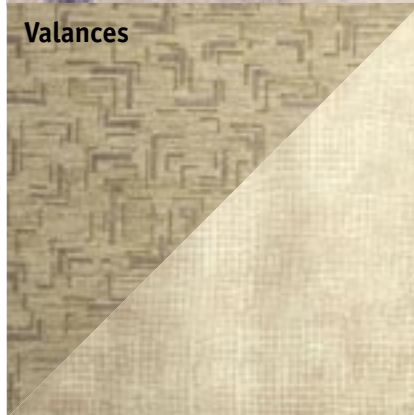

**VENETIAN
(TRADITIONAL)**

Cabinets

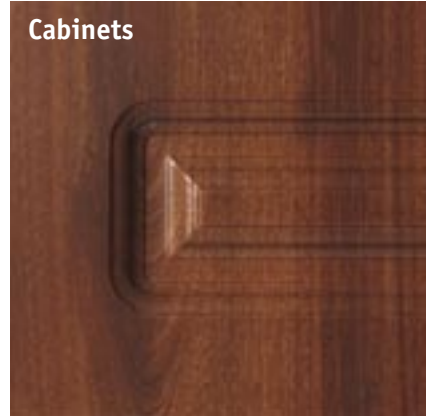

Upholstery

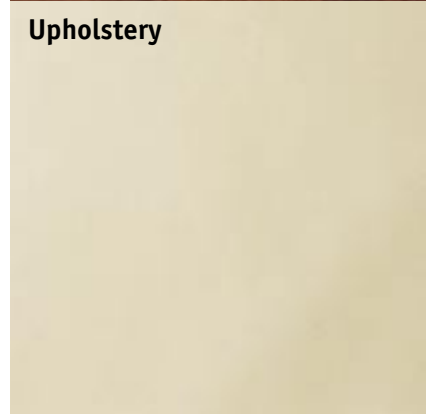

Bedroom



Valances



2006 COACH HOUSE PLATINUM 230 & 231XL

■ MODEL: 230 ■ COLOR: Venetian (premium paint graphics)



*E*conomy Without Sacrifice

The Coach House® Platinum™ 230 and 231XL provide the most economical way to enjoy the superior engineering and construction that set Coach House apart from the rest. These easy-to-drive 23-foot Class C motorhomes include all the comforts of home in a handsome package.

The 231XL combines the exceptional maneuverability of our 23-foot coach with the added convenience of a mid-body slideout housing a power sofa-bed. Fully extended, the slideout provides an extra foot of legroom in the aisle. At night, the power sofa-bed lowers at the touch of a button to become a spacious double bed.

The 230 and 231XL are each available in a Side Dinette floor plan. The flexible Side Dinette can be converted into a twin bed, providing additional sleeping space for a friend or family member.

A large, functional galley occupies the front of each coach. The solid-surface countertop includes matching covers for the two-bowl sink and the three-burner LP stove. There is plenty of storage for all your cooking utensils, and a large pull-out pantry provides easy access to all your groceries. Completing the galley are a 6-cubic-foot three-way refrigerator and a convection/microwave oven.



■ FLOOR PLAN: 231XL SD ■ DECOR: Venetian

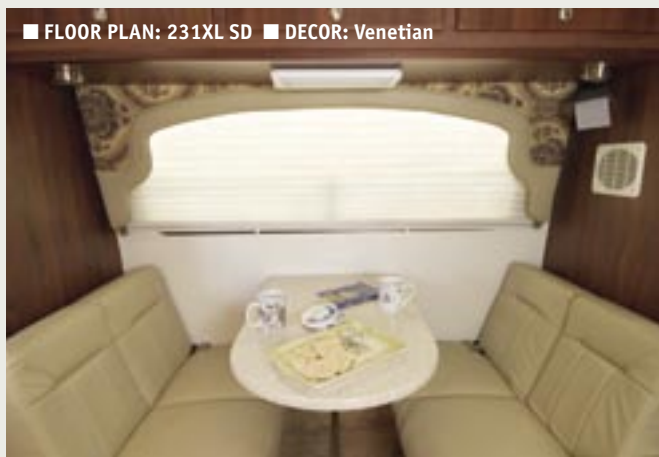

■ FLOOR PLAN: 231XL SD ■ DECOR: Venetian

ABOVE: The Venetian interior is rich and traditional. Warm accents complement the look.

LEFT: The Side Dinette is a cozy place for a quiet meal. At night, it converts into a twin bed.

231XL TB Twin Bed with slideout

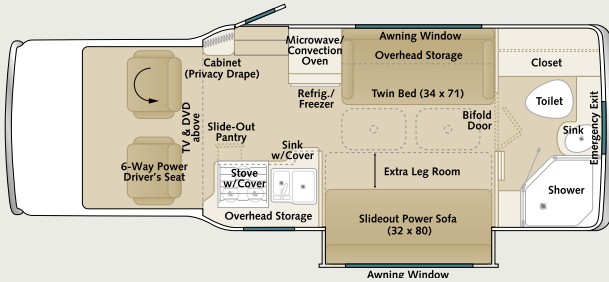

231XL SD Side Dinette with slideout

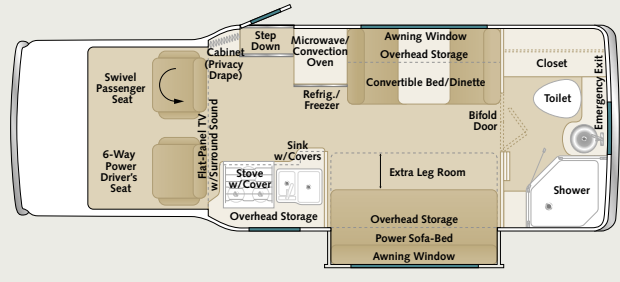

230 TB Twin Bed

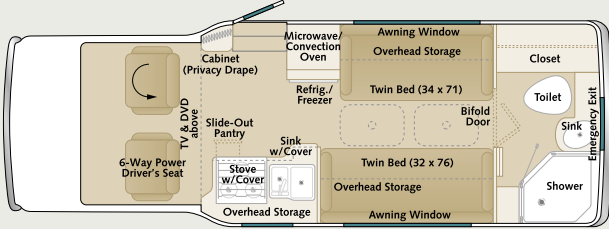

230 SD Side Dinette

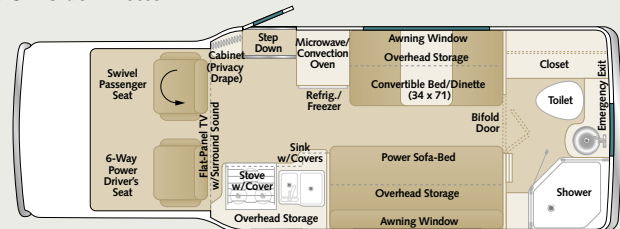

S = Standard O = Optional

INTERIOR FEATURES

- Three color choices:
 - Venetian (traditional);
 - Sanibel (transitional);
 - Fusion (contemporary) S
- Formica/Wilsonart cabinets S
- Expansive overhead cabinetry S
- Large wardrobe closet S
- Solid-surface counter tops S
- Flat-panel television S
- Surround Sound for front TV with DVD, CD, VCR, AM/FM & more S
- Day-night shades S
- TV antenna S
- Front privacy drape on overhead track S
- Premium-grade carpet and floor coverings S
- 6-way power driver's seat S
- Swivel front passenger seat S
- Mirror in bathroom S
- His-and-hers medicine cabinet S
- Separate 6-ft. 2-in. stand-up shower S
- Separate porcelain toilet S
- Separate lavatory sink S
- Fire extinguisher S
- Dashboard kit S
- Optima leather-touch upholstery .. S
- Floor safe 0
- Rear view mirror w/compass and outside temperature 0

EXTERIOR FEATURES

- Patented aerodynamic one-piece body S
- Electric entrance step with light ... S
- Class III trailer hitch S
- Large lockable exterior storage S
- Recessed spare tire S
- 1.5-inch square-tube steel floor trusses S
- Stainless steel wheel simulators ... S
- Exterior hot and cold shower S
- Full-size side entry door w/screen . S

CHASSIS FEATURES

Ford E-450 Super Duty Chassis (158-in. wheelbase) with 6.8-liter Triton V-10 engine; automatic 5-speed TorqShift transmission with tow/haul mode; power steering; power windows; power door locks; power side mirrors; 55-gallon gas tank; 4-wheel anti lock disc brakes; spare tire and rim; air conditioning; cruise control; AM/FM/CD stereo; tilt steering wheel; intermittent wipers; front chrome bumper and grill; aero halogen headlamps; light and convenience group; driver and passenger airbags.

Optional Engine: 6.0-liter diesel

- Telephone and cable TV jacks S
- Firestone Ride-Rite air suspension system w/compressor S
- HWH hydraulic slideout (231XL) ... S
- Primary windows (Thermo-Pane) ... S
- Premium paint and graphics 0
- Full-body paint (excl. rooftop) 0
- HWH automatic hydraulic leveling system 0
- Mor-Ryde suspension 0
- Billet front engine grill 0
- Front air dam & fog lights 0
- Retractable box awning 0
- Electric box awning 0

GALLEY

- Recessed three-burner LP gas stove w/cover S
- Range hood with monitor panel S
- Convection/microwave oven S
- Recessed double-basin kitchen sink w/covers S
- 6-cu.-ft. three-way refrigerator ... S
- Spacious pantry S
- Built-in coffeemaker 0

SELF-SUPPORTING SYSTEMS

- All-weather interior plumbing S
- Concealed 68-lb. propane tank S
- 6-gal. LPG/electric water heater ... S
- Porcelain flush toilet S
- Demand fresh water system S

- Porch, compartment and entry lights S
- GPS system 0
- Automatic satellite dish (in motion) 0
- Automatic satellite dish (stationary) 0
- Power inverter 0
- Solar battery charger 0
- Color back-up video camera 0
- Security alarm w/keyless remote... 0
- Additional 3rd auxiliary battery ... 0

DIMENSIONS

- Wheelbase 158"
- Overall length 23' 2"
- Overall width 8' 0"
- Overall width with slideout extended (231XL) 9' 0"
- Overall height incl. A/C 10' 5"
- Interior headroom 6' 3"
- Dry weight (230) 10,500 lbs.
- Dry weight (231XL) 11,500 lbs.
- GVWR (max. weight of loaded vehicle) 14,050 lbs.
- GCWR (max. weight of loaded vehicle plus tow) 20,000 lbs.
- Rear axle ratio (gas) 4.56 to 1
- Rear axle ratio (diesel) 4.10 to 1

BED SIZES

- Power sofa bed 54" x 76"
- Dinette bed 34" x 71"

TANK CAPACITIES

- Gas tank 55 gal.
- Fresh water tank (230) 30 gal.
- Fresh water tank (231XL) 25 gal.
- Grey water tank 30 gal.
- Black water tank 25 gal.



3480 TECHNOLOGY DRIVE · NOKOMIS, FL 34275
(941) 485-0984 · 1-800-235-0984 · www.coachhousesrv.com

2007 COACH HOUSE PLATINUM 232XL

■ COLOR: Venetian (optional full-body paint)

NEW
for 2007!

Live Large in a Smaller Motorhome

The new Coach House® Platinum™ 232XL answers the question, “How much luxury can you build into an easy-to-drive 23-foot motorhome?” Well, check it out:

- ✓ Permanent double bed? *Check.*
- ✓ Full bathroom with an enclosed stand-up shower and separate porcelain commode? *Check.*
- ✓ Well-equipped kitchen with sink, stove, refrigerator and microwave/convection oven? *Check.*
- ✓ Plenty of room for dining and relaxing? *Check.*
- ✓ Entertainment center? *Check.*

How did we manage to get so much living space into a 23-foot RV? With *two* trouble-free HWH hydraulic slideouts. At the push of a button, the front sofa or dinette slides out, opening up valuable space in the heart of the unit, where you will be cooking, relaxing or entertaining. Push another button, and the double bed in the rear slides out, providing easy access to the bathroom and storage.

The Platinum 232XL is available in two well-thought-out floor plans, a Front Dinette (which can be converted to a twin bed) and a Front Sofa (with a motorized sofa that folds down into a double bed).



■ FLOOR PLAN: 232XL FD ■ DECOR: Sanibel

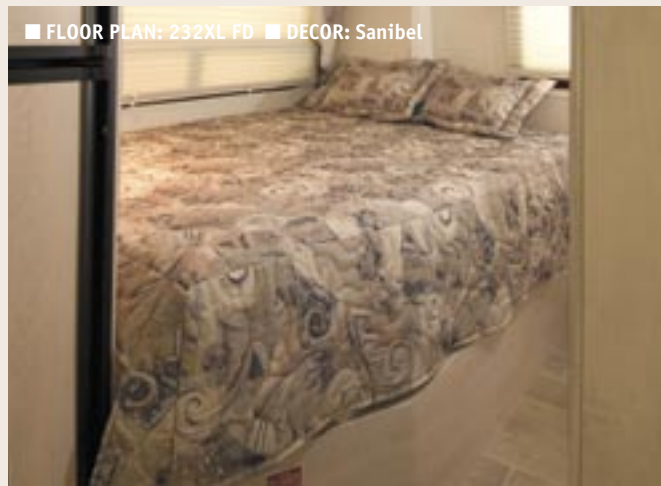

■ FLOOR PLAN: 232XL FD ■ DECOR: Sanibel

ABOVE: View to the rear shows permanent double bed (left) and bathroom. Kitchen and dinette are in the front of the coach.

LEFT: Permanent double bed is contained in its own slideout. A 23-foot motorhome has never felt so spacious!

232XL FD Front Dinette with two slideouts

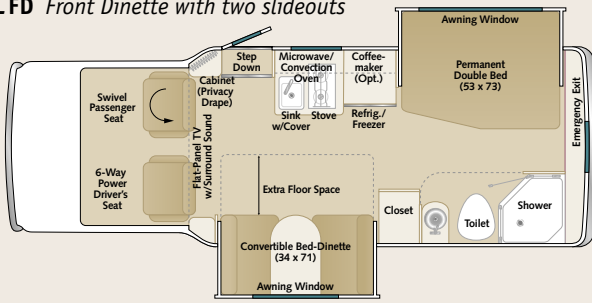

232XL FS Front Sofa with two slideouts



S = Standard O = Optional

INTERIOR FEATURES

- Three color choices:
 - Venetian (traditional);
 - Sanibel (transitional);
 - Fusion (contemporary)S
- Formica/Wilsonart cabinetsS
- Expansive overhead cabinetryS
- Large wardrobe closetS
- Solid-surface counter topsS
- Flat-panel televisionS
- Surround Sound for front TV with DVD, CD, VCR, AM/FM and moreS
- Day-night shadesS
- TV antennaS
- Front privacy drape on overhead trackS
- Premium-grade carpet and floor coveringsS
- 6-way power driver's seatS
- Swivel front passenger seatS
- Mirror in bathroomS
- Separate 6-ft 2-in. stand-up showerS
- Separate porcelain toiletS
- Separate lavatory sinkS
- Fire extinguisherS
- Dashboard kitS
- Optima leather-touch upholstery ..S
- Floor safe0
- Rear view mirror w/compass and outside temperature0

EXTERIOR FEATURES

- Patented aerodynamic one-piece bodyS
- Electric entrance step with light ...S
- Class III trailer hitchS
- Large lockable exterior storageS
- Recessed spare tireS
- 1.5-inch square-tube steel floor trussesS
- Stainless steel wheel simulators ...S
- Exterior hot and cold showerS
- Full-size side entry door w/screen .S
- Telephone and cable TV jacksS
- Two HWH hydraulic slideoutsS
- Firestone Ride-Rite air suspension system w/compressorS
- Primary windows (Thermo-Pane) ...S
- Premium paint and graphics0

CHASSIS FEATURES

Ford E-450 Super Duty Chassis (158-in. wheelbase) with 6.8-liter Triton V-10 engine; automatic 5-speed TorqShift transmission with tow/haul mode; power steering; power windows; power door locks; power side mirrors; 55-gallon gas tank; 4-wheel anti lock disc brakes; spare tire and rim; air conditioning; cruise control; AM/FM/CD stereo; tilt steering wheel; intermittent wipers; front chrome bumper and grill; aero halogen headlamps; light and convenience group; driver and passenger airbags.

Optional Engine: 6.0-liter diesel

- Full-body paint (excl. rooftop)0
- HWH automatic hydraulic leveling system0
- Billet front engine grill0
- Front air dam & fog lights0
- Retractable box awning0
- Electric box awning0

GALLEY

- Two-burner LP gas stoveS
- Range hood with monitor panel ...S
- Convection/microwave ovenS
- Recessed kitchen sink w/coverS
- 6-cu.-ft. three-way refrigeratorS
- Built-in coffeemaker0

SELF-SUPPORTING SYSTEMS

- All-weather interior plumbingS
- Concealed 68-lb. propane tankS
- 6-gallon propane/electric water heaterS
- Porcelain flush toiletS
- Demand fresh water systemS
- City water connectionS
- Universal utility compartmentS

HEATING AND COOLING

- 13,500-Btu ducted roof air conditioner with heat stripS
- 30,000-Btu auto LP gas furnaceS
- Two Fantastic roof vents with thermostat and 3-speed fanS
- Heavy-duty insulation R-28S
- Heated holding tanks0

ELECTRICAL

- 110v/12v 45-amp converter/chargerS

- Color back-up video camera and monitor0
- Security alarm w/keyless remote ...0
- Additional 3rd auxiliary battery0
- Solar battery charger0

DIMENSIONS

- Wheelbase 158"
- Overall length23' 2"
- Overall width 8' 0"
- Overall width with slideouts extended 11'
- Overall height incl. A/C10' 5"
- Interior headroom 6' 3"
- Dry weight 11,850 lbs.
- GVWR (max. weight of loaded vehicle) 14,050 lbs.
- GCWR (max. weight of loaded vehicle plus tow) 20,000 lbs.
- Rear axle ratio (gas) 4.56 to 1
- Rear axle ratio (diesel) 4.10 to 1

BED SIZES

- Power sofa (FS only)54" x 71"
- Dinette bed (FD only)34" x 71"
- Double bed w/innerspring mattress53" x 73"

TANK CAPACITIES

- Gas tank 55 gal.
- Fresh water tank 28 gal.
- Grey water tank 28 gal.
- Black water tank 25 gal.



3480 TECHNOLOGY DRIVE · NOKOMIS, FL 34275
(941) 485-0984 · 1-800-235-0984 · www.coachhouse.com

Your Authorized Coach House® Dealer

2006 COACH HOUSE PLATINUM 261XL

■ COLOR: Sanibel (optional full-body paint)



Entertain in the Wide-Open Spaces

We could have called this model “The Entertainer.” With its front slideout sofa-bed, the Platinum™ 261XL provides an amazingly large living area for you and your guests to dine and relax in comfort. Up to seven people may be seated comfortably using the sofa, the dinette or lounge (depending on the floorplan) and the swivel front passenger seat.

The Platinum 261XL is available in two floor plans, a Side Dinette and a Club Lounge. The Side Dinette can be converted into a twin bed at night, providing an additional bed for a friend or family member. The Club Lounge provides a permanent table and seats for two. Both floor plans feature a power sofa-bed that folds down into a double bed at the press of a button.

Besides its spacious living area, the Platinum 261XL also boasts a roomy kitchen that feels like it belongs in a much larger motorhome. The ample countertop is made even bigger with the use of fitted covers over the double-basin kitchen sink and the three-burner stove. The pull-out pantry and additional storage compartment hold bag after bag of groceries.

And like all members of the Platinum family, the 261XL boasts more standard features than any other vehicle in its class.



■ FLOOR PLAN: 261XL CL ■ DECOR: Sanibel



■ FLOOR PLAN: 261XL CL ■ DECOR: Sanibel

ABOVE: With the slideout extended, the 261XL offers the living space of a much larger vehicle.

LEFT: The spacious galley of the 261XL offers the largest countertop of any Coach House Platinum model.

261XL CL Club Lounge with slideout

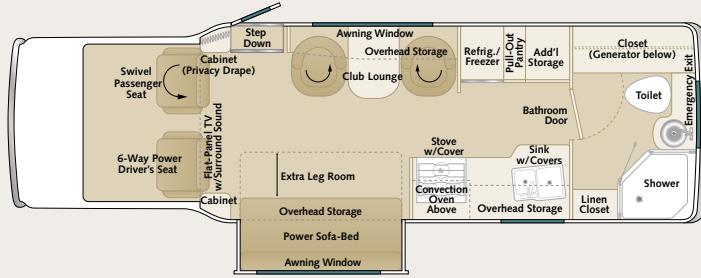

261XL SD Side Dinette with slideout

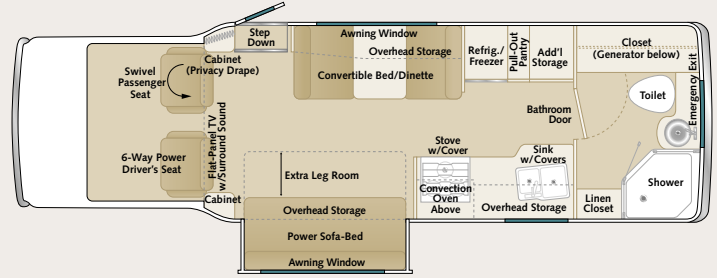

S = Standard O = Optional

INTERIOR FEATURES

- Three color choices:
 - Venetian (traditional);
 - Sanibel (transitional);
 - Fusion (contemporary)S
- Formica/Wilsonart cabinetsS
- Expansive overhead cabinetryS
- Large wardrobe closetS
- Solid-surface counter topsS
- Flat-panel televisionS
- Surround Sound for front TV with DVD, CD, VCR, AM/FM and moreS
- Day-night shadesS
- TV antennaS
- Front privacy drape on overhead trackS
- Premium-grade carpet and floor coveringsS
- 6-way power driver's seatS
- Swivel front passenger seatS
- Mirror in bathroomS
- His-and-hers medicine cabinetS
- Separate 6-ft 2-in. stand-up showerS
- Separate porcelain toiletS
- Separate lavatory sinkS
- Fire extinguisherS
- Dashboard kitS
- Optima leather-touch upholstery ..S
- Floor safe0
- Rear view mirror w/compass and outside temperature0

EXTERIOR FEATURES

- Patented aerodynamic one-piece bodyS
- Electric entrance step with light ...S
- Class III trailer hitchS
- Large lockable exterior storageS
- Recessed spare tireS
- 1.5-inch square-tube aluminum floor trussesS
- Stainless steel wheel simulators ...S
- Exterior hot and cold showerS
- Full-size side entry door w/screen .S
- Telephone and cable TV jacksS
- HWH hydraulic slideoutS
- Firestone Ride-Rite air suspension system w/compressorS
- Rear skid wheelsS

CHASSIS FEATURES

Ford E-450 Super Duty Chassis (176-in. wheelbase) with 6.8-liter Triton V-10 engine; automatic 5-speed TorqShift transmission with tow/haul mode; power steering; power windows; power door locks; power side mirrors; 55-gallon gas tank; 4-wheel anti lock disc brakes; spare tire and rim; air conditioning; cruise control; AM/FM/CD stereo; tilt steering wheel; intermittent wipers; front chrome bumper and grill; aero halogen headlamps; light and convenience group; driver and passenger airbags.

Optional Engine: 6.0-liter diesel

- Primary windows (Thermo-Pane) ...S
- Premium paint and graphics0
- Full-body paint (excl. rooftop)0
- HWH automatic hydraulic leveling system0
- Billet front engine grill0
- Front air dam & fog lights0
- Retractable box awning0
- Electric box awning0

GALLEY

- Recessed three-burner LP gas stove w/coverS
- Range hood with monitor panelS
- Convection/microwave ovenS
- Recessed double-basin kitchen sink w/coversS
- 6-cu.-ft. three-way refrigeratorS
- Spacious pantryS
- Built-in coffeemaker0

SELF-SUPPORTING SYSTEMS

- All-weather interior plumbingS
- Concealed 68-lb. propane tankS
- 6-gallon electric/engine assist water heaterS
- Porcelain flush toiletS
- Demand fresh water systemS
- City water connectionS
- Universal utility compartmentS

HEATING AND COOLING

- 13,500-Btu ducted roof air conditioner with heat stripS
- 30,000-Btu auto LP gas furnaceS
- Two Fantastic roof vents with thermostat and 3-speed fanS
- Heavy-duty insulation R-28S

- Heated holding tanks0

ELECTRICAL

- 110v/12v 45-amp converter/chargerS
- 4.0kw generator (Micro-quiet) (3.6LPG generator with diesel)S
- Ample 110v electrical outletsS
- Interior light groupS
- Carbon monoxide, LP gas and smoke detectorsS
- Emergency start switchS
- Two auxiliary coach batteries (room for three)S
- Auxiliary battery disconnectS
- 30-foot shore power cordS
- Exterior 110v outletS
- Battery isolatorS
- Porch, compartment and entry lightsS
- GPS system0
- Power inverter0

- Automatic satellite dish (in motion)0
- Automatic satellite dish (stationary)0
- Color back-up video camera0
- Security alarm w/keyless remote ...0
- Additional 3rd auxiliary battery0
- Solar battery charger0

DIMENSIONS

- Wheelbase 176"
- Overall length 26' 10"
- Overall width 8' 0"
- Overall width with slideout extended 10' 4"
- Overall height incl. A/C 10' 5"
- Interior headroom 6' 3"
- Dry weight 11,580 lbs.
- GVWR (max. weight of loaded vehicle) 14,050 lbs.
- GCWR (max. weight of loaded vehicle plus tow) 20,000 lbs.
- Rear axle ratio (gas) 4.56 to 1
- Rear axle ratio (diesel) 4.10 to 1

BED SIZES

- Power sofa in slideout 54" x 75"
- Dinette (SD only) 34" x 78"

TANK CAPACITIES

- Gas tank 55 gal.
- Fresh water tank 32 gal.
- Grey water tank 30 gal.
- Black water tank 25 gal.



3480 TECHNOLOGY DRIVE · NOKOMIS, FL 34275
(941) 485-0984 · 1-800-235-0984 · www.coachhouse.com



The Ultimate in Luxury and Spaciousness

The Coach House Platinum™ 272XL is the ultimate motorhome for those who want all the comforts of home in an easy-to-drive vehicle. The unique low-profile design cuts through the wind to maximize fuel economy, while being very stable in all weather conditions.

The 272XL features two distinct living areas. The front area is great for entertaining, dining, cooking, relaxing or watching your favorite show on the flat-panel TV with surround sound. The rear offers a full permanent bed with plenty of light for reading, awning windows for visibility and ventilation, plenty of storage for clothing and other travel needs, and privacy to make you feel safe and secure.

Two HWH slideout rooms provide a dramatic increase in floor space at the push of a button when you reach your destination. A fully automatic leveling system keeps your vehicle level and stable while you enjoy your favorite campground or campsite.

Standard features include a generator, a ducted air conditioning system with heat strip, a 30,000-Btu furnace, a flat-panel TV with surround sound, Optima leather seating, solid-surface countertops, abundant storage, a Class III trailer hitch, air-ride suspension, two Fantastic roof vents, and much more.



■ FLOOR PLAN: 272XL FS ■ DECOR: Fusion



■ FLOOR PLAN: 272XL FS ■ DECOR: Fusion

ABOVE: The contemporary Fusion interior is tastefully designed with soft, neutral colors. Optima leather furniture completes the stylish look.

LEFT: The bedroom has a permanent double bed, plenty of storage, and nice soft lighting.

272XL FS Front Sofa with dual slideouts

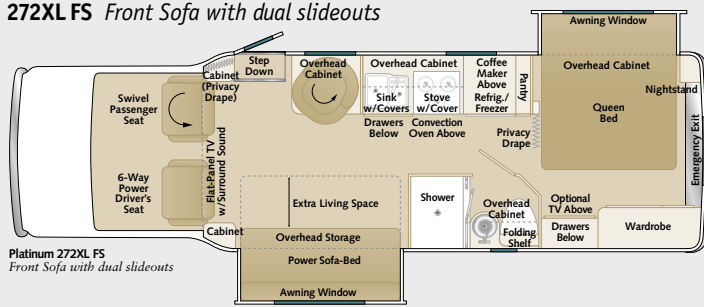

Platinum 272XL FS
Front Sofa with dual slideouts

272XL FD Front Dinette with dual slideouts

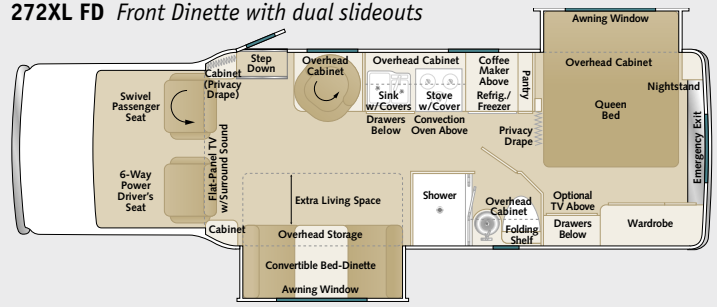

S = Standard O = Optional

INTERIOR FEATURES

- Three color choices:
Venetian (traditional);
Sanibel (transitional);
Fusion (contemporary)S
- Formica/Wilsonart cabinetsS
- Expansive overhead cabinetryS
- Large wardrobe closetS
- Solid-surface counter topsS
- Flat-panel televisionS
- Surround Sound for front TV with
DVD, CD, VCR, AM/FM & more.....S
- Day-night shadesS
- TV antennaS
- Front privacy drape on overhead
trackS
- Premium-grade carpet and floor
coveringsS
- 6-way power driver's seatS
- Swivel front passenger seat.....S
- Mirror in bathroomS
- His-and-hers medicine cabinet.....S
- Separate 6-ft 2-in. stand-up
showerS
- Separate porcelain toilet.....S
- Separate lavatory sinkS
- Fire extinguisher.....S
- Dashboard kit.....S
- Optima leather-touch upholstery ..S
- Flat-panel TV in bedroom.....0
- Floor safe0
- Rear view mirror w/compass
and outside temperature.....0

EXTERIOR FEATURES

- Patented aerodynamic one-piece
bodyS
- Electric entrance step with light ...S
- Class III trailer hitchS
- Large lockable exterior storage.....S
- Underfloor spare tireS
- 1.5-inch square-tube aluminum
floor trussesS
- Stainless steel wheel simulators ...S
- Exterior hot and cold shower.....S
- Full-size side entry door w/screen.S
- Telephone and cable TV jacksS
- Two HWH hydraulic slideouts.....S
- Firestone Ride-Rite air suspension
system w/compressor.....S
- Rear skid wheelsS

CHASSIS FEATURES

Ford E-450 Super Duty Chassis (176-in. wheelbase) with 6.8-liter Triton V-10 engine; automatic 5-speed TorqShift transmission with tow/haul mode; power steering; power windows; power door locks; power side mirrors; 55-gallon gas tank; 4-wheel anti lock disc brakes; spare tire and rim; air conditioning; cruise control; AM/FM/CD stereo; tilt steering wheel; intermittent wipers; front chrome bumper and grill; aero halogen headlamps; light and convenience group; driver and passenger airbags.

Optional Engine: 6.0-liter diesel

- HWH automatic hydraulic
leveling systemS
- Primary windows (Thermo-Pane)...S
- Premium paint and graphics.....0
- Full-body paint (excl. rooftop)0
- Billet front engine grill0
- Front air dam & fog lights.....0
- Retractable box awning.....0
- Electric box awning0

GALLEY

- Recessed three-burner LP gas
stove w/coverS
- Range hood with monitor panel....S
- Convection/microwave ovenS
- Recessed double-basin kitchen
sink w/coversS
- 6-cu.-ft. three-way refrigeratorS
- Spacious pantryS
- Built-in coffeemaker.....0

SELF-SUPPORTING SYSTEMS

- All-weather interior plumbingS
- Concealed 68-lb. propane tankS
- 6-gallon electric/engine assist
water heaterS
- Porcelain flush toiletS
- Demand fresh water systemS
- City water connectionS
- Universal utility compartment.....S

HEATING AND COOLING

- 13,500-Btu ducted roof air
conditioner with heat strip.....S
- 30,000-Btu auto LP gas furnace.....S
- Two Fantastic roof vents with
thermostat and 3-speed fanS
- Heavy-duty insulation R-28S

- Heated holding tanks0

ELECTRICAL

- 110v/12v 45-amp converter/
chargerS
- 4.0kw generator (Micro-quiet)
(3.6LPG generator with diesel)S
- Ample 110v electrical outlets.....S
- Interior light groupS
- Carbon monoxide, LP gas and
smoke detectorsS
- Emergency start switchS
- Two auxiliary coach batteries
(room for three)S
- Auxiliary battery disconnectS
- 30-foot shore power cordS
- Exterior 110v outletS
- Battery isolatorS
- Porch, compartment and entry
lightsS
- Power inverter.....0
- Automatic satellite dish
(in motion)0

- Automatic satellite dish
(stationary).....0
- Solar battery charger0
- Color back-up video camera0
- GPS system0
- Security alarm w/keyless remote...0
- Additional 3rd auxiliary battery0

DIMENSIONS

- Wheelbase176"
- Overall length.....26' 10"
- Overall width.....8' 0"
- Overall width with
slideouts extended11' 6"
- Overall height incl. A/C.....10' 5"
- Interior headroom.....6' 3"
- Dry weight11,900 lbs.
- GVWR (max. weight
of loaded vehicle).....14,050 lbs.
- GCWR (max. weight of loaded
vehicle plus tow).....20,000 lbs.
- Rear axle ratio (gas)4.56 to 1
- Rear axle ratio (diesel)....4.10 to 1

BED SIZES

- Queen bed in bedroom60" x 72"
- Power sofa in front slideout
(FS only).....54" x 72"
- Dinette in front slideout
(FD only)34" x 72"

TANK CAPACITIES

- Gas tank55 gal.
- Fresh water tank38 gal.
- Grey water tank25 gal.
- Black water tank.....20 gal.



3480 TECHNOLOGY DRIVE · NOKOMIS, FL 34275
(941) 485-0984 · 1-800-235-0984 · www.coachhouse.com

Customer Testimonials

“Coach House is the best planned and executed RV I’ve ever seen, down to the last detail. I am just thrilled with it.”

— Jean N.

“We are extremely pleased with the ease of handling, the excellent workmanship, and all the nice features — and are especially pleased about your continued interest in our satisfaction.”

— Bob & Louise J.

“This is our second Coach House, and we are already anticipating our next purchase. Frankly, with the quality of Coach House, and the kind of service you provide, we would not even look at another company’s product.”

— Jack & Martha N.

“What do we think of the new Platinum? We love it! The E-450 chassis handles very well — the ride is excellent.”

— Bill and Jeri S.



3480 TECHNOLOGY DRIVE • NOKOMIS, FL 34275
(941) 485-0984 • 1-800-235-0984 • www.coachhousesrv.com



MADE IN THE U.S.A.