

evconnectors
Innovative power connectors for electric vehicles



Electric Vehicle Charging
Products & Connectors



EVconnectors is the brand name for a range of products and Connectors specifically for the Electric Vehicle industry.

The EV connectors focus particularly on the emerging Electric Vehicle market and the associated infrastructure product manufacturing companies in addition to the long term after market requirements.

The Products and Services aim to fill the demand from Car, Commercial Electric vehicle and Street Charging Equipment manufacturers who require a specialist supplier to support the requirements of the industry.

www.evconnectors.com





Charging Modes and Standards

04



Cable Selection Guide

05



Type 1 - J1772 Plug & Socket / Inlet

06 - 09



Type 2 - 62196-2 Vehicle Charging Plugs

10 - 13



Type 2 - 62196-2 Charging Station Socket / Inlet

14 - 17



Type 2 - 62196-2 New Vehicle Inlet & Plugs

18 - 23



EV Tester and Rescue

24 - 25

› Charging Modes

CHARGING MODES	INTERLOCKING	SINGLE PHASE	3 PHASE
Mode 1	In Vehicle	MAX 16A - 3.7 kW	MAX 16A - 11.0 kW
Mode 2	In Vehicle	MAX 32A - 7.4 kW	MAX 32A - 22.0 kW
Mode 3	Vehicle and Charging Sockets	MAX 63A - 14.5 kW	MAX 63A - 43.5 kW

Different Charging Modes are defined for various applications and charging requirements.

The EV Market is currently adopting Mode 3 for Street and Fast Charging were Vehicles can be charged with upto 63A 3 Phase current.

Mode 1 and 2 are Domestic Chargers which will be superceded with intelligent versions.

› Standards









STANDARDS	CAPACITY		
J1772 TYPE 1	up to 7.4 kW	up to 63A	Single Phase
62196-2 TYPE 2	up to 44 kW	up to 63A	Single - 3 Phase

J1772 Type 1 is generally the adopted standard in Japan and the US.

62196-2 Type 2 adopted by the European Charger Manufacturers.

62196-2 version 2 is now available where the contact gender has been changed to bring the standard for Vehicles into line with traditional IEC legislation.

› Cable Selection Guide

Vehicle	Vehicle Plug DSI	Charger Plug DSIEC	Part No.	Description	Cable Length
 <p>5 Pin J1772 Male Vehicle Inlet Chevrolet Volt Citroen C-Zero Ford Focus Electric Mia Mitsubishi I-Miev Nissan NV200 SE Van Nissan Leaf Peugeot Ion Renault Fluence Renault Kangoo Smiths Edison Van Smiths Newton Tata Indica Vista EV Toyota Prius Vauxhall Ampera</p>	Type 1 Female Mode 3 	Type 2 Male Mode 3 	DSI-DSIEC-EV16P-XC	Type 1 to Type 2 16A Plug	3 or 5m Cable
			DSI-DSIEC-EV32P-XC	Type 1 to Type 2 32A Plug	3 or 5m Cable
 <p>7 Pin 62196-2 Female Vehicle Inlet Smart</p>	Type 2 Male Mode 3 	Type 2 Male Mode 3 	DSIEC-2EV16P-XC	Type 2 to Type 2 16A Plug	3 or 5m Cable
			DSIEC-2EV32P-XC	Type 2 to Type 2 32A Plug	3 or 5m Cable
 <p>7 Pin 62196-2 Male Vehicle Inlet Smart 2 Renault Zoe NEW</p>	Type 2 Female Mode 3 	Type 2 Male Mode 3 	DSIEC2b-2e-EV16P-XC	Type 2 to Type 2 16A Plug	3 or 5m Cable
			DSIEC2b-2e-EV32P-XC	Type 2 to Type 2 32A Plug	3 or 5m Cable

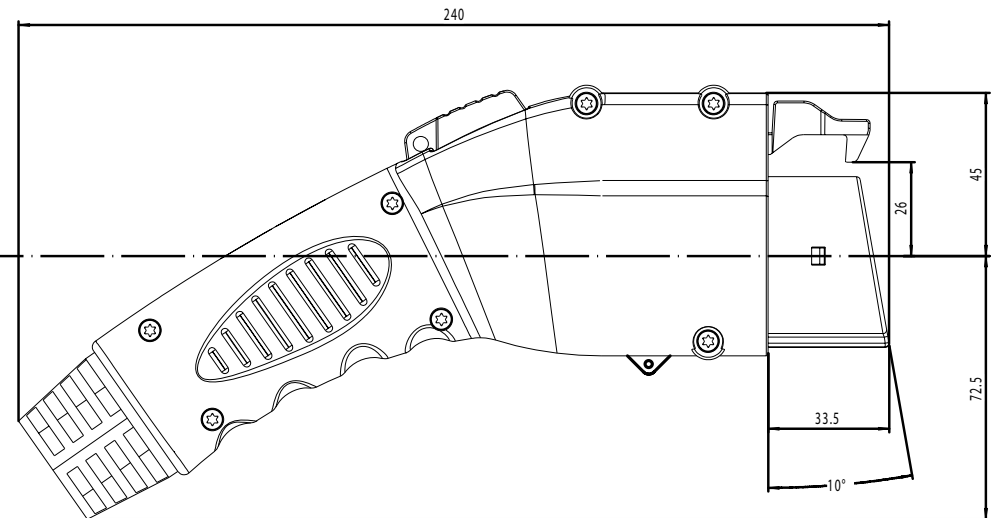
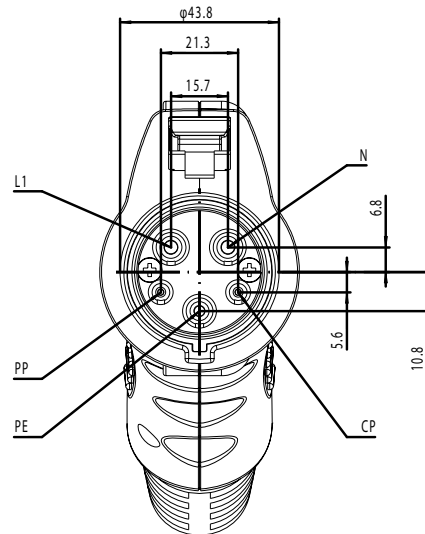

› J1772 › Female Plug

- IP54 Rated Ergonomic Pistol Grip Style
- Impact Resistant 'Run Over' Proof
- 10,000 Mating Cycles
- Cable Strain Relief Feature
- Insulated Terminal Design
- Locking Feature for Padlock
- Dust Cap on Lanyard
- Custom Options on Cable Length and Colour
- CE & UL Approved





› J1772 › Plug + Cable

Cable Colour Option › ■ Orange ■ Black

Type	DSI-EV16-70	Mating Force	≤80N
Colour	White	Mating Cycles	≥10000
Rated Current	16A/ 32A/ 63A/ 70A	Flame Retardant	UL94 V-0
Rated Voltage	500V	IP Rating	IP54
Test Voltage	2000V	Operating Temperature	-30°C to 60°C
Insulation Resistance	500MΩ	Cable Size	13mm ² - 2.5mm ²
Contact Resistance	0.055±0.005Ω	Plug Material	PC/Copper Alloy

	Series	Rated voltage	Rated current	Power	Cable size
1	DSI-EV70	240V AC	70 Amp	16.8KW	13mm ²
2	DSI-EV63	240V AC	63 Amp	15.1KW	10mm ²
3	DSI-EV32	240V AC	32 Amp	7.6KW	4mm ²
4	DSI-EV16	240V AC	16 Amp	3.8KW	2.5mm ²

Part Numbers

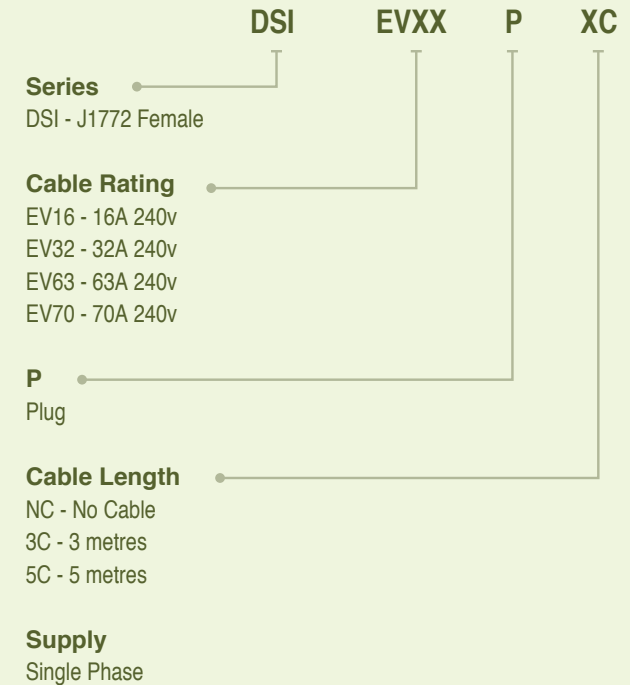

BUY ONLINE

www.evconnectors.com

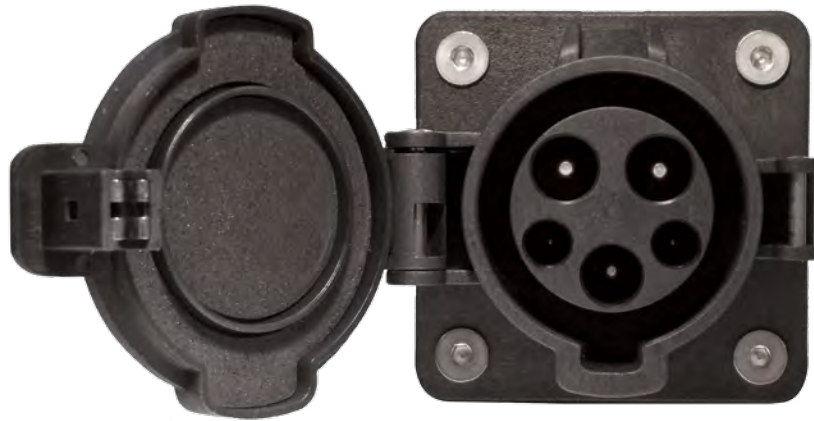

› J1772 › Male Socket / Inlet

- 4 Point Fixing
- Hinged Lid
- Low Contact Resistance
- CE & UL Approved

For Product Specifications See Page 7

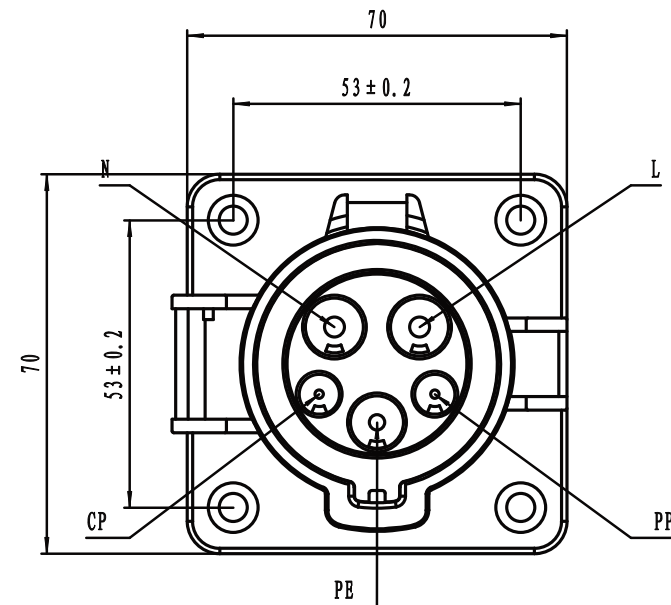

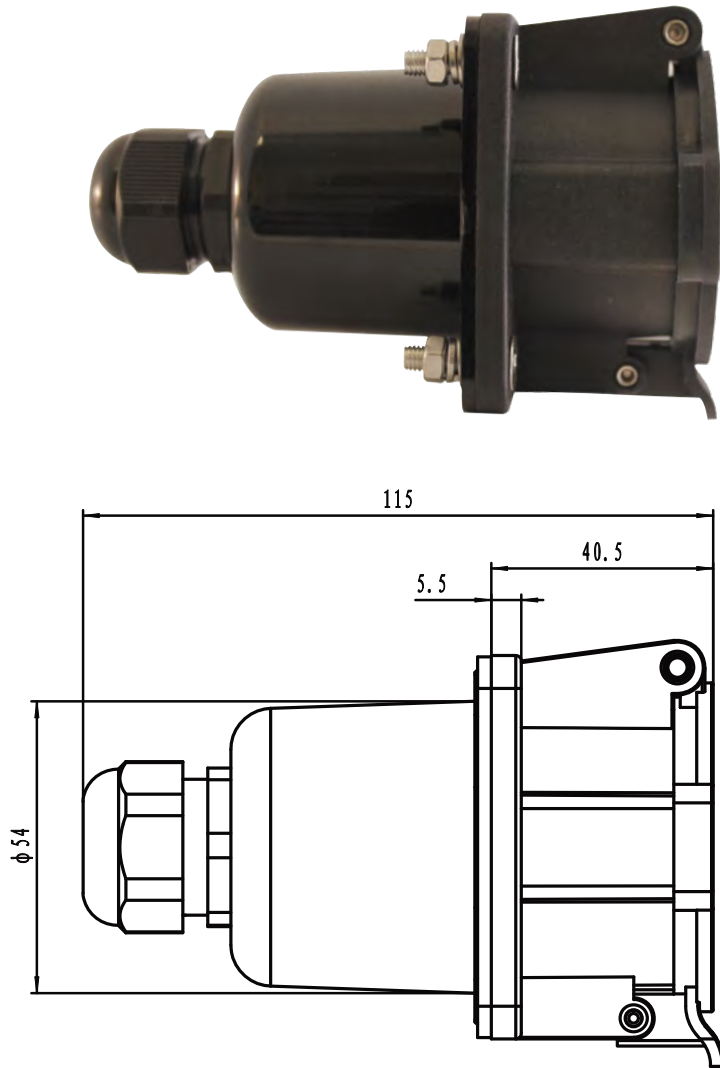

Part Numbers

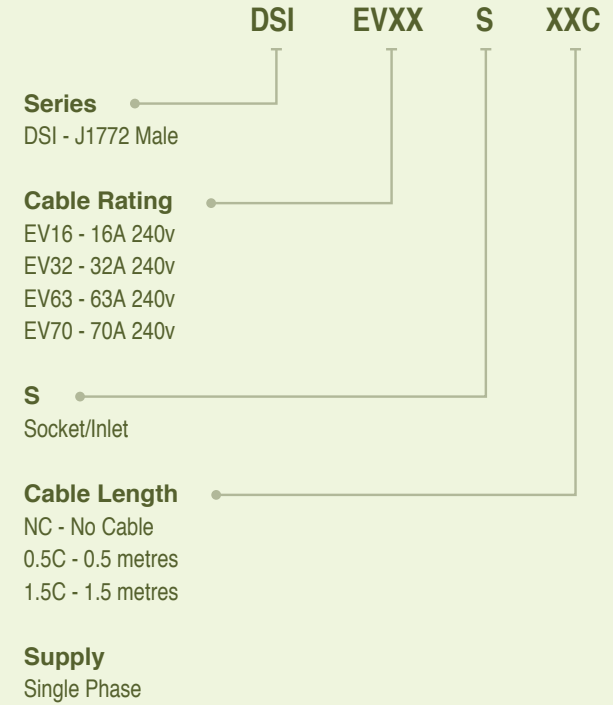

BUY ONLINE

www.evconnectors.com

› J1772 to 62196-2 › Female to Male Plug

- IP54 Rated Ergonomic Pistol Grip Style
- Impact Resistant 'Run Over' Proof
- 10,000 Mating Cycles
- Cable Strain Relief Feature
- Insulated Terminal Design
- J1772 Locking Feature for Padlock
- Dust Cap on Lanyard
- High Viz Orange Or Black Cable
- Custom Options on Cable Length and Colour
- CE & UL Approved





Cable Colour Option > Orange Black



CURLY CABLE
Available soon on all products

Part Numbers

DSI DSIEC EVXXP P XC

Series

DSI - J1772 Female
DSIEC - 62196-2 Male

Cable Rating

EV16 - 16A 240v
EV32 - 32A 240v
EV63 - 63A 240v

P

Plug

Cable Length

3C - 3 metres
5C - 5 metres

Supply

Single Phase



BUY ONLINE

www.evconnectors.com



› 62196-2 › Male Plug

- IP54 Rated Ergonomic Pistol Grip Style
- Impact Resistant 'Run Over' Proof
- 10,000 Mating Cycles
- Cable Strain Relief Feature
- Insulated Terminal Design
- Single and 3 Phase Cable
- Dust Cap on Lanyard
- High Viz Orange or Black Cable
- Custom Options on Cable Length and Colour
- CE & TUV Approved

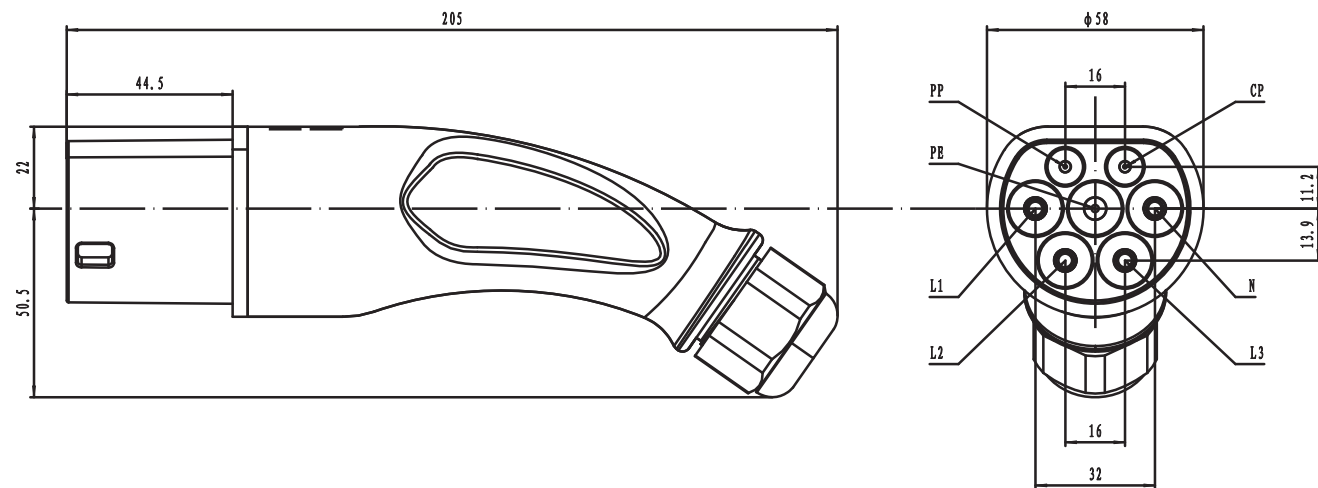



› 62196-2 › Male Plug + Cable



› 62196-2 › Male to Male Plug

Cable Colour Option ›  Orange  Black

Type	DSIEC-16-63	Mating Force	≤80N
Colour	White	Mating Cycles	≥10000
Rated Current	16A/ 32A/ 63A	Flame Retardant	UL94 V-0
Rated Voltage	500V	IP Rating	IP54
Test Voltage	2000V	Operating Temperature	-30°C to 60°C
Insulation Resistance	500MΩ	Cable Size	10mm ² - 2.5mm ²
Contact Resistance	0.055±0.005Ω	Plug Material	PC/Copper Alloy

	Series	Rated voltage	Rated current	Power	Cable size
1	DSIEC63	240 / 415V AC	63 Amp	15.1 / 45.3KW	10mm ²
2	DSIEC32	240 / 415V AC	32 Amp	7.6 / 22.8KW	6mm ²
3	DSIEC16	240 / 415V AC	16 Amp	3.8 / 11.5KW	2.5mm ²

Part Numbers

DSIEC 2 EVXX P XC 3

Series
DSIEC - 62196-2 Male

No. of Plugs
[blank] - Single Plug
2 - Plug to Plug

Cable Rating
EV16 - 16A 240-450v
EV32 - 32A 240-450v
EV63 - 63A 240-450v

P
Plug

Cable Length
NC - No Cable
3C - 3 metres
5C - 5 metres

Supply
[blank] - Single Phase
3 - Three Phase



BUY ONLINE

www.evconnectors.com



› 62196-2 › Female Socket › 3 Point Fixing

- 3 Point Fixing
- Water Drain
- Hinged Lid
- Electronic Locking Solenoid with Manual Override
- Solenoid Fixing options, Vertical, 120° or 240°
- Single and 3 Phase



For Product Specifications See Page 13

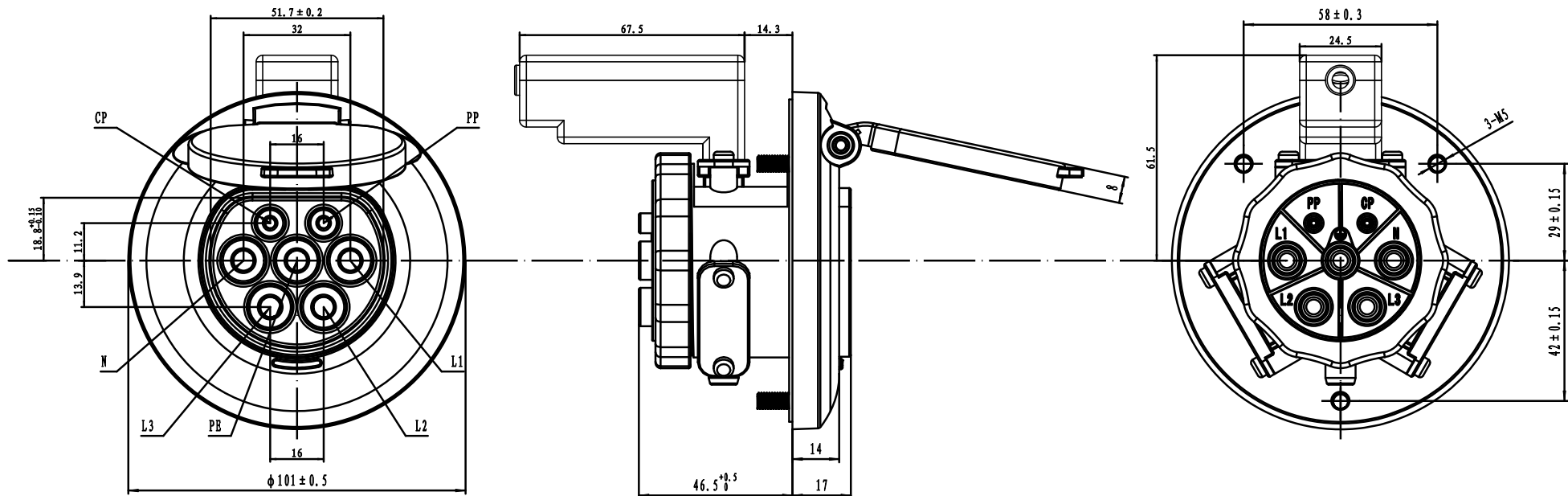

› 3 Point Fixing › Hinged Lid



› 3 Point Fixing › Locking Solenoid, Manual Override

Part Numbers

DSIEC EL/ELB G EVXX S XXC 3

Series

DSIEC - 62196-2 Female

Locking Solenoid

EL - Version 1 Pull Unlock

G - Hinged Lid

Cable Rating

EV16 - 16A 240-415v

EV32 - 32A 240-415v

EV63 - 63A 240-415v

S - Socket/Inlet

Cable Length

NC - No Cable

3C - 3 metres

5C - 5 metres

Supply

[blank] - Single Phase

3 - Three Phase



BUY ONLINE

www.evconnectors.com



› 62196-2 › Female Socket › 4 Point Fixing

- 4 Point Fixing
- Screw Termination - Field Wireable
- Water Drain
- Hinged Lid
- Electronic Locking Solenoid with Manual Override
- Single and 3 Phase



For Product Specifications See Page 13

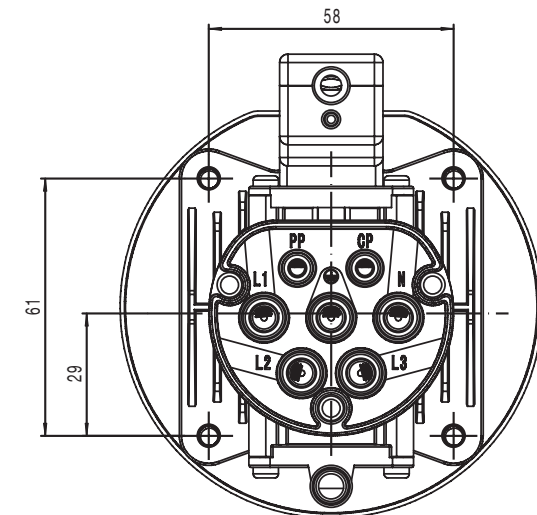
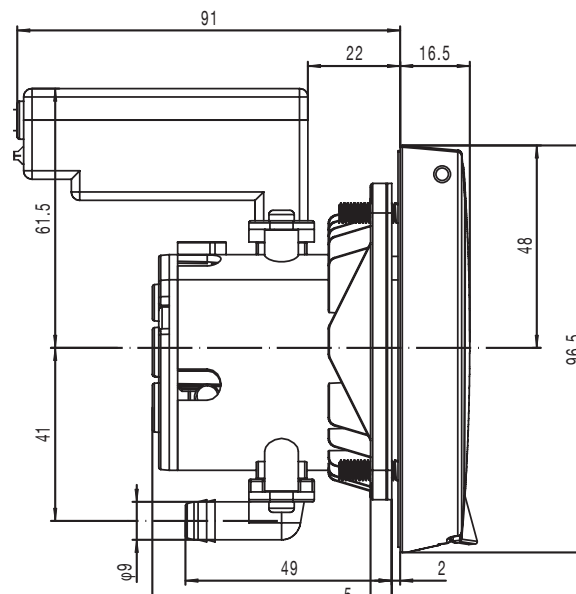
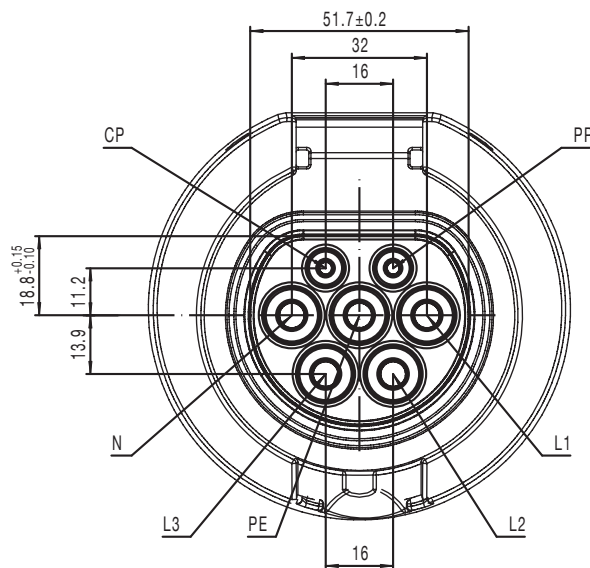

› 4 Point Fixing › Hinged Lid



› 4 Point Fixing › Locking Solenoid Manual Override



› Lever Release

› Pull Release

Part Numbers

DSIEC M EL/ELB G EVXX S XXC 3

Series

DSIEC - 62196-2 Female

M - Four Point Fixing

Locking Solenoid

EL - Version 1 Pull Unlock

ELB - Version 2 Lever Unlock

G - Hinged Lid

Cable Rating

EV16 - 16A 240-415v

EV32 - 32A 240-415v

EV63 - 63A 240-415v

S - Socket/Inlet

Cable Length

NC - No Cable

3C - 3 metres

5C - 5 metres

Supply

[blank] - Single Phase

3 - Three Phase



BUY ONLINE

www.evconnectors.com



› 62196-2 › Male Locking Inlet

- 4 Point Fixing
- Water Drain
- Dust Cap with Lanyard
- Gaiter Protection
- Cable with Conduit
- Water Drain
- Electronic Locking Solenoid with Manual Override
- Solenoid Fixing options, Vertical, 120° or 240°
- Single and 3 Phase

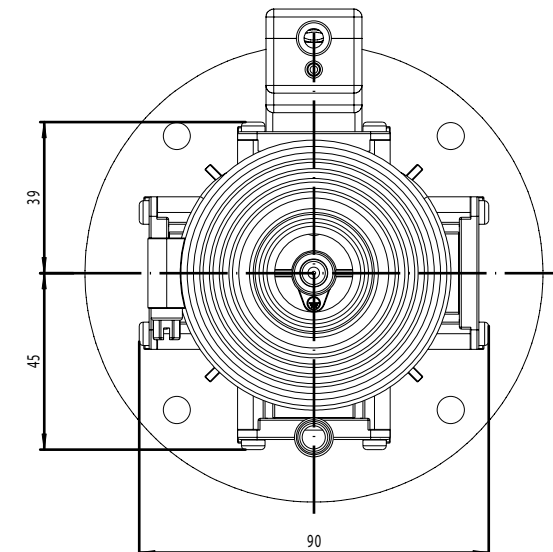
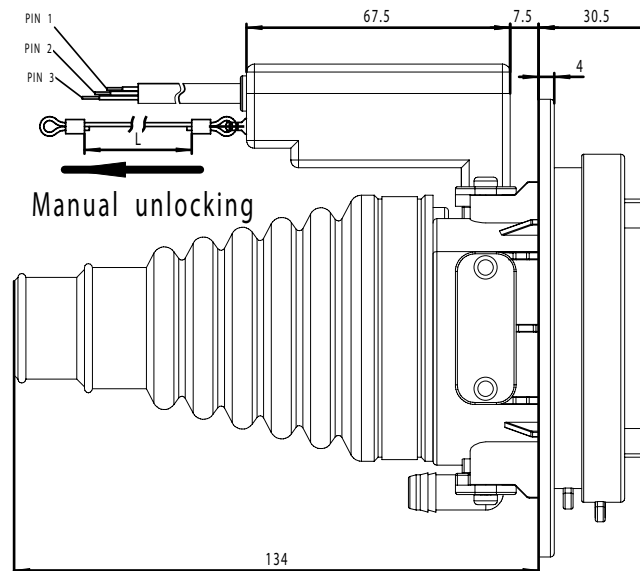
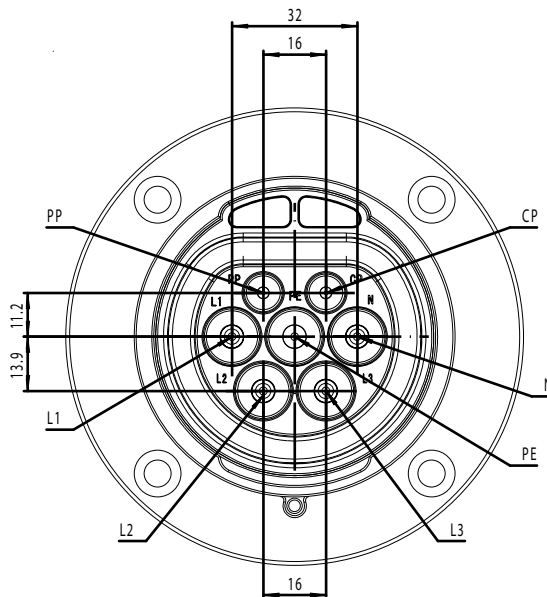



› Male Locking Socket + Cable



Part Numbers

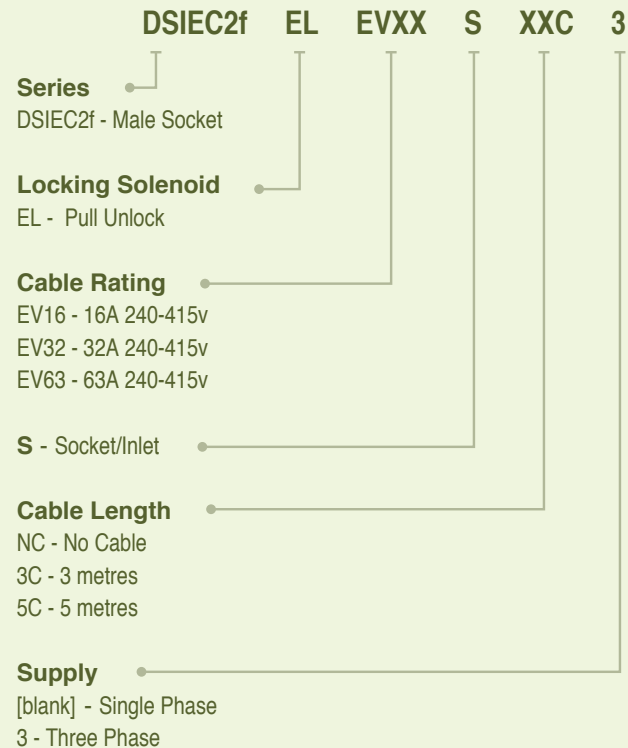

BUY ONLINE

www.evconnectors.com

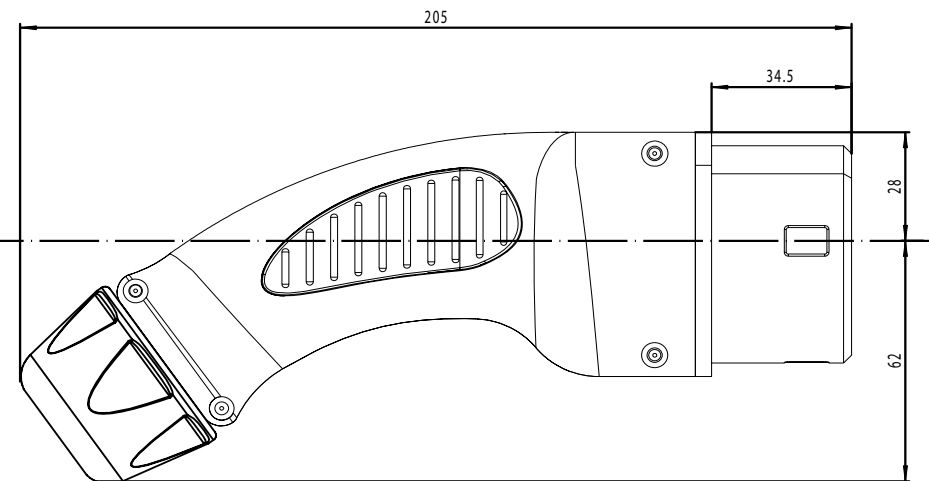
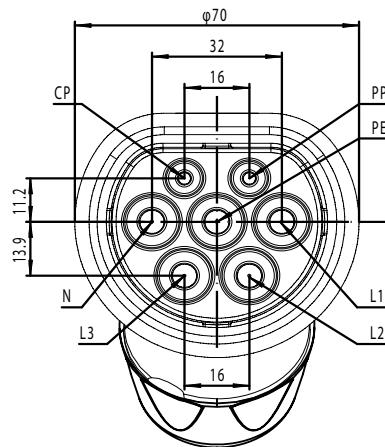

› 62196-2 › Female Plug

- IP54 Rated Ergonomic Pistol Grip Style
- Impact Resistant 'Run Over' Proof
- 10,000 Mating Cycles
- Cable Strain Relief Feature
- Insulated Terminal Design
- Single and 3 Phase Cable
- Dust Cap on Lanyard
- High Viz Orange or Black Cable
- Custom Options on Cable Length and Colour
- CE & TUV Approved





› 62196-2 › Female Plug + Cable

Cable Colour Option › ■ Orange ■ Black

Type	DSIEC-16-63	Mating Force	≤80N
Colour	White	Mating Cycles	≥10000
Rated Current	16A/ 32A/ 63A	Flame Retardant	UL94 V-0
Rated Voltage	500V	IP Rating	IP54
Test Voltage	2000V	Operating Temperature	-30°C to 60°C
Insulation Resistance	500MΩ	Cable Size	10mm ² - 2.5mm ²
Contact Resistance	0.055±0.005Ω	Plug Material	PC/Copper Alloy

	Series	Rated voltage	Rated current	Power	Cable size
1	DSIEC63	240 / 415V AC	63 Amp	15.1 / 45.3KW	10mm ²
2	DSIEC32	240 / 415V AC	32 Amp	7.6 / 22.8KW	6mm ²
3	DSIEC16	240 / 415V AC	16 Amp	3.8 / 11.5KW	2.5mm ²

Part Numbers

DSIEC2e EVXX P XXC 3

Series
DSIEC2e - Female Plug

Cable Rating
EV16 - 16A 240-450v
EV32 - 32A 240-450v
EV63 - 63A 240-450v

P
Plug

Cable Length
NC - No Cable
3C - 3 metres
5C - 5 metres

Supply
[blank] - Single Phase
3 - Three Phase



BUY ONLINE

www.evconnectors.com

› 62196-2

› Male to Female Plugs

- IP54 Rated Ergonomic Pistol Grip Style
- Impact Resistant 'Run Over' Proof
- 10,000 Mating Cycles
- Cable Strain Relief Feature
- Insulated Terminal Design
- Single and 3 Phase Cable
- Dust Cap on Lanyard
- High Viz Orange or Black Cable
- Custom Options on Cable Length and Colour
- CE & TUV Approved





Cable Colour Option > Orange Black

Type	DSIEC-16-63	Mating Force	≤80N
Colour	White	Mating Cycles	≥10000
Rated Current	16A/ 32A/ 63A	Flame Retardant	UL94 V-0
Rated Voltage	500V	IP Rating	IP54
Test Voltage	2000V	Operating Temperature	-30°C to 60°C
Insulation Resistance	500MΩ	Cable Size	10mm ² - 2.5mm ²
Contact Resistance	0.055±0.005Ω	Plug Material	PC/Copper Alloy

	Series	Rated voltage	Rated current	Power	Cable size
1	DSIEC63	240 / 415V AC	63 Amp	15.1 / 45.3KW	10mm ²
2	DSIEC32	240 / 415V AC	32 Amp	7.6 / 22.8KW	6mm ²
3	DSIEC16	240 / 415V AC	16 Amp	3.8 / 11.5KW	2.5mm ²

Part Numbers

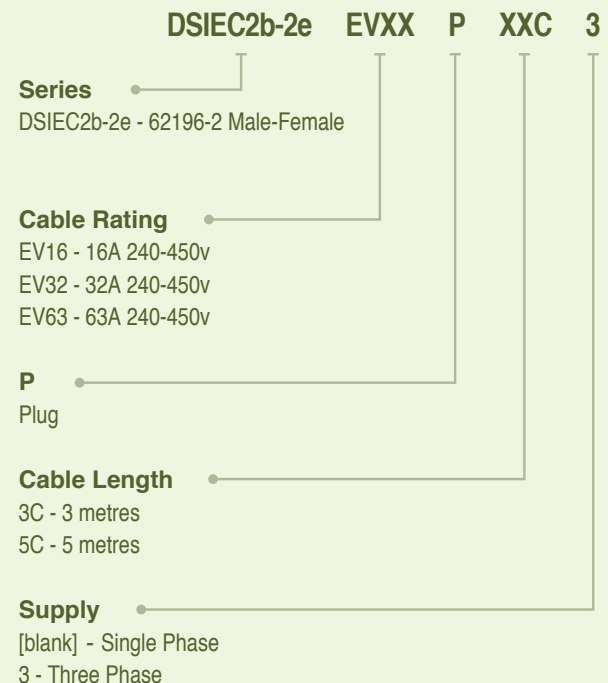

BUY ONLINE

www.evconnectors.com



› EV Tester

The electric vehicle charging station test system is designed to fully test a charging point for compliance with IEC61851 mode 3.

Housed in a “Peli” GRP enclosure, the system is lightweight, portable and extremely rugged.

- For use with Single or 3 Phase Mode 3 EV Charger Points
- Two meter Tethered Cable with 62196-2 Plug
- Peli IP Rated GPR Enclosure
- Contactor Fault Detection
- Provides for State A,B,C and D as per IEC618651
- Code Resistor Testing
- Integrated 13A Socket for Test Equipment

BUY ONLINE

www.evconnectors.com



» EV Rescue

Worlds first **TOTALLY PORTABLE EV POWER**

- Standalone Power for Roadside Assistance or Showroom use
- Unique 5kW Portable EV Charging System
- Type 2 Socket with Mode 3 Communication
- Easy to use Rugged Controls
- Optional GSM Communication & Smartphone APP
- Cost effective solution for Recovery Specialist and Fleet Management





Tel: 01371 811230
Fax: 01371 810933
Email: sales@evconnectors.com

EVconnectors Ltd.
14 Bluegate Business Park
Great Bardfield
Essex
CM7 4PZ

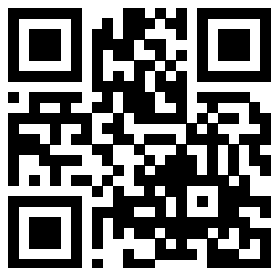

www.evconnectors.com