



**IntegriFuse**<sup>TM</sup>

# Electrofusion Fittings

Couplers | Saddles

Threaded Saddles

Specialty Fittings





# SDR 11 Electrofusion Coupler | IPS Series

Water - 200 PSI (ASTM) / 232 PSI (ISO) | Gas - 100 PSI @ 73° F Sustainable Maximum Operating Pressure

Suitable for use on IPS SDR 9 to SDR 17 HDPE Pipe (Fusing from SDR 21 to SDR 32.5 may require special barcode)

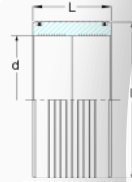
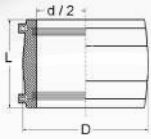

Nominal Size	OD	D	L	Weight	Item Code	FM Class
1" IPS	1.315"	1.7"	3.4"	0.1 lbs.	200302	FM 200/232
1 ¼" IPS	1.660"	2.2"	3.7"	0.2 lbs.	200303	FM 200/232
1 ½" IPS	1.900"	2.7"	3.9"	0.4 lbs.	200304	FM 200/232
2" IPS	2.375"	3.2"	4.6"	0.5 lbs.	200305	FM 200/232
3" IPS	3.500"	4.4"	5.0"	0.9 lbs.	200307	FM 200/232
4" IPS	4.500"	5.9"	5.9"	2.1 lbs.	200310	FM 200/232
5" IPS	5.563"	6.9"	6.5"	2.9 lbs.	200312	FM 200/232
6" IPS	6.625"	8.7"	7.9"	5.3 lbs.	200314	FM 200/232
8" IPS	8.625"	10.7"	8.9"	8.6 lbs.	200317	FM 200/232
10" IPS	10.750"	13.3"	9.8"	15.4 lbs.	200320	FM 200/232
12" IPS	12.750"	15.9"	11.4"	24.3 lbs.	200323	FM 200/232
14" IPS	14.000"	17.2"	11.8"	30.9 lbs.	200326	FM 200/232
16" IPS (1)	16.000"	19.8"	13.9"	40.1 lbs.	200329	FM 200/232
18" IPS (1)	18.000"	22.3"	16.7"	65.3 lbs.	200332	FM 200/232
20" IPS (1)	20.000"	24.8"	18.0"	99.2 lbs.	200335	FM 200/232
22" IPS (1)	22.000"	27.4"	19.5"	121.3 lbs.	200336	FM 200/232
24" IPS (1)	24.000"	30.6"	19.8"	160.9 lbs.	200338	FM 200/232
26" IPS (1)(2)	26.000"	31.9"	20.2"	172.0 lbs.	200339	FM 200
28" IPS (1)(2)	28.000"	34.5"	20.7"	176.4 lbs.	200341	FM 200
30" IPS (1)(2)	30.000"	37.0"	20.7"	237.7 lbs.	200343	
32" IPS (1)(2)	32.000"	39.6"	20.7"	264.6 lbs.	200345	
34" IPS (1)(2)	34.000"	42.1"	21.7"	308.7 lbs.	200356	
36" IPS (1)(2)	36.000"	44.1"	21.1"	319.7 lbs.	200347	
42" IPS (1)(2)	42.000"	51.2"	22.6"	465.2 lbs.	200349	
48" IPS (1)(2)	48.000"	58.7"	26.2"	661.4 lbs.	200351	



## SDR 11 Electrofusion Coupler | DIPS Series

Water - 200 PSI (ASTM) / 232 PSI (ISO) | Gas - 100 PSI @ 73° F Sustainable Maximum Operating Pressure

Suitable for use on IPS SDR 9 to SDR 17 HDPE Pipe

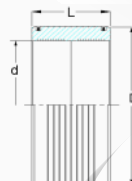
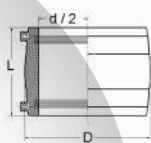

Nominal Size	OD	D	L	Weight	Item Code	FM Class
4" DIPS	4.800"	6.0"	6.1"	2.0 lbs.	200309	FM 200/232
6" DIPS	6.900"	8.5"	7.5"	5.1 lbs.	200313	FM 200/232
8" DIPS	9.050"	11.2"	8.6"	9.9 lbs.	200316	FM 200/232
10" DIPS	11.100"	13.6"	9.8"	14.9 lbs.	200319	FM 200/232
12" DIPS	13.200"	16.3"	11.8"	25.6 lbs.	200322	FM 200/232
14" DIPS (1)	15.300"	18.9"	13.9"	41.3 lbs.	200325	FM 200/232
16" DIPS (1)	17.400"	21.3"	16.6"	62.2 lbs.	200328	FM 200/232
18" DIPS (1)	19.500"	25.0"	17.9"	102.5 lbs.	200331	FM 200/232
20" DIPS (1)	21.600"	27.4"	19.5"	132.3 lbs.	200334	FM 200/232
24" DIPS (1)(2)	25.800"	31.9"	20.3"	176.4 lbs.	200337	FM 200/232
30" DIPS (1)(2)	32.000"	39.6"	20.7"	264.6 lbs.	200356	
36" DIPS (1)(2)	38.300"	47.4"	22.8"			Special Order
42" DIPS (1)(2)	44.500"	54.0"	25.2"			Special Order
48" DIPS (1)(2)	50.800"					Special Order



## SDR 11 Electrofusion Coupler | CTS Series

Water - 200 PSI (ASTM) / 232 PSI (ISO) | Gas - 100 PSI @ 73° F Sustainable Maximum Operating Pressure

Suitable for use on IPS SDR 9 to SDR 17 HDPE Pipe

Nominal Size	OD	D	L	Weight	Item Code
½" CTS	0.840"	1.61"	2.80"	0.1 lbs.	290400
¾" CTS	1.050"	1.61"	2.80"	0.1 lbs.	290402

(1) Dual fusion zones

(2) Requires the I Fuse 105 EF Processor for fusion





# SDR 7 Electrofusion Coupler | IPS Series

Water - 330 PSI (ASTM) / 362 PSI (ISO) | Gas - 125 PSI @ 73° F Sustainable Maximum Operating Pressure

Suitable for use on IPS SDR 7 to SDR 9 HDPE Pipe

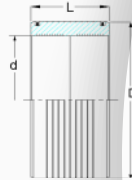
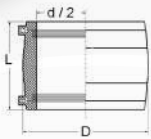

Nominal Size	OD	D	L	Weight	Item Code	FM Class
2" IPS	2.375"	3.46"	4.53"	0.7 lbs.	200306	FM 267/400
3" IPS	3.500"	4.92"	5.20"	1.5 lbs.	200308	FM 267/400
4" IPS	4.500"	6.30"	6.30"	3.0 lbs.	200311	FM 267/400
6" IPS	6.625"	9.33"	7.87"	8.2 lbs.	200315	FM 267/400
8" IPS	8.625"	12.13"	9.84"	17.1 lbs.	200318	FM 267/400
10" IPS	10.750"	15.16"	10.83"	30.2 lbs.	200321	FM 267/400
12" IPS	12.750"	18.50"	13.94"	65.0 lbs.	200324	FM 267/400
14" IPS	14.000"	19.53"	13.78"	67.4 lbs.	200327	FM 267/400
16" IPS (1)	16.000"	22.44"	15.87"	101 lbs.	200330	FM 267/400
18" IPS (1)	18.000"	25.00"	17.91"	139 lbs.	200333	FM 267/400
20" IPS (1)	20.000"	28.00"	18.50"		200357	FM 267/400
22" IPS (1)	22.000"	30.90"	19.70"		200358	FM 267/400
24" IPS (1)	24.000"	33.60"	20.70"		200359	FM 267/400

(1) Dual fusion zones

(2) Requires the I Fuse 105 EF Processor for fusion



## SDR 17 Electrofusion Coupler | IPS Series

Water - 125 PSI (ASTM) / 145 PSI (ISO) @ 73° F Sustainable Maximum Operating Pressure

Suitable for use on IPS SDR 17 to SDR 26 HDPE Pipe (Barcodes for SDR 32.5 upon request)

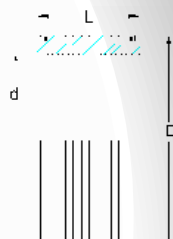

Nominal Size	OD	D	L	Weight	Item Code	FM Class
22" IPS (1)	22.000"	25.0"	17.9"		200360	FM 150
24" IPS (1)	24.000"	28.0"	19.9"		200361	FM 150
26" IPS (1) (2)	26.000"	29.6"	19.7"		200362	FM 150
28" IPS (1) (2)	28.000"	31.9"	19.3"	115 lbs.	200340	FM 150
30" IPS (1) (2)	30.000"	34.3"	19.3"	152 lbs.	200342	FM 150
32" IPS (1) (2)	32.000"	36.6"	19.7"	168 lbs.	200344	FM 150
34" IPS (1) (2)	34.000"	38.7"	20.5"		200363	FM 150
36" IPS (1) (2)	36.000"	40.9"	20.1"		200346	FM 150
42" IPS (1) (2)	42.000"	48.0"	21.3"	278 lbs.	200348	FM 150
48" IPS (1) (2)	48.000"	54.5"	25.2"	353 lbs.	200350	FM 150
54" IPS (1) (2)	54.000"	61.3"	24.8"		200355	SDR 15.5/17

(1) Dual fusion zones

(2) Requires the I Fuse 105 EF Processor for fusion



# SDR 26 Electrofusion Coupler | IPS Series

Water - 80 PSI (ASTM) / 91 PSI (ISO) @ 73° F Sustainable Maximum Operating Pressure

Suitable for use on IPS SDR 26 to SDR 41 HDPE Pipe

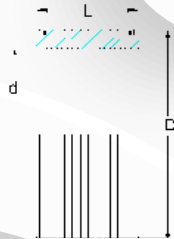

Nominal Size	OD	D	L	Item Code
28" IPS (1) (2)	28.000"	30.55"	13.78"	200400
30" IPS (1) (2)	30.000"	33.46"	15.35"	200401
32" IPS (1) (2)	32.000"	35.63"	16.73"	200402
36" IPS (1) (2)	36.000"	39.88"	16.73"	200403
42" IPS (1) (2)	42.000"	47.64"	17.72"	200404
48" IPS (1) (2)	48.000"	52.36"	17.72"	200405
54" IPS (1) (2)	54.000"			

(1) Dual fusion zones

(2) Requires the I Fuse 105 EF Processor for fusion

# IntegriFuse™

## Electrofusion

### What makes these fittings so different?

Integrity Fusion Products has been the leader in providing cutting edge electrofusion fittings since 2007. We have continued to improve electrofusion technology over the years. Here are a few unique features of our IntegriFuse Electrofusion Fittings.

#### All IntegriFuse Electrofusion Fittings Feature:

- No pre-heat barcodes required
- Melt Indicators on every fitting
- Pressure test the fittings immediately after the listed cool time
- Traceability Barcodes on every fitting
- Backed by 30+ years of experience in designing, developing, and producing electrofusion fittings & equipment with strict quality management standards
- Certified to NSF 61 and AWWA C901 / C 906

#### All IntegriFuse EF Couplers:

- Available in SDR 7 - 9, 11 - 17, 17 - 26, and 32.5
- FM 200 / FM 232 or FM 267 / FM 400 Designation

#### IntegriFuse EF Branch Saddles:

- All straps needed are included for hassle free installation
- Larger fusion area to provide greater surface melt
- Flex Base Option in Most Sizes which:
  - Cover IPS & DIPS & multiple size pipe range
  - Reduce Inventory Parts Needed
  - Fully pressure rated
- FM Approvals

#### IntegriFuse Large Diameter Electrofusion Couplers:

- Utilizes Higher Amperage (105A) to create more heat, allowing the pipe to expand to help reduce any gaps between the pipe and coupler
- Higher amperage allows for larger gaps to start the fusion process
- Wider Fusion zone to allow for greater surface melt
- Deeper melt penetration due to higher amperage and more melt
- Wider cold zones allowing for more flexibility in pipe stab depth
- All couplers through 54" are injection molded (not fabricated out of pipe or billet as other brands)
- Cooling time listed on coupler indicates when the fitting joint can be fully pressure tested

