

# Emerald Waterways cabin plans

## Owner's One-bedroom Suite CAT SA

Our Owner's One-bedroom Suites boast their very own bedroom which closes off from the rest of the cabin; a separate lounge area; and a fantastic outdoor balcony complete with open-air system, allowing you to enjoy the views of your surroundings whatever the weather.

These cabins also include a selection of special features, a spacious bathroom, a luxurious walk-in closet, a complimentary Nespresso machine and a complimentary mini-bar restocked daily with wine, beer and soft drinks. So that you can keep up-to-date with the latest news, you'll have an iPad to make use of throughout your cruise. And in order to offer you a more intimate dining experience, you can order a continental breakfast, pre-dinner canapés and after-dinner sweet treats to enjoy in the privacy of your suite's lounge or outdoors on your balcony.

- 29m<sup>2</sup> / 315ft<sup>2</sup> ■ Outdoor private balcony with open-air system ■ Separate bedroom and lounge area ■ Bathroom with shower, indulgent toiletries, hair dryer, onboard complimentary bathrobes and slippers ■ Walk-in closet ■ Complimentary in-suite mini-bar, restocked daily with wine, beer and soft drinks ■ Complimentary bottled water, restocked daily ■ Complimentary Nespresso machine ■ Complimentary WiFi ■ Use of an iPad ■ Queen-size or twin beds ■ Pillow menu ■ Telephone ■ Safe for your valuables ■ Individual climate control ■ Flat screen TV and infotainment system ■ Continental breakfast, pre-dinner canapés and after-dinner sweet treats served in your suite ■ Four items of laundry a day ■ Invite to dinner at the Captain's Table

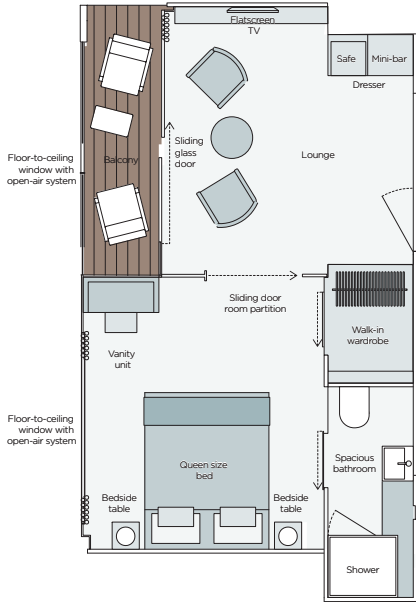

Owner's One-bedroom Suite

## Grand Balcony Suite CAT 5

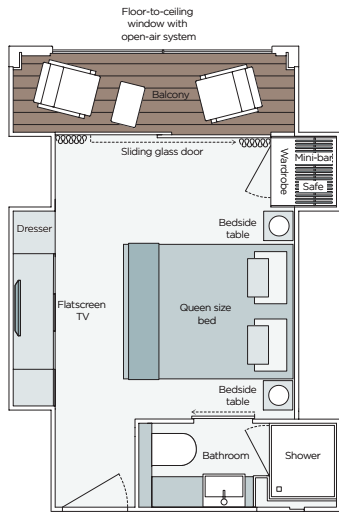

Each of our Grand Balcony Suites boasts a number of fantastic inclusions, such as an in-suite Nespresso machine – an added home comfort that means that you can relax with a hot beverage at any time, day or night. You'll also have the option to order a delicious continental breakfast to enjoy on the balcony. And for the perfect start and finish to your evening meal, you can enjoy pre-dinner canapés and after-dinner sweets courtesy of your exclusive room service, which is included in the price of your suite.

Grand Balcony Suites also offer a spacious outdoor balcony, allowing you to make the most of your cruise's beautiful landscapes and take in the fresh air. And should the weather take a turn for the worse, you needn't worry because all it takes is the touch of a button and our state-of-the-art open-air system window rises from the balcony and encloses the area so that you can still sit out and admire the views together, or unwind with a drink.

- 19.5m<sup>2</sup> / 210ft<sup>2</sup> ■ Outdoor private balcony with open-air system ■ Bathroom with shower, indulgent toiletries, hair dryer, onboard complimentary bathrobes and slippers
- In-suite mini-bar available at own expense ■ Complimentary bottled water, restocked daily
- Complimentary Nespresso machine ■ Complimentary WiFi ■ Queen-size or twin hotel-style beds
- Pillow menu ■ Telephone ■ Safe for your valuables ■ Individual climate control
- Flat screen TV and infotainment system ■ Continental breakfast, pre-dinner canapés and after-dinner sweet treats served in your suite
- Two items of laundry a day



Grand Balcony Suite Bathroom



Grand Balcony Suite

# Emerald Waterways cabin plans

## Emerald Panorama Balcony Suite

CAT C CAT B CAT A CAT R CAT P

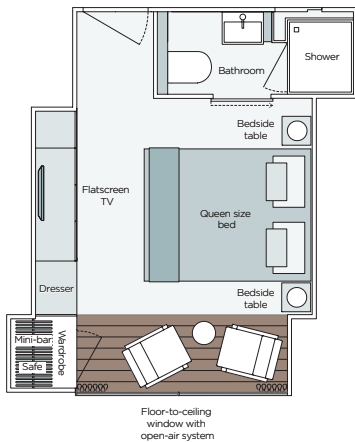

We've put every effort into designing beautiful staterooms and suites, selecting the most elegant décor and furnishings to create a haven for you to relax in as you sail through the most picturesque landscapes. But with our Emerald Panorama Balcony Suite, we've gone one step further and created a completely new type of cabin that's unique to European river cruising. These spectacular suites boast our revolutionary indoor balcony design, complete with decking area, table and chairs – generating an entirely new space for you to enjoy the landscapes you pass. With the touch of a button, the upper part of the cabin's floor-to-ceiling window drops down to unveil uninterrupted views of the stunning scenery, opening up the cabin and bringing the outdoors in.

In our Emerald Panorama Balcony Suites, you'll also find a mini-fridge – perfect for storing any gifts that need keeping cool, such as chocolates, confectionery or special local drinks. You can use your mini-fridge to keep your complimentary bottled water cool too.

- 16.7m<sup>2</sup> / 180ft<sup>2</sup>
- Indoor balcony with open-air system
- Bathroom with shower, indulgent toiletries and hair dryer
- Complimentary bottled water, restocked daily
- Complimentary WiFi
- Queen-size or twin hotel-style beds
- Telephone
- Safe for your valuables
- Individual climate control
- Flat screen TV and infotainment system
- Mini-fridge



Emerald Panorama Balcony Suite

**Important information:** The cabin plans and photographs are an indication only and may vary from ship to ship.

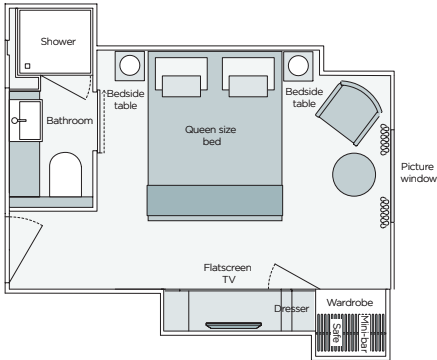

## Emerald Stateroom CAT E CAT D

All Emerald Staterooms feature picture windows and the same high quality facilities as all other cabins. Plus, they're bigger than other standard staterooms, providing excellent value for money.

- 15m<sup>2</sup> / 162ft<sup>2</sup> ■ Picture window (150cm x 34cm) ■ Bathroom with shower, indulgent toiletries and hair dryer ■ Complimentary bottled water, restocked daily ■ Complimentary WiFi ■ Queen-size or twin hotel-style beds ■ Telephone ■ Safe for your valuables ■ Individual climate control ■ Flat screen TV and infotainment system ■ Mini-fridge

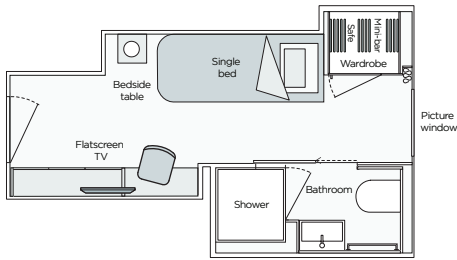

## Emerald Single Stateroom CAT ES

Each ship also offers two Emerald Single Staterooms featuring picture windows and the same high quality facilities as all other cabins. With their deluxe single bed, they provide excellent value for money for single guests.

- 10.9m<sup>2</sup> / 117ft<sup>2</sup> ■ Picture window ■ Bathroom with shower, indulgent toiletries and hair dryer ■ Complimentary bottled water, restocked daily ■ Complimentary WiFi ■ Telephone ■ Safe for your valuables ■ Individual climate control ■ Flat screen TV and infotainment system ■ Mini-fridge

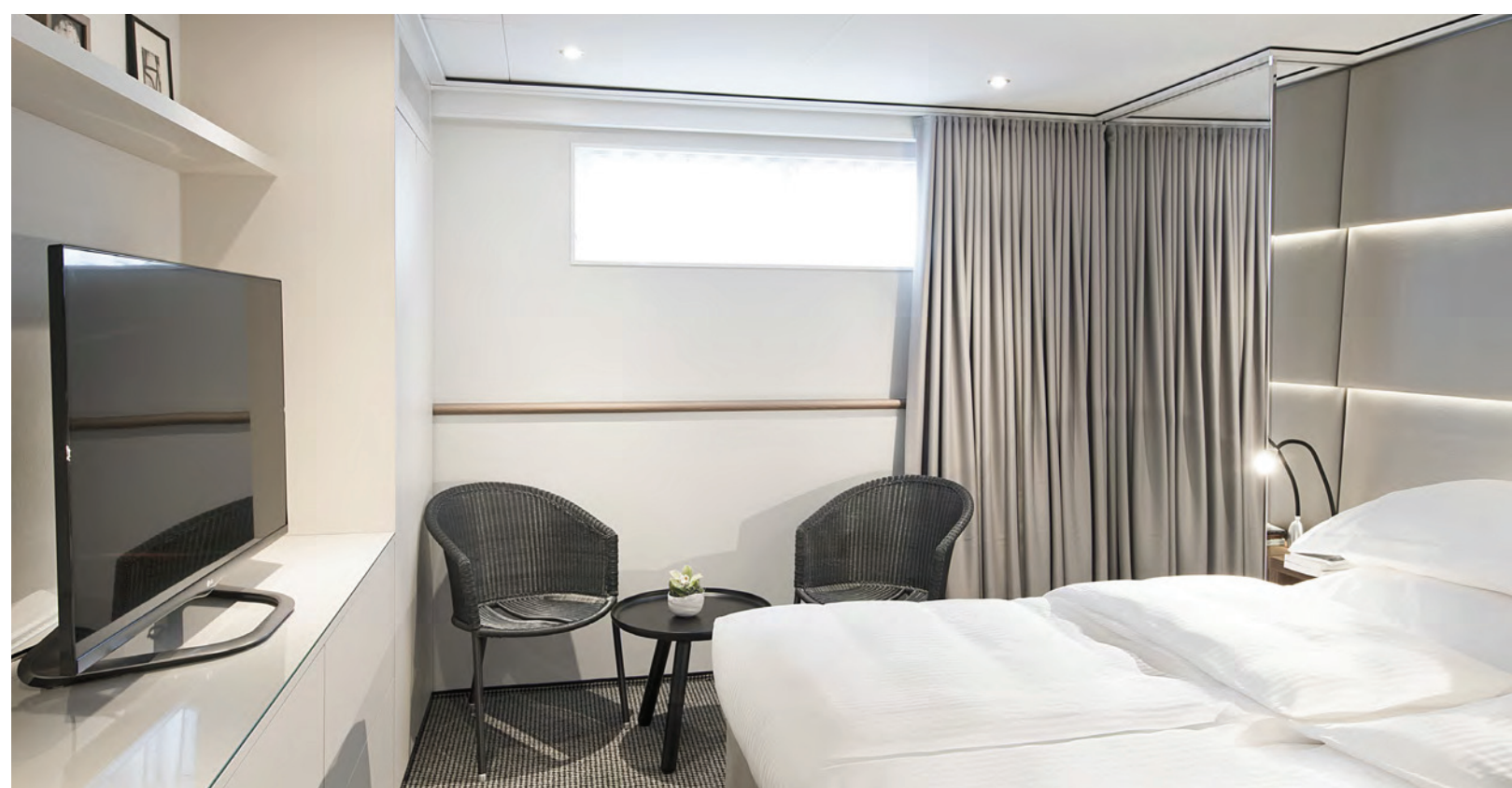

Emerald Stateroom

# Emerald Waterways deck plan

- Emerald Star / Emerald Sky / Emerald Dawn / Emerald Sun / Emerald Belle
- Draft: 1.45m
- Height: 6m
- Length: 135m
- Width: 11.45m
- Speed: 25km/h
- Crew Members: 47
- Staterooms: 20
- Suites: 72
- Guests: 182
- Year of construction: 2014 / 15

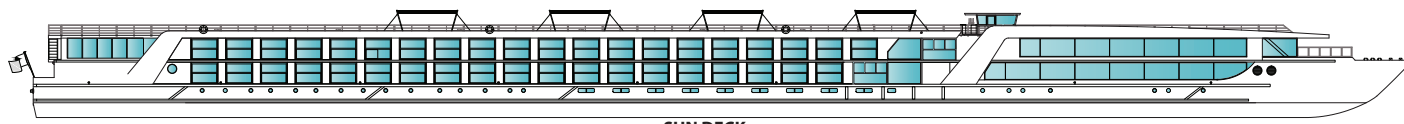

Sun Deck

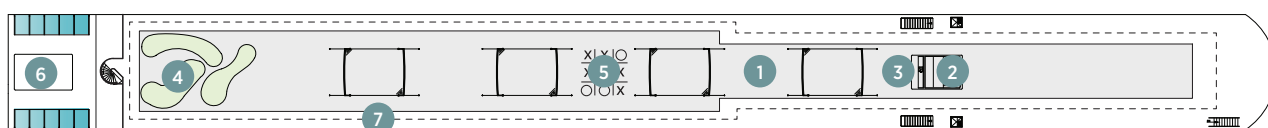

Horizon Deck

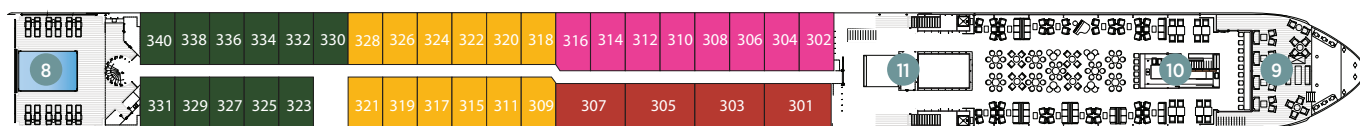

Vista Deck

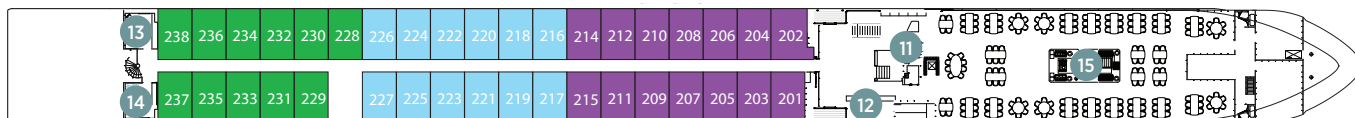

Riviera Deck

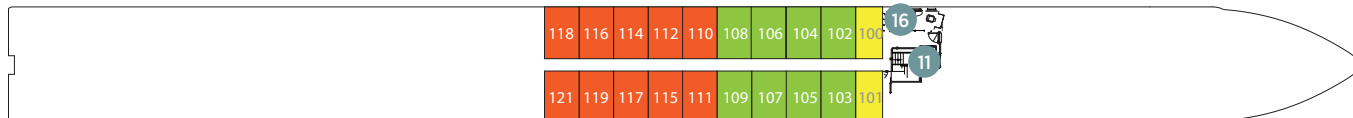

- |               |   |           |                                     |           |                        |
|---------------|---|-----------|-------------------------------------|-----------|------------------------|
| <b>CAT E</b>  | Riviera Deck - Emerald Stateroom - 162 ft <sup>2</sup>              | <b>1</b>  | Sun Deck with Deck Chairs           | <b>11</b> | Lift                   |
| <b>CAT D</b>  | Riviera Deck - Emerald Stateroom - 162 ft <sup>2</sup>              | <b>2</b>  | Navigation Bridge                   | <b>12</b> | Reception              |
| <b>CAT ES</b> | Riviera Deck - Emerald Single Stateroom - 117 ft <sup>2</sup>       | <b>3</b>  | Sky Barbecue                        | <b>13</b> | Wellness Area          |
| <b>CAT C</b>  | Vista Deck - Emerald Panorama Balcony Suite - 180 ft <sup>2</sup>   | <b>4</b>  | Golf Putting Green                  | <b>14</b> | Fitness Area           |
| <b>CAT B</b>  | Vista Deck - Emerald Panorama Balcony Suite - 180 ft <sup>2</sup>   | <b>5</b>  | Games Area                          | <b>15</b> | Reflections Restaurant |
| <b>CAT A</b>  | Vista Deck - Emerald Panorama Balcony Suite - 180 ft <sup>2</sup>   | <b>6</b>  | Retractable Glass Roof              | <b>16</b> | Hairdresser            |
| <b>CAT R</b>  | Horizon Deck - Emerald Panorama Balcony Suite - 180 ft <sup>2</sup> | <b>7</b>  | Walking Track                       |           |                        |
| <b>CAT P</b>  | Horizon Deck - Emerald Panorama Balcony Suite - 180 ft <sup>2</sup> | <b>8</b>  | Daytime Pool & Bar / Evening Cinema |           |                        |
| <b>CAT S</b>  | Horizon Deck - Grand Balcony Suite - 210 ft <sup>2</sup>            | <b>9</b>  | The Terrace                         |           |                        |
| <b>CAT SA</b> | Horizon Deck - Owner's One-bedroom Suite - 315 ft <sup>2</sup>      | <b>10</b> | Horizon Bar and Lounge              |           |                        |

**Important information:** Cabin 202 has modified entry, bathroom configuration with personal assistance fittings and has no decked area with table and chairs. The deckplan and cabin layout images are an indication only and may vary.